



Certificate of Appropriateness

Milwaukee Historic Preservation Commission/841 N Broadway/Milwaukee, WI 53202/phone 414-286-5722

Property Description of work

2044 N. Lake Dr., North Point South Historic District

Install an exhaust for two bathrooms on the back of the house. Exhaust to be painted to match exterior wall. Replace a wall-mounted air conditioning unit on the back of the house with an all-wood Marvin window with simulated divided lights per the attached specs.

Date issued 6/23/2025

In accordance with the provisions of Section 320-21 (11) and (12) of the Milwaukee Code of Ordinances, the Milwaukee Historic Preservation Commission has issued a certificate of appropriateness for the work listed above. The work was found to be consistent with preservation guidelines. The following conditions apply to this certificate of appropriateness:

N/A

All work must be done in a craftsman-like manner. Staff must approve any changes or additions to this certificate before work begins. Work that is not completed in accordance with this certificate may be subject to correction orders or citations. If you require technical assistance, please contact Historic Preservation staff as follows: Phone: (414) 286-5722 E-mail: hpc@milwaukee.gov.

Permits and timeline

You are responsible for determining if permits are required and obtaining them prior to commencing work. Consult the Development Center on the web or by telephone for details: www.milwaukee.gov/lms - (414) 286-8210. If permits are not required, work must be completed within one year of the date this certificate was issued. If permits are required, permits must be obtained within one year of the date this certificate was issued.

City of Milwaukee Historic Preservation

Copies to: Development Center

FOUR PAGES TO FOLLOW

SINGLE BATH FAN VENT
TO TERMINATE
SOMEWHERE WITHIN
DASHED LINES. UP TO 6"
DIAMETER. SEE NEXT
PAGE FOR VENT
TERMINATION COVER.



PRODUCT: COPPER WALL VENT CAP (__WVC_)

MATERIALS: COPPER

SIZES: 3" - 10" | SCREEN ONLY, DAMPER ONLY, DAMPER & SCREEN



PRODUCT HIGHLIGHTS

THE WALL CAP IS IDEAL FOR USE WITH THE DAMPER ONLY DRYER VENTING, KITCHEN FAN EXHAUST, BATH FAN EXHAUST, FURNACE AIR INTAKE (SCREEN ONLY), WHOLE HOUSE VENTILATIONS, AND HRV'S. VENTS WITH DAMPERS COME STANDARD WITH A SPRING CLOSURE DAMPER AND WEATHER SEAL FOR INCREASED ENERGY

- SPRING CLOSE FOAM LINED DAMPERS
- COPPER SCREENS ARE 1/4"
- 1/8" SCREENS AVAILABLE UPON REQUEST
- 16 OZ. COPPER

SPECIFICATION KEY

SPECIFY DAMPER & SCREEN OPTIONS

BEFORE PART

D = DAMPER ONLY (DWV__#)

S = SCREEN ONLY (SWV__#)

SD = SCREEN & DAMPER (SDWV__#)

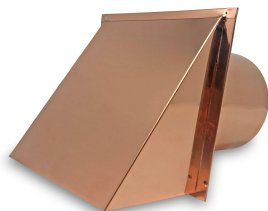
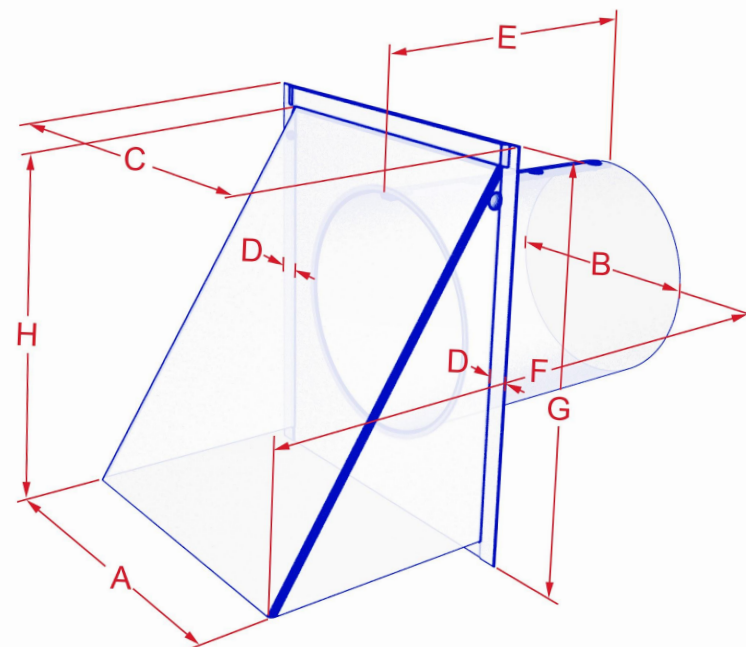

SKU	SIZE	A	B	C	D	E	F	G	H
__WVC3	3"	5.000	3.00	6.00	.5	5.00	12.375	6.625	5.375
__WVC4	4"	5.000	4.00	6.00	.5	5.00	12.375	6.625	5.375
__WVC5	5"	6.000	5.00	7.00	.5	5.00	12.250	7.000	6.125
__WVC6	6"	7.0625	6.00	8.00	.5	5.00	12.750	8.000	7.375
__WVC7	7"	9.375	7.00	9.00	.5	5.00	13.750	9.000	7.875
__WVC8	8"	9.375	8.00	11.00	.5	5.00	13.625	11.000	9.812
__WVC10	10"	12.000	10.00	13.00	.5	5.00	15.000	13.500	11.812



EMAIL: DAVE@LUXURYMETALS.COM
PHONE: (206) 406-7346 | WEBSITE: WWW.LUXURYMETALS.COM



Luxury Metals LLC
4708 W Fairview Ave #100
Boise, ID 83706



HISTORIC MILK
DELIVERY DOOR
REMAINS.

AC UNIT TO BE REMOVED
FROM WINDOW OPENING
AND REPLACED WITH
MARVIN ULTIMATE WINDOW.
SEE NEXT PAGE FOR
WINDOW SPEC.

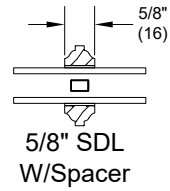
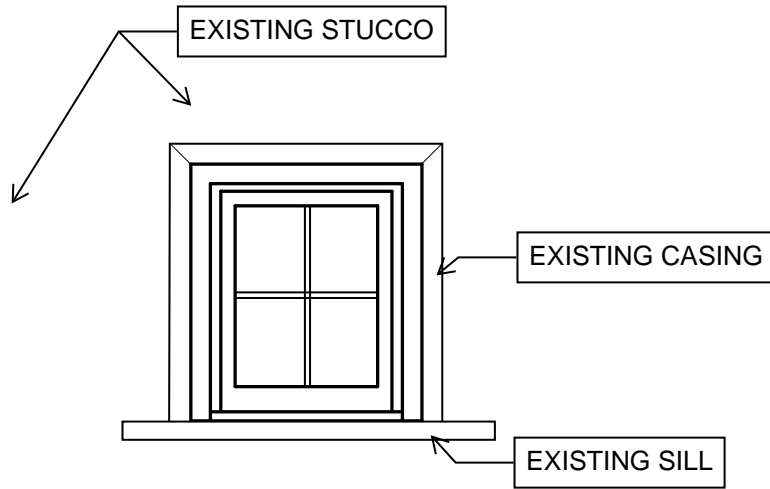

WOOD EXTERIOR,
PAINTED TO MATCH
HOUSE EXTERIOR

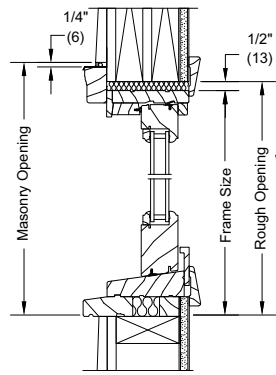

2" (51) SASH PICTURE UNIT
HEAD JAMB

WOOD INTERIOR,
PAINTED TO MATCH
HOUSE INTERIOR

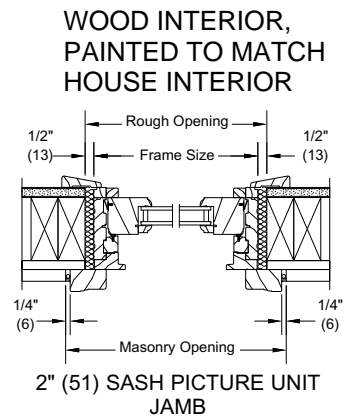

WOOD EXTERIOR,
PAINTED TO MATCH
HOUSE EXTERIOR