



CITY OF MILWAUKEE  
OFFICE OF THE CITY CLERK

Tuesday, July 05, 2022

COMMITTEE MEETING NOTICE

AD 06

SHAMA, Wajih, Agent  
Shama 2022 LLC  
2900 N 12TH St  
Milwaukee, WI 53206

You are requested to attend a virtual hearing to be held on:

**Tuesday, July 19, 2022 at 09:30 AM**

**Regarding:** Your Food Dealer License Application as agent for "Shama 2022 LLC" for "Yellow Castle" at 2900 N 12TH St.

This meeting will be held via GoToMeeting. Please see the enclosed best practices document for further instructions. The access code is <https://meet.goto.com/935616013>. If you wish to call in, please call **+1 (872) 240-3311** and use Access Code: **935-616-013**.

There is a possibility that your application may be denied for one or more of the following reasons: The recommendation of the committee regarding the application shall be based on evidence presented at the hearing. Per MCO 85-2.7-4, probative evidence concerning whether or not a new license should be granted may be presented on the following subjects: whether or not the applicant meets the municipal requirements, the appropriateness of the location and premises where the licensed premises is to be located and whether use of the premises for the purposes or activities permitted by the license would tend to facilitate a public or private nuisance or create undesirable neighborhood problems such as disorderly patrons, unreasonably loud noise, litter, and excessive traffic and parking congestion. Probative evidence relating to these matters may be taken from the plan of operation submitted with the license application, if any, but shall not include the content of any music. Evidence regarding the fitness of the location of the premises to be maintained as the principal place of business, including but not limited to whether there is an overconcentration of businesses of the type for which the license is sought; whether the proposal is consistent with any pertinent neighborhood business or development plans, or the location's proximity to areas where children are typically present. The applicant's record in operating similarly licensed premises; and whether or not the applicant has been charged with or convicted of any felony, misdemeanor, municipal offense or other offense, the circumstances of which substantially relate to the activity to be permitted by the license being applied for or any other factor which reasonably relates to the public health, safety or welfare may also be considered. See attached police report or correspondence.

**Notice for applicants with warrants or unpaid fines:**

**Proof of warrant satisfaction or payment of fines must be submitted at the hearing on the above date and time. Failure to comply with this requirement may result in a delay of the granting/denial of your application.**

Failure to attend this meeting may result in the denial of your license. Individual applicants and partnership applicants must attend or attend by an attorney. The agent or attorney for corporate or limited liability applicants must attend. If you wish to do so and at your own expense, you may be accompanied by an attorney of your choosing to represent you at this hearing.

You will be given an opportunity to speak on behalf of the application and to respond and challenge any charges or reasons given for the denial. No petitions can be accepted by the committee, unless the people who signed the petition attend the virtual hearing and are willing to testify. You may present witnesses under oath and you may also confront and cross-examine opposing witnesses under oath. If you have difficulty with the English language, you should request an interpreter attend the meeting with you, at your expense, so that you can answer questions and participate in your hearing.

PLEASE NOTE: Upon reasonable notice, efforts will be made to accommodate the needs of disabled individuals through sign language interpreters or other auxiliary aids. For additional information or to request this service, contact the Council Services Division ADA Coordinator at (414) 286-2998, Fax - (414) 286-3456, TDD - (414) 286-2025.

JIM OWCZARSKI, CITY CLERK

BY: \_\_\_\_\_

Jim Cooney  
License Division Manager

**If you have questions regarding this meeting, please contact the staff assistant, Yadira Melendez at (414) 286-2775 or [stas5@milwaukee.gov](mailto:stas5@milwaukee.gov)**

200 E. Wells Street, Room 105, City Hall, Milwaukee, WI 53202. [www.milwaukee.gov/license](http://www.milwaukee.gov/license)  
Phone: (414) 286-2238 Fax: (414) 286-3057 Email Address: [License@milwaukee.gov](mailto:License@milwaukee.gov)



CITY OF MILWAUKEE  
OFFICE OF THE CITY CLERK

Tuesday, July 05, 2022

COMMITTEE MEETING NOTICE

AD 06

SHAMA, Wajih, Agent  
Shama 2022 LLC  
2048 W BOLIVAR AV  
Milwaukee, WI 53221

You are requested to attend a virtual hearing to be held on:

**Tuesday, July 19, 2022 at 09:30 AM**

**Regarding:** Your Food Dealer License Application as agent for "Shama 2022 LLC" for "Yellow Castle" at 2900 N 12TH St.

This meeting will be held via GoToMeeting. Please see the enclosed best practices document for further instructions. The access code is <https://meet.goto.com/935616013>. If you wish to call in, please call [+1 \(872\) 240-3311](tel:+18722403311) and use Access Code: 935-616-013.

There is a possibility that your application may be denied for one or more of the following reasons: The recommendation of the committee regarding the application shall be based on evidence presented at the hearing. Per MCO 85-2.7-4, probative evidence concerning whether or not a new license should be granted may be presented on the following subjects: whether or not the applicant meets the municipal requirements, the appropriateness of the location and premises where the licensed premises is to be located and whether use of the premises for the purposes or activities permitted by the license would tend to facilitate a public or private nuisance or create undesirable neighborhood problems such as disorderly patrons, unreasonably loud noise, litter, and excessive traffic and parking congestion. Probative evidence relating to these matters may be taken from the plan of operation submitted with the license application, if any, but shall not include the content of any music. Evidence regarding the fitness of the location of the premises to be maintained as the principal place of business, including but not limited to whether there is an overconcentration of businesses of the type for which the license is sought; whether the proposal is consistent with any pertinent neighborhood business or development plans, or the location's proximity to areas where children are typically present. The applicant's record in operating similarly licensed premises; and whether or not the applicant has been charged with or convicted of any felony, misdemeanor, municipal offense or other offense, the circumstances of which substantially relate to the activity to be permitted by the license being applied for or any other factor which reasonably relates to the public health, safety or welfare may also be considered. See attached police report or correspondence.

**Notice for applicants with warrants or unpaid fines:**

**Proof of warrant satisfaction or payment of fines must be submitted at the hearing on the above date and time. Failure to comply with this requirement may result in a delay of the granting/denial of your application.**

Failure to attend this meeting may result in the denial of your license. Individual applicants and partnership applicants must attend or attend by an attorney. The agent or attorney for corporate or limited liability applicants must attend. If you wish to do so and at your own expense, you may be accompanied by an attorney of your choosing to represent you at this hearing.

You will be given an opportunity to speak on behalf of the application and to respond and challenge any charges or reasons given for the denial. No petitions can be accepted by the committee, unless the people who signed the petition attend the virtual hearing and are willing to testify. You may present witnesses under oath and you may also confront and cross-examine opposing witnesses under oath. If you have difficulty with the English language, you should request an interpreter attend the meeting with you, at your expense, so that you can answer questions and participate in your hearing.

PLEASE NOTE: Upon reasonable notice, efforts will be made to accommodate the needs of disabled individuals through sign language interpreters or other auxiliary aids. For additional information or to request this service, contact the Council Services Division ADA Coordinator at (414) 286-2998, Fax - (414) 286-3456, TDD - (414) 286-2025.

JIM OWCZARSKI, CITY CLERK

BY: \_\_\_\_\_

Jim Cooney  
License Division Manager

**If you have questions regarding this meeting, please contact the staff assistant, Yadira Melendez at (414) 286-2775 or [stasst5@milwaukee.gov](mailto:stasst5@milwaukee.gov)**

200 E. Wells Street, Room 105, City Hall, Milwaukee, WI 53202. [www.milwaukee.gov/license](http://www.milwaukee.gov/license)  
Phone: (414) 286-2238 Fax: (414) 286-3057 Email Address: [License@milwaukee.gov](mailto:License@milwaukee.gov)

**Cox, Andrew**

---

**From:** License  
**Sent:** Wednesday, June 8, 2022 6:43 PM  
**To:** Cox, Andrew  
**Cc:** Byrd, Yashica; Martin, Faviola  
**Subject:** FW: Notice of Public Interest New License Filed: Response

Please add

---

**From:**  
**Sent:** Monday, June 6, 2022 11:46 AM  
**To:** License <LICENSE@milwaukee.gov>  
**Subject:** Notice of Public Interest New License Filed: Response

You don't often get email from [License](#). [Learn why this is important](#)

Hello, my name is [REDACTED], and I am writing in response to the Public Notice of Interest mailed to my address, [REDACTED]. I am thrilled about the attention to new retail establishment notification in this area and community. However, I want to object to granting the applicant Wajih Shama, Agt. Shama 2022 LLC and deny approval for licensing to opening a food dealer/retail convenience store at the 2900 N. 12th location. Wajih Shama, Agt. Shama 2022, business at that location of interest continues to produce traffic leading to dirty conditions, cramped, unsafe traffic flow, and a plethora of unhealthy food choices that damage the community and extract critical resources that are truly needed to improve the neighborhood constructively.

Therefore, I would like the applicant to be denied the license to operate at 2900 N12th Street, Milwaukee, Wisconsin, 53206.

Thank you,

**REDACTED RECORD**



Tuesday, July 05, 2022



# Notice of Public Hearing

Blank Notice

---

SHAMA, Wajih  
Yellow Castle at 2900 N 12TH St.  
Food Dealer License Application

**Tuesday, July 19, 2022 at 09:30 AM**

To whom it may concern:

The above application has been made by the above named applicant(s). This requires approval from the Licenses Committee and the Common Council of the City of Milwaukee. The hearing before the Licenses Committee will take place virtually on 07/19/2022 at 09:30 AM. This is a public hearing. Those wishing to view the proceeding are able to do so via the City Channel – Channel 25 on Spectrum Cable – or on the Internet at <http://city.milwaukee.gov/citychannel>. Those wishing to provide oral testimony will be asked to do so by phone or internet and are asked to contact the staff assistant, Yadira Melendez at (414) 286-2775 or [stasst5@milwaukee.gov](mailto:stasst5@milwaukee.gov) for necessary information. Please make such requests no later than one business day prior to the start of the meeting. You are not required to attend the hearing, but please see the information below if you would like to provide testimony. Once the Licenses Committee makes its recommendation, this recommendation is forwarded to the full Common Council for approval at its next regularly scheduled hearing.

---

## Important details for those wishing to provide information for the Licenses Committee to consider when making its recommendation:

1. The license application is scheduled to be heard at the above time. Due to other hearings running longer than scheduled, you may have to wait some time to provide your testimony.
2. You must testify as to matters that you have personally experienced or seen. (You cannot provide testimony for your neighbor, parent or anyone else; this is considered hearsay and cannot be considered by the committee.)
3. No letters or petitions can be accepted by the committee (unless the person who wrote the letter or the persons who signed the petition are willing to testify).
4. Persons opposed to the license application are given the opportunity to testify first; supporters may testify after the opponents have finished.
5. When you are called to testify, you will be sworn in and asked to give your name, and address. (If your first and/or last names are uncommon please spell them.)
6. You may then provide testimony.
  - a. Include only information relating to the above license application.
  - b. Include only information you have personally witnessed or seen.
  - c. Provide concise and relevant information detailing how this business has affected or may affect the peaceful enjoyment of your neighborhood.
  - d. If by the time you have the opportunity to testify, the information you wish to share has already been provided to the committee, you may state that you agree with the previous testimony. Redundant or repetitive testimony will not assist the committee in making its recommendation.
7. After giving your testimony, the members of the Licenses Committee and the licensee may ask questions regarding the testimony you have given or other factors relating to the license application.
8. Business Competition is not a valid basis for denial or non-renewal of a license.

**Please Note:** If you have submitted an objection to the above application your objection cannot be considered by the committee unless you personally testify at the hearing.

OCCUPANT	MAIL ADDRESS	CITY STATE ZIP
CURRENT OCCUPANT	1120 W LOCUST ST	MILWAUKEE, WI 53206-2656
CURRENT OCCUPANT	1218 W LOCUST ST	MILWAUKEE, WI 53206-2657
CURRENT OCCUPANT	1218A W LOCUST ST	MILWAUKEE, WI 53206-2657
CURRENT OCCUPANT	1220 W LOCUST ST	MILWAUKEE, WI 53206-2657
CURRENT OCCUPANT	2858 N 12TH ST	MILWAUKEE, WI 53206-2615
CURRENT OCCUPANT	2859 N 12TH ST	MILWAUKEE, WI 53206-2616
CURRENT OCCUPANT	2860 N 12TH ST	MILWAUKEE, WI 53206-2615
CURRENT OCCUPANT	2861 N 11TH ST	MILWAUKEE, WI 53206-3261
CURRENT OCCUPANT	2861 N 12TH ST	MILWAUKEE, WI 53206-2616
CURRENT OCCUPANT	2861A N 11TH ST	MILWAUKEE, WI 53206-3261
CURRENT OCCUPANT	2865 N 11TH ST	MILWAUKEE, WI 53206-3261
CURRENT OCCUPANT	2867 N 11TH ST	MILWAUKEE, WI 53206-3261
CURRENT OCCUPANT	2869 N 12TH ST	MILWAUKEE, WI 53206-2616
CURRENT OCCUPANT	2901 N 11TH ST	MILWAUKEE, WI 53206-2774
CURRENT OCCUPANT	2901A N 11TH ST	MILWAUKEE, WI 53206-2774
CURRENT OCCUPANT	2903 N 12TH ST	MILWAUKEE, WI 53206-2618
CURRENT OCCUPANT	2905 N 11TH ST	MILWAUKEE, WI 53206-2774
CURRENT OCCUPANT	2905 N 12TH ST	MILWAUKEE, WI 53206-2618
CURRENT OCCUPANT	2907 N 11TH ST	MILWAUKEE, WI 53206-2774
CURRENT OCCUPANT	2908 N 12TH ST	MILWAUKEE, WI 53206-2617
CURRENT OCCUPANT	2908 N 13TH ST	MILWAUKEE, WI 53206-2712
CURRENT OCCUPANT	2908A N 12TH ST	MILWAUKEE, WI 53206-2617
CURRENT OCCUPANT	2911 N 11TH LN	MILWAUKEE, WI 53206-2772
CURRENT OCCUPANT	2911 N 11TH ST	MILWAUKEE, WI 53206-2774
CURRENT OCCUPANT	2911 N 12TH ST	MILWAUKEE, WI 53206-2618
CURRENT OCCUPANT	2911A N 11TH ST	MILWAUKEE, WI 53206-2774
CURRENT OCCUPANT	2913 N 11TH ST	MILWAUKEE, WI 53206-2774
CURRENT OCCUPANT	2914 N 13TH ST	MILWAUKEE, WI 53206-2712
CURRENT OCCUPANT	2915 N 11TH ST	MILWAUKEE, WI 53206-2774
CURRENT OCCUPANT	2915 N 12TH ST	MILWAUKEE, WI 53206-2618
CURRENT OCCUPANT	2918 N 12TH ST	MILWAUKEE, WI 53206-2617
CURRENT OCCUPANT	2918 N 13TH ST	MILWAUKEE, WI 53206-2712
CURRENT OCCUPANT	2918A N 13TH ST	MILWAUKEE, WI 53206-2712
CURRENT OCCUPANT	2919 N 12TH ST	MILWAUKEE, WI 53206-2618
CURRENT OCCUPANT	2920 N 12TH ST	MILWAUKEE, WI 53206-2617
CURRENT OCCUPANT	2921 N 11TH LN	MILWAUKEE, WI 53206-2772
CURRENT OCCUPANT	2925 N 11TH ST	MILWAUKEE, WI 53206-2774
CURRENT OCCUPANT	2926 N 12TH ST	MILWAUKEE, WI 53206-2617
CURRENT OCCUPANT	2926A N 12TH ST	MILWAUKEE, WI 53206-2617
CURRENT OCCUPANT	2927 N 12TH ST	MILWAUKEE, WI 53206-2618
CURRENT OCCUPANT	2929 N 11TH LN	MILWAUKEE, WI 53206-2772
CURRENT OCCUPANT	2929 N 11TH ST	MILWAUKEE, WI 53206-2774
CURRENT OCCUPANT	2930 N 12TH ST	MILWAUKEE, WI 53206-2617
CURRENT OCCUPANT	2931 N 11TH ST	MILWAUKEE, WI 53206-2774
CURRENT OCCUPANT	2933 N 11TH ST	MILWAUKEE, WI 53206-2774
CURRENT OCCUPANT	2933A N 11TH ST	MILWAUKEE, WI 53206-2774

CURRENT OCCUPANT 2943 N 11TH LN MILWAUKEE, WI 53206-2772

Blank Notice

Total Records: 47

Radius 250.0 feet and Center of the Circle: 2900 N 12th St



# BUSINESS LICENSE PLAN OF OPERATION

ccl-busplan 5/12/2020

Office of the City Clerk License Division  
200 E. Wells St. Room 105, Milwaukee, WI 53202  
(414) 286-2238 www.milwaukee.gov/license e-mail address: license@milwaukee.gov

## 1. Type of Business

Applying for:  Extended Hours (12AM to 5AM) - If a food establishment, check all that apply:  Delivery  Drive Thru  Dining Room  
 Self Service Laundry  Massage Establishment  Filling Station  
 Other (supplemental application for specific license also required)

Provide a detailed description of the type of business you plan on operating:

Convenience Store

Do you have any experience operating this type of business?  No  Yes If yes, explain: I have worked at a convenience store before

## 2. Business Operations

- a. Proposed Opening Date: 6/1/22
- b. Is this premise under construction?  No  Yes If yes, list estimated completion date: \_\_\_\_\_
- c. Is this a franchise?  No  Yes
- d. Is this premises currently licensed?  No  Yes If yes, list type of license: \_\_\_\_\_
- e. Is the current licensee operating?  No  Yes If no, list date closed: \_\_\_\_\_
- f. Do you have future plans for other businesses, licenses or permits at this location?  No  Yes  
If yes, explain: \_\_\_\_\_
- g. Have you previously held an Extended Hours License in Milwaukee?  No  Yes  
If yes, list address(es): \_\_\_\_\_
- h. Are other businesses operating in the same building?  No  Yes If yes, describe: \_\_\_\_\_

## 3. Litter & Noise

- a. How are grounds kept clean?  Sweep  Pressure Wash  Pick Up Litter  Other: \_\_\_\_\_
- b. How often will grounds be cleaned?  Daily  Weekly  As Needed  Monthly  Other: \_\_\_\_\_
- c. Grounds cleaned by:  Licensee  Building Owner  Employees  Hired Maintenance  Other: \_\_\_\_\_
- d. How are noise issues prevented and/or addressed?  Security  Manager approaches customer(s)  Call Police  
 Signs Posted  Other: \_\_\_\_\_
- e. Will a sound amplification system be used?  No  Yes If yes, describe: \_\_\_\_\_

## 4. Smoking & Sanitation

- a. Are there designated outdoor smoking areas?  No  Yes If yes, describe: \_\_\_\_\_
- b. Number of Garbage Cans: Inside: 2 Locations: cashier, backroom  
Outside: 1 Locations: side of building
- c. Is a crowd control barrier used?  No  Yes If yes, describe: \_\_\_\_\_
- d. How many restrooms are on the premises? 1
- e. Name of solid waste contractor:  Advanced Disposal  Waste Management  Other: \_\_\_\_\_

## 5. Security

- a. Are there onsite parking spaces?  No  Yes If yes, how many? \_\_\_\_\_ and describe the parking security plan: \_\_\_\_\_
- b. Is there a loading zone?  No  Yes If yes, describe the loading area security plan: \_\_\_\_\_
- c. Will you have security personnel on premise?  No  Yes If yes, how many? \_\_\_\_\_ and answer the following:  
 What are their responsibilities? \_\_\_\_\_  
 Is security equipment used?  No  Yes If yes, describe \_\_\_\_\_  
 List their licensing, certification, or training credentials \_\_\_\_\_
- d. Will there be security cameras?  No  Yes If yes, how many? 8 and list locations: by cashier, outside of building
- e. Will searches/identification checks be done upon entry?  No  Yes If yes, describe \_\_\_\_\_

## 6. Percentage of Sales (must total 100%)

Alcohol _____%	Food <u>70</u> %	Secondhand Merchandise _____%	Precious Metals & Gems _____%
Entertainment _____%	Cigarettes <u>25</u> %	Personal Services (such as tattoo, body piercing, salon, tailor, tanning, etc.) _____%	Other <u>5</u> % Describe: <u>General Merchant</u>
Pawnbroker Activity _____%	Salvaged Materials _____% (such as scrap metal)		

## 7. Businesses/Licenses on the Premises (check all that apply):

### Type 1

- Full Service Restaurant  Cafe/Coffee Shop  Deli or Fast Food Restaurant  Private/Fraternal/Veterans Club
- Night Club  Tavern  Cocktail Lounge  Teen Club
- Banquet Hall  Sports Facility  Bowling Alley
- Hotel/Motel : Number of Floors: \_\_\_\_\_  Rooming House: Number of Floors: \_\_\_\_\_  
 Number of Rooms: \_\_\_\_\_ Number of Rooms: \_\_\_\_\_

### Type 2

- Liquor Store  Corner Store  Supermarket  Convenience Store
- Gas Station  Amusement/Phonograph Distributor  Recycling, Salvage or Towing
- Used Car Dealer  Personal Service Establishment  
(such as tattoo business, hair salon, tailor, etc.)  Recording Studio

What other licenses/permits will you hold at this location? (check all that apply)

- Occupancy Permit  Cigarette & Tobacco  Gas Station  Extended Hours  Class "B" Tavern  Weights & Measures
- Secondhand Dealer  Precious Metal & Gem  Other: \_\_\_\_\_

## 8. Legal Capacity (only if a Type 1 premises in #7 above)

Capacity \_\_\_\_\_ (Call the Milwaukee Development Center at 414-286-8211 if you have questions.)



## 9. Premises Description

- a. Identify all area(s) of the premises that will be used in operating this business (include areas used only for storage):  
 1<sup>st</sup> Floor  2<sup>nd</sup> Floor  Basement Storage  Patio  Beer Garden  Sidewalk Café  Deck  Rooftop  
 Other: Describe: \_\_\_\_\_
- b. Describe Location:  Major Thoroughfare  Secondary Street  Other: \_\_\_\_\_
- c. Nearest Major Cross Street: 12 n st, W Locust St.
- d. Describe Building:  Free Standing Building  Strip Mall  Other: \_\_\_\_\_
- e. Describe Premises Structure:  Single Story  Multi-Story - # of Stories 2  Other: \_\_\_\_\_
- f. Describe Surrounding Area:  Commercial  Residential  Industrial  Other: \_\_\_\_\_
- g. Building Owner Name: Forerunner Holdings LLC Phone Number: 414-699-7207  
 Building Owner Address: 6946 W Brown Dr Franklin, WI 53132

## 10. Hours of Operation & Customers

Will customers be entering the premises?  No  Yes

Day of the Week	Proposed Hours of Operation:		Estimated Number of Customers expected each day	Potential Age Range of Customers	Class B Tavern Applicant Only: Age Restriction (If none, write 'None')
	Open Time (include a.m. or p.m.)	Close Time (include a.m. or p.m.)			
Sunday	8 am	9 pm	100-150	16-35	
Monday	8 am	9 pm	100-150	16-35	
Tuesday	8 am	9 pm	100-150	16-35	
Wednesday	8 am	9 pm	100-150	16-35	
Thursday	8 am	9 pm	100-150	16-35	
Friday	8 am	9 pm	100-150	16-35	
Saturday	8 am	9 pm	100-150	16-35	

An Extended Hours Establishment License is required for any convenience store, filling station, personal service establishment (such as tattoo, body piercing, salon, tailor, tanning, etc.), recording studio or restaurant which is open between the hours of 12:00 a.m. and 5:00 a.m.

Alcohol Establishments Permitted Hours of Operation: Class A: 8:00 am to 9:00 pm Sunday thru Saturday  
 Class B: 6:00 am to 2:00 am Sunday thru Thursday, 6:00 am to 2:30 am Friday & Saturday

Entertainment Outdoor Closing Hours: 10:00pm Sunday-Thursday; 12:00am Friday & Saturday; unless a different time, either earlier or later, is established by the Common Council in its approval of the licensee's plan of operation.

## 11. Signature(s)

Signature of Sole Proprietor, Partner, or 20% or more Shareholder  
 (If there are no 20% or more shareholders,  
 Corporate Officer-print name/title and sign)

Signature of additional partner or 20% or more shareholder

See Application Information for a complete list of all required application forms.



# FOOD DEALER LICENSE PLAN OF OPERATION

OFFICE OF THE CITY CLERK, LICENSE DIVISION  
CITY HALL, 200 E. WELLS ST, ROOM 105, MILWAUKEE, WI 53202  
(414) 286-2238 • [license@milwaukee.gov](mailto:license@milwaukee.gov) • [www.milwaukee.gov/license](http://www.milwaukee.gov/license)

Legal Entity Name: Shama 2022 LLC

Premises Address: 2900 n 12<sup>th</sup> St. Milwaukee, WI 53208

## SECTION 1 TYPE OF BUSINESS

What will be the majority of your food sales? (check one)

Restaurant Items (meals):

MEALS include, but are not limited to, chicken, ribs, sandwiches, roasted corn, baked potatoes, hot dogs, brats, tacos, nachos w/ cheese and meat, French fries, cooked or deep fried vegetables/fruit, cooked cheese curds, corn dogs, egg rolls, salads.

Retail Items (snacks and beverages):

RETAIL Items include, but are not limited to, ice cream/soft serve, lemonade, snow cones, coffee, espresso, cappuccino, tea, fruit juice, smoothies, candy, dispensed soda, fruit cups, bakery, cookies, kettle corn, cotton candy, funnel cakes, fritters, tortilla chips w/ cheese.

Will it be a convenience store?  Yes  No

A convenience store contains less than 5,000 square feet of retail space and has, as its primary business, the sale of basic food items and in addition, sells household products or is a filling station that sells basic food items and household products.

Bed & Breakfast

Micro Market

All Applicants: Submit a menu or a list of food items that will be sold.

Will any wholesale business be done?  No  Yes If yes, what percentage of food sales will be wholesale?

Less than 25%

25% or More AND:

Restaurant Items (meals) will be sold -- Complete this application and also contact DATCP.

NO restaurant items (meals) will be sold - Do NOT complete this application. Contact DATCP only.

## SECTION 2 FOOD PROCESSING

Will any food processing be done?  No  Yes

Processing is defined as assembling, grinding, cutting, mixing, baking, coating, stuffing, packing, bottling, grilling, canning, extracting, fermenting, distilling, pickling, freezing, drying, smoking, or packaging.

## SECTION 3 FOOD REQUIRING TEMPERATURE CONTROL

Will any food that requires temperature control be sold?  No  Yes  
(includes dairy products such as milk, cheese, and ice cream, fish, shellfish, meat, poultry)

If yes, list the types of food items: Milk, eggs, ice cream

**SECTION 4 DETAILS OF OPERATION**

Will you have seating on site for dining?  No  Yes

Will you be doing any catering?  No  Yes

Will you be doing any delivery?  No  Yes

Will you have outdoor activities?  No  Yes - Check all that apply:  Bar  Cooking/Grilling  Dining

Will you have a drive thru window?  No  Yes - Are hours different from inside?  No  Yes  
 If Yes, provide drive thru hours: \_\_\_\_\_

Will scales or barcode scanners be used?  No  Yes - You must also apply for a Weights & Measures License.

**SECTION 5 ADDITIONAL SITES**

Where will food be prepared and/or sold?

At a single site  At multiple sites: How many? \_\_\_\_\_ (for example, a hotel with several dining rooms or bars)

If multiple sites, attach a Food Dealer Additional Site Addendum (ccl-foodadd) for each additional site.

**SECTION 6 CONSTRUCTION OR CHANGES**

Are you planning any construction, remodeling or equipment changes?

No If No, SKIP to Section 8

Yes If Yes, check all that apply:  New construction of a building  Renovation or remodeling  
 Construction changes to existing building  Equipment changes only

Provide a brief description of the changes: \_\_\_\_\_

Start date: \_\_\_\_\_

Name, Address & Phone Number of Architect: \_\_\_\_\_

Name, Address & Phone Number of Contractor: \_\_\_\_\_

**SECTION 7 ALCOHOL BEVERAGES**

Are you applying for an alcohol beverage license?

No If No, SKIP to Section 8

Yes If YES, if your food license is approved prior to the alcohol license, when do you want the food license issued?  
 Immediately  At the same time as the alcohol license

**SECTION 8 ACKNOWLEDGEMENTS & SIGNATURE**

You must initial each item confirming your understanding:

WS I understand the Health Department must conduct an inspection and advise the License Division of their approval before the license may be issued.

WS I understand I must obtain an occupancy permit from the Department of Neighborhood Services and an inspection may be required. Neighborhood Services must advise the License Division of their approval before the license may be issued.

WS I understand the district alderperson will review and either support or object to my application. If he/she objects, I may appeal and be scheduled to appear before the Licenses Committee. The Licenses Committee will then make a recommendation to the Common Council. The Common Council must grant the license before it may be issued.

WS I understand proof of payment for all license fees must be on file in the License Division before the license may be issued and the license must be issued and posted in my establishment prior to opening for business.

WS I will not operate my food business until the license has been issued and posted in the establishment.

Signature of Sole Proprietor, Partner, or 20% Shareholder: \_\_\_\_\_

Signature of Additional Partner: \_\_\_\_\_

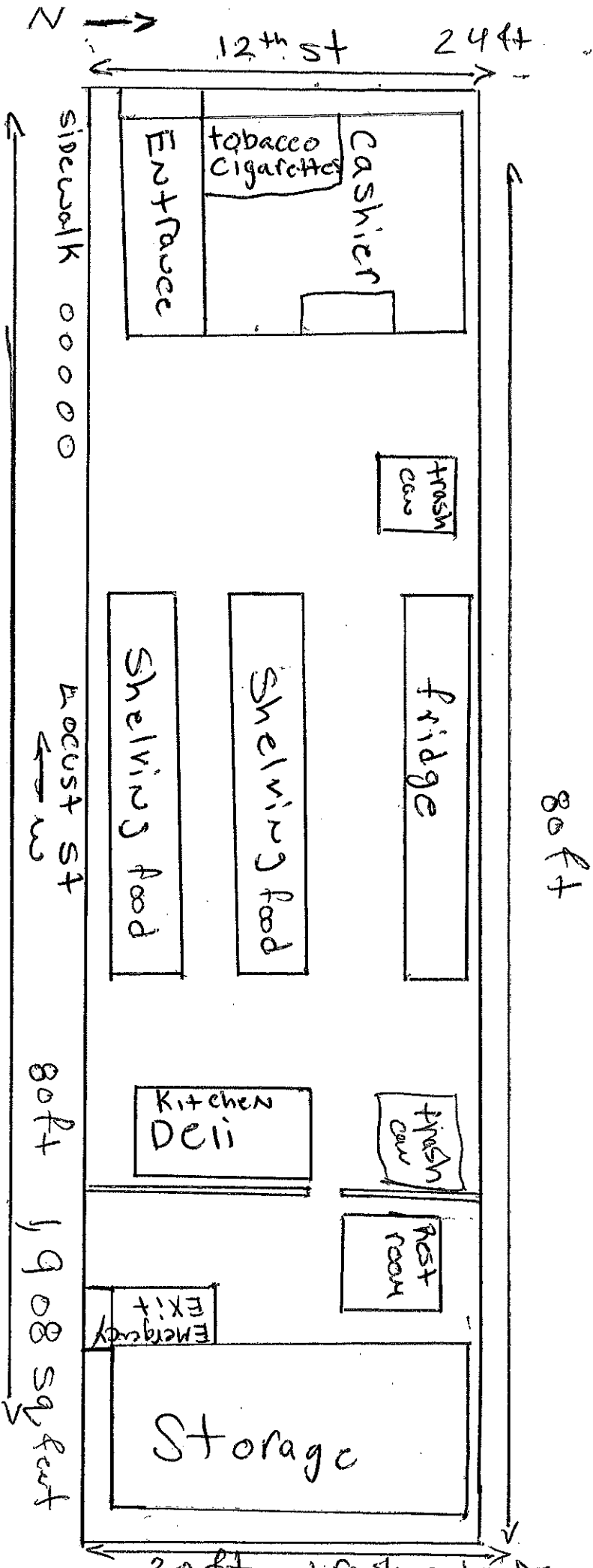

Wajin Sharma, Sharma 2022 LLC  
 Yellow castle  
 2900 N 12th  
 June 1 2022