



CITY OF MILWAUKEE
OFFICE OF THE CITY CLERK

Thursday, September 16, 2021

COMMITTEE MEETING NOTICE

AD 08

SINGH, Kamal, Agent
Kamal Food Mart, LLC
2539 W GRANT St

Milwaukee, WI 53215

You are requested to attend a virtual hearing to be held on:

Tuesday, September 28, 2021 at 01:20 PM



Regarding: Your Class A Malt and Food Dealer License Applications as agent for "Kamal Food Mart, LLC" for "Kamal Food Mart" at 2539 W GRANT St.

This meeting will be held via GoToMeeting. Please see the enclosed best practices document for further instructions. The access code is <https://global.gotomeeting.com/join/284170701>. If you wish to call in, please call +1 (786) 535-3211 and use Access Code: 284-170-701.

There is a possibility that your application may be denied for one or more of the following reasons: The recommendation of the committee regarding the application shall be based on evidence presented at the hearing. Per MCO 85-2.7-4, probative evidence concerning whether or not a new license should be granted may be presented on the following subjects: whether or not the applicant meets the municipal requirements, the appropriateness of the location and premises where the licensed premises is to be located and whether use of the premises for the purposes or activities permitted by the license would tend to facilitate a public or private nuisance or create undesirable neighborhood problems such as disorderly patrons, unreasonably loud noise, litter, and excessive traffic and parking congestion. Probative evidence relating to these matters may be taken from the plan of operation submitted with the license application, if any, but shall not include the content of any music. Evidence regarding the fitness of the location of the premises to be maintained as the principal place of business, including but not limited to whether there is an overconcentration of businesses of the type for which the license is sought; whether the proposal is consistent with any pertinent neighborhood business or development plans, or the location's proximity to areas where children are typically present. The applicant's record in operating similarly licensed premises; and whether or not the applicant has been charged with or convicted of any felony, misdemeanor, municipal offense or other offense, the circumstances of which substantially relate to the activity to be permitted by the license being applied for or any other factor which reasonably relates to the public health, safety or welfare may also be considered. See attached police report or correspondence.

Notice for applicants with warrants or unpaid fines:

Proof of warrant satisfaction or payment of fines must be submitted at the hearing on the above date and time. Failure to comply with this requirement may result in a delay of the granting/denial of your application.

Failure to attend this meeting may result in the denial of your license. Individual applicants and partnership applicants must attend or attend by an attorney. The agent or attorney for corporate or limited liability applicants must attend. If you wish to do so and at your own expense, you may be accompanied by an attorney of your choosing to represent you at this hearing.

You will be given an opportunity to speak on behalf of the application and to respond and challenge any charges or reasons given for the denial. No petitions can be accepted by the committee, unless the people who signed the petition attend the virtual hearing and are willing to testify. You may present witnesses under oath and you may also confront and cross-examine opposing witnesses under oath. If you have difficulty with the English language, you should request an interpreter attend the meeting with you, at your expense, so that you can answer questions and participate in your hearing.

PLEASE NOTE: Upon reasonable notice, efforts will be made to accommodate the needs of disabled individuals through sign language interpreters or other auxiliary aids. For additional information or to request this service, contact the Council Services Division ADA Coordinator at (414) 286-2998, Fax - (414) 286-3456, TDD - (414) 286-2025.

JIM OWCZARSKI, CITY CLERK

BY: _____

Jim Cooney

License Division Manager

If you have questions regarding this meeting, please contact the staff assistant, Molly Kuether-Steele at (414) 286-2775 or molly.kuether-steele@milwaukee.gov.

200 E. Wells Street, Room 105, City Hall, Milwaukee, WI 53202. www.milwaukee.gov/license
Phone: (414) 286-2238 Fax: (414) 286-3057 Email Address: License@milwaukee.gov



CITY OF MILWAUKEE
OFFICE OF THE CITY CLERK

Thursday, September 16, 2021

COMMITTEE MEETING NOTICE

AD 08

SINGH, Kamal, Agent
Kamal Food Mart, LLC
1430 E Buckwood Dr

Oak Creek, WI 53154

You are requested to attend a virtual hearing to be held on:

Tuesday, September 28, 2021 at 01:20 PM

Regarding: Your Class A Malt and Food Dealer License Applications as agent for "Kamal Food Mart, LLC" for "Kamal Food Mart" at 2539 W GRANT St.

This meeting will be held via GoToMeeting. Please see the enclosed best practices document for further instructions. The access code is <https://global.gotomeeting.com/join/284170701>. If you wish to call in, please call +1 (786) 535-3211 and use Access Code: 284-170-701.

There is a possibility that your application may be denied for one or more of the following reasons: The recommendation of the committee regarding the application shall be based on evidence presented at the hearing. Per MCO 85-2.7-4, probative evidence concerning whether or not a new license should be granted may be presented on the following subjects: whether or not the applicant meets the municipal requirements, the appropriateness of the location and premises where the licensed premises is to be located and whether use of the premises for the purposes or activities permitted by the license would tend to facilitate a public or private nuisance or create undesirable neighborhood problems such as disorderly patrons, unreasonably loud noise, litter, and excessive traffic and parking congestion. Probative evidence relating to these matters may be taken from the plan of operation submitted with the license application, if any, but shall not include the content of any music. Evidence regarding the fitness of the location of the premises to be maintained as the principal place of business, including but not limited to whether there is an overconcentration of businesses of the type for which the license is sought; whether the proposal is consistent with any pertinent neighborhood business or development plans, or the location's proximity to areas where children are typically present. The applicant's record in operating similarly licensed premises; and whether or not the applicant has been charged with or convicted of any felony, misdemeanor, municipal offense or other offense, the circumstances of which substantially relate to the activity to be permitted by the license being applied for or any other factor which reasonably relates to the public health, safety or welfare may also be considered. See attached police report or correspondence.

Notice for applicants with warrants or unpaid fines:

Proof of warrant satisfaction or payment of fines must be submitted at the hearing on the above date and time. Failure to comply with this requirement may result in a delay of the granting/denial of your application.

Failure to attend this meeting may result in the denial of your license. Individual applicants and partnership applicants must attend or attend by an attorney. The agent or attorney for corporate or limited liability applicants must attend. If you wish to do so and at your own expense, you may be accompanied by an attorney of your choosing to represent you at this hearing.

You will be given an opportunity to speak on behalf of the application and to respond and challenge any charges or reasons given for the denial. No petitions can be accepted by the committee, unless the people who signed the petition attend the virtual hearing and are willing to testify. You may present witnesses under oath and you may also confront and cross-examine opposing witnesses under oath. If you have difficulty with the English language, you should request an interpreter attend the meeting with you, at your expense, so that you can answer questions and participate in your hearing.

PLEASE NOTE: Upon reasonable notice, efforts will be made to accommodate the needs of disabled individuals through sign language interpreters or other auxiliary aids. For additional information or to request this service, contact the Council Services Division ADA Coordinator at (414) 286-2998, Fax - (414) 286-3456, TDD - (414) 286-2025.

JIM OWCZARSKI, CITY CLERK

BY: _____

Jim Cooney

License Division Manager

If you have questions regarding this meeting, please contact the staff assistant, Molly Kuether-Steele at (414) 286-2775 or molly.kuether-steele@milwaukee.gov.

200 E. Wells Street, Room 105, City Hall, Milwaukee, WI 53202. www.milwaukee.gov/license
Phone: (414) 286-2238 Fax: (414) 286-3057 Email Address: License@milwaukee.gov

MILWAUKEE POLICE DEPARTMENT LICENSING

CRIMINAL RECORD/ORDINANCE VIOLATION/INCIDENTS SYNOPSIS

DATE: 07/30/21
LICENSE TYPE: Class B Tavern
NEW:
RENEWAL:

No. 327229
Application Date: 07/22/21

License Location: 2539 W. Grant Street
Business Name: Kamal Food Mart

Licensee/Applicant: SINGH, Kamal
(Last Name, First Name, MI)
Date of Birth: 01/06/1996

Home Address: 1430 E. Buckwood Drive
City: Oak Creek State: WI Zip Code: 53154
Home Phone: 414-975-0332

This report is written by Police Officer Corstan D. COURT, assigned to the License Investigation Unit, Days.

The Milwaukee Police Department's investigation regarding this application revealed the following:

1. On 01/31/17 the applicant was cited in the City of Oak Creek for Possession of Marijuana.

Charge: Possession of Marijuana
Finding: Guilty
Sentence: fine
Date: 03/14/17
Case: 17002373

MILWAUKEE POLICE DEPARTMENT LICENSING

CRIMINAL RECORD/ORDINANCE VIOLATION/INCIDENTS SYNOPSIS

DATE: 07/08/21

LICENSE TYPE: Class B Tavern

NEW:

RENEWAL:

No. 326447

Application Date: 07/07/21

License Location: 2539 W Grant St

Business Name: Supermarket La Veracruzana

Licensee/Applicant: TREDER, Eric J
(Last Name, First Name, MI)

Date of Birth: 12/18/1983

Home Address: 4780 N. Calhoun Road

City: Brookfield

State: WI **Zip Code:** 53005

Home Phone: 414-899-6852

This report is written by Police Officer Corstan D. COURT, assigned to the License Investigation Unit, Days.

The Milwaukee Police Department's investigation regarding this application revealed the following:

1. On 02/19/2019 officers, along with agents from the Wisconsin Department of Revenue, conducted a search warrant at Supermarket La Veracruzana, 2539 W. Grant St. The warrant was issued for tax purposes and the agents seized all tobacco products. The applicant was not on scene but spoke with the agents by phone.

=====

Date:8/30/21
Officer:VODICKA

City of Milwaukee Police Department
90-5-1.5 Crime Prevention Survey
Convenience Store/Liquor Store Inspection

Name of Premise: Kamal Food Mart
Address: 2539 W Grant St
Phone: 414-800-4241

Owner:Kamal Jeet SINGH
Owner address: 1430 E Buckwood Dr
City State Zip: Oak Creek, WI 53154
Owner Phone: 975-7704
Owner email: Bhajansingh325@gmail.com

Manager:
Home Address:
City State Zip:
Phone:
Email:

Preferred contact: same

Location currently open: YES NO

Projected open date:

Day's open: S M T W Th F SA xALL

Hours of Operation: Sun: 9:00a-9:00p 24 hours Y N
Mon:
Tue:
Wed:
Thu:
Fri:
Sat:

Premise Type: Liquor Store
xConvenience Store
Other:

Licenses currently held:

- Alcohol: Yes x No Class: A #:
- Tobacco: Yes x No #:
- Food: Yes x No #:
- Extended Hours: Yes x No #:
- Secondhand Dealer: Yes x No Type: #:
- Other: Yes x No Type: #:
- Other: Yes x No Type: #:

Who is your alcohol distributor? Beer Capital

Exterior Survey:

1. Is the area around the location clean? x Yes No
2. What surrounds the location? (Check all the apply)
 - a. Park
 - b. School
 - c. Youth Center
 - d. x Church
 - e. Tavern(s) If so, how many
 - f. x Residential
 - g. Other businesses
 - h. Other:
3. Can you see from the outside of the location into the interior Yes x No
4. Can you see the employees inside of the location from the outside Yes x No
5. Are exterior windows free of signage Yes x No
6. Is there a parking lot Yes x No
7. Is the parking lot clean? Yes No
8. Is the parking lot well lit? Yes No
9. Are there areas where a person could conceal themselves Yes x No
10. Is there exterior lighting? x Yes No. Does it appears to be adequate x Yes No
11. Exterior Payphone? Yes x No
12. Are there No Loitering Signs posted? x Yes No
13. Are there exterior security cameras Yes No How Many: 2
14. Are the address numbers prominently displayed and easy to see x Yes No

Camera Survey:

15. Does this location have security cameras? x Yes No
16. Are they in working order? x Yes No
17. What format are the cameras?
 - a. Color x Yes No
 - b. Digital x Yes No
 - c. VCR Yes No
 - d. Recorded x Yes No
18. How long is footage stored for later viewing: 2 weeks
19. Are there exterior cameras x Yes No How many: 2

20. Are there interior cameras Yes No How many: 6
 21. Do all employees know how to retrieve recorded digital images/footage? Yes No

Interior Survey:

22. Is the storeowner willing to be a standing complainant regarding loitering? Yes No
 a. If yes have them fill out the standing complaint form and give them two of the commercial signs Yes No
 23. Is the interior of the location neat and clean? Yes No
 24. Does an interior camera face the entrance/exit? Yes No
 25. Is there a lockable area that separates employees from customers? Yes No
 26. Does the store sell single chore boy? Yes No
 27. Does the store sell blunt wraps? Yes No
 28. Does the store sell scales? Yes No
 29. Does the store sell items that may be used as crack pipes? Yes No
 a. Describe item N/A
 30. Does the store have an over abundance of sandwich baggies: Yes No
 31. Does the owner understand that these items are often used for drug use? Yes No
 32. Do the products in the store appear to be new and rotated often? Yes No
 33. Are emergency and non-emergency numbers posted near the phone? Yes No
 34. Does the owner know how to contact their police district directly? Yes No
 a. Did you provide a district contact guide to the owner? Yes No

Complete this section if alcohol establishment is a convenience store:

(** Read full ordinance for all details "68-55 Convenience Food Stores")

All convenience food stores not exempted under sub. 3 shall:

1. Is the cash register located in a manner so that at the time of a sales transaction, the employee and customer are both visible from the sidewalk? Yes No **
2. Are the glass entrance and exit doors clear of any signs or advertisements with the exception of a sign which states that the cash register contains \$50 or less and that the safe is no accessible to employees? Yes No
3. Does the store maintain one of the following on the licensed premise:
 - a. A safe that was in use at the convenience food store on August 17, 1994? Yes No
 - b. A drop-safe or time release safe that weighs at least 500 pounds or which is attached to or set into the floor in a manner approved by the police department? Yes No
4. Is lighting provided for the store's parking area during all hours of darkness when employees or customers are on the premises at a minimum average of 2-foot candles per square foot, unless the store is not open for business after sunset and before sunrise? Yes No N/A
5. Are at least two high-resolution surveillance security cameras installed? Yes No
6. Are the security cameras in working order? Yes No
7. Does one camera show an overall view of the counter and register area? Yes No
8. Does one camera show a clear, identifiable, full frame image of the face of each person entering and leaving the store? Yes No
9. Are the camera views obstructed by fixtures or displays? Yes No
10. Is the recorded footage stored for at least 30 days? Yes No
11. Do all store employees know how to record footage from the camera system to media capable of being transferred to police custody? Yes No

12. Are customer entrances/exits made of glass or other transparent material? Yes No
 a. Exception: A store that does not have such doors on August 17, 1994 shall not be required to install such doors until the holder of the store's food dealer license changes.
13. Has the owner and their employees attended the Robbery Prevention Training within 120 days of ownership or employment? Yes No
 a. Contact Community Outreach and Education at 935-7836 for schedule.

Sub 3. Exemptions. The requirements of this section do not apply to a convenience food store that conforms to either of the following descriptions:

- a-1. The store is located in an enclosed shopping structure, enclosed commercial building or hospital. A convenience food store is not in an enclosed structure or building if a customer can enter it directly from the outside.
 Does store conform to a-1 Yes No

- a-2. The store physically separates employees from customers with a solid partition that bars a person from entering the employee area from the customer area, has a secure lock on the employee side of any door between the employee area and the customer, and conducts all transaction through a service window or similar arrangement.
 Does store conform to a-2 Yes No

- a. At the commissioner's discretion, a convenience store may be exempted from any or all of the regulations specified in sub 2.
 Does this location hold an exemption from the commissioner regarding any of the requirements of Sub 2? Yes No

ADDITIONAL COMMENTS/RECOMMENDATIONS:

Area of Interest (AOI) Information

Area : 21,862,585.76 ft²

Jul 22 2021 16:32:35 Central Daylight Time

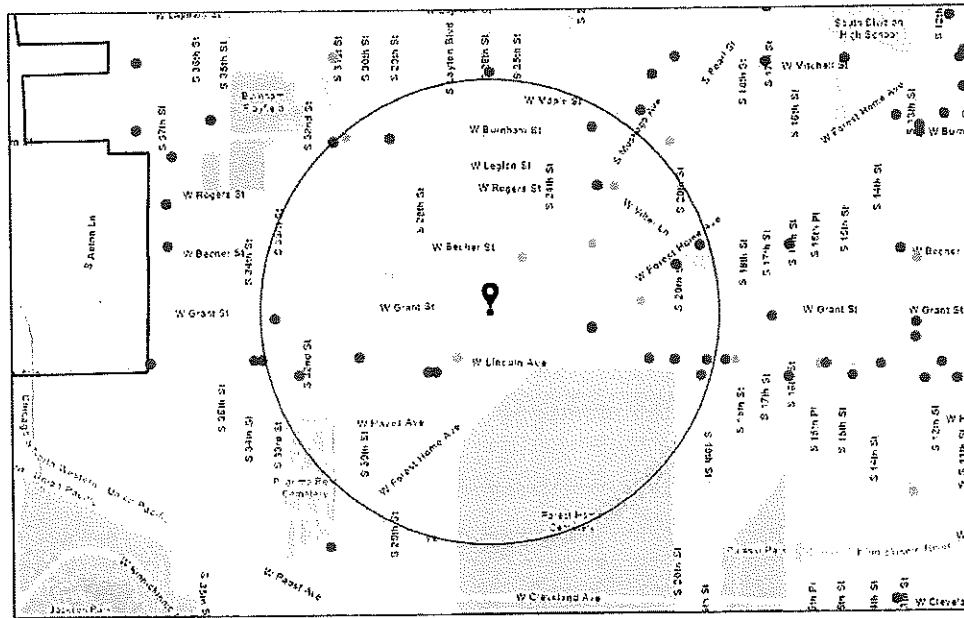

- Alcohol Licenses
- Class A Intoxicating Liquor
 - Class A Fermented Malt Beverage

- Class A Liquor and Malt
- Class B Fermented Malt Beverage
- Class B Tavern

City Limits

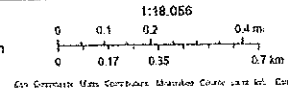

Summary

Name	Count	Area(ft ²)	Length(mi)
Alcohol Licenses	23		

Alcohol Licenses

#	Legal Entity	Trade Name	Licensee	Address	License Type Name	Total Capacity	Expiration Date	Count
1	Seven Star Liquor LLC	Seven Star Liquor	JASJEET SINGH, Agt	2223 W Forest Home AV	Class A Malt & Class A Liquor License		7/25/2021, 7:00 PM	1
2	LA PICA #3, LLC	LA PICA CARR 3 BAR & HALL	WILLIAM RIVERA, Agt	3427-31 W LINCOLN AV	Class B Tavern License	162	7/28/2021, 7:00 PM	1
3	La Hamaca Bar LLC	La Hamaca Bar	Luis Lopez-Gonzalez, Agt	1993 S MUSKEGO AV	Class B Tavern License		9/28/2021, 7:00 PM	1
4	BURNHAM BEER SPOT, INC.	JoJo's Mini Mart	Paramjit Singh, Agt	1900 S 31ST ST	Class A Fermented Malt Beverage Retailer's License		9/20/2021, 7:00 PM	1
5	Holler House	Holler House	Catherine Haefke, SP	2042 W Lincoln AV	Class B Tavern License		9/20/2021, 7:00 PM	1
6	EL PARIAN	EL PARIAN	RICARDO MONTES ALVARADO, SP	2901 W BURNHAM ST	Class B Tavern License	60	11/11/2021, 6:00 PM	1
7	LINCOLN BEER & LIQUOR INC.	LINCOLN BEER & LIQUOR	Gurjit K Singh, Agt	2717 W Lincoln AV	Class A Malt & Class A Liquor License		10/31/2021, 7:00 PM	1
8	Forest Home Ave Chicken Palace LLC	Chicken Palace - Forest Home/ Chicken Palace Forest Home Food Truck	Rosa Isela Real Perez, Agt	1937 W Forest Home AV	Class B Tavern License	71	11/22/2021, 6:00 PM	1
9	TEDDY'S INCOME, INC	SHARI'S STILL	SHERYL L LARSON, Agt	1834 S 23RD ST	Class B Tavern License	49	1/20/2022, 6:00 PM	1
10	RTSP, LLC	JUST ONE MORE	ANTONIO S PEREZ, Agt	3209 W LINCOLN AV	Class B Tavern License	25	1/17/2022, 6:00 PM	1
11	Aarvind Food Mart, LLC	Lucky Food & Beer	LAKHWINDER KAUR, Agt	2638 W Lincoln AV	Class A Fermented Malt Beverage Retailer's License		12/16/2021, 6:00 PM	1
12	CHILLY WILLYS SALOON	CHILLY WILLYS SALOON	DAVID W OLSON, SP	3301 W GRANT ST	Class B Tavern License	25	2/28/2022, 6:00 PM	1
13	Villana's Place, LLC	Villana's Place	Juan Manuel Macias Gallardo, Agt	3000 W LINCOLN AV	Class B Tavern License	160	2/7/2022, 6:00 PM	1
14	Diamante Negro LLC	Diamante Negro	Tomas Hernandez, Agt	1900 W LINCOLN AV	Class B Tavern License		3/1/2022, 6:00 PM	1
15	Chispita's Store LLC	Jalisco's Supermarket	Monica Gomez Vega, Agt	2000 W LINCOLN AV	Class A Malt & Class A Liquor License		3/30/2022, 7:00 PM	1
16	Irene's Catering Service, Inc	Irene's Catering Service, Inc	THOMAS A REWOLINSKI, Agt	1901 W Lincoln AV	Class B Tavern License		10/18/2021, 7:00 PM	1

17	ABDELAL, LLC	GRANT MARKET	SAED F ABDELAL, Agt	2100 W GRANT ST	Class A Fermented Malt Beverage Retailer's License		5/13/2022, 7:00 PM	1
18	Farida, LLC	South Ave Foods	Thaher M Qatoum, Agt	2108 S 25TH ST	Class A Fermented Malt Beverage Retailer's License		5/5/2022, 7:00 PM	1
19	Punjab Food LLC	J&C El Centenario Market	Rita M Bhatti, Agt	2082 S Muskego AV	Class A Fermented Malt Beverage Retailer's License		5/23/2022, 7:00 PM	1
20	LA ARRACHERA	LA ARRACHERA	MARINA VARA DE ARANA, SP	1988 S MUSKEGO AV	Class A Fermented Malt Beverage Retailer's License		7/16/2022, 7:00 PM	1
21	LA PICA #3, LLC	LA PICA CARR 3 BAR & HALL	WILLIAM RIVERA, Agt	3427-31 W LINCOLN AV	Class B Tavern License	162	7/28/2022, 7:00 PM	1
22	Seven Star Liquor LLC	Seven Star Liquor	JASJEET SINGH, Agt	2223 W Forest Home AV	Class A Malt & Class A Liquor License		7/25/2022, 7:00 PM	1
23	PROMOCIONES MEXICAS LLC	EL GRAN TEOCALLI	PALOMA NAVA, Agt	2011 W FOREST HOME AV	Class B Tavern License	282	7/5/2022, 7:00 PM	1

Establishments within a 0.5 miles radius centered on area of interest.



Thursday, September 16, 2021

Licenses Committee Notice of Hearing

TEJINDER RAJPUT
10115 S HAMPTON DR
OAK CREEK, WI 53154

The Licenses Committee will consider the following license application:

Class A Malt and Food Dealer License Applications
SINGH, Kamal, Agent
Kamal Food Mart at 2539 W GRANT St

Date: 9/28/2021

Time: 01:20 PM

Location: The hearing before the Licenses Committee will take place virtually on Tuesday, September 28, 2021. This is a public hearing. Those wishing to view the proceeding are able to do so via the City Channel – Channel 25 on Spectrum Cable – or on the Internet at <http://city.milwaukee.gov/citychannel>. Those wishing to provide oral testimony will be asked to do so by phone or internet and are asked to contact the staff assistant, Molly Kuether-Steele at (414) 286-2775 or molly.kuether-steele@milwaukee.gov for necessary information. Please make such requests no later than one business day prior to the start of the meeting. You are not required to attend the hearing, but please see the information below if you would like to provide testimony

Please note this application may be recommended for denial based on fitness of the location due to concentration of alcohol beverage outlets in the area. If the application is denied for this reason, no other application for an alcohol beverage license for this location shall be recommended for approval by the Licenses Committee within three years of the date of denial unless the applicant has demonstrated a change of circumstances since the prior denial.





Thursday, September 16, 2021

Licenses Committee Notice of Hearing

TEJINDER RAJPUT
2539 W Grant St
Milwaukee, WI 53215

The Licenses Committee will consider the following license application:

Class A Malt and Food Dealer License Applications
SINGH, Kamal, Agent
Kamal Food Mart at 2539 W GRANT St

Date: 9/28/2021

Time: 01:20 PM

Location: The hearing before the Licenses Committee will take place virtually on Tuesday, September 28, 2021. This is a public hearing. Those wishing to view the proceeding are able to do so via the City Channel – Channel 25 on Spectrum Cable – or on the Internet at <http://city.milwaukee.gov/citychannel>. Those wishing to provide oral testimony will be asked to do so by phone or internet and are asked to contact the staff assistant, Molly Kuether-Steele at (414) 286-2775 or molly.kuether-steele@milwaukee.gov for necessary information. Please make such requests no later than one business day prior to the start of the meeting. You are not required to attend the hearing, but please see the information below if you would like to provide testimony

Please note this application may be recommended for denial based on fitness of the location due to concentration of alcohol beverage outlets in the area. If the application is denied for this reason, no other application for an alcohol beverage license for this location shall be recommended for approval by the Licenses Committee within three years of the date of denial unless the applicant has demonstrated a change of circumstances since the prior denial.





Thursday, September 16, 2021



Notice of Public Hearing

blank
notice

SINGH, Kamal, Agent
Kamal Food Mart at 2539 W GRANT St
Class A Malt and Food Dealer License Applications

Tuesday, September 28, 2021 at 1:20 PM

To whom it may concern:

The above application has been made by the above named applicant(s). This requires approval from the Licenses Committee and the Common Council of the City of Milwaukee. The hearing before the Licenses Committee will take place virtually on 9/28/2021 at 1:20 PM. This is a public hearing. Those wishing to view the proceeding are able to do so via the City Channel – Channel 25 on Spectrum Cable – or on the Internet at <http://city.milwaukee.gov/citychannel>. Those wishing to provide oral testimony will be asked to do so by phone or internet and are asked to contact the staff assistant, Molly Kuether-Steele at (414) 286-2775 or molly.kuether-steele@milwaukee.gov for necessary information. Please make such requests no later than one business day prior to the start of the meeting. You are not required to attend the hearing, but please see the information below if you would like to provide testimony. Once the Licenses Committee makes its recommendation, this recommendation is forwarded to the full Common Council for approval at its next regularly scheduled hearing.

Important details for those wishing to provide information for the Licenses Committee to consider when making its recommendation:

1. The license application is scheduled to be heard at the above time. Due to other hearings running longer than scheduled, you may have to wait some time to provide your testimony.
2. You must testify as to matters that you have personally experienced or seen. (You cannot provide testimony for your neighbor, parent or anyone else; this is considered hearsay and cannot be considered by the committee.)
3. No letters or petitions can be accepted by the committee (unless the person who wrote the letter or the persons who signed the petition are willing to testify).
4. Persons opposed to the license application are given the opportunity to testify first; supporters may testify after the opponents have finished.
5. When you are called to testify, you will be sworn in and asked to give your name, and address. (If your first and/or last names are uncommon please spell them.)
6. You may then provide testimony.
 - a. Include only information relating to the above license application.
 - b. Include only information you have personally witnessed or seen.
 - c. Provide concise and relevant information detailing how this business has affected or may affect the peaceful enjoyment of your neighborhood.
 - d. If by the time you have the opportunity to testify, the information you wish to share has already been provided to the committee, you may state that you agree with the previous testimony. Redundant or repetitive testimony will not assist the committee in making its recommendation.
7. After giving your testimony, the members of the Licenses Committee and the licensee may ask questions regarding the testimony you have given or other factors relating to the license application.
8. Business Competition is not a valid basis for denial or non-renewal of a license.

Please Note: If you have submitted an objection to the above application your objection cannot be considered by the committee unless you personally testify at the hearing.

OCCUPANT	MAIL ADDRESS	CITY STATE ZIP
CURRENT OCCUPANT	2154 S 26TH ST	MILWAUKEE, WI 53215-2513
CURRENT OCCUPANT	2155 S 26TH ST	MILWAUKEE, WI 53215-2512
CURRENT OCCUPANT	2158 S 26TH ST	MILWAUKEE, WI 53215-2513
CURRENT OCCUPANT	2159 S 25TH ST	MILWAUKEE, WI 53215-2508
CURRENT OCCUPANT	2159 S 26TH ST	MILWAUKEE, WI 53215-2512
CURRENT OCCUPANT	2159A S 25TH ST	MILWAUKEE, WI 53215-2508
CURRENT OCCUPANT	2161 S 26TH ST	MILWAUKEE, WI 53215-2512
CURRENT OCCUPANT	2161A S 26TH ST	MILWAUKEE, WI 53215-2512
CURRENT OCCUPANT	2162 S 26TH ST	MILWAUKEE, WI 53215-2513
CURRENT OCCUPANT	2162A S 26TH ST	MILWAUKEE, WI 53215-2513
CURRENT OCCUPANT	2163 S 26TH ST	MILWAUKEE, WI 53215-2512
CURRENT OCCUPANT	2169 S 26TH ST	MILWAUKEE, WI 53215-2512
CURRENT OCCUPANT	2169A S 26TH ST	MILWAUKEE, WI 53215-2512
CURRENT OCCUPANT	2174 S 26TH ST	MILWAUKEE, WI 53215-2513
CURRENT OCCUPANT	2200 S LAYTON BLVD	MILWAUKEE, WI 53215-2461
CURRENT OCCUPANT	2200A S LAYTON BLVD	MILWAUKEE, WI 53215-2461
CURRENT OCCUPANT	2208 S LAYTON BLVD	MILWAUKEE, WI 53215-2461
CURRENT OCCUPANT	2210 S LAYTON BLVD	MILWAUKEE, WI 53215-2461
CURRENT OCCUPANT	2212 S LAYTON BLVD	MILWAUKEE, WI 53215-2461
CURRENT OCCUPANT	2213 S 25TH ST	MILWAUKEE, WI 53215-2510
CURRENT OCCUPANT	2216 S 26TH ST	MILWAUKEE, WI 53215-2515
CURRENT OCCUPANT	2217 S 25TH ST	MILWAUKEE, WI 53215-2510
CURRENT OCCUPANT	2217A S 25TH ST	MILWAUKEE, WI 53215-2510
CURRENT OCCUPANT	2219 S 26TH ST	MILWAUKEE, WI 53215-2514
CURRENT OCCUPANT	2220 S 26TH ST	MILWAUKEE, WI 53215-2515
CURRENT OCCUPANT	2220 S LAYTON BLVD	MILWAUKEE, WI 53215-2461
CURRENT OCCUPANT	2220A S 26TH ST	MILWAUKEE, WI 53215-2515
CURRENT OCCUPANT	2221 S 25TH ST	MILWAUKEE, WI 53215-2510
CURRENT OCCUPANT	2221 S 26TH ST	MILWAUKEE, WI 53215-2514
CURRENT OCCUPANT	2221A S 25TH ST	MILWAUKEE, WI 53215-2510
CURRENT OCCUPANT	2222 S 26TH ST	MILWAUKEE, WI 53215-2515
CURRENT OCCUPANT	2222 S LAYTON BLVD	MILWAUKEE, WI 53215-2461
CURRENT OCCUPANT	2223 S 26TH ST	MILWAUKEE, WI 53215-2514
CURRENT OCCUPANT	2225 S 26TH ST	MILWAUKEE, WI 53215-2514
CURRENT OCCUPANT	2227 S 25TH ST	MILWAUKEE, WI 53215-2510
CURRENT OCCUPANT	2229 S 25TH ST	MILWAUKEE, WI 53215-2510
CURRENT OCCUPANT	2229 S 26TH ST	MILWAUKEE, WI 53215-2514
CURRENT OCCUPANT	2229A S 26TH ST	MILWAUKEE, WI 53215-2514
CURRENT OCCUPANT	2230 S 26TH ST	MILWAUKEE, WI 53215-2515
CURRENT OCCUPANT	2231 S 25TH ST	MILWAUKEE, WI 53215-2510
CURRENT OCCUPANT	2231 S 26TH ST	MILWAUKEE, WI 53215-2514
CURRENT OCCUPANT	2231A S 25TH ST	MILWAUKEE, WI 53215-2510
CURRENT OCCUPANT	2233 S 26TH ST	MILWAUKEE, WI 53215-2514
CURRENT OCCUPANT	2234 S 26TH ST	MILWAUKEE, WI 53215-2515
CURRENT OCCUPANT	2234A S 26TH ST	MILWAUKEE, WI 53215-2515
CURRENT OCCUPANT	2235 S 25TH ST	MILWAUKEE, WI 53215-2510

CURRENT OCCUPANT	2237 S 26TH ST	MILWAUKEE, WI 53215-2514
CURRENT OCCUPANT	2238 S 26TH ST	MILWAUKEE, WI 53215-2515
CURRENT OCCUPANT	2239 S 26TH ST	MILWAUKEE, WI 53215-2514
CURRENT OCCUPANT	2241 S 25TH ST	MILWAUKEE, WI 53215-2510
CURRENT OCCUPANT	2241 S 26TH ST	MILWAUKEE, WI 53215-2514
CURRENT OCCUPANT	2242 S 26TH ST	MILWAUKEE, WI 53215-2515
CURRENT OCCUPANT	2243 S 26TH ST	MILWAUKEE, WI 53215-2514
CURRENT OCCUPANT	2244 S 26TH ST	MILWAUKEE, WI 53215-2515
CURRENT OCCUPANT	2245 S 25TH ST	MILWAUKEE, WI 53215-2510
CURRENT OCCUPANT	2245 S 26TH ST	MILWAUKEE, WI 53215-2514
CURRENT OCCUPANT	2245A S 25TH ST	MILWAUKEE, WI 53215-2510
CURRENT OCCUPANT	2246 S 26TH ST	MILWAUKEE, WI 53215-2515
CURRENT OCCUPANT	2249 S 26TH ST	MILWAUKEE, WI 53215-2514
CURRENT OCCUPANT	2502 W GRANT ST	MILWAUKEE, WI 53215-2535
CURRENT OCCUPANT	2502A W GRANT ST	MILWAUKEE, WI 53215-2535
CURRENT OCCUPANT	2504 W GRANT ST	MILWAUKEE, WI 53215-2535
CURRENT OCCUPANT	2507 W GRANT ST	MILWAUKEE, WI 53215-2534
CURRENT OCCUPANT	2508 W GRANT ST	MILWAUKEE, WI 53215-2535
CURRENT OCCUPANT	2509 W GRANT ST	MILWAUKEE, WI 53215-2534
CURRENT OCCUPANT	2512 W GRANT ST	MILWAUKEE, WI 53215-2535
CURRENT OCCUPANT	2512A W GRANT ST	MILWAUKEE, WI 53215-2535
CURRENT OCCUPANT	2515 W GRANT ST	MILWAUKEE, WI 53215-2534
CURRENT OCCUPANT	2516 W GRANT ST	MILWAUKEE, WI 53215-2535
CURRENT OCCUPANT	2522 W GRANT ST	MILWAUKEE, WI 53215-2535
CURRENT OCCUPANT	2522A W GRANT ST	MILWAUKEE, WI 53215-2535
CURRENT OCCUPANT	2525 W GRANT ST	MILWAUKEE, WI 53215-2534
CURRENT OCCUPANT	2526 W GRANT ST	MILWAUKEE, WI 53215-2535
CURRENT OCCUPANT	2526A W GRANT ST	MILWAUKEE, WI 53215-2535
CURRENT OCCUPANT	2529 W GRANT ST	MILWAUKEE, WI 53215-2534
CURRENT OCCUPANT	2530 W GRANT ST	MILWAUKEE, WI 53215-2535
CURRENT OCCUPANT	2530A W GRANT ST	MILWAUKEE, WI 53215-2535
CURRENT OCCUPANT	2534 W GRANT ST	MILWAUKEE, WI 53215-2535
CURRENT OCCUPANT	2601 W GRANT ST	MILWAUKEE, WI 53215-2464
CURRENT OCCUPANT	2601A W GRANT ST	MILWAUKEE, WI 53215-2464
CURRENT OCCUPANT	2607 W GRANT ST	MILWAUKEE, WI 53215-2464
CURRENT OCCUPANT	2608 W GRANT ST	MILWAUKEE, WI 53215-2465
CURRENT OCCUPANT	2609 W GRANT ST	MILWAUKEE, WI 53215-2464
CURRENT OCCUPANT	2609A W GRANT ST	MILWAUKEE, WI 53215-2464
CURRENT OCCUPANT	2612 W GRANT ST	MILWAUKEE, WI 53215-2465
CURRENT OCCUPANT	2612A W GRANT ST	MILWAUKEE, WI 53215-2465
CURRENT OCCUPANT	2615 W GRANT ST	MILWAUKEE, WI 53215-2464
CURRENT OCCUPANT	2616 W GRANT ST	MILWAUKEE, WI 53215-2465
CURRENT OCCUPANT	2616A W GRANT ST	MILWAUKEE, WI 53215-2465
CURRENT OCCUPANT	2619 W GRANT ST	MILWAUKEE, WI 53215-2464
CURRENT OCCUPANT	2619A W GRANT ST	MILWAUKEE, WI 53215-2464
CURRENT OCCUPANT	2620 W GRANT ST	MILWAUKEE, WI 53215-2465

blank

notice

Total Records: 92

Radius: 250.0 feet and Center of Circle: 2539 W Grant St



BUSINESS LICENSE PLAN OF OPERATION

Office of the City Clerk License Division
200 E. Wells St. Room 105, Milwaukee, WI 53202
(414) 286-2238 www.milwaukee.gov/license e-mail address: license@milwaukee.gov

ccl-busplan 5/12/2020

1. Type of Business

Applying for: Extended Hours (12AM to 5AM) - If a food establishment, check all that apply: Delivery Drive Thru Dining Room
 Self Service Laundry Massage Establishment Filling Station
 Other (supplemental application for specific license also required)

Provide a detailed description of the type of business you plan on operating:

GROCERY STORE

Do you have any experience operating this type of business? No Yes If yes, explain: I have been working in the business for several years

2. Business Operations

- a. Proposed Opening Date: 7/7/2021
- b. Is this premise under construction? No Yes If yes, list estimated completion date: _____
- c. Is this a franchise? No Yes
- d. Is this premises currently licensed? No Yes If yes, list type of license: _____
- e. Is the current licensee operating? No Yes If no, list date closed: _____
- f. Do you have future plans for other businesses, licenses or permits at this location? No Yes
If yes, explain: _____
- g. Have you previously held an Extended Hours License in Milwaukee? No Yes
If yes, list address(es): _____
- h. Are other businesses operating in the same building? No Yes If yes, describe: _____

3. Litter & Noise

- a. How are grounds kept clean? Sweep Pressure Wash Pick Up Litter Other: _____
- b. How often will grounds be cleaned? Daily Weekly As Needed Monthly Other: _____
- c. Grounds cleaned by: Licensee Building Owner Employees Hired Maintenance Other: _____
- d. How are noise issues prevented and/or addressed? Security Manager approaches customer(s) Call Police
 Signs Posted Other: _____
- e. Will a sound amplification system be used? No Yes If yes, describe: _____

4. Smoking & Sanitation

- a. Are there designated outdoor smoking areas? No Yes If yes, describe: _____
- b. Number of Garbage Cans: Inside: 2 Locations: NEXT THE CASH REGISTER, REAR OF THE STORE
Outside: 1 Locations: BY THE ENTRANCE
- c. Is a crowd control barrier used? No Yes If yes, describe: _____
- d. How many restrooms are on the premises? 1
- e. Name of solid waste contractor: Advanced Disposal Waste Management Other: COMMERCIAL RUBBISH

5. Security

- a. Are there onsite parking spaces? No Yes If yes, how many? _____ and describe the parking security plan: _____
- b. Is there a loading zone? No Yes If yes, describe the loading area security plan: _____
- c. Will you have security personnel on premise? No Yes If yes, how many? _____ and answer the following:
 What are their responsibilities? _____
 Is security equipment used? No Yes If yes, describe _____
 List their licensing, certification, or training credentials _____
- d. Will there be security cameras? No Yes If yes, how many? 10 and list locations: all around the store the inside & the outside
- e. Will searches/identification checks be done upon entry? No Yes If yes, describe _____

6. Percentage of Sales (must total 100%)

Alcohol <u>45</u> %	Food <u>35</u> %	Secondhand Merchandise <u>0</u> %	Precious Metals & Gems <u>0</u> %
Entertainment <u>0</u> %	Cigarettes <u>20</u> %	Personal Services (such as tattoo, body piercing, salon, tailor, tanning, etc.) <u>0</u> %	Other <u>0</u> % Describe: <u>0</u>
Pawnbroker Activity <u>0</u> %	Salvaged Materials <u>0</u> % (such as scrap metal)		

7. Businesses/Licenses on the Premises (check all that apply):

Type 1

- Full Service Restaurant Cafe/Coffee Shop Deli or Fast Food Restaurant Private/Fraternal/Veterans Club
- Night Club Tavern Cocktail Lounge Teen Club
- Banquet Hall Sports Facility Bowling Alley
- Hotel/Motel: Number of Floors: _____ Number of Rooms: _____
 Rooming House: Number of Floors: _____ Number of Rooms: _____

Type 2

- Liquor Store Corner Store Supermarket Convenience Store
- Gas Station Amusement/Phonograph Distributor Recycling, Salvage or Towing
- Used Car Dealer Personal Service Establishment (such as tattoo business, hair salon, tailor, etc.) Recording Studio

What other licenses/permits will you hold at this location? (check all that apply)

- Occupancy Permit Cigarette & Tobacco Gas Station Extended Hours Class "B" Tavern Weights & Measures
- Secondhand Dealer Precious Metal & Gem Other: _____

8. Legal Capacity (only if a Type 1 premises in #7 above)

Capacity _____ (Call the Milwaukee Development Center at 414-286-8211 if you have questions.)

9. Premises Description

- a. Identify all area(s) of the premises that will be used in operating this business (include areas used only for storage):
 1st Floor 2nd Floor Basement Storage Patio Beer Garden Sidewalk Café Deck Rooftop
 Other: Describe: _____
- b. Describe Location: Major Thoroughfare Secondary Street Other: _____
- c. Nearest Major Cross Street: _____
- d. Describe Building: Free Standing Building Strip Mall Other: _____
- e. Describe Premises Structure: Single Story Multi-Story - # of Stories _____ Other: _____
- f. Describe Surrounding Area: Commercial Residential Industrial Other: _____
- g. Building Owner Name: x Tajinder Rajput Phone Number: x 847-845-1688
 Building Owner Address: 2539 W GRANT STREET, MILWAUKEE, WI 53215

10. Hours of Operation & Customers

Will customers be entering the premises? No Yes

Day of the Week	Proposed Hours of Operation:		Estimated Number of Customers expected each day	Potential Age Range of Customers	Class B Tavern Applicant Only: Age Restriction (if none, write 'None')
	Open Time (include a.m. or p.m.)	Close Time (include a.m. or p.m.)			
Sunday	9:00 AM	9:00 PM	30	ADULTS	NONE
Monday	=	=	=	=	
Tuesday	=	=	=	=	
Wednesday	=	=	=	=	
Thursday	=	=	=	=	
Friday	=	=	=	=	
Saturday	=	=	50	=	

An Extended Hours Establishment License is required for any convenience store, filling station, personal service establishment (such as tattoo, body piercing, salon, tailor, tanning, etc.), recording studio or restaurant which is open between the hours of 12:00 a.m. and 5:00 a.m.

Alcohol Establishments Permitted Hours of Operation: Class A: 8:00 am to 9:00 pm Sunday thru Saturday
 Class B: 6:00 am to 2:00 am Sunday thru Thursday, 6:00 am to 2:30 am Friday & Saturday

Entertainment Outdoor Closing Hours: 10:00pm Sunday-Thursday; 12:00am Friday & Saturday; unless a different time, either earlier or later, is established by the Common Council in its approval of the licensee's plan of operation.

11. Signature(s)

x [Signature]
 Signature of Sole Proprietor, Partner, or 20% or more Shareholder
 (If there are no 20% or more shareholders,
 Corporate Officer-print name/title and sign)

 Signature of additional partner or 20% or more shareholder

See Application Information for a complete list of all required application forms.



**ALCOHOL BEVERAGE & PUBLIC ENTERTAINMENT PREMISES
SUPPLEMENTAL APPLICATION**

Office of the City Clerk License Division
200 E. Wells St. Room 105, Milwaukee, WI 53202
(414) 286-2238 e-mail address: license@milwaukee.gov www.milwaukee.gov/license

Legal Entity Name: <u>Kamal Food Mart LLC</u>	
Premise Address: <u>2539 W Grant St, Milwaukee, WI 53215</u>	
Proximity of Premises to Church, School, Daycare Center or Hospital	
Is the building within 300 feet of any church, school, daycare center or hospital? <input checked="" type="checkbox"/> No <input type="checkbox"/> Yes	
"Service Bar Only" Designation	
If applying for Class B or C license, are you applying for "Service Bar Only"? <input checked="" type="checkbox"/> No <input type="checkbox"/> Yes	
Service Bar Only means customers cannot sit at the bar. Alcohol is served to employees who serve patrons seated at tables. No stools, chairs or other articles of furniture shall be placed at the service bar for patrons to sit upon.	
Business Information	
a) Are you taking out this application for anyone that may not be eligible for a license? <input checked="" type="checkbox"/> No <input type="checkbox"/> Yes If yes, list their name and address: _____	
b) Will the agent, a partner or the individual licensee be conducting the day-to-day operations of the business? <input type="checkbox"/> No <input checked="" type="checkbox"/> Yes If no, list the name and address of the person(s) who will: _____	
Class B Applicants: If the agent, a partner or the individual licensee will not be conducting the day-to-day operations of the business, the person(s) listed above must obtain a Class B Managers license.	
c) Does anyone else have money invested or any other interest in this business? <input checked="" type="checkbox"/> No <input type="checkbox"/> Yes If yes, explain: _____	
d) Have you made an agreement with anyone to repay any loan or any other payments based upon income from the business? <input checked="" type="checkbox"/> No <input type="checkbox"/> Yes If yes, list name and address: _____	
Property Information (New & Transfer Applicants Only)	
a) Do you own or lease the building? <input type="checkbox"/> Own <input checked="" type="checkbox"/> Lease	
b) Who owns the fixtures (for example, coolers, etc.)? <u>owner</u>	
c) Are you purchasing the stock and/or fixtures? <input checked="" type="checkbox"/> No <input type="checkbox"/> Yes If yes, amount paid \$ _____	
d) Total amount paid for business \$ _____	
e) Total amount paid for goodwill of the business \$ _____	
Goodwill comprises the reputation and customer relationships of an existing business. If the price you pay for the business exceeds the fair market value of all of the rest of the assets of the business, the excess may be considered goodwill.	
f) Have you made arrangements with the seller for payment of personal property taxes? <input checked="" type="checkbox"/> No <input type="checkbox"/> Yes	
Lease Information (New & Transfer Applicants who are leasing the premises only)	
a) Date lease begins <u>11/1/2020</u> Ends <u>10/31, 2025</u>	
b) Monthly rental \$ <u>1,000</u>	
c) Do you have an option to renew the lease? <input type="checkbox"/> No <input checked="" type="checkbox"/> Yes	
d) Does your lease allow for assignment to another party without the consent of the owner? <input checked="" type="checkbox"/> No <input type="checkbox"/> Yes	
e) For what length of time have you been guaranteed occupancy (number of years)? <u>5 years</u>	

Lease Information (Continued)

- f) In addition to paying the monthly rental, will you have to pay anything additional to the owner of the building to guarantee performance of the lease? No Yes If yes, explain _____
- g) Does the present owner or occupancy object to the granting of your license? No Yes
If yes, explain _____

Change of Agent Applicants Only

Have there been any changes to the floor plan since the last application was submitted? No Yes
If no, a new floor plan is not required. If yes, submit a new floor plan and explain the change(s):

Signature



Signature of Sole Proprietor, Partner or 20% or More Shareholder
(If no 20% or more Shareholder, Corporate Officer - print name/title and sign)

Note: All information contained in this application is subject to approval by the Common Council.
Deviating from approved plan of operation will subject licensee to citations, and/or suspension or non-renewal of the license.
Contact the License Division for information on how to request changes.

New and transfer of premises applicants must submit the following:

- Detailed floor plan
- If a restaurant, copy of the menu



FOOD DEALER LICENSE PLAN OF OPERATION

cci-foodplan 2/28/19

OFFICE OF THE CITY CLERK, LICENSE DIVISION
CITY HALL, 200 E. WELLS ST, ROOM 105, MILWAUKEE, WI 53202
(414) 286-2238 • license@milwaukee.gov • www.milwaukee.gov/license

Legal Entity Name: **KAMAL FOOD MART LLC**

Premises Address: **2539 W Grant St. Milwaukee, WI 53215**

SECTION 1 TYPE OF BUSINESS

What will be the majority of your food sales? (check one)

Restaurant Items (meals):

MEALS include, but are not limited to, chicken, ribs, sandwiches, roasted corn, baked potatoes, hot dogs, brats, tacos, nachos w/ cheese and meat, French fries, cooked or deep fried vegetables/fruit, cooked cheese curds, corn dogs, egg rolls, salads.

Retail Items (snacks and beverages):

RETAIL items include, but are not limited to, ice cream/soft serve, lemonade, snow cones, coffee, espresso, cappuccino, tea, fruit juice, smoothies, candy, dispensed soda, fruit cups, bakery, cookies, kettle corn, cotton candy, funnel cakes, fritters, tortilla chips w/ cheese.

Will it be a convenience store? Yes No

A convenience store contains less than 5,000 square feet of retail space and has, as its primary business, the sale of basic food items and in addition, sells household products or is a filling station that sells basic food items and household products.

Bed & Breakfast

Micro Market

All Applicants: Submit a menu or a list of food items that will be sold.

Will any wholesale business be done? No Yes If yes, what percentage of food sales will be wholesale?

Less than 25%

25% or More AND:

Restaurant items (meals) will be sold - Complete this application and also contact DATCP.

NO restaurant items (meals) will be sold - Do NOT complete this application. Contact DATCP only.

SECTION 2 FOOD PROCESSING

Will any food processing be done? No Yes

Processing is defined as assembling, grinding, cutting, mixing, baking, coating, stuffing, packing, bottling, grilling, canning, extracting, fermenting, distilling, pickling, freezing, drying, smoking, or packaging.

SECTION 3 FOOD REQUIRING TEMPERATURE CONTROL

Will any food that requires temperature control be sold? No Yes
(includes dairy products such as milk, cheese, and ice cream, fish, shellfish, meat, poultry)

If yes, list the types of food items: Milk-Eggs-Meat-Frozenfood

SECTION 4 DETAILS OF OPERATION

Will you have seating on site for dining? No Yes

Will you be doing any catering? No Yes

Will you be doing any delivery? No Yes

Will you have outdoor activities? No Yes - Check all that apply: Bar Cooking/Grilling Dining

Will you have a drive thru window? No Yes - Are hours different from inside? No Yes
 If Yes, provide drive thru hours: _____

Will scales or barcode scanners be used? No Yes - You must also apply for a Weights & Measures License.

SECTION 5 ADDITIONAL SITES

Where will food be prepared and/or sold?
 At a single site At multiple sites: How many? _____ (for example, a hotel with several dining rooms or bars)
 If multiple sites, attach a Food Dealer Additional Site Addendum (ccl-foodadd) for each additional site.

SECTION 6 CONSTRUCTION OR CHANGES

Are you planning any construction, remodeling or equipment changes?
 No If No, SKIP to Section 8
 Yes If Yes, check all that apply: New construction of a building Renovation or remodeling
 Construction changes to existing building Equipment changes only

Provide a brief description of the changes: _____
 Start date: _____
 Name, Address & Phone Number of Architect: _____
 Name, Address & Phone Number of Contractor: _____

SECTION 7 ALCOHOL BEVERAGES

Are you applying for an alcohol beverage license?
 No If No, SKIP to Section 8
 Yes If YES, if your food license is approved prior to the alcohol license, when do you want the food license issued?
 Immediately At the same time as the alcohol license

SECTION 8 ACKNOWLEDGEMENTS & SIGNATURE

You must initial each item confirming your understanding:

KS _____ I understand the Health Department must conduct an inspection and advise the License Division of their approval before the license may be issued.

KS _____ I understand I must obtain an occupancy permit from the Department of Neighborhood Services and an inspection may be required. Neighborhood Services must advise the License Division of their approval before the license may be issued.

KS _____ I understand the district alderperson will review and either support or object to my application. If he/she objects, I may appeal and be scheduled to appear before the Licenses Committee. The Licenses Committee will then make a recommendation to the Common Council. The Common Council must grant the license before it may be issued.

KS _____ I understand proof of payment for all license fees must be on file in the License Division before the license may be issued and the license must be issued and posted in my establishment prior to opening for business.

KS _____ I will not operate my food business until the license has been issued and posted in the establishment.

Signature of Sole Proprietor, Partner, or 20% Shareholder: Kennel Syde

Signature of Additional Partner: _____

Kamal Food Mart LLC
2539 W Grant St.
Milwaukee, WI 53215
Agent: Singh Kamal
Total Sq Footage: 910
1/28/2021

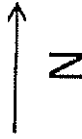

26th Street

Street Parking Only

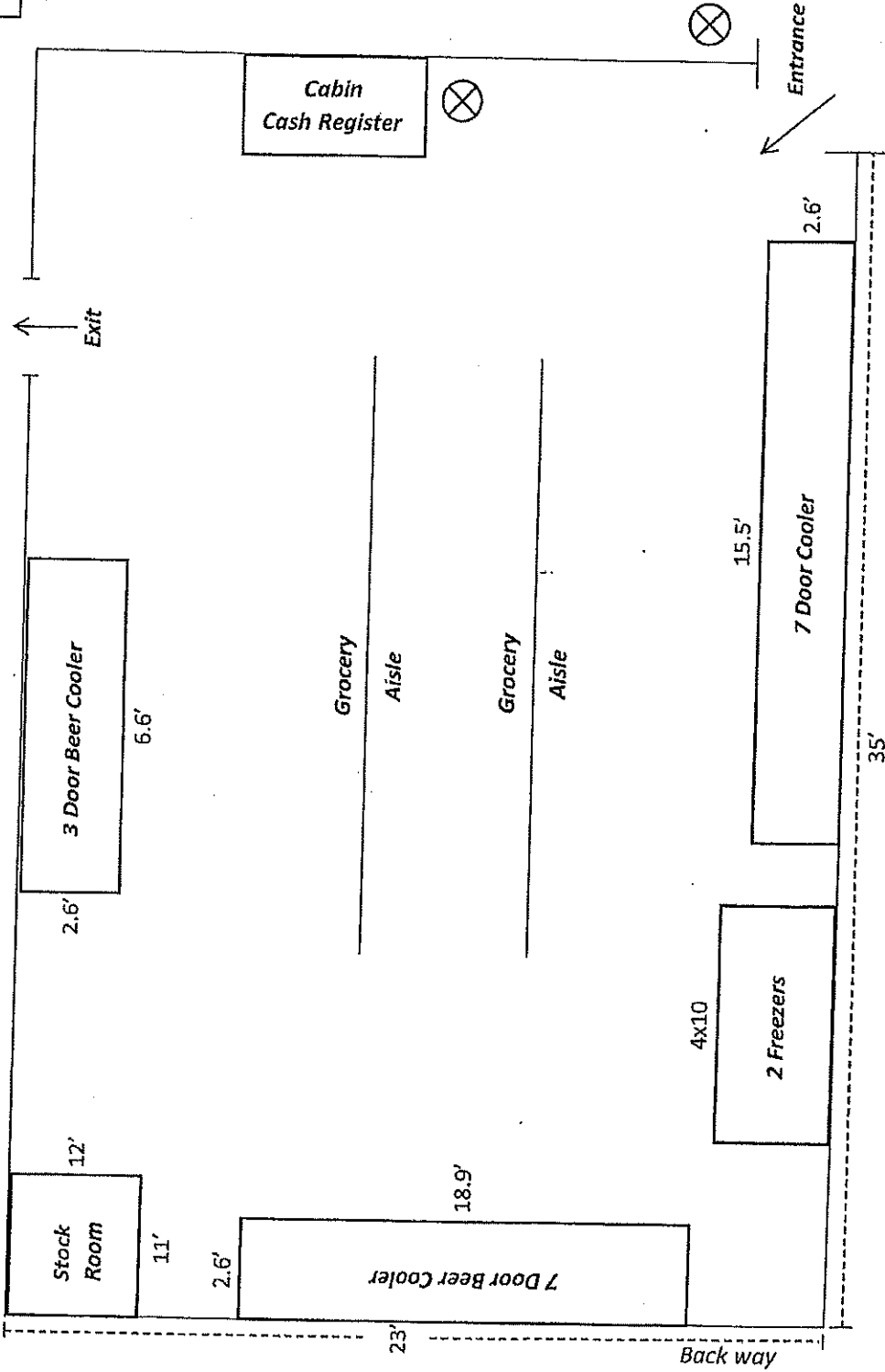

Grant St