

ALL DIMENSIONS SHOWN ARE MEASURED TO THE
NEAREST HUNDREDTH OF A FOOT.
ALL BEARINGS ARE REFERENCED TO THE NORTH LINE
OF THE NE 1/4 OF SECTION 17, T 7 N, R 22 E, WHICH
BEARS S89°32'05"E. WISCONSIN COUNTY COORDINATE
SYSTEM, MILWAUKEE COUNTY.



STAFF APPROVED

CERTIFIED SURVEY MAP NO. _____

A division of Lots 6, 7, 8, 9 and 10, in Block 4, in Chas. Fahsel's Subdivision No. 1 in the NE 1/4 of Section 17, part of Lots 11 & 15 in Block 4, in Assessment Subdivision No. 31, being in the Northwest 1/4 of the Northeast 1/4 of Section 17, in Township 7 North, Range 22 East, in the City of Milwaukee, Milwaukee County, Wisconsin.

SURVEYOR'S CERTIFICATE

STATE OF WISCONSIN }
 :SS
WAUKESHA COUNTY }

I, JOHN P. CASUCCI, Professional Land Surveyor, do hereby certify:

THAT I have surveyed, divided and mapped a division of Lots 6, 7, 8, 9 and 10, in Block 4, in Chas. Fahsel's Subdivision No. 1 in the NE 1/4 of Section 17, part of Lots 11 & 15 in Block 4, in Assessment Subdivision No. 31, being in the Northwest 1/4 of the Northeast 1/4 of Section 17, in Township 7 North, Range 22 East, in the City of Milwaukee, Milwaukee County, Wisconsin, which is bounded and described as follows:

COMMENCING at the Northwest corner of the Northeast 1/4 of said Section 17; thence South 89° 32' 05" East along the North line of said 1/4 Section a distance of 1002.54 feet to a point; thence South 00° 29' 45" West along the East line of North Dr. Martin Luther King Jr. Drive and it's extension 115.00 feet to the point of beginning of lands to be described; thence South 89° 32' 05" East 150.00 feet to a point in the West line of a 20 foot public alley; thence South 00° 29' 45" West along said West line 404.196 feet to the Northeast corner of Lot 8 in D.T. Brown's Subdivision of Lot G, Block 4; thence North 89° 26' 31" West along the North line of said Lot 150.00 feet to a point in the East line of North Dr. Martin Luther King Jr. Drive; thence North 00° 29' 45" East along said East line 403.953 feet to the point of beginning.

Said lands contain 60,611 square feet or 1.3914 acres

THAT I have made the survey, land division and map by the direction of MLK Investment LLC, owner.

THAT the map is a correct representation of all the exterior boundaries of the land surveyed and the land division thereof made.

THAT I have complied with Chapter 236 of the Wisconsin Statutes and Chapter 119 of the Milwaukee Code of Ordinances in surveying, dividing and mapping the same. Per Wis. Stat. 236.21 (1), this certificate has the same force and effect as an affidavit.

JULY 1, 2024
Field date
Revised 8-1-24
Revised 3-10-25



John P. Casucci

JOHN P. CASUCCI
PROFESSIONAL LAND SURVEYOR S-2055

CERTIFIED SURVEY MAP NO. _____

A division of Lots 6, 7, 8, 9 and 10, in Block 4, in Chas. Fahsel's Subdivision No. 1 in the NE 1/4 of Section 17, part of Lots 11 & 15 in Block 4, in Assessment Subdivision No. 31, being in the Northwest 1/4 of the Northeast 1/4 of Section 17, in Township 7 North, Range 22 East, in the City of Milwaukee, Milwaukee County, Wisconsin.

ENTITY OWNER'S CERTIFICATE

MLK Investment, LLC, a limited liability company duly organized and existing under and by virtue of the laws of the State of Wisconsin, as owner, certifies that said company caused the land described on this Certified Survey Map, to be surveyed, divided and mapped as represented on this Map in accordance with the requirements of Chapter 236 of the Wisconsin Statutes and Chapter 119 of the Milwaukee Code of Ordinances In consideration of the approval of the map by the Milwaukee Common Council, the undersigned agrees:

That all utility lines to provide electric power and telephone service and cable television or communications systems lines or cables to all lots in the certified survey map (other than already- existing lines and cables) shall be installed underground in easements provided therefore, where feasible.

THIS agreement is binding on the undersigned and successors and assigns.

Date: March 12, 2025

Entity Name: MLK Investment LLC

Signature: M. Araf MEMBER

Print Name: MOHAMMED GHAFAR

Title: Member

STATE OF Wisconsin }
Milwaukee COUNTY }SS

PERSONALLY came before me this 12th day of March, 2025

Mohammed Ghaffar, the managing member of the above named limited liability company to me known to be the person who executed the foregoing instrument, and acknowledged that he/she executed the foregoing instrument as such officer on behalf of the entity, by its authority.

Lauren L. Wick

Lauren L. Wick, esq

(print name)
Notary Public, State of Wisconsin
My commission expires permanent



(Notary Seal)

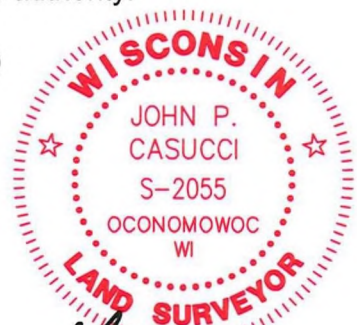

John P. Casucci

JULY 1, 2024
Revised 8-1-24
Revised 3-10-25

raSmith
CREATIVITY BEYOND ENGINEERING

16745 W Bluemound Road
Brookfield, WI 53005-5938
(262) 781-1000
rasmith.com

CERTIFIED SURVEY MAP NO. _____

A division of Lots 6, 7, 8, 9 and 10, in Block 4, in Chas. Fahsel's Subdivision No. 1 in the NE 1/4 of Section 17, part of Lots 11 & 15 in Block 4, in Assessment Subdivision No. 31, being in the Northwest 1/4 of the Northeast 1/4 of Section 17, in Township 7 North, Range 22 East, in the City of Milwaukee, Milwaukee County, Wisconsin.

CERTIFICATE OF CITY TREASURER

I, SPENCER COGGS, being the duly elected and acting City Treasurer of the City of Milwaukee, certify that in accordance with the records in the office of the City Treasurer of the City of Milwaukee there are no unpaid taxes or unpaid special assessments on the land included in this certified survey map.

Per Wis. Stat. 75.06 and 74.87, the City of Milwaukee collects property taxes and enforces nonpayment of same on parcels in the City of Milwaukee. Per Wis. Stat. 74.83, the City of Milwaukee and Milwaukee County entered into an Intergovernmental Cooperation Agreement approved by Council Resolution 901408, whereby the city is the sole collector and enforcer of property taxes for parcels in the city.

Date: 4/7/2025

for
LaQuisha H. Schneider
SPENCER COGGS, CITY TREASURER

CERTIFICATE OF CITY CLERK REGARDING COMMON COUNCIL APPROVAL

I, JAMES R. OWCZARSKI, certify that this certified survey map was approved under Resolution File

No. 241965, adopted by the Common Council of the City of Milwaukee on

Date: 4-22-2025

[Signature]
JAMES R. OWCZARSKI, CITY CLERK

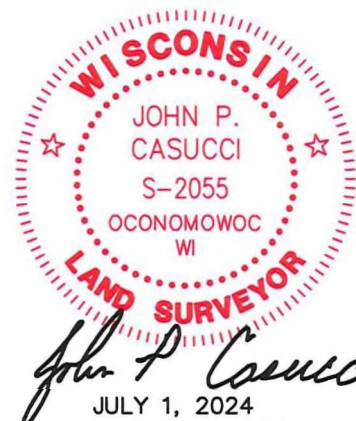

JULY 1, 2024
Revised 8-1-24
Revised 3-10-25

THIS INSTRUMENT WAS DRAFTED BY JOHN P. CASUCCI,
PROFESSIONAL LAND SURVEYOR S-2055

169290.CS10

raSmith
CREATIVITY BEYOND ENGINEERING

16745 W. Bluemound Road
Brookfield, WI 53005-5938
(262) 781-1000
rasmith.com