



NEW PROPOSED METHOD OF INSTALLATION (DIRECT PAINTING)

- Painting directly on surface
- Protects Historic Brick
- Removable by painting over it
- More visible
- Faster to complete

Sectional View Of A Typical EIFS Application

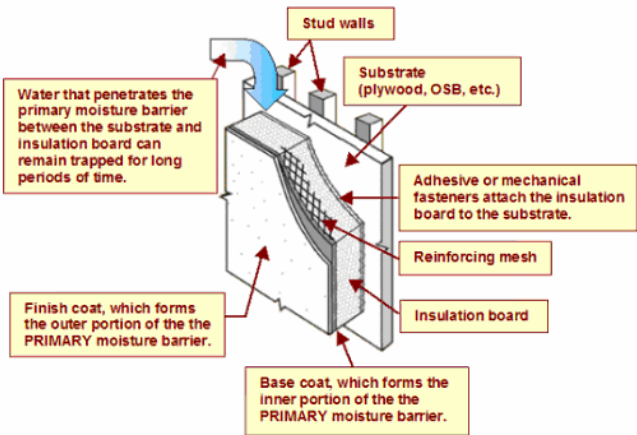
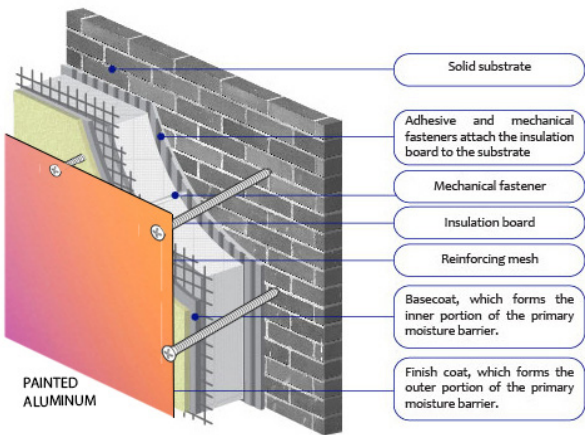

Figure 1



This EIFS diagram is only to show the concept that panels would be drilled through the EIFS wall into the brick. It does not accurately detail the wall composition or type of screws or method. It was recommended the brick be inspected for good condition to anchor screws.

ORIGINAL PROPOSAL: EIFS WALL MEANS ANCHORING REMOVABLE PANELS INTO BRICK, HOLES

According to Pam's email the wall is a type of common construction called "Exterior Insulated Finish System (EIFS)". A google image search shows similar composition with variations in layering, material type and substrate (brick, concrete, etc). It's not meant for anchoring into.

This diagram is just to show typical wall composition but isn't the actual wall. Additional samples: <https://www.terrace-iefs.com/what-is-iefs-etics/>

ALUMINUM PANELS

OmegaBond aluminum composite panels. Spec sheet: <https://www.laminatorsinc.com/sign-panels/products/omega-bond>

*Note screws every 2' around perimeter of each of 24-26 panels

*Minimum 260 screws into brick. (Look close for white dots)

*Wall is not perfectly flat, panels may not line up perfectly.

*Chance of moisture build up behind panels causing water damage to wall or bowing

