



LIVING WITH HISTORY

Certificate of Appropriateness

Milwaukee Historic Preservation Commission/200 E. Wells Street/Milwaukee, WI 53202/phone 414-286-5712/fax 414-286-3004

Property 3288 N. LAKE DR. North Lake Drive Estates Historic District
Description of work Install non-illuminated monument style lawn sign 12 feet by 3 feet, with masonry piers and raised, individual letters (type A) on front elevation near foundation and 380 feet from the street.

Date issued 8/16/2013 PTS ID 82096 COA, monument type sign on front lawn

In accordance with the provisions of Section 320-21 (11) and (12) of the Milwaukee Code of Ordinances, the Milwaukee Historic Preservation Commission has issued a certificate of appropriateness for the work listed above. The work was found to be consistent with preservation guidelines. The following conditions apply to this certificate of appropriateness:

All work will be done to according to attached drawings, photos and specifications. The masonry piers will be cast stone made as closely as possible to the appearance of the genuine stone on the house. The sign will be free-standing and not attached to the house. Signboard will be non-illuminated and composed of raised individual letters.

All work must be done in a craftsman-like manner, and must be completed within one year of the date this certificate was issued. Staff must approve any changes or additions to this certificate before work begins. Work that is not completed in accordance with this certificate may be subject to correction orders or citations. If you require technical assistance, please contact Paul Jakubovich of the Historic Preservation staff as follows: Phone: (414) 286-5712 Fax: (414) 286-3004 E-mail: pjakub@milwaukee.gov. If permits are required, you are responsible for obtaining them from the Milwaukee Development Center. If you have questions about permit requirements, please consult the Development Center's web site, www.milwaukee.gov/build, or call (414) 286-8210.

Paul Jakubovich
City of Milwaukee Historic Preservation

Copies to: Development Center, Ald. Nik Kovac, Inspector Bill Richter (286-2518), Inspector Heidi Weed



SIGN ELEVATION
SCALE: 1/2"=1'



DIMENSIONS
SCALE: 1/2"=1'
NOTE: ALL DIMENSIONS APPROXIMATE.
VERIFY WITH FABRICATOR

Dimensions and specifications for a free-standing monument type lawn sign which will be located near the foundation of the front elevation facing west.



PROPOSED NEW PEDESTAL SIGN
VIEW FROM LAKE DRIVE



SIGN ELEVATION
SCALE: 1/2" = 1'

Elevation of new sign. Signboard is 12 feet long and 3 feet in height.



**Masonry piers for the sign
will feature cast stone
made to resemble the
stone on the main house
pictured here.**



Partial front elevation
(west) showing new
monument sign

WEST ELEVATION
SCALE: 1/8" = 1'
SEE SHEET 2 FOR DETAILS, DIMENSIONS

PROPOSED NEW
PEDESTAL SIGN



↑
LOCATION OF NEW SIGN
IN FRONT OF EXISTING
BUILDING - SEE ENLARGED
ELEVATIONS AND PHOTOGRAPHS
FOR DETAILS AND DIMENSIONS

WEST ELEVATION
NOT TO SCALE

Complete front elevation (west) showing new sign placement and size

Location of new free-standing monument sign.

EDGE OF SIGN

NG

LOCATION OF PROPOSED NEW PEDESTAL SIGN

ADMINISTRATION

DORMITORY WING

CLASSROOM WING

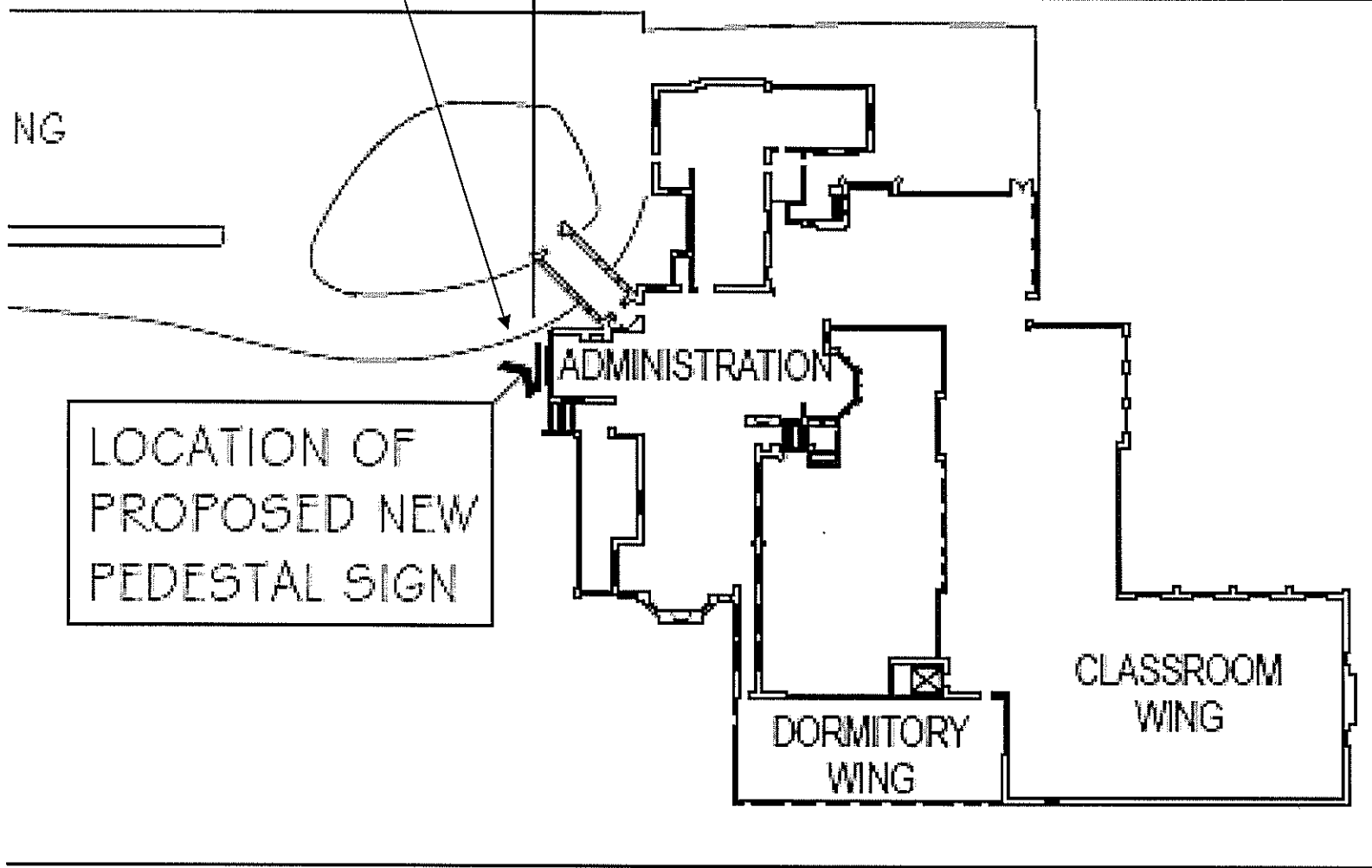
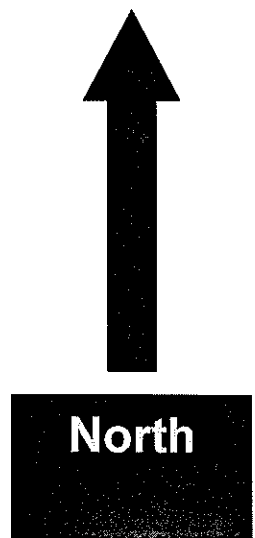

Photo rendering showing new, free-standing monument sign on the front (west elevation) of the house



PROPOSED NEW PEDESTAL SIGN
VIEW AT BUILDING ENTRANCE