



CITY OF MILWAUKEE
OFFICE OF THE CITY CLERK

Thursday, October 11, 2018

COMMITTEE MEETING NOTICE

AD 05

EBERT, Jason M, Agent
Riteway Bus Service, Inc
P.O Box 398
Germantown, WI 53022

You are requested to attend a hearing which is to be held in Room 301-B, Third Floor, City Hall on:

Tuesday, October 23, 2018 at 09:15 AM

Regarding: Your Recycling, Salvaging, or Towing Premises License Application requesting Removing/Recycling Waste Tires and Removing/Recycling Salvaged Motor Vehicle Parts as agent for "Riteway Bus Service, Inc" for "GORITWAY Transportation Group" at 5444 N 124th St.

There is a possibility that your application may be denied for one or more of the following reasons: The recommendation of the committee regarding the application shall be based on evidence presented at the hearing. Per MCO 85-2.7-4, probative evidence concerning whether or not a new license should be granted may be presented on the following subjects: whether or not the applicant meets the municipal requirements, the appropriateness of the location and premises where the licensed premises is to be located and whether use of the premises for the purposes or activities permitted by the license would tend to facilitate a public or private nuisance or create undesirable neighborhood problems such as disorderly patrons, unreasonably loud noise, litter, and excessive traffic and parking congestion. Probative evidence relating to these matters may be taken from the plan of operation submitted with the license application, if any, but shall not include the content of any music. Evidence regarding the fitness of the location of the premises to be maintained as the principal place of business, including but not limited to whether there is an overconcentration of businesses of the type for which the license is sought; whether the proposal is consistent with any pertinent neighborhood business or development plans, or the location's proximity to areas where children are typically present. The applicant's record in operating similarly licensed premises; and whether or not the applicant has been charged with or convicted of any felony, misdemeanor, municipal offense or other offense, the circumstances of which substantially relate to the activity to be permitted by the license being applied for or any other factor which reasonably relates to the public health, safety or welfare may also be considered.

Notice for applicants with warrants or unpaid fines:

Proof of warrant satisfaction or payment of fines must be submitted at the hearing on the above date and time. Failure to comply with this requirement may result in a delay of the granting/denial of your application.

Failure to appear at this meeting may result in the denial of your license. Individual applicants must appear only in person or by an attorney. Corporate or Limited Liability applicants must appear only by the agent designated on the application or by an attorney. Partnership applicants must appear by a partner listed on the application or by an attorney. If you wish to do so and at your own expense, you may be accompanied by an attorney of your choosing to represent you at this hearing.

You will be given an opportunity to speak on behalf of the application and to respond and challenge any charges or reasons given for the denial. No petitions can be accepted by the committee, unless the people who signed the petition are present at the committee hearing and willing to testify. You may present witnesses under oath and you may also confront and cross-examine opposing witnesses under oath. If you have difficulty with the English language, you should bring an interpreter with you, at your expense, so that you can answer questions and participate in your hearing.

You may examine the application file at this office during regular business hours prior to the hearing date. Inquiries regarding this matter may be directed to the person whose signature appears below.

Limited parking for persons attending meetings in City Hall is available at reduced rates (5 hour limit) at the Milwaukee Center on the southwest corner of East Kilbourn and North Water Street. Parking tickets must be validated in the first floor information booth in City Hall.

PLEASE NOTE: Upon reasonable notice, efforts will be made to accommodate the needs of disabled individuals through sign language interpreters or other auxiliary aids. For additional information or to request this service, contact the Council Services Division ADA Coordinator at (414) 286-2998, Fax - (414) 286-3456, TDD - (414) 286-2025.

JIM OWCZARSKI, CITY CLERK

BY:

Jessica Ceella

License Division Manager

If you have questions regarding this notice, please contact the License Division at (414) 286-2238.

200 E. Wells Street, Room 105, City Hall, Milwaukee, WI 53202. www.milwaukee.gov/license
Phone: (414) 286-2238 Fax: (414) 286-3057 Email Address: License@milwaukee.gov



CITY OF MILWAUKEE
OFFICE OF THE CITY CLERK

Thursday, October 11, 2018

COMMITTEE MEETING NOTICE

AD 05

EBERT, Jason M, Agent
Riteway Bus Service, Inc
N1568 Lake Ridge Dr
Adell, WI 53001

You are requested to attend a hearing which is to be held in Room 301-B, Third Floor, City Hall on:

Tuesday, October 23, 2018 at 09:15 AM

Regarding: Your Recycling, Salvaging, or Towing Premises License Application Requesting Removing/Recycling Waste Tires and Removing/Recycling Salvaged Motor Vehicle Parts as agent for "Riteway Bus Service, Inc" for "GORITEWAY Transportation Group" at 5444 N 124th St.

There is a possibility that your application may be denied for one or more of the following reasons: The recommendation of the committee regarding the application shall be based on evidence presented at the hearing. Per MCO 85-2.7-4, probative evidence concerning whether or not a new license should be granted may be presented on the following subjects: whether or not the applicant meets the municipal requirements, the appropriateness of the location and premises where the licensed premises is to be located and whether use of the premises for the purposes or activities permitted by the license would tend to facilitate a public or private nuisance or create undesirable neighborhood problems such as disorderly patrons, unreasonably loud noise, litter, and excessive traffic and parking congestion. Probative evidence relating to these matters may be taken from the plan of operation submitted with the license application, if any, but shall not include the content of any music. Evidence regarding the fitness of the location of the premises to be maintained as the principal place of business, including but not limited to whether there is an overconcentration of businesses of the type for which the license is sought; whether the proposal is consistent with any pertinent neighborhood business or development plans, or the location's proximity to areas where children are typically present. The applicant's record in operating similarly licensed premises; and whether or not the applicant has been charged with or convicted of any felony, misdemeanor, municipal offense or other offense, the circumstances of which substantially relate to the activity to be permitted by the license being applied for or any other factor which reasonably relates to the public health, safety or welfare may also be considered.

Notice for applicants with warrants or unpaid fines:

Proof of warrant satisfaction or payment of fines must be submitted at the hearing on the above date and time. Failure to comply with this requirement may result in a delay of the granting/denial of your application.

Failure to appear at this meeting may result in the denial of your license. Individual applicants must appear only in person or by an attorney. Corporate or Limited Liability applicants must appear only by the agent designated on the application or by an attorney. Partnership applicants must appear by a partner listed on the application or by an attorney. If you wish to do so and at your own expense, you may be accompanied by an attorney of your choosing to represent you at this hearing.

You will be given an opportunity to speak on behalf of the application and to respond and challenge any charges or reasons given for the denial. No petitions can be accepted by the committee, unless the people who signed the petition are present at the committee hearing and willing to testify. You may present witnesses under oath and you may also confront and cross-examine opposing witnesses under oath. If you have difficulty with the English language, you should bring an interpreter with you, at your expense, so that you can answer questions and participate in your hearing.

You may examine the application file at this office during regular business hours prior to the hearing date. Inquiries regarding this matter may be directed to the person whose signature appears below.

Limited parking for persons attending meetings in City Hall is available at reduced rates (5 hour limit) at the Milwaukee Center on the southwest corner of East Kilbourn and North Water Street. Parking tickets must be validated in the first floor information booth in City Hall.

PLEASE NOTE: Upon reasonable notice, efforts will be made to accommodate the needs of disabled individuals through sign language interpreters or other auxiliary aids. For additional information or to request this service, contact the Council Services Division ADA Coordinator at (414) 286-2998, Fax - (414) 286-3456, TDD - (414) 286-2025.

JIM OWCZARSKI, CITY CLERK

BY: _____

Jessica Celella

License Division Manager

If you have questions regarding this notice, please contact the License Division at (414) 286-2238.

200 E. Wells Street, Room 105, City Hall, Milwaukee, WI 53202. www.milwaukee.gov/license
Phone: (414) 286-2238 Fax: (414) 286-3057 Email Address: License@milwaukee.gov



BUSINESS LICENSE PLAN OF OPERATION

ccl-busplan 3/7/16

Office of the City Clerk License Division
200 E. Wells St. Room 105, Milwaukee, WI 53202
(414) 286-2238 www.milwaukee.gov/license e-mail address: license@milwaukee.gov

1. Type of Business

- Applying for: Extended Hours Establishment Filling Station
 Self Service Laundry Rooming House Hotel/Motel Massage Establishment
 Other (supplemental application for specific license also required)

Provide a detailed description of the type of business you plan on operating:

School Bus Terminal

Do you have any experience operating this type of business? No Yes If yes, explain: *operate 20 locations across state*

2. Business Operations

- a. Proposed Opening Date: *Already open*
- b. Is this premise under construction? No Yes If yes, list estimated completion date: _____
- c. Is this a franchise? No Yes
- d. Is this premises currently licensed? No Yes If yes, list type of license: *Occupancy / unfired Pressure vessel*
- e. Is the current licensee operating? No Yes If no, list date closed: _____
- f. Do you have future plans for other businesses, licenses or permits at this location? No Yes
If yes, explain: _____
- g. Have you previously held an Extended Hours License in Milwaukee? No Yes
If yes, list address(es): _____
- h. Are other businesses operating in the same building? No Yes If yes, describe: _____

3. Litter & Noise

- a. How are grounds kept clean? Sweep Pressure Wash Pick Up Litter Other: _____
- b. How often will grounds be cleaned? Daily Weekly As Needed Monthly Other: _____
- c. Grounds cleaned by: Licensee Building Owner Employees Hired Maintenance Other: _____
- d. How are noise issues prevented and/or addressed? Security Manager approaches customer(s) Call Police
 Signs Posted Other: *Issues are addressed by staff with employees*
- e. Will a sound amplification system be used? No Yes If yes, describe: _____

4. Smoking & Sanitation

- a. Are there designated outdoor smoking areas? No Yes If yes, describe: _____
- b. Number of Garbage Cans: Inside: _____ Locations: _____
Outside: _____ Locations: _____
- c. Is a crowd control barrier used? No Yes If yes, describe: _____
- d. How many restrooms are on the premises? *3*
- e. Name of solid waste contractor: Advanced Disposal Waste Management Other: _____

5. Security

- a. Are there onsite parking spaces? No Yes If yes, indicate how many? 70 and describe the parking security plan: only after hours parking inside gated area / Employee parking outside during Business hours
- b. Is there a loading zone? No Yes If yes, describe the loading area security plan: _____
- c. Will you have security personnel on premise? No Yes If yes, how many? _____ and answer the following:
 What are their responsibilities? _____
 Is security equipment used? No Yes If yes, describe _____
 List their licensing, certification, or training credentials _____
- d. Will there be security cameras? No Yes If yes, where? _____
- e. Will searches/identification checks be done upon entry? No Yes If yes, describe _____

6. Percentage of Sales (must total 100%)

Alcohol <u>0</u> %	Food <u>0</u> %	Secondhand Merchandise <u>0</u> %	Precious Metals & Gems <u>0</u> %
Entertainment <u>0</u> %	Cigarettes <u>0</u> %		
Pawnbroker Activity <u>0</u> %	Salvaged Materials <u>0</u> % (such as scrap metal)	Personal Services (such as tattoo, body piercing, salon, tailor, tanning, etc.) <u>0</u> %	Other <u>100</u> % Describe: <u>Student Transport</u>

7. Businesses/Licenses on the Premises (check all that apply):

Type 1

- Full Service Restaurant Cafe/Coffee Shop Deli or Fast Food Restaurant Private/Fraternal/Veterans Club
- Night Club Tavern Cocktail Lounge Teen Club
- Banquet Hall Sports Facility Bowling Alley
- Hotel/Motel : Number of Floors: _____ Rooming House: Number of Floors: _____
 Number of Rooms: _____ Number of Rooms: _____

Type 2

- Liquor Store Corner Store Supermarket Convenience Store
- Gas Station Amusement/Phonograph Distributor Recycling, Salvage or Towing
- Used Car Dealer Personal Service Establishment
(such as tattoo business, hair salon, tailor, etc.) Recording Studio

What other licenses/permits will you hold at this location? (check all that apply)

- Occupancy Permit Cigarette & Tobacco Gas Station Extended Hours Class "B" Tavern Weights & Measures
- Secondhand Dealer Precious Metal & Gem Other: _____

8. Legal Capacity (only if a Type 1 premises in #7 above)

Capacity NA (Call the Milwaukee Development Center at 414-286-8211 if you have questions.)

9. Premises Description

- a. Identify all area(s) of the premises that will be used in operating this business (include areas used only for storage):
 1st Floor 2nd Floor Basement Storage Patio Beer Garden Sidewalk Café Deck Rooftop
 Other: Describe: _____
- b. Describe Location: Major Thoroughfare Secondary Street Other: _____
- c. Nearest Major Cross Street: Silver Spring B BYH
- d. Describe Building: Free Standing Building Strip Mall Other: _____
- e. Describe Premises Structure: Single Story Multi-Story - # of Stories _____ Other: _____
- f. Describe Surrounding Area: Commercial Residential Industrial Other: _____
- g. Building Owner Name: Milwaukee Properties L.P. Phone Number: _____
 Business Owner Address: P.O. Box 1221, Camp Hill, PA 17001-1221

10. Hours of Operation & Customers

Will customers be entering the premises? No Yes

Day of the Week	Proposed Hours of Operation:		Estimated Number of Customers expected each day	Potential Age Range of Customers	Class B Tavern Applicant Only: Age Restriction (If none, write 'None')
	Open Time (include a.m. or p.m.)	Close Time (include a.m. or p.m.)			
Sunday					
Monday	5am	5PM	0	NA	None
Tuesday	5am	5PM	0	NA	None
Wednesday	5am	5PM	0	NA	None
Thursday	5am	5PM	0	NA	None
Friday	5am	5PM	0	NA	None
Saturday					

Extended Hours Establishment License is required for any convenience store, filling station, personal service establishment (such as tattoo, body piercing, salon, tailor, tanning, etc.), recording studio or restaurant which is open between the hours of 12 a.m. and 5 a.m.

Entertainment Indoor Closing Hours : If alcohol beverage establishment, same as alcohol license hours.
 If non-alcohol establishment 1:00 am Sunday to Thursday; 1:30 am Friday and Saturday.

Entertainment Outdoor Closing Hours : 10:00 pm Sunday – Thursday; 12:00 am Friday and Saturday,
 unless otherwise approved by Common Council in licensee's plan of operation.

11. Signature(s)

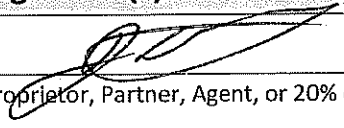
 Sole Proprietor, Partner, Agent, or 20% or more Shareholder

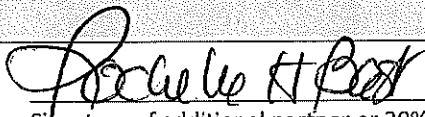
 Signature of additional partner or 20% or more Shareholder

See Application Information for a list of all required application forms.



**RECYCLING, SALVAGING OR TOWING PREMISES
LICENSE SUPPLEMENTAL APPLICATION**

ccl-rstprem 12/11/15

Office of the City Clerk License Division
200 E. Wells St. Room 105, Milwaukee, WI 53202
(414) 286-2238 e-mail address: license@milwaukee.gov

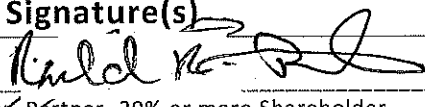
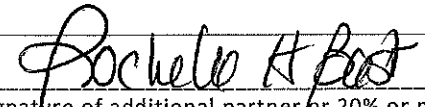
Legal Entity Name: <u>RiteWay BUS service INC.</u>				
Business Address: <u>5444 N. 124th St., Milwaukee, WI 53007</u>				
Do you currently hold any licenses in the City of Milwaukee? <input type="checkbox"/> No <input checked="" type="checkbox"/> Yes If yes, list: <u>Occupancy Permit, Certified Vessel, Day-Last Tire, Limo/ Shuttle</u>				
Has any person on the application ever had a license relating to the activities licensed in Milwaukee Code of Ordinances Chapter 93 denied, not renewed, suspended, or revoked? <input checked="" type="checkbox"/> No <input type="checkbox"/> Yes				
If yes, provide the circumstances and jurisdiction in which the event occurred (including a record of any actions from the State Department of Transportation and Financial Institutions relating to suspensions, revocations, forfeitures and warnings imposed by these departments relating to the operation of any automotive sales business by the applicant): _____				
Do you understand that you must follow all recordkeeping, reporting and operating regulations in MCO 93-43-49? <input type="checkbox"/> No <input checked="" type="checkbox"/> Yes				
Do you understand that all records and reports must be available to the police department upon request? <input type="checkbox"/> No <input checked="" type="checkbox"/> Yes				
Business Operations				
Check all activities that apply:				
<input type="checkbox"/> Non-Consensual Towing: Provide the address within the City of Milwaukee where vehicles will be towed: _____				
Junk/Valuable Metal: <input type="checkbox"/> Dealing, Storing and/or Transporting <input type="checkbox"/> Removing and/or Recycling				
Waste Tires: <input type="checkbox"/> Dealing, Storing and/or Transporting <input checked="" type="checkbox"/> Removing and/or Recycling				
Salvaged Motor Vehicle Parts: <input type="checkbox"/> Dealing, Storing and/or Transporting <input checked="" type="checkbox"/> Removing and/or Recycling (including tires/batteries)				
Do you have an additional yard(s) used for storage? <input checked="" type="checkbox"/> No <input type="checkbox"/> Yes If yes, provide the address(es) below and submit an additional \$50 per yard: _____				
How many motor vehicles will be used in the business operations? <u>0</u> Provide information for each vehicle on page 2.				
Required Signature(s)				
 Sole Proprietor, Partner, 20% or more Shareholder, or the Agent - only if there are no 20% or more shareholders			 Signature of additional partner or 20% or more shareholder	
Office Use Only:			Initials	Filed
App#	YD#	Permit #s	Paid	MPD
DNS	LC	CC	Mayor's Signature	License #



CITY OF MILWAUKEE
OFFICE OF THE CITY CLERK

Thursday, October 11, 2018

COMMITTEE MEETING NOTICE

AD 05

MOLLEL, Godson J, Agent
Takason Motors Inc
8144 W APPLETON Av

Milwaukee, WI 53218

You are requested to attend a hearing which is to be held in Room 301-B, Third Floor, City Hall on:

Tuesday, October 23, 2018 at 09:15 AM

Regarding: Your Secondhand Motor Vehicle Dealer's License Application as  for "Takason Motors Inc" for "Takason Motors Inc" at 8144 W APPLETON Av.

There is a possibility that your application may be denied for one or more of the following reasons: Neighborhood Objections to the granting of such a license due to the creation of undesirable neighborhood problems, such as: parking and traffic problems which cause the normal flow of traffic on roadways and alleys to be impeded, loitering, littering, noise, loud music, and conduct which will have an adverse impact on the public health, safety and welfare of the community. Additionally, the over concentration of secondhand motor vehicle dealers in the neighborhood such that the concentration will have an adverse impact on the public health, safety and welfare of the neighborhood. you do not meet the statutory and municipal requirements; the appropriateness of the location to be licensed and whether the location will create undesirable neighborhood problems, whether or not you have been charged with or convicted of any felony, misdemeanor, municipal offense or other offense, the circumstances of which substantially relate to the licensed activity; and any other factors which reasonably relate to the public health, safety and welfare. Please be advised the public will be able to provide information to the committee in person or in writing. The committee will receive and consider evidence regarding the above mentioned criteria.

Notice for applicants with warrants or unpaid fines:

Proof of warrant satisfaction or payment of fines must be submitted at the hearing on the above date and time. Failure to comply with this requirement may result in a delay of the granting/denial of your application.

Failure to appear at this meeting may result in the denial of your license. Individual applicants must appear only in person or by an attorney. Corporate or Limited Liability applicants must appear only by the agent designated on the application or by an attorney. Partnership applicants must appear by a partner listed on the application or by an attorney. If you wish to do so and at your own expense, you may be accompanied by an attorney of your choosing to represent you at this hearing.

You will be given an opportunity to speak on behalf of the application and to respond and challenge any charges or reasons given for the denial. No petitions can be accepted by the committee, unless the people who signed the petition are present at the committee hearing and willing to testify. You may present witnesses under oath and you may also confront and cross-examine opposing witnesses under oath. If you have difficulty with the English language, you should bring an interpreter with you, at your expense, so that you can answer questions and participate in your hearing.

You may examine the application file at this office during regular business hours prior to the hearing date. Inquiries regarding this matter may be directed to the person whose signature appears below.

Limited parking for persons attending meetings in City Hall is available at reduced rates (5 hour limit) at the Milwaukee Center on the southwest corner of East Kilbourn and North Water Street. Parking tickets must be validated in the first floor information booth in City Hall.

PLEASE NOTE: Upon reasonable notice, efforts will be made to accommodate the needs of disabled individuals through sign language interpreters or other auxiliary aids. For additional information or to request this service, contact the Council Services Division ADA Coordinator at (414) 286-2998, Fax - (414) 286-3456, TDD - (414) 286-2025.

JIM OWCZARSKI, CITY CLERK

BY:

Jessica Celella
License Division Manager

If you have questions regarding this notice, please contact the License Division at (414) 286-2238.



CITY OF MILWAUKEE
OFFICE OF THE CITY CLERK

Thursday, October 11, 2018

COMMITTEE MEETING NOTICE

AD 05

MOLLEL, Godson J, Agent
Takason Motors Inc
3754 N 51st Blvd

Milwaukee, WI 53216

You are requested to attend a hearing which is to be held in Room 301-B, Third Floor, City Hall on:

Tuesday, October 23, 2018 at 09:15 AM

Regarding: Your Secondhand Motor Vehicle Dealer's License Application as agent for "Takason Motors Inc" for "Takason Motors Inc" at 8144 W APPLETON Av.

There is a possibility that your application may be denied for one or more of the following reasons: Neighborhood Objections to the granting of such a license due to the creation of undesirable neighborhood problems, such as: parking and traffic problems which cause the normal flow of traffic on roadways and alleys to be impeded, loitering, littering, noise, loud music, and conduct which will have an adverse impact on the public health, safety and welfare of the community. Additionally, the over concentration of secondhand motor vehicle dealers in the neighborhood such that the concentration will have an adverse impact on the public health, safety and welfare of the neighborhood. you do not meet the statutory and municipal requirements; the appropriateness of the location to be licensed and whether the location will create undesirable neighborhood problems, whether or not you have been charged with or convicted of any felony, misdemeanor, municipal offense or other offense, the circumstances of which substantially relate to the licensed activity; and any other factors which reasonably relate to the public health, safety and welfare. Please be advised the public will be able to provide information to the committee in person or in writing. The committee will receive and consider evidence regarding the above mentioned criteria.

Notice for applicants with warrants or unpaid fines:

Proof of warrant satisfaction or payment of fines must be submitted at the hearing on the above date and time. Failure to comply with this requirement may result in a delay of the granting/denial of your application.

Failure to appear at this meeting may result in the denial of your license. Individual applicants must appear only in person or by an attorney. Corporate or Limited Liability applicants must appear only by the agent designated on the application or by an attorney. Partnership applicants must appear by a partner listed on the application or by an attorney. If you wish to do so and at your own expense, you may be accompanied by an attorney of your choosing to represent you at this hearing.

You will be given an opportunity to speak on behalf of the application and to respond and challenge any charges or reasons given for the denial. No petitions can be accepted by the committee, unless the people who signed the petition are present at the committee hearing and willing to testify. You may present witnesses under oath and you may also confront and cross-examine opposing witnesses under oath. If you have difficulty with the English language, you should bring an interpreter with you, at your expense, so that you can answer questions and participate in your hearing.

You may examine the application file at this office during regular business hours prior to the hearing date. Inquiries regarding this matter may be directed to the person whose signature appears below.

Limited parking for persons attending meetings in City Hall is available at reduced rates (5 hour limit) at the Milwaukee Center on the southwest corner of East Kilbourn and North Water Street. Parking tickets must be validated in the first floor information booth in City Hall.

PLEASE NOTE: Upon reasonable notice, efforts will be made to accommodate the needs of disabled individuals through sign language interpreters or other auxiliary aids. For additional information or to request this service, contact the Council Services Division ADA Coordinator at (414) 286-2998, Fax - (414) 286-3456, TDD - (414) 286-2025.

JIM OWCZARSKI, CITY CLERK

BY: _____

Jessica Celella
License Division Manager

If you have questions regarding this notice, please contact the License Division at (414) 286-2238.



Thursday, October 11, 2018



Notice of Public Hearing

MOLLEL, Godson J, Agent
Takason Motors Inc at 8144 W APPLETON Av
Secondhand Motor Vehicle Dealer's License Application

Tuesday, October 23, 2018 at 9:15 AM

To whom it may concern:

The above application has been made by the above named applicant(s). This requires approval from the Licenses Committee and the Common Council of the City of Milwaukee. The hearing before the Licenses Committee will take place on 10/23/2018 at 9:15 AM, in Room 301-B, Third Floor, City Hall. If you wish, you may provide testimony at the hearing regarding the request; see below for further information. You are not required to attend the hearing. Once the Licenses Committee makes its recommendation, this recommendation is forwarded to the full Common Council for approval at its next regularly scheduled hearing. Please review the information below and if you have further questions regarding this process, please contact the License Division at (414) 286-2238.

Important details for those wishing to provide information for the Licenses Committee to consider when making its recommendation:

1. The license application is scheduled to be heard at the above time. Due to other hearings running longer than scheduled, you may have to wait some time to provide your testimony.
2. You must appear in person and testify as to matters that you have personally experienced or seen. (You cannot provide testimony for your neighbor, parent or anyone else; this is considered hearsay and cannot be considered by the committee.)
3. No letters or petitions can be accepted by the committee (unless the person who wrote the letter or the persons who signed the petition are present at the committee hearing and willing to testify).
4. Persons opposed to the license application are given the opportunity to testify first; supporters may testify after the opponents have finished.
5. When you are called to testify, you will be sworn in and asked to give your name, and address. (If your first and/or last names are uncommon please spell them.)
6. You may then provide testimony.
 - a. Include only information relating to the above license application.
 - b. Include only information you have personally witnessed or seen.
 - c. Provide concise and relevant information detailing how this business has affected or may affect the peaceful enjoyment of your neighborhood.
 - d. If by the time you have the opportunity to testify, the information you wish to share has already been provided to the committee, you may state that you agree with the previous testimony. Redundant or repetitive testimony will not assist the committee in making its recommendation.
7. After giving your testimony, the members of the Licenses Committee and the licensee may ask questions regarding the testimony you have given or other factors relating to the license application.
8. Business Competition is not a valid basis for denial or non-renewal of a license.
Please Note: If you have submitted an objection to the above application your objection cannot be considered by the committee unless you personally testify at the hearing.

OCCUPANT	MAIL ADDRESS	CITY, STATE ZIP
CURRENT OCCUPANT	8219 W APPLETON AVE 2	MILWAUKEE, WI 53218
CURRENT OCCUPANT	8109 W BECKETT AVE	MILWAUKEE, WI 53218
CURRENT OCCUPANT	8132 W BECKETT AVE 5	MILWAUKEE, WI 53218
CURRENT OCCUPANT	8136 W APPLETON AVE A	MILWAUKEE, WI 53218
CURRENT OCCUPANT	8110 W APPLETON AVE	MILWAUKEE, WI 53218
CURRENT OCCUPANT	8047 W BECKETT AVE	MILWAUKEE, WI 53218
CURRENT OCCUPANT	8035 W BECKETT AVE	MILWAUKEE, WI 53218
CURRENT OCCUPANT	8215 W APPLETON AVE	MILWAUKEE, WI 53218
CURRENT OCCUPANT	8132 W BECKETT AVE 4	MILWAUKEE, WI 53218
CURRENT OCCUPANT	8055 W BECKETT AVE	MILWAUKEE, WI 53218
CURRENT OCCUPANT	8057 W BECKETT AVE	MILWAUKEE, WI 53218
CURRENT OCCUPANT	8049 W BECKETT AVE	MILWAUKEE, WI 53218
CURRENT OCCUPANT	8219 W APPLETON AVE 5	MILWAUKEE, WI 53218
CURRENT OCCUPANT	8219 W APPLETON AVE 1	MILWAUKEE, WI 53218
CURRENT OCCUPANT	8123 W BECKETT AVE	MILWAUKEE, WI 53218
CURRENT OCCUPANT	8144A W APPLETON AVE	MILWAUKEE, WI 53218
CURRENT OCCUPANT	8113 W BECKETT AVE	MILWAUKEE, WI 53218
CURRENT OCCUPANT	8132 W BECKETT AVE 3	MILWAUKEE, WI 53218
CURRENT OCCUPANT	8145 W APPLETON AVE	MILWAUKEE, WI 53218
CURRENT OCCUPANT	8115 W BECKETT AVE	MILWAUKEE, WI 53218
CURRENT OCCUPANT	8132 W BECKETT AVE 2	MILWAUKEE, WI 53218
CURRENT OCCUPANT	8127 W APPLETON AVE 3	MILWAUKEE, WI 53218
CURRENT OCCUPANT	8102 W APPLETON AVE	MILWAUKEE, WI 53218
CURRENT OCCUPANT	8033 W BECKETT AVE	MILWAUKEE, WI 53218
CURRENT OCCUPANT	8067 W BECKETT AVE	MILWAUKEE, WI 53218
CURRENT OCCUPANT	8219 W APPLETON AVE 6	MILWAUKEE, WI 53218
CURRENT OCCUPANT	8200 W APPLETON AVE A	MILWAUKEE, WI 53218
CURRENT OCCUPANT	8132 W BECKETT AVE 1	MILWAUKEE, WI 53218
CURRENT OCCUPANT	8132 W BECKETT AVE 6	MILWAUKEE, WI 53218
CURRENT OCCUPANT	8117 W APPLETON AVE	MILWAUKEE, WI 53218
CURRENT OCCUPANT	8118 W APPLETON AVE	MILWAUKEE, WI 53218
CURRENT OCCUPANT	8112 W APPLETON AVE	MILWAUKEE, WI 53218
CURRENT OCCUPANT	8061 W BECKETT AVE	MILWAUKEE, WI 53218
CURRENT OCCUPANT	8076 W BECKETT AVE	MILWAUKEE, WI 53218
CURRENT OCCUPANT	8060 W BECKETT AVE	MILWAUKEE, WI 53218
CURRENT OCCUPANT	8219 W APPLETON AVE 4	MILWAUKEE, WI 53218
CURRENT OCCUPANT	8219 W APPLETON AVE 3	MILWAUKEE, WI 53218
CURRENT OCCUPANT	8122 W COURTLAND AVE	MILWAUKEE, WI 53218
CURRENT OCCUPANT	8071 W BECKETT AVE	MILWAUKEE, WI 53218
CURRENT OCCUPANT	8203 W APPLETON AVE	MILWAUKEE, WI 53218
CURRENT OCCUPANT	8141 W APPLETON AVE	MILWAUKEE, WI 53218
CURRENT OCCUPANT	8143 W APPLETON AVE	MILWAUKEE, WI 53218
CURRENT OCCUPANT	8127 W APPLETON AVE 2	MILWAUKEE, WI 53218
CURRENT OCCUPANT	8136 W APPLETON AVE	MILWAUKEE, WI 53218
CURRENT OCCUPANT	8063 W BECKETT AVE	MILWAUKEE, WI 53218
CURRENT OCCUPANT	8051 W BECKETT AVE	MILWAUKEE, WI 53218

CURRENT OCCUPANT	8045 W BECKETT AVE	MILWAUKEE, WI 53218
CURRENT OCCUPANT	8039 W BECKETT AVE	MILWAUKEE, WI 53218
CURRENT OCCUPANT	8041 W BECKETT AVE	MILWAUKEE, WI 53218
CURRENT OCCUPANT	8065 W BECKETT AVE	MILWAUKEE, WI 53218
CURRENT OCCUPANT	8076 W BECKETT AVE A	MILWAUKEE, WI 53218
CURRENT OCCUPANT	8107 W BECKETT AVE	MILWAUKEE, WI 53218
CURRENT OCCUPANT	8103 W BECKETT AVE	MILWAUKEE, WI 53218
CURRENT OCCUPANT	8132 W BECKETT AVE 7	MILWAUKEE, WI 53218
CURRENT OCCUPANT	8127 W APPLETON AVE 4	MILWAUKEE, WI 53218
CURRENT OCCUPANT	8105 W APPLETON AVE	MILWAUKEE, WI 53218
CURRENT OCCUPANT	8116 W APPLETON AVE	MILWAUKEE, WI 53218
CURRENT OCCUPANT	8026 W COURTLAND AVE	MILWAUKEE, WI 53218
CURRENT OCCUPANT	8062 W BECKETT AVE	MILWAUKEE, WI 53218
CURRENT OCCUPANT	8052 W BECKETT AVE	MILWAUKEE, WI 53218
CURRENT OCCUPANT	8153 W APPLETON AVE	MILWAUKEE, WI 53218
CURRENT OCCUPANT	8147 W APPLETON AVE	MILWAUKEE, WI 53218
CURRENT OCCUPANT	8135 W APPLETON AVE	MILWAUKEE, WI 53218
CURRENT OCCUPANT	8127 W APPLETON AVE 1	MILWAUKEE, WI 53218
CURRENT OCCUPANT	8124 W APPLETON AVE	MILWAUKEE, WI 53218

Total Records: 65

Radius: 250.0 feet and Center of Circle: 8144 W Appleton Ave



BUSINESS LICENSE PLAN OF OPERATION

cci-busplan 12/14/17

Office of the City Clerk License Division
200 E. Wells St. Room 105, Milwaukee, WI 53202
(414) 286-2238 www.milwaukee.gov/license e-mail address: license@milwaukee.gov

1. Type of Business

Applying for: Extended Hours (12AM to 5AM) - If a food establishment, check all that apply: Delivery Drive Thru Dining Room
 Self Service Laundry Massage Establishment Filling Station
 Other (supplemental application for specific license also required)

Provide a detailed description of the type of business you plan on operating:

USED CAR DEALERSHIP RETAIL.

Do you have any experience operating this type of business? No Yes If yes, explain: I have bought car and resold

2. Business Operations

- a. Proposed Opening Date: 10/2/18
- b. Is this premise under construction? No Yes If yes, list estimated completion date: _____
- c. Is this a franchise? No Yes
- d. Is this premises currently licensed? No Yes If yes, list type of license: YES But have Expired
- e. Is the current licensee operating? No Yes If no, list date closed: _____
- f. Do you have future plans for other businesses, licenses or permits at this location? No Yes
If yes, explain: Repair Shop later
- g. Have you previously held an Extended Hours License in Milwaukee? No Yes
If yes, list address(es): _____
- h. Are other businesses operating in the same building? No Yes If yes, describe: _____

3. Litter & Noise

- a. How are grounds kept clean? Sweep Pressure Wash Pick Up Litter Other: Clean up as needed
- b. How often will grounds be cleaned? Daily Weekly As Needed Monthly Other: _____
- c. Grounds cleaned by: Licensee Building Owner Employees Hired Maintenance Other: _____
- d. How are noise issues prevented and/or addressed? Security Manager approaches customer(s) Call Police
 Signs Posted Other: _____
- e. Will a sound amplification system be used? No Yes If yes, describe: _____

4. Smoking & Sanitation

- a. Are there designated outdoor smoking areas? No Yes If yes, describe: _____
- b. Number of Garbage Cans: Inside: 2 Locations: Whole Office and inside garage
Outside: 1 Locations: By the Alley
- c. Is a crowd control barrier used? No Yes If yes, describe: _____
- d. How many restrooms are on the premises? 1
- e. Name of solid waste contractor: Advanced Disposal Waste Management Other: _____

5. Security

- a. Are there onsite parking spaces? No Yes If yes, indicate how many? _____ and describe the parking security plan: _____
- b. Is there a loading zone? No Yes If yes, describe the loading area security plan: _____
- c. Will you have security personnel on premise? No Yes If yes, how many? _____ and answer the following:
 What are their responsibilities? _____
 Is security equipment used? No Yes If yes, describe 24 hours recording camera
 List their licensing, certification, or training credentials _____
- d. Will there be security cameras? No Yes If yes, where? in the office and outside the lot
- e. Will searches/identification checks be done upon entry? No Yes If yes, describe _____

6. Percentage of Sales (must total 100%)

Alcohol _____%	Food _____%	Secondhand Merchandise _____%	Precious Metals & Gems _____%
Entertainment _____%	Cigarettes _____%		
Pawnbroker Activity _____%	Salvaged Materials _____% (such as scrap metal)	Personal Services (such as tattoo, body piercing, salon, tailor, tanning, etc.) _____%	Other <u>100</u> % Describe: _____

7. Businesses/Licenses on the Premises (check all that apply):

Type 1

- Full Service Restaurant Cafe/Coffee Shop Deli or Fast Food Restaurant Private/Fraternal/Veterans Club
- Night Club Tavern Cocktail Lounge Teen Club
- Banquet Hall Sports Facility Bowling Alley
- Hotel/Motel: Number of Floors: _____ Rooming House: Number of Floors: _____
 Number of Rooms: _____ Number of Rooms: _____

Type 2

- Liquor Store Corner Store Supermarket Convenience Store
- Gas Station Amusement/Phonograph Distributor Recycling, Salvage or Towing
- Used Car Dealer Personal Service Establishment
 (such as tattoo business, hair salon, tailor, etc.) Recording Studio

What other licenses/permits will you hold at this location? (check all that apply)

- Occupancy Permit Cigarette & Tobacco Gas Station Extended Hours Class "B" Tavern Weights & Measures
- Secondhand Dealer Precious Metal & Gem Other: _____

8. Legal Capacity (only if a Type 1 premises in #7 above)

Capacity _____ (Call the Milwaukee Development Center at 414-286-8211 if you have questions.)

9. Premises Description

a. Identify all area(s) of the premises that will be used in operating this business (include areas used only for storage):

1st Floor 2nd Floor Basement Storage Patio Beer Garden Sidewalk Café Deck Rooftop

Other: Describe: parking lot area

b. Describe Location: Major Thoroughfare Secondary Street Other: _____

c. Nearest Major Cross Street: Appleton Ave and Courtland

d. Describe Building: Free Standing Building Strip Mall Other: _____

e. Describe Premises Structure: Single Story Multi-Story - # of Stories _____ Other: _____

f. Describe Surrounding Area: Commercial Residential Industrial Other: Mixed Area

g. Building Owner Name: Godson Mallet Phone Number: 414 426 5546

Business Owner Address: 3754 N 51st Blvd Milwaukee WI 53216

10. Hours of Operation & Customers

Will customers be entering the premises? No Yes

Day of the Week	Proposed Hours of Operation:		Estimated Number of Customers expected each day	Potential Age Range of Customers	Class B Tavern Applicant Only: Age Restriction (If none, write 'None')
	Open Time (include a.m. or p.m.)	Close Time (include a.m. or p.m.)			
Sunday	CLOSED			18-90	
Monday	10 AM	6:00 pm		18-90	
Tuesday	10 AM	6:00 pm		18-90	
Wednesday	10 AM	6:00 pm		18-90	
Thursday	10 AM	6:00 pm		18-90	
Friday	10 AM	6:00 pm		18-90	
Saturday	9 AM	3:00 pm		18-90	

An Extended Hours Establishment License is required for any convenience store, filling station, personal service establishment (such as tattoo, body piercing, salon, tailor, tanning, etc.), recording studio or restaurant which is open between the hours of 12:00 a.m. and 5:00 a.m.

Alcohol Establishments Permitted Hours of Operation: Class A: 8:00 am to 9:00 pm Sunday thru Saturday
Class B: 6:00 am to 2:00 am Sunday thru Thursday, 6:00 am to 2:30 am Friday & Saturday

Entertainment Outdoor Closing Hours: 10:00pm Sunday-Thursday; 12:00am Friday & Saturday; unless a different time, either earlier or later, is established by the Common Council in its approval of the licensee's plan of operation.

11. Signature(s)

Godson Mallet

Signature of Sole Proprietor, Partner, or 20% or more Shareholder
(If there are no 20% or more shareholders,
Corporate Officer-print name/title and sign)

Signature of additional partner or 20% or more shareholder

See Application Information for a complete list of all required application forms.



**SECONDHAND MOTOR VEHICLE DEALER LICENSE
SUPPLEMENTAL PLAN OF OPERATION**

Office of the City Clerk License Division
200 E. Wells St. Room 105, Milwaukee, WI 53202
(414) 286-2238 e-mail address: license@milwaukee.gov

Legal Entity Name: TAKASON MOTORS INC
 Premise Address: (cannot be a home) 8144 W APPLETON AVE Milwaukee WI 53218
 What type of license are you applying for? (check one) Retail Wholesale
 In addition to secondhand vehicles, will you be dealing in secondhand vehicle parts? Yes No

RETAIL DEALERS ONLY

Total Number of Parking Spaces (including customer/employee parking) 39 g-m
 Number of Parking Spaces that will be used for Display/Storage of Secondhand Motor Vehicles 35 g-m

STORAGE, MAINTENANCE & REPAIR

1. Do you understand that all vehicles associated with the business must be stored on the licensed premise? Yes No
 What are your plans to ensure this requirement is met (check all that apply)?
 Employee Training Supervisor Monitoring Fenced Lot Keys Kept in Locked Box
 Other: _____

2. Do you understand all maintenance/repair work to these vehicles must be confined to the licensed premise? Yes No
 What are your plans to ensure this requirement is met (check all that apply)?
 Employee Training Supervisor Monitoring Designated Repair Area
 Other: _____

3. Do you understand all keys to used motor vehicles offered for sale must be kept in a secure lockbox inside the dealership building at all times when the dealership is not open for business? Yes No
 What are your plans to ensure this requirement is met (check all that apply)?
 Employee Training Supervisor Monitoring Other: _____

DISCLOSURE

Has any person on the application ever had a license relating to the activities licensed in Milwaukee Code of Ordinances Chapter 92 denied, not renewed, suspended, or revoked? No Yes
 If yes, provide the circumstances and jurisdiction in which the event occurred (including a record of any actions from the State Department of Transportation and Financial Institutions relating to suspensions, revocations, forfeitures and warnings imposed by these departments relating to the operation of any automotive sales business by the applicant):

REQUIRED SIGNATURE(S)

Gordon Malik
 Sole Proprietor, Partner, or 20% or more Shareholder
 (If there are no 20% or more shareholders,
 Corporate Officer-print name/title and sign)

 Additional partner or 20% or more shareholder

SUBMIT THIS FORM WITH THE BUSINESS LICENSE APPLICATION & PLAN OF OPERATION

Office Use Only:				
Initials	Filed	App #	Paid	MPD
DNS	LC	CC	Issued	License #



CITY OF MILWAUKEE
OFFICE OF THE CITY CLERK

Friday, October 12, 2018

COMMITTEE MEETING NOTICE

AD 05

PATEL, Nikhilkumar, Agent
Hampton Beer & Food LLC
10707 W Hampton Av

Milwaukee, WI 53225

You are requested to attend a hearing which is to be held in Room 301-B, Third Floor, City Hall on:

Tuesday, October 23, 2018 at 09:15 AM

Regarding: Your Class A Malt, Class A Liquor-Cider Only, and Food  er License Applications as agent for "Hampton Beer & Food LLC" for "PK'S Pantry" at 10707 W Hampton Av.

There is a possibility that your application may be denied for one or more of the following reasons: The recommendation of the committee regarding the application shall be based on evidence presented at the hearing. Per MCO 85-2.7-4, probative evidence concerning whether or not a new license should be granted may be presented on the following subjects: whether or not the applicant meets the municipal requirements, the appropriateness of the location and premises where the licensed premises is to be located and whether use of the premises for the purposes or activities permitted by the license would tend to facilitate a public or private nuisance or create undesirable neighborhood problems such as disorderly patrons, unreasonably loud noise, litter, and excessive traffic and parking congestion. Probative evidence relating to these matters may be taken from the plan of operation submitted with the license application, if any, but shall not include the content of any music. Evidence regarding the fitness of the location of the premises to be maintained as the principal place of business, including but not limited to whether there is an overconcentration of businesses of the type for which the license is sought; whether the proposal is consistent with any pertinent neighborhood business or development plans, or the location's proximity to areas where children are typically present. The applicant's record in operating similarly licensed premises; and whether or not the applicant has been charged with or convicted of any felony, misdemeanor, municipal offense or other offense, the circumstances of which substantially relate to the activity to be permitted by the license being applied for or any other factor which reasonably relates to the public health, safety or welfare may also be considered. See attached police report or correspondence.

Notice for applicants with warrants or unpaid fines:

Proof of warrant satisfaction or payment of fines must be submitted at the hearing on the above date and time. Failure to comply with this requirement may result in a delay of the granting/denial of your application.

Failure to appear at this meeting may result in the denial of your license. Individual applicants must appear only in person or by an attorney. Corporate or Limited Liability applicants must appear only by the agent designated on the application or by an attorney. Partnership applicants must appear by a partner listed on the application or by an attorney. If you wish to do so and at your own expense, you may be accompanied by an attorney of your choosing to represent you at this hearing.

You will be given an opportunity to speak on behalf of the application and to respond and challenge any charges or reasons given for the denial. No petitions can be accepted by the committee, unless the people who signed the petition are present at the committee hearing and willing to testify. You may present witnesses under oath and you may also confront and cross-examine opposing witnesses under oath. If you have difficulty with the English language, you should bring an interpreter with you, at your expense, so that you can answer questions and participate in your hearing.

You may examine the application file at this office during regular business hours prior to the hearing date. Inquiries regarding this matter may be directed to the person whose signature appears below.

Limited parking for persons attending meetings in City Hall is available at reduced rates (5 hour limit) at the Milwaukee Center on the southwest corner of East Kilbourn and North Water Street. Parking tickets must be validated in the first floor information booth in City Hall.

PLEASE NOTE: Upon reasonable notice, efforts will be made to accommodate the needs of disabled individuals through sign language interpreters or other auxiliary aids. For additional information or to request this service, contact the Council Services Division ADA Coordinator at (414) 286-2998, Fax - (414) 286-3456, TDD - (414) 286-2025.

JIM OW CZARSKI, CITY CLERK

BY:

Jessica Celella

License Division Manager

If you have questions regarding this notice, please contact the License Division at (414) 286-2238.

200 E. Wells Street, Room 105, City Hall, Milwaukee, WI 53202. www.milwaukee.gov/license
Phone: (414) 286-2238 Fax: (414) 286-3057 Email Address: License@milwaukee.gov



CITY OF MILWAUKEE
OFFICE OF THE CITY CLERK

Friday, October 12, 2018

COMMITTEE MEETING NOTICE

AD 05

PATEL, Nikhilkumar, Agent
Hampton Beer & Food LLC
4514 W Tesch Ave

Greenfield, WI 53220

You are requested to attend a hearing which is to be held in Room 301-B, Third Floor, City Hall on:

Tuesday, October 23, 2018 at 09:15 AM

Regarding: Your Class A Malt, Class A Liquor-Cider Only, and Food Dealer License Applications as agent for "Hampton Beer & Food LLC" for "PK'S Pantry" at 10707 W Hampton Av.

There is a possibility that your application may be denied for one or more of the following reasons: The recommendation of the committee regarding the application shall be based on evidence presented at the hearing. Per MCO 85-2.7-4, probative evidence concerning whether or not a new license should be granted may be presented on the following subjects: whether or not the applicant meets the municipal requirements, the appropriateness of the location and premises where the licensed premises is to be located and whether use of the premises for the purposes or activities permitted by the license would tend to facilitate a public or private nuisance or create undesirable neighborhood problems such as disorderly patrons, unreasonably loud noise, litter, and excessive traffic and parking congestion. Probative evidence relating to these matters may be taken from the plan of operation submitted with the license application, if any, but shall not include the content of any music. Evidence regarding the fitness of the location of the premises to be maintained as the principal place of business, including but not limited to whether there is an overconcentration of businesses of the type for which the license is sought; whether the proposal is consistent with any pertinent neighborhood business or development plans, or the location's proximity to areas where children are typically present. The applicant's record in operating similarly licensed premises; and whether or not the applicant has been charged with or convicted of any felony, misdemeanor, municipal offense or other offense, the circumstances of which substantially relate to the activity to be permitted by the license being applied for or any other factor which reasonably relates to the public health, safety or welfare may also be considered. See attached police report or correspondence.

Notice for applicants with warrants or unpaid fines: Proof of warrant satisfaction or payment of fines must be submitted at the hearing on the above date and time. Failure to comply with this requirement may result in a delay of the granting/denial of your application.

Failure to appear at this meeting may result in the denial of your license. Individual applicants must appear only in person or by an attorney. Corporate or Limited Liability applicants must appear only by the agent designated on the application or by an attorney. Partnership applicants must appear by a partner listed on the application or by an attorney. If you wish to do so and at your own expense, you may be accompanied by an attorney of your choosing to represent you at this hearing.

You will be given an opportunity to speak on behalf of the application and to respond and challenge any charges or reasons given for the denial. No petitions can be accepted by the committee, unless the people who signed the petition are present at the committee hearing and willing to testify. You may present witnesses under oath and you may also confront and cross-examine opposing witnesses under oath. If you have difficulty with the English language, you should bring an interpreter with you, at your expense, so that you can answer questions and participate in your hearing.

You may examine the application file at this office during regular business hours prior to the hearing date. Inquiries regarding this matter may be directed to the person whose signature appears below.

Limited parking for persons attending meetings in City Hall is available at reduced rates (5 hour limit) at the Milwaukee Center on the southwest corner of East Kilbourn and North Water Street. Parking tickets must be validated in the first floor information booth in City Hall.

PLEASE NOTE: Upon reasonable notice, efforts will be made to accommodate the needs of disabled individuals through sign language interpreters or other auxiliary aids. For additional information or to request this service, contact the Council Services Division ADA Coordinator at (414) 286-2998, Fax - (414) 286-3456, TDD - (414) 286-2025.

JIM OWCZARSKI, CITY CLERK

BY:

Jessica Celella
License Division Manager

If you have questions regarding this notice, please contact the License Division at (414) 286-2238.

200 E. Wells Street, Room 105, City Hall, Milwaukee, WI 53202. www.milwaukee.gov/license
Phone: (414) 286-2238 Fax: (414) 286-3057 Email Address: License@milwaukee.gov

Case : 101002437702

Client Info:

Name:

Address:

Phone Number:

Email:

Confidential?: Y

Issue: City Clerk License Object/Support Web

Date Submitted: 08/21/2018

Status: open

Date Completed:

Address: 10707 W HAMPTON AV

Due Date: 09/20/2018

Reason for request:

Object to License| I would like to object to PK'S Pantry to get a liquor license because there is already a liquor store right across the street. The neighborhood is filled with children and kids go to pk's pantry.

Case notes:

1. entered address: 10707 W HAMPTON AV

Staff comments:

Agent Created Case

[Click here to view map and/or images](#)

REDACTED RECORD

Cooney, Jim

From: Michael S. Maistelman <msm@maistelmanlaw.com>
Sent: Tuesday, August 7, 2018 2:36 PM
To: Cooney, Jim
Subject: Re: Class A Liquor, Class A Malt & Food Dealer Retail-Convenience

Hey Jim,

Im losing my mind....

That is what multitasking does.

Not objecting - but just want to get notice of the hearing.

The property address is 10707 W Hampton Ave.

Thanks,

Mike

--
Attorney Michael S. Maistelman
Maistelman & Associates, LLC
8989 N Port Washington Rd ~ Suite 207
Milwaukee, WI 53217
414-908-4254
414-447-0232 (fax)
414-333-9700 (cell)
msm@maistelmanlaw.com
<http://www.maistelmanlaw.com>

Confidentiality Notice: This electronic mail transmission may contain legally privileged and/or confidential information. Do not read this if you are not the person(s) named. Any use, distribution, copying, or disclosure by any other person is strictly prohibited. If you received this transmission in error, please notify the sender by telephone 414.908.4254 or send an electronic mail message to msm@maistelmanlaw.com and destroy the original transmission and its attachments without reading or saving in any manner.
IRS CIRCULAR 230 NOTICE: To ensure compliance with requirements imposed by the IRS, we inform you that any U.S. tax advice contained in this communication (or in any attachment) is not intended or written to be used, and cannot be used, for the purpose of (i) avoiding penalties under the Internal Revenue Code or (ii) promoting, marketing or recommending to another party any transaction or matter addressed in this communication (or in any attachment).

On Aug 7, 2018, at 2:32 PM, Cooney, Jim <jcoone@milwaukee.gov> wrote:

Are you objecting to an application? If so, which one, this email doesn't tell me?

Jim Cooney
License Specialist III
City of Milwaukee
200 E Wells St #105
Milwaukee, WI 53202
414-286-2238

<image001.jpg>

From: Michael S. Maistelman [<mailto:msm@maistelmanlaw.com>]
Sent: Tuesday, August 7, 2018 2:29 PM
To: License
Subject: Class A Liquor, Class A Malt & Food Dealer Retail-Convenience

Please add me to the list so that I can receive notice of the Licensing Hearing for the above application.

Thank you,

Michael

—
Attorney Michael S. Maistelman
Maistelman & Associates, LLC
8989 N Port Washington Rd ~ Suite 207
Milwaukee, WI 53217
414-908-4254
414-447-0232 (fax)
414-333-9700 (cell)
msm@maistelmanlaw.com
<http://www.maistelmanlaw.com>

Confidentiality Notice: This electronic mail transmission may contain legally privileged and/or confidential information. Do not read this if you are not the person(s) named. Any use, distribution, copying, or disclosure by any other person is strictly prohibited. If you received this transmission in error, please notify the sender by telephone 414.908.4254 or send an electronic mail message to msm@maistelmanlaw.com and destroy the original transmission and its attachments without reading or saving in any manner.
IRS CIRCULAR 230 NOTICE: To ensure compliance with requirements imposed by the IRS, we inform you that any U.S. tax advice contained in this communication (or in any attachment) is not intended or written to be used, and cannot be used, for the purpose of (i) avoiding penalties under the Internal Revenue Code or (ii) promoting, marketing or recommending to another party any transaction or matter addressed in this communication (or in any attachment).

The City of Milwaukee is subject to Wisconsin Statutes related to public records. Unless otherwise exempted from the public records law, senders and receivers of City of Milwaukee e-mail should presume that e-mail is subject to release upon request, and is subject to state records retention requirements. See City of Milwaukee full e-mail disclaimer at www.milwaukee.gov/email_disclaimer

Moon Siefert, Linda

From: License
Sent: Wednesday, August 8, 2018 8:58 AM
To: Moon Siefert, Linda
Subject: FW: PK's Pantry 10707 W Hampton Ave

Follow Up Flag: Follow up
Flag Status: Flagged

Categories: Red Category

REDACTED RECORD

Please add

From:
Sent: Tuesday, August 7, 2018 7:28 PM
To: License
Subject: PK's Pantry 10707 W Hampton Ave

To whom it may concern I really don't think we need another liquor store in our neighborhood. I mean they already sell beer, tobacco, and lottery tickets. The idea of two liquor stores within 100 feet of each other is very unnecessary. We have a lot of kids in our neighborhood with schools and public parks near by that do not need to be exposed to multiple liquor stores. Is that the only thing you want our youth to look forward to is drinking? We as an community have to do better. We all know liquor stores are common to distressed neighborhoods also an outlet for crime and loitering. One liquor store is more than enough. I feel our neighborhood is a nice diverse place to live where the people are kind and we don't have people hanging around and I would like to keep it that way. If you okay this it may seriously have an negative impact on health, safety, and welfare of family orientated neighborhood.

Sincerely a concern neighbor

Cooney, Jim

From: | [redacted]@yahoo.com
Sent: Monday, August 6, 2018 2:12 PM
To: License
Subject: Classic A liquor, pk's pantry 10707 w. Hampton avenue

[redacted] idea of two liquor stores directly accross from each other is highly unnecessary and pure greed. The pantry is not known for donating or sponsoring anything productive for this community. The (children) and families of this neighborhood patronize the pantry daily. It will have an adverse impact on the health, safety and welfare of the public, if these kids and families are forced to mingle with the traffic the liquor will bring. Again it's already a liquor store across the street. Thank you for your time and consideration in this matter.

Sent from Yahoo Mail on Android

REDACTED RECORD

Date:09-22-18
Officer: Geniesse

City of Milwaukee Police Department
90-5-1.5 Crime Prevention Survey
Convenience Store/Liquor Store Inspection

Name of Premise: PK's Pantry
Address: 10707 W Hampton Ave
Phone: 414-463-1335

Owner: Nikhilkumar J Patel 09/17/85
Owner address: 4514 W Tesch Ave
City State Zip: Greenfield, WI. 53220
Owner Phone: 414-595-9162
Owner email: njp23073644 @gmail.com

Manager: Nikhilkumar J Patel
Home Address: 4514 W Tesch Ave
City State Zip: Greenfield Ave
Phone: 414-595-9162
Email: njp23073644@gmail.com

Preferred contact: Nikhilkumar Patel

Location currently open: YES NO

Projected open date:

Day's open: S M T W Th F SA ALL

Hours of Operation: Sun: 7a-9p 24 hours Y N
Mon: 7a-9p
Tue: 7a-9p
Wed: 7a-9p
Thu: 7a-9p
Fri: 7a-9p
Sat: 7a-9p

Premise Type: Liquor Store
Convenience Store
Other:

Licenses currently held:

- Alcohol: Yes No Class: #:
Tobacco: Yes No #:
Food: Yes No #:
Extended Hours: Yes No #:
Secondhand Dealer: Yes No Type: #:
Other: Yes No Type: #:
Other: Yes No Type: #:

Exterior Survey:

1. Is the area around the location clean? Yes No
2. What surrounds the location? (Check all the apply)
 - a. Park
 - b. School
 - c. Youth Center
 - d. Church
 - e. Tavern(s) If so, how many
 - f. Residential
 - g. Other businesses
 - h. Other:
3. Can you see from the outside of the location into the interior Yes No
4. Can you see the employees inside of the location from the outside Yes No
5. Are exterior windows free of signage Yes No
6. Is there a parking lot Yes No
7. Is the parking lot clean? Yes No
8. Is the parking lot well lit? Yes No
9. Are there areas where a person could conceal themselves Yes No
10. Is there exterior lighting? Yes No. Does it appears to be adequate Yes No
11. Exterior Payphone? Yes No
12. Are there No Loitering Signs posted? Yes No
13. Are there exterior security cameras Yes No How Many: 4
14. Are the address numbers prominently displayed and easy to see Yes No

Camera Survey:

15. Does this location have security cameras? Yes No
16. Are they in working order? Yes No
17. What format are the cameras?
 - a. Color Yes No
 - b. Digital Yes No
 - c. VCR Yes No
 - d. Recorded Yes No
18. How long is footage stored for later viewing: 7 days
19. Are there exterior cameras Yes No How many: 4
20. Are there interior cameras Yes No How many: 12
21. Do all employees know how to retrieve recorded digital images/footage? Yes No

Interior Survey:

22. Is the storeowner willing to be a standing complainant regarding loitering? Yes No
a. If yes have them fill out the standing complaint form and give them two of the commercial signs Yes No
23. Is the interior of the location neat and clean? Yes No
24. Does an interior camera face the entrance/exit? Yes No
25. Is there a lockable area that separates employees from customers? Yes No
26. Does the store sell single chore boy? Yes No
27. Does the store sell blunt wraps? Yes No
28. Does the store sell scales? Yes No
29. Does the store sell items that may be used as crack pipes? Yes No
a. Describe item
30. Does the store have an over abundance of sandwich baggies: Yes No
31. Does the owner understand that these items are often used for drug use? Yes No
32. Do the products in the store appear to be new and rotated often? Yes No
33. Are emergency and non-emergency numbers posted near the phone? Yes No
34. Does the owner know how to contact their police district directly? Yes No
a. Did you provide a district contact guide to the owner? Yes No

Complete this section if alcohol establishment is a convenience store:

(** Read full ordinance for all details "68-4.3 Convenience Food Stores")

All convenience food stores not exempted under sub. 3 shall:

1. Is the cash register located in a manner so that at the time of a sales transaction, the employee and customer are both visible from the sidewalk? Yes No **
2. Are the glass entrance and exit doors clear of any signs or advertisements with the exception of a sign which states that the cash register contains \$50 or less and that the safe is no accessible to employees? Yes No
3. Does the store maintain one of the following on the licensed premise:
 - a. A safe that was in use at the convenience food store on August 17, 1994? Yes No
 - b. A drop-safe or time release safe that weighs at least 500 pounds or which is attached to or set into the floor in a manner approved by the police department? Yes No
4. Is lighting provided for the store's parking area during all hours of darkness when employees or customers are on the premises at a minimum average of 2-foot candles per square foot, unless the store is not open for business after sunset and before sunrise? Yes No N/A
5. Are at least two high-resolution surveillance security cameras installed? Yes No
6. Are the security cameras in working order? Yes No
7. Does one camera show an overall view of the counter and register area? Yes No
8. Does one camera show a clear, identifiable, full frame image of the face of each person entering and leaving the store? Yes No
9. Are the camera views obstructed by fixtures or displays? Yes No
10. Is the recorded footage stored for at least 30 days? Yes No
11. Do all store employees know how to record footage from the camera system to media capable of being transferred to police custody? Yes No

12. Are customer entrances/exits made of glass or other transparent material? Yes No
a. Exception: A store that does not have such doors on August 17, 1994 shall not be required to install such doors until the holder of the store's food dealer license changes.
13. Has the owner and their employees attended the Robbery Prevention Training within 120 days of ownership or employment? Yes No
a. Contact Community Outreach and Education at 935-7836 for schedule.

Sub 3. Exemptions. The requirements of this section do not apply to a convenience food store that conforms to either of the following descriptions:

- a-1. The store is located in an enclosed shopping structure, enclosed commercial building or hospital. A convenience food store is not in an enclosed structure or building if a customer can enter it directly from the outside.
Does store conform to a-1 Yes No
- a-2. The store physically separates employees from customers with a solid partition that bars a person from entering the employee area from the customer area, has a secure lock on the employee side of any door between the employee area and the customer, and conducts all transaction through a service window or similar arrangement.
Does store conform to a-2 Yes No
- a. At the commissioner's discretion, a convenience store may be exempted from any or all of the regulations specified in sub 2.
Does this location hold an exemption from the commissioner regarding any of the requirements of Sub 2? Yes No

ADDITIONAL COMMENTS/RECOMMENDATIONS:

Alcohol concentration for 10707 W Hampton Ave

City of Milwaukee, Wisconsin

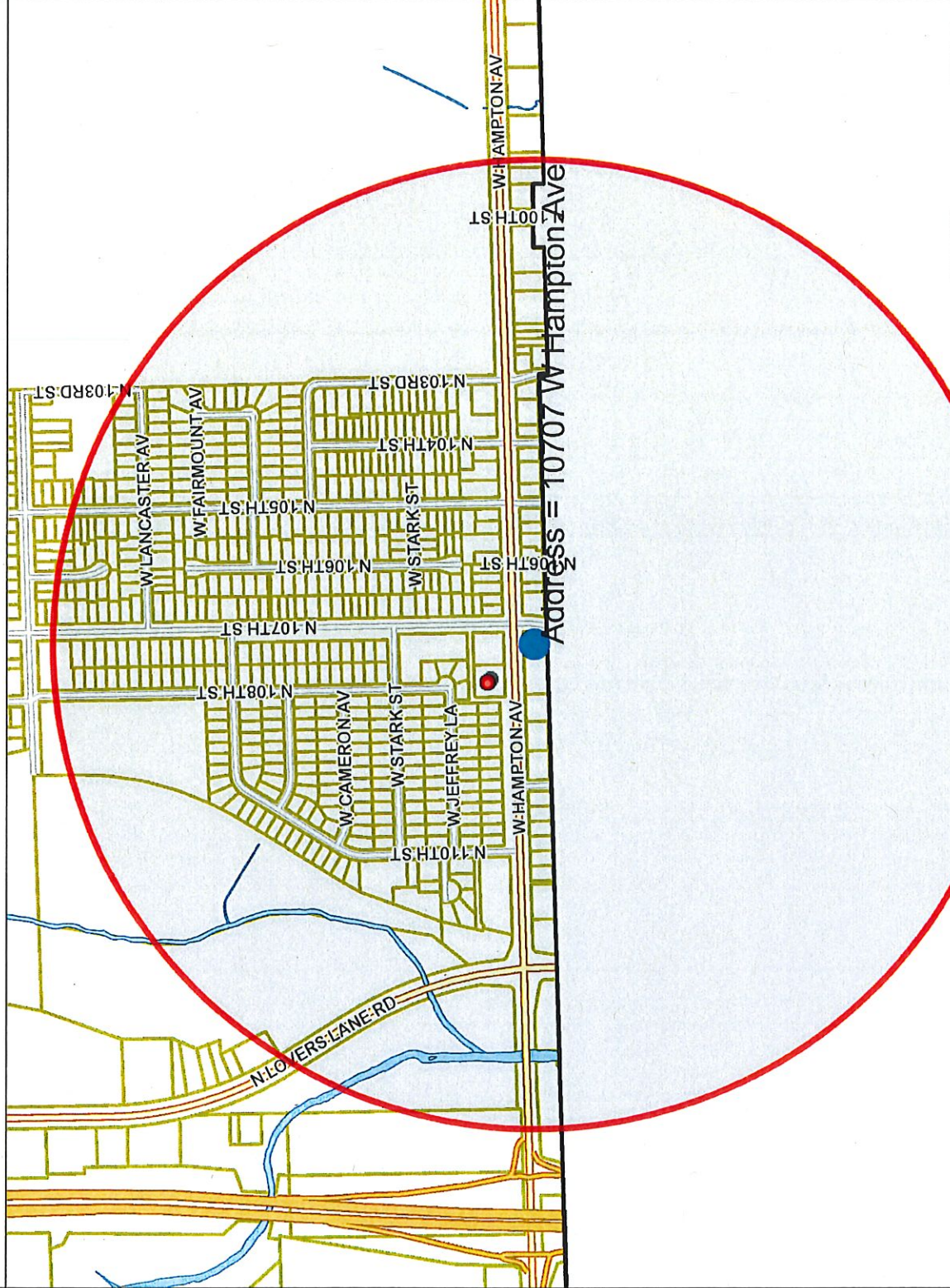

© City of Milwaukee, Wisconsin
 Map Milwaukee: Property Information
 Disclaimer
 7/30/2018
 Map Scale: 1: 10,000
 833.3
 0
 416.67
 833.3 Feet



- Legend -

- Street names 10,000
- City limits
- Freeways 15,000
- Freeways
- Exit ramps
- Entry ramps
- Ramps
- Major streets 10,000
- Streets 10,000
- Waterways
- Milwaukee Parcels
- Street names 10,000
- Alcohol licenses
- Class A intoxicating liquor
- Class A fermented malt beverage
- Class A liquor and malt
- Class B fermented malt beverage
- Class B tavern
- Class C wine retailer

- Notes -

Alcohol establishments within a .5 mile radius centered on 10707 W Hampton ave on 7/30/2018

City of Milwaukee
 Department of Administration - ITMD

Alcohol establishments within a .5 mile radius centered on 10707 W Hampton Ave on 7/30/2018

License Summary

- Class A Fermented Malt Beverage Retailer's License
- Class A Malt & Class A Liquor License
- Class A Retailer's Intoxicating Liquor License

Total: 1
1
1

Legal entity	Trade name	Licensee	License type name	Total capacity	Room capacity	Address	Expiration date
Ever Green Pantry Inc	PK Pantry	Chandrika Patel, Agt	Class A Fermented Malt Beverage Retailer's License			10707 W Hampton AV	6/9/2019 19:00
BOB & AL, LLC	HAMPTON BEVERAGE	BHAVESH B PATEL, Agt	Class A Malt & Class A Liquor License			10722 W HAMPTON AV	7/25/2019 19:00
Ever Green Pantry Inc	PK Pantry	Chandrika Patel, Agt	Class A Retailer's Intoxicating Liquor License			10707 W Hampton AV	6/9/2019 19:00

Grand Total: 3



Friday, October 12, 2018

Licenses Committee Notice of Hearing

Ever Green Pantry Inc
10707 W Hampton Av
Milwaukee, WI 53225

Date: 10/23/2018
Time: 09:15 AM
Location: Room 301-B, Third Floor, City Hall

The Licenses Committee will consider the following license application:

Class A Malt, Class A Liquor-Cider Only, and Food Dealer License Applications
PATEL, Nikhilkumar, Agent
PK'S Pantry at 10707 W Hampton Av

Please note this application may be recommended for denial based on fitness of the location due to concentration of alcohol beverage outlets in the area. If the application is denied for this reason, no other application for an alcohol beverage license for this location shall be recommended for approval by the Licenses Committee within three years of the date of denial unless the applicant has demonstrated a change of circumstances since the prior denial.

If you have any questions, please call (414) 286-2238.





Friday, October 12, 2018



Notice of Public Hearing

PATEL, Nikhilkumar, Agent
PK'S Pantry at 10707 W Hampton Av
Class A Malt, Class A Liquor-Cider Only, and Food Dealer License Applications

Tuesday, October 23, 2018 at 9:15 AM

To whom it may concern:

The above application has been made by the above named applicant(s). This requires approval from the Licenses Committee and the Common Council of the City of Milwaukee. The hearing before the Licenses Committee will take place on 10/23/2018 at 9:15 AM, in Room 301-B, Third Floor, City Hall. If you wish, you may provide testimony at the hearing regarding the request; see below for further information. You are not required to attend the hearing. Once the Licenses Committee makes its recommendation, this recommendation is forwarded to the full Common Council for approval at its next regularly scheduled hearing. Please review the information below and if you have further questions regarding this process, please contact the License Division at (414) 286-2238.

Important details for those wishing to provide information for the Licenses Committee to consider when making its recommendation:

1. The license application is scheduled to be heard at the above time. Due to other hearings running longer than scheduled, you may have to wait some time to provide your testimony.
2. You must appear in person and testify as to matters that you have personally experienced or seen. (You cannot provide testimony for your neighbor, parent or anyone else; this is considered hearsay and cannot be considered by the committee.)
3. No letters or petitions can be accepted by the committee (unless the person who wrote the letter or the persons who signed the petition are present at the committee hearing and willing to testify).
4. Persons opposed to the license application are given the opportunity to testify first; supporters may testify after the opponents have finished.
5. When you are called to testify, you will be sworn in and asked to give your name, and address. (If your first and/or last names are uncommon please spell them.)
6. You may then provide testimony.
 - a. Include only information relating to the above license application.
 - b. Include only information you have personally witnessed or seen.
 - c. Provide concise and relevant information detailing how this business has affected or may affect the peaceful enjoyment of your neighborhood.
 - d. If by the time you have the opportunity to testify, the information you wish to share has already been provided to the committee, you may state that you agree with the previous testimony. Redundant or repetitive testimony will not assist the committee in making its recommendation.
7. After giving your testimony, the members of the Licenses Committee and the licensee may ask questions regarding the testimony you have given or other factors relating to the license application.
8. Business Competition is not a valid basis for denial or non-renewal of a license.
Please Note: If you have submitted an objection to the above application your objection cannot be considered by the committee unless you personally testify at the hearing.

OCCUPANT	MAIL ADDRESS	CITY, STATE ZIP
CURRENT OCCUPANT	10815 W HAMPTON AVE 4	MILWAUKEE, WI 53225
CURRENT OCCUPANT	10815 W HAMPTON AVE 5	MILWAUKEE, WI 53225
CURRENT OCCUPANT	10739 W HAMPTON AVE 3	MILWAUKEE, WI 53225
CURRENT OCCUPANT	10739 W HAMPTON AVE 8	MILWAUKEE, WI 53225
CURRENT OCCUPANT	4766 N 107TH ST	MILWAUKEE, WI 53225
CURRENT OCCUPANT	10615 W HAMPTON AVE	MILWAUKEE, WI 53225
CURRENT OCCUPANT	10729 W HAMPTON AVE 2	MILWAUKEE, WI 53225
CURRENT OCCUPANT	10729 W HAMPTON AVE 8	MILWAUKEE, WI 53225
CURRENT OCCUPANT	10739 W HAMPTON AVE 5	MILWAUKEE, WI 53225
CURRENT OCCUPANT	10739 W HAMPTON AVE 6	MILWAUKEE, WI 53225
CURRENT OCCUPANT	10623 W HAMPTON AVE	MILWAUKEE, WI 53225
CURRENT OCCUPANT	10630 W HAMPTON AVE	MILWAUKEE, WI 53225
CURRENT OCCUPANT	10815 W HAMPTON AVE 2	MILWAUKEE, WI 53225
CURRENT OCCUPANT	10815 W HAMPTON AVE 6	MILWAUKEE, WI 53225
CURRENT OCCUPANT	10729 W HAMPTON AVE 5	MILWAUKEE, WI 53225
CURRENT OCCUPANT	10729 W HAMPTON AVE 6	MILWAUKEE, WI 53225
CURRENT OCCUPANT	10729 W HAMPTON AVE 1	MILWAUKEE, WI 53225
CURRENT OCCUPANT	10815 W HAMPTON AVE 3	MILWAUKEE, WI 53225
CURRENT OCCUPANT	10729 W HAMPTON AVE 3	MILWAUKEE, WI 53225
CURRENT OCCUPANT	10739 W HAMPTON AVE 7	MILWAUKEE, WI 53225
CURRENT OCCUPANT	10620 W HAMPTON AVE	MILWAUKEE, WI 53225
CURRENT OCCUPANT	10815 W HAMPTON AVE 1	MILWAUKEE, WI 53225
CURRENT OCCUPANT	10815 W HAMPTON AVE 8	MILWAUKEE, WI 53225
CURRENT OCCUPANT	10739 W HAMPTON AVE 2	MILWAUKEE, WI 53225
CURRENT OCCUPANT	10621 W HAMPTON AVE	MILWAUKEE, WI 53225
CURRENT OCCUPANT	10629 W HAMPTON AVE	MILWAUKEE, WI 53225
CURRENT OCCUPANT	10631 W HAMPTON AVE	MILWAUKEE, WI 53225
CURRENT OCCUPANT	4820 N 107TH ST	MILWAUKEE, WI 53225
CURRENT OCCUPANT	10729 W HAMPTON AVE 4	MILWAUKEE, WI 53225
CURRENT OCCUPANT	10739 W HAMPTON AVE 1	MILWAUKEE, WI 53225
CURRENT OCCUPANT	10613 W HAMPTON AVE	MILWAUKEE, WI 53225
CURRENT OCCUPANT	10815 W HAMPTON AVE 7	MILWAUKEE, WI 53225
CURRENT OCCUPANT	10729 W HAMPTON AVE 7	MILWAUKEE, WI 53225
CURRENT OCCUPANT	10739 W HAMPTON AVE 4	MILWAUKEE, WI 53225
CURRENT OCCUPANT	4764 N 107TH ST	MILWAUKEE, WI 53225
CURRENT OCCUPANT	10640 W HAMPTON AVE	MILWAUKEE, WI 53225
CURRENT OCCUPANT	4822 N 107TH ST	MILWAUKEE, WI 53225
CURRENT OCCUPANT	10627 W HAMPTON AVE	MILWAUKEE, WI 53225

Total Records: 38

Radius: 250.0 feet and Center of Circle: 10707 W Hampton Ave



BUSINESS LICENSE PLAN OF OPERATION

ccl-busplan 12/14/17

Office of the City Clerk License Division
200 E. Wells St. Room 105, Milwaukee, WI 53202
(414) 286-2238 www.milwaukee.gov/license e-mail address: license@milwaukee.gov

1. Type of Business

- Applying for: Extended Hours (12AM to 5AM) - If a food establishment, check all that apply: Delivery Drive Thru Dining Room
 Self Service Laundry Massage Establishment Filling Station
 Other (supplemental application for specific license also required)

Provide a detailed description of the type of business you plan on operating:

CONVENIENCE STORE WITH BEER.

Do you have any experience operating this type of business? No Yes If yes, explain: WORKING ON SAME FIELD

2. Business Operations

- a. Proposed Opening Date: 09/01/2018
- b. Is this premise under construction? No Yes If yes, list estimated completion date: _____
- c. Is this a franchise? No Yes
- d. Is this premises currently licensed? No Yes If yes, list type of license: FOOD, CLASS A BEER, CIG.
- e. Is the current licensee operating? No Yes If no, list date closed: _____
- f. Do you have future plans for other businesses, licenses or permits at this location? No Yes
If yes, explain: ALCOHOL
- g. Have you previously held an Extended Hours License in Milwaukee? No Yes
If yes, list address(es): _____
- h. Are other businesses operating in the same building? No Yes If yes, describe: _____

3. Litter & Noise

- a. How are grounds kept clean? Sweep Pressure Wash Pick Up Litter Other: _____
- b. How often will grounds be cleaned? Daily Weekly As Needed Monthly Other: _____
- c. Grounds cleaned by: Licensee Building Owner Employees Hired Maintenance Other: _____
- d. How are noise issues prevented and/or addressed? Security Manager approaches customer(s) Call Police
 Signs Posted Other: _____
- e. Will a sound amplification system be used? No Yes If yes, describe: _____

4. Smoking & Sanitation

- a. Are there designated outdoor smoking areas? No Yes If yes, describe: _____
- b. Number of Garbage Cans: Inside: 2 Locations: BY CASH REGISTER & RESTROOM
Outside: 1 Locations: BY FRONT DOOR OUTSIDE
- c. Is a crowd control barrier used? No Yes If yes, describe: _____
- d. How many restrooms are on the premises? 1
- e. Name of solid waste contractor: Advanced Disposal Waste Management Other: _____

5. Security

- a. Are there onsite parking spaces? No Yes If yes, indicate how many? 10 and describe the parking security plan: SECURITY CAMERA SYSTEM MONITORS PARKING 61 24/7
- b. Is there a loading zone? No Yes If yes, describe the loading area security plan: _____
- c. Will you have security personnel on premise? No Yes If yes, how many? _____ and answer the following:
 What are their responsibilities? _____
 Is security equipment used? No Yes If yes, describe _____
 List their licensing, certification, or training credentials _____
- d. Will there be security cameras? No Yes If yes, where? MONITORS INSIDE @ STORE SURROUNDINGS
- e. Will searches/identification checks be done upon entry? No Yes If yes, describe FOR BEER + CIG.

6. Percentage of Sales (must total 100%)

Alcohol <u>30</u> %	Food <u>30</u> %	Secondhand Merchandise _____ %	Precious Metals & Gems _____ %
Entertainment _____ %	Cigarettes <u>40</u> %	_____ %	_____ %
Pawnbroker Activity _____ %	Salvaged Materials _____ % (such as scrap metal)	Personal Services (such as tattoo, body piercing, salon, tailor, tanning, etc.) _____ %	Other _____ % Describe: _____

7. Businesses/Licenses on the Premises (check all that apply):

Type 1

- Full Service Restaurant Cafe/Coffee Shop Deli or Fast Food Restaurant Private/Fraternal/Veterans Club
- Night Club Tavern Cocktail Lounge Teen Club
- Banquet Hall Sports Facility Bowling Alley
- Hotel/Motel : Number of Floors: _____ Rooming House: Number of Floors: _____
 Number of Rooms: _____ Number of Rooms: _____

Type 2

- Liquor Store Corner Store Supermarket Convenience Store
- Gas Station Amusement/Phonograph Distributor Recycling, Salvage or Towing
- Used Car Dealer Personal Service Establishment
(such as tattoo business, hair salon, tailor, etc.) Recording Studio

What other licenses/permits will you hold at this location? (check all that apply)

- Occupancy Permit Cigarette & Tobacco Gas Station Extended Hours Class "B" Tavern Weights & Measures
- Secondhand Dealer Precious Metal & Gem Other: _____

8. Legal Capacity (only if a Type 1 premises in #7 above)

N/A

Capacity _____ (Call the Milwaukee Development Center at 414-286-8211 if you have questions.)

9. Premises Description

- a. Identify all area(s) of the premises that will be used in operating this business (include areas used only for storage):
 1st Floor 2nd Floor Basement Storage Patio Beer Garden Sidewalk Café Deck Rooftop
 Other: Describe: _____
- b. Describe Location: Major Thoroughfare Secondary Street Other: _____
- c. Nearest Major Cross Street: 107TH ST & HAMPTON AVE
- d. Describe Building: Free Standing Building Strip Mall Other: _____
- e. Describe Premises Structure: Single Story Multi-Story - # of Stories _____ Other: _____
- f. Describe Surrounding Area: Commercial Residential Industrial Other: _____
- g. Building Owner Name: B.K. PATOL Phone Number: 414-610-5296
 Business Owner Address: 10707 W HAMPTON AVE MIL

10. Hours of Operation & Customers

Will customers be entering the premises? No Yes FROM MON TO SUN
NICHOE START BELL 8:00 AM 9:00 PM

Day of the Week	Proposed Hours of Operation:		Estimated Number of Customers expected each day	Potential Age Range of Customers	Class B Tavern Applicant Only: Age Restriction (If none, write 'None')
	Open Time (include a.m. or p.m.)	Close Time (include a.m. or p.m.)			
Sunday	7:00 AM	9:00 PM	250	5 TO 80	NONE
Monday	7:00 AM	9:00 PM	250	"	"
Tuesday	7:00 AM	9:00 PM	250	"	"
Wednesday	7:00 AM	9:00 PM	250	"	"
Thursday	7:00 AM	9:00 PM	250	"	"
Friday	7:00 AM	9:00 PM	250	"	"
Saturday	7:00 AM	9:00 PM	250	"	"

An Extended Hours Establishment License is required for any convenience store, filling station, personal service establishment (such as tattoo, body piercing, salon, tailor, tanning, etc.), recording studio or restaurant which is open between the hours of 12:00 a.m. and 5:00 a.m.

Alcohol Establishments Class A: 8:00 am to 9:00 pm Sunday thru Saturday
 Permitted Hours of Operation: Class B: 6:00 am to 2:00 am Sunday thru Thursday, 6:00 am to 2:30 am Friday & Saturday

Entertainment Outdoor Closing Hours: 10:00pm Sunday-Thursday; 12:00am Friday & Saturday; unless a different time, either earlier or later, is established by the Common Council in its approval of the licensee's plan of operation.

11. Signature(s)

[Signature]
 Signature of Sole Proprietor, Partner, or 20% or more Shareholder
 (If there are no 20% or more shareholders,
 Corporate Officer-print name/title and sign)

[Signature]
 Signature of additional partner or 20% or more shareholder

See Application Information for a complete list of all required application forms.

Lease Information (New & Transfer Applicants who are leasing the premises only)

- a) Date lease begins _____ Ends _____
- b) Monthly rental \$ _____
- c) Do you have an option to renew the lease? No Yes
- d) Does your lease allow for assignment to another party without the consent of the owner? No Yes
- e) For what length of time have you been guaranteed occupancy (number of years)? _____
- f) In addition to paying the monthly rental, will you have to pay anything additional to the owner of the building to guarantee performance of the lease? No Yes If yes, explain _____
- g) Does the present owner or occupancy object to the granting of your license? No Yes
If yes, explain _____

Change of Agent Applicants Only

Have there been any changes to the floor plan since the last application was submitted? No Yes
If no, a new floor plan is not required. If yes, submit a new floor plan and explain the change(s): _____

Notarized Signatures of Applicants

SUBSCRIBED AND SWORN TO BEFORE ME

This 20 day of July

Ajit N. Patel
(Clerk/Notary Public)

My Commission Expires 12-01-2010
*Notary Seal must be affixed.

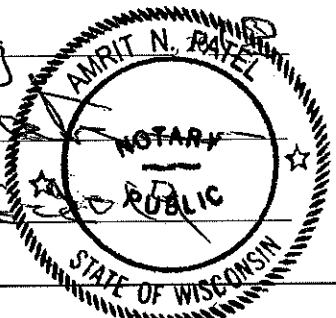

K. P. Patel
Sole Proprietor, Partner, 20% or more Shareholder, or
Agent – only if there are no 20% or more shareholders

M. J. Patel
Additional partner or 20% or more shareholder

Note: All information contained in this application is subject to approval by the Common Council.
Deviating from approved plan of operation will subject licensee to citations, and/or suspension or non-renewal of the license.
Contact the License Division for information on how to request changes.

New and transfer of premise applicants must submit the following:

- Proof of ownership, lease or offer to purchase the building
- Detailed floor plan
- If a restaurant, copy of the menu



FOOD DEALER LICENSE PLAN OF OPERATION

OFFICE OF THE CITY CLERK, LICENSE DIVISION
CITY HALL, 200 E. WELLS ST, ROOM 105, MILWAUKEE, WI 53202
(414) 286-2238 • license@milwaukee.gov • www.milwaukee.gov/license

Legal Entity Name: HAMPTON BEER & FOOD INC

Premises Address: 10707 W. HAMPTON AVE

SECTION 1 TYPE OF BUSINESS

Type of application (check one): taking over a currently operating business starting a new business

Anticipated opening date? SOON AS POSSIBLE

Check the type that best describes your business (check only one):
See Food Dealer License Information sheet for definitions.

Restaurant Bed & Breakfast
 Retail Establishment Base for Food Peddler
 Base for Temporary/Seasonal Food Stand

If retail, will it be a convenience store? Yes No
 (Convenience Stores have less than 5,000 sq ft of retail space,
 primary business is the sale of basic food items, and in addition sells household products)

In addition, will any wholesale business be done? Yes No

If yes, what percentage of the business will be wholesale? Less than 25% 25% or More (Contact DATCP)*

Will retail items be sold? No Yes If Yes, indicate percentage of food sales 100 %

Will restaurant items be sold? No* Yes If Yes, indicate percentage of food sales _____ %

* if you checked "25% or More" of the business will be wholesale and answered "No" to restaurant items being sold, do not continue completing this application. A City of Milwaukee License is not required. Contact DATCP only.

SECTION 2 FOOD PROCESSING

Will any food processing be done? No Yes
Processing is defined as assembling, grinding, cutting, mixing, baking, coating, stuffing, packing, bottling, grilling, canning, extracting, fermenting, distilling, pickling, freezing, drying, smoking, or packaging.

If Yes, check the types of food items:

SNACKS & BEVERAGES
includes, but is not limited to, ice cream/soft serve, lemonade, snow cones, coffee, espresso, cappuccino, tea, fruit juice, smoothies, candy, dispensed soda, fruit cups, bakery, cookies, popcorn, kettle corn, cotton candy, funnel cakes, fritters, tortilla chips w/ cheese

MEALS
includes, but is not limited to, chicken, ribs, sandwiches, roasted corn, baked potatoes, hot dogs, brats, tacos, nachos w/ cheese and meat, French fries, cooked or deep fried vegetables/fruit, cooked cheese curds, corn dogs, egg rolls, salads

SECTION 3 FOOD REQUIRING TEMPERATURE CONTROL

Will any food that requires temperature control be sold? No Yes
 (includes dairy products such as milk, cheese, and ice cream, fish, shellfish, meat, poultry)

If yes, list the types of food items: MILK, CHEESE, ICE CREAM, MEAT

SECTION 4 SHARED KITCHEN

Will you be sharing kitchen space with another operator?

- No If No, SKIP to Section 5
- Yes If Yes, check one:
- I will rent space from another operator ("Shared Kitchen Agreement" is required)
- I will rent space to another operator (peddler/caterer)

SECTION 5 DETAILS OF OPERATION

Answer the following questions:

- Will you have seating on site for dining? No Yes
- Will you be doing any catering? No Yes
- Will you be doing any delivery? No Yes
- Will you have outdoor activities? No Yes
- If Yes to outdoor activities, check all that apply: Bar Cooking/Grilling Dining
- Will you have a drive thru window? No Yes
- If Yes to drive thru, are hours different from inside? No Yes
- If Yes, provide drive thru hours: _____
- Will any scales or barcode scanners be used? No Yes
- If Yes, a Weights & Measures application must be completed and a license obtained.

SECTION 6 ADDITIONAL SITES

Where will food be prepared and/or sold?

- At a single site
- At multiple sites (for example, a hotel with several dining rooms or bars) How many? _____
- If multiple sites, attach a Food Dealer Additional Site Addendum (ccl-foodadd) for each additional site.

SECTION 7 CONSTRUCTION OR CHANGES

Are you planning any construction, remodeling or equipment changes?

- No If No, SKIP to Section 8
- Yes If Yes, check all that apply:
- New construction of a building
- Construction changes to an existing building
- Renovation or remodeling
- Equipment changes only (installation or replacement)

Provide a brief description of the changes: _____

Start date: _____

Name, Address & Phone Number of Architect: _____

Name, Address & Phone Number of Contractor: _____

SECTION 8 ALCOHOL BEVERAGES

Are you applying for an alcohol beverage license?

- No If No, SKIP to Section 9
- Yes If YES, if your food license is approved prior to the alcohol beverage license, when do you want the food license issued? Immediately At the same time as the alcohol license

SECTION 9 ACKNOWLEDGEMENTS & SIGNATURE

You must initial each item confirming your understanding:

- ML I understand the Health Department must conduct an inspection and advise the License Division of their approval before the license may be issued.
- ML I understand I must obtain an occupancy permit from the Department of Neighborhood Services and an inspection may be required. Neighborhood Services must advise the License Division of their approval before the license may be issued.
- DP I understand the district alderperson will review and either approve or deny my application. If denied, I may appeal and be scheduled to appear before the Licenses Committee. The Licenses Committee will then make a recommendation to the Common Council. The Common Council must grant the license before it may be issued.
- ML I understand proof of payment for all license fees must be on file in the License Division before the license may be issued.
- DP I understand the license must be issued and posted in my establishment prior to opening for business.
- ML I will not operate my food business until the license has been issued and posted in the establishment.

Signature of sole proprietor, partner, agent or 20% shareholder: X *Quish L. De*

Signature of additional partner(s): *M. J. Petrell*

107 TH ST

TOTAL SQFT
15300

— 48 FEET —

BACK DOOR

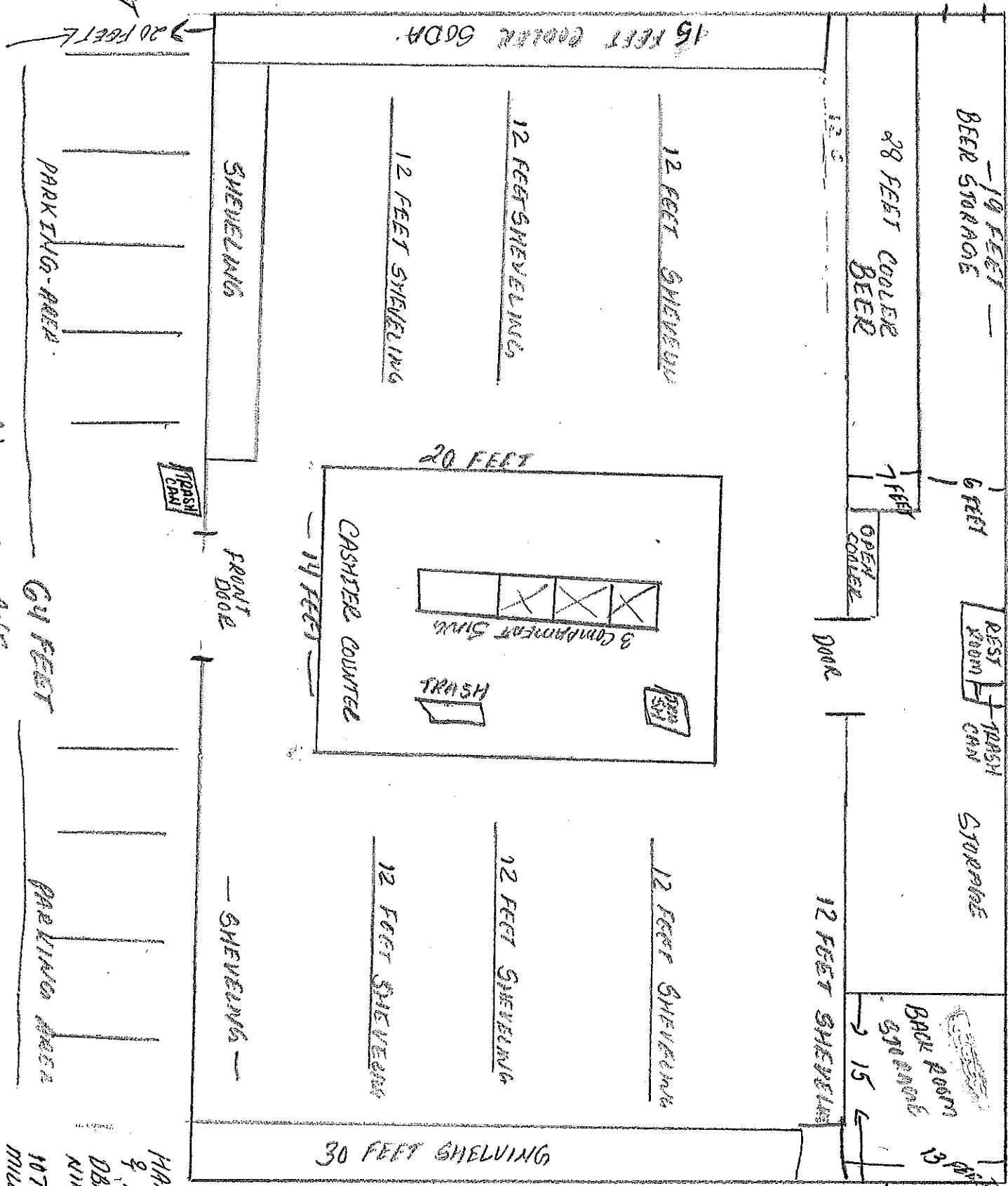

— 64 FEET —

HAMPSON BEER & FOOD LLC
 DBA. PE'S PUB
 NIKHIL KUMAR
 RAGAN
 10707 W HAMPTON MILWAUKEE, WI 53224

— 48 FEET —

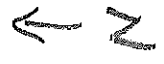



**CITY OF MILWAUKEE
OFFICE OF THE CITY CLERK**

Friday, October 12, 2018

COMMITTEE MEETING NOTICE

AD 05

WESTERHAUSEN, Kelly J, Agent
Kellyz LLC
7022 W North Av
Wauwatosa, WI 53213

You are requested to attend a hearing which is to be held in Room 301-B, Third Floor, City Hall on:

Tuesday, October 23, 2018 at 09:15 AM

Regarding: Your Class B Tavern, Food Dealer, and Public Entertainment Premises License Applications with 25+ Age Restriction and Requesting Jukebox, Karaoke, 5 Amusement Machines, and 1 Pool Table as agent for "Kellyz LLC" for "Kellyz" at 7964 W APPLETON Av.

There is a possibility that your application may be denied for one or more of the following reasons: The recommendation of the committee regarding the application shall be based on evidence presented at the hearing. Per MCO 85-2.7-4, probative evidence concerning whether or not a new license should be granted may be presented on the following subjects: whether or not the applicant meets the municipal requirements, the appropriateness of the location and premises where the licensed premises is to be located and whether use of the premises for the purposes or activities permitted by the license would tend to facilitate a public or private nuisance or create undesirable neighborhood problems such as disorderly patrons, unreasonably loud noise, litter, and excessive traffic and parking congestion. Probative evidence relating to these matters may be taken from the plan of operation submitted with the license application, if any, but shall not include the content of any music. Evidence regarding the fitness of the location of the premises to be maintained as the principal place of business, including but not limited to whether there is an overconcentration of businesses of the type for which the license is sought; whether the proposal is consistent with any pertinent neighborhood business or development plans, or the location's proximity to areas where children are typically present. The applicant's record in operating similarly licensed premises; and whether or not the applicant has been charged with or convicted of any felony, misdemeanor, municipal offense or other offense, the circumstances of which substantially relate to the activity to be permitted by the license being applied for or any other factor which reasonably relates to the public health, safety or welfare may also be considered. See attached police report or correspondence.

Notice for applicants with warrants or unpaid fines:

Proof of warrant satisfaction or payment of fines must be submitted at the hearing on the above date and time. Failure to comply with this requirement may result in a delay of the granting/denial of your application.

Failure to appear at this meeting may result in the denial of your license. Individual applicants must appear only in person or by an attorney. Corporate or Limited Liability applicants must appear only by the agent designated on the application or by an attorney. Partnership applicants must appear by a partner listed on the application or by an attorney. If you wish to do so and at your own expense, you may be accompanied by an attorney of your choosing to represent you at this hearing.

You will be given an opportunity to speak on behalf of the application and to respond and challenge any charges or reasons given for the denial. No petitions can be accepted by the committee, unless the people who signed the petition are present at the committee hearing and willing to testify. You may present witnesses under oath and you may also confront and cross-examine opposing witnesses under oath. If you have difficulty with the English language, you should bring an interpreter with you, at your expense, so that you can answer questions and participate in your hearing.

You may examine the application file at this office during regular business hours prior to the hearing date. Inquiries regarding this matter may be directed to the person whose signature appears below.

Limited parking for persons attending meetings in City Hall is available at reduced rates (5 hour limit) at the Milwaukee Center on the southwest corner of East Kilbourn and North Water Street. Parking tickets must be validated in the first floor information booth in City Hall.

PLEASE NOTE: Upon reasonable notice, efforts will be made to accommodate the needs of disabled individuals through sign language interpreters or other auxiliary aids. For additional information or to request this service, contact the Council Services Division ADA Coordinator at (414) 286-2998, Fax - (414) 286-3456, TDD - (414) 286-2025.

JIM OWCZARSKI, CITY CLERK

BY: _____

Jessica Ceella

License Division Manager

If you have questions regarding this notice, please contact the License Division at (414) 286-2238.

200 E. Wells Street, Room 105, City Hall, Milwaukee, WI 53202. www.milwaukee.gov/license
Phone: (414) 286-2238 Fax: (414) 286-3057 Email Address: License@milwaukee.gov

Cooney, Jim

From: License
Sent: Thursday, September 6, 2018 7:54 AM
To: Cooney, Jim
Subject: FW: Please Review License for a "B" Tavern To Be Opened 7964 W. Appleton Ave. Formerly RHINOS

Keren Becker
License Specialist III
City Clerk – License Division
O: (414) 286-2238
F: (414) 286-3057
License@Milwaukee.gov
www.Milwaukee.gov/license

REDACTED RECORD



From: Reiss, Tess
Sent: Wednesday, September 5, 2018 3:58 PM
To: [REDACTED]
Cc: License
Subject: RE: Please Review License for a "B" Tavern To Be Opened 7964 W. Appleton Ave. Formerly RHINOS

Nicholas,

Thank you for your concern regarding a possible tavern license application at the former Rhino's, 7964 W Appleton Av.

According to the License Division, no application has been accepted for this location. The information that you provided will be added to the License Division's file on the matter. Further, as you pointed out, the notice is not a valid notice issued by the License Division.

If and when a proper application is made, you and other neighbors will certainly be notified.

I hope that answers your questions. Please let me know if I may be of further assistance.

Thanks,
Tess

Tess Reiss
Legislative Assistant
Aldermanic District 5
414.286.3870
ajde5@milwaukee.gov
200 E Wells St, Room 205
Milwaukee, WI 53202

From: [REDACTED]
Sent: Tuesday, September 04, 2018 4:49 PM

To: License

Cc: Reiss, Tess

Subject: Please Review License for a "B" Tavern To Be Opened 7964 W. Appleton Ave. Formerly RHINOS

September 4th 2018

Renewal Alcohol Beverage License Application

(Fraudulent Public Notice ccl-not49/12)

7964 W. Appleton Ave.

(Formerly "RHINOS" Class B Tavern)

REDACTED RECORD

Dear Mr. Owczarski,

I am writing you with grave concerns of a known nuisance bar that was located at 7964 W. Appleton Ave; "RHINOS" formerly a class B tavern. This bar's license was revoked Tuesday May 15th 2018 with a 5-0 vote (171878) of the common council licensing committee and was even appealed by Karen Miller and a vote of those common council members present to approve the recommendations of the licenses committee as contained in file 171878 was approved with a 14-0 on Wednesday May 30th for non-renewal.

The current building owner Karen Miller has posted a Notice Of Public Interest on the door of the building located at 7964 W. Appleton Ave. and to a reasonable person there has been information of the notice purposely redacted for objection submissions and dates to submit objections. This is fraudulent behavior that goes hand in hand with previous behavior at this establishment and if this building located at 7964 W. Appleton Ave. is allowed to operate any type of Tavern or related business; beyond reasonable doubt there will be a hit to the quality of life for the neighborhood.

Below are state statutes and local city ordinances, along with photos that will that will strengthen the argument of why there should not be any type of Tavern or related business that will affect quality of life on a detrimental level.

Local Ordinances

Liquor and Tavern Regulations 90-4-7.9

f. Objections. f-1. The city clerk shall issue the license unless a written objection regarding the licensee or the location has been filed with the city clerk. The objection may be filed by any interested person. If a written objection is filed, the application shall be forwarded to the licensing committee for its recommendation to the common council. f-2. The written objection must address one or more of the following factors: f-2-a. The appropriateness of the location and site for which the license is sought and whether the event for which the license is sought will create undesirable neighborhood problems. f-2-b. The hours during which the event would be operated on the site and the likely effect of the event on the surrounding area. f-2-c. Whether previous licenses granted to the same applicant or to other applicants for the same site have resulted in neighborhood problems including, but not limited to, complaints of loud music, noise, litter, disorderly assemblages, loitering or public urination. f-2-d. Whether the applicant has been charged or convicted of any felony, misdemeanor, municipal offense or other offense, the circumstances of which substantially relate to the

activity for which the license is sought. f-2-e. Any other factors which reasonably relate to the public health, safety and welfare.

90-2. State Law Applicable. In addition to the requirements imposed by ch. 125, Wis. Stats., incorporated by reference herein, the following regulations shall apply to all licenses granted or issued under this chapter.

90-3. License Required. 1. BASIC REQUIREMENT. It shall be unlawful for any person to sell, barter or offer for sale or barter in the city any intoxicating liquors or fermented malt beverages without having obtained a license as provided for in this chapter, or to be in violation of the terms of such license.

REDACTED RECORD

State Law

125.04(3)(j). *Penalty for materially false application information.* Any person who knowingly provides materially false information in an application for a license or permit under this chapter may be required to forfeit not more than \$1,000.

(5) Qualifications for licenses and permits.

(b) *Criminal offenders.* No license or permit related to alcohol beverages may, subject to ss. 111.321, 111.322 and 111.335, be issued under this chapter to any person who has habitually been a law offender or has been convicted of a felony unless the person has been duly pardoned.

(13) Penalties. Any person who violates sub. (1) may be fined not more than \$10,000 or imprisoned for not more than 9 months or both.

History: 1981 c. 79, 235, 391; 1983 a. 27, 72, 74, 493, 494, 516; 1985 a. 302; 1987 a. 35, 301, 399; 1989 a. 31, 253; 1991 a. 39; 1993 a. 112, 259, 491; 1995 a. 23; 1995 a. 27 ss. 4117b, 4117c, 9154 (1); 1995 a. 225; 1997 a. 27; 2003 a. 250; 2007 a. 20, 85; 2011 a. 32; 2017 a. 59; 2017 a. 207 s. 5; 2017 a. 289.

Sub. (3) (h) [formerly s. 176.14] requires a licensee to update an application during the license year to facilitate scrutiny of the ongoing operation. The licensing authority has discretion to approve or disapprove any reported expansion of a licensed premises. *Alberti v. City of Whitewater*, 109 Wis. 2d 592, 327 N.W.2d 150 (Ct. App. 1982).

Licensees who are natural persons are liable for criminal acts of employees. *State v. Beaudry*, 119 Wis. 2d 96, 349 N.W.2d 106 (Ct. App. 1984). But see s. 125.115.

The registered agent of a corporate alcohol beverage licensee is subject to vicarious criminal liability for an employee's violation of the closing hour law. *State v. Beaudry*, 123 Wis. 2d 40, 365 N.W.2d 593 (1985).

A person may be a "habitual law offender" under sub. (5) (b) without having been convicted of any crime. *Smith v. Oak Creek*, 139 Wis. 2d 788, 407 N.W.2d 901 (1987).

Sub. (1) requires that the actual owner of an establishment selling intoxicating liquor possess the license in his or her own name. *State v. Eastman*, 148 Wis. 2d 254, 435 N.W.2d 278 (Ct. App. 1988).

A license never should have been issued when a notice of application had not been published as required under s. 125.04 (3) (g), and a license issued without publication is void under s. 125.04 (2). Selling liquor under a void license constitutes a violation of s. 125.66 (1). Under s. 125.12, a renewal licensee, if refused, is guaranteed a right to be heard by the municipality, and the municipality must show cause for refusal, but a new licensee, if refused, has no such guarantee. When an original license is void, the applicant is a new licensee. *Williams v. City of Lake Geneva*, 2002 WI App 95, 253 Wis. 2d 618, 643 N.W.2d 864, 01-1733.

Proprietors of a bed and breakfast may solicit voluntary contributions from guests at a social event held on the premises to defray the cost of alcohol, but proprietors who do not hold a license may not serve alcohol at a social event only to those who pay an admission fee. 80 Atty. Gen. 218.

Error! Filename not specified.

I thank you for your time and discretion and hope that the City Of Milwaukee performs it's duties and enforces city and state laws to protect our way of life in the City Of Milwaukee.

Sincerely,

P.S.

I have also attached the file of this letter to this email for download.

REDACTED RECORD

September 4th 2018

Renewal Alcohol Beverage License Application

(Fraudulent Public Notice ccl-not49/12)

7964 W. Appleton Ave.

(Formerly "RHINOS" Class B Tavern)

REDACTED RECORD

Dear Mr. Owczarski,

I am writing you with grave concerns of a known nuisance bar that was located at 7964 W. Appleton Ave; "RHINOS" formerly a class B tavern. This bar's license was revoked Tuesday May 15th 2018 with a 5-0 vote (171878) of the common council licensing committee and was even appealed by Karen Miller and a vote of those common council members present to approve the recommendations of the licenses committee as contained in file 171878 was approved with a 14-0 on Wednesday May 30th for non-renewal.

The current building owner Karen Miller has posted a Notice Of Public Interest on the door of the building located at 7964 W. Appleton Ave. and to a reasonable person there has been information of the notice purposely redacted for objection submissions and dates to submit objections. This is fraudulent behavior that goes hand in hand with previous behavior at this establishment and if this building located at 7964 W. Appleton Ave. is allowed to operate any type of Tavern or related business; beyond reasonable doubt there will be a hit to the quality of life for the neighborhood.

Below are state statutes and local city ordinances, along with photos that will that will strengthen the argument of why there should not be any type of Tavern or related business that will affect quality of life on a detrimental level.

Local Ordinances

Liquor and Tavern Regulations 90-4-7.9

f. Objections. f-1. The city clerk shall issue the license unless a written objection regarding the licensee or the location has been filed with the city clerk. The objection may be filed by any interested person. If a written objection is filed, the application shall be forwarded to the licensing committee for its recommendation to the common council. f-2. The written objection must address one or more of the following factors: f-2-a. The appropriateness of the location and site for which the license is sought and whether the event for which the license is sought will create undesirable neighborhood problems. f-2-b. The hours during which the event would be operated on the site and the likely effect of the event on the surrounding area. f-2-c. Whether previous licenses granted to the same applicant or to other applicants for the same site have resulted in neighborhood problems including, but not limited to, complaints of

loud music, noise, litter, disorderly assemblages, loitering or public urination. f-2-d. Whether the applicant has been charged or convicted of any felony, misdemeanor, municipal offense or other offense, the circumstances of which substantially relate to the activity for which the license is sought. f-2-e. Any other factors which reasonably relate to the public health, safety and welfare.

90-2. State Law Applicable. In addition to the requirements imposed by ch. 125, Wis. Stats., incorporated by reference herein, the following regulations shall apply to all licenses granted or issued under this chapter.

90-3. License Required. 1. BASIC REQUIREMENT. It shall be unlawful for any person to sell, barter or offer for sale or barter in the city any intoxicating liquors or fermented malt beverages without having obtained a license as provided for in this chapter, or to be in violation of the terms of such license.

State Law

125.04(3)(j). *Penalty for materially false application information.* Any person who knowingly provides materially false information in an application for a license or permit under this chapter may be required to forfeit not more than \$1,000.

(5) QUALIFICATIONS FOR LICENSES AND PERMITS.

(b) Criminal offenders. No license or permit related to alcohol beverages may, subject to ss. 111.321, 111.322 and 111.335, be issued under this chapter to any person who has habitually been a law offender or has been convicted of a felony unless the person has been duly pardoned.

(13) PENALTIES. Any person who violates sub. (1) may be fined not more than \$10,000 or imprisoned for not more than 9 months or both.

History: 1981 c. 79, 235, 391; 1983 a. 27, 72, 74, 493, 494, 516; 1985 a. 302; 1987 a. 35, 301, 399; 1989 a. 31, 253; 1991 a. 39; 1993 a. 112, 259, 491; 1995 a. 23; 1995 a. 27 ss. 4117b, 4117c, 9154 (1); 1995 a. 225; 1997 a. 27; 2003 a. 250; 2007 a. 20, 85; 2011 a. 32; 2017 a. 59; 2017 a. 207 s. 5; 2017 a. 289.

Sub. (3) (h) [formerly s. 176.14] requires a licensee to update an application during the license year to facilitate scrutiny of the ongoing operation. The licensing authority has discretion to approve or disapprove any reported expansion of a licensed premises. *Alberti v. City of Whitewater*, 109 Wis. 2d 592, 327 N.W.2d 150 (Ct. App. 1982).

Licensees who are natural persons are liable for criminal acts of employees. *State v. Beaudry*, 119 Wis. 2d 96, 349 N.W.2d 106 (Ct. App. 1984). But see s. 125.115.

The registered agent of a corporate alcohol beverage licensee is subject to vicarious criminal liability for an employee's violation of the closing hour law. *State v. Beaudry*, 123 Wis. 2d 40, 365 N.W.2d 593 (1985).

A person may be a "habitual law offender" under sub. (5) (b) without having been convicted of any crime. *Smith v. Oak Creek*, 139 Wis. 2d 788, 407 N.W.2d 901 (1987).

Sub. (1) requires that the actual owner of an establishment selling intoxicating liquor possess the license in his or her own name. *State v. Eastman*, 148 Wis. 2d 254, 435 N.W.2d 278 (Ct. App. 1988).

A license never should have been issued when a notice of application had not been published as required under s. 125.04 (3) (g), and a license issued without publication is void under s. 125.04 (2). Selling liquor under a void license constitutes a violation of s. 125.66 (1). Under s. 125.12, a renewal licensee, if refused, is guaranteed a right to be heard by the municipality, and the municipality must show cause for refusal, but a new licensee, if refused, has no such guarantee. When an original license is void, the applicant is a new licensee. *Williams v. City of Lake Geneva*, 2002 WI App 95, 253 Wis. 2d 618, 643 N.W.2d 864, 01-1733.

Proprietors of a bed and breakfast may solicit voluntary contributions from guests at a social event held on the premises to defray the cost of alcohol, but proprietors who do not hold a license may not serve alcohol at a social event only to those who pay an admission fee. 80 Atty. Gen. 218.

ID REQUIRED

cc-104 9/13



NOTICE OF PUBLIC INTEREST

Renewal Alcohol Beverage License Application Filed

Pursuant to s. 90-11-1-b, Milwaukee Code of Ordinances, notice is hereby given that the following alcohol beverage retail establishment license renewal application has been filed with the Office of the City Clerk-License Division:

License Type:	Class "B" Tavern
Legal Entity:	Kelly Westerhausen, dba Kelly's
Business Name:	Kelly's
Premise Address:	7964 W. Appleton Avenue Milwaukee, 53218

HOW TO SUBMIT OBJECTIONS

Written objections to the renewal of the license or in support of suspension of the license based on the operation of the licensed premises can be submitted by any interested party to the Office of the City Clerk-License Division, City Hall, Room 105, 200 East Wells Street, Milwaukee, WI, 53202, or via email to

Email Address should be Present

WHEN TO SUBMIT OBJECTIONS

Written objections to the renewal of the license or in support of suspension of the license must be received 45 days before the expiration of the current license.

The current license expires on:

New

This should be a date

WHAT TO SUBMIT IN OBJECTIONS

Written objections must include the following information:

1. Name of the person objecting,
2. Mailing or email address of the person objecting,
3. Information known to the objector that may form a basis for nonrenewal or suspension of the license. Such information should relate to the manner in which the operation of the license premises during the current license period has had an adverse impact on the health, safety and welfare of the public and the neighborhood.

Notice to Applicants: Upon filing of the application, this notice shall be posted in a conspicuous place viewable to members of the public from the outside of the licensed premises, and shall remain posted until 45 days before the expiration of the current license. See "Forms" at

Again no email present

REDACTED RECORD

TWO DRINK MINIMUM

REDACTED RECORD

I thank you for your time and discretion and hope that the City Of Milwaukee performs it's duties and enforces city and state laws to protect our way of life in the City Of Milwaukee.

Sincerely,

[REDACTED]
[REDACTED]
[REDACTED]

August 13, 2018

CITY OF MILWAUKEE
LICENSE DIVISION

2018 SEP 17 P 3:05

City Clerk-License Div.
City Hall – Room 105
200 East Wells Street
Milwaukee, WI 53202

RE: Class B Tavern license – Kelly Westerhausen
Kelly'z, 7964 W. Appleton Ave, Milwaukee

The tavern has a long history of illegal activity, drugs,
violence and gunfire under several owner/operators.

The applicant has direct ties to the previous operator
and will attract the same customers that caused all of
the trouble over the past decade.

Please deny the issuance of this new liquor license.

Respectfully submitted,

REDACTED RECORD

Cooney, Jim

From:
Sent: Friday, September 14, 2018 1:45 PM
To: License
Cc: Reiss, Tess
Subject: Objection to license application to Kelly's Located 7964 W. Appleton Ave.
Attachments: kellyz 7964 w appleton ave license application data.docx

September 14th 2018

Opposition/Impact statement
Alcohol Beverage Retail License Application
Proposed Business: Kelly'z
7964 W. Appleton Ave.

Dear Jim Owczarski,

I am writing you today in opposition of Kelly J. Westerhausen's application for an alcohol beverage retail license. Recently the community made a collective effort to object to the renewal application of Karen Miller for her business Rhino's that was located at 7964 W. Appleton on the basis of nuisance, narcotics trafficking, human trafficking, shooting, etc. We as a neighborhood were successful in our objection and the quality of life here has increased exponentially. I was notified via the license division of the city of Milwaukee that Kelly J. Westerhausen would like to open a class B Tavern in the same location (7964 W. Appleton Ave.). The building is still owned by Karen Miller. I anticipate the same issues if this proposed establishment were to be granted a license for a Class B Tavern. Kelly J. Westerhausen has had 3 misdemeanors in the recent years for Battery, Disorderly Conduct, and Criminal Damage. There is a childcare service literally 20 feet from the entrance of this building and a church less than 300 feet from the main entrance of the proposed Class B Tavern. It is in my opinion that if a license were to be granted that the City of Milwaukee would be jeopardizing the safety, well-being, and the quality of life for the residents of this community.

Below are City of Milwaukee that pertain or will pertain to the said subject above:

Liquor and Tavern Regulations 90-5-1-c

c-2-h. Whether or not, pursuant to s. 90- 14, the premises is less than 300 feet from any church, school or hospital.

c-3. Right to Occupy. An applicant for an alcohol beverage retail establishment license shall file a copy of the document that establishes the right of the applicant to occupy the premises for which a license is sought. c-3-a. Documents establishing a right to occupy include deeds, leases, accepted offers to purchase and similar documents including agreements that are contingent upon issuance of the requested license.

1.5. POLICE REVIEW OF FLOOR PLAN, PLAN OF OPERATION AND CRIME PREVENTION THROUGH ENVIRONMENTAL DESIGN SURVEY. Following submission of the floor plan and plan of operation required by s. 90-5-1-c, but prior to the scheduling of a licensing committee hearing under s. 90-5-8-a-2, the applicant for a new Class "A," Class "B" or "Class C" retail license shall meet in person with a police department community liaison officer or other designee of the chief of police to review the floor plan and plan of operation and to conduct a crime prevention through environmental design (CPTED) survey.

2. TRUTH OF STATEMENTS AND AFFIDAVITS; PENALTY. a. All matters submitted in writing to the city by any applicant or licensee pertaining to an intoxicating liquor or fermented malt beverage license shall be true. Any person who submits in writing any untrue statement or affidavit to the city in connection with any such license or application shall be fined not to exceed \$500 or in default of payment thereof shall be imprisoned in the county jail or house of correction of Milwaukee county for not more than 90 days; and that license, if granted, shall be subject to revocation and no intoxicating liquor or fermented malt beverage license of any kind or nature whatsoever shall thereafter be granted to such a person for a period of one year from the date of such revocation.

3. TIME OF FILING; LEGAL NOTICE AND FEE. a. Filing Time. Application shall be filed for all liquor and beer licenses at least 30 days prior to the date of granting by the common council. When an application has been on file at least 14 days prior to the date of granting, and the police investigation has been completed with no police objection, and there are no other objections to the granting of the license, the common council may grant such licenses prior to the passage of the full 30 days.

6. FINGERPRINTING. All applicants for a "Class A" retailer's intoxicating liquor license, a "Class B" tavern license, a Class "B" manager's license, a Class "A" fermented malt beverage retailer's license, a "Class C" wine retailer license, a Class "D" operator's license or a Class "D" provisional operator's license shall be fingerprinted as provided in s. 85-21-1. 7. INVESTIGATION. a. All applications shall be referred to the chief of police, the commissioner of neighborhood services and the commissioner of health, all of whom shall cause an investigation to be made and report their findings to the licensing committee of the common council. For an application for a "Class A" or "Class B" license for the sale of intoxicating liquor, the report of the commissioner of neighborhood services shall include a statement as to whether the main entrance of the premises is less than 300 feet from the main entrance of any church, school, day care center or hospital.

a-2-c. Certification shall not be made within 10 days following written and signed and sworn assurance to the city clerk by the applicant that notice of the application, on a form prescribed by the city clerk and approved by the licensing committee, has been conspicuously posted on the outside of the premises at applicant's expense providing notice to members of the public that an application has been made and that objections to the application may be filed with the city clerk, and that a survey form may be submitted electronically, through the city Internet site, by phone or in writing. The written and signed assurance shall include a statement of applicant's intent to maintain the posting, or replace any missing posting, until the date scheduled for hearing by the licensing committee.

Sincerely,

REDACTED RECORD

Email: _____

P.S.

I have an attached Word Document format of this letter.

REDACTED RECORD

Known Addresses

Address

8036 West Green Tree Road, Milwaukee, WI 53223

Address

6764 N 76th St, Milwaukee, WI 53223

Kelly Jo Westerhausen DOB 01/01/1978

Driver's License

REDACTED RECORD

W236-5107-8506-06

Also known as

Name	Type
Peters, Kelly Jo	Also known as

Liquor and Tavern Regulations 90-5-1-c

c-2-h. Whether or not, pursuant to s. 90- 14, the premises is less than 300 feet from any church, school or hospital.

c-3. Right to Occupy. An applicant for an alcohol beverage retail establishment license shall file a copy of the document that establishes the right of the applicant to occupy the premises for which a license is sought. c-3-a. Documents establishing a right to occupy include deeds, leases, accepted offers to purchase and similar documents including agreements that are contingent upon issuance of the requested license.

Liquor and Tavern Regulations 90-5-1.5

1.5. POLICE REVIEW OF FLOOR PLAN, PLAN OF OPERATION AND CRIME PREVENTION THROUGH ENVIRONMENTAL DESIGN SURVEY. Following submission of the floor plan and plan of operation required by s. 90-5-1-c, but prior to the scheduling of a licensing committee hearing under s. 90-5-8-a-2, the applicant for a new Class "A," Class "B" or "Class C" retail license shall meet in person with a police department community liaison officer or other designee of the chief of police to review the floor plan and plan of operation and to conduct a crime prevention through environmental design (CPTED) survey.

2. TRUTH OF STATEMENTS AND AFFIDAVITS; PENALTY. a. All matters submitted in writing to the city by any applicant or licensee pertaining to an intoxicating liquor or fermented malt beverage license shall be true. Any person who submits in writing any untrue statement or affidavit to the city in connection with

any such license or application shall be fined not to exceed \$500 or in default of payment thereof shall be imprisoned in the county jail or house of correction of Milwaukee county for not more than 90 days; and that license, if granted, shall be subject to revocation and no intoxicating liquor or fermented malt beverage license of any kind or nature whatsoever shall thereafter be granted to such a person for a period of one year from the date of such revocation.

3. TIME OF FILING; LEGAL NOTICE AND FEE. a. Filing Time. Application shall be filed for all liquor and beer licenses at least 30 days prior to the date of granting by the common council. When an application has been on file at least 14 days prior to the date of granting, and the police investigation has been completed with no police objection, and there are no other objections to the granting of the license, the common council may grant such licenses prior to the passage of the full 30 days.

6. FINGERPRINTING. All applicants for a "Class A" retailer's intoxicating liquor license, a "Class B" tavern license, a Class "B" manager's license, a Class "A" fermented malt beverage retailer's license, a "Class C" wine retailer license, a Class "D" operator's license or a Class "D" provisional operator's license shall be fingerprinted as provided in s. 85-21-1. 7. INVESTIGATION. a. All applications shall be referred to the chief of police, the commissioner of neighborhood services and the commissioner of health, all of whom shall cause an investigation to be made and report their findings to the licensing committee of the common council. For an application for a "Class A" or "Class B" license for the sale of intoxicating liquor, the report of the commissioner of neighborhood services shall include a statement as to whether the main entrance of the premises is less than 300 feet from the main entrance of any church, school, day care center or hospital.

a-2-c. Certification shall not be made within 10 days following written and signed and sworn assurance to the city clerk by the applicant that notice of the application, on a form prescribed by the city clerk and approved by the licensing committee, has been conspicuously posted on the outside of the premises at applicant's expense providing notice to members of the public that an application has been made and that objections to the application may be filed with the city clerk, and that a survey form may be submitted electronically, through the city Internet site, by phone or in writing. The written and signed assurance shall include a statement of applicant's intent to maintain the posting, or replace any missing posting, until the date scheduled for hearing by the licensing committee.

REDACTED RECORD

Case : 101002468647

Client Info:

Name: y

Address:

Phone Number:

Email

Confidential?: N

Issue: City Clerk License Object/Support Web | Date Submitted: 09/14/2018

Status: open | Date Completed:

Address: 7964 W APPLETON AV | Due Date: 10/14/2018

Reason for request:

Object to License| I believe this will increase crime and have a negative impact on the surrounding residential neighborhood.

Case notes:

1. entered address: 7964 W APPLETON AV

Staff comments:

Agent Created Case

[Click here to view map and/or images](#)

REDACTED RECORD

Cooney, Jim

From: _____
Sent: Saturday, September 15, 2018 1:04 PM
To: License
Subject: Tavern license Kelly'z 7964 W. Appleton Av

To whom it may concern;

My name is _____ I am writing to state my objections to the license being issued to the establishment at 7964 w Appleton ave.

First of all the name on the signs all say, and have said for years RINO'S. I was surprised to learn it was called KELLY'Z.

During the day the bar is relatively quite, although in the summer the motorcycles are parked on the sidewalk.

In the evening it's a different story, there are loud arguments, gun shots, and blaring music from cars.

I am extremely concerned for me, and my family's well being. All it takes is one stray bullet to hurt or even kill someone!

These are my objections to this establishment being opened. Even writing this I feel concerned for our safety.

Sincerely,

REDACTED RECORD

MILWAUKEE POLICE DEPARTMENT LICENSING

CRIMINAL RECORD/ORDINANCE VIOLATION/INCIDENTS SYNOPSIS

DATE: 09/12/18

LICENSE TYPE: Class B Tavern

NEW:

RENEWAL:

No. 280753

Application Date: 09/10/18

License Location: 7964 W. Appleton Avenue

Business Name: Kelly'z

Licensee/Applicant: WESTERHAUSEN, Kelly J
(Last Name, First Name, MI)

Date of Birth: 01/06/1978

Home Address: 7022 W. North Avenue

City: Wauwatosa

State: WI **Zip Code:** 53213

Home Phone: 414-460-9205

This report is written by Police Officer Corstan D. COURT, assigned to the License Investigation Unit, Days.

The Milwaukee Police Department's investigation regarding this application revealed the following:

1. On 06/22/11 the applicant was charged in Milwaukee County with Criminal Damage to Property (Felony).

Charge: Criminal Damage to Property (amended to Misdemeanor)
 Finding: Guilty
 Sentence: 6 days House of Correction
 Date: 04/25/12
 Case: 2011CF002619

2. On 05/13/14 the applicant was charged in Milwaukee County with Substantial Battery (Felony) and Disorderly Conduct (Misdemeanor).

Charge 1: Battery
 2: Disorderly Conduct
 Finding: Guilty
 Sentence: 18 months Probation
 Date: 03/24/15
 Case: 2014CF001996

Date:09/23/2018
Officer: Bowie Buchner

City of Milwaukee Police Department
90-5-1.5 Crime Prevention Survey
Tavern Inspection

Name of Premise: Kelly'z
Address: 7964 W Appleton Av
Phone: None at time of inspection

Owner: Karen Miller
Owner address: 10400 W Grantosa Dr
City State Zip: Milwaukee, WI 53222
Owner Phone: 414-331-7284
Owner email: karenamiller@gmail.com

Licensee/Agent: Kelly Westerhausen
Home Address: 7022 W North Av
City State Zip: Wauwatosa, WI 53213
Phone: 414-460-9205
Email: kelleywesterhausen@gmail.com

Preferred contact: Kelly Westerhausen

Location currently open: YES NO

Projected open date: As soon as licenses are approved

Day's open: S M T W Th F SA ALL

Hours of Operation: Sun: 11:00am – 2:00am 24 hours Y N
Mon: 11:00am – 2:00am
Tue: 11:00am – 2:00am
Wed: 11:00am – 2:00am
Thu: 11:00am – 2:00am
Fri: 11:00am – 2:00am
Sat: 11:00am – 2:00am

Premise Type: Tavern/Bar
Restaurant
Other:

Licenses currently held:

Alcohol: Yes No Class: B #: BTAVN 280753
 Tobacco: Yes No #:
 Food: Yes No #: FREST280755
 Extended Hours: Yes No #:
 Secondhand Dealer: Yes No Type: #:
 Other: Yes No Type: Class D Operator's License #: BART 224060
 Other: Yes No Type: Public Entertainment Premises #: PEP 280757

Exterior Survey:

1. Is the area around the location clean? Yes No
2. What surrounds the location? (Check all the apply)
 - a. Park
 - b. School
 - c. Youth Center
 - d. Church
 - e. Tavern(s) If so, how many
 - f. Residential
 - g. Other businesses
 - h. Other:
3. Can you see from the outside of the location into the interior Yes No
4. Can you see the employees inside of the location from the outside Yes No
5. Are exterior windows free of signage Yes No
6. Is there a parking lot Yes No
7. Is the parking lot clean? Yes No
8. Off-Street parking Yes No
9. Is the parking lot well lit? Yes No
10. Valet Parking Yes No
 - a. Will this lot have a guard? Yes No
 - b. Will this lot have cameras? Yes No
11. Are there areas where a person could conceal themselves Yes No
12. Is there exterior lighting? Yes No. Does it appears to be adequate Yes No
13. Exterior Payphone? Yes No
14. Are there No Loitering Signs posted? Yes No
15. Are there exterior security cameras Yes No How Many: 4
16. Are the address numbers prominently displayed and easy to see Yes No

Camera Survey:

17. Does this location have security cameras? Yes No
18. Are they in working order? Yes No
19. What format are the cameras?
 - a. Color Yes No
 - b. Digital Yes No
 - c. Recorded Yes No
20. How long is footage stored for later viewing: 30 days
21. Are there exterior cameras Yes No How many: 4
22. Are there interior cameras Yes No How many: 10
23. Do all employees know how to retrieve recorded digital images/footage? Yes No

24. Cameras located in parking lot Yes No How many 4

Interior Survey:

25. What is the planned capacity 50
26. What is the minimum number of employees That will be on premise 2
27. Is the storeowner willing to be a standing complainant regarding loitering? Yes No
- a. If yes have them fill out the standing complaint form and give them two of the commercial signs Yes No
28. Is the interior of the location neat and clean? Yes No
29. Does an interior camera face the entrance/exit? Yes No
30. Is there a lockable area that separates employees from customers? Yes No
31. Are emergency and non-emergency numbers posted near the phone? Yes No
32. Does the owner know how to contact their police district directly? Yes No
- a. Did you provide a district contact guide to the owner? Yes No

Security

33. How many security personnel are going to be employed: 1 or 2 at a time
34. How ill they be deployed: Interior 1 Exterior 1
35. What days will they be deployed Mon Tue Wed Thu Fri Sat Sun
36. Will the security be managed by business or contracted
37. Will they be armed Yes No
38. What type of security measures to be used:
- Wanding/metal detector
 - ID Scanner
 - Dress Code
 - Cover Charge
 - Age restriction 25 and up
 - Other

ADDITIONAL COMMENTS/RECOMMENDATIONS:

Windows were boarded up at time of inspection. When business is open the boards will be removed and you will be able to see from the outside of the location into the interior. Both the owner of the building and the licensee were on scene for this inspection.

MILWAUKEE POLICE DEPARTMENT
LICENSE INVESTIGATION UNIT

CRIMINAL RECORD/ORDINANCE VIOLATION/INCIDENTS
SYNOPSIS

DATE: 04/16/2018
LICENSE TYPE: BTAVN
NEW:
RENEWAL: X

No. 272620
Application Date: 04/12/2018
Expiration Date:

License Location: 7964 W Appleton Av
Business Name: Rhino's

Aldermanic District: 05

Licensee/Applicant: MILLER, Karen A
(Last Name, First Name, MI)
Date of Birth: 01/20/1957

Male: Female: x

Home Address: 10400 W Grantosa Drive
City: Milwaukee
Home Phone: (414) 462-5222

State: WI Zip Code: 53222

This report is written by Police Officer David NOVAK, assigned to the License Investigation Unit, Days.

The Milwaukee Police Department's investigation regarding this application revealed the following:

1. On 8-22-04, at Rhino's, 7964 W Appleton Avenue, a police officer conducted a premises check. During his investigation, it was discovered that no placard from City of Milwaukee indicating maximum capacity of the premises was displayed.

Charge: Posting of Occupancy Capacity
Finding: guilty
Sentence: fined \$100.00
Date: 11-9-04
Case: 04109661
Citation: 58701893

Note: Applicant was warned regarding filing the Auxiliary Questionnaire with inaccurate information, and instructed to file an amended application.

2. On 1-30-05, at 12:17AM, officers were dispatched to Rhino's Bar, 7964 W Appleton Avenue. On arrival they spoke to Daniel McGarry, who's band, "Master Jacks". was hired by the bar to entertain the customers. He told officers he stepped outside for a cigarette and some fresh air, when he was the victim of an armed robbery, and was shot in the right leg during the incident. Report filed.

=====

3. On 03/21/07 at 12:29 am, Milwaukee police were dispatched to 7964 W Appleton Avenue for a Fight complaint. Investigation revealed two patrons were involved in a fight inside the bar with tables being turned over. Police were called with both actors leaving the tavern. No damage was found and when police arrived, spoke to the bartender identified as Kevin Kasier, who advised both patrons had left.

4. On 09/18/07 at 1:12 am, applicant was issued two citations for Class B Premises- Open Door After Hours and Class B Licensee's Responsibility at 7964 W Appleton Avenue.

Charge: Class B Premises- Open Door After Hours
Class B Licensee's Responsibility
Finding: Guilty
Dismissed w/o prejudice
Sentence: Fined \$200.00
Date: 12/12/07
Case: 07111077

5. On 11/28/07 at 8:21 pm, Milwaukee police were dispatched to 7964 W Appleton for an Armed Robbery complaint. Officers spoke to the licensee, Karen Miller, who stated unknown actors entered Rhinos bar, displayed a shotgun and demanded money and valuables from owner and patrons. Actors rifled thru victims pockets and cash register obtaining money and valuables without victims consent. Both actors then fled the bar. No injuries were reported. Reports were filed.

6. On 03/23/08 at 9:08 pm, Milwaukee police were dispatched to 7964 W Appleton for an Armed Robbery complaint. Officers spoke to the victim who stated she parked her car in the lot of Rhinos tavern when she was approached by 3 males who stated, "gimmie your or I'm going to blast you...". The victim stated she jumped back into her car and drove away with nothing being taken from her. No injuries were reported.

=====
7. On 06/04/08 at 2:00 am, Milwaukee police were dispatched to 7964 W Appleton Avenue for an Armed Robbery complaint. Officers spoke to the victim who stated he left the Rhino's tavern and was walking to the parking lot when he was approached by two males who were armed with guns. The suspects demanded and obtained his property and fled the scene. Police spoke to the bartender Adam McCullough who stated he was in the bar and did not witness the robbery. McCullough further stated there were no cameras on the outside of the building. No injuries were reported.

=====
8. On 08/30/09 at 12:56 am, Milwaukee police were dispatched to 7964 W Appleton for an Armed Robbery complaint. Investigation revealed two patrons of Rhino's Tavern were robbed outside the business with no injuries being reported. An offense report was filed.

=====
9. On 10/13/2016 at 12:26am officers were dispatched to Rhinos Tavern, 7964 W. Appleton Av for a shooting. The victim was located inside with a gunshot to his stomach. The investigation revealed the suspect was the tavern's security guard, who was not on scene when the officer arrived. The applicant did not know the security guards name because she paid him cash. Milwaukee Police Department IR# 16-287-0008 filed.
=====

10. On 06/18/2017 at 2:18am officers were dispatched to 7964 W. Appleton Av to investigate a shooting. The investigation revealed that a patron was walking to his car and was shot in the leg in the parking lot. The manager was cooperative and allowed officers to view the surveillance video. No violations were observed inside the tavern.
11. On 09/17/2017 at 2:19am officers were dispatched to Rhino's bar, 7964 W. Appleton Av, for a Trouble with Subject call. The caller stated he was trying to close the bar but subjects were refusing to leave. When the officers arrived they observed two female subjects fighting in the parking lot. One of the officer deployed O.C. spray to stop the fight. Both subjects were arrested.
12. On 12/02/2017 at 3:43am officers were dispatched to Rhino's tavern, 7964 W. Appleton Av, to a report the bar was open after hours. When the officers arrived they observed three employees leaving with the last subject out locking the door. One of the subjects assured the officer they were not open after hours.
13. On 02/03/2018 an officer was monitoring Rhino's, 7964 W. Appleton Av, regarding complaints of cocaine distribution. The officer observed a subject exit the bar and enter an auto. A hand to hand transaction was observed and a traffic stop was performed. A search of the occupants revealed cocaine and the subjects were arrested.
14. On 03/15/2018 at 2:13am officers were dispatched to Rhino's, 7964 W. Appleton Av, to investigate a shooting. Upon arrival the officer observed the victim lying in the parking lot. The officer interviewed two employees who stated they were inside getting the patrons out when they heard shots fired outside. They did not observe the incident. The employees were cooperative with the investigation.
15. On 03/29/2018 a meeting was held at District 7 regarding Rhino's. The applicant stated her son works the night shift and she would start coming in during the evening hours. She stated she has been getting new patrons due to other taverns closing in the area and she has started using her ID scanner again. She stated the shootings have been happening in the parking lot and not inside her tavern. She was advised that in an incident occurs on her property she is responsible. She was advised she would receive a nuisance designation and she should create an action plan. She was also advised to not have employees cleaning up until all patrons have left the property and to have uniformed security monitor the inside and outside.
16. On 04/02/2018 an officer investigated a battery complaint which occurred at Rhino's, 7964 W. Appleton Av, on 03/26/2018 at 2am. The victim was reporting that he was beat by a bartender with a bat. The officer went to the tavern to find out the bartender's name. He spoke with the applicant, who came to the tavern in order for the officer to observe the video surveillance. The applicant stated the patron had actually beaten up her bartender with the bat. The officer watched the video which showed the patron and bartender having an argument. The patron then punching the bartender. The patron was then trying to get behind the bar and the bartender got the bat and attempted to hit the patron, missing him. The patron was able to get the bat from the bartender and began to punch, kick and hit the bartender with the bat. The officer asked why this incident was not reported by the bar and the applicant stated the bartender did not want to prosecute. This incident happened prior to a meeting on 03/29/2018 at District 7 regarding the tavern being named a nuisance property but this incident was not brought up at that time.

17. On 04/01/2018-04/03/2018 an officer was monitoring Rhino's, 7964 W. Appleton Av, regarding complaints of cocaine distribution. The officer sent in a confidential informant who was able to purchase a white powdery substance from a patron in the bathroom.

Previous Premise

Alcohol concentration for 7964 W Appleton Ave

City of Milwaukee, Wisconsin



- Legend -

- Street names 10,000
- City limits
- Freeways 15,000
- Freeways
- Exit ramps
- Entry ramps
- Ramps
- Major streets 10,000
- Streets 10,000
- Waterways
- Milwaukee Parcels
- Street names 10,000
- Alcohol licenses
- Class A intoxicating liquor
- Class A fermented malt beverage
- Class A liquor and malt
- Class B fermented malt beverage
- Class B tavern
- Class C wine retailer

- Notes -

Alcohol establishments within a .5 mile radius centered on 7964 W Appleton Ave on 9/10/2018



Department of Administration - ITMD

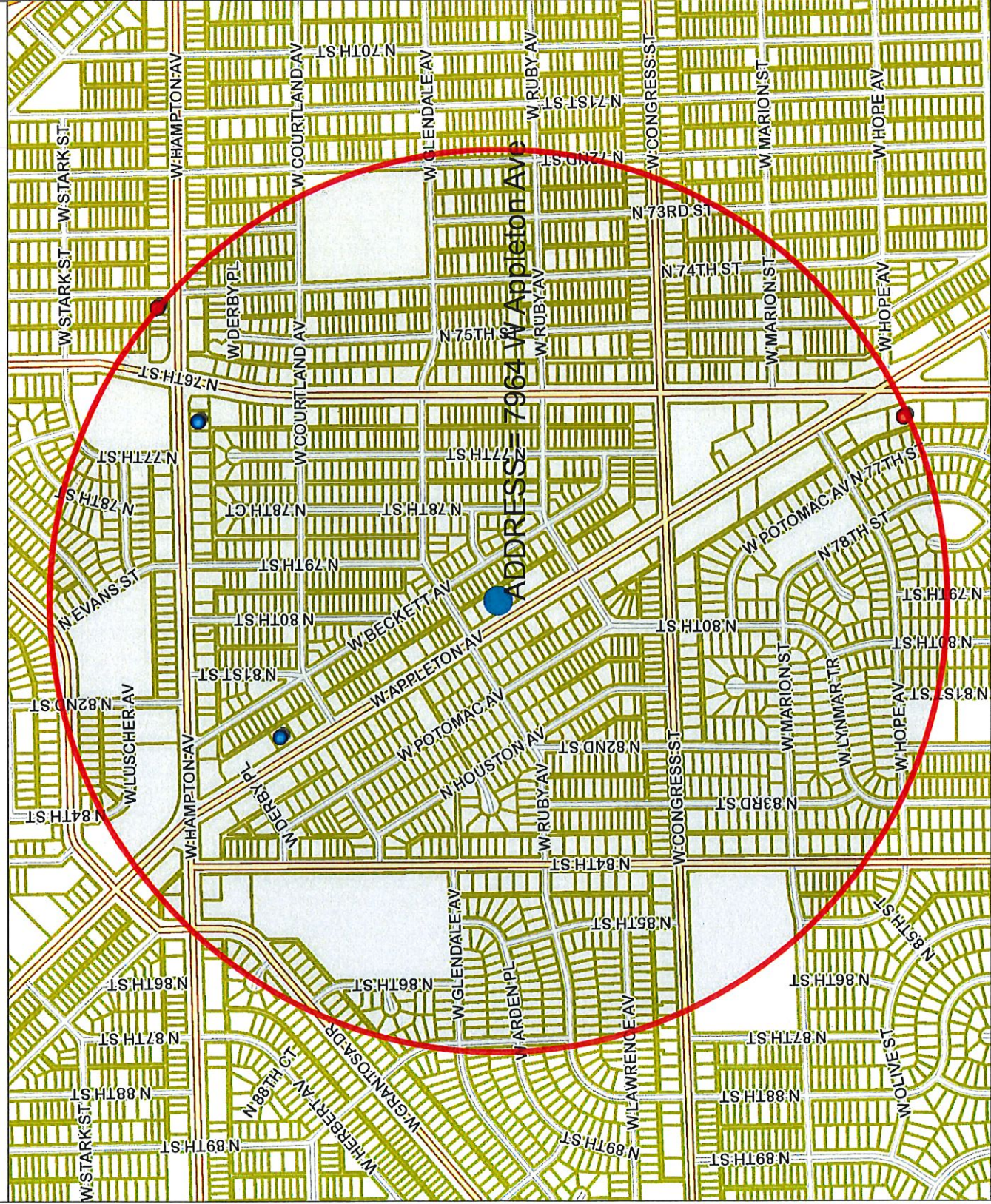

Map Scale: 1: 10,000

Alcohol establishments within a .5 mile radius centered on 7964 W Appleton Ave on 9/10/2018

License summary:

Class A Malt & Class A Liquor License

Class B Tavern License

Total:

1
2

Legal entity	Trade name	Licensee	License type name	Total capacity	Room capacity	Address	Expiration date
TOTO'S, INC	OTTO'S BEVERAGE CENTER	JOHN M SEEGER, Agt	Class A Malt & Class A Liquor License			4163 N 76TH ST	1/22/2019 18:00
BURRITO BUENO, INC	BURRITO BUENO	MARCO ARTEAGA, Agt	Class B Tavern License	90		8238 W APPLETON AV	7/4/2019 19:00
DIAMONDS, INC	DIAMONDS PUB & GRILL	HUMPHREY F NANGAH, Agt	Class B Tavern License	100		7607 W HAMPTON AV	2/10/2019 18:00
Grand Total: 3							



Friday, October 12, 2018

Licenses Committee Notice of Hearing

KAREN MILLER
10400 W GRANTOSA DR
MILWAUKEE, WI 53222

Date: 10/23/2018
Time: 09:15 AM
Location: Room 301-B, Third Floor, City Hall

The Licenses Committee will consider the following license application:

Class B Tavern, Food Dealer, and Public Entertainment Premises License
Applications with 25+ Age Restriction and Requesting Jukebox, Karaoke, 5
Amusement Machines, and 1 Pool Table
WESTERHAUSEN, Kelly J, Agent
Kelly'z at 7964 W APPLETON Av

Please note this application may be recommended for denial based on fitness of the location due to concentration of alcohol beverage outlets in the area. If the application is denied for this reason, no other application for an alcohol beverage license for this location shall be recommended for approval by the Licenses Committee within three years of the date of denial unless the applicant has demonstrated a change of circumstances since the prior denial.

If you have any questions, please call (414) 286-2238.





Friday, October 12, 2018

Licenses Committee Notice of Hearing

KAREN MILLER
7964 W Appleton Ave
MILWAUKEE, WI 53218

Date: 10/23/2018
Time: 09:15 AM
Location: Room 301-B, Third Floor, City Hall

The Licenses Committee will consider the following license application:

Class B Tavern, Food Dealer, and Public Entertainment Premises License
Applications with 25+ Age Restriction and Requesting Jukebox, Karaoke, 5
Amusement Machines, and 1 Pool Table
WESTERHAUSEN, Kelly J, Agent
Kelly'z at 7964 W APPLETON Av

Please note this application may be recommended for denial based on fitness of the location due to concentration of alcohol beverage outlets in the area. If the application is denied for this reason, no other application for an alcohol beverage license for this location shall be recommended for approval by the Licenses Committee within three years of the date of denial unless the applicant has demonstrated a change of circumstances since the prior denial.

If you have any questions, please call (414) 286-2238.





Friday, October 12, 2018



Notice of Public Hearing

WESTERHAUSEN, Kelly J, Agent
Kelly'z at 7964 W APPLETON Av

Class B Tavern, Food Dealer, and Public Entertainment Premises License Applications with 25+ Age Restriction and Requesting Jukebox, Karaoke, 5 Amusement Machines, and 1 Pool Table

Tuesday, October 23, 2018 at 9:15 AM

To whom it may concern:

The above application has been made by the above named applicant(s). This requires approval from the Licenses Committee and the Common Council of the City of Milwaukee. The hearing before the Licenses Committee will take place on 10/23/2018 at 9:15 AM, in Room 301-B, Third Floor, City Hall. If you wish, you may provide testimony at the hearing regarding the request; see below for further information. You are not required to attend the hearing. Once the Licenses Committee makes its recommendation, this recommendation is forwarded to the full Common Council for approval at its next regularly scheduled hearing. Please review the information below and if you have further questions regarding this process, please contact the License Division at (414) 286-2238.

Important details for those wishing to provide information for the Licenses Committee to consider when making its recommendation:

1. The license application is scheduled to be heard at the above time. Due to other hearings running longer than scheduled, you may have to wait some time to provide your testimony.
2. You must appear in person and testify as to matters that you have personally experienced or seen. (You cannot provide testimony for your neighbor, parent or anyone else; this is considered hearsay and cannot be considered by the committee.)
3. No letters or petitions can be accepted by the committee (unless the person who wrote the letter or the persons who signed the petition are present at the committee hearing and willing to testify).
4. Persons opposed to the license application are given the opportunity to testify first; supporters may testify after the opponents have finished.
5. When you are called to testify, you will be sworn in and asked to give your name, and address. (If your first and/or last names are uncommon please spell them.)
6. You may then provide testimony.
 - a. Include only information relating to the above license application.
 - b. Include only information you have personally witnessed or seen.
 - c. Provide concise and relevant information detailing how this business has affected or may affect the peaceful enjoyment of your neighborhood.
 - d. If by the time you have the opportunity to testify, the information you wish to share has already been provided to the committee, you may state that you agree with the previous testimony. Redundant or repetitive testimony will not assist the committee in making its recommendation.
7. After giving your testimony, the members of the Licenses Committee and the licensee may ask questions regarding the testimony you have given or other factors relating to the license application.
8. Business Competition is not a valid basis for denial or non-renewal of a license.
Please Note: If you have submitted an objection to the above application your objection cannot be considered by the committee unless you personally testify at the hearing.

OCCUPANT	MAIL ADDRESS	CITY, STATE ZIP
CURRENT OCCUPANT	7868 W BECKETT AVE	MILWAUKEE, WI 53218
CURRENT OCCUPANT	7903 W BECKETT AVE	MILWAUKEE, WI 53218
CURRENT OCCUPANT	7837 W BECKETT AVE	MILWAUKEE, WI 53218
CURRENT OCCUPANT	7881 W BECKETT AVE	MILWAUKEE, WI 53218
CURRENT OCCUPANT	7874 W BECKETT AVE	MILWAUKEE, WI 53218
CURRENT OCCUPANT	7989 W APPLETON AVE	MILWAUKEE, WI 53218
CURRENT OCCUPANT	7971 W APPLETON AVE	MILWAUKEE, WI 53218
CURRENT OCCUPANT	7927 W APPLETON AVE	MILWAUKEE, WI 53218
CURRENT OCCUPANT	7924 W APPLETON AVE 1	MILWAUKEE, WI 53218
CURRENT OCCUPANT	7924 W APPLETON AVE 3	MILWAUKEE, WI 53218
CURRENT OCCUPANT	7947 W APPLETON AVE 3	MILWAUKEE, WI 53218
CURRENT OCCUPANT	7853 W BECKETT AVE	MILWAUKEE, WI 53218
CURRENT OCCUPANT	7875 W BECKETT AVE	MILWAUKEE, WI 53218
CURRENT OCCUPANT	7887 W BECKETT AVE	MILWAUKEE, WI 53218
CURRENT OCCUPANT	7924 W APPLETON AVE 5	MILWAUKEE, WI 53218
CURRENT OCCUPANT	7924 W APPLETON AVE 4	MILWAUKEE, WI 53218
CURRENT OCCUPANT	7947 W APPLETON AVE 1	MILWAUKEE, WI 53218
CURRENT OCCUPANT	7948 W APPLETON AVE	MILWAUKEE, WI 53218
CURRENT OCCUPANT	7839 W BECKETT AVE	MILWAUKEE, WI 53218
CURRENT OCCUPANT	7849 W BECKETT AVE	MILWAUKEE, WI 53218
CURRENT OCCUPANT	7855 W BECKETT AVE	MILWAUKEE, WI 53218
CURRENT OCCUPANT	7862 W BECKETT AVE	MILWAUKEE, WI 53218
CURRENT OCCUPANT	7979 W APPLETON AVE	MILWAUKEE, WI 53218
CURRENT OCCUPANT	7961 W APPLETON AVE	MILWAUKEE, WI 53218
CURRENT OCCUPANT	7961A W APPLETON AVE	MILWAUKEE, WI 53218
CURRENT OCCUPANT	7859 W BECKETT AVE	MILWAUKEE, WI 53218
CURRENT OCCUPANT	7863 W BECKETT AVE	MILWAUKEE, WI 53218
CURRENT OCCUPANT	7865 W BECKETT AVE	MILWAUKEE, WI 53218
CURRENT OCCUPANT	7869 W BECKETT AVE	MILWAUKEE, WI 53218
CURRENT OCCUPANT	7832 W ARDEN PL	MILWAUKEE, WI 53218
CURRENT OCCUPANT	7886 W BECKETT AVE	MILWAUKEE, WI 53218
CURRENT OCCUPANT	7937A W APPLETON AVE	MILWAUKEE, WI 53218
CURRENT OCCUPANT	8070 W POTOMAC AVE	MILWAUKEE, WI 53218
CURRENT OCCUPANT	7963 W APPLETON AVE	MILWAUKEE, WI 53218
CURRENT OCCUPANT	7955A W APPLETON AVE	MILWAUKEE, WI 53218
CURRENT OCCUPANT	7955 W APPLETON AVE	MILWAUKEE, WI 53218
CURRENT OCCUPANT	7823 W BECKETT AVE	MILWAUKEE, WI 53218
CURRENT OCCUPANT	7861 W BECKETT AVE	MILWAUKEE, WI 53218
CURRENT OCCUPANT	7977 W APPLETON AVE	MILWAUKEE, WI 53218
CURRENT OCCUPANT	7924 W APPLETON AVE B	MILWAUKEE, WI 53218
CURRENT OCCUPANT	7924 W APPLETON AVE 2	MILWAUKEE, WI 53218
CURRENT OCCUPANT	7947 W APPLETON AVE 2	MILWAUKEE, WI 53218
CURRENT OCCUPANT	7873 W BECKETT AVE	MILWAUKEE, WI 53218
CURRENT OCCUPANT	7880 W BECKETT AVE	MILWAUKEE, WI 53218
CURRENT OCCUPANT	7937 W APPLETON AVE	MILWAUKEE, WI 53218
CURRENT OCCUPANT	7947 W APPLETON AVE 4	MILWAUKEE, WI 53218

CURRENT OCCUPANT	7825 W BECKETT AVE	MILWAUKEE, WI 53218
CURRENT OCCUPANT	7829 W BECKETT AVE A	MILWAUKEE, WI 53218
CURRENT OCCUPANT	7829 W BECKETT AVE	MILWAUKEE, WI 53218
CURRENT OCCUPANT	7845 W BECKETT AVE	MILWAUKEE, WI 53218
CURRENT OCCUPANT	7836 W BECKETT AVE	MILWAUKEE, WI 53218
CURRENT OCCUPANT	7844 W BECKETT AVE	MILWAUKEE, WI 53218

Total Records: 52

Radius: 250.0 feet and Center of Circle: 7964 W Appleton Ave



BUSINESS LICENSE PLAN OF OPERATION

ccl-busplan 12/14/17

Office of the City Clerk License Division
200 E. Wells St. Room 105, Milwaukee, WI 53202
(414) 286-2238 www.milwaukee.gov/license e-mail address: license@milwaukee.gov

1. Type of Business

Applying for: Extended Hours (12AM to 5AM) - If a food establishment, check all that apply: Delivery Drive Thru Dining Room
 Self Service Laundry Massage Establishment Filling Station
 Other (supplemental application for specific license also required)

Provide a detailed description of the type of business you plan on operating:
Tavern

Do you have any experience operating this type of business? No Yes If yes, explain: manager at different bars over the years.

2. Business Operations

a. Proposed Opening Date: September 12, 2018

b. Is this premise under construction? No Yes If yes, list estimated completion date: _____

c. Is this a franchise? No Yes

d. Is this premises currently licensed? No Yes If yes, list type of license: _____

e. Is the current licensee operating? No Yes If no, list date closed: _____

f. Do you have future plans for other businesses, licenses or permits at this location? No Yes
 If yes, explain: _____

g. Have you previously held an Extended Hours License in Milwaukee? No Yes
 If yes, list address(es): _____

h. Are other businesses operating in the same building? No Yes If yes, describe: _____

3. Litter & Noise

a. How are grounds kept clean? Sweep Pressure Wash Pick Up Litter Other: _____

b. How often will grounds be cleaned? Daily Weekly As Needed Monthly Other: _____

c. Grounds cleaned by: Licensee Building Owner Employees Hired Maintenance Other: _____

d. How are noise issues prevented and/or addressed? Security Manager approaches customer(s) Call Police
 Signs Posted Other: _____

e. Will a sound amplification system be used? No Yes If yes, describe: _____

4. Smoking & Sanitation

a. Are there designated outdoor smoking areas? No Yes If yes, describe: porch

b. Number of Garbage Cans: Inside: 4 Locations: 2 behind bar, 1 in each bathroom
 Outside: 2 Locations: Back

c. Is a crowd control barrier used? No Yes If yes, describe: _____

d. How many restrooms are on the premises? 2

e. Name of solid waste contractor: Advanced Disposal Waste Management Other: _____

9. Premises Description

a. Identify all area(s) of the premises that will be used in operating this business (include areas used only for storage):

1st Floor 2nd Floor Basement Storage Patio Beer Garden Sidewalk Café Deck Rooftop

Other: Describe: _____

b. Describe Location: Major Thoroughfare Secondary Street Other: _____

c. Nearest Major Cross Street: Appleton & Hampton

d. Describe Building: Free Standing Building Strip Mall Other: _____

e. Describe Premises Structure: Single Story Multi-Story - # of Stories _____ Other: _____

f. Describe Surrounding Area: Commercial Residential Industrial Other: _____

g. Building Owner Name: Karen A. Miller Phone Number: 414-331-7284

Business Owner Address: 10400 W. Grantosa Dr. Milwaukee, WI 53222

10. Hours of Operation & Customers

Will customers be entering the premises? No Yes

Day of the Week	Proposed Hours of Operation:		Estimated Number of Customers expected each day	Potential Age Range of Customers	Class B Tavern Applicant Only: Age Restriction (If none, write 'None')
	Open Time (include a.m. or p.m.)	Close Time (include a.m. or p.m.)			
Sunday	11:00 A.M.	2:00 A.M.	75	30-60	25 & up
Monday	11:00 A.M.	2:00 A.M.	75	30-60	25 & up
Tuesday	11:00 A.M.	2:00 A.M.	75	30-60	25 & up
Wednesday	11:00 A.M.	2:00 A.M.	75	30-60	25 & up
Thursday	11:00 A.M.	2:00 A.M.	75	30-60	25 & up
Friday	11:00 A.M.	2:00 A.M.	75	30-60	25 & up
Saturday	11:00 A.M.	2:00 A.M.	75	30-60	25 & up

An Extended Hours Establishment License is required for any convenience store, filling station, personal service establishment (such as tattoo, body piercing, salon, tailor, tanning, etc.), recording studio or restaurant which is open between the hours of 12:00 a.m. and 5:00 a.m.

Alcohol Establishments Class A: 8:00 am to 9:00 pm Sunday thru Saturday
Permitted Hours of Operation: Class B: 6:00 am to 2:00 am Sunday thru Thursday, 6:00 am to 2:30 am Friday & Saturday

Entertainment Outdoor Closing Hours: 10:00pm Sunday-Thursday; 12:00am Friday & Saturday; unless a different time, either earlier or later, is established by the Common Council in its approval of the licensee's plan of operation.

11. Signature(s)

Kelly Westover
Signature of Sole Proprietor, Partner, or 20% or more Shareholder
(If there are no 20% or more shareholders,
Corporate Officer-print name/title and sign)

Signature of additional partner or 20% or more shareholder

See Application Information for a complete list of all required application forms.



ALCOHOL BEVERAGE & PUBLIC ENTERTAINMENT PREMISES SUPPLEMENTAL APPLICATION

Office of the City Clerk License Division

200 E. Wells St. Room 105, Milwaukee, WI 53202

(414) 286-2238 e-mail address: license@milwaukee.gov www.milwaukee.gov/license

Legal Entity Name: <u>Kelly's LLC</u>	
Premise Address: <u>7964 W. Appleton Ave Milwaukee, WI 53218</u>	
Proximity of Premises to Church, School, Daycare Center or Hospital	
Is the building within 300 feet of any church, school, daycare center or hospital? <input type="checkbox"/> No <input checked="" type="checkbox"/> Yes	
"Service Bar Only" Designation	
If applying for Class B or C license, are you applying for "Service Bar Only"? <input checked="" type="checkbox"/> No <input type="checkbox"/> Yes	
Service Bar Only means customers cannot sit at the bar. Alcohol is served to patrons seated at tables. No stools, chairs or other articles of furniture shall be placed at the service bar for patrons to sit upon.	
Business Information	
a) Are you taking out this application for anyone that may not be eligible for a license? <input checked="" type="checkbox"/> No <input type="checkbox"/> Yes If yes, list their name and address: _____	
b) Will the agent, a partner or the individual licensee be conducting the day-to-day operations of the business? <input checked="" type="checkbox"/> No <input type="checkbox"/> Yes If no, list the name and address of the person(s) who will: _____	
Class B Applicants: If the agent, a partner or the individual licensee will not be conducting the day-to-day operations of the business, the person(s) listed above must obtain a Class B Managers license.	
c) Does anyone else have money invested or any other interest in this business? <input checked="" type="checkbox"/> No <input type="checkbox"/> Yes If yes, explain: _____	
d) Have you made an agreement with anyone to repay any loan or any other payments based upon income from the business? <input checked="" type="checkbox"/> No <input type="checkbox"/> Yes If yes, list name and address: _____	
Proof of Ownership, Lease, or Offer to Purchase (New & Transfer Applicants Only)	
Submit proof of ownership, lease, or offer to purchase the building with this application. A lease or offer to purchase must:	
a) Be in the same legal entity name as that apply for the license	
b) Reflect the same address as the premises address on this application	
c) Reflect current dates and	
d) Be signed by the lessor/seller and lessee/buyer	
Property Information (New & Transfer Applicants Only)	
a) Do you own or lease the building?	<input type="checkbox"/> Own <input checked="" type="checkbox"/> Lease
b) Who owns the fixtures (for example, coolers, etc.)?	<u>Karen Miller</u>
c) Are you purchasing the stock and/or fixtures?	<input type="checkbox"/> No <input checked="" type="checkbox"/> Yes If yes, amount paid \$ <u>10,977.⁰⁰</u>
d) Total amount paid for business	\$ <u>250,000.⁰⁰</u>
e) Total amount paid for goodwill of the business	\$ <u>77,100.⁰⁰</u>
Goodwill comprises the reputation and customer relationships of an existing business. If the price you pay for the business exceeds the fair market value of all of the rest of the assets of the business, the excess may be considered goodwill.	
f) Have you made arrangements with the seller for payment of personal property taxes?	<input checked="" type="checkbox"/> No <input type="checkbox"/> Yes

See Application Information for a list of all required application forms.

Lease Information (New & Transfer Applicants who are leasing the premises only)

- a) Date lease begins Sept 2018 Ends Sept 2020
- b) Monthly rental \$ 2500.00
- c) Do you have an option to renew the lease? No Yes
- d) Does your lease allow for assignment to another party without the consent of the owner? No Yes
- e) For what length of time have you been guaranteed occupancy (number of years)? 2 years
- f) In addition to paying the monthly rental, will you have to pay anything additional to the owner of the building to guarantee performance of the lease? No Yes If yes, explain Rent
- g) Does the present owner or occupancy object to the granting of your license? No Yes
If yes, explain _____

Change of Agent Applicants Only

Have there been any changes to the floor plan since the last application was submitted? No Yes
If no, a new floor plan is not required. If yes, submit a new floor plan and explain the change(s): _____

Notarized Signatures of Applicants

SUBSCRIBED AND SWORN TO BEFORE ME

This 21 day of August, 20 18

Alexis Gatson
(Clerk/Notary Public)

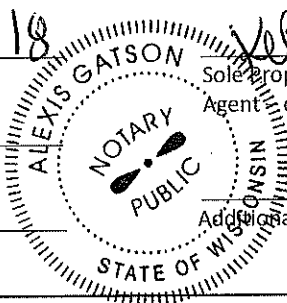

[Signature]
Sole Proprietor, Partner, 20% or more Shareholder, or Agent only if there are no 20% or more shareholders

My Commission Expires 2/12/2019
*Notary Seal must be affixed.

Additional partner or 20% or more shareholder

Note: All information contained in this application is subject to approval by the Common Council. Deviating from approved plan of operation will subject licensee to citations, and/or suspension or non-renewal of the license. Contact the License Division for information on how to request changes.

New and transfer of premise applicants must submit the following:

- Proof of ownership, lease or offer to purchase the building
- Detailed floor plan
- If a restaurant, copy of the menu

SECTION 4 SHARED KITCHEN

Will you be sharing kitchen space with another operator?

- No If No, SKIP to Section 5
- Yes If Yes, check one:
 - I will rent space from another operator ("Shared Kitchen Agreement" is required)
 - I will rent space to another operator (peddler/caterer)

SECTION 5 DETAILS OF OPERATION

Answer the following questions:

- Will you have seating on site for dining? No Yes
- Will you be doing any catering? No Yes
- Will you be doing any delivery? No Yes
- Will you have outdoor activities? No Yes
 - If Yes to outdoor activities, check all that apply: Bar Cooking/Grilling Dining
- Will you have a drive thru window? No Yes
 - If Yes to drive thru, are hours different from inside? No Yes
 - If Yes, provide drive thru hours: _____
- Will any scales or barcode scanners be used? No Yes
 - If Yes, a Weights & Measures application must be completed and a license obtained.

SECTION 6 ADDITIONAL SITES

Where will food be prepared and/or sold?

- At a single site
 - At multiple sites (for example, a hotel with several dining rooms or bars) How many? _____
- If multiple sites, attach a Food Dealer Additional Site Addendum (ccl-foodadd) for each additional site.

SECTION 7 CONSTRUCTION OR CHANGES

Are you planning any construction, remodeling or equipment changes?

- No If No, SKIP to Section 8
- Yes If Yes, check all that apply:
 - New construction of a building
 - Construction changes to an existing building
 - Renovation or remodeling
 - Equipment changes only (installation or replacement)

Provide a brief description of the changes: _____

Start date: _____

Name, Address & Phone Number of Architect: _____

Name, Address & Phone Number of Contractor: _____

SECTION 8 ALCOHOL BEVERAGES

Are you applying for an alcohol beverage license?

- No If No, SKIP to Section 9
- Yes If YES, if your food license is approved prior to the alcohol beverage license, when do you want the food license issued? Immediately At the same time as the alcohol license

SECTION 9 ACKNOWLEDGEMENTS & SIGNATURE

You must initial each item confirming your understanding:

- KW I understand the Health Department must conduct an inspection and advise the License Division of their approval before the license may be issued.
- KW I understand I must obtain an occupancy permit from the Department of Neighborhood Services and an inspection may be required. Neighborhood Services must advise the License Division of their approval before the license may be issued.
- KW I understand the district alderperson will review and either approve or deny my application. If denied, I may appeal and be scheduled to appear before the Licenses Committee. The Licenses Committee will then make a recommendation to the Common Council. The Common Council must grant the license before it may be issued.
- KW I understand proof of payment for all license fees must be on file in the License Division before the license may be issued.
- KW I understand the license must be issued and posted in my establishment prior to opening for business.
- KW I will not operate my food business until the license has been issued and posted in the establishment.

Signature of sole proprietor, partner, agent or 20% shareholder: Kelly W. [Signature]

Signature of additional partner(s): _____



PUBLIC ENTERTAINMENT PREMISES LICENSE SUPPLEMENTAL APPLICATION

Office of the City Clerk License Division
200 E. Wells St. Room 105, Milwaukee, WI 53202
(414) 286-2238 www.milwaukee.gov/license e-mail address: license@milwaukee.gov

PREMISES ADDRESS: 7904 W. Appleton Ave Milwaukee WI 53218

TYPES OF ENTERTAINMENT (CHECK ALL THAT APPLY)

<input type="checkbox"/> Instrumental Musicians	<input type="checkbox"/> Bands	<input type="checkbox"/> Battle of the Bands	<input type="checkbox"/> Comedy Acts
<input type="checkbox"/> Disc Jockey	<input type="checkbox"/> Magic Shows	<input type="checkbox"/> Poetry Readings	<input type="checkbox"/> Dancing by Performers
<input checked="" type="checkbox"/> Jukebox	<input type="checkbox"/> Wrestling	<input type="checkbox"/> Patron Contests	<input type="checkbox"/> Patrons Dancing
<input type="checkbox"/> Adult Entertainment/ Strippers/Erotic Dance	<input checked="" type="checkbox"/> Karaoke	<input type="checkbox"/> Bowling Alley	<input checked="" type="checkbox"/> Pool Tables
<input type="checkbox"/> Motion Pictures on Projection Screens – How many? _____	<input checked="" type="checkbox"/> Amusement Machines – How many? <u>5</u>	<input type="checkbox"/> Concerts	<input type="checkbox"/> Theatrical Performances
<input type="checkbox"/> Other: _____		How many? _____ Approx. # per year? _____	How many? <u>1</u> Approx. # per year? _____

Entertainment Outdoor Closing Hours: 10:00pm Sunday-Thursdays; 12:00am Friday & Saturday; unless a different time, either earlier or later, is established by the Common Council in its approval of the licensee's plan of operation.

PROMOTERS/SOUND AMPLIFICATION

Will promoters ever be used for any of the entertainment? No Yes If Yes, Describe: _____

At any time will sound amplification be used? No Yes If Yes, Describe: _____

LEGAL CAPACITY OF PREMISES

50 (Call the Development Center at 414-286-8211 with questions.) Legal capacity determines the fee for your Public Entertainment Premises License. If you would like to request the license be approved with a lower capacity than that listed above, indicate the lower capacity here: _____. If approved, this lower capacity will print on your license and override the capacity listed on your Occupancy Permit.

NOTARIZED SIGNATURES

I understand that after the license has been issued, a change to the plan of operation will require a written request to change and approval from the Common Council. I agree to inform the City Clerk within 10 days of any substantial changes in the information supplied in this application.

I understand that I shall not willfully refuse to provide the services offered under this license, or add charges or require deposits not required of the general public because of race, color, sex, religion, national origin or ancestry, age, handicap, lawful source of income, marital status, sexual orientation, gender identity or expression, familial status or the fact that a person is now or has been a member of the military service, whether dressed in uniform or not; and shall not seek such information as a condition of employment, or penalize any employee or discriminate in the selection of personnel for training or promotion on the basis of such information.

I have knowledge of the City Ordinances currently regulating public entertainment, and understand that the license may be subject to suspension, non-renewal or revocation, if I violate any rule, law or regulation of the city of Milwaukee and State of Wisconsin.

SUBSCRIBED AND SWORN TO BEFORE ME

This 27th day of August, 2018
Alexis Gatson
(Clerk/Notary Public)

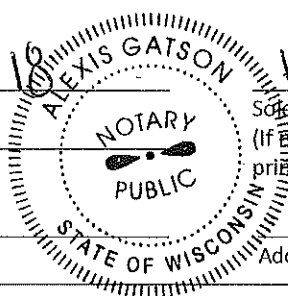

Kelly W. Steinhilber
Sole Proprietor, Partner or 20% or More Shareholder
(If ~~no~~ 20% or more shareholder, Corporate Officer -
print name/title and sign)

My Commission Expires 2/12/2019
Notary Seal must be affixed

Additional partner or 20% or more shareholder

Office Use Only:

Initials: _____ Filed: _____ App: _____

Check if only PEP (must be heard w/in 60 days) Granted _____ License # _____

7964 W. Appleton Ave - Milwaukee WI 53218

KELLY B LLC
Kelly Westerkow So
Kelly Z

8/16/18

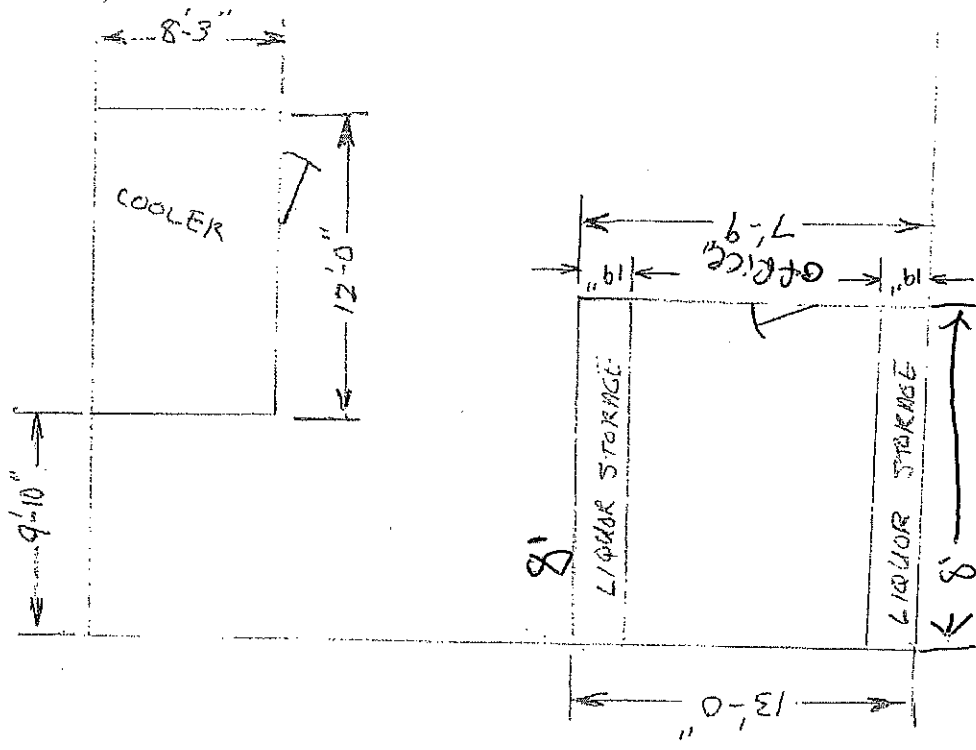
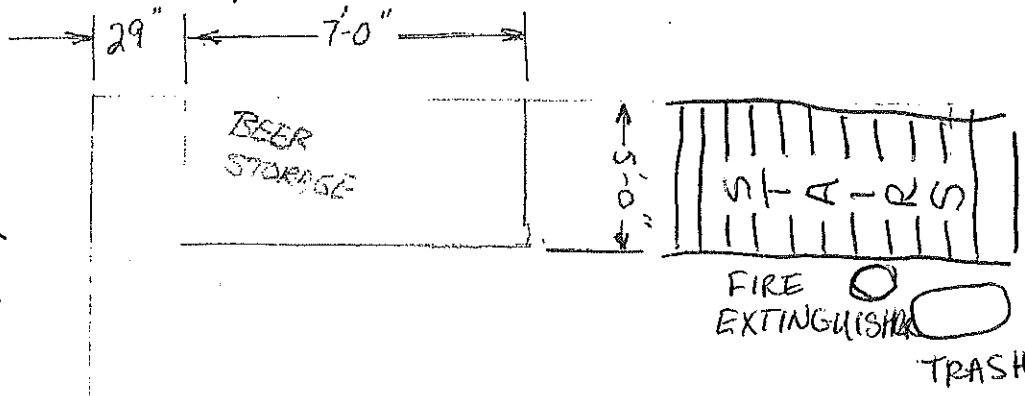

N



**CITY OF MILWAUKEE
OFFICE OF THE CITY CLERK**

Thursday, October 11, 2018

COMMITTEE MEETING NOTICE

AD 05

Lamont Williams
10734 W Hampton Av
Milwaukee, WI 53225

You are requested to attend a hearing which is to be held in Room 301-B, Third Floor, City Hall on:

Tuesday, October 23, 2018 at 09:15 AM

Regarding: Your Secondhand Dealer's and Food Dealer License Applications for "Williams Logistics" at 10734 W Hampton Av.

There is a possibility that your application may be denied for one or more of the following reasons: The recommendation of the committee regarding the application shall be based on evidence presented at the hearing. Per MCO 85-2.7-4, probative evidence concerning whether or not a new license should be granted may be presented on the following subjects: whether or not the applicant meets the municipal requirements, the appropriateness of the location and premises where the licensed premises is to be located and whether use of the premises for the purposes or activities permitted by the license would tend to facilitate a public or private nuisance or create undesirable neighborhood problems such as disorderly patrons, unreasonably loud noise, litter, and excessive traffic and parking congestion. Probative evidence relating to these matters may be taken from the plan of operation submitted with the license application, if any, but shall not include the content of any music. Evidence regarding the fitness of the location of the premises to be maintained as the principal place of business, including but not limited to whether there is an overconcentration of businesses of the type for which the license is sought; whether the proposal is consistent with any pertinent neighborhood business or development plans, or the location's proximity to areas where children are typically present. The applicant's record in operating similarly licensed premises; and whether or not the applicant has been charged with or convicted of any felony, misdemeanor, municipal offense or other offense, the circumstances of which substantially relate to the activity to be permitted by the license being applied for or any other factor which reasonably relates to the public health, safety or welfare may also be considered. See attached police report or correspondence.

Notice for applicants with warrants or unpaid fines:

Proof of warrant satisfaction or payment of fines must be submitted at the hearing on the above date and time. Failure to comply with this requirement may result in a delay of the granting/denial of your application.

Failure to appear at this meeting may result in the denial of your license. Individual applicants must appear only in person or by an attorney. Corporate or Limited Liability applicants must appear only by the agent designated on the application or by an attorney. Partnership applicants must appear by a partner listed on the application or by an attorney. If you wish to do so and at your own expense, you may be accompanied by an attorney of your choosing to represent you at this hearing.

You will be given an opportunity to speak on behalf of the application and to respond and challenge any charges or reasons given for the denial. No petitions can be accepted by the committee, unless the people who signed the petition are present at the committee hearing and willing to testify. You may present witnesses under oath and you may also confront and cross-examine opposing witnesses under oath. If you have difficulty with the English language, you should bring an interpreter with you, at your expense, so that you can answer questions and participate in your hearing.

You may examine the application file at this office during regular business hours prior to the hearing date. Inquiries regarding this matter may be directed to the person whose signature appears below.

Limited parking for persons attending meetings in City Hall is available at reduced rates (5 hour limit) at the Milwaukee Center on the southwest corner of East Kilbourn and North Water Street. Parking tickets must be validated in the first floor information booth in City Hall.

PLEASE NOTE: Upon reasonable notice, efforts will be made to accommodate the needs of disabled individuals through sign language interpreters or other auxiliary aids. For additional information or to request this service, contact the Council Services Division ADA Coordinator at (414) 286-2998, Fax - (414) 286-3456, TDD - (414) 286-2025.

JIM OWCZARSKI, CITY CLERK

BY: _____

Jessica Celella

License Division Manager

If you have questions regarding this notice, please contact the License Division at (414) 286-2238.

200 E. Wells Street, Room 105, City Hall, Milwaukee, WI 53202. www.milwaukee.gov/license
Phone: (414) 286-2238 Fax: (414) 286-3057 Email Address: License@milwaukee.gov



CITY OF MILWAUKEE
OFFICE OF THE CITY CLERK

Thursday, October 11, 2018

COMMITTEE MEETING NOTICE

AD 05

Lamont Williams

2847 N 51st St

Milwaukee, WI 53210

You are requested to attend a hearing which is to be held in Room 301-B, Third Floor, City Hall on:

Tuesday, October 23, 2018 at 09:15 AM

Regarding: Your Secondhand Dealer's and Food Dealer License Applications for "Williams Logistics" at 10734 W Hampton Av.

There is a possibility that your application may be denied for one or more of the following reasons: The recommendation of the committee regarding the application shall be based on evidence presented at the hearing. Per MCO 85-2.7-4, probative evidence concerning whether or not a new license should be granted may be presented on the following subjects: whether or not the applicant meets the municipal requirements, the appropriateness of the location and premises where the licensed premises is to be located and whether use of the premises for the purposes or activities permitted by the license would tend to facilitate a public or private nuisance or create undesirable neighborhood problems such as disorderly patrons, unreasonably loud noise, litter, and excessive traffic and parking congestion. Probative evidence relating to these matters may be taken from the plan of operation submitted with the license application, if any, but shall not include the content of any music. Evidence regarding the fitness of the location of the premises to be maintained as the principal place of business, including but not limited to whether there is an overconcentration of businesses of the type for which the license is sought; whether the proposal is consistent with any pertinent neighborhood business or development plans, or the location's proximity to areas where children are typically present. The applicant's record in operating similarly licensed premises; and whether or not the applicant has been charged with or convicted of any felony, misdemeanor, municipal offense or other offense, the circumstances of which substantially relate to the activity to be permitted by the license being applied for or any other factor which reasonably relates to the public health, safety or welfare may also be considered. See attached police report or correspondence.

Notice for applicants with warrants or unpaid fines:

Proof of warrant satisfaction or payment of fines must be submitted at the hearing on the above date and time. Failure to comply with this requirement may result in a delay of the granting/denial of your application.

Failure to appear at this meeting may result in the denial of your license. Individual applicants must appear only in person or by an attorney. Corporate or Limited Liability applicants must appear only by the agent designated on the application or by an attorney. Partnership applicants must appear by a partner listed on the application or by an attorney. If you wish to do so and at your own expense, you may be accompanied by an attorney of your choosing to represent you at this hearing.

You will be given an opportunity to speak on behalf of the application and to respond and challenge any charges or reasons given for the denial. No petitions can be accepted by the committee, unless the people who signed the petition are present at the committee hearing and willing to testify. You may present witnesses under oath and you may also confront and cross-examine opposing witnesses under oath. If you have difficulty with the English language, you should bring an interpreter with you, at your expense, so that you can answer questions and participate in your hearing.

You may examine the application file at this office during regular business hours prior to the hearing date. Inquiries regarding this matter may be directed to the person whose signature appears below.

Limited parking for persons attending meetings in City Hall is available at reduced rates (5 hour limit) at the Milwaukee Center on the southwest corner of East Kilbourn and North Water Street. Parking tickets must be validated in the first floor information booth in City Hall.

PLEASE NOTE: Upon reasonable notice, efforts will be made to accommodate the needs of disabled individuals through sign language interpreters or other auxiliary aids. For additional information or to request this service, contact the Council Services Division ADA Coordinator at (414) 286-2998, Fax - (414) 286-3456, TDD - (414) 286-2025.

JIM OWCZARSKI, CITY CLERK

BY: _____

Jessica Celella

License Division Manager

If you have questions regarding this notice, please contact the License Division at (414) 286-2238.

200 E. Wells Street, Room 105, City Hall, Milwaukee, WI 53202. www.milwaukee.gov/license
Phone: (414) 286-2238 Fax: (414) 286-3057 Email Address: License@milwaukee.gov

MILWAUKEE POLICE DEPARTMENT LICENSING

CRIMINAL RECORD/ORDINANCE VIOLATION/INCIDENTS SYNOPSIS

DATE: 09/18/2018

LICENSE TYPE: SECONDHAND DEALER'S LICENSE

No. 281045

NEW:

Application Date: 09/17/2018

RENEWAL:

License Location: 10734 W Hampton Av

Business Name: Williams Logistics

Licensee/Applicant: WILLIAMS, Lamont
(Last Name, First Name, MI)

Date of Birth: 09/09/1973

Home Address: 2847 N 51st St

City: Milwaukee

State: WI **Zip Code:** 53210

Home Phone:

This report is written by Police Officer David Novak, assigned to the License Investigation Unit, Days.

The Milwaukee Police Department's investigation regarding this application revealed the following:

1. The applicant is on probation for a 1993 Armed Robbery conviction. Email notification to the Wisconsin Department of Corrections on 09/18/2018 requesting they provide information to the License Division regarding the probation/parole status and the end date of the status.

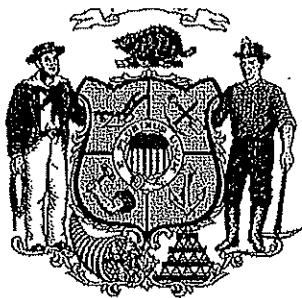

Wisconsin Department of Corrections

Governor Scott Walker | Secretary Cathy A. Jess

Division of Community Corrections | Region 3 Office

Date: 10/02/2018

To: Milwaukee Common Council/Licensing Division

From: Probation and Parole Agent Joe Befi #30216

It was brought to my attention that Mr. Lamont Williams has applied for a Food Dealer License from the City of Milwaukee. Mr. Lamont Williams is currently on a Parole term which is scheduled to discharge on 04/08/2029 for the offense of Armed Robbery and Carrying a Concealed Weapon.

This letter is to inform you that such a licensure would not be in violation of his rules/conditions of supervision. If circumstances change, we will take whatever action we deem appropriate, including action which may affect such licensure. This decision was made based in part, on the following information:

A - Residence Stability: offender has maintained residence stability (yes)
offender has not maintained residence stability (no)

B - Reporting History: offender has maintained required contacts with agent (yes)
offender has not maintained required contacts with agent (no)

C - Police Contact: offender has had police contact while on supervision (no)
offender has not had police contact while on supervision (yes)

D - Overall level of cooperation: has offender complied with referrals and services designed to address criminogenic needs (yes)

**** DCC recommends license not be granted due the following:(check one)

- * License/employment has a direct nexus to committing offense. _____
- * License/employment would have a negative impact on the offender based on specific treatment needs. (HIPPA prohibits the disclosure of specific treatment needs) _____
- * Sex offenses. _____

In providing the information within this letter, the Department of Corrections assumes no liability for the Council's reliance on such information.

Sincerely,

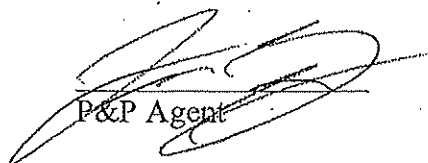
P&P Agent

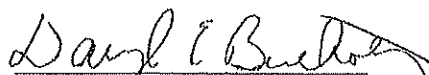
Corrections Field Supervisor



Thursday, October 11, 2018



Notice of Public Hearing

WILLIAMS, Lamont
Williams Logistics at 10734 W Hampton Av
Secondhand Dealer's and Food Dealer License Applications

Tuesday, October 23, 2018 at 9:15 AM

To whom it may concern:

The above application has been made by the above named applicant(s). This requires approval from the Licenses Committee and the Common Council of the City of Milwaukee. The hearing before the Licenses Committee will take place on 10/23/2018 at 9:15 AM, in Room 301-B, Third Floor, City Hall. If you wish, you may provide testimony at the hearing regarding the request; see below for further information. You are not required to attend the hearing. Once the Licenses Committee makes its recommendation, this recommendation is forwarded to the full Common Council for approval at its next regularly scheduled hearing. Please review the information below and if you have further questions regarding this process, please contact the License Division at (414) 286-2238.

Important details for those wishing to provide information for the Licenses Committee to consider when making its recommendation:

1. The license application is scheduled to be heard at the above time. Due to other hearings running longer than scheduled, you may have to wait some time to provide your testimony.
2. You must appear in person and testify as to matters that you have personally experienced or seen. (You cannot provide testimony for your neighbor, parent or anyone else; this is considered hearsay and cannot be considered by the committee.)
3. No letters or petitions can be accepted by the committee (unless the person who wrote the letter or the persons who signed the petition are present at the committee hearing and willing to testify).
4. Persons opposed to the license application are given the opportunity to testify first; supporters may testify after the opponents have finished.
5. When you are called to testify, you will be sworn in and asked to give your name, and address. (If your first and/or last names are uncommon please spell them.)
6. You may then provide testimony.
 - a. Include only information relating to the above license application.
 - b. Include only information you have personally witnessed or seen.
 - c. Provide concise and relevant information detailing how this business has affected or may affect the peaceful enjoyment of your neighborhood.
 - d. If by the time you have the opportunity to testify, the information you wish to share has already been provided to the committee, you may state that you agree with the previous testimony. Redundant or repetitive testimony will not assist the committee in making its recommendation.
7. After giving your testimony, the members of the Licenses Committee and the licensee may ask questions regarding the testimony you have given or other factors relating to the license application.
8. Business Competition is not a valid basis for denial or non-renewal of a license.
Please Note: If you have submitted an objection to the above application your objection cannot be considered by the committee unless you personally testify at the hearing.

OCCUPANT	MAIL ADDRESS	CITY, STATE ZIP
CURRENT OCCUPANT	10831 W HAMPTON AVE 3	MILWAUKEE, WI 53225
CURRENT OCCUPANT	10815 W HAMPTON AVE 4	MILWAUKEE, WI 53225
CURRENT OCCUPANT	10815 W HAMPTON AVE 5	MILWAUKEE, WI 53225
CURRENT OCCUPANT	10739 W HAMPTON AVE 3	MILWAUKEE, WI 53225
CURRENT OCCUPANT	10739 W HAMPTON AVE 8	MILWAUKEE, WI 53225
CURRENT OCCUPANT	10810 W HAMPTON AVE	MILWAUKEE, WI 53225
CURRENT OCCUPANT	10729 W HAMPTON AVE 2	MILWAUKEE, WI 53225
CURRENT OCCUPANT	10729 W HAMPTON AVE 8	MILWAUKEE, WI 53225
CURRENT OCCUPANT	10739 W HAMPTON AVE 5	MILWAUKEE, WI 53225
CURRENT OCCUPANT	10739 W HAMPTON AVE 6	MILWAUKEE, WI 53225
CURRENT OCCUPANT	10831 W HAMPTON AVE 8	MILWAUKEE, WI 53225
CURRENT OCCUPANT	10831 W HAMPTON AVE 1A	MILWAUKEE, WI 53225
CURRENT OCCUPANT	10829 W JEFFREY LN	MILWAUKEE, WI 53225
CURRENT OCCUPANT	10828 W HAMPTON AVE	MILWAUKEE, WI 53225
CURRENT OCCUPANT	10815 W HAMPTON AVE 2	MILWAUKEE, WI 53225
CURRENT OCCUPANT	10815 W HAMPTON AVE 6	MILWAUKEE, WI 53225
CURRENT OCCUPANT	10729 W HAMPTON AVE 5	MILWAUKEE, WI 53225
CURRENT OCCUPANT	10729 W HAMPTON AVE 6	MILWAUKEE, WI 53225
CURRENT OCCUPANT	10729 W HAMPTON AVE 1	MILWAUKEE, WI 53225
CURRENT OCCUPANT	10831 W HAMPTON AVE 2	MILWAUKEE, WI 53225
CURRENT OCCUPANT	10836 W HAMPTON AVE	MILWAUKEE, WI 53225
CURRENT OCCUPANT	10815 W HAMPTON AVE 3	MILWAUKEE, WI 53225
CURRENT OCCUPANT	10729 W HAMPTON AVE 3	MILWAUKEE, WI 53225
CURRENT OCCUPANT	10739 W HAMPTON AVE 7	MILWAUKEE, WI 53225
CURRENT OCCUPANT	10831 W HAMPTON AVE 1B	MILWAUKEE, WI 53225
CURRENT OCCUPANT	10822 W JEFFREY LN	MILWAUKEE, WI 53225
CURRENT OCCUPANT	10820 W HAMPTON AVE	MILWAUKEE, WI 53225
CURRENT OCCUPANT	10815 W HAMPTON AVE 1	MILWAUKEE, WI 53225
CURRENT OCCUPANT	10815 W HAMPTON AVE 8	MILWAUKEE, WI 53225
CURRENT OCCUPANT	10812 W JEFFREY LN	MILWAUKEE, WI 53225
CURRENT OCCUPANT	10739 W HAMPTON AVE 2	MILWAUKEE, WI 53225
CURRENT OCCUPANT	4856 N 108TH ST	MILWAUKEE, WI 53225
CURRENT OCCUPANT	4846 N 108TH ST	MILWAUKEE, WI 53225
CURRENT OCCUPANT	10831 W HAMPTON AVE 5	MILWAUKEE, WI 53225
CURRENT OCCUPANT	10837 W JEFFREY LN	MILWAUKEE, WI 53225
CURRENT OCCUPANT	10821 W JEFFREY LN	MILWAUKEE, WI 53225
CURRENT OCCUPANT	10729 W HAMPTON AVE 4	MILWAUKEE, WI 53225
CURRENT OCCUPANT	10739 W HAMPTON AVE 1	MILWAUKEE, WI 53225
CURRENT OCCUPANT	10831 W HAMPTON AVE 4	MILWAUKEE, WI 53225
CURRENT OCCUPANT	10831 W HAMPTON AVE 6	MILWAUKEE, WI 53225
CURRENT OCCUPANT	10831 W HAMPTON AVE 7	MILWAUKEE, WI 53225
CURRENT OCCUPANT	10828 W JEFFREY LN	MILWAUKEE, WI 53225
CURRENT OCCUPANT	10815 W HAMPTON AVE 7	MILWAUKEE, WI 53225
CURRENT OCCUPANT	10813 W JEFFREY LN	MILWAUKEE, WI 53225
CURRENT OCCUPANT	10804 W JEFFREY LN	MILWAUKEE, WI 53225
CURRENT OCCUPANT	10729 W HAMPTON AVE 7	MILWAUKEE, WI 53225

CURRENT OCCUPANT	10739 W HAMPTON AVE 4	MILWAUKEE, WI 53225
CURRENT OCCUPANT	4840 N 108TH ST	MILWAUKEE, WI 53225
CURRENT OCCUPANT	10801 W JEFFREY LN	MILWAUKEE, WI 53225

Total Records: 49

Radius: 250.0 feet and Center of Circle: 10734 W Hampton Ave



BUSINESS LICENSE PLAN OF OPERATION

ccl-busplan 12/14/17

Office of the City Clerk License Division
200 E. Wells St. Room 105, Milwaukee, WI 53202
(414) 286-2238 www.milwaukee.gov/license e-mail address: license@milwaukee.gov

1. Type of Business

Applying for: Extended Hours (12AM to 5AM) - If a food establishment, check all that apply: Delivery Drive Thru Dining Room
 Self Service Laundry Massage Establishment Filling Station
 Other (supplemental application for specific license also required)

Provide a detailed description of the type of business you plan on operating:

Neighborhood store, (Pantry - Convenience)

Do you have any experience operating this type of business? No Yes If yes, explain: Prior resale shop / currently resale shop

2. Business Operations

- a. Proposed Opening Date: opened July 2018
- b. Is this premise under construction? No Yes If yes, list estimated completion date: _____
- c. Is this a franchise? No Yes
- d. Is this premises currently licensed? No Yes If yes, list type of license: Occupancy licensed
- e. Is the current licensee operating? No Yes If no, list date closed: _____
- f. Do you have future plans for other businesses, licenses or permits at this location? No Yes
If yes, explain: _____
- g. Have you previously held an Extended Hours License in Milwaukee? No Yes
If yes, list address(es): _____
- h. Are other businesses operating in the same building? No Yes If yes, describe: restaurant, tax, barber, beauty, liquor store

3. Litter & Noise

- a. How are grounds kept clean? Sweep Pressure Wash Pick Up Litter Other: Dumpsters
- b. How often will grounds be cleaned? Daily Weekly As Needed Monthly Other: _____
- c. Grounds cleaned by: Licensee Building Owner Employees Hired Maintenance Other: _____
- d. How are noise issues prevented and/or addressed? Security Manager approaches customer(s) Call Police
 Signs Posted Other: _____
- e. Will a sound amplification system be used? No Yes If yes, describe: _____

4. Smoking & Sanitation

- a. Are there designated outdoor smoking areas? No Yes If yes, describe: _____
- b. Number of Garbage Cans: Inside: 2 Locations: back of store
Outside: 2 Locations: Back of building
- c. Is a crowd control barrier used? No Yes If yes, describe: _____
- d. How many restrooms are on the premises? 1
- e. Name of solid waste contractor: Advanced Disposal Waste Management Other: eagle

5. Security

- a. Are there onsite parking spaces? No Yes If yes, indicate how many? 20-25 and describe the parking security plan: owner has cameras/lights
- b. Is there a loading zone? No Yes If yes, describe the loading area security plan: _____
- c. Will you have security personnel on premise? No Yes If yes, how many? _____ and answer the following:
 What are their responsibilities? _____
 Is security equipment used? No Yes If yes, describe cameras
 List their licensing, certification, or training credentials _____
- d. Will there be security cameras? No Yes If yes, where? Front / Back buildings
- e. Will searches/identification checks be done upon entry? No Yes If yes, describe _____

6. Percentage of Sales (must total 100%)

Alcohol <u>0</u> %	Food <u>60</u> %	Secondhand Merchandise <u>40</u> %	Precious Metals & Gems <u>0</u> %
Entertainment <u>0</u> %	Cigarettes <u>0</u> %		
Pawnbroker Activity <u>0</u> %	Salvaged Materials <u>0</u> % (such as scrap metal)	Personal Services (such as tattoo, body piercing, salon, tailor, tanning, etc.) <u>0</u> %	Other _____ % Describe: _____

7. Businesses/Licenses on the Premises (check all that apply):

Type 1

- Full Service Restaurant Cafe/Coffee Shop Deli or Fast Food Restaurant Private/Fraternal/Veterans Club
- Night Club Tavern Cocktail Lounge Teen Club
- Banquet Hall Sports Facility Bowling Alley
- Hotel/Motel : Number of Floors: _____ Rooming House: Number of Floors: _____
 Number of Rooms: _____ Number of Rooms: _____

Type 2

- Liquor Store Corner Store Supermarket Convenience Store
- Gas Station Amusement/Phonograph Distributor Recycling, Salvage or Towing
- Used Car Dealer Personal Service Establishment
(such as tattoo business, hair salon, tailor, etc.) Recording Studio

What other licenses/permits will you hold at this location? (check all that apply)

- Occupancy Permit Cigarette & Tobacco Gas Station Extended Hours Class "B" Tavern Weights & Measures
- Secondhand Dealer Precious Metal & Gem Other: _____

8. Legal Capacity (only if a Type 1 premises in #7 above)

Capacity _____ (Call the Milwaukee Development Center at 414-286-8211 if you have questions.)

9. Premises Description

- a. Identify all area(s) of the premises that will be used in operating this business (include areas used only for storage):
 1st Floor 2nd Floor Basement Storage Patio Beer Garden Sidewalk Café Deck Rooftop
 Other: Describe: _____
- b. Describe Location: Major Thoroughfare Secondary Street Other: West Hampton Ave. (107th)
- c. Nearest Major Cross Street: Mayfair / Lovers Lane
- d. Describe Building: Free Standing Building Strip Mall Other: _____
- e. Describe Premises Structure: Single Story Multi-Story - # of Stories _____ Other: _____
- f. Describe Surrounding Area: Commercial Residential Industrial Other: _____
- g. Building Owner Name: Al Patel Phone Number: 414 718-9594
 Business Owner Address: 10728 W. Hampton Ave

10. Hours of Operation & Customers

Will customers be entering the premises? No Yes

Day of the Week	Proposed Hours of Operation:		Estimated Number of Customers expected each day	Potential Age Range of Customers	Class B Tavern Applicant Only: Age Restriction (If none, write 'None')
	Open Time (include a.m. or p.m.)	Close Time (include a.m. or p.m.)			
Sunday	10am	6 pm	30-40	10-50	
Monday	11am	8 pm	30-40	10-50	
Tuesday	11am	8 pm	30-40	10-50	
Wednesday	11am	8 pm	30-40	10-50	
Thursday	11am	8 pm	30-40	10-50	
Friday	11am	8 pm	30-40	10-50	
Saturday	10am	6 pm	30-40	10-50	

An Extended Hours Establishment License is required for any convenience store, filling station, personal service establishment (such as tattoo, body piercing, salon, tailor, tanning, etc.), recording studio or restaurant which is open between the hours of 12:00 a.m. and 5:00 a.m.

Alcohol Establishments Class A: 8:00 am to 9:00 pm Sunday thru Saturday
 Permitted Hours of Operation: Class B: 6:00 am to 2:00 am Sunday thru Thursday, 6:00 am to 2:30 am Friday & Saturday

Entertainment Outdoor Closing Hours: 10:00pm Sunday-Thursday; 12:00am Friday & Saturday; unless a different time, either earlier or later, is established by the Common Council in its approval of the licensee's plan of operation.

11. Signature(s)

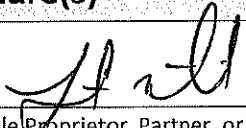
 Signature of Sole Proprietor, Partner, or 20% or more Shareholder
 (If there are no 20% or more shareholders, Corporate Officer-print name/title and sign)

 Signature of additional partner or 20% or more shareholder

See Application Information for a complete list of all required application forms.



**SECONDHAND DEALER LICENSE
SUPPLEMENTAL PLAN OF OPERATION**

ccl-shdpla 12/12/17

Office of the City Clerk License Division
200 E. Wells St. Room 105, Milwaukee, WI 53202
(414) 286-2238 e-mail: license@milwaukee.gov

Legal Entity Name: <u>Lamont Williams</u>		
Premises Address: <u>10734 W. Hampton Ave.</u>		
What type of license are you applying for? (check one) <input checked="" type="checkbox"/> Secondhand Dealer <input type="checkbox"/> Secondhand Dealer-Bicycles Only <input type="checkbox"/> Secondhand Dealer Mall		
INDIVIDUAL, ALL PARTNERS, OR AGENT OF CORP/LLC		
Place of birth: <input type="checkbox"/> WI <input checked="" type="checkbox"/> Other: <u>MS</u>		
Have you been living in Wisconsin for at least 90 days prior to filing this application? <input type="checkbox"/> No If no, you are not eligible to apply for this license at this time. Per MCO 92-2-5-c, the individual, both partners, or agent of a corporation or limited liability company must be a resident of the state of Wisconsin for at least 90 days before the date of application. <input checked="" type="checkbox"/> Yes If yes, list all address(es) where you lived within the last year: <input checked="" type="checkbox"/> Current Address Only <u>2847 W. 51st street</u> <input type="checkbox"/> Other: _____		
MERCHANDISE & SALES		
List all items you will be selling: <u>used appliances, clothings, electronics, tables, chairs, ect</u>		
Will a scale be used for items being sold by weight (price per pound, ounce, gram, etc.)? Will a barcode scanner be used to determine the price of items? If yes to either question, a Weights & Measures License is also required. An application can be obtained from www.milwaukee.gov/license or by contacting our office.		<input checked="" type="checkbox"/> No <input type="checkbox"/> Yes <input checked="" type="checkbox"/> No <input type="checkbox"/> Yes
MANAGER OF BUSINESS		
<input checked="" type="checkbox"/> Same as individual, partner, or agent of corporation/limited liability company		
<input type="checkbox"/> Other: Name: _____		Date of Birth: _____
Address (include, city, state, zip code): _____		
LIST ANY OTHER LICENSES YOU HOLD AT THIS ADDRESS AND THE STATUS		
<input checked="" type="checkbox"/> Occupancy Permit <input checked="" type="checkbox"/> Active <input type="checkbox"/> Suspended <input type="checkbox"/> Other: _____	<input checked="" type="checkbox"/> Wisconsin State Seller's Permit <input checked="" type="checkbox"/> Active <input type="checkbox"/> Suspended <input type="checkbox"/> Other: _____	<input type="checkbox"/> Other(s): <u>Food Dealers License</u> <input type="checkbox"/> Active <input type="checkbox"/> Suspended <input type="checkbox"/> Other: <u>Applied</u>
SECURITY		
What are your plans to provide security for business records? <input type="checkbox"/> Kept in safe <input type="checkbox"/> Kept in locked cabinet <input checked="" type="checkbox"/> Other: <u>Home / safe</u>		
What are your plans to ensure that business is not conducted with minors? <input checked="" type="checkbox"/> Check ID <input type="checkbox"/> Other: _____		

ANNUAL SALES

What is your estimated sales volume for the calendar year in US Dollars? \$ 8,000.00

AFFIRMATION OF UNDERSTANDING – REGULATIONS

Read and initial each item confirming your understanding:

1. lw ✓ I understand no purchase or exchange of any property may be made without obtaining the seller's identification information, as stipulated in 92-11 of the Milwaukee Code of Ordinances (MCO).
2. lw ✓ I understand no item may be received with an altered or obliterated serial number.
3. lw ✓ I understand description records of any item purchased or exchanged must be maintained as stipulated in 92-12 of the MCO.
4. lw ✓ I understand that each transaction description record must be reported as stipulated in 92-13 of the MCO, including color photographs and color video recordings as required in 92-12-3 MCO.
5. lw ✓ I understand that every item purchased or exchanged must be available for inspection by the police department at any reasonable time.
6. lw ✓ I understand that every item exchanged or purchased or accepted on consignment must be kept on the dealer's premises separate and apart from any other property, unchanged and unaltered, for 10 days for inspection by the police department; additional holding periods may be requested by the department.
7. lw ✓ I understand that the police may extend the 10 day holding period if there is reason to believe that the item purchased or exchanged was not sold or exchanged by the rightful owner.
8. lw ✓ I understand that no transactions may be conducted with a minor less than 18 years of age unless the minor is with a parent or guardian, or the dealer has a written consent on file signed in the dealer's presence by the parent or guardian.
9. lw ✓ I understand secondhand dealer must report to the police department any item presented in the course of business if there is reason to believe the item was stolen.

REQUIRED SIGNATURE(S)

I understand that a NEWPRS account (a database to manage and store purchase information) must be obtained prior to operating and utilized for all business transactions.

Signature of Sole Proprietor, Partner, or 20% or more Shareholder (If there are no 20% or more shareholders, Corporate Officer-print name/title and sign)

Signature of additional partner(s) or 20% or more shareholder(s)

SUBMIT THIS FORM ALONG WITH THE BUSINESS LICENSE APPLICATION & BUSINESS LICENSE PLAN OF OPERATION

Office Use Only:

Initials	Filed	App #	Paid
<input type="checkbox"/> Q to MPD	<input type="checkbox"/> Q to DNS	LC Required	ReQ to LIU after LC
CC Required	LIU Approval (NEWPRS)	Issued 1yr/Bikes Only 2yr	License #



FOOD DEALER LICENSE PLAN OF OPERATION

OFFICE OF THE CITY CLERK, LICENSE DIVISION
 CITY HALL, 200 E. WELLS ST, ROOM 105, MILWAUKEE, WI 53202
 (414) 286-2238 • license@milwaukee.gov • www.milwaukee.gov/license

Legal Entity Name: Lamont Williams / Williams Logistics

Premises Address: 10734 W. Hampton Ave

SECTION 1 TYPE OF BUSINESS

Type of application (check one): taking over a currently operating business starting a new business
 Anticipated opening date? July 2018

Check the type that best describes your business (check only one):
 See Food Dealer License Information sheet for definitions.

<input type="checkbox"/> Restaurant	<input type="checkbox"/> Bed & Breakfast
<input checked="" type="checkbox"/> Retail Establishment	<input type="checkbox"/> Base for Food Peddler
If retail, will it be a convenience store? <input checked="" type="checkbox"/> Yes <input checked="" type="checkbox"/> No	<input type="checkbox"/> Base for Temporary/Seasonal Food Stand

(Convenience Stores have less than 5,000 sq ft of retail space, primary business is the sale of basic food items, and in addition sells household products)

In addition, will any wholesale business be done? Yes No

If yes, what percentage of the business will be wholesale? Less than 25% 25% or More (Contact DATCP)*

Will retail items be sold? No Yes If Yes, indicate percentage of food sales 50 %

Will restaurant items be sold? No* Yes If Yes, indicate percentage of food sales _____ %

** If you checked "25% or More" of the business will be wholesale and answered "No" to restaurant items being sold, do not continue completing this application. A City of Milwaukee License is not required. Contact DATCP only.*

SECTION 2 FOOD PROCESSING

Will any food processing be done? No Yes
Processing is defined as assembling, grinding, cutting, mixing, baking, coating, stuffing, packing, bottling, grilling, canning, extracting, fermenting, distilling, pickling, freezing, drying, smoking, or packaging.

If Yes, check the types of food items:

SNACKS & BEVERAGES
includes, but is not limited to, ice cream/soft serve, lemonade, snow cones, coffee, espresso, cappuccino, tea, fruit juice, smoothies, candy, dispensed soda, fruit cups, bakery, cookies, popcorn, kettle corn, cotton candy, funnel cakes, fritters, tortilla chips w/ cheese

MEALS
includes, but is not limited to, chicken, ribs, sandwiches, roasted corn, baked potatoes, hot dogs, brats, tacos, nachos w/ cheese and meat, French fries, cooked or deep fried vegetables/fruit, cooked cheese curds, corn dogs, egg rolls, salads

SECTION 3 FOOD REQUIRING TEMPERATURE CONTROL

Will any food that requires temperature control be sold? No Yes
 (includes dairy products such as milk, cheese, and ice cream, fish, shellfish, meat, poultry)

If yes, list the types of food items: Milk, cheese, meat, eggs, pizza ect.

SECTION 4 SHARED KITCHEN

Will you be sharing kitchen space with another operator?

- No If No, SKIP to Section 5
- Yes If Yes, check one:
 - I will rent space from another operator ("Shared Kitchen Agreement" is required)
 - I will rent space to another operator (peddler/caterer)

SECTION 5 DETAILS OF OPERATION

Answer the following questions:

- Will you have seating on site for dining? No Yes
- Will you be doing any catering? No Yes
- Will you be doing any delivery? No Yes
- Will you have outdoor activities? No Yes
 - If Yes to outdoor activities, check all that apply: Bar Cooking/Grilling Dining
- Will you have a drive thru window? No Yes
 - If Yes to drive thru, are hours different from inside? No Yes
 - If Yes, provide drive thru hours: _____
- Will any scales or barcode scanners be used? No Yes
 - If Yes, a Weights & Measures application must be completed and a license obtained.

SECTION 6 ADDITIONAL SITES

Where will food be prepared and/or sold?

- At a single site
 - At multiple sites (for example, a hotel with several dining rooms or bars) How many? _____
- If multiple sites, attach a Food Dealer Additional Site Addendum (ccl-foodadd) for each additional site.

SECTION 7 CONSTRUCTION OR CHANGES

Are you planning any construction, remodeling or equipment changes?

- No If No, SKIP to Section 8
- Yes If Yes, check all that apply:
 - New construction of a building
 - Construction changes to an existing building
 - Renovation or remodeling
 - Equipment changes only (installation or replacement)

Provide a brief description of the changes: _____

Start date: _____

Name, Address & Phone Number of Architect: _____

Name, Address & Phone Number of Contractor: _____

SECTION 8 ALCOHOL BEVERAGES

Are you applying for an alcohol beverage license?

- No If No, SKIP to Section 9
- Yes If YES, if your food license is approved prior to the alcohol beverage license, when do you want the food license issued? Immediately At the same time as the alcohol license

SECTION 9 ACKNOWLEDGEMENTS & SIGNATURE

You must initial each item confirming your understanding:

- LW I understand the Health Department must conduct an inspection and advise the License Division of their approval before the license may be issued.
- LW I understand I must obtain an occupancy permit from the Department of Neighborhood Services and an inspection may be required. Neighborhood Services must advise the License Division of their approval before the license may be issued.
- LW I understand the district alderperson will review and either approve or deny my application. If denied, I may appeal and be scheduled to appear before the Licenses Committee. The Licenses Committee will then make a recommendation to the Common Council. The Common Council must grant the license before it may be issued.
- LW I understand proof of payment for all license fees must be on file in the License Division before the license may be issued.
- LW I understand the license must be issued and posted in my establishment prior to opening for business.
- LW I will not operate my food business until the license has been issued and posted in the establishment.

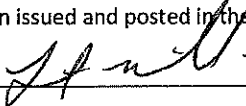
Signature of sole proprietor, partner, agent or 20% shareholder: 

Signature of additional partner(s): _____

Williams Logistics 10734 W. Hampton Ave

Sept. 17, 2018

The Ultimate Grocery List! (Compliments of www.grocerylists.org)

FOODSTUFFS

Fresh vegetables

- Asparagus
- Broccoli
- Carrots
- Cauliflower
- Celery
- Corn
- Cucumbers
- Lettuce / Greens
- Mushrooms
- Onions
- Peppers
- Potatoes
- Spinach
- Squash
- Zucchini
- Tomatoes*
- _____
- _____

Fresh fruits

- Apples
- Avocados
- Bananas
- Berries
- Cherries
- Grapefruit
- Grapes
- Kiwis
- Lemons / Limes
- Melon
- Oranges
- Peaches
- Nectarines
- Pears
- Plums
- _____
- _____

Refrigerated items

- Bagels
- Chip dip
- English muffins
- Eggs / Fake eggs
- Fruit juice
- Hummus
- Ready-bake breads
- Tofu
- Tortillas
- _____
- _____

Frozen

- Breakfasts
- Burritos
- Fish sticks
- Ice cream / Sorbet
- Juice concentrate
- Pizza / Pizza Rolls
- Popsicles
- Fries / Tater tots
- TV dinners
- Vegetables
- Veggie burgers
- _____
- _____

Condiments / Sauces

- BBQ sauce
- Gravy
- Honey
- Hot sauce
- Jam / Jelly / Preserves
- Ketchup / Mustard
- Mayonnaise
- Pasta sauce
- Relish
- Salad dressing
- Salsa
- Soy sauce
- Steak sauce
- Syrup
- Worcestershire sauce
- _____
- _____

Various groceries

- Bouillon cubes
- Cereal
- Coffee / Filters
- Instant potatoes
- Lemon / Lime juice
- Mac & cheese
- Olive oil
- Pancake / Waffle mix
- Pasta
- Peanut butter
- Pickles
- Rice
- Tea
- Vegetable oil
- Vinegar
- _____
- _____

Canned foods

- Applesauce
- Baked beans
- Chili
- Fruit
- Olives
- Tinned meats
- Tuna / Chicken
- Soups
- Tomatoes
- Veggies
- _____
- _____

Spices & herbs

- Basil
- Black pepper
- Cilantro
- Cinnamon
- Garlic
- Ginger
- Mint
- Oregano
- Paprika
- Parsley
- Red pepper
- Salt
- Spice mix
- Vanilla extract
- _____
- _____

Dairy

- Butter / Margarine
- Cottage cheese
- Half & half
- Milk
- Sour cream
- Whipped cream
- Yogurt
- _____
- _____

Cheese

- Bleu cheese
- Cheddar
- Cottage cheese
- Cream cheese
- Feta
- Goat cheese
- Mozzarella / Provolone
- Parmesan
- Provolone
- Ricotta
- Sandwich slices
- Swiss
- _____
- _____

Meat

- Bacon / Sausage
- Beef
- Chicken
- Ground beef / Turkey
- Ham / Pork
- Hot dogs
- Luncheon
- Turkey
- _____
- _____

Seafood

- Catfish
- Crab
- Lobster
- Mussels
- Oysters
- Salmon
- Shrimp
- Tilapia
- Tuna
- _____
- _____

Beverages

- Beer
- Club soda / Tonic
- Champagne
- Gin
- Juice
- Mixers
- Red wine / White wine
- Rum
- Sake
- Soda pop
- Sports drink
- Whiskey
- Vodka
- _____
- _____

Baked goods

- Bagels / Croissants
- Buns / Rolls
- Cake / Cookies
- Donuts / Pastries
- Fresh bread
- Sliced bread
- Pie! Pie! Pie!
- Pita bread
- _____
- _____

Baking

- Baking powder / Soda
- Bread crumbs
- Cake / Brownie mix
- Cake icing / Decorations
- Chocolate chips / Cocoa
- Flour
- Shortening
- Sugar
- Sugar substitute
- Yeast
- _____
- _____

Snacks

- Candy / Gum
- Cookies
- Crackers
- Dried fruit
- Granola bars / Mix
- Nuts / Seeds
- Oatmeal
- Popcorn
- Potato / Corn chips
- Pretzels
- _____
- _____

Themed meals

- ~~Burger night~~
- ~~Chili night~~
- ~~Pizza night~~
- ~~Spaghetti night~~
- ~~Taco night~~
- ~~Take-out deli food~~
- _____
- _____

Baby stuff

- Baby food
- Diapers
- Formula
- Lotion
- Baby wash
- Wipes
- _____
- _____

Pets

- Cat food / Treats
- Cat litter
- Dog food / Treats
- Flea treatment
- Pet shampoo
- _____
- _____

HOUSEHOLD

Personal care

- Antiperspirant / Deodorant
- Bath soap / Hand soap
- Condoms / Other b.c.
- Cosmetics
- Cotton swabs / Balls
- Facial cleanser
- Facial tissue
- Feminine products
- Floss
- Hair gel / Spray
- Lip balm
- Moisturizing lotion
- Mouthwash
- Razors / Shaving cream
- Shampoo / Conditioner
- Sunblock
- Toilet paper
- Toothpaste
- Vitamins / Supplements
- _____
- _____

Medicine

- Allergy
- Antibiotic
- Antidiarrheal
- Aspirin
- Antacid
- Band-aids / Medical
- Cold / Flu / Sinus
- Pain reliever
- Prescription pick-up
- _____
- _____

Kitchen

- Aluminum foil
- Napkins
- Non-stick spray
- Paper towels
- Plastic wrap
- Sandwich / Freezer bags
- Wax paper
- _____
- _____

Cleaning products

- Air freshener
- Bathroom cleaner
- Bleach / Detergent
- Dish / Dishwasher soap
- Garbage bags
- Glass cleaner
- Mop head / Vacuum bags
- Sponges / Scrubbers
- _____
- _____

Office supplies

- CDRs / DVDs
- Notepad / Envelopes
- Glue / Tape
- Printer paper
- Pens / Pencils
- Postage stamps
- _____
- _____

Other stuff

- Automotive
- Batteries
- Charcoal / Propane
- Flowers / Greeting card
- Insect repellent
- Light bulbs
- Newspaper / Magazine
- Random impulse buy
- _____
- _____

Carcinogens

- ~~Arsenic~~
- ~~Asbestos~~
- ~~Cigarettes~~
- ~~Radiomictides~~
- ~~Vinyl chloride~~

Other

- _____
- _____
- _____
- _____
- _____

