



CITY OF MILWAUKEE
OFFICE OF THE CITY CLERK

Thursday, November 19, 2020

COMMITTEE MEETING NOTICE

AD 08

GREWAL, Pritpal S, Agent
National Metro LLC
PO Box 461

Butler, WI 53007

You are requested to attend a virtual hearing to be held on:

Tuesday, December 01, 2020 at 02:10 PM

Regarding: Your Extended Hours Establishments, Filling Station, Dealer, and Weights & Measures License Applications Requesting to be Open 24 Hours as agent for "National Metro LLC" for "Clark On National" at 812 S Layton Bl.

This meeting will be held via GoToMeeting. Please see the enclosed best practices document for further instructions. The access code is <https://global.gotomeeting.com/join/907185773>. If you wish to call in, please call +1 (786) 535-3211 and use Access Code: 907-185-773.

There is a possibility that your application may be denied for one or more of the following reasons: The recommendation of the committee regarding the application shall be based on evidence presented at the hearing. Per MCO 85-2.7-4, probative evidence concerning whether or not a new license should be granted may be presented on the following subjects: whether or not the applicant meets the municipal requirements, the appropriateness of the location and premises where the licensed premises is to be located and whether use of the premises for the purposes or activities permitted by the license would tend to facilitate a public or private nuisance or create undesirable neighborhood problems such as disorderly patrons, unreasonably loud noise, litter, and excessive traffic and parking congestion. Probative evidence relating to these matters may be taken from the plan of operation submitted with the license application, if any, but shall not include the content of any music. Evidence regarding the fitness of the location of the premises to be maintained as the principal place of business, including but not limited to whether there is an overconcentration of businesses of the type for which the license is sought; whether the proposal is consistent with any pertinent neighborhood business or development plans, or the location's proximity to areas where children are typically present. The applicant's record in operating similarly licensed premises; and whether or not the applicant has been charged with or convicted of any felony, misdemeanor, municipal offense or other offense, the circumstances of which substantially relate to the activity to be permitted by the license being applied for or any other factor which reasonably relates to the public health, safety or welfare may also be considered.

Notice for applicants with warrants or unpaid fines: Proof of warrant satisfaction or payment of fines must be submitted at the hearing on the above date and time. Failure to comply with this requirement may result in a delay of the granting/denial of your application.

Failure to attend this meeting may result in the denial of your license. Individual applicants and partnership applicants must attend or attend by an attorney. The agent or attorney for corporate or limited liability applicants must attend. If you wish to do so and at your own expense, you may be accompanied by an attorney of your choosing to represent you at this hearing.

You will be given an opportunity to speak on behalf of the application and to respond and challenge any charges or reasons given for the denial. No petitions can be accepted by the committee, unless the people who signed the petition attend the virtual hearing and are willing to testify. You may present witnesses under oath and you may also confront and cross-examine opposing witnesses under oath. If you have difficulty with the English language, you should request an interpreter attend the meeting with you, at your expense, so that you can answer questions and participate in your hearing.

PLEASE NOTE: Upon reasonable notice, efforts will be made to accommodate the needs of disabled individuals through sign language interpreters or other auxiliary aids. For additional information or to request this service, contact the Council Services Division ADA Coordinator at (414) 286-2998, Fax - (414) 286-3456, TDD - (414) 286-2025.

JIM OWCZARSKI, CITY CLERK

BY: _____

Jessica Celella

License Division Manager

If you have questions regarding this meeting, please contact the staff assistant, Molly Kuether-Steele at (414) 286-2775 or molly.kuether-steele@milwaukee.gov.



CITY OF MILWAUKEE
OFFICE OF THE CITY CLERK

Thursday, November 19, 2020

COMMITTEE MEETING NOTICE

AD 08

GREWAL, Pritpal S, Agent
National Metro LLC
W174N10148 Tanglewood Dr

Germantown, WI 53022

You are requested to attend a virtual hearing to be held on:

Tuesday, December 01, 2020 at 02:10 PM

Regarding: Your Extended Hours Establishments, Filling Station, Food Dealer, and Weights & Measures License Applications Requesting to be Open 24 Hours as agent for "National Metro LLC" for "Clark On National" at 812 S Layton Bl.

This meeting will be held via GoToMeeting. Please see the enclosed best practices document for further instructions. The access code is <https://global.gotomeeting.com/join/907185773>. If you wish to call in, please call +1 (786) 535-3211 and use Access Code: 907-185-773.

There is a possibility that your application may be denied for one or more of the following reasons: The recommendation of the committee regarding the application shall be based on evidence presented at the hearing. Per MCO 85-2.7-4, probative evidence concerning whether or not a new license should be granted may be presented on the following subjects: whether or not the applicant meets the municipal requirements, the appropriateness of the location and premises where the licensed premises is to be located and whether use of the premises for the purposes or activities permitted by the license would tend to facilitate a public or private nuisance or create undesirable neighborhood problems such as disorderly patrons, unreasonably loud noise, litter, and excessive traffic and parking congestion. Probative evidence relating to these matters may be taken from the plan of operation submitted with the license application, if any, but shall not include the content of any music. Evidence regarding the fitness of the location of the premises to be maintained as the principal place of business, including but not limited to whether there is an overconcentration of businesses of the type for which the license is sought; whether the proposal is consistent with any pertinent neighborhood business or development plans, or the location's proximity to areas where children are typically present. The applicant's record in operating similarly licensed premises; and whether or not the applicant has been charged with or convicted of any felony, misdemeanor, municipal offense or other offense, the circumstances of which substantially relate to the activity to be permitted by the license being applied for or any other factor which reasonably relates to the public health, safety or welfare may also be considered.

Notice for applicants with warrants or unpaid fines:

Proof of warrant satisfaction or payment of fines must be submitted at the hearing on the above date and time. Failure to comply with this requirement may result in a delay of the granting/denial of your application.

Failure to attend this meeting may result in the denial of your license. Individual applicants and partnership applicants must attend or attend by an attorney. The agent or attorney for corporate or limited liability applicants must attend. If you wish to do so and at your own expense, you may be accompanied by an attorney of your choosing to represent you at this hearing.

You will be given an opportunity to speak on behalf of the application and to respond and challenge any charges or reasons given for the denial. No petitions can be accepted by the committee, unless the people who signed the petition attend the virtual hearing and are willing to testify. You may present witnesses under oath and you may also confront and cross-examine opposing witnesses under oath. If you have difficulty with the English language, you should request an interpreter attend the meeting with you, at your expense, so that you can answer questions and participate in your hearing.

PLEASE NOTE: Upon reasonable notice, efforts will be made to accommodate the needs of disabled individuals through sign language interpreters or other auxiliary aids. For additional information or to request this service, contact the Council Services Division ADA Coordinator at (414) 286-2998, Fax - (414) 286-3456, TDD - (414) 286-2025.

JIM OW CZARSKI, CITY CLERK

BY: _____

Jessica Celella

License Division Manager

If you have questions regarding this meeting, please contact the staff assistant, Molly Kuether-Steele at (414) 286-2775 or molly.kuether-steele@milwaukee.gov.



Thursday, November 19, 2020



Notice of Public Hearing

blank
notice

GREWAL, Pritpal S, Agent
Clark On National at 812 S Layton Bl
Extended Hours Establishments, Filling Station, Food Dealer, and Weights & Measures License
Applications Requesting to be Open 24 Hours

Tuesday, December 1, 2020 at 2:10 PM

To whom it may concern:

The above application has been made by the above named applicant(s). This requires approval from the Licenses Committee and the Common Council of the City of Milwaukee. The hearing before the Licenses Committee will take place virtually on 12/1/2020 at 2:10 PM. This is a public hearing. Those wishing to view the proceeding are able to do so via the City Channel – Channel 25 on Spectrum Cable – or on the Internet at <http://city.milwaukee.gov/citychannel>. Those wishing to provide oral testimony will be asked to do so by phone or internet and are asked to contact the staff assistant, Molly Kuether-Steele at (414) 286-2775 or molly.kuether-steele@milwaukee.gov for necessary information. Please make such requests no later than one business day prior to the start of the meeting. You are not required to attend the hearing, but please see the information below if you would like to provide testimony. Once the Licenses Committee makes its recommendation, this recommendation is forwarded to the full Common Council for approval at its next regularly scheduled hearing.

Important details for those wishing to provide information for the Licenses Committee to consider when making its recommendation:

1. The license application is scheduled to be heard at the above time. Due to other hearings running longer than scheduled, you may have to wait some time to provide your testimony.
2. You must testify as to matters that you have personally experienced or seen. (You cannot provide testimony for your neighbor, parent or anyone else; this is considered hearsay and cannot be considered by the committee.)
3. No letters or petitions can be accepted by the committee (unless the person who wrote the letter or the persons who signed the petition are willing to testify).
4. Persons opposed to the license application are given the opportunity to testify first; supporters may testify after the opponents have finished.
5. When you are called to testify, you will be sworn in and asked to give your name, and address. (If your first and/or last names are uncommon please spell them.)
6. You may then provide testimony.
 - a. Include only information relating to the above license application.
 - b. Include only information you have personally witnessed or seen.
 - c. Provide concise and relevant information detailing how this business has affected or may affect the peaceful enjoyment of your neighborhood.
 - d. If by the time you have the opportunity to testify, the information you wish to share has already been provided to the committee, you may state that you agree with the previous testimony. Redundant or repetitive testimony will not assist the committee in making its recommendation.
7. After giving your testimony, the members of the Licenses Committee and the licensee may ask questions regarding the testimony you have given or other factors relating to the license application.
8. Business Competition is not a valid basis for denial or non-renewal of a license.

Please Note: If you have submitted an objection to the above application your objection cannot be considered by the committee unless you personally testify at the hearing.

OCCUPANT	MAIL ADDRESS	CITY, STATE ZIP
CURRENT OCCUPANT	2539 W NATIONAL AVE	MILWAUKEE, WI 53204
CURRENT OCCUPANT	2600 W NATIONAL AVE 507	MILWAUKEE, WI 53204
CURRENT OCCUPANT	2600 W NATIONAL AVE 1007	MILWAUKEE, WI 53204
CURRENT OCCUPANT	2600 W NATIONAL AVE 1006	MILWAUKEE, WI 53204
CURRENT OCCUPANT	2600 W NATIONAL AVE 909	MILWAUKEE, WI 53204
CURRENT OCCUPANT	2600 W NATIONAL AVE 1106	MILWAUKEE, WI 53204
CURRENT OCCUPANT	2600 W NATIONAL AVE 708	MILWAUKEE, WI 53204
CURRENT OCCUPANT	2600 W NATIONAL AVE 610	MILWAUKEE, WI 53204
CURRENT OCCUPANT	2600 W NATIONAL AVE 902	MILWAUKEE, WI 53204
CURRENT OCCUPANT	2600 W NATIONAL AVE 810	MILWAUKEE, WI 53204
CURRENT OCCUPANT	2600 W NATIONAL AVE 1102	MILWAUKEE, WI 53204
CURRENT OCCUPANT	2600 W NATIONAL AVE 510	MILWAUKEE, WI 53204
CURRENT OCCUPANT	2600 W NATIONAL AVE 307	MILWAUKEE, WI 53204
CURRENT OCCUPANT	2600 W NATIONAL AVE 309	MILWAUKEE, WI 53204
CURRENT OCCUPANT	776 S 26TH ST A	MILWAUKEE, WI 53204
CURRENT OCCUPANT	754 S 26TH ST 7	MILWAUKEE, WI 53204
CURRENT OCCUPANT	754 S 26TH ST 3	MILWAUKEE, WI 53204
CURRENT OCCUPANT	754 S LAYTON BLVD 103	MILWAUKEE, WI 53215
CURRENT OCCUPANT	746 S LAYTON BLVD 207	MILWAUKEE, WI 53215
CURRENT OCCUPANT	746 S LAYTON BLVD 103	MILWAUKEE, WI 53215
CURRENT OCCUPANT	746 S 26TH ST	MILWAUKEE, WI 53204
CURRENT OCCUPANT	738 S LAYTON BLVD 1	MILWAUKEE, WI 53215
CURRENT OCCUPANT	739 S 26TH ST 3	MILWAUKEE, WI 53204
CURRENT OCCUPANT	733 S 26TH ST	MILWAUKEE, WI 53204
CURRENT OCCUPANT	2600 W NATIONAL AVE 603	MILWAUKEE, WI 53204
CURRENT OCCUPANT	2600 W NATIONAL AVE 1107	MILWAUKEE, WI 53204
CURRENT OCCUPANT	2600 W NATIONAL AVE 905	MILWAUKEE, WI 53204
CURRENT OCCUPANT	2600 W NATIONAL AVE 501	MILWAUKEE, WI 53204
CURRENT OCCUPANT	2600 W NATIONAL AVE 203	MILWAUKEE, WI 53204
CURRENT OCCUPANT	2600 W NATIONAL AVE 709	MILWAUKEE, WI 53204
CURRENT OCCUPANT	2600 W NATIONAL AVE 707	MILWAUKEE, WI 53204
CURRENT OCCUPANT	2600 W NATIONAL AVE 1110	MILWAUKEE, WI 53204
CURRENT OCCUPANT	2600 W NATIONAL AVE 805	MILWAUKEE, WI 53204
CURRENT OCCUPANT	2600 W NATIONAL AVE 504	MILWAUKEE, WI 53204
CURRENT OCCUPANT	2600 W NATIONAL AVE 1002	MILWAUKEE, WI 53204
CURRENT OCCUPANT	2600 W NATIONAL AVE 410	MILWAUKEE, WI 53204
CURRENT OCCUPANT	2600 W NATIONAL AVE 207	MILWAUKEE, WI 53204
CURRENT OCCUPANT	2600 W NATIONAL AVE 209	MILWAUKEE, WI 53204
CURRENT OCCUPANT	2600 W NATIONAL AVE 1003	MILWAUKEE, WI 53204
CURRENT OCCUPANT	754 S LAYTON BLVD 104	MILWAUKEE, WI 53215
CURRENT OCCUPANT	750 S 26TH ST	MILWAUKEE, WI 53204
CURRENT OCCUPANT	746 S LAYTON BLVD 104	MILWAUKEE, WI 53215
CURRENT OCCUPANT	746 S LAYTON BLVD 203	MILWAUKEE, WI 53215
CURRENT OCCUPANT	743 S 26TH ST	MILWAUKEE, WI 53204
CURRENT OCCUPANT	738 S LAYTON BLVD 4	MILWAUKEE, WI 53215
CURRENT OCCUPANT	727 S 26TH ST 2	MILWAUKEE, WI 53204

CURRENT OCCUPANT	2600 W NATIONAL AVE 808	MILWAUKEE, WI 53204
CURRENT OCCUPANT	2600 W NATIONAL AVE 807	MILWAUKEE, WI 53204
CURRENT OCCUPANT	2600 W NATIONAL AVE 802	MILWAUKEE, WI 53204
CURRENT OCCUPANT	2600 W NATIONAL AVE 201	MILWAUKEE, WI 53204
CURRENT OCCUPANT	2600 W NATIONAL AVE 606	MILWAUKEE, WI 53204
CURRENT OCCUPANT	2600 W NATIONAL AVE 306	MILWAUKEE, WI 53204
CURRENT OCCUPANT	2600 W NATIONAL AVE 704	MILWAUKEE, WI 53204
CURRENT OCCUPANT	2600 W NATIONAL AVE 809	MILWAUKEE, WI 53204
CURRENT OCCUPANT	2600 W NATIONAL AVE 904	MILWAUKEE, WI 53204
CURRENT OCCUPANT	2600 W NATIONAL AVE 706	MILWAUKEE, WI 53204
CURRENT OCCUPANT	2600 W NATIONAL AVE 305	MILWAUKEE, WI 53204
CURRENT OCCUPANT	2600 W NATIONAL AVE 710	MILWAUKEE, WI 53204
CURRENT OCCUPANT	2600 W NATIONAL AVE 901	MILWAUKEE, WI 53204
CURRENT OCCUPANT	2600 W NATIONAL AVE 608	MILWAUKEE, WI 53204
CURRENT OCCUPANT	2600 W NATIONAL AVE 1104	MILWAUKEE, WI 53204
CURRENT OCCUPANT	776 S 26TH ST	MILWAUKEE, WI 53204
CURRENT OCCUPANT	754 S 26TH ST 2	MILWAUKEE, WI 53204
CURRENT OCCUPANT	754 S 26TH ST 5	MILWAUKEE, WI 53204
CURRENT OCCUPANT	754 S 26TH ST 8	MILWAUKEE, WI 53204
CURRENT OCCUPANT	754 S LAYTON BLVD 206	MILWAUKEE, WI 53215
CURRENT OCCUPANT	746 S LAYTON BLVD 204	MILWAUKEE, WI 53215
CURRENT OCCUPANT	733 S 26TH ST C	MILWAUKEE, WI 53204
CURRENT OCCUPANT	2600 W NATIONAL AVE 509	MILWAUKEE, WI 53204
CURRENT OCCUPANT	2600 W NATIONAL AVE 301	MILWAUKEE, WI 53204
CURRENT OCCUPANT	2600 W NATIONAL AVE 310	MILWAUKEE, WI 53204
CURRENT OCCUPANT	2600 W NATIONAL AVE 908	MILWAUKEE, WI 53204
CURRENT OCCUPANT	2600 W NATIONAL AVE 602	MILWAUKEE, WI 53204
CURRENT OCCUPANT	2600 W NATIONAL AVE 202	MILWAUKEE, WI 53204
CURRENT OCCUPANT	2600 W NATIONAL AVE 402	MILWAUKEE, WI 53204
CURRENT OCCUPANT	2600 W NATIONAL AVE 505	MILWAUKEE, WI 53204
CURRENT OCCUPANT	2600 W NATIONAL AVE 401	MILWAUKEE, WI 53204
CURRENT OCCUPANT	2600 W NATIONAL AVE 1001	MILWAUKEE, WI 53204
CURRENT OCCUPANT	2600 W NATIONAL AVE 405	MILWAUKEE, WI 53204
CURRENT OCCUPANT	2600 W NATIONAL AVE 1010	MILWAUKEE, WI 53204
CURRENT OCCUPANT	2600 W NATIONAL AVE 907	MILWAUKEE, WI 53204
CURRENT OCCUPANT	2600 W NATIONAL AVE 304	MILWAUKEE, WI 53204
CURRENT OCCUPANT	754 S 26TH ST 6	MILWAUKEE, WI 53204
CURRENT OCCUPANT	754 S LAYTON BLVD 205	MILWAUKEE, WI 53215
CURRENT OCCUPANT	754 S LAYTON BLVD 106	MILWAUKEE, WI 53215
CURRENT OCCUPANT	754 S LAYTON BLVD 203	MILWAUKEE, WI 53215
CURRENT OCCUPANT	750A S 26TH ST	MILWAUKEE, WI 53204
CURRENT OCCUPANT	752A S 26TH ST	MILWAUKEE, WI 53204
CURRENT OCCUPANT	746 S LAYTON BLVD 108	MILWAUKEE, WI 53215
CURRENT OCCUPANT	739 S 26TH ST 1	MILWAUKEE, WI 53204
CURRENT OCCUPANT	733 S 26TH ST A	MILWAUKEE, WI 53204
CURRENT OCCUPANT	2600 W NATIONAL AVE 302	MILWAUKEE, WI 53204
CURRENT OCCUPANT	2600 W NATIONAL AVE 604	MILWAUKEE, WI 53204

CURRENT OCCUPANT	2600 W NATIONAL AVE 702	MILWAUKEE, WI 53204
CURRENT OCCUPANT	2600 W NATIONAL AVE 1103	MILWAUKEE, WI 53204
CURRENT OCCUPANT	2600 W NATIONAL AVE 1108	MILWAUKEE, WI 53204
CURRENT OCCUPANT	2600 W NATIONAL AVE 806	MILWAUKEE, WI 53204
CURRENT OCCUPANT	772 S 26TH ST	MILWAUKEE, WI 53204
CURRENT OCCUPANT	754 S LAYTON BLVD 101	MILWAUKEE, WI 53215
CURRENT OCCUPANT	752 S 26TH ST	MILWAUKEE, WI 53204
CURRENT OCCUPANT	747 S 26TH ST	MILWAUKEE, WI 53204
CURRENT OCCUPANT	746 S LAYTON BLVD 202	MILWAUKEE, WI 53215
CURRENT OCCUPANT	746 S LAYTON BLVD 106	MILWAUKEE, WI 53215
CURRENT OCCUPANT	746 S LAYTON BLVD 206	MILWAUKEE, WI 53215
CURRENT OCCUPANT	746 S LAYTON BLVD 205	MILWAUKEE, WI 53215
CURRENT OCCUPANT	2600 W NATIONAL AVE 804	MILWAUKEE, WI 53204
CURRENT OCCUPANT	2600 W NATIONAL AVE 1105	MILWAUKEE, WI 53204
CURRENT OCCUPANT	2600 W NATIONAL AVE 801	MILWAUKEE, WI 53204
CURRENT OCCUPANT	2600 W NATIONAL AVE 607	MILWAUKEE, WI 53204
CURRENT OCCUPANT	2600 W NATIONAL AVE 506	MILWAUKEE, WI 53204
CURRENT OCCUPANT	2600 W NATIONAL AVE 705	MILWAUKEE, WI 53204
CURRENT OCCUPANT	2600 W NATIONAL AVE 206	MILWAUKEE, WI 53204
CURRENT OCCUPANT	2600 W NATIONAL AVE 605	MILWAUKEE, WI 53204
CURRENT OCCUPANT	2600 W NATIONAL AVE 1101	MILWAUKEE, WI 53204
CURRENT OCCUPANT	2600 W NATIONAL AVE 906	MILWAUKEE, WI 53204
CURRENT OCCUPANT	2600 W NATIONAL AVE 205	MILWAUKEE, WI 53204
CURRENT OCCUPANT	2600 W NATIONAL AVE 403	MILWAUKEE, WI 53204
CURRENT OCCUPANT	2600 W NATIONAL AVE 1109	MILWAUKEE, WI 53204
CURRENT OCCUPANT	2600 W NATIONAL AVE 502	MILWAUKEE, WI 53204
CURRENT OCCUPANT	754 S LAYTON BLVD 204	MILWAUKEE, WI 53215
CURRENT OCCUPANT	746 S LAYTON BLVD 105	MILWAUKEE, WI 53215
CURRENT OCCUPANT	746 S LAYTON BLVD 101	MILWAUKEE, WI 53215
CURRENT OCCUPANT	738 S LAYTON BLVD 2	MILWAUKEE, WI 53215
CURRENT OCCUPANT	733 S 26TH ST B	MILWAUKEE, WI 53204
CURRENT OCCUPANT	727 S 26TH ST	MILWAUKEE, WI 53204
CURRENT OCCUPANT	2600 W NATIONAL AVE 406	MILWAUKEE, WI 53204
CURRENT OCCUPANT	2600 W NATIONAL AVE 701	MILWAUKEE, WI 53204
CURRENT OCCUPANT	2600 W NATIONAL AVE 1009	MILWAUKEE, WI 53204
CURRENT OCCUPANT	2600 W NATIONAL AVE 910	MILWAUKEE, WI 53204
CURRENT OCCUPANT	2600 W NATIONAL AVE 1005	MILWAUKEE, WI 53204
CURRENT OCCUPANT	2600 W NATIONAL AVE 903	MILWAUKEE, WI 53204
CURRENT OCCUPANT	2600 W NATIONAL AVE 308	MILWAUKEE, WI 53204
CURRENT OCCUPANT	2600 W NATIONAL AVE 1008	MILWAUKEE, WI 53204
CURRENT OCCUPANT	2600 W NATIONAL AVE 210	MILWAUKEE, WI 53204
CURRENT OCCUPANT	2600 W NATIONAL AVE 408	MILWAUKEE, WI 53204
CURRENT OCCUPANT	2600 W NATIONAL AVE 409	MILWAUKEE, WI 53204
CURRENT OCCUPANT	754 S 26TH ST 4	MILWAUKEE, WI 53204
CURRENT OCCUPANT	754 S LAYTON BLVD 105	MILWAUKEE, WI 53215
CURRENT OCCUPANT	754 S LAYTON BLVD 201	MILWAUKEE, WI 53215
CURRENT OCCUPANT	746 S LAYTON BLVD 102	MILWAUKEE, WI 53215

CURRENT OCCUPANT	746 S LAYTON BLVD 201	MILWAUKEE, WI 53215
CURRENT OCCUPANT	739 S 26TH ST 2	MILWAUKEE, WI 53204
CURRENT OCCUPANT	2600 W NATIONAL AVE 407	MILWAUKEE, WI 53204
CURRENT OCCUPANT	2600 W NATIONAL AVE 208	MILWAUKEE, WI 53204
CURRENT OCCUPANT	2600 W NATIONAL AVE 703	MILWAUKEE, WI 53204
CURRENT OCCUPANT	2600 W NATIONAL AVE 303	MILWAUKEE, WI 53204
CURRENT OCCUPANT	2600 W NATIONAL AVE 404	MILWAUKEE, WI 53204
CURRENT OCCUPANT	2600 W NATIONAL AVE 204	MILWAUKEE, WI 53204
CURRENT OCCUPANT	2600 W NATIONAL AVE 609	MILWAUKEE, WI 53204
CURRENT OCCUPANT	2600 W NATIONAL AVE 803	MILWAUKEE, WI 53204
CURRENT OCCUPANT	2600 W NATIONAL AVE 503	MILWAUKEE, WI 53204
CURRENT OCCUPANT	2600 W NATIONAL AVE 1004	MILWAUKEE, WI 53204
CURRENT OCCUPANT	2600 W NATIONAL AVE 601	MILWAUKEE, WI 53204
CURRENT OCCUPANT	2600 W NATIONAL AVE 508	MILWAUKEE, WI 53204
CURRENT OCCUPANT	754 S 26TH ST 1	MILWAUKEE, WI 53204
CURRENT OCCUPANT	754 S LAYTON BLVD 102	MILWAUKEE, WI 53215
CURRENT OCCUPANT	754 S LAYTON BLVD 202	MILWAUKEE, WI 53215
CURRENT OCCUPANT	746 S LAYTON BLVD 107	MILWAUKEE, WI 53215
CURRENT OCCUPANT	746 S LAYTON BLVD 208	MILWAUKEE, WI 53215
CURRENT OCCUPANT	738 S LAYTON BLVD 3	MILWAUKEE, WI 53215
blank	notice	

Total Records: 160

Radius: 250.0 feet and Center of Circle: 812 S Layton Blvd



BUSINESS LICENSE PLAN OF OPERATION

ccl-busplan 5/12/2020

Office of the City Clerk License Division
200 E. Wells St. Room 105, Milwaukee, WI 53202
(414) 286-2238 www.milwaukee.gov/license e-mail address: license@milwaukee.gov

1. Type of Business

Applying for: Extended Hours (12AM to 5AM) - If a food establishment, check all that apply: Delivery Drive Thru Dining Room
 Self Service Laundry Massage Establishment Filling Station
 Other (supplemental application for specific license also required)

Provide a detailed description of the type of business you plan on operating:

Car station + c-store + car wash

Do you have any experience operating this type of business? No Yes If yes, explain: *ALREADY IN SAME TYPE of BUSINESS*

2. Business Operations

- a. Proposed Opening Date: 11-30-2020
- b. Is this premise under construction? No Yes If yes, list estimated completion date: _____
- c. Is this a franchise? No Yes
- d. Is this premises currently licensed? No Yes If yes, list type of license: Filling station, food, City license
- e. Is the current licensee operating? No Yes If no, list date closed: _____
- f. Do you have future plans for other businesses, licenses or permits at this location? No Yes
If yes, explain: _____
- g. Have you previously held an Extended Hours License in Milwaukee? No Yes
If yes, list address(es): 3510 N 7th Street MILWAUKEE WI 53212
- h. Are other businesses operating in the same building? No Yes If yes, describe: _____

3. Litter & Noise

- a. How are grounds kept clean? Sweep Pressure Wash Pick Up Litter Other: _____
- b. How often will grounds be cleaned? Daily Weekly As Needed Monthly Other: _____
- c. Grounds cleaned by: Licensee Building Owner Employees Hired Maintenance Other: _____
- d. How are noise issues prevented and/or addressed? Security Manager approaches customer(s) Call Police
 Signs Posted Other: _____
- e. Will a sound amplification system be used? No Yes If yes, describe: _____

4. Smoking & Sanitation

- a. Are there designated outdoor smoking areas? No Yes If yes, describe: BY outside Door + BY cooler
- b. Number of Garbage Cans: Inside: 4 Locations: 1 in cash area 1 BY coffee 2 inside entrance
Outside: 8 Locations: BY pumps & front of the building
- c. Is a crowd control barrier used? No Yes If yes, describe: _____
- d. How many restrooms are on the premises? 2
- e. Name of solid waste contractor: Advanced Disposal Waste Management Other: _____

5. Security

- a. Are there onsite parking spaces? No Yes If yes, how many? 6 and describe the parking security plan: 6 CAMERAS monitor parking lot
- b. Is there a loading zone? No Yes If yes, describe the loading area security plan: _____
- c. Will you have security personnel on premise? No Yes If yes, how many? _____ and answer the following:
 What are their responsibilities? _____
 Is security equipment used? No Yes If yes, describe _____
 List their licensing, certification, or training credentials _____
- d. Will there be security cameras? No Yes If yes, how many? 16 and list locations: 16 inside + 6 outside building.
- e. Will searches/identification checks be done upon entry? No Yes If yes, describe _____

6. Percentage of Sales (must total 100%)

Alcohol _____%	Food <u>40</u> %	Secondhand Merchandise _____%	Precious Metals & Gems _____%
Entertainment _____%	Cigarettes <u>10</u> %	_____%	_____%
Pawnbroker Activity _____%	Salvaged Materials _____% (such as scrap metal)	Personal Services (such as tattoo, body piercing, salon, tailor, tanning, etc.) _____%	Other <u>50</u> % Describe: <u>gas, lottery</u>

7. Businesses/Licenses on the Premises (check all that apply):

Type 1

- Full Service Restaurant Cafe/Coffee Shop Deli or Fast Food Restaurant Private/Fraternal/Veterans Club
- Night Club Tavern Cocktail Lounge Teen Club
- Banquet Hall Sports Facility Bowling Alley
- Hotel/Motel: Number of Floors: _____ Rooming House: Number of Floors: _____
 Number of Rooms: _____ Number of Rooms: _____

Type 2

- Liquor Store Corner Store Supermarket Convenience Store
- Gas Station Amusement/Phonograph Distributor Recycling, Salvage or Towing
- Used Car Dealer Personal Service Establishment
(such as tattoo business, hair salon, tailor, etc.) Recording Studio

What other licenses/permits will you hold at this location? (check all that apply)

- Occupancy Permit Cigarette & Tobacco Gas Station Extended Hours Class "B" Tavern Weights & Measures
- Secondhand Dealer Precious Metal & Gem Other: _____

8. Legal Capacity (only if a Type 1 premises in #7 above)

Capacity _____ (Call the Milwaukee Development Center at 414-286-8211 if you have questions.)

9. Premises Description

a. Identify all area(s) of the premises that will be used in operating this business (include areas used only for storage):

1st Floor 2nd Floor Basement Storage Patio Beer Garden Sidewalk Café Deck Rooftop

Other: Describe: _____

b. Describe Location: Major Thoroughfare Secondary Street Other: 27th street

c. Nearest Major Cross Street: NATIONAL

d. Describe Building: Free Standing Building Strip Mall Other: _____

e. Describe Premises Structure: Single Story Multi-Story - # of Stories _____ Other: _____

f. Describe Surrounding Area: Commercial Residential Industrial Other: _____

g. Building Owner Name: Sharif malik Phone Number: _____

Building Owner Address: 812 S Lorton Blvd Milwaukee WI 53215

10. Hours of Operation & Customers

Will customers be entering the premises? No Yes

Day of the Week	Proposed Hours of Operation:		Estimated Number of Customers expected each day	Potential Age Range of Customers	Class B Tavern Applicant Only: Age Restriction (If none, write 'None')
	Open Time (include a.m. or p.m.)	Close Time (include a.m. or p.m.)			
Sunday	12:00 AM	11:59 PM	300		
Monday	12:00 AM	11:59 PM	300		
Tuesday	12:00 AM	11:59 PM	300		
Wednesday	12:00 AM	11:59 PM	300		
Thursday	12:00 AM	11:59 PM	300		
Friday	12:00 AM	11:59 PM	300		
Saturday	12:00 AM	11:59 PM	300		

An Extended Hours Establishment License is required for any convenience store, filling station, personal service establishment (such as tattoo, body piercing, salon, tailor, tanning, etc.), recording studio or restaurant which is open between the hours of 12:00 a.m. and 5:00 a.m.

Alcohol Establishments Class A: 8:00 am to 9:00 pm Sunday thru Saturday
 Permitted Hours of Operation: Class B: 6:00 am to 2:00 am Sunday thru Thursday, 6:00 am to 2:30 am Friday & Saturday

Entertainment Outdoor Closing Hours: 10:00pm Sunday-Thursday; 12:00am Friday & Saturday; unless a different time, either earlier or later, is established by the Common Council in its approval of the licensee's plan of operation.

11. Signature(s)

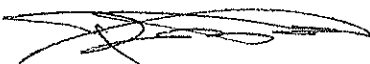
 Signature of Sole Proprietor, Partner, or 20% or more Shareholder
 (If there are no 20% or more shareholders,
 Corporate Officer-print name/title and sign)

Signature of additional partner or 20% or more shareholder

See Application Information for a complete list of all required application forms.



FOOD DEALER LICENSE PLAN OF OPERATION

OFFICE OF THE CITY CLERK, LICENSE DIVISION
CITY HALL, 200 E. WELLS ST, ROOM 105, MILWAUKEE, WI 53202
(414) 286-2238 • license@milwaukee.gov • www.milwaukee.gov/license

Legal Entity Name:	NATIONAL METRO LLC
Premises Address:	812 S LAYTON BLVD 53215
SECTION 1 TYPE OF BUSINESS	
<p>What will be the majority of your food sales? (check one)</p> <p><input type="checkbox"/> Restaurant Items (meals): MEALS include, but are not limited to, chicken, ribs, sandwiches, roasted corn, baked potatoes, hot dogs, brats, tacos, nachos w/ cheese and meat, French fries, cooked or deep fried vegetables/fruit, cooked cheese curds, corn dogs, egg rolls, salads.</p> <p><input checked="" type="checkbox"/> Retail Items (snacks and beverages): RETAIL items include, but are not limited to, ice cream/soft serve, lemonade, snow cones, coffee, espresso, cappuccino, tea, fruit juice, smoothies, candy, dispensed soda, fruit cups, bakery, cookies, kettle corn, cotton candy, funnel cakes, fritters, tortilla chips w/ cheese.</p> <p>Will it be a convenience store? <input checked="" type="checkbox"/> Yes <input type="checkbox"/> No A convenience store contains less than 5,000 square feet of retail space and has, as its primary business, the sale of basic food items and in addition, sells household products or is a filling station that sells basic food items and household products.</p> <p><input type="checkbox"/> Bed & Breakfast <input type="checkbox"/> Micro Market</p> <p>All Applicants: Submit a menu or a list of food items that will be sold.</p>	
<p>Will any wholesale business be done? <input checked="" type="checkbox"/> No <input type="checkbox"/> Yes If yes, what percentage of food sales will be wholesale?</p> <p><input type="checkbox"/> Less than 25%</p> <p><input type="checkbox"/> 25% or More AND: <input type="checkbox"/> Restaurant items (meals) will be sold – Complete this application and also contact DATCP. <input type="checkbox"/> NO restaurant items (meals) will be sold - Do NOT complete this application. Contact DATCP only.</p>	
SECTION 2 FOOD PROCESSING	
<p>Will any food processing be done? <input checked="" type="checkbox"/> No <input type="checkbox"/> Yes</p> <p>Processing is defined as assembling, grinding, cutting, mixing, baking, coating, stuffing, packing, bottling, grilling, canning, extracting, fermenting, distilling, pickling, freezing, drying, smoking, or packaging.</p>	
SECTION 3 FOOD REQUIRING TEMPERATURE CONTROL	
<p>Will any food that requires temperature control be sold? <input type="checkbox"/> No <input checked="" type="checkbox"/> Yes (includes dairy products such as milk, cheese, and ice cream, fish, shellfish, meat, poultry)</p> <p>If yes, list the types of food items: <u>MILK, EGGS, CHEESE, ICE CREAMS</u></p>	

SECTION 4 DETAILS OF OPERATION

Will you have seating on site for dining? No Yes

Will you be doing any catering? No Yes

Will you be doing any delivery? No Yes

Will you have outdoor activities? No Yes - Check all that apply: Bar Cooking/Grilling Dining

Will you have a drive thru window? No Yes - Are hours different from inside? No Yes
 If Yes, provide drive thru hours: _____

Will scales or barcode scanners be used? No Yes - You must also apply for a Weights & Measures License.

SECTION 5 ADDITIONAL SITES

Where will food be prepared and/or sold?

At a single site At multiple sites: How many? _____ (for example, a hotel with several dining rooms or bars)

If multiple sites, attach a Food Dealer Additional Site Addendum (ccl-foodadd) for each additional site.

SECTION 6 CONSTRUCTION OR CHANGES

Are you planning any construction, remodeling or equipment changes?

No If No, SKIP to Section 8

Yes If Yes, check all that apply: New construction of a building Renovation or remodeling
 Construction changes to existing building Equipment changes only

Provide a brief description of the changes: _____

Start date: _____

Name, Address & Phone Number of Architect: _____

Name, Address & Phone Number of Contractor: _____

SECTION 7 ALCOHOL BEVERAGES

Are you applying for an alcohol beverage license?

No If No, SKIP to Section 8

Yes If YES, if your food license is approved prior to the alcohol license, when do you want the food license issued?
 Immediately At the same time as the alcohol license

SECTION 8 ACKNOWLEDGEMENTS & SIGNATURE

You must initial each item confirming your understanding:

PS I understand the Health Department must conduct an inspection and advise the License Division of their approval before the license may be issued.

PS I understand I must obtain an occupancy permit from the Department of Neighborhood Services and an inspection may be required. Neighborhood Services must advise the License Division of their approval before the license may be issued.

PS I understand the district alderperson will review and either support or object to my application. If he/she objects, I may appeal and be scheduled to appear before the Licenses Committee. The Licenses Committee will then make a recommendation to the Common Council. The Common Council must grant the license before it may be issued.

PS I understand proof of payment for all license fees must be on file in the License Division before the license may be issued and the license must be issued and posted in my establishment prior to opening for business.

PS I will not operate my food business until the license has been issued and posted in the establishment.

Signature of Sole Proprietor, Partner, or 20% Shareholder: _____

Signature of Additional Partner: _____



WEIGHTS & MEASURES PLAN OF OPERATION

cci-wmplan 1/9/18

Office of the City Clerk License Division
200 E. Wells St. Room 105, Milwaukee, WI 53202
(414) 286-2238 www.milwaukee.gov/license license@milwaukee.gov

Legal Entity Name: NATIONAL METRO LLC
Premise Address: 812 S Layton Blvd Milwaukee WI 53215

Type of Business

Provide a brief description of the establishment/business:

Cow's St-thrower store + operation

Other licenses may be required depending on the type of business you are operating.

Food Cig, ~~Not~~ Tended, weight, filling station

Litter & Noise

- a. How are grounds kept clean? Sweep Pressure Wash Pick Up Litter Other: _____
- b. How often will grounds be cleaned? Daily Weekly As Needed Monthly Other: _____
- c. Grounds cleaned by: Licensee Building Owner Employees Hired Maintenance Other: _____
- d. How are noise issues prevented and/or addressed? Security Manager approaches customer(s) Call Police
 Signs Posted Other: _____

Signature

Signature of Sole Proprietor, Partner, or 20% or more Shareholder
(If there are no 20% or more shareholders,
Corporate Officer-print name/title and sign)

Signature of additional partner or 20% or more shareholder

This form must be submitted with the Business License Application, Weights & Measures License Supplemental Application, and appropriate fee. Forms can be obtained online at www.milwaukee.gov/licenses.

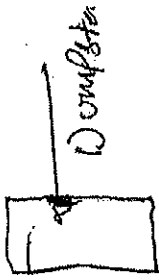

Window

FAST FUEL CONVENIENCE 1 LLC

Total Square Footage = 3000

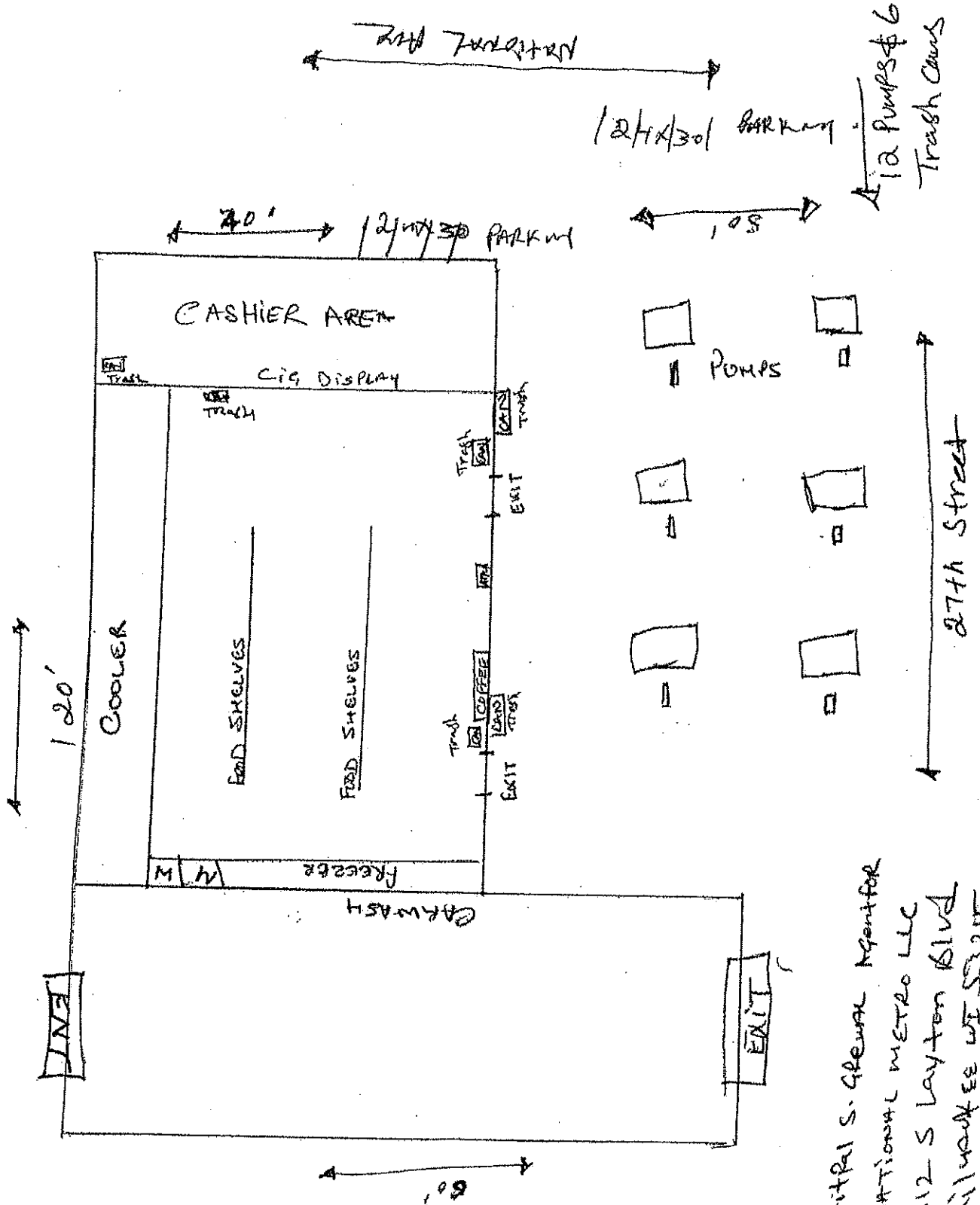

Patricia S. General Manager
 NATIONAL METRO LLC
 212 S Layton Blvd
 Milwaukee WI 53211
 DATE OCTOBER 27, 2010