

EXHIBIT A

File No. 030140

ZND/CC

**DETAILED PLANNED DEVELOPMENT:
PROJECT DESCRIPTION AND OWNER'S STATEMENT OF INTENT
BY: ST. MICHAEL HOSPITAL OF FRANCISCAN SISTERS
OF MILWAUKEE, INC.**

I. COMPONENTS OF DETAILED PLAN AND SUPPORTING MATERIALS.

St. Michael Hospital of Franciscan Sisters of Milwaukee, Inc. ("St. Michael") requests approval from the City of Milwaukee ("City") for a Detailed Planned Development ("DPD") at its hospital campus at 2400 West Villard Avenue, Milwaukee, Wisconsin ("Campus") in accordance with this Statement of Intent ("Statement"). This DPD constitutes the third phase in a multi-phase development concept for the Campus. This DPD includes: (i) an addition of the day surgery area ("Day Surgery Area") consisting of approximately 16,560 square feet with two entrances; (ii) an enclosed stairwell consisting of approximately 660 square feet; and (iii) an emergency generator building consisting of approximately 1,250 square feet. A Proposed Expansion Site Plan – General is included for reference. This Statement, together with the accompanying plan sheets and related materials identified below, constitutes and supports the DPD and includes:

DPD Sheet 000	Cover Sheet
DPD Sheet 001	Vicinity Map
DPD Sheet 002	Plat of Survey
DPD Sheet 003	Existing Facilities Site Plan-General
DPD Sheet 004	Proposed Expansion Site Plan-General
DPD Sheet 005	Site Plan
DPD Sheet GPD4	Previously Approved Proposed Expansion Site Plan-General
DPD Sheet 006	Site Grading Plan
DPD Sheet 007	Site Utility Plan
DPD Sheet 008	Site Landscape Plan
DPD Sheet 009	Site Details
DPD Sheet 200	Partial Basement Floor Plan
DPD Sheet 201	Partial Ground Floor Plan
DPD Sheet 202	Partial Penthouse Floor Plan
DPD Sheet 203	Partial Roof Floor Plan
DPD Sheet 300	Exterior Elevations
DPD Sheet 400	Generator Building Plan and Elevations

II. DESCRIPTION OF THE DEVELOPMENT.

A. Day Surgery Area, Entrances and Enclosed Stairwells. The Day Surgery Area will directly connect to the existing Cancer Center and operating rooms within the hospital building. The new entrances and enclosed stairwell are adjacent to or are in close proximity to the new Day Surgery Area addition. The Day Surgery Area addition, new entrances and enclosed stairwell and related remodeling will be constructed at the northeasterly portion of the Campus. The north side of the Campus will continue to be accessed from 25th Street via existing curb cuts to existing parking lots.

The Day Surgery Area addition represents an important addition to the Campus, significantly upgrading the quality and capacity of St. Michael's outpatient surgery facilities and capabilities.

B. Emergency Generator Building. Consistent with current industry safety procedures, we are proposing that the emergency generator servicing the Campus be located in a dedicated emergency generator building which will also permit increased capacity thereby promoting health and safety for hospital patients. The new building will be located in the northwesterly portions of the Campus.

III. COMPLIANCE WITH STANDARDS.

The proposed DPD plan complies with, or varies from, the standards prescribed by Section 295-907-3 of the Milwaukee Code of Ordinances in the following respects:

A. Uses (295-907-3 – a). All proposed additions conform with the allowed medical/hospital uses.

B. Size (295-907-3). The total affected land area for all proposed additions will be approximately 13,100 square feet.

C. Space Between Structures (295-907-3-d). The location of the proposed additions will comply with the applicable provisions of the Wisconsin Administrative Code, ILHR Chs. 50-64.

D. Setbacks (295-907-3-e). The proposed setbacks for the additions will comply with the 25-foot setback requirement prescribed in Section 295-907-3-e as shown on the DPD Proposed Expansion Site Plan.

E. Screening (295-907-3-f). The landscaping plan for the new additions, including any proposed screening, is illustrated on the DPD Landscape Plan and will be properly maintained in compliance with City landscape screening requirements.

F. Open Spaces (295-907-3-g). St. Michael will continue to landscape and maintain open spaces on the Campus in an aesthetically pleasing manner and such as not to create a nuisance or hazardous condition. Open space locations and the accompanying

landscape planning are shown on the Proposed Expansion Site Plan and the DPD Landscape Plan respectively.

G. Circulation Facilities (295-907-3-h). Circulation patterns, including pedestrian and vehicle ingress and egress and parking and loading facilities, are shown on the DPD Proposed Expansion Site Plan. Adequate access for pedestrians and public and private vehicles shall be provided. If during construction alternative parking is required, St. Michael will arrange available off-site parking for employees and transport them between the private "off-site" parking and the Campus by shuttle bus. Designated "on-site" shuttle bus stops and proposed "on-site" routes are indicated on the DPD Proposed Expansion Site Plan. Parking and loading facilities are to be located near the Building and will be adequately screened and landscaped (see DPD Landscape Plan). Circulation facilities will comply with the design specifications of the City and the American Concrete Institute, American Asphalt Institute or the State of Wisconsin, Department of Transportation, as applicable.

H. Landscaping (295-907-3-i). Landscaping plans are shown on the Proposed Expansion Site Plan and the DPD Landscape Plan respectively. St. Michael will be responsible for the continuous landscape maintenance of any elements which it installs, including plant material replacement on a seasonal basis as such material becomes no longer compatible in size to the plant list specifications and inconsistent with typical form/shape of the species due to dieback, stunting or damage. No City-approved material shall be substituted without City approval. Plant material sizes specified shall not be decreased subsequent or prior to installation.

I. Lighting (295-907-3-j). New lighting will conform to the illuminating Engineering Society Standards and City Ordinances. New lighting facilities are identified on the DPD Site Utility Plan.

J. Utilities (295-907-3-k). All new utility lines will be installed underground. The utility design is shown on the DPD Site Utility Plan.

K. Signs (295-907-3-l). No new signs are included as part of this proposed expansion.

L. Survey (295-907-2-c-5). The Plat of Survey shows topography at one-foot contour levels, for greater detail instead of the two-foot contour detail required by City ordinance. The grading for the site is shown on the DPD Site Grading Plan.

IV. MINOR MODIFICATIONS.

Section 295-907-2-i of the Milwaukee Code of Ordinances provides that general and detailed plans may establish reasonable limits within which minor modifications may be allowed, provided that such minor modifications do not result in certain changes to the plan relating to its general character, or such things as land coverage of buildings and

parking areas. See, Section 295-907-2-i of the Milwaukee Ordinances. St. Michael, in generating the plans for this DPD, has attempted to anticipate all factors required to complete the project successfully, and has invested a substantial amount of time and capital in its planning process. However, neither St. Michael nor the City can absolutely predict how the plans set forth herein may unfold in their implementation. In recognition of this fact, and acknowledging the need to maintain flexibility of plans to be modified for particular circumstances, St. Michael's will retain the right to make minor modifications to the DPD at any time. However, in no event will any such minor modifications undertaken by St. Michael cause any of those effects set forth in Section 295-907-2-i-1-7 inclusive of the Milwaukee Ordinances.

V. STATISTICAL SHEET INFORMATION.

The statistical sheet required at Section 295-907-2-c-1 of the Milwaukee Ordinances is attached as Exhibit A.

EXHIBIT A

STATISTICAL SHEET

A.	Gross Land Area – New DPD	30,773 SF (0.71 acres)
B.	Land Covered by Principal Buildings – New DPD	13,100 SF (0.30 acres)
C.	Land for Parking and Drives – New DPD	9,671 SF (0.22 acres)
D.	Open Space – New DPD	8,002 SF (0.18 acres)
E.	Total Square Footage of Buildings – New DPD	18,470 SF
G.	Parking Spaces Added as Part of DPD*	0

SF = Square feet of actual area in acres.

* Current total parking spaces of 940 shall be reduced to 926 total parking spaces upon completion of the proposed expansion. The ratio of parking spaces per 1000 square feet of building area after the proposed expansion is 1.164

L M A R C H I T E C T S

AERIAL VIEW

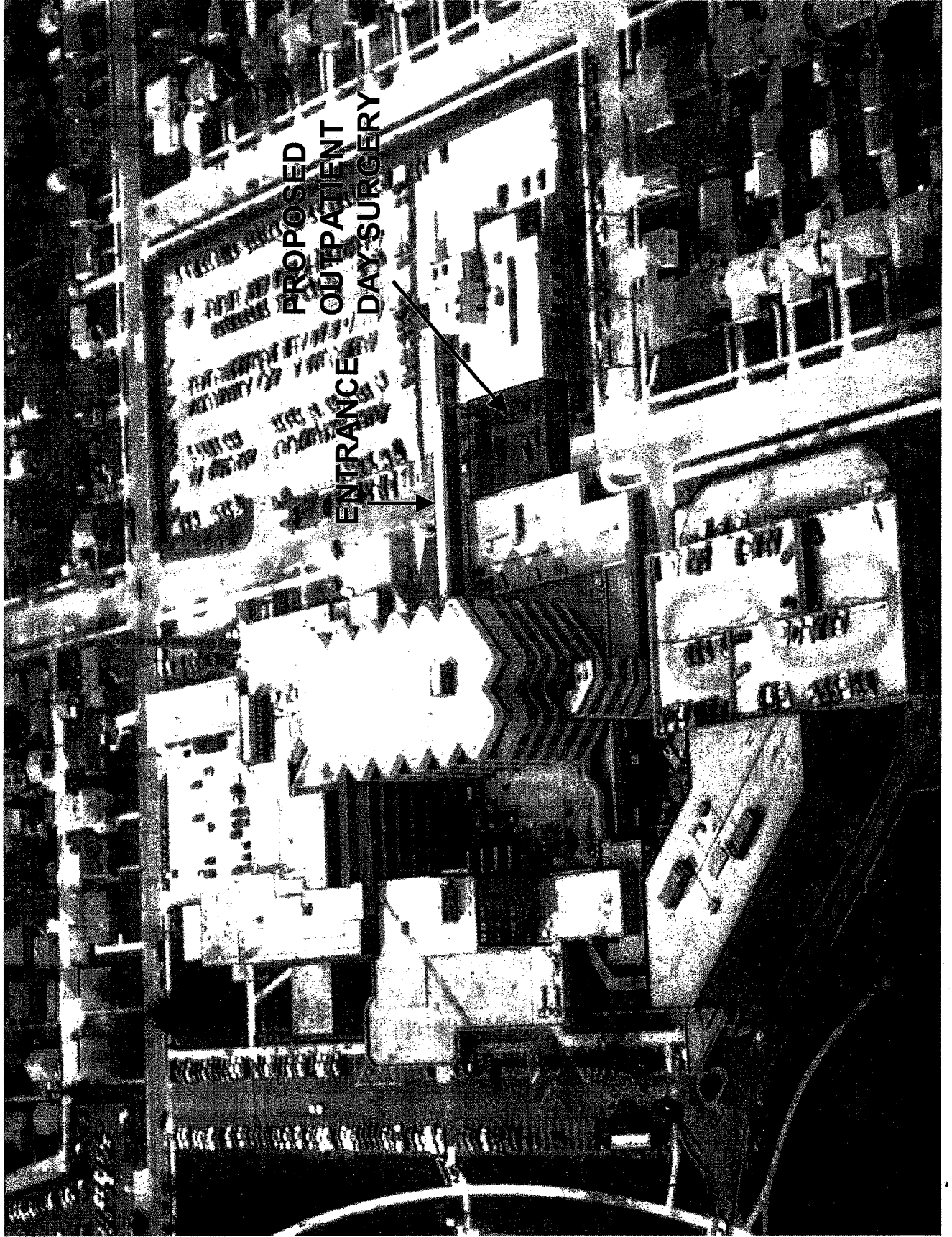

HOSPITAL		AREA - 882,842 SF	
1	HOSPITAL	31	HOSPITAL
2	STORY (1)	2	STORY
3	HOSPITAL	17	HOSPITAL
4	STORY (1)	7	STORY
5	HOSPITAL	18	HOSPITAL
6	STORY (1)	1	STORY
7	HOSPITAL	19	HOSPITAL
8	STORY (1)	2	STORY (NO BDR)
9	HOSPITAL	20	HOSPITAL
10	STORY (1)	3	STORY (NO BDR)
11	HOSPITAL	21	HOSPITAL
12	STORY (1)	8	STORY (0)
13	HOSPITAL	22	HOSPITAL
14	STORY (1)	8	STORY (1)
15	HOSPITAL	23	HOSPITAL
16	STORY (1)	2	STORY
17	HOSPITAL	24	HOSPITAL
18	STORY (1)	1	STORY
19	HOSPITAL	25	HOSPITAL
20	STORY (1)	1	STORY
21	HOSPITAL	26	HOSPITAL
22	STORY (1)	4	STORY
23	HOSPITAL	27	HOSPITAL
24	STORY (1)	1	STORY
25	HOSPITAL	28	HOSPITAL
26	STORY (1)	1	STORY
27	HOSPITAL	29	CONVENT
28	STORY (1)	1	STORY
29	HOSPITAL	30	SECTION
30	STORY (1)	1	STORY
31	HOSPITAL		

UNLESS NOTED OTHERWISE (ASSEMBLY NOT INCLUDED IN STORY COUNT)

PROFESSIONAL OFFICE BUILDING
 1983 - 3 STORY
 AREA - 46,500 SF

PARKING STRUCTURE
 1983 - 2 STORY
 AREA - 18,000 SF

COMPREHENSIVE CANCER CENTER
 1983 - 2 STORY
 AREA - 18,000 SF

MEDICAL OFFICE/MEDICAL RECORDS
 1983 - 2 STORY + 3 STORIES
 AREA - 36,500 SF + TWO 500 SF STORIES

PARKING STRUCTURE
 1983 - 3 STORY + SKYWALK
 AREA - TWO 500 SF + 2,200 SF SKYWALK

FAMILY CARE CENTER
 1983 - 2 STORY + SKYWALK
 AREA - 7,400 SF

NOTES:

- (1) TOP LEVEL IS MECHANICAL SPACE
- (2) TOP TWO LEVELS ARE MECHANICAL SPACE
- (3) ELEVATED SKYWALK CONNECTS TO THE EXISTING EIGHT-STORY BUILDING AND IS LOCATED COMPLETELY SOUTH OF THE NORTH FACE OF THE EXISTING ONE-STORY BUILDING
- (4) INCLUDES 2 STORY ADDITION

GENERAL NOTES:

- LOADING FACILITIES & REFUSE COLLECTION FACILITIES ARE LOCATED AT THE RECEIVING DOCK ON THE EAST END OF THE MAIN HOSPITAL BUILDING
- PROPOSED SKYWALK TO MATCH EXISTING HOSPITAL SKYWALK. A TOTAL OF 8 SKYWALKS PROPOSED. EACH SKYWALK IS 4' WIDE X 4' DEEP - 16' HIGH. ALL SKYWALKS & ALUMINUM SIGN ON CONCRETE FEDERAL BASE - PER CITY OF MILWAUKEE GENERAL ORDINANCES & REQUIREMENTS
- LANDSCAPE WITH PARKING LOT SCREENING BUFFER & ALL EXISTING TREES TO BE MAINTAINED. LANDSCAPE WITH PARKING LOT SCREENING BUFFER - PER CITY OF MILWAUKEE GENERAL ORDINANCES & REQUIREMENTS
- PROPOSED GENERAL PLAN TRACT AREA TO WHICH THAT OF ENTIRE TRACT (578,220 SF ±, 13,274 ACRES)

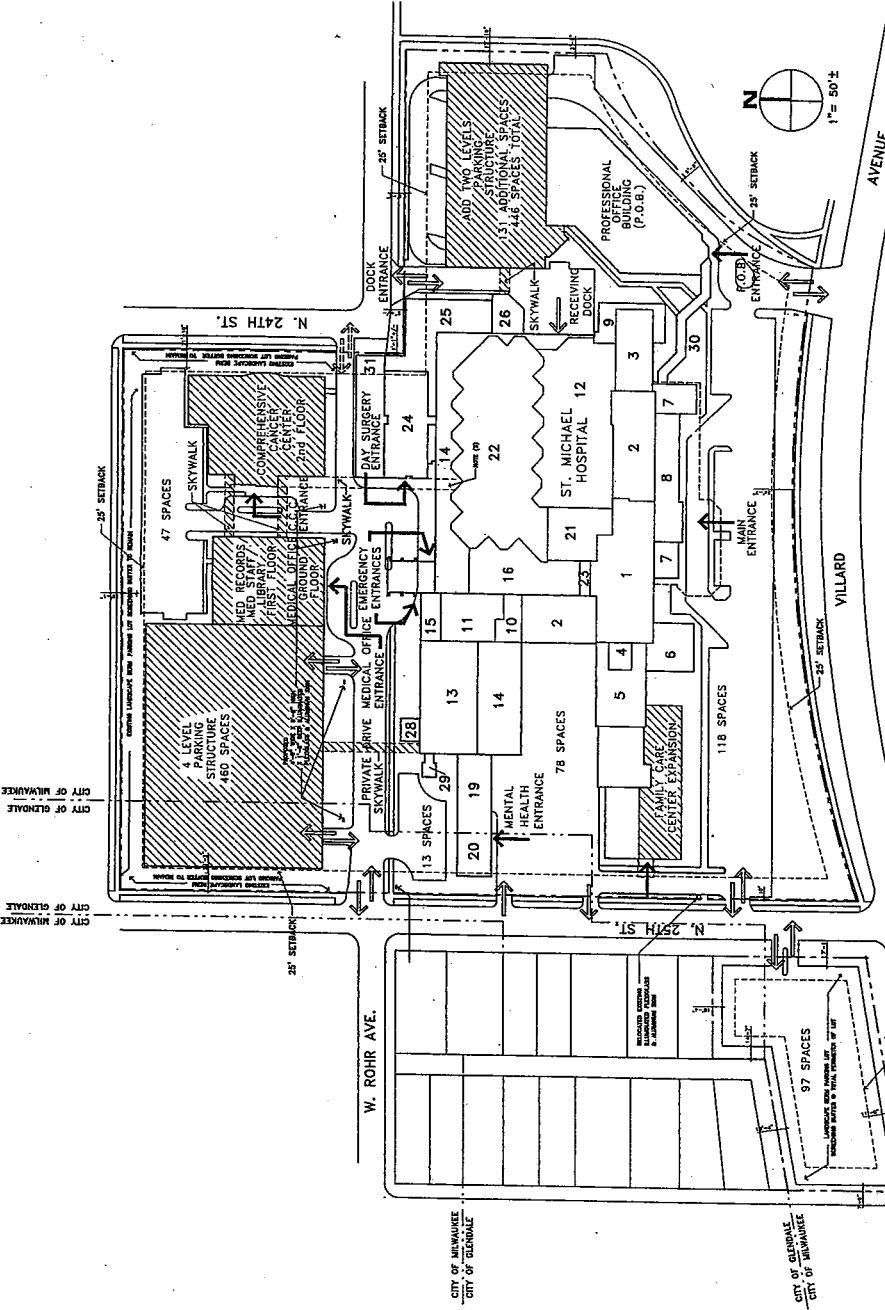

PROPOSED EXPANSION SITE PLAN

- VEHICULAR CIRCULATION
- SECONDARY VEHICULAR CIRCULATION
- PEDESTRIAN CIRCULATION

ONES LAND AREA: 578,220 SF (13,274 ACRES)
 LAND DEVOTED TO PARKING, DRIVES & PARKING STRUCTURES: 218,048 SF
 LAND DEVOTED TO UNIMPROVED OPEN SPACE: 116,233 SF
 TOTAL LAND AREA: 894,491 SF
 PROPOSED NUMBER OF BUILDINGS: 1 BUILDING, 2 BUILDING ADDITIONS, 1 PARKING STRUCTURE, AND 1 PARKING STRUCTURE ADDITION
 PARKING SPACES PROVIDED: 1,283 (547 SURFACE PARKING & 736 STRUCTURE PARKING)
 PARKING SPACES PROVIDED PER THOUSAND SQUARE FEET OF BUILDING AREA: 1.5878

GP44

11/20/2019 10:23:19 AM

ST. MICHAEL HOSPITAL

AMBULATORY SURGERY RENOVATIONS & EMERGENCY GENERATOR BUILDING MILWAUKEE, WISCONSIN

DETAIL PLAN DEVELOPMENT

OWNER
 COVENANT HEALTHCARE SYSTEM, INC.
 1126 SOUTH 70TH STREET, SUITE S308
 MILWAUKEE, WISCONSIN 53214
 PHONE: (414)488-2389

ARCHITECT
 BLM / CRA, Inc.
 2520 RENAISSANCE BOULEVARD
 KING OF PRUSSIA, PA 19406
 PHONE: (610) 270-0589

ENGINEERS
 ARNOLD & O'SHERIDAN, INC.
 1111 DENING WAY
 MADISON, WI 53717
 (608) 821-6500

- DRAWING LIST:**
- 000 COVER SHEET
 - 001 PLAN INDEX
 - 002 PLANNING STUDY
 - 003 PRELIMINARY SITES PLAN - GENERAL
 - 004 PRELIMINARY SITES PLAN - DETAILED
 - 005 SITE CONCEPT PLAN
 - 006 SITE LAYOUT PLAN
 - 007 SITE LAYOUT PLAN
 - 008 SITE LAYOUT PLAN
 - 009 SITE LAYOUT PLAN
 - 010 PARKING GARAGE FLOOR PLAN
 - 011 PARKING GARAGE FLOOR PLAN
 - 012 PARKING GARAGE FLOOR PLAN
 - 013 PARKING GARAGE FLOOR PLAN
 - 014 PARKING GARAGE FLOOR PLAN
 - 015 PARKING GARAGE FLOOR PLAN
 - 016 PARKING GARAGE FLOOR PLAN
 - 017 PARKING GARAGE FLOOR PLAN
 - 018 PARKING GARAGE FLOOR PLAN
 - 019 PARKING GARAGE FLOOR PLAN
 - 020 PARKING GARAGE FLOOR PLAN
 - 021 PARKING GARAGE FLOOR PLAN
 - 022 PARKING GARAGE FLOOR PLAN
 - 023 PARKING GARAGE FLOOR PLAN
 - 024 PARKING GARAGE FLOOR PLAN
 - 025 PARKING GARAGE FLOOR PLAN
 - 026 PARKING GARAGE FLOOR PLAN
 - 027 PARKING GARAGE FLOOR PLAN
 - 028 PARKING GARAGE FLOOR PLAN
 - 029 PARKING GARAGE FLOOR PLAN
 - 030 PARKING GARAGE FLOOR PLAN
 - 031 PARKING GARAGE FLOOR PLAN
 - 032 PARKING GARAGE FLOOR PLAN
 - 033 PARKING GARAGE FLOOR PLAN
 - 034 PARKING GARAGE FLOOR PLAN
 - 035 PARKING GARAGE FLOOR PLAN
 - 036 PARKING GARAGE FLOOR PLAN
 - 037 PARKING GARAGE FLOOR PLAN
 - 038 PARKING GARAGE FLOOR PLAN
 - 039 PARKING GARAGE FLOOR PLAN
 - 040 PARKING GARAGE FLOOR PLAN
 - 041 PARKING GARAGE FLOOR PLAN
 - 042 PARKING GARAGE FLOOR PLAN
 - 043 PARKING GARAGE FLOOR PLAN
 - 044 PARKING GARAGE FLOOR PLAN
 - 045 PARKING GARAGE FLOOR PLAN
 - 046 PARKING GARAGE FLOOR PLAN
 - 047 PARKING GARAGE FLOOR PLAN
 - 048 PARKING GARAGE FLOOR PLAN
 - 049 PARKING GARAGE FLOOR PLAN
 - 050 PARKING GARAGE FLOOR PLAN
 - 051 PARKING GARAGE FLOOR PLAN
 - 052 PARKING GARAGE FLOOR PLAN
 - 053 PARKING GARAGE FLOOR PLAN
 - 054 PARKING GARAGE FLOOR PLAN
 - 055 PARKING GARAGE FLOOR PLAN
 - 056 PARKING GARAGE FLOOR PLAN
 - 057 PARKING GARAGE FLOOR PLAN
 - 058 PARKING GARAGE FLOOR PLAN
 - 059 PARKING GARAGE FLOOR PLAN
 - 060 PARKING GARAGE FLOOR PLAN
 - 061 PARKING GARAGE FLOOR PLAN
 - 062 PARKING GARAGE FLOOR PLAN
 - 063 PARKING GARAGE FLOOR PLAN
 - 064 PARKING GARAGE FLOOR PLAN
 - 065 PARKING GARAGE FLOOR PLAN
 - 066 PARKING GARAGE FLOOR PLAN
 - 067 PARKING GARAGE FLOOR PLAN
 - 068 PARKING GARAGE FLOOR PLAN
 - 069 PARKING GARAGE FLOOR PLAN
 - 070 PARKING GARAGE FLOOR PLAN
 - 071 PARKING GARAGE FLOOR PLAN
 - 072 PARKING GARAGE FLOOR PLAN
 - 073 PARKING GARAGE FLOOR PLAN
 - 074 PARKING GARAGE FLOOR PLAN
 - 075 PARKING GARAGE FLOOR PLAN
 - 076 PARKING GARAGE FLOOR PLAN
 - 077 PARKING GARAGE FLOOR PLAN
 - 078 PARKING GARAGE FLOOR PLAN
 - 079 PARKING GARAGE FLOOR PLAN
 - 080 PARKING GARAGE FLOOR PLAN
 - 081 PARKING GARAGE FLOOR PLAN
 - 082 PARKING GARAGE FLOOR PLAN
 - 083 PARKING GARAGE FLOOR PLAN
 - 084 PARKING GARAGE FLOOR PLAN
 - 085 PARKING GARAGE FLOOR PLAN
 - 086 PARKING GARAGE FLOOR PLAN
 - 087 PARKING GARAGE FLOOR PLAN
 - 088 PARKING GARAGE FLOOR PLAN
 - 089 PARKING GARAGE FLOOR PLAN
 - 090 PARKING GARAGE FLOOR PLAN
 - 091 PARKING GARAGE FLOOR PLAN
 - 092 PARKING GARAGE FLOOR PLAN
 - 093 PARKING GARAGE FLOOR PLAN
 - 094 PARKING GARAGE FLOOR PLAN
 - 095 PARKING GARAGE FLOOR PLAN
 - 096 PARKING GARAGE FLOOR PLAN
 - 097 PARKING GARAGE FLOOR PLAN
 - 098 PARKING GARAGE FLOOR PLAN
 - 099 PARKING GARAGE FLOOR PLAN
 - 100 PARKING GARAGE FLOOR PLAN

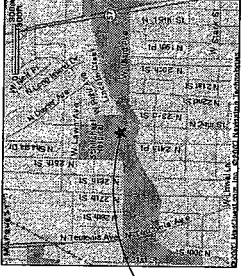
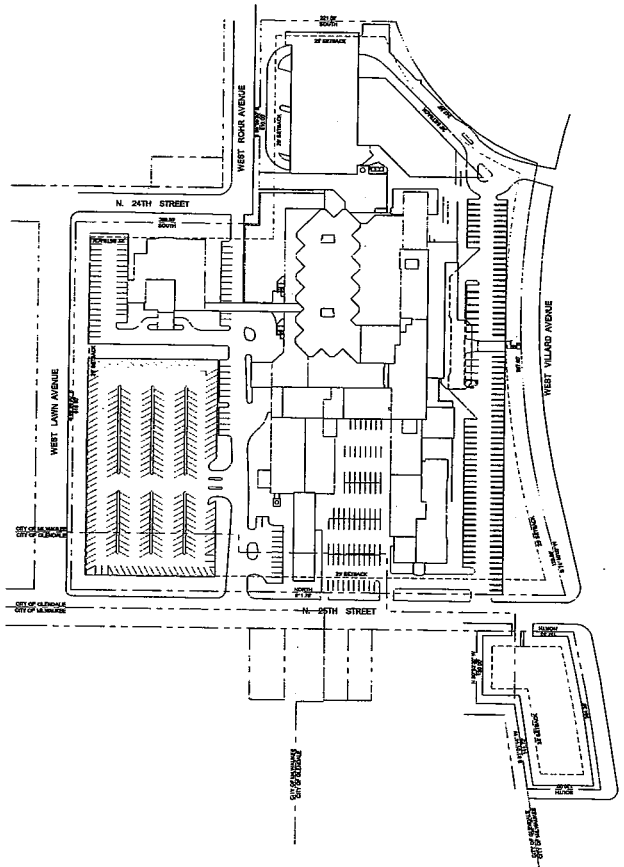

(R) PROJECT LOCATION PLAN
 SCALE: 1"=50'

(F) SITE PLAN
 SCALE: 1"=50'

BEAC 1 2 3 4 5 6

A

B

C

D

E

F

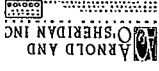

BLM ARCHITECTS
2820 Massachusetts Blvd, P.O. Box 100, Philadelphia, PA 19104

ST. MICHAEL HOSPITAL
AMBULATORY SURGERY
MILWAUKEE, WISCONSIN

SHEET TITLE
VICTORY MAP

St. Michael Hospital
AMBULATORY SURGERY
MILWAUKEE, WISCONSIN

NO.	DESCRIPTION	DATE
1		
2		
3		
4		
5		
6		
7		
8		
9		
10		
11		
12		
13		
14		
15		
16		
17		
18		
19		
20		

SHEET NO. 100

100

8
7
6
5
4
3
2

A B C D E F

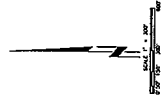
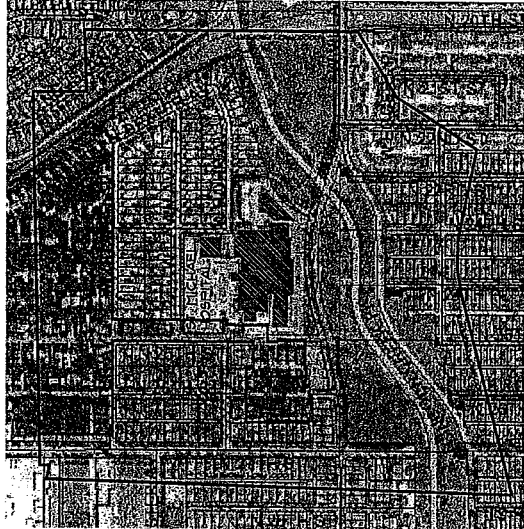

MAP AND ORTHOPHOTO OBTAINED FROM THE CITY OF MILWAUKEE - MAP MILWAUKEE PROGRAM

0
1
2
3
4
5
6
7
8

BLM
ARCHITECTS
3520 Renaissance Blvd. King of Prussia, PA 19151
LAWRENCE, MICHIGAN

ST. MICHAEL HOSPITAL
AMBULATORY SURGERY

St. Michael's Hospital
CONTRACT

SHEET NO.	002
DATE	
DESIGNED BY	
CHECKED BY	
IN CHARGE	

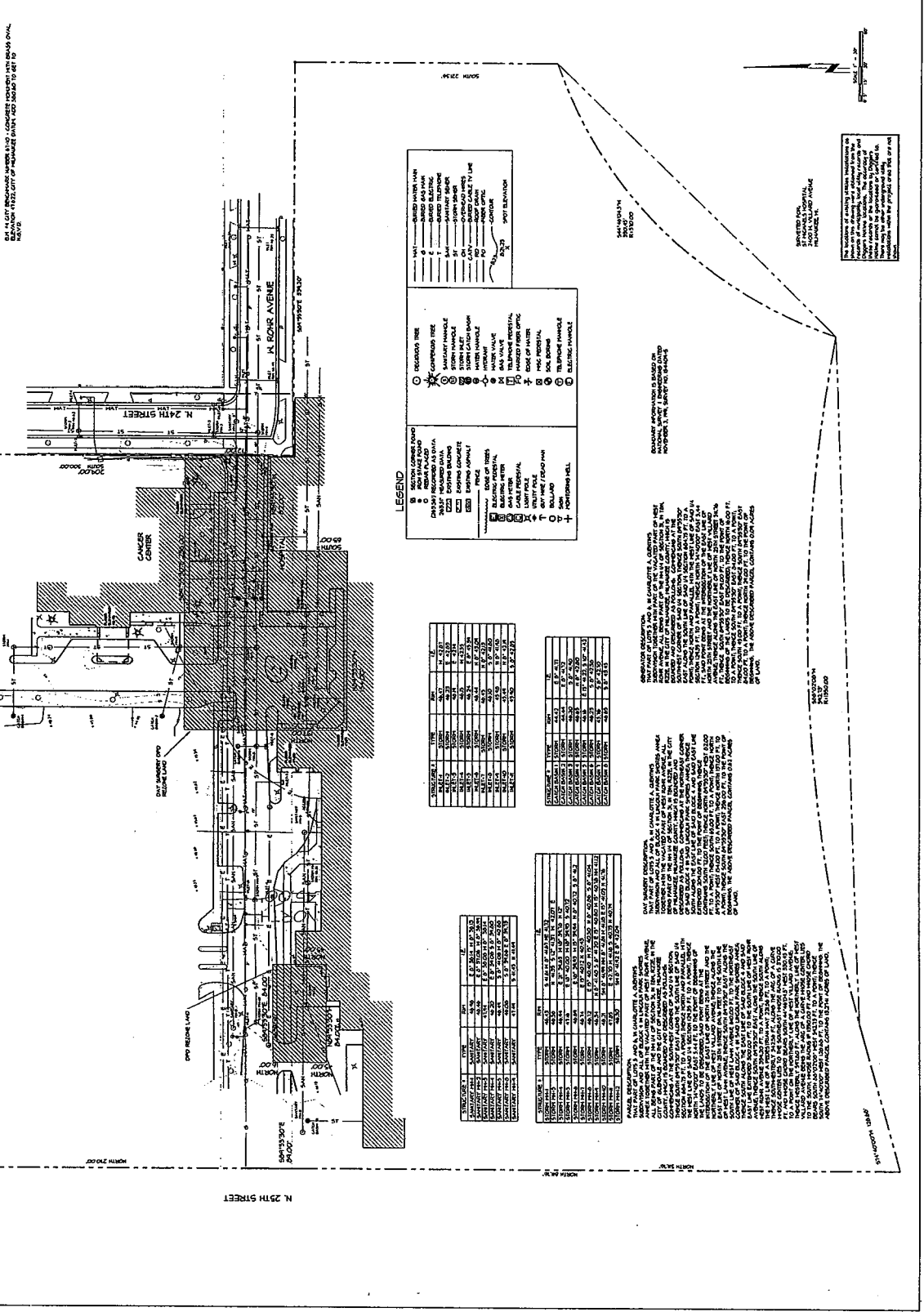

- ### LEGEND
- SECTION CORNER MARK
 - REBAR WALL
 - CONCRETE WALL
 - CONCRETE FLOOR
 - CONCRETE SLAB
 - CONCRETE SLAB WITH DIMENSION
 - CONCRETE SLAB WITH DIMENSION AND AREA
 - CONCRETE SLAB WITH DIMENSION AND AREA AND PERCENTAGE
 - CONCRETE SLAB WITH DIMENSION AND AREA AND PERCENTAGE AND FINISH
 - CONCRETE SLAB WITH DIMENSION AND AREA AND PERCENTAGE AND FINISH AND AREA
 - CONCRETE SLAB WITH DIMENSION AND AREA AND PERCENTAGE AND FINISH AND AREA AND PERCENTAGE
 - CONCRETE SLAB WITH DIMENSION AND AREA AND PERCENTAGE AND FINISH AND AREA AND PERCENTAGE AND FINISH
 - CONCRETE SLAB WITH DIMENSION AND AREA AND PERCENTAGE AND FINISH AND AREA AND PERCENTAGE AND FINISH AND AREA
 - CONCRETE SLAB WITH DIMENSION AND AREA AND PERCENTAGE AND FINISH AND AREA AND PERCENTAGE AND FINISH AND AREA AND PERCENTAGE
 - CONCRETE SLAB WITH DIMENSION AND AREA AND PERCENTAGE AND FINISH AND AREA AND PERCENTAGE AND FINISH AND AREA AND PERCENTAGE AND FINISH
 - CONCRETE SLAB WITH DIMENSION AND AREA AND PERCENTAGE AND FINISH AND AREA AND PERCENTAGE AND FINISH AND AREA AND PERCENTAGE AND FINISH AND AREA
 - CONCRETE SLAB WITH DIMENSION AND AREA AND PERCENTAGE AND FINISH AND AREA AND PERCENTAGE AND FINISH AND AREA AND PERCENTAGE AND FINISH AND AREA AND PERCENTAGE
 - CONCRETE SLAB WITH DIMENSION AND AREA AND PERCENTAGE AND FINISH AND AREA AND PERCENTAGE AND FINISH AND AREA AND PERCENTAGE AND FINISH AND AREA AND PERCENTAGE AND FINISH
 - CONCRETE SLAB WITH DIMENSION AND AREA AND PERCENTAGE AND FINISH AND AREA AND PERCENTAGE AND FINISH AND AREA AND PERCENTAGE AND FINISH AND AREA AND PERCENTAGE AND FINISH AND AREA
 - CONCRETE SLAB WITH DIMENSION AND AREA AND PERCENTAGE AND FINISH AND AREA AND PERCENTAGE AND FINISH AND AREA AND PERCENTAGE AND FINISH AND AREA AND PERCENTAGE AND FINISH AND AREA AND PERCENTAGE
 - CONCRETE SLAB WITH DIMENSION AND AREA AND PERCENTAGE AND FINISH AND AREA AND PERCENTAGE AND FINISH AND AREA AND PERCENTAGE AND FINISH AND AREA AND PERCENTAGE AND FINISH AND AREA AND PERCENTAGE AND FINISH
 - CONCRETE SLAB WITH DIMENSION AND AREA AND PERCENTAGE AND FINISH AND AREA AND PERCENTAGE AND FINISH AND AREA AND PERCENTAGE AND FINISH AND AREA AND PERCENTAGE AND FINISH AND AREA AND PERCENTAGE AND FINISH AND AREA
 - CONCRETE SLAB WITH DIMENSION AND AREA AND PERCENTAGE AND FINISH AND AREA AND PERCENTAGE AND FINISH AND AREA AND PERCENTAGE AND FINISH AND AREA AND PERCENTAGE AND FINISH AND AREA AND PERCENTAGE AND FINISH AND AREA AND PERCENTAGE
 - CONCRETE SLAB WITH DIMENSION AND AREA AND PERCENTAGE AND FINISH AND AREA AND PERCENTAGE AND FINISH AND AREA AND PERCENTAGE AND FINISH AND AREA AND PERCENTAGE AND FINISH AND AREA AND PERCENTAGE AND FINISH AND AREA AND PERCENTAGE AND FINISH
 - CONCRETE SLAB WITH DIMENSION AND AREA AND PERCENTAGE AND FINISH AND AREA AND PERCENTAGE AND FINISH AND AREA AND PERCENTAGE AND FINISH AND AREA AND PERCENTAGE AND FINISH AND AREA AND PERCENTAGE AND FINISH AND AREA AND PERCENTAGE AND FINISH AND AREA
 - CONCRETE SLAB WITH DIMENSION AND AREA AND PERCENTAGE AND FINISH AND AREA AND PERCENTAGE AND FINISH AND AREA AND PERCENTAGE AND FINISH AND AREA AND PERCENTAGE AND FINISH AND AREA AND PERCENTAGE AND FINISH AND AREA AND PERCENTAGE AND FINISH AND AREA AND PERCENTAGE
 - CONCRETE SLAB WITH DIMENSION AND AREA AND PERCENTAGE AND FINISH AND AREA AND PERCENTAGE AND FINISH AND AREA AND PERCENTAGE AND FINISH AND AREA AND PERCENTAGE AND FINISH AND AREA AND PERCENTAGE AND FINISH AND AREA AND PERCENTAGE AND FINISH AND AREA AND PERCENTAGE AND FINISH
 - CONCRETE SLAB WITH DIMENSION AND AREA AND PERCENTAGE AND FINISH AND AREA AND PERCENTAGE AND FINISH AND AREA AND PERCENTAGE AND FINISH AND AREA AND PERCENTAGE AND FINISH AND AREA AND PERCENTAGE AND FINISH AND AREA AND PERCENTAGE AND FINISH AND AREA AND PERCENTAGE AND FINISH AND AREA AND PERCENTAGE
 - CONCRETE SLAB WITH DIMENSION AND AREA AND PERCENTAGE AND FINISH AND AREA AND PERCENTAGE AND FINISH AND AREA AND PERCENTAGE AND FINISH AND AREA AND PERCENTAGE AND FINISH AND AREA AND PERCENTAGE AND FINISH AND AREA AND PERCENTAGE AND FINISH AND AREA AND PERCENTAGE AND FINISH AND AREA AND PERCENTAGE AND FINISH
 - CONCRETE SLAB WITH DIMENSION AND AREA AND PERCENTAGE AND FINISH AND AREA AND PERCENTAGE AND FINISH AND AREA AND PERCENTAGE AND FINISH AND AREA AND PERCENTAGE AND FINISH AND AREA AND PERCENTAGE AND FINISH AND AREA AND PERCENTAGE AND FINISH AND AREA AND PERCENTAGE AND FINISH AND AREA AND PERCENTAGE AND FINISH AND AREA AND PERCENTAGE AND FINISH AND AREA AND PERCENTAGE

ITEM	QTY	UNIT	PRICE	TOTAL
CONCRETE SLAB	100	SQ YD	10.00	1000.00
CONCRETE WALL	50	LF	20.00	1000.00
CONCRETE FLOOR	200	SQ YD	5.00	1000.00
CONCRETE SLAB WITH DIMENSION	150	SQ YD	15.00	2250.00
CONCRETE SLAB WITH DIMENSION AND AREA	100	SQ YD	20.00	2000.00
CONCRETE SLAB WITH DIMENSION AND AREA AND PERCENTAGE	50	SQ YD	30.00	1500.00
CONCRETE SLAB WITH DIMENSION AND AREA AND PERCENTAGE AND FINISH	25	SQ YD	40.00	1000.00
CONCRETE SLAB WITH DIMENSION AND AREA AND PERCENTAGE AND FINISH AND AREA	10	SQ YD	50.00	500.00
CONCRETE SLAB WITH DIMENSION AND AREA AND PERCENTAGE AND FINISH AND AREA AND PERCENTAGE	5	SQ YD	60.00	300.00
CONCRETE SLAB WITH DIMENSION AND AREA AND PERCENTAGE AND FINISH AND AREA AND PERCENTAGE AND FINISH	2	SQ YD	70.00	140.00
CONCRETE SLAB WITH DIMENSION AND AREA AND PERCENTAGE AND FINISH AND AREA AND PERCENTAGE AND FINISH AND AREA AND PERCENTAGE	1	SQ YD	80.00	80.00
CONCRETE SLAB WITH DIMENSION AND AREA AND PERCENTAGE AND FINISH AND AREA AND PERCENTAGE AND FINISH AND AREA AND PERCENTAGE AND FINISH AND AREA AND PERCENTAGE	0.5	SQ YD	90.00	45.00
CONCRETE SLAB WITH DIMENSION AND AREA AND PERCENTAGE AND FINISH AND AREA AND PERCENTAGE AND FINISH AND AREA AND PERCENTAGE AND FINISH AND AREA AND PERCENTAGE AND FINISH AND AREA AND PERCENTAGE	0.25	SQ YD	100.00	25.00

NOTES:

- ALL ELEVATIONS ARE CITY OF PHILADELPHIA DASH.
- CONCRETE REINFORCING TO BE PERMITTED.
- SEE SHEET 001 FOR UTILITY LOCATIONS.
- SEE SHEET 003 FOR UTILITY LOCATIONS.
- SEE SHEET 004 FOR UTILITY LOCATIONS.
- SEE SHEET 005 FOR UTILITY LOCATIONS.
- SEE SHEET 006 FOR UTILITY LOCATIONS.
- SEE SHEET 007 FOR UTILITY LOCATIONS.
- SEE SHEET 008 FOR UTILITY LOCATIONS.
- SEE SHEET 009 FOR UTILITY LOCATIONS.
- SEE SHEET 010 FOR UTILITY LOCATIONS.
- SEE SHEET 011 FOR UTILITY LOCATIONS.
- SEE SHEET 012 FOR UTILITY LOCATIONS.
- SEE SHEET 013 FOR UTILITY LOCATIONS.
- SEE SHEET 014 FOR UTILITY LOCATIONS.
- SEE SHEET 015 FOR UTILITY LOCATIONS.
- SEE SHEET 016 FOR UTILITY LOCATIONS.
- SEE SHEET 017 FOR UTILITY LOCATIONS.
- SEE SHEET 018 FOR UTILITY LOCATIONS.
- SEE SHEET 019 FOR UTILITY LOCATIONS.
- SEE SHEET 020 FOR UTILITY LOCATIONS.

ST. MICHAEL'S HOSPITAL
1415 Locust Street, Philadelphia, PA 19106
TEL: 215-625-2000
WWW.STMICHAELSHOSPITAL.PHILADELPHIA.PA



BLM/CRA
INC.

ST. MICHAEL HOSPITAL
DETAILED PLAN DEVELOPMENT
EXISTING FACILITIES SITE PLAN - GENERAL

PROJECT TITLE	EXISTING FACILITIES SITE PLAN - GENERAL
DATE	5/23/03
PROJECT NO.	243
CONTRACT NO.	
SHEET NO.	003

003
VI

CITY PLAN COMMISSION SUBMISSION - 05/23/03

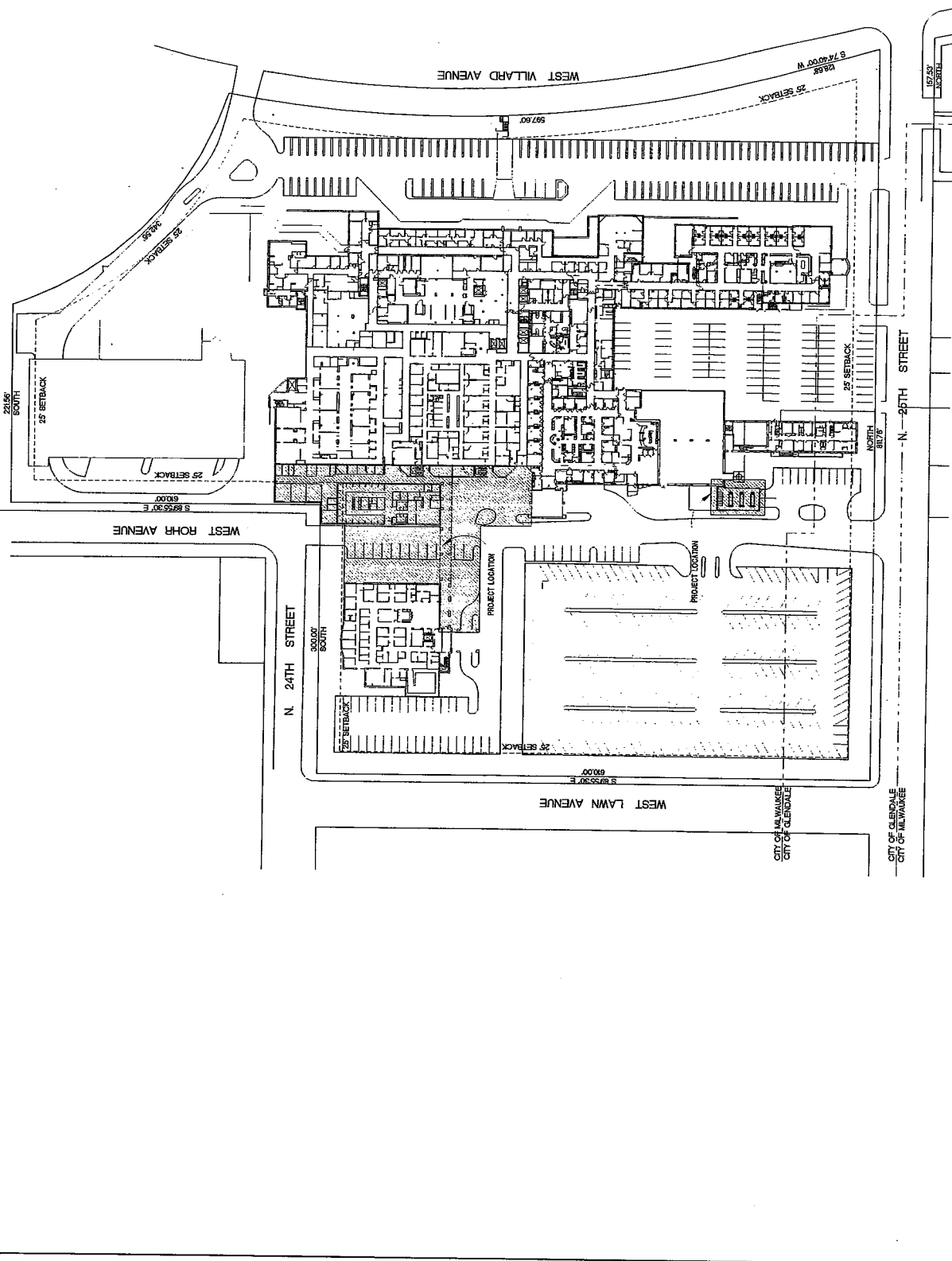

(R) EXISTING FACILITIES SITE PLAN - GENERAL
PAGE 144

A B C D E F

A B C D E F

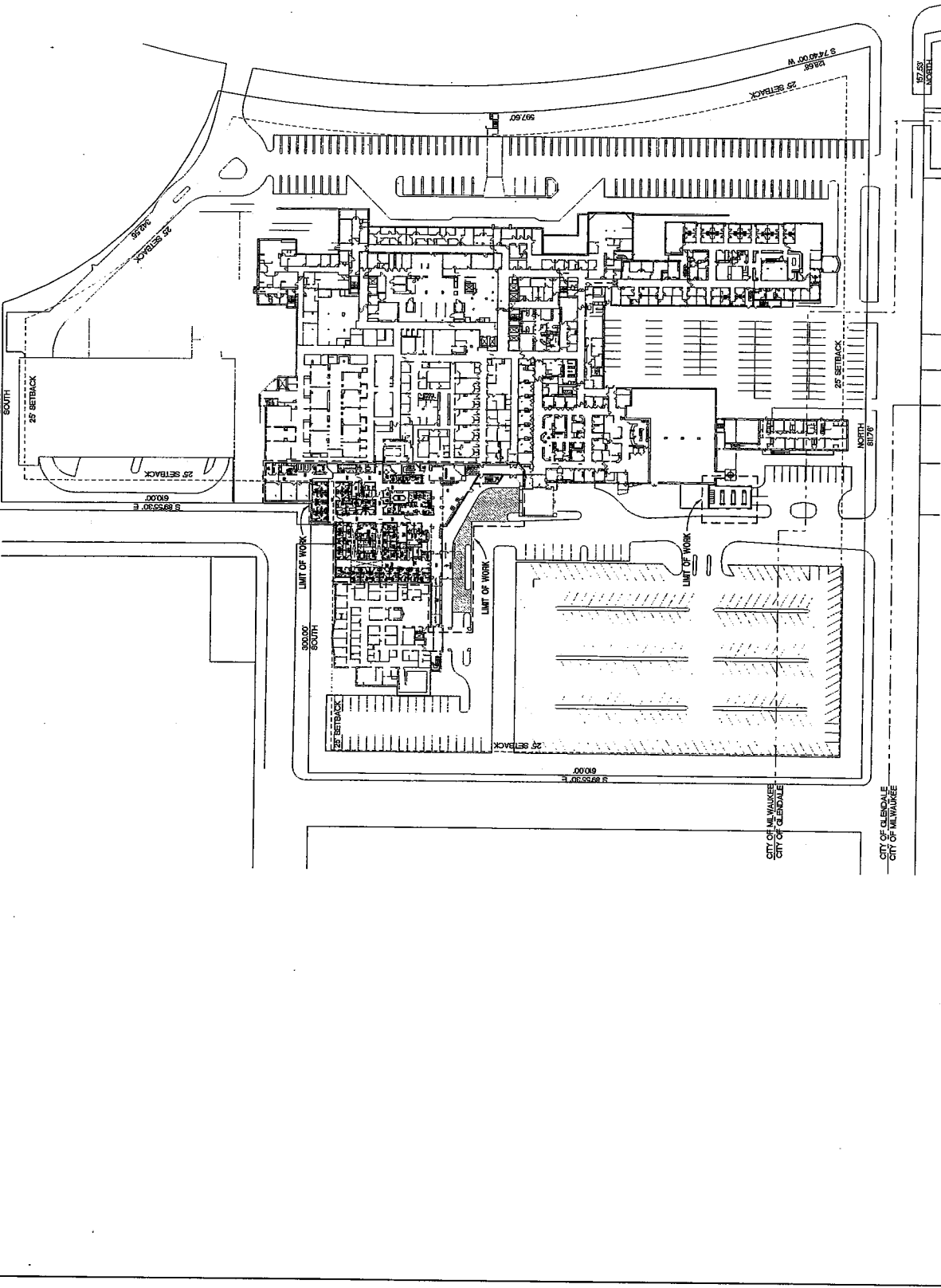

PROPOSED EXPANSION SITE PLAN - GENERAL
SCALE: AS SHOWN

CITY PLAN COMMISSION SUBMISSION - 05/29/03



BLM/CRA
INC.

ST. MICHAEL HOSPITAL
DETAILED PLAN DEVELOPMENT
PROPOSED EXPANSION SITE PLAN - GENERAL

PROJECT NO.	2481
DATE	05/29/03
SHEET NO.	004
TOTAL SHEETS	10

ST. MICHAEL HOSPITAL
3500 PONDVIEW BLVD
MILWAUKEE, WI 53227
TEL: 414-224-2200
WWW.STMICHAELHOSPITAL.COM

SHEET NO. 005

SHEET TITLE SITE PLAN

St. Michael Hospital

Convent

DATE	NOV 11 2003
BY	BLM ARCHITECTS
CHECKED BY	BLM ARCHITECTS
SCALE	AS SHOWN
PROJECT NO.	005
SHEET NO.	005
SHEET TITLE	SITE PLAN

ST. MICHAEL HOSPITAL
AMBULATORY SURGERY
MILWAUKEE, WISCONSIN

BLM
ARCHITECTS
2520 Philadelphia Blvd. King of Prussia, PA 19106

ARNOLD AND
SHERIDAN INC.
ARCHITECTS
1500 MARKET STREET
PHILADELPHIA, PA 19102

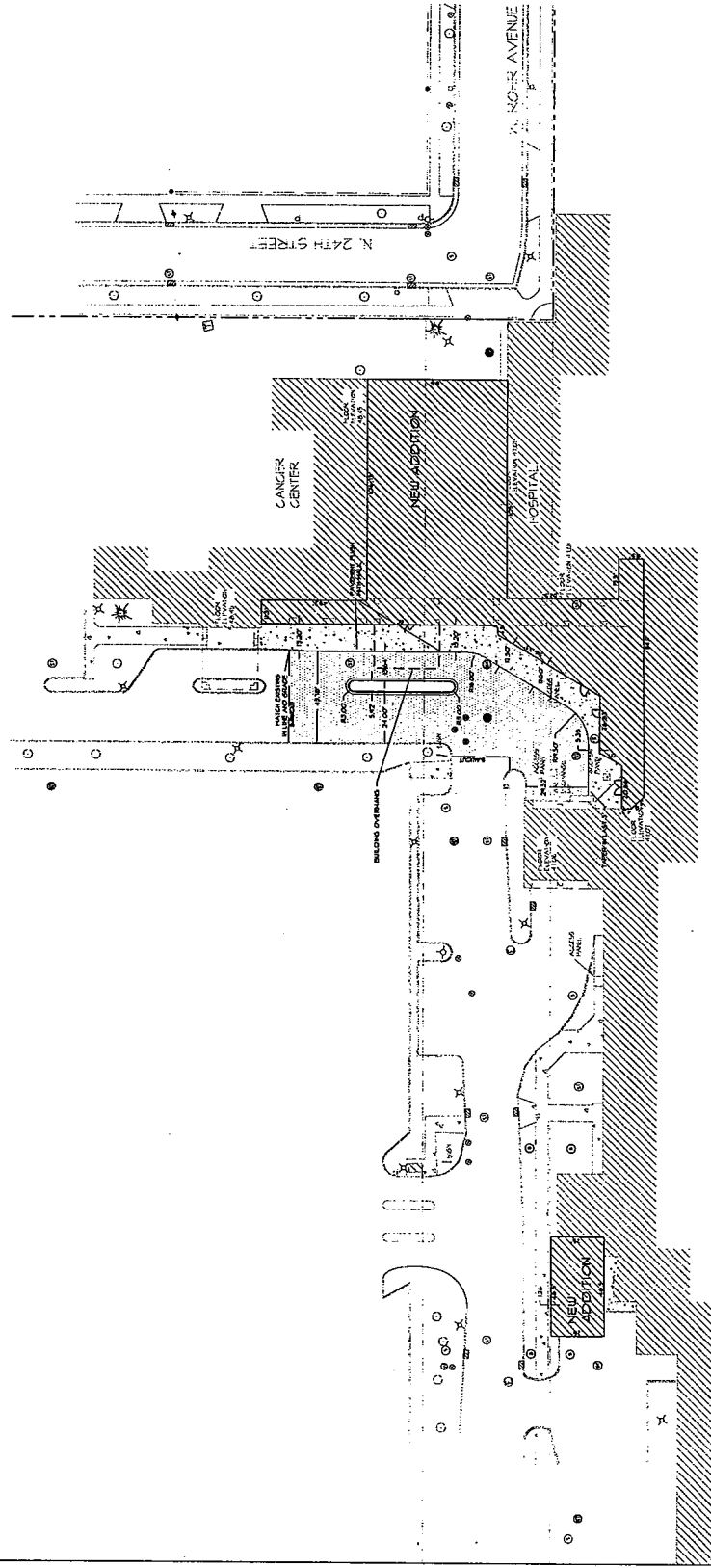

LEGEND

○	PROPOSED TREE
○	EXISTING TREE
○	PROPOSED WATER TANK
○	EXISTING WATER TANK
○	PROPOSED ELECTRICAL
○	EXISTING ELECTRICAL
○	PROPOSED SLOPE
○	EXISTING SLOPE
○	PROPOSED STORM DRAIN
○	EXISTING STORM DRAIN
○	PROPOSED WATER MAIN
○	EXISTING WATER MAIN
○	PROPOSED GAS
○	EXISTING GAS
○	PROPOSED CABLE TV
○	EXISTING CABLE TV
○	PROPOSED FIBER OPTIC
○	EXISTING FIBER OPTIC
○	PROPOSED TELEPHONE
○	EXISTING TELEPHONE
○	PROPOSED ELECTRICAL
○	EXISTING ELECTRICAL



DATE	DESCRIPTION

1 2 3 4 5 6 7 8

A B C D E F

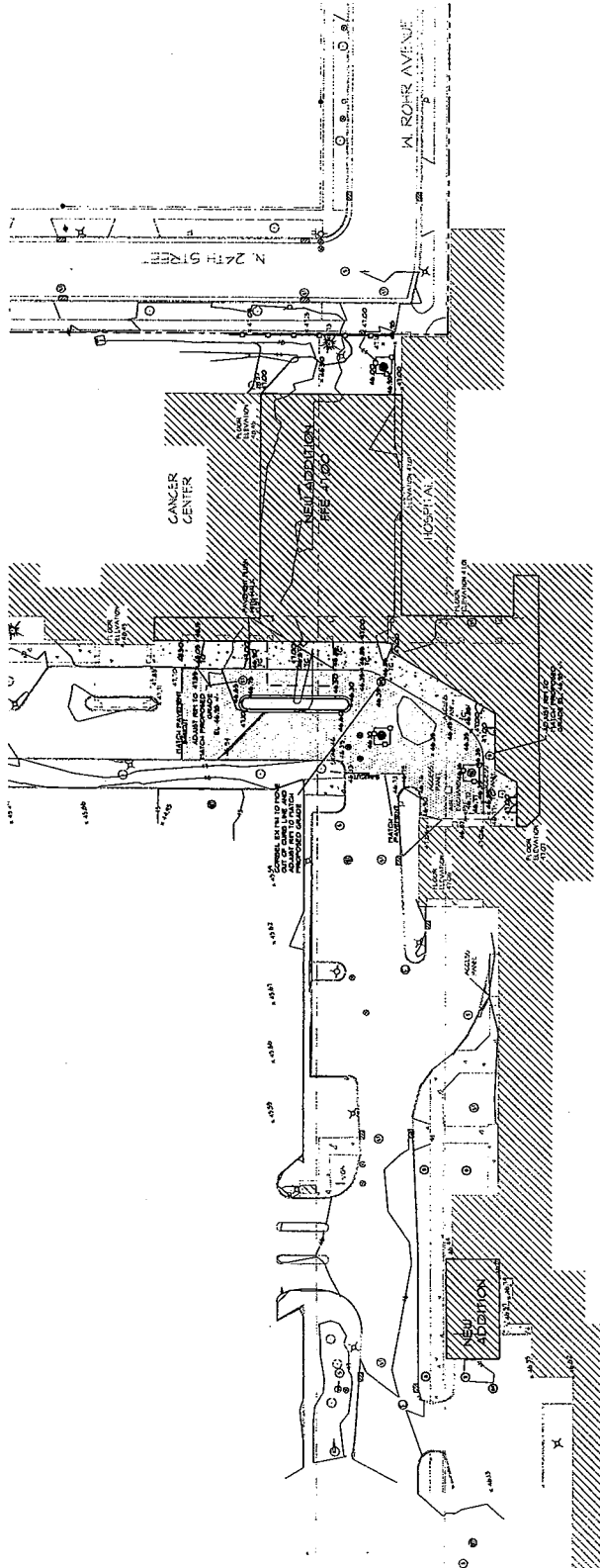

LEGEND

1	3/4" DIA. CONCRETE RING	1	CONCRETE TIE	1	1" DIA. RIGID PIPING
2	1" DIA. CONCRETE RING	2	CONCRETE TIE	2	2" DIA. RIGID PIPING
3	2" DIA. CONCRETE RING	3	CONCRETE TIE	3	3" DIA. RIGID PIPING
4	3" DIA. CONCRETE RING	4	CONCRETE TIE	4	4" DIA. RIGID PIPING
5	4" DIA. CONCRETE RING	5	CONCRETE TIE	5	5" DIA. RIGID PIPING
6	5" DIA. CONCRETE RING	6	CONCRETE TIE	6	6" DIA. RIGID PIPING
7	6" DIA. CONCRETE RING	7	CONCRETE TIE	7	7" DIA. RIGID PIPING
8	7" DIA. CONCRETE RING	8	CONCRETE TIE	8	8" DIA. RIGID PIPING
9	8" DIA. CONCRETE RING	9	CONCRETE TIE	9	9" DIA. RIGID PIPING
10	9" DIA. CONCRETE RING	10	CONCRETE TIE	10	10" DIA. RIGID PIPING
11	10" DIA. CONCRETE RING	11	CONCRETE TIE	11	11" DIA. RIGID PIPING
12	11" DIA. CONCRETE RING	12	CONCRETE TIE	12	12" DIA. RIGID PIPING
13	12" DIA. CONCRETE RING	13	CONCRETE TIE	13	13" DIA. RIGID PIPING
14	13" DIA. CONCRETE RING	14	CONCRETE TIE	14	14" DIA. RIGID PIPING
15	14" DIA. CONCRETE RING	15	CONCRETE TIE	15	15" DIA. RIGID PIPING
16	15" DIA. CONCRETE RING	16	CONCRETE TIE	16	16" DIA. RIGID PIPING
17	16" DIA. CONCRETE RING	17	CONCRETE TIE	17	17" DIA. RIGID PIPING
18	17" DIA. CONCRETE RING	18	CONCRETE TIE	18	18" DIA. RIGID PIPING
19	18" DIA. CONCRETE RING	19	CONCRETE TIE	19	19" DIA. RIGID PIPING
20	19" DIA. CONCRETE RING	20	CONCRETE TIE	20	20" DIA. RIGID PIPING
21	20" DIA. CONCRETE RING	21	CONCRETE TIE	21	21" DIA. RIGID PIPING
22	21" DIA. CONCRETE RING	22	CONCRETE TIE	22	22" DIA. RIGID PIPING
23	22" DIA. CONCRETE RING	23	CONCRETE TIE	23	23" DIA. RIGID PIPING
24	23" DIA. CONCRETE RING	24	CONCRETE TIE	24	24" DIA. RIGID PIPING
25	24" DIA. CONCRETE RING	25	CONCRETE TIE	25	25" DIA. RIGID PIPING
26	25" DIA. CONCRETE RING	26	CONCRETE TIE	26	26" DIA. RIGID PIPING
27	26" DIA. CONCRETE RING	27	CONCRETE TIE	27	27" DIA. RIGID PIPING
28	27" DIA. CONCRETE RING	28	CONCRETE TIE	28	28" DIA. RIGID PIPING
29	28" DIA. CONCRETE RING	29	CONCRETE TIE	29	29" DIA. RIGID PIPING
30	29" DIA. CONCRETE RING	30	CONCRETE TIE	30	30" DIA. RIGID PIPING
31	30" DIA. CONCRETE RING	31	CONCRETE TIE	31	31" DIA. RIGID PIPING
32	31" DIA. CONCRETE RING	32	CONCRETE TIE	32	32" DIA. RIGID PIPING
33	32" DIA. CONCRETE RING	33	CONCRETE TIE	33	33" DIA. RIGID PIPING
34	33" DIA. CONCRETE RING	34	CONCRETE TIE	34	34" DIA. RIGID PIPING
35	34" DIA. CONCRETE RING	35	CONCRETE TIE	35	35" DIA. RIGID PIPING
36	35" DIA. CONCRETE RING	36	CONCRETE TIE	36	36" DIA. RIGID PIPING
37	36" DIA. CONCRETE RING	37	CONCRETE TIE	37	37" DIA. RIGID PIPING
38	37" DIA. CONCRETE RING	38	CONCRETE TIE	38	38" DIA. RIGID PIPING
39	38" DIA. CONCRETE RING	39	CONCRETE TIE	39	39" DIA. RIGID PIPING
40	39" DIA. CONCRETE RING	40	CONCRETE TIE	40	40" DIA. RIGID PIPING
41	40" DIA. CONCRETE RING	41	CONCRETE TIE	41	41" DIA. RIGID PIPING
42	41" DIA. CONCRETE RING	42	CONCRETE TIE	42	42" DIA. RIGID PIPING
43	42" DIA. CONCRETE RING	43	CONCRETE TIE	43	43" DIA. RIGID PIPING
44	43" DIA. CONCRETE RING	44	CONCRETE TIE	44	44" DIA. RIGID PIPING
45	44" DIA. CONCRETE RING	45	CONCRETE TIE	45	45" DIA. RIGID PIPING
46	45" DIA. CONCRETE RING	46	CONCRETE TIE	46	46" DIA. RIGID PIPING
47	46" DIA. CONCRETE RING	47	CONCRETE TIE	47	47" DIA. RIGID PIPING
48	47" DIA. CONCRETE RING	48	CONCRETE TIE	48	48" DIA. RIGID PIPING
49	48" DIA. CONCRETE RING	49	CONCRETE TIE	49	49" DIA. RIGID PIPING
50	49" DIA. CONCRETE RING	50	CONCRETE TIE	50	50" DIA. RIGID PIPING

NOTES:
 1. ALL NEW CONCRETE SHALL BE 3000 PSI STRENGTH CONCRETE.
 2. ALL NEW CONCRETE SHALL BE CAST AND FINISHED TO THE PERMANENT GRADE.
 3. ALL NEW CONCRETE SHALL BE CAST AND FINISHED TO THE PERMANENT GRADE.
 4. ALL NEW CONCRETE SHALL BE CAST AND FINISHED TO THE PERMANENT GRADE.
 5. ALL NEW CONCRETE SHALL BE CAST AND FINISHED TO THE PERMANENT GRADE.
 6. ALL NEW CONCRETE SHALL BE CAST AND FINISHED TO THE PERMANENT GRADE.
 7. ALL NEW CONCRETE SHALL BE CAST AND FINISHED TO THE PERMANENT GRADE.
 8. ALL NEW CONCRETE SHALL BE CAST AND FINISHED TO THE PERMANENT GRADE.
 9. ALL NEW CONCRETE SHALL BE CAST AND FINISHED TO THE PERMANENT GRADE.
 10. ALL NEW CONCRETE SHALL BE CAST AND FINISHED TO THE PERMANENT GRADE.



ST. MICHAEL HOSPITAL
 AMBULATORY SURGERY
 350 Broadview Blvd King of Prussia, PA 19380
 BLM ARCHITECTS

ARNOLD AND SHERIDAN INC
 250 Broadview Blvd King of Prussia, PA 19380

1 2 3 4 5 6 7 8

A B C D E F

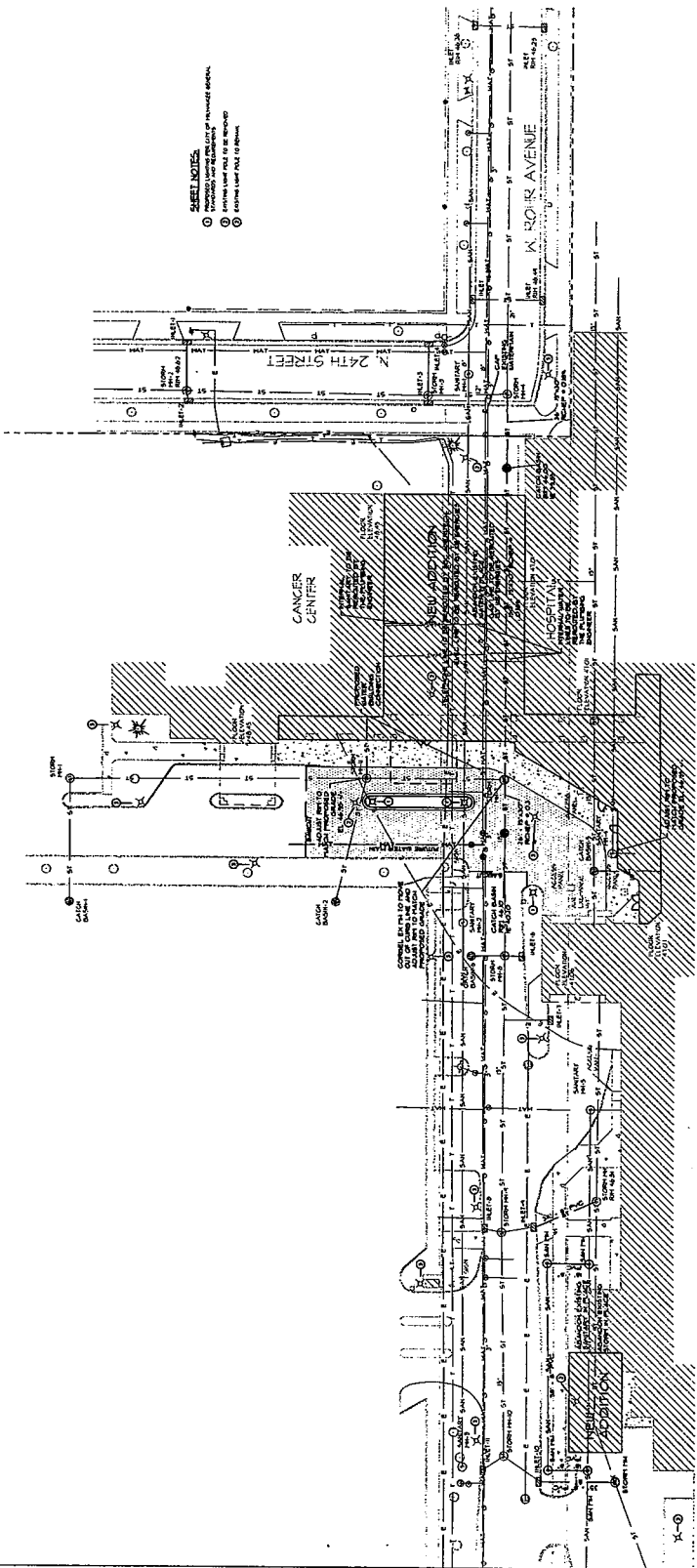

SHEET NOTES
 1. ALL UTILITIES SHOWN ARE BASED ON RECORD DRAWINGS AND FIELD SURVEY.
 2. ALL UTILITIES SHOWN ARE TO BE RELOCATED AS SHOWN.
 3. ALL UTILITIES SHOWN ARE TO BE RELOCATED TO THE NEW ADDITION.

LEGEND

1	EXISTING WATER MAIN
2	EXISTING SEWER MAIN
3	EXISTING GAS MAIN
4	EXISTING TELEPHONE MAIN
5	EXISTING CABLE MAIN
6	EXISTING LIGHTNING PROTECTION MAIN
7	EXISTING FIBER OPTIC MAIN
8	EXISTING WATER MAIN
9	EXISTING SEWER MAIN
10	EXISTING GAS MAIN
11	EXISTING TELEPHONE MAIN
12	EXISTING CABLE MAIN
13	EXISTING LIGHTNING PROTECTION MAIN
14	EXISTING FIBER OPTIC MAIN
15	EXISTING WATER MAIN
16	EXISTING SEWER MAIN
17	EXISTING GAS MAIN
18	EXISTING TELEPHONE MAIN
19	EXISTING CABLE MAIN
20	EXISTING LIGHTNING PROTECTION MAIN
21	EXISTING FIBER OPTIC MAIN

ITEM NO.	DESCRIPTION	QUANTITY	UNIT	PRICE	TOTAL
1	EXISTING WATER MAIN	100	LINEAL FEET	15.00	1500.00
2	EXISTING SEWER MAIN	100	LINEAL FEET	15.00	1500.00
3	EXISTING GAS MAIN	100	LINEAL FEET	15.00	1500.00
4	EXISTING TELEPHONE MAIN	100	LINEAL FEET	15.00	1500.00
5	EXISTING CABLE MAIN	100	LINEAL FEET	15.00	1500.00
6	EXISTING LIGHTNING PROTECTION MAIN	100	LINEAL FEET	15.00	1500.00
7	EXISTING FIBER OPTIC MAIN	100	LINEAL FEET	15.00	1500.00

ITEM NO.	DESCRIPTION	QUANTITY	UNIT	PRICE	TOTAL
1	EXISTING WATER MAIN	100	LINEAL FEET	15.00	1500.00
2	EXISTING SEWER MAIN	100	LINEAL FEET	15.00	1500.00
3	EXISTING GAS MAIN	100	LINEAL FEET	15.00	1500.00
4	EXISTING TELEPHONE MAIN	100	LINEAL FEET	15.00	1500.00
5	EXISTING CABLE MAIN	100	LINEAL FEET	15.00	1500.00
6	EXISTING LIGHTNING PROTECTION MAIN	100	LINEAL FEET	15.00	1500.00
7	EXISTING FIBER OPTIC MAIN	100	LINEAL FEET	15.00	1500.00

ITEM NO.	DESCRIPTION	QUANTITY	UNIT	PRICE	TOTAL
1	EXISTING WATER MAIN	100	LINEAL FEET	15.00	1500.00
2	EXISTING SEWER MAIN	100	LINEAL FEET	15.00	1500.00
3	EXISTING GAS MAIN	100	LINEAL FEET	15.00	1500.00
4	EXISTING TELEPHONE MAIN	100	LINEAL FEET	15.00	1500.00
5	EXISTING CABLE MAIN	100	LINEAL FEET	15.00	1500.00
6	EXISTING LIGHTNING PROTECTION MAIN	100	LINEAL FEET	15.00	1500.00
7	EXISTING FIBER OPTIC MAIN	100	LINEAL FEET	15.00	1500.00

ITEM NO.	DESCRIPTION	QUANTITY	UNIT	PRICE	TOTAL
1	EXISTING WATER MAIN	100	LINEAL FEET	15.00	1500.00
2	EXISTING SEWER MAIN	100	LINEAL FEET	15.00	1500.00
3	EXISTING GAS MAIN	100	LINEAL FEET	15.00	1500.00
4	EXISTING TELEPHONE MAIN	100	LINEAL FEET	15.00	1500.00
5	EXISTING CABLE MAIN	100	LINEAL FEET	15.00	1500.00
6	EXISTING LIGHTNING PROTECTION MAIN	100	LINEAL FEET	15.00	1500.00
7	EXISTING FIBER OPTIC MAIN	100	LINEAL FEET	15.00	1500.00

The location of existing utility lines is shown on this plan for information only. The location of existing utility lines is shown on this plan for information only. The location of existing utility lines is shown on this plan for information only.

ST. MICHAEL HOSPITAL
 AMBULATORY SURGERY
 LA. WYKER, WISCONSIN

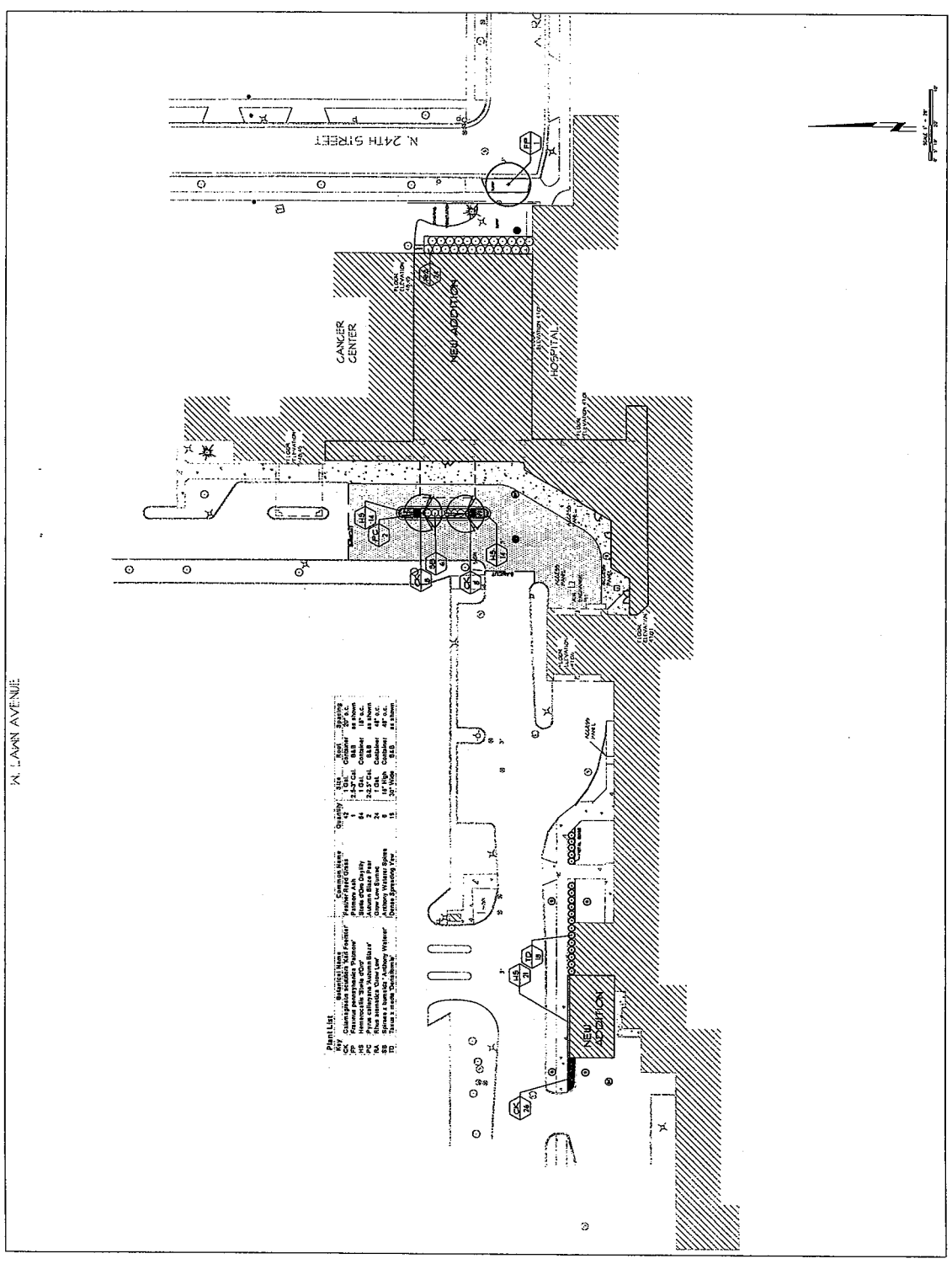

Plant List

Plant	Quantity	Notes
1	1	1' x 1' x 1' - 10' x 10' - 10' x 10' - 10' x 10'
2	1	2' x 2' - 10' x 10' - 10' x 10' - 10' x 10'
3	1	3' x 3' - 10' x 10' - 10' x 10' - 10' x 10'
4	1	4' x 4' - 10' x 10' - 10' x 10' - 10' x 10'
5	1	5' x 5' - 10' x 10' - 10' x 10' - 10' x 10'
6	1	6' x 6' - 10' x 10' - 10' x 10' - 10' x 10'
7	1	7' x 7' - 10' x 10' - 10' x 10' - 10' x 10'
8	1	8' x 8' - 10' x 10' - 10' x 10' - 10' x 10'
9	1	9' x 9' - 10' x 10' - 10' x 10' - 10' x 10'
10	1	10' x 10' - 10' x 10' - 10' x 10' - 10' x 10'

2 3 4 5 6 7 8
 A B C D E F

2 3 4 5 6 7 8

A

B

C

D

E

F

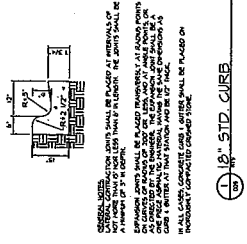
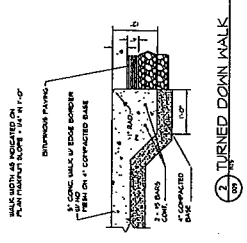
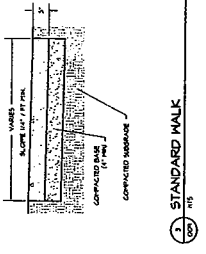
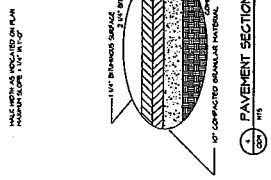
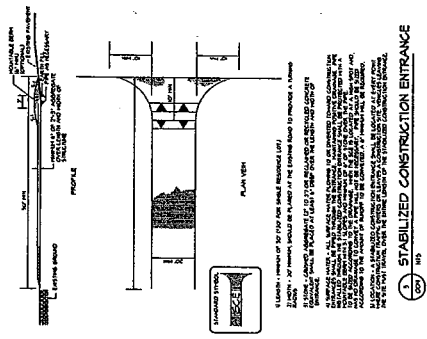
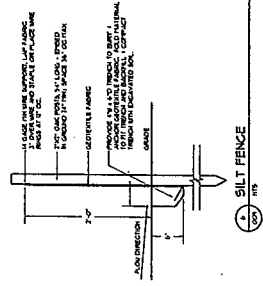
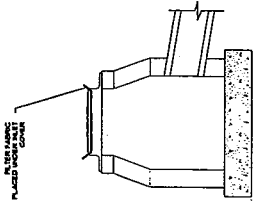
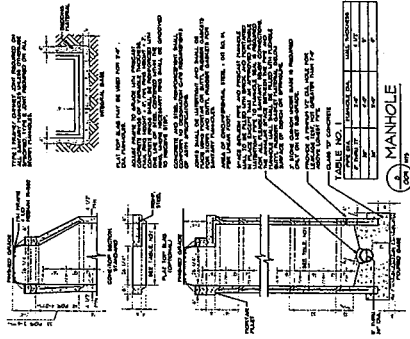
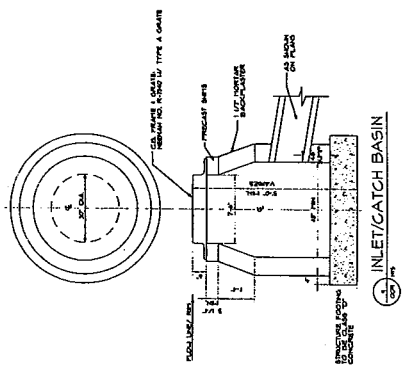

ARNOLD AND SHERIDAN INC
ARCHITECTS
1500 BROADWAY, SUITE 1000
PHILADELPHIA, PA 19102
TEL: 215-581-1000

BLM ARCHITECTS
3250 RIVERSIDE BLVD, 10TH FLOOR, PHILADELPHIA, PA 19104
TEL: 215-581-1000

**ST. MICHAEL HOSPITAL
AMBULATORY SURGERY**
LAWRENCE, WOODBURN

CONTRACT
SHEET TITLE
SITE DETAILS

NO.	DESCRIPTION	DATE
1	ISSUED FOR PERMIT	10/1/00
2	ISSUED FOR CONSTRUCTION	10/1/00
3	ISSUED FOR AS-BUILT	10/1/00
4	ISSUED FOR RECORD	10/1/00
5	ISSUED FOR FINAL	10/1/00
6	ISSUED FOR ARCHIVE	10/1/00
7	ISSUED FOR PROJECT CLOSE	10/1/00
8	ISSUED FOR PROJECT CLOSE	10/1/00
9	ISSUED FOR PROJECT CLOSE	10/1/00
10	ISSUED FOR PROJECT CLOSE	10/1/00
11	ISSUED FOR PROJECT CLOSE	10/1/00
12	ISSUED FOR PROJECT CLOSE	10/1/00
13	ISSUED FOR PROJECT CLOSE	10/1/00
14	ISSUED FOR PROJECT CLOSE	10/1/00
15	ISSUED FOR PROJECT CLOSE	10/1/00
16	ISSUED FOR PROJECT CLOSE	10/1/00
17	ISSUED FOR PROJECT CLOSE	10/1/00
18	ISSUED FOR PROJECT CLOSE	10/1/00
19	ISSUED FOR PROJECT CLOSE	10/1/00
20	ISSUED FOR PROJECT CLOSE	10/1/00
21	ISSUED FOR PROJECT CLOSE	10/1/00
22	ISSUED FOR PROJECT CLOSE	10/1/00
23	ISSUED FOR PROJECT CLOSE	10/1/00
24	ISSUED FOR PROJECT CLOSE	10/1/00
25	ISSUED FOR PROJECT CLOSE	10/1/00
26	ISSUED FOR PROJECT CLOSE	10/1/00
27	ISSUED FOR PROJECT CLOSE	10/1/00
28	ISSUED FOR PROJECT CLOSE	10/1/00
29	ISSUED FOR PROJECT CLOSE	10/1/00
30	ISSUED FOR PROJECT CLOSE	10/1/00

SHEET NO. **009**

CONTRACT - 2000 BLM ARCHITECTS
SHEET NO. 009

CITY PLAN COMMISSION SUBMISSION - 05/23/03

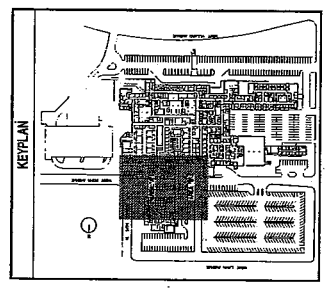
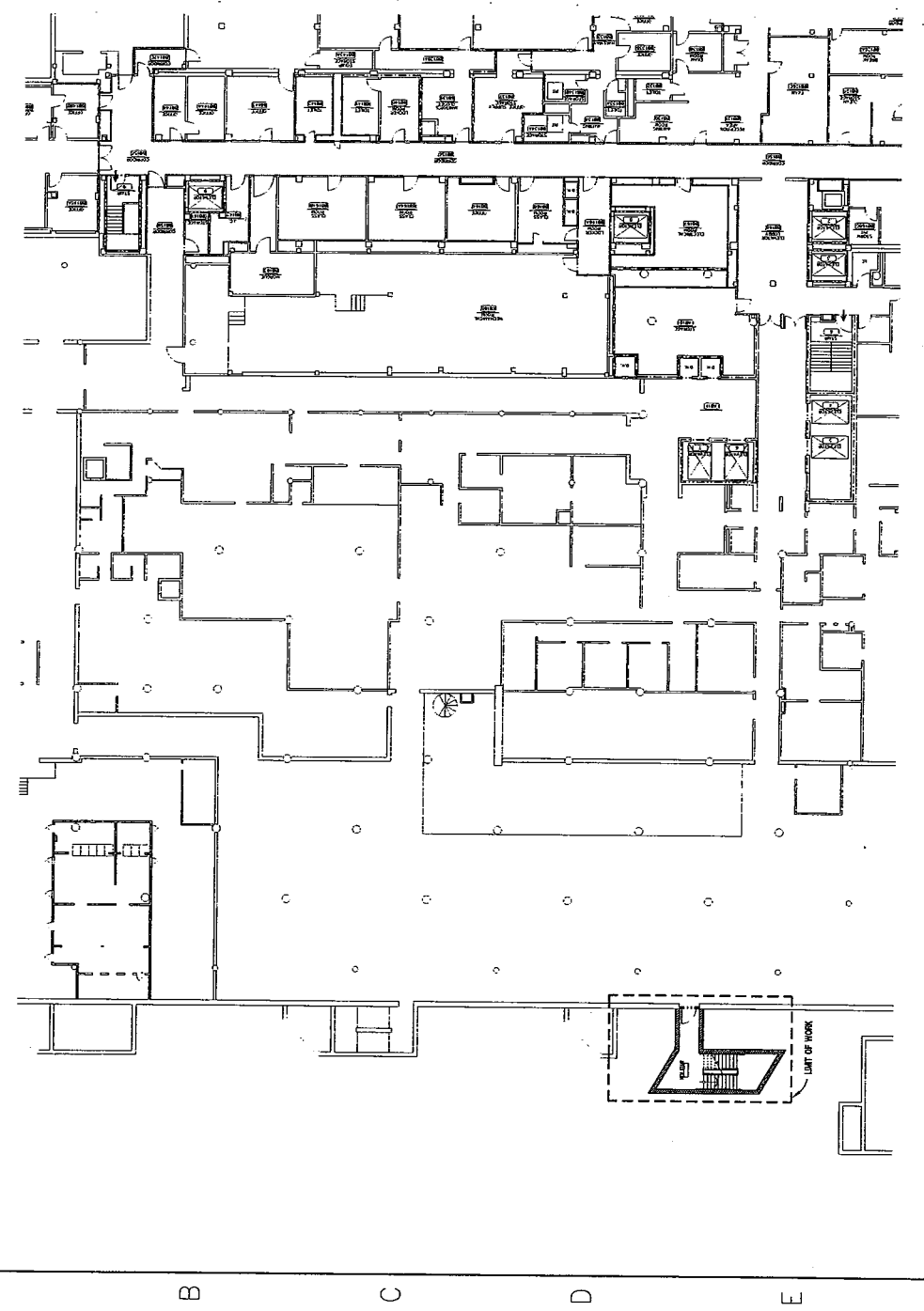

(A) PARTIAL BASEMENT FLOOR - ARCHITECTURAL AND EQUIPMENT PLAN
DATE: 3/22/03

A B C D E F

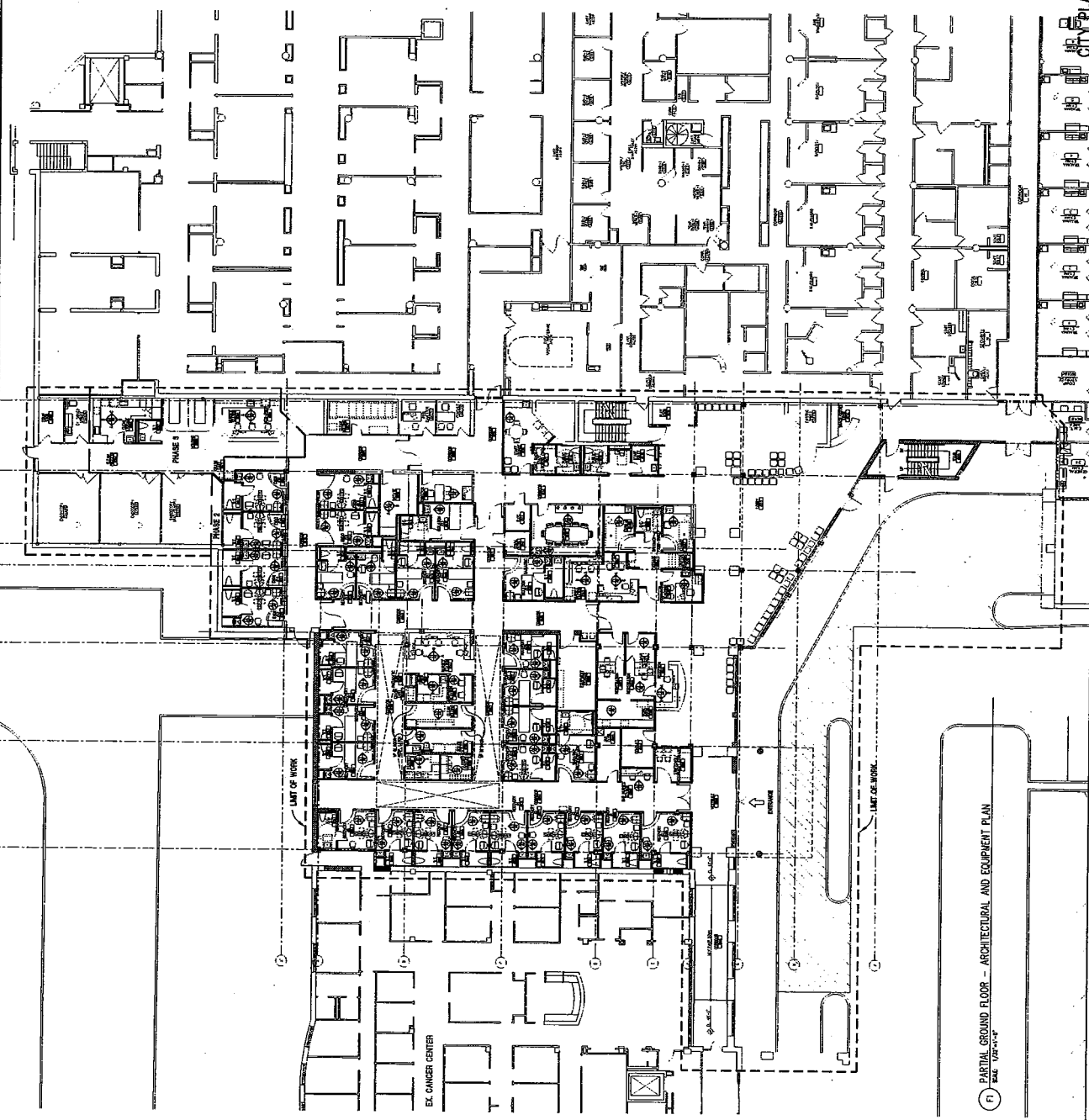
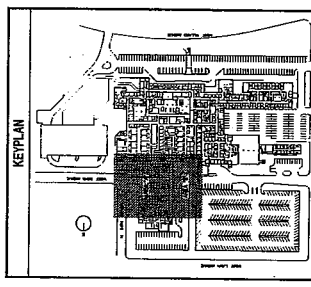

(F) PARTIAL GROUND FLOOR - ARCHITECTURAL AND EQUIPMENT PLAN
 DATE: 1/28/03

CITY PLAN COMMISSION SUBMISSION - 05/23/03

CITY PLAN COMMISSION SUBMISSION - 05/23/03

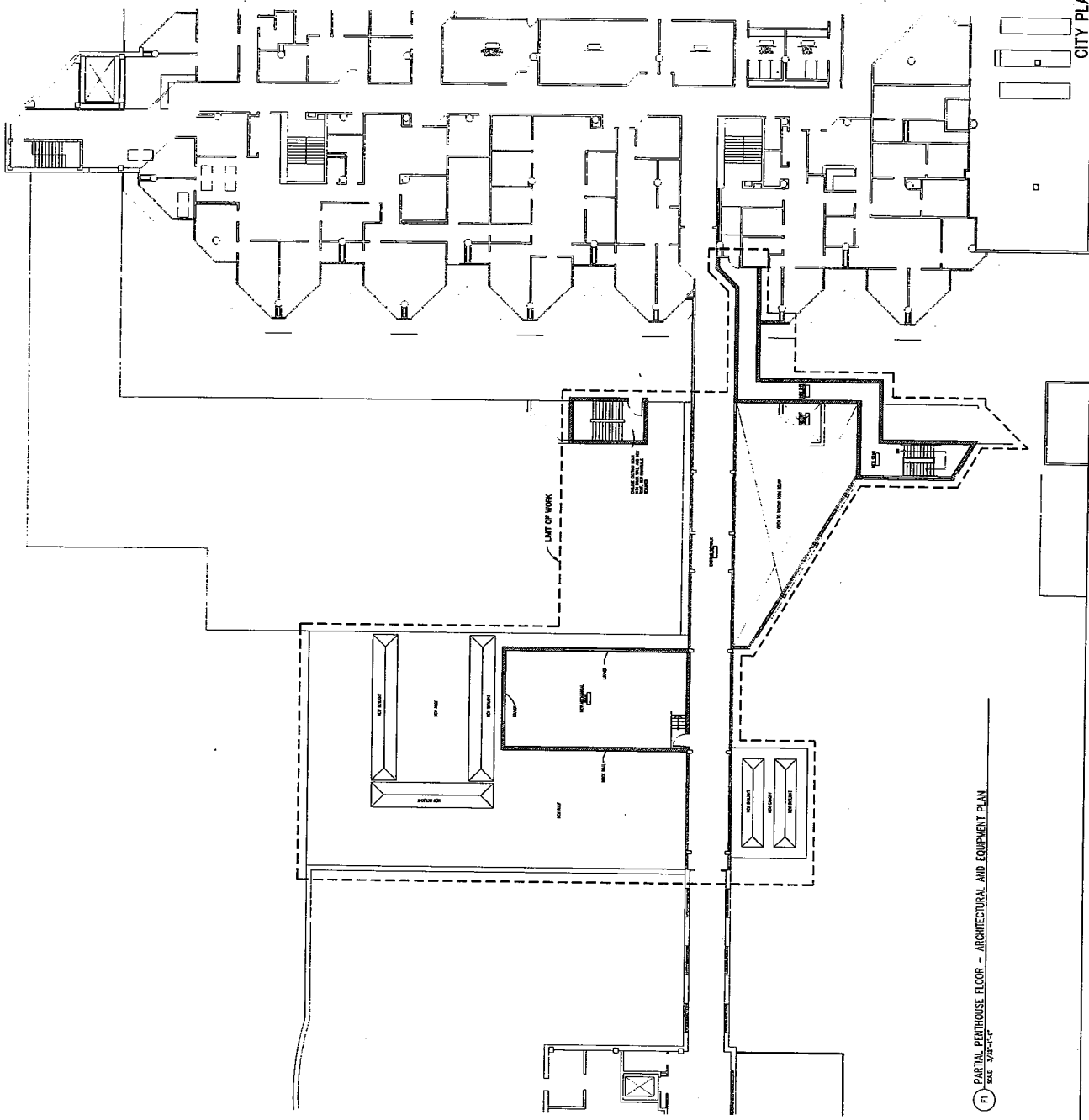
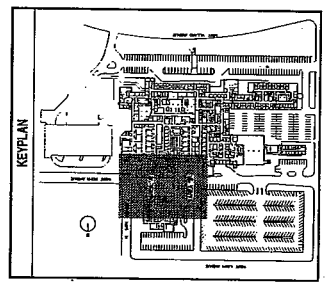

(F) PARTIAL PENTHOUSE FLOOR - ARCHITECTURAL AND EQUIPMENT PLAN
 SCALE: 1/8" = 1'-0"

A B C D E F

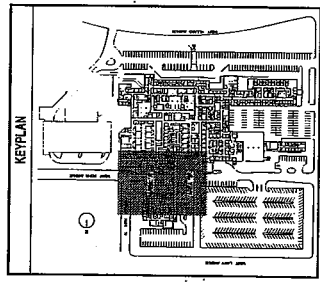
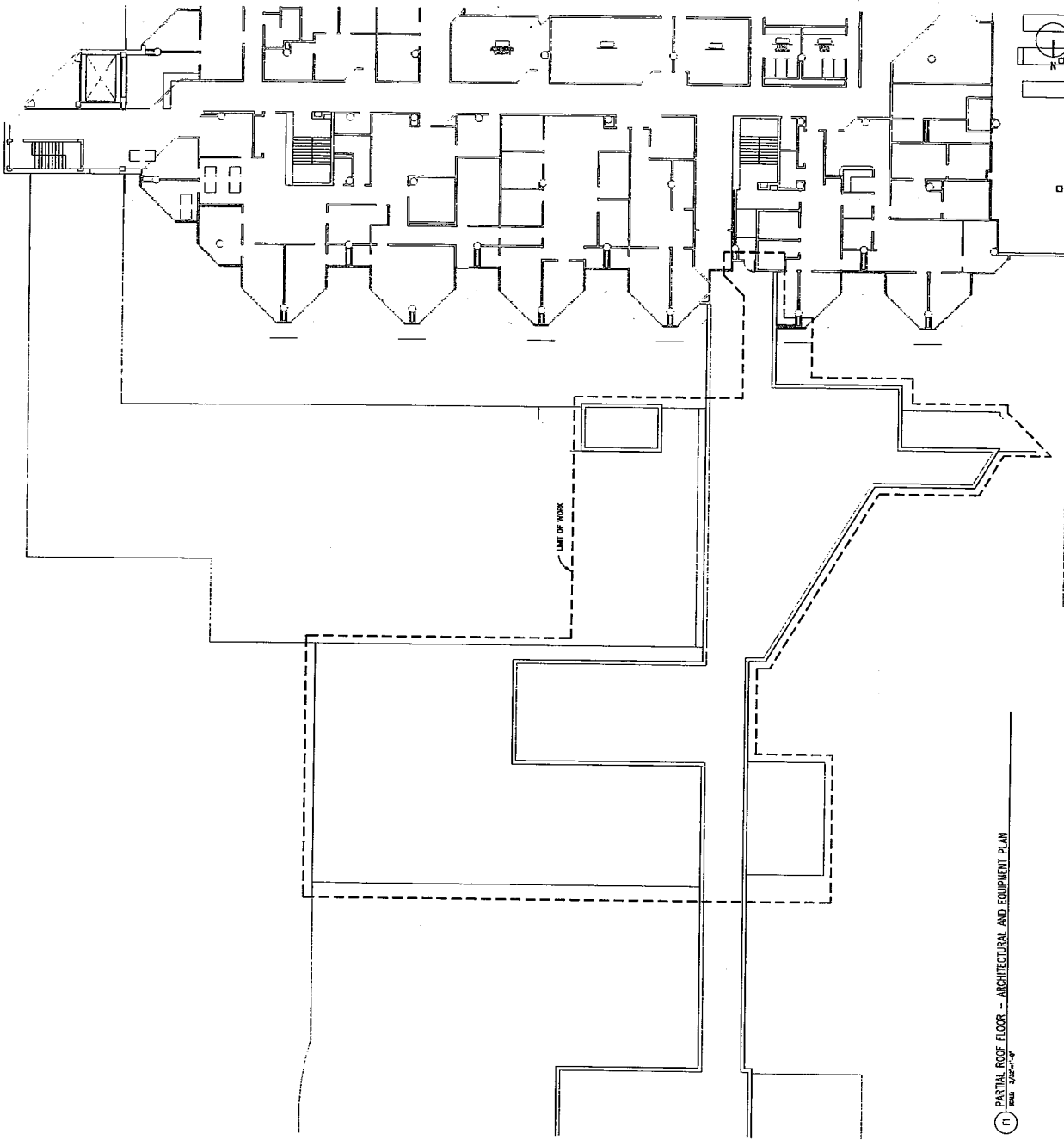

(F) PARTIAL ROOF FLOOR -- ARCHITECTURAL AND EQUIPMENT PLAN
SCALE: 1/8" = 1'-0"

PROJECT NO.	2481
DATE	5/23/03
SHEET NO.	300
CONTRACT NO.	
OWNER	
DESIGNER	
DATE	
SCALE	
TITLE	EXTENSION ELEVATIONS

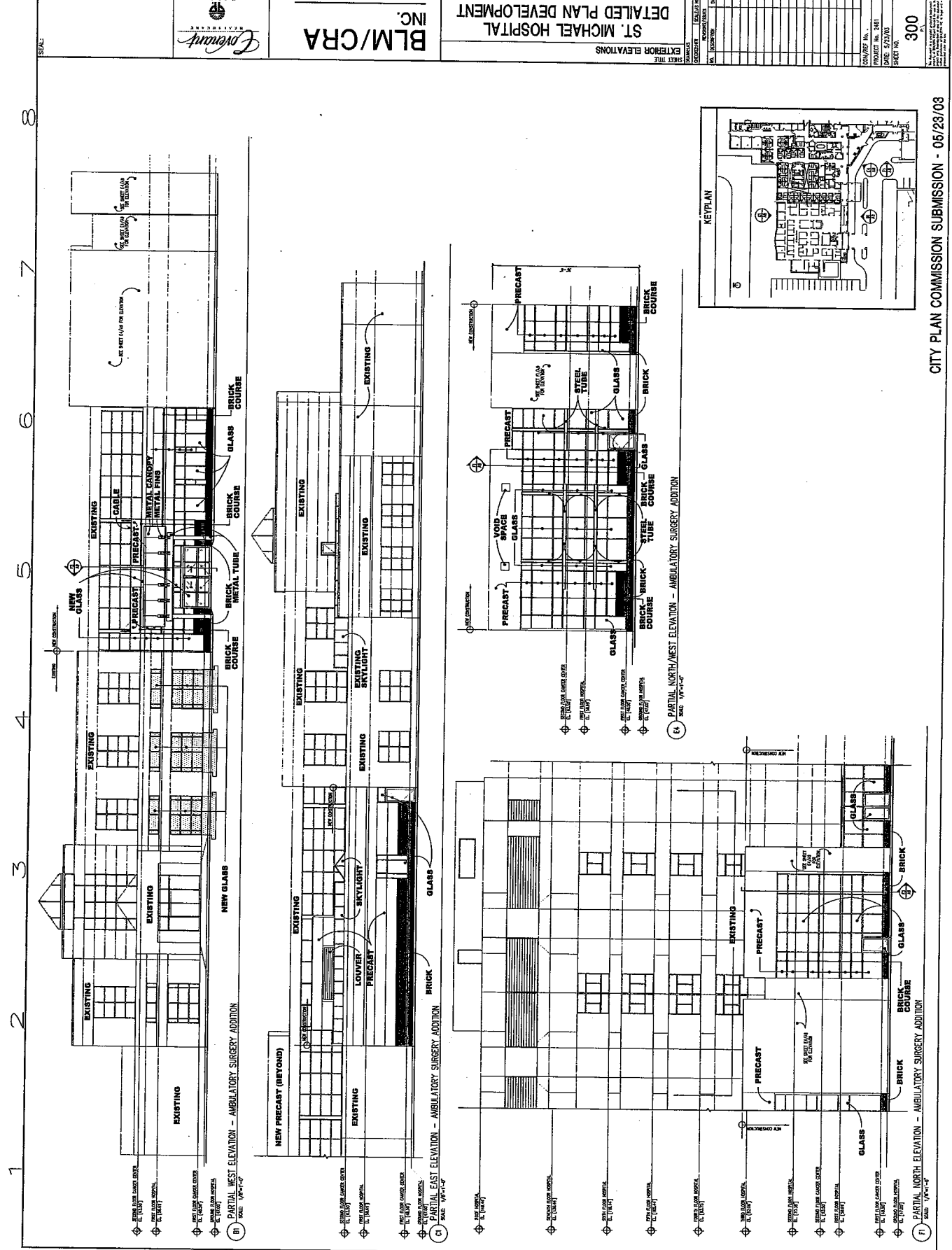

8
 7
 6
 5
 4
 3
 2
 1

