



**CITY OF MILWAUKEE  
OFFICE OF THE CITY CLERK**

Wednesday, January 22, 2020

**COMMITTEE MEETING NOTICE**

AD 05

AJMERI, Akil, Agent  
5417 N Lovers LLC  
5417 N LOVERS LANE Rd

Milwaukee, WI 53225

You are requested to attend a hearing which is to be held in Room 301-B, Third Floor, City Hall on:

**Tuesday, January 28, 2020 at 11:00 AM**

**Regarding:** Your Class A Malt & Class A Liquor and Food Dealer  Applications as agent for "5417 N Lovers LLC" for "AYRA'S Grocery Spirits & Cigars" at 5417 N LOVERS LANE Rd.

There is a possibility that your application may be denied for one or more of the following reasons: The recommendation of the committee regarding the application shall be based on evidence presented at the hearing. Per MCO 85-2.7-4, probative evidence concerning whether or not a new license should be granted may be presented on the following subjects: whether or not the applicant meets the municipal requirements, the appropriateness of the location and premises where the licensed premises is to be located and whether use of the premises for the purposes or activities permitted by the license would tend to facilitate a public or private nuisance or create undesirable neighborhood problems such as disorderly patrons, unreasonably loud noise, litter, and excessive traffic and parking congestion. Probative evidence relating to these matters may be taken from the plan of operation submitted with the license application, if any, but shall not include the content of any music. Evidence regarding the fitness of the location of the premises to be maintained as the principal place of business, including but not limited to whether there is an overconcentration of businesses of the type for which the license is sought; whether the proposal is consistent with any pertinent neighborhood business or development plans, or the location's proximity to areas where children are typically present. The applicant's record in operating similarly licensed premises; and whether or not the applicant has been charged with or convicted of any felony, misdemeanor, municipal offense or other offense, the circumstances of which substantially relate to the activity to be permitted by the license being applied for or any other factor which reasonably relates to the public health, safety or welfare may also be considered. See attached police report or correspondence.

**Notice for applicants with warrants or unpaid fines:** Proof of warrant satisfaction or payment of fines must be submitted at the hearing on the above date and time. Failure to comply with this requirement may result in a delay of the granting/denial of your application.

Failure to appear at this meeting may result in the denial of your license. Individual applicants must appear only in person or by an attorney. Corporate or Limited Liability applicants must appear only by the agent designated on the application or by an attorney. Partnership applicants must appear by a partner listed on the application or by an attorney. If you wish to do so and at your own expense, you may be accompanied by an attorney of your choosing to represent you at this hearing.

You will be given an opportunity to speak on behalf of the application and to respond and challenge any charges or reasons given for the denial. No petitions can be accepted by the committee, unless the people who signed the petition are present at the committee hearing and willing to testify. You may present witnesses under oath and you may also confront and cross-examine opposing witnesses under oath. If you have difficulty with the English language, you should bring an interpreter with you, at your expense, so that you can answer questions and participate in your hearing.

You may examine the application file at this office during regular business hours prior to the hearing date. Inquiries regarding this matter may be directed to the person whose signature appears below.

Limited parking for persons attending meetings in City Hall is available at reduced rates (5 hour limit) at the Milwaukee Center on the southwest corner of East Kilbourn and North Water Street. Parking tickets must be validated in the first floor information booth in City Hall.

PLEASE NOTE: Upon reasonable notice, efforts will be made to accommodate the needs of disabled individuals through sign language interpreters or other auxiliary aids. For additional information or to request this service, contact the Council Services Division ADA Coordinator at (414) 286-2998, Fax - (414) 286-3456, TDD - (414) 286-2025.

JIM OWCZARSKI, CITY CLERK

BY: \_\_\_\_\_

Jessica Celella  
License Division Manager

**If you have questions regarding this notice, please contact the License Division at (414) 286-2238.**

200 E. Wells Street, Room 105, City Hall, Milwaukee, WI 53202. [www.milwaukee.gov/license](http://www.milwaukee.gov/license)  
Phone: (414) 286-2238 Fax: (414) 286-3057 Email Address: [License@milwaukee.gov](mailto:License@milwaukee.gov)



CITY OF MILWAUKEE  
OFFICE OF THE CITY CLERK

Wednesday, January 22, 2020

COMMITTEE MEETING NOTICE

AD 05

AJMERI, Akil, Agent  
5417 N Lovers LLC  
2714 4 1/2 Mile Rd

Racine, WI 53402

You are requested to attend a hearing which is to be held in Room 301-B, Third Floor, City Hall on:

**Tuesday, January 28, 2020 at 11:00 AM**

**Regarding:** Your Class A Malt & Class A Liquor and Food Dealer License Applications as agent for "5417 N Lovers LLC" for "AYRA'S Grocery Spirits & Cigars" at 5417 N LOVERS LANE Rd.

There is a possibility that your application may be denied for one or more of the following reasons: The recommendation of the committee regarding the application shall be based on evidence presented at the hearing. Per MCO 85-2.7-4, probative evidence concerning whether or not a new license should be granted may be presented on the following subjects: whether or not the applicant meets the municipal requirements, the appropriateness of the location and premises where the licensed premises is to be located and whether use of the premises for the purposes or activities permitted by the license would tend to facilitate a public or private nuisance or create undesirable neighborhood problems such as disorderly patrons, unreasonably loud noise, litter, and excessive traffic and parking congestion. Probative evidence relating to these matters may be taken from the plan of operation submitted with the license application, if any, but shall not include the content of any music. Evidence regarding the fitness of the location of the premises to be maintained as the principal place of business, including but not limited to whether there is an overconcentration of businesses of the type for which the license is sought; whether the proposal is consistent with any pertinent neighborhood business or development plans, or the location's proximity to areas where children are typically present. The applicant's record in operating similarly licensed premises; and whether or not the applicant has been charged with or convicted of any felony, misdemeanor, municipal offense or other offense, the circumstances of which substantially relate to the activity to be permitted by the license being applied for or any other factor which reasonably relates to the public health, safety or welfare may also be considered. See attached police report or correspondence.

**Notice for applicants with warrants or unpaid fines:** Proof of warrant satisfaction or payment of fines must be submitted at the hearing on the above date and time. Failure to comply with this requirement may result in a delay of the granting/denial of your application.

Failure to appear at this meeting may result in the denial of your license. Individual applicants must appear only in person or by an attorney. Corporate or Limited Liability applicants must appear only by the agent designated on the application or by an attorney. Partnership applicants must appear by a partner listed on the application or by an attorney. If you wish to do so and at your own expense, you may be accompanied by an attorney of your choosing to represent you at this hearing.

You will be given an opportunity to speak on behalf of the application and to respond and challenge any charges or reasons given for the denial. No petitions can be accepted by the committee, unless the people who signed the petition are present at the committee hearing and willing to testify. You may present witnesses under oath and you may also confront and cross-examine opposing witnesses under oath. If you have difficulty with the English language, you should bring an interpreter with you, at your expense, so that you can answer questions and participate in your hearing.

You may examine the application file at this office during regular business hours prior to the hearing date. Inquiries regarding this matter may be directed to the person whose signature appears below.

Limited parking for persons attending meetings in City Hall is available at reduced rates (5 hour limit) at the Milwaukee Center on the southwest corner of East Kilbourn and North Water Street. Parking tickets must be validated in the first floor information booth in City Hall.

PLEASE NOTE: Upon reasonable notice, efforts will be made to accommodate the needs of disabled individuals through sign language interpreters or other auxiliary aids. For additional information or to request this service, contact the Council Services Division ADA Coordinator at (414) 286-2998, Fax - (414) 286-3456, TDD - (414) 286-2025.

JIM OWCZARSKI, CITY CLERK

BY: \_\_\_\_\_  
Jessica Celella

License Division Manager

If you have questions regarding this notice, please contact the License Division at (414) 286-2238.

200 E. Wells Street, Room 105, City Hall, Milwaukee, WI 53202. [www.milwaukee.gov/license](http://www.milwaukee.gov/license)  
Phone: (414) 286-2238 Fax: (414) 286-3057 Email Address: [License@milwaukee.gov](mailto:License@milwaukee.gov)

Date: 12/13/19  
Officer: T. Geniesse

City of Milwaukee Police Department  
90-5-1.5 Crime Prevention Survey  
Convenience Store/Liquor Store Inspection

Name of Premise: Ayra's Grocery and Spirits  
Address: 5417 N Lovers Lane Rd  
Phone: None

Owner: Akil I Ajmeri I/M 11/04/1968  
Owner address: 2714 ½ Mile Rd  
City State Zip: Racine, WI 53402  
Owner Phone: 262-770-0344  
Owner email: akilajmeri@gmail.com

Manager: Akil I Ajmeri  
Home Address: 2714 ½ Mile Rd  
City State Zip: Racine, WI 53402  
Phone: 262-770-0344  
Email: akiljmeri@gmail.com

Preferred contact: Akil Ajmeri

Location currently open:  YES  NO

Projected open date: summer of 2020

Day's open: S M T W Th F SA ALL

Hours of Operation: Sun: 9a-9p 24 hours Y N  
Mon: 9a-9p  
Tue: 9a-9p  
Wed: 9a-9p  
Thu: 9a-9p  
Fri: 9a-9p  
Sat: 9a-9p

Premise Type: Liquor Store  
Convenience Store  
Other: Grocery

Licenses currently held:

- Alcohol:  Yes  No Class: #:  
Tobacco:  Yes  No #:  
Food:  Yes  No #:  
Extended Hours:  Yes  No #:  
Secondhand Dealer:  Yes  No Type: #:  
Other:  Yes  No Type: #:  
Other:  Yes  No Type: #:

**Akil currently holds license in Racine, Alcohol, tobacco, class B, class A**

**Exterior Survey:**

1. Is the area around the location clean?  Yes  No
2. What surrounds the location? (Check all the apply)
  - a.  Park
  - b.  School
  - c.  Youth Center
  - d.  Church
  - e.  Tavern(s) If so, how many
  - f.  Residential
  - g.  Other businesses
  - h.  Other:
3. Can you see from the outside of the location into the interior  Yes  No
4. Can you see the employees inside of the location from the outside  Yes  No
5. Are exterior windows free of signage  Yes  No
6. Is there a parking lot  Yes  No
7. Is the parking lot clean?  Yes  No
8. Is the parking lot well lit?  Yes  No
9. Are there areas where a person could conceal themselves  Yes  No
10. Is there exterior lighting?  Yes  No. Does it appears to be adequate  Yes  No
11. Exterior Payphone?  Yes  No
12. Are there No Loitering Signs posted?  Yes  No
13. Are there exterior security cameras  Yes  No How Many:
14. Are the address numbers prominently displayed and easy to see  Yes  No

**Akil will post "No Loitering" signs and fill out the standing complainant form. Lighting will be placed and bright.**

**Camera Survey:**

15. Does this location have security cameras?  Yes  No
16. Are they in working order?  Yes  No
17. What format are the cameras?
  - a. Color  Yes  No
  - b. Digital  Yes  No
  - c. VCR  Yes  No
  - d. Recorded  Yes  No
18. How long is footage stored for later viewing:

19. Are there exterior cameras  Yes  No How many:  
 20. Are there interior cameras  Yes  No How many:  
 21. Do all employees know how to retrieve recorded digital images/footage?  Yes  No

**This is an empty building that will be under construction. The plan as of now is to install 16-20 cameras. There will be interior and exterior cameras. Storage will be held for 30 days and the owner and manager will be the only ones who will be able to operate the cameras.**

**Interior Survey:**

22. Is the storeowner willing to be a standing complainant regarding loitering?  Yes  No  
 a. If yes have them fill out the standing complaint form and give them two of the commercial signs  Yes  No  
 23. Is the interior of the location neat and clean?  Yes  No  
 24. Does an interior camera face the entrance/exit?  Yes  No  
 25. Is there a lockable area that separates employees from customers?  Yes  No  
 26. Does the store sell single chore boy?  Yes  No  
 27. Does the store sell blunt wraps?  Yes  No  
 28. Does the store sell scales?  Yes  No  
 29. Does the store sell items that may be used as crack pipes?  Yes  No  
 a. Describe item  
 30. Does the store have an over abundance of sandwich baggies:  Yes  No  
 31. Does the owner understand that these items are often used for drug use?  Yes  No  
 32. Do the products in the store appear to be new and rotated often?  Yes  No  
 33. Are emergency and non-emergency numbers posted near the phone?  Yes  No  
 34. Does the owner know how to contact their police district directly?  Yes  No  
 a. Did you provide a district contact guide to the owner?  Yes  No

**Complete this section if alcohol establishment is a convenience store:**

(\*\* Read full ordinance for all details "68-4.3 Convenience Food Stores")

All convenience food stores not exempted under sub. 3 shall:

1. Is the cash register located in a manner so that at the time of a sales transaction, the employee and customer are both visible from the sidewalk?  Yes  No \*\*
2. Are the glass entrance and exit doors clear of any signs or advertisements with the exception of a sign which states that the cash register contains \$50 or less and that the safe is no accessible to employees?  Yes  No **Advised to post**
3. Does the store maintain one of the following on the licensed premise:
  - a. A safe that was in use at the convenience food store on August 17, 1994?  Yes  No
  - b. A drop-safe or time release safe that weighs at least 500 pounds or which is attached to or set into the floor in a manner approved by the police department?  Yes  No
4. Is lighting provided for the store's parking area during all hours of darkness when employees or customers are on the premises at a minimum average of 2-foot candles per square foot, unless the store is not open for business after sunset and before sunrise?  Yes  No  N/A
5. Are at least two high-resolution surveillance security cameras installed?  Yes  No
6. Are the security cameras in working order?  Yes  No
7. Does one camera show an overall view of the counter and register area?  Yes  No

8. Does one camera show a clear, identifiable, full frame image of the face of each person entering and leaving the store?  Yes  No
9. Are the camera views obstructed by fixtures or displays?  Yes  No
10. Is the recorded footage stored for at least 30 days?  Yes  No
11. Do all store employees know how to record footage from the camera system to media capable of being transferred to police custody?  Yes  No
12. Are customer entrances/exits made of glass or other transparent material?  Yes  No
  - a. Exception: A store that does not have such doors on August 17, 1994 shall not be required to install such doors until the holder of the store's food dealer license changes.
13. Has the owner and their employees attended the Robbery Prevention Training within 120 days of ownership or employment?  Yes  No
  - a. Contact Community Outreach and Education at 935-7836 for schedule.

**Sub 3. Exemptions.** The requirements of this section do not apply to a convenience food store that conforms to either of the following descriptions:

- a-1. The store is located in an enclosed shopping structure, enclosed commercial building or hospital. A convenience food store is not in an enclosed structure or building if a customer can enter it directly from the outside.  
Does store conform to a-1  Yes  No
- a-2. The store physically separates employees from customers with a solid partition that bars a person from entering the employee area from the customer area, has a secure lock on the employee side of any door between the employee area and the customer, and conducts all transaction through a service window or similar arrangement.  
Does store conform to a-2  Yes  No
  - a. At the commissioner's discretion, a convenience store may be exempted from any or all of the regulations specified in sub 2.  
Does this location hold an exemption from the commissioner regarding any of the requirements of Sub 2?  Yes  No

**ADDITIONAL COMMENTS/RECOMMENDATIONS:**

Akil, will contact District Four, for a walk through prior to opening. It was currently still set up like a restaurant. He stated this will be under full construction, once he has ownership of the building.



# Concentration Map

## Area of Interest (AOI) Information

Area : 21,862,585.72 ft<sup>2</sup>

Jan 22 2020 11:42:31 Central Standard Time

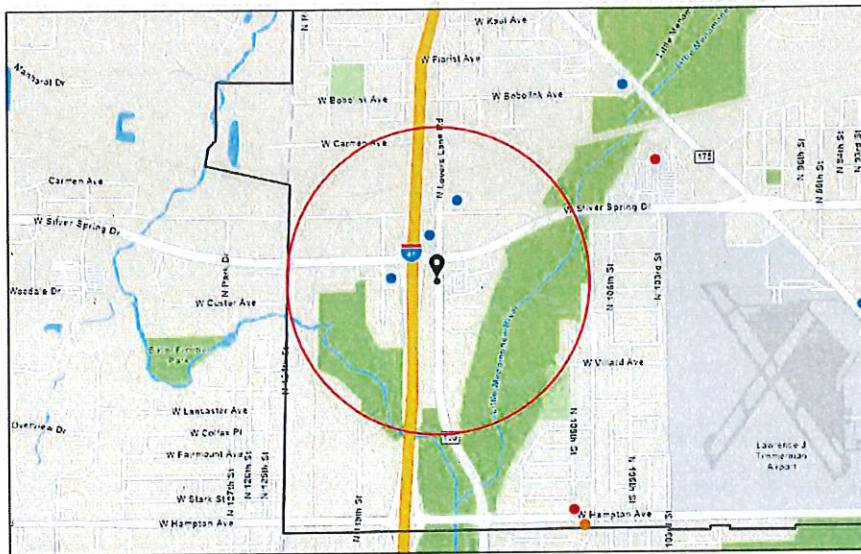

- Alcohol Licenses
- Class A Liquor and Malt
- Class A Intoxicating Liquor
- Class A Fermented Malt Beverage
- City Boundary

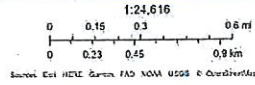

## Summary

Name	Count	Area(ft <sup>2</sup> )	Length(mi)
Alcohol Licenses	3		

## Alcohol Licenses

#	Legal Entity	Trade Name	Licensee	Address	License Type Name	Total Capacity	Expiration Date	Count
1	CAMELOT BANQUET ROOMS, INC	Silk/Rock Country	SCOTT A KRAHN, Agt	11400 W SILVER SPRING RD	Class B Tavern License	376	6/29/2020, 7:00 PM	1
2	DGMK, INC	Olive Tree Cafe	DENNIS GIANNOPOULOS, Agt	5547 N LOVERS LANE RD	Class B Tavern License	150	2/29/2020, 6:00 PM	1
3	MANCHESTER LIQUOR, LLC	HYATT PLACE MILWAUKEE WEST	ANTHONY SILENO, JR, Agt	11777 W SILVER SPRING DR	Class B Tavern License	300	4/13/2020, 7:00 PM	1

Establishments within a 0.5 miles radius centered on area of interest.





Wednesday, January 22, 2020

## Licenses Committee Notice of Hearing

AA WESTPHAL PROPERTIES LLC  
5401 N LOVERS LANE Rd  
Milwaukee, WI 53225

Date: 1/28/2020  
Time: 11:00 AM  
Location: Room 301-B, Third Floor, City Hall

The Licenses Committee will consider the following license application:

Class A Malt & Class A Liquor and Food Dealer License Applications  
AJMERI, Akil, Agent  
AYRA'S Grocery Spirits & Cigars at 5417 N LOVERS LANE Rd

Please note this application may be recommended for denial based on fitness of the location due to concentration of alcohol beverage outlets in the area. If the application is denied for this reason, no other application for an alcohol beverage license for this location shall be recommended for approval by the Licenses Committee within three years of the date of denial unless the applicant has demonstrated a change of circumstances since the prior denial.

If you have any questions, please call (414) 286-2238.





Wednesday, January 22, 2020



# Notice of Public Hearing

---

AJMERI, Akil, Agent  
AYRA'S Grocery Spirits & Cigars at 5417 N LOVERS LANE Rd  
Class A Malt & Class A Liquor and Food Dealer License Applications

**Tuesday, January 28, 2020 at 11:00 AM**

To whom it may concern:

The above application has been made by the above named applicant(s). This requires approval from the Licenses Committee and the Common Council of the City of Milwaukee. The hearing before the Licenses Committee will take place on 1/28/2020 at 11:00 AM, in Room 301-B, Third Floor, City Hall. If you wish, you may provide testimony at the hearing regarding the request; see below for further information. You are not required to attend the hearing. Once the Licenses Committee makes its recommendation, this recommendation is forwarded to the full Common Council for approval at its next regularly scheduled hearing. Please review the information below and if you have further questions regarding this process, please contact the License Division at (414) 286-2238.

---

## Important details for those wishing to provide information for the Licenses Committee to consider when making its recommendation:

1. The license application is scheduled to be heard at the above time. Due to other hearings running longer than scheduled, you may have to wait some time to provide your testimony.
2. You must appear in person and testify as to matters that you have personally experienced or seen. (You cannot provide testimony for your neighbor, parent or anyone else; this is considered hearsay and cannot be considered by the committee.)
3. No letters or petitions can be accepted by the committee (unless the person who wrote the letter or the persons who signed the petition are present at the committee hearing and willing to testify).
4. Persons opposed to the license application are given the opportunity to testify first; supporters may testify after the opponents have finished.
5. When you are called to testify, you will be sworn in and asked to give your name, and address. (If your first and/or last names are uncommon please spell them.)
6. You may then provide testimony.
  - a. Include only information relating to the above license application.
  - b. Include only information you have personally witnessed or seen.
  - c. Provide concise and relevant information detailing how this business has affected or may affect the peaceful enjoyment of your neighborhood.
  - d. If by the time you have the opportunity to testify, the information you wish to share has already been provided to the committee, you may state that you agree with the previous testimony. Redundant or repetitive testimony will not assist the committee in making its recommendation.
7. After giving your testimony, the members of the Licenses Committee and the licensee may ask questions regarding the testimony you have given or other factors relating to the license application.
8. Business Competition is not a valid basis for denial or non-renewal of a license.  
**Please Note: If you have submitted an objection to the above application your objection cannot be considered by the committee unless you personally testify at the hearing.**

OCCUPANT	MAIL ADDRESS	CITY, STATE ZIP
CURRENT OCCUPANT	5366A N LOVERS LANE RD 141	MILWAUKEE, WI 53225
CURRENT OCCUPANT	5366B N LOVERS LANE RD 146	MILWAUKEE, WI 53225
CURRENT OCCUPANT	5366B N LOVERS LANE RD 147	MILWAUKEE, WI 53225
CURRENT OCCUPANT	5368A N LOVERS LANE RD 151	MILWAUKEE, WI 53225
CURRENT OCCUPANT	5368A N LOVERS LANE RD 152	MILWAUKEE, WI 53225
CURRENT OCCUPANT	5356A N LOVERS LANE RD 201	MILWAUKEE, WI 53225
CURRENT OCCUPANT	5360A N LOVERS LANE RD 119	MILWAUKEE, WI 53225
CURRENT OCCUPANT	5360B N LOVERS LANE RD 223	MILWAUKEE, WI 53225
CURRENT OCCUPANT	5364A N LOVERS LANE RD 134	MILWAUKEE, WI 53225
CURRENT OCCUPANT	5364A N LOVERS LANE RD 135	MILWAUKEE, WI 53225
CURRENT OCCUPANT	5364B N LOVERS LANE RD 138	MILWAUKEE, WI 53225
CURRENT OCCUPANT	5366A N LOVERS LANE RD 241	MILWAUKEE, WI 53225
CURRENT OCCUPANT	5366B N LOVERS LANE RD 148	MILWAUKEE, WI 53225
CURRENT OCCUPANT	5368B N LOVERS LANE RD 154	MILWAUKEE, WI 53225
CURRENT OCCUPANT	5368B N LOVERS LANE RD 254	MILWAUKEE, WI 53225
CURRENT OCCUPANT	5356B N LOVERS LANE RD 208	MILWAUKEE, WI 53225
CURRENT OCCUPANT	5358A N LOVERS LANE RD 209	MILWAUKEE, WI 53225
CURRENT OCCUPANT	5358A N LOVERS LANE RD 210	MILWAUKEE, WI 53225
CURRENT OCCUPANT	5358B N LOVERS LANE RD 115	MILWAUKEE, WI 53225
CURRENT OCCUPANT	5358B N LOVERS LANE RD 215	MILWAUKEE, WI 53225
CURRENT OCCUPANT	5360A N LOVERS LANE RD 218	MILWAUKEE, WI 53225
CURRENT OCCUPANT	5360B N LOVERS LANE RD 121	MILWAUKEE, WI 53225
CURRENT OCCUPANT	5360B N LOVERS LANE RD 123	MILWAUKEE, WI 53225
CURRENT OCCUPANT	5362A N LOVERS LANE RD 128	MILWAUKEE, WI 53225
CURRENT OCCUPANT	5362A N LOVERS LANE RD 225	MILWAUKEE, WI 53225
CURRENT OCCUPANT	5362A N LOVERS LANE RD 227	MILWAUKEE, WI 53225
CURRENT OCCUPANT	5366B N LOVERS LANE RD 245	MILWAUKEE, WI 53225
CURRENT OCCUPANT	5368A N LOVERS LANE RD 249	MILWAUKEE, WI 53225
CURRENT OCCUPANT	5356A N LOVERS LANE RD 202	MILWAUKEE, WI 53225
CURRENT OCCUPANT	5356B N LOVERS LANE RD 207	MILWAUKEE, WI 53225
CURRENT OCCUPANT	5358A N LOVERS LANE RD 109	MILWAUKEE, WI 53225
CURRENT OCCUPANT	5358A N LOVERS LANE RD 212	MILWAUKEE, WI 53225
CURRENT OCCUPANT	5362A N LOVERS LANE RD 226	MILWAUKEE, WI 53225
CURRENT OCCUPANT	5362B N LOVERS LANE RD 129	MILWAUKEE, WI 53225
CURRENT OCCUPANT	5362B N LOVERS LANE RD 229	MILWAUKEE, WI 53225
CURRENT OCCUPANT	5362B N LOVERS LANE RD 232	MILWAUKEE, WI 53225
CURRENT OCCUPANT	5364B N LOVERS LANE RD 240	MILWAUKEE, WI 53225
CURRENT OCCUPANT	5366B N LOVERS LANE RD 145	MILWAUKEE, WI 53225
CURRENT OCCUPANT	5368A N LOVERS LANE RD 252	MILWAUKEE, WI 53225
CURRENT OCCUPANT	5368B N LOVERS LANE RD 156	MILWAUKEE, WI 53225
CURRENT OCCUPANT	5368B N LOVERS LANE RD 253	MILWAUKEE, WI 53225
CURRENT OCCUPANT	5368B N LOVERS LANE RD 256	MILWAUKEE, WI 53225
CURRENT OCCUPANT	5356A N LOVERS LANE RD 104	MILWAUKEE, WI 53225
CURRENT OCCUPANT	5356B N LOVERS LANE RD 105	MILWAUKEE, WI 53225
CURRENT OCCUPANT	5356B N LOVERS LANE RD 206	MILWAUKEE, WI 53225
CURRENT OCCUPANT	5358A N LOVERS LANE RD 111	MILWAUKEE, WI 53225



CURRENT OCCUPANT	5356A N LOVERS LANE RD 203	MILWAUKEE, WI 53225
CURRENT OCCUPANT	5358B N LOVERS LANE RD 213	MILWAUKEE, WI 53225
CURRENT OCCUPANT	5358B N LOVERS LANE RD 216	MILWAUKEE, WI 53225
CURRENT OCCUPANT	5360A N LOVERS LANE RD 117	MILWAUKEE, WI 53225
CURRENT OCCUPANT	5360A N LOVERS LANE RD 220	MILWAUKEE, WI 53225
CURRENT OCCUPANT	5362B N LOVERS LANE RD 231	MILWAUKEE, WI 53225
CURRENT OCCUPANT	5364A N LOVERS LANE RD 234	MILWAUKEE, WI 53225
CURRENT OCCUPANT	5364B N LOVERS LANE RD 237	MILWAUKEE, WI 53225
CURRENT OCCUPANT	5368A N LOVERS LANE RD 149	MILWAUKEE, WI 53225
CURRENT OCCUPANT	5368A N LOVERS LANE RD 251	MILWAUKEE, WI 53225
CURRENT OCCUPANT	5356A N LOVERS LANE RD 204	MILWAUKEE, WI 53225
CURRENT OCCUPANT	5356B N LOVERS LANE RD 106	MILWAUKEE, WI 53225
CURRENT OCCUPANT	5356B N LOVERS LANE RD 107	MILWAUKEE, WI 53225
CURRENT OCCUPANT	5358A N LOVERS LANE RD 110	MILWAUKEE, WI 53225
CURRENT OCCUPANT	5358B N LOVERS LANE RD 114	MILWAUKEE, WI 53225
CURRENT OCCUPANT	5358B N LOVERS LANE RD 116	MILWAUKEE, WI 53225
CURRENT OCCUPANT	5360A N LOVERS LANE RD 219	MILWAUKEE, WI 53225
CURRENT OCCUPANT	5360B N LOVERS LANE RD 124	MILWAUKEE, WI 53225
CURRENT OCCUPANT	5362B N LOVERS LANE RD 130	MILWAUKEE, WI 53225

Total Records: 112

Radius: 250.0 feet and Center of Circle: 5417 N Lovers Lane Rd



# BUSINESS LICENSE PLAN OF OPERATION

ccl-busplan 3/15/18

Office of the City Clerk License Division  
200 E. Wells St. Room 105, Milwaukee, WI 53202  
(414) 286-2238 www.milwaukee.gov/license e-mail address: license@milwaukee.gov

## 1. Type of Business

- Applying for:  Extended Hours (12AM to 5AM) - If a food establishment, check all that apply:  Delivery  Drive Thru  Dining Room  
 Self Service Laundry  Massage Establishment  Filling Station  
 Other (supplemental application for specific license also required)

Provide a detailed description of the type of business you plan on operating:

**Grocery Store with High-end Cigars with Walk in Humidor & Spirits**

Do you have any experience operating this type of business?  No  Yes If yes, explain: **Multiple Locations in Racine, WI**

## 2. Business Operations

- a. Proposed Opening Date: 12/01/2019
- b. Is this premise under construction?  No  Yes If yes, list estimated completion date: \_\_\_\_\_
- c. Is this a franchise?  No  Yes
- d. Is this premises currently licensed?  No  Yes If yes, list type of license: Class B
- e. Is the current licensee operating?  No  Yes If no, list date closed: \_\_\_\_\_
- f. Do you have future plans for other businesses, licenses or permits at this location?  No  Yes  
If yes, explain: \_\_\_\_\_
- g. Have you previously held an Extended Hours License in Milwaukee?  No  Yes  
If yes, list address(es): \_\_\_\_\_
- h. Are other businesses operating in the same building?  No  Yes If yes, describe: \_\_\_\_\_

## 3. Litter & Noise

- a. How are grounds kept clean?  Sweep  Pressure Wash  Pick Up Litter  Other: \_\_\_\_\_
- b. How often will grounds be cleaned?  Daily  Weekly  As Needed  Monthly  Other: \_\_\_\_\_
- c. Grounds cleaned by:  Licensee  Building Owner  Employees  Hired Maintenance  Other: \_\_\_\_\_
- d. How are noise issues prevented and/or addressed?  Security  Manager approaches customer(s)  Call Police  
 Signs Posted  Other: \_\_\_\_\_
- e. Will a sound amplification system be used?  No  Yes If yes, describe: \_\_\_\_\_

## 4. Smoking & Sanitation

- a. Are there designated outdoor smoking areas?  No  Yes If yes, describe: \_\_\_\_\_
- b. Number of Garbage Cans: Inside: 4 Locations: Bathroom, Counter, Enter and Exit  
Outside: 1 Locations: Front Door
- c. Is a crowd control barrier used?  No  Yes If yes, describe: \_\_\_\_\_
- d. How many restrooms are on the premises? 2
- e. Name of solid waste contractor:  Advanced Disposal  Waste Management  Other: Eagle Disposal

## 5. Security

- a. Are there onsite parking spaces?  No  Yes If yes, how many? 15 and describe the parking security plan: Outdoor Cameras and Indoor Cameras (20 Camera System)
- b. Is there a loading zone?  No  Yes If yes, describe the loading area security plan: \_\_\_\_\_
- c. Will you have security personnel on premise?  No  Yes If yes, how many? \_\_\_\_\_ and answer the following:  
 What are their responsibilities? \_\_\_\_\_  
 Is security equipment used?  No  Yes If yes, describe 20 Camera CCTV System with monitors  
 List their licensing, certification, or training credentials \_\_\_\_\_
- d. Will there be security cameras?  No  Yes If yes, how many? 20 and list locations: \_\_\_\_\_  
Indoors and Outdoors
- e. Will searches/identification checks be done upon entry?  No  Yes If yes, describe \_\_\_\_\_

## 6. Percentage of Sales (must total 100%)

Alcohol <u>25</u> %	Food <u>50</u> %	Secondhand Merchandise _____ %	Precious Metals & Gems _____ %
Entertainment _____ %	Cigarettes <u>25</u> %	Personal Services (such as tattoo, body piercing, salon, tailor, tanning, etc.) _____ %	Other _____ %
Pawnbroker Activity _____ %	Salvaged Materials _____ % (such as scrap metal)	Describe: _____	

## 7. Businesses/Licenses on the Premises (check all that apply)

### Type 1

- Full Service Restaurant  Cafe/Coffee Shop  Deli or Fast Food Restaurant  Private/Fraternal/Veterans Club
- Night Club  Tavern  Cocktail Lounge  Teen Club
- Banquet Hall  Sports Facility  Bowling Alley
- Hotel/Motel: Number of Floors: \_\_\_\_\_ Number of Rooms: \_\_\_\_\_  
 Rooming House: Number of Floors: \_\_\_\_\_ Number of Rooms: \_\_\_\_\_

### Type 2

- Liquor Store  Corner Store  Supermarket  Convenience Store
- Gas Station  Amusement/Phonograph Distributor  Recycling, Salvage or Towing
- Used Car Dealer  Personal Service Establishment  
(such as tattoo business, hair salon, tailor, etc.)  Recording Studio

What other licenses/permits will you hold at this location? (check all that apply)

- Occupancy Permit  Cigarette & Tobacco  Gas Station  Extended Hours  Class "B" Tavern  Weights & Measures
- Secondhand Dealer  Precious Metal & Gem  Other: \_\_\_\_\_

## 8. Legal Capacity (only if a Type 1 premises in #7 above)

Capacity \_\_\_\_\_ (Call the Milwaukee Development Center at 414-286-8211 if you have questions.)

## 9. Premises Description

- a. Identify all area(s) of the premises that will be used in operating this business (include areas used only for storage):  
 1<sup>st</sup> Floor  2<sup>nd</sup> Floor  Basement Storage  Patio  Beer Garden  Sidewalk Café  Deck  Rooftop  
 Other: Describe: \_\_\_\_\_
- b. Describe Location:  Major Thoroughfare  Secondary Street  Other: HWY 100 & Silver Spring
- c. Nearest Major Cross Street: Silver Spring
- d. Describe Building:  Free Standing Building  Strip Mall  Other: \_\_\_\_\_
- e. Describe Premises Structure:  Single Story  Multi-Story - # of Stories \_\_\_\_\_  Other: \_\_\_\_\_
- f. Describe Surrounding Area:  Commercial  Residential  Industrial  Other: \_\_\_\_\_
- g. Building Owner Name: Greg Westphal Phone Number: 414-614-6960  
 Business Owner Address: 5401 N Lovers Lane Road, Milwaukee, WI-53225

## 10. Hours of Operation & Customers

Will customers be entering the premises?  No  Yes

Day of the Week	Proposed Hours of Operation:		Estimated Number of Customers expected each day	Potential Age Range of Customers	Class B Tavern Applicant Only Age Restriction (If none, write 'None')
	Open Time (Include a.m. or p.m.)	Close Time (Include a.m. or p.m.)			
Sunday	9am	9pm	100+	25-55	None
Monday	9am	9pm	100+	25-55	None
Tuesday	9am	9pm	100+	25-55	None
Wednesday	9am	9pm	100+	25-55	None
Thursday	9am	9pm	100+	25-55	None
Friday	9am	9pm	100+	25-55	None
Saturday	9am	9pm	100+	25-55	None

An Extended Hours Establishment License is required for any convenience store, filling station, personal service establishment (such as tattoo, body piercing, salon, tailor, tanning, etc.), recording studio or restaurant which is open between the hours of 12:00 a.m. and 5:00 a.m.

Alcohol Establishments Permitted Hours of Operation: Class A: 8:00 am to 9:00 pm Sunday thru Saturday  
 Class B: 6:00 am to 2:00 am Sunday thru Thursday, 6:00 am to 2:30 am Friday & Saturday

Entertainment Outdoor Closing Hours: 10:00pm Sunday, Thursday; 12:00am Friday & Saturday; unless a different time, either earlier or later, is established by the Common Council in its approval of the licensee's plan of operation.

## 11. Signature(s)

Signature of Sole Proprietor, Partner, or 20% or more Shareholder  
 (If there are no 20% or more shareholders, Corporate Officer-print name/title and sign)

Signature of additional partner or 20% or more shareholder

See Application Information for a complete list of all required application forms.





# FOOD DEALER LICENSE PLAN OF OPERATION

OFFICE OF THE CITY CLERK, LICENSE DIVISION  
CITY HALL, 200 E. WELLS ST, ROOM 105, MILWAUKEE, WI 53202  
(414) 286-2238 • [license@milwaukee.gov](mailto:license@milwaukee.gov) • [www.milwaukee.gov/license](http://www.milwaukee.gov/license)

Legal Entity Name: 5417 N Lovers LLC

Premises Address: 5417 N Lovers Lane Road, Milwaukee, WI-53225

## SECTION 1 TYPE OF BUSINESS

What will be the majority of your food sales? (check one)

Restaurant Items (meals):  
MEALS include, but are not limited to, chicken, ribs, sandwiches, roasted corn, baked potatoes, hot dogs, brats, tacos, nachos w/ cheese and meat, French fries, cooked or deep fried vegetables/fruit, cooked cheese curds, corn dogs, egg rolls, salads.

Retail Items (snacks and beverages):  
RETAIL items include, but are not limited to, ice cream/soft serve, lemonade, snow cones, coffee, espresso, cappuccino, tea, fruit juice, smoothies, candy, dispensed soda, fruit cups, bakery, cookies, kettle corn, cotton candy, funnel cakes, fritters, tortilla chips w/ cheese.

Will it be a convenience store?  Yes  No

A convenience store contains less than 5,000 square feet of retail space and has, as its primary business, the sale of basic food items and in addition, sells household products or is a filling station that sells basic food items and household products.

- Bed & Breakfast
- Micro Market

All Applicants: Submit a menu or a list of food items that will be sold.

Will any wholesale business be done?  No  Yes If yes, what percentage of food sales will be wholesale?

Less than 25%

25% or More AND:

Restaurant items (meals) will be sold – Complete this application and also contact DATCP.

NO restaurant items (meals) will be sold - Do NOT complete this application. Contact DATCP only.

## SECTION 2 FOOD PROCESSING

Will any food processing be done?  No  Yes

Processing is defined as assembling, grinding, cutting, mixing, baking, coating, stuffing, packing, bottling, grilling, canning, extracting, fermenting, distilling, pickling, freezing, drying, smoking, or packaging.

## SECTION 3 FOOD REQUIRING TEMPERATURE CONTROL

Will any food that requires temperature control be sold?  No  Yes  
(includes dairy products such as milk, cheese, and ice cream, fish, shellfish, meat, poultry)

If yes, list the types of food items: Milk, Eggs, Ice Cream, Frozen Food

**SECTION 4 DETAILS OF OPERATION**

Will you have seating on site for dining?  No  Yes

Will you be doing any catering?  No  Yes

Will you be doing any delivery?  No  Yes

Will you have outdoor activities?  No  Yes - Check all that apply:  Bar  Cooking/Grilling  Dining

Will you have a drive thru window?  No  Yes - Are hours different from inside?  No  Yes  
 If Yes, provide drive thru hours: \_\_\_\_\_

Will scales or barcode scanners be used?  No  Yes - You must also apply for a Weights & Measures License.

**SECTION 5 ADDITIONAL SITES**

Where will food be prepared and/or sold?

At a single site  At multiple sites: How many? \_\_\_\_\_ (for example, a hotel with several dining rooms or bars)

If multiple sites, attach a Food Dealer Additional Site Addendum (ccl-foodadd) for each additional site.

**SECTION 6 CONSTRUCTION OR CHANGES**

Are you planning any construction, remodeling or equipment changes?

No If No, SKIP to Section 8

Yes If Yes, check all that apply:  New construction of a building  Renovation or remodeling  
 Construction changes to existing building  Equipment changes only

Provide a brief description of the changes: Installing Walk in Cooler

Start date: 12-15-190

Name, Address & Phone Number of Architect: Bill Morris  
262-620-0563

Name, Address & Phone Number of Contractor: 3685 S 4th Ave, Kenosha, WI

**SECTION 7 ALCOHOL BEVERAGES**

Are you applying for an alcohol beverage license?

No If No, SKIP to Section 9

Yes If YES, if your food license is approved prior to the alcohol license, when do you want the food license issued?

Immediately  At the same time as the alcohol license

**SECTION 8 ACKNOWLEDGEMENTS & SIGNATURE**

You must initial each item confirming your understanding:

AA I understand the Health Department must conduct an inspection and advise the License Division of their approval before the license may be issued.

AA I understand I must obtain an occupancy permit from the Department of Neighborhood Services and an inspection may be required. Neighborhood Services must advise the License Division of their approval before the license may be issued.

AA I understand the district alderperson will review and either support or object to my application. If he/she objects, I may appeal and be scheduled to appear before the Licenses Committee. The Licenses Committee will then make a recommendation to the Common Council. The Common Council must grant the license before it may be issued.

AA I understand proof of payment for all license fees must be on file in the License Division before the license may be issued and the license must be issued and posted in my establishment prior to opening for business.

AA I will not operate my food business until the license has been issued and posted in the establishment.

Signature of Sole Proprietor, Partner, or 20% Shareholder: [Signature]

Signature of Additional Partner: \_\_\_\_\_

# List of items

- Milk
- Eggs
- Cereals
- Chips
- Can Foods
- Frozen Meals
- Ice Creams
- Sauce bottles
- Pastas
- Beer
- Wine
- Liqueur
- Snack items. Peanuts, Granola bars
- Towel, Tissue
- cleaning supply.

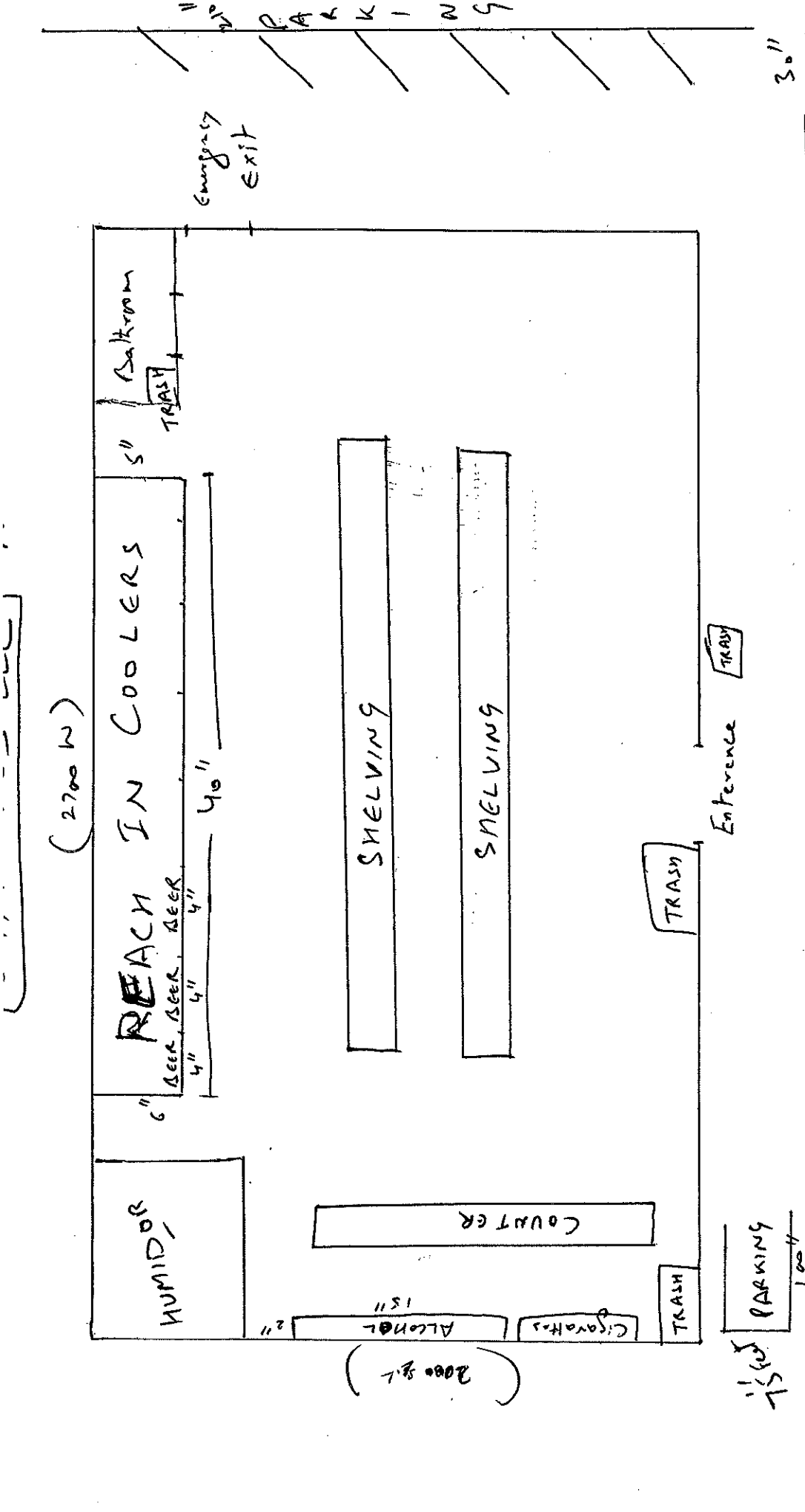

SHHY 100

4700 sq. Foot

N →

9/16/19

5417 N. Lovers Lane Road, Milwaukee



**CITY OF MILWAUKEE  
OFFICE OF THE CITY CLERK**

Wednesday, January 22, 2020

**COMMITTEE MEETING NOTICE**

AD 05

Joe M Anderson

6171 N 118th St

Milwaukee, WI 53225

You are requested to attend a hearing which is to be held in Room 301-B, Third Floor, City Hall on:

**Tuesday, January 28, 2020 at 11:00 AM**

**Regarding:** Your Secondhand Motor Vehicle Dealer's - Whole  Only License Application for "Anderson investments" at 6171 N 118th St.

There is a possibility that your application may be denied for one or more of the following reasons: Neighborhood Objections to the granting of such a license due to the creation of undesirable neighborhood problems, such as: parking and traffic problems which cause the normal flow of traffic on roadways and alleys to be impeded, loitering, littering, noise, loud music, and conduct which will have an adverse impact on the public health, safety and welfare of the community. Additionally, the over concentration of secondhand motor vehicle dealers in the neighborhood such that the concentration will have an adverse impact on the public health, safety and welfare of the neighborhood. you do not meet the statutory and municipal requirements; the appropriateness of the location to be licensed and whether the location will create undesirable neighborhood problems, whether or not you have been charged with or convicted of any felony, misdemeanor, municipal offense or other offense, the circumstances of which substantially relate to the licensed activity; and any other factors which reasonably relate to the public health, safety and welfare. Please be advised the public will be able to provide information to the committee in person or in writing. The committee will receive and consider evidence regarding the above mentioned criteria.

**Notice for applicants with warrants or unpaid fines:**

Proof of warrant satisfaction or payment of fines must be submitted at the hearing on the above date and time. Failure to comply with this requirement may result in a delay of the granting/denial of your application.

Failure to appear at this meeting may result in the denial of your license. Individual applicants must appear only in person or by an attorney. Corporate or Limited Liability applicants must appear only by the agent designated on the application or by an attorney. Partnership applicants must appear by a partner listed on the application or by an attorney. If you wish to do so and at your own expense, you may be accompanied by an attorney of your choosing to represent you at this hearing.

You will be given an opportunity to speak on behalf of the application and to respond and challenge any charges or reasons given for the denial. No petitions can be accepted by the committee, unless the people who signed the petition are present at the committee hearing and willing to testify. You may present witnesses under oath and you may also confront and cross-examine opposing witnesses under oath. If you have difficulty with the English language, you should bring an interpreter with you, at your expense, so that you can answer questions and participate in your hearing.

You may examine the application file at this office during regular business hours prior to the hearing date. Inquiries regarding this matter may be directed to the person whose signature appears below.

Limited parking for persons attending meetings in City Hall is available at reduced rates (5 hour limit) at the Milwaukee Center on the southwest corner of East Kilbourn and North Water Street. Parking tickets must be validated in the first floor information booth in City Hall.

PLEASE NOTE: Upon reasonable notice, efforts will be made to accommodate the needs of disabled individuals through sign language interpreters or other auxiliary aids. For additional information or to request this service, contact the Council Services Division ADA Coordinator at (414) 286-2998, Fax - (414) 286-3456, TDD - (414) 286-2025.

JIM OWCZARSKI, CITY CLERK

BY: \_\_\_\_\_

Jessica Ceella

License Division Manager

**If you have questions regarding this notice, please contact the License Division at (414) 286-2238.**



Wednesday, January 22, 2020



# Notice of Public Hearing

---

ANDERSON, Joe M  
Anderson investments at 6171 N 118th St  
Secondhand Motor Vehicle Dealer's - Wholesale Only License Application

**Tuesday, January 28, 2020 at 11:00 AM**

To whom it may concern:

The above application has been made by the above named applicant(s). This requires approval from the Licenses Committee and the Common Council of the City of Milwaukee. The hearing before the Licenses Committee will take place on 1/28/2020 at 11:00 AM, in Room 301-B, Third Floor, City Hall. If you wish, you may provide testimony at the hearing regarding the request; see below for further information. You are not required to attend the hearing. Once the Licenses Committee makes its recommendation, this recommendation is forwarded to the full Common Council for approval at its next regularly scheduled hearing. Please review the information below and if you have further questions regarding this process, please contact the License Division at (414) 286-2238.

---

## Important details for those wishing to provide information for the Licenses Committee to consider when making its recommendation:

1. The license application is scheduled to be heard at the above time. Due to other hearings running longer than scheduled, you may have to wait some time to provide your testimony.
2. You must appear in person and testify as to matters that you have personally experienced or seen. (You cannot provide testimony for your neighbor, parent or anyone else; this is considered hearsay and cannot be considered by the committee.)
3. No letters or petitions can be accepted by the committee (unless the person who wrote the letter or the persons who signed the petition are present at the committee hearing and willing to testify).
4. Persons opposed to the license application are given the opportunity to testify first; supporters may testify after the opponents have finished.
5. When you are called to testify, you will be sworn in and asked to give your name, and address. (If your first and/or last names are uncommon please spell them.)
6. You may then provide testimony.
  - a. Include only information relating to the above license application.
  - b. Include only information you have personally witnessed or seen.
  - c. Provide concise and relevant information detailing how this business has affected or may affect the peaceful enjoyment of your neighborhood.
  - d. If by the time you have the opportunity to testify, the information you wish to share has already been provided to the committee, you may state that you agree with the previous testimony. Redundant or repetitive testimony will not assist the committee in making its recommendation.
7. After giving your testimony, the members of the Licenses Committee and the licensee may ask questions regarding the testimony you have given or other factors relating to the license application.
8. Business Competition is not a valid basis for denial or non-renewal of a license.  
**Please Note: If you have submitted an objection to the above application your objection cannot be considered by the committee unless you personally testify at the hearing.**

OCCUPANT	MAIL ADDRESS	CITY, STATE ZIP
CURRENT OCCUPANT	6209A N 118TH ST	MILWAUKEE, WI 53225
CURRENT OCCUPANT	11915 W LYNX AVE	MILWAUKEE, WI 53225
CURRENT OCCUPANT	6125 N 118TH ST	MILWAUKEE, WI 53225
CURRENT OCCUPANT	11904 W LYNX AVE	MILWAUKEE, WI 53225
CURRENT OCCUPANT	11914 W LYNX AVE	MILWAUKEE, WI 53225
CURRENT OCCUPANT	6126 N 118TH ST	MILWAUKEE, WI 53225
CURRENT OCCUPANT	6140 N 118TH ST	MILWAUKEE, WI 53225
CURRENT OCCUPANT	11915 W RIO ST	MILWAUKEE, WI 53225
CURRENT OCCUPANT	11914 W RIO ST	MILWAUKEE, WI 53225
CURRENT OCCUPANT	11900 W RIO ST	MILWAUKEE, WI 53225
CURRENT OCCUPANT	6129 N 118TH ST	MILWAUKEE, WI 53225
CURRENT OCCUPANT	6139 N 118TH ST	MILWAUKEE, WI 53225
CURRENT OCCUPANT	6220 N 118TH ST	MILWAUKEE, WI 53225
CURRENT OCCUPANT	6137 N 117TH ST	MILWAUKEE, WI 53225
CURRENT OCCUPANT	6147 N 117TH ST	MILWAUKEE, WI 53225
CURRENT OCCUPANT	6160 N 118TH ST	MILWAUKEE, WI 53225
CURRENT OCCUPANT	11922 W RIO ST	MILWAUKEE, WI 53225
CURRENT OCCUPANT	6169 N 117TH ST	MILWAUKEE, WI 53225
CURRENT OCCUPANT	11925 W LYNX AVE	MILWAUKEE, WI 53225
CURRENT OCCUPANT	11901 W RIO ST	MILWAUKEE, WI 53225
CURRENT OCCUPANT	6183 N 118TH ST	MILWAUKEE, WI 53225
CURRENT OCCUPANT	6217 N 118TH ST	MILWAUKEE, WI 53225
CURRENT OCCUPANT	6180 N 118TH ST	MILWAUKEE, WI 53225
CURRENT OCCUPANT	6181 N 117TH ST	MILWAUKEE, WI 53225
CURRENT OCCUPANT	6150 N 119TH ST	MILWAUKEE, WI 53225
CURRENT OCCUPANT	6204 N 118TH ST	MILWAUKEE, WI 53225
CURRENT OCCUPANT	6205 N 117TH ST	MILWAUKEE, WI 53225
CURRENT OCCUPANT	6150 N 118TH ST	MILWAUKEE, WI 53225
CURRENT OCCUPANT	6157 N 117TH ST	MILWAUKEE, WI 53225
CURRENT OCCUPANT	6171 N 118TH ST	MILWAUKEE, WI 53225
CURRENT OCCUPANT	6163 N 118TH ST	MILWAUKEE, WI 53225
CURRENT OCCUPANT	6170 N 118TH ST	MILWAUKEE, WI 53225
CURRENT OCCUPANT	11901 W LYNX AVE	MILWAUKEE, WI 53225

Total Records: 33

Radius: 250.0 feet and Center of Circle: 6171 N 118th St



# BUSINESS LICENSE PLAN OF OPERATION

ccl-busplan 3/15/18

Office of the City Clerk License Division  
200 E. Wells St. Room 105, Milwaukee, WI 53202  
(414) 286-2238 www.milwaukee.gov/license e-mail address: [license@milwaukee.gov](mailto:license@milwaukee.gov)

## 1. Type of Business

Applying for:  Extended Hours (12AM to 5AM) - If a food establishment, check all that apply:  Delivery  Drive Thru  Dining Room  
 Self Service Laundry  Massage Establishment  Filling Station  
 Other (supplemental application for specific license also required)

Provide a detailed description of the type of business you plan on operating:  
*wholesale of motor vehicles*

Do you have any experience operating this type of business?  No  Yes If yes, explain:

## 2. Business Operations

a. Proposed Opening Date: *12.20.19*  
b. Is this premise under construction?  No  Yes If yes, list estimated completion date: \_\_\_\_\_  
c. Is this a franchise?  No  Yes  
d. Is this premises currently licensed?  No  Yes If yes, list type of license: \_\_\_\_\_  
e. Is the current licensee operating?  No  Yes If no, list date closed: \_\_\_\_\_  
f. Do you have future plans for other businesses, licenses or permits at this location?  No  Yes  
If yes, explain: \_\_\_\_\_  
g. Have you previously held an Extended Hours License in Milwaukee?  No  Yes  
If yes, list address(es): \_\_\_\_\_  
h. Are other businesses operating in the same building?  No  Yes If yes, describe: \_\_\_\_\_

## 3. Litter & Noise

a. How are grounds kept clean?  Sweep  Pressure Wash  Pick Up Litter  Other: \_\_\_\_\_  
b. How often will grounds be cleaned?  Daily  Weekly  As Needed  Monthly  Other: \_\_\_\_\_  
c. Grounds cleaned by:  Licensee  Building Owner  Employees  Hired Maintenance  Other: \_\_\_\_\_  
d. How are noise issues prevented and/or addressed?  Security  Manager approaches customer(s)  Call Police  
 Signs Posted  Other: \_\_\_\_\_  
e. Will a sound amplification system be used?  No  Yes If yes, describe: \_\_\_\_\_

## 4. Smoking & Sanitation

a. Are there designated outdoor smoking areas?  No  Yes If yes, describe: \_\_\_\_\_  
b. Number of Garbage Cans: Inside: *2* Locations: *Basement*  
Outside: *2* Locations: *drive way*  
c. Is a crowd control barrier used?  No  Yes If yes, describe: \_\_\_\_\_  
d. How many restrooms are on the premises? *2*  
e. Name of solid waste contractor:  Advanced Disposal  Waste Management  Other: \_\_\_\_\_



## 5. Security

- a. Are there onsite parking spaces?  No  Yes If yes, how many? 2 and describe the parking security plan: compad
- b. Is there a loading zone?  No  Yes If yes, describe the loading area security plan: \_\_\_\_\_
- c. Will you have security personnel on premise?  No  Yes If yes, how many? \_\_\_\_\_ and answer the following:  
 What are their responsibilities? \_\_\_\_\_  
 Is security equipment used?  No  Yes If yes, describe cameras  
 List their licensing, certification, or training credentials \_\_\_\_\_
- d. Will there be security cameras?  No  Yes If yes, how many? 4 and list locations: outside House
- e. Will searches/identification checks be done upon entry?  No  Yes If yes, describe \_\_\_\_\_

## 6. Percentage of Sales (must total 100%)

Alcohol <u>0</u> %	Food <u>0</u> %	Secondhand Merchandise _____ %	Precious Metals & Gems _____ %
Entertainment <u>0</u> %	Cigarettes <u>0</u> %		
Pawnbroker Activity <u>0</u> %	Salvaged Materials <u>0</u> % (such as scrap metal)	Personal Services (such as tattoo, body piercing, salon, tailor, tanning, etc.) <u>0</u> %	Other <u>100</u> % Describe: <u>wholesale Auto</u>

## 7. Businesses/Licenses on the Premises (check all that apply):

### Type 1

- Full Service Restaurant     Cafe/Coffee Shop     Deli or Fast Food Restaurant     Private/Fraternal/Veterans Club
- Night Club     Tavern     Cocktail Lounge     Teen Club
- Banquet Hall     Sports Facility     Bowling Alley
- Hotel/Motel: Number of Floors: \_\_\_\_\_ Number of Rooms: \_\_\_\_\_  
 Rooming House: Number of Floors: \_\_\_\_\_ Number of Rooms: \_\_\_\_\_

### Type 2

- Liquor Store     Corner Store     Supermarket     Convenience Store
- Gas Station     Amusement/Phonograph Distributor     Recycling, Salvage or Towing
- Used Car Dealer     Personal Service Establishment  
(such as tattoo business, hair salon, tailor, etc.)     Recording Studio

What other licenses/permits will you hold at this location? (check all that apply)

- Occupancy Permit     Cigarette & Tobacco     Gas Station     Extended Hours     Class "B" Tavern     Weights & Measures
- Secondhand Dealer     Precious Metal & Gem     Other: \_\_\_\_\_

## 8. Legal Capacity (only if a Type 1 premises in #7 above)

Capacity \_\_\_\_\_ (Call the Milwaukee Development Center at 414-286-8211 if you have questions.)

## 9. Premises Description

- a. Identify all area(s) of the premises that will be used in operating this business (include areas used only for storage):  
 1<sup>st</sup> Floor  2<sup>nd</sup> Floor  Basement Storage  Patio  Beer Garden  Sidewalk Café  Deck  Rooftop  
 Other: Describe: \_\_\_\_\_
- b. Describe Location:  Major Thoroughfare  Secondary Street  Other: \_\_\_\_\_
- c. Nearest Major Cross Street: Florist Ave
- d. Describe Building:  Free Standing Building  Strip Mall  Other: \_\_\_\_\_
- e. Describe Premises Structure:  Single Story  Multi-Story - # of Stories \_\_\_\_\_  Other: \_\_\_\_\_
- f. Describe Surrounding Area:  Commercial  Residential  Industrial  Other: \_\_\_\_\_
- g. Building Owner Name: Joe Anderson Phone Number: 414-915-0987  
 Business Owner Address: 121 W 118th

## 10. Hours of Operation & Customers

Will customers be entering the premises?  No  Yes

Day of the Week	Proposed Hours of Operation:		Estimated Number of Customers expected each day	Potential Age Range of Customers	Class B Tavern Applicant Only: Age Restriction (If none, write 'None')
	Open Time (include a.m. or p.m.)	Close Time (include a.m. or p.m.)			
Sunday	—	—	0		
Monday	8:00 A.M.	4:00 P.M.	3		
Tuesday	8:00 A.M.	4:00 P.M.	3		
Wednesday	9:00 A.M.	3:00 P.M.	3		
Thursday	9:00 A.M.	3:00 P.M.	3		
Friday	9:00 P.M.	3:00 P.M.	3		
Saturday	—	—	0		

An Extended Hours Establishment License is required for any convenience store, filling station, personal service establishment (such as tattoo, body piercing, salon, tailor, tanning, etc.), recording studio or restaurant which is open between the hours of 12:00 a.m. and 5:00 a.m.

Alcohol Establishments Class A: 8:00 am to 9:00 pm Sunday thru Saturday  
 Permitted Hours of Operation: Class B: 6:00 am to 2:00 am Sunday thru Thursday, 6:00 am to 2:30 am Friday & Saturday

Entertainment Outdoor Closing Hours: 10:00pm Sunday-Thursday; 12:00am Friday & Saturday; unless a different time, either earlier or later, is established by the Common Council in its approval of the licensee's plan of operation.

## 11. Signature(s)

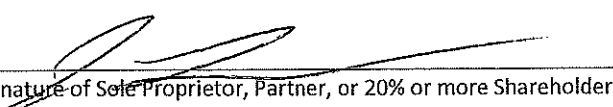
  
 Signature of Sole Proprietor, Partner, or 20% or more Shareholder  
 (If there are no 20% or more shareholders,  
 Corporate Officer-print name/title and sign)

\_\_\_\_\_  
 Signature of additional partner or 20% or more shareholder

See Application Information for a complete list of all required application forms.



SECONDHAND MOTOR VEHICLE DEALER LICENSE
SUPPLEMENTAL PLAN OF OPERATION

Office of the City Clerk License Division
200 E. Wells St. Room 105, Milwaukee, WI 53202
(414) 286-2238 e-mail address: license@milwaukee.gov

Legal Entity Name: Anderson Investments

Premises Address: 6121 W 118th

SECTION 1 LICENSE TYPE

What type of license are you applying for? (check one) [ ] Retail [X] Wholesale

SECTION 2

Will you also be dealing in secondhand vehicle parts? [ ] Yes [X] No

If wholesale, is the premises address a residential (home) address? [X] Yes [ ] No

If yes, you must obtain a Home Occupational Statement from the Department of Neighborhood Services (414) 286-3874.

No vehicles can be parked and no customers are allowed at the premises.

The following questions in Section 2 do not apply to wholesale from a residential address. Go to Section 3.

Number of parking spaces available to customers/employees 1

Number of parking spaces that will be used for display/storage of Secondhand Motor Vehicles 2

Do you understand that all vehicles associated with the business must be stored on the licensed premise? [X] Yes [ ] No

What are your plans to ensure this requirement is met (check all that apply)? [ ] Employee Training

[X] Supervisor Monitoring [ ] Fenced Lot [ ] Keys Kept in Locked Box [ ] Other:

Do you understand all maintenance/repair work to these vehicles must be confined to the licensed premise? [X] Yes [ ] No

What are your plans to ensure this requirement is met (check all that apply)? [ ] Employee Training

[ ] Supervisor Monitoring [X] Designated Repair Area [ ] Other:

Do you understand all keys to used motor vehicles offered for sale must be kept in a secure lockbox inside the dealership building at all times when the dealership is not open for business? [X] Yes [ ] No

What are your plans to ensure this requirement is met (check all that apply)? [ ] Employee Training

[X] Supervisor Monitoring [ ] Other:

SECTION 3 DISCLOSURE

Has any person on the application ever had a license relating to the activities licensed in Milwaukee Code of Ordinances Chapter 92 denied, not renewed, suspended, or revoked? [ ] No [X] Yes

If yes, provide the circumstances and jurisdiction in which the event occurred (including a record of any actions from the State Department of Transportation and Financial Institutions relating to suspensions, revocations, forfeitures and warnings imposed by these departments relating to the operation of any automotive sales business by the applicant):

SECTION 4 SIGNATURES

Sole Proprietor, Partner, or 20% or more Shareholder (If there are no 20% or more shareholders, Corporate Officer-print name/title and sign)

Additional partner or 20% or more shareholder



APPLICATION AMENDMENT

Office of the City Clerk License Division
200 E. Wells Street, Room 105, Milwaukee, WI 53202 (414) 286-2238

302672
ccl-amend 9/10/18

Date: 1-7-19

To the License Division of the City of Milwaukee:

I, Joe Anderson, wish to amend my answer(s) on the application for a
wholesale license at 6171 N 118th
(full legal name) (type of license) (premises address, if applicable)

by adding or amending the following information (complete only those sections being amended):

- 1. Answer to Question(s) # should be:
2. Agent should be (full legal name): Also complete 3, 4, 5 & 6
3. Date of birth should be:
4. Home address should be (include city/state/zip):
5. Phone number should be (include area code):
6. Driver's License Number/State ID Number should be:
7. Corporation/LLC name should be (full legal name):
8. Business name should be:
9. Premises address should be (include city/state/zip):
10. Business phone number should be (include area code):
11. Mailing address should be (include city/state/zip):
12. Email address should be:
13. Recycling/Salvaging/Towing: Location where vehicle will be parked should be (include city/state/zip):
14. Class B Tavern: Age Distinction should be:
15. Other: Remove all parking spaces

(Check with the License Division before submitting "Other" amendments using this form.)

Signature of Licensee (Individual, Partner, or Agent of Corp/LLC)

Office Use Only: Application #: 302672 Date: 1-7-2020 Initials: [Signature] To LC:
LC Email: [ ]MPD [ ]NS [ ]HD Initials:

Print 5



**CITY OF MILWAUKEE  
OFFICE OF THE CITY CLERK**

Wednesday, January 22, 2020

**COMMITTEE MEETING NOTICE**

AD 05

ANDERSON, Kizzie A, Agent  
FIRE SIDE BBQ AND GRILL LLC  
9500 N Carlotta Ln  
Brown Deer, WI 53223

You are requested to attend a hearing which is to be held in Room 301-B, Third Floor, City Hall on:

**Tuesday, January 28, 2020 at 11:00 AM**

**Regarding:** Your Class B Tavern, Public Entertainment Premises, and Food Dealer License Applications Requesting Jukebox, Bands, Karaoke, Comedy Acts, and 1 Pool Table as agent for "FIRE SIDE BBQ AND GRILL LLC" for "Fireside" at 7706 W BURLEIGH St.



There is a possibility that your application may be denied for one or more of the following reasons: The recommendation of the committee regarding the application shall be based on evidence presented at the hearing. Per MCO 85-2.7-4, probative evidence concerning whether or not a new license should be granted may be presented on the following subjects: whether or not the applicant meets the municipal requirements, the appropriateness of the location and premises where the licensed premises is to be located and whether use of the premises for the purposes or activities permitted by the license would tend to facilitate a public or private nuisance or create undesirable neighborhood problems such as disorderly patrons, unreasonably loud noise, litter, and excessive traffic and parking congestion. Probative evidence relating to these matters may be taken from the plan of operation submitted with the license application, if any, but shall not include the content of any music. Evidence regarding the fitness of the location of the premises to be maintained as the principal place of business, including but not limited to whether there is an overconcentration of businesses of the type for which the license is sought; whether the proposal is consistent with any pertinent neighborhood business or development plans, or the location's proximity to areas where children are typically present. The applicant's record in operating similarly licensed premises; and whether or not the applicant has been charged with or convicted of any felony, misdemeanor, municipal offense or other offense, the circumstances of which substantially relate to the activity to be permitted by the license being applied for or any other factor which reasonably relates to the public health, safety or welfare may also be considered. See attached police report or correspondence.

**Notice for applicants with warrants or unpaid fines:**

Proof of warrant satisfaction or payment of fines must be submitted at the hearing on the above date and time. Failure to comply with this requirement may result in a delay of the granting/denial of your application.

Failure to appear at this meeting may result in the denial of your license. Individual applicants must appear only in person or by an attorney. Corporate or Limited Liability applicants must appear only by the agent designated on the application or by an attorney. Partnership applicants must appear by a partner listed on the application or by an attorney. If you wish to do so and at your own expense, you may be accompanied by an attorney of your choosing to represent you at this hearing.

You will be given an opportunity to speak on behalf of the application and to respond and challenge any charges or reasons given for the denial. No petitions can be accepted by the committee, unless the people who signed the petition are present at the committee hearing and willing to testify. You may present witnesses under oath and you may also confront and cross-examine opposing witnesses under oath. If you have difficulty with the English language, you should bring an interpreter with you, at your expense, so that you can answer questions and participate in your hearing.

You may examine the application file at this office during regular business hours prior to the hearing date. Inquiries regarding this matter may be directed to the person whose signature appears below.

Limited parking for persons attending meetings in City Hall is available at reduced rates (5 hour limit) at the Milwaukee Center on the southwest corner of East Kilbourn and North Water Street. Parking tickets must be validated in the first floor information booth in City Hall.

PLEASE NOTE: Upon reasonable notice, efforts will be made to accommodate the needs of disabled individuals through sign language interpreters or other auxiliary aids. For additional information or to request this service, contact the Council Services Division ADA Coordinator at (414) 286-2998, Fax - (414) 286-3456, TDD - (414) 286-2025.

JIM OWCZARSKI, CITY CLERK

BY:

Jessica Celella

License Division Manager

**If you have questions regarding this notice, please contact the License Division at (414) 286-2238.**

200 E. Wells Street, Room 105; City Hall, Milwaukee, WI 53202. [www.milwaukee.gov/license](http://www.milwaukee.gov/license)  
Phone: (414) 286-2238 Fax: (414) 286-3057 Email Address: [License@milwaukee.gov](mailto:License@milwaukee.gov)

Moon Siefert, Linda

---

**From:** License  
**Sent:** Monday, December 30, 2019 3:22 PM  
**To:** Moon Siefert, Linda  
**Cc:** Martin, Faviola  
**Subject:** FW: Fireside application

**Follow Up Flag:** Follow up  
**Flag Status:** Flagged

**Categories:** Red Category

**REDACTED RECORD**

Please attached

Keren Becker  
License Specialist III  
City Clerk – License Division  
O: (414) 286-2238  
[License@Milwaukee.gov](mailto:License@Milwaukee.gov)  
[www.Milwaukee.gov/license](http://www.Milwaukee.gov/license)

-----Original Message-----

**From:**  
**Sent:** Monday, December 30, 2019 1:04 PM  
**To:** License  
**Subject:** Fireside application

This is [redacted] We are [redacted] to the  
proposed license of Fireside BBQ & Grill.  
I (we) do not oppose the license itself, but do object to having bands and karaoke.  
There is also a concern of the customers parking in front of our [redacted] shop and to the corner during our open hours,  
leaving no parking for our customers and the other 2 businesses next to us.

Date: 1/10/2020

Officer: Bowie Buchner

City of Milwaukee Police Department

90-5-1.5 Crime Prevention Survey

Tavern Inspection

Name of Premise: Fireside

Address: 7706 W Burleigh St

Phone:

Owner: Kizzie Anderson

Owner address: 9500 N Carlotta La

City State Zip: Brown Deer, WI 53223

Owner Phone: 414-418-4410

Owner email: kizbland31@gmail.com

Licensee/Agent: Kizzie Anderson

Home Address: 9500 N Carlotta La

City State Zip: Brown Deer, WI, 53223

Phone: 414-418-4410

Email: kizbland31@gmail.com

Preferred contact: Kizzie Anderson

Other: Yes No Type:Public Entertainment #: PEP 303934

Other: Yes No Type:Click here to enter text. #: Click here to enter text.

**Exterior Survey:**

1. Is the area around the location clean? Yes No
2. What surrounds the location? (Check all the apply)
  - a. Park
  - b. School
  - c. Youth Center
  - d. Church
  - e. Tavern(s) If so, how many Click here to enter text.
  - f. Residential
  - g. Other businesses
  - h. Other: Click here to enter text.
3. Can you see from the outside of the location into the interior Yes No
4. Can you see the employees inside of the location from the outside Yes No
5. Are exterior windows free of signage Yes No
6. Is there a parking lot Yes No
7. Is the parking lot clean? Yes No
8. Off-Street parking Yes No
9. Is the parking lot well lit? Yes No
10. Valet Parking Yes No
  - a. Will this lot have a guard? Yes No
  - b. Will this lot have cameras? Yes No



**Interior Survey:**

25. What is the planned capacity Unknown what the capacity was for sure, but she thought is was over 100

26. What is the minimum number of employees that will be on premise 6

27. Is the storeowner willing to be a standing complainant regarding loitering? Yes No

a. If yes have them fill out the standing complaint form and give them two of the commercial signs Yes No

28. Is the interior of the location neat and clean? Yes No

29. Does an interior camera face the entrance/exit? Yes No

30. Is there a lockable area that separates employees from customers? Yes No

31. Are emergency and non-emergency numbers posted near the phone? Yes No

32. Does the owner know how to contact their police district directly? Yes No

a. Did you provide a district contact guide to the owner? Yes No

appears that when uncovered you will be able to see from the outside of the location into the interior. I was advised the person that was going to install the cameras was going to be coming and advising on how many cameras he thought would be required. I was advised at the time that they planned to have seven cameras covering the exterior and eight covering the interior. One of the interior camera will cover the entrance.



# Alcohol Concentration for 7706 W Burleigh St

City of Milwaukee, Wisconsin



## - Legend -

- Milwaukee parcels
- Street names 10,000
- City limits
- Freeways 15,000
- Freeways
- Exit ramps
- Entry ramps
- Ramps
- Major streets 10,000
- Streets 10,000
- Waterways
- Milwaukee parcels
- Alcohol Licenses
  - Class A Intoxicating Liquor
  - Class A Fermented Malt Beverage
  - Class A Liquor and Malt
  - Class B Fermented Malt Beverage
  - Class B Tavern
  - Class C Wine Retailer

## - Notes -

Alcohol Establishments within a .5 Mile Radius Centered on 7706 W Burleigh St as of 12/18/19



Department of Administration - ITMD

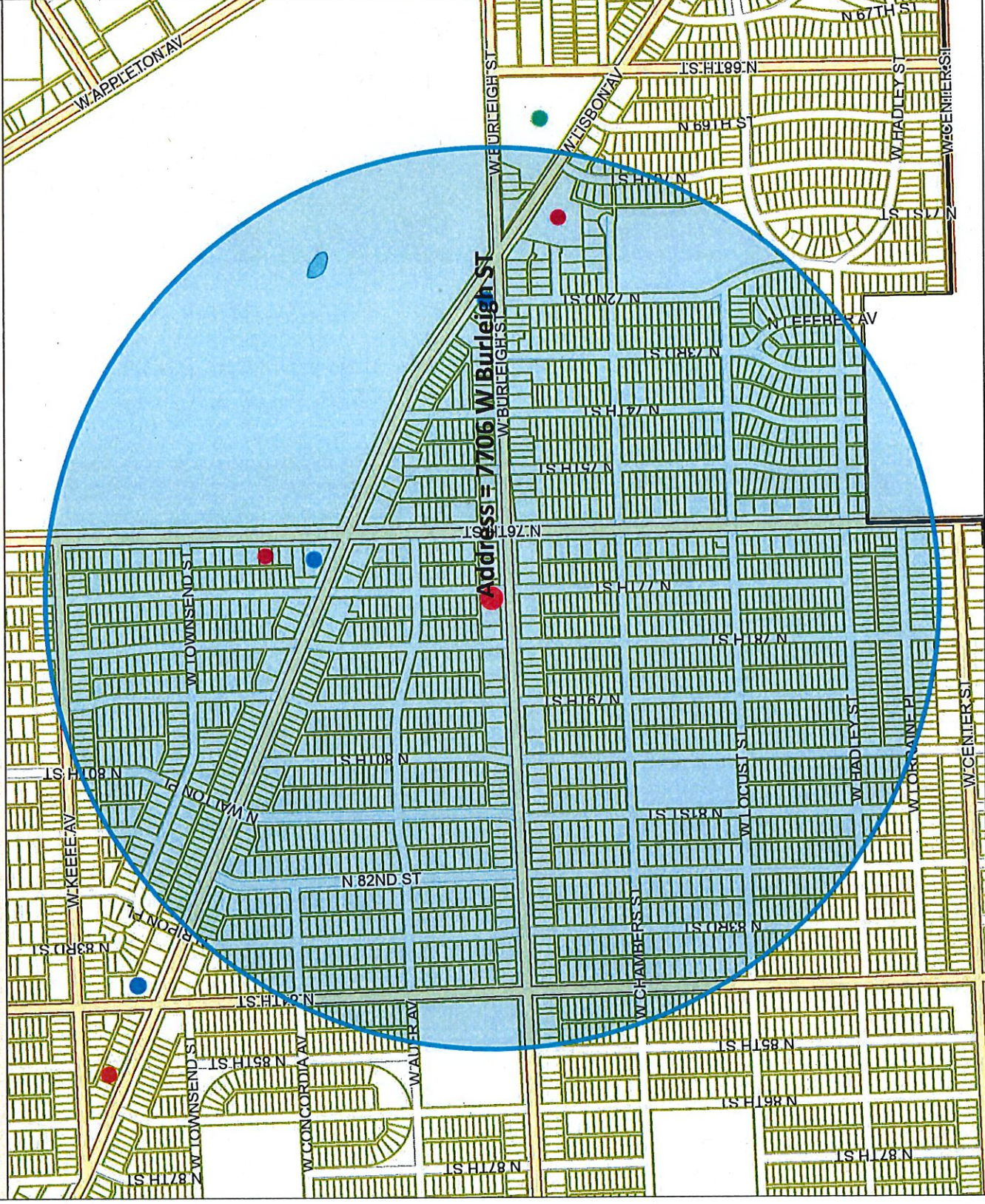

Map Scale: 1: 10,000



Licensed Alcohol Beverage Establishments within a .5 Miles Radius Centered on 7706 W Burleigh St as of 12/18/19										
License Summary										
Total										
Class A Malt & Class A Liquor License									2	
Class B Tavern License									2	
									4	
										Grand Total
CORP_NAME	TRADE_NAME	LICENSEE	ENTITY_ADDRESS	PROFESSION_FULL_NAME	TOT_CAP	EXPIRA				
C & G LIQUORS	C & G LIQUORS	CETTERY M GARDNER, SP	3307 N 76TH ST	Class A Malt & Class A Liquor License		11/26/2020				
SEFTAR & SON FOODS, INC	SENTRY FOODS #2815	Robert J Ahrens, Agt	7101 W LISBON AV	Class A Malt & Class A Liquor License		2/10/2020				
Gard's Restaurant & Lounge	Gard's Restaurant & Lounge	DENISE M FONDER, SP	7170 W Burleigh ST	Class B Tavern License	80	8/23/2020				
JERAUG, INC	THE CORNER PUB	DAVID P PESCHEK, Agt	7602 W LISBON AV	Class B Tavern License	83	6/30/2020				



Wednesday, January 22, 2020

## Licenses Committee Notice of Hearing

HOME AT HEART PROPERTIES CO  
7718 W Burleigh St  
Milwaukee, WI 53222

Date: 1/28/2020  
Time: 11:00 AM  
Location: Room 301-B, Third Floor, City Hall

The Licenses Committee will consider the following license application:

Class B Tavern, Public Entertainment Premises, and Food Dealer License  
Applications Requesting Jukebox, Bands, Karaoke, Comedy Acts, and 1 Pool Table  
ANDERSON, Kizzie A, Agent  
Fireside at 7706 W BURLEIGH St

Please note this application may be recommended for denial based on fitness of the location due to concentration of alcohol beverage outlets in the area. If the application is denied for this reason, no other application for an alcohol beverage license for this location shall be recommended for approval by the Licenses Committee within three years of the date of denial unless the applicant has demonstrated a change of circumstances since the prior denial.

If you have any questions, please call (414) 286-2238.





Wednesday, January 22, 2020

## Licenses Committee Notice of Hearing

HOME AT HEART PROPERTIES CO  
PO Box 242228  
Milwaukee, WI 53224

Date: 1/28/2020  
Time: 11:00 AM  
Location: Room 301-B, Third Floor, City Hall

The Licenses Committee will consider the following license application:

Class B Tavern, Public Entertainment Premises, and Food Dealer License  
Applications Requesting Jukebox, Bands, Karaoke, Comedy Acts, and 1 Pool Table  
ANDERSON, Kizzie A, Agent  
Fireside at 7706 W BURLEIGH St

Please note this application may be recommended for denial based on fitness of the location due to concentration of alcohol beverage outlets in the area. If the application is denied for this reason, no other application for an alcohol beverage license for this location shall be recommended for approval by the Licenses Committee within three years of the date of denial unless the applicant has demonstrated a change of circumstances since the prior denial.

If you have any questions, please call (414) 286-2238.





Wednesday, January 22, 2020



# Notice of Public Hearing

---

ANDERSON, Kizzie A, Agent  
Fireside at 7706 W BURLEIGH St  
Class B Tavern, Public Entertainment Premises, and Food Dealer License Applications  
Requesting Jukebox, Bands, Karaoke, Comedy Acts, and 1 Pool Table

**Tuesday, January 28, 2020 at 11:00 AM**

To whom it may concern:

The above application has been made by the above named applicant(s). This requires approval from the Licenses Committee and the Common Council of the City of Milwaukee. The hearing before the Licenses Committee will take place on 1/28/2020 at 11:00 AM, in Room 301-B, Third Floor, City Hall. If you wish, you may provide testimony at the hearing regarding the request; see below for further information. You are not required to attend the hearing. Once the Licenses Committee makes its recommendation, this recommendation is forwarded to the full Common Council for approval at its next regularly scheduled hearing. Please review the information below and if you have further questions regarding this process, please contact the License Division at (414) 286-2238.

---

## Important details for those wishing to provide information for the Licenses Committee to consider when making its recommendation:

1. The license application is scheduled to be heard at the above time. Due to other hearings running longer than scheduled, you may have to wait some time to provide your testimony.
2. You must appear in person and testify as to matters that you have personally experienced or seen. (You cannot provide testimony for your neighbor, parent or anyone else; this is considered hearsay and cannot be considered by the committee.)
3. No letters or petitions can be accepted by the committee (unless the person who wrote the letter or the persons who signed the petition are present at the committee hearing and willing to testify).
4. Persons opposed to the license application are given the opportunity to testify first; supporters may testify after the opponents have finished.
5. When you are called to testify, you will be sworn in and asked to give your name, and address. (If your first and/or last names are uncommon please spell them.)
6. You may then provide testimony.
  - a. Include only information relating to the above license application.
  - b. Include only information you have personally witnessed or seen.
  - c. Provide concise and relevant information detailing how this business has affected or may affect the peaceful enjoyment of your neighborhood.
  - d. If by the time you have the opportunity to testify, the information you wish to share has already been provided to the committee, you may state that you agree with the previous testimony. Redundant or repetitive testimony will not assist the committee in making its recommendation.
7. After giving your testimony, the members of the Licenses Committee and the licensee may ask questions regarding the testimony you have given or other factors relating to the license application.
8. Business Competition is not a valid basis for denial or non-renewal of a license.  
**Please Note: If you have submitted an objection to the above application your objection cannot be considered by the committee unless you personally testify at the hearing.**

OCCUPANT	MAIL ADDRESS	CITY, STATE ZIP
CURRENT OCCUPANT	3075 N 78TH ST 1	MILWAUKEE, WI 53222
CURRENT OCCUPANT	3121 N 78TH ST	MILWAUKEE, WI 53222
CURRENT OCCUPANT	3126 N 77TH ST	MILWAUKEE, WI 53222
CURRENT OCCUPANT	3121 N 76TH ST 4	MILWAUKEE, WI 53222
CURRENT OCCUPANT	3142 N 78TH ST	MILWAUKEE, WI 53222
CURRENT OCCUPANT	3121 N 76TH ST 1	MILWAUKEE, WI 53222
CURRENT OCCUPANT	3148 N 78TH ST	MILWAUKEE, WI 53222
CURRENT OCCUPANT	3075 N 78TH ST 2	MILWAUKEE, WI 53222
CURRENT OCCUPANT	3126 N 78TH ST	MILWAUKEE, WI 53222
CURRENT OCCUPANT	3127 N 77TH ST	MILWAUKEE, WI 53222
CURRENT OCCUPANT	3136 N 77TH ST	MILWAUKEE, WI 53222
CURRENT OCCUPANT	3143 N 78TH ST	MILWAUKEE, WI 53222
CURRENT OCCUPANT	3105 N 77TH ST 4	MILWAUKEE, WI 53222
CURRENT OCCUPANT	3121 N 77TH ST	MILWAUKEE, WI 53222
CURRENT OCCUPANT	3121 N 76TH ST 3	MILWAUKEE, WI 53222
CURRENT OCCUPANT	3121 N 76TH ST 2	MILWAUKEE, WI 53222
CURRENT OCCUPANT	7631 W BURLEIGH ST	MILWAUKEE, WI 53222
CURRENT OCCUPANT	3120 N 77TH ST	MILWAUKEE, WI 53222
CURRENT OCCUPANT	3129 N 78TH ST	MILWAUKEE, WI 53222
CURRENT OCCUPANT	3132 N 78TH ST	MILWAUKEE, WI 53222
CURRENT OCCUPANT	3133 N 77TH ST	MILWAUKEE, WI 53222
CURRENT OCCUPANT	3132 N 77TH ST	MILWAUKEE, WI 53222
CURRENT OCCUPANT	3138 N 78TH ST	MILWAUKEE, WI 53222
CURRENT OCCUPANT	3143 N 77TH ST	MILWAUKEE, WI 53222
CURRENT OCCUPANT	3075 N 78TH ST 3	MILWAUKEE, WI 53222
CURRENT OCCUPANT	7702 W BURLEIGH ST 2	MILWAUKEE, WI 53222
CURRENT OCCUPANT	3120 N 78TH ST	MILWAUKEE, WI 53222
CURRENT OCCUPANT	3131 N 78TH ST	MILWAUKEE, WI 53222
CURRENT OCCUPANT	3075 N 78TH ST 4	MILWAUKEE, WI 53222
CURRENT OCCUPANT	7702 W BURLEIGH ST	MILWAUKEE, WI 53222
CURRENT OCCUPANT	3137 N 77TH ST	MILWAUKEE, WI 53222
CURRENT OCCUPANT	3142 N 77TH ST	MILWAUKEE, WI 53222
CURRENT OCCUPANT	3147 N 77TH ST	MILWAUKEE, WI 53222
CURRENT OCCUPANT	3105 N 77TH ST 3	MILWAUKEE, WI 53222
CURRENT OCCUPANT	3137 N 78TH ST	MILWAUKEE, WI 53222

Total Records: 35

Radius: 250.0 feet and Center of Circle: 7706 W Burleigh St





# BUSINESS LICENSE PLAN OF OPERATION

ccl-busplan 3/15/18

Office of the City Clerk License Division  
200 E. Wells St. Room 105, Milwaukee, WI 53202  
(414) 286-2238 www.milwaukee.gov/license e-mail address: license@milwaukee.gov

## 1. Type of Business

Applying for:  Extended Hours (12AM to 5AM) - If a food establishment, check all that apply:  Delivery  Drive Thru  Dining Room  
 Self Service Laundry  Massage Establishment  Filling Station  
 Other (supplemental application for specific license also required) Restaurant

Provide a detailed description of the type of business you plan on operating:

Restaurant (Full Service)

Do you have any experience operating this type of business?  No  Yes If yes, explain: Owned Restaurant in past

## 2. Business Operations

- a. Proposed Opening Date: February 18 2020
- b. Is this premise under construction?  No  Yes If yes, list estimated completion date: January 10th 2020
- c. Is this a franchise?  No  Yes
- d. Is this premises currently licensed?  No  Yes If yes, list type of license: \_\_\_\_\_
- e. Is the current licensee operating?  No  Yes If no, list date closed: \_\_\_\_\_
- f. Do you have future plans for other businesses, licenses or permits at this location?  No  Yes  
If yes, explain: \_\_\_\_\_
- g. Have you previously held an Extended Hours License in Milwaukee?  No  Yes  
If yes, list address(es): \_\_\_\_\_
- h. Are other businesses operating in the same building?  No  Yes If yes, describe: \_\_\_\_\_

## 3. Litter & Noise

- a. How are grounds kept clean?  Sweep  Pressure Wash  Pick Up Litter  Other: \_\_\_\_\_
- b. How often will grounds be cleaned?  Daily  Weekly  As Needed  Monthly  Other: \_\_\_\_\_
- c. Grounds cleaned by:  Licensee  Building Owner  Employees  Hired Maintenance  Other: \_\_\_\_\_
- d. How are noise issues prevented and/or addressed?  Security  Manager approaches customer(s)  Call Police  
 Signs Posted  Other: \_\_\_\_\_
- e. Will a sound amplification system be used?  No  Yes If yes, describe: \_\_\_\_\_

## 4. Smoking & Sanitation

- a. Are there designated outdoor smoking areas?  No  Yes If yes, describe: Outside
- b. Number of Garbage Cans: Inside: 6 Locations: behind both liquor stations, in each rest room  
Outside: 1 Locations: Behind Building (Dumpster)
- c. Is a crowd control barrier used?  No  Yes If yes, describe: \_\_\_\_\_
- d. How many restrooms are on the premises? 2
- e. Name of solid waste contractor:  Advanced Disposal  Waste Management  Other: \_\_\_\_\_

## 5. Security

- a. Are there onsite parking spaces?  No  Yes If yes, how many? \_\_\_\_\_ and describe the parking security plan: Street Parking
- b. Is there a loading zone?  No  Yes If yes, describe the loading area security plan: loading zone is in back of Restaurant in alley, and we have security cameras
- c. Will you have security personnel on premise?  No  Yes If yes, how many? \_\_\_\_\_ and answer the following:  
 What are their responsibilities? \_\_\_\_\_  
 Is security equipment used?  No  Yes If yes, describe \_\_\_\_\_  
 List their licensing, certification, or training credentials \_\_\_\_\_
- d. Will there be security cameras?  No  Yes If yes, how many? 5 and list locations: One in front at door area and in back, one in sitting area (front) one in back of sitting area one in hallway and restroom
- e. Will searches/identification checks be done upon entry?  No  Yes If yes, describe By bar / Alcohol purchase

## 6. Percentage of Sales (must total 100%)

Alcohol <u>20</u> %	Food <u>80</u> %	Secondhand Merchandise <u>0</u> %	Precious Metals & Gems _____ %
Entertainment _____ %	Cigarettes <u>0</u> %	Personal Services (such as tattoo, body piercing, salon, tailor, tanning, etc.) _____ %	Other _____ % Describe: _____
Pawnbroker Activity _____ %	Salvaged Materials _____ % (such as scrap metal)		

## 7. Businesses/Licenses on the Premises (check all that apply):

**Type 1**

Full Service Restaurant  Cafe/Coffee Shop  Deli or Fast Food Restaurant  Private/Fraternal/Veterans Club

Night Club  Tavern  Cocktail Lounge  Teen Club

Banquet Hall  Sports Facility  Bowling Alley

Hotel/Motel : Number of Floors: \_\_\_\_\_  Rooming House: Number of Floors: \_\_\_\_\_  
 Number of Rooms: \_\_\_\_\_ Number of Rooms: \_\_\_\_\_

**Type 2**

Liquor Store  Corner Store  Supermarket  Convenience Store

Gas Station  Amusement/Phonograph Distributor  Recycling, Salvage or Towing

Used Car Dealer  Personal Service Establishment (such as tattoo business, hair salon, tailor, etc.)  Recording Studio

What other licenses/permits will you hold at this location? (check all that apply)

- Occupancy Permit  Cigarette & Tobacco  Gas Station  Extended Hours  Class "B" Tavern  Weights & Measures
- Secondhand Dealer  Precious Metal & Gem  Other: \_\_\_\_\_

## 8. Legal Capacity (only if a Type 1 premises in #7 above)

Capacity 150 (Call the Milwaukee Development Center at 414-286-8211 if you have questions.)

## 9. Premises Description

a. Identify all area(s) of the premises that will be used in operating this business (include areas used only for storage):

1<sup>st</sup> Floor  2<sup>nd</sup> Floor  Basement Storage  Patio  Beer Garden  Sidewalk Café  Deck  Rooftop

Other: Describe: \_\_\_\_\_

b. Describe Location:  Major Thoroughfare  Secondary Street  Other: \_\_\_\_\_

c. Nearest Major Cross Street: 77th & Bluefish

d. Describe Building:  Free Standing Building  Strip Mall  Other: Step of Building

e. Describe Premises Structure:  Single Story  Multi-Story - # of Stories \_\_\_\_\_  Other: \_\_\_\_\_

f. Describe Surrounding Area:  Commercial  Residential  Industrial  Other: \_\_\_\_\_

g. Building Owner Name: Home at Heart Properties Phone Number: 414-461-2600

Business Owner Address: P.O. Box 242228 Milwaukee, WI 53224

## 10. Hours of Operation & Customers

Will customers be entering the premises?  No  Yes

Day of the Week	Proposed Hours of Operation:		Estimated Number of Customers expected each day	Potential Age Range of Customers	Class B Tavern Applicant Only: Age Restriction (If none, write 'None')
	Open Time (include a.m. or p.m.)	Close Time (include a.m. or p.m.)			
Sunday	10 AM	10 PM	50	0-100	
Monday	11 AM	12 AM	30-40	0-100	
Tuesday	11 AM	12 AM	30-40	0-100	
Wednesday	11 AM	12 AM	30-40	0-100	
Thursday	11 AM	12 AM	30-40	0-100	
Friday	11 AM	1:30 AM	50-60	0-100	
Saturday	11 AM	1:30 AM	60-65	0-100	

An Extended Hours Establishment License is required for any convenience store, filling station, personal service establishment (such as tattoo, body piercing, salon, tailor, tanning, etc.), recording studio or restaurant which is open between the hours of 12:00 a.m. and 5:00 a.m.

Alcohol Establishments Permitted Hours of Operation: Class A: 8:00 am to 9:00 pm Sunday thru Saturday  
Class B: 6:00 am to 2:00 am Sunday thru Thursday, 6:00 am to 2:30 am Friday & Saturday

Entertainment Outdoor Closing Hours: 10:00pm Sunday-Thursday; 12:00am Friday & Saturday; unless a different time, either earlier or later, is established by the Common Council in its approval of the licensee's plan of operation.

## 11. Signature(s)

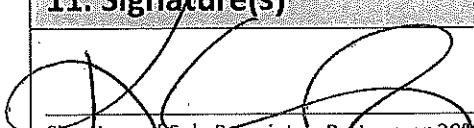
  
Signature of Sole Proprietor, Partner, or 20% or more Shareholder  
(If there are no 20% or more shareholders, Corporate Officer-print name/title and sign)

  
Signature of additional partner or 20% or more shareholder

See Application Information for a complete list of all required application forms.



# ALCOHOL BEVERAGE & PUBLIC ENTERTAINMENT PREMISES SUPPLEMENTAL APPLICATION

Office of the City Clerk License Division  
200 E. Wells St. Room 105, Milwaukee, WI 53202  
(414) 286-2238 e-mail address: license@milwaukee.gov [www.milwaukee.gov/license](http://www.milwaukee.gov/license)

Legal Entity Name: <u>Fireside BBQ and Grill LLC</u>	
Premise Address: <u>7706 W. Burleigh Street Milwaukee, WI 53222</u>	
<b>Proximity of Premises to Church, School, Daycare Center or Hospital</b>	
Is the building within 300 feet of any church, school, daycare center or hospital? <input checked="" type="checkbox"/> No <input type="checkbox"/> Yes	
<b>"Service Bar Only" Designation</b>	
If applying for Class B or C license, are you applying for "Service Bar Only"? <input checked="" type="checkbox"/> No <input type="checkbox"/> Yes Service Bar Only means customers cannot sit at the bar. Alcohol is served to employees who serve patrons seated at tables. No stools, chairs or other articles of furniture shall be placed at the service bar for patrons to sit upon.	
<b>Business Information</b>	
a) Are you taking out this application for anyone that may not be eligible for a license? <input checked="" type="checkbox"/> No <input type="checkbox"/> Yes If yes, list their name and address: _____	
b) Will the agent, a partner or the individual licensee be conducting the day-to-day operations of the business? <input type="checkbox"/> No <input checked="" type="checkbox"/> Yes If no, list the name and address of the person(s) who will: _____	
Class B Applicants: If the agent, a partner or the individual licensee will not be conducting the day-to-day operations of the business, the person(s) listed above must obtain a Class B Managers license.	
c) Does anyone else have money invested or any other interest in this business? <input checked="" type="checkbox"/> No <input type="checkbox"/> Yes If yes, explain: _____	
d) Have you made an agreement with anyone to repay any loan or any other payments based upon income from the business? <input checked="" type="checkbox"/> No <input type="checkbox"/> Yes If yes, list name and address: _____	
<b>Proof of Ownership, Lease, or Offer to Purchase (New &amp; Transfer Applicants Only)</b>	
Submit proof of ownership, lease, or offer to purchase the building with this application. A lease or offer to purchase must: a) Be in the same legal entity name as that apply for the license b) Reflect the same address as the premises address on this application c) Reflect current dates and d) Be signed by the lessor/seller and lessee/buyer	
<b>Property Information (New &amp; Transfer Applicants Only)</b>	
a) Do you own or lease the building? <input type="checkbox"/> Own <input checked="" type="checkbox"/> Lease	
b) Who owns the fixtures (for example, coolers, etc.)? <u>Fireside BBQ and Grill</u>	
c) Are you purchasing the stock and/or fixtures? <input checked="" type="checkbox"/> No <input type="checkbox"/> Yes If yes, amount paid \$ _____	
d) Total amount paid for business \$ <u>0</u>	
e) Total amount paid for goodwill of the business \$ <u>0</u>	
Goodwill comprises the reputation and customer relationships of an existing business. If the price you pay for the business exceeds the fair market value of all of the rest of the assets of the business, the excess may be considered goodwill.	
f) Have you made arrangements with the seller for payment of personal property taxes? <input checked="" type="checkbox"/> No <input type="checkbox"/> Yes <u>no seller</u>	

See Application Information for a list of all required application forms.

### Lease Information (New & Transfer Applicants who are leasing the premises only)

- a) Date lease begins 11/01/19 Ends 10/31/2022
- b) Monthly rental \$ 1,800
- c) Do you have an option to renew the lease?  No  Yes
- d) Does your lease allow for assignment to another party without the consent of the owner?  No  Yes
- e) For what length of time have you been guaranteed occupancy (number of years)? 3
- f) In addition to paying the monthly rental, will you have to pay anything additional to the owner of the building to guarantee performance of the lease?  No  Yes If yes, explain Utilities bill
- g) Does the present owner or occupancy object to the granting of your license?  No  Yes  
If yes, explain \_\_\_\_\_

### Change of Agent Applicants Only

- Have there been any changes to the floor plan since the last application was submitted?  No  Yes  
If no, a new floor plan is not required. If yes, submit a new floor plan and explain the change(s): \_\_\_\_\_

### Signature

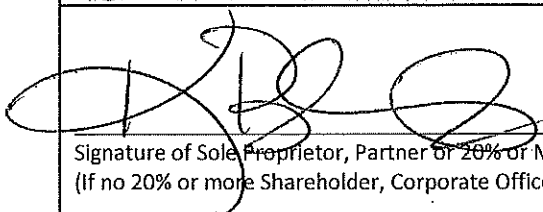

Signature of Sole Proprietor, Partner or 20% or More Shareholder  
(If no 20% or more Shareholder, Corporate Officer - print name/title and sign)

Note: All information contained in this application is subject to approval by the Common Council.  
Deviating from approved plan of operation will subject licensee to citations, and/or suspension or non-renewal of the license.  
Contact the License Division for information on how to request changes.

### New and transfer of premises applicants must submit the following:

- Proof of ownership, lease or offer to purchase the building
- Detailed floor plan
- If a restaurant, copy of the menu



# FOOD DEALER LICENSE PLAN OF OPERATION

ccl-foodplan 2/28/19

OFFICE OF THE CITY CLERK, LICENSE DIVISION  
CITY HALL, 200 E. WELLS ST, ROOM 105, MILWAUKEE, WI 53202  
(414) 286-2238 • [license@milwaukee.gov](mailto:license@milwaukee.gov) • [www.milwaukee.gov/license](http://www.milwaukee.gov/license)

Legal Entity Name: Fire Side BBQ and Grill LLC

Premises Address: 7700 W. Bourkeish Street

## SECTION 1 TYPE OF BUSINESS

What will be the majority of your food sales? (check one)

Restaurant Items (meals):

MEALS include, but are not limited to, chicken, ribs, sandwiches, roasted corn, baked potatoes, hot dogs, brats, tacos, nachos w/ cheese and meat, French fries, cooked or deep fried vegetables/fruit, cooked cheese curds, corn dogs, egg rolls, salads.

Retail Items (snacks and beverages):

RETAIL items include, but are not limited to, ice cream/soft serve, lemonade, snow cones, coffee, espresso, cappuccino, tea, fruit juice, smoothies, candy, dispensed soda, fruit cups, bakery, cookies, kettle corn, cotton candy, funnel cakes, fritters, tortilla chips w/ cheese.

Will it be a convenience store?  Yes  No

A convenience store contains less than 5,000 square feet of retail space and has, as its primary business, the sale of basic food items and in addition, sells household products or is a filling station that sells basic food items and household products.

Bed & Breakfast

Micro Market

All Applicants: Submit a menu or a list of food items that will be sold.

Will any wholesale business be done?  No  Yes If yes, what percentage of food sales will be wholesale?

Less than 25%

25% or More AND:

Restaurant items (meals) will be sold – Complete this application and also contact DATCP.

NO restaurant items (meals) will be sold - Do NOT complete this application. Contact DATCP only.

## SECTION 2 FOOD PROCESSING

Will any food processing be done?  No  Yes

Processing is defined as assembling, grinding, cutting, mixing, baking, coating, stuffing, packing, bottling, grilling, canning, extracting, fermenting, distilling, pickling, freezing, drying, smoking, or packaging.

## SECTION 3 FOOD REQUIRING TEMPERATURE CONTROL

Will any food that requires temperature control be sold?  No  Yes  
(includes dairy products such as milk, cheese, and ice cream, fish, shellfish, meat, poultry)

If yes, list the types of food items:  ribs, Fish, Chicken, Turkey, etc.

<b>SECTION 4      DETAILS OF OPERATION</b>	
Will you have seating on site for dining?	<input type="checkbox"/> No <input checked="" type="checkbox"/> Yes
Will you be doing any catering?	<input checked="" type="checkbox"/> No <input type="checkbox"/> Yes
Will you be doing any delivery?	<input checked="" type="checkbox"/> No <input type="checkbox"/> Yes
Will you have outdoor activities?	<input checked="" type="checkbox"/> No <input type="checkbox"/> Yes - Check all that apply: <input type="checkbox"/> Bar <input type="checkbox"/> Cooking/Grilling <input type="checkbox"/> Dining
Will you have a drive thru window?	<input checked="" type="checkbox"/> No <input type="checkbox"/> Yes - Are hours different from inside? <input type="checkbox"/> No <input type="checkbox"/> Yes If Yes, provide drive thru hours: _____
Will scales or barcode scanners be used?	<input checked="" type="checkbox"/> No <input type="checkbox"/> Yes - You must also apply for a Weights & Measures License.
<b>SECTION 5      ADDITIONAL SITES</b>	
Where will food be prepared and/or sold?	
<input checked="" type="checkbox"/> At a single site <input type="checkbox"/> At multiple sites: How many? _____ (for example, a hotel with several dining rooms or bars)	
If multiple sites, attach a Food Dealer Additional Site Addendum (ccl-foodadd) for each additional site.	
<b>SECTION 6      CONSTRUCTION OR CHANGES</b>	
Are you planning any construction, remodeling or equipment changes?	
<input checked="" type="checkbox"/> No    If No, SKIP to Section 8	
<input checked="" type="checkbox"/> Yes    If Yes, check all that apply: <input type="checkbox"/> New construction of a building <input checked="" type="checkbox"/> Renovation or remodeling	
<input type="checkbox"/> Construction changes to existing building <input type="checkbox"/> Equipment changes only	
Provide a brief description of the changes: <u>Updating of Equipment, <sup>New</sup> FLOORING, PAINTING, Updating FIXTURES.</u>	
Start date: _____	
Name, Address & Phone Number of Architect: <u>AMIR ADAM 414-702-2610</u>	
Name, Address & Phone Number of Contractor: <u>Jose Hernandez 414-704-1349</u>	
<b>SECTION 7      ALCOHOL BEVERAGES</b>	
Are you applying for an alcohol beverage license?	
<input type="checkbox"/> No    If No, SKIP to Section 9	
<input checked="" type="checkbox"/> Yes    If YES, if your food license is approved prior to the alcohol license, when do you want the food license issued?	
<input checked="" type="checkbox"/> Immediately <input type="checkbox"/> At the same time as the alcohol license	
<b>SECTION 8      ACKNOWLEDGEMENTS &amp; SIGNATURE</b>	
You must initial each item confirming your understanding:	
<u>[Signature]</u>	I understand the Health Department must conduct an inspection and advise the License Division of their approval before the license may be issued.
<u>[Signature]</u>	I understand I must obtain an occupancy permit from the Department of Neighborhood Services and an inspection may be required. Neighborhood Services must advise the License Division of their approval before the license may be issued.
<u>[Signature]</u>	I understand the district alderperson will review and either support or object to my application. If he/she objects, I may appeal and be scheduled to appear before the Licenses Committee. The Licenses Committee will then make a recommendation to the Common Council. The Common Council must grant the license before it may be issued.
<u>[Signature]</u>	I understand proof of payment for all license fees must be on file in the License Division before the license may be issued and the license must be issued and posted in my establishment prior to opening for business.
<u>[Signature]</u>	I will not operate my food business until the license has been issued and posted in the establishment.
Signature of Sole Proprietor, Partner, or 20% Shareholder: <u>[Signature]</u>	
Signature of Additional Partner: _____	



# PUBLIC ENTERTAINMENT PREMISES LICENSE SUPPLEMENTAL APPLICATION

Office of the City Clerk License Division  
200 E. Wells St. Room 105, Milwaukee, WI 53202  
(414) 286-2238 [www.milwaukee.gov/license](http://www.milwaukee.gov/license) e-mail address: [license@milwaukee.gov](mailto:license@milwaukee.gov)

PREMISES ADDRESS: 7706 W. Burleigh St Milw, WI 53222

**TYPES OF ENTERTAINMENT (CHECK ALL THAT APPLY)**

<input type="checkbox"/> Instrumental Musicians	<input type="checkbox"/> Battle of the Bands	<input type="checkbox"/> Dancing by Performers	<input type="checkbox"/> Amusement Machines How many? _____
<input checked="" type="checkbox"/> Bands	<input checked="" type="checkbox"/> Comedy Acts	<input type="checkbox"/> Adult Entertainment/ Strippers/Erotic Dance	<input type="checkbox"/> Concerts Approx. # per year? _____
<input type="checkbox"/> Bowling Alley How many? _____	<input type="checkbox"/> Disc Jockey	<input type="checkbox"/> Wrestling	<input type="checkbox"/> Theatrical Performances Approx. # per year? _____
<input checked="" type="checkbox"/> Pool Tables How many? <u>2</u>	<input type="checkbox"/> Magic Shows	<input type="checkbox"/> Patron Contests	<input checked="" type="checkbox"/> Jukebox
<input type="checkbox"/> Motion Pictures (movies by admission) - How many? _____	<input type="checkbox"/> Poetry Readings	<input type="checkbox"/> Patrons Dancing	<input checked="" type="checkbox"/> Karaoke
<input type="checkbox"/> Other: _____			

Entertainment Outdoor Closing Hours: 10:00pm Sunday-Thursday; 12:00am Friday & Saturday; unless a different time, either earlier or later, is established by the Common Council in its approval of the licensee's plan of operation.

**PROMOTERS/SOUND AMPLIFICATION**

Will promoters ever be used for any of the entertainment?  No  Yes If Yes, Describe:

At any time will sound amplification be used?  No  Yes If Yes, Describe:

**LEGAL CAPACITY OF PREMISES**

150 (Call the Development Center at 414-286-8211 with questions.) Legal capacity determines the fee for your Public Entertainment Premises License. If you would like to request the license be approved with a lower capacity than that listed above, indicate the lower capacity here: 125. If approved, this lower capacity will print on your license and override the capacity listed on your Occupancy Permit.

**ACKNOWLEDGEMENT/SIGNATURE**

I understand that after the license has been issued, a change to the plan of operation will require a written request to change and approval from the Common Council. I agree to inform the City Clerk within 10 days of any substantial changes in the information supplied in this application. I understand that I shall not willfully refuse to provide the services offered under this license, or add charges or require deposits not required of the general public because of race, color, sex, religion, national origin or ancestry, age, handicap, lawful source of income, marital status, sexual orientation, gender identity or expression, familial status or the fact that a person is now or has been a member of the military service, whether dressed in uniform or not; and shall not seek such information as a condition of employment, or penalize any employee or discriminate in the selection of personnel for training or promotion on the basis of such information.

I have knowledge of the City Ordinances currently regulating public entertainment, and understand that the license may be subject to suspension, non-renewal or revocation, if I violate any rule, law or regulation of the city of Milwaukee and State of Wisconsin.

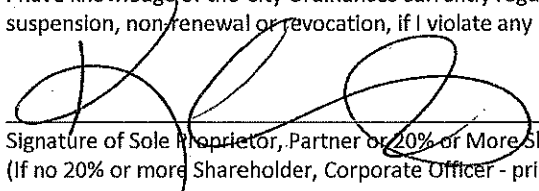

Signature of Sole Proprietor, Partner or 20% or More Shareholder  
(If no 20% or more Shareholder, Corporate Officer - print name/title and sign)

**Office Use Only:**  
Initials: \_\_\_\_\_ Filed: \_\_\_\_\_ App: \_\_\_\_\_  
Only PEP?  No  Yes If Yes,  Queue to MPD and  Email Mgrs/Team Lead (must be heard w/in 60 days)



12/12/19

North ↑

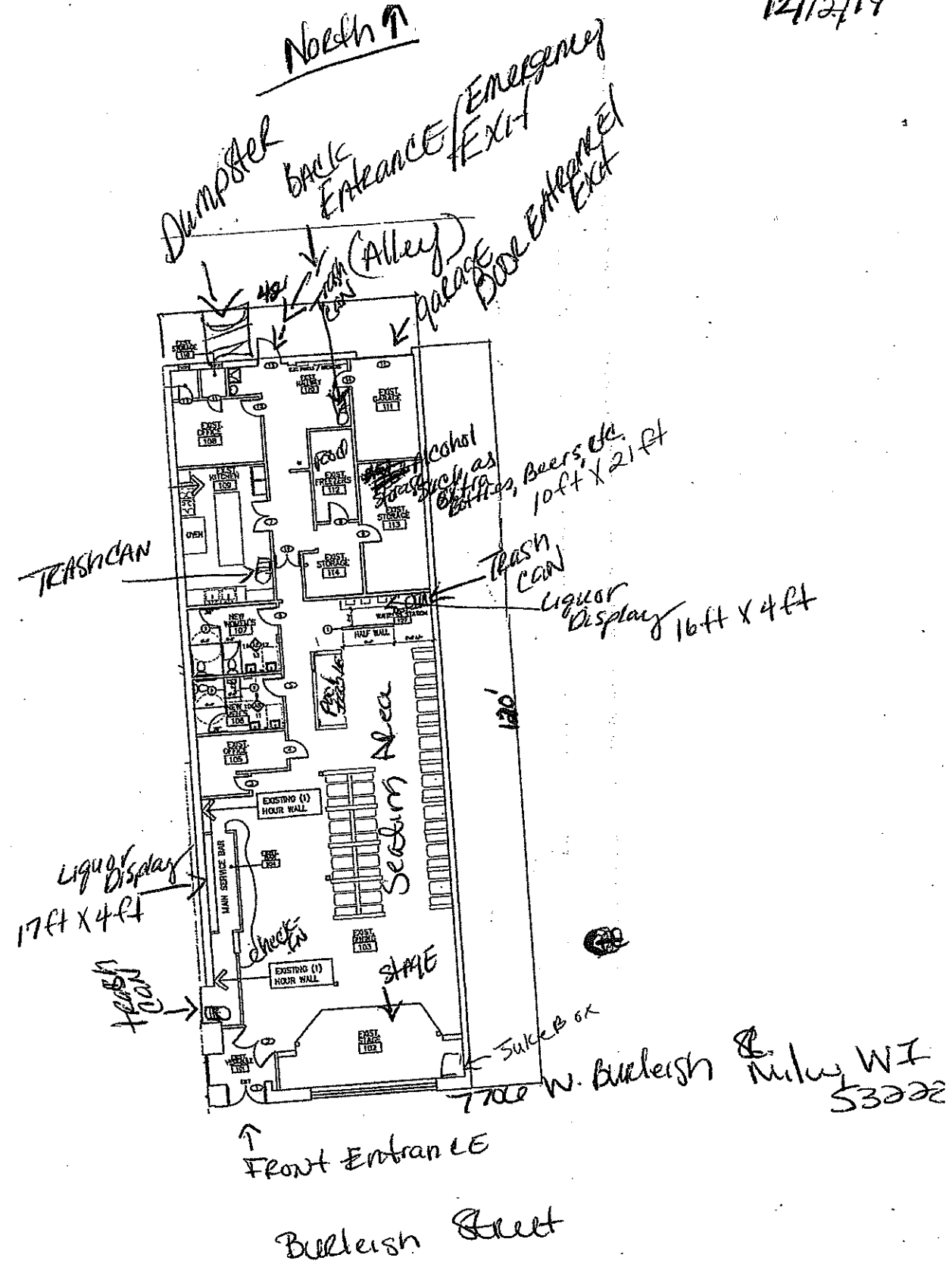

TOTAL Square Footage = 5,040 sq

Agent: Kizzie Anderson

Fireside  
Fireside BBQ and grill



CITY OF MILWAUKEE  
OFFICE OF THE CITY CLERK

Wednesday, January 22, 2020

COMMITTEE MEETING NOTICE

AD 05

GHAFFAR, Imran, Agent  
R&A Group LLC  
10400 W Silver Spring DR #400

Milwaukee, WI 53225

You are requested to attend a hearing which is to be held in Room 301-B, Third Floor, City Hall on:

**Tuesday, January 28, 2020 at 11:00 AM**

**Regarding:** Your Food Dealer License Renewal Application as agent for "R&A Group LLC" for "Tobacco Deal" at 10400 W Silver Spring DR #400.

There is a possibility that your application may be denied for one or more of the following reasons: The recommendation of the committee regarding the application shall be based on evidence presented at the hearing. Per MCO 85-4-4, unless otherwise specified in the code, probative evidence concerning non-renewal, suspension or revocation may include evidence of the following: failure of the applicant to meet municipal qualifications, pending charges against or the conviction of any felony, misdemeanor, municipal offense or other offense, the circumstances of which substantially relate to the circumstances of the particular licensed or permitted activity, by the applicant or by any employee or other agent of the applicant. If the activities of the applicant involve a licensed premises, whether the premises tends to facilitate a public or private nuisance or has been the source of congregations of persons which have resulted in any of the following: disturbance of the peace; illegal drug activity; public drunkenness; drinking in public; harassment of passers-by; gambling; prostitution; sale of stolen goods; public urination; theft; assaults; battery; acts of vandalism including graffiti, excessive littering, loitering, illegal parking, loud noise at times when the licensed premise is open for business; traffic violations; curfew violations; lewd conduct; display of materials harmful to minors, pursuant to s. 106-9.6; or any other factor which reasonably relates to the public health, safety and welfare, or failure to comply with the approved plan of operation. See attached police report or correspondence.

**Notice for applicants with warrants or unpaid fines:**

Proof of warrant satisfaction or payment of fines must be submitted at the hearing on the above date and time. Failure to comply with this requirement may result in a delay of the granting/denial of your application.

Failure to appear at this meeting may result in the denial of your license. Individual applicants must appear only in person or by an attorney. Corporate or Limited Liability applicants must appear only by the agent designated on the application or by an attorney. Partnership applicants must appear by a partner listed on the application or by an attorney. If you wish to do so and at your own expense, you may be accompanied by an attorney of your choosing to represent you at this hearing.

You will be given an opportunity to speak on behalf of the application and to respond and challenge any charges or reasons given for the denial. No petitions can be accepted by the committee, unless the people who signed the petition are present at the committee hearing and willing to testify. You may present witnesses under oath and you may also confront and cross-examine opposing witnesses under oath. If you have difficulty with the English language, you should bring an interpreter with you, at your expense, so that you can answer questions and participate in your hearing.

You may examine the application file at this office during regular business hours prior to the hearing date. Inquiries regarding this matter may be directed to the person whose signature appears below.

Limited parking for persons attending meetings in City Hall is available at reduced rates (5 hour limit) at the Milwaukee Center on the southwest corner of East Kilbourn and North Water Street. Parking tickets must be validated in the first floor information booth in City Hall.

PLEASE NOTE: Upon reasonable notice, efforts will be made to accommodate the needs of disabled individuals through sign language interpreters or other auxiliary aids. For additional information or to request this service, contact the Council Services Division ADA Coordinator at (414) 286-2998, Fax - (414) 286-3456, TDD - (414) 286-2025.

JIM OWCZARSKI, CITY CLERK

BY:

\_\_\_\_\_  
Jessica Celella  
License Division Manager

If you have questions regarding this notice, please contact the License Division at (414) 286-2238.

200 E. Wells Street, Room 105, City Hall, Milwaukee, WI 53202. [www.milwaukee.gov/license](http://www.milwaukee.gov/license)  
Phone: (414) 286-2238 Fax: (414) 286-3057 Email Address: [License@milwaukee.gov](mailto:License@milwaukee.gov)

# MILWAUKEE POLICE DEPARTMENT

## LICENSING

### CRIMINAL RECORD/ORDINANCE VIOLATION/INCIDENTS SYNOPSIS

DATE: 11/06/2019  
 LICENSE TYPE: FOOD  
 NEW:   
 RENEWAL:

No. 302540  
 Application Date: 11/06/2019

License Location: 10400 W Silver Spring Dr  
 Business Name: R&A Group LLC

Licensee/Applicant: GHAFAR, Imran  
(Last Name, First Name, MI)

Date of Birth: 01/28/1981

Home Address: 12069 W Willow Glen Ct  
 City: Thiensville State: WI Zip Code: 53092  
 Home Phone:

This report is written by Police Officer David Novak, assigned to the License Investigation Unit, Days.

The Milwaukee Police Department's investigation regarding this application revealed the following:

1. On 05/19/2018 the applicant was cited in the City of Milwaukee at 6243 N. Teutonia Av for Sale of Cigarettes to Minor/Underage.

Charge: Sale of Cigarettes to Minor/Underage  
 Finding: Guilty  
 Sentence: Fined \$400.00  
 Date: 09/18/2019  
 Case: 19007670

2. On 10/26/2019 a 17-year-old working in conjunction with the Milwaukee Police and the WI WINS Tobacco Initiative was able to purchase a Black and Mild cigar from the clerk at Tobacco Deal, 10400 W. Silver Spring Dr. The did ask for an ID but made the sale anyways. The clerk stated he did look at the ID but appeared confused on what year someone should be born in to allow tobacco sales. The applicant was advised of this incident and that he would be receiving a citation for Sale of Cigarette to Minor/Underage.

Charge: Sale of Cigarette to Minor/Underage  
 Finding: pending initial appearance on 12/23/2019  
 Sentence:  
 Date:  
 Case: 0681JKHWRV

# Milwaukee Police Department

749 W. State Street Milwaukee, WI 53233

414-933-4444



Case #: 192990073

OtherEvent #: 19-LP-1128

## Incident

### 10400 W SILVER SPRING DR Milwaukee, WISCONSIN 53225

Incident Date/Time:: 10/26/2019 10:06:00  
CAD Number:: 192990807  
District:: 4  
Beat:: 420  
Reporting Area:: 654

## Business Agent (1)

### GHAFFAR, IMRAN NMI

Person Involvement: (Must choose Agent  
AGENT from drop down): Agent  
DOB:: 01/28/1981  
Sex:: MALE  
Race:: UNKNOWN  
Phone 1 Number:: (414)-683-1879  
Address:: 12069 N WILLOW GLEN CT  
City:: Theinsville  
State:: WISCONSIN  
Zip Code:: 53092

## Licensed Persons Involved (1)

### Thapa, Bhimsen

Person Involvement:: Employee  
DOB:: 09/19/1986  
Sex:: MALE  
Race:: ASIAN  
Phone 1 Number:: 4146280980  
Phone 1 Type:: Cell  
Address:: 4123 N Ardmore Av  
Apartment or Suite:: 5  
City:: Shorewood  
State:: WISCONSIN  
Zip Code:: 53211

## Licensed Premise Data (1)

### Tobacco Deal

Address:: 10400 W SILVER SPRING DR  
City:: Milwaukee  
State:: WISCONSIN  
Zip Code:: 53225  
License Type:: Food Dealer  
Licensee Notification Was Made:: Yes  
Licensee Notified Date/Time:: 10/26/2019 10:25:00  
Business Was Cited For Violation:: Yes

# Milwaukee Police Department

749 W. State Street Milwaukee, WI 53233

414-933-4444



Case #: 192990073

OtherEvent #: 19-LP-1128

Citation Number: (Additional Citations List In Narrative): 0681JKHWRV  
Violation/Ordinance Number:: 106-30-2-a  
Licensee was cooperative: (If not explain in narrative): Yes  
Licensee or Manager was on premises at time of violation/incident:: No

## Narrative (1)

### INITIAL INVESTIGATION

Novak, David A 008860

10/26/2019

This report was written by PO David NOVAK assigned to License Investigation Unit days.

On Saturday October 26, 2019 I was assigned to work the Wisconsin WINS Youth Tobacco Initiative, which checks area vendors for age compliance tobacco purchases. Assisting in this assignment was Tamesha A ROBERSON (b/f, 04/21/2002). ROBERSON is 17 years old and is not of legal age to purchase tobacco.

At approximately 10:06am ROBERSON entered the Tobacco Deal at 10400 W. Silver Spring Dr. She was able to purchase a Black and Mild cigar from the cashier for \$1.00. ROBERSON stated the clerk did ask for an ID but made the sale anyway. I entered the store and the described cashier was identified as Bhimsen THAPA (w/m, 09/19/1986). THAPA stated he did look at her ID but he seemed confused as to what year someone should be born in that would make them 18. I did observe the tobacco sale sticker on the counter by the register that stated anyone born after this date in 2001 was too young to buy tobacco products. I spoke with the agent, Imran GHAFAR, by phone and advised him he would be receiving a citation for Sale of Cigarette to Minor/Underage. He stated that he has given THAPA training on when to make sales and has had him sign a form stating he understands.

Buyer

Tamesha ROBERSON

3067 N. 21st St

Milwaukee WI 53206

Observer

Erik KILPATRICK

2467 N. 21st St

Milwaukee WI 53206

# Milwaukee Police Department

749 W. State Street Milwaukee, WI 53233

414-933-4444



Case #: 192990073

OtherEvent #: 19-LP-1128

## Officer (2)

Reporting Officer:	Novak, David A (008860)	10/26/2019 12:26:00
Section: (Work Location):	27	
Approving Officer:	Raden, Chad M (010032)	10/30/2019 10:18:54
Section: (Work Location):	27	



Wednesday, January 22, 2020



# Notice of Public Hearing

---

GHAFFAR, Imran, Agent  
Tobacco Deal at 10400 W Silver Spring DR #400  
Food Dealer License Renewal Application

**Tuesday, January 28, 2020 at 11:00 AM**

To whom it may concern:

The above application has been made by the above named applicant(s). This requires approval from the Licenses Committee and the Common Council of the City of Milwaukee. The hearing before the Licenses Committee will take place on 1/28/2020 at 11:00 AM, in Room 301-B, Third Floor, City Hall. If you wish, you may provide testimony at the hearing regarding the request; see below for further information. You are not required to attend the hearing. Once the Licenses Committee makes its recommendation, this recommendation is forwarded to the full Common Council for approval at its next regularly scheduled hearing. Please review the information below and if you have further questions regarding this process, please contact the License Division at (414) 286-2238.

---

## Important details for those wishing to provide information for the Licenses Committee to consider when making its recommendation:

1. The license application is scheduled to be heard at the above time. Due to other hearings running longer than scheduled, you may have to wait some time to provide your testimony.
2. You must appear in person and testify as to matters that you have personally experienced or seen. (You cannot provide testimony for your neighbor, parent or anyone else; this is considered hearsay and cannot be considered by the committee.)
3. No letters or petitions can be accepted by the committee (unless the person who wrote the letter or the persons who signed the petition are present at the committee hearing and willing to testify).
4. Persons opposed to the license application are given the opportunity to testify first; supporters may testify after the opponents have finished.
5. When you are called to testify, you will be sworn in and asked to give your name, and address. (If your first and/or last names are uncommon please spell them.)
6. You may then provide testimony.
  - a. Include only information relating to the above license application.
  - b. Include only information you have personally witnessed or seen.
  - c. Provide concise and relevant information detailing how this business has affected or may affect the peaceful enjoyment of your neighborhood.
  - d. If by the time you have the opportunity to testify, the information you wish to share has already been provided to the committee, you may state that you agree with the previous testimony. Redundant or repetitive testimony will not assist the committee in making its recommendation.
7. After giving your testimony, the members of the Licenses Committee and the licensee may ask questions regarding the testimony you have given or other factors relating to the license application.
8. Business Competition is not a valid basis for denial or non-renewal of a license.  
**Please Note: If you have submitted an objection to the above application your objection cannot be considered by the committee unless you personally testify at the hearing.**

OCCUPANT	MAIL ADDRESS	CITY, STATE ZIP
CURRENT OCCUPANT	10437 W SILVER SPRING DR	MILWAUKEE, WI 53225
CURRENT OCCUPANT	10405 W SILVER SPRING DR	MILWAUKEE, WI 53225
CURRENT OCCUPANT	10501 W SILVER SPRING DR	MILWAUKEE, WI 53225
CURRENT OCCUPANT	10429 W SILVER SPRING DR	MILWAUKEE, WI 53225
CURRENT OCCUPANT	10431 W SILVER SPRING DR	MILWAUKEE, WI 53225
CURRENT OCCUPANT	10325 W SILVER SPRING DR	MILWAUKEE, WI 53225
CURRENT OCCUPANT	10503 W SILVER SPRING DR	MILWAUKEE, WI 53225
CURRENT OCCUPANT	10333 W SILVER SPRING DR	MILWAUKEE, WI 53225
CURRENT OCCUPANT	10419 W SILVER SPRING DR	MILWAUKEE, WI 53225
CURRENT OCCUPANT	5576 N 103RD ST	MILWAUKEE, WI 53225
CURRENT OCCUPANT	10439 W SILVER SPRING DR	MILWAUKEE, WI 53225
CURRENT OCCUPANT	10411 W SILVER SPRING DR	MILWAUKEE, WI 53225
CURRENT OCCUPANT	10341 W SILVER SPRING DR	MILWAUKEE, WI 53225

Total Records: 13

Radius: 250.0 feet and Center of Circle: 10400 W Silver Spring Dr





# BUSINESS LICENSE RENEWAL PLAN OF OPERATION

Office of the City Clerk License Division  
200 E. Wells St. Room 105, Milwaukee, WI 53202

Licenses to be Renewed	Renewal Fee(s)	
Food Dealer - FOOD 9658	\$200.00	
Extended Hours -		Expiration Date: 2/6/2020
Filling Station -		File By Date: 11/21/2019
Cigarette & Tobacco - CIG 1028096	\$100.00	Date Late Fee Begins: 11/22/2019
Weights & Measures -		Late Fee Amount: \$75.00
Sidewalk Dining -		
<b>TOTAL DUE</b>	<b>\$300.00</b>	

Legal Entity Name: R&A Group LLC

Premises Address: 10400 W SILVER SPRING DR #400

## Changes Since Last Application?

Are there any changes in your plans to address litter, noise, and/or security?  No  Yes If yes, describe: \_\_\_\_\_

Are there any changes to the hours of operation (as listed on your current license)?  No  Yes If yes, describe: \_\_\_\_\_

Are there any changes to your current plan of operation or floor plan\*?  No  Yes If yes, describe: \_\_\_\_\_

\*If there are changes to the floor plan, a new floor plan must be submitted with this renewal application. A sample plan can be found online at [www.milwaukee.gov/licenses](http://www.milwaukee.gov/licenses) under License Forms and Related Information.

Weights & Measures Licensees Only	Sidewalk Dining:
Number/Type of Devices:  Are there any changes to the number or types of devices? <input checked="" type="checkbox"/> No <input type="checkbox"/> Yes If yes, contact our office for further instructions.	Are there any changes to the sidewalk dining site plan?  <input checked="" type="checkbox"/> No <input type="checkbox"/> Yes If Yes, submit an updated site plan with this application.

## Food Dealer Licensees Only

Your current food license includes the following business operations: **No Processing, Hazardous Foods, Sales < \$20,000, Food Store**  
Are there any changes to your plan of operation (for example, adding processing, changing sales amount or complexity, etc.)?  No  Yes  
If yes, you must complete a "Request to Modify Food Establishment/Food Operation Plan" which can be obtained at [www.milwaukee.gov/licenses](http://www.milwaukee.gov/licenses) under "Forms and Related Information" or by contacting our office.

## All Applicants: Signature

  
 \_\_\_\_\_  
 Signature of Sole Proprietor; a Partner; or if a Corporation or LLC, the Agent must sign