



# PETITION FOR A SPECIAL PRIVILEGE

ccl-246 (7/15)

SP 2753

CCF 160862

- New application \$250.00 Fee**
- Amendment to add items to Special Privilege # \_\_\_\_\_ (\$125.00 Fee)**
- Amendment to remove items from Special Privilege # \_\_\_\_\_ (No fee)**
- Amendment for change of ownership for Special Privilege # \_\_\_\_\_ (No fee)**

- File petition with the Department of Public Works, Attention: Special Privileges, 841 North Broadway, Room 919, Milwaukee, WI 53202.
- Fee must be submitted with petition. Checks should be made payable to the City of Milwaukee.
- Questions? Call 414-286-2454

To the Honorable, The Common Council of the City of Milwaukee:

The Licensee Head of the Heard LLC  
(Name of Individual, Partners, Corporation or LLC)

being the owners of the following property known by street address as 1271 North 6<sup>th</sup> Street, Milwaukee WI 53203  
(Street Address and Zip Code)

in the 4<sup>th</sup> Aldermanic District respectfully petition the Common Council of the City of Milwaukee according to the provisions of Section 66.0425 of the Wisconsin Statutes, that the following privilege be granted:

Description of Special Privilege: Installation of tree grates and tree guards.

Of which a plan or sketch is herewith submitted. Petitioner agrees to comply with all laws and all ordinances of the City of Milwaukee, to abide by any order or resolution of the Common Council affecting this privilege, to be primarily liable for damages to person or property by reason of the granting of such privilege, pay annual compensation as provided by law in the sum to be fixed by the proper city officers, and to file and keep current throughout the existence of the privilege, a certificate of insurance indicating applicant holds a public liability policy in at least the sums of \$25,000.00/\$50,000.00 bodily injury, and \$10,000.00 property damage, insuring the city against any liability that might arise by reason of the privilege.

Petitioner further agrees to remove said privilege whenever public necessity so requires when so ordered upon resolution adopted by the Common Council or other legislative body.

Should this special privilege be discontinued for any reason whatsoever, petitioner agrees to remove all construction work executed pursuant to this special privilege, to restore to its former condition and to the approval of the Commissioner of Public Works, any curb, pavement, or other public improvement which was removed, changed or disturbed by reason of the granting of this special privilege. Petitioner further agrees not to contest the validity of Section 66.0425 of the Wisconsin Statutes, or the legality of this special privilege in any way.

Name (Please Print): Peter Feigin  
(Individual, Partner, or Agent if corporation or LLC as shown above)

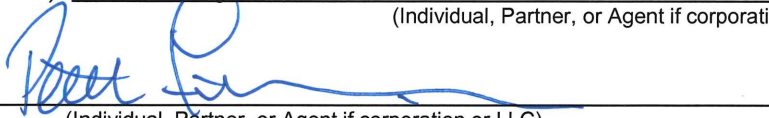
Signature:  Date: 9/22/16  
(Individual, Partner, or Agent if corporation or LLC)

Corporation or LLC Name: Head of the Heard LLC  
(If applicable, as shown above)

Mailing Address (If different than property address above): 1543 North 2<sup>nd</sup> Street, 6<sup>th</sup> Floor

(OVER)

City: Milwaukee State: WI Zip: 53212

Telephone: (414) 227-0599 E-Mail: PFeigin@bucks.com

Architect/Engineer/Contractor (If Applicable)

Name: \_\_\_\_\_

Address: \_\_\_\_\_

City: \_\_\_\_\_ State: \_\_\_\_\_ Zip: \_\_\_\_\_

Telephone: \_\_\_\_\_ E-Mail: \_\_\_\_\_

**IMPORTANT NOTICE FOR CUSTOMERS PAYING BY CHECK**

When you provide a check as payment, you authorize us either to use information from your check to make a one-time electronic fund transfer from your account or to process the payment as a check transaction.

**PAID**  
\$ \$250.00 PMS  
SEP 26 2016

Special Privilege Application  
City of Milwaukee  
Department of Public Works

1 2 3 4 5 6 7 8

D  
C  
B  
A

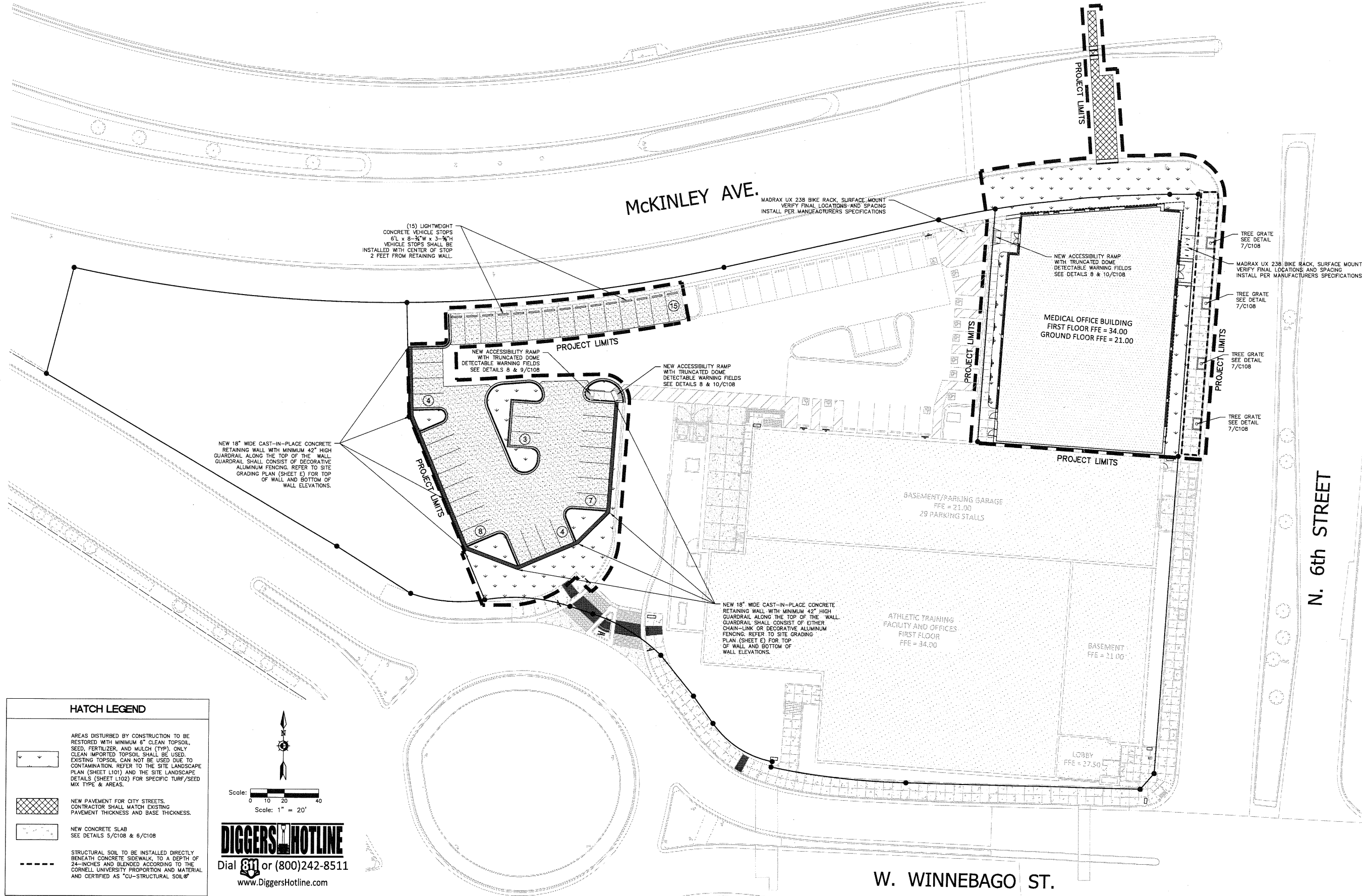

**HATCH LEGEND**

AREAS DISTURBED BY CONSTRUCTION TO BE RESTORED WITH MINIMUM 6" CLEAN TOPSOIL, SEED, FERTILIZER, AND MULCH (TYP). ONLY CLEAN IMPORTED TOPSOIL SHALL BE USED. EXISTING TOPSOIL CAN NOT BE USED DUE TO CONTAMINATION. REFER TO THE SITE LANDSCAPE PLAN (SHEET L101) AND THE SITE LANDSCAPE DETAILS (SHEET L102) FOR SPECIFIC TURF/SEED MIX TYPE & AREAS.

NEW PAVEMENT FOR CITY STREETS. CONTRACTOR SHALL MATCH EXISTING PAVEMENT THICKNESS AND BASE THICKNESS.

NEW CONCRETE SLAB  
SEE DETAILS 5/C108 & 6/C108

STRUCTURAL SOIL TO BE INSTALLED DIRECTLY BENEATH CONCRETE SIDEWALK, TO A DEPTH OF 24-INCHES AND BLENDED ACCORDING TO THE CORNELL UNIVERSITY PROPORTION AND MATERIAL AND CERTIFIED AS "CU-STRUCTURAL SOIL®"

Scale: 1" = 20'

**DIGGERS HOTLINE**  
Dial 811 or (800)242-8511  
www.DiggersHotline.com

**eu.a**  
epstein uhen : architects

MILWAUKEE 333 East Chicago Street  
Milwaukee, Wisconsin 53202  
telephone 414.271.5350

MADISON 309 West Johnson Street, Suite 202  
Madison, Wisconsin 53703  
telephone 608.442.5350

**KAPUR & ASSOCIATES, INC.**  
CONSULTING ENGINEERS  
7711 N. PORT WASHINGTON ROAD  
MILWAUKEE, WISCONSIN 53217  
Phone: 414.351.8668 Fax: 414.351.4117  
www.kapurengineers.com

ISSUANCE AND REVISIONS

CONSTRUCTION DOCUMENTS  
BID PACKAGE 1 - SITE AND FOOTINGS / FOUNDATIONS

#	DATE	DESCRIPTION

PROJECT INFORMATION

**HEAD OF THE HERD BLOCK 8 DEVELOPMENT**

1271 N. 6th Street  
Milwaukee, WI 53203

PROJECT NUMBER: 4-15542-01  
PROJECT MANAGER: RK

KEY PLAN

SHEET INFORMATION

DATE: JULY 29, 2016

SHEET NAME: **SITE PLAN C102**

SHEET NUMBER:  

© Epstein Uhen Architects, Inc.

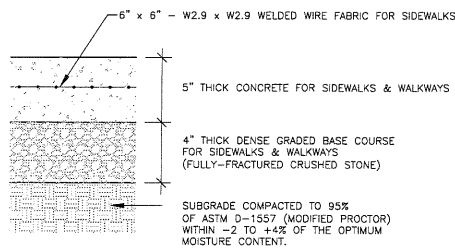

5 CONCRETE SIDEWALK/SLAB  
N.T.S.

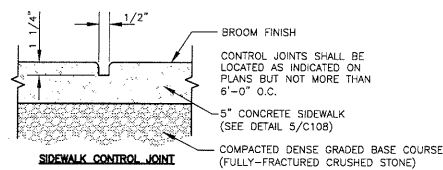

6 CONTROL & CONSTRUCTION JOINT DETAILS (TYP.)  
N.T.S.

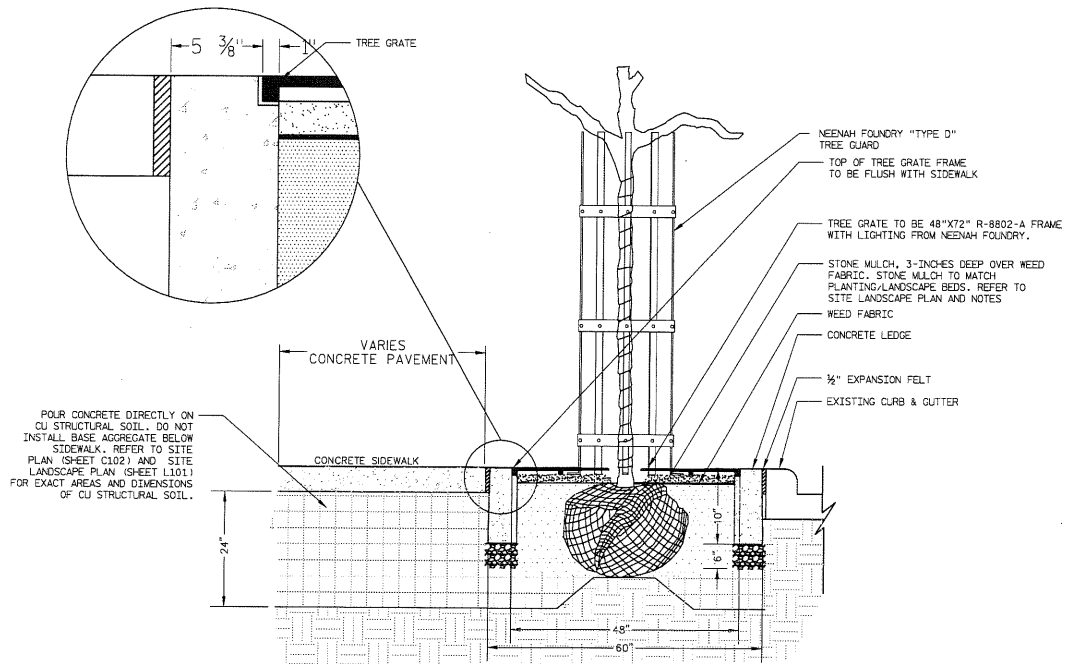

7 TREE PLANTING WITH GRATE ABUTTING CURB AND GUTTER  
N.T.S.

EXPANSION JOINT TO ENGINEER'S DETAILS SEE NOTE 3

PAVEMENT PER DESIGN DOCUMENTS

SEE NOTE 4

6" [150mm]

6" [150mm]

6" [150mm]

1/8" [3mm]

**KS200 - KLASSIKDRAIN - LOAD CLASS B**  
Exposed Concrete Pavement

**ACO Polymer Products, Inc.**

825 W. Beechcraft St  
Casa Grande, AZ 85122  
Tel: 520-421-9898  
Fax: 520-421-9899

9470 Pinecone Dr.  
Mentor, OH 44060  
Tel: 440-639-7230  
Fax: 440-639-7235

4211 Pleasant Rd.  
Fort Mill, SC 29708  
Tel: 440-639-7230  
Fax: 803-802-1063

Arizona Tel: 888-490-9552 e-mail: sales@acousa.com Ohio Tel: 800-543-4764 www.acousa.com South Carolina Tel: 800-543-4764

**SPECIFICATION CLAUSE**  
**KS200 KLASSIKDRAIN - LOAD CLASS B**

**GENERAL**  
THE SURFACE DRAINAGE SYSTEM SHALL BE POLYMER CONCRETE KS200 CHANNEL SYSTEM WITH STAINLESS STEEL EDGE RAILS AS MANUFACTURED BY ACO POLYMER PRODUCTS, INC.

**MATERIALS**  
CHANNELS SHALL BE MANUFACTURED FROM POLYESTER RESIN POLYMER CONCRETE WITH AN INTEGRALLY CAST-IN STAINLESS STEEL EDGE RAIL. MINIMUM PROPERTIES OF POLYMER CONCRETE WILL BE AS FOLLOWS:

COMPRESSIVE STRENGTH:	14,000 PSI
FLEXURAL STRENGTH:	4,000 PSI
TENSILE STRENGTH:	1,500 PSI
WATER ABSORPTION:	0.07%
FROST PROOF:	YES
DILUTE ACID AND ALKALI RESISTANT:	YES
B117 SALT SPRAY TEST COMPLIANT:	YES

THE SYSTEM SHALL BE 8" (200mm) NOMINAL INTERNAL WIDTH WITH A 10.2" (260mm) OVERALL WIDTH AND A BUILT-IN SLOPE OF 0.5%. CHANNEL INVERT SHALL HAVE DEVELOPED "Y" SHAPE. ALL CHANNELS SHALL BE INTERLOCKING WITH A MALE/FEMALE JOINT.

THE COMPLETE DRAINAGE SYSTEM SHALL BE BY ACO POLYMER PRODUCTS, INC. ANY DEVIATION OR PARTIAL SYSTEM DESIGN AND/OR IMPROPER INSTALLATION WILL VOID ANY AND ALL WARRANTIES PROVIDED BY ACO POLYMER PRODUCTS, INC.

CHANNEL SHALL WITHSTAND LOADING TO PROPER LOAD CLASS AS OUTLINED BY EN 1433. GRATE TYPE SHALL BE APPROPRIATE TO MEET THE SYSTEM LOAD CLASS SPECIFIED AND INTENDED APPLICATION. GRATES SHALL BE SECURED USING 'QUICKLOK' BOLTLESS LOCKING SYSTEM. CHANNEL AND GRATE SHALL BE CERTIFIED TO MEET THE SPECIFIED EN 1433 LOAD CLASS. THE SYSTEM SHALL BE INSTALLED IN ACCORDANCE WITH THE MANUFACTURER'S INSTRUCTIONS AND RECOMMENDATIONS.

**NOTES:**

- IT IS NECESSARY TO ENSURE MINIMUM DIMENSIONS SHOWN ARE SUITABLE FOR EXISTING GROUND CONDITIONS. ENGINEERING ADVICE MAY BE REQUIRED.
- MINIMUM CONCRETE STRENGTH OF 4,000 PSI IS RECOMMENDED. CONCRETE SHOULD BE VIBRATED TO ELIMINATE AIR POCKETS.
- EXPANSION AND CONTRACTION CONTROL JOINTS AND REINFORCEMENT ARE RECOMMENDED TO PROTECT CHANNEL AND CONCRETE SURROUND. ENGINEERING ADVICE MAY BE REQUIRED.
- THE FINISHED LEVEL OF THE CONCRETE SURROUND MUST BE APPROX. 1/8" [3mm] ABOVE THE TOP OF THE CHANNEL EDGE.
- CONCRETE BASE THICKNESS SHOULD MATCH SLAB THICKNESS. ENGINEERING ADVICE MAY BE REQUIRED TO DETERMINE PROPER LOAD CLASS.
- REFER TO ACO'S LATEST INSTALLATION INSTRUCTIONS FOR FURTHER DETAILS.

8 TRENCH DRAIN DETAIL  
N.T.S.



**milwaukee** 333 East Chicago Street  
Milwaukee, Wisconsin 53202  
telephone 414.271.5350

**madison** 309 West Johnson Street, Suite 202  
Madison, Wisconsin 53703  
telephone 608.442.5350



ISSUANCE AND REVISIONS

CONSTRUCTION DOCUMENTS

BID PACKAGE 1 - SITE AND FOOTINGS / FOUNDATIONS

#	DATE	DESCRIPTION

PROJECT INFORMATION

**HEAD OF THE HERD BLOCK 8 DEVELOPMENT**

1271 N. 6th Street  
Milwaukee, WI 53203

PROJECT NUMBER: 4-15542-01  
PROJECT MANAGER: RK

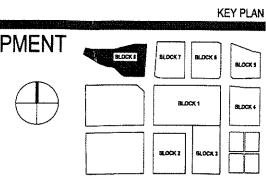

SHEET INFORMATION

DATE: JULY 29, 2016

SHEET NAME: SITE DETAILS  
**C108**

SHEET NUMBER: