



CITY OF MILWAUKEE  
OFFICE OF THE CITY CLERK

Thursday, August 25, 2016

COMMITTEE MEETING NOTICE

AD 04

COOK, Thomas M, Agent  
Pacific Bells LLC  
111 W 39th St

Vancouver, WA 98660

You are requested to attend a hearing which is to be held in Room 301-B, Third Floor, City Hall on:

**Tuesday, September 06, 2016 at 10:45 AM**

**Regarding:** Your Food Dealer -Restaurant Application as agent for "Pacific Bells LLC" for "Taco Bell #31490" at 2210 W Wisconsin Av.



There is a possibility that your application may be denied for one or more of the following reasons: The recommendation of the committee regarding the application shall be based on evidence presented at the hearing. Per MCO 85-2.7-4, probative evidence concerning whether or not a new license should be granted may be presented on the following subjects: whether or not the applicant meets the municipal requirements, the appropriateness of the location and premises where the licensed premises is to be located and whether use of the premises for the purposes or activities permitted by the license would tend to facilitate a public or private nuisance or create undesirable neighborhood problems such as disorderly patrons, unreasonably loud noise, litter, and excessive traffic and parking congestion. Probative evidence relating to these matters may be taken from the plan of operation submitted with the license application, if any, but shall not include the content of any music. Evidence regarding the fitness of the location of the premises to be maintained as the principal place of business, including but not limited to whether there is an overconcentration of businesses of the type for which the license is sought; whether the proposal is consistent with any pertinent neighborhood business or development plans, or the location's proximity to areas where children are typically present. The applicant's record in operating similarly licensed premises; and whether or not the applicant has been charged with or convicted of any felony, misdemeanor, municipal offense or other offense, the circumstances of which substantially relate to the activity to be permitted by the license being applied for or any other factor which reasonably relates to the public health, safety or welfare may also be considered. See attached police report or correspondence.

**Notice for applicants with warrants or unpaid fines:**

Proof of warrant satisfaction or payment of fines must be submitted at the hearing on the above date and time. Failure to comply with this requirement may result in a delay of the granting/denial of your application.

Failure to appear at this meeting may result in the denial of your license. Individual applicants must appear only in person or by an attorney. Corporate or Limited Liability applicants must appear only by the agent designated on the application or by an attorney. Partnership applicants must appear by a partner listed on the application or by an attorney. If you wish to do so and at your own expense, you may be accompanied by an attorney of your choosing to represent you at this hearing.

You will be given an opportunity to speak on behalf of the application and to respond and challenge any charges or reasons given for the denial. No petitions can be accepted by the committee, unless the people who signed the petition are present at the committee hearing and willing to testify. You may present witnesses under oath and you may also confront and cross-examine opposing witnesses under oath. If you have difficulty with the English language, you should bring an interpreter with you, at your expense, so that you can answer questions and participate in your hearing.

You may examine the application file at this office during regular business hours prior to the hearing date. Inquiries regarding this matter may be directed to the person whose signature appears below.

Limited parking for persons attending meetings in City Hall is available at reduced rates (5 hour limit) at the Milwaukee Center on the southwest corner of East Kilbourn and North Water Street. Parking tickets must be validated in the first floor information booth in City Hall.

PLEASE NOTE: Upon reasonable notice, efforts will be made to accommodate the needs of disabled individuals through sign language interpreters or other auxiliary aids. For additional information or to request this service, contact the Council Services Division ADA Coordinator at (414) 286-2998, Fax - (414) 286-3456, TDD - (414) 286-2025.

JIM OWZARSKI, CITY CLERK

BY:

Jason Schunk  
License Division Manager

If you have questions regarding this notice, please contact the License Division at (414) 286-2238.

200 E. Wells Street, Room 105, City Hall, Milwaukee, WI 53202. [www.milwaukee.gov/license](http://www.milwaukee.gov/license)  
Phone: (414) 286-2238 Fax: (414) 286-3057 Email Address: [License@milwaukee.gov](mailto:License@milwaukee.gov)

**Cooney, James**

---

**From:** Fowler, Natalie  
**Sent:** Wednesday, May 18, 2016 10:57 AM  
**To:** License  
**Cc:** Schunk, Jason  
**Subject:** RE: Aggressive Panhandling 2210 W. Wisconsin Ave.

Keith,

Have you reached out to the beat officers at the Avenues West Substation? Also, are there any other details you can provide? We will send to the licensing department.

Cheers,  
Natalie

**Natalie Fowler**

Legislative Assistant  
City of Milwaukee Common Council  
Alderman Robert Bauman | 4th District  
200 East Wells Street - Room 205 | Milwaukee, WI 53202  
(414) 286-2886 Office | (414) 286-3456 Fax  
[natalie.fowler@milwaukee.gov](mailto:natalie.fowler@milwaukee.gov) Email

---

**From:** I  
**Sent:** Wednesday, May 18, 2016 10:53 AM  
**To:** Fowler, Natalie; License  
**Subject:** Aggressive Panhandling 2210 W. Wisconsin Ave.

No assistance from Taco Bell staff.

T

10

**REDACTED RECORD**



Thursday, August 25, 2016



# Notice of Public Hearing

---

COOK, Thomas M, Agent  
Taco Bell #31490 at 2210 W Wisconsin Av  
Food Dealer -Restaurant Application

**Tuesday, September 06, 2016 at 10:45 AM**

To whom it may concern:

The above application has been made by the above named applicant(s). This requires approval from the Licenses Committee and the Common Council of the City of Milwaukee. The hearing before the Licenses Committee will take place on 9/6/2016 at 10:45 AM, in Room 301-B, Third Floor, City Hall. If you wish, you may provide testimony at the hearing regarding the request; see below for further information. You are not required to attend the hearing. Once the Licenses Committee makes its recommendation, this recommendation is forwarded to the full Common Council for approval at its next regularly scheduled hearing. Please review the information below and if you have further questions regarding this process, please contact the License Division at (414) 286-2238.

---

## Important details for those wishing to provide information for the Licenses Committee to consider when making its recommendation:

1. The license application is scheduled to be heard at the above time. Due to other hearings running longer than scheduled, you may have to wait some time to provide your testimony.
2. You must appear in person and testify as to matters that you have personally experienced or seen. (You cannot provide testimony for your neighbor, parent or anyone else; this is considered hearsay and cannot be considered by the committee.)
3. No letters or petitions can be accepted by the committee (unless the person who wrote the letter or the persons who signed the petition are present at the committee hearing and willing to testify).
4. Persons opposed to the license application are given the opportunity to testify first; supporters may testify after the opponents have finished.
5. When you are called to testify, you will be sworn in and asked to give your name, and address. (If your first and/or last names are uncommon please spell them.)
6. You may then provide testimony.
  - a. Include only information relating to the above license application.
  - b. Include only information you have personally witnessed or seen.
  - c. Provide concise and relevant information detailing how this business has affected or may affect the peaceful enjoyment of your neighborhood.
  - d. If by the time you have the opportunity to testify, the information you wish to share has already been provided to the committee, you may state that you agree with the previous testimony. Redundant or repetitive testimony will not assist the committee in making its recommendation.
7. After giving your testimony, the members of the Licenses Committee and the licensee may ask questions regarding the testimony you have given or other factors relating to the license application.
8. Business Competition is not a valid basis for denial or non-renewal of a license.  
**Please Note: If you have submitted an objection to the above application your objection cannot be considered by the committee unless you personally testify at the hearing.**

| OCCUPANT         | MAIL ADDRESS             | CITY AND ZIP CODE        |
|------------------|--------------------------|--------------------------|
| CURRENT OCCUPANT | 2324 W WISCONSIN AVE 25  | MILWAUKEE, WI 53233-1857 |
| CURRENT OCCUPANT | 2324 W WISCONSIN AVE 51  | MILWAUKEE, WI 53233-2911 |
| CURRENT OCCUPANT | 2324 W WISCONSIN AVE 59  | MILWAUKEE, WI 53233-2911 |
| CURRENT OCCUPANT | 2324 W WISCONSIN AVE 11  | MILWAUKEE, WI 53233-1856 |
| CURRENT OCCUPANT | 2324 W WISCONSIN AVE 48  | MILWAUKEE, WI 53233-2910 |
| CURRENT OCCUPANT | 2324 W WISCONSIN AVE 45  | MILWAUKEE, WI 53233-2910 |
| CURRENT OCCUPANT | 2324 W WISCONSIN AVE 13  | MILWAUKEE, WI 53233-1856 |
| CURRENT OCCUPANT | 2324 W WISCONSIN AVE 24  | MILWAUKEE, WI 53233-1857 |
| CURRENT OCCUPANT | 2324 W WISCONSIN AVE 32  | MILWAUKEE, WI 53233-2909 |
| CURRENT OCCUPANT | 2324 W WISCONSIN AVE 64  | MILWAUKEE, WI 53233-2913 |
| CURRENT OCCUPANT | 730 N 23RD ST 311        | MILWAUKEE, WI 53233-1917 |
| CURRENT OCCUPANT | 730 N 23RD ST 103        | MILWAUKEE, WI 53233-1917 |
| CURRENT OCCUPANT | 730 N 23RD ST 105        | MILWAUKEE, WI 53233-1917 |
| CURRENT OCCUPANT | 730 N 23RD ST 200        | MILWAUKEE, WI 53233-1917 |
| CURRENT OCCUPANT | 730 N 23RD ST 205        | MILWAUKEE, WI 53233-1917 |
| CURRENT OCCUPANT | 730 N 23RD ST 203        | MILWAUKEE, WI 53233-1917 |
| CURRENT OCCUPANT | 726 N 23RD ST 4          | MILWAUKEE, WI 53233-1954 |
| CURRENT OCCUPANT | 2224 W WISCONSIN AVE 501 | MILWAUKEE, WI 53233-1989 |
| CURRENT OCCUPANT | 2224 W WISCONSIN AVE 308 | MILWAUKEE, WI 53233-1986 |
| CURRENT OCCUPANT | 2224 W WISCONSIN AVE 611 | MILWAUKEE, WI 53233-1990 |
| CURRENT OCCUPANT | 2224 W WISCONSIN AVE 300 | MILWAUKEE, WI 53233-1986 |
| CURRENT OCCUPANT | 2224 W WISCONSIN AVE 610 | MILWAUKEE, WI 53233-1990 |
| CURRENT OCCUPANT | 2224 W WISCONSIN AVE 605 | MILWAUKEE, WI 53233-1990 |
| CURRENT OCCUPANT | 2224 W WISCONSIN AVE 109 | MILWAUKEE, WI 53233-1943 |
| CURRENT OCCUPANT | 742 N 22ND ST 11         | MILWAUKEE, WI 53233-1915 |
| CURRENT OCCUPANT | 742 N 22ND ST 9          | MILWAUKEE, WI 53233-1915 |
| CURRENT OCCUPANT | 742 N 22ND ST 8          | MILWAUKEE, WI 53233-1915 |
| CURRENT OCCUPANT | 742 N 22ND ST 7          | MILWAUKEE, WI 53233-1915 |
| CURRENT OCCUPANT | 742 N 22ND ST 12         | MILWAUKEE, WI 53233-1915 |
| CURRENT OCCUPANT | 746 N 22ND ST 16         | MILWAUKEE, WI 53233-1915 |
| CURRENT OCCUPANT | 2111 W WISCONSIN AVE 18  | MILWAUKEE, WI 53233-1910 |
| CURRENT OCCUPANT | 2111 W WISCONSIN AVE 16  | MILWAUKEE, WI 53233-1910 |
| CURRENT OCCUPANT | 2113 W WISCONSIN AVE F   | MILWAUKEE, WI 53233-1910 |
| CURRENT OCCUPANT | 737 N 21ST ST 108        | MILWAUKEE, WI 53233-1946 |
| CURRENT OCCUPANT | 737 N 21ST ST 103        | MILWAUKEE, WI 53233-1961 |
| CURRENT OCCUPANT | 737 N 21ST ST 112        | MILWAUKEE, WI 53233-1946 |
| CURRENT OCCUPANT | 737 N 21ST ST 306        | MILWAUKEE, WI 53233-1949 |
| CURRENT OCCUPANT | 2324 W WISCONSIN AVE 40  | MILWAUKEE, WI 53233-2910 |
| CURRENT OCCUPANT | 2324 W WISCONSIN AVE 10  | MILWAUKEE, WI 53233-1856 |
| CURRENT OCCUPANT | 2324 W WISCONSIN AVE 28  | MILWAUKEE, WI 53233-1857 |
| CURRENT OCCUPANT | 2324 W WISCONSIN AVE 67  | MILWAUKEE, WI 53233-2913 |
| CURRENT OCCUPANT | 730 N 23RD ST 209        | MILWAUKEE, WI 53233-1917 |
| CURRENT OCCUPANT | 730 N 23RD ST 304        | MILWAUKEE, WI 53233-1917 |
| CURRENT OCCUPANT | 730 N 23RD ST 305        | MILWAUKEE, WI 53233-1917 |
| CURRENT OCCUPANT | 730 N 23RD ST 307        | MILWAUKEE, WI 53233-1917 |
| CURRENT OCCUPANT | 730 N 23RD ST 109        | MILWAUKEE, WI 53233-1917 |
| CURRENT OCCUPANT | 730 N 23RD ST 301        | MILWAUKEE, WI 53233-1917 |
| CURRENT OCCUPANT | 730 N 23RD ST 107        | MILWAUKEE, WI 53233-1917 |
| CURRENT OCCUPANT | 726 N 23RD ST 3          | MILWAUKEE, WI 53233-1954 |
| CURRENT OCCUPANT | 726 N 23RD ST 7          | MILWAUKEE, WI 53233-3012 |
| CURRENT OCCUPANT | 726 N 23RD ST 8          | MILWAUKEE, WI 53233-3012 |
| CURRENT OCCUPANT | 2224 W WISCONSIN AVE 609 | MILWAUKEE, WI 53233-1990 |
| CURRENT OCCUPANT | 2224 W WISCONSIN AVE 211 | MILWAUKEE, WI 53233-1984 |
| CURRENT OCCUPANT | 2224 W WISCONSIN AVE 200 | MILWAUKEE, WI 53233-1984 |
| CURRENT OCCUPANT | 2224 W WISCONSIN AVE 206 | MILWAUKEE, WI 53233-1984 |

|                  |                          |                          |
|------------------|--------------------------|--------------------------|
| CURRENT OCCUPANT | 2224 W WISCONSIN AVE 201 | MILWAUKEE, WI 53233-1984 |
| CURRENT OCCUPANT | 2224 W WISCONSIN AVE 404 | MILWAUKEE, WI 53233-1987 |
| CURRENT OCCUPANT | 2224 W WISCONSIN AVE 306 | MILWAUKEE, WI 53233-1986 |
| CURRENT OCCUPANT | 2224 W WISCONSIN AVE 410 | MILWAUKEE, WI 53233-1987 |
| CURRENT OCCUPANT | 2224 W WISCONSIN AVE 203 | MILWAUKEE, WI 53233-1984 |
| CURRENT OCCUPANT | 2224 W WISCONSIN AVE 208 | MILWAUKEE, WI 53233-1984 |
| CURRENT OCCUPANT | 2217 W WISCONSIN AVE 6   | MILWAUKEE, WI 53233-1923 |
| CURRENT OCCUPANT | 2217 W WISCONSIN AVE 4   | MILWAUKEE, WI 53233-1923 |
| CURRENT OCCUPANT | 2217 W WISCONSIN AVE 11  | MILWAUKEE, WI 53233-1923 |
| CURRENT OCCUPANT | 2217 W WISCONSIN AVE 7   | MILWAUKEE, WI 53233-1923 |
| CURRENT OCCUPANT | 743 N 22ND ST            | MILWAUKEE, WI 53233-1914 |
| CURRENT OCCUPANT | 746 N 22ND ST 13         | MILWAUKEE, WI 53233-1915 |
| CURRENT OCCUPANT | 754 N 22ND ST 22         | MILWAUKEE, WI 53233-1915 |
| CURRENT OCCUPANT | 2111 W WISCONSIN AVE 19  | MILWAUKEE, WI 53233-1910 |
| CURRENT OCCUPANT | 2113 W WISCONSIN AVE 12  | MILWAUKEE, WI 53233-1910 |
| CURRENT OCCUPANT | 2113 W WISCONSIN AVE 9   | MILWAUKEE, WI 53233-1910 |
| CURRENT OCCUPANT | 2113 W WISCONSIN AVE 7   | MILWAUKEE, WI 53233-1910 |
| CURRENT OCCUPANT | 737 N 21ST ST 100        | MILWAUKEE, WI 53233-1948 |
| CURRENT OCCUPANT | 737 N 21ST ST 206        | MILWAUKEE, WI 53233-1978 |
| CURRENT OCCUPANT | 737 N 21ST ST 104        | MILWAUKEE, WI 53233-1948 |
| CURRENT OCCUPANT | 737 N 21ST ST 105        | MILWAUKEE, WI 53233-1961 |
| CURRENT OCCUPANT | 727 N 21ST ST 103        | MILWAUKEE, WI 53233-1912 |
| CURRENT OCCUPANT | 727 N 21ST ST 105        | MILWAUKEE, WI 53233-1912 |
| CURRENT OCCUPANT | 727 N 21ST ST 407        | MILWAUKEE, WI 53233-1912 |
| CURRENT OCCUPANT | 727 N 21ST ST 202        | MILWAUKEE, WI 53233-1912 |
| CURRENT OCCUPANT | 727 N 21ST ST 106        | MILWAUKEE, WI 53233-1912 |
| CURRENT OCCUPANT | 727 N 21ST ST 308        | MILWAUKEE, WI 53233-1912 |
| CURRENT OCCUPANT | 2324 W WISCONSIN AVE 21  | MILWAUKEE, WI 53233-1857 |
| CURRENT OCCUPANT | 2324 W WISCONSIN AVE 57  | MILWAUKEE, WI 53233-2911 |
| CURRENT OCCUPANT | 2324 W WISCONSIN AVE 63  | MILWAUKEE, WI 53233-2913 |
| CURRENT OCCUPANT | 2324 W WISCONSIN AVE 61  | MILWAUKEE, WI 53233-2913 |
| CURRENT OCCUPANT | 2324 W WISCONSIN AVE 37  | MILWAUKEE, WI 53233-2909 |
| CURRENT OCCUPANT | 2324 W WISCONSIN AVE 22  | MILWAUKEE, WI 53233-1857 |
| CURRENT OCCUPANT | 730 N 23RD ST 101        | MILWAUKEE, WI 53233-1917 |
| CURRENT OCCUPANT | 726 N 23RD ST 10         | MILWAUKEE, WI 53233-3013 |
| CURRENT OCCUPANT | 726 N 23RD ST 11         | MILWAUKEE, WI 53233-3013 |
| CURRENT OCCUPANT | 726 N 23RD ST 12         | MILWAUKEE, WI 53233-3013 |
| CURRENT OCCUPANT | 2224 W WISCONSIN AVE 406 | MILWAUKEE, WI 53233-1987 |
| CURRENT OCCUPANT | 2224 W WISCONSIN AVE 402 | MILWAUKEE, WI 53233-1987 |
| CURRENT OCCUPANT | 2224 W WISCONSIN AVE 311 | MILWAUKEE, WI 53233-1986 |
| CURRENT OCCUPANT | 2224 W WISCONSIN AVE 604 | MILWAUKEE, WI 53233-1990 |
| CURRENT OCCUPANT | 2224 W WISCONSIN AVE 504 | MILWAUKEE, WI 53233-1989 |
| CURRENT OCCUPANT | 2224 W WISCONSIN AVE 607 | MILWAUKEE, WI 53233-1990 |
| CURRENT OCCUPANT | 2224 W WISCONSIN AVE 601 | MILWAUKEE, WI 53233-1990 |
| CURRENT OCCUPANT | 2224 W WISCONSIN AVE 602 | MILWAUKEE, WI 53233-1990 |
| CURRENT OCCUPANT | 2224 W WISCONSIN AVE 303 | MILWAUKEE, WI 53233-1986 |
| CURRENT OCCUPANT | 2224 W WISCONSIN AVE 205 | MILWAUKEE, WI 53233-1984 |
| CURRENT OCCUPANT | 2224 W WISCONSIN AVE 304 | MILWAUKEE, WI 53233-1986 |
| CURRENT OCCUPANT | 2224 W WISCONSIN AVE 103 | MILWAUKEE, WI 53233-1943 |
| CURRENT OCCUPANT | 734 N 22ND ST 2          | MILWAUKEE, WI 53233-1915 |
| CURRENT OCCUPANT | 734 N 22ND ST 3          | MILWAUKEE, WI 53233-1915 |
| CURRENT OCCUPANT | 754 N 22ND ST 19         | MILWAUKEE, WI 53233-1915 |
| CURRENT OCCUPANT | 754 N 22ND ST 23         | MILWAUKEE, WI 53233-1915 |
| CURRENT OCCUPANT | 2113 W WISCONSIN AVE D   | MILWAUKEE, WI 53233-1910 |
| CURRENT OCCUPANT | 737 N 21ST ST 107        | MILWAUKEE, WI 53233-1946 |
| CURRENT OCCUPANT | 737 N 21ST ST 208        | MILWAUKEE, WI 53233-1947 |

|                  |                          |                          |
|------------------|--------------------------|--------------------------|
| CURRENT OCCUPANT | 737 N 21ST ST 203        | MILWAUKEE, WI 53233-1948 |
| CURRENT OCCUPANT | 727 N 21ST ST 102        | MILWAUKEE, WI 53233-1912 |
| CURRENT OCCUPANT | 727 N 21ST ST 305        | MILWAUKEE, WI 53233-1912 |
| CURRENT OCCUPANT | 727 N 21ST ST 306        | MILWAUKEE, WI 53233-1912 |
| CURRENT OCCUPANT | 2324 W WISCONSIN AVE 68  | MILWAUKEE, WI 53233-2913 |
| CURRENT OCCUPANT | 2324 W WISCONSIN AVE 31  | MILWAUKEE, WI 53233-2909 |
| CURRENT OCCUPANT | 2324 W WISCONSIN AVE 49  | MILWAUKEE, WI 53233-2910 |
| CURRENT OCCUPANT | 2324 W WISCONSIN AVE 69  | MILWAUKEE, WI 53233-2913 |
| CURRENT OCCUPANT | 2324 W WISCONSIN AVE 41  | MILWAUKEE, WI 53233-2910 |
| CURRENT OCCUPANT | 2324 W WISCONSIN AVE 19  | MILWAUKEE, WI 53233-1856 |
| CURRENT OCCUPANT | 2324 W WISCONSIN AVE 29  | MILWAUKEE, WI 53233-1857 |
| CURRENT OCCUPANT | 2324 W WISCONSIN AVE 60  | MILWAUKEE, WI 53233-2913 |
| CURRENT OCCUPANT | 730 N 23RD ST 110        | MILWAUKEE, WI 53233-1917 |
| CURRENT OCCUPANT | 730 N 23RD ST 306        | MILWAUKEE, WI 53233-1917 |
| CURRENT OCCUPANT | 730 N 23RD ST 303        | MILWAUKEE, WI 53233-1917 |
| CURRENT OCCUPANT | 730 N 23RD ST 308        | MILWAUKEE, WI 53233-1917 |
| CURRENT OCCUPANT | 730 N 23RD ST 300        | MILWAUKEE, WI 53233-1917 |
| CURRENT OCCUPANT | 730 N 23RD ST 202        | MILWAUKEE, WI 53233-1917 |
| CURRENT OCCUPANT | 730 N 23RD ST 108        | MILWAUKEE, WI 53233-1917 |
| CURRENT OCCUPANT | 726 N 23RD ST 1          | MILWAUKEE, WI 53233-1954 |
| CURRENT OCCUPANT | 2224 W WISCONSIN AVE 106 | MILWAUKEE, WI 53233-1943 |
| CURRENT OCCUPANT | 2224 W WISCONSIN AVE 606 | MILWAUKEE, WI 53233-1990 |
| CURRENT OCCUPANT | 2224 W WISCONSIN AVE 210 | MILWAUKEE, WI 53233-1984 |
| CURRENT OCCUPANT | 2224 W WISCONSIN AVE 505 | MILWAUKEE, WI 53233-1989 |
| CURRENT OCCUPANT | 2224 W WISCONSIN AVE 310 | MILWAUKEE, WI 53233-1986 |
| CURRENT OCCUPANT | 2224 W WISCONSIN AVE 209 | MILWAUKEE, WI 53233-1984 |
| CURRENT OCCUPANT | 2224 W WISCONSIN AVE 411 | MILWAUKEE, WI 53233-1987 |
| CURRENT OCCUPANT | 2224 W WISCONSIN AVE 506 | MILWAUKEE, WI 53233-1989 |
| CURRENT OCCUPANT | 2217 W WISCONSIN AVE 12  | MILWAUKEE, WI 53233-1923 |
| CURRENT OCCUPANT | 2217 W WISCONSIN AVE 8   | MILWAUKEE, WI 53233-1923 |
| CURRENT OCCUPANT | 2111 W WISCONSIN AVE 17  | MILWAUKEE, WI 53233-1910 |
| CURRENT OCCUPANT | 2115 W WISCONSIN AVE 6   | MILWAUKEE, WI 53233-1910 |
| CURRENT OCCUPANT | 2113 W WISCONSIN AVE 8   | MILWAUKEE, WI 53233-1910 |
| CURRENT OCCUPANT | 2115 W WISCONSIN AVE C   | MILWAUKEE, WI 53233-1910 |
| CURRENT OCCUPANT | 2115 W WISCONSIN AVE 4   | MILWAUKEE, WI 53233-1910 |
| CURRENT OCCUPANT | 737 N 21ST ST 111        | MILWAUKEE, WI 53233-1961 |
| CURRENT OCCUPANT | 737 N 21ST ST 302        | MILWAUKEE, WI 53233-1980 |
| CURRENT OCCUPANT | 737 N 21ST ST 205        | MILWAUKEE, WI 53233-1978 |
| CURRENT OCCUPANT | 737 N 21ST ST 210        | MILWAUKEE, WI 53233-1978 |
| CURRENT OCCUPANT | 737 N 21ST ST 211        | MILWAUKEE, WI 53233-1947 |
| CURRENT OCCUPANT | 737 N 21ST ST 201        | MILWAUKEE, WI 53233-1978 |
| CURRENT OCCUPANT | 727 N 21ST ST 403        | MILWAUKEE, WI 53233-1948 |
| CURRENT OCCUPANT | 727 N 21ST ST 404        | MILWAUKEE, WI 53233-1912 |
| CURRENT OCCUPANT | 727 N 21ST ST 107        | MILWAUKEE, WI 53233-1912 |
| CURRENT OCCUPANT | 727 N 21ST ST 207        | MILWAUKEE, WI 53233-1912 |
| CURRENT OCCUPANT | 2324 W WISCONSIN AVE 65  | MILWAUKEE, WI 53233-2913 |
| CURRENT OCCUPANT | 2324 W WISCONSIN AVE 12  | MILWAUKEE, WI 53233-1856 |
| CURRENT OCCUPANT | 2324 W WISCONSIN AVE 50  | MILWAUKEE, WI 53233-2911 |
| CURRENT OCCUPANT | 2324 W WISCONSIN AVE 44  | MILWAUKEE, WI 53233-2910 |
| CURRENT OCCUPANT | 2324 W WISCONSIN AVE 35  | MILWAUKEE, WI 53233-2909 |
| CURRENT OCCUPANT | 2324 W WISCONSIN AVE 46  | MILWAUKEE, WI 53233-2910 |
| CURRENT OCCUPANT | 2324 W WISCONSIN AVE 55  | MILWAUKEE, WI 53233-2911 |
| CURRENT OCCUPANT | 2324 W WISCONSIN AVE 47  | MILWAUKEE, WI 53233-2910 |
| CURRENT OCCUPANT | 2324 W WISCONSIN AVE 14  | MILWAUKEE, WI 53233-1856 |
| CURRENT OCCUPANT | 730 N 23RD ST 302        | MILWAUKEE, WI 53233-1917 |
| CURRENT OCCUPANT | 730 N 23RD ST 102        | MILWAUKEE, WI 53233-1917 |

|                  |                          |                          |
|------------------|--------------------------|--------------------------|
| CURRENT OCCUPANT | 730 N 23RD ST 104        | MILWAUKEE, WI 53233-1917 |
| CURRENT OCCUPANT | 730 N 23RD ST 201        | MILWAUKEE, WI 53233-1917 |
| CURRENT OCCUPANT | 730 N 23RD ST 204        | MILWAUKEE, WI 53233-1917 |
| CURRENT OCCUPANT | 730 N 23RD ST 206        | MILWAUKEE, WI 53233-1917 |
| CURRENT OCCUPANT | 726 N 23RD ST 17         | MILWAUKEE, WI 53233-3013 |
| CURRENT OCCUPANT | 726 N 23RD ST 16         | MILWAUKEE, WI 53233-3013 |
| CURRENT OCCUPANT | 726 N 23RD ST 2          | MILWAUKEE, WI 53233-1954 |
| CURRENT OCCUPANT | 726 N 23RD ST 9          | MILWAUKEE, WI 53233-3013 |
| CURRENT OCCUPANT | 2224 W WISCONSIN AVE 207 | MILWAUKEE, WI 53233-1984 |
| CURRENT OCCUPANT | 2224 W WISCONSIN AVE 204 | MILWAUKEE, WI 53233-1984 |
| CURRENT OCCUPANT | 2224 W WISCONSIN AVE 302 | MILWAUKEE, WI 53233-1986 |
| CURRENT OCCUPANT | 2224 W WISCONSIN AVE 405 | MILWAUKEE, WI 53233-1987 |
| CURRENT OCCUPANT | 2224 W WISCONSIN AVE 408 | MILWAUKEE, WI 53233-1987 |
| CURRENT OCCUPANT | 2224 W WISCONSIN AVE 107 | MILWAUKEE, WI 53233-1943 |
| CURRENT OCCUPANT | 2224 W WISCONSIN AVE 307 | MILWAUKEE, WI 53233-1986 |
| CURRENT OCCUPANT | 2224 W WISCONSIN AVE 600 | MILWAUKEE, WI 53233-1990 |
| CURRENT OCCUPANT | 2224 W WISCONSIN AVE 603 | MILWAUKEE, WI 53233-1990 |
| CURRENT OCCUPANT | 2224 W WISCONSIN AVE 503 | MILWAUKEE, WI 53233-1989 |
| CURRENT OCCUPANT | 2224 W WISCONSIN AVE 110 | MILWAUKEE, WI 53233-1943 |
| CURRENT OCCUPANT | 2224 W WISCONSIN AVE 509 | MILWAUKEE, WI 53233-1989 |
| CURRENT OCCUPANT | 2224 W WISCONSIN AVE 502 | MILWAUKEE, WI 53233-1989 |
| CURRENT OCCUPANT | 2217 W WISCONSIN AVE 5   | MILWAUKEE, WI 53233-1923 |
| CURRENT OCCUPANT | 2217 W WISCONSIN AVE 2   | MILWAUKEE, WI 53233-1923 |
| CURRENT OCCUPANT | 734 N 22ND ST 1          | MILWAUKEE, WI 53233-1915 |
| CURRENT OCCUPANT | 2113 W WISCONSIN AVE E   | MILWAUKEE, WI 53233-1910 |
| CURRENT OCCUPANT | 737 N 21ST ST 301        | MILWAUKEE, WI 53233-1979 |
| CURRENT OCCUPANT | 737 N 21ST ST 308        | MILWAUKEE, WI 53233-1949 |
| CURRENT OCCUPANT | 737 N 21ST ST 207        | MILWAUKEE, WI 53233-1978 |
| CURRENT OCCUPANT | 737 N 21ST ST 202        | MILWAUKEE, WI 53233-1947 |
| CURRENT OCCUPANT | 737 N 21ST ST 304        | MILWAUKEE, WI 53233-1980 |
| CURRENT OCCUPANT | 737 N 21ST ST 212        | MILWAUKEE, WI 53233-1947 |
| CURRENT OCCUPANT | 737 N 21ST ST 312        | MILWAUKEE, WI 53233-1980 |
| CURRENT OCCUPANT | 727 N 21ST ST 405        | MILWAUKEE, WI 53233-1912 |
| CURRENT OCCUPANT | 727 N 21ST ST 302        | MILWAUKEE, WI 53233-1912 |
| CURRENT OCCUPANT | 2324 W WISCONSIN AVE 33  | MILWAUKEE, WI 53233-2909 |
| CURRENT OCCUPANT | 2324 W WISCONSIN AVE 23  | MILWAUKEE, WI 53233-1857 |
| CURRENT OCCUPANT | 2324 W WISCONSIN AVE 16  | MILWAUKEE, WI 53233-1856 |
| CURRENT OCCUPANT | 2324 W WISCONSIN AVE 66  | MILWAUKEE, WI 53233-2913 |
| CURRENT OCCUPANT | 2324 W WISCONSIN AVE 62  | MILWAUKEE, WI 53233-2913 |
| CURRENT OCCUPANT | 2324 W WISCONSIN AVE 34  | MILWAUKEE, WI 53233-2909 |
| CURRENT OCCUPANT | 2324 W WISCONSIN AVE 27  | MILWAUKEE, WI 53233-1857 |
| CURRENT OCCUPANT | 2324 W WISCONSIN AVE 20  | MILWAUKEE, WI 53233-1857 |
| CURRENT OCCUPANT | 2324 W WISCONSIN AVE 53  | MILWAUKEE, WI 53233-2911 |
| CURRENT OCCUPANT | 730 N 23RD ST 207        | MILWAUKEE, WI 53233-1917 |
| CURRENT OCCUPANT | 726 N 23RD ST 15         | MILWAUKEE, WI 53233-3013 |
| CURRENT OCCUPANT | 726 N 23RD ST 5          | MILWAUKEE, WI 53233-1954 |
| CURRENT OCCUPANT | 726 N 23RD ST 6          | MILWAUKEE, WI 53233-3012 |
| CURRENT OCCUPANT | 2224 W WISCONSIN AVE 400 | MILWAUKEE, WI 53233-1987 |
| CURRENT OCCUPANT | 2224 W WISCONSIN AVE 403 | MILWAUKEE, WI 53233-1987 |
| CURRENT OCCUPANT | 2224 W WISCONSIN AVE 409 | MILWAUKEE, WI 53233-1987 |
| CURRENT OCCUPANT | 2224 W WISCONSIN AVE 104 | MILWAUKEE, WI 53233-1943 |
| CURRENT OCCUPANT | 2224 W WISCONSIN AVE 202 | MILWAUKEE, WI 53233-1984 |
| CURRENT OCCUPANT | 2224 W WISCONSIN AVE 100 | MILWAUKEE, WI 53233-1943 |
| CURRENT OCCUPANT | 2224 W WISCONSIN AVE 507 | MILWAUKEE, WI 53233-1989 |
| CURRENT OCCUPANT | 2224 W WISCONSIN AVE 511 | MILWAUKEE, WI 53233-1989 |
| CURRENT OCCUPANT | 2224 W WISCONSIN AVE 510 | MILWAUKEE, WI 53233-1989 |

|                  |                          |                          |
|------------------|--------------------------|--------------------------|
| CURRENT OCCUPANT | 2224 W WISCONSIN AVE 305 | MILWAUKEE, WI 53233-1986 |
| CURRENT OCCUPANT | 2224 W WISCONSIN AVE 301 | MILWAUKEE, WI 53233-1986 |
| CURRENT OCCUPANT | 2217 W WISCONSIN AVE 3   | MILWAUKEE, WI 53233-1923 |
| CURRENT OCCUPANT | 734 N 22ND ST 6          | MILWAUKEE, WI 53233-1915 |
| CURRENT OCCUPANT | 754 N 22ND ST 20         | MILWAUKEE, WI 53233-1915 |
| CURRENT OCCUPANT | 742 N 22ND ST 10         | MILWAUKEE, WI 53233-1915 |
| CURRENT OCCUPANT | 754 N 22ND ST 21         | MILWAUKEE, WI 53233-1915 |
| CURRENT OCCUPANT | 2115 W WISCONSIN AVE 1   | MILWAUKEE, WI 53233-1910 |
| CURRENT OCCUPANT | 2111 W WISCONSIN AVE 15  | MILWAUKEE, WI 53233-1910 |
| CURRENT OCCUPANT | 2115 W WISCONSIN AVE 5   | MILWAUKEE, WI 53233-1910 |
| CURRENT OCCUPANT | 2115 W WISCONSIN AVE 2   | MILWAUKEE, WI 53233-1910 |
| CURRENT OCCUPANT | 737 N 21ST ST 101        | MILWAUKEE, WI 53233-1961 |
| CURRENT OCCUPANT | 737 N 21ST ST 310        | MILWAUKEE, WI 53233-1949 |
| CURRENT OCCUPANT | 737 N 21ST ST 209        | MILWAUKEE, WI 53233-1978 |
| CURRENT OCCUPANT | 737 N 21ST ST 204        | MILWAUKEE, WI 53233-1947 |
| CURRENT OCCUPANT | 737 N 21ST ST 300        | MILWAUKEE, WI 53233-1980 |
| CURRENT OCCUPANT | 737 N 21ST ST 303        | MILWAUKEE, WI 53233-1979 |
| CURRENT OCCUPANT | 737 N 21ST ST 305        | MILWAUKEE, WI 53233-1979 |
| CURRENT OCCUPANT | 727 N 21ST ST 406        | MILWAUKEE, WI 53233-1912 |
| CURRENT OCCUPANT | 727 N 21ST ST 301        | MILWAUKEE, WI 53233-1912 |
| CURRENT OCCUPANT | 727 N 21ST ST 203        | MILWAUKEE, WI 53233-1912 |
| CURRENT OCCUPANT | 727 N 21ST ST 304        | MILWAUKEE, WI 53233-1912 |
| CURRENT OCCUPANT | 727 N 21ST ST 101        | MILWAUKEE, WI 53233-1912 |
| CURRENT OCCUPANT | 727 N 21ST ST 204        | MILWAUKEE, WI 53233-1912 |
| CURRENT OCCUPANT | 727 N 21ST ST 401        | MILWAUKEE, WI 53233-1912 |
| CURRENT OCCUPANT | 727 N 21ST ST 408        | MILWAUKEE, WI 53233-1912 |
| CURRENT OCCUPANT | 2324 W WISCONSIN AVE 39  | MILWAUKEE, WI 53233-2909 |
| CURRENT OCCUPANT | 2324 W WISCONSIN AVE 43  | MILWAUKEE, WI 53233-2910 |
| CURRENT OCCUPANT | 2324 W WISCONSIN AVE 38  | MILWAUKEE, WI 53233-2909 |
| CURRENT OCCUPANT | 2324 W WISCONSIN AVE 15  | MILWAUKEE, WI 53233-1856 |
| CURRENT OCCUPANT | 2324 W WISCONSIN AVE 36  | MILWAUKEE, WI 53233-2909 |
| CURRENT OCCUPANT | 2324 W WISCONSIN AVE 17  | MILWAUKEE, WI 53233-1856 |
| CURRENT OCCUPANT | 2324 W WISCONSIN AVE 52  | MILWAUKEE, WI 53233-2911 |
| CURRENT OCCUPANT | 730 N 23RD ST 210        | MILWAUKEE, WI 53233-1917 |
| CURRENT OCCUPANT | 730 N 23RD ST 106        | MILWAUKEE, WI 53233-1917 |
| CURRENT OCCUPANT | 730 N 23RD ST 208        | MILWAUKEE, WI 53233-1917 |
| CURRENT OCCUPANT | 726 N 23RD ST 18         | MILWAUKEE, WI 53233-3013 |
| CURRENT OCCUPANT | 726 N 23RD ST 13         | MILWAUKEE, WI 53233-3013 |
| CURRENT OCCUPANT | 2224 W WISCONSIN AVE 309 | MILWAUKEE, WI 53233-1986 |
| CURRENT OCCUPANT | 2224 W WISCONSIN AVE 500 | MILWAUKEE, WI 53233-1989 |
| CURRENT OCCUPANT | 2224 W WISCONSIN AVE 508 | MILWAUKEE, WI 53233-1989 |
| CURRENT OCCUPANT | 2224 W WISCONSIN AVE 608 | MILWAUKEE, WI 53233-1990 |
| CURRENT OCCUPANT | 2224 W WISCONSIN AVE 105 | MILWAUKEE, WI 53233-1943 |
| CURRENT OCCUPANT | 2224 W WISCONSIN AVE 108 | MILWAUKEE, WI 53233-1943 |
| CURRENT OCCUPANT | 2224 W WISCONSIN AVE 102 | MILWAUKEE, WI 53233-1943 |
| CURRENT OCCUPANT | 2217 W WISCONSIN AVE 1   | MILWAUKEE, WI 53233-1923 |
| CURRENT OCCUPANT | 2217 W WISCONSIN AVE 9   | MILWAUKEE, WI 53233-1923 |
| CURRENT OCCUPANT | 2217 W WISCONSIN AVE 10  | MILWAUKEE, WI 53233-1923 |
| CURRENT OCCUPANT | 734 N 22ND ST 5          | MILWAUKEE, WI 53233-1915 |
| CURRENT OCCUPANT | 734 N 22ND ST 4          | MILWAUKEE, WI 53233-1915 |
| CURRENT OCCUPANT | 2111 W WISCONSIN AVE 14  | MILWAUKEE, WI 53233-1910 |
| CURRENT OCCUPANT | 2113 W WISCONSIN AVE 11  | MILWAUKEE, WI 53233-1910 |
| CURRENT OCCUPANT | 2115 W WISCONSIN AVE 3   | MILWAUKEE, WI 53233-1910 |
| CURRENT OCCUPANT | 2115 W WISCONSIN AVE A   | MILWAUKEE, WI 53233-1910 |
| CURRENT OCCUPANT | 737 N 21ST ST 307        | MILWAUKEE, WI 53233-1949 |
| CURRENT OCCUPANT | 737 N 21ST ST 110        | MILWAUKEE, WI 53233-1946 |



|                  |                          |                          |
|------------------|--------------------------|--------------------------|
| CURRENT OCCUPANT | 737 N 21ST ST 311        | MILWAUKEE, WI 53233-1979 |
| CURRENT OCCUPANT | 737 N 21ST ST 309        | MILWAUKEE, WI 53233-1949 |
| CURRENT OCCUPANT | 727 N 21ST ST 108        | MILWAUKEE, WI 53233-1912 |
| CURRENT OCCUPANT | 727 N 21ST ST 307        | MILWAUKEE, WI 53233-1912 |
| CURRENT OCCUPANT | 727 N 21ST ST 205        | MILWAUKEE, WI 53233-1912 |
| CURRENT OCCUPANT | 2324 W WISCONSIN AVE 26  | MILWAUKEE, WI 53233-1857 |
| CURRENT OCCUPANT | 2324 W WISCONSIN AVE 54  | MILWAUKEE, WI 53233-2911 |
| CURRENT OCCUPANT | 2324 W WISCONSIN AVE 30  | MILWAUKEE, WI 53233-2909 |
| CURRENT OCCUPANT | 2324 W WISCONSIN AVE 42  | MILWAUKEE, WI 53233-2910 |
| CURRENT OCCUPANT | 2324 W WISCONSIN AVE 18  | MILWAUKEE, WI 53233-1856 |
| CURRENT OCCUPANT | 2324 W WISCONSIN AVE 58  | MILWAUKEE, WI 53233-2911 |
| CURRENT OCCUPANT | 2324 W WISCONSIN AVE 56  | MILWAUKEE, WI 53233-2911 |
| CURRENT OCCUPANT | 730 N 23RD ST 309        | MILWAUKEE, WI 53233-1917 |
| CURRENT OCCUPANT | 730 N 23RD ST 211        | MILWAUKEE, WI 53233-1917 |
| CURRENT OCCUPANT | 730 N 23RD ST 310        | MILWAUKEE, WI 53233-1917 |
| CURRENT OCCUPANT | 726 N 23RD ST 14         | MILWAUKEE, WI 53233-3013 |
| CURRENT OCCUPANT | 2224 W WISCONSIN AVE 101 | MILWAUKEE, WI 53233-1943 |
| CURRENT OCCUPANT | 2224 W WISCONSIN AVE 407 | MILWAUKEE, WI 53233-1987 |
| CURRENT OCCUPANT | 2224 W WISCONSIN AVE 401 | MILWAUKEE, WI 53233-1987 |
| CURRENT OCCUPANT | 2224 W WISCONSIN AVE 111 | MILWAUKEE, WI 53233-1943 |
| CURRENT OCCUPANT | 746 N 22ND ST 15         | MILWAUKEE, WI 53233-1915 |
| CURRENT OCCUPANT | 746 N 22ND ST 14         | MILWAUKEE, WI 53233-1915 |
| CURRENT OCCUPANT | 746 N 22ND ST 18         | MILWAUKEE, WI 53233-1915 |
| CURRENT OCCUPANT | 746 N 22ND ST 17         | MILWAUKEE, WI 53233-1915 |
| CURRENT OCCUPANT | 754 N 22ND ST 24         | MILWAUKEE, WI 53233-1915 |
| CURRENT OCCUPANT | 2111 W WISCONSIN AVE 20  | MILWAUKEE, WI 53233-1910 |
| CURRENT OCCUPANT | 2113 W WISCONSIN AVE 10  | MILWAUKEE, WI 53233-1910 |
| CURRENT OCCUPANT | 2115 W WISCONSIN AVE B   | MILWAUKEE, WI 53233-1910 |
| CURRENT OCCUPANT | 737 N 21ST ST 200        | MILWAUKEE, WI 53233-1979 |
| CURRENT OCCUPANT | 737 N 21ST ST 106        | MILWAUKEE, WI 53233-1946 |
| CURRENT OCCUPANT | 737 N 21ST ST 102        | MILWAUKEE, WI 53233-1948 |
| CURRENT OCCUPANT | 737 N 21ST ST 109        | MILWAUKEE, WI 53233-1961 |
| CURRENT OCCUPANT | 727 N 21ST ST 208        | MILWAUKEE, WI 53233-1912 |
| CURRENT OCCUPANT | 727 N 21ST ST 206        | MILWAUKEE, WI 53233-1912 |
| CURRENT OCCUPANT | 727 N 21ST ST 201        | MILWAUKEE, WI 53233-1912 |
| CURRENT OCCUPANT | 727 N 21ST ST 303        | MILWAUKEE, WI 53233-1912 |
| CURRENT OCCUPANT | 727 N 21ST ST 104        | MILWAUKEE, WI 53233-1912 |
| CURRENT OCCUPANT | 727 N 21ST ST 402        | MILWAUKEE, WI 53233-1912 |

**Total Records: 318**

**Radius: 250.0 feet and Center of Circle: 2210 W Wisconsin AV**



## BUSINESS LICENSE PLAN OF OPERATION

ccl-busplan 3/7/16

Office of the City Clerk License Division

200 E. Wells St. Room 105, Milwaukee, WI 53202

(414) 286-2238 www.milwaukee.gov/license e-mail address: [license@milwaukee.gov](mailto:license@milwaukee.gov)

### 1. Type of Business

- Applying for:  Extended Hours Establishment  Filling Station  
 Self Service Laundry  Rooming House  Hotel/Motel  Massage Establishment  
 Other (supplemental application for specific license also required)

Provide a detailed description of the type of business you plan on operating:

Mexican Fast Food Restaurant with dine in / carry out / Drive thru - Taco Bell

Do you have any experience operating this type of business?  No  Yes If yes, explain: Pacific Bells, LLC operates over 100 Taco Bells across 4 states

### 2. Business Operations

- a. Proposed Opening Date: \_\_\_\_\_
- b. Is this premise under construction?  No  Yes If yes, list estimated completion date: \_\_\_\_\_
- c. Is this a franchise?  No  Yes
- d. Is this premises currently licensed?  No  Yes If yes, list type of license: \_\_\_\_\_
- e. Is the current licensee operating?  No  Yes If no, list date closed: \_\_\_\_\_
- f. Do you have future plans for other businesses, licenses or permits at this location?  No  Yes  
If yes, explain: \_\_\_\_\_
- g. Have you previously held an Extended Hours License in Milwaukee?  No  Yes  
If yes, list address(es): \_\_\_\_\_
- h. Are other businesses operating in the same building?  No  Yes If yes, describe: \_\_\_\_\_

### 3. Litter & Noise

- a. How are grounds kept clean?  Sweep  Pressure Wash  Pick Up Litter  Other: \_\_\_\_\_
- b. How often will grounds be cleaned?  Daily  Weekly  As Needed  Monthly  Other: \_\_\_\_\_
- c. Grounds cleaned by:  Licensee  Building Owner  Employees  Hired Maintenance  Other: \_\_\_\_\_
- d. How are noise issues prevented and/or addressed?  Security  Manager approaches customer(s)  Call Police  
 Signs Posted  Other: \_\_\_\_\_
- e. Will a sound amplification system be used?  No  Yes If yes, describe: Drive thru has speaker

### 4. Smoking & Sanitation

- a. Are there designated outdoor smoking areas?  No  Yes If yes, describe: \_\_\_\_\_
- b. Number of Garbage Cans: Inside: 6-8 Locations: Dining Room, Kitchen, restrooms  
Outside: 2 Locations: Near Entrances
- c. Is a crowd control barrier used?  No  Yes If yes, describe: \_\_\_\_\_
- d. How many restrooms are on the premises? 2 - one each for men and women
- e. Name of solid waste contractor:  Advanced Disposal  Waste Management  Other: Lincoln Waste Management

## 5. Security

a. Are there onsite parking spaces?  No  Yes If yes, indicate how many? 10-15 and describe the parking security plan: Manager walks lot hourly

b. Is there a loading zone?  No  Yes If yes, describe the loading area security plan: \_\_\_\_\_

c. Will you have security personnel on premise?  No  Yes If yes, how many? \_\_\_\_\_ and answer the following:

What are their responsibilities? \_\_\_\_\_

Is security equipment used?  No  Yes If yes, describe \_\_\_\_\_

List their licensing, certification, or training credentials \_\_\_\_\_

d. Will there be security cameras?  No  Yes If yes, where? Multi camera in Dining room/back of house

e. Will searches/identification checks be done upon entry?  No  Yes If yes, describe \_\_\_\_\_

## 6. Percentage of Sales (must total 100%)

|                            |   |  |                               |
|----------------------------|---|--|-------------------------------|
| Alcohol _____%             | Food <u>100</u> %                               | Secondhand Merchandise _____%  | Precious Metals & Gems _____% |
| Entertainment _____%       | Cigarettes _____%                               | Personal Services (such as tattoo, body piercing, salon, tailor, tanning, etc.) _____% | Other _____% Describe: _____  |
| Pawnbroker Activity _____% | Salvaged Materials _____% (such as scrap metal) |  |                               |

## 7. Businesses/Licenses on the Premises (check all that apply):

### Type 1

- Full Service Restaurant   
  Cafe/Coffee Shop   
  Deli or Fast Food Restaurant   
  Private/Fraternal/Veterans Club  
 Night Club   
  Tavern   
  Cocktail Lounge   
  Teen Club  
 Banquet Hall   
  Sports Facility   
  Bowling Alley  
 Hotel/Motel: Number of Floors: \_\_\_\_\_   
  Rooming House: Number of Floors: \_\_\_\_\_  
 Number of Rooms: \_\_\_\_\_   
 Number of Rooms: \_\_\_\_\_

### Type 2

- Liquor Store   
  Corner Store   
  Supermarket   
  Convenience Store  
 Gas Station   
  Amusement/Phonograph Distributor   
  Recycling, Salvage or Towing  
 Used Car Dealer   
  Personal Service Establishment (such as tattoo business, hair salon, tailor, etc.)   
  Recording Studio

What other licenses/permits will you hold at this location? (check all that apply)

- Occupancy Permit   
  Cigarette & Tobacco   
  Gas Station   
  Extended Hours   
  Class "B" Tavern   
  Weights & Measures  
 Secondhand Dealer   
 Precious Metal & Gem   
 Other: \_\_\_\_\_

## 8. Legal Capacity (only if a Type 1 premises in #7 above)

Capacity \_\_\_\_\_ (Call the Milwaukee Development Center at 414-286-8211 if you have questions.)

## 9. Premises Description

a. Identify all area(s) of the premises that will be used in operating this business (include areas used only for storage):

1<sup>st</sup> Floor  2<sup>nd</sup> Floor  Basement Storage  Patio  Beer Garden  Sidewalk Café  Deck  Rooftop

Other: Describe: \_\_\_\_\_

b. Describe Location:  Major Thoroughfare  Secondary Street  Other: \_\_\_\_\_

c. Nearest Major Cross Street: 22nd Street

d. Describe Building:  Free Standing Building  Strip Mall  Other: \_\_\_\_\_

e. Describe Premises Structure:  Single Story  Multi-Story - # of Stories \_\_\_\_\_  Other: \_\_\_\_\_

f. Describe Surrounding Area:  Commercial  Residential  Industrial  Other: \_\_\_\_\_

g. Building Owner Name: Pacific Bells, LLC Phone Number: (360) 694-7455

Business Owner Address: 111 W. 39th St. Vancouver, WA 98660

## 10. Hours of Operation & Customers

Will customers be entering the premises?  No  Yes

| Day of the Week | Proposed Hours of Operation:     |                                   | Estimated Number of Customers expected each day | Potential Age Range of Customers | Class B Tavern Applicant Only: Age Restriction (If none, write 'None') |
|-----------------|----------------------------------|-----------------------------------|---|----------------------------------|--|
|                 | Open Time (include a.m. or p.m.) | Close Time (include a.m. or p.m.) |   |                                  |  |
| Sunday          | 7am                              | 12am                              | 500   | all                              |  |
| Monday          | 7am                              | 12am                              | 600   | all                              |  |
| Tuesday         | 7am                              | 12am                              | 600   | all                              |  |
| Wednesday       | 7am                              | 12am                              | 600   | all                              |  |
| Thursday        | 7am                              | 12am                              | 600   | all                              |  |
| Friday          | 7am                              | 12am                              | 800   | all                              |  |
| Saturday        | 7am                              | 12am                              | 400   | all                              |  |

Extended Hours Establishment License is required for any convenience store, filling station, personal service establishment (such as tattoo, body piercing, salon, tailor, tanning, etc.), recording studio or restaurant which is open between the hours of 12 a.m. and 5 a.m.

Entertainment Indoor Closing Hours : If alcohol beverage establishment, same as alcohol license hours.  
If non-alcohol establishment 1:00 am Sunday to Thursday; 1:30 am Friday and Saturday.

Entertainment Outdoor Closing Hours : 10:00 pm Sunday – Thursday; 12:00 am Friday and Saturday,  
unless otherwise approved by Common Council in licensee's plan of operation.

## 11. Signature(s)

[Signature]  
Sole Proprietor, Partner, Agent, or 20% or more Shareholder

\_\_\_\_\_  
Signature of additional partner or 20% or more Shareholder

See Application Information for a list of all required application forms.



# FOOD DEALER LICENSE PLAN OF OPERATION

ccl-foodplan 2/22/16

OFFICE OF THE CITY CLERK, LICENSE DIVISION  
CITY HALL, 200 E. WELLS ST, ROOM 105, MILWAUKEE, WI 53202  
(414) 286-2238 • [license@milwaukee.gov](mailto:license@milwaukee.gov) • [www.milwaukee.gov/license](http://www.milwaukee.gov/license)

Legal Entity Name: Pacific Bells, LLC dba Taco Bell #31490

Premises Address: 2210 W. Wisconsin Ave Milwaukee, WI 53233

### SECTION 1

Type of application (check one):  taking over a currently operating business  starting a new business

Anticipated opening date? \_\_\_\_\_

Check the type that best describes your business (check only one):  
See Food Dealer License Information sheet for definitions.

Restaurant  Community Food Program  
 Retail Establishment  Bed & Breakfast  
 If retail, will it be a convenience store?  Yes  No  
 (less than 5,000 sq ft of retail space, primary business is the sale of basic food items, and in addition sells household products)  Base for Food Peddler  
 Base for Temporary/Seasonal Food Stand

In addition, will any wholesale business be done?  Yes  No

If yes, what percentage of the business will be wholesale?  Less than 25%  25% or More (Contact DATCP)\*

Will retail items be sold?  No  Yes If Yes, indicate percentage of food sales \_\_\_\_\_ %

Will restaurant items be sold?  No\*  Yes If Yes, indicate percentage of food sales 100 %

\* If you checked "25% or More" of the business will be wholesale and answered "No" to restaurant items being sold, do not continue completing this application. A City of Milwaukee License is not required. Contact DATCP only.

2016 APR 18 P 12:13  
CITY OF MILWAUKEE  
LICENSE DIVISION

### SECTION 2

Will you be sharing kitchen space with another operator?

No If No, SKIP to Section 3

Yes If Yes, check one:

I will rent space from another operator ("Shared Kitchen Agreement" is required)

I will rent space to another operator (peddler/caterer)

### SECTION 3

Answer the following questions:

Will you have seating on site for dining?  No  Yes

Will you be doing any catering?  No  Yes

Will you be doing any delivery?  No  Yes

Will you have outdoor activities?  No  Yes

If Yes to outdoor activities, check all that apply:  Bar  Cooking/Grilling  Dining

Will you have a drive thru window?  No  Yes

If Yes to drive thru, are hours different from inside?  No  Yes

If Yes, provide drive thru hours: \_\_\_\_\_

Will any scales or barcode scanners be used?  No  Yes

If Yes, a Weights & Measures application must be completed and a license obtained.

**SECTION 4**

Where will food be prepared and/or sold?

- At a single site
- At multiple sites (for example, a hotel with several dining rooms or bars) How many? \_\_\_\_\_  
If multiple sites, attach a Food Dealer Additional Site Addendum (ccl-foodadd) for each additional site.

**SECTION 5**

Are you planning any construction, remodeling or equipment changes?

- No If No, SKIP to Section 6
- Yes If Yes, check all that apply:
  - New construction of a building
  - Construction changes to an existing building
  - Renovation or remodeling
  - Equipment changes only (installation or replacement)

Provide a brief description of the changes: \_\_\_\_\_

Start date: \_\_\_\_\_

Name, Address & Phone Number of Architect: \_\_\_\_\_

Name, Address & Phone Number of Contractor: \_\_\_\_\_

**SECTION 6**

Are you applying for an alcohol beverage license?

- No If No, SKIP to Section 7
- Yes If YES, if your food license is approved prior to the alcohol beverage license, when do you want the food license issued?  Immediately  At the same time as the alcohol license

**SECTION 7**

You must initial each item confirming your understanding:

- TC I understand the Health Department must conduct an inspection and advise the License Division of their approval before the license may be issued.
- TC I understand I must obtain an occupancy permit from the Department of Neighborhood Services and an inspection may be required. Neighborhood Services must advise the License Division of their approval before the license may be issued.
- TC I understand the district alderperson will review and either approve or deny my application. If denied, I may appeal and be scheduled to appear before the Licenses Committee. The Licenses Committee will then make a recommendation to the Common Council. The Common Council must grant the license before it may be issued.
- TC I understand proof of payment for all license fees must be on file in the License Division before the license may be issued.
- TC I understand the license must be issued and posted in my establishment prior to opening for business.
- TC I will not operate my food business until the license has been issued and posted in the establishment.

Signature of sole proprietor, partner, agent or 20% shareholder: \_\_\_\_\_

Signature of additional partner(s): \_\_\_\_\_





CITY OF MILWAUKEE  
OFFICE OF THE CITY CLERK

Thursday, August 25, 2016

COMMITTEE MEETING NOTICE

AD 04

PACK, James P, Agent  
WTRWKS, LLC  
1111 N WATER St

MILWAUKEE, WI 53202

You are requested to attend a hearing which is to be held in Room 301-B, Third Floor, City Hall on:

**Tuesday, September 06, 2016 at 10:45 AM**

**Regarding:** Your Class B Tavern License Renewal Application as agent for "WTRWKS, LLC" for "ROSIE'S WATERWORKS" at 1111 N WATER St.

There is a possibility that your application may be denied for one or more of the following reasons: The recommendation of the committee regarding the application shall be based on evidence presented at the hearing. Per MCO 85-4-4, unless otherwise specified in the code, probative evidence concerning non-renewal, suspension or revocation may include evidence of the following: failure of the applicant to meet municipal qualifications, pending charges against or the conviction of any felony, misdemeanor, municipal offense or other offense, the circumstances of which substantially relate to the circumstances of the particular licensed or permitted activity, by the applicant or by any employee or other agent of the applicant. If the activities of the applicant involve a licensed premises, whether the premises tends to facilitate a public or private nuisance or has been the source of congregations of persons which have resulted in any of the following: disturbance of the peace; illegal drug activity; public drunkenness; drinking in public; harassment of passers-by; gambling; prostitution; sale of stolen goods; public urination; theft; assaults; battery; acts of vandalism including graffiti, excessive littering, loitering, illegal parking, loud noise at times when the licensed premise is open for business; traffic violations; curfew violations; lewd conduct; display of materials harmful to minors, pursuant to s. 106-9.6; or any other factor which reasonably relates to the public health, safety and welfare, or failure to comply with the approved plan of operation. See attached police report or correspondence.

**Notice for applicants with warrants or unpaid fines:**

Proof of warrant satisfaction or payment of fines must be submitted at the hearing on the above date and time. Failure to comply with this requirement may result in a delay of the granting/denial of your application.

Failure to appear at this meeting may result in the denial of your license. Individual applicants must appear only in person or by an attorney. Corporate or Limited Liability applicants must appear only by the agent designated on the application or by an attorney. Partnership applicants must appear by a partner listed on the application or by an attorney. If you wish to do so and at your own expense, you may be accompanied by an attorney of your choosing to represent you at this hearing.

You will be given an opportunity to speak on behalf of the application and to respond and challenge any charges or reasons given for the denial. No petitions can be accepted by the committee, unless the people who signed the petition are present at the committee hearing and willing to testify. You may present witnesses under oath and you may also confront and cross-examine opposing witnesses under oath. If you have difficulty with the English language, you should bring an interpreter with you, at your expense, so that you can answer questions and participate in your hearing.

You may examine the application file at this office during regular business hours prior to the hearing date. Inquiries regarding this matter may be directed to the person whose signature appears below.

Limited parking for persons attending meetings in City Hall is available at reduced rates (5 hour limit) at the Milwaukee Center on the southwest corner of East Kilbourn and North Water Street. Parking tickets must be validated in the first floor information booth in City Hall.

PLEASE NOTE: Upon reasonable notice, efforts will be made to accommodate the needs of disabled individuals through sign language interpreters or other auxiliary aids. For additional information or to request this service, contact the Council Services Division ADA Coordinator at (414) 286-2998, Fax - (414) 286-3456, TDD - (414) 286-2025.

JIM OWCZARSKI, CITY CLERK

BY:

Jason Schunk  
License Division Manager

If you have questions regarding this notice, please contact the License Division at (414) 286-2238.

200 E. Wells Street, Room 105, City Hall, Milwaukee, WI 53202. [www.milwaukee.gov/license](http://www.milwaukee.gov/license)  
Phone: (414) 286-2238 Fax: (414) 286-3057 Email Address: [License@milwaukee.gov](mailto:License@milwaukee.gov)



**MILWAUKEE POLICE DEPARTMENT  
LICENSE INVESTIGATION UNIT**

**CRIMINAL RECORD/ORDINANCE VIOLATION/INCIDENTS  
SYNOPSIS**

**DATE: 06/14/2016**

**LICENSE TYPE: BTAVN**

**No. 232539**

**NEW:**

**Application Date: 06/13/2016**

**RENEWAL: X**

**Expiration Date:**

**License Location: 1111 N Water St**

**Aldermanic District: 04**

**Business Name: Rosie's Waterworks**

**Licensee/Applicant: Pack, James P**

(Last Name, First Name, MI)

**Date of Birth: 08/12/68**

**Male: X**

**Female:**

**Home Address: 2115 W Greenwood Rd**

**City: Glendale**

**State: Wi**

**Zip Code: 53209**

**Home Phone(414) 271-0916**

This report is written by Police Officer Gilbert Gwinn, assigned to the License Investigation Unit, Days.

The Milwaukee Police Department's investigation regarding this application revealed the following:

1. Charge : Possession of a Switchblade Knife  
Finding : Guilty, Waukesha Co Circuit Court  
Sentence : Fined  
Date : 05/11/92  
Case : 91CM2770
2. On 05/22/96 City of Glendale Police Officers stopped a jeep in the 5400 block of N. Port Washington Rd for a traffic violation. The passenger of the vehicle was arrested for Obstructing an Officer. At that time the Officer performed a search of the vehicle, finding several prescription type containers. Inside one of the containers was found an amount of Marijuana, and in another container was some Valium. The driver of the vehicle (James P. Pack) admitted that the Marijuana was his for his personal use, and the Valium was his, and he did not have a prescription for them. He further stated that he used the Valium for his asthma.

Charge : Possession of Controlled Substance (Diazepam)  
Finding : Guilty,of amended charge of Disorderly Conduct  
Sentence : 90 Days House of Correction & 1 year probation  
Date : 08/29/96  
Case : 2-607659

3. On 08/17/85 at 11:20PM Fox Point Police Officers were sent to a suspicious auto with three Males at 251 W. Nokomis Court, Fox Point. Upon the Officers arrival the Officer recovered a baggie containing Marijuana which was on the front seat of the auto wrapped in a blue jean jacket belonging to Corporate Officer, Darrell I. Sanderson. Mr. Sanderson denied any knowledge of the ownership of the Marijuana.

Charge : Possession of Controlled Substance (Marijuana)  
Finding : Guilty – amended to Disorderly Conduct  
Sentence : Fined \$67.50  
Date : 02/18/86  
Case : C-64806 (Ordinance)

4. On 07/01/93 at 6655 N. Green Bay Av. City of Glendale Police Officers found Darrell I. Sanderson to be in possession of 2.8 grams of Marijuana which was recovered from his jacket pocket along with a pipe used for smoking Marijuana.

Charge : Possession of Controlled Substance (Marijuana)  
Finding : Guilty – amended to County Ordinance violation  
Sentence : Fined \$100.00 or 5 Days House of Correction  
Date : 07/22/93  
Case : 2-305613

5. On 06/19/98 Mr. Sanderson filed an Auxiliary Questionnaire in regards to this Class “B” Tavern application. He answered NO to question #2 which asks “Have you ever been convicted of any felony or misdemeanor (other than traffic) for violation of any federal laws, any Wisconsin laws, any laws of any other states or ordinances of any municipality?” Due to the two convictions listed above this is a false statement.

Charge : Truth of Statements & Affidavits – Falsifying  
Finding : Guilty  
Sentence : Fined \$100.00  
Date : 01/05/99  
Case : 98118069

6. INCIDENT: On Sunday, 03/21/99 at 4:12AM Officers were dispatched to 1111 N. Water St. (Rosie’s Waterworks) for a Battery Complaint. Upon their arrival Officers spoke to the caller Geoffrey W. Thomas who is an employee at this location. He stated that at about 3:00AM while standing behind the bar, that another employee (Todd M. Corcoran) called him a pussy, and told him he was going to take him outside and kick his ass. At this time Corcoran reached across the bar attempting to grab his shirt which resulted in him receiving minor scratches to his stomach area.

- 7. INCIDENT: On Sunday, 06/13/99 at 1:25AM Officers were flagged down for a trouble with subjects at W. Highland, and N. Water St. Investigation revealed that at about 1:10AM two subjects became involved in an argument over a woman inside Rosie's bar located at 1111 N. Water St. The owner James Pack immediately ejected both parties from the bar. Once outside a fight took place in which an employee (John Golatke) attempted to break up the fight. He was struck once to the nose causing a broken nose. Another victim Stephen Panlener was struck several times causing a one-inch laceration, which required stitches. Another person Leisa Phillips attempted to break up the fight but was struck by Frank Cieslik to the back with a bottle, which caused bruising, and pain. Leisa refused to go to the Hospital for treatment. Two patrons (Joseph Levan, and Frank Cieslik were charged with Substantial Battery (FELONY)
  
- 8. INCIDENT: On 04/01/2001 at 1:02 AM officers responded to the licensed premises at 1111 N Water St, Rosie's Waterworks, regarding Trouble with Subjects. Investigation revealed that two actors stole wallets from three patrons of the tavern. One of the actors threw a beer at a tavern employee. That patron was taken into custody.
  
- 9. INCIDENT – On 1-1-04, at 5:00AM, an officer on patrol, was flagged down in front of Rosie's Tavern, 1111 N Water Street, by a group of citizens. The officer observed a man lying on the ground in front of the tavern stairs, with an injury to the head. The officer called for medical assistance. The investigation revealed that the victim was a patron inside the tavern, and was observed by the doorman harassing female patrons. He was asked to leave, and took a swing at the doorman, and pushed him. The doorman, Brian J Steffen, DOB: 3-5-75, escorted the patron through the door, and he fell down the stairs. He was treated at the scene, and it appeared he did not require further attention. After being treated by M.F.D. personnel, he was issued a Disorderly Citation, and he was released. Report filed.

- 
- 10. On 01/01/2005 at 2:00 AM, officers were flagged down by the applicant who informed them that there was a patron in the tavern with a gun. The suspect was located in the bar and found to be in possession of a knife. He was cited for Disorderly Conduct and taken into custody for several outstanding warrants. The applicant and employees of the tavern were very cooperative with officers. Incident Report Filed.
  
  - 11. On 03/27/2005 at 1:40 AM the applicant was cited for Noise Nuisances at 1111 N Water St. No further information.

Charge : Noise Nuisances  
Finding : **Dismissed w/o prejudice**  
Date : 11/13/06  
Case : 05043842

12. On 05-29-05 at 12:35am, applicant was issued a citation for Doors Kept Closed After Designated Hours at 1111 N Water St.

Charge: Doors Kept Closed After Designated Hours  
Finding: Dismissed  
Date: 10/23/06  
Case: 05066172

=====

Items 11 and 12 were previously reported, dispositions now added 06/11/07.

13. On 10/04/06 at 11:36 pm, Milwaukee police were flagged down by security at Rosies Water Works for a Trouble With Subject. Investigation revealed two patrons inside the tavern became disorderly with security asking them to leave. These patrons refused and security began to physically remove them when they became physical with security. One security guard was punched and began striking the patron back. Officers issued several citations for Assault and Battery to the two patrons and one security guard. One patron also received a citation for Disorderly Conduct.

=====

14. On 09/02/07 at 12:44 am, Milwaukee police were dispatched to 1111 N Water Street for a Battery complaint. Investigation revealed a patron struck another while inside Rosies. The subject was arrested and issued a citation for Assault and Battery.

=====

15. On 07/09/08 at 6:58 pm, Milwaukee police were working the Wisconsin Wins Tobacco Initiative and had an underage female enter 1111 N Water Street in attempts to purchase tobacco products. The underage female asked the bartender Courtney Hanson for change so she could buy cigarettes and Hanson provided the change without asking for any ID. Hanson was issued a citation for Sale of Tobacco To Minor.

Charge: Sale of Tobacco To Minor  
Finding: Dismissed w/o prejudice  
Date: 03/09/09  
Case: 08084943

=====

16. 03/04/10 at 2:26 am, Milwaukee police observed a patron acting disorderly at Rosies on N Water Street. The patron was kicking and hitting the taverns door and struggling with the taverns employees'. Officers identified themselves and the patron continued to be disorderly and resist officers. The subject was arrested and was charged with several violations. Officers spoke with James Pack regarding the incident and found no violations.

17. On 04/05/10 at 7:42 pm, Milwaukee police were dispatched to 1100 N Water for a Battery complaint. Police spoke to the victim and observed the victim to have a one-inch laceration above his right eye. The victim stated he was in the bathroom of Rosies washing his hands when he observed a subject urinating on someone's feet in the stall next to him. The victim stated he advised the guy that he was urinating on someone and that the guy gave him a dirty look. The victim stated he turned to leave the bathroom when the subject punched him once above his right eye with the subject leaving the bathroom. The victim needed 10 stitches to close the cut. No charges were issued due to the victim not wanting to prosecute.

=====

18. On 10/10/10, Milwaukee police received a phone call complaint regarding a Theft that occurred at Rosie's Water Works. The complainant stated she and a friend were patrons at Rosie's and that their purses were stolen off a pool table. An officer spoke to James Pack who related he was aware of the incident but had not witnessed it. Video was in poor quality to depict anyone removing and carry the purses away. A report was filed.

=====

19. On 03/15/2014 Milwaukee police were flagged down regarding a Battery complaint at 1111 North Water Street (Rosie's on Water). Investigation revealed a patron of the business was struck in the head with a bottle resulting in an injury which required staples to close. Milwaukee police incident report # 140740091 filed.

=====

20. On 05/03/2014 a 20 year old Milwaukee police aide, working in conjunction with Milwaukee police, attempted to gain entry to Rosie's Waterworks (1111 North Water Street) but was turned away when she could not produce proof she had attained the legal drinking age of 21.

21. On 08/31/2014 the applicant was cited at 1111 North Water Street in the city of Milwaukee for Food Peddlers-Sale on Public Way.

Charge: Food Peddlers-Sale on Public Way  
Finding: Dismissed without prejudice  
Sentence:  
Date: 07/20/2015  
Case: 14065213

22. On 09/05/2014 the applicant was cited at 1111 North Water Street in the city of Milwaukee for Food Peddlers-Sale on Public Way.

Charge: Food Peddlers-Sale on Public Way  
Finding: Dismissed without prejudice  
Sentence:  
Date: 07/20/2015  
Case: 14065214

23. On 09/21/2014 a Milwaukee police officer observed a subject exiting Rosie's Waterworks (1111 North Water Street) holding his jacket as if concealing something. This subject later removed a bottle of Miller beer and began to drink it. When asked, this subject stated he had bought the beer from Rosie's. Security officers told police "It ain't our problem".
24. On 10/05/2014 Milwaukee police responded to a battery complaint at 1412 North Van Buren Street. The victim, Ryan Goebel, told officers he had been inside Rosie's Waterworks (1123 North Water Street) when someone struck him in the head with a glass. Milwaukee police incident report #142780101 filed.
25. On 04/11/2015 Milwaukee police responded to a theft complaint at 1111 North Water Street. The suspect in this offense was apprehended in part because of assistance offered in the form of video provided by the applicant.

=====  
Item #21 and #22 previously reported, disposition added 06/14/2016.

26. On 02/19/2015 a Milwaukee police officer conducted a tavern check at Rosie's Waterworks (1111 North Water Street) and dropped off a packet of tavern related ordinances.
27. On 02/26/2015 a 19 year old Milwaukee police aide, working in conjunction with Milwaukee police, attempted to gain entry to Rosie's (1111 North Water Street) but was turned away when she could not produce proof she had attained the legal drinking age of 21.
28. On 05/29/2015 Milwaukee police responded to a subject down complaint at 1111 North Water Street. Officers discovered a subject, Andre Wilks, receiving medical care. Wilks told officers he had been a customer at Rosie's and struck his head on the sidewalk when he fell while standing near the main entrance. Milwaukee police incident report #151490178 filed.
29. On 07/31/2015 Milwaukee police observed the licensee of Rosie's Waterworks (1111 North Water Street) operating a mobile food cart from his private property and advised him that while this was a violation of Municipal Ordinance, no police action would be taken pending the outcome of his open case for the same violation in Municipal Court. (See item #21).
30. On 08/07/2015 a 20 year old Milwaukee police aide, working in conjunction with Milwaukee police, attempted to gain entry to Rosie's Waterworks (1111 North Water Street) but was turned away when she could not produce proof she had attained the legal drinking age of 21.
31. On 08/16/2015 Milwaukee police observed the licensee of Rosie's Waterworks (1111 North Water Street) operating a mobile food cart from his private property and advised him that while this was a violation of Municipal Ordinance, no police action would be taken pending the outcome of his open case for the same violation in Municipal Court. (See item #22).

32. On 02/18/2016 Milwaukee police, along with and agent from the Wisconsin Department of Revenue, conducted an inspection at Rosie's Waterworks (1111 North Water Street). The following discrepancies were discovered, 13 bottles of contaminated liquor, no invoices for inspection, three illegal video gaming machines, and proof of liquor bottle refilling. Additionally, it was discovered the bartender, Matthew Blume, did not possess a valid Class D operator's license. The applicant was cited.

|           |   |
|-----------|---|
| Charge:   | Responsible Person on Premises Required |
| Finding:  | Guilty                                  |
| Sentence: | \$175.00 fine                           |
| Date:     | 05/26/2016                              |
| Case:     | 16013791                                |

MILWAUKEE POLICE DEPARTMENT
REPORT OF INCIDENTS INVOLVING LICENSED PERSONS OR PREMISES

TO: Captain of Police Leslie THIELE

Business Name: Rosie's Waterworks
Address of Licensed Premises: 1111 N Water ST
Business Phone:

District: 1

Type of License: Blavern

Violation / Incident #

Date of Incident: 2/19/15

Licensee or Manager on premises at time of violation / Incident? Yes No

Licensee cooperative? Yes No (if no, explain in narrative section)

Licensee Notified by Officer: Matthew Anderson

Date: 2/19/15 Time: 929pm

Licensee or Agent's Name: James P PACK
Home Address: 2115 W Greenwood La Glendale WI

Date of Birth: 08-12-68
Home Phone: 414-403-7050

Co-Licensee Name:
Home Address:
Class S License Number:

Date of Birth:
Home Phone:

Bartender Name:
Home Address:
Class D License Number:

Date of Birth:
Home Phone:

Licensed Person / Public Pass. Vehicle, etc.:
Home Address:
Class D License Number:

Date of Birth:
Home Phone:

VIOLATION/INCIDENT - DESCRIBE FACTS AND CIRCUMSTANCES IN NARRATIVE SECTION

Name of Person Cited:
Citation Number: Violation & Ord. / Statute No.: Date of Birth: Court Date:
Name of Person Cited:
Citation Number: Violation & Ord. / Statute No.: Date of Birth: Court Date:
Name of Person Cited:
Citation Number: Violation & Ord. / Statute No.: Date of Birth: Court Date:
Name of Person Cited:
Citation Number: Violation & Ord. / Statute No.: Date of Birth: Court Date:
Name of Person Cited:
Citation Number: Violation & Ord. / Statute No.: Date of Birth: Court Date:

Investigating Officer: Donald Krenzien District / Bureau: 14 Date: 3/11/15

Handwritten signature of Donald Krenzien

Commanding Officer

Date: 3-11-15

DISPOSITION - FOR LICENSING ONLY

Table with 5 columns: Citation No., Case Number, Disposition, Judge, Date. Includes a stamp for LICENSING INVESTIGATION UNIT.

By: [Handwritten signature]



PA-33E Narrative

This report was written by Police Officer Donald Krenzien, assigned to District One late power shift.

On Thursday, February 19, 2015 at approximately 9:29pm, PO Matthew Anderson conducted a tavern check at Rosie's Waterworks, which was located at 1111 N Water St. PO Anderson handed Jake Baldwin a packet of several tavern related ordinances that taverns are often found to be in violation of. PO Anderson discussed the tavern's procedures to prevent these ordinances from being violated. PO Anderson then offered Baldwin time to ask questions related to these ordinances or any other issues.

# MILWAUKEE POLICE DEPARTMENT

REPORT OF INCIDENTS INVOLVING LICENSED PERSONS OR PREMISES

15-009

TO: Captain of Police Leslie THIELE

Business Name: Rosie's Waterworks  
Address of Licensed Premises: 1111 N Water ST  
Business Phone: 414-274-721

Type of License: Blavern

District: 1

Violation /  Incident #

Date of Incident: 3/26/15

Licensee or Manager on premises at time of violation / incident?  Yes  No

Licensee cooperative?  Yes  No (if no, explain in narrative section)

Licensee Notified by Officer: Donald Krenzien

Date: 3/8/15 Time: 9:28pm

Licensee or Agent's Name: James P PACK  
Home Address: 2115 W Greenwood La Glendale WI

Date of Birth: 08-12-68  
Home Phone: 414-403-7050

Co-Licensee Name:  
Home Address:  
Class S License Number:

Date of Birth:  
Home Phone:

Bartender Name:  
Home Address:  
Class D License Number:

Date of Birth:  
Home Phone:

Licensed Person / Public Pass. Vehicle, etc.:  
Home Address:  
Class D License Number:

Date of Birth:  
Home Phone:

### VIOLATION/INCIDENT - DESCRIBE FACTS AND CIRCUMSTANCES IN NARRATIVE SECTION

|                       |                                |                |
|-----------------------|--------------------------------|----------------|
| Name of Person Cited: |                                | Date of Birth: |
| Citation Number:      | Violation & Ord. / Statue No.: | Court Date:    |
| Name of Person Cited: |                                | Date of Birth: |
| Citation Number:      | Violation & Ord. / Statue No.: | Court Date:    |
| Name of Person Cited: |                                | Date of Birth: |
| Citation Number:      | Violation & Ord. / Statue No.: | Court Date:    |
| Name of Person Cited: |                                | Date of Birth: |
| Citation Number:      | Violation & Ord. / Statue No.: | Court Date:    |
| Name of Person Cited: |                                | Date of Birth: |
| Citation Number:      | Violation & Ord. / Statue No.: | Court Date:    |

Investigating Officer: Donald Krenzien

District / Bureau: 1

Date: 2/26/15

*[Signature]*  
Commanding Officer

*[Signature]*  
Date

### DISPOSITION - FOR LICENSING ONLY

| Citation No. | Case Number | Disposition | Judge | Date |
|--------------|-------------|-------------|-------|------|
|              |             |             |       |      |
|              |             |             |       |      |
|              |             |             |       |      |
|              |             |             |       |      |
|              |             |             |       |      |
|              |             |             |       |      |

LICENSE INVESTIGATION UNIT  
Received *[Signature]*  
Referred

By *[Signature]*

This report is written by Police Officer Donald Krenzien, assigned District One, Late Power Shift.

On the evening of Thursday, February 26, 2015 through the morning of Friday, February 27, 2015 District One personnel performed an underage tavern enforcement initiative. The officer's who participated in the operation were Police Officer Christopher Martin, assigned to District One, Police Officer Dorian Andress assigned to District 3, and myself. For the underage persons in this initiative we used one MPD police aide who works in the Police Administration Building. Police Aid Teresa Westfahl assigned to the Police Academy. Westfahl was confirmed to be underage by her Wisconsin identification card (2/17/1996)

Prior to attempting any checks of licensed class B tavern establishments the police aide and plain clothed police officer were given instructions. Westfahl and Andress were told that they were not allowed to consume any intoxicating beverages. They could not lie if asked if they were underage, or show any form of documentation, which could be construed as identification. It was explained that they had to order an alcoholic beverage, directly from a bartender behind a bar, then meet the plainclothes officer observing them with the alcoholic beverage for a photo in the tavern and then leave together. It was explained that at all times the plainclothes officer shadowing them would be in visual sight and observe the financial transaction for alcoholic beverages.

After this briefing Martin and I escorted P.O. Andress who was in plainclothes and P.A. Westfahl to multiple taverns located throughout the District One boundaries.

Westfahl and Andress attempted to gained entry to the class "B" licensed tavern, Rosie's located at 1111 N Water St. Westfahl and Andress was challenged at the point of entry and turned away when Westfahl couldn't prove she was of age.

I notified Jackie Peterson that they passed.

**MILWAUKEE POLICE DEPARTMENT**  
**REPORT OF INCIDENTS INVOLVING LICENSED PERSONS OR PREMISES**

15-168

TO: Captain of Police Leslie THIELE

Business Name: Rosie's Waterworks  
 Address of Licensed Premises: 1111 N Water ST  
 Business Phone: 414-274-721

Type of License: Blavern

District: 1

Violation /  Incident # 151490178      Date of Incident: 05-29-15

Licensee or Manager on premises at time of violation / incident?  Yes  No

Licensee cooperative?  Yes  No (if no, explain in narrative section)

Licensee Notified by Officer: P.O. Ryan DUMMANN

Date: 05-29-15

Time: 01:15AM

Licensee or Agent's Name: James P PACK  
 Home Address: 2115 W Greenwood La Glendale WI

Date of Birth: 08-12-68  
 Home Phone: 414-403-7050

Co-Licensee Name:  
 Home Address:  
 Class S License Number:

Date of Birth:  
 Home Phone:

Bartender Name:  
 Home Address:  
 Class D License Number:

Date of Birth:  
 Home Phone:

Licensed Person / Public Pass. Vehicle, etc.:  
 Home Address:  
 Class D License Number:

Date of Birth:  
 Home Phone:

**VIOLATION/INCIDENT - DESCRIBE FACTS AND CIRCUMSTANCES IN NARRATIVE SECTION**

|   |                                |                               |
|---|--------------------------------|-------------------------------|
| Name of Person Cited:<br>Citation Number: | Violation & Ord. / Statue No.: | Date of Birth:<br>Court Date: |
| Name of Person Cited:<br>Citation Number: | Violation & Ord. / Statue No.: | Date of Birth:<br>Court Date: |
| Name of Person Cited:<br>Citation Number: | Violation & Ord. / Statue No.: | Date of Birth:<br>Court Date: |
| Name of Person Cited:<br>Citation Number: | Violation & Ord. / Statue No.: | Date of Birth:<br>Court Date: |
| Name of Person Cited:<br>Citation Number: | Violation & Ord. / Statue No.: | Date of Birth:<br>Court Date: |

Investigating Officer: P.O. Josh POST      District / Bureau: 14      Date: 06-11-15  
*Capt. Leslie Thiele*      08-28-15  
 Commanding Officer      Date

**DISPOSITION - FOR LICENSING ONLY**

| Citation No. | Case Number | Disposition | Judge                      | Date |
|--------------|-------------|-------------|----------------------------|------|
|              |             |             |                            |      |
|              |             |             |                            |      |
|              |             |             |                            |      |
|              |             |             |                            |      |
|              |             |             |                            |      |
|              |             |             |                            |      |
|              |             |             | LICENSE INVESTIGATION UNIT |      |
|              |             |             | Received <u>05-15</u>      |      |
|              |             |             | Referred                   |      |
|              |             |             | By <u><i>SPU</i></u>       |      |

This report is submitted by P.O. Josh POST, who is assigned to District One, Late-Power Shift. On Friday, May 29<sup>th</sup>, 2015, at approximately 1:20AM, Squad 1341 (P.O. Ryan DUMMANN) was dispatched to 1111 North Water Street regarding a Subject Down complaint.

Upon arrival P.O. DUMMANN observed Andre J. WILKS, B/M, 5-28-1985, receiving medical care for his injuries. WILKS appeared to be highly intoxicated at the time.

Upon speaking with WILKS, he relayed the following information to P.O. DUMMANN regarding the incident. WILKS stated that he had been out at Rosie's Bar during the evening in order to celebrate his birthday. While WILKS was standing outside the main entrance to the bar, he fell backwards off of the steps to the bar and hit his head on the ground. WILKS was extremely argumentative and uncooperative and refused to answer any other questions regarding the incident. WILKS was then conveyed to Mt. Siani Hospital for his injuries by Bell 411. WILKS was admitted to Mt. Sinai at 1:51am and was treated by Dr. Josh Pierre.

While on scene, P.O. DUMMANN spoke with the bouncer for Rosie's Bar, Brian J. TICAR, W/M, 9-11-81, who relayed the following information regarding the incident. TICAR stated that he was working the front door for Rosie's that evening and WILKS had come in earlier in the evening. TICAR stated that WILKS had been drinking heavily, but had not been causing a disturbance inside or outside the bar. WILKS then went outside the bar and was standing on the front steps to the bar when he fell backwards and hit his head on the sidewalk. WILKS immediately started to bleed from the back of his head and Rosie's staff called for medical attention.

MILWAUKEE POLICE DEPARTMENT  
REPORT OF INCIDENTS INVOLVING LICENSED PERSONS OR PREMISES

15-196

TO: Captain of Police Leslie THIELE

Business Name: Rosie's Waterworks  
Address of Licensed Premises: 1111 N Water ST  
Business Phone: 414-274-721

Type of License: Blavern

District: 1

Violation /  Incident # sale from priva

Date of Incident: 07/31/15

Licensee or Manager on premises at time of violation / Incident?  Yes  No

Licensee cooperative?  Yes  No (If no, explain in narrative section)

Licensee Notified by Officer: P.O. Robert FERRELL

Date: 7/31/15 Time: 22:00

Licensee or Agent's Name: James P PACK  
Home Address: 2115 W Greenwood La Glendale WI

Date of Birth: 08-12-68  
Home Phone: 414-403-7050

Co-Licensee Name:  
Home Address:  
Class S License Number:

Date of Birth:  
Home Phone:

Bartender Name:  
Home Address:  
Class D License Number:

Date of Birth:  
Home Phone:

Licensed Person / Public Pass. Vehicle, etc.:  
Home Address:  
Class D License Number:

Date of Birth:  
Home Phone:

VIOLATION/INCIDENT - DESCRIBE FACTS AND CIRCUMSTANCES IN NARRATIVE SECTION

Name of Person Cited:

Citation Number:

Violation & Ord. / Statue No.:

Date of Birth:

Court Date:

Name of Person Cited:

Citation Number:

Violation & Ord. / Statue No.:

Date of Birth:

Court Date:

Name of Person Cited:

Citation Number:

Violation & Ord. / Statue No.:

Date of Birth:

Court Date:

Name of Person Cited:

Citation Number:

Violation & Ord. / Statue No.:

Date of Birth:

Court Date:

Name of Person Cited:

Citation Number:

Violation & Ord. / Statue No.:

Date of Birth:

Court Date:

Investigating Officer: P.O. Robert Ferrell

District / Bureau: 14

Date: 07-31-15

Act. Cpt. J. Pucial  
Commanding Officer

08-10-15  
Date

DISPOSITION - FOR LICENSING ONLY

| Citation No. | Case Number | Disposition | Judge | Date |
|--------------|-------------|-------------|-------|------|
|              |             |             |       |      |
|              |             |             |       |      |
|              |             |             |       |      |
|              |             |             |       |      |
|              |             |             |       |      |
|              |             |             |       |      |
|              |             |             |       |      |

LICENSE INVESTIGATION UNIT

Received 8-18-15

Referred

By [Signature]

This report is written by P.O. Robert FERRELL, District One, Power Shift. On Friday 07/31/2015, at 22:00 I observed the Licensee of Rosie's Water Works (1111 N Water St) operating a mobile food cart from his private property.

I advised him that this was technically still against City Ordinance but no police action would be taken pending the outcome of his open case for same violation in Municipal Court. Sq 1411 (Sgt Thomas ACKLEY) was advised of the violation prior to my leaving the property.

MILWAUKEE POLICE DEPARTMENT  
REPORT OF INCIDENTS INVOLVING LICENSED PERSONS OR PREMISES

15-255

TO: Captain of Police Leslie THIELE

Business Name: Rosie's Waterworks  
Address of Licensed Premises: 1111 N Water ST  
Business Phone:

Type of License: Blavern

District: 1

Violation /  Incident # Underage Sting

Date of Incident: 8/7/15

Licensee or Manager on premises at time of violation / incident?  Yes  No

Licensee cooperative?  Yes  No (If no, explain in narrative section)

Licensee Notified by Officer: P.O. Mariolys Flores

Date: 8/19/15 Time: 12:37am

Licensee or Agent's Name: James P PACK  
Home Address: 2115 W Greenwood La Glendale WI

Date of Birth: 08-12-68  
Home Phone: 414-403-7050

Co-Licensee Name:  
Home Address:  
Class S License Number:

Date of Birth:  
Home Phone:

Bartender Name:  
Home Address:  
Class D License Number:

Date of Birth:  
Home Phone:

Licensed Person / Public Pass, Vehicle, etc.:  
Home Address:  
Class D License Number:

Date of Birth:  
Home Phone:

VIOLATION/INCIDENT - DESCRIBE FACTS AND CIRCUMSTANCES IN NARRATIVE SECTION

|   |                                |                               |
|---|--------------------------------|-------------------------------|
| Name of Person Cited:<br>Citation Number: | Violation & Ord. / Statue No.: | Date of Birth:<br>Court Date: |
| Name of Person Cited:<br>Citation Number: | Violation & Ord. / Statue No.: | Date of Birth:<br>Court Date: |
| Name of Person Cited:<br>Citation Number: | Violation & Ord. / Statue No.: | Date of Birth:<br>Court Date: |
| Name of Person Cited:<br>Citation Number: | Violation & Ord. / Statue No.: | Date of Birth:<br>Court Date: |
| Name of Person Cited:<br>Citation Number: | Violation & Ord. / Statue No.: | Date of Birth:<br>Court Date: |

Investigating Officer: P.O. Zachary JOHNSON

District / Bureau: 14

Date: 8/20/15

*[Signature]*  
Capt Leslie Thiele  
Commanding Officer

*[Signature]*  
Date

DISPOSITION - FOR LICENSING ONLY

| Citation No. | Case Number | Disposition | Judge | Date |
|--------------|-------------|-------------|-------|------|
|              |             |             |       |      |
|              |             |             |       |      |
|              |             |             |       |      |
|              |             |             |       |      |
|              |             |             |       |      |
|              |             |             |       |      |

LICENSE INVESTIGATION UNIT

Received 9-11-15

Referred

By *[Signature]*



This report is written by Police Officer Mariolys Flores, assigned to District One, Late Power Shift.

On the evening of Friday, August 7, 2015 through the morning of Saturday, August 8, 2015 District One personnel performed an underage tavern enforcement initiative. There were three teams that were part of this initiative. Each team had an MPD Police Aide, a Police Officer, both of which were acting in a plainclothes capacity with a uniformed Police Officer or Sergeant monitoring from a short distance. The Police Aide for each team was under the age of 21. This was verified by their respective Wisconsin driver's license. Police Aide Laura Nirode (PS 024687, DOB 06/15/95), Police Aide Elizabeth Sauer (PS 024693, DOB 08/11/1994), PA Chelsey McDowell (PS 024685, DOB 08/16/94), PO Karlee Kennon (PS 021519), PO Dorian Andress (PS 019758) and PO Kira Williams (PS 019786) were in plainclothes while PO Mariolys Flores (PS 024325), PO Zachary Johnson (PS 022614) and Sergeant Thomas Ackley (PS 018520) were in full uniform.

Prior to attempting any checks of licensed establishments the Police Aides and Police Officers were given instructions. All plainclothes members of this initiative were advised they are not allowed to consume any intoxicating beverages. If asked about their age, the members were told to tell the truth. The Police Officers were directed to produce ID's, but the underage Police Aides were directed to not produce any form of identification. It was explained that the Police Aide was to order an alcoholic beverage. It was explained that at all times the plainclothes Police Officer should be in visual sight and observe the financial transaction for alcoholic beverages. All plainclothes members of this initiative submitted a sample of their breath to a PBT test before and after the initiative. All members registered 0.0% BAC.

After the briefing, the teams conducted underage checks at multiple taverns and convenient stores located throughout the District One boundaries.

Police Officer Karlee Kennon, Police Aide Chelsey McDowell attempted to gain entry to the class "B" licensed tavern, Rosie's Waterworks located at 1111 N. Water St. Police Aide McDowell was challenged at the point of entry and turned away when she couldn't provide identification.

On Wednesday, August 19, 2015 at 12:37 a.m., I, Police Officer Mariolys Flores informed Brian Ticar, shift manager that they passed. While at the tavern, I asked Ticar if they had an ID scanner, at which time Ticar replied that they did not.

MILWAUKEE POLICE DEPARTMENT
REPORT OF INCIDENTS INVOLVING LICENSED PERSONS OR PREMISES

TO: Captain of Police Leslie THIELE

Business Name: Rosie's Waterworks
Address of Licensed Premises: 1111 N Water ST
Business Phone: 414-274-721

Type of License: Blavern

District: 1

[X] Violation / [ ] Incident # sale from priva Date of Incident: 08/16/15

Licensee or Manager on premises at time of violation / incident? [X] Yes [ ] No

Licensee cooperative? [X] Yes [ ] No (If no, explain in narrative section)

Licensee Notified by Officer: P.O. Robert FERRELL

Date: 8/16/15 Time: 00:35

Licensee or Agent's Name: James P PACK
Home Address: 2115 W Greenwood La Glendale WI

Date of Birth: 08-12-68
Home Phone: 414-403-7050

Co-Licensee Name:
Home Address:
Class S License Number:

Date of Birth:
Home Phone:

Bartender Name:
Home Address:
Class D License Number:

Date of Birth:
Home Phone:

Licensed Person / Public Pass. Vehicle, etc.:
Home Address:
Class D License Number:

Date of Birth:
Home Phone:

VIOLATION/INCIDENT - DESCRIBE FACTS AND CIRCUMSTANCES IN NARRATIVE SECTION

Name of Person Cited:
Citation Number: Violation & Ord. / Statue No.:
Date of Birth:
Court Date:
Name of Person Cited:
Citation Number: Violation & Ord. / Statue No.:
Date of Birth:
Court Date:
Name of Person Cited:
Citation Number: Violation & Ord. / Statue No.:
Date of Birth:
Court Date:
Name of Person Cited:
Citation Number: Violation & Ord. / Statue No.:
Date of Birth:
Court Date:
Name of Person Cited:
Citation Number: Violation & Ord. / Statue No.:
Date of Birth:
Court Date:

Investigating Officer: P.O. Robert FERRELL

District / Bureau: 14

Date: 8/16/15

Commanding Officer: [Signature]

Date: 08-17-15

DISPOSITION - FOR LICENSING ONLY

Table with 5 columns: Citation No., Case Number, Disposition, Judge, Date. Includes 'LICENSE INVESTIGATION UNIT' and 'Received' stamp.

By: [Signature]

**PA-33E Narrative**

This report is written by P.O. Robert FERRELL, District One, Power Shift. On Friday 08/16/2015, at 00:28 I observed the Licensee of Rosie's Water Works (1111 N Water St) operating a mobile food cart from his private property.

I advised him that this was technically still against City Ordinance but no police action would be taken pending the outcome of his open case for same violation in Municipal Court. Sq 1411 (Sgt Thomas ACKLEY) was advised of the violation prior to my leaving the property.

MILWAUKEE POLICE DEPARTMENT  
REPORT OF INCIDENTS INVOLVING LICENSED PERSONS OR PREMISES

16-051  
TA

TO: Captain of Police Eric MOORE

Business Name: Rosie's Waterworks  
Address of Licensed Premises: 1111 N Water ST  
Business Phone:

District: 1

Type of License: Blavern

Violation /  Incident # Date of Incident: 2/18/16

Licensee or Manager on premises at time of violation / Incident?  Yes  No

Licensee cooperative?  Yes  No (If no, explain in narrative section)

Licensee Notified by Officer:

Date: Time:

Licensee or Agent's Name: James P PACK  
Home Address: 2115 W Greenwood La Glendale WI

Date of Birth: 08-12-68  
Home Phone: 414-403-7050

Co-Licensee Name:  
Home Address:  
Class S License Number:

Date of Birth:  
Home Phone:

Bartender Name:  
Home Address:  
Class D License Number:

Date of Birth:  
Home Phone:

Licensed Person / Public Pass, Vehicle, etc.:  
Home Address:  
Class D License Number:

Date of Birth:  
Home Phone:

VIOLATION/INCIDENT - DESCRIBE FACTS AND CIRCUMSTANCES IN NARRATIVE SECTION

Name of Person Cited: Matthew S BLUME  
Citation Number: 6157592-0 Violation & Ord. / Statue No.: 90-4-10A

Date of Birth: 3/5/81  
Court Date: 4/5/16

Name of Person Cited: James P PACK  
Citation Number: J98117LCTKF Violation & Ord. / Statue No.: 90-8-1

Date of Birth: 8/12/68  
Court Date: 4/5/16

Name of Person Cited:  
Citation Number: Violation & Ord. / Statue No.:

Date of Birth:  
Court Date:

Name of Person Cited:  
Citation Number: Violation & Ord. / Statue No.:

Date of Birth:  
Court Date:

Name of Person Cited:  
Citation Number: Violation & Ord. / Statue No.:

Date of Birth:  
Court Date:

Investigating Officer: BOGUST *Richard A Bogust* District / Bureau: 1

Date: 2/19/16

*Sgt Tim Ackley*  
Commanding Officer

*3-10-16*  
Date

DISPOSITION - FOR LICENSING ONLY

| Citation No. | Case Number | Disposition | Judge | Date |
|--------------|-------------|-------------|-------|------|
|              |             |             |       |      |
|              |             |             |       |      |
|              |             |             |       |      |
|              |             |             |       |      |
|              |             |             |       |      |
|              |             |             |       |      |

LICENSE INVESTIGATION UNIT

Received *3-28-16*

Referred

By *[Signature]*

PA-33E Narrative

This report is submitted by P.O. BOGUST assigned to District One, Power Shift, squad 1460. On 02/18/16 at approximately 7:18 PM the Dept of Revenue and myself conducted an inspection on Rosies Bar located at 1111 N Water St. When I entered the bar it was open with about ten patrons inside drinking. I observed one bartender behind the bar actively attending as a Bar Tender. I identified the subject by Wisconsin Drivers License as Matthew S BLUME (w/m 03/05/81) when asked for his Bartender License BLUME informed me that he didn't have one.

BLUME was working in the establishment alone at this time with no supervision from any other employee or licensee. The bar was temporarily closed until the licensee arrived on scene, James P PACK (w/m 08/12/68).

The bar was given a full inspection by The Dept of Revenue with the following discrepancies, no licensed operator, 13 bottles of contaminated liquor (fruit flies in bottles), no invoices available for inspection as required by law for past two year of operation, three illegal video gaming machines (gambling) and proof of liquor refilling (large Patron bottles used to fill smaller bottles).

PACK was given a copy of the field report and explained all discrepancies noted on the form. I cited BLUME for no having a class D bartending license, and PACK for having his tavern open and operating for the sale of alcoholic beverages without a responsible licensed person on premises



Thursday, August 25, 2016



# Notice of Public Hearing

---

PACK, James P, Agent  
ROSIE'S WATERWORKS at 1111 N WATER St  
Class B Tavern License Renewal Application

**Tuesday, September 06, 2016 at 10:45 AM**

To whom it may concern:

The above application has been made by the above named applicant(s). This requires approval from the Licenses Committee and the Common Council of the City of Milwaukee. The hearing before the Licenses Committee will take place on 9/6/2016 at 10:45 AM, in Room 301-B, Third Floor, City Hall. If you wish, you may provide testimony at the hearing regarding the request; see below for further information. You are not required to attend the hearing. Once the Licenses Committee makes its recommendation, this recommendation is forwarded to the full Common Council for approval at its next regularly scheduled hearing. Please review the information below and if you have further questions regarding this process, please contact the License Division at (414) 286-2238.

---

## Important details for those wishing to provide information for the Licenses Committee to consider when making its recommendation:

1. The license application is scheduled to be heard at the above time. Due to other hearings running longer than scheduled, you may have to wait some time to provide your testimony.
2. You must appear in person and testify as to matters that you have personally experienced or seen. (You cannot provide testimony for your neighbor, parent or anyone else; this is considered hearsay and cannot be considered by the committee.)
3. No letters or petitions can be accepted by the committee (unless the person who wrote the letter or the persons who signed the petition are present at the committee hearing and willing to testify).
4. Persons opposed to the license application are given the opportunity to testify first; supporters may testify after the opponents have finished.
5. When you are called to testify, you will be sworn in and asked to give your name, and address. (If your first and/or last names are uncommon please spell them.)
6. You may then provide testimony.
  - a. Include only information relating to the above license application.
  - b. Include only information you have personally witnessed or seen.
  - c. Provide concise and relevant information detailing how this business has affected or may affect the peaceful enjoyment of your neighborhood.
  - d. If by the time you have the opportunity to testify, the information you wish to share has already been provided to the committee, you may state that you agree with the previous testimony. Redundant or repetitive testimony will not assist the committee in making its recommendation.
7. After giving your testimony, the members of the Licenses Committee and the licensee may ask questions regarding the testimony you have given or other factors relating to the license application.
8. Business Competition is not a valid basis for denial or non-renewal of a license.  
**Please Note: If you have submitted an objection to the above application your objection cannot be considered by the committee unless you personally testify at the hearing.**

| OCCUPANT         | MAIL ADDRESS          | CITY AND ZIP CODE        |
|------------------|-----------------------|--------------------------|
| CURRENT OCCUPANT | 233 E JUNEAU AVE 407  | MILWAUKEE, WI 53202-3275 |
| CURRENT OCCUPANT | 233 E JUNEAU AVE 501  | MILWAUKEE, WI 53202-3275 |
| CURRENT OCCUPANT | 233 E JUNEAU AVE 506  | MILWAUKEE, WI 53202-3275 |
| CURRENT OCCUPANT | 233 E JUNEAU AVE 515  | MILWAUKEE, WI 53202-3275 |
| CURRENT OCCUPANT | 233 E JUNEAU AVE 608  | MILWAUKEE, WI 53202-3275 |
| CURRENT OCCUPANT | 233 E JUNEAU AVE 618  | MILWAUKEE, WI 53202-3275 |
| CURRENT OCCUPANT | 233 E JUNEAU AVE 807  | MILWAUKEE, WI 53202-3296 |
| CURRENT OCCUPANT | 233 E JUNEAU AVE 814  | MILWAUKEE, WI 53202-3296 |
| CURRENT OCCUPANT | 233 E JUNEAU AVE 913  | MILWAUKEE, WI 53202-3296 |
| CURRENT OCCUPANT | 233 E JUNEAU AVE 915  | MILWAUKEE, WI 53202-3296 |
| CURRENT OCCUPANT | 233 E JUNEAU AVE 1018 | MILWAUKEE, WI 53202-3086 |
| CURRENT OCCUPANT | 233 E JUNEAU AVE 1019 | MILWAUKEE, WI 53202-3086 |
| CURRENT OCCUPANT | 233 E JUNEAU AVE 1107 | MILWAUKEE, WI 53202-3086 |
| CURRENT OCCUPANT | 233 E JUNEAU AVE 1108 | MILWAUKEE, WI 53202-3086 |
| CURRENT OCCUPANT | 233 E JUNEAU AVE 1405 | MILWAUKEE, WI 53202-3088 |
| CURRENT OCCUPANT | 233 E JUNEAU AVE 1408 | MILWAUKEE, WI 53202-3088 |
| CURRENT OCCUPANT | 233 E JUNEAU AVE 611  | MILWAUKEE, WI 53202-3296 |
| CURRENT OCCUPANT | 233 E JUNEAU AVE 909  | MILWAUKEE, WI 53202-3296 |
| CURRENT OCCUPANT | 1103 N WATER ST 308   | MILWAUKEE, WI 53202-6658 |
| CURRENT OCCUPANT | 1103 N WATER ST 307   | MILWAUKEE, WI 53202-6658 |
| CURRENT OCCUPANT | 1103 N WATER ST 403   | MILWAUKEE, WI 53202-6658 |
| CURRENT OCCUPANT | 233 E JUNEAU AVE 505  | MILWAUKEE, WI 53202-3275 |
| CURRENT OCCUPANT | 233 E JUNEAU AVE 519  | MILWAUKEE, WI 53202-3275 |
| CURRENT OCCUPANT | 233 E JUNEAU AVE 602  | MILWAUKEE, WI 53202-3275 |
| CURRENT OCCUPANT | 233 E JUNEAU AVE 604  | MILWAUKEE, WI 53202-3275 |
| CURRENT OCCUPANT | 233 E JUNEAU AVE 606  | MILWAUKEE, WI 53202-3275 |
| CURRENT OCCUPANT | 233 E JUNEAU AVE 614  | MILWAUKEE, WI 53202-3275 |
| CURRENT OCCUPANT | 233 E JUNEAU AVE 801  | MILWAUKEE, WI 53202-3275 |
| CURRENT OCCUPANT | 233 E JUNEAU AVE 808  | MILWAUKEE, WI 53202-3296 |
| CURRENT OCCUPANT | 233 E JUNEAU AVE 817  | MILWAUKEE, WI 53202-3296 |
| CURRENT OCCUPANT | 233 E JUNEAU AVE 818  | MILWAUKEE, WI 53202-3296 |
| CURRENT OCCUPANT | 233 E JUNEAU AVE 1001 | MILWAUKEE, WI 53202-3086 |
| CURRENT OCCUPANT | 233 E JUNEAU AVE 1004 | MILWAUKEE, WI 53202-3086 |
| CURRENT OCCUPANT | 233 E JUNEAU AVE 1010 | MILWAUKEE, WI 53202-3086 |
| CURRENT OCCUPANT | 233 E JUNEAU AVE 1014 | MILWAUKEE, WI 53202-3086 |
| CURRENT OCCUPANT | 233 E JUNEAU AVE 1307 | MILWAUKEE, WI 53202-3087 |
| CURRENT OCCUPANT | 233 E JUNEAU AVE 1402 | MILWAUKEE, WI 53202-3088 |
| CURRENT OCCUPANT | 233 E JUNEAU AVE 1406 | MILWAUKEE, WI 53202-3088 |
| CURRENT OCCUPANT | 233 E JUNEAU AVE 1409 | MILWAUKEE, WI 53202-3088 |
| CURRENT OCCUPANT | 233 E JUNEAU AVE 612  | MILWAUKEE, WI 53202-3296 |
| CURRENT OCCUPANT | 233 E JUNEAU AVE 811  | MILWAUKEE, WI 53202-3296 |
| CURRENT OCCUPANT | 1137 N EDISON ST      | MILWAUKEE, WI 53202-3147 |
| CURRENT OCCUPANT | 1123 N EDISON ST      | MILWAUKEE, WI 53202-3147 |
| CURRENT OCCUPANT | 1129 N EDISON ST      | MILWAUKEE, WI 53202-3147 |
| CURRENT OCCUPANT | 1103 N WATER ST 306   | MILWAUKEE, WI 53202-6657 |
| CURRENT OCCUPANT | 1103 N WATER ST 401   | MILWAUKEE, WI 53202-6658 |
| CURRENT OCCUPANT | 1103 N WATER ST 204   | MILWAUKEE, WI 53202-3123 |
| CURRENT OCCUPANT | 1103 N WATER ST 311   | MILWAUKEE, WI 53202-6658 |
| CURRENT OCCUPANT | 1103 N WATER ST 402   | MILWAUKEE, WI 53202-6658 |
| CURRENT OCCUPANT | 1111 N EDISON ST      | MILWAUKEE, WI 53202-3147 |
| CURRENT OCCUPANT | 1115 N EDISON ST      | MILWAUKEE, WI 53202-3147 |
| CURRENT OCCUPANT | 1125 N EDISON ST      | MILWAUKEE, WI 53202-3147 |
| CURRENT OCCUPANT | 233 E JUNEAU AVE 518  | MILWAUKEE, WI 53202-3275 |
| CURRENT OCCUPANT | 233 E JUNEAU AVE 516  | MILWAUKEE, WI 53202-3275 |
| CURRENT OCCUPANT | 233 E JUNEAU AVE 609  | MILWAUKEE, WI 53202-3275 |

|                  |                       |                          |
|------------------|-----------------------|--------------------------|
| CURRENT OCCUPANT | 233 E JUNEAU AVE 615  | MILWAUKEE, WI 53202-3275 |
| CURRENT OCCUPANT | 233 E JUNEAU AVE 702  | MILWAUKEE, WI 53202-3275 |
| CURRENT OCCUPANT | 233 E JUNEAU AVE 710  | MILWAUKEE, WI 53202-3275 |
| CURRENT OCCUPANT | 233 E JUNEAU AVE 713  | MILWAUKEE, WI 53202-3275 |
| CURRENT OCCUPANT | 233 E JUNEAU AVE 605  | MILWAUKEE, WI 53202-3275 |
| CURRENT OCCUPANT | 233 E JUNEAU AVE 715  | MILWAUKEE, WI 53202-3275 |
| CURRENT OCCUPANT | 233 E JUNEAU AVE 802  | MILWAUKEE, WI 53202-3275 |
| CURRENT OCCUPANT | 233 E JUNEAU AVE 805  | MILWAUKEE, WI 53202-3296 |
| CURRENT OCCUPANT | 233 E JUNEAU AVE 901  | MILWAUKEE, WI 53202-3296 |
| CURRENT OCCUPANT | 233 E JUNEAU AVE 906  | MILWAUKEE, WI 53202-3296 |
| CURRENT OCCUPANT | 233 E JUNEAU AVE 917  | MILWAUKEE, WI 53202-3296 |
| CURRENT OCCUPANT | 233 E JUNEAU AVE 1002 | MILWAUKEE, WI 53202-3086 |
| CURRENT OCCUPANT | 233 E JUNEAU AVE 1105 | MILWAUKEE, WI 53202-3086 |
| CURRENT OCCUPANT | 233 E JUNEAU AVE 1201 | MILWAUKEE, WI 53202-3087 |
| CURRENT OCCUPANT | 233 E JUNEAU AVE 1202 | MILWAUKEE, WI 53202-3087 |
| CURRENT OCCUPANT | 233 E JUNEAU AVE 1308 | MILWAUKEE, WI 53202-3087 |
| CURRENT OCCUPANT | 233 E JUNEAU AVE 1205 | MILWAUKEE, WI 53202-3088 |
| CURRENT OCCUPANT | 1139 N EDISON ST      | MILWAUKEE, WI 53202-3147 |
| CURRENT OCCUPANT | 1109 N EDISON ST      | MILWAUKEE, WI 53202-3147 |
| CURRENT OCCUPANT | 1105 N EDISON ST      | MILWAUKEE, WI 53202-3147 |
| CURRENT OCCUPANT | 1103 N WATER ST 203   | MILWAUKEE, WI 53202-3123 |
| CURRENT OCCUPANT | 1103 N WATER ST 210   | MILWAUKEE, WI 53202-3124 |
| CURRENT OCCUPANT | 1103 N WATER ST 208   | MILWAUKEE, WI 53202-3124 |
| CURRENT OCCUPANT | 1103 N WATER ST 309   | MILWAUKEE, WI 53202-6658 |
| CURRENT OCCUPANT | 1103 N WATER ST 406   | MILWAUKEE, WI 53202-6660 |
| CURRENT OCCUPANT | 1103 N WATER ST 302   | MILWAUKEE, WI 53202-6657 |
| CURRENT OCCUPANT | 1121 N EDISON ST      | MILWAUKEE, WI 53202-3147 |
| CURRENT OCCUPANT | 1141 N EDISON ST      | MILWAUKEE, WI 53202-3147 |
| CURRENT OCCUPANT | 233 E JUNEAU AVE 617  | MILWAUKEE, WI 53202-3275 |
| CURRENT OCCUPANT | 233 E JUNEAU AVE 703  | MILWAUKEE, WI 53202-3275 |
| CURRENT OCCUPANT | 233 E JUNEAU AVE 705  | MILWAUKEE, WI 53202-3275 |
| CURRENT OCCUPANT | 233 E JUNEAU AVE 707  | MILWAUKEE, WI 53202-3275 |
| CURRENT OCCUPANT | 233 E JUNEAU AVE 716  | MILWAUKEE, WI 53202-3275 |
| CURRENT OCCUPANT | 233 E JUNEAU AVE 816  | MILWAUKEE, WI 53202-3275 |
| CURRENT OCCUPANT | 233 E JUNEAU AVE 903  | MILWAUKEE, WI 53202-3296 |
| CURRENT OCCUPANT | 233 E JUNEAU AVE 908  | MILWAUKEE, WI 53202-3296 |
| CURRENT OCCUPANT | 233 E JUNEAU AVE 919  | MILWAUKEE, WI 53202-3296 |
| CURRENT OCCUPANT | 233 E JUNEAU AVE 1005 | MILWAUKEE, WI 53202-3086 |
| CURRENT OCCUPANT | 233 E JUNEAU AVE 1006 | MILWAUKEE, WI 53202-3086 |
| CURRENT OCCUPANT | 233 E JUNEAU AVE 1009 | MILWAUKEE, WI 53202-3086 |
| CURRENT OCCUPANT | 233 E JUNEAU AVE 1017 | MILWAUKEE, WI 53202-3086 |
| CURRENT OCCUPANT | 233 E JUNEAU AVE 1102 | MILWAUKEE, WI 53202-3086 |
| CURRENT OCCUPANT | 1103 N WATER ST 202   | MILWAUKEE, WI 53202-3123 |
| CURRENT OCCUPANT | 1127 N WATER ST       | MILWAUKEE, WI 53202-3107 |
| CURRENT OCCUPANT | 233 E JUNEAU AVE 509  | MILWAUKEE, WI 53202-3275 |
| CURRENT OCCUPANT | 233 E JUNEAU AVE 512  | MILWAUKEE, WI 53202-3275 |
| CURRENT OCCUPANT | 233 E JUNEAU AVE 409  | MILWAUKEE, WI 53202-3275 |
| CURRENT OCCUPANT | 233 E JUNEAU AVE 412  | MILWAUKEE, WI 53202-3275 |
| CURRENT OCCUPANT | 233 E JUNEAU AVE 504  | MILWAUKEE, WI 53202-3275 |
| CURRENT OCCUPANT | 233 E JUNEAU AVE 601  | MILWAUKEE, WI 53202-3275 |
| CURRENT OCCUPANT | 233 E JUNEAU AVE 701  | MILWAUKEE, WI 53202-3275 |
| CURRENT OCCUPANT | 233 E JUNEAU AVE 709  | MILWAUKEE, WI 53202-3275 |
| CURRENT OCCUPANT | 233 E JUNEAU AVE 711  | MILWAUKEE, WI 53202-3275 |
| CURRENT OCCUPANT | 233 E JUNEAU AVE 804  | MILWAUKEE, WI 53202-3296 |
| CURRENT OCCUPANT | 233 E JUNEAU AVE 815  | MILWAUKEE, WI 53202-3296 |
| CURRENT OCCUPANT | 233 E JUNEAU AVE 902  | MILWAUKEE, WI 53202-3296 |



|                  |                       |                          |
|------------------|-----------------------|--------------------------|
| CURRENT OCCUPANT | 233 E JUNEAU AVE 912  | MILWAUKEE, WI 53202-3296 |
| CURRENT OCCUPANT | 233 E JUNEAU AVE 1003 | MILWAUKEE, WI 53202-3086 |
| CURRENT OCCUPANT | 233 E JUNEAU AVE 1015 | MILWAUKEE, WI 53202-3086 |
| CURRENT OCCUPANT | 233 E JUNEAU AVE 1016 | MILWAUKEE, WI 53202-3086 |
| CURRENT OCCUPANT | 233 E JUNEAU AVE 1103 | MILWAUKEE, WI 53202-3086 |
| CURRENT OCCUPANT | 233 E JUNEAU AVE 1104 | MILWAUKEE, WI 53202-3086 |
| CURRENT OCCUPANT | 233 E JUNEAU AVE 1106 | MILWAUKEE, WI 53202-3086 |
| CURRENT OCCUPANT | 233 E JUNEAU AVE 1109 | MILWAUKEE, WI 53202-3086 |
| CURRENT OCCUPANT | 233 E JUNEAU AVE 1208 | MILWAUKEE, WI 53202-3087 |
| CURRENT OCCUPANT | 233 E JUNEAU AVE 1301 | MILWAUKEE, WI 53202-3087 |
| CURRENT OCCUPANT | 233 E JUNEAU AVE 1401 | MILWAUKEE, WI 53202-3088 |
| CURRENT OCCUPANT | 233 E JUNEAU AVE 1403 | MILWAUKEE, WI 53202-3088 |
| CURRENT OCCUPANT | 233 E JUNEAU AVE 1012 | MILWAUKEE, WI 53202-3088 |
| CURRENT OCCUPANT | 1135 N EDISON ST      | MILWAUKEE, WI 53202-3147 |
| CURRENT OCCUPANT | 1133 N EDISON ST      | MILWAUKEE, WI 53202-3147 |
| CURRENT OCCUPANT | 1107 N EDISON ST      | MILWAUKEE, WI 53202-3147 |
| CURRENT OCCUPANT | 1103 N WATER ST 410   | MILWAUKEE, WI 53202-6661 |
| CURRENT OCCUPANT | 1103 N WATER ST 411   | MILWAUKEE, WI 53202-6661 |
| CURRENT OCCUPANT | 1103 N WATER ST 408   | MILWAUKEE, WI 53202-6660 |
| CURRENT OCCUPANT | 1103 N WATER ST 301   | MILWAUKEE, WI 53202-6657 |
| CURRENT OCCUPANT | 1143 N EDISON ST      | MILWAUKEE, WI 53202-3147 |
| CURRENT OCCUPANT | 233 E JUNEAU AVE 410  | MILWAUKEE, WI 53202-3275 |
| CURRENT OCCUPANT | 233 E JUNEAU AVE 513  | MILWAUKEE, WI 53202-3275 |
| CURRENT OCCUPANT | 233 E JUNEAU AVE 404  | MILWAUKEE, WI 53202-3275 |
| CURRENT OCCUPANT | 233 E JUNEAU AVE 406  | MILWAUKEE, WI 53202-3275 |
| CURRENT OCCUPANT | 233 E JUNEAU AVE 607  | MILWAUKEE, WI 53202-3275 |
| CURRENT OCCUPANT | 233 E JUNEAU AVE 619  | MILWAUKEE, WI 53202-3275 |
| CURRENT OCCUPANT | 233 E JUNEAU AVE 712  | MILWAUKEE, WI 53202-3275 |
| CURRENT OCCUPANT | 233 E JUNEAU AVE 803  | MILWAUKEE, WI 53202-3275 |
| CURRENT OCCUPANT | 233 E JUNEAU AVE 819  | MILWAUKEE, WI 53202-3296 |
| CURRENT OCCUPANT | 233 E JUNEAU AVE 911  | MILWAUKEE, WI 53202-3296 |
| CURRENT OCCUPANT | 233 E JUNEAU AVE 1203 | MILWAUKEE, WI 53202-3087 |
| CURRENT OCCUPANT | 233 E JUNEAU AVE 1204 | MILWAUKEE, WI 53202-3087 |
| CURRENT OCCUPANT | 233 E JUNEAU AVE 1209 | MILWAUKEE, WI 53202-3087 |
| CURRENT OCCUPANT | 233 E JUNEAU AVE 1303 | MILWAUKEE, WI 53202-3087 |
| CURRENT OCCUPANT | 233 E JUNEAU AVE 1306 | MILWAUKEE, WI 53202-3087 |
| CURRENT OCCUPANT | 233 E JUNEAU AVE 1309 | MILWAUKEE, WI 53202-3087 |
| CURRENT OCCUPANT | 233 E JUNEAU AVE 812  | MILWAUKEE, WI 53202-3295 |
| CURRENT OCCUPANT | 1103 N WATER ST 206   | MILWAUKEE, WI 53202-3123 |
| CURRENT OCCUPANT | 1103 N WATER ST 209   | MILWAUKEE, WI 53202-3124 |
| CURRENT OCCUPANT | 1103 N WATER ST 412   | MILWAUKEE, WI 53202-6661 |
| CURRENT OCCUPANT | 1103 N WATER ST 305   | MILWAUKEE, WI 53202-6657 |
| CURRENT OCCUPANT | 1103 N WATER ST 310   | MILWAUKEE, WI 53202-6658 |
| CURRENT OCCUPANT | 1103 N WATER ST 404   | MILWAUKEE, WI 53202-6660 |
| CURRENT OCCUPANT | 1103 N WATER ST 312   | MILWAUKEE, WI 53202-6658 |
| CURRENT OCCUPANT | 1103 N WATER ST 407   | MILWAUKEE, WI 53202-6660 |
| CURRENT OCCUPANT | 1103 N WATER ST 303   | MILWAUKEE, WI 53202-6657 |
| CURRENT OCCUPANT | 1127 N EDISON ST      | MILWAUKEE, WI 53202-3147 |
| CURRENT OCCUPANT | 233 E JUNEAU AVE 507  | MILWAUKEE, WI 53202-3275 |
| CURRENT OCCUPANT | 233 E JUNEAU AVE 508  | MILWAUKEE, WI 53202-3275 |
| CURRENT OCCUPANT | 233 E JUNEAU AVE 510  | MILWAUKEE, WI 53202-3275 |
| CURRENT OCCUPANT | 233 E JUNEAU AVE 603  | MILWAUKEE, WI 53202-3275 |
| CURRENT OCCUPANT | 233 E JUNEAU AVE 502  | MILWAUKEE, WI 53202-3275 |
| CURRENT OCCUPANT | 233 E JUNEAU AVE 517  | MILWAUKEE, WI 53202-3275 |
| CURRENT OCCUPANT | 233 E JUNEAU AVE 405  | MILWAUKEE, WI 53202-3275 |
| CURRENT OCCUPANT | 233 E JUNEAU AVE 610  | MILWAUKEE, WI 53202-3275 |

|                  |                       |                          |
|------------------|-----------------------|--------------------------|
| CURRENT OCCUPANT | 233 E JUNEAU AVE 704  | MILWAUKEE, WI 53202-3275 |
| CURRENT OCCUPANT | 233 E JUNEAU AVE 708  | MILWAUKEE, WI 53202-3275 |
| CURRENT OCCUPANT | 233 E JUNEAU AVE 717  | MILWAUKEE, WI 53202-3275 |
| CURRENT OCCUPANT | 233 E JUNEAU AVE 718  | MILWAUKEE, WI 53202-3275 |
| CURRENT OCCUPANT | 233 E JUNEAU AVE 910  | MILWAUKEE, WI 53202-3296 |
| CURRENT OCCUPANT | 233 E JUNEAU AVE 914  | MILWAUKEE, WI 53202-3296 |
| CURRENT OCCUPANT | 233 E JUNEAU AVE 916  | MILWAUKEE, WI 53202-3296 |
| CURRENT OCCUPANT | 233 E JUNEAU AVE 1302 | MILWAUKEE, WI 53202-3087 |
| CURRENT OCCUPANT | 233 E JUNEAU AVE 1206 | MILWAUKEE, WI 53202-3272 |
| CURRENT OCCUPANT | 233 E JUNEAU AVE 1011 | MILWAUKEE, WI 53202-3088 |
| CURRENT OCCUPANT | 1103 N EDISON ST      | MILWAUKEE, WI 53202-3147 |
| CURRENT OCCUPANT | 1113 N EDISON ST      | MILWAUKEE, WI 53202-3147 |
| CURRENT OCCUPANT | 1103 N WATER ST 211   | MILWAUKEE, WI 53202-3124 |
| CURRENT OCCUPANT | 1103 N WATER ST 409   | MILWAUKEE, WI 53202-6661 |
| CURRENT OCCUPANT | 1131 N EDISON ST      | MILWAUKEE, WI 53202-3147 |
| CURRENT OCCUPANT | 1119 N EDISON ST      | MILWAUKEE, WI 53202-3147 |
| CURRENT OCCUPANT | 233 E JUNEAU AVE 511  | MILWAUKEE, WI 53202-3275 |
| CURRENT OCCUPANT | 233 E JUNEAU AVE 503  | MILWAUKEE, WI 53202-3275 |
| CURRENT OCCUPANT | 233 E JUNEAU AVE 514  | MILWAUKEE, WI 53202-3275 |
| CURRENT OCCUPANT | 233 E JUNEAU AVE 408  | MILWAUKEE, WI 53202-3275 |
| CURRENT OCCUPANT | 233 E JUNEAU AVE 411  | MILWAUKEE, WI 53202-3275 |
| CURRENT OCCUPANT | 233 E JUNEAU AVE 616  | MILWAUKEE, WI 53202-3275 |
| CURRENT OCCUPANT | 233 E JUNEAU AVE 706  | MILWAUKEE, WI 53202-3275 |
| CURRENT OCCUPANT | 233 E JUNEAU AVE 714  | MILWAUKEE, WI 53202-3275 |
| CURRENT OCCUPANT | 233 E JUNEAU AVE 719  | MILWAUKEE, WI 53202-3275 |
| CURRENT OCCUPANT | 233 E JUNEAU AVE 806  | MILWAUKEE, WI 53202-3296 |
| CURRENT OCCUPANT | 233 E JUNEAU AVE 809  | MILWAUKEE, WI 53202-3296 |
| CURRENT OCCUPANT | 233 E JUNEAU AVE 810  | MILWAUKEE, WI 53202-3297 |
| CURRENT OCCUPANT | 233 E JUNEAU AVE 904  | MILWAUKEE, WI 53202-3296 |
| CURRENT OCCUPANT | 233 E JUNEAU AVE 905  | MILWAUKEE, WI 53202-3296 |
| CURRENT OCCUPANT | 233 E JUNEAU AVE 907  | MILWAUKEE, WI 53202-3296 |
| CURRENT OCCUPANT | 233 E JUNEAU AVE 918  | MILWAUKEE, WI 53202-3296 |
| CURRENT OCCUPANT | 233 E JUNEAU AVE 1007 | MILWAUKEE, WI 53202-3086 |
| CURRENT OCCUPANT | 233 E JUNEAU AVE 1008 | MILWAUKEE, WI 53202-3086 |
| CURRENT OCCUPANT | 233 E JUNEAU AVE 1101 | MILWAUKEE, WI 53202-3086 |
| CURRENT OCCUPANT | 233 E JUNEAU AVE 1207 | MILWAUKEE, WI 53202-3087 |
| CURRENT OCCUPANT | 233 E JUNEAU AVE 1304 | MILWAUKEE, WI 53202-3087 |
| CURRENT OCCUPANT | 233 E JUNEAU AVE 1305 | MILWAUKEE, WI 53202-3087 |
| CURRENT OCCUPANT | 233 E JUNEAU AVE 1404 | MILWAUKEE, WI 53202-3088 |
| CURRENT OCCUPANT | 233 E JUNEAU AVE 1407 | MILWAUKEE, WI 53202-3088 |
| CURRENT OCCUPANT | 1117 N EDISON ST      | MILWAUKEE, WI 53202-3147 |
| CURRENT OCCUPANT | 1103 N WATER ST 405   | MILWAUKEE, WI 53202-6660 |
| CURRENT OCCUPANT | 1103 N WATER ST 201   | MILWAUKEE, WI 53202-3123 |
| CURRENT OCCUPANT | 1103 N WATER ST 205   | MILWAUKEE, WI 53202-3123 |
| CURRENT OCCUPANT | 1103 N WATER ST 207   | MILWAUKEE, WI 53202-3124 |
| CURRENT OCCUPANT | 1103 N WATER ST 304   | MILWAUKEE, WI 53202-6657 |
| CURRENT OCCUPANT | 1103 N WATER ST 212   | MILWAUKEE, WI 53202-3124 |
| CURRENT OCCUPANT | 1101 N EDISON ST      | MILWAUKEE, WI 53202-3147 |

**Total Records: 216**

**Radius: 250.0 feet and Center of Circle: 1111 N Water ST**

# 2016-2017 Plan of Operation for 1111 N WATER ST

## 1. Litter & Security Plans

How are the grounds kept clean?  Sweep  Pressure Wash  Pick Up Litter  Other:

How often will grounds be cleaned?  Daily  Weekly  Other:

Who cleans the grounds?  Licensee  Building Owner  Employees  Hired Maintenance  Other:

How are noise issues prevented and/or addressed?  Security  Manager approaches customer(s)  Call Police  Signs Posted  Other:

Are there designated outdoor smoking areas?  No  Yes If Yes, Describe: Rear outside entrance ramp

Number of garbage cans: Inside 12 Locations: Throughout tavern  
Outside 3 Locations: rear of premises

Is a crowd control barrier used?  No  Yes If Yes, Describe:

Number of restrooms: 1 men / 1 women

Name of solid waste contractor: Waste Management

Are there parking spaces on the premises?  No  Yes If Yes, list number of spaces: 30 and describe security plans: lot attendant

Are there designated loading areas?  No  Yes If Yes, describe security plans:

Do you have security personnel on the premise?  No  Yes If Yes, how many? 4  
AND What are their responsibilities? maintain order & check identification  
What security equipment do they use? None  
List their licensing, certification or training credentials: None

Are there security cameras?  No  Yes If Yes, list all locations: Throughout tavern

Are searches and/or identification checks conducted upon entry?  No  Yes If Yes, describe: Identification verification

## 2. Percentage of Sales (must total 100%)

Alcohol 100 % Food Sales \_\_\_\_\_ % Entertainment \_\_\_\_\_ % Other \_\_\_\_\_ %

## 3. Businesses On The Premises (choose all that apply):

- Restaurant  Cafe/Coffee Shop  Cocktail Lounge  Convenience Store  Other:  
 Night Club  Tavern  Banquet Hall  Sports Facility  
 Liquor Store  Hotel  Supermarket  Private/Fraternal/Veterans' Club

## 4. Hours of Operation and Age Restriction

Are there any changes to the current hours of operation or age restriction?  No  Yes If Yes, Describe:

Please Note: If you will be open earlier or later than the hours listed on your current license for even one event or holiday (for example, St. Patrick's Day, Brewers Opening Day, etc.) during the license period, this must be reported and printed on your license. Your hours of operation and age restriction are listed on your current license.

## 5. Floor Plan and Capacity

Are you requesting any changes to the floor plan or capacity?  No  Yes If Yes, Describe:

If requesting changes to the floor plan, submit a new floor plan with this application. Changes in floor plan include changing the location of tables, games, etc. within your current licensed premises. If your changes include adding any additional areas or square footage to your premises, or any renovations to the building will be done, a Permanent Extension of Premises application must be filed.

## 6. Sidewalk Dining (if renewing a current license)

Are there any changes to the sidewalk dining site plan?  No  Yes If Yes, submit an updated site plan with this application.



CITY OF MILWAUKEE  
OFFICE OF THE CITY CLERK

Monday, August 29, 2016

COMMITTEE MEETING NOTICE

AD 04

SINGH, Jaswinder, Agent  
Golden Mid Town Foods, Inc  
N54 W16569 Ravenwood DR

Menomonee Falls, WI 53051

You are requested to attend a hearing which is to be held in Room 301-B, Third Floor, City Hall on:

**Tuesday, September 06, 2016 at 10:45 AM**

**Regarding:** Your Class A Malt License Transfer - Change of Location and Food Dealer and Weights & Measures License Applications as agent or "Golden Mid Town Foods, Inc" for "Golden Mid Town Foods" at 2729 W VLIET St.

There is a possibility that your application may be denied for one or more of the following reasons: The recommendation of the committee regarding the application shall be based on evidence presented at the hearing. Per MCO 85-2.7-4, probative evidence concerning whether or not a new license should be granted may be presented on the following subjects: whether or not the applicant meets the municipal requirements, the appropriateness of the location and premises where the licensed premises is to be located and whether use of the premises for the purposes or activities permitted by the license would tend to facilitate a public or private nuisance or create undesirable neighborhood problems such as disorderly patrons, unreasonably loud noise, litter, and excessive traffic and parking congestion. Probative evidence relating to these matters may be taken from the plan of operation submitted with the license application, if any, but shall not include the content of any music. Evidence regarding the fitness of the location of the premises to be maintained as the principal place of business, including but not limited to whether there is an overconcentration of businesses of the type for which the license is sought; whether the proposal is consistent with any pertinent neighborhood business or development plans, or the location's proximity to areas where children are typically present. The applicant's record in operating similarly licensed premises; and whether or not the applicant has been charged with or convicted of any felony, misdemeanor, municipal offense or other offense, the circumstances of which substantially relate to the activity to be permitted by the license being applied for or any other factor which reasonably relates to the public health, safety or welfare may also be considered. See attached police report or correspondence. Possible denial because: This proposed location is in an area that has previously been found by the Common Council to be over concentrated with alcohol outlets. Attached is the concentration of alcohol beverage outlets in the area map existing at the time of the determination of the over concentration based on an address of 966 N. 27th Street. The Licenses Committee will consider concentration of alcohol beverage outlets as one question regarding the suitability of this location to be licensed as an alcohol beverage establishment. You may present evidence supporting your application. One issue that evidence should address is whether the licensure of this location is appropriate in light of the concentration of alcohol beverage outlets.

**Notice for applicants with warrants or unpaid fines:**

**Proof of warrant satisfaction or payment of fines must be submitted at the hearing on the above date and time. Failure to comply with this requirement may result in a delay of the granting/denial of your application.**

Failure to appear at this meeting may result in the denial of your license. Individual applicants must appear only in person or by an attorney. Corporate or Limited Liability applicants must appear only by the agent designated on the application or by an attorney. Partnership applicants must appear by a partner listed on the application or by an attorney. If you wish to do so and at your own expense, you may be accompanied by an attorney of your choosing to represent you at this hearing.

You will be given an opportunity to speak on behalf of the application and to respond and challenge any charges or reasons given for the denial. No petitions can be accepted by the committee, unless the people who signed the petition are present at the committee hearing and willing to testify. You may present witnesses under oath and you may also confront and cross-examine opposing witnesses under oath. If you have difficulty with the English language, you should bring an interpreter with you, at your expense, so that you can answer questions and participate in your hearing.

You may examine the application file at this office during regular business hours prior to the hearing date. Inquiries regarding this matter may be directed to the person whose signature appears below.

Limited parking for persons attending meetings in City Hall is available at reduced rates (5 hour limit) at the Milwaukee Center on the southwest corner of East Kilbourn and North Water Street. Parking tickets must be validated in the first floor information booth in City Hall.

PLEASE NOTE: Upon reasonable notice, efforts will be made to accommodate the needs of disabled individuals through sign language interpreters or other auxiliary aids. For additional information or to request this service, contact the Council Services Division ADA Coordinator at (414) 286-2998, Fax - (414) 286-3456, TDD - (414) 286-2025.

JIM OWCZARSKI, CITY CLERK

BY: 

Jason Schunk  
License Division Manager

**If you have questions regarding this notice, please contact the License Division at (414) 286-2238.**

200 E. Wells Street, Room 105, City Hall, Milwaukee, WI 53202. [www.milwaukee.gov/license](http://www.milwaukee.gov/license)  
Phone: (414) 286-2238 Fax: (414) 286-3057 Email Address: [License@milwaukee.gov](mailto:License@milwaukee.gov)

Date: 06 30 2016  
Officer: TRUNKEL

City of Milwaukee Police Department  
90-5-1.5 Crime Prevention Survey  
Convenience Store/Liquor Store Inspection

Name of Premise: Golden MID Town Foods  
Address: 2729 W Vliet ST  
Phone: 414-933-7700

Owner: Jaswinder Singh  
Owner address: N54W16569 Ravenwood Dr  
City State Zip: Menomonee Falls WI 53051  
Owner Phone: 262-252-2701 262271-3483  
Owner email:

Manager:  
Home Address:  
City State Zip:  
Phone:  
Email:

Preferred contact: Store Phone

Location currently open:  YES  NO AS A Chinese / ASIAN Food Store

Projected open date: August 1st 2016 AS NEW STORE

Day's open: S M T W Th F SA ALL

Hours of Operation: Sun: 8A - 9 PM 24 hours Y N  
Mon:  
Tue:  
Wed:  
Thu:  
Fri:  
Sat:

Premise Type: Liquor Store  
Convenience Store  
Other:

Licenses currently held:

- Alcohol:  Yes  No Class:
- Tobacco:  Yes  No #: 232689
- Food:  Yes  No #: 232687
- Extended Hours:  Yes  No #:
- Secondhand Dealer:  Yes  No Type: #:
- Other:  Yes  No Type: #: 232690 Weights + Measure
- Other:  Yes  No Type: #:

Applied for

#: AMALT 232687

Exterior Survey:

1. Is the area around the location clean?  Yes  No
2. What surrounds the location? (Check all the apply)
  - a.  Park
  - b.  School
  - c.  Youth Center
  - d.  Church
  - e.  Tavern(s) If so, how many
  - f.  Residential
  - g.  Other businesses
  - h.  Other:
3. Can you see from the outside of the location into the interior  Yes  No
4. Can you see the employees inside of the location from the outside  Yes  No
5. Are exterior windows free of signage  Yes  No
6. Is there a parking lot  Yes  No
7. Is the parking lot clean?  Yes  No
8. Is the parking lot well lit?  Yes  No
9. Are there areas where a person could conceal themselves  Yes  No
10. Is there exterior lighting?  Yes  No. Does it appears to be adequate  Yes  No
11. Exterior Payphone?  Yes  No
12. Are there No Loitering Signs posted?  Yes  No
13. Are there exterior security cameras  Yes  No How Many:
14. Are the address numbers prominently displayed and easy to see  Yes  No *BUT NOT ON THE STREET SIDE*

Camera Survey:

15. Does this location have security cameras?  Yes  No
16. Are they in working order?  Yes  No
17. What format are the cameras?
  - a. Color  Yes  No
  - b. Digital  Yes  No
  - c. VCR  Yes  No
  - d. Recorded  Yes  No
18. How long is footage stored for later viewing: *N/A*
19. Are there exterior cameras  Yes  No How many: *NONE*
20. Are there interior cameras  Yes  No How many:
21. Do all employees know how to retrieve recorded digital images/footage?  Yes  No

**Interior Survey:**

22. Is the storeowner willing to be a standing complainant regarding loitering?  Yes  No  
a. If yes have them fill out the standing complaint form and give them two of the commercial signs  Yes  No
23. Is the interior of the location neat and clean?  Yes  No
24. Does an interior camera face the entrance/exit?  Yes  No
25. Is there a lockable area that separates employees from customers?  Yes  No
26. Does the store sell single chore boy?  Yes  No
27. Does the store sell blunt wraps?  Yes  No
28. Does the store sell scales?  Yes  No
29. Does the store sell items that may be used as crack pipes?  Yes  No  
a. Describe item N/A
30. Does the store have an over abundance of sandwich baggies:  Yes  No
31. Does the owner understand that these items are often used for drug use?  Yes  No
32. Do the products in the store appear to be new and rotated often?  Yes  No
33. Are emergency and non-emergency numbers posted near the phone?  Yes  No
34. Does the owner know how to contact their police district directly?  Yes  No  
a. Did you provide a district contact guide to the owner?  Yes  No

*His merchandise is NOT there*

**Complete this section if alcohol establishment is a convenience store:**

(\*\* Read full ordinance for all details "68-55 Convenience Food Stores")

All convenience food stores not exempted under sub. 3 shall:

1. Is the cash register located in a manner so that at the time of a sales transaction, the employee and customer are both visible from the sidewalk?  Yes  No \*\*
2. Are the glass entrance and exit doors clear of any signs or advertisements with the exception of a sign which states that the cash register contains \$50 or less and that the safe is no accessible to employees?  Yes  No
3. Does the store maintain one of the following on the licensed premise:
  - a. A safe that was in use at the convenience food store on August 17, 1994?  Yes  No
  - b. A drop-safe or time release safe that weighs at least 500 pounds or which is attached to or set into the floor in a manner approved by the police department?  Yes  No
4. Is lighting provided for the store's parking area during all hours of darkness when employees or customers are on the premises at a minimum average of 2-foot candles per square foot, unless the store is not open for business after sunset and before sunrise?  Yes  No  N/A
5. Are at least two high-resolution surveillance security cameras installed?  Yes  No
6. Are the security cameras in working order?  Yes  No
7. Does one camera show an overall view of the counter and register area?  Yes  No
8. Does one camera show a clear, identifiable, full frame image of the face of each person entering and leaving the store?  Yes  No
9. Are the camera views obstructed by fixtures or displays?  Yes  No
10. Is the recorded footage stored for at least 30 days?  Yes  No

*N/A*

11. Do all store employees know how to record footage from the camera system to media capable of being transferred to police custody?  Yes  No
12. Are customer entrances/exits made of glass or other transparent material?  Yes  No N/A
- a. Exception: A store that does not have such doors on August 17, 1994 shall not be required to install such doors until the holder of the store's food dealer license changes.
13. Has the owner and their employees attended the Robbery Prevention Training within 120 days of ownership or employment?  Yes  No
- a. Contact Community Outreach and Education at 935-7836 for schedule.

**Sub 3. Exemptions.** The requirements of this section do not apply to a convenience food store that conforms to either of the following descriptions:

- a-1. The store is located in an enclosed shopping structure, enclosed commercial building or hospital. A convenience food store is not in an enclosed structure or building if a customer can enter it directly from the outside.  
Does store conform to a-1  Yes  No
- a-2. The store physically separates employees from customers with a solid partition that bars a person from entering the employee area from the customer area, has a secure lock on the employee side of any door between the employee area and the customer, and conducts all transaction through a service window or similar arrangement.  
Does store conform to a-2  Yes  No
- a. At the commissioner's discretion, a convenience store may be exempted from any or all of the regulations specified in sub 2.  
Does this location hold an exemption from the commissioner regarding any of the requirements of Sub 2?  Yes  No

**ADDITIONAL COMMENTS/RECOMMENDATIONS:**

Jasvinder Singh DID NOT RETURN OUR CALLS until 6/28/16. He then left 15 messages.

There are NO CAMERAS he said he might get 5 or 6 in September

There is a GLASS Entrance Door on the inside has A Bullet hole AND spider web.

There are NOT any NO Loitering Signs. He plans to open the day after the sale is final on 7/31/16.  
WANTS to operate without cameras for over a month.



# MILWAUKEE POLICE DEPARTMENT

## LICENSING

### CRIMINAL RECORD/ORDINANCE VIOLATION/INCIDENTS SYNOPSIS

DATE: 06/17/2016

LICENSE TYPE: CLASS A FERMENTED MALT

NEW:

RENEWAL:

No. 232687

Application Date: 06/17/2016

License Location: 2729 West Vliet Street (moved from 801 North 27<sup>th</sup>)

Business Name: Golden Mid Town Foods

Licensee/Applicant: Singh, Jaswinder  
(Last Name, First Name, MI)

Date of Birth: 03/02/1958

Home Address: N54 W16569 Ravens Wood Dr

City: Menomonee Falls

State: WI Zip Code: 53051

Home Phone: (262) 252-2701

This report is written by Police Officer David NOVAK, assigned to the License Investigation Unit, Days.

The Milwaukee Police Department's investigation regarding this application revealed the following:

1. On 7-6-2004 an undercover Milwaukee police officer entered the Golden Mid Town Foods store at 801 N 27<sup>th</sup> St. The officer was able to purchase a 4 inch glass tube that is the most common way to ingest crack cocaine, from an employee, Taranjit Kaur. The corporate Officer Nirmal Singh and the clerk, Taranjit Kaur were charged with the following:

As to Nirmal Singh:

Charge: Manufacture/Deliver Drug Paraphemalia (Misdemeanor)  
Finding: Pending Review Hearing on 03-06-07 8:30am.  
Case: 2004CM004989

As to Taranjit Kaur:

Charge: Manufacture/Deliver Drug Paraphernalia  
Finding: Dismissed  
Date: 09/27/05  
Case: 2004CM004988

RE: SINGH, Jaswinder

2. On 12-20-05 at 5:20pm, corporate Officer Nirmal Singh was issued a citation for Sale Of Alcohol to Underage Persons at 801 N 27<sup>th</sup> St.

Charge: Sale of Alcohol to Underage Persons  
Finding: Guilty  
Sentence: Fined \$100.00  
Date: 03-24-06  
Case: 06006931

3. On 04-08-06, Milwaukee Police were working on a tobacco compliance DPM and sent in a 15 year old, under the direction of Milwaukee Police, who bought a pack of New Port cigarettes from the clerk, identified as Gurnek Singh, W/M 04-10-55, 2185 S 60<sup>th</sup> Street. A citation was issued.

Charge: Sale of Tobacco Product to Underage Person  
Finding: Guilty  
Sentence: Fined \$100.00  
Date: 06-05-06  
Case: 06046843

- =====
4. On 07/24/07 at 9:45am officers went to 801 N. 27<sup>th</sup> St. Golden Mid Town Foods. A 20 year old Police Aide, was directed to enter the store, where he was able to purchase a 6 pack of beer from the clerk Nirmal Singh, without being asked for identification. Normal Singh is listed as a corporate officer for this location, but the citation was issued to the applicant.

Charge: Sale to Underage Person Prohibited  
Finding: Dismissed without Prejudice  
Date: 01/16/08  
Case: 07088324

5. On 02/23/08 the applicant was cited in the City of Milwaukee for Sale of Cigarettes in Package/Container without Stamp.

Charge: Sale of Cigarettes in Package/Container without Stamp  
Finding: Guilty  
Sentence: \$80.00 fine  
Date: 05/21/2008  
Case: 08031425

=====

**Item #5 previously considered. Disposition added 05/12/2009.**

**Item #5 has resulted in a warrant for the applicant's arrest. Warrant letter sent 05/12/2009.**

=====

6. On 12/02/2009 at 5:25pm Milwaukee Police conducted a licensed premise check at 801 North 27<sup>th</sup> Street (Golden Mid-Town Foods). During this check, food items that were out of date and had passed their sell by date were discovered. The applicant was issued a citation for Rotate Milk Inventory/Remove Outdated.

Charge: Rotate Milk Inventory/Remove Outdated  
Finding: Dismissed w/o prejudice  
Date: 12/20/10  
Case: 10002276

=====  
Incident # 6 previously reported, disposition now added on 05/02/11.  
=====

7. On 08/09/2013 Officers made contact with the applicant at 801 N 27<sup>th</sup> St (Golden Midtown Foods) regarding Secondhand Dealer License. He was given a copy of City Ordinance regarding Secondhand Dealers and signed a receipt acknowledging that fact.

- =====  
8. On 05/27/2014 Milwaukee police conducted a licensed premise check at 801 North 27<sup>th</sup> Street (Golden Mid Town Foods) based on information that the store was selling individual cigarettes. A pack of open cigarettes was discovered behind the cash register. One of the cashiers, Nirmal Singh, told officers he was not aware he could not sell individual cigarettes. Officers advised employees that they cannot sell individual cigarettes or open pre-packaged multipacks of cigars for individual sale. When asked by officers, Singh stated they check identification prior to making tobacco sales.

9. On 09/20/2014 a 17 year old, working in conjunction with Milwaukee police, was able to purchase a 3 pack of Jackpot brand cigars from the cashier, Nirmal Singh, at 801 North 27<sup>th</sup> Street (Golden Mid Town Foods). The applicant was cited.

Charge: Sale of Cigarettes to Minor/Underage  
Finding: Dismissed without prejudice  
Sentence:  
Date: 02/19/2015  
Case: 14067786

=====

# Alcohol Concentration for 2729 W Vliet St

City of Milwaukee, Wisconsin

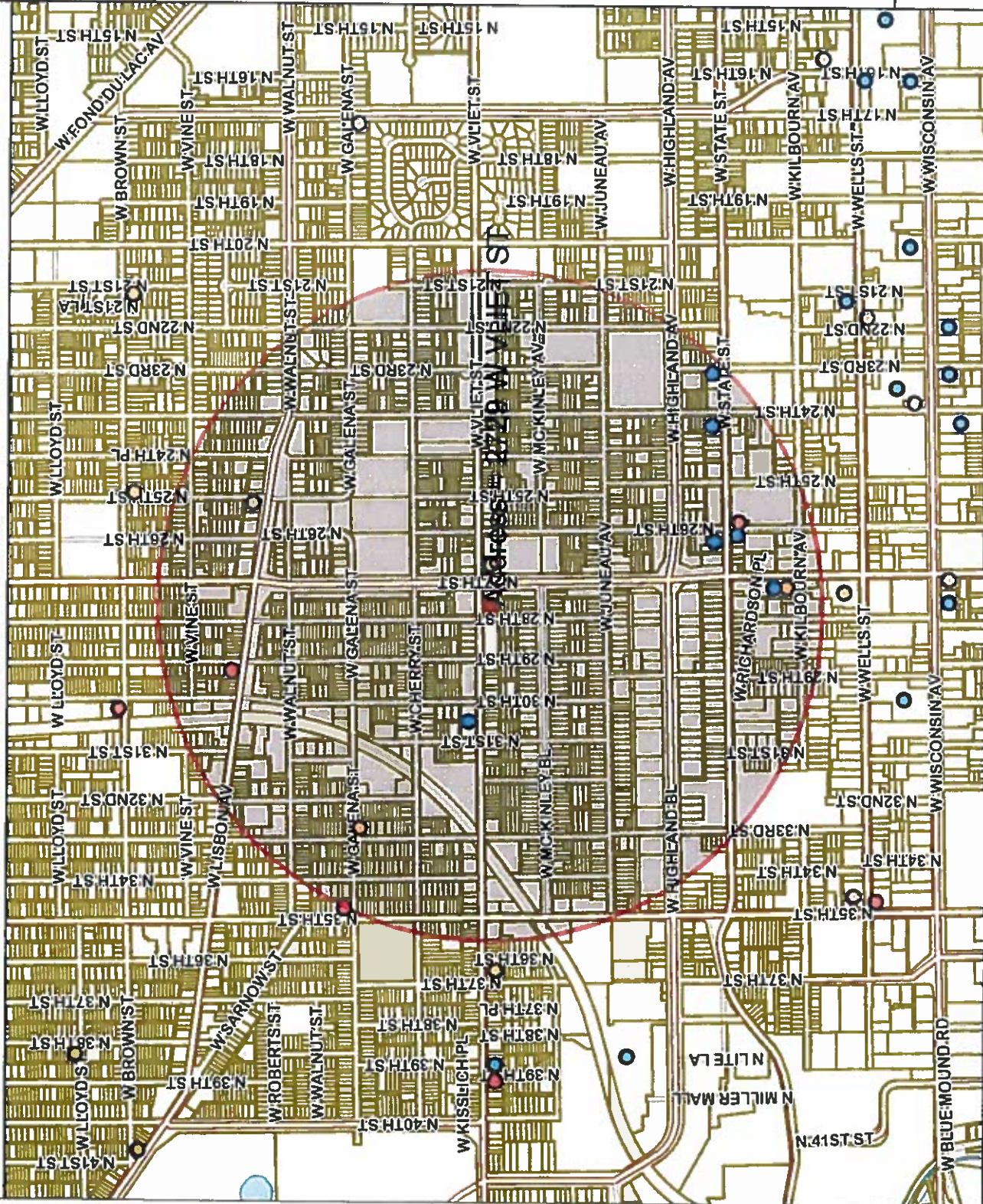

## - Legend -

- City limits
- Parcels
- Freeways
- Freeways
- Exit ramps
- Entry ramps
- Ramps
- Major streets
- Streets
- Waterways
- Alcohol licenses**
- Class A intoxicating liquor
- Class A fermented malt beverage
- Class A liquor and malt
- Class B fermented malt beverage
- Class B tavern
- Class C wine retailer

## - Notes -

Alcohol establishments within a .5 mile radius centered on 2729 W Vliet St on June 16, 2016

City of Milwaukee  
Department of Administration - ITMD



Map Scale: 1 : 13,402

© City of Milwaukee, Wisconsin  
Map Milwaukee: Property Information  
Disclaimer  
6/16/2016

| Licensed Alcohol Beverage Establishments within a .5 Mile Radius Centered on 2729 W Vliet St on June 16, 2016 |                             |                           |                  |  |                |               |                 |       |    |
|---|-----------------------------|---------------------------|------------------|--|----------------|---------------|-----------------|-------|----|
| Legal entity  | Trade name                  | Licensee                  | Address          | License type name                                  | Total capacity | Room capacity | Expiration date | Total |    |
| GROCERY KING, INC   | BRIGHT FOOD MARKET          | MOHAMMED M HASAN, Agt     | 2500 W LISBON AV | Class A Fermented Malt Beverage Retailer's License |                |               | 7/24/2016       |       | 4  |
| M N Supermarket Inc   | Kilbourn Supermarket        | DAVINDER SINGH, Agt       | 1901 N 27th ST   | Class A Fermented Malt Beverage Retailer's License |                |               | 5/20/2017       |       | 2  |
| MIKE'S FOOD   | MIKE'S FOOD                 | MOHAMMAD B ABDELLATIF, SP | 1556 N 33RD ST   | Class A Fermented Malt Beverage Retailer's License |                |               | 5/18/2017       |       | 6  |
| Vliet Street Market, LLC  | Vliet Street Market         | Sukhjinder Singh, Agt     | 2631 W Vliet ST  | Class A Fermented Malt Beverage Retailer's License |                |               | 7/25/2016       |       |    |
| DAVIDSON LIQUOR   | DAVIDSON LIQUOR             | NAIL F MSEITIF, SP        | 2900 W LISBON AV | Class A Malt & Class A Liquor License              |                |               | 2/21/2017       |       |    |
| PK Liquor Inc   | State Beer Liquor           | DAVINDER SINGH, Agt       | 2537 W State ST  | Class A Malt & Class A Liquor License              |                |               | 7/21/2016       |       |    |
| DLR, INC  | RICKEY'S ON STATE           | DONALD L RAFFAELLI, Agt   | 2601 W STATE ST  | Class B Tavern License                             | 100            |               | 9/24/2016       |       |    |
| Five O'Clock Steakhouse Inc   | Five O'Clock Steakhouse     | Jason C Blank, Agt        | 2415 W State ST  | Class B Tavern License                             |                |               | 3/28/2017       |       |    |
| GARE-BEAR'S   | GARE-BEAR'S                 | GARY L LIESKE, SP         | 927 N 27TH ST    | Class B Tavern License                             | 70             |               | 6/30/2016       |       |    |
| MIKE'S A LITTLE BIT COUNTRY   | MIKE'S A LITTLE BIT COUNTRY | MICHAEL CHRIST, SP        | 2608 W STATE ST  | Class B Tavern License                             | 50             |               | 6/30/2016       |       |    |
| Talk of the Town  | Talk of the Town            | Dyan A Ward, SP           | 2302 W State ST  | Class B Tavern License                             | 80             |               | 3/2/2017        |       |    |
| WI AFRICAN AMERICAN WOMEN, LTD  | WAAW                        | JOSEPHINE D HILL, Agt     | 3020 W VLIET ST  | Class B Tavern License                             |                |               | 9/20/2016       |       |    |
| Grand Total   |                             |                           |                  |  |                |               |                 |       | 12 |

# Alcohol Concentration for 962 & 966 N 27th Street

City of Milwaukee, Wisconsin

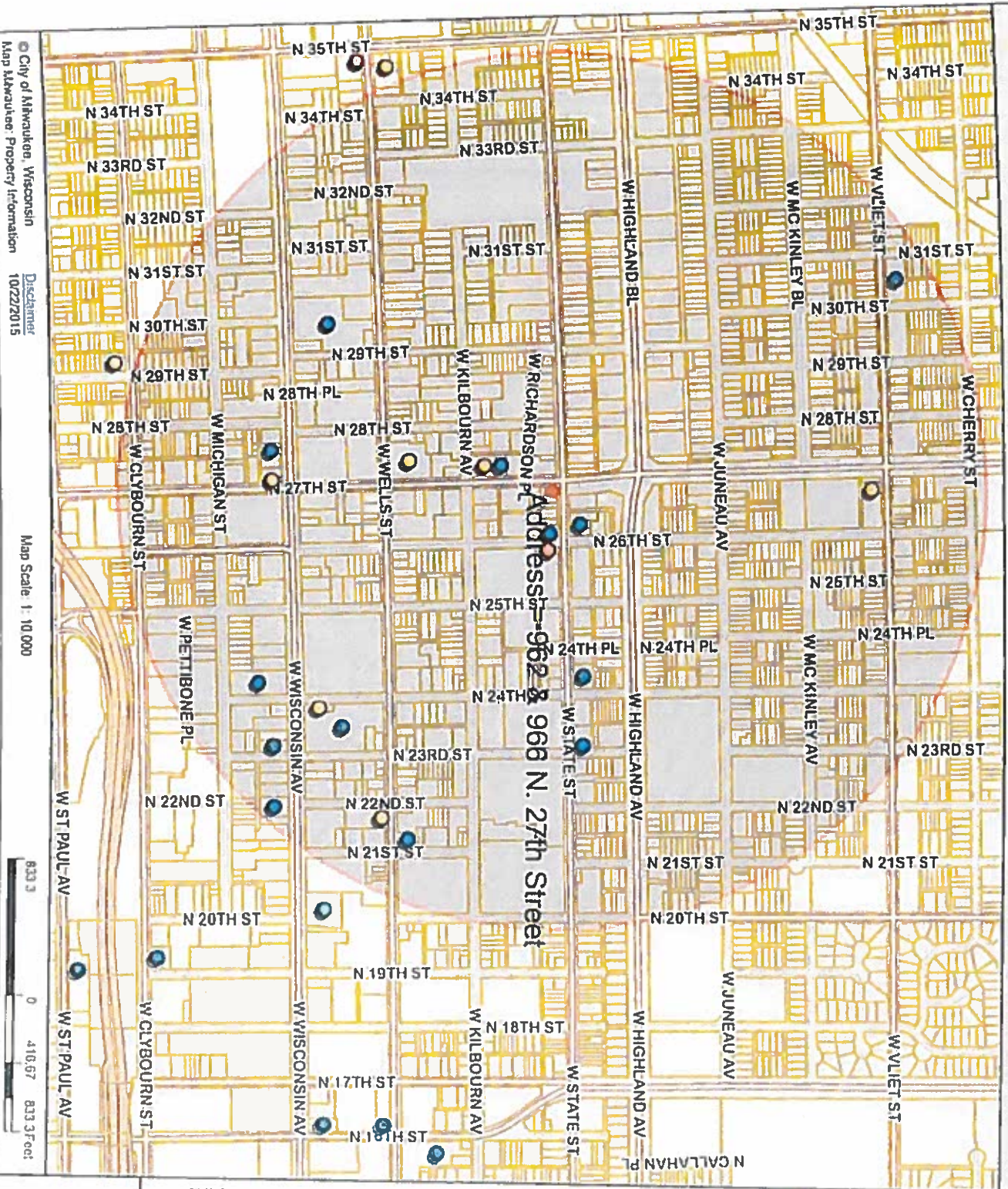

City of Milwaukee, Wisconsin  
 Map Milwaukee Property Information  
 Disclaimer  
 10/22/2015

Map Scale: 1:10,000



**City of Milwaukee**  
 Department of Administration - IT&ID

**Legend**

- City limits
- Parcels
- Freeways
- Freeways
- Exit ramps
- Entry ramps
- Ramps
- Major streets
- Streets
- Waterways

**Alcohol licenses**

- Class A (retailing liquor)
- Class A (fermented malt beverage)
- Class A (liquor and malt)
- Class D (fermented malt beverage)
- Class B (beer)
- Class C (wine retailer)

**Notes**

Alcohol establishments within a .5 mile radius centered on 962 & 966 N 27th Street on 10/22/15



Unbonded Alcohol Beverage Establishments within a 3-Mile Radius Centred on 932 S 90th St, 77th Street, 10/22/15

| Legal entity                            | Trade Name                      | License   | Address             | License Type Name                                   | Total capacity | Begin capacity  | Expiration date |
|---|---------------------------------|---|---------------------|---|----------------|---|-----------------|
| VENET STREET MARKET, LLC                | VENET STREET MARKET             | Class A Fermented Alcoh Beverage Retailer's License | 2821 W VALT ST      | Class A Fermented Alcoh Beverage Retailer's License |                |   | 7/25/2016       |
| QUORUM MAD TOWN FOODS, INC              | QUORUM MAD TOWN FOODS           | Class A Fermented Alcoh Beverage Retailer's License | 801 N 27TH ST       | Class A Fermented Alcoh Beverage Retailer's License |                |   | 2/23/2016       |
| LUCKY SUPERMARKET                       | LUCKY SUPERMARKET               | Class B Tavern License                              | 2201 W WINGSDOWN AV | Class B Tavern License                              |                |   | 9/25/2016       |
| DELTA-1, INC                            | QUICK HONEY                     | Class B Tavern License                              | 1138 W WINGSDOWN AV | Class B Tavern License                              |                |   | 1/31/2016       |
| Mid M Supermarket Inc                   | Edwards Supermarket             | Class A Fermented Alcoh Beverage Retailer's License | 901 N 27th St       | Class A Fermented Alcoh Beverage Retailer's License |                |   | 5/20/2016       |
| Wanda Food Market                       | Wanda Food Market               | Class A Fermented Alcoh Beverage Retailer's License | 2131 W WEBB ST      | Class A Fermented Alcoh Beverage Retailer's License |                |   | 7/1/2016        |
| Old Liquor Inc                          | Salem Beer Liquor               | Class A Retail & Cash A Liquor License              | 1537 W 54th St      | Class A Retail & Cash A Liquor License              |                |   | 7/27/2016       |
| THE OTTOLUCK CLUB OF LAKELAND, LLC      | OTTOLUCK CLUB                   | Class B Tavern License                              | 3013-16 W STATE ST  | Class B Tavern License                              | 186            |   | 7/17/2016       |
| TRIPOLI BEHARIE                         | TRIPOLI BEHARIE                 | Class B Tavern License                              | 3000 W WINGSDOWN AV | Class B Tavern License                              | 1089           |   | 5/24/2016       |
| THAICHINE, LLC                          | COMFORT SAVORING BAR & GRILL    | Class B Tavern License                              | 2127-27 W WILDS ST  | Class B Tavern License                              | 228            | License 100, Replacment 28  | 6/20/2016       |
| THE BAR & SHOPS, LLC                    | Bar & Shops                     | Class B Tavern License                              | 3166 W WEBB ST      | Class B Tavern License                              | 73             |   | 5/11/2016       |
| DEL, INC                                | ROCKETS ON STATE                | Class B Tavern License                              | 1802 W STATE ST     | Class B Tavern License                              | 100            |   | 9/24/2016       |
| GRAB-SEALS                              | GRAB-SEALS                      | Class B Tavern License                              | 1327 N 27TH ST      | Class B Tavern License                              | 78             |   | 6/20/2016       |
| MADY'S A LITTLE BIT COUNTRY             | MADY'S A LITTLE BIT COUNTRY     | Class B Tavern License                              | 7608 W STATE ST     | Class B Tavern License                              | 50             |   | 6/20/2016       |
| LEVERAGE SERVICES OF LAKELAND, LLC      | THE NAME/THE LONES CLUBS        | Class B Tavern License                              | 1601 W WINGSDOWN AV | Class B Tavern License                              |                | Balcony 84 Very = 888<br>Balroom (3rd level) = 1230<br>Barre Backery = 743<br>Pool (1st level) = 1517 | 4/7/2016        |
| UTRACQUAH LODGING, INC                  | UTRACQUAH LODGING               | Class B Tavern License                              | 1302 W SAID ST      | Class B Tavern License                              | 86             |   | 3/27/2016       |
| LAKELAND LODGING, LLC                   | LAKELAND LODGING HOTEL          | Class B Tavern License                              | 1725 W WINGSDOWN AV | Class B Tavern License                              | 73             |   | 6/20/2016       |
| WINGSDOWN WOMEN WOMEN LTD               | WAAAW                           | Class B Tavern License                              | 1920 W VILLET ST    | Class B Tavern License                              | 140            |   | 6/13/2016       |
| LAKELAND LODGING, LLC                   | LAKELAND LODGING                | Class B Tavern License                              | 1301 W WINGSDOWN AV | Class B Tavern License                              | 120            |   | 9/20/2016       |
| WISH CULTURAL & HERITAGE CENTER WA, INC | WISH CULTURAL & HERITAGE CENTER | Class B Tavern License                              | 1133 W WINGSDOWN AV | Class B Tavern License                              |                |   | 6/13/2016       |



Monday, August 29, 2016

## Licenses Committee Notice of Hearing

Cher Yang  
2729 W Vliet St

Milwaukee, WI 53208

Date: 9/6/2016  
Time: 10:45 AM  
Location: Room 301-B, Third Floor, City Hall

The Licenses Committee will consider the following license application:

Class A Malt License Transfer - Change of Location and Food Dealer and Weights  
& Measures License Applications  
SINGH, Jaswinder, Agent  
Golden Mid Town Foods at 2729 W VLIET St

Please note this application may be recommended for denial based on fitness of the location due to concentration of alcohol beverage outlets in the area. If the application is denied for this reason, no other application for an alcohol beverage license for this location shall be recommended for approval by the Licenses Committee within three years of the date of denial unless the applicant has demonstrated a change of circumstances since the prior denial.

If you have any questions, please call (414) 286-2238.







Monday, August 29, 2016



# Notice of Public Hearing

---

SINGH, Jaswinder, Agent  
Golden Mid Town Foods at 2729 W VLIET St  
Class A Malt License Transfer - Change of Location and Food Dealer and Weights & Measures  
License Applications

**Tuesday, September 06, 2016 at 10:45 AM**

To whom it may concern:

The above application has been made by the above named applicant(s). This requires approval from the Licenses Committee and the Common Council of the City of Milwaukee. The hearing before the Licenses Committee will take place on 9/6/2016 at 10:45 AM, in Room 301-B, Third Floor, City Hall. If you wish, you may provide testimony at the hearing regarding the request; see below for further information. You are not required to attend the hearing. Once the Licenses Committee makes its recommendation, this recommendation is forwarded to the full Common Council for approval at its next regularly scheduled hearing. Please review the information below and if you have further questions regarding this process, please contact the License Division at (414) 286-2238.

---

## Important details for those wishing to provide information for the Licenses Committee to consider when making its recommendation:

1. The license application is scheduled to be heard at the above time. Due to other hearings running longer than scheduled, you may have to wait some time to provide your testimony.
2. You must appear in person and testify as to matters that you have personally experienced or seen. (You cannot provide testimony for your neighbor, parent or anyone else; this is considered hearsay and cannot be considered by the committee.)
3. No letters or petitions can be accepted by the committee (unless the person who wrote the letter or the persons who signed the petition are present at the committee hearing and willing to testify).
4. Persons opposed to the license application are given the opportunity to testify first; supporters may testify after the opponents have finished.
5. When you are called to testify, you will be sworn in and asked to give your name, and address. (If your first and/or last names are uncommon please spell them.)
6. You may then provide testimony.
  - a. Include only information relating to the above license application.
  - b. Include only information you have personally witnessed or seen.
  - c. Provide concise and relevant information detailing how this business has affected or may affect the peaceful enjoyment of your neighborhood.
  - d. If by the time you have the opportunity to testify, the information you wish to share has already been provided to the committee, you may state that you agree with the previous testimony. Redundant or repetitive testimony will not assist the committee in making its recommendation.
7. After giving your testimony, the members of the Licenses Committee and the licensee may ask questions regarding the testimony you have given or other factors relating to the license application.
8. Business Competition is not a valid basis for denial or non-renewal of a license.  
**Please Note: If you have submitted an objection to the above application your objection cannot be considered by the committee unless you personally testify at the hearing.**

| OCCUPANT         | MAIL ADDRESS           | CITY AND ZIP CODE        |
|------------------|------------------------|--------------------------|
| CURRENT OCCUPANT | 1332 N 28TH ST         | MILWAUKEE, WI 53208-2411 |
| CURRENT OCCUPANT | 1322 N 29TH ST         | MILWAUKEE, WI 53208-2415 |
| CURRENT OCCUPANT | 2824 W VLIET ST        | MILWAUKEE, WI 53208-2429 |
| CURRENT OCCUPANT | 2816 W MC KINLEY BLVD  | MILWAUKEE, WI 53208-2927 |
| CURRENT OCCUPANT | 1337 N 28TH ST         | MILWAUKEE, WI 53208-2412 |
| CURRENT OCCUPANT | 1325 N 28TH ST         | MILWAUKEE, WI 53208-2412 |
| CURRENT OCCUPANT | 1322 N 28TH ST         | MILWAUKEE, WI 53208-2411 |
| CURRENT OCCUPANT | 1316 N 28TH ST         | MILWAUKEE, WI 53208-2411 |
| CURRENT OCCUPANT | 2726 W MC KINLEY BLVD  | MILWAUKEE, WI 53208-2925 |
| CURRENT OCCUPANT | 1327A N 28TH ST        | MILWAUKEE, WI 53208-2412 |
| CURRENT OCCUPANT | 2816 W VLIET ST        | MILWAUKEE, WI 53208-2429 |
| CURRENT OCCUPANT | 1424 N 28TH ST         | MILWAUKEE, WI 53208-2413 |
| CURRENT OCCUPANT | 2730 W MC KINLEY BLVD  | MILWAUKEE, WI 53208-2925 |
| CURRENT OCCUPANT | 2718 W MC KINLEY BLVD  | MILWAUKEE, WI 53208-2925 |
| CURRENT OCCUPANT | 2718A W MC KINLEY BLVD | MILWAUKEE, WI 53208-2925 |
| CURRENT OCCUPANT | 1336 N 29TH ST         | MILWAUKEE, WI 53208-2415 |
| CURRENT OCCUPANT | 1330 N 29TH ST         | MILWAUKEE, WI 53208-2415 |
| CURRENT OCCUPANT | 2832 W VLIET ST        | MILWAUKEE, WI 53208-2429 |
| CURRENT OCCUPANT | 1325A N 28TH ST        | MILWAUKEE, WI 53208-2412 |
| CURRENT OCCUPANT | 1336 N 28TH ST         | MILWAUKEE, WI 53208-2411 |
| CURRENT OCCUPANT | 1324 N 29TH ST         | MILWAUKEE, WI 53208-2415 |
| CURRENT OCCUPANT | 2808 W VLIET ST        | MILWAUKEE, WI 53208-2429 |
| CURRENT OCCUPANT | 1324 N 28TH ST         | MILWAUKEE, WI 53208-2411 |
| CURRENT OCCUPANT | 1320 N 28TH ST         | MILWAUKEE, WI 53208-2411 |
| CURRENT OCCUPANT | 2720 W MC KINLEY BLVD  | MILWAUKEE, WI 53208-2925 |
| CURRENT OCCUPANT | 2637 W VLIET ST        | MILWAUKEE, WI 53205-1837 |
| CURRENT OCCUPANT | 2728A W MC KINLEY BLVD | MILWAUKEE, WI 53208-2925 |
| CURRENT OCCUPANT | 2712 W MC KINLEY BLVD  | MILWAUKEE, WI 53208-2925 |
| CURRENT OCCUPANT | 1327 N 28TH ST         | MILWAUKEE, WI 53208-2412 |
| CURRENT OCCUPANT | 1334 N 28TH ST         | MILWAUKEE, WI 53208-2411 |
| CURRENT OCCUPANT | 1330 N 28TH ST         | MILWAUKEE, WI 53208-2411 |
| CURRENT OCCUPANT | 2728 W MC KINLEY BLVD  | MILWAUKEE, WI 53208-2925 |
| CURRENT OCCUPANT | 2714 W MC KINLEY BLVD  | MILWAUKEE, WI 53208-2925 |
| CURRENT OCCUPANT | 1334 N 29TH ST         | MILWAUKEE, WI 53208-2415 |
| CURRENT OCCUPANT | 1328 N 29TH ST         | MILWAUKEE, WI 53208-2415 |
| CURRENT OCCUPANT | 1348 N 28TH ST         | MILWAUKEE, WI 53208-2411 |
| CURRENT OCCUPANT | 2720A W MC KINLEY BLVD | MILWAUKEE, WI 53208-2925 |
| CURRENT OCCUPANT | 1414 N 27TH ST         | MILWAUKEE, WI 53208-2409 |
| CURRENT OCCUPANT | 2818 W MC KINLEY BLVD  | MILWAUKEE, WI 53208-2927 |
| CURRENT OCCUPANT | 1421 N 28TH ST         | MILWAUKEE, WI 53208-2414 |
| CURRENT OCCUPANT | 1335 N 28TH ST         | MILWAUKEE, WI 53208-2412 |
| CURRENT OCCUPANT | 2810 W MC KINLEY BLVD  | MILWAUKEE, WI 53208-2927 |

**Total Records: 43**

**Radius: 250.0 feet and Center of Circle: 2729 W Vliet ST**



# BUSINESS LICENSE PLAN OF OPERATION

ccl-busplan 9/15/15

Office of the City Clerk License Division  
200 E. Wells St. Room 105, Milwaukee, WI 53202  
(414) 286-2238 www.milwaukee.gov/license e-mail address: [license@milwaukee.gov](mailto:license@milwaukee.gov)

## 1. Type of Business

- Applying for:  Extended Hours Establishment  Filling Station  Waste Tire Transporter  Waste Tire Generator  
 Self Service Laundry  Rooming House: Number of Units: \_\_\_\_\_  Hotel/Motel: Number of Units: \_\_\_\_\_  
 Massage Establishment  Other (supplemental application for specific license also required)

Provide a detailed description of the type of business you plan on operating:  
Grocery store

Do you have any experience operating this type of business?  No  Yes If yes, explain: Grocery store

## 2. Business Operations

- a. Proposed Opening Date: 7/31/16
- b. Is this premise under construction?  No  Yes If yes, list estimated completion date: \_\_\_\_\_
- c. Is this a franchise?  No  Yes
- d. Is this premises currently licensed?  No  Yes If yes, list type of license: FOOD DEALER LIC
- e. Is the current licensee operating?  No  Yes If no, list date closed: \_\_\_\_\_
- f. Do you have future plans for other businesses, licenses or permits at this location?  No  Yes  
If yes, explain: Beer Lic
- g. Have you previously held an Extended Hours License in Milwaukee?  No  Yes  
If yes, list address(es): B
- h. Are other businesses operating in the same building?  No  Yes If yes, describe: \_\_\_\_\_

## 3. Litter & Noise

- a. How are grounds kept clean?  Sweep  Pressure Wash  Pick Up Litter  Hired Maintenance  
 Building Owner Responsibility  Garbage Cans Outside  Other: \_\_\_\_\_
- b. How often will grounds be cleaned?  Daily  Weekly  As Needed  Monthly  Other: \_\_\_\_\_
- c. Grounds cleaned by:  Licensee  Building Owner  Employees  Hired Maintenance  Other: \_\_\_\_\_
- d. How are noise issues prevented and/or addressed?  Security  Manager approaches customer(s)  Call Police  
 Signs Posted  Other: \_\_\_\_\_
- e. Will a sound amplification system be used?  No  Yes If yes, describe: \_\_\_\_\_

## 4. Smoking & Sanitation

- f. Are there designated outdoor smoking areas?  No  Yes If yes, describe: outside
- g. Number of Garbage Cans: Inside: 1 Locations: front back door  
Outside: 1 Locations: entrance exit
- h. Is a crowd control barrier used?  No  Yes If yes, describe: \_\_\_\_\_
- i. Describe sanitation facilities (restrooms): 2
- Name of solid waste contractor:  Advanced Disposal  Waste Management  Other: \_\_\_\_\_



## 9. Premises Description

d. Identify all area(s) of the premises that will be used in operating this business (include areas used only for storage):

1<sup>st</sup> Floor  2<sup>nd</sup> Floor  Basement Storage  Patio  Beer Garden  Sidewalk Café  Deck  Rooftop

Other: Describe: \_\_\_\_\_

e. Describe Location:  Major Thoroughfare  Secondary Street  Other: \_\_\_\_\_

f. Nearest Major Cross Street: 27<sup>th</sup> St Ulica St.

g. Describe Building:  Free Standing Building  Strip Mall  Other: \_\_\_\_\_

h. Describe Premises Structure:  Single Story  Multi-Story - # of Stories \_\_\_\_\_  Other: \_\_\_\_\_

i. Describe Surrounding Area:  Commercial  Residential  Industrial  Other: mi

j. Building Owner Name: JASWINDER SINGH Phone Number: 262-271-3483

Business Owner Address: JASWINDER SINGH

## 10. Hours of Operation & Customers

Will customers be entering the premises?  No  Yes

| Day of the Week | Proposed Hours of Operation:     |                                   | Estimated Number of Customers expected each day | Potential Age Range of Customers | Class B Applicants: Age Restriction (if none, write 'None') |
|-----------------|----------------------------------|-----------------------------------|---|----------------------------------|---|
|                 | Open Time (include a.m. or p.m.) | Close Time (include a.m. or p.m.) |   |                                  |   |
| Sunday          | 8-                               | 9-                                | 250   | ALL AGE                          |   |
| Monday          | 8-                               | 9                                 | 250   | ALL AGE                          |   |
| Tuesday         | 8-                               | 9                                 | 250   | ALL AGE                          |   |
| Wednesday       | 8-                               | 9                                 | 250   | ALL AGE                          |   |
| Thursday        | 8-                               | 9                                 | 250   | ALL AGE                          |   |
| Friday          | 8-                               | 9                                 | 250   | ALL AGE                          |   |
| Saturday        | 8-                               | 9                                 | 250   | ALL AGE                          |   |

Extended Hours Establishment License is required for any convenience store, filling station, personal service establishment (such as tattoo, body piercing, salon, tailor, tanning, etc.), recording studio or restaurant which is open between the hours of 12 a.m. and 5 a.m.

Entertainment Indoor Closing Hours - If alcohol beverage establishment, same as alcohol license hours.  
If non-alcohol establishment 1:00 am Sunday to Thursday; 1:30 am Friday and Saturday.

Entertainment Outdoor Closing Hours - 10:00 pm Sunday - Thursday; 12:00 am Friday and Saturday, unless otherwise approved by Common Council in licensee's plan of operation.

## 11. Signature(s)

Jaswinder Singh  
Sole Proprietor, Partner, Agent, or 20% or more Shareholder

\_\_\_\_\_  
Signature of additional partner or 20% or more Shareholder

See Application Information for a list of all required application forms.



# ALCOHOL BEVERAGE & PUBLIC ENTERTAINMENT PREMISES SUPPLEMENTAL PLAN OF OPERATION

Office of the City Clerk License Division  
200 E. Wells St. Room 105, Milwaukee, WI 53202  
(414) 286-2238 e-mail address: license@milwaukee.gov www.milwaukee.gov/license

Legal Entity Name: GREEN MIDDLETOWN FOODS INC.

Premise Address: 2729 W. VILLET ST

### Proximity of Premises to Church, School, Daycare Center or Hospital

Is there at least 300 feet between the building and any church, school, daycare center or hospital?  Yes  No

### "Service Bar Only" Designation

If applying for Class B or C license, are you applying for "Service Bar Only"?  No  Yes  
Service Bar Only means customers cannot sit at the bar. Alcohol is served to patrons seated at tables. No stools, chairs or other articles of furniture shall be placed at the service bar for patrons to sit upon.

### Business Information

- a) Are you taking out this application for anyone that may not be eligible for a license?  No  Yes  
If yes, list name and address: \_\_\_\_\_
  - b) Will the agent, a partner or the individual licensee be conducting the day-to-day operations of the business?  No  Yes  
If no, list the name and address of the person(s) who will: \_\_\_\_\_
- Class B Applicants: If the agent, a partner or the individual licensee will not be conducting the day-to-day operations of the business, the person(s) listed above must obtain a Class B Managers license.
- c) Does anyone else have money invested or any other interest in this business?  No  Yes  
If yes, explain: \_\_\_\_\_
  - d) Have you made an agreement with anyone to repay any loan or any other payments based upon income from the business?  No  Yes  
If yes, list name and address: \_\_\_\_\_

### Proof of Ownership, Lease, or Offer to Purchase (new & transfer applicants only)

Submit proof of ownership, lease, or offer to purchase the building with this application.  
A lease or offer to purchase must:

- a) Be in the same legal entity name as that apply for the license
- b) Reflect the same address as the premises address on this application
- c) Reflect current dates and
- d) Be signed by the lessor/seller and lessee/buyer

### Property Information (new & transfer applicants only)

- a) Do you own or lease the building?  Own  Lease
  - b) Who owns the fixtures (for example, coolers, etc.)? N/A
  - c) Are you purchasing the stock and/or fixtures?  No  Yes If yes, amount paid \$ 10,000
  - d) Total amount paid for business 500,000
  - e) Total amount paid for goodwill of the business \$ 0
- Goodwill comprises the reputation and customer relationships of an existing business. If the price you pay for the business exceeds the fair market value of all of the rest of the assets of the business, the excess may be considered goodwill.
- f) Have you made arrangements with the seller for payment of personal property taxes?  No  Yes

**See Application Information for a list of all required application forms.**

**Lease Information (new & transfer applicants who are leasing the premises only)**

- a) Date lease begins 8/2016 Ends 7/3021
- b) Monthly rental \$ 2500
- c) Do you have an option to renew the lease?  No  Yes
- d) Does your lease allow for assignment to another party without the consent of the owner?  No  Yes
- e) For what length of time have you been guaranteed occupancy (number of years)? NA
- f) In addition to paying the monthly rental, will you have to pay anything additional to the owner of the building to guarantee performance of the lease?  No  Yes If yes, explain NA
- g) Does the present owner or occupancy object to the granting of your license?  No  Yes  
If yes, explain NA

**Change of Agent Applicants Only**

Have there been any changes to the floor plan since the last application was submitted?  No  Yes  
If no, a new floor plan is not required. If yes, submit a new floor plan and explain the change(s): \_\_\_\_\_

**Notarized Signatures of Applicants**

SUBSCRIBED AND SWORN TO BEFORE ME

This 14 day of June, 2016

[Signature]  
Sole Proprietor, Partner, 20% or more Shareholder, or Agent – only if there are no 20% or more shareholders

(Clerk/Notary Public)

My Commission Expires 9/2/18

\*Notary Seal must be affixed.

Additional partner or 20% or more shareholder

Note: All information contained in this application is subject to approval by the Common Council. Deviating from approved plan of operation will subject licensee to citations, and/or suspension or non-renewal of the license. Contact the License Division for information on how to request changes.

**New and transfer of premise applicants must submit the following:**

- Proof of ownership, lease or offer to purchase the building
- Detailed floor plan
- If a restaurant, copy of the menu

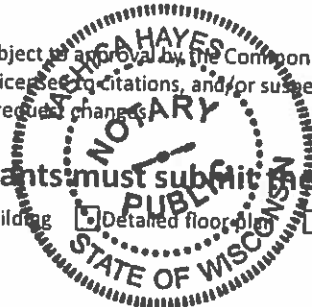



# FOOD DEALER LICENSE PLAN OF OPERATION

ccl-foodplan 2/22/16

OFFICE OF THE CITY CLERK, LICENSE DIVISION  
CITY HALL, 200 E. WELLS ST, ROOM 105, MILWAUKEE, WI 53202  
(414) 286-2238 • [license@milwaukee.gov](mailto:license@milwaukee.gov) • [www.milwaukee.gov/license](http://www.milwaukee.gov/license)

Legal Entity Name: GOLDEN MIDTOWN FOODS INC.

Premises Address: 2729 W. VLIET ST MIL WI 53208

### SECTION 1

Type of application (check one):  taking over a currently operating business  starting a new business  
Anticipated opening date? \_\_\_\_\_

Check the type that best describes your business (check only one):

See Food Dealer License Information sheet for definitions.

- Restaurant
  - Retail Establishment
  - Community Food Program
  - Bed & Breakfast
  - Base for Food Peddler
  - Base for Temporary/Seasonal Food Stand
- If retail, will it be a convenience store?  Yes  No  
(less than 5,000 sq ft of retail space, primary business is the sale of basic food items, and in addition sells household products)

In addition, will any wholesale business be done?  Yes  No

If yes, what percentage of the business will be wholesale?  Less than 25%  25% or More (Contact DATCP)\*

Will retail items be sold?  No  Yes If Yes, indicate percentage of food sales 100 %

Will restaurant items be sold?  No\*  Yes If Yes, indicate percentage of food sales \_\_\_\_\_ %

\* If you checked "25% or More" of the business will be wholesale and answered "No" to restaurant items being sold, do not continue completing this application. A City of Milwaukee License is not required. Contact DATCP only.

### SECTION 2

Will you be sharing kitchen space with another operator?

- No If No, SKIP to Section 3
- Yes If Yes, check one:
  - I will rent space from another operator ("Shared Kitchen Agreement" is required)
  - I will rent space to another operator (peddler/caterer)

### SECTION 3

Answer the following questions:

- Will you have seating on site for dining?  No  Yes
- Will you be doing any catering?  No  Yes
- Will you be doing any delivery?  No  Yes
- Will you have outdoor activities?  No  Yes
  - If Yes to outdoor activities, check all that apply:  Bar  Cooking/Grilling  Dining
- Will you have a drive thru window?  No  Yes
  - If Yes to drive thru, are hours different from inside?  No  Yes
  - If Yes, provide drive thru hours: \_\_\_\_\_
- Will any scales or barcode scanners be used?  No  Yes
  - If Yes, a Weights & Measures application must be completed and a license obtained.



**SECTION 4**

Where will food be prepared and/or sold?

At a single site

At multiple sites (for example, a hotel with several dining rooms or bars) How many? \_\_\_\_\_

If multiple sites, attach a Food Dealer Additional Site Addendum (ccl-foodadd) for each additional site.

**SECTION 5**

Are you planning any construction, remodeling or equipment changes?

No If No, SKIP to Section 6

Yes If Yes, check all that apply:

New construction of a building

Construction changes to an existing building

Renovation or remodeling

Equipment changes only (installation or replacement)

Provide a brief description of the changes: \_\_\_\_\_

Start date: \_\_\_\_\_

Name, Address & Phone Number of Architect: \_\_\_\_\_

Name, Address & Phone Number of Contractor: \_\_\_\_\_

**SECTION 6**

Are you applying for an alcohol beverage license?

No If No, SKIP to Section 7

Yes If YES, if your food license is approved prior to the alcohol beverage license, when do you want the food license issued?  Immediately  At the same time as the alcohol license

**SECTION 7**

You must initial each item confirming your understanding:

I understand the Health Department must conduct an inspection and advise the License Division of their approval before the license may be issued.

I understand I must obtain an occupancy permit from the Department of Neighborhood Services and an inspection may be required. Neighborhood Services must advise the License Division of their approval before the license may be issued.

I understand the district alderperson will review and either approve or deny my application. If denied, I may appeal and be scheduled to appear before the Licenses Committee. The Licenses Committee will then make a recommendation to the Common Council. The Common Council must grant the license before it may be issued.

I understand proof of payment for all license fees must be on file in the License Division before the license may be issued.

I understand the license must be issued and posted in my establishment prior to opening for business.

I will not operate my food business until the license has been issued and posted in the establishment.

Signature of sole proprietor, partner, agent or 20% shareholder: 

Signature of additional partner(s): \_\_\_\_\_



**WEIGHTS & MEASURES LICENSE SUPPLEMENTAL APPLICATION**

OFFICE OF THE CITY CLERK, LICENSE DIVISION  
 CITY HALL, 200 E. WELLS ST, ROOM 105, MILWAUKEE, WI 53202 •  
 (414) 286-2238 • [license@milwaukee.gov](mailto:license@milwaukee.gov) • [www.milwaukee.gov/license](http://www.milwaukee.gov/license)

Legal Entity Name: GOLDEN MIDTOWN FOODS INC.  
 Premise Address: 2729 - W. Vliet St MILWAUKEE WI 53208

**1. Device Type(s)**

- Check all device types for which you need a license.
  - For each device type checked, indicate how many you have in the Number of Devices column (b).
  - Calculate the Total Fee Per Device Type by multiplying the Fee Per Device Type (a) by the Number of Devices (b).
  - Add all Total Fee Per Device Type amounts together and that will be your Total Fee Due.
- \* **Exception:** The Scanner fee is not per device. Check the box for the appropriate range.  
 If you have 1-3 scanners, the total due is \$130. If you have 4 or more scanners, the total due is \$250.  
 Check the Number of Devices (b).

| Device Type   | License Period | Fee Per Device Type (a)      | Number of Devices (b)   | Total Fee Per Device Type (a x b) |
|---|----------------|------------------------------|---|-----------------------------------|
| <b>Liquid Measuring Devices</b>                       |                |                              |   |                                   |
| <input type="checkbox"/> Retail Petroleum Meters      | 12 months      | \$60                         |   |                                   |
| <input type="checkbox"/> 0 to 30 gallons per minute   | 24 months      | \$60                         |   |                                   |
| <input type="checkbox"/> 31 to 200 gallons per minute | 24 months      | \$250                        |   |                                   |
| <input type="checkbox"/> Over 200 gallons per minute  | 24 months      | \$250                        |   |                                   |
| <b>Scales</b>   |                |                              |   |                                   |
| <input checked="" type="checkbox"/> 0 to 300 pounds   | 24 months      | \$55                         | 1   | 55-00                             |
| <input type="checkbox"/> 301 to 5,000 pounds          | 24 months      | \$190                        |   |                                   |
| <input type="checkbox"/> 5,001 to 40,000 pounds       | 24 months      | \$300                        |   |                                   |
| <input type="checkbox"/> Over 40,000 pounds           | 24 months      | \$400                        |   |                                   |
| <b>Scanners</b>                                       |                |                              |   |                                   |
|   |                | Fee for scanners is by range | Check how many scanners you have  |                                   |
| <input checked="" type="checkbox"/> Up to 3 scanners  | 24 months      | \$130 total*                 | <input checked="" type="checkbox"/> 1 <input type="checkbox"/> 2 <input type="checkbox"/> 3 | 130-00                            |
| <input type="checkbox"/> Four or more scanners        | 24 months      | \$250 total*                 | <input type="checkbox"/> 4 <input type="checkbox"/> Other                                   |                                   |
| <b>Other Devices</b>                                  |                |                              |   |                                   |
| <input type="checkbox"/> Length Measuring Device      | 24 months      | \$60                         |   |                                   |
| <input type="checkbox"/> Taxi Cab Meter               | 24 months      | \$130                        |   |                                   |
| <input type="checkbox"/> Timing Device                | 24 months      | \$30                         |   |                                   |

**Total Fee Due** 185-00

**2. Establishment Type**

Provide a brief description of the establishment/business:

GROCERY STORE

Other licenses may be required depending on the type of business you are operating.

### 3. Acknowledgements and Signature

I hereby agree that I will comply with the applicable sections of the Wisconsin State Statutes, Administrative Code and the Milwaukee Code of Ordinances regarding the operation of weighing and measuring devices.

I understand that all devices must be operated within the specifications, tolerances and other technical requirements set forth in the National Institute of Standards and Technology Handbook 44.

I understand that the license for which I am applying must be posted on the premises or in my vehicle prior to opening for business or operating the device.

I understand that these device licenses are not transferable (with the exception of scanners). If the device is replaced or needs to be resealed, I must apply for and receive a new license so that an inspection of the device can be performed prior to its use.

I acknowledge that as a condition of being issued this license, I must allow the Health Department into the establishment to test the device to validate its specifications/tolerances. If my devices are found out of compliance, I may be charged inspection fees.

I have read, understand, and will adhere to all the above acknowledgments.



Signature of Sole Proprietor, Partner, 20% or more Shareholder  
or Agent – if there are no 20% or more shareholders

Date: 6/16/10

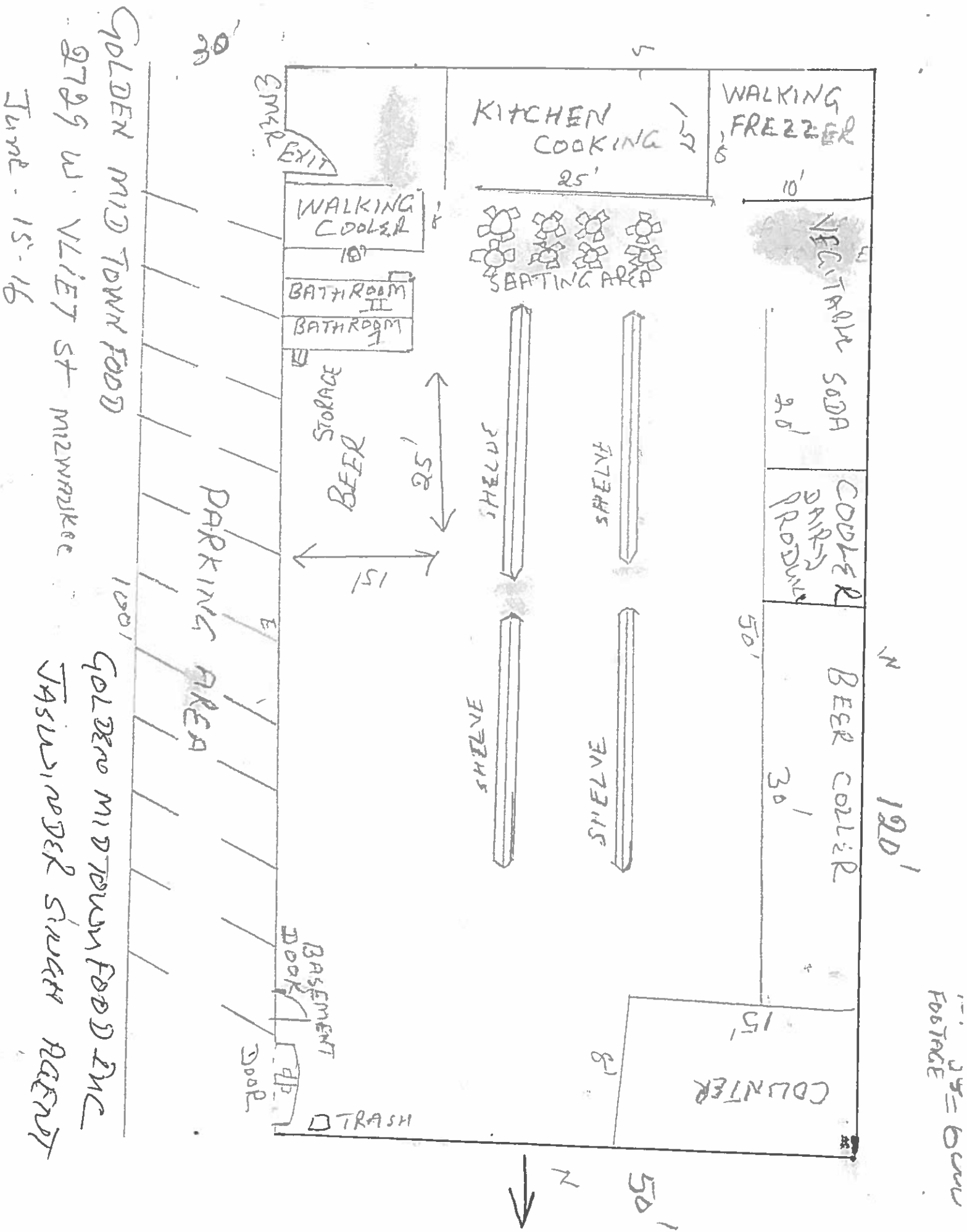

GOLDEN MID TOWN FOOD  
 9729 W. VLIET ST MILWAUKEE  
 June - 15-16

GOLDEN MID TOWN FOOD INC  
 JASWINDER SINGH RAGHU

1" = 6'00"

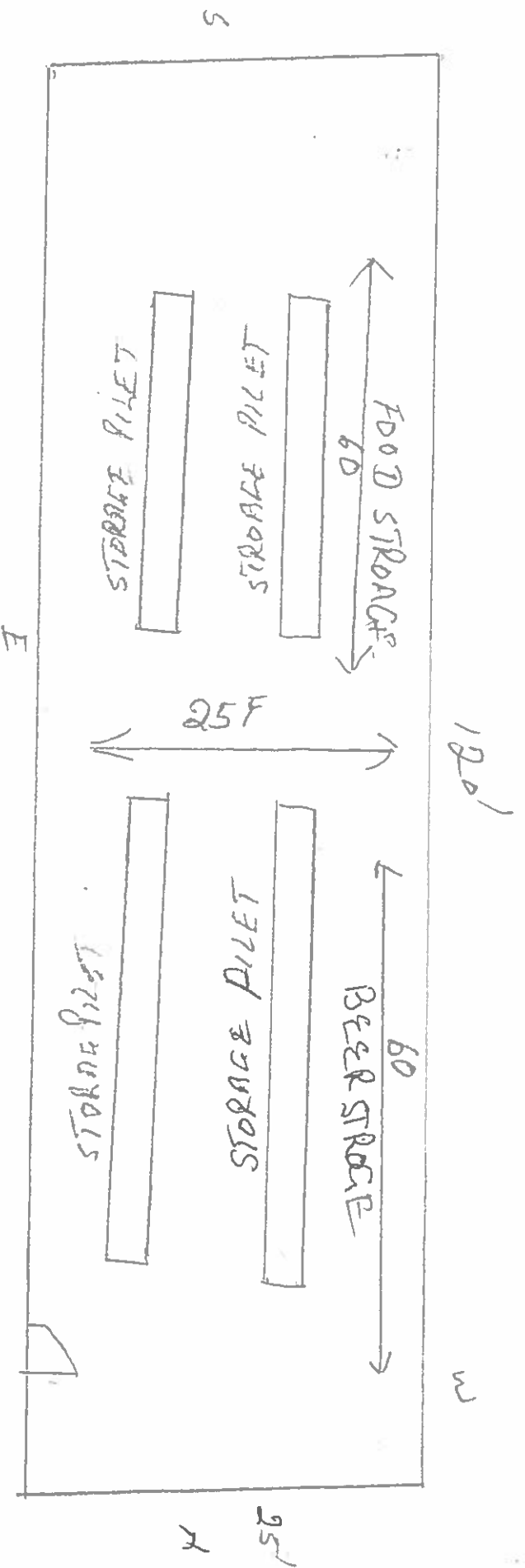

GOLDEN MIDDOWN FOOD

Basement

2799 W. WILLET ST

MILWAUKEE WI

JUNE 15 16

GOLDEN MIDDOWN FOOD INC

JASWINDER SUDHA AGENT