



CITY OF MILWAUKEE
OFFICE OF THE CITY CLERK

Tuesday, March 12, 2024

COMMITTEE MEETING NOTICE

AD 12

DARAR, Darshan S, Agent
THREE STAR PETROLEUM INC.
907 W Greenfield Av
Milwaukee, WI 53204

You are requested to attend a hearing which is to be held in Room 301-B, Third Floor, City Hall or you may attend virtually using the link below.

Tuesday, March 26, 2024 at 09:05 AM

The access code is <https://meet.goto.com/913368045>. If you wish to call in: **+1 (408) 650-3123** and use Access Code: **913-368-045**
Please see the enclosed best practices document for further instructions.

Regarding: Your Filling Station, Food Dealer and Weights & Measures License Applications as agent for "THREE STAR PETROLEUM INC." for "THREE STAR FOODS" at  W Greenfield Av.

There is a possibility that your application may be denied for one or more of the following reasons: The recommendation of the committee regarding the application shall be based on evidence presented at the hearing. Per MCO 85-2.7-4, probative evidence concerning whether or not a new license should be granted may be presented on the following subjects: whether or not the applicant meets the municipal requirements, the appropriateness of the location and premises where the licensed premises is to be located and whether use of the premises for the purposes or activities permitted by the license would tend to facilitate a public or private nuisance or create undesirable neighborhood problems such as disorderly patrons, unreasonably loud noise, litter, and excessive traffic and parking congestion. Probative evidence relating to these matters may be taken from the plan of operation submitted with the license application, if any, but shall not include the content of any music. Evidence regarding the fitness of the location of the premises to be maintained as the principal place of business, including but not limited to whether there is an overconcentration of businesses of the type for which the license is sought; whether the proposal is consistent with any pertinent neighborhood business or development plans, or the location's proximity to areas where children are typically present. The applicant's record in operating similarly licensed premises; and whether or not the applicant has been charged with or convicted of any felony, misdemeanor, municipal offense or other offense, the circumstances of which substantially relate to the activity to be permitted by the license being applied for or any other factor which reasonably relates to the public health, safety or welfare may also be considered. See attached police report or correspondence.

Notice for applicants with warrants or unpaid fines:

Proof of warrant satisfaction or payment of fines must be submitted at the hearing on the above date and time. Failure to comply with this requirement may result in a delay of the granting/denial of your application.

Failure to appear at this meeting may result in the denial of your license. Individual applicants must appear only in person or by an attorney. Corporate or Limited Liability applicants must appear only by the agent designated on the application or by an attorney. Partnership applicants must appear by a partner listed on the application or by an attorney. If you wish to do so and at your own expense, you may be accompanied by an attorney of your choosing to represent you at this hearing.

You will be given an opportunity to speak on behalf of the application and to respond and challenge any charges or reasons given for the denial. No petitions can be accepted by the committee, unless the people who signed the petition are present at the committee hearing and willing to testify. You may present witnesses under oath and you may also confront and cross-examine opposing witnesses under oath. If you have difficulty with the English language, you should bring an interpreter with you, at your expense, so that you can answer questions and participate in your hearing.

You may examine the application file at this office during regular business hours prior to the hearing date. Inquiries regarding this matter may be directed to the person whose signature appears below.

Limited parking for persons attending meetings during normal business hours is available at reduced rates (5 hour limit) at the Milwaukee Center on the southwest corner of Kilbourn Avenue and Water Street. You must present a copy of the meeting notice to the parking cashier.

PLEASE NOTE: Upon reasonable notice, efforts will be made to accommodate the needs of disabled individuals through sign language interpreters or other auxiliary aids. For additional information or to request this service, contact the Council Services Division ADA Coordinator at (414) 286-2998, Fax - (414) 286-3456, TDD - (414) 286-2025.

JIM OWCZARSKI, CITY CLERK

BY: _____

Jim Cooney
License Division Manager

If you have questions regarding this notice, please contact the License Division at (414) 286-2238.

200 E. Wells Street, Room 105, City Hall, Milwaukee, WI 53202. www.milwaukee.gov/license
Phone: (414) 286-2238 Fax: (414) 286-3057 Email Address: License@milwaukee.gov



**CITY OF MILWAUKEE
OFFICE OF THE CITY CLERK**

Tuesday, March 12, 2024

COMMITTEE MEETING NOTICE

AD 12

DARAR, Darshan S, Agent
THREE STAR PETROLEUM INC.
10710 GEIST RIDGE CT
Fishers, IN 46040

You are requested to attend a hearing which is to be held in Room 301-B, Third Floor, City Hall or you may attend virtually using the link below.

Tuesday, March 26, 2024 at 09:05 AM

The access code is <https://meet.goto.com/9133368045>. If you wish to call in: +1 (408) 650-3123 and use Access Code: 913-368-045
Please see the enclosed best practices document for further instructions.

Regarding: Your Filling Station, Food Dealer and Weights & Measures License Applications as agent for "THREE STAR PETROLEUM INC." for "THREE STAR FOODS" at 907 W Greenfield Av.

There is a possibility that your application may be denied for one or more of the following reasons: The recommendation of the committee regarding the application shall be based on evidence presented at the hearing. Per MCO 85-2.7-4, probative evidence concerning whether or not a new license should be granted may be presented on the following subjects: whether or not the applicant meets the municipal requirements, the appropriateness of the location and premises where the licensed premises is to be located and whether use of the premises for the purposes or activities permitted by the license would tend to facilitate a public or private nuisance or create undesirable neighborhood problems such as disorderly patrons, unreasonably loud noise, litter, and excessive traffic and parking congestion. Probative evidence relating to these matters may be taken from the plan of operation submitted with the license application, if any, but shall not include the content of any music. Evidence regarding the fitness of the location of the premises to be maintained as the principal place of business, including but not limited to whether there is an overconcentration of businesses of the type for which the license is sought; whether the proposal is consistent with any pertinent neighborhood business or development plans, or the location's proximity to areas where children are typically present. The applicant's record in operating similarly licensed premises; and whether or not the applicant has been charged with or convicted of any felony, misdemeanor, municipal offense or other offense, the circumstances of which substantially relate to the activity to be permitted by the license being applied for or any other factor which reasonably relates to the public health, safety or welfare may also be considered. See attached police report or correspondence.

Notice for applicants with warrants or unpaid fines:

Proof of warrant satisfaction or payment of fines must be submitted at the hearing on the above date and time. Failure to comply with this requirement may result in a delay of the granting/denial of your application.

Failure to appear at this meeting may result in the denial of your license. Individual applicants must appear only in person or by an attorney. Corporate or Limited Liability applicants must appear only by the agent designated on the application or by an attorney. Partnership applicants must appear by a partner listed on the application or by an attorney. If you wish to do so and at your own expense, you may be accompanied by an attorney of your choosing to represent you at this hearing.

You will be given an opportunity to speak on behalf of the application and to respond and challenge any charges or reasons given for the denial. No petitions can be accepted by the committee, unless the people who signed the petition are present at the committee hearing and willing to testify. You may present witnesses under oath and you may also confront and cross-examine opposing witnesses under oath. If you have difficulty with the English language, you should bring an interpreter with you, at your expense, so that you can answer questions and participate in your hearing.

You may examine the application file at this office during regular business hours prior to the hearing date. Inquiries regarding this matter may be directed to the person whose signature appears below.

Limited parking for persons attending meetings during normal business hours is available at reduced rates (5 hour limit) at the Milwaukee Center on the southwest corner of Kilbourn Avenue and Water Street. You must present a copy of the meeting notice to the parking cashier.

PLEASE NOTE: Upon reasonable notice, efforts will be made to accommodate the needs of disabled individuals through sign language interpreters or other auxiliary aids. For additional information or to request this service, contact the Council Services Division ADA Coordinator at (414) 286-2998, Fax - (414) 286-3456, TDD - (414) 286-2025.

JIM OWCZARSKI, CITY CLERK

BY: _____

Jim Cooney
License Division Manager

If you have questions regarding this notice, please contact the License Division at (414) 286-2238.

200 E. Wells Street, Room 105, City Hall, Milwaukee, WI 53202. www.milwaukee.gov/license
Phone: (414) 286-2238 Fax: (414) 286-3057 Email Address: License@milwaukee.gov



Tuesday, March 12, 2024



Notice of Public Hearing

Blank Notice

DARAR, Darshan S, Agent
THREE STAR FOODS at 907 W Greenfield Av
Filling Station, Food Dealer and Weights & Measures License Applications

Tuesday, March 26, 2024 at 9:05 AM

To whom it may concern:

The above application has been made by the above named applicant(s). This requires approval from the Licenses Committee and the Common Council of the City of Milwaukee. The hearing before the Licenses Committee will take place on 3/26/2024 at 9:05 AM in Room 301-B, Third Floor, City Hall. This is a public hearing. Those wishing to view the proceeding are able to do so via the City Channel – Channel 25 on Spectrum Cable – or on the Internet at <http://city.milwaukee.gov/citychannel>. Those wishing to provide oral testimony via phone or internet are asked to contact the staff assistant, Yadira Melendez at (414) 286-2775 or stasst5@milwaukee.gov for necessary information. Please make such requests no later than one business day prior to the start of the meeting. You are not required to attend the hearing, but please see the information below if you would like to provide testimony. Once the Licenses Committee makes its recommendation, this recommendation is forwarded to the full Common Council for approval at its next regularly scheduled hearing.

Important details for those wishing to provide information for the Licenses Committee to consider when making its recommendation:

1. The license application is scheduled to be heard at the above time. Due to other hearings running longer than scheduled, you may have to wait some time to provide your testimony.
2. You must appear in person and testify as to matters that you have personally experienced or seen. (You cannot provide testimony for your neighbor, parent or anyone else; this is considered hearsay and cannot be considered by the committee.)
3. No letters or petitions can be accepted by the committee (unless the person who wrote the letter or the persons who signed the petition are present at the committee hearing and willing to testify).
4. Persons opposed to the license application are given the opportunity to testify first; supporters may testify after the opponents have finished.
5. When you are called to testify, you will be sworn in and asked to give your name, and address. (If your first and/or last names are uncommon please spell them.)
6. You may then provide testimony.
 - a. Include only information relating to the above license application.
 - b. Include only information you have personally witnessed or seen.
 - c. Provide concise and relevant information detailing how this business has affected or may affect the peaceful enjoyment of your neighborhood.
 - d. If by the time you have the opportunity to testify, the information you wish to share has already been provided to the committee, you may state that you agree with the previous testimony. Redundant or repetitive testimony will not assist the committee in making its recommendation.
7. After giving your testimony, the members of the Licenses Committee and the licensee may ask questions regarding the testimony you have given or other factors relating to the license application.
8. Business Competition is not a valid basis for denial or non-renewal of a license.
Please Note: If you have submitted an objection to the above application your objection cannot be considered by the committee unless you personally testify at the hearing.

OCCUPANT	MAIL ADDRESS	CITY STATE ZIP
CURRENT OCCUPANT	1001 W GREENFIELD AVE	MILWAUKEE, WI 53204-2863
CURRENT OCCUPANT	1001 W GREENFIELD AVE# A	MILWAUKEE, WI 53204-2863
CURRENT OCCUPANT	1311 S 9TH ST	MILWAUKEE, WI 53204-2814
CURRENT OCCUPANT	1316 S 9TH ST	MILWAUKEE, WI 53204-2813
CURRENT OCCUPANT	1316A S 9TH ST	MILWAUKEE, WI 53204-2813
CURRENT OCCUPANT	1322 S 9TH ST	MILWAUKEE, WI 53204-2813
CURRENT OCCUPANT	1322A S 9TH ST	MILWAUKEE, WI 53204-2813
CURRENT OCCUPANT	1323 S 9TH ST	MILWAUKEE, WI 53204-2814
CURRENT OCCUPANT	1326 S 9TH ST	MILWAUKEE, WI 53204-2813
CURRENT OCCUPANT	1327 S 9TH ST	MILWAUKEE, WI 53204-2814
CURRENT OCCUPANT	1328 S 9TH ST	MILWAUKEE, WI 53204-2813
CURRENT OCCUPANT	1334 S 9TH ST	MILWAUKEE, WI 53204-2813
CURRENT OCCUPANT	1334A S 9TH ST	MILWAUKEE, WI 53204-2813
CURRENT OCCUPANT	1336 S 9TH ST	MILWAUKEE, WI 53204-2813
CURRENT OCCUPANT	1338 S 9TH ST	MILWAUKEE, WI 53204-2813
CURRENT OCCUPANT	1404 S 10TH ST	MILWAUKEE, WI 53204-2854
CURRENT OCCUPANT	1413 S 10TH ST	MILWAUKEE, WI 53204-2855
CURRENT OCCUPANT	1414 S 10TH ST	MILWAUKEE, WI 53204-2854
CURRENT OCCUPANT	1415 S 10TH ST	MILWAUKEE, WI 53204-2855
CURRENT OCCUPANT	1416 S 10TH ST	MILWAUKEE, WI 53204-2854
CURRENT OCCUPANT	1418 S 10TH ST	MILWAUKEE, WI 53204-2854
CURRENT OCCUPANT	1419 S 10TH ST	MILWAUKEE, WI 53204-2855
CURRENT OCCUPANT	1420 S 10TH ST	MILWAUKEE, WI 53204-2854
CURRENT OCCUPANT	1421 S 10TH ST	MILWAUKEE, WI 53204-2855
CURRENT OCCUPANT	1421A S 10TH ST	MILWAUKEE, WI 53204-2855
CURRENT OCCUPANT	1422 S 10TH ST	MILWAUKEE, WI 53204-2854
CURRENT OCCUPANT	1422 S 9TH ST	MILWAUKEE, WI 53204-2833
CURRENT OCCUPANT	1423 S 9TH ST	MILWAUKEE, WI 53204-2834
CURRENT OCCUPANT	1424 S 10TH ST	MILWAUKEE, WI 53204-2854
CURRENT OCCUPANT	1425 S 10TH ST	MILWAUKEE, WI 53204-2855
CURRENT OCCUPANT	1426 S 10TH ST	MILWAUKEE, WI 53204-2854
CURRENT OCCUPANT	1426 S 9TH ST	MILWAUKEE, WI 53204-2833
CURRENT OCCUPANT	1427 S 10TH ST	MILWAUKEE, WI 53204-2855
CURRENT OCCUPANT	1427 S 9TH ST	MILWAUKEE, WI 53204-2834
CURRENT OCCUPANT	1427A S 9TH ST	MILWAUKEE, WI 53204-2834
CURRENT OCCUPANT	1428 S 10TH ST	MILWAUKEE, WI 53204-2854
CURRENT OCCUPANT	1428 S 9TH ST	MILWAUKEE, WI 53204-2833
CURRENT OCCUPANT	1428A S 10TH ST	MILWAUKEE, WI 53204-2854
CURRENT OCCUPANT	1428A S 9TH ST	MILWAUKEE, WI 53204-2833
CURRENT OCCUPANT	1429 S 10TH ST	MILWAUKEE, WI 53204-2855
CURRENT OCCUPANT	1430 S 10TH ST	MILWAUKEE, WI 53204-2854
CURRENT OCCUPANT	1431 S 10TH ST	MILWAUKEE, WI 53204-2855
CURRENT OCCUPANT	1431 S 8TH ST	MILWAUKEE, WI 53204-2832
CURRENT OCCUPANT	1431 S 9TH ST	MILWAUKEE, WI 53204-2834
CURRENT OCCUPANT	1431A S 8TH ST	MILWAUKEE, WI 53204-2832
CURRENT OCCUPANT	1434 S 10TH ST	MILWAUKEE, WI 53204-2854

CURRENT OCCUPANT	1434 S 9TH ST	MILWAUKEE, WI 53204-2833
CURRENT OCCUPANT	1434 S 9TH ST# A	MILWAUKEE, WI 53204-2833
CURRENT OCCUPANT	1434 S 9TH ST# B	MILWAUKEE, WI 53204-2833
CURRENT OCCUPANT	1434A S 10TH ST	MILWAUKEE, WI 53204-2854
CURRENT OCCUPANT	1435 S 9TH ST	MILWAUKEE, WI 53204-2834
CURRENT OCCUPANT	1435A S 9TH ST	MILWAUKEE, WI 53204-2834
CURRENT OCCUPANT	1436 S 9TH ST	MILWAUKEE, WI 53204-2833
CURRENT OCCUPANT	1436A S 9TH ST	MILWAUKEE, WI 53204-2833
CURRENT OCCUPANT	1438 S 10TH ST	MILWAUKEE, WI 53204-2854
CURRENT OCCUPANT	1440 S 10TH ST	MILWAUKEE, WI 53204-2854
CURRENT OCCUPANT	1440A S 10TH ST	MILWAUKEE, WI 53204-2854
CURRENT OCCUPANT	1443 S 9TH ST	MILWAUKEE, WI 53204-2834
CURRENT OCCUPANT	1444 S 10TH ST	MILWAUKEE, WI 53204-2854
CURRENT OCCUPANT	1500 S 10TH ST	MILWAUKEE, WI 53204-2856
CURRENT OCCUPANT	1502 S 10TH ST	MILWAUKEE, WI 53204-2856
CURRENT OCCUPANT	1502 S 9TH ST	MILWAUKEE, WI 53204-2835
CURRENT OCCUPANT	1503 S 9TH ST	MILWAUKEE, WI 53204-2836
CURRENT OCCUPANT	1505 S 9TH ST	MILWAUKEE, WI 53204-2836
CURRENT OCCUPANT	1507 S 9TH ST	MILWAUKEE, WI 53204-2836
CURRENT OCCUPANT	816 W GREENFIELD AVE# 101	MILWAUKEE, WI 53204-2819
CURRENT OCCUPANT	816 W GREENFIELD AVE# 102	MILWAUKEE, WI 53204-2819
CURRENT OCCUPANT	816 W GREENFIELD AVE# 103	MILWAUKEE, WI 53204-2819
CURRENT OCCUPANT	816 W GREENFIELD AVE# 104	MILWAUKEE, WI 53204-2819
CURRENT OCCUPANT	816 W GREENFIELD AVE# 105	MILWAUKEE, WI 53204-2819
CURRENT OCCUPANT	816 W GREENFIELD AVE# 106	MILWAUKEE, WI 53204-2819
CURRENT OCCUPANT	816 W GREENFIELD AVE# 201	MILWAUKEE, WI 53204-2819
CURRENT OCCUPANT	816 W GREENFIELD AVE# 202	MILWAUKEE, WI 53204-2819
CURRENT OCCUPANT	816 W GREENFIELD AVE# 203	MILWAUKEE, WI 53204-2819
CURRENT OCCUPANT	816 W GREENFIELD AVE# 204	MILWAUKEE, WI 53204-2819
CURRENT OCCUPANT	816 W GREENFIELD AVE# 205	MILWAUKEE, WI 53204-2819
CURRENT OCCUPANT	816 W GREENFIELD AVE# 206	MILWAUKEE, WI 53204-2819
CURRENT OCCUPANT	816 W GREENFIELD AVE# 301	MILWAUKEE, WI 53204-2819
CURRENT OCCUPANT	816 W GREENFIELD AVE# 302	MILWAUKEE, WI 53204-2819
CURRENT OCCUPANT	816 W GREENFIELD AVE# 303	MILWAUKEE, WI 53204-2819
CURRENT OCCUPANT	816 W GREENFIELD AVE# 304	MILWAUKEE, WI 53204-2819
CURRENT OCCUPANT	816 W GREENFIELD AVE# 305	MILWAUKEE, WI 53204-2819
CURRENT OCCUPANT	816 W GREENFIELD AVE# 306	MILWAUKEE, WI 53204-2819
CURRENT OCCUPANT	828 W ORCHARD ST	MILWAUKEE, WI 53204-2840
CURRENT OCCUPANT	832 W GREENFIELD AVE	MILWAUKEE, WI 53204-2819
CURRENT OCCUPANT	904 W GREENFIELD AVE	MILWAUKEE, WI 53204-2822
CURRENT OCCUPANT	908 W GREENFIELD AVE	MILWAUKEE, WI 53204-2822
CURRENT OCCUPANT	910 W GREENFIELD AVE	MILWAUKEE, WI 53204-2822
CURRENT OCCUPANT	912 W GREENFIELD AVE	MILWAUKEE, WI 53204-2822
CURRENT OCCUPANT	914 W GREENFIELD AVE	MILWAUKEE, WI 53204-2822
CURRENT OCCUPANT	915 W MADISON ST	MILWAUKEE, WI 53204-2321
CURRENT OCCUPANT	916 W GREENFIELD AVE	MILWAUKEE, WI 53204-2822
CURRENT OCCUPANT	917 W MADISON ST	MILWAUKEE, WI 53204-2321

CURRENT OCCUPANT	917A W MADISON ST	MILWAUKEE, WI 53204-2321
CURRENT OCCUPANT	918 W GREENFIELD AVE	MILWAUKEE, WI 53204-2822
CURRENT OCCUPANT	919 W MADISON ST	MILWAUKEE, WI 53204-2321
CURRENT OCCUPANT	920 W GREENFIELD AVE	MILWAUKEE, WI 53204-2822
CURRENT OCCUPANT	924 W GREENFIELD AVE	MILWAUKEE, WI 53204-2822
CURRENT OCCUPANT	924A W GREENFIELD AVE	MILWAUKEE, WI 53204-2822
CURRENT OCCUPANT	925 W GREENFIELD AVE	MILWAUKEE, WI 53204-2823
CURRENT OCCUPANT	928 W GREENFIELD AVE	MILWAUKEE, WI 53204-2822
CURRENT OCCUPANT	931 W GREENFIELD AVE	MILWAUKEE, WI 53204-2823
CURRENT OCCUPANT	931 W GREENFIELD AVE# A	MILWAUKEE, WI 53204-2823
CURRENT OCCUPANT	931 W GREENFIELD AVE# B	MILWAUKEE, WI 53204-2823
CURRENT OCCUPANT	935A W GREENFIELD AVE	MILWAUKEE, WI 53204-2823
CURRENT OCCUPANT	939 W GREENFIELD AVE	MILWAUKEE, WI 53204-2823

Blank Notice

Total Records: 106

Radius 250.0 feet and Center of the Circle: 907 W Greenfield Av



APPLICATION AMENDMENT

Office of the City Clerk License Division
200 E. Wells Street, Room 105, Milwaukee, WI 53202 (414) 286-2238

ccl-amend 9/10/18

Date: 02/20/2024

To the License Division of the City of Milwaukee: THREE STAR PETROLEUM INC
I, DARSHAN S DARAR (full legal name), wish to amend my answer(s) on the application for a

PROCESSING FOOD (type of license) license at 907 W GREENFIELD AVE MILWAUKEE (premises address, if applicable)
WI 53204

by adding or amending the following information (complete only those sections being amended):

1. Answer to Question(s) # _____ should be: _____
2. Agent should be (full legal name): _____ Also complete 3, 4, 5 & 6
3. Date of birth should be: _____
4. Home address should be (include city/state/zip): _____
5. Phone number should be (include area code): _____
6. Driver's License Number/State ID Number should be: _____
7. Corporation/LLC name should be (full legal name): _____
8. Business name should be: _____
9. Premises address should be (include city/state/zip): _____
10. Business phone number should be (include area code): _____
11. Mailing address should be (include city/state/zip): _____
12. Email address should be: _____
13. Recycling/Salvaging/Towing: Location where vehicle will be parked should be (include city/state/zip): _____
14. Class B Tavern: Age Distinction should be: _____
15. Other: I want food processing licence, Cappiccino Machine
Coffee Machine with Grinding
(Check with the License Division before submitting "Other" amendments using this form.)

Darshan S. Darar
Signature of Licensee (Individual, Partner, or Agent of Corp/LLC)

Office Use Only: Application #: 360507 Date: 2.23.24 Initials: TR To LC: _____
LC Email: MPD NS HD Initials: _____



APPLICATION AMENDMENT

Office of the City Clerk License Division
200 E. Wells Street, Room 105, Milwaukee, WI 53202 (414) 286-2238

Date: 01/22/24

To the License Division of the City of Milwaukee:

DARSHANI S. DARAR THREE STAR PETROLEUM INC, wish to amend my answer(s) on the application for a
(full legal name)

24 HRS App# 360505 license at 907 W GREENFIELD AVE MILWAUKEE
(type of license) (premises address, if applicable) WI 53204

by adding or amending the following information (complete only those sections being amended):

1. Answer to Question(s) # _____ should be: _____
2. Agent should be (full legal name): _____ Also complete 3, 4, 5 & 6
3. Date of birth should be: _____
4. Home address should be (include city/state/zip): _____
5. Phone number should be (include area code): _____
6. Driver's License Number/State ID Number should be: _____
7. Corporation/LLC name should be (full legal name): _____
8. Business name should be: _____
9. Premises address should be (include city/state/zip): _____
10. Business phone number should be (include area code): _____
11. Mailing address should be (include city/state/zip): _____
12. Email address should be: _____
13. Recycling/Salvaging/Towing: Location where vehicle will be parked should be (include city/state/zip): _____
14. Class B Tavern: Age Distinction should be: _____
15. Other: Withdraw 24 Hours Application
Extended

(Check with the License Division before submitting "Other" amendments using this form.)

Darshan S. Darar
Signature of Licensee (Individual, Partner, or Agent of Corp/LLC)

Office Use Only: Application #: 360505 Date: 1.23.24 Initials: TR To LC: _____
LC Email: MPD NS HD Initials: _____



BUSINESS LICENSE PLAN OF OPERATION

ccl-busplan 5/12/2020

Office of the City Clerk License Division
200 E. Wells St. Room 105, Milwaukee, WI 53202
(414) 286-2238 www.milwaukee.gov/license e-mail address: license@milwaukee.gov

1. Type of Business

Applying for: Extended Hours (12AM to 5AM) - If a food establishment, check all that apply: Delivery Drive Thru Dining Room
 Self Service Laundry Massage Establishment Filling Station
 Other (supplemental application for specific license also required)

Provide a detailed description of the type of business you plan on operating:

GAS-STATION / C-STORE

Do you have any experience operating this type of business? No Yes If yes, explain: we operate over 40 stores in

Other States.

2. Business Operations

- a. Proposed Opening Date: JAN / 23 / 2024
- b. Is this premise under construction? No Yes If yes, list estimated completion date: _____
- c. Is this a franchise? No Yes
- d. Is this premises currently licensed? No Yes If yes, list type of license: TOBACCO, OCCUPANCY, Weight & Measure
- e. Is the current licensee operating? No Yes If no, list date closed: _____
- f. Do you have future plans for other businesses, licenses or permits at this location? No Yes
If yes, explain: _____
- g. Have you previously held an Extended Hours License in Milwaukee? No Yes
If yes, list address(es): _____
- h. Are other businesses operating in the same building? No Yes If yes, describe: _____

3. Litter & Noise

- a. How are grounds kept clean? Sweep Pressure Wash Pick Up Litter Other: Clean Every 4 HOURS
- b. How often will grounds be cleaned? Daily Weekly As Needed Monthly Other: _____
- c. Grounds cleaned by: Licensee Building Owner Employees Hired Maintenance Other: _____
- d. How are noise issues prevented and/or addressed? Security Manager approaches customer(s) Call Police
 Signs Posted Other: _____
- e. Will a sound amplification system be used? No Yes If yes, describe: _____

4. Smoking & Sanitation

- a. Are there designated outdoor smoking areas? No Yes If yes, describe: NO-SMOKING 10ft from Building
- b. Number of Garbage Cans: Inside: 4 Locations: Every Corner
Outside: 6 Locations: 4 By the Pumps, 2 in front
- c. Is a crowd control barrier used? No Yes If yes, describe: _____
- d. How many restrooms are on the premises? 2
- e. Name of solid waste contractor: Advanced Disposal Waste Management Other: _____

5. Security

- a. Are there onsite parking spaces? No Yes If yes, how many? 12 and describe the parking security plan: By Security cameras
- b. Is there a loading zone? No Yes If yes, describe the loading area security plan: _____
- c. Will you have security personnel on premise? No Yes If yes, how many? _____ and answer the following:
 What are their responsibilities? _____
 Is security equipment used? No Yes If yes, describe _____
 List their licensing, certification, or training credentials _____
- d. Will there be security cameras? No Yes If yes, how many? 16 and list locations: All around Pumps & Building and 6 Inside
- e. Will searches/identification checks be done upon entry? No Yes If yes, describe _____

6. Percentage of Sales (must total 100%)

Alcohol <u>N/A</u> %	Food <u>40</u> %	Secondhand Merchandise _____ %	Precious Metals & Gems _____ %
Entertainment <u>N/A</u> %	Cigarettes <u>30</u> %	_____ %	_____ %
Pawnbroker Activity _____ %	Salvaged Materials _____ % (such as scrap metal)	Personal Services (such as tattoo, body piercing, salon, tailor, tanning, etc.) _____ %	Other <u>30</u> % Describe: <u>Gasoline</u>

7. Businesses/Licenses on the Premises (check all that apply):

Type 1

- Full Service Restaurant Cafe/Coffee Shop Deli or Fast Food Restaurant Private/Fraternal/Veterans Club
- Night Club Tavern Cocktail Lounge Teen Club
- Banquet Hall Sports Facility Bowling Alley
- Hotel/Motel: Number of Floors: _____ Number of Rooms: _____
 Rooming House: Number of Floors: _____ Number of Rooms: _____

Type 2

- Liquor Store Corner Store Supermarket Convenience Store
- Gas Station Amusement/Phonograph Distributor Recycling, Salvage or Towing
- Used Car Dealer Personal Service Establishment (such as tattoo business, hair salon, tailor, etc.) Recording Studio

What other licenses/permits will you hold at this location? (check all that apply)

- Occupancy Permit Cigarette & Tobacco Gas Station Extended Hours Class "B" Tavern Weights & Measures
- Secondhand Dealer Precious Metal & Gem Other: _____

8. Legal Capacity (only if a Type 1 premises in #7 above)

Capacity _____ (Call the Milwaukee Development Center at 414-286-8211 if you have questions.)

9. Premises Description

a. Identify all area(s) of the premises that will be used in operating this business (include areas used only for storage):

1st Floor 2nd Floor Basement Storage Patio Beer Garden Sidewalk Café Deck Rooftop

Other: Describe: _____

b. Describe Location: Major Thoroughfare Secondary Street Other: _____

c. Nearest Major Cross Street: 9th and greenfield ave

d. Describe Building: Free Standing Building Strip Mall Other: _____

e. Describe Premises Structure: Single Story Multi-Story - # of Stories _____ Other: _____

f. Describe Surrounding Area: Commercial Residential Industrial Other: _____

g. Building Owner Name: SEI 7/11 Phone Number: 513-806-6812

Building Owner Address: 907 W GREENFIELD AV MILWAUKEE WI 53204

10. Hours of Operation & Customers

Will customers be entering the premises? No Yes

Day of the Week	Proposed Hours of Operation:		Estimated Number of Customers expected each day	Potential Age Range of Customers	Class B Tavern Applicant Only: Age Restriction (If none, write 'None')
	Open Time (include a.m. or p.m.)	Close Time (include a.m. or p.m.)			
Sunday	12:00 AM	11:59 PM	500	0-100	
Monday	12:00 AM	11:59 PM	500	0-100	
Tuesday	12:00 AM	11:59 PM	500	0-100	
Wednesday	12:00 AM	11:59 PM	500	0-100	
Thursday	12:00 AM	11:59 PM	600	0-100	
Friday	12:00 AM	11:59 PM	700	0-100	
Saturday	12:00 AM	11:59 PM	500	0-100	

An Extended Hours Establishment License is required for any convenience store, filling station, personal service establishment (such as tattoo, body piercing, salon, tailor, tanning, etc.), recording studio or restaurant which is open between the hours of 12:00 a.m. and 5:00 a.m.

Alcohol Establishments Class A: 8:00 am to 9:00 pm Sunday thru Saturday
 Permitted Hours of Operation: Class B: 6:00 am to 2:00 am Sunday thru Thursday, 6:00 am to 2:30 am Friday & Saturday

Entertainment Outdoor Closing Hours: 10:00pm Sunday-Thursday; 12:00am Friday & Saturday; unless a different time, either earlier or later, is established by the Common Council in its approval of the licensee's plan of operation.

11. Signature(s)

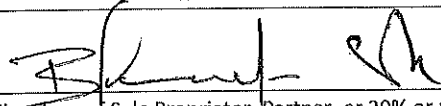
 Signature of Sole Proprietor, Partner, or 20% or more Shareholder
 (If there are no 20% or more shareholders,
 Corporate Officer-print name/title and sign)

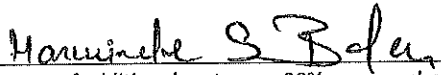
 Signature of additional partner or 20% or more shareholder

See Application Information for a complete list of all required application forms.



**FILLING STATION LICENSE AND
WEIGHTS & MEASURES (RETAIL PETROLEUM METERS)
LICENSE SUPPLEMENTAL APPLICATION**

OFFICE OF THE CITY CLERK, LICENSE DIVISION
CITY HALL, 200 E. WELLS ST, ROOM 105, MILWAUKEE, WI 53202
(414) 286-2238 • license@milwaukee.gov • www.milwaukee.gov/license

Legal Entity Name: THREE STAR PETROLEUM INC

Premise Address: 907 W @ greenfield AVE Milwaukee WI 53204

Filling Station License Fee \$ 275

Weights & Measures License Fee
Number of Retail Petroleum Meters* 40 x \$60 per meter = \$ 2400

*For each nozzle, count the number of grades (not including midgrade if mixed in the pump), add the number of all grades together and that is your number of retail petroleum meters.

Will electronic scanners be used to determine/record the price of items? No Yes
Will scales be used to price items based on their weight? No Yes
If yes to either or both questions, a separate Weights & Measures License Application must be submitted for these devices.

Acknowledgements and Signature

I confirm that all information is true and correct. I understand any changes to the information in this application must be reported to the City Clerk License Division within 10 days. I have knowledge of the City of Milwaukee ordinances currently regulating the licenses applied for and understand that the licenses may be subject to suspension, non-renewal, or revocation if I violate these regulations.

[Signature]
Signature of Sole Proprietor, Partner, or 20% or more Shareholder
(If no 20% or more Shareholder, Corporate Officer must sign and provide title)

[Signature]
Signature of Additional Partner or 20% or more Shareholder

Submit this form with the following:

- Business License Application
- Business Plan of Operation
- Floor plan
- License fees

Forms can be obtained online at www.milwaukee.gov/licenses

Office Use Only:

App#	_____	Filed	_____	Initials	_____
Paid	_____	MPD	_____	CC	_____
HD	_____	DNS	_____	Lic #	_____



WEIGHTS & MEASURES PLAN OF OPERATION

ccl-wmplan 1/9/18

Office of the City Clerk License Division
200 E. Wells St. Room 105, Milwaukee, WI 53202
(414) 286-2238 www.milwaukee.gov/license license@milwaukee.gov

Legal Entity Name: THREE STAR PETROLEUM INC

Premise Address: 907 W Greenfield Ave, Milwaukee WI 53204

Type of Business

Provide a brief description of the establishment/business:

GAS STATION

Other licenses may be required depending on the type of business you are operating.

Litter & Noise

- a. How are grounds kept clean? Sweep Pressure Wash Pick Up Litter Other: 4 TIMES EVERY HOUR
- b. How often will grounds be cleaned? Daily Weekly As Needed Monthly Other: _____
- c. Grounds cleaned by: Licensee Building Owner Employees Hired Maintenance Other: _____
- d. How are noise issues prevented and/or addressed? Security Manager approaches customer(s) Call Police
 Signs Posted Other: _____

Signature

Signature of Sole Proprietor, Partner, or 20% or more Shareholder
(If there are no 20% or more shareholders,
Corporate Officer-print name/title and sign)

Signature of additional partner or 20% or more shareholder

This form must be submitted with the Business License Application, Weights & Measures License Supplemental Application, and appropriate fee. Forms can be obtained online at www.milwaukee.gov/licenses.



FOOD DEALER LICENSE PLAN OF OPERATION

ccl-foodplan 2/28/19

OFFICE OF THE CITY CLERK, LICENSE DIVISION
CITY HALL, 200 E. WELLS ST, ROOM 105, MILWAUKEE, WI 53202
(414) 286-2238 • license@milwaukee.gov • www.milwaukee.gov/license

Legal Entity Name: THREE STAR PETROLEUM INC

Premises Address: 907 W GREEN FIELD AVE MILWAUKEE WI 53204

SECTION 1 TYPE OF BUSINESS

What will be the majority of your food sales? (check one)

Restaurant Items (meals):
MEALS include, but are not limited to, chicken, ribs, sandwiches, roasted corn, baked potatoes, hot dogs, brats, tacos, nachos w/ cheese and meat, French fries, cooked or deep fried vegetables/fruit, cooked cheese curds, corn dogs, egg rolls, salads.

Retail Items (snacks and beverages):
RETAIL items include, but are not limited to, ice cream/soft serve, lemonade, snow cones, coffee, espresso, cappuccino, tea, fruit juice, smoothies, candy, dispensed soda, fruit cups, bakery, cookies, kettle corn, cotton candy, funnel cakes, fritters, tortilla chips w/ cheese.

Will it be a convenience store? Yes No
A convenience store contains less than 5,000 square feet of retail space and has, as its primary business, the sale of basic food items and in addition, sells household products or is a filling station that sells basic food items and household products.

Bed & Breakfast
 Micro Market

All Applicants: Submit a menu or a list of food items that will be sold.

Will any wholesale business be done? No Yes If yes, what percentage of food sales will be wholesale?

Less than 25%

25% or More AND:
 Restaurant items (meals) will be sold – Complete this application and also contact DATCP.
 NO restaurant items (meals) will be sold - Do NOT complete this application. Contact DATCP only.

SECTION 2 FOOD PROCESSING

Will any food processing be done? No Yes

Processing is defined as assembling, grinding, cutting, mixing, baking, coating, stuffing, packing, bottling, grilling, canning, extracting, fermenting, distilling, pickling, freezing, drying, smoking, or packaging.

SECTION 3 FOOD REQUIRING TEMPERATURE CONTROL

Will any food that requires temperature control be sold? No Yes
(includes dairy products such as milk, cheese, and ice cream, fish, shellfish, meat, poultry)

If yes, list the types of food items: MILK, ICE CREAM, CHEESE, BUTTER

SECTION 4 DETAILS OF OPERATION

Will you have seating on site for dining? No Yes
 Will you be doing any catering? No Yes
 Will you be doing any delivery? No Yes
 Will you have outdoor activities? No Yes - Check all that apply: Bar Cooking/Grilling Dining
 Will you have a drive thru window? No Yes - Are hours different from inside? No Yes
 If Yes, provide drive thru hours: _____
 Will scales or barcode scanners be used? No Yes - You must also apply for a Weights & Measures License.

SECTION 5 ADDITIONAL SITES

Where will food be prepared and/or sold?
 At a single site At multiple sites: How many? _____ (for example, a hotel with several dining rooms or bars)
 If multiple sites, attach a Food Dealer Additional Site Addendum (ccl-foodadd) for each additional site.

SECTION 6 CONSTRUCTION OR CHANGES

Are you planning any construction, remodeling or equipment changes?
 No If No, SKIP to Section 7
 Yes If Yes, check all that apply: New construction of a building Renovation or remodeling
 Construction changes to existing building Equipment changes only
 Provide a brief description of the changes: _____
 Start date: _____
 Name, Address & Phone Number of Architect: THOMAS
 Name, Address & Phone Number of Contractor: THOMAS 513-806-6812
907W greenfield Ave Milwaukee WI

SECTION 7 ALCOHOL BEVERAGES

Are you applying for an alcohol beverage license?
 No If No, SKIP to Section 8
 Yes If YES, if your food license is approved prior to the alcohol license, when do you want the food license issued?
 Immediately At the same time as the alcohol license

SECTION 8 ACKNOWLEDGEMENTS & SIGNATURE

You must initial each item confirming your understanding:

- BS I understand the Health Department must conduct an inspection and advise the License Division of their approval before the license may be issued.
- BS I understand I must obtain an occupancy permit from the Department of Neighborhood Services and an inspection may be required. Neighborhood Services must advise the License Division of their approval before the license may be issued.
- BS I understand the district alderperson will review and either support or object to my application. If he/she objects, I may appeal and be scheduled to appear before the Licenses Committee. The Licenses Committee will then make a recommendation to the Common Council. The Common Council must grant the license before it may be issued.
- BS I understand proof of payment for all license fees must be on file in the License Division before the license may be issued and the license must be issued and posted in my establishment prior to opening for business.
- BS I will not operate my food business until the license has been issued and posted in the establishment.

Signature of Sole Proprietor, Partner, or 20% Shareholder: _____

Signature of Additional Partner: Haninder S. Bala



**WEIGHTS & MEASURES LICENSE
SUPPLEMENTAL APPLICATION**

OFFICE OF THE CITY CLERK, LICENSE DIVISION
CITY HALL, 200 E. WELLS ST, ROOM 105, MILWAUKEE, WI 53202
(414) 286-2238 • license@milwaukee.gov • www.milwaukee.gov/license

Office Use Only:

App# WEM 31005
Filed _____
Initials _____
Paid _____
Lic # _____

Legal Entity Name: THREE STAR PETROLEUM INC

Premise Address: 907 W Greenfield Ave Milwaukee, WI 53204

Device Type(s)

- Check all device types for which you need a license.
 - For each device type checked, indicate how many you have in the Number of Devices column (b).
 - Calculate the Total Fee Per Device Type by multiplying the Fee Per Device Type (a) by the Number of Devices (b).
 - Add all Total Fee Per Device Type amounts together and that will be your Total Fee Due.
- * **Exception:** The Scanner fee is not per device. Check the box for the appropriate range.
If you have 1-3 scanners, the total due is \$130. If you have 4 or more scanners, the total due is \$250.
Check the Number of Devices (b).

Device Type	License Period	Fee Per Device Type (a)	Number of Devices (b)	Total Fee Per Device Type (a x b)
Liquid Measuring Devices				
<input type="checkbox"/> Retail Petroleum Meters	12 months	\$60		
<input checked="" type="checkbox"/> 0 to 30 gallons per minute	24 months	\$60		
<input type="checkbox"/> 31 to 200 gallons per minute	24 months	\$250		
<input type="checkbox"/> Over 200 gallons per minute	24 months	\$250		
Scales				
<input type="checkbox"/> Measuring any weight amount	24 months	\$55		
Scanners				
		Fee for scanners is by range	Check how many scanners you have	
<input checked="" type="checkbox"/> Up to 3 scanners	24 months	\$130 total*	<input type="checkbox"/> 1 <input checked="" type="checkbox"/> 2 <input type="checkbox"/> 3	
<input type="checkbox"/> Four or more scanners	24 months	\$250 total*	<input type="checkbox"/> 4 <input type="checkbox"/> Other	
Other Devices				
<input type="checkbox"/> Length Measuring Device	24 months	\$60		
<input type="checkbox"/> Timing Device	24 months	\$30		
Total Fee Due				130.00

Signature

I hereby agree that I will comply with the applicable sections of the Wisconsin State Statutes, Administrative Code and the Milwaukee Code of Ordinances regarding the operation of weighing and measuring devices.

I understand that all devices must be operated within the specifications, tolerances and other technical requirements set forth in the National Institute of Standards and Technology Handbook 44. I understand that the license for which I am applying must be posted on the premises or in my vehicle prior to opening for business or operating the device.

I understand that these device licenses are not transferable (with the exception of scanners). If the device is replaced or needs to be resealed, I must apply for and receive a new license so that an inspection of the device can be performed prior to its use. I acknowledge that as a condition of being issued this license, I must allow the Health Department into the establishment to test the device to validate its specifications/tolerances. If my devices are found out of compliance, I may be charged inspection fees. I have read, understand, and will adhere to all the above acknowledgments.

[Signature]
Signature of Sole Proprietor, Partner, or 20% or more Shareholder
(If there are no 20% or more shareholders, Corporate Officer-print name/title and sign)

[Signature]
Signature of additional partner or 20% or more shareholder

This form must be submitted with the Business License Application, Weights & Measures Plan of Operation, and appropriate fee. Forms can be obtained online at www.milwaukee.gov/licenses.

TOTAL SQUARE
foot
= 4500

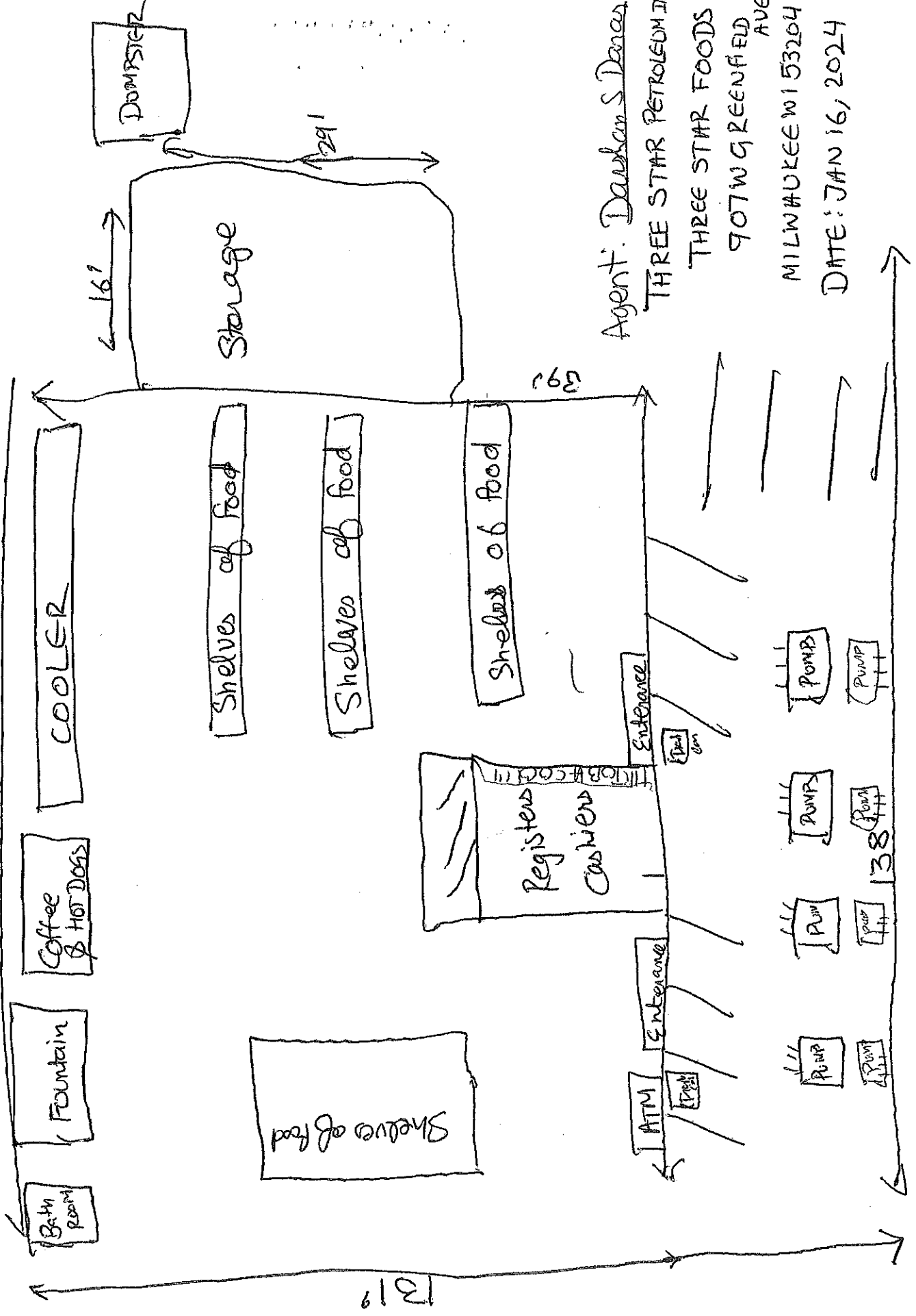

Agent: Dawson S. Dancy
 THREE STAR PETROLEUM INC.
 THREE STAR FOODS
 907 W GREENFIELD
 AVE
 MILWAUKEE WI 53204
 DATE: JAN 16, 2024

