



Certificate of Appropriateness

Milwaukee Historic Preservation Commission/841 N Broadway/Milwaukee, WI 53202/phone 414-286-5722

Property Description of work

1501 N. Marshall St., Graham Row

Install an exhaust vent for a residential range hood on the north elevation per the attached plans. Vent painted to match existing trim paint.

Date issued 7/25/2025

In accordance with the provisions of Section 320-21 (11) and (12) of the Milwaukee Code of Ordinances, the Milwaukee Historic Preservation Commission has issued a certificate of appropriateness for the work listed above. The work was found to be consistent with preservation guidelines. The following conditions apply to this certificate of appropriateness:

N/A

All work must be done in a craftsman-like manner. Staff must approve any changes or additions to this certificate before work begins. Work that is not completed in accordance with this certificate may be subject to correction orders or citations. If you require technical assistance, please contact Historic Preservation staff as follows: Phone: (414) 286-5722 E-mail: hpc@milwaukee.gov.

Permits and timeline

You are responsible for determining if permits are required and obtaining them prior to commencing work. Consult the Development Center on the web or by telephone for details: www.milwaukee.gov/lms - (414) 286-8210. If permits are not required, work must be completed within one year of the date this certificate was issued. If permits are required, permits must be obtained within one year of the date this certificate was issued.

City of Milwaukee Historic Preservation

Copies to: Development Center



EXTERIOR STAINLESS STEEL THROUGH WALL VENT - PAINTED TO MATCH EXISTING TRIM PAINT

PROPOSED NEW WALL VENT LOCATION ON NORTH SIDE OF MASONRY WALL

ALTERNATE INTENDED LOCATION WOULD BE WITHIN 3'-0" OF AN OPERABLE WINDOW/DOOR



PLAN LEGEND		
EXISTING DOOR TO REMAIN	EXISTING DOOR TO BE REMOVED	NEW DOOR
EXISTING WALL TO REMAIN	EXISTING WALL TO BE REMOVED	NEW WALL
EXISTING WINDOW TO REMAIN	EXISTING WINDOW TO BE REMOVED	NEW WINDOW

A02
2

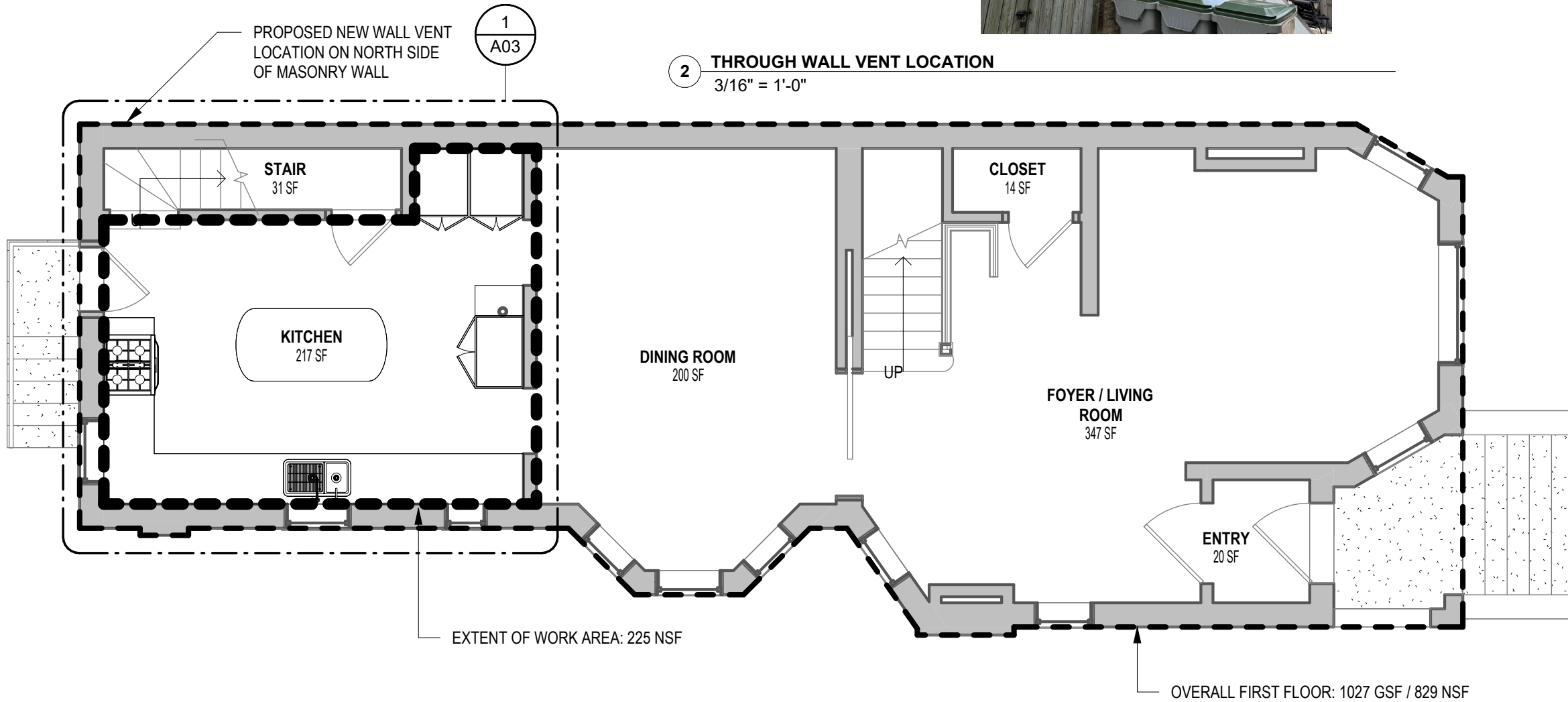

1 NEW WORK PLAN - FIRST FLOOR
3/16" = 1'-0"

2 THROUGH WALL VENT LOCATION
3/16" = 1'-0"