

Document Number

**AFFIDAVIT OF
CORRECTION FOR
CERTIFIED SURVEY MAP
NO. 8363**

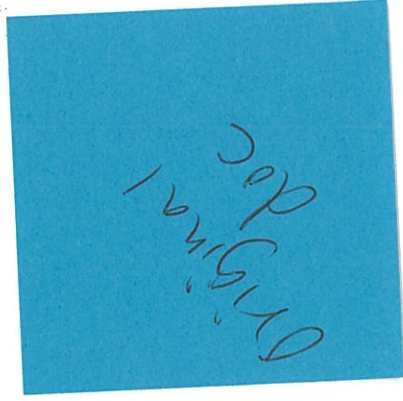

STATE OF WISCONSIN)
MILWAUKEE COUNTY) SS.

Recording Area

Name and Return Address
Benji Timm
City of Milwaukee - DCD
809 North Broadway - 2nd Floor
Milwaukee, WI 53202

AFFIDAVIT OF CORRECTION

WHEREAS, AFFILIANT, Baiba Rozite, a surveyor for The Sigma Group ("Sigma"), hereby swears and affirms as follows:

1. The Redevelopment Authority of the City of Milwaukee ("RACM") owns Lot 3 of Certified Survey Map ("CSM") 8363. The address and TIN for said Lot 3 are:

Address: 2725 West Hopkins Street, Milwaukee, WI
TIN: 269-0443-000
2. RACM hired Sigma to do survey work regarding said Lot 3. Baiba Rozite, a surveyor for Sigma did that survey work.
3. CSM 8363 was approved by the City of Milwaukee ("City") Common Council and then recorded in the Milwaukee County Register of Deeds Office ("ROD") on June 27, 2011 as Document No. 10009389.
4. On Page 1 of CSM 8363, on Lot 3 the reference to a "10' ELECTRICAL EASEMENT DOC. NO. 3909211," is hereby changed to "10' GAS EASEMENT DOC. NO. 3909211," as reflected in the actual wording of said document.
5. Also, as indicated, on page 1 of CSM 8363 the location of the 10' wide easement area described in Document No. 3909211 is corrected as shown in attached Exhibit A, based on the metes and bounds description contained in said Document No. 3909211.
6. I make and record this Affidavit to correct the errors, stated above.

This correction is authorized by Wis. Stat. 706.085.

Signed: [Signature] 8-12-2014
Baiba Rozite, Wisconsin Registered Land Surveyor, No. S-2351

STATE OF WISCONSIN)
MILWAUKEE COUNTY) SS.

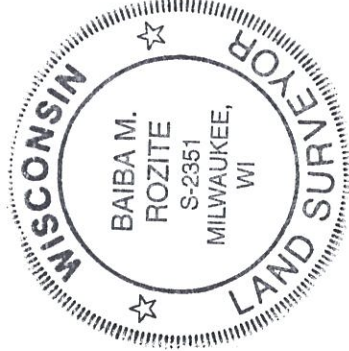

Subscribed and sworn to (or affirmed) before me this 12 day of August, 2014.

Notary Public: David L. Czernicki

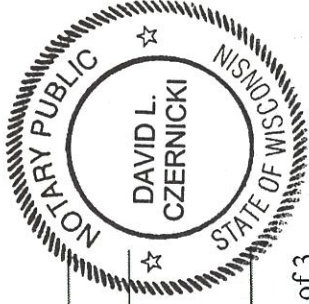

Notary Public, State of Wisconsin
My Commission (expires) (is): 1/17/2016

1 of 3

(Municipal Approval Stamps)

INFRASTRUCTURE SERVICES DIVISION
CENTRAL DRAFTING & RECORDS MANAGER
[Signature] 8-15-14
APPROVED
APPROVED
8/15/14 mgc

DEPARTMENT OF CITY DEVELOPMENT
CITY OF MILWAUKEE

JUL 11, 2014
[Signature]
STAFF APPROVED

STATE OF WISCONSIN)
MILWAUKEE COUNTY) SS

AFFIDAVIT OF CORRECTION FOR CERTIFIED SURVEY MAP NO. 8363

COMMON COUNCIL CERTIFICATE OF APPROVAL

I certify that this Affidavit of Correction for Certified Survey Map No. 8363 was approved under Resolution File No. 140722, adopted by the Common Council of the City of Milwaukee on September 3, 2014.



James R. Owczarski, City Clerk



Tom Barrett, Mayor

Tom Barrett, Mayor

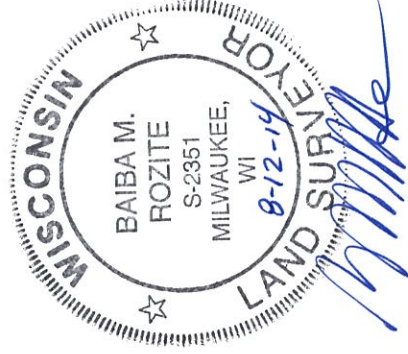

NW COR. NE 1/4
SEC. 12-7-21
BRASS CAP

W. CAPITOL DR. (width varies) N88° 28' 13"E 2691.29' (TOTAL)

N1/4 COR. SEC.
12-7-21
BRASS CAP

S1° 31' 47"E 72.00'

N0° 59' 20"W
100.00'

N89° 00' 40"E
69.90'

N89° 02' 23"E 190.16'

70'

S37° 53' 44"E 217.77'

(RW
width
varies)

10' GAS EASEMENT
DOC. #3909211

N. 31ST ST.

S0° 35' 01"E 273.31'

LOT 3
C.S.M. #83363

SOOLINE R.R.

N3° 54' 38"W 2983.97'
1622.28'

S36° 25' 17"E 2045.90'

W. HOPKINS ST.

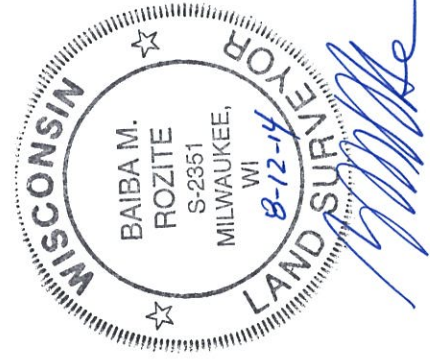

THE SIGMA
Single Source. Sound Solutions. GROUP
www.thesigmagroup.com
1300 West Canal Street
Milwaukee, WI 53233
Phone: 414-643-4200
Fax: 414-643-4210



EXHIBIT A