



**CITY OF MILWAUKEE
OFFICE OF THE CITY CLERK**

Thursday, January 11, 2024

COMMITTEE MEETING NOTICE

AD 09

QADIR, Shabbir, Agent
CH PETRO MART LLC
5958 S 18th St
Milwaukee, WI 53221

You are requested to attend a hearing which is to be held in Room 301-B, Third Floor, City Hall or you may attend virtually using the link below.

Tuesday, January 23, 2024 at 11:05 AM

The access code is <https://meet.goto.com/859644933>. If you wish to call in: [+1 \(224\) 501-3412](tel:+12245013412) and use Access Code: **859-644-933**
Please see the enclosed best practices document for further instructions.

Regarding: Your Extended Hours Establishments, Filling Station, Food Dealer and Weights & Measures License Applications Requesting To Open 24Hrs Everyday as agent for "CH PETRO MART LLC" for "Clark" at 6829 N 76TH St.



There is a possibility that your application may be denied for one or more of the following reasons: The recommendation of the committee regarding the application shall be based on evidence presented at the hearing. Per MCO 85-2.7-4, probative evidence concerning whether or not a new license should be granted may be presented on the following subjects: whether or not the applicant meets the municipal requirements, the appropriateness of the location and premises where the licensed premises is to be located and whether use of the premises for the purposes or activities permitted by the license would tend to facilitate a public or private nuisance or create undesirable neighborhood problems such as disorderly patrons, unreasonably loud noise, litter, and excessive traffic and parking congestion. Probative evidence relating to these matters may be taken from the plan of operation submitted with the license application, if any, but shall not include the content of any music. Evidence regarding the fitness of the location of the premises to be maintained as the principal place of business, including but not limited to whether there is an overconcentration of businesses of the type for which the license is sought; whether the proposal is consistent with any pertinent neighborhood business or development plans, or the location's proximity to areas where children are typically present. The applicant's record in operating similarly licensed premises; and whether or not the applicant has been charged with or convicted of any felony, misdemeanor, municipal offense or other offense, the circumstances of which substantially relate to the activity to be permitted by the license being applied for or any other factor which reasonably relates to the public health, safety or welfare may also be considered. See attached police report or correspondence.

**Notice for applicants with
warrants or unpaid fines:**

Proof of warrant satisfaction or payment of fines must be submitted at the hearing on the above date and time. Failure to comply with this requirement may result in a delay of the granting/denial of your application.

Failure to appear at this meeting may result in the denial of your license. Individual applicants must appear only in person or by an attorney. Corporate or Limited Liability applicants must appear only by the agent designated on the application or by an attorney. Partnership applicants must appear by a partner listed on the application or by an attorney. If you wish to do so and at your own expense, you may be accompanied by an attorney of your choosing to represent you at this hearing.

You will be given an opportunity to speak on behalf of the application and to respond and challenge any charges or reasons given for the denial. No petitions can be accepted by the committee, unless the people who signed the petition are present at the committee hearing and willing to testify. You may present witnesses under oath and you may also confront and cross-examine opposing witnesses under oath. If you have difficulty with the English language, you should bring an interpreter with you, at your expense, so that you can answer questions and participate in your hearing.

You may examine the application file at this office during regular business hours prior to the hearing date. Inquiries regarding this matter may be directed to the person whose signature appears below.

Limited parking for persons attending meetings during normal business hours is available at reduced rates (5 hour limit) at the Milwaukee Center on the southwest corner of Kilbourn Avenue and Water Street. You must present a copy of the meeting notice to the parking cashier.

PLEASE NOTE: Upon reasonable notice, efforts will be made to accommodate the needs of disabled individuals through sign language interpreters or other auxiliary aids. For additional information or to request this service, contact the Council Services Division ADA Coordinator at (414) 286-2998, Fax - (414) 286-3456, TDD - (414) 286-2025.

JIM OWCZARSKI, CITY CLERK

BY:

Jim Cooney
License Division Manager

If you have questions regarding this notice, please contact the License Division at (414) 286-2238.

200 E. Wells Street, Room 105, City Hall, Milwaukee, WI 53202. www.milwaukee.gov/license
Phone: (414) 286-2238 Fax: (414) 286-3057 Email Address: License@milwaukee.gov



Thursday, January 11, 2024



Notice of Public Hearing

Blank Notice

QADIR, Shabbir, Agent
Clark at 6829 N 76TH St

Extended Hours Establishments, Filling Station, Food Dealer and Weights & Measures License
Applications Requesting To Open 24Hrs Everyday

Tuesday, January 23, 2024 at 11:05 AM

To whom it may concern:

The above application has been made by the above named applicant(s). This requires approval from the Licenses Committee and the Common Council of the City of Milwaukee. The hearing before the Licenses Committee will take place on 1/23/2024 at 11:05 AM in Room 301-B, Third Floor, City Hall. This is a public hearing. Those wishing to view the proceeding are able to do so via the City Channel – Channel 25 on Spectrum Cable – or on the Internet at <http://city.milwaukee.gov/citychannel>. Those wishing to provide oral testimony via phone or internet are asked to contact the staff assistant, Yadira Melendez at (414) 286-2775 or stasst5@milwaukee.gov for necessary information. Please make such requests no later than one business day prior to the start of the meeting. You are not required to attend the hearing, but please see the information below if you would like to provide testimony. Once the Licenses Committee makes its recommendation, this recommendation is forwarded to the full Common Council for approval at its next regularly scheduled hearing.

Important details for those wishing to provide information for the Licenses Committee to consider when making its recommendation:

1. The license application is scheduled to be heard at the above time. Due to other hearings running longer than scheduled, you may have to wait some time to provide your testimony.
2. You must appear in person and testify as to matters that you have personally experienced or seen. (You cannot provide testimony for your neighbor, parent or anyone else; this is considered hearsay and cannot be considered by the committee.)
3. No letters or petitions can be accepted by the committee (unless the person who wrote the letter or the persons who signed the petition are present at the committee hearing and willing to testify).
4. Persons opposed to the license application are given the opportunity to testify first; supporters may testify after the opponents have finished.
5. When you are called to testify, you will be sworn in and asked to give your name, and address. (If your first and/or last names are uncommon please spell them.)
6. You may then provide testimony.
 - a. Include only information relating to the above license application.
 - b. Include only information you have personally witnessed or seen.
 - c. Provide concise and relevant information detailing how this business has affected or may affect the peaceful enjoyment of your neighborhood.
 - d. If by the time you have the opportunity to testify, the information you wish to share has already been provided to the committee, you may state that you agree with the previous testimony. Redundant or repetitive testimony will not assist the committee in making its recommendation.
7. After giving your testimony, the members of the Licenses Committee and the licensee may ask questions regarding the testimony you have given or other factors relating to the license application.
8. Business Competition is not a valid basis for denial or non-renewal of a license.
Please Note: If you have submitted an objection to the above application your objection cannot be considered by the committee unless you personally testify at the hearing.

OCCUPANT	MAIL ADDRESS	CITY STATE ZIP
CURRENT OCCUPANT	6754 N 77TH ST	MILWAUKEE, WI 53223-5624
CURRENT OCCUPANT	6756 N 77TH ST	MILWAUKEE, WI 53223-5624
CURRENT OCCUPANT	6758 N 77TH ST	MILWAUKEE, WI 53223-5624
CURRENT OCCUPANT	6760 N 77TH ST	MILWAUKEE, WI 53223-5624
CURRENT OCCUPANT	6761 N 76TH ST	MILWAUKEE, WI 53223-5611
CURRENT OCCUPANT	6762 N 77TH ST	MILWAUKEE, WI 53223-5624
CURRENT OCCUPANT	6763 N 76TH ST	MILWAUKEE, WI 53223-5611
CURRENT OCCUPANT	6764 N 76TH ST	MILWAUKEE, WI 53223-5612
CURRENT OCCUPANT	6764 N 77TH ST	MILWAUKEE, WI 53223-5624
CURRENT OCCUPANT	6767 N 76TH ST	MILWAUKEE, WI 53223-5611
CURRENT OCCUPANT	6769 N 76TH ST	MILWAUKEE, WI 53223-5611
CURRENT OCCUPANT	6770 N 76TH ST	MILWAUKEE, WI 53223-5612
CURRENT OCCUPANT	7501 W GREEN TREE RD# 1	MILWAUKEE, WI 53223-5024
CURRENT OCCUPANT	7501 W GREEN TREE RD# 10	MILWAUKEE, WI 53223-5025
CURRENT OCCUPANT	7501 W GREEN TREE RD# 11	MILWAUKEE, WI 53223-5025
CURRENT OCCUPANT	7501 W GREEN TREE RD# 12	MILWAUKEE, WI 53223-5025
CURRENT OCCUPANT	7501 W GREEN TREE RD# 13	MILWAUKEE, WI 53223-5025
CURRENT OCCUPANT	7501 W GREEN TREE RD# 14	MILWAUKEE, WI 53223-5025
CURRENT OCCUPANT	7501 W GREEN TREE RD# 2	MILWAUKEE, WI 53223-5024
CURRENT OCCUPANT	7501 W GREEN TREE RD# 3	MILWAUKEE, WI 53223-5024
CURRENT OCCUPANT	7501 W GREEN TREE RD# 4	MILWAUKEE, WI 53223-5024
CURRENT OCCUPANT	7501 W GREEN TREE RD# 5	MILWAUKEE, WI 53223-5024
CURRENT OCCUPANT	7501 W GREEN TREE RD# 6	MILWAUKEE, WI 53223-5024
CURRENT OCCUPANT	7501 W GREEN TREE RD# 7	MILWAUKEE, WI 53223-5024
CURRENT OCCUPANT	7501 W GREEN TREE RD# 8	MILWAUKEE, WI 53223-5025
CURRENT OCCUPANT	7501 W GREEN TREE RD# 9	MILWAUKEE, WI 53223-5025
CURRENT OCCUPANT	7609 W GREEN TREE RD	MILWAUKEE, WI 53223-4910
CURRENT OCCUPANT	7611 W GREEN TREE RD	MILWAUKEE, WI 53223-4910
CURRENT OCCUPANT	7615 W GREEN TREE RD	MILWAUKEE, WI 53223-4910
CURRENT OCCUPANT	7617 W GREEN TREE RD	MILWAUKEE, WI 53223-4910
CURRENT OCCUPANT	7700 W CASPER ST	MILWAUKEE, WI 53223-5630
CURRENT OCCUPANT	7701 W BEECHWOOD AVE	MILWAUKEE, WI 53223-4956
CURRENT OCCUPANT	7701 W GREEN TREE RD	MILWAUKEE, WI 53223-4912
CURRENT OCCUPANT	7702 W BEECHWOOD AVE	MILWAUKEE, WI 53223-4957
CURRENT OCCUPANT	7702 W GREEN TREE RD	MILWAUKEE, WI 53223-4913
CURRENT OCCUPANT	7710 W BEECHWOOD AVE	MILWAUKEE, WI 53223-4957
CURRENT OCCUPANT	7710 W GREEN TREE RD	MILWAUKEE, WI 53223-4913
CURRENT OCCUPANT	7713 W BEECHWOOD AVE	MILWAUKEE, WI 53223-4956
CURRENT OCCUPANT	7713 W GREEN TREE RD	MILWAUKEE, WI 53223-4912
CURRENT OCCUPANT	7718 W BEECHWOOD AVE	MILWAUKEE, WI 53223-4957
CURRENT OCCUPANT	7718 W GREEN TREE RD	MILWAUKEE, WI 53223-4913
CURRENT OCCUPANT	7719 W GREEN TREE RD	MILWAUKEE, WI 53223-4912
CURRENT OCCUPANT	7721 W BEECHWOOD AVE	MILWAUKEE, WI 53223-4956
CURRENT OCCUPANT	7726 W GREEN TREE RD	MILWAUKEE, WI 53223-4913
CURRENT OCCUPANT	7729 W BEECHWOOD AVE	MILWAUKEE, WI 53223-4956

Blank Notice

Total Records: 45

Radius 250.0 feet and Center of the Circle: 6829 N 76th St



BUSINESS LICENSE PLAN OF OPERATION

cel-busplan 5/12/2020

Office of the City Clerk License Division
200 E. Wells St. Room 105, Milwaukee, WI 53202
(414) 286-2238 www.milwaukee.gov/license e-mail address: business@milwaukee.gov

1. Type of Business

Applying for: ☒ Extended Hours (12AM to 5AM) - If a food establishment, check all that apply: ☐ Delivery ☐ Drive Thru ☐ Dining Room
☐ Self Service Laundry ☐ Massage Establishment ☒ Filling Station
☐ Other (supplemental application for specific license also required)

Provide a detailed description of the type of business you plan on operating: Gas Station C-STORE

Do you have any experience operating this type of business? ☐ No ☒ Yes If yes, explain: Manage station for 5 years

2. Business Operations

- a. Proposed Opening Date: 01/01/2024
- b. Is this premise under construction? ☒ No ☐ Yes If yes, list estimated completion date: _____
- c. Is this a franchise? ☒ No ☐ Yes
- d. Is this premises currently licensed? ☐ No ☒ Yes If yes, list type of license: Filling Station
- e. Is the current licensee operating? ☐ No ☒ Yes If no, list date closed: _____
- f. Do you have future plans for other businesses, licenses or permits at this location? ☒ No ☐ Yes
If yes, explain: CIGS, FOOD DEALER
- g. Have you previously held an Extended Hours License in Milwaukee? ☐ No ☒ Yes
If yes, list address(es): _____
- h. Are other businesses operating in the same building? ☒ No ☐ Yes if yes, describe: _____

3. Litter & Noise

- a. How are grounds kept clean? ☒ Sweep ☐ Pressure Wash ☒ Pick Up Litter ☐ Other: _____
- b. How often will grounds be cleaned? ☒ Daily ☐ Weekly ☐ As Needed ☐ Monthly ☐ Other: _____
- c. Grounds cleaned by: ☒ Licensee ☐ Building Owner ☒ Employees ☐ Hired Maintenance ☐ Other: _____
- d. How are noise issues prevented and/or addressed? ☐ Security ☒ Manager approaches customer(s) ☒ Call Police
☒ Signs Posted ☐ Other: _____
- e. Will a sound amplification system be used? ☒ No ☐ Yes If yes, describe: _____

4. Smoking & Sanitation

- a. Are there designated outdoor smoking areas? ☒ No ☐ Yes If yes, describe: _____
- b. Number of Garbage Cans: Inside: 4 Locations: Coffee Counter/Bathroom/ Exit door
Outside: 5 Locations: by Gas Pumps, and exit door
- c. Is a crowd control barrier used? ☒ No ☐ Yes If yes, describe: _____
- d. How many restrooms are on the premises? 2
- e. Name of solid waste contractor: ☐ Advanced Disposal ☒ Waste Management ☐ Other: _____

5. Security

- a. Are there onsite parking spaces? ☐ No ☒ Yes If yes, how many? 5 and describe the parking security plan: Security Camera
- b. Is there a loading zone? ☒ No ☐ Yes If yes, describe the loading area security plan: _____
- c. Will you have security personnel on premise? ☒ No ☐ Yes If yes, how many? _____ and answer the following:
 What are their responsibilities? _____
 Is security equipment used? ☒ No ☐ Yes If yes, describe _____
 List their licensing, certification, or training credentials _____
- d. Will there be security cameras? ☐ No ☒ Yes If yes, how many? 5 and list locations: Cash Register, 2 inside store, and Gas Pump
- e. Will searches/identification checks be done upon entry? ☒ No ☐ Yes If yes, describe _____

6. Percentage of Sales (must total 100%)

Alcohol _____%	Food <u>5</u> %	Secondhand Merchandise _____%	Precious Metals & Gems _____%
Entertainment _____%	Cigarettes <u>30</u> %		
Pawnbroker Activity _____%	Salvaged Materials _____% (such as scrap metal)	Personal Services (such as tattoo, body piercing, salon, tailor, tanning, etc.) _____%	Other <u>65</u> % Describe: <u>Gas/Labor</u>

7. Businesses/Licenses on the Premises (check all that apply):

Type 1

- ☐ Full Service Restaurant ☐ Cafe/Coffee Shop ☐ Deli or Fast Food Restaurant ☐ Private/Fraternal/Veterans Club
- ☐ Night Club ☐ Tavern ☐ Cocktail Lounge ☐ Teen Club
- ☐ Banquet Hall ☐ Sports Facility ☐ Bowling Alley
- ☐ Hotel/Motel: Number of Floors: _____ Number of Rooms: _____
☐ Rooming House: Number of Floors: _____ Number of Rooms: _____

Type 2

- ☐ Liquor Store ☐ Corner Store ☐ Supermarket ☒ Convenience Store
- ☒ Gas Station ☐ Amusement/Phonograph Distributor ☐ Recycling, Salvage or Towing
- ☐ Used Car Dealer ☐ Personal Service Establishment
(such as tattoo business, hair salon, tailor, etc.) ☐ Recording Studio

What other licenses/permits will you hold at this location? (check all that apply)

- ☒ Occupancy Permit ☒ Cigarette & Tobacco ☒ Gas Station ☐ Extended Hours ☐ Class "B" Tavern ☒ Weights & Measures
- ☐ Secondhand Dealer ☐ Precious Metal & Gems ☐ Other: _____

8. Legal Capacity (only if a Type 1 premises in #7 above)

Capacity _____ (Call the Milwaukee Development Center at 414-286-8211 if you have questions.)

9. Premises Description

a. Identify all area(s) of the premises that will be used in operating this business (include areas used only for storage):

☒ 1st Floor ☐ 2nd Floor ☐ Basement Storage ☐ Patio ☐ Beer Garden ☐ Sidewalk Café ☐ Deck ☐ Rooftop

☐ Other: Describe: _____

b. Describe Location: ☒ Major Thoroughfare ☐ Secondary Street ☐ Other: North 76th Street

c. Nearest Major Cross Street: Green Tree rd.

d. Describe Building: ☒ Free Standing Building ☐ Strip Mall ☐ Other: _____

e. Describe Premises Structure: ☒ Single Story ☐ Multi-Story - # of Stories _____ ☐ Other: _____

f. Describe Surrounding Area: ☒ Commercial ☒ Residential ☐ Industrial ☐ Other: _____

g. Building Owner Name: Anup Khullar Phone Number: 414-353-1644

Building Owner Address: 8200 W. Brown Deer Rd.

10. Hours of Operation & Customers

Will customers be entering the premises? ☐ No ☒ Yes

Day of the Week	Proposed Hours of Operation:		Estimated Number of Customers expected each day	Potential Age Range of Customers	Class B Tavern Applicant Only: Age Restriction (If none, write 'None')
	Open Time (include a.m. or p.m.)	Close Time (include a.m. or p.m.)			
Sunday	24 HRS		300	30-40	
Monday	24 HRS		300	30-40	
Tuesday	24 HRS		300	30-40	
Wednesday	24 HRS		300	30-40	
Thursday	24 HRS		300	30-40	
Friday	24 HRS		300	30-40	
Saturday	24 HRS		300	30-40	

40 Extended Hours Establishment License is required for any convenience store, filling station, personal service establishment (such as tattoo, body piercing, salon, tailor, tanning, etc.), recording studio or restaurant which is open between the hours of 12:00 a.m. and 5:00 a.m.

Alcohol Establishments Class A: 8:00 am to 9:00 pm Sunday thru Saturday

Permitted Hours of Operation: Class B: 6:00 am to 2:00 am Sunday thru Thursday, 6:00 am to 2:30 am Friday & Saturday

Entertainment Outdoor Closing Hours: 10:00pm Sunday-Thursday; 12:00am Friday & Saturday; unless a different time, either earlier or later, is established by the Common Council in its approval of the licensee's plan of operation.

11. Signature(s)

Signature of Sole Proprietor, Partner, or 20% or more Shareholder
(If there are no 20% or more shareholders,
Corporate Officer-print name/title and sign)

Signature of additional partner or 20% or more shareholder

See Application Information for a complete list of all required application fees.



FILLING STATION LICENSE AND WEIGHTS & MEASURES (RETAIL PETROLEUM METERS) LICENSE SUPPLEMENTAL APPLICATION

OFFICE OF THE CITY CLERK, LICENSE DIVISION
CITY HALL, 200 E. WELLS ST., ROOM 105, MILWAUKEE, WI 53202
(414) 286-2238 • license@milwaukee.gov • www.milwaukee.gov/licenses

Legal Entity Name: **CH PETRO MART LLC**

Premise Address: **6829 North 76th street Milwaukee, WI 53223**

Filling Station License Fee \$ 275

Weights & Measures License Fee

Number of Retail Petroleum Meters* 16 x \$60 per meter = \$ 960

*For each nozzle, count the number of grades (not including midgrade if mixed in the pump), add the number of all grades together and that is your number of retail petroleum meters.

Will electronic scanners be used to determine/record the price of items?

☐ No ☒ Yes

Will scales be used to price items based on their weight?

☒ No ☐ Yes

If yes to either or both questions, a separate Weights & Measures License Application must be submitted for these devices.

Acknowledgements and Signature

I confirm that all information is true and correct. I understand any changes to the information in this application must be reported to the City Clerk License Division within 10 days. I have knowledge of the City of Milwaukee ordinances currently regulating the licenses applied for and understand that the licenses may be subject to suspension, non-renewal, or revocation if I violate these regulations.

Signature of Sole Proprietor, Partner, or 20% or more Shareholder
(If no 20% or more Shareholder, Corporate Officer must sign and provide title)

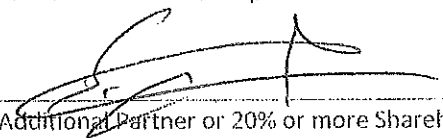
Signature of Additional Partner or 20% or more Shareholder

Submit this form with the following:

- Business License Application
- Business Plan of Operation
- Floor plan
- License fees

Forms can be obtained online at www.milwaukee.gov/licenses

Office Use Only:

Appl#	_____	Filed	_____	Initials	_____
Paid	_____	MPD	_____	CC	_____
HD	_____	DNS	_____	Lic #	_____

**FOOD DEALER LICENSE PLAN OF OPERATION**

OFFICE OF THE CITY CLERK, LICENSE DIVISION

CITY HALL, 200 E. WELLS ST, ROOM 105, MILWAUKEE, WI 53202

(414) 286-2238 • licens-@milwaukee.gov • www.milwaukee.gov/licensingLegal Entity Name: **CH PETRO MART LLC**Premises Address: **6829 North 76th Street Milwaukee, WI 53223****SECTION 1 TYPE OF BUSINESS**

What will be the majority of your food sales? (check one)

☐ Restaurant Items (meals):

MEALS include, but are not limited to, chicken, ribs, sandwiches, roasted corn, baked potatoes, hot dogs, brats, tacos, nachos w/ cheese and meat, French fries, cooked or deep fried vegetables/fruit, cooked cheese curds, corn ongs, egg rolls, salads.

☒ Retail Items (snacks and beverages):

RETAIL items include, but are not limited to, ice cream/soft serve, lemonade, snow cones, coffee, espresso, cappuccino, tea, fruit juice, smoothies, candy, dispensed soda, fruit cups, bakery, cookies, kettle corn, cotton candy, funnel cakes, fritters, tortilla chips w/ cheese.

Will it be a convenience store? ☒ Yes ☐ No

A convenience store contains less than 5,000 square feet of retail space and has, as its primary business, the sale of basic food items and in addition, sells household products or is a filling station that sells basic food items and household products.

☐ Bed & Breakfast☐ Micro Market

All Applicants: Submit a menu or a list of food items that will be sold.

Will any wholesale business be done? ☒ No ☐ Yes If yes, what percentage of food sales will be wholesale?☐ Less than 25%☐ 25% or More AND:☐ Restaurant items (meals) will be sold.- Complete this application and also contact DATCP.☐ NO restaurant items (meals) will be sold - Do NOT complete this application. Contact DATCP only.**SECTION 2 FOOD PROCESSING**Will any food processing be done? ☐ No ☒ Yes

Processing is defined as assembling, grinding, cutting, mixing, baking, coating, stuffing, packing, bottling, grilling, roasting, extracting, fermenting, distilling, pickling, freezing, drying, smoking, or packaging.

SECTION 3 FOOD REQUIRING TEMPERATURE CONTROLWill any food that requires temperature control be sold? ☐ No ☒ Yes
(includes dairy products such as milk, cheese, and ice cream, fish, shellfish, meat, poultry)

Frozen Meals, Milk, ice cream, eggs,

If yes, list the types of food items:

SECTION 4 DETAILS OF OPERATION

- Will you have seating on site for dining? ☒ No ☐ Yes
- Will you be doing any catering? ☒ No ☐ Yes
- Will you be doing any delivery? ☒ No ☐ Yes
- Will you have outdoor activities? ☒ No ☐ Yes - Check all that apply: ☐ Bar ☐ Cooking/Grilling ☐ Dining
- Will you have a drive thru window? ☒ No ☐ Yes - Are hours different from inside? ☐ No ☐ Yes
- If Yes, provide drive thru hours: _____
- Will scales or barcode scanners be used? ☐ No ☒ Yes - You must also apply for a Weights & Measures License.

SECTION 5 ADDITIONAL SITES

Where will food be prepared and/or sold?

- ☒ At a single site ☐ At multiple sites: How many? _____ (for example, a hotel with several dining rooms or bars)

If multiple sites, attach a Food Dealer Additional Site Addendum (ccl-foodadd) for each additional site.

SECTION 6 CONSTRUCTION OR CHANGES

Are you planning any construction, remodeling or equipment changes?

- ☒ No If No, SKIP to Section 8
- ☐ Yes If Yes, check all that apply: ☐ New construction of a building ☐ Renovation or remodeling
- ☐ Construction changes to existing building ☐ Equipment changes only

Provide a brief description of the changes: _____

Start date: _____

Name, Address & Phone Number of Architect: _____

Name, Address & Phone Number of Contractor: _____

SECTION 7 ALCOHOL BEVERAGES

Are you applying for an alcohol beverage license?

- ☒ No If No, SKIP to Section 8
- ☐ Yes If YES, if your food license is approved prior to the alcohol license, when do you want the food license issued?
- ☐ Immediately ☐ At the same time as the alcohol license

SECTION 8 ACKNOWLEDGEMENTS & SIGNATURE

You must initial each item confirming your understanding:

- ☒ I understand the Health Department must conduct an inspection and advise the License Division of their approval before the license may be issued.
- ☒ I understand I must obtain an occupancy permit from the Department of Neighborhood Services and an inspection may be required. Neighborhood Services must advise the License Division of their approval before the license may be issued.
- ☒ I understand the district alderperson will review and either support or object to my application. If he/she objects, I may appeal and be scheduled to appear before the Licenses Committee. The Licenses Committee will then make a recommendation to the Common Council. The Common Council must grant the license before it may be issued.
- ☒ I understand proof of payment for all license fees must be on file in the License Division before the license may be issued and the license must be issued and posted in my establishment prior to opening for business.
- ☒ I will not operate my food business until the license has been issued and posted in the establishment.

Signature of Sole Proprietor, Partner, or 20% Shareholder: _____

Signature of Additional Partner: _____



WEIGHTS & MEASURES LICENSE SUPPLEMENTAL APPLICATION

OFFICE OF THE CITY CLERK, LICENSE DIVISION
CITY HALL, 200 E. WELLS ST, ROOM 105 MILWAUKEE, WI 53202
(414) 286-2238 • license@milwaukee.gov • www.milwaukee.gov/licenses

Office Use Only:

App# _____
Filed _____
Initials _____
Paid _____
Lic # _____

Legal Entity Name: CH Petro mart LLC

Premise Address: 6829 N. 76th street milwaukee, WI 53223

Device Type(s)

- Check all device types for which you need a license.
- For each device type checked, indicate how many you have in the Number of Devices column (b).
- Calculate the Total Fee Per Device Type by multiplying the Fee Per Device Type (a) by the Number of Devices (b).
- Add all Total Fee Per Device Type amounts together and that will be your Total Fee Due.
- * **Exception:** The Scanner fee is not per device. Check the box for the appropriate range.
If you have 1-3 scanners, the total due is \$130. If you have 4 or more scanners, the total due is \$250.
Check the Number of Devices (b).

Device Type	License Period	Fee Per Device Type (a)	Number of Devices (b)	Total Fee Per Device Type (a x b)
Liquid Measuring Devices				
<input type="checkbox"/> Retail Petroleum Meters	12 months	\$60		
<input type="checkbox"/> 0 to 30 gallons per minute	24 months	\$60		
<input type="checkbox"/> 31 to 200 gallons per minute	24 months	\$750		
<input type="checkbox"/> Over 200 gallons per minute	24 months	\$750		
Scales				
<input type="checkbox"/> Measuring any weight amount	24 months	\$55		
Scanners				
		Fee for scanners is by range	Check how many scanners you have	
<input checked="" type="checkbox"/> Up to 3 scanners	24 months	\$130 total	<input checked="" type="checkbox"/> 1 <input type="checkbox"/> 2 <input type="checkbox"/> 3	
<input type="checkbox"/> Four or more scanners	24 months	\$250 total	<input type="checkbox"/> 4 <input type="checkbox"/> Other	
Other Devices				
<input type="checkbox"/> Length Measuring Device	24 months	\$60		
<input type="checkbox"/> Timing Device	24 months	\$30		
Total Fee Due				130.00

Signature _____

I hereby agree that I will comply with the applicable sections of the Wisconsin State Statutes, Administrative Code and the Milwaukee Code of Ordinances regarding the operation of weighing and measuring devices.

I understand that all devices must be operated within the specifications, tolerances and other technical requirements set forth in the National Institute of Standards and Technology Handbook 44. I understand that the license for which I am applying must be posted on the premises or in my vehicle prior to opening for business or operating the device.

I understand that these device licenses are not transferable (with the exception of scanners). If the device is replaced or needs to be repaired, I must apply for and receive a new license so that an inspection of the device can be performed prior to its use.

I acknowledge that as a condition of being issued this license, I must allow the Health Department into the establishment to test the device to validate its specifications/tolerances. If my devices are found out of compliance, I may be charged inspection fees.

I have read, understand, and will adhere to all the above acknowledgments.

Signature of Sole Proprietor, Partner, or 20% or more Shareholder
(if there are no 20% or more shareholders,
Corporate Officer-print name/title and sign)

Signature of additional person(s) 20% or more Shareholder

License must be submitted with the business license application. Additional information is available on the City of Milwaukee website or www.milwaukee.gov/licenses.



WEIGHTS & MEASURES PLAN OF OPERATION

cd-wmplan 1/9/18

Office of the City Clerk License Division
200 E. Wells St. Room 105, Milwaukee, WI 53202
(414) 286-2238 www.milwaukee.gov/license license@milwaukee.gov

Legal Entity Name: CH. Petro mast LLC

Premise Address: 6824 N. 76th Street Milwaukee, WI 53223

Type of Business

Provide a brief description of the establishment/business:

Other licenses may be required depending on the type of business you are operating.

Litter & Noise

- a. How are grounds kept clean? ☒ Sweep ☐ Pressure Wash ☒ Pick Up Litter ☐ Other: _____
- b. How often will grounds be cleaned? ☒ Daily ☐ Weekly ☐ As Needed ☐ Monthly ☐ Other: _____
- c. Grounds cleaned by: ☒ Licensee ☐ Building Owner ☐ Employees ☐ Hired Maintenance ☐ Other: _____
- d. How are noise issues prevented and/or addressed? ☐ Security ☒ Manager approaches customer(s) ☒ Call Police
☐ Signs Posted ☐ Other: _____

Signature

Signature of Sole Proprietor, Partner, or 20% or more Shareholder
(If there are no 20% or more shareholders,
Corporate Officer-print name/title and sign)

Signature of additional partner or 20% or more shareholder

This form must be submitted with the Business License Application. Weights & Measures License Application for Application, and appropriate fee. Forms can be obtained online at www.milwaukee.gov/licenses.

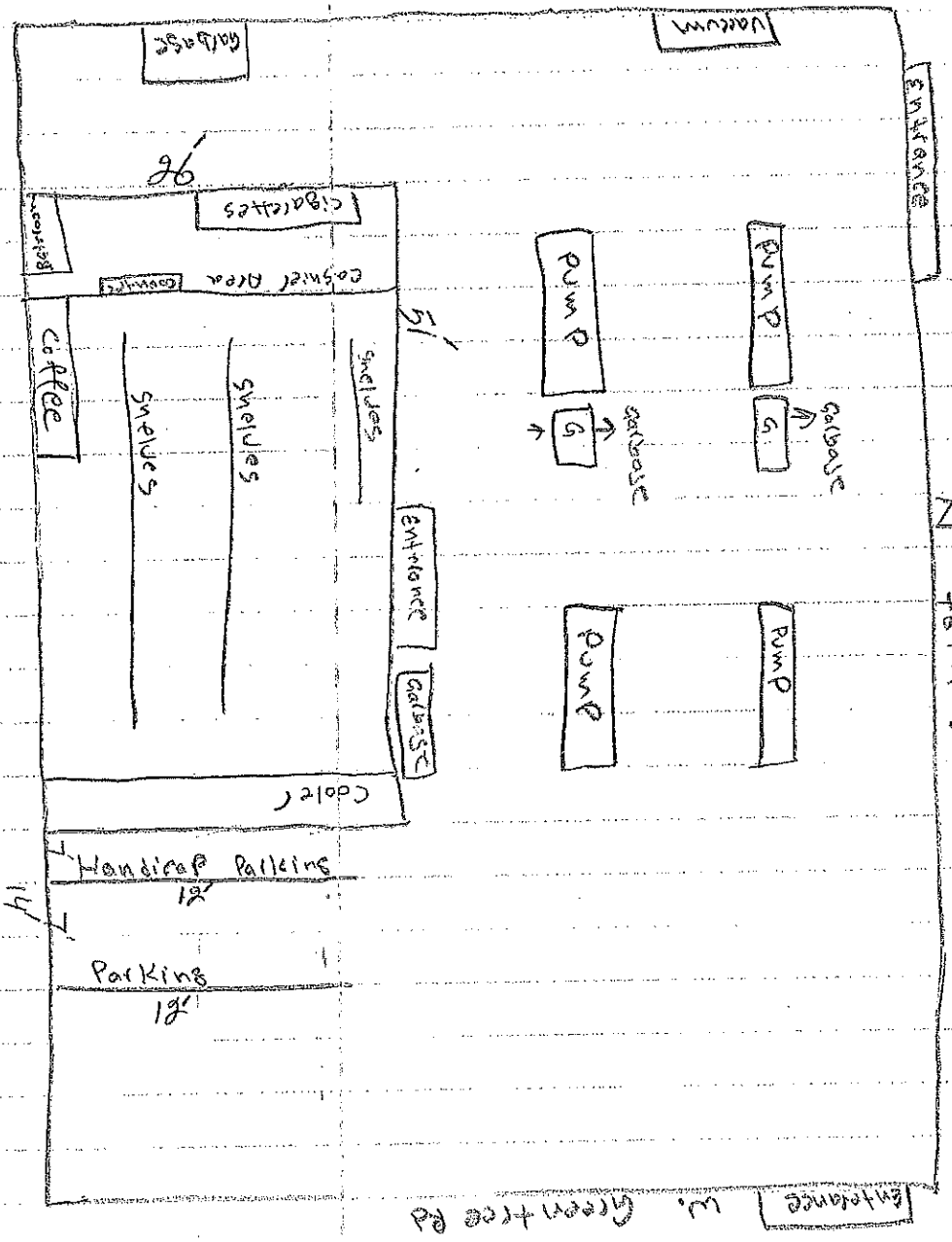
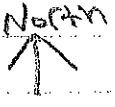

Entrance w. Green tree Rd

N 76th St.

CLARK

SHABIR QADIR
CH: 0-110 000-111
6829 N. 76th St.
Milwaukee, WI 53221
Date: 11/06/2023
Total Sq: 1326