



**CITY OF MILWAUKEE  
OFFICE OF THE CITY CLERK**

Thursday, October 05, 2023

**COMMITTEE MEETING NOTICE**

AD 14

NAVARRO, Evalise R, Agent  
B&J Investing Group LLC  
2242 S KINNICKINNIC Av  
Milwaukee, WI 53207

You are requested to attend a hearing which is to be held in Room 301-B, Third Floor, City Hall or you may attend virtually using the link below.

**Tuesday, October 17, 2023 at 02:20 PM**

The access code is <https://meet.goto.com/428236653>. If you wish to call in: **+1 (571) 317-3122** and use Access Code: **428-236-653**.

Please see the enclosed best practices document for further instructions.

**Regarding:** Your Class B Tavern, Public Entertainment Premises and Food Dealer License Applications Requesting Disc Jockey, Jukebox and Patrons Dancing as agent for "B&J Investing Group LLC" for "Pink Agave" at 2242 S KINNICKINNIC Av.



There is a possibility that your application may be denied for one or more of the following reasons: The recommendation of the committee regarding the application shall be based on evidence presented at the hearing. Per MCO 85-2.7-4, probative evidence concerning whether or not a new license should be granted may be presented on the following subjects: whether or not the applicant meets the municipal requirements, the appropriateness of the location and premises where the licensed premises is to be located and whether use of the premises for the purposes or activities permitted by the license would tend to facilitate a public or private nuisance or create undesirable neighborhood problems such as disorderly patrons, unreasonably loud noise, litter, and excessive traffic and parking congestion. Probative evidence relating to these matters may be taken from the plan of operation submitted with the license application, if any, but shall not include the content of any music. Evidence regarding the fitness of the location of the premises to be maintained as the principal place of business, including but not limited to whether there is an overconcentration of businesses of the type for which the license is sought; whether the proposal is consistent with any pertinent neighborhood business or development plans, or the location's proximity to areas where children are typically present. The applicant's record in operating similarly licensed premises; and whether or not the applicant has been charged with or convicted of any felony, misdemeanor, municipal offense or other offense, the circumstances of which substantially relate to the activity to be permitted by the license being applied for or any other factor which reasonably relates to the public health, safety or welfare may also be considered. See attached police report or correspondence.

**Notice for applicants with  
warrants or unpaid fines:**

**Proof of warrant satisfaction or payment of fines must be submitted at the hearing on the above date and time. Failure to comply with this requirement may result in a delay of the granting/denial of your application.**

Failure to appear at this meeting may result in the denial of your license. Individual applicants must appear only in person or by an attorney. Corporate or Limited Liability applicants must appear only by the agent designated on the application or by an attorney. Partnership applicants must appear by a partner listed on the application or by an attorney. If you wish to do so and at your own expense, you may be accompanied by an attorney of your choosing to represent you at this hearing.

You will be given an opportunity to speak on behalf of the application and to respond and challenge any charges or reasons given for the denial. No petitions can be accepted by the committee, unless the people who signed the petition are present at the committee hearing and willing to testify. You may present witnesses under oath and you may also confront and cross-examine opposing witnesses under oath. If you have difficulty with the English language, you should bring an interpreter with you, at your expense, so that you can answer questions and participate in your hearing.

You may examine the application file at this office during regular business hours prior to the hearing date. Inquiries regarding this matter may be directed to the person whose signature appears below.

Limited parking for persons attending meetings during normal business hours is available at reduced rates (5 hour limit) at the Milwaukee Center on the southwest corner of Kilbourn Avenue and Water Street. You must present a copy of the meeting notice to the parking cashier.

PLEASE NOTE: Upon reasonable notice, efforts will be made to accommodate the needs of disabled individuals through sign language interpreters or other auxiliary aids. For additional information or to request this service, contact the Council Services Division ADA Coordinator at (414) 286-2998, Fax - (414) 286-3456, TDD - (414) 286-2025.

**JIM OWCZARSKI, CITY CLERK**

BY:

**Jim Cooney**  
License Division Manager

**If you have questions regarding this notice, please contact the License Division at (414) 286-2238.**

200 E. Wells Street, Room 105, City Hall, Milwaukee, WI 53202. [www.milwaukee.gov/license](http://www.milwaukee.gov/license)  
Phone: (414) 286-2238 Fax: (414) 286-3057 Email Address: [License@milwaukee.gov](mailto:License@milwaukee.gov)





**CITY OF MILWAUKEE  
OFFICE OF THE CITY CLERK**

Thursday, October 05, 2023

**COMMITTEE MEETING NOTICE**

AD 14

NAVARRO, Evalise R, Agent  
B&J Investing Group LLC  
3013 W LAKEFIELD DR  
Milwaukee, WI 53215

You are requested to attend a hearing which is to be held in Room 301-B, Third Floor, City Hall or you may attend virtually using the link below.

**Tuesday, October 17, 2023 at 02:20 PM**

The access code is <https://meet.goto.com/428236653>. If you wish to call in: **+1 (571) 317-3122** and use Access Code: **428-236-653**.

Please see the enclosed best practices document for further instructions.

**Regarding:** Your Class B Tavern, Public Entertainment Premises and Food Dealer License Applications Requesting Disc Jockey, Jukebox and Patrons Dancing as agent for "B&J Investing Group LLC" for "Pink Agave" at 2242 S KINNICKINNIC Av.

There is a possibility that your application may be denied for one or more of the following reasons: The recommendation of the committee regarding the application shall be based on evidence presented at the hearing. Per MCO 85-2.7-4, probative evidence concerning whether or not a new license should be granted may be presented on the following subjects: whether or not the applicant meets the municipal requirements, the appropriateness of the location and premises where the licensed premises is to be located and whether use of the premises for the purposes or activities permitted by the license would tend to facilitate a public or private nuisance or create undesirable neighborhood problems such as disorderly patrons, unreasonably loud noise, litter, and excessive traffic and parking congestion. Probative evidence relating to these matters may be taken from the plan of operation submitted with the license application, if any, but shall not include the content of any music. Evidence regarding the fitness of the location of the premises to be maintained as the principal place of business, including but not limited to whether there is an overconcentration of businesses of the type for which the license is sought; whether the proposal is consistent with any pertinent neighborhood business or development plans, or the location's proximity to areas where children are typically present. The applicant's record in operating similarly licensed premises; and whether or not the applicant has been charged with or convicted of any felony, misdemeanor, municipal offense or other offense, the circumstances of which substantially relate to the activity to be permitted by the license being applied for or any other factor which reasonably relates to the public health, safety or welfare may also be considered. See attached police report or correspondence.

**Notice for applicants with  
warrants or unpaid fines:**

**Proof of warrant satisfaction or payment of fines must be submitted at the hearing on the above date and time. Failure to comply with this requirement may result in a delay of the granting/denial of your application.**

Failure to appear at this meeting may result in the denial of your license. Individual applicants must appear only in person or by an attorney. Corporate or Limited Liability applicants must appear only by the agent designated on the application or by an attorney. Partnership applicants must appear by a partner listed on the application or by an attorney. If you wish to do so and at your own expense, you may be accompanied by an attorney of your choosing to represent you at this hearing.

You will be given an opportunity to speak on behalf of the application and to respond and challenge any charges or reasons given for the denial. No petitions can be accepted by the committee, unless the people who signed the petition are present at the committee hearing and willing to testify. You may present witnesses under oath and you may also confront and cross-examine opposing witnesses under oath. If you have difficulty with the English language, you should bring an interpreter with you, at your expense, so that you can answer questions and participate in your hearing.

You may examine the application file at this office during regular business hours prior to the hearing date. Inquiries regarding this matter may be directed to the person whose signature appears below.

Limited parking for persons attending meetings during normal business hours is available at reduced rates (5 hour limit) at the Milwaukee Center on the southwest corner of Kilbourn Avenue and Water Street. You must present a copy of the meeting notice to the parking cashier.

PLEASE NOTE: Upon reasonable notice, efforts will be made to accommodate the needs of disabled individuals through sign language interpreters or other auxiliary aids. For additional information or to request this service, contact the Council Services Division ADA Coordinator at (414) 286-2998, Fax - (414) 286-3456, TDD - (414) 286-2025.

**JIM OWCZARSKI, CITY CLERK**

BY: \_\_\_\_\_

**Jim Cooney**  
License Division Manager

**If you have questions regarding this notice, please contact the License Division at (414) 286-2238.**

200 E. Wells Street, Room 105, City Hall, Milwaukee, WI 53202. [www.milwaukee.gov/license](http://www.milwaukee.gov/license)  
Phone: (414) 286-2238 Fax: (414) 286-3057 Email Address: [License@milwaukee.gov](mailto:License@milwaukee.gov)

Date: 8-7-2023  
Officer: Michael Ward

City of Milwaukee Police Department  
90-5-1.5 Crime Prevention Survey  
Tavern Inspection

Name of Premise: Pink Agave  
Address: 2242 S. Kinnickinnic Ave  
Phone: 414-837-3054

Owner: Evalisse R. Navarro  
Owner address: 3013 W. Lakefield Drive  
City State Zip: Milwaukee WI 53215  
Owner Phone: 414-379-2170  
Owner email: rosanavarro.en@gmail.com

Licensee/Agent: Same  
Home Address:  
City State Zip:  
Phone:  
Email:

Preferred contact:

Location currently open: ☐ YES ☒ NO

Projected open date:

Day's open: ☒S ☐M ☐T ☒W ☒Th ☒F ☒SA ☐ALL

Hours of Operation: Sun: 3pm-12am ☐24 hours ☐Y ☐N  
Mon:  
Tue:  
Wed: 5pm-12am  
Thu: 5pm-12am  
Fri: 5pm-12am  
Sat: 3pm-2am

Premise Type: ☒Tavern/Bar  
☐Restaurant  
☐Other:

Licenses currently held:

Alcohol: ☐ Yes ☐ No Class: #:  
Tobacco: ☐ Yes ☐ No #:  
Food: ☐ Yes ☐ No #:  
Extended Hours: ☐ Yes ☐ No #:  
Secondhand Dealer: ☐ Yes ☐ No Type: #:  
Other: ☐ Yes ☐ No Type: #:  
Other: ☐ Yes ☐ No Type: #:

**Exterior Survey:**

1. Is the area around the location clean? ☒ Yes ☐ No
2. What surrounds the location? (Check all the apply)
  - a. ☐ Park
  - b. ☐ School
  - c. ☐ Youth Center
  - d. ☐ Church
  - e. ☒ Tavern(s) If so, how many 4
  - f. ☒ Residential
  - g. ☒ Other businesses
  - h. ☐ Other:
3. Can you see from the outside of the location into the interior ☐ Yes ☒ No
4. Can you see the employees inside of the location from the outside ☐ Yes ☒ No
5. Are exterior windows free of signage ☒ Yes ☐ No
6. Is there a parking lot ☐ Yes ☒ No
7. Is the parking lot clean? ☐ Yes ☐ No **No Parking Lot**
8. Off-Street parking ☒ Yes ☐ No
9. Is the parking lot well lit? ☐ Yes ☐ No **No Parking Lot**
10. Valet Parking ☐ Yes ☒ No
  - a. Will this lot have a guard? ☐ Yes ☐ No **No Parking Lot**
  - b. Will this lot have cameras? ☐ Yes ☐ No **No Parking Lot**
11. Are there areas where a person could conceal themselves ☐ Yes ☒ No
12. Is there exterior lighting? ☒ Yes ☐ No. Does it appears to be adequate ☒ Yes ☐ No
13. Exterior Payphone? ☐ Yes ☒ No
14. Are there No Loitering Signs posted? ☐ Yes ☒ No
15. Are there exterior security cameras ☒ Yes ☐ No How Many: 2
16. Are the address numbers prominently displayed and easy to see ☐ Yes ☒ No

**Camera Survey:**

17. Does this location have security cameras? ☒ Yes ☐ No
18. Are they in working order? ☒ Yes ☐ No
19. What format are the cameras?
  - a. Color ☒ Yes ☐ No
  - b. Digital ☒ Yes ☐ No
  - c. Recorded ☒ Yes ☐ No
20. How long is footage stored for later viewing:
21. Are there exterior cameras ☒ Yes ☐ No How many: 2
22. Are there interior cameras ☒ Yes ☐ No How many: 10

23. Do all employees know how to retrieve recorded digital images/footage? ☐ Yes ☒ No  
24. Cameras located in parking lot ☐ Yes ☐ No How many **No Parking Lot**

**Interior Survey:**

25. What is the planned capacity: **60**  
26. What is the minimum number of employees That will be on premise **3**  
27. Is the storeowner willing to be a standing complainant regarding loitering? ☐ Yes ☒ No  
**Not at this time.**  
a. If yes have them fill out the standing complaint form and give them two of the commercial signs ☐ Yes ☐ No  
28. Is the interior of the location neat and clean? ☒ Yes ☐ No  
29. Does an interior camera face the entrance/exit? ☒ Yes ☐ No  
30. Is there a lockable area that separates employees from customers? ☐ Yes ☒ No  
31. Are emergency and non-emergency numbers posted near the phone? ☒ Yes ☐ No  
32. Does the owner know how to contact their police district directly? ☒ Yes ☐ No  
a. Did you provide a district contact guide to the owner? ☒ Yes ☐ No

**Security**

33. How many security personnel are going to be employed: **2**  
34. How will they be deployed: Interior **2** Exterior **Front door/interior rear of bar**  
35. What days will they be deployed ☐ Mon ☐ Tue ☐ Wed ☐ Thu ☒ Fri ☒ Sat ☒ Sun  
36. Will the security be managed by business ☐ or contracted ☒  
37. Will they be armed ☒ Yes ☐ No  
38. What type of security measures to be used:  
☐ Wanding/metal detector  
☐ ID Scanner  
☒ Dress Code  
☐ Cover Charge  
☐ Age restriction  
☐ Other

**ADDITIONAL COMMENTS/RECOMMENDATIONS:**

This report is written by Police officer Michael WARD, assigned to District 6 Community Liaison Office.

We met with Evalisse R. Navarro, and made the following recommendation.

The location's front windows and main entrance point are currently blacked out. Our recommendation is to remove the film to create better sight lines from the street. Navarro stated her plan is to remove the film from the windows and the door.

Currently there is no address displayed for the business. Our recommendation is to place the address above main entrance. Navarro stated she will add the address numbers above the door.

All cameras are in working order at this time. Navarro did not know at the time how long the footage is stored. Our recommendations would be for at least several days.

Navarro stated the location will have security over the weekend. Navarro stated they will be contracted and may be armed. Navarro stated one will be posted at the front door (interior) and one located in the rear of the bar (interior).

Navarro is aware of the standing complaint form and will look over the document. If loitering becomes an issue, she is willing to fill out form.

This concludes my additional notes.



City of 2242 S Kinnickinnic

### Area of Interest (AOI) Information

Area : 21,862,585.93 ft<sup>2</sup>

Jul 10 2023 15:21:19 Central Daylight Time

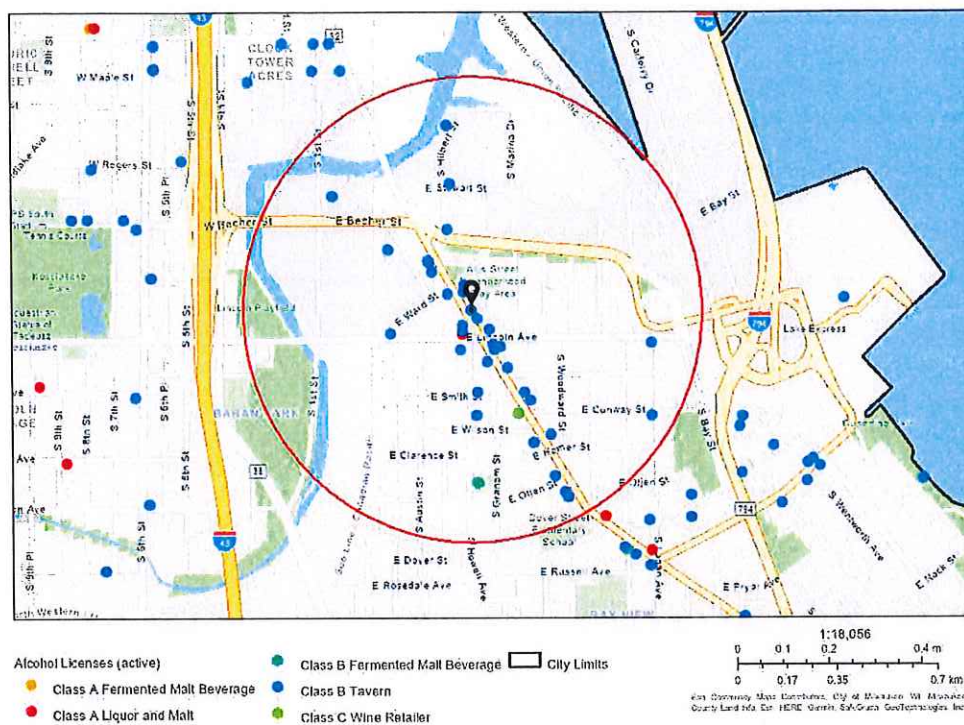



Summary

Name	Count	Area(ft²)	Length(mi)
Alcohol Licenses	39		

Alcohol Licenses



#	Legal Entity	Trade Name	Licensee	Address	License Type Name	Total Capacity	Expiration Date	Count
1	U.C. Jonas Inc	Mothership	PAUL U JONAS, Agt	2301 S Logan AV	Class B Tavern License		7/25/2023, 7:00 PM	1
2	MAPLE LEAF ENTERPRISE S, LLC	SUGAR MAPLE	ADRIENNE M PIERLUISSI, Agt	441 E LINCOLN AV	Class B Tavern License	160	7/29/2023, 7:00 PM	1
3	SUMO, LLC	THE HIGHBURY PUB	JOSEPH R KATZ, Agt	2322 S KINNICKINNI C AV	Class B Tavern License	80	7/26/2023, 7:00 PM	1
4	HIGGSKI, INC	BAY VIEW BOWL	MICHAEL S KOSINSKI, Agt	2416 S KINNICKINNI C AV	Class B Tavern License	160	7/25/2023, 7:00 PM	1
5	PKNJ, LLC	Sorella	Kyle C Toner, Agt	2535 S Kinnickinnic AV	Class B Tavern License		8/16/2023, 7:00 PM	1
6	Three Sheets LLC	The Stone	SHAWN T LEET, Agt	2422 S Howell AV	Class B Tavern License	80	7/28/2023, 7:00 PM	1
7	Guanajuato Mexican Restaurant, LLC	Guanajuato Mexican Restaurant	CAROLINA GAMINO, Agt	2317 S Howell AV	Class B Tavern License		8/2/2023, 7:00 PM	1
8	Rap Us Corp	Cafe India - Bar & Grill	RAKESH REHAN, Agt	2201 S Kinnickinnic AV	Class B Tavern License		9/14/2023, 7:00 PM	1
9	MPR CORPORATION	Bay View Supermarket	PARESH C PATEL, Agt	2277 S HOWELL AV	Class A Malt & Class A Liquor License		9/19/2023, 7:00 PM	1
10	RSVR LLC	RSVR	Reid C Spiering, Agt	2210 S KINNICKINNI C AV	Class B Tavern License		10/10/2023, 7:00 PM	1
11	Semolina MKE LLC	Semolina MKE	Petra L Orlowski, Agt	2474 S KINNICKINNI C AV	Class B Tavern License		10/16/2023, 7:00 PM	1
12	KRS Hospitality Group LLC	Makk'n'Cheese/Blind Tiger	Marcos A Ramos-Garcia, Agt	2242 S Kinnickinnic AV	Class B Tavern License	60	10/9/2023, 7:00 PM	1
13	Vine Society LLC	Voyager Wine & Cocktail Bar	JORDAN A BURICH, Agt	422 E Lincoln AV	Class B Tavern License	49	10/17/2023, 7:00 PM	1
14	Bridgewater MKE, LLC	Bridgewater Modern Grill	David J Marcus, Agt	2011 S 1st ST Unit 4	Class B Tavern License		10/15/2023, 7:00 PM	1
15	AA Entertainment, LLC	The Backyard	Sam J Leaf, Agt	2155 S KINNICKINNI C AV	Class B Tavern License	160	10/17/2023, 7:00 PM	1
16	BABY BOOMERS	BABY BOOMERS	WENDELL E BENNETT, SP	182 E LINCOLN AV	Class B Tavern License	80	11/4/2023, 7:00 PM	1
17	Revel Group Inc	Revel	Haley I Pollard, Agt	2246 S Kinnickinnic AV	Class B Tavern License	80	10/31/2023, 7:00 PM	1
18	ST AUGUSTINE CONGREGATION	ST AUGUSTINE OF HIPPO PARISH	Joseph A Laska, Agt	2530 S HOWELL AV	Class B Fermented Malt Beverage Retailer's License		12/30/2023, 6:00 PM	1

19	WHEEL & SPROCKET, INC	Wheel & Sprocket	Noel C Kegel, Agt	187 E BECHER ST	Class B Tavern License		12/20/2023, 6:00 PM	1
20	Morgan Kenwood, LTD	Avalon	JANE M SCHILZ, Agt	2473 S Kinnickinnic AV	Class B Tavern License		1/16/2024, 6:00 PM	1
21	GW Mireles Inc	Cafe Corazon Bay View	GEORGE MIRELES, Agt	2394 S Kinnickinnic AV	Class B Tavern License	99	2/2/2024, 6:00 PM	1
22	MARY JANE RESTAURANT LLC	Cheba Hut	Heather R Huhn, Agt	2202 S KINNICKINNI C AV	Class B Tavern License		2/1/2024, 6:00 PM	1
23	Egg & Flour II LLC	Egg & Flour	Adam M Pawlak, Agt	2273 S HOWELL AV	Class B Tavern License		3/2/2024, 6:00 PM	1
24	Homerun Holdings LLC	Santino's Social Club	Gregory L Huber, Agt	352 E Stewart ST	Class B Tavern License		3/1/2024, 6:00 PM	1
25	Lion's Tooth, LLC	Lion's Tooth	Michelle M McClone-Carriere, Agt	2421 S KINNICKINNI C AV	Class B Fermented Malt Beverage Retailer's License		3/22/2024, 7:00 PM	1
26	Lion's Tooth, LLC	Lion's Tooth	Michelle M McClone-Carriere, Agt	2421 S KINNICKINNI C AV	Class C Wine Retailer's License		3/22/2024, 7:00 PM	1
27	SABOR TROPICAL RESTAURANT LLC	SABOR TROPICAL	Julio R Arias, Agt	2258 S KINNICKINNI C AV	Class B Tavern License		3/18/2024, 7:00 PM	1
28	BAY STREET PUB, LLC	BAY STREET PUB	MARK R PASCHAL, Agt	338 E BAY ST	Class B Tavern License	70	4/13/2024, 7:00 PM	1
29	Nonfiction LLC	Nonfiction Natural Wines	Bradley A Kruse, Agt	2563 S Kinnickinnic AV	Class B Tavern License		3/19/2024, 7:00 PM	1
30	CIAO CUCINA, LLC	CAFE LULU	SARAH F JONAS, Agt	2261-65 S Howell AV	Class B Tavern License	189	4/8/2024, 7:00 PM	1
31	HONEYPIE CAFE, INC.	Honeypie	VALERI A LUCKS, Agt	2569 S KINNICKINNI C AV	Class B Tavern License		4/28/2024, 7:00 PM	1
32	LANDLUBBERS, INC	BARNACLE BUD'S	GENE M MC KIERNAN, Agt	1955 S HILBERT ST	Class B Tavern License	50	4/2/2024, 7:00 PM	1
33	Tulum Latin Gastropub, LLC	Tulum Latin Gastropub	Ernesto Carmona, Agt	2352-54 S KINNICKINNI C AV	Class B Tavern License		4/24/2024, 7:00 PM	1
34	Caviche, Inc.	C-Viche	KARLOS J SORIANO, Agt	2165 S Kinnickinnic AV	Class B Tavern License		4/16/2024, 7:00 PM	1
35	FRANK'S NEWPORT, LLC	THE NEWPORT LOUNGE	FRANCIS C CREED, Agt	939 E CONWAY ST	Class B Tavern License	80	5/18/2024, 7:00 PM	1
36	Lost Whale Enterprises LLC	Lost Whale	Richard W Duval, Agt	2151 S KINNICKINNI C AV	Class B Tavern License		6/18/2024, 7:00 PM	1
37	NEVADA PRODUCTIONS LLC	THE TONIC TAVERN	PAUL U JONAS, Agt	2335 S KINNICKINNI C AV	Class B Tavern License	99	2/26/2024, 6:00 PM	1

38	Cream City Hospitality LLC	Heirloom MKE	Jessica J Ignatiev, Agt	2376-78 S HOWELL AV	Class B Tavern License		6/20/2024, 7:00 PM	1
39	DRI 5 BAYVIEW LLC	Centraal Grand Cafe & Tappery	ERIC G WAGNER, Agt	2306 S KINNICKINNI C AV	Class B Tavern License	261	6/29/2024, 7:00 PM	1

Establishments within a 0.5 miles radius centered on area of interest.



Thursday, October 05, 2023



# Notice of Public Hearing

Blank Notice

---

NAVARRO, Evalise R, Agent

Pink Agave at 2242 S KINNICKINNIC Av

Class B Tavern, Public Entertainment Premises and Food Dealer License Applications Requesting  
Disc Jockey, Jukebox and Patrons Dancing

**Tuesday, October 17, 2023 at 2:20 PM**

To whom it may concern:

The above application has been made by the above named applicant(s). This requires approval from the Licenses Committee and the Common Council of the City of Milwaukee. The hearing before the Licenses Committee will take place on 10/17/2023 at 2:20 PM in Room 301-B, Third Floor, City Hall. This is a public hearing. Those wishing to view the proceeding are able to do so via the City Channel – Channel 25 on Spectrum Cable – or on the Internet at <http://city.milwaukee.gov/citychannel>. Those wishing to provide oral testimony via phone or internet are asked to contact the staff assistant, Yadira Melendez at (414) 286-2775 or [stasst5@milwaukee.gov](mailto:stasst5@milwaukee.gov) for necessary information. Please make such requests no later than one business day prior to the start of the meeting. You are not required to attend the hearing, but please see the information below if you would like to provide testimony. Once the Licenses Committee makes its recommendation, this recommendation is forwarded to the full Common Council for approval at its next regularly scheduled hearing.

---

## **Important details for those wishing to provide information for the Licenses Committee to consider when making its recommendation:**

1. The license application is scheduled to be heard at the above time. Due to other hearings running longer than scheduled, you may have to wait some time to provide your testimony.
2. You must appear in person and testify as to matters that you have personally experienced or seen. (You cannot provide testimony for your neighbor, parent or anyone else; this is considered hearsay and cannot be considered by the committee.)
3. No letters or petitions can be accepted by the committee (unless the person who wrote the letter or the persons who signed the petition are present at the committee hearing and willing to testify).
4. Persons opposed to the license application are given the opportunity to testify first; supporters may testify after the opponents have finished.
5. When you are called to testify, you will be sworn in and asked to give your name, and address. (If your first and/or last names are uncommon please spell them.)
6. You may then provide testimony.
  - a. Include only information relating to the above license application.
  - b. Include only information you have personally witnessed or seen.
  - c. Provide concise and relevant information detailing how this business has affected or may affect the peaceful enjoyment of your neighborhood.
  - d. If by the time you have the opportunity to testify, the information you wish to share has already been provided to the committee, you may state that you agree with the previous testimony. Redundant or repetitive testimony will not assist the committee in making its recommendation.
7. After giving your testimony, the members of the Licenses Committee and the licensee may ask questions regarding the testimony you have given or other factors relating to the license application.
8. Business Competition is not a valid basis for denial or non-renewal of a license.  
**Please Note: If you have submitted an objection to the above application your objection cannot be considered by the committee unless you personally testify at the hearing.**

[illegible]



[illegible]

CURRENT OCCUPANT	2218 S KINNICKINNIC AVE	MILWAUKEE, WI 53207-1330
CURRENT OCCUPANT	2219 S ALLIS ST	MILWAUKEE, WI 53207-1320
CURRENT OCCUPANT	2219 S KINNICKINNIC AVE	MILWAUKEE, WI 53207-1329
CURRENT OCCUPANT	2219 S KINNICKINNIC AVE# A	MILWAUKEE, WI 53207-1329
CURRENT OCCUPANT	2220 S ROBINSON AVE	MILWAUKEE, WI 53207-1338
CURRENT OCCUPANT	2222 S ALLIS ST	MILWAUKEE, WI 53207-1321
CURRENT OCCUPANT	2224 S ROBINSON AVE	MILWAUKEE, WI 53207-1338
CURRENT OCCUPANT	2225 S KINNICKINNIC AVE	MILWAUKEE, WI 53207-1329
CURRENT OCCUPANT	2226 S ALLIS ST	MILWAUKEE, WI 53207-1321
CURRENT OCCUPANT	2226 S KINNICKINNIC AVE	MILWAUKEE, WI 53207-1330
CURRENT OCCUPANT	2227 S KINNICKINNIC AVE	MILWAUKEE, WI 53207-1329
CURRENT OCCUPANT	2228 S ROBINSON AVE	MILWAUKEE, WI 53207-1338
CURRENT OCCUPANT	2230 S KINNICKINNIC AVE	MILWAUKEE, WI 53207-1330
CURRENT OCCUPANT	2231 S ALLIS ST	MILWAUKEE, WI 53207-1320
CURRENT OCCUPANT	2231 S KINNICKINNIC AVE	MILWAUKEE, WI 53207-1329
CURRENT OCCUPANT	2231A S ALLIS ST	MILWAUKEE, WI 53207-1320
CURRENT OCCUPANT	2232 S ALLIS ST# 1	MILWAUKEE, WI 53207-1357
CURRENT OCCUPANT	2232 S ALLIS ST# 2	MILWAUKEE, WI 53207-1357
CURRENT OCCUPANT	2232 S ALLIS ST# 3	MILWAUKEE, WI 53207-1357
CURRENT OCCUPANT	2232 S ALLIS ST# 4	MILWAUKEE, WI 53207-1357
CURRENT OCCUPANT	2232 S ROBINSON AVE	MILWAUKEE, WI 53207-1338
CURRENT OCCUPANT	2232A S ROBINSON AVE	MILWAUKEE, WI 53207-1338
CURRENT OCCUPANT	2234 S KINNICKINNIC AVE	MILWAUKEE, WI 53207-1330
CURRENT OCCUPANT	2235 S ALLIS ST	MILWAUKEE, WI 53207-1320
CURRENT OCCUPANT	2235 S KINNICKINNIC AVE# 1	MILWAUKEE, WI 53207-1329
CURRENT OCCUPANT	2235 S KINNICKINNIC AVE# 2	MILWAUKEE, WI 53207-1329
CURRENT OCCUPANT	2235A S ALLIS ST	MILWAUKEE, WI 53207-1320
CURRENT OCCUPANT	2236 S ALLIS ST	MILWAUKEE, WI 53207-1321
CURRENT OCCUPANT	2236 S ALLIS ST# A	MILWAUKEE, WI 53207-1321
CURRENT OCCUPANT	2236 S KINNICKINNIC AVE	MILWAUKEE, WI 53207-1330
CURRENT OCCUPANT	2236 S ROBINSON AVE	MILWAUKEE, WI 53207-1338
CURRENT OCCUPANT	2237 S ALLIS ST	MILWAUKEE, WI 53207-1320
CURRENT OCCUPANT	2239 S ALLIS ST	MILWAUKEE, WI 53207-1320
CURRENT OCCUPANT	2240 S ALLIS ST	MILWAUKEE, WI 53207-1321
CURRENT OCCUPANT	2240 S ROBINSON AVE	MILWAUKEE, WI 53207-1338
CURRENT OCCUPANT	2242 S ALLIS ST	MILWAUKEE, WI 53207-1321
CURRENT OCCUPANT	2242 S ROBINSON AVE	MILWAUKEE, WI 53207-1338
CURRENT OCCUPANT	2242A S ALLIS ST	MILWAUKEE, WI 53207-1321
CURRENT OCCUPANT	2243 S KINNICKINNIC AVE	MILWAUKEE, WI 53207-1329
CURRENT OCCUPANT	2244 S ALLIS ST	MILWAUKEE, WI 53207-1321
CURRENT OCCUPANT	2244 S KINNICKINNIC AVE# 1	MILWAUKEE, WI 53207-1330
CURRENT OCCUPANT	2245 S KINNICKINNIC AVE	MILWAUKEE, WI 53207-1329
CURRENT OCCUPANT	2246 S ALLIS ST	MILWAUKEE, WI 53207-1321
CURRENT OCCUPANT	2247 S KINNICKINNIC AVE	MILWAUKEE, WI 53207-1329
CURRENT OCCUPANT	2255 S ALLIS ST# A	MILWAUKEE, WI 53207-1362
CURRENT OCCUPANT	2255 S ALLIS ST# B	MILWAUKEE, WI 53207-1362
CURRENT OCCUPANT	2255 S ALLIS ST# C	MILWAUKEE, WI 53207-1362

CURRENT OCCUPANT	2255 S ALLIS ST# D	MILWAUKEE, WI 53207-1362
CURRENT OCCUPANT	2255 S ALLIS ST# E	MILWAUKEE, WI 53207-1362
CURRENT OCCUPANT	2257A S HOWELL AVE	MILWAUKEE, WI 53207-1325
CURRENT OCCUPANT	2258 S ALLIS ST	MILWAUKEE, WI 53207-1321
CURRENT OCCUPANT	2260 S ALLIS ST	MILWAUKEE, WI 53207-1321
CURRENT OCCUPANT	2262 S ALLIS ST	MILWAUKEE, WI 53207-1321
CURRENT OCCUPANT	2263 S HOWELL AVE# 1	MILWAUKEE, WI 53207-1325
CURRENT OCCUPANT	2263 S HOWELL AVE# 2	MILWAUKEE, WI 53207-1325
CURRENT OCCUPANT	2263 S HOWELL AVE# 3	MILWAUKEE, WI 53207-1325
CURRENT OCCUPANT	2263 S HOWELL AVE# 4	MILWAUKEE, WI 53207-1325
CURRENT OCCUPANT	2263 S HOWELL AVE# 5	MILWAUKEE, WI 53207-1325
CURRENT OCCUPANT	2264 S ALLIS ST	MILWAUKEE, WI 53207-1321
CURRENT OCCUPANT	2266 S ALLIS ST	MILWAUKEE, WI 53207-1321
CURRENT OCCUPANT	2268 S ALLIS ST	MILWAUKEE, WI 53207-1321
CURRENT OCCUPANT	2268 S KINNICKINNIC AVE	MILWAUKEE, WI 53207-1330
CURRENT OCCUPANT	2270 S ALLIS ST	MILWAUKEE, WI 53207-1321
CURRENT OCCUPANT	2272 S ALLIS ST	MILWAUKEE, WI 53207-1321
CURRENT OCCUPANT	2274 S ALLIS ST	MILWAUKEE, WI 53207-1321
CURRENT OCCUPANT	348 E LINCOLN AVE	MILWAUKEE, WI 53207-1549
CURRENT OCCUPANT	352 E LINCOLN AVE	MILWAUKEE, WI 53207-1549
CURRENT OCCUPANT	352A E LINCOLN AVE	MILWAUKEE, WI 53207-1549

Blank Notice

Total Records: 161

Radius 250.0 feet and Center of the Circle: 2242 S Kinnickinnic Av



## BUSINESS LICENSE PLAN OF OPERATION

ccl-busplan 3/15/18

Office of the City Clerk License Division  
200 E. Wells St. Room 105, Milwaukee, WI 53202  
(414) 286-2238 www.milwaukee.gov/license e-mail address: [license@milwaukee.gov](mailto:license@milwaukee.gov)

### 1. Type of Business

Applying for: ☐ Extended Hours (12AM to 5AM) - If a food establishment, check all that apply: ☐ Delivery ☐ Drive Thru ☒ Dining Room  
☐ Self Service Laundry ☐ Massage Establishment ☐ Filling Station  
☒ Other (supplemental application for specific license also required)

Provide a detailed description of the type of business you plan on operating:

tavern lounge w/ food w/ a calm atmosphere

Do you have any experience operating this type of business? ☐ No ☒ Yes If yes, explain: managing bar

### 2. Business Operations

- a. Proposed Opening Date: ASAP
- b. Is this premise under construction? ☒ No ☐ Yes If yes, list estimated completion date: \_\_\_\_\_
- c. Is this a franchise? ☒ No ☐ Yes
- d. Is this premises currently licensed? ☐ No ☒ Yes If yes, list type of license: Tavern B, Food, late night exhours
- e. Is the current licensee operating? ☐ No ☒ Yes If no, list date closed: \_\_\_\_\_
- f. Do you have future plans for other businesses, licenses or permits at this location? ☒ No ☐ Yes  
If yes, explain: \_\_\_\_\_
- g. Have you previously held an Extended Hours License in Milwaukee? ☒ No ☐ Yes  
If yes, list address(es): \_\_\_\_\_
- h. Are other businesses operating in the same building? ☒ No ☐ Yes If yes, describe: \_\_\_\_\_

### 3. Litter & Noise

- a. How are grounds kept clean? ☒ Sweep ☐ Pressure Wash ☒ Pick Up Litter ☐ Other: \_\_\_\_\_
- b. How often will grounds be cleaned? ☒ Daily ☐ Weekly ☐ As Needed ☐ Monthly ☐ Other: \_\_\_\_\_
- c. Grounds cleaned by: ☒ Licensee ☐ Building Owner ☒ Employees ☐ Hired Maintenance ☐ Other: \_\_\_\_\_
- d. How are noise issues prevented and/or addressed? ☐ Security ☒ Manager approaches customer(s) ☐ Call Police  
☒ Signs Posted ☐ Other: \_\_\_\_\_
- e. Will a sound amplification system be used? ☒ No ☐ Yes If yes, describe: \_\_\_\_\_

### 4. Smoking & Sanitation

- a. Are there designated outdoor smoking areas? ☒ No ☐ Yes If yes, describe: \_\_\_\_\_
- b. Number of Garbage Cans: Inside: 7 Locations: Kitchen, bathrooms, Bar Area, entrance/front  
Outside: 1 Locations: Behind building (near alley) Back
- c. Is a crowd control barrier used? ☒ No ☐ Yes If yes, describe: \_\_\_\_\_
- d. How many restrooms are on the premises? 2
- e. Name of solid waste contractor: ☐ Advanced Disposal ☒ Waste Management ☐ Other: \_\_\_\_\_

## 5. Security

- a. Are there onsite parking spaces? ☒ No ☐ Yes If yes, how many? \_\_\_\_\_ and describe the parking security plan: \_\_\_\_\_
- b. Is there a loading zone? ☐ No ☒ Yes If yes, describe the loading area security plan: will be monitored for business purposes only
- c. Will you have security personnel on premise? ☐ No ☒ Yes If yes, how many? 2 and answer the following:  
 What are their responsibilities? check ID, pat down, keep environment safe  
 Is security equipment used? ☐ No ☒ Yes If yes, describe metal detector wand  
 List their licensing, certification, or training credentials Security license
- d. Will there be security cameras? ☐ No ☒ Yes If yes, how many? 14 and list locations: front of the building, back of the building, inside
- e. Will searches/identification checks be done upon entry? ☐ No ☒ Yes If yes, describe security checking ID's after a certain time

## 6. Percentage of Sales (must total 100%)

Alcohol <u>30</u> %	Food <u>50</u> %	Secondhand Merchandise _____ %	Precious Metals & Gems _____ %
Entertainment <u>20</u> %	Cigarettes _____ %		
Pawnbroker Activity _____ %	Salvaged Materials _____ % (such as scrap metal)	Personal Services (such as tattoo, body piercing, salon, tailor, tanning, etc.) _____ %	Other _____ % Describe: _____

## 7. Businesses/Licenses on the Premises (check all that apply):

### Type 1

- ☒ Full Service Restaurant ☐ Cafe/Coffee Shop ☐ Deli or Fast Food Restaurant ☐ Private/Fraternal/Veterans Club
- ☐ Night Club ☒ Tavern ☒ Cocktail Lounge ☐ Teen Club
- ☐ Banquet Hall ☐ Sports Facility ☐ Bowling Alley
- ☐ Hotel/Motel : Number of Floors: \_\_\_\_\_ Number of Rooms: \_\_\_\_\_
- ☐ Rooming House: Number of Floors: \_\_\_\_\_ Number of Rooms: \_\_\_\_\_

### Type 2

- ☐ Liquor Store ☐ Corner Store ☐ Supermarket ☐ Convenience Store
- ☐ Gas Station ☐ Amusement/Phonograph Distributor ☐ Recycling, Salvage or Towing
- ☐ Used Car Dealer ☐ Personal Service Establishment  
(such as tattoo business, hair salon, tailor, etc.) ☐ Recording Studio

What other licenses/permits will you hold at this location? (check all that apply)

- ☒ Occupancy Permit ☐ Cigarette & Tobacco ☐ Gas Station ☐ Extended Hours ☒ Class "B" Tavern ☐ Weights & Measures
- ☐ Secondhand Dealer ☐ Precious Metal & Gem ☐ Other: \_\_\_\_\_

## 8. Legal Capacity (only if a Type 1 premises in #7 above)

Capacity 60 (Call the Milwaukee Development Center at 414-286-8211 if you have questions.)



## 9. Premises Description

- a. Identify all area(s) of the premises that will be used in operating this business (include areas used only for storage):  
☒ 1<sup>st</sup> Floor ☐ 2<sup>nd</sup> Floor ☐ Basement Storage ☐ Patio ☐ Beer Garden ☐ Sidewalk Café ☐ Deck ☐ Rooftop  
☐ Other: Describe: \_\_\_\_\_
- b. Describe Location: ☒ Major Thoroughfare ☐ Secondary Street ☐ Other: \_\_\_\_\_
- c. Nearest Major Cross Street: Kinnickinnic Ave & Lincoln Ave.
- d. Describe Building: ☒ Free Standing Building ☐ Strip Mall ☐ Other: \_\_\_\_\_
- e. Describe Premises Structure: ☒ Single Story ☐ Multi-Story - # of Stories \_\_\_\_\_ ☐ Other: \_\_\_\_\_
- f. Describe Surrounding Area: ☒ Commercial ☐ Residential ☐ Industrial ☐ Other: \_\_\_\_\_
- g. Building Owner Name: Kendrick Wandell Phone Number: (414) 467-4067  
 Business Owner Address: 162 N. 67<sup>th</sup> St. Milwaukee WI 53213

## 10. Hours of Operation & Customers

Will customers be entering the premises? ☐ No ☒ Yes

Day of the Week	Proposed Hours of Operation:		Estimated Number of Customers expected each day	Potential Age Range of Customers	Class B Tavern Applicant Only: Age Restriction (If none, write 'None')
	Open Time (include a.m. or p.m.)	Close Time (include a.m. or p.m.)			
Sunday	3pm	12am	100	All ages	None
Monday	closed	closed	0		
Tuesday	closed	closed	0		
Wednesday	5pm	12am	50	All ages	None
Thursday	5pm	12am	50	All ages	None
Friday	5pm	2am	150	All ages	None
Saturday	3pm	2am	150	All ages	None

An Extended Hours Establishment License is required for any convenience store, filling station, personal service establishment (such as tattoo, body piercing, salon, tailor, tanning, etc.), recording studio or restaurant which is open between the hours of 12:00 a.m. and 5:00 a.m.

Alcohol Establishments Class A: 8:00 am to 9:00 pm Sunday thru Saturday  
 Permitted Hours of Operation: Class B: 6:00 am to 2:00 am Sunday thru Thursday, 6:00 am to 2:30 am Friday & Saturday

Entertainment Outdoor Closing Hours: 10:00pm Sunday-Thursday; 12:00am Friday & Saturday; unless a different time, either earlier or later, is established by the Common Council in its approval of the licensee's plan of operation.

## 11. Signature(s)

Erik Nanni  
 Signature of Sole Proprietor, Partner, or 20% or more Shareholder  
 (If there are no 20% or more shareholders,  
 Corporate Officer-print name/title and sign)

\_\_\_\_\_  
 Signature of additional partner or 20% or more shareholder

See Application Information for a complete list of all required application forms.



# ALCOHOL BEVERAGE & PUBLIC ENTERTAINMENT PREMISES SUPPLEMENTAL APPLICATION

Office of the City Clerk License Division

200 E. Wells St. Room 105, Milwaukee, WI 53202

(414) 286-2238 e-mail address: license@milwaukee.gov [www.milwaukee.gov/license](http://www.milwaukee.gov/license)Legal Entity Name: B & J Investing Group LLCPremise Address: 2242 S Kinnickinnic Ave Milwaukee WI 53207**Proximity of Premises to Church, School, Daycare Center or Hospital**Is the building within 300 feet of any church, school, daycare center or hospital? ☒ No ☐ Yes**"Service Bar Only" Designation**If applying for Class B or C license, are you applying for "Service Bar Only"? ☒ No ☐ Yes

Service Bar Only means customers cannot sit at the bar. Alcohol is served to employees who serve patrons seated at tables. No stools, chairs or other articles of furniture shall be placed at the service bar for patrons to sit upon.

**Business Information**a) Are you taking out this application for anyone that may not be eligible for a license? ☒ No ☐ Yes

If yes, list their name and address: \_\_\_\_\_

b) Will the agent, a partner or the individual licensee be conducting the day-to-day operations of the business? ☐ No ☒ Yes

If no, list the name and address of the person(s) who will: \_\_\_\_\_

Class B Applicants: If the agent, a partner or the individual licensee will not be conducting the day-to-day operations of the business, the person(s) listed above must obtain a Class B Managers license.

c) Does anyone else have money invested or any other interest in this business? ☒ No ☐ Yes

If yes, explain: \_\_\_\_\_

d) Have you made an agreement with anyone to repay any loan or any other payments based upon income from the business?

☒ No ☐ Yes If yes, list name and address: \_\_\_\_\_**Proof of Ownership, Lease, or Offer to Purchase (New & Transfer Applicants Only)**

Submit proof of ownership, lease, or offer to purchase the building with this application.

A lease or offer to purchase must:

- a) Be in the same legal entity name as that apply for the license
- b) Reflect the same address as the premises address on this application
- c) Reflect current dates and
- d) Be signed by the lessor/seller and lessee/buyer

**Property Information (New & Transfer Applicants Only)**a) Do you own or lease the building? ☐ Own ☒ Leaseb) Who owns the fixtures (for example, coolers, etc.)? landlordc) Are you purchasing the stock and/or fixtures? ☐ No ☐ Yes If yes, amount paid \$ \_\_\_\_\_d) Total amount paid for business \$ NAe) Total amount paid for goodwill of the business \$ 0.00

Goodwill comprises the reputation and customer relationships of an existing business. If the price you pay for the business exceeds the fair market value of all of the rest of the assets of the business, the excess may be considered goodwill.

f) Have you made arrangements with the seller for payment of personal property taxes? ☒ No ☐ Yes**See Application Information for a list of all required application forms.**

### Lease Information (New & Transfer Applicants who are leasing the premises only)

- a) Date lease begins 07/06/23 Ends renewal date 10/01/24
- b) Monthly rental \$ 3100
- c) Do you have an option to renew the lease? ☐ No ☒ Yes
- d) Does your lease allow for assignment to another party without the consent of the owner? ☒ No ☐ Yes
- e) For what length of time have you been guaranteed occupancy (number of years)? extension of lease
- f) In addition to paying the monthly rental, will you have to pay anything additional to the owner of the building to guarantee performance of the lease? ☒ No ☐ Yes If yes, explain \_\_\_\_\_
- g) Does the present owner or occupancy object to the granting of your license? ☒ No ☐ Yes  
If yes, explain \_\_\_\_\_

### Change of Agent Applicants Only

Have there been any changes to the floor plan since the last application was submitted? ☒ No ☐ Yes

If no, a new floor plan is not required. If yes, submit a new floor plan and explain the change(s): \_\_\_\_\_

### Signature

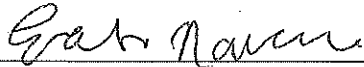

Signature of Sole Proprietor, Partner or 20% or More Shareholder

(If no 20% or more Shareholder, Corporate Officer - print name/title and sign)

Note: All information contained in this application is subject to approval by the Common Council.

Deviating from approved plan of operation will subject licensee to citations, and/or suspension or non-renewal of the license.

Contact the License Division for information on how to request changes.

### New and transfer of premises applicants must submit the following:

- ☐ Proof of ownership, lease or offer to purchase the building
- ☐ Detailed floor plan
- ☐ If a restaurant, copy of the menu



# FOOD DEALER LICENSE PLAN OF OPERATION

OFFICE OF THE CITY CLERK, LICENSE DIVISION  
CITY HALL, 200 E. WELLS ST, ROOM 105, MILWAUKEE, WI 53202  
(414) 286-2238 • [license@milwaukee.gov](mailto:license@milwaukee.gov) • [www.milwaukee.gov/license](http://www.milwaukee.gov/license)

Legal Entity Name: B & J Investing Group LLC

Premises Address: 2242 Skinnickinnic Ave. Milwaukee WI 53207

## SECTION 1 TYPE OF BUSINESS

What will be the majority of your food sales? (check one)

☒ Restaurant Items (meals):

MEALS include, but are not limited to, chicken, ribs, sandwiches, roasted corn, baked potatoes, hot dogs, brats, tacos, nachos w/ cheese and meat, French fries, cooked or deep fried vegetables/fruit, cooked cheese curds, corn dogs, egg rolls, salads.

☐ Retail Items (snacks and beverages):

RETAIL items include, but are not limited to, ice cream/soft serve, lemonade, snow cones, coffee, espresso, cappuccino, tea, fruit juice, smoothies, candy, dispensed soda, fruit cups, bakery, cookies, kettle corn, cotton candy, funnel cakes, fritters, tortilla chips w/ cheese.

Will it be a convenience store? ☐ Yes ☒ No

A convenience store contains less than 5,000 square feet of retail space and has, as its primary business, the sale of basic food items and in addition, sells household products or is a filling station that sells basic food items and household products.

☐ Bed & Breakfast

☐ Micro Market

All Applicants: Submit a menu or a list of food items that will be sold.

Will any wholesale business be done? ☒ No ☐ Yes If yes, what percentage of food sales will be wholesale?

☐ Less than 25%

☐ 25% or More AND:

☐ Restaurant items (meals) will be sold – Complete this application and also contact DATCP.

☐ NO restaurant items (meals) will be sold - Do NOT complete this application. Contact DATCP only.

## SECTION 2 FOOD PROCESSING

Will any food processing be done? ☐ No ☒ Yes

Processing is defined as assembling, grinding, cutting, mixing, baking, coating, stuffing, packing, bottling, grilling, canning, extracting, fermenting, distilling, pickling, freezing, drying, smoking, or packaging.

## SECTION 3 FOOD REQUIRING TEMPERATURE CONTROL

Will any food that requires temperature control be sold? ☐ No ☒ Yes

(includes dairy products such as milk, cheese, and ice cream, fish, shellfish, meat, poultry)

If yes, list the types of food items: cheese, poultry, vegetables

**SECTION 4 DETAILS OF OPERATION**

- Will you have seating on site for dining? ☐ No ☒ Yes
- Will you be doing any catering? ☒ No ☐ Yes
- Will you be doing any delivery? ☒ No ☐ Yes
- Will you have outdoor activities? ☒ No ☐ Yes - Check all that apply: ☐ Bar ☐ Cooking/Grilling ☐ Dining
- Will you have a drive thru window? ☒ No ☐ Yes - Are hours different from inside? ☐ No ☐ Yes
- If Yes, provide drive thru hours: \_\_\_\_\_
- Will scales or barcode scanners be used? ☒ No ☐ Yes - You must also apply for a Weights & Measures License.

**SECTION 5 ADDITIONAL SITES**

Where will food be prepared and/or sold?

- ☒ At a single site ☐ At multiple sites: How many? \_\_\_\_\_ (for example, a hotel with several dining rooms or bars)

If multiple sites, attach a Food Dealer Additional Site Addendum (ccl-foodadd) for each additional site.

**SECTION 6 CONSTRUCTION OR CHANGES**

Are you planning any construction, remodeling or equipment changes?

- ☒ No If No, SKIP to Section 8
- ☐ Yes If Yes, check all that apply: ☐ New construction of a building ☐ Renovation or remodeling
- ☐ Construction changes to existing building ☐ Equipment changes only

Provide a brief description of the changes: \_\_\_\_\_

Start date: \_\_\_\_\_

Name, Address & Phone Number of Architect: \_\_\_\_\_

Name, Address & Phone Number of Contractor: \_\_\_\_\_

**SECTION 7 ALCOHOL BEVERAGES**

Are you applying for an alcohol beverage license?

- ☐ No If No, SKIP to Section 8
- ☒ Yes If YES, if your food license is approved prior to the alcohol license, when do you want the food license issued?
- ☒ Immediately ☐ At the same time as the alcohol license

**SECTION 8 ACKNOWLEDGEMENTS & SIGNATURE**

You must initial each item confirming your understanding:

- EN I understand the Health Department must conduct an inspection and advise the License Division of their approval before the license may be issued.
- EN I understand I must obtain an occupancy permit from the Department of Neighborhood Services and an inspection may be required. Neighborhood Services must advise the License Division of their approval before the license may be issued.
- EN I understand the district alderperson will review and either support or object to my application. If he/she objects, I may appeal and be scheduled to appear before the Licenses Committee. The Licenses Committee will then make a recommendation to the Common Council. The Common Council must grant the license before it may be issued.
- EN I understand proof of payment for all license fees must be on file in the License Division before the license may be issued and the license must be issued and posted in my establishment prior to opening for business.
- EN I will not operate my food business until the license has been issued and posted in the establishment.

Signature of Sole Proprietor, Partner, or 20% Shareholder: Julia Mauer

Signature of Additional Partner: \_\_\_\_\_





# PUBLIC ENTERTAINMENT PREMISES LICENSE SUPPLEMENTAL APPLICATION

Office of the City Clerk License Division  
200 E. Wells St. Room 105, Milwaukee, WI 53202  
(414) 286-2238 [www.milwaukee.gov/license](http://www.milwaukee.gov/license) e-mail address: [license@milwaukee.gov](mailto:license@milwaukee.gov)

PREMISES ADDRESS: 2242 S Kinnickinnic Ave Milwaukee WI 53215

## TYPES OF ENTERTAINMENT (CHECK ALL THAT APPLY)

- |   |   |   |   |
|---|---|---|---|
| <input type="checkbox"/> Instrumental Musicians                                     | <input type="checkbox"/> Battle of the Bands    | <input type="checkbox"/> Dancing by Performers                          | <input type="checkbox"/> Amusement Machines<br>How many? _____                |
| <input type="checkbox"/> Bands  | <input type="checkbox"/> Comedy Acts            | <input type="checkbox"/> Adult Entertainment/<br>Strippers/Erotic Dance | <input type="checkbox"/> Concerts<br>Approx. # per year? _____                |
| <input type="checkbox"/> Bowling Alley<br>How many? _____                           | <input checked="" type="checkbox"/> Disc Jockey | <input type="checkbox"/> Wrestling                                      | <input type="checkbox"/> Theatrical Performances<br>Approx. # per year? _____ |
| <input type="checkbox"/> Pool Tables<br>How many? _____                             | <input type="checkbox"/> Magic Shows            | <input type="checkbox"/> Patron Contests                                | <input checked="" type="checkbox"/> Jukebox                                   |
| <input type="checkbox"/> Motion Pictures (movies by<br>admission) - How many? _____ | <input type="checkbox"/> Poetry Readings        | <input checked="" type="checkbox"/> Patrons Dancing                     | <input type="checkbox"/> Karaoke  |
| <input type="checkbox"/> Other: _____   |   |   |   |

Entertainment Outdoor Closing Hours: 10:00pm Sunday-Thursdays; 12:00am Friday & Saturday; unless a different time, either earlier or later, is established by the Common Council in its approval of the licensee's plan of operation.

## PROMOTERS/SOUND AMPLIFICATION

Will promoters ever be used for any of the entertainment? ☒ No ☐ Yes If Yes, Describe:

At any time will sound amplification be used? ☒ No ☐ Yes If Yes, Describe:

## LEGAL CAPACITY OF PREMISES

\_\_\_\_\_ (Call the Development Center at 414-286-8211 with questions.) Legal capacity determines the fee for your Public Entertainment Premises License. If you would like to request the license be approved with a lower capacity than that listed above, indicate the lower capacity here: \_\_\_\_\_. If approved, this lower capacity will print on your license and override the capacity listed on your Occupancy Permit.

## ACKNOWLEDGEMENT/SIGNATURE

I understand that after the license has been issued, a change to the plan of operation will require a written request to change and approval from the Common Council. I agree to inform the City Clerk within 10 days of any substantial changes in the information supplied in this application. I understand that I shall not willfully refuse to provide the services offered under this license, or add charges or require deposits not required of the general public because of race, color, sex, religion, national origin or ancestry, age, handicap, lawful source of income, marital status, sexual orientation, gender identity or expression, familial status or the fact that a person is now or has been a member of the military service, whether dressed in uniform or not; and shall not seek such information as a condition of employment, or penalize any employee or discriminate in the selection of personnel for training or promotion on the basis of such information.

I have knowledge of the City Ordinances currently regulating public entertainment, and understand that the license may be subject to suspension, non-renewal or revocation, if I violate any rule, law or regulation of the city of Milwaukee and State of Wisconsin.



Signature of Sole Proprietor, Partner or 20% or More Shareholder  
(If no 20% or more Shareholder, Corporate Officer - print name/title and sign)

## Office Use Only:

Initials: \_\_\_\_\_ Filed: \_\_\_\_\_ App: \_\_\_\_\_

Only PEP? ☐ No ☐ Yes If Yes, ☐ Queue to MPD and ☐ Email Mgrs/Team Lead (must be heard w/in 60 days)

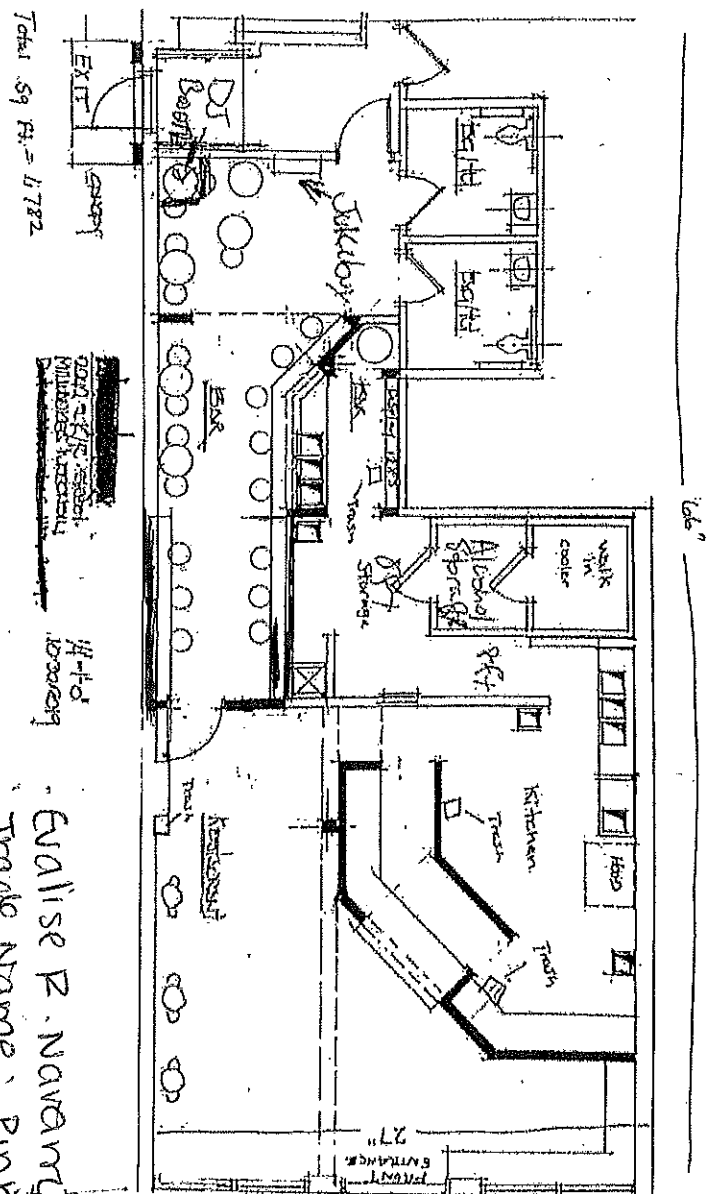

Kinnickinnic Ave

BBJ investing  
 Evalise P. NAVARNO Agent for Group LLC  
 Trade Name: PINK PIGARE  
 2947 S Kinnickinnic Ave, Milwaukee WI, 53207  
 Date: 07/06/2003

# BAR MENU

## GREEN POZOLE

Our Special Recipe

## MEXICAN ELOTE

Corn slathered in mayo, cojito cheese, chilli powder, and lime

## CHIPS & SALSA

Pairs perfect with a Paloma

## CHICKEN TOSTADAS

Shredded chipotle chicken, beans, topped with lettuce, cojita cheese, tomato, crema drizzle

## EASY LIVIN'

Our Special Recipe

## LEMON COLA

Our Special Recipe

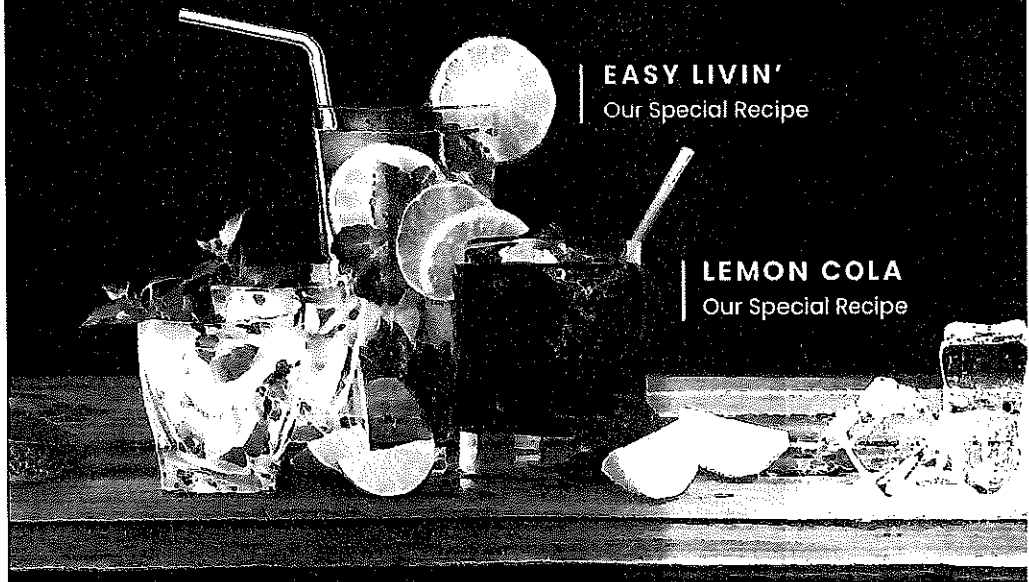

# PINK AGAVE

## COCKTAIL'S

### SIGNATURE

#### THE PINK AGAVE

Corralejo blanco tequila, agave, muddled blueberry & mint, watermelon juice

#### SPICY MAMI

Casamigos reposado, Grand Marnier, agave, sour, muddled jalapeños & lime

#### OG PALOMA

casamigos blanco, agave, freshly squeezed limes, jarrito grapefruit soda

#### BAD BUNNY (RUM MULE)

Malibu, ginger beer, freshly squeezed lime

#### SOMETHING REFRESHING

Kettle cucumber & mint vodka, muddled lime & tajin, lemon lime soda,

#### GRANNY'S LEMONADE

Hennessy, lemonade, strawberry purée

#### ISLAND MOJITO

Bacardi lmon, agave, muddled lime & mint, pineapple juice, mineral water

#### LIL' RAZZLE DAZZLE

Bombay bramble, Benedictine, orange Bitters, pineapple juice, lime juice, club soda

