



CITY OF MILWAUKEE  
OFFICE OF THE CITY CLERK

Tuesday, March 19, 2024

COMMITTEE MEETING NOTICE

AD 14

PHADUNGSIL, Kanokporn, Agent  
MPK 65 LLC  
2159 S KINNICKINNIC Av #A2  
Milwaukee, WI 53207

You are requested to attend a hearing which is to be held in Room 301-B, Third Floor, City Hall or you may attend virtually using the link below.

**Tuesday, March 26, 2024 at 11:20 AM**

The access code is <https://meet.goto.com/913368045>. If you wish to call in: [+1 \(408\) 650-3123](tel:+14086503123) and use Access Code: [913-368-045](tel:913368045)  
Please see the enclosed best practices document for further instructions.

**Regarding:** Your Class B Tavern and Food Dealer License Applications as agent for "MPK 65 LLC" for "ROOM SERVICE" at 2159 S KINNICKINNIC Av #A 

There is a possibility that your application may be denied for one or more of the following reasons: The recommendation of the committee regarding the application shall be based on evidence presented at the hearing. Per MCO 85-2.7-4, probative evidence concerning whether or not a new license should be granted may be presented on the following subjects: whether or not the applicant meets the municipal requirements, the appropriateness of the location and premises where the licensed premises is to be located and whether use of the premises for the purposes or activities permitted by the license would tend to facilitate a public or private nuisance or create undesirable neighborhood problems such as disorderly patrons, unreasonably loud noise, litter, and excessive traffic and parking congestion. Probative evidence relating to these matters may be taken from the plan of operation submitted with the license application, if any, but shall not include the content of any music. Evidence regarding the fitness of the location of the premises to be maintained as the principal place of business, including but not limited to whether there is an overconcentration of businesses of the type for which the license is sought; whether the proposal is consistent with any pertinent neighborhood business or development plans, or the location's proximity to areas where children are typically present. The applicant's record in operating similarly licensed premises; and whether or not the applicant has been charged with or convicted of any felony, misdemeanor, municipal offense or other offense, the circumstances of which substantially relate to the activity to be permitted by the license being applied for or any other factor which reasonably relates to the public health, safety or welfare may also be considered. See attached police report or correspondence.

**Notice for applicants with warrants or unpaid fines:**

**Proof of warrant satisfaction or payment of fines must be submitted at the hearing on the above date and time. Failure to comply with this requirement may result in a delay of the granting/denial of your application.**

Failure to appear at this meeting may result in the denial of your license. Individual applicants must appear only in person or by an attorney. Corporate or Limited Liability applicants must appear only by the agent designated on the application or by an attorney. Partnership applicants must appear by a partner listed on the application or by an attorney. If you wish to do so and at your own expense, you may be accompanied by an attorney of your choosing to represent you at this hearing. You will be given an opportunity to speak on behalf of the application and to respond and challenge any charges or reasons given for the denial. No petitions can be accepted by the committee, unless the people who signed the petition are present at the committee hearing and willing to testify. You may present witnesses under oath and you may also confront and cross-examine opposing witnesses under oath. If you have difficulty with the English language, you should bring an interpreter with you, at your expense, so that you can answer questions and participate in your hearing.

You may examine the application file at this office during regular business hours prior to the hearing date. Inquiries regarding this matter may be directed to the person whose signature appears below.

Limited parking for persons attending meetings during normal business hours is available at reduced rates (5 hour limit) at the Milwaukee Center on the southwest corner of Kilbourn Avenue and Water Street. You must present a copy of the meeting notice to the parking cashier.

PLEASE NOTE: Upon reasonable notice, efforts will be made to accommodate the needs of disabled individuals through sign language interpreters or other auxiliary aids. For additional information or to request this service, contact the Council Services Division ADA Coordinator at (414) 286-2998, Fax - (414) 286-3456, TDD - (414) 286-2025.

JIM OWCZARSKI, CITY CLERK

BY: \_\_\_\_\_

Jim Cooney  
License Division Manager

**If you have questions regarding this notice, please contact the License Division at (414) 286-2238.**

200 E. Wells Street, Room 105, City Hall, Milwaukee, WI 53202. [www.milwaukee.gov/license](http://www.milwaukee.gov/license)  
Phone: (414) 286-2238 Fax: (414) 286-3057 Email Address: [License@milwaukee.gov](mailto:License@milwaukee.gov)





CITY OF MILWAUKEE  
OFFICE OF THE CITY CLERK

Tuesday, March 19, 2024

COMMITTEE MEETING NOTICE

AD 14

PHADUNGSIL, Kanokporn, Agent  
MPK 65 LLC  
3909 N MURRAY AV #1109  
Shorewood, WI 53211

You are requested to attend a hearing which is to be held in Room 301-B, Third Floor, City Hall or you may attend virtually using the link below.

**Tuesday, March 26, 2024 at 11:20 AM**

The access code is <https://meet.goto.com/913368045>. If you wish to call in: **+1 (408) 650-3123** and use Access Code: **913-368-045**  
Please see the enclosed best practices document for further instructions.

**Regarding:** Your Class B Tavern and Food Dealer License Applications as agent for "MPK 65 LLC" for "ROOM SERVICE" at 2159 S KINNICKINNIC Av #A2.

There is a possibility that your application may be denied for one or more of the following reasons: The recommendation of the committee regarding the application shall be based on evidence presented at the hearing. Per MCO 85-2.7-4, probative evidence concerning whether or not a new license should be granted may be presented on the following subjects: whether or not the applicant meets the municipal requirements, the appropriateness of the location and premises where the licensed premises is to be located and whether use of the premises for the purposes or activities permitted by the license would tend to facilitate a public or private nuisance or create undesirable neighborhood problems such as disorderly patrons, unreasonably loud noise, litter, and excessive traffic and parking congestion. Probative evidence relating to these matters may be taken from the plan of operation submitted with the license application, if any, but shall not include the content of any music. Evidence regarding the fitness of the location of the premises to be maintained as the principal place of business, including but not limited to whether there is an overconcentration of businesses of the type for which the license is sought; whether the proposal is consistent with any pertinent neighborhood business or development plans, or the location's proximity to areas where children are typically present. The applicant's record in operating similarly licensed premises; and whether or not the applicant has been charged with or convicted of any felony, misdemeanor, municipal offense or other offense, the circumstances of which substantially relate to the activity to be permitted by the license being applied for or any other factor which reasonably relates to the public health, safety or welfare may also be considered. See attached police report or correspondence.

**Notice for applicants with warrants or unpaid fines:**

**Proof of warrant satisfaction or payment of fines must be submitted at the hearing on the above date and time. Failure to comply with this requirement may result in a delay of the granting/denial of your application.**

Failure to appear at this meeting may result in the denial of your license. Individual applicants must appear only in person or by an attorney. Corporate or Limited Liability applicants must appear only by the agent designated on the application or by an attorney. Partnership applicants must appear by a partner listed on the application or by an attorney. If you wish to do so and at your own expense, you may be accompanied by an attorney of your choosing to represent you at this hearing. You will be given an opportunity to speak on behalf of the application and to respond and challenge any charges or reasons given for the denial. No petitions can be accepted by the committee, unless the people who signed the petition are present at the committee hearing and willing to testify. You may present witnesses under oath and you may also confront and cross-examine opposing witnesses under oath. If you have difficulty with the English language, you should bring an interpreter with you, at your expense, so that you can answer questions and participate in your hearing.

You may examine the application file at this office during regular business hours prior to the hearing date. Inquiries regarding this matter may be directed to the person whose signature appears below.

Limited parking for persons attending meetings during normal business hours is available at reduced rates (5 hour limit) at the Milwaukee Center on the southwest corner of Kilbourn Avenue and Water Street. You must present a copy of the meeting notice to the parking cashier.

PLEASE NOTE: Upon reasonable notice, efforts will be made to accommodate the needs of disabled individuals through sign language interpreters or other auxiliary aids. For additional information or to request this service, contact the Council Services Division ADA Coordinator at (414) 286-2998, Fax - (414) 286-3456, TDD - (414) 286-2025.

JIM OWCZARSKI, CITY CLERK

BY: \_\_\_\_\_

Jim Cooney  
License Division Manager

If you have questions regarding this notice, please contact the License Division at (414) 286-2238.

200 E. Wells Street, Room 105, City Hall, Milwaukee, WI 53202. [www.milwaukee.gov/license](http://www.milwaukee.gov/license)  
Phone: (414) 286-2238 Fax: (414) 286-3057 Email Address: License@milwaukee.gov

Date:3/19/24  
Officer: PO Matthew Diener

City of Milwaukee Police Department  
90-5-1.5 Crime Prevention Survey  
Tavern Inspection

Name of Premise: Room Service  
Address: 2159 S Kinnickinnic Av  
Phone: 414-414-9789

Owner: Kanokporn PHADUNGSIL  
Owner address: 3909 N Murray Av #119  
City State Zip: Shorewood, WI 53211  
Owner Phone: 917-855-1058  
Owner email: info@roomservicebayview.com

Licensee/Agent: same  
Home Address:  
City State Zip:  
Phone:  
Email:

Preferred contact: Owner

Location currently open:  YES  NO

Projected open date: ASAP

Day's open: S M T W Th F SA ALL

Hours of Operation: Sun: 11a-10:30p 24 hours Y N  
Mon: 11a-10:30p  
Tue: 11a-10:30p  
Wed: 11a-10:30p  
Thu: 11a-10:30p  
Fri: 11:30a-1a  
Sat: 11:30a-1a

Premise Type:  Tavern/Bar  
 Restaurant  
 Other:

Licenses currently held:

- Alcohol:  Yes  No Class: #:  
Tobacco:  Yes  No #:  
Food:  Yes  No #:  
Other:  Yes  No Type: #:  
Other:  Yes  No Type: #:

**Exterior Survey:**

1. Is the area around the location clean?  Yes  No
2. What surrounds the location? (Check all the apply)
  - a.  Park
  - b.  School
  - c.  Youth Center
  - d.  Church
  - e.  Tavern(s) If so, how many
  - f.  Residential
  - g.  Other businesses
  - h.  Other:
3. Can you see from the outside of the location into the interior  Yes  No
4. Can you see the employees inside of the location from the outside  Yes  No
5. Are exterior windows free of signage  Yes  No
6. Street parking  Yes  No
7. Is there a parking lot  Yes  No
8. Is the parking lot clean?  Yes  No
9. Is the parking lot well lit?  Yes  No
10. Valet Parking  Yes  No
  - a. Will this lot have a guard?  Yes  No
  - b. Will this lot have cameras?  Yes  No
11. Are there areas where a person could conceal themselves  Yes  No
12. Is there exterior lighting?  Yes  No. Does it appears to be adequate  Yes  No
13. Exterior Payphone?  Yes  No
14. Are there No Loitering Signs posted?  Yes  No
15. Are there exterior security cameras  Yes  No How Many: 4
16. Are the address numbers prominently displayed and easy to see  Yes  No

**Camera Survey:**

17. Does this location have security cameras?  Yes  No
18. Are they in working order?  Yes  No
19. What format are the cameras?
  - a. Color  Yes  No
  - b. Digital  Yes  No
  - c. VCR  Yes  No
  - d. Recorded  Yes  No
20. How long is footage stored for later viewing: 2 weeks
21. Are there exterior cameras  Yes  No How many: 4
22. Are there interior cameras  Yes  No How many: 5

23. Do all employees know how to retrieve recorded digital images/footage?  Yes  No  
 24. Cameras located in parking lot  Yes  No How many1

**Interior Survey:**

25. What is the planned/posted capacity 117  
 26. What is the minimum number of employees that will be on premise 8  
 27. Is the storeowner willing to be a standing complainant regarding loitering?  Yes  No  
 a. If yes have them fill out the standing complaint form and give them two of the commercial signs  Yes  No  
 28. Is the interior of the location neat and clean?  Yes  No  
 29. Does an interior camera face the entrance/exit?  Yes  No  
 30. Are emergency and non-emergency numbers posted near the phone?  Yes  No  
 31. Does the owner know how to contact their police district directly?  Yes  No  
 a. Did you provide a district contact guide to the owner?  Yes  No

**Security**

32. How many security personnel are going to be employed: N/A  
 33. How will they be deployed: Interior Exterior  
 34. What days will they be deployed  Mon  Tue  Wed  Thu  Fri  Sat  Sun  
 35. Will the security be managed by business  or contracted   
 36. Will they be armed  Yes  No  
 37. What type of security measures will be used:  
 Wanding/metal detector  
 ID Scanner  
 Dress Code  
 Cover Charge  
 Age restriction  
 Other  
 38. When at capacity, how will the overflow crowd be managed?  
 39. Will a guard monitor the overflow crowd at all times?  Yes  No

**ADDITIONAL COMMENTS/RECOMMENDATIONS:**

Premise will be an upscale Thai restaurant with a rear parking lot and upstairs patio. Location very clean and well lit with camera coverage.





# Concentration Map for 2159 S Kinnickinnic Ave Unit A2

## Area of Interest (AOI) Information

Area : 21,862,585.55 ft<sup>2</sup>

Feb 20 2024 9:53:12 Central Standard Time

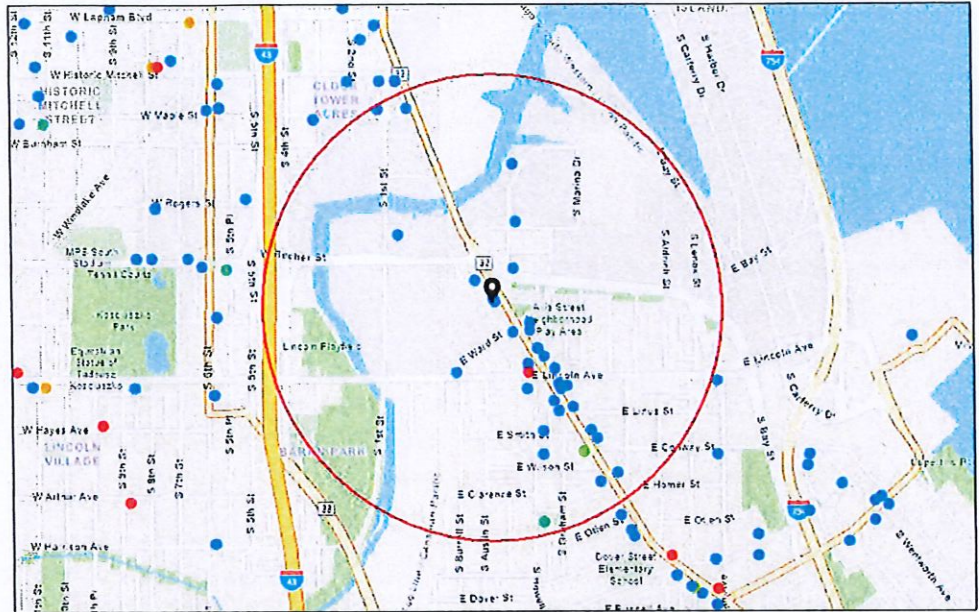

- Alcohol Licenses (active)
- Class A Femented Malt Beverage
  - Class A Liquor and Malt
  - Class B Fermented Malt Beverage
  - Class B Tavern
  - Class C Wine Retailer

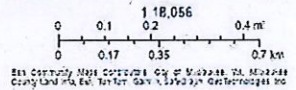

### Summary

| Name             | Count | Area(ft <sup>2</sup> ) | Length(mi) |
|------------------|-------|------------------------|------------|
| Alcohol Licenses | 36    |                        |            |

Alcohol Licenses



| #  | Legal Entity                       | Trade Name                    | Licensee                         | Address                    | License Type Name                                  | Total Capacity | Expiration Date    | Count |
|----|------------------------------------|-------------------------------|----------------------------------|----------------------------|--|----------------|--------------------|-------|
| 1  | Egg & Flour II LLC                 | Egg & Flour                   | Adam M Pawlak, Agt               | 2273 S HOWELL AV           | Class B Tavern License                             |                | 3/2/2024, 6:00 PM  | 1     |
| 2  | Lion's Tooth, LLC                  | Lion's Tooth                  | Michelle M McClone-Carriere, Agt | 2421 S KINNICKINNI C AV    | Class B Fermented Malt Beverage Retailer's License |                | 3/22/2024, 7:00 PM | 1     |
| 3  | Lion's Tooth, LLC                  | Lion's Tooth                  | Michelle M McClone-Carriere, Agt | 2421 S KINNICKINNI C AV    | Class C Wine Retailer's License                    |                | 3/22/2024, 7:00 PM | 1     |
| 4  | SABOR TROPICAL RESTAURANT LLC      | SABOR TROPICAL                | Julio R Arias, Agt               | 2258 S KINNICKINNI C AV    | Class B Tavern License                             |                | 3/18/2024, 7:00 PM | 1     |
| 5  | BAY STREET PUB, LLC                | BAY STREET PUB                | MARK R PASCHAL, Agt              | 338 E BAY ST               | Class B Tavern License                             | 70             | 4/13/2024, 7:00 PM | 1     |
| 6  | CIAO CUCINA, LLC                   | CAFE LULU                     | SARAH F JONAS, Agt               | 2261-65 S Howell AV        | Class B Tavern License                             | 189            | 4/8/2024, 7:00 PM  | 1     |
| 7  | LANDLUBBER S, INC                  | BARNACLE BUD'S                | GENE M MC KIERNAN, Agt           | 1955 S HILBERT ST          | Class B Tavern License                             | 50             | 4/2/2024, 7:00 PM  | 1     |
| 8  | Tulum Latin Gastropub, LLC         | Tulum Latin Gastropub         | Ernesto Carmona, Agt             | 2352-54 S KINNICKINNI C AV | Class B Tavern License                             |                | 4/24/2024, 7:00 PM | 1     |
| 9  | Lost Whale Enterprises LLC         | Lost Whale                    | Richard W Duval, Agt             | 2151 S KINNICKINNI C AV    | Class B Tavern License                             |                | 6/18/2024, 7:00 PM | 1     |
| 10 | NEVADA PRODUCTIONS LLC             | THE TONIC TAVERN              | PAUL U JONAS, Agt                | 2335 S KINNICKINNI C AV    | Class B Tavern License                             | 99             | 2/26/2024, 6:00 PM | 1     |
| 11 | Cream City Hospitality LLC         | Heirloom MKE                  | Jessica J Ignatiev, Agt          | 2376-78 S HOWELL AV        | Class B Tavern License                             |                | 6/20/2024, 7:00 PM | 1     |
| 12 | DRI 5 BAYVIEW LLC                  | Centraal Grand Cafe & Tappery | ERIC G WAGNER, Agt               | 2306 S KINNICKINNI C AV    | Class B Tavern License                             | 261            | 6/29/2024, 7:00 PM | 1     |
| 13 | MAPLE LEAF ENTERPRISES, LLC        | SUGAR MAPLE                   | ADRIENNE M PIERLUISSI, Agt       | 441 E LINCOLN AV           | Class B Tavern License                             | 160            | 7/29/2024, 7:00 PM | 1     |
| 14 | BOTTLE MILWAUKEE, LLC              | THE BOTTLE MILWAUKEE          | TONY D WOJTECKI, Agt             | 1753 S KINNICKINNI C AV    | Class B Tavern License                             | 99             | 7/25/2024, 7:00 PM | 1     |
| 15 | HIGGSKI, INC                       | BAY VIEW BOWL                 | MICHAEL S KOSINSKI, Agt          | 2416 S KINNICKINNI C AV    | Class B Tavern License                             | 160            | 7/25/2024, 7:00 PM | 1     |
| 16 | SUSHI YUKI RESTAURANT, INC.        | SUSHI YUKI                    | Jin San Koh, Agt                 | 2349 S KINNICKINNI C AV    | Class B Tavern License                             |                | 7/24/2024, 7:00 PM | 1     |
| 17 | Three Sheets LLC                   | The Stone                     | SHAWN T LEET, Agt                | 2422 S Howell AV           | Class B Tavern License                             | 80             | 7/28/2024, 7:00 PM | 1     |
| 18 | Guanajuato Mexican Restaurant, LLC | Guanajuato Mexican Restaurant | CAROLINA GAMINO, Agt             | 2317 S Howell AV           | Class B Tavern License                             |                | 8/2/2024, 7:00 PM  | 1     |



|    |                           |                              |                            |                                |  |     |                     |   |
|----|---------------------------|------------------------------|----------------------------|--------------------------------|--|-----|---------------------|---|
| 19 | SUMO, LLC                 | THE HIGHBURY PUB             | JOSEPH R KATZ, Agt         | 2322 S KINNICKINNI C AV        | Class B Tavern License                             | 80  | 7/26/2024, 7:00 PM  | 1 |
| 20 | MPR CORPORATION           | Bay View Supermarket         | PARESH C PATEL, Agt        | 2277 S HOWELL AV               | Class A Malt & Class A Liquor License              |     | 9/19/2024, 7:00 PM  | 1 |
| 21 | Rap Us Corp               | Cafe India - Bar & Grill     | RAKESH REHAN, Agt          | 2201 S Kinnickinnic AV         | Class B Tavern License                             |     | 9/14/2024, 7:00 PM  | 1 |
| 22 | Semolina MKE LLC          | Semolina MKE                 | Petra L Orłowski, Agt      | 2474 S KINNICKINNI C AV        | Class B Tavern License                             |     | 10/16/2024, 7:00 PM | 1 |
| 23 | Vine Society LLC          | Voyager Wine & Cocktail Bar  | JORDAN A BURICH, Agt       | 422 E Lincoln AV               | Class B Tavern License                             | 49  | 10/17/2024, 7:00 PM | 1 |
| 24 | AA Entertainment, LLC     | The Backyard                 | Sam J Leaf, Agt            | 2155 S KINNICKINNI C AV        | Class B Tavern License                             | 160 | 10/17/2024, 7:00 PM | 1 |
| 25 | Revel Group Inc           | Revel                        | Haley Irene Garcia, Agt    | 2246 S Kinnickinnic AV         | Class B Tavern License                             | 80  | 10/31/2024, 7:00 PM | 1 |
| 26 | Bridgewater MKE, LLC      | Bridgewater Modern Grill     | David J Marcus, Agt        | 2011 S 1ST ST Unit 4           | Class B Tavern License                             |     | 10/29/2024, 7:00 PM | 1 |
| 27 | B&J Investing Group LLC   | Pink Agave                   | Evalise R Navarro, Agt     | 2242 S KINNICKINNI C AV        | Class B Tavern License                             |     | 11/11/2024, 6:00 PM | 1 |
| 28 | RSVR LLC                  | RSVR                         | Reid C Spiering, Agt       | 2210 S KINNICKINNI C AV        | Class B Tavern License                             |     | 11/19/2024, 6:00 PM | 1 |
| 29 | ST AUGUSTINE CONGREGATION | ST AUGUSTINE OF HIPPO PARISH | Joseph A Laska, Agt        | 2530 S HOWELL AV               | Class B Fermented Malt Beverage Retailer's License |     | 12/30/2024, 6:00 PM | 1 |
| 30 | RED MAPLE MKE LLC         | RED MAPLE MKE                | Robin L Koutecky, Agt      | 100 W MAPLE ST                 | Class B Tavern License                             | 49  | 1/15/2025, 6:00 PM  | 1 |
| 31 | Morgan Kenwood, LTD       | Avalon                       | JANE M SCHILZ, Agt         | 2473 S Kinnickinnic AV         | Class B Tavern License                             |     | 1/16/2025, 6:00 PM  | 1 |
| 32 | JSK Social Inc.           | Satchmo's                    | Ting M Burazin, Agt        | 182 E LINCOLN AV               | Class B Tavern License                             |     | 1/8/2025, 6:00 PM   | 1 |
| 33 | MARY JANE RESTAURANTS LLC | Cheba Hut                    | Heather R Huhn, Agt        | 2202 S KINNICKINNI C AV        | Class B Tavern License                             |     | 2/1/2025, 6:00 PM   | 1 |
| 34 | TODDBAYVIEW LLC           | TODD I BELIEVE I CAN FRY     | Paphitchaya Liotrakun, Agt | 2159 S KINNICKINNI C AV Unit 1 | Class B Tavern License                             |     | 1/15/2025, 6:00 PM  | 1 |
| 35 | GW Mireles Inc            | Cafe Corazon Bay View        | GEORGE MIRELES, Agt        | 2394 S Kinnickinnic AV         | Class B Tavern License                             | 99  | 2/2/2025, 6:00 PM   | 1 |
| 36 | Homerun Holdings LLC      | Santino's Social Club        | Gregory L Huber, Agt       | 352 E Stewart ST               | Class B Tavern License                             |     | 3/1/2025, 6:00 PM   | 1 |

Establishments within a 0.5 miles radius centered on area of interest.



Tuesday, March 19, 2024



# Notice of Public Hearing

Blank Notice

---

PHADUNGSIL, Kanokporn, Agent  
ROOM SERVICE at 2159 S KINNICKINNIC Av #A2  
Class B Tavern and Food Dealer License Applications

**Tuesday, March 26, 2024 at 11:20 AM**

To whom it may concern:

The above application has been made by the above named applicant(s). This requires approval from the Licenses Committee and the Common Council of the City of Milwaukee. The hearing before the Licenses Committee will take place on 3/26/2024 at 11:20 AM in Room 301-B, Third Floor, City Hall. This is a public hearing. Those wishing to view the proceeding are able to do so via the City Channel – Channel 25 on Spectrum Cable – or on the Internet at <http://city.milwaukee.gov/citychannel>. Those wishing to provide oral testimony via phone or internet are asked to contact the staff assistant, Yadira Melendez at (414) 286-2775 or [stasst5@milwaukee.gov](mailto:stasst5@milwaukee.gov) for necessary information. Please make such requests no later than one business day prior to the start of the meeting. You are not required to attend the hearing, but please see the information below if you would like to provide testimony. Once the Licenses Committee makes its recommendation, this recommendation is forwarded to the full Common Council for approval at its next regularly scheduled hearing.

---

## Important details for those wishing to provide information for the Licenses Committee to consider when making its recommendation:

1. The license application is scheduled to be heard at the above time. Due to other hearings running longer than scheduled, you may have to wait some time to provide your testimony.
2. You must appear in person and testify as to matters that you have personally experienced or seen. (You cannot provide testimony for your neighbor, parent or anyone else; this is considered hearsay and cannot be considered by the committee.)
3. No letters or petitions can be accepted by the committee (unless the person who wrote the letter or the persons who signed the petition are present at the committee hearing and willing to testify).
4. Persons opposed to the license application are given the opportunity to testify first; supporters may testify after the opponents have finished.
5. When you are called to testify, you will be sworn in and asked to give your name, and address. (If your first and/or last names are uncommon please spell them.)
6. You may then provide testimony.
  - a. Include only information relating to the above license application.
  - b. Include only information you have personally witnessed or seen.
  - c. Provide concise and relevant information detailing how this business has affected or may affect the peaceful enjoyment of your neighborhood.
  - d. If by the time you have the opportunity to testify, the information you wish to share has already been provided to the committee, you may state that you agree with the previous testimony. Redundant or repetitive testimony will not assist the committee in making its recommendation.
7. After giving your testimony, the members of the Licenses Committee and the licensee may ask questions regarding the testimony you have given or other factors relating to the license application.
8. Business Competition is not a valid basis for denial or non-renewal of a license.  
**Please Note: If you have submitted an objection to the above application your objection cannot be considered by the committee unless you personally testify at the hearing.**

















|                  |                            |                          |
|------------------|----------------------------|--------------------------|
| CURRENT OCCUPANT | 2161 S ROBINSON AVE# 307   | MILWAUKEE, WI 53207-1378 |
| CURRENT OCCUPANT | 2161 S ROBINSON AVE# 308   | MILWAUKEE, WI 53207-1378 |
| CURRENT OCCUPANT | 2161 S ROBINSON AVE# 309   | MILWAUKEE, WI 53207-1378 |
| CURRENT OCCUPANT | 2161 S ROBINSON AVE# 310   | MILWAUKEE, WI 53207-1378 |
| CURRENT OCCUPANT | 2161 S ROBINSON AVE# 311   | MILWAUKEE, WI 53207-1378 |
| CURRENT OCCUPANT | 2161 S ROBINSON AVE# 312   | MILWAUKEE, WI 53207-1378 |
| CURRENT OCCUPANT | 2161 S ROBINSON AVE# 313   | MILWAUKEE, WI 53207-1378 |
| CURRENT OCCUPANT | 2161 S ROBINSON AVE# 314   | MILWAUKEE, WI 53207-1378 |
| CURRENT OCCUPANT | 2161 S ROBINSON AVE# 315   | MILWAUKEE, WI 53207-1378 |
| CURRENT OCCUPANT | 2161 S ROBINSON AVE# 316   | MILWAUKEE, WI 53207-1378 |
| CURRENT OCCUPANT | 2161 S ROBINSON AVE# 317   | MILWAUKEE, WI 53207-1378 |
| CURRENT OCCUPANT | 2161 S ROBINSON AVE# 318   | MILWAUKEE, WI 53207-1378 |
| CURRENT OCCUPANT | 2163A S KINNICKINNIC AVE   | MILWAUKEE, WI 53207-1327 |
| CURRENT OCCUPANT | 2179 S KINNICKINNIC AVE    | MILWAUKEE, WI 53207-1327 |
| CURRENT OCCUPANT | 2180 S ROBINSON AVE        | MILWAUKEE, WI 53207-1336 |
| CURRENT OCCUPANT | 2180A S ROBINSON AVE       | MILWAUKEE, WI 53207-1336 |
| CURRENT OCCUPANT | 2183 S KINNICKINNIC AVE    | MILWAUKEE, WI 53207-1327 |
| CURRENT OCCUPANT | 2186 S ROBINSON AVE        | MILWAUKEE, WI 53207-1336 |
| CURRENT OCCUPANT | 2187 S KINNICKINNIC AVE    | MILWAUKEE, WI 53207-1327 |
| CURRENT OCCUPANT | 2187A S KINNICKINNIC AVE   | MILWAUKEE, WI 53207-1327 |
| CURRENT OCCUPANT | 2188 S ROBINSON AVE        | MILWAUKEE, WI 53207-1336 |
| CURRENT OCCUPANT | 2188 S ROBINSON AVE# 1     | MILWAUKEE, WI 53207-1336 |
| CURRENT OCCUPANT | 2188 S ROBINSON AVE# 2     | MILWAUKEE, WI 53207-1336 |
| CURRENT OCCUPANT | 2188 S ROBINSON AVE# 3     | MILWAUKEE, WI 53207-1336 |
| CURRENT OCCUPANT | 2188 S ROBINSON AVE# 4     | MILWAUKEE, WI 53207-1336 |
| CURRENT OCCUPANT | 2189 S KINNICKINNIC AVE    | MILWAUKEE, WI 53207-1327 |
| CURRENT OCCUPANT | 2189 S KINNICKINNIC AVE# A | MILWAUKEE, WI 53207-1327 |
| CURRENT OCCUPANT | 250 E WARD ST# 101         | MILWAUKEE, WI 53207-1373 |
| CURRENT OCCUPANT | 250 E WARD ST# 102         | MILWAUKEE, WI 53207-1373 |
| CURRENT OCCUPANT | 250 E WARD ST# 103         | MILWAUKEE, WI 53207-1373 |
| CURRENT OCCUPANT | 250 E WARD ST# 104         | MILWAUKEE, WI 53207-1373 |
| CURRENT OCCUPANT | 250 E WARD ST# 105         | MILWAUKEE, WI 53207-1373 |
| CURRENT OCCUPANT | 250 E WARD ST# 106         | MILWAUKEE, WI 53207-1373 |
| CURRENT OCCUPANT | 250 E WARD ST# 107         | MILWAUKEE, WI 53207-1373 |
| CURRENT OCCUPANT | 250 E WARD ST# 108         | MILWAUKEE, WI 53207-1373 |
| CURRENT OCCUPANT | 250 E WARD ST# 109         | MILWAUKEE, WI 53207-1373 |
| CURRENT OCCUPANT | 250 E WARD ST# 110         | MILWAUKEE, WI 53207-1373 |
| CURRENT OCCUPANT | 250 E WARD ST# 111         | MILWAUKEE, WI 53207-1373 |
| CURRENT OCCUPANT | 250 E WARD ST# 112         | MILWAUKEE, WI 53207-1373 |
| CURRENT OCCUPANT | 250 E WARD ST# 113         | MILWAUKEE, WI 53207-1373 |
| CURRENT OCCUPANT | 250 E WARD ST# 114         | MILWAUKEE, WI 53207-1373 |
| CURRENT OCCUPANT | 250 E WARD ST# 115         | MILWAUKEE, WI 53207-1373 |
| CURRENT OCCUPANT | 250 E WARD ST# 116         | MILWAUKEE, WI 53207-1373 |
| CURRENT OCCUPANT | 250 E WARD ST# 117         | MILWAUKEE, WI 53207-1373 |
| CURRENT OCCUPANT | 250 E WARD ST# 118         | MILWAUKEE, WI 53207-1373 |
| CURRENT OCCUPANT | 250 E WARD ST# 119         | MILWAUKEE, WI 53207-1373 |
| CURRENT OCCUPANT | 250 E WARD ST# 120         | MILWAUKEE, WI 53207-1373 |









|                  |                    |                          |
|------------------|--------------------|--------------------------|
| CURRENT OCCUPANT | 310 E WARD ST# 405 | MILWAUKEE, WI 53207-1374 |
| CURRENT OCCUPANT | 310 E WARD ST# 406 | MILWAUKEE, WI 53207-1374 |
| CURRENT OCCUPANT | 310 E WARD ST# 407 | MILWAUKEE, WI 53207-1374 |
| CURRENT OCCUPANT | 310 E WARD ST# 408 | MILWAUKEE, WI 53207-1374 |
| CURRENT OCCUPANT | 310 E WARD ST# 409 | MILWAUKEE, WI 53207-1374 |
| CURRENT OCCUPANT | 310 E WARD ST# 410 | MILWAUKEE, WI 53207-1374 |
| CURRENT OCCUPANT | 310 E WARD ST# 411 | MILWAUKEE, WI 53207-1374 |
| CURRENT OCCUPANT | 310 E WARD ST# 412 | MILWAUKEE, WI 53207-1374 |
| CURRENT OCCUPANT | 310 E WARD ST# 413 | MILWAUKEE, WI 53207-1374 |
| CURRENT OCCUPANT | 310 E WARD ST# 414 | MILWAUKEE, WI 53207-1374 |
| CURRENT OCCUPANT | 310 E WARD ST# 415 | MILWAUKEE, WI 53207-1374 |
| CURRENT OCCUPANT | 310 E WARD ST# 416 | MILWAUKEE, WI 53207-1374 |
| CURRENT OCCUPANT | 310 E WARD ST# 417 | MILWAUKEE, WI 53207-1374 |
| CURRENT OCCUPANT | 310 E WARD ST# 418 | MILWAUKEE, WI 53207-1374 |
| CURRENT OCCUPANT | 310 E WARD ST# 419 | MILWAUKEE, WI 53207-1374 |
| CURRENT OCCUPANT | 326 E ARCHER AVE   | MILWAUKEE, WI 53207-1323 |
| CURRENT OCCUPANT | 326A E ARCHER AVE  | MILWAUKEE, WI 53207-1323 |
| CURRENT OCCUPANT | 338 E WARD ST      | MILWAUKEE, WI 53207-1348 |
| CURRENT OCCUPANT | 338A E WARD ST     | MILWAUKEE, WI 53207-1348 |

Blank Notice

Total Records: 488

Radius 250.0 feet and Center of the Circle: 2159 S Kinnickinnic Av



# BUSINESS LICENSE PLAN OF OPERATION

ccl-busplan 5/12/2020

Office of the City Clerk License Division  
200 E. Wells St. Room 105, Milwaukee, WI 53202  
(414) 286-2238 www.milwaukee.gov/license e-mail address: license@milwaukee.gov

## 1. Type of Business

Applying for:  Extended Hours (12AM to 5AM) - If a food establishment, check all that apply:  Delivery  Drive Thru  Dining Room  
 Self Service Laundry  Massage Establishment  Filling Station  
 Other (supplemental application for specific license also required)

Provide a detailed description of the type of business you plan on operating:  
**RESTAURANT WITH DINE IN / CARRY OUT AND DELIVERY**

Do you have any experience operating this type of business?  No  Yes If yes, explain: **I OWN RESTAURANT IN NYC FOR 6 YEARS**

## 2. Business Operations

- a. Proposed Opening Date: 03/15/2024
- b. Is this premise under construction?  No  Yes If yes, list estimated completion date: 02/29/2024
- c. Is this a franchise?  No  Yes
- d. Is this premises currently licensed?  No  Yes If yes, list type of license: \_\_\_\_\_
- e. Is the current licensee operating?  No  Yes If no, list date closed: \_\_\_\_\_
- f. Do you have future plans for other businesses, licenses or permits at this location?  No  Yes  
If yes, explain: \_\_\_\_\_
- g. Have you previously held an Extended Hours License in Milwaukee?  No  Yes  
If yes, list address(es): \_\_\_\_\_
- h. Are other businesses operating in the same building?  No  Yes If yes, describe: \_\_\_\_\_

## 3. Litter & Noise

- a. How are grounds kept clean?  Sweep  Pressure Wash  Pick Up Litter  Other: \_\_\_\_\_
- b. How often will grounds be cleaned?  Daily  Weekly  As Needed  Monthly  Other: \_\_\_\_\_
- c. Grounds cleaned by:  Licensee  Building Owner  Employees  Hired Maintenance  Other: \_\_\_\_\_
- d. How are noise issues prevented and/or addressed?  Security  Manager approaches customer(s)  Call Police  
 Signs Posted  Other: \_\_\_\_\_
- e. Will a sound amplification system be used?  No  Yes If yes, describe: \_\_\_\_\_

## 4. Smoking & Sanitation

- a. Are there designated outdoor smoking areas?  No  Yes If yes, describe: \_\_\_\_\_
- b. Number of Garbage Cans: Inside: 8 Locations: 2 BATHROOMS, SUSHI BAR, KITCHEN, DISH WASHER, DRINK BAR  
Outside: 1 Locations: BY PARKING IN THE BACK
- c. Is a crowd control barrier used?  No  Yes If yes, describe: \_\_\_\_\_
- d. How many restrooms are on the premises? 2
- e. Name of solid waste contractor:  Advanced Disposal  Waste Management  Other: EAGLE



### 5. Security

- a. Are there onsite parking spaces?  No  Yes If yes, how many? \_\_\_\_\_ and describe the parking security plan: \_\_\_\_\_
- b. Is there a loading zone?  No  Yes If yes, describe the loading area security plan: \_\_\_\_\_
- c. Will you have security personnel on premise?  No  Yes If yes, how many? \_\_\_\_\_ and answer the following:  
 What are their responsibilities? \_\_\_\_\_  
 Is security equipment used?  No  Yes If yes, describe \_\_\_\_\_  
 List their licensing, certification, or training credentials \_\_\_\_\_
- d. Will there be security cameras?  No  Yes If yes, how many? 8 and list locations: OUT DOOR, SUSHI, KITCHEN DRINK BAR, CASHIER
- e. Will searches/identification checks be done upon entry?  No  Yes If yes, describe \_\_\_\_\_

### 6. Percentage of Sales (must total 100%)

|                             |   |   |                                  |
|-----------------------------|---|---|----------------------------------|
| Alcohol <u>30</u> %         | Food <u>170</u> %                                   | Secondhand Merchandise _____ %  | Precious Metals & Gems _____ %   |
| Entertainment _____ %       | Cigarettes _____ %                                  | Personal Services (such as tattoo, body piercing, salon, tailor, tanning, etc.) _____ % | Other _____ %<br>Describe: _____ |
| Pawnbroker Activity _____ % | Salvaged Materials _____ %<br>(such as scrap metal) |   |                                  |

### 7. Businesses/Licenses on the Premises (check all that apply):

#### Type 1

- Full Service Restaurant     Cafe/Coffee Shop     Deli or Fast Food Restaurant     Private/Fraternal/Veterans Club
- Night Club     Tavern     Cocktail Lounge     Teen Club
- Banquet Hall     Sports Facility     Bowling Alley
- Hotel/Motel : Number of Floors: \_\_\_\_\_     Rooming House: Number of Floors: \_\_\_\_\_  
 Number of Rooms: \_\_\_\_\_    Number of Rooms: \_\_\_\_\_

#### Type 2

- Liquor Store     Corner Store     Supermarket     Convenience Store
- Gas Station     Amusement/Phonograph Distributor     Recycling, Salvage or Towing
- Used Car Dealer     Personal Service Establishment  
 (such as tattoo business, hair salon, tailor, etc.)     Recording Studio

What other licenses/permits will you hold at this location? (check all that apply)

- Occupancy Permit     Cigarette & Tobacco     Gas Station     Extended Hours     Class "B" Tavern     Weights & Measures
- Secondhand Dealer     Precious Metal & Gem     Other: \_\_\_\_\_

### 8. Legal Capacity (only if a Type 1 premises in #7 above)

Capacity \_\_\_\_\_ (Call the Milwaukee Development Center at 414-286-8211 if you have questions.)

## 9. Premises Description

- a. Identify all area(s) of the premises that will be used in operating this business (include areas used only for storage):  
 1<sup>st</sup> Floor  2<sup>nd</sup> Floor  Basement Storage  Patio  Beer Garden  Sidewalk Café  Deck  Rooftop  
 Other: Describe: \_\_\_\_\_
- b. Describe Location:  Major Thoroughfare  Secondary Street  Other: MAIN ST. (KINNICKINNIG AVE)
- c. Nearest Major Cross Street: ROBINSON AVE
- d. Describe Building:  Free Standing Building  Strip Mall  Other: \_\_\_\_\_
- e. Describe Premises Structure:  Single Story  Multi-Story - # of Stories \_\_\_\_\_  Other: 1 WITH ROOFTOP
- f. Describe Surrounding Area:  Commercial  Residential  Industrial  Other: \_\_\_\_\_
- g. Building Owner Name: JTC COMMERCIAL LLC Phone Number: 715-429-0499  
 Building Owner Address: 2170 S ROBINSON AVE, MILWAUKEE, WI 53207

## 10. Hours of Operation & Customers

Will customers be entering the premises?  No  Yes

| Day of the Week | Proposed Hours of Operation:     |                                   | Estimated Number of Customers expected each day | Potential Age Range of Customers | Class B Tavern Applicant Only: Age Restriction (If none, write 'None') |
|-----------------|----------------------------------|-----------------------------------|---|----------------------------------|--|
|                 | Open Time (include a.m. or p.m.) | Close Time (include a.m. or p.m.) |   |                                  |  |
| Sunday          | 12 PM.                           | to 12 AM                          | 100   | 22 - 60                          |  |
| Monday          | 11:30 AM                         | 12 AM                             | 100   | 22 - 60                          |  |
| Tuesday         | 11:30 AM                         | 12 AM                             | 100   | 22 - 60                          |  |
| Wednesday       | 11:30 AM                         | 12 AM                             | 100   | 22 - 60                          |  |
| Thursday        | 11:30 AM                         | 12 AM                             | 100   | 22 - 60                          |  |
| Friday          | 11:30 AM                         | 1 AM                              | 100   | 22 - 60                          |  |
| Saturday        | 11:30 AM                         | 1 AM.                             | 100   | 22 - 60                          |  |

An Extended Hours Establishment License is required for any convenience store, filling station, personal service establishment (such as tattoo, body piercing, salon, tailor, tanning, etc.), recording studio or restaurant which is open between the hours of 12:00 a.m. and 5:00 a.m.

Alcohol Establishments Class A: 8:00 am to 9:00 pm Sunday thru Saturday  
 Permitted Hours of Operation: Class B: 6:00 am to 2:00 am Sunday thru Thursday, 6:00 am to 2:30 am Friday & Saturday

Entertainment Outdoor Closing Hours: 10:00pm Sunday-Thursday; 12:00am Friday & Saturday; unless a different time, either earlier or later, is established by the Common Council in its approval of the licensee's plan of operation.

## 11. Signature(s)

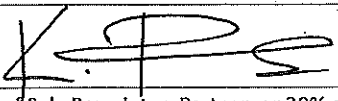
  
 \_\_\_\_\_  
 Signature of Sole Proprietor, Partner, or 20% or more Shareholder  
 (If there are no 20% or more shareholders,  
 Corporate Officer-print name/title and sign)

\_\_\_\_\_  
 Signature of additional partner or 20% or more shareholder

See Application Information for a complete list of all required application forms.



## ALCOHOL BEVERAGE & PUBLIC ENTERTAINMENT PREMISES SUPPLEMENTAL APPLICATION

Office of the City Clerk License Division  
200 E. Wells St. Room 105, Milwaukee, WI 53202  
(414) 286-2238 e-mail address: license@milwaukee.gov [www.milwaukee.gov/license](http://www.milwaukee.gov/license)

Legal Entity Name: MPK 65 LLC

Premise Address: 2159 Unit A2 S. Kinnickinnic Ave Milwaukee WI 53207

### Proximity of Premises to Church, School, Daycare Center or Hospital

Is the building within 300 feet of any church, school, daycare center or hospital?  No  Yes

### "Service Bar Only" Designation

If applying for Class B or C license, are you applying for "Service Bar Only"?  No  Yes

Service Bar Only means customers cannot sit at the bar. Alcohol is served to employees who serve patrons seated at tables. No stools, chairs or other articles of furniture shall be placed at the service bar for patrons to sit upon.

### Business Information

a) Are you taking out this application for anyone that may not be eligible for a license?  No  Yes

If yes, list their name and address: \_\_\_\_\_

b) Will the agent, a partner or the individual licensee be conducting the day-to-day operations of the business?  No  Yes

If no, list the name and address of the person(s) who will: \_\_\_\_\_

Class B Applicants: If the agent, a partner or the individual licensee will not be conducting the day-to-day operations of the business, the person(s) listed above must obtain a Class B Managers license.

c) Does anyone else have money invested or any other interest in this business?  No  Yes

If yes, explain: \_\_\_\_\_

d) Have you made an agreement with anyone to repay any loan or any other payments based upon income from the business?

No  Yes If yes, list name and address: \_\_\_\_\_

### Property Information (New & Transfer Applicants Only)

a) Do you own or lease the building?  Own  Lease

b) Who owns the fixtures (for example, coolers, etc.)? \_\_\_\_\_

c) Are you purchasing the stock and/or fixtures?  No  Yes If yes, amount paid \$ 450,000

d) Total amount paid for business \$ 2,000,000

e) Total amount paid for goodwill of the business \$ \_\_\_\_\_

Goodwill comprises the reputation and customer relationships of an existing business. If the price you pay for the business exceeds the fair market value of all of the rest of the assets of the business, the excess may be considered goodwill.

f) Have you made arrangements with the seller for payment of personal property taxes?  No  Yes

### Lease Information (New & Transfer Applicants who are leasing the premises only)

a) Date lease begins 09/01/2023 Ends 09/01/2033

b) Monthly rental \$ 7,500

c) Do you have an option to renew the lease?  No  Yes

d) Does your lease allow for assignment to another party without the consent of the owner?  No  Yes

e) For what length of time have you been guaranteed occupancy (number of years)? 20

### Lease Information (Continued)

- f) In addition to paying the monthly rental, will you have to pay anything additional to the owner of the building to guarantee performance of the lease?  No  Yes If yes, explain Common Areas
- g) Does the present owner or occupant object to the granting of your license?  No  Yes  
If yes, explain \_\_\_\_\_

### Change of Agent Applicants Only

Have there been any changes to the floor plan since the last application was submitted?  No  Yes  
If no, a new floor plan is not required. If yes, submit a new floor plan and explain the change(s):  
\_\_\_\_\_

### Signature



Signature of Sole Proprietor, Partner or 20% or More Shareholder  
(If no 20% or more Shareholder, Corporate Officer - print name/title and sign)

Note: All information contained in this application is subject to approval by the Common Council.  
Deviating from approved plan of operation will subject licensee to citations, and/or suspension or non-renewal of the license.  
Contact the License Division for information on how to request changes.

### New and transfer of premises applicants must submit the following:

- Detailed floor plan
- If a restaurant, copy of the menu



# FOOD DEALER LICENSE PLAN OF OPERATION

OFFICE OF THE CITY CLERK, LICENSE DIVISION  
CITY HALL, 200 E. WELLS ST, ROOM 105, MILWAUKEE, WI 53202  
(414) 286-2238 • [license@milwaukee.gov](mailto:license@milwaukee.gov) • [www.milwaukee.gov/license](http://www.milwaukee.gov/license)

Legal Entity Name: MPK 65 LLC  
Premises Address: 2159 Unit A2 S. Kinnickinnic Ave Milwaukee WI 53207

## SECTION 1 TYPE OF BUSINESS

What will be the majority of your food sales? (check one)

Restaurant Items (meals):  
MEALS include, but are not limited to, chicken, ribs, sandwiches, roasted corn, baked potatoes, hot dogs, brats, tacos, nachos w/ cheese and meat, French fries, cooked or deep fried vegetables/fruit, cooked cheese curds, corn dogs, egg rolls, salads.

Retail Items (snacks and beverages):  
RETAIL items include, but are not limited to, ice cream/soft serve, lemonade, snow cones, coffee, espresso, cappuccino, tea, fruit juice, smoothies, candy, dispensed soda, fruit cups, bakery, cookies, kettle corn, cotton candy, funnel cakes, fritters, tortilla chips w/ cheese.

Will it be a convenience store?  Yes  No

A convenience store contains less than 5,000 square feet of retail space and has, as its primary business, the sale of basic food items and in addition, sells household products or is a filling station that sells basic food items and household products.

- Bed & Breakfast
- Micro Market

All Applicants: Submit a menu or a list of food items that will be sold.

Will any wholesale business be done?  No  Yes If yes, what percentage of food sales will be wholesale?

Less than 25%

25% or More AND:

Restaurant items (meals) will be sold – Complete this application and also contact DATCP.

NO restaurant items (meals) will be sold - Do NOT complete this application. Contact DATCP only.

## SECTION 2 FOOD PROCESSING

Will any food processing be done?  No  Yes

Processing is defined as assembling, grinding, cutting, mixing, baking, coating, stuffing, packing, bottling, grilling, canning, extracting, fermenting, distilling, pickling, freezing, drying, smoking, or packaging.

## SECTION 3 FOOD REQUIRING TEMPERATURE CONTROL

Will any food that requires temperature control be sold?  No  Yes  
(includes dairy products such as milk, cheese, and ice cream, fish, shellfish, meat, poultry)

If yes, list the types of food items: Fish (Sushi)



**SECTION 4 DETAILS OF OPERATION**

Will you have seating on site for dining?  No  Yes

Will you be doing any catering?  No  Yes

Will you be doing any delivery?  No  Yes

Will you have outdoor activities?  No  Yes - Check all that apply:  Bar  Cooking/Grilling  Dining

Will you have a drive thru window?  No  Yes - Are hours different from inside?  No  Yes  
 If Yes, provide drive thru hours: \_\_\_\_\_

Will scales or barcode scanners be used?  No  Yes - You must also apply for a Weights & Measures License.

**SECTION 5 ADDITIONAL SITES**

Where will food be prepared and/or sold?

At a single site  At multiple sites: How many? \_\_\_\_\_ (for example, a hotel with several dining rooms or bars)

If multiple sites, attach a Food Dealer Additional Site Addendum (ccl-foodadd) for each additional site.

**SECTION 6 CONSTRUCTION OR CHANGES**

Are you planning any construction, remodeling or equipment changes?

No If No, SKIP to Section 7

Yes If Yes, check all that apply:  New construction of a building  Renovation or remodeling  
 Construction changes to existing building  Equipment changes only

Provide a brief description of the changes: \_\_\_\_\_

Start date: \_\_\_\_\_

Name, Address & Phone Number of Architect: \_\_\_\_\_

Name, Address & Phone Number of Contractor: \_\_\_\_\_

**SECTION 7 ALCOHOL BEVERAGES**

Are you applying for an alcohol beverage license?

No If No, SKIP to Section 8

Yes If YES, if your food license is approved prior to the alcohol license, when do you want the food license issued?  
 Immediately  At the same time as the alcohol license

**SECTION 8 ACKNOWLEDGEMENTS & SIGNATURE**

You must initial each item confirming your understanding:

Kp I understand the Health Department must conduct an inspection and advise the License Division of their approval before the license may be issued.

Kp I understand I must obtain an occupancy permit from the Department of Neighborhood Services and an inspection may be required. Neighborhood Services must advise the License Division of their approval before the license may be issued.

Kp I understand the district alderperson will review and either support or object to my application. If he/she objects, I may appeal and be scheduled to appear before the Licenses Committee. The Licenses Committee will then make a recommendation to the Common Council. The Common Council must grant the license before it may be issued.

Kp I understand proof of payment for all license fees must be on file in the License Division before the license may be issued and the license must be issued and posted in my establishment prior to opening for business.

Kp I will not operate my food business until the license has been issued and posted in the establishment.

Signature of Sole Proprietor, Partner, or 20% Shareholder: K. J. S.

Signature of Additional Partner: \_\_\_\_\_

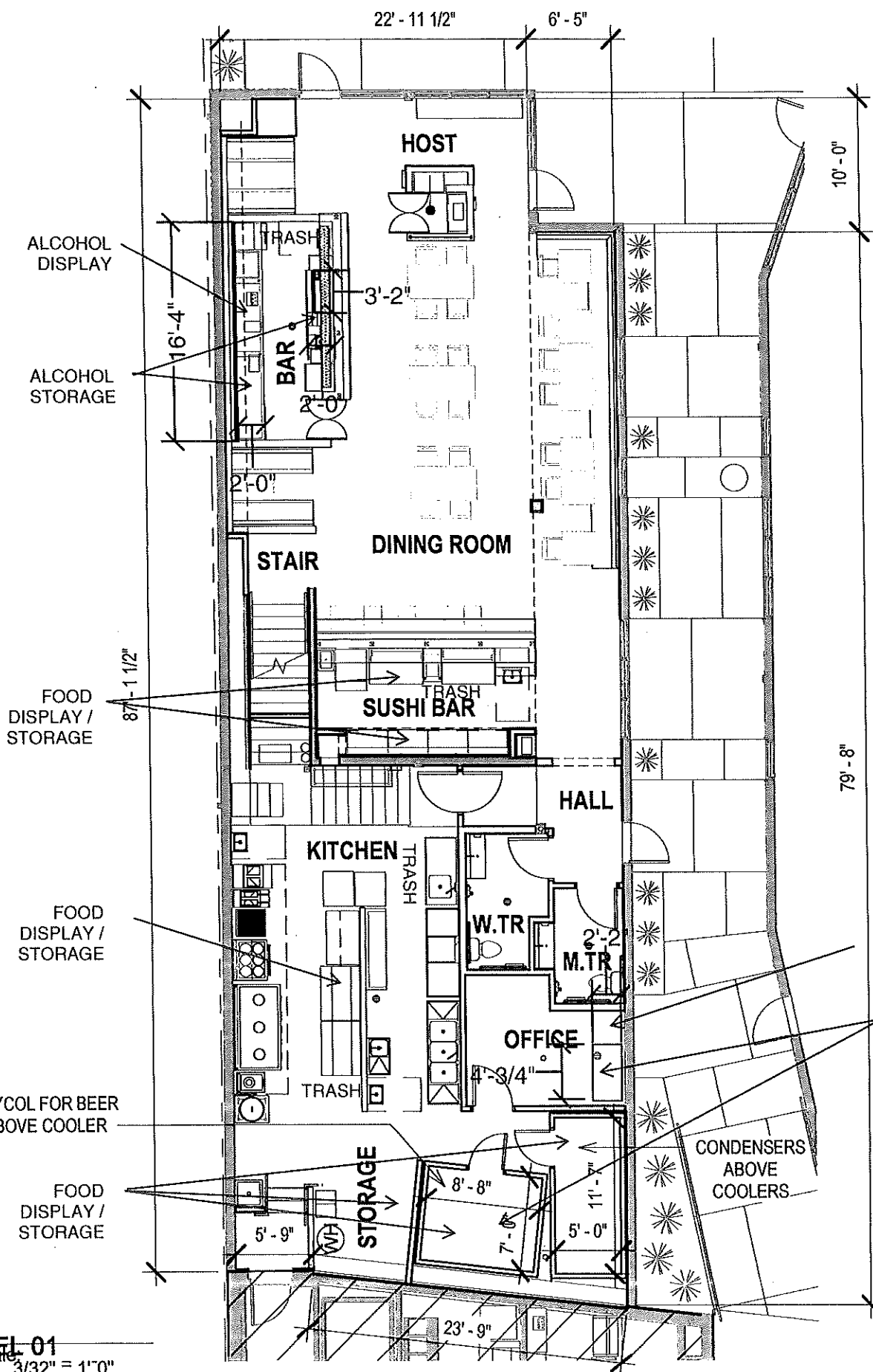

**LEVEL 01**  
Scale: 3/32" = 1'-0"

NORTH 

KANOKPORN PHADUNGSIL AGENT FOR  
DATE: 02/20/24 DBA  
MPK65 LLC

# ROOM SERVICE

2159 S KINNICKINNIC AVE - UNIT A2  
MILWAUKEE, WISCONSIN

TOTAL SF 2 3399 SF

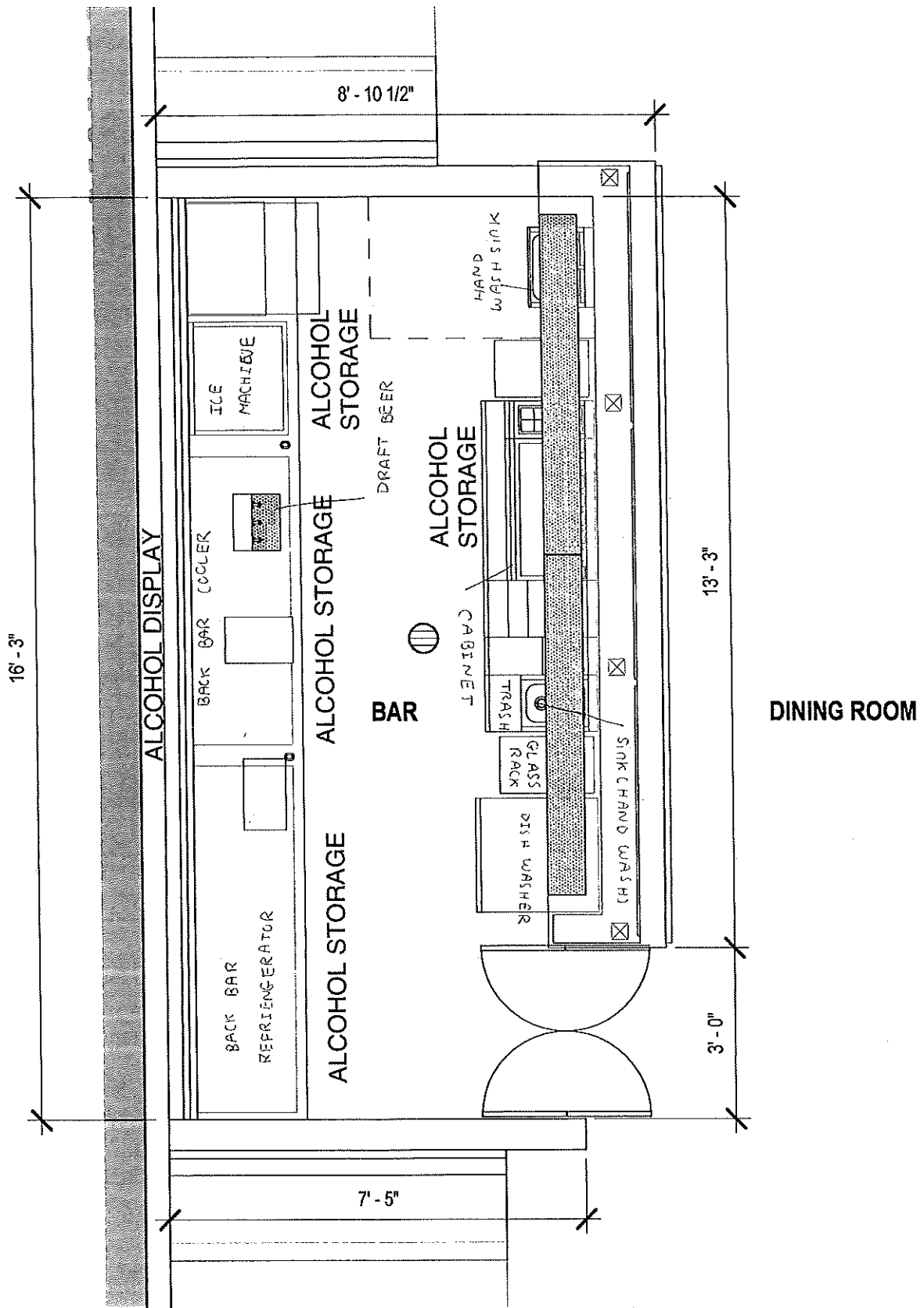

**ENLARGED PLAN - BAR**

Scale: 3/8" = 1'-0"



KANOKORN PHADUNG-SIL AGENT FOR MPK65 LLC

DATE: 02/20/24

DBA

**ROOM SERVICE**

2159 S KINNICKINNIC AVE-UNIT A2  
MILWAUKEE, WISCONSIN

TOTAL SF = 3,399

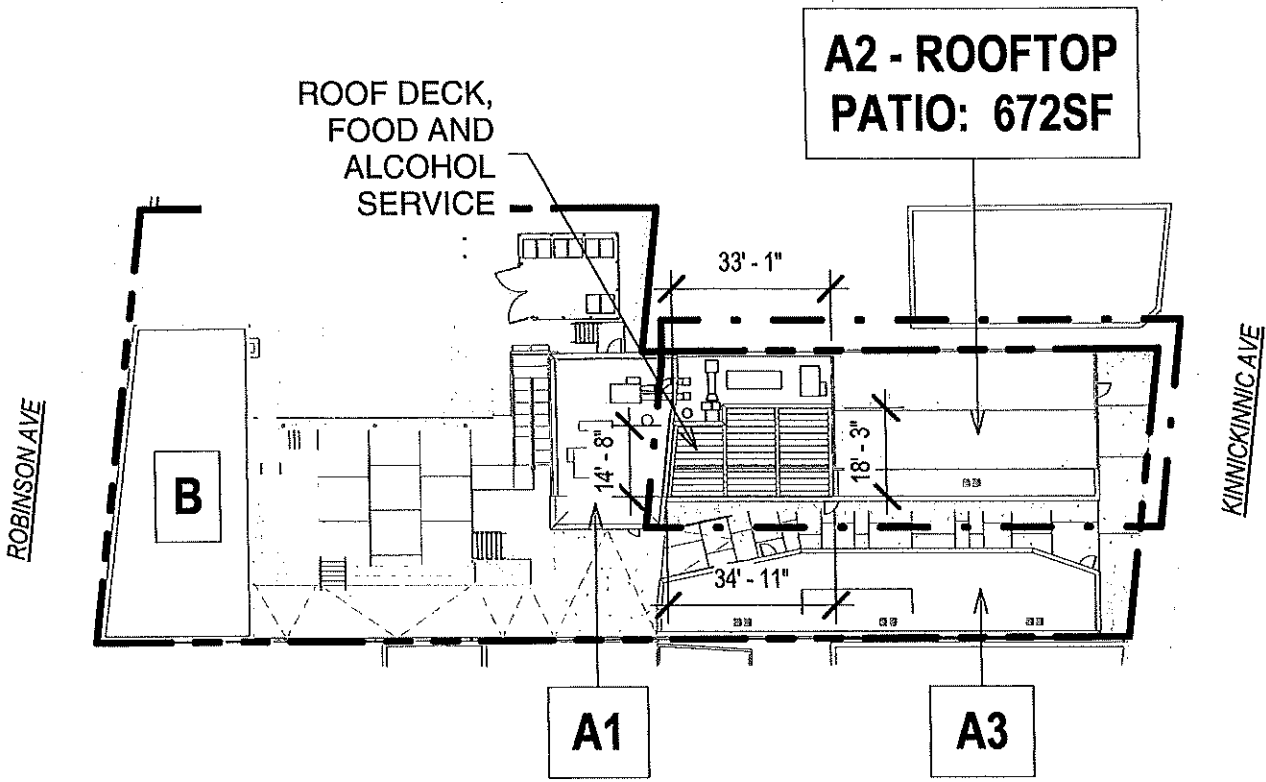

**ARCHITECTURAL SITE PLAN - ROOFTOP**  
 Scale: 1" = 40'0"

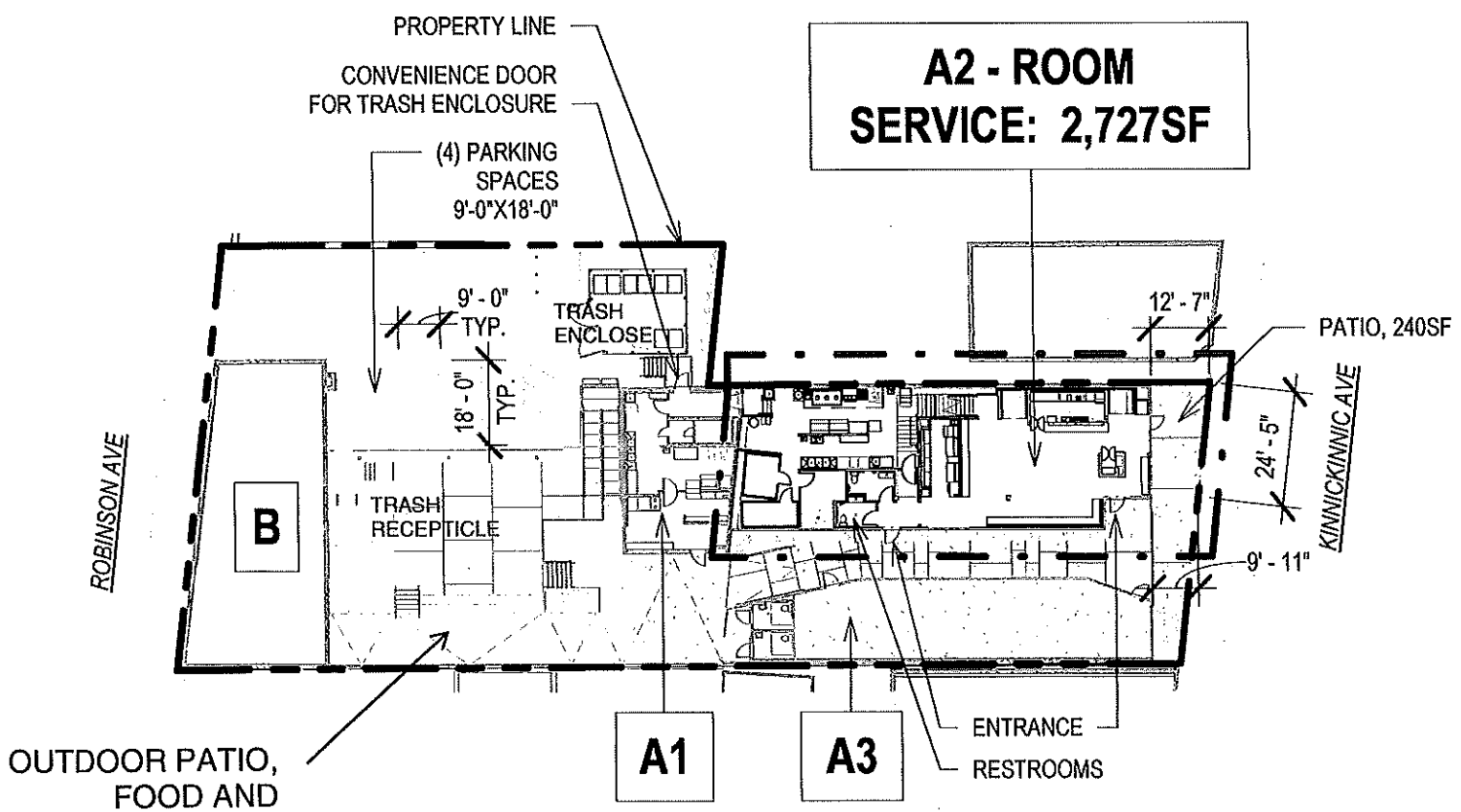

**ARCHITECTURAL SITE PLAN**  
 Scale: 1" = 40'0"

LEGAL ENTITY FOR RESTAURANT:  
 MPK65 LLC

DATE: 02/20/24  
 ANCKORN PHOTONICS, MPK65 LLC  
 AGENT FOR

DBA **ROOM SERVICE**  
 2159 S KINNICKINNIC AVE - UNIT A2  
 MILWAUKEE, WISCONSIN

TOTAL SF = 3,399 SF.  
 First floor and Roof Top

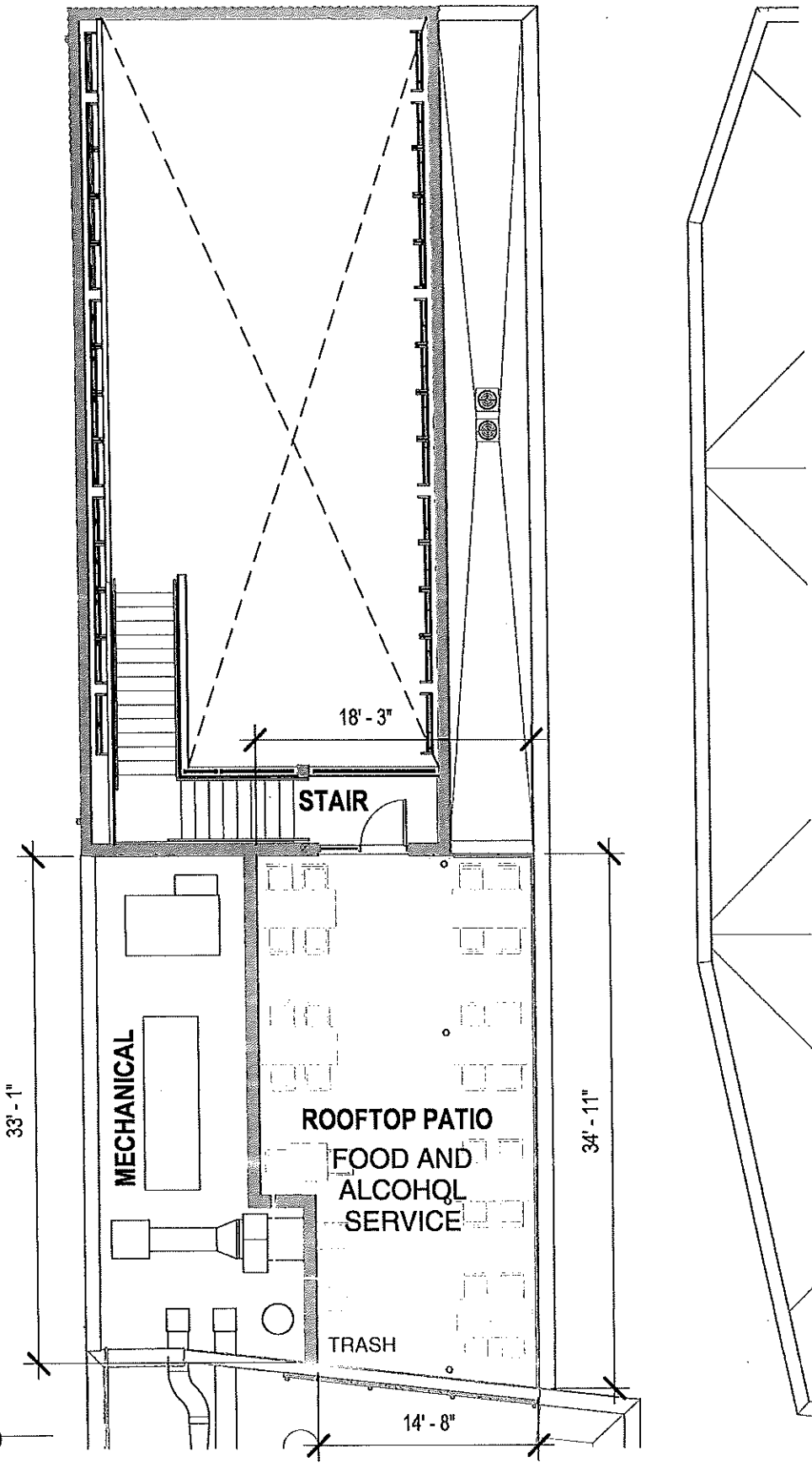

**ROOFTOP PATIO**  
 Scale: 3/32" = 1"0"



DATE: 02/20/24  
 Kanokporn Phadungsil  
 AGENT FOR

DBA  
 MPK 65 LLC

**ROOM SERVICE**  
 2159 S KINNICKINNIC AVE-A2  
 MILWAUKEE, WISCONSIN

TOTAL SF = 3399 SF  
 First floor and Roof Top



SUSHI BAR



BEHIND SUSHI BAR



EQUIPMENT SCHEDULE - A2

|    |   |
|----|---|
| 1  | POS STATION                                 |
| 2  | LOCKERS                                     |
| 3  | RICE COOKER ON TABLE                        |
| 4  | STOCK POT ON TABLE                          |
| 5  | 3-BURNER WOK RANGE                          |
| 6  | 8-BURNER GAS RANGE                          |
| 7  | GAS CHARBROILER ON TABLE                    |
| 8  | 50 LB FRYER                                 |
| 9  | 70-100 LB FRYER                             |
| 10 | ICE MAKER                                   |
| 11 | 2'X6' STAINLESS TABLE                       |
| 12 | SANDWICH PREP TABLE                         |
| 13 | 18" STAINLESS TABLE                         |
| 14 | HAND WASH SINK                              |
| 15 | 18'X6' STAINLESS TABLE W/ DISH STORAGE      |
| 16 | PREWASH SINK                                |
| 17 | DISHWASHER                                  |
| 18 | THREE COMPARTMENT SINK W/ DRAINBOARDS       |
| 19 | SODA SYRUP RACK                             |
| 20 | WALL-MOUNTED PREP SINK                      |
| 21 | UNDERCOUNTER SUSHI CASE                     |
| 22 | TRASH                                       |
| 23 | WALL-MOUNTED HAND SINK                      |
| 24 | KEG TAP & REFRIGERATOR                      |
| 25 | 3 DOOR LC REFRIGERATOR                      |
| 26 | DRINK STATION                               |
| 27 | GLASS RACK                                  |
| 28 | UNDERBAR DISHWASHER                         |
| 29 | UNDERBAR ICE MAKER                          |
| 30 | STAINLESS UNDERCOUNTER DESSERT REFRIGERATOR |
| 31 | DESSERT CHEST FREEZER                       |
| 32 | MEGA TOP COOLER                             |
| 33 | COUNTERTOP SMART OVEN                       |

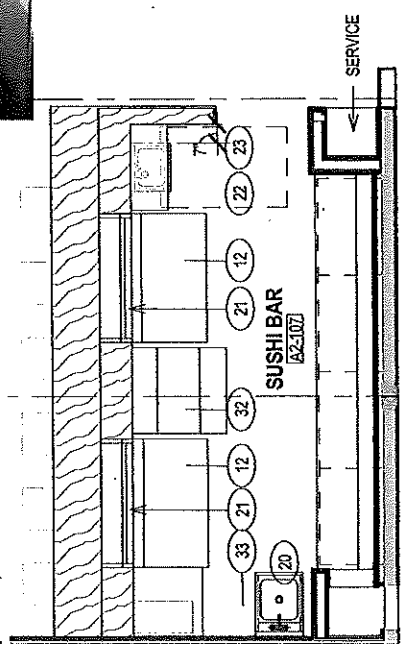

2159 KK | INTERIOR VIEW - SUSHI SERVICE SIDE  
12.20.2022

DRINK BAR





DRINK BAR AND SEATING



DRINK BAR AND DINE IN ROOM

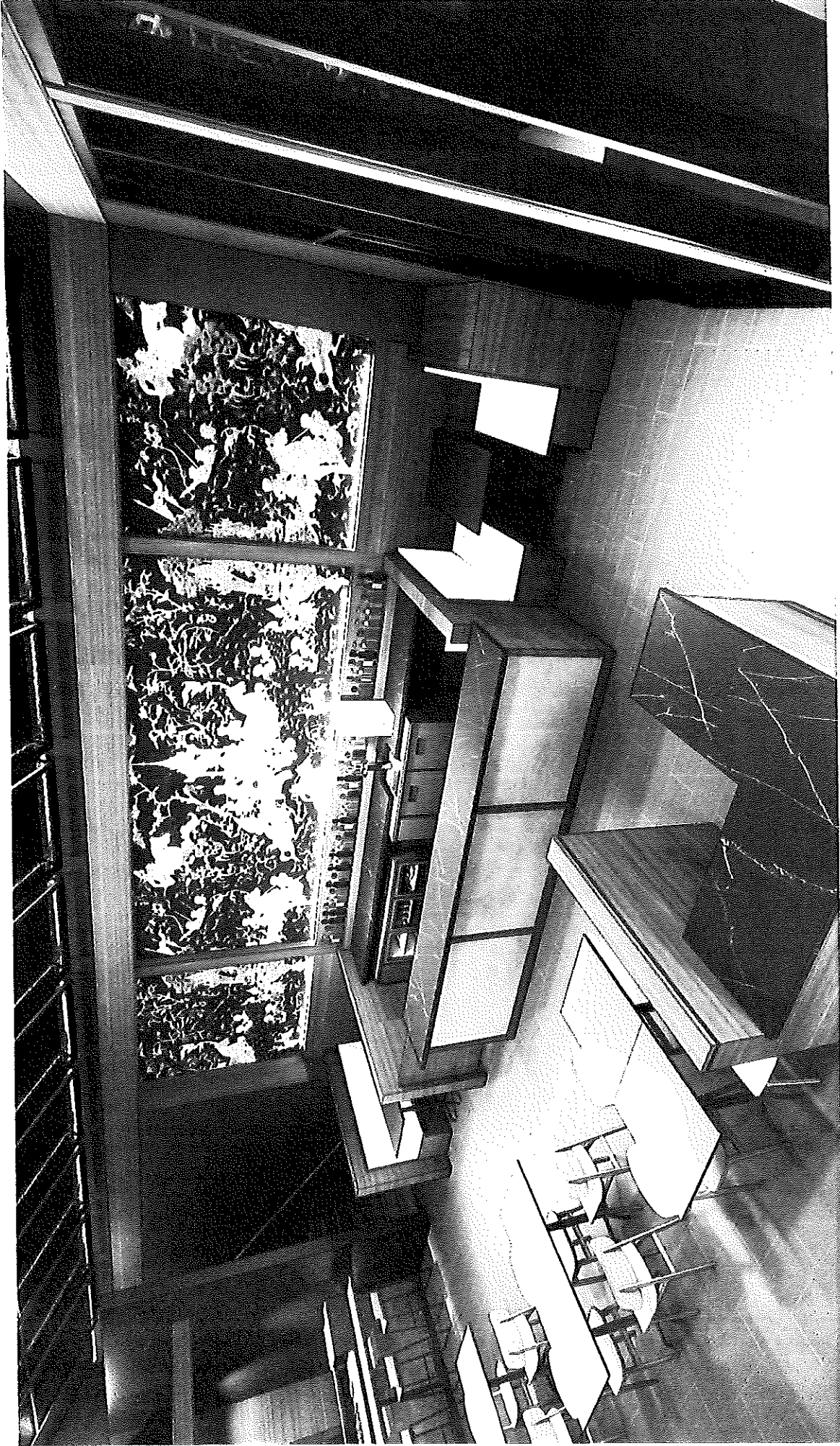

2159 KK | INTERIOR VIEW - BAR  
12-20-2022

DAN BEYER ARCH  
COPYRIGHT 2021, DAN BEYER



DRINK BAR



2159 KK | INTERIOR VIEW - BAR BACK  
12.20.2022

DAN BEYER ARCH  
COPYRIGHT 2021, DAN BEYER

DRINK BAR AND DINE IN ROOM



2159 KK | INTERIOR VIEW - HOST STAND  
12.29.2022

DAN BEYER ARCHITECTS  
COPYRIGHT 2021, DAN BEYER



DINE IN ROOM / SUSHI BAR



2159 KK | INTERIOR VIEW - FROM FRONT  
12.20.2022

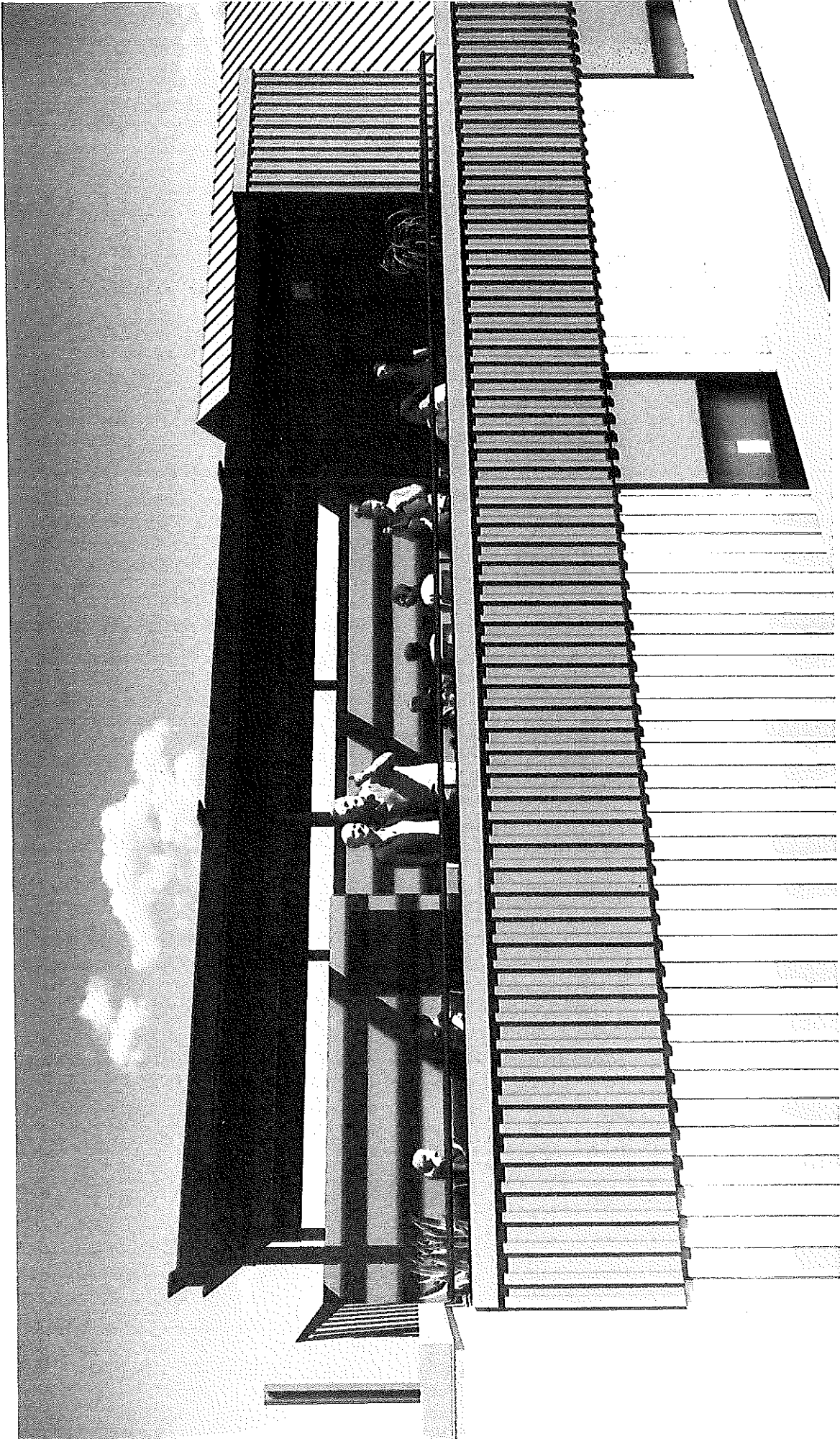

K1 | PERGOLA - VIEW FROM SOUTH



K1 | PERGOLA - VIEW FROM WEST

# *Room Service*

2159 unit A2 Kinnickinnic Ave Milwaukee WI 53207

# MENU

# Cocktails

## STRAWBERRY STING 12

strawberry, hot honey, lemon,  
cava rosé, soju

## SOM ZA 12

Peach liqueur, ST Germaine, lime  
juice, lychee juice, blood orange,

## YUZU 12

Zacapa rum, 151 rum, Cointreau,  
pineapple juice, yuzu juice,  
almond syrup

## MATCHARITA 12

Matcha, green apple mint,,  
cucumber, soju

## MAGICAL GALAXY 12

Vodka, butterfly pea flowers, ginger  
beer, lime juice



# wine

## Sparkling

PROSECCO SANTA MARINA, Italy  
12/48

## White

PINOT GRIGIO TRE FILI ORGANIC, Italy  
13/52

SAUVIGNON BLANC STEENBERG, S  
Africa 12/48

CHARDONNAY CALDEN Argentina 11/44

ROSE COTE DE TROPHEE France 13/53

ALBARINO ZARATE Spain 65

CHABLIS PIERRE QUENARD France 70

REISLING ALBERT SELTZ France 80

## Red

PINOT NOIR SANTA MARINA Italy 11/44

CABERNET SAUVIGNON OZ Australia  
12/48

BORDEAUX CHATEAU PERRON France  
70

NEBBIOLO CASA DI MIRAFIORE Italy 95

## Sake

House hot/cold sake 9

Nigori Sake 22

Shochu Hari 17

Shibata Shuzo Yuzu (Junmai Ginjo,  
cloudy, Achi 24

Snow Angel Nigori (cloudy, Hyogo 14

## Beer

Sapporo (Draft) Lager, Japan 7/25

Heineken Lager, Netherland 7

Singha Lager, Thailand 7

Corona lager, Mexico 7

Orion Lager, Japan. 7

## Soft Drink

COKE/DIET COKE/GINGER ALE 2.50

PERRIER 4.50

POLAND SPRING WATER 2

THAI ICED TEA 5

THAI ICED COFFEE 5

YUZU MATCHA ICED TEA 6

SWEETENED THAI LEMON ICED TEA 6

HOT YUZU MATCHA 6

HOT GREEN TEA 5

HOT JASMINE TEA 5

# Lunch

Mon - Fri 11:30 - 2:45 pm.

## Starter

SEA SALT or SPICY EDAMAME (V, GF) 5

TRUFFLE PARMESAN FRIES (V) 11

HOMEMADE GYOZA 8

ground pork, napa cabbage, ginger, scallion pan seared, oils & vinegar

CRAB RANGOON 8

kani, cream cheese wonton, celery, sweet chili sauce

PORK BUNS (2pcs) 12

sweet braised pork, cucumber, scallion.w.hoisin sauce

TAMAGO/PORTOBELLO MUSHROOM BUNS (2pcs) 11

Portobello mushroom, cucumber, scallion.w.hoisin sauce

BEEF BULGOGI TACOS (3pcs) 14

Kimchi slaw, Asian pear, wonton shell, scallion, toasted sesame

SPICY TUNA PIZZA 15

crispy roti, guacamole, masago, kani, furikake flakes  
scallion, spicy mayo, eel sauce

CRISPY RICE SUSHI (spicy tuna or spicy salmon) 15

Jalapeno, eel sauce, spicy mayo

## Salad

CLASSIC HOUSE SALAD, (V, GF) 5  
mixed greens, cherry tomato, cucumber

SEAWEED SALAD 6 V

Seasoned seaweed, w.sweet sesame oil

KANI SALAD 9

cucumber, masago, sesame, Japanese mayo  
tempura flakes

SPICY SASHIMI SALAD 16 GF

assorted sashimi w. mixed greens tomato  
& mango in a spicy soy dressing

## Poke Bowl

choice of rice or salad base & served w. miso soup or salad, \*black rice +3  
all include furikake, sesame, edamame, scallion, avocado, crispy wontons, nori

### HAWAIIAN AHI TUNA POKE 18

Tuna, white onion, masago, seaweed salad, avocado edamame seed furikake nori,  
tempura flakes Scallion sesame seeds citrus shoyu

### CITRUS SALMON POKE 18

salmon, mango, seaweed salad, jalapeno edamame, avocado,  
furikake nori rice puffs, nori, scallion, sesame seeds, citrus ponzu

### "50/50"POKE 18

tuna, salmon, jalapeno, seaweed salad, guacamole edamame, scallion,  
sesame seed, nori, fried shallots, citrus shoyu and citrus ponzu sauce

## Rice Bowl

served w.miso soup or salad \*black rice +\$3  
all include shiitake mushrooms, kale, onions, carrots,  
squash  
, red cabbage, organic sunny-side egg  
SILKEN TOFU (V, GF) 15

PORTOBELLO MUSHROOM (V, GF) 15

FREE RANGE TERIYAKI CHICKEN (GF) 15

PORK BELLY 17

GRASS-FED BULGOGI BEEF SIRLOIN 17

## Taste Thai 15

served w. miso soup or salad, \*black rice +\$3  
choice of chicken, vegetable, tofu, beef, \*shrimp add \$ 3

### PAD THAI

Stir-fried Thai noodles w.egg bean sprouts, chives, sweet pickled radish & ground peanuts  
in a tamarind sauce

### SPICY THAI BASIL

Stir-fried white onion, string bean, bell pepper  
in a spicy garlic basil sauce

### PHANAENG CURRY

coconut cream curry sauce, fresh kaffir lime leave

# Sushi Roll

## PINK LADY ROLL 18

Spicy salmon, shrimp tempura, avocado, cucumber & caviar  
wrapped in pink soy paper, spicy mayo, eel sauce

## ANGRY LOBSTER ROLL 18

Kani, avocado, topping w. spicy lobster, salad, spicy mayo,  
eel sauce

## ZEST ROLL 18

Mix sashimi, spicy sauce, citrus lime

## HARAJUKU ROLL 18

Salmon, mango, cucumber, topped with w. spicy salmon, mango crunchy  
flake, scallion mango sauce

## MALIBU BAY ROLL 18

Crispy soft shell crab, spicy tuna, avocado, sesame, yuzu mayo

## GREEN MARKET ROLL 17

Kale, asparagus, seaweed salad, cucumber, avocado, soy paper  
spicy soy mustard

## SPICY BLACK RICE ROLL 17

Nori, cucumber, avocado, portobello mushroom, kimchi,  
black sesame sauce

# Temaki

## Signature Set 28

50/50 poke, crispy shallot, citrus shoyu  
Spicy Hotate, tobiko, spicy yuzu sauce  
Shrimp tempura spicy mayo  
Unagi  
Avocado Cucumber, black sesame sauce

## Vegan Set 28

Avocado Cucumber black sesame sauce  
Crispy Tofu, crushed, Thai sweet chili sauce  
Sweet Potato tempura yuzu miso  
Eggplant, gobo, crunch glaze balsamic  
Shitake mushroom, yuzu zest sauce

## Classic Set 25

Spicy tuna, jalapeno  
kani, avocado, cucumber, masago  
Salmon guacamole  
Yellowtail scallion  
Abi wasabi soy sauce

# BUILD YOUR OWN TEMAKI

Choose and 5 temaki form the selection below priced a la carte

## SIGNATURE

50/50 poke, crispy shallots citrus shoyu 6

Spicy Hotate, tobiko spicy yuzu sauce 6

Shrimp tempura spicy mayo 6

Unagi 5

Avocado Cucumber black sesame sauce 5

## VEGAN

Avocado Cucumber black sesame sauce 4.5

Crispy Tofu, crushed Thai sweet chili sauce 4.5

Sweet Potato tempura yuzu miso 4.5

Eggplant gobo crunch glaze balsamic 4.5

Shitake mushroom yuzu zest sauce 4.5

Asparagus cucumber 4.5

Avocado Mango 4.5

## CLASSIC

Spicy tuna, jalapeno 5

Spicy salmon 5

kani, avocado, cucumber, masago 5

Salmon guacamole 5

Yellowtail scallion 5

Abi wasabi soy sauce 5

## ROOM SERVICE SUPREME

TRIPLE IN ONE toro,uni,caviar 38

TWO IN LOVE wagyu A5, uni 29

SPICY LOBATER 11

TORO SCALLION 11

UNI 16

AKA ABI 9

+add caviar to any temaki 11

+add ikura to any temaki 4