



CITY OF MILWAUKEE
OFFICE OF THE CITY CLERK

Thursday, February 04, 2021

COMMITTEE MEETING NOTICE

AD 06

GLOVER, Devida M, Agent
The 4th Quarter Sports Bar and Grill LLC
3532 N 14TH St

Milwaukee, WI 53206

You are requested to attend a virtual hearing to be held on:

Wednesday, February 17, 2021 at 10:10 AM

Regarding: Your Class B Tavern and Public Entertainment Premises License Transfer Applications with Change of Location and Food Dealer License Application as agent for "The 4th Quarter Sports Bar and Grill LLC" for "The 4th Quarter" at 1300 W KEEFE Av.

This meeting will be held via GoToMeeting. Please see the enclosed best practices document for further instructions. The access code is <https://global.gotomeeting.com/join/987330253>. If you wish to call in, please call +1 (872) 240-3212 and use Access Code: 987-330-253.

There is a possibility that your application may be denied for one or more of the following reasons: The recommendation of the committee regarding the application shall be based on evidence presented at the hearing. Per MCO 85-2.7-4, probative evidence concerning whether or not a new license should be granted may be presented on the following subjects: whether or not the applicant meets the municipal requirements, the appropriateness of the location and premises where the licensed premises is to be located and whether use of the premises for the purposes or activities permitted by the license would tend to facilitate a public or private nuisance or create undesirable neighborhood problems such as disorderly patrons, unreasonably loud noise, litter, and excessive traffic and parking congestion. Probative evidence relating to these matters may be taken from the plan of operation submitted with the license application, if any, but shall not include the content of any music. Evidence regarding the fitness of the location of the premises to be maintained as the principal place of business, including but not limited to whether there is an overconcentration of businesses of the type for which the license is sought; whether the proposal is consistent with any pertinent neighborhood business or development plans, or the location's proximity to areas where children are typically present. The applicant's record in operating similarly licensed premises; and whether or not the applicant has been charged with or convicted of any felony, misdemeanor, municipal offense or other offense, the circumstances of which substantially relate to the activity to be permitted by the license being applied for or any other factor which reasonably relates to the public health, safety or welfare may also be considered. See attached police report or correspondence.

Notice for applicants with warrants or unpaid fines:

Proof of warrant satisfaction or payment of fines must be submitted at the hearing on the above date and time. Failure to comply with this requirement may result in a delay of the granting/denial of your application.

Failure to attend this meeting may result in the denial of your license. Individual applicants and partnership applicants must attend or attend by an attorney. The agent or attorney for corporate or limited liability applicants must attend. If you wish to do so and at your own expense, you may be accompanied by an attorney of your choosing to represent you at this hearing.

You will be given an opportunity to speak on behalf of the application and to respond and challenge any charges or reasons given for the denial. No petitions can be accepted by the committee, unless the people who signed the petition attend the virtual hearing and are willing to testify. You may present witnesses under oath and you may also confront and cross-examine opposing witnesses under oath. If you have difficulty with the English language, you should request an interpreter attend the meeting with you, at your expense, so that you can answer questions and participate in your hearing.

PLEASE NOTE: Upon reasonable notice, efforts will be made to accommodate the needs of disabled individuals through sign language interpreters or other auxiliary aids. For additional information or to request this service, contact the Council Services Division ADA Coordinator at (414) 286-2998, Fax - (414) 286-3456, TDD - (414) 286-2025.

JIM OWCZARSKI, CITY CLERK

BY: _____

Jessica Ceella

License Division Manager

If you have questions regarding this meeting, please contact the staff assistant, Molly Kuether-Steele at (414) 286-2775 or molly.kuether-steele@milwaukee.gov.

Summary

Name	Count	Area(ft ²)	Length(mi)
Alcohol Licenses	16		

Alcohol Licenses

#	Legal Entity	Trade Name	Licensee	Address	License Type Name	Total Capacity	Expiration Date	Count
1	Action Food & Liquor LLC	Action Food & Liquor	Mohammad Owais, Agt	3455 N Martin L King Jr DR	Class A Malt & Class A Liquor License		10/15/2021, 7:00 PM	1
2	YOUNG'S BAR, INC	YOUNG'S BAR	CHARLENE E GRAY, Agt	3571 N TEUTONIA AV	Class B Tavern License	50	6/13/2021, 7:00 PM	1
3	CATFISH LOUNGE, INC	CATFISH LOUNGE	JAMIE N GLADNEY, Agt	3646 N TEUTONIA AV	Class B Tavern License	80	6/12/2021, 7:00 PM	1
4	BUCKSHOTS BAR LLC	BUCKSHOTS BAR	DAVID NUNEZ-CRUZ, Agt	3219 S 13TH ST	Class B Tavern License	25	10/11/2021, 7:00 PM	1
5	CASPAR'S LOUNGE	CASPAR'S LOUNGE	LUTHER BROWN, SP	1300 W KEEFE AV	Class B Tavern License	60	6/29/2021, 7:00 PM	1
6	Fateh 1 Inc.	Jack's Liquor	Sukhchain Singh, Agt	3565-67 N Teutonia AV	Class A Malt & Class A Liquor License		6/30/2021, 7:00 PM	1
7	ADAMS FOOD LLC	BURLEIGH FOOD MART	MUSTAFA T MUSTAFA, Agt	1120 W BURLEIGH ST	Class A Fermented Malt Beverage Retailer's License		12/9/2021, 6:00 PM	1
8	SHANAA GROCERY, INC	MR F FOODS	BASSEL S HAMZA, Agt	3246 N 15TH ST	Class A Fermented Malt Beverage Retailer's License		12/15/2021, 6:00 PM	1
9	King Hall, LLC	King Hall	DAREN JACKSON, Agt	3413 N Martin L King Jr DR	Class B Tavern License	200	1/29/2021, 6:00 PM	1
10	ATKINSON BEER & LIQUOR MART, INC	ATKINSON BEER & LIQUOR MART, INC	DARRELL C NICHOLSON, Agt	1101 W ATKINSON AV	Class A Malt & Class A Liquor License		2/8/2021, 6:00 PM	1
11	Bungalow Restaurant, LLC	Henry and Bobbie's Bungalow	Demetrius T Jones, Agt	3466 N 14th ST	Class B Tavern License		7/5/2021, 7:00 PM	1
12	Oldies But Goodies Inc	Oldies But Goodies Lounge	VICKIE M BROOKS, Agt	3501 N 6th ST	Class B Tavern License	80	7/26/2021, 7:00 PM	1
13	B & S FOOD MARKET, INC	B & S FOOD MARKET	MILOU A ELWERFALLI, Agt	3299 N 12TH ST	Class A Fermented Malt Beverage Retailer's License		4/5/2021, 7:00 PM	1
14	ATKINSON FOOD MART CORP	Atkinson Food Mart	Mandeep Dran, Agt	1301 W ATKINSON AV	Class A Malt & Class A Liquor License		8/23/2021, 7:00 PM	1
15	MALLETT'S FOODS	MALLETT'S FOODS	JOE F MALLET, SP	3501 N 14TH ST	Class A Fermented Malt Beverage Retailer's License		10/16/2021, 7:00 PM	1
16	STEWART'S REST SPOT	STEWART'S REST SPOT	JESSICA P STEWART, SP	1422 W ATKINSON AV	Class B Tavern License	49	10/10/2021, 7:00 PM	1

Establishments within a 0.5 miles radius centered on area of interest.



Thursday, February 04, 2021



Notice of Public Hearing

blank
notice

GLOVER, Devida M, Agent
The 4th Quarter at 1300 W KEEFE Av
Class B Tavern and Public Entertainment Premises License Transfer Applications with Change of
Location and Food Dealer License Application

Wednesday, February 17, 2021 at 10:10 AM

To whom it may concern:

The above application has been made by the above named applicant(s). This requires approval from the Licenses Committee and the Common Council of the City of Milwaukee. The hearing before the Licenses Committee will take place virtually on 2/17/2021 at 10:10 AM. This is a public hearing. Those wishing to view the proceeding are able to do so via the City Channel – Channel 25 on Spectrum Cable – or on the Internet at <http://city.milwaukee.gov/citychannel>. Those wishing to provide oral testimony will be asked to do so by phone or internet and are asked to contact the staff assistant, Molly Kuether-Steele at (414) 286-2775 or molly.kuether-steele@milwaukee.gov for necessary information. Please make such requests no later than one business day prior to the start of the meeting. You are not required to attend the hearing, but please see the information below if you would like to provide testimony. Once the Licenses Committee makes its recommendation, this recommendation is forwarded to the full Common Council for approval at its next regularly scheduled hearing.

Important details for those wishing to provide information for the Licenses Committee to consider when making its recommendation:

1. The license application is scheduled to be heard at the above time. Due to other hearings running longer than scheduled, you may have to wait some time to provide your testimony.
2. You must testify as to matters that you have personally experienced or seen. (You cannot provide testimony for your neighbor, parent or anyone else; this is considered hearsay and cannot be considered by the committee.)
3. No letters or petitions can be accepted by the committee (unless the person who wrote the letter or the persons who signed the petition are willing to testify).
4. Persons opposed to the license application are given the opportunity to testify first; supporters may testify after the opponents have finished.
5. When you are called to testify, you will be sworn in and asked to give your name, and address. (If your first and/or last names are uncommon please spell them.)
6. You may then provide testimony.
 - a. Include only information relating to the above license application.
 - b. Include only information you have personally witnessed or seen.
 - c. Provide concise and relevant information detailing how this business has affected or may affect the peaceful enjoyment of your neighborhood.
 - d. If by the time you have the opportunity to testify, the information you wish to share has already been provided to the committee, you may state that you agree with the previous testimony. Redundant or repetitive testimony will not assist the committee in making its recommendation.
7. After giving your testimony, the members of the Licenses Committee and the licensee may ask questions regarding the testimony you have given or other factors relating to the license application.
8. Business Competition is not a valid basis for denial or non-renewal of a license.

Please Note: If you have submitted an objection to the above application your objection cannot be considered by the committee unless you personally testify at the hearing.

OCCUPANT	MAIL ADDRESS	CITY, STATE ZIP
CURRENT OCCUPANT	3522 N 13TH ST	MILWAUKEE, WI 53206
CURRENT OCCUPANT	1223 W KEEFE AVE	MILWAUKEE, WI 53206
CURRENT OCCUPANT	1212 W KEEFE AVE	MILWAUKEE, WI 53206
CURRENT OCCUPANT	1213 W KEEFE AVE	MILWAUKEE, WI 53206
CURRENT OCCUPANT	3523 N 12TH ST	MILWAUKEE, WI 53206
CURRENT OCCUPANT	3528 N 14TH ST	MILWAUKEE, WI 53206
CURRENT OCCUPANT	3547 N 13TH ST	MILWAUKEE, WI 53206
CURRENT OCCUPANT	3451 N 13TH ST	MILWAUKEE, WI 53206
CURRENT OCCUPANT	3454 N 14TH ST	MILWAUKEE, WI 53206
CURRENT OCCUPANT	1314 W KEEFE AVE	MILWAUKEE, WI 53206
CURRENT OCCUPANT	1310 W KEEFE AVE	MILWAUKEE, WI 53206
CURRENT OCCUPANT	3515A N 13TH ST	MILWAUKEE, WI 53206
CURRENT OCCUPANT	3441 N 13TH ST	MILWAUKEE, WI 53206
CURRENT OCCUPANT	1225 W KEEFE AVE	MILWAUKEE, WI 53206
CURRENT OCCUPANT	3533 N 13TH ST	MILWAUKEE, WI 53206
CURRENT OCCUPANT	3537 N 13TH ST	MILWAUKEE, WI 53206
CURRENT OCCUPANT	3450 N 14TH ST	MILWAUKEE, WI 53206
CURRENT OCCUPANT	3457 N 13TH ST	MILWAUKEE, WI 53206
CURRENT OCCUPANT	3457A N 13TH ST	MILWAUKEE, WI 53206
CURRENT OCCUPANT	3512 N 13TH ST	MILWAUKEE, WI 53206
CURRENT OCCUPANT	3522 N 14TH ST	MILWAUKEE, WI 53206
CURRENT OCCUPANT	3446 N 14TH ST	MILWAUKEE, WI 53206
CURRENT OCCUPANT	3448 N 14TH ST	MILWAUKEE, WI 53206
CURRENT OCCUPANT	3534 N 13TH ST	MILWAUKEE, WI 53206
CURRENT OCCUPANT	3531 N 12TH ST	MILWAUKEE, WI 53206
CURRENT OCCUPANT	3527 N 13TH ST	MILWAUKEE, WI 53206
CURRENT OCCUPANT	3547 N 13TH ST A	MILWAUKEE, WI 53206
CURRENT OCCUPANT	3456 N 14TH ST	MILWAUKEE, WI 53206
CURRENT OCCUPANT	3460A N 14TH ST	MILWAUKEE, WI 53206
CURRENT OCCUPANT	1329 W KEEFE AVE	MILWAUKEE, WI 53206
CURRENT OCCUPANT	1306A W KEEFE AVE	MILWAUKEE, WI 53206
CURRENT OCCUPANT	3508A N 14TH ST	MILWAUKEE, WI 53206
CURRENT OCCUPANT	3508 N 14TH ST	MILWAUKEE, WI 53206
CURRENT OCCUPANT	1235 W KEEFE AVE 2	MILWAUKEE, WI 53206
CURRENT OCCUPANT	1315 W KEEFE AVE	MILWAUKEE, WI 53206
CURRENT OCCUPANT	1314A W KEEFE AVE	MILWAUKEE, WI 53206
CURRENT OCCUPANT	3512 N 14TH ST	MILWAUKEE, WI 53206
CURRENT OCCUPANT	3512A N 14TH ST	MILWAUKEE, WI 53206
CURRENT OCCUPANT	3528 N 13TH ST	MILWAUKEE, WI 53206
CURRENT OCCUPANT	3542 N 14TH ST	MILWAUKEE, WI 53206
CURRENT OCCUPANT	1235 W KEEFE AVE 3	MILWAUKEE, WI 53206
CURRENT OCCUPANT	3460 N 14TH ST	MILWAUKEE, WI 53206
CURRENT OCCUPANT	3515 N 13TH ST	MILWAUKEE, WI 53206
CURRENT OCCUPANT	3518 N 14TH ST	MILWAUKEE, WI 53206
CURRENT OCCUPANT	3523 N 13TH ST	MILWAUKEE, WI 53206
CURRENT OCCUPANT	1209 W KEEFE AVE	MILWAUKEE, WI 53206

CURRENT OCCUPANT	3532 N 14TH ST	MILWAUKEE, WI 53206
CURRENT OCCUPANT	1235 W KEEFE AVE 1	MILWAUKEE, WI 53206
CURRENT OCCUPANT	1229 W KEEFE AVE	MILWAUKEE, WI 53206
CURRENT OCCUPANT	3505 N 13TH ST	MILWAUKEE, WI 53206
CURRENT OCCUPANT	3446 N 13TH ST	MILWAUKEE, WI 53206
CURRENT OCCUPANT	1212A W KEEFE AVE	MILWAUKEE, WI 53206
CURRENT OCCUPANT	3514 N 13TH ST	MILWAUKEE, WI 53206
CURRENT OCCUPANT	3436 N 13TH ST	MILWAUKEE, WI 53206
CURRENT OCCUPANT	3441A N 13TH ST	MILWAUKEE, WI 53206
CURRENT OCCUPANT	3538 N 13TH ST	MILWAUKEE, WI 53206
CURRENT OCCUPANT	3538 N 14TH ST	MILWAUKEE, WI 53206
CURRENT OCCUPANT	1306 W KEEFE AVE	MILWAUKEE, WI 53206
CURRENT OCCUPANT	1232 W KEEFE AVE	MILWAUKEE, WI 53206
CURRENT OCCUPANT	1234 W KEEFE AVE	MILWAUKEE, WI 53206
CURRENT OCCUPANT	3518A N 14TH ST	MILWAUKEE, WI 53206
blank	notice	

Total Records: 61

Radius: 250.0 feet and Center of Circle: 1300 W Keefe Ave



BUSINESS LICENSE PLAN OF OPERATION

cel-busplan 5/13/2020

Office of the City Clerk License Division
200 E. Wells St. Room 105, Milwaukee, WI 53203
(414) 226-2238 www.milwaukee.gov/licensing e-mail address license@milwaukee.gov

1. Type of Business

Applying for: Extended Hours (12AM to 3AM) - if a food establishment, check all that apply Delivery Drive Thru Dining Room
 Self Service Laundry Massage Establishment Filling Station
 Other (supplemental application for specific license also required)

Provide a detailed description of the type of business you plan on operating:

BAR + Grill

Do you have any experience operating this type of business? No Yes If yes, explain owner Best Friends Kebab and wine of the 4th quarter

2. Business Operations

- a. Proposed Opening Date: Dec 1st
- b. Is this premise under construction? No Yes if yes, list estimated completion date: _____
- c. Is this a franchise? No Yes
- d. Is this premises currently licensed? No Yes if yes, list type of license: Class B Tavern
- e. Is the current licensee operating? No Yes if no, list date closed: _____
- f. Do you have future plans for other businesses, licenses or permits at this location? No Yes
If yes, explain: _____
- g. Have you previously held an Extended Hours License in Milwaukee? No Yes
If yes, list address(es): _____
- h. Are other businesses operating in the same building? No Yes if yes, describe: _____

3. Litter & Noise

- a. How are grounds kept clean? Sweep Pressure Wash Pick Up Litter Other: _____
- b. How often will grounds be cleaned? Daily Weekly As Needed Monthly Other: _____
- c. Grounds cleaned by: Licensee Building Owner Employees Hired Maintenance Other: _____
- d. How are noise issues prevented and/or addressed? Security Manager approaches customer(s) Call Police
 Signs Posted Other: _____
- e. Will a sound amplification system be used? No Yes if yes, describe: _____

4. Smoking & Sanitation

- a. Are there designated outdoor smoking areas? No Yes if yes, describe: Side of Building
- b. Number of Garbage Cans: Inside: 5 locations: Bar, Bathrooms, Kitchen
Outside: 1 locations: Rear
- c. Is a crowd control barrier used? No Yes if yes, describe: _____
- d. How many restrooms are on the premises? 2
- e. Name of solid waste contractor: Advanced Disposal Waste Management Other: _____

5. Security

- a. Are there on-site parking spaces? No Yes. If yes, how many? _____ and describe the parking security plan: _____
- b. Is there a loading zone? No Yes. If yes, describe the loading area security plan: _____
- c. Will you have security personnel on premise? No Yes. If yes, how many? 1 and answer the following:
 What are their responsibilities? Checking IDs "Safety of Customers"
 Is security equipment used? No Yes. If yes, describe: _____
 List their licensing, certification, or training credentials: in house training
- d. Will there be security cameras? No Yes. If yes, how many? 8 and list locations: Out side to view and inside
- e. Will searches/identification checks be done upon entry? No Yes. If yes, describe: look at id card pat down

6. Percentage of Sales (must total 100%)

Alcohol <u>60</u> %	Food <u>40</u> %	Secondhand Merchandise <u>0</u> %	Precious Metals & Gems <u>0</u> %
Entertainment <u>0</u> %	Cigarettes <u>0</u> %	Personal Services (such as tattoo, body piercing, salon, tailor, tanning, etc.) <u>0</u> %	Other _____ % Describe: _____
Pawnbroker Activity <u>0</u> %	Salvaged Materials (such as scrap metal) <u>0</u> %		

7. Businesses/Licenses on the Premises (check all that apply):

- Type 1**
- Full Service Restaurant Cafe/Coffee Shop Deli or Fast Food Restaurant Private/Fraternal/Veterans Club
- Night Club Tavern Cocktail Lounge Teen Club
- Banquet Hall Sports Facility Bowling Alley
- Hotel/Motel Number of Floors: _____ Rooming House: Number of Floors: _____
 Number of Rooms: _____ Number of Rooms: _____

- Type 2**
- Liquor Store Corner Store Supermarket Convenience Store
- Gas Station Amusement/Photograph Distributor Recycling, Salvage or Towing
- Used Car Dealer Personal Service Establishment (such as tattoo business, hair salon, tailor, etc.) Recording Studio

- What other licenses/permits will you hold at this location? (check all that apply)
- Occupancy Permit Cigarette & Tobacco Gas Station Extended Hours Class "B" Tavern Weights & Measures
- Secondhand Dealer Precious Metal & Gem Other _____

8. Legal Capacity (only if a Type 1 premises in #7 above)

Capacity 60 (Call the Milwaukee Development Center at 414-285-8211 if you have questions.)

9. Premises Description

a. Identify all area(s) of the premises that will be used in operating this business (include areas used only for storage)
 1st Floor 2nd Floor Basement Storage Patio Beer Garden Sidewalk Café Deck Rooftop

Other: Describe: _____

b. Describe Location: Major Thoroughfare Secondary Street Other: _____

c. Nearest Major Cross Street: Keele Ave

d. Describe Building: Free Standing Building Strip Mall Other: _____

e. Describe Premises Structure: Single Story Multi-Story - # of Stories 2 Other: _____

f. Describe Surrounding Area: Commercial Residential Industrial Other: _____

g. Building Owner Name: Luther Brown Phone Number: 414-416-9548

Building Owner Address: 4561 N 23rd St Milwaukee WI 53209

10. Hours of Operation & Customers

Will customers be entering the premises? No Yes

Day of the Week	Proposed Hours of Operation:		Estimated Number of Customers expected each day	Potential Age Range of Customers	Class B Tavern Applicant Only: Age Restriction (If none, write 'None')
	Open Time (include a.m. or p.m.)	Close Time (include a.m. or p.m.)			
Sunday	6 AM	2 AM	80	35-up	none
Monday	6 AM	2 AM	50	35-up	none
Tuesday	6 AM	2 AM	50	35-up	none
Wednesday	6 AM	2 AM	50	35-up	none
Thursday	6 AM	2 AM	50	35-up	none
Friday	6 AM	2:30 AM	80+	35-up	none
Saturday	6 AM	2:30 AM	80+	35-up	none

An Extended Hours Establishment License is required for any convenience store, filling station, personal service establishment (such as tattoo, body piercing, salon, taylor, tanning, etc.), recording studio or restaurant which is open between the hours of 12:00 a.m. and 5:00 a.m.

Alcohol Establishments Permitted Hours of Operation: Class A: 8:00 am to 9:00 pm Sunday thru Saturday
 Class B: 6:00 am to 2:00 am Sunday thru Thursday, 6:00 am to 2:30 am Friday & Saturday

Entertainment Outdoor Closing Hours: 10:00pm Sunday-Thursday; 12:00am Friday & Saturday; unless a different time, either earlier or later, is established by the Common Council in its approval of the licensee's plan of operation.

11. Signature(s)

J. Claver
 Signature of Sole Proprietor, Partner, or 20% or more Shareholder
 (If there are no 20% or more shareholders,
 Corporate Officer print name/title and sign)

Signature of additional partner or 20% or more shareholder

See Application Information for a complete list of all required application forms.



ALCOHOL BEVERAGE & PUBLIC ENTERTAINMENT PREMISES SUPPLEMENTAL APPLICATION

col 4/29/13

Office of the City Clerk License Division
200 E. Wells St. Room 105, Milwaukee, WI 53202
(414) 226-2238 e-mail address: license@milwaukee.gov www.milwaukee.gov/licensing

Legal Entity Name: THE 414 Quarter Sports Bar and Grill LLC

Premise Address: 1300 W. Keefe Ave

Proximity of Premises to Church, School, Daycare Center or Hospital

Is the building within 300 feet of any church, school, daycare center or hospital? No Yes

"Service Bar Only" Designation

If applying for Class B or C license, are you applying for "Service Bar Only"? No Yes
Service Bar Only means customers cannot sit at the bar. Alcohol is served to employees who serve patrons seated at tables. No stools, chairs or other articles of furniture shall be placed at the service bar for patrons to sit upon.

Business Information

a) Are you taking out this application for anyone that may not be eligible for a license? No Yes
If yes, list their name and address: _____

b) Will the agent, a partner or the individual licensee be conducting the day-to-day operations of the business? No Yes
If no, list the name and address of the person(s) who will: _____

Class B Applicants: If the agent, a partner or the individual licensee will not be conducting the day-to-day operations of the business, the person(s) listed above must obtain a Class B Manager's license.

c) Does anyone else have money invested or any other interest in this business? No Yes
If yes, explain: _____

d) Have you made an agreement with anyone to repay any loan or any other payments based upon income from the business? No Yes
If yes, list name and address: _____

Property Information (New & Transfer Applicants Only)

a) Do you own or lease the building? Own Lease

b) Who owns the fixtures (for example, cookers, etc.)? Devide Glover

c) Are you purchasing the stock and/or fixtures? No Yes if yes, amount paid \$ _____

d) Total amount paid for business \$162,000

e) Total amount paid for goodwill of the business \$22,000

Goodwill comprises the reputation and customer relationships of an existing business. If the price you pay for the business exceeds the fair market value of all of the rest of the assets of the business, the excess may be considered goodwill.

f) Have you made arrangements with the seller for payment of personal property taxes? No Yes

Lease Information (New & Transfer Applicants who are leasing the premises only)

a) Date lease begins N/A Ends _____

b) Monthly rental \$1,915.00

c) Do you have an option to renew the lease? No Yes

d) Does your lease allow for assignment to another party without the consent of the owner? No Yes

e) For what length of time have you been guaranteed occupancy (number of years)? 20 yrs

Lease Information (Continued)

- f) In addition to paying the monthly rental, will you have to pay anything additional to the owner of the building to guarantee performance of the lease? No Yes. If yes, explain _____
- g) Does the present rental or occupancy object to the granting of your license? No Yes
If yes, explain _____

Change of Agent Applicants Only

- Have there been any changes to the floor plan since the last application was submitted? No Yes
If no, a new floor plan is not required. If yes, submit a new floor plan and explain the change(s) _____

Signature

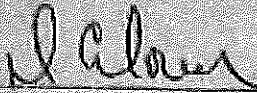

Signature of Sole Proprietor, Partner or 20% or More Shareholder
(If no 20% or more Shareholder, Corporate Officer - print name/title and sign)

Note: All information contained in this application is subject to approval by the Common Council.
Deviating from approved plan of operation will subject licensee to citations, and/or suspension or non-renewal of the license.
Contact the License Division for information on how to request changes.

New and transfer of premises applicants must submit the following:

- Detailed floor plan
- If a restaurant, copy of the menu



PUBLIC ENTERTAINMENT PREMISES LICENSE SUPPLEMENTAL APPLICATION

ref number 877115 ✓

Office of the City Clerk License Division
200 E. Wells St. Room 105, Milwaukee, WI 53202
(414) 286-2234 www.milwaukee.gov/licenses e-mail address licensing@milwaukee.gov

PREMISES ADDRESS: 1300 W Keefe

TYPES OF ENTERTAINMENT (CHECK ALL THAT APPLY)

<input type="checkbox"/> Instrumental Musicians	<input type="checkbox"/> Battle of the Bands	<input type="checkbox"/> Dancing by Performers	<input checked="" type="checkbox"/> Amusement Machines How many? <u>5</u>
<input type="checkbox"/> Bands	<input type="checkbox"/> Comedy Acts	<input type="checkbox"/> Adult Entertainment/ Strippers/Erotic Dance	<input type="checkbox"/> Concerts Approx. # per year? _____
<input type="checkbox"/> Bowling Alley How many? _____	<input type="checkbox"/> Disc Jockey	<input type="checkbox"/> Wrestling	<input type="checkbox"/> Theatrical Performances Approx. # per year? _____
<input type="checkbox"/> Pool Tables How many? _____	<input type="checkbox"/> Magic Shows	<input type="checkbox"/> Patron Contests	<input checked="" type="checkbox"/> Jukebox
<input type="checkbox"/> Motion Pictures (movie by admission) How many? _____	<input type="checkbox"/> Poetry Readings	<input type="checkbox"/> Patron Dancing	<input type="checkbox"/> Karaoke
<input type="checkbox"/> Other _____			

Entertainment Outdoor Closing Hours: 10:00pm Sunday-Thursday, 12:00am Friday & Saturday, unless a different time, either earlier or later, is established by the Common Council in its oversight of the license's plan of operation.

PROMOTERS/SOUND AMPLIFICATION

Will promoters ever be used for any of the entertainment? No Yes. If Yes, Describe: _____

At any time will sound amplification be used? No Yes. If Yes, Describe: _____

LEGAL CAPACITY OF PREMISES

LOD (Call the Development Center at 414-286-8211 with questions.) Legal capacity determines the fee for your Public Entertainment Premises License. If you would like to request the license be approved with a lower capacity than that listed above, indicate the lower capacity here: _____ If approved, this lower capacity will print on your license and override the capacity listed on your Occupancy Permit.

ACKNOWLEDGEMENT/SIGNATURE

I understand that after the license has been issued, a change to the plan of operation will require a written request to change and approval from the Common Council. I agree to inform the City Clerk within 10 days of any substantial changes in the information supplied in this application. I understand that I shall not willfully refuse to provide the services offered under this license, or add charges or require deposits not required of the general public because of race, color, sex, religion, national origin or ancestry, age, handicap, lawful source of income, marital status, sexual orientation, gender identity or expression, familial status or the fact that a person is now or has been a member of the military service, whether dressed in uniform or not, and shall not use such information as a condition of employment, or penalize any employee or discriminate in the selection of personnel for training or promotion on the basis of such information.

I have knowledge of the City Ordinances currently regulating public entertainment, and understand that the license may be subject to suspension, non-renewal or revocation, if I violate any rule, law or regulation of the City of Milwaukee and State of Wisconsin.

J. Clow
Signature of Sole Proprietor, Partner or 25% or More Shareholder
(If no 25% or more shareholder, Corporate Officer - print name/title and sign)

Office Use Only

Invoice: _____ Filed: _____ App: _____
Only MPD? No Yes. If Yes, Queue to MPD and Email Mgrs/Team Lead (must be heard w/in 60 days)



FOOD DEALER LICENSE PLAN OF OPERATION

of December 31, 2019

OFFICE OF THE CITY CLERK, LICENSE DIVISION
CITY HALL, 100 N. WILSON ST., ROOM 105, MILWAUKEE, WI 53202
(414) 226-2258 • www.milwaukee.gov • www.milwaukee.gov/licenses

Legal Entity Name: THE 4TH QUARTER SPORTS BAR AND GOLF LLC

Premises Address: 1300 W KEEFER AVE

SECTION 1 TYPE OF BUSINESS

What will be the majority of your food sales? (check one)

Restaurant Items (meals):
MEALS include, but are not limited to, chicken, ribs, sandwiches, roasted corn, baked potatoes, hot dogs, brats, burgers, nothing w/ cheese and meat, french fries, cooked or deep-fried vegetables/fish, cooked cheese curds, corn dogs, egg rolls, salads

Retail Items (snacks and beverages):
ALL items include, but are not limited to, hot food/drink service (feminine, pizza cones, coffee, espresso, cappuccino, tea, fruit juice, smoothies, candy, deep-fried foods, fruit cups, bakery, cookies, kettle corn, cotton candy, fudge, cakes, fritters, tortilla chips w/ cheese)

Will it be a convenience store? Yes No
A convenience store contains less than 5,000 square feet of retail space and has, as its primary business, the sale of basic food items and in addition, sells household products or is a filling station that sells basic food items and household products.

Deli & Breakfast
 Micro Market

All Applicants: Submit a menu or a list of food items that will be sold.

Will any wholesale business be done? No Yes. If yes, what percentage of food sales will be wholesale?

Less than 25%
 25% or More AND:
 Restaurant items (meals) will be sold - Complete this application and also contact DATCP.
 NO restaurant items (meals) will be sold - Do NOT complete this application. Contact DATCP only.

SECTION 2 FOOD PROCESSING

Will any food processing be done? No Yes

Processing is defined as assembling, grinding, cutting, mixing, baking, coating, stuffing, packing, bottling, grating, canning, extruding, fermenting, distilling, pickling, freezing, drying, smoking, or packaging.

SECTION 3 FOOD REQUIRING TEMPERATURE CONTROL

Will any food that requires temperature control be sold? No Yes
(includes dairy products such as milk, cheese, and ice cream; fish, shellfish, meat, poultry)

If yes, list the types of food items: FISH, MEAT, VEGETABLES

SECTION 4 DETAILS OF OPERATION

Will you have seating on site for dining? No Yes

Will you be doing any catering? No Yes

Will you be doing any deliveries? No Yes

Will you have outdoor facilities? No Yes. Check all that apply: Bar Smoking/Gaming Pool

Will you have a drive thru window? No Yes - Are about different from inside? No Yes
If Yes, provide drive thru hours: _____

Will scales or bicycle scales be used? No Yes. You must also apply for a Weights & Measures license

SECTION 5 ADDITIONAL SITES

Where will food be prepared (indoor/outdoor)?

At a single site At multiple sites. How many? _____ (for example, a hotel with several dining rooms or bars)

If multiple sites, attach a Food Dealer Additional Site Addendum (FD-302add) for each additional site

SECTION 6 CONSTRUCTION OR CHANGES

Are you planning any construction, remodeling or equipment changes?

No. If No, skip to Section 8

Yes. If Yes, check all that apply: New construction of a building Renovation or remodeling
 Construction changes to existing building Equipment changes only

Provide a brief description of the changes: _____

Start date: _____

Name, Address & Phone Number of Architect: _____

Name, Address & Phone Number of Contractor: _____

SECTION 7 ALCOHOL BEVERAGES

Are you applying for an alcohol beverage license?

No. If No, skip to Section 8

Yes. If YES, if your food license is approved prior to the alcohol license, when do you want the food license raised?
 Immediately At the same time as the alcohol license

SECTION 8 ACKNOWLEDGEMENTS & SIGNATURE

You must initial each item confirming your understanding:

DG I understand the Health Department must conduct an inspection and advise the License Division of their approval before the license may be issued.

DG I understand I must obtain an occupancy permit from the Department of Neighborhood Services and an inspection may be required. Neighborhood Services must advise the License Division of their approval before the license may be issued.

PL I understand the district supervisor will review and either support or object to my application. If he/she objects, I may appeal and be scheduled to appear before the License Committee. The License Committee will then make a recommendation to the Common Council. The Common Council must grant the license before it may be issued.

DG I understand proof of payment for all license fees must be on file in the License Division before the license may be issued and the license must be posted in my establishment prior to opening for business.

DG I understand my food business must have the license posted in the establishment.

Signature of Food Processor, Vendor, or 20% Shareholder: D. Alamy

Signature of Applicant: _____

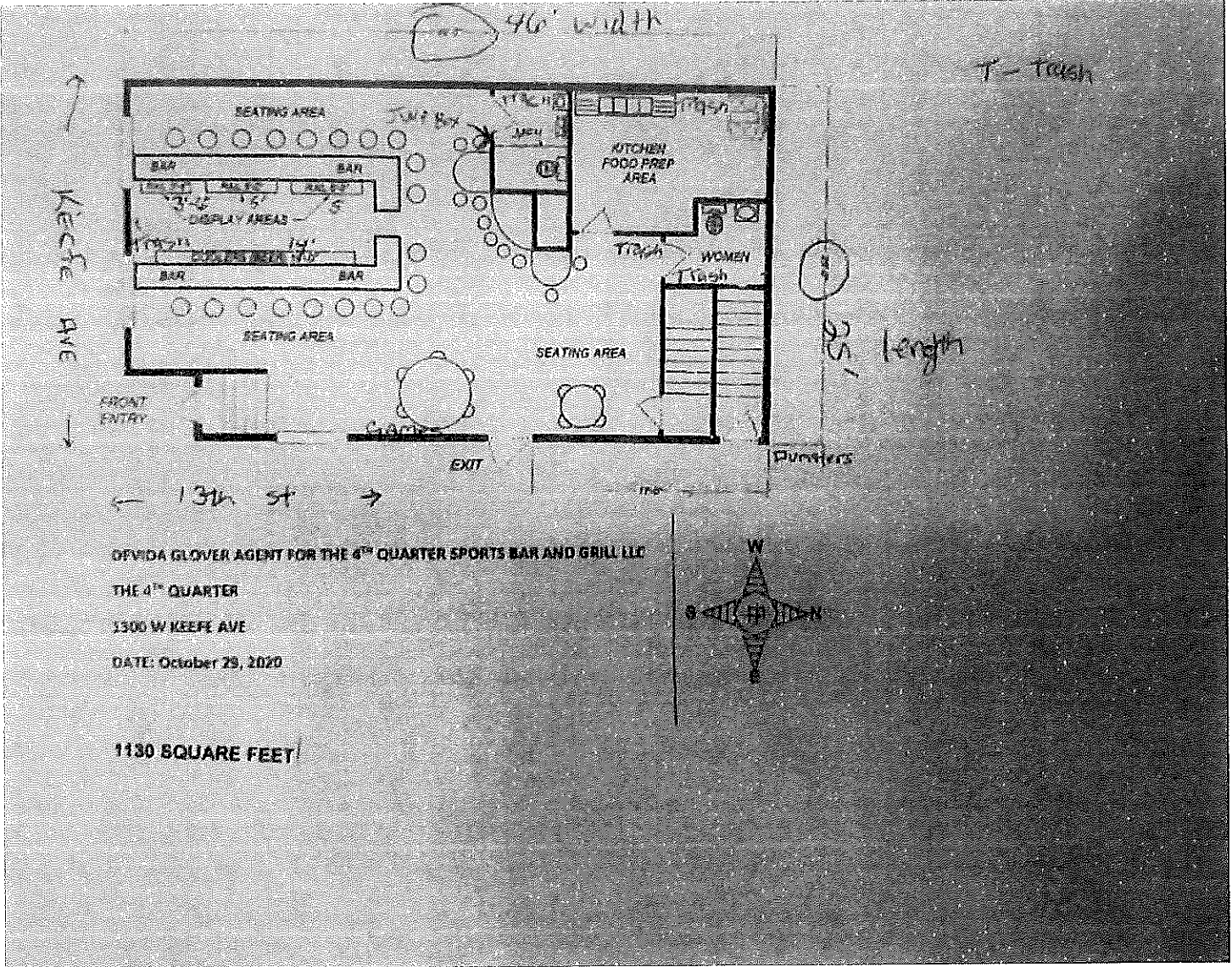

OFVIDA GLOVER AGENT FOR THE 4TH QUARTER SPORTS BAR AND GRILL LLC
 THE 4TH QUARTER
 1300 W KEEFE AVE
 DATE: October 29, 2020

1130 SQUARE FEET