

106435

CERTIFICATE OF APPROPRIATENESS APPLICATION FORM

Incomplete applications will not be processed for Commission review.
Please print legibly.

1. HISTORIC NAME OF PROPERTY OR HISTORIC DISTRICT: (if known)
NORTH POINT NORTH HISTORIC DISTRICT

ADDRESS OF PROPERTY:
2822 E. BELLEVIEW MILWAUKEE

filed @ HPC
10/24/2015

2. NAME AND ADDRESS OF OWNER:

Name(s): MICHAEL AND CINDY HOSALE

Address: 2604 N. LAKE DRIVE

City: MILWAUKEE State: WI ZIP: 53211

Email: cynhosale@gmail.com

Telephone number (area code & number) Daytime: 414 491 3792 Evening: 414 491 3792
CINDY CELL (CINDY CELL)

3. APPLICANT, AGENT OR CONTRACTOR: (if different from owner)

Name(s): WINTERS REMODELING GROUP LLC

Address: 7772 HARWOOD AVENUE

City: WAUWATOSA State: WI ZIP Code: 53213

Email: wintersgroupllc@hpeprint.com

Telephone number (area code & number) Daytime: 414 771 6202 Evening: 414 218 9215

4. ATTACHMENTS: (Because projects can vary in size and scope, please call the HPC Office at 414-286-5712 for submittal requirements)

A. REQUIRED FOR MAJOR PROJECTS:

Photographs of affected areas & all sides of the building (annotated photos recommended)

Sketches and Elevation Drawings (1 full size and 1 reduced to 11" x 17" or 8 1/2" x 11")
A digital copy of the photos and drawings is also requested.

Material and Design Specifications (see next page)

B. NEW CONSTRUCTION ALSO REQUIRES:

Floor Plans (1 full size and 1 reduced to a maximum of 11" x 17")

Site Plan showing location of project and adjoining structures and fences

PLEASE NOTE: YOUR APPLICATION CANNOT BE PROCESSED UNLESS
BOTH PAGES OF THIS FORM ARE PROPERLY COMPLETED
AND SIGNED.

5. DESCRIPTION OF PROJECT:

Tell us what you want to do. Describe all proposed work including materials, design, and dimensions. Additional pages may be attached.

THE "HUNG" BAY WINDOW SECTION OF THE HOUSE HAS A 1960'S LOOK WITH LAP SIDING THAT IS NOT OF THE ERA THAT THIS HOUSE COMES FROM. (SEE PHOTO)

WE PROPOSE TO REMOVE THIS SIDING AND REPLACE WITH A FLAT INSET PANEL FRAMING WITH 5/4" MINATEC - WHICH WILL BE PAINTED THE COLOR OF THE HOUSE TRIM. (SEE PROPOSED)

6. SIGNATURE OF APPLICANT:

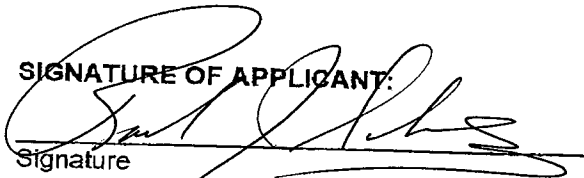
Signature

ROBERT J. SCHULZ

Please print or type name

Date 10-27-15

This form and all supporting documentation **MUST** arrive by 12:00 noon on the deadline date established to be considered at the next Historic Preservation Commission Meeting. Any information not provided to staff in advance of the meeting will not be considered by the Commission during their deliberation. Please call if you have any questions and staff will assist you.

Hand Deliver or Mail Form to:
Historic Preservation Commission
City Clerk's Office
200 E. Wells St. Room B-4
Milwaukee, WI 53202

PHONE: (414) 286-5722

FAX: (414) 286-3004

www.milwaukee.gov/hpc

Or click the **SUBMIT** button to automatically email this form for submission.

2822 E. BELLEVUE
EXISTING

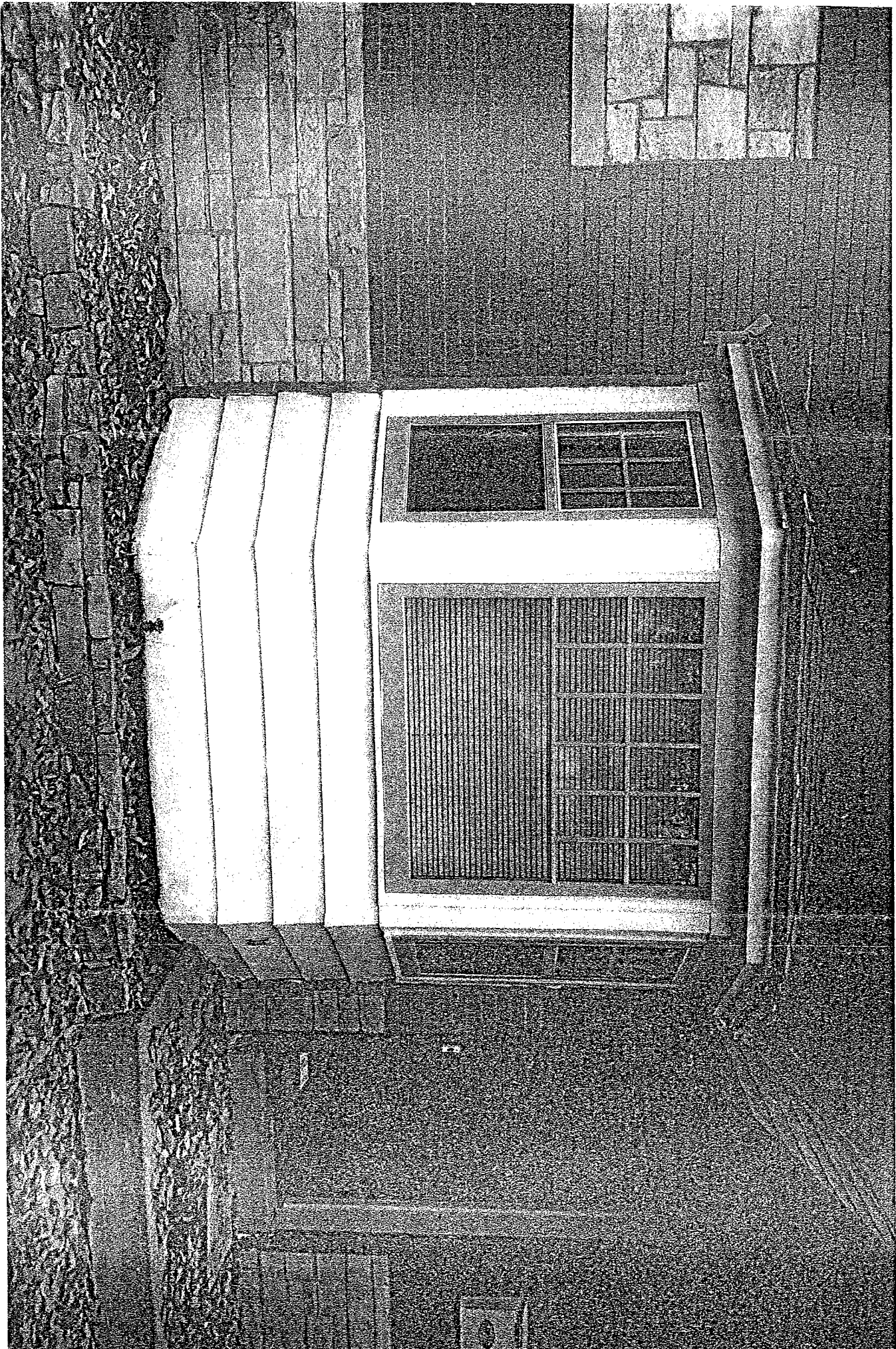

OCTOBER 2015

2822 E. BELLEVIEW - PROPOSED

A - FLAT PANEL B - 5/4 MINUTEK - PAINT - SAME COLOR OF TRIM

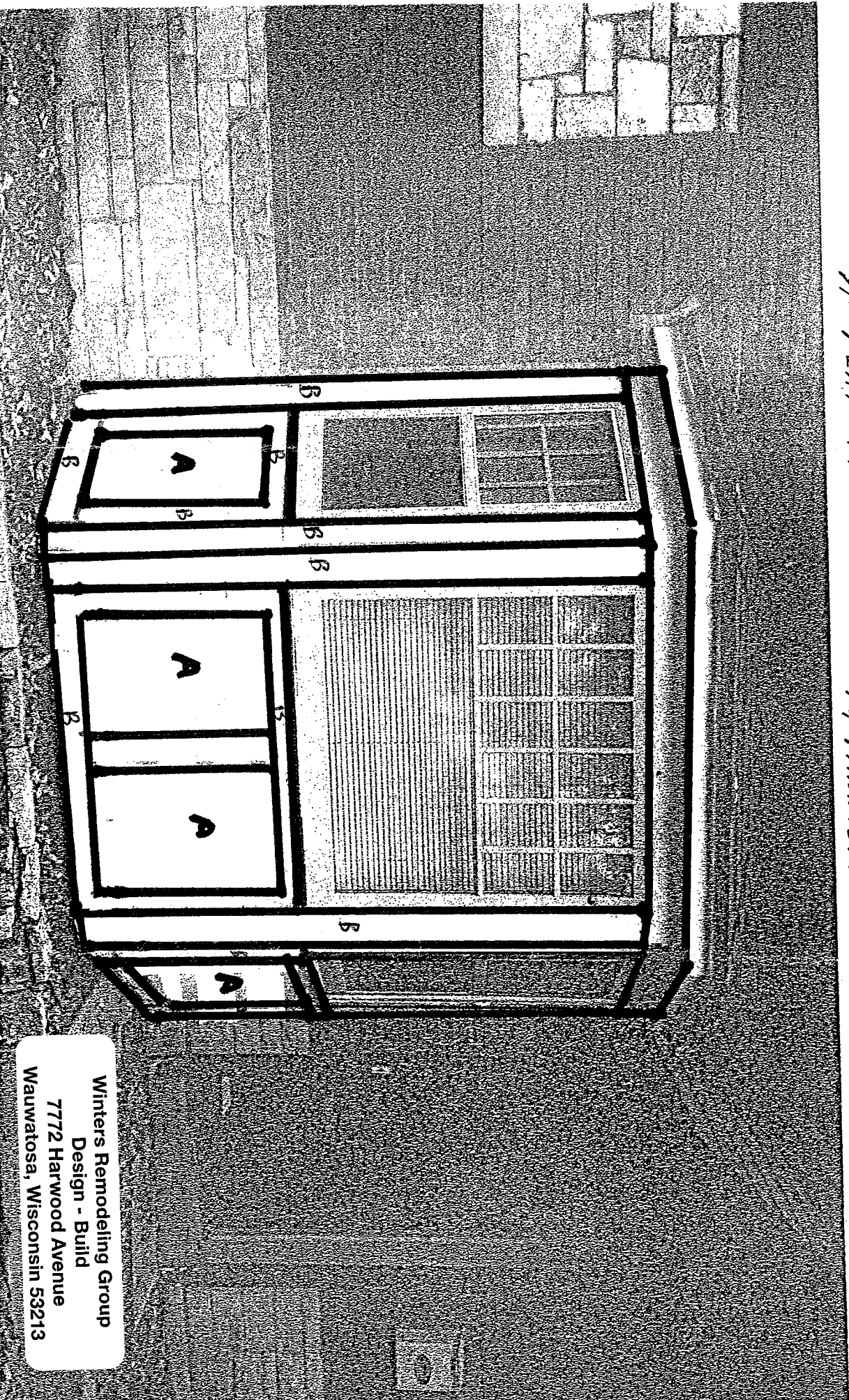

Winters Remodeling Group
Design - Build
7772 Harwood Avenue
Wauwatosa, Wisconsin 53213

2822 E. BELLEVIEW

