



Stock No. 26273

DD# 2446

CERTIFIED SURVEY MAP NO. _____

SHEET 1 OF 3

BEING A REDIVISION OF LOT 16, IN BLOCK 37, IN SHERMAN'S ADDITION, IN THE S.E. AND SOUTHWEST 1/4 OF THE NORTHEAST 1/4 OF SECTION 20, IN TOWNSHIP 7 NORTH, RANGE 22 EAST, IN THE CITY OF MILWAUKEE, MILWAUKEE COUNTY, WISCONSIN.

TAX KEY NO. 353-0850-100 ZONING: RT4

NW COR. N.E. 1/4 SEC. 20-7-22
CONC. MON. W/ BRASS CAP
393,390.63 / 2,556,450.98

NE COR. N.E. 1/4 SEC. 20-7-22
CONC. MON. W/ BRASS CAP
393,430.70 / 2,559,104.38

NORTH LINE N.E. 1/4 SEC. 20-7-22

2653.92

1325.89
S. 89°08'05"W.

20' PUBLIC ALLEY

N00°43'52"W. 50.11
(REC. AS 5000)

LOT 13 BLK. 37
N. 88°55'51"E.
61.400

PARCEL 2
3,076 SQ. FT.

SHERMAN'S ADDITION

150.855

89-455
EXISTING DWELLING

PARCEL 1
4,481 SQ. FT.

61.40
S. 88°55'22"W.

150.86

W. VINE ST.

P.O.B.
SE. COR.
BLK. 37
(80' R.O.W.)

N. 2nd ST.
(80' R.O.W.)

S. 00°44'12"E. 2307.10

1325.89
S. 89°08'05"W.

8' +
8' +

S. 00°44'12"E.

50.09
(REC. AS 50.00)

8' +
8' +

(80' R.O.W.)

SCALE: 1" = 30'



LOCATION MAP
N.E. 1/4 SEC. 20-7-22

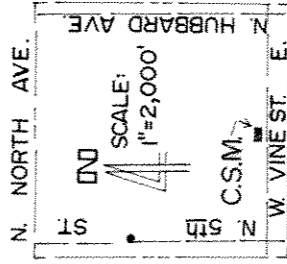

NOTES

- DENOTES 1" X 24" IRON PIPE, 113 LBS. PER LINEAL FOOT SET
- + DENOTES OFFSET CROSS SET IN CONC. SIDE WALK - OFFSET AS SHOWN

ALL BEARINGS REFER TO THE NORTH LINE OF THE N.E. 1/4 SEC. 20-7-22 WHICH IS ASSUMED TO BEAR S. 89°08'05"W. (WISC. STATE PLANE COORD. SYSTEM - SOUTH ZONE, APR. 2001 DAT)

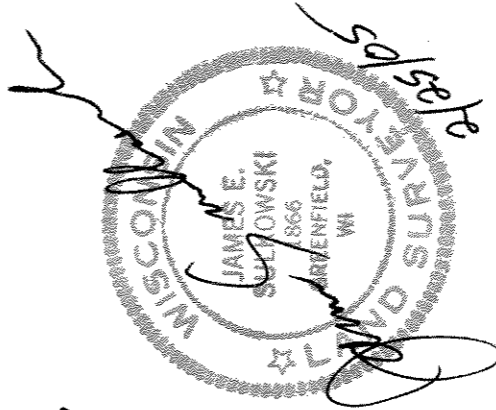

PREPARED BY
MORTGAGE SURVEY SERVICE
6617 W. COLDSRING RD.
GREENFIELD, WI 53220
(414) 327-4400

INFRASTRUCTURE SERVICES DIVISION

Marcia Amador 5/13/05
CENTRAL DRAFTING & RECORDS MANAGER

Timothy Thur 5/12/05
ENGR. IN CHARGE ENVIRON. ENGR.

for CORRECT

for [Signature] 5/16/05
CITY ENGINEER

IMAN APPROVED

DEPARTMENT OF CITY DEVELOPMENT

CITY ENGINEER

APR 18 2005

STAFF APPROVED



Stock No. 26273

DVD # 2476

CERTIFIED SURVEY MAP NO. _____

SHEET 2 OF 3

BEING A REDIVISION OF LOT 16, IN BLOCK 37, IN SHERMAN'S ADDITION, IN THE SOUTHEAST AND SOUTHWEST 1/4 OF THE NORTHEAST 1/4 OF SECTION 20, IN TOWNSHIP 7 NORTH, RANGE 22 EAST, IN THE CITY OF MILWAUKEE, MILWAUKEE COUNTY, WISCONSIN.

SURVEYOR CERTIFICATE
STATE OF WISCONSIN)
MILWAUKEE COUNTY) SS

I, James E. Sulkowski, registered land surveyor, do hereby certify:

That I have surveyed, divided and mapped a Redivision of Lot 16 in Block 37, in SHERMAN'S ADDITION, in the Southeast and Southwest 1/4 of the Northeast 1/4 of Section 20, in Township 7 North, Range 22 East, in the City of Milwaukee, Milwaukee County, Wisconsin, which is bounded and described as follows: Commencing at the Northeast corner of said Northeast 1/4 Section; thence South 89 deg. 08' 05" West along the North line of said Northeast 1/4 Section, 1325.89 feet to a point; thence South 00 deg. 44' 12" East, 2307.10 feet to a point, said point being the Southeast corner of said Block 37, and the point of beginning of the land to be described; thence South 88 deg. 55' 22" West, 150.86 feet to a point; thence North 00 deg. 43' 52" West, 50.11 feet to a point; thence North 88 deg. 55' 51" East, 150.855 feet to a point; thence South 00 deg. 44' 12" East, 50.09 feet to the point of beginning.

That I have made this survey, land division and map by the direction of Krista Jeray, owner of said land.

That such a map is a correct representation of all exterior boundaries of the land surveyed and the land division made thereof.

That I have fully complied with the Provisions of Chapter 236 of the Wisconsin Statutes and Chapter 119 of the Milwaukee Code of Ordinances in surveying, dividing and mapping the same.

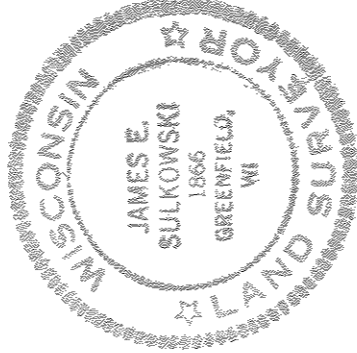

James Sulkowski
James E. Sulkowski, Registered
Wisconsin Land Surveyor S-1866

2/25/05

OWNER'S CERTIFICATE

As owner, I hereby certify that I have caused the land described on this map to be surveyed, divided and mapped as represented on this map in accordance with the requirements of Chapter 119 of the Milwaukee Code of Ordinances.

In consideration of the approval by the Common Council of the City of Milwaukee, the undersigned agrees:

That all utility lines to provide electric power and telephone service and cable televisions or communication systems or cables to all parcels in the Certified Survey Map shall be installed underground in easements provided thereof, where feasible.

This agreement shall be binding on the undersigned and assigns. Witness the hand and seal of said owner this _____ day of _____, 20____.

Krista Jeray
Krista Jeray

Witness

STATE OF WISCONSIN)
COUNTY OF MILWAUKEE) SS

Personally came before me this 9th day of March, 20 05, the above named Krista Jeray, to me known to be the person who executed the foregoing instrument and acknowledged the same.

Robert J. Koch

Notary Public, State of Wisconsin
My Commission Expires: Permanent

Robert James Koch
Notary Public
State of Wisconsin



Stock No. 26273

DID# 2476

CERTIFIED SURVEY MAP NO. _____

SHEET 3 OF 3

BEING A REDIVISION OF LOT 16, IN BLOCK 37, IN SHERMAN'S ADDITION,
IN THE SOUTHEAST AND SOUTHWEST 1/4 OF THE NORTHEAST 1/4 OF
SECTION 20, IN TOWNSHIP 7 NORTH, RANGE 22 EAST, IN THE CITY OF
MILWAUKEE, MILWAUKEE COUNTY, WISCONSIN.

STATE OF WISCONSIN)
COUNTY OF MILWAUKEE) SS

I, Wayne F. Whitlow, being duly elected, qualified and acting Treasurer of the City of Milwaukee, do hereby certify that in accordance with the records in the Office of the City Treasurer of the City of Milwaukee, there are no unpaid taxes or unpaid special assessments on the land included in this Certified Survey Map.

Dated this 17th day of MAY, 20 05.

Wayne F. Whitlow

Wayne F. Whitlow, City Treasurer

COMMON COUNCIL CERTIFICATE OF APPROVAL

I, hereby certify that this Certified Survey Map was approved under Resolution No. 050111, adopted by the Common Council of the City of Milwaukee, on this 20th day of May, 20 05.

Ronald Leonhardt Tom Barrett

Ronald D. Leonhardt, City Clerk

Tom Barrett, Mayor

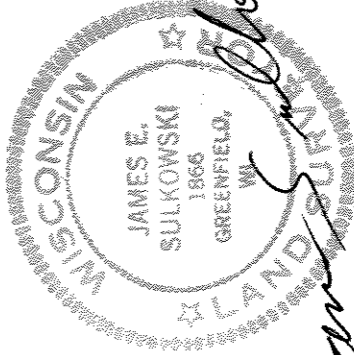

James E. Sulkowski 2/25/09