



PETITION FOR A SPECIAL PRIVILEGE

ccl-246 (7/15)

SP 2829

CCF _____

New application \$250.00 Fee

Amendment to add items to Special Privilege # 2484 (\$125.00 Fee)

Amendment to remove items from Special Privilege # _____ (No fee)

Amendment for change of ownership for Special Privilege # _____ (No fee)

- File petition with the Department of Public Works, Attention: Special Privileges, 841 North Broadway, Room 919, Milwaukee, WI 53202.
- Fee must be submitted with petition. Checks should be made payable to the City of Milwaukee.
- Questions? Call 414-286-2454

To the Honorable, The Common Council of the City of Milwaukee:

The Licensee Satori Restaurant, LLC
(Name of Individual, Partners, Corporation or LLC)

being the owners of the following property known by street address as 928-32 E Brady St
(Street Address and Zip Code)

in the 3rd Aldermanic District respectfully petition the Common Council of the City of Milwaukee according to the provisions of Section 66.0425 of the Wisconsin Statutes, that the following privilege be granted:

Description of Special Privilege: Amendment to CCF 090767 for addition of a patio platform

Of which a plan or sketch is herewith submitted. Petitioner agrees to comply with all laws and all ordinances of the City of Milwaukee, to abide by any order or resolution of the Common Council affecting this privilege, to be primarily liable for damages to person or property by reason of the granting of such privilege, pay annual compensation as provided by law in the sum to be fixed by the proper city officers, and to file and keep current throughout the existence of the privilege, a certificate of insurance indicating applicant holds a public liability policy in at least the sums of \$25,000.00/\$50,000.00 bodily injury, and \$10,000.00 property damage, insuring the city against any liability that might arise by reason of the privilege.

Petitioner further agrees to remove said privilege whenever public necessity so requires when so ordered upon resolution adopted by the Common Council or other legislative body.

Should this special privilege be discontinued for any reason whatsoever, petitioner agrees to remove all construction work executed pursuant to this special privilege, to restore to its former condition and to the approval of the Commissioner of Public Works, any curb, pavement, or other public improvement which was removed, changed or disturbed by reason of the granting of this special privilege. Petitioner further agrees not to contest the validity of Section 66.0425 of the Wisconsin Statutes, or the legality of this special privilege in any way.

Name (Please Print): NONGLUK BURANABUNYUT
(Individual, Partner, or Agent if corporation or LLC as shown above)

Signature: Nongluk B Date: 7/11/19
(Individual, Partner, or Agent if corporation or LLC)

Corporation or LLC Name: Satori Restaurant
(If applicable, as shown above)

Mailing Address (If different than property address above): 932 E. Brady St. Milwaukee WI 53202

(OVER)

City: _____ State: _____ Zip: _____

Telephone: _____ E-Mail: _____

Architect/Engineer/Contractor (If Applicable)

Name: _____

Address: _____

City: _____ State: _____ Zip: _____

Telephone: _____ E-Mail: _____

IMPORTANT NOTICE FOR CUSTOMERS PAYING BY CHECK

When you provide a check as payment, you authorize us either to use information from your check to make a one-time electronic fund transfer from your account or to process the payment as a check transaction.

PAID

\$ 125.00 *DMS*

JUL 11 2019

Special Privilege Application
City of Milwaukee
Department of Public Works

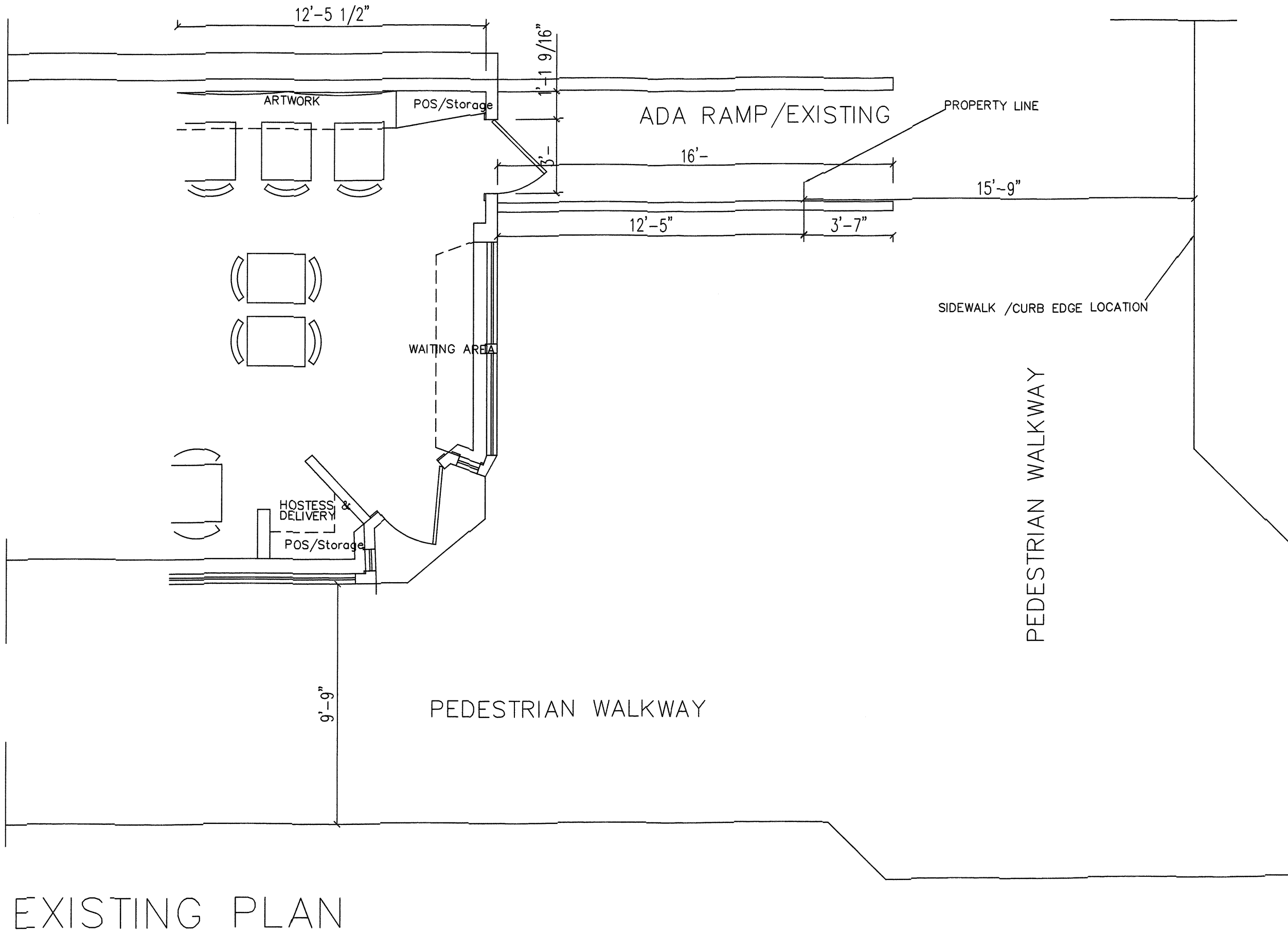

EXISTING PLAN

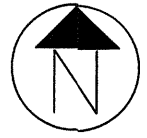

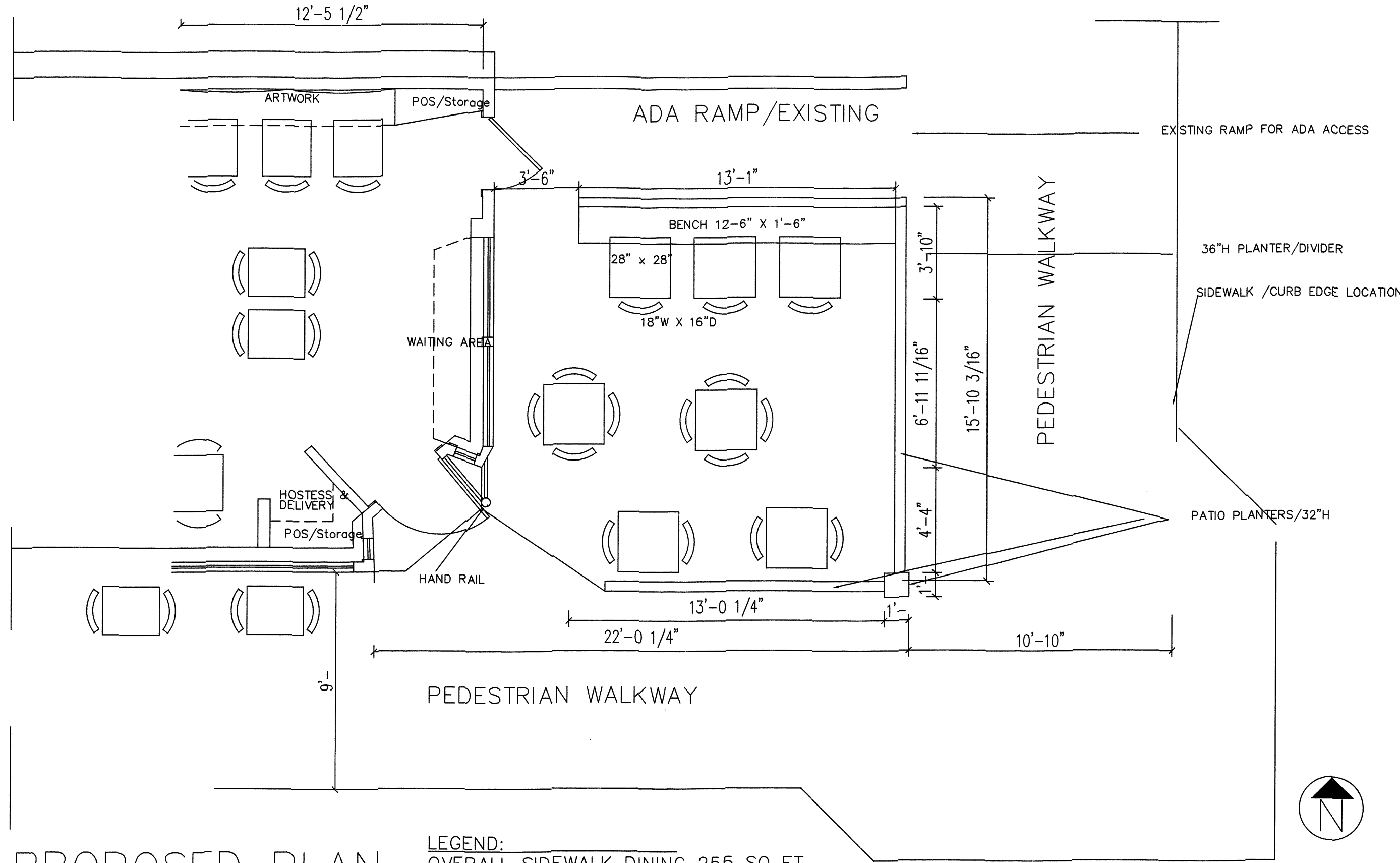

PROPOSED PLAN

LEGEND:
 OVERALL SIDEWALK DINING 255 SQ. FT.
 ALL TABLES 28" X 28" SQUARE
 ALL CHAIRS 18"S X 16"D
 Colleen Thompson, 414-378-5569

PAGE: 1 of 1
 THIS IS AN ORIGINAL DESIGN AND MUST NOT BE RELEASED OR COPIED UNLESS APPLICABLE FEE HAS BEEN PAID OR JOB ORDER PLACED.
 ALL SIZE DESIGNATIONS & DIMENSIONS GIVEN ARE SUBJECT TO VERIFICATION ON JOB SITE AND ADJUSTMENT TO FIT JOB CONDITIONS.
 SCALE: 1/4" = 1' -
 DATE: -4/24/19
 REVISION: -4/30/19
 REVISION: -
 PROJECT: Thai-namite Restuarant
 932 Brady Street
 Milwaukee WI 53202

i.e. DESIGN
 100 E. MELIOTT STREET MILWAUKEE WISCONSIN 53202

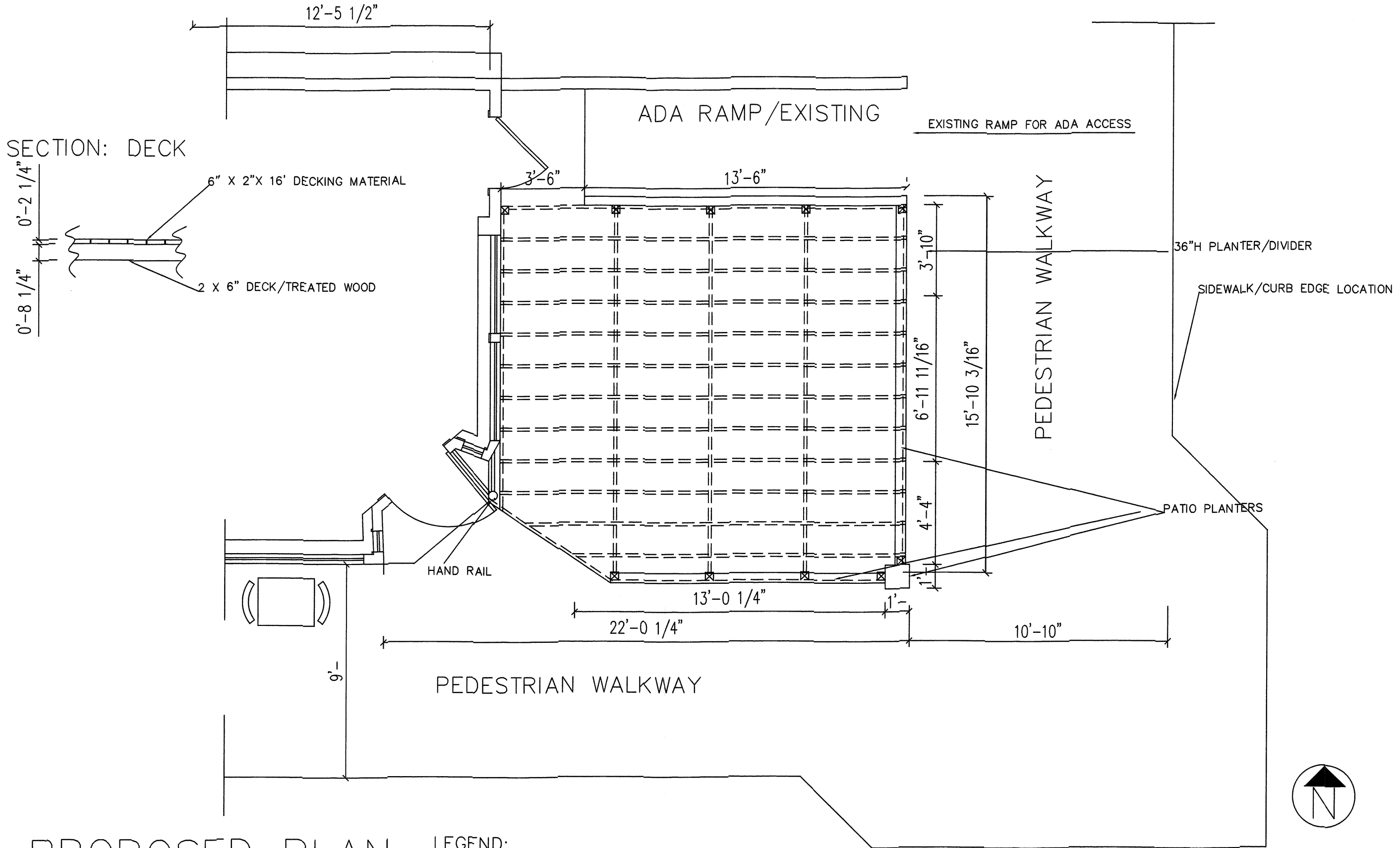

LEGEND:
 OVERALL SIDEWALK DINING 255 SQ. FT.
 ALL TABLES 28" X 28" SQUARE, CHAIRS 18' X 16"
 CORNER SUPPORT METAL STUD FRAME SECURED TO CONCRETE

