

**LAND DISPOSITION REPORT
COMMON COUNCIL OF THE CITY OF MILWAUKEE**

DATE

April 14, 2026

RESPONSIBLE STAFF

Deborah McCollum-Gathing, In Rem Disposition Manager, Department of City Development

PARCEL ADDRESS & DESCRIPTION

1408 West Concordia Avenue: A 1,722 square foot residential property. The residential duplex house was built in 1910 on 4,400 square foot lot. The City of Milwaukee ("City") acquired the property through tax foreclosure on September 26, 2025. The property location is in CONTINUATION OF TEUTONIA HEIGHTS IN SE 1/4 SEC 7-7-22 BLOCK 6 E 40' OF W 80'(LOTS 55 TO 57 & S 16.29' LOT 54)



Map of Property Location

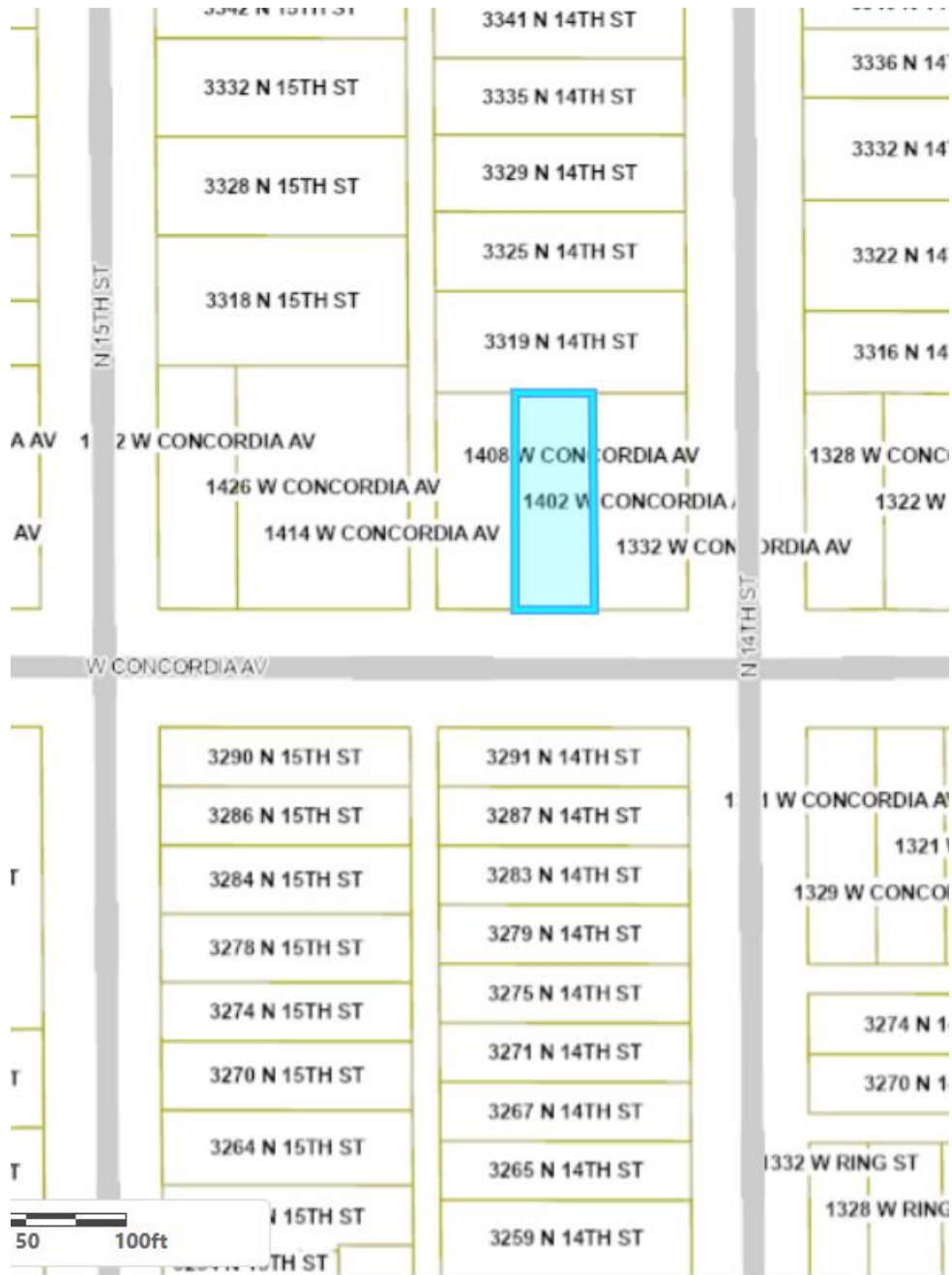

Due Diligence Checklist
Address: 1408 West Concordia Avenue

Buyer

Geo D. Owens for Global Estates, LLC (the “Buyer”) The property sale will be titled the same as the as the tax-foreclosure. The Buyer meets the guidelines to purchase a City property.

Project Description

The City of Milwaukee acquired the property from Global Estates, LLC.

Purchase Terms and Conditions

The purchase price will be \$24,677.89 but subject to change. The conveyance will be on an “as is, where is” basis including all environmental and geotechnical conditions, if any.

Total Costs and Expenses Incurred Plus Taxes, Fees, and Interest Owed

The vacant residential duplex property was acquired through property tax foreclosure on September 26, 2025. The price for the Property will be \$24,677.89 as March 13, 2026. The Buyer, Geo D. Owens for Global Estates, LLC understands that the purchase will be titled as it was prior to the foreclosure.

Tax Consequences to the City of Milwaukee

The property will be returned to the tax rolls.