



CITY OF MILWAUKEE
OFFICE OF THE CITY CLERK

Thursday, March 26, 2015

COMMITTEE MEETING NOTICE

AD 06

GHANI, Yasir A, Agent
Y&A LLC
2438 W Hopkins St

Milwaukee, WI 53206

You are requested to attend a hearing which is to be held in Room 301-B, Third Floor, City Hall on:

Monday, April 06, 2015 at 02:00 PM

Regarding: Your Class A Malt & Class A Liquor License and Food Dealer License Transfer - Change of Agent and Shareholder as agent for "Y&A LLC" for "Mothers Food and Liquor" at 2438 W Hopkins St.

There is a possibility that your application may be denied for one or more of the following reasons: The recommendation of the committee regarding the application shall be based on evidence presented at the hearing. Per MCO 85-2.7-4, probative evidence concerning whether or not a new license should be granted may be presented on the following subjects: whether or not the applicant meets the municipal requirements, the appropriateness of the location and premises where the licensed premises is to be located and whether use of the premises for the purposes or activities permitted by the license would tend to facilitate a public or private nuisance or create undesirable neighborhood problems such as disorderly patrons, unreasonably loud noise, litter, and excessive traffic and parking congestion. Probative evidence relating to these matters may be taken from the plan of operation submitted with the license application, if any, but shall not include the content of any music. Evidence regarding the fitness of the location of the premises to be maintained as the principal place of business, including but not limited to whether there is an overconcentration of businesses of the type for which the license is sought; whether the proposal is consistent with any pertinent neighborhood business or development plans, or the location's proximity to areas where children are typically present. The applicant's record in operating similarly licensed premises; and whether or not the applicant has been charged with or convicted of any felony, misdemeanor, municipal offense or other offense, the circumstances of which substantially relate to the activity to be permitted by the license being applied for or any other factor which reasonably relates to the public health, safety or welfare may also be considered. See attached police report or correspondence.

Notice for applicants with warrants or unpaid fines:

Proof of warrant satisfaction or payment of fines must be submitted at the hearing on the above date and time. Failure to comply with this requirement may result in a delay of the granting/denial of your application.

Failure to appear at this meeting may result in the denial of your license. Individual applicants must appear only in person or by an attorney. Corporate or Limited Liability applicants must appear only by the agent designated on the application or by an attorney. Partnership applicants must appear by a partner listed on the application or by an attorney. If you wish to do so and at your own expense, you may be accompanied by an attorney of your choosing to represent you at this hearing.

You will be given an opportunity to speak on behalf of the application and to respond and challenge any charges or reasons given for the denial. No petitions can be accepted by the committee, unless the people who signed the petition are present at the committee hearing and willing to testify. You may present witnesses under oath and you may also confront and cross-examine opposing witnesses under oath. If you have difficulty with the English language, you should bring an interpreter with you, at your expense, so that you can answer questions and participate in your hearing.

You may examine the application file at this office during regular business hours prior to the hearing date. Inquiries regarding this matter may be directed to the person whose signature appears below.

Limited parking for persons attending meetings in City Hall is available at reduced rates (5 hour limit) at the Milwaukee Center on the southwest corner of East Kilbourn and North Water Street. Parking tickets must be validated in the first floor information booth in City Hall.

PLEASE NOTE: Upon reasonable notice, efforts will be made to accommodate the needs of disabled individuals through sign language interpreters or other auxiliary aids. For additional information or to request this service, contact the Council Services Division ADA Coordinator at (414) 286-2998, Fax - (414) 286-3456, TDD - (414) 286-2025.

JIM OWCZARSKI, CITY CLERK

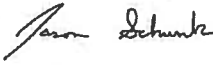
BY: 

Jason Schunk
License Division Manager

If you have questions regarding this notice, please contact the License Division at (414) 286-2238.

200 E. Wells Street, Room 105, City Hall, Milwaukee, WI 53202. www.milwaukee.gov/license
Phone: (414) 286-2238 Fax: (414) 286-3057 Email Address: License@milwaukee.gov

MILWAUKEE POLICE DEPARTMENT LICENSING

CRIMINAL RECORD/ORDINANCE VIOLATION/INCIDENTS SYNOPSIS

DATE: 11/26/2014

LICENSE TYPE: CLASS A MALT & LIQUOR

No. 200156

NEW:

Application Date: 11/24/2014

RENEWAL:

License Location: 2438 W Hopkins St

Business Name: Mothers Food & Liquor

Licensee/Applicant: Farhud, Ali M
(Last Name, First Name, MI)

Date of Birth: 02/25/1989

Home Address: 4042 S 5th St

City: Milwaukee

State: WI Zip Code: 53207

Home Phone: (414) 403-8774

This report is written by Police Officer David NOVAK, assigned to the License Investigation Unit, Days.

The Milwaukee Police Department's investigation regarding this application revealed the following:

1. On 03/16/2010, the applicant was arrested by Oak Creek Police Department for:

Charge:	Possession of THC
Finding:	Convicted of Disorderly Conduct – Oak Creek Municipal Court
Sentence:	Fine
Date:	05/11/2010

- =====
2. On 12/12/2013 Officers arrested three subjects outside of Mothers Foods at 2438 W. Hopkins St for Narcotics violations. The applicant was very cooperative with officers regarding obtaining video evidence of what occurred outside the business.
 3. On 07/19/2014 Officers were working the Wisconsin WINS Tobacco Initiative. A 17 year old went into Mothers Foods at 2438 W. Hopkins St and was able to purchase two Swisher Sweet cigars without Identification. The cashier was Yasir A. GHANI and admitted to selling the cigars. The applicant was cited for Sale of Cigarettes to Minor/Underage.

Charge: Sale of Cigarettes to Minor/Underage
Finding: Guilty
Sentence: Fined \$120.00
Date: 10/22/2014
Case: 14056051

Previous premise

MILWAUKEE POLICE DEPARTMENT
LICENSE INVESTIGATION UNIT

CRIMINAL RECORD/ORDINANCE VIOLATION/INCIDENTS
SYNOPSIS

DATE: 09/16/13

LICENSE TYPE: ALQML

NEW:

RENEWAL: X

No. 174099

Application Date: 09/16/13

Expiration Date:

License Location: 2438 W Hopkins Street

Aldermanic District:

Business Name: Y & K Enterprises

Licensee/Applicant: Ahmad, Daya

(Last Name, First Name, MI)

Date of Birth: 10/28/1980

Home Address: 4452 W Sumac Pl

City: Milwaukee

State: WI

Zip Code: 53219

Home Phone: (414) 541-5451

This report is written by Police Officer Kristyn KUKOWSKI, assigned to the License Investigation Unit, Days.

The Milwaukee Police Department's investigation regarding this application revealed the following:

1. On 11/08/1998, the applicant was arrested by Greendale Police Department for:

Charge: Disorderly Conduct
Finding: Convicted – Greendale Municipal Court
Sentence: Fine
Date: 12/16/1998

2. On 03/20/1999, the applicant was arrested by Greenfield Police Department for:

Charge1: Aggravated Battery/Intent-Great Harm
Charge2: Battery

Finding1: Convicted of amended charge Battery – Milwaukee County Circuit Court
Finding2: Convicted – Milwaukee County Circuit Court
Finding3: Convicted of additional charge Criminal Damage – Milwaukee County Circuit Court

Sentence1-3: Milwaukee County House Of Correction – 9 Months Concurrent / Probation 2 Years

Date1-3: 06/30/1999

Case#: 1999CF001415

3. On 08/26/1999, the applicant was charged by Milwaukee County for:

Charge: Battery
Finding: Guilty of amended charge Disorderly Conduct – Milwaukee County Circuit Court
Sentence: Forfeiture / Fine
Date: 12/07/1999
Case#: 1999CM008495

4. On 06/19/2000, the applicant was arrested by Greenfield Police Department for:

Charge: Disorderly Conduct
Finding: Convicted
Sentence: Fine
Date: 09/20/2000

=====
The following applies to corporate officer Fathi M Jaber:

5. On 03/13/11, Jaber was cited for Sale of Cigarettes To Minor/Underage Person at 2438 W Hopkins Street. He has a future court date on 09/21/11 at 1:30 am. (11079502)

Dismissed w/o prejudice

=====
Incident # 5 previously reported, disposition now added on 09/11/12.

The following applies to Fathi Jaber:

6. On 11/13/10, Jaber received a citation for Sale of Cigarettes to Minor/Underage at 2438 W Hopkins Street.

Charge: Sale of Cigarettes to Minor/Underage
Finding: Guilty
Sentence: Fined \$120.00
Date: 11/29/11
Case: 11079502

=====
7. On 07/13/13 at 10:30 am, Milwaukee police were working the Wisconsin WINS Tobacco Initiative and had a 16 year old student enter 2438 W Hopkins in attempts to purchase a cigar. The student was able to purchase a Black & Mild cigar from the clerk who identified as Yasir Ghani, without having to provide ID. The licensee, Daya Ahmad, received a citation for Sale of Cigarettes to Minor/Underage at 2438 W Hopkins.

Charge: Sale of Cigarette To Minor/Underage
Finding: Pre Trial 1:30 pm 09/27/13
Sentence:
Date:
Case: 13075001

Previous premise



Thursday, March 26, 2015



Notice of Public Hearing

GHANI, Yasir A, Agent

Mothers Food and Liquor at 2438 W Hopkins St

Class A Malt & Class A Liquor License and Food Dealer License Transfer - Change of Agent and Shareholder

Monday, April 06, 2015 at 2:00 PM

To whom it may concern:

The above application has been made by the above named applicant(s). This requires approval from the Licenses Committee and the Common Council of the City of Milwaukee. The hearing before the Licenses Committee will take place on 4/6/2015 at 2:00 PM, in Room 301-B, Third Floor, City Hall. If you wish, you may provide testimony at the hearing regarding the request; see below for further information. You are not required to attend the hearing. Once the Licenses Committee makes its recommendation, this recommendation is forwarded to the full Common Council for approval at its next regularly scheduled hearing. Please review the information below and if you have further questions regarding this process, please contact the License Division at (414) 286-2238.

Important details for those wishing to provide information for the Licenses Committee to consider when making its recommendation:

1. The license application is scheduled to be heard at the above time. Due to other hearings running longer than scheduled, you may have to wait some time to provide your testimony.
2. You must appear in person and testify as to matters that you have personally experienced or seen. (You cannot provide testimony for your neighbor, parent or anyone else; this is considered hearsay and cannot be considered by the committee.)
3. No letters or petitions can be accepted by the committee (unless the person who wrote the letter or the persons who signed the petition are present at the committee hearing and willing to testify).
4. Persons opposed to the license application are given the opportunity to testify first; supporters may testify after the opponents have finished.
5. When you are called to testify, you will be sworn in and asked to give your name, and address. (If your first and/or last names are uncommon please spell them.)
6. You may then provide testimony.
 - a. Include only information relating to the above license application.
 - b. Include only information you have personally witnessed or seen.
 - c. Provide concise and relevant information detailing how this business has affected or may affect the peaceful enjoyment of your neighborhood.
 - d. If by the time you have the opportunity to testify, the information you wish to share has already been provided to the committee, you may state that you agree with the previous testimony. Redundant or repetitive testimony will not assist the committee in making its recommendation.
7. After giving your testimony, the members of the Licenses Committee and the licensee may ask questions regarding the testimony you have given or other factors relating to the license application.
8. Business Competition is not a valid basis for denial or non-renewal of a license.
Please Note: If you have submitted an objection to the above application your objection cannot be considered by the committee unless you personally testify at the hearing.

RESIDENT	MAIL ADDRESS	CITY AND ZIP CODE
CURRENT RESIDENT	2406 W HOPKINS ST	MILWAUKEE, WI 53206-1250
CURRENT RESIDENT	2408 W HOPKINS ST	MILWAUKEE, WI 53206-1250
CURRENT RESIDENT	2410 W HOPKINS ST	MILWAUKEE, WI 53206-1250
CURRENT RESIDENT	2411 W HOPKINS ST	MILWAUKEE, WI 53206-1251
CURRENT RESIDENT	2412 W HOPKINS ST	MILWAUKEE, WI 53206-1250
CURRENT RESIDENT	2420 W HOPKINS ST	MILWAUKEE, WI 53206-1250
CURRENT RESIDENT	2420 W TOWNSEND ST	MILWAUKEE, WI 53206-1316
CURRENT RESIDENT	2428 W HOPKINS ST	MILWAUKEE, WI 53206-1250
CURRENT RESIDENT	2428 W TOWNSEND ST	MILWAUKEE, WI 53206-1316
CURRENT RESIDENT	2442 W HOPKINS ST	MILWAUKEE, WI 53206-1250
CURRENT RESIDENT	2446 W HOPKINS ST	MILWAUKEE, WI 53206-1250
CURRENT RESIDENT	2450 W HOPKINS ST	MILWAUKEE, WI 53206-1250
CURRENT RESIDENT	2450A W HOPKINS ST	MILWAUKEE, WI 53206-1250
CURRENT RESIDENT	2455 W HOPKINS ST	MILWAUKEE, WI 53206-1252
CURRENT RESIDENT	2455A W HOPKINS ST	MILWAUKEE, WI 53206-1252
CURRENT RESIDENT	2464 W HOPKINS ST	MILWAUKEE, WI 53206-1250
CURRENT RESIDENT	3328 N 24TH PL	MILWAUKEE, WI 53206-1229
CURRENT RESIDENT	3341 N 24TH PL	MILWAUKEE, WI 53206-1230
CURRENT RESIDENT	3341A N 24TH PL	MILWAUKEE, WI 53206-1230
CURRENT RESIDENT	3345 N 24TH PL	MILWAUKEE, WI 53206-1230
CURRENT RESIDENT	3345A N 24TH PL	MILWAUKEE, WI 53206-1230
CURRENT RESIDENT	3349 N 24TH PL	MILWAUKEE, WI 53206-1230
CURRENT RESIDENT	3354 N 25TH ST	MILWAUKEE, WI 53206-1236
CURRENT RESIDENT	3354A N 25TH ST	MILWAUKEE, WI 53206-1236
CURRENT RESIDENT	3358 N 24TH ST	MILWAUKEE, WI 53206-1233
CURRENT RESIDENT	3358 N 25TH ST	MILWAUKEE, WI 53206-1236
CURRENT RESIDENT	3359 N 24TH PL	MILWAUKEE, WI 53206-1230
CURRENT RESIDENT	3362 N 25TH ST	MILWAUKEE, WI 53206-1236
CURRENT RESIDENT	3365 N 24TH PL	MILWAUKEE, WI 53206-1230
CURRENT RESIDENT	3365 N 24TH ST	MILWAUKEE, WI 53206-1228
CURRENT RESIDENT	3367 N 24TH PL	MILWAUKEE, WI 53206-1230
CURRENT RESIDENT	3370 N 24TH ST	MILWAUKEE, WI 53206-1233
CURRENT RESIDENT	3370A N 24TH ST	MILWAUKEE, WI 53206-1233
CURRENT RESIDENT	3372 N 24TH ST	MILWAUKEE, WI 53206-1233
CURRENT RESIDENT	3374 N 24TH ST	MILWAUKEE, WI 53206-1233
CURRENT RESIDENT	3378 N 24TH ST	MILWAUKEE, WI 53206-1233
CURRENT RESIDENT	3379 N 24TH ST	MILWAUKEE, WI 53206-1228
CURRENT RESIDENT	3382 N 24TH ST	MILWAUKEE, WI 53206-1233
CURRENT RESIDENT	3382A N 24TH ST	MILWAUKEE, WI 53206-1233
CURRENT RESIDENT	3383 N 24TH ST	MILWAUKEE, WI 53206-1228
CURRENT RESIDENT	3386 N 24TH ST	MILWAUKEE, WI 53206-1233
CURRENT RESIDENT	3386A N 24TH ST	MILWAUKEE, WI 53206-1233
CURRENT RESIDENT	3387 N 24TH ST	MILWAUKEE, WI 53206-1228
CURRENT RESIDENT	3390 N 24TH ST	MILWAUKEE, WI 53206-1233
CURRENT RESIDENT	3390A N 24TH ST	MILWAUKEE, WI 53206-1233
CURRENT RESIDENT	3391 N 24TH ST	MILWAUKEE, WI 53206-1228
CURRENT RESIDENT	3393 N 24TH ST	MILWAUKEE, WI 53206-1228
CURRENT RESIDENT	3394 N 24TH ST	MILWAUKEE, WI 53206-1233
CURRENT RESIDENT	3395 N 24TH ST	MILWAUKEE, WI 53206-1228
CURRENT RESIDENT	3401 N 24TH ST	MILWAUKEE, WI 53206-1304
CURRENT RESIDENT	3403 N 24TH ST	MILWAUKEE, WI 53206-1304
CURRENT RESIDENT	3405 N 24TH ST	MILWAUKEE, WI 53206-1304
CURRENT RESIDENT	3407 N 24TH ST	MILWAUKEE, WI 53206-1304
CURRENT RESIDENT	3418 N 24TH PL	MILWAUKEE, WI 53206-1301

Total Records: 55

Radius: 250.0 feet and Center of Circle: 2438 W Hopkins ST



PLAN OF OPERATION CONFIRMATION STATEMENT

Office of the City Clerk License Division
200 E. Wells St. Room 105, Milwaukee, WI 53202
(414) 286-2238 license@milwaukee.gov

Date: 2/3-15

License(s) Being Applied For: Class A Food Cig W/M

I confirm that the plan of operation on file which was previously submitted with my Class A
(type of license)
application has not changed, except for the addition of this business being operated.

I understand any changes to the plan of operation on file must be reported to the City Clerk License Division within 10 days of the change.

Yasir Ghani
Print name of individual, partner, agent or 20% or more shareholder

[Handwritten Signature]
Signature



CITY OF MILWAUKEE
OFFICE OF THE CITY CLERK

Thursday, March 26, 2015

COMMITTEE MEETING NOTICE

AD 06

HARPER, Kenneth D, Agent
H RENTALS, LLC
408 E NORTH AV

MILWAUKEE, WI 53212

You are requested to attend a hearing which is to be held in Room 301-B, Third Floor, City Hall on:

Monday, April 06, 2015 at 02:00 PM

Regarding: Your Class B Tavern and Public Entertainment Premises License Renewal Applications Adding 3 Amusement Machines as agent for "H RENTALS, LLC" for "BOSSES LOUNGE" at 408 E NORTH Av.

There is a possibility that your application may be denied for one or more of the following reasons: The recommendation of the committee regarding the application shall be based on evidence presented at the hearing. Per MCO 85-4-4, unless otherwise specified in the code, probative evidence concerning non-renewal, suspension or revocation may include evidence of the following: failure of the applicant to meet municipal qualifications, pending charges against or the conviction of any felony, misdemeanor, municipal offense or other offense, the circumstances of which substantially relate to the circumstances of the particular licensed or permitted activity, by the applicant or by any employee or other agent of the applicant. If the activities of the applicant involve a licensed premises, whether the premises tends to facilitate a public or private nuisance or has been the source of congregations of persons which have resulted in any of the following: disturbance of the peace; illegal drug activity; public drunkenness; drinking in public; harassment of passers-by; gambling; prostitution; sale of stolen goods; public urination; theft; assaults; battery; acts of vandalism including graffiti, excessive littering, loitering, illegal parking, loud noise at times when the licensed premise is open for business; traffic violations; curfew violations; lewd conduct; display of materials harmful to minors, pursuant to s. 106-9.6; or any other factor which reasonably relates to the public health, safety and welfare, or failure to comply with the approved plan of operation. See attached police report or correspondence.

Notice for applicants with warrants or unpaid fines: Proof of warrant satisfaction or payment of fines must be submitted at the hearing on the above date and time. Failure to comply with this requirement may result in a delay of the granting/denial of your application.

Failure to appear at this meeting may result in the denial of your license. Individual applicants must appear only in person or by an attorney. Corporate or Limited Liability applicants must appear only by the agent designated on the application or by an attorney. Partnership applicants must appear by a partner listed on the application or by an attorney. If you wish to do so and at your own expense, you may be accompanied by an attorney of your choosing to represent you at this hearing.

You will be given an opportunity to speak on behalf of the application and to respond and challenge any charges or reasons given for the denial. No petitions can be accepted by the committee, unless the people who signed the petition are present at the committee hearing and willing to testify. You may present witnesses under oath and you may also confront and cross-examine opposing witnesses under oath. If you have difficulty with the English language, you should bring an interpreter with you, at your expense, so that you can answer questions and participate in your hearing.

You may examine the application file at this office during regular business hours prior to the hearing date. Inquiries regarding this matter may be directed to the person whose signature appears below.

Limited parking for persons attending meetings in City Hall is available at reduced rates (5 hour limit) at the Milwaukee Center on the southwest corner of East Kilbourn and North Water Street. Parking tickets must be validated in the first floor information booth in City Hall.

PLEASE NOTE: Upon reasonable notice, efforts will be made to accommodate the needs of disabled individuals through sign language interpreters or other auxiliary aids. For additional information or to request this service, contact the Council Services Division ADA Coordinator at (414) 286-2998, Fax - (414) 286-3456, TDD - (414) 286-2025.

JIM OW CZARSKI, CITY CLERK

BY: Jason Schunk
Jason Schunk
License Division Manager

If you have questions regarding this notice, please contact the License Division at (414) 286-2238.

200 E. Wells Street, Room 105, City Hall, Milwaukee, WI 53202. www.milwaukee.gov/license
Phone: (414) 286-2238 Fax: (414) 286-3057 Email Address: License@milwaukee.gov

MILWAUKEE POLICE DEPARTMENT
LICENSE INVESTIGATION UNIT

CRIMINAL RECORD/ORDINANCE VIOLATION/INCIDENTS
SYNOPSIS

DATE: 03/09/2015

LICENSE TYPE: BTAVN

NEW:

RENEWAL: X

No. 205954

Application Date: 03/09/2015

Expiration Date:

License Location: 408 E North Avenue

Aldermanic District: 06

Business Name: Bosses Lounge

Licensee/Applicant: Harper, Kenneth D

(Last Name, First Name, MI)

Date of Birth: 08/02/78

Male:

Female:

Home Address: 2850 N 6th Street

City: Milwaukee

State: Wi

Zip Code: 53212

Home Phone: (414) 263-3724

This report is written by Police Officer David NOVAK, assigned to the License Investigation Unit, Days.

The Milwaukee Police Department's investigation regarding this application revealed the following:

1. On 04/10/11, applicant was charged with Disorderly Conduct and three counts of Unlawful Phone Use-Threaten W/Obscenity in Milwaukee County.

Charge:	Disorderly Conduct
	Unlawful Phone Use-Threaten W/Obscenity (three counts)
Finding:	Convicted
	Dismissed on Prosecutor's Motion
Sentence:	Fined
Date:	10/18/12
Case:	12CM001055

2. Applicant has the following outstanding traffic citations:

13036087	\$151.80	Due on 07/08/13
13036088	\$88.80	Due on 07/08/13
13036089	\$114.00	Due on 07/08/13
13036090	\$88.80	Due on 07/08/13

The following applies to Tommy L Harris:

3. On 01/21/10, Harris received a citation for Presence of Minor at Licensed Premise at 408 E North Avenue.

Charge: Presence of Minor at Licensed Premises
Finding: Guilty
Sentence: Fined \$250.00
Date: 03/15/10
Case: 10020348

4. On 06/02/13, Harris received a citation for Sale of Intoxicant to Intoxicated Person at 408 E North Avenue.

Charge: Sale of Intoxicant to Intoxicated Person
Finding: Dismissed without prejudice
Sentence:
Date: 10/23/2013
Case: 13070905

5. On 06/28/13 at 2:35 am, Harris received a citation for Class B Premises Allow Patron After Hours at 408 E North Avenue.

Charge: Class B Premises Allow Patron After Hours
Finding: Guilty
Sentence: Fined \$368.00
Date: 08/22/13
Case: 13070906

6. On 07/22/13 at 10:45 pm, Harris received a citation for Liquor License Required at 408 E North Avenue.

Charge: Liquor License Required
Finding: Guilty
Sentence: 1957.00
Date: 10/23/2013
Case: 13079864

=====
Items #4 and #6 previously reported. Disposition added 03/03/2014.

7. On 09/01/2013 Tommy L. Harris was cited at 408 East North Avenue in the city of Milwaukee for Liquor License Required. Tommy L. Harris is listed on the application as 100% shareholder.

Charge: Liquor License Required
Finding: Guilty
Sentence: \$2500.00 fine
Date: 12/06/2013
Case: 13097276

=====

8. On 06/18/2014 Tommy L. HARRIS was cited in the City of Milwaukee at 2039 N. 39th St for Fail to Provide Access for Inspection.

Charge: Fail to Provide Access for Inspection
Finding: Guilty
Sentence: Fined \$502.00 **BENCH WARRANT ISSUED**
Date: 09/04/2014
Case: 14050524

9. On 12/01/2014 Officers responded to 408 E. North Av, Bosses Lounge, for a shots fired complaint. The investigation revealed the bar was shot multiple times by an unknown subject. No one was injured and the bar was closed at the time.

MILWAUKEE POLICE DEPARTMENT
REPORT OF INCIDENTS INVOLVING LICENSED PERSONS OR PREMISES

TO: Captain Thomas G. STIGLER

Business Name: Bosses Lounge
Address of Licensed Premises: 408 E. North Av
Business Phone: 372-7202

District: 5

Type of License: Tavern

Violation / Incident # 14-335-0009 Date of Incident: 12/01/14

Licensee or Manager on premises at time of violation / incident? Yes No

Licensee cooperative? Yes No (If no, explain in narrative section)

Licensee Notified by Officer: Jeffrey KRUEGER Date: 12/01/14 Time: 2:00am

Licensee or Agent's Name: Kenneth D. HARPER Date of Birth: 8/02/78
Home Address: 2850 N 6th St Home Phone: 262-716-7996

Co-Licensee Name: Date of Birth:
Home Address: Home Phone:
Class S License Number:

Bartender Name: Samuel HOSKINS Date of Birth:
Home Address: Home Phone:
Class D License Number: 0204862

Licensed Person / Public Pass. Vehicle, etc.: Date of Birth:
Home Address: Home Phone:
Class D License Number:

VIOLATION/INCIDENT - DESCRIBE FACTS AND CIRCUMSTANCES IN NARRATIVE SECTION

Name of Person Cited: Date of Birth:
Citation Number: Violation & Ord. / Statue No.: Court Date:

Name of Person Cited: Date of Birth:
Citation Number: Violation & Ord. / Statue No.: Court Date:

Name of Person Cited: Date of Birth:
Citation Number: Violation & Ord. / Statue No.: Court Date:

Name of Person Cited: Date of Birth:
Citation Number: Violation & Ord. / Statue No.: Court Date:

Name of Person Cited: Date of Birth:
Citation Number: Violation & Ord. / Statue No.: Court Date:

Investigating Officer: P.O. NAVONE District / Bureau: 5 Date: 12/01/14

Commanding Officer Signature and Name

Date

DISPOSITION - FOR LICENSING ONLY

Table with 5 columns: Citation No., Case Number, Disposition, Judge, Date. Includes handwritten entries for 'LICENSE INVESTIGATION UNIT', 'Received 12-02-14', and 'By' with signature.

PA-33E Narrative

On Monday, December 01, 2014 at approximately 1:42am, P.O. Mark STASZEWSKI and I (Squad 5342), were dispatched to 408 E. North Av (Bosses Lounge) for a shots fired complaint. Upon arrival, it was discovered that Bosses Lounge was shot multiple times by an unknown black male, through a small window on the west side of the building. No people were shot during this incident. It should be noted that the business was closed when this incident occurred and the bartender was no longer at the location. Workers that were still on scene were unable to provide the bartender's full information.



Thursday, March 26, 2015



Notice of Public Hearing

HARPER, Kenneth D, Agent
BOSSES LOUNGE at 408 E NORTH Av
Class B Tavern and Public Entertainment Premises License Renewal Applications Adding 3
Amusement Machines

Monday, April 06, 2015 at 2:00 PM

To whom it may concern:

The above application has been made by the above named applicant(s). This requires approval from the Licenses Committee and the Common Council of the City of Milwaukee. The hearing before the Licenses Committee will take place on 4/6/2015 at 2:00 PM, in Room 301-B, Third Floor, City Hall. If you wish, you may provide testimony at the hearing regarding the request; see below for further information. You are not required to attend the hearing. Once the Licenses Committee makes its recommendation, this recommendation is forwarded to the full Common Council for approval at its next regularly scheduled hearing. Please review the information below and if you have further questions regarding this process, please contact the License Division at (414) 286-2238.

Important details for those wishing to provide information for the Licenses Committee to consider when making its recommendation:

1. The license application is scheduled to be heard at the above time. Due to other hearings running longer than scheduled, you may have to wait some time to provide your testimony.
2. You must appear in person and testify as to matters that you have personally experienced or seen. (You cannot provide testimony for your neighbor, parent or anyone else; this is considered hearsay and cannot be considered by the committee.)
3. No letters or petitions can be accepted by the committee (unless the person who wrote the letter or the persons who signed the petition are present at the committee hearing and willing to testify).
4. Persons opposed to the license application are given the opportunity to testify first; supporters may testify after the opponents have finished.
5. When you are called to testify, you will be sworn in and asked to give your name, and address. (If your first and/or last names are uncommon please spell them.)
6. You may then provide testimony.
 - a. Include only information relating to the above license application.
 - b. Include only information you have personally witnessed or seen.
 - c. Provide concise and relevant information detailing how this business has affected or may affect the peaceful enjoyment of your neighborhood.
 - d. If by the time you have the opportunity to testify, the information you wish to share has already been provided to the committee, you may state that you agree with the previous testimony. Redundant or repetitive testimony will not assist the committee in making its recommendation.
7. After giving your testimony, the members of the Licenses Committee and the licensee may ask questions regarding the testimony you have given or other factors relating to the license application.
8. Business Competition is not a valid basis for denial or non-renewal of a license.
Please Note: If you have submitted an objection to the above application your objection cannot be considered by the committee unless you personally testify at the hearing.

RESIDENT	MAIL ADDRESS	CITY AND ZIP CODE
CURRENT RESIDENT	2224 N BUFFUM ST	MILWAUKEE, WI 53212-3328
CURRENT RESIDENT	2224A N BUFFUM ST	MILWAUKEE, WI 53212-3328
CURRENT RESIDENT	2228 N BUFFUM ST	MILWAUKEE, WI 53212-3328
CURRENT RESIDENT	2232 N BUFFUM ST	MILWAUKEE, WI 53212-3328
CURRENT RESIDENT	2241 N BUFFUM ST	MILWAUKEE, WI 53212-3327
CURRENT RESIDENT	2244 N BUFFUM ST	MILWAUKEE, WI 53212-3328
CURRENT RESIDENT	2305 N BUFFUM ST	MILWAUKEE, WI 53212-3305
CURRENT RESIDENT	2307 N BUFFUM ST	MILWAUKEE, WI 53212-3305
CURRENT RESIDENT	2308 N BUFFUM ST	MILWAUKEE, WI 53212-3306
CURRENT RESIDENT	2311 N BUFFUM ST	MILWAUKEE, WI 53212-3305
CURRENT RESIDENT	2313 N HOLTON ST	MILWAUKEE, WI 53212-3355
CURRENT RESIDENT	2313A N HOLTON ST	MILWAUKEE, WI 53212-3355
CURRENT RESIDENT	2313B N HOLTON ST	MILWAUKEE, WI 53212-3355
CURRENT RESIDENT	2320 N BUFFUM ST	MILWAUKEE, WI 53212-3306
CURRENT RESIDENT	2320A N BUFFUM ST	MILWAUKEE, WI 53212-3306
CURRENT RESIDENT	2321 N BUFFUM ST	MILWAUKEE, WI 53212-3305
CURRENT RESIDENT	2321A N BUFFUM ST	MILWAUKEE, WI 53212-3305
CURRENT RESIDENT	2322 N BUFFUM ST	MILWAUKEE, WI 53212-3306
CURRENT RESIDENT	2323 N HOLTON ST	MILWAUKEE, WI 53212-3355
CURRENT RESIDENT	2324 N BUFFUM ST	MILWAUKEE, WI 53212-3306
CURRENT RESIDENT	2324A N BUFFUM ST	MILWAUKEE, WI 53212-3306
CURRENT RESIDENT	2326 N BUFFUM ST	MILWAUKEE, WI 53212-3306
CURRENT RESIDENT	2327 N BUFFUM ST	MILWAUKEE, WI 53212-3305
CURRENT RESIDENT	2327A N BUFFUM ST	MILWAUKEE, WI 53212-3305
CURRENT RESIDENT	2334 N BUFFUM ST	MILWAUKEE, WI 53212-3306
CURRENT RESIDENT	2337 N HOLTON ST	MILWAUKEE, WI 53212-3355
CURRENT RESIDENT	2339 N BUFFUM ST	MILWAUKEE, WI 53212-3305
CURRENT RESIDENT	2339 N HOLTON ST	MILWAUKEE, WI 53212-3355
CURRENT RESIDENT	2339A N BUFFUM ST	MILWAUKEE, WI 53212-3305
CURRENT RESIDENT	2339B N BUFFUM ST	MILWAUKEE, WI 53212-3305
CURRENT RESIDENT	338 E NORTH AVE	MILWAUKEE, WI 53212-3318

Total Records: 32

Radius: 250.0 feet and Center of Circle: 408 E North AV

2014-2015 Plan of Operation for 408 E NORTH AV

1. Litter and Noise

How are the grounds kept clean? Sweep Pressure Wash Pick Up Litter Other: _____

How often will grounds be cleaned? Daily Weekly Other: _____

Grounds Cleaned By: Licensee Building Owner Employees Hired Maintenance Other: _____

How are noise issues prevented and/or addressed? Security Manager approaches customer(s) Call Police
 Signs Posted Other: _____

2. Smoking and Sanitation

Are there designated outdoor smoking areas? No Yes
 If yes, describe the area(s) and provide location(s): Side of Building in gate

Number of Garbage Cans: Inside: 5 Locations: 1 in each bathroom and 4 in open
 Outside: 2 Locations: Side of Building

Is a Crowd Control Barrier used? No Yes If yes, describe: _____

Describe sanitation facilities (restrooms): 1 man 1 woman

Provide name of solid waste contractor: None

3. Security

Are there parking spaces on the premises? No Yes If yes, number of spaces: _____ and describe security provisions: _____

Are there designated loading areas? No Yes If yes, describe security provisions _____

Do you have security personnel on the premise? No Yes If yes, how many? _____

AND What are their responsibilities? _____
 What security equipment do they use? _____
 List their licensing, certification or training credentials: _____

Are there security cameras? No Yes If yes, list all locations: 6 inside 2 outside

Are searches and/or identification checks conducted upon entry? No Yes If yes, describe: at the door by Manager or bartender

4. Percentage of Sales (must total 100%)

Alcohol <u>100</u> %	Food Sales _____ %	Entertainment _____ %	Other _____ %
----------------------	--------------------	-----------------------	---------------

5. Businesses On The Premise (choose all that apply):

- | | | | |
|--|--|--|---|
| <input type="checkbox"/> Full Service Restaurant | <input type="checkbox"/> Cafe/Coffee Shop | <input type="checkbox"/> Deli or Fast Food Rest. | <input type="checkbox"/> Private/Fraternal/Veterans' Club |
| <input type="checkbox"/> Night Club | <input checked="" type="checkbox"/> Tavern | <input type="checkbox"/> Cocktail Lounge | <input type="checkbox"/> Teen Club |
| <input type="checkbox"/> Bowling Alley | <input type="checkbox"/> Hotel | <input type="checkbox"/> Banquet Hall | <input type="checkbox"/> Sports Facility |
| <input type="checkbox"/> Liquor Store | <input type="checkbox"/> Corner Store | <input type="checkbox"/> Supermarket | <input type="checkbox"/> Convenience Store |
| <input type="checkbox"/> Gas Station | <input type="checkbox"/> Other _____ | | |

6. Hours of Operation and Age Restriction

Are there any changes to the current hours of operation or age restriction? No Yes If yes, describe _____

Please Note: If you will be open earlier or later than the hours listed on your current license for even one event or holiday (for example, St. Patrick's Day, Brewers Opening Day, etc.) during the license period, this must be reported and printed on your license. Your hours of operation and age restriction are listed on your current license.

7. Floor Plan

Are there any changes to the current floor plan? No Yes If yes, describe _____

AND submit a new floor plan with this application. Changes in floor plan include changing the location of tables, games, etc. within your current licensed premises. If your changes include adding any additional areas or square footage to your premises, or any renovations to the building will be done, a Permanent Extension of Premises application must be filed.

(1) CURRENT ENTERTAINMENT

The following types of entertainment have been approved for your current Public Entertainment Premises license: Bands, Dancing by Performer(s), Instrumental Musicians, Disc Jockey, Poetry Readings, Patron Contests, Patrons Dancing, Jukebox, Karaoke, Comedy Acts, 1 Amusement Machine, 1 Pool Table

(2) SELECT ANY TYPES OF ENTERTAINMENT THAT YOU ARE REQUESTING TO ADD *No changes in entertainment shall take place until approved by the Common Council and a new license has been issued and posted on the premises.

Grid of checkboxes for entertainment types: Instrumental Musicians, Bands, Battle of the Bands, Comedy Acts, Disc Jockey, Magic Shows, Poetry Readings, Dancing by Performers, Jukebox, Wrestling, Patron Contests, Patrons Dancing, Adult Entertainment/Strippers/Erotic Dance, Karaoke, Bowling Alley, Pool Tables, Motion Pictures, Amusement Machines, Concerts, Theatrical Performances. Includes 'How many?' and 'Approx. # per year?' fields.

(3) REMOVE ENTERTAINMENT

If applicable, list any entertainment you wish to remove:

(4) WILL PROMOTERS EVER BE USED FOR ANY OF THE ENTERTAINMENT?

Yes/No selection: [X] No [] Yes, describe:

(5) LEGAL CAPACITY OF PREMISES

60 (Call the Milwaukee Development Center at 414-286-8211 if you have questions.) Your legal capacity will determine the license fee for your Public Entertainment Premise License. If you would like to request that the license be approved with a lower capacity than that listed above, indicate lower capacity. If approved, this lower capacity will print on your license and override the capacity listed on your Occupancy Permit.

(6) IDENTIFY IF SOUND AMPLIFICATION IS USED

Yes/No selection: [] No [X] Yes, describe: by DJs and bands

(7) DECLARATIONS, ACKNOWLEDGEMENTS, & DISCLOSURES

Read And Initial Each Item Confirming Your Understanding:

- 1 KH I understand that after the license has been issued, a change to the plan of operation will require a written request to change and approval from the Common Council.
2 KH I agree to inform the City Clerk within 10 days of any substantial changes in the information supplied in this application.
3 KH I understand that I shall not willfully refuse to provide the services offered under this license, or add charges or require deposits not required of the general public because of race, color, sex, religion, national origin or ancestry, age, handicap, lawful source of income, marital status, sexual orientation, gender identity or expression, familial status or the fact that a person is now or has been a member of the military service, whether dressed in uniform or not; and shall not seek such information as a condition of employment, or penalize any employee or discriminate in the selection of personnel for training or promotion on the basis of such information.
4 KH I have knowledge of the City Ordinances currently regulating public entertainment, and understand that the license may be subject to suspension, non-renewal or revocation, if I violate any rule, law or regulation of the city of Milwaukee and State of Wisconsin.
5 KH I request that my Public Entertainment Premises License Application be held subject to the processing and review requirements of the other licenses for which I am applying. I, therefore, waive the requirement of the Milwaukee Code of Ordinances Section 108-5-1b requiring that the Common Council grant or deny my Public Entertainment Premises License Application within 60 days of certification. (If you do not wish to waive this requirement, you must complete the Public Entertainment Premises Waiver Exemption Form (ccl-pepxmpt) and submit it with this application.)

(9) NOTARIZED SIGNATURES OF APPLICANT

SUBSCRIBED AND SWORN TO BEFORE ME

This 10th day of March, 2015

Signature: David Harris

(Clerk/Notary Public)

My Commission Expires 2/19/17

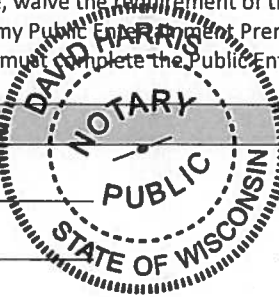

Signature of Agent/Owner/Partner

Agent/Owner/Partner

Additional Owner/Partner

*Notary Seal must be affixed.



CITY OF MILWAUKEE
OFFICE OF THE CITY CLERK

Thursday, March 26, 2015

COMMITTEE MEETING NOTICE

AD 06

KAUR, Kamal, Agent
Atkinson Gas Mart LLC
808 W Atkinson Av

Milwaukee, WI 53206

You are requested to attend a hearing which is to be held in Room 301-B, Third Floor, City Hall on:

Monday, April 06, 2015 at 02:00 PM

Regarding: Your Extended Hours Establishments Renewal Application as agent for "Atkinson Gas Mart LLC" for "Atkinson Gas Mart" at 808 W Atkinson Av.

There is a possibility that your application may be denied for one or more of the following reasons: The recommendation of the committee regarding the application shall be based on evidence presented at the hearing. Per MCO 85-4-4, unless otherwise specified in the code, probative evidence concerning non-renewal, suspension or revocation may include evidence of the following: failure of the applicant to meet municipal qualifications, pending charges against or the conviction of any felony, misdemeanor, municipal offense or other offense, the circumstances of which substantially relate to the circumstances of the particular licensed or permitted activity, by the applicant or by any employee or other agent of the applicant. If the activities of the applicant involve a licensed premises, whether the premises tends to facilitate a public or private nuisance or has been the source of congregations of persons which have resulted in any of the following: disturbance of the peace; illegal drug activity; public drunkenness; drinking in public; harassment of passers-by; gambling; prostitution; sale of stolen goods; public urination; theft; assaults; battery; acts of vandalism including graffiti, excessive littering, loitering, illegal parking, loud noise at times when the licensed premise is open for business; traffic violations; curfew violations; lewd conduct; display of materials harmful to minors, pursuant to s. 106-9.6; or any other factor which reasonably relates to the public health, safety and welfare, or failure to comply with the approved plan of operation. See attached police report or correspondence.

Notice for applicants with warrants or unpaid fines:

Proof of warrant satisfaction or payment of fines must be submitted at the hearing on the above date and time. Failure to comply with this requirement may result in a delay of the granting/denial of your application.

Failure to appear at this meeting may result in the denial of your license. Individual applicants must appear only in person or by an attorney. Corporate or Limited Liability applicants must appear only by the agent designated on the application or by an attorney. Partnership applicants must appear by a partner listed on the application or by an attorney. If you wish to do so and at your own expense, you may be accompanied by an attorney of your choosing to represent you at this hearing.

You will be given an opportunity to speak on behalf of the application and to respond and challenge any charges or reasons given for the denial. No petitions can be accepted by the committee, unless the people who signed the petition are present at the committee hearing and willing to testify. You may present witnesses under oath and you may also confront and cross-examine opposing witnesses under oath. If you have difficulty with the English language, you should bring an interpreter with you, at your expense, so that you can answer questions and participate in your hearing.

You may examine the application file at this office during regular business hours prior to the hearing date. Inquiries regarding this matter may be directed to the person whose signature appears below.

Limited parking for persons attending meetings in City Hall is available at reduced rates (5 hour limit) at the Milwaukee Center on the southwest corner of East Kilbourn and North Water Street. Parking tickets must be validated in the first floor information booth in City Hall.

PLEASE NOTE: Upon reasonable notice, efforts will be made to accommodate the needs of disabled individuals through sign language interpreters or other auxiliary aids. For additional information or to request this service, contact the Council Services Division ADA Coordinator at (414) 286-2998, Fax - (414) 286-3456, TDD - (414) 286-2025.

JIM OWCZARSKI, CITY CLERK

BY:

Jason Schunk
License Division Manager

If you have questions regarding this notice, please contact the License Division at (414) 286-2238.

200 E. Wells Street, Room 105, City Hall, Milwaukee, WI 53202. www.milwaukee.gov/license
Phone: (414) 286-2238 Fax: (414) 286-3057 Email Address: License@milwaukee.gov

MILWAUKEE POLICE DEPARTMENT LICENSING

CRIMINAL RECORD/ORDINANCE VIOLATION/INCIDENTS SYNOPSIS

DATE: 02/25/15

LICENSE TYPE: EXTENDED HRS

No. 205289

NEW:

Application Date:

RENEWAL:

License Location: 808 W Atkinson Avenue

Business Name: Atkinson Gas

Licensee/Applicant: Kaur, Kamal
(Last Name, First Name, MI)

Date of Birth: 10/28/87

Home Address: 305 N 166th Street

City: Brookfield

State: WI **Zip Code:** 53005

Home Phone:

This report is written by Police Officer KUKOWSKI, assigned to the License Investigation Unit, Days.

The Milwaukee Police Department's investigation regarding this application revealed the following:

1. On 07/19/14, Milwaukee police were working the WINS Tobacco Initiative and had a student under the age of 18 enter 808 W Atkinson Avenue in attempts to purchase tobacco products. The clerk, identified as Kiranjeet Sagar, sold the student two Swisher Sweets cigars for \$1.00. Sagar admitted to the sale and states she usually checks ID's 90% of time. Sohinder Singh was cited for this violation.

As to Sohinder Singh:

Charge: Sale of Cigarettes to Minor/Underage
Finding: Guilty
Sentence: Fined \$260.00
Date: 09/05/14
Case: 14054184

MILWAUKEE POLICE DEPARTMENT
REPORT OF INCIDENTS INVOLVING LICENSED PERSONS OR PREMISES

TO: Regina M. HOWARD

Business Name: Save Your Way gas station
Address of Licensed Premises: 808 W. Atkinson Ave.
Business Phone: 414-562-1682

District: 5

Type of License: Tobacco 24HR

[X] Violation / [] Incident #

Date of Incident: 07/19/14

Licensee or Manager on premises at time of violation / Incident? [] Yes [X] No

Licensee cooperative? [X] Yes [] No (if no, explain in narrative section)

Licensee Notified by Officer: P.O. Dean DRAJKOWSKI

Date: 07/19/14

Time: 1115

Licensee or Agent's Name: SINGH, Sohinder
Home Address: 305 N. 166th St.

Date of Birth: 10-25-79
Home Phone: 414-562-1682

Co-Licensee Name:
Home Address:
Class S License Number:

Date of Birth:
Home Phone:

Bartender Name:
Home Address:
Class D License Number:

Date of Birth:
Home Phone:

Licensed Person / Public Pass. Vehicle, etc.:
Home Address:
Class D License Number:

Date of Birth:
Home Phone:

VIOLATION/INCIDENT - DESCRIBE FACTS AND CIRCUMSTANCES IN NARRATIVE SECTION

Name of Person Cited: SINGH, Sohinder
Citation Number: 48970711044

Violation & Ord. / Statue No.: 106-30-2-a Tobacco

Date of Birth: 10-25-79
Court Date: 09/05/14

Name of Person Cited:
Citation Number:

Violation & Ord. / Statue No.:

Date of Birth:
Court Date:

Name of Person Cited:
Citation Number:

Violation & Ord. / Statue No.:

Date of Birth:
Court Date:

Name of Person Cited:
Citation Number:

Violation & Ord. / Statue No.:

Date of Birth:
Court Date:

Name of Person Cited:
Citation Number:

Violation & Ord. / Statue No.:

Date of Birth:
Court Date:

Investigating Officer: P.O. Dean DRAJKOWSKI

District / Bureau: 27

Date: 07/19/14

[Signature]
Commanding Officer

7-29-14
Date

DISPOSITION - FOR LICENSING ONLY

Table with 5 columns: Citation No., Case Number, Disposition, Judge, Date. Includes rows for 'LICENSE INVESTIGATION UNIT', 'Received', and 'Referred' with signatures.

This report was written by P.O. Dean DRAJKOWSKI assigned to the License Unit day shift.

On Saturday, July 19, 2014, I was assigned to the Wisconsin WINS Youth Tobacco Initiative, which checks area vendors for age compliance tobacco purchases. I was working with Xavier T. ASHFORD, B/M, 04-07-97, of 618 W. Locust St., phone #262-617-1811, who is 17 years old and not of legal age to purchase tobacco. A photo of ASHFORD was taken at the beginning of the assignment for identification.

At about 11:15 AM, ASHFORD entered the Save Your Way gas station located at 808 W. Atkinson Ave. and purchased two Swisher Sweets cigars for \$1.00. ASHFORD provided a description of the cashier that sold him the tobacco. I entered the store and identified the cashier as Kiranjeet K. SAGAR, A/F, 12-16-77. SAGAR first denied selling ASHFORD tobacco. SAGAR then stated she didn't remember if she checked his id. SAGAR stated she usually checks id 90% of the time and also apologized.

The licensee for the Save Your Way gas station was Sohinder SINGH, A/M, 10-25-79. SINGH was responsible for his employee who sold tobacco to ASHFORD. SINGH was issued a citation for adult sell tobacco to person under 18.

Cooney, James

From:
Sent: Tuesday, February 10, 2015 9:58 AM
To: License
Subject: Fwd: Gas Station at 808 west Atkinson ,Save your way

----- Forwarded message -----

From:
Date: Mon, Feb 9, 2015 at 12:50 PM
Subject: Gas Station at 808 west Atkinson ,Save your way
To: License@millwaukee.gov

this gas station is a Public Nuisance , there is Drug Deals , Prostitution going on 24hrs a day Loud Music in the early hours of the morning !!! the patrons of the gas station arc constantly using the bathroom on the side of my house because they dont have or offer them the use of a bathroom , all summer the gas station had 2 couches in the back of their property where bums and crack heads were sleeping I had 2 board up my back gate 2 stop them from using my backyard as a bathroom people were having sex on the couches all summer call the police , complain to my Alderman !!! PLEASE I need some HELP I feel like a Prisoner in my own Home !!



Thursday, March 26, 2015



Notice of Public Hearing

KAUR, Kamal, Agent
Atkinson Gas Mart at 808 W Atkinson Av
Extended Hours Establishments Renewal Application

Monday, April 06, 2015 at 2:00 PM

To whom it may concern:

The above application has been made by the above named applicant(s). This requires approval from the Licenses Committee and the Common Council of the City of Milwaukee. The hearing before the Licenses Committee will take place on 4/6/2015 at 2:00 PM, in Room 301-B, Third Floor, City Hall. If you wish, you may provide testimony at the hearing regarding the request; see below for further information. You are not required to attend the hearing. Once the Licenses Committee makes its recommendation, this recommendation is forwarded to the full Common Council for approval at its next regularly scheduled hearing. Please review the information below and if you have further questions regarding this process, please contact the License Division at (414) 286-2238.

Important details for those wishing to provide information for the Licenses Committee to consider when making its recommendation:

1. The license application is scheduled to be heard at the above time. Due to other hearings running longer than scheduled, you may have to wait some time to provide your testimony.
2. You must appear in person and testify as to matters that you have personally experienced or seen. (You cannot provide testimony for your neighbor, parent or anyone else; this is considered hearsay and cannot be considered by the committee.)
3. No letters or petitions can be accepted by the committee (unless the person who wrote the letter or the persons who signed the petition are present at the committee hearing and willing to testify).
4. Persons opposed to the license application are given the opportunity to testify first; supporters may testify after the opponents have finished.
5. When you are called to testify, you will be sworn in and asked to give your name, and address. (If your first and/or last names are uncommon please spell them.)
6. You may then provide testimony.
 - a. Include only information relating to the above license application.
 - b. Include only information you have personally witnessed or seen.
 - c. Provide concise and relevant information detailing how this business has affected or may affect the peaceful enjoyment of your neighborhood.
 - d. If by the time you have the opportunity to testify, the information you wish to share has already been provided to the committee, you may state that you agree with the previous testimony. Redundant or repetitive testimony will not assist the committee in making its recommendation.
7. After giving your testimony, the members of the Licenses Committee and the licensee may ask questions regarding the testimony you have given or other factors relating to the license application.
8. Business Competition is not a valid basis for denial or non-renewal of a license.
Please Note: If you have submitted an objection to the above application your objection cannot be considered by the committee unless you personally testify at the hearing.

RESIDENT	MAIL ADDRESS	CITY AND ZIP CODE
CURRENT RESIDENT	3535 N 8TH ST	MILWAUKEE, WI 53206-3301
CURRENT RESIDENT	3550 N 9TH ST	MILWAUKEE, WI 53206-3305
CURRENT RESIDENT	3559 N 9TH ST	MILWAUKEE, WI 53206-3306
CURRENT RESIDENT	3560 N 9TH ST	MILWAUKEE, WI 53206-3305
CURRENT RESIDENT	3567 N 9TH ST	MILWAUKEE, WI 53206-3306
CURRENT RESIDENT	3568 N 9TH ST	MILWAUKEE, WI 53206-3305
CURRENT RESIDENT	3608 N 9TH ST	MILWAUKEE, WI 53206-3307
CURRENT RESIDENT	3610 N 9TH ST	MILWAUKEE, WI 53206-3307
CURRENT RESIDENT	3614 N 9TH ST	MILWAUKEE, WI 53206-3307
CURRENT RESIDENT	3614A N 9TH ST	MILWAUKEE, WI 53206-3307
CURRENT RESIDENT	3618 N 9TH ST	MILWAUKEE, WI 53206-3307
CURRENT RESIDENT	3620 N 9TH ST	MILWAUKEE, WI 53206-3307
CURRENT RESIDENT	3624 N 9TH ST	MILWAUKEE, WI 53206-3307
CURRENT RESIDENT	3626 N 9TH ST	MILWAUKEE, WI 53206-3307
CURRENT RESIDENT	3628 N 9TH ST	MILWAUKEE, WI 53206-3307
CURRENT RESIDENT	3629 N 8TH ST	MILWAUKEE, WI 53206-3302
CURRENT RESIDENT	3632 N 9TH ST	MILWAUKEE, WI 53206-3307
CURRENT RESIDENT	3633 N 8TH ST	MILWAUKEE, WI 53206-3302
CURRENT RESIDENT	3633A N 8TH ST	MILWAUKEE, WI 53206-3302
CURRENT RESIDENT	3634 N 9TH ST	MILWAUKEE, WI 53206-3307
CURRENT RESIDENT	3634A N 9TH ST	MILWAUKEE, WI 53206-3307
CURRENT RESIDENT	3635 N 8TH ST	MILWAUKEE, WI 53206-3302
CURRENT RESIDENT	3641 N 8TH ST	MILWAUKEE, WI 53206-3302
CURRENT RESIDENT	3643 N 8TH ST	MILWAUKEE, WI 53206-3302
CURRENT RESIDENT	3649 N 8TH ST	MILWAUKEE, WI 53206-3302
CURRENT RESIDENT	3649A N 8TH ST	MILWAUKEE, WI 53206-3302
CURRENT RESIDENT	835 W ATKINSON AVE	MILWAUKEE, WI 53206-3323
CURRENT RESIDENT	835A W ATKINSON AVE	MILWAUKEE, WI 53206-3323
CURRENT RESIDENT	836 W ATKINSON AVE	MILWAUKEE, WI 53206-3322

Total Records: 30

Radius: 250.0 feet and Center of Circle: 808 W Atkinson AV



**EXTENDED HOURS ESTABLISHMENT
RENEWAL LICENSE SUPPLEMENTAL
APPLICATION & PLAN OF OPERATION**

Office of the City Clerk License Division
200 E. Wells St. Room 105, Milwaukee, WI 53202
(414) 286-2238 email address: license@milwaukee.gov www.milwaukee.gov/license

Current License # **24HRS 197354 Atkinson Gas Mart LLC 808 W ATKINSON AV**

PRORATED RENEWAL FEE = \$ \$131.25

Align to expire on **12/5/2015** with **Cigarette & Tobacco License**

SECTION I LICENSES, OCCUPANCY & PARKING

What type of business is operated at this location? (check all that apply) Convenience Store Filling Station
 Personal Service Establishment Recording Studio Restaurant, Sit-Down Restaurant, Fast-Food/Carry Out

What other types of licenses or permits do you, or will you, hold at this location? (check all that apply)

Occupancy Permit Gas Station Cigarette Food Class "B" Tavern Other: _____

RESTAURANTS ONLY:

Legal Occupancy Limit/Capacity ▶ N/A

RESTAURANTS & PERSONAL SERVICE ESTABLISHMENTS ONLY:

Number of Off-Street Parking Places ▶ N/A

SECTION II HOURS OF OPERATION

Are there any changes to the current hours of operation (as listed on your current license) or number of customers expected each day? NO If NO, skip this section and go to Section III

YES If YES, provide all proposed operating hours below. If closed on a certain day of the week, write "closed."

Check here if proposed change of hours of operation is to be applied to a Food License

DAY OF THE WEEK	Opening Time (include AM/PM)	Closing Time (include AM/PM)	Number of customers expected each day
Sunday			
Monday			
Tuesday			
Wednesday			
Thursday			
Friday			
Saturday			

SECTION III PLANS FOR SECURITY, LITTER & NOISE

How is security provided at the premise?

Security Cameras Alarm System Other: _____

Who is responsible for keeping the grounds clean of litter and debris?

Licensee Building Owner Employees Hired Maintenance Other: _____

How are the grounds kept clean of litter and debris?

Sweep Pressure Wash Pick Up Litter Garbage Cans Outside Other: _____

How often are the grounds cleaned of litter and debris? Daily Weekly Other: _____

How are noise issues prevented or addressed?

Security Call police Signs posted Manager approaches customer(s) Other: _____

I agree to have all licenses I hold at this location aligned to expire on the same day.

X Ramal Kaw
Signature of Licensee

COMPLETE REVERSE SIDE ---->



CITY OF MILWAUKEE
OFFICE OF THE CITY CLERK

Thursday, March 26, 2015

COMMITTEE MEETING NOTICE

AD 06

WILLIE M NASH

333 E Keefe Av

Milwaukee, WI 53212

You are requested to attend a hearing which is to be held in Room 301-B, Third Floor, City Hall on:

Monday, April 06, 2015 at 02:00 PM

Regarding: Your Class B Tavern and Public Entertainment Premises License Renewal Applications Adding 1 Pool Table for "Mae's Circle Lounge" at 333 E Keefe Av.

There is a possibility that your application may be denied for  more of the following reasons: The recommendation of the committee regarding the application shall be based on evidence presented at the hearing. Per MCO 85-4-4, unless otherwise specified in the code, probative evidence concerning non-renewal, suspension or revocation may include evidence of the following: failure of the applicant to meet municipal qualifications, pending charges against or the conviction of any felony, misdemeanor, municipal offense or other offense, the circumstances of which substantially relate to the circumstances of the particular licensed or permitted activity, by the applicant or by any employee or other agent of the applicant. If the activities of the applicant involve a licensed premises, whether the premises tends to facilitate a public or private nuisance or has been the source of congregations of persons which have resulted in any of the following: disturbance of the peace; illegal drug activity; public drunkenness; drinking in public; harassment of passers-by; gambling; prostitution; sale of stolen goods; public urination; theft; assaults; battery; acts of vandalism including graffiti, excessive littering, loitering, illegal parking, loud noise at times when the licensed premise is open for business; traffic violations; curfew violations; lewd conduct; display of materials harmful to minors, pursuant to s. 106-9.6; or any other factor which reasonably relates to the public health, safety and welfare, or failure to comply with the approved plan of operation. See attached police report or correspondence.

Notice for applicants with warrants or unpaid fines:

Proof of warrant satisfaction or payment of fines must be submitted at the hearing on the above date and time. Failure to comply with this requirement may result in a delay of the granting/denial of your application.

Failure to appear at this meeting may result in the denial of your license. Individual applicants must appear only in person or by an attorney. Corporate or Limited Liability applicants must appear only by the agent designated on the application or by an attorney. Partnership applicants must appear by a partner listed on the application or by an attorney. If you wish to do so and at your own expense, you may be accompanied by an attorney of your choosing to represent you at this hearing.

You will be given an opportunity to speak on behalf of the application and to respond and challenge any charges or reasons given for the denial. No petitions can be accepted by the committee, unless the people who signed the petition are present at the committee hearing and willing to testify. You may present witnesses under oath and you may also confront and cross-examine opposing witnesses under oath. If you have difficulty with the English language, you should bring an interpreter with you, at your expense, so that you can answer questions and participate in your hearing.

You may examine the application file at this office during regular business hours prior to the hearing date. Inquiries regarding this matter may be directed to the person whose signature appears below.

Limited parking for persons attending meetings in City Hall is available at reduced rates (5 hour limit) at the Milwaukee Center on the southwest corner of East Kilbourn and North Water Street. Parking tickets must be validated in the first floor information booth in City Hall.

PLEASE NOTE: Upon reasonable notice, efforts will be made to accommodate the needs of disabled individuals through sign language interpreters or other auxiliary aids. For additional information or to request this service, contact the Council Services Division ADA Coordinator at (414) 286-2998, Fax - (414) 286-3456, TDD - (414) 286-2025.

JIM OWZARSKI, CITY CLERK

BY:

Jason Schunk
License Division Manager

If you have questions regarding this notice, please contact the License Division at (414) 286-2238.

200 E. Wells Street, Room 105, City Hall, Milwaukee, WI 53202. www.milwaukee.gov/license
Phone: (414) 286-2238 Fax: (414) 286-3057 Email Address: License@milwaukee.gov



Thursday, March 26, 2015



Notice of Public Hearing

NASH, Willie M
Mae's Circle Lounge at 333 E Keefe Av
Class B Tavern and Public Entertainment Premises License Renewal Applications Adding 1 Pool
Table

Monday, April 06, 2015 at 2:00 PM

To whom it may concern:

The above application has been made by the above named applicant(s). This requires approval from the Licenses Committee and the Common Council of the City of Milwaukee. The hearing before the Licenses Committee will take place on 4/6/2015 at 2:00 PM, in Room 301-B, Third Floor, City Hall. If you wish, you may provide testimony at the hearing regarding the request; see below for further information. You are not required to attend the hearing. Once the Licenses Committee makes its recommendation, this recommendation is forwarded to the full Common Council for approval at its next regularly scheduled hearing. Please review the information below and if you have further questions regarding this process, please contact the License Division at (414) 286-2238.

Important details for those wishing to provide information for the Licenses Committee to consider when making its recommendation:

1. The license application is scheduled to be heard at the above time. Due to other hearings running longer than scheduled, you may have to wait some time to provide your testimony.
2. You must appear in person and testify as to matters that you have personally experienced or seen. (You cannot provide testimony for your neighbor, parent or anyone else; this is considered hearsay and cannot be considered by the committee.)
3. No letters or petitions can be accepted by the committee (unless the person who wrote the letter or the persons who signed the petition are present at the committee hearing and willing to testify).
4. Persons opposed to the license application are given the opportunity to testify first; supporters may testify after the opponents have finished.
5. When you are called to testify, you will be sworn in and asked to give your name, and address. (If your first and/or last names are uncommon please spell them.)
6. You may then provide testimony.
 - a. Include only information relating to the above license application.
 - b. Include only information you have personally witnessed or seen.
 - c. Provide concise and relevant information detailing how this business has affected or may affect the peaceful enjoyment of your neighborhood.
 - d. If by the time you have the opportunity to testify, the information you wish to share has already been provided to the committee, you may state that you agree with the previous testimony. Redundant or repetitive testimony will not assist the committee in making its recommendation.
7. After giving your testimony, the members of the Licenses Committee and the licensee may ask questions regarding the testimony you have given or other factors relating to the license application.
8. Business Competition is not a valid basis for denial or non-renewal of a license.
Please Note: If you have submitted an objection to the above application your objection cannot be considered by the committee unless you personally testify at the hearing.

RESIDENT	MAIL ADDRESS	CITY AND ZIP CODE
CURRENT RESIDENT	3440 N RICHARDS ST	MILWAUKEE, WI 53212-1642
CURRENT RESIDENT	3444 N RICHARDS ST	MILWAUKEE, WI 53212-1642
CURRENT RESIDENT	3448 N RICHARDS ST	MILWAUKEE, WI 53212-1642
CURRENT RESIDENT	3448A N RICHARDS ST	MILWAUKEE, WI 53212-1642
CURRENT RESIDENT	3449 N HOLTON ST	MILWAUKEE, WI 53212-1653
CURRENT RESIDENT	3449A N HOLTON ST	MILWAUKEE, WI 53212-1653
CURRENT RESIDENT	3450 N RICHARDS ST	MILWAUKEE, WI 53212-1642
CURRENT RESIDENT	3462 N RICHARDS ST	MILWAUKEE, WI 53212-1642
CURRENT RESIDENT	3462A N RICHARDS ST	MILWAUKEE, WI 53212-1642
CURRENT RESIDENT	3468 N RICHARDS ST	MILWAUKEE, WI 53212-1642
CURRENT RESIDENT	3470 N RICHARDS ST	MILWAUKEE, WI 53212-1642
CURRENT RESIDENT	3472 N RICHARDS ST	MILWAUKEE, WI 53212-1642
CURRENT RESIDENT	3475 N BUFFUM ST	MILWAUKEE, WI 53212-1649
CURRENT RESIDENT	405 E KEEFE AVE	MILWAUKEE, WI 53212-1609
CURRENT RESIDENT	409 E KEEFE AVE	MILWAUKEE, WI 53212-1609
CURRENT RESIDENT	409A E KEEFE AVE	MILWAUKEE, WI 53212-1609
CURRENT RESIDENT	417 E KEEFE AVE	MILWAUKEE, WI 53212-1609
CURRENT RESIDENT	421 E KEEFE AVE	MILWAUKEE, WI 53212-1609
CURRENT RESIDENT	425 E KEEFE AVE	MILWAUKEE, WI 53212-1609
CURRENT RESIDENT	425 E KEEFE AVE A	MILWAUKEE, WI 53212-1609

Total Records: 21

Radius: 250.0 feet and Center of Circle: 333 E Keefe AV

2014-2015 Plan of Operation for 333 E KEEFE AV

1. Litter and Noise

How are the grounds kept clean? Sweep Pressure Wash Pick Up Litter Other: _____

How often will grounds be cleaned? Daily Weekly Other: AS NEEDED

Grounds Cleaned By: Licensee Building Owner Employees Hired Maintenance Other: _____

How are noise issues prevented and/or addressed? Security Manager approaches customer(s) Call Police
 Signs Posted Other: WILL CALL POLICE IF NEEDED

2. Smoking and Sanitation

Are there designated outdoor smoking areas? No Yes
 If yes, describe the area(s) and provide location(s): WALK TO REAR OF BUILDING

Number of Garbage Cans: Inside: 3 Locations: FRONT OF BAR - REAR - WASH SINK
 Outside: 1 Locations: DUMPSTER REAR OF BUILDING

Is a Crowd Control Barrier used? No Yes If yes, describe: FOLLOW CAPACITY LAW

Describe sanitation facilities (restrooms): MENS ROOM TOILET/URINAL WOMENS TOILET

Provide name of solid waste contractor: TO GO DISPOSAL

3. Security

Are there parking spaces on the premises? No Yes If yes, number of spaces: _____ and describe security provisions:
STREET PARKING BOTH SIDES OF STREET

Are there designated loading areas? No Yes If yes, describe security provisions: KEEFE FRONT - REAR BUILDING

Do you have security personnel on the premise? No Yes If yes, how many? _____

AND What are their responsibilities? N/A
 What security equipment do they use? N/A
 List their licensing, certification or training credentials: N/A

Are there security cameras? No Yes If yes, list all locations: KEEFE FRONT, REAR OF BUILDING - INSIDE FRONT DOOR

Are searches and/or identification checks conducted upon entry? No Yes If yes, describe: LICENSEE CHECKS UPON ENTRY IF NEEDED

4. Percentage of Sales (must total 100%)

Alcohol <u>100</u> %	Food Sales <u>0</u> %	Entertainment <u>0</u> %	Other <u>0</u> %
----------------------	-----------------------	--------------------------	------------------

5. Businesses On The Premise (choose all that apply):

<input type="checkbox"/> Full Service Restaurant	<input type="checkbox"/> Cafe/Coffee Shop	<input type="checkbox"/> Deli or Fast Food Rest.	<input type="checkbox"/> Private/Fraternal/Veterans' Club
<input type="checkbox"/> Night Club	<input checked="" type="checkbox"/> Tavern	<input type="checkbox"/> Cocktail Lounge	<input type="checkbox"/> Teen Club
<input type="checkbox"/> Bowling Alley	<input type="checkbox"/> Hotel	<input type="checkbox"/> Banquet Hall	<input type="checkbox"/> Sports Facility
<input type="checkbox"/> Liquor Store	<input type="checkbox"/> Corner Store	<input type="checkbox"/> Supermarket	<input type="checkbox"/> Convenience Store
<input type="checkbox"/> Gas Station	<input type="checkbox"/> Other _____		

6. Hours of Operation and Age Restriction

Are there any changes to the current hours of operation or age restriction? No Yes If yes, describe _____

Please Note: If you will be open earlier or later than the hours listed on your current license for even one event or holiday (for example, St. Patrick's Day, Brewers Opening Day, etc.) during the license period, this must be reported and printed on your license. Your hours of operation and age restriction are listed on your current license.

7. Floor Plan

Are there any changes to the current floor plan? No Yes If yes, describe _____

AND submit a new floor plan with this application. Changes in floor plan include changing the location of tables, games, etc. within your current licensed premises. If your changes include adding any additional areas or square footage to your premises, or any renovations to the building will be done, a Permanent Extension of Premises application must be filed.

(1) CURRENT ENTERTAINMENT

The following types of entertainment have been approved for your current Public Entertainment Premises license:
Jukebox, 3 Amusement Machines

(2) SELECT ANY TYPES OF ENTERTAINMENT THAT YOU ARE REQUESTING TO ADD *No changes in entertainment shall take place until approved by the Common Council and a new license has been issued and posted on the premises.

- Instrumental Musicians, Bands, Battle of the Bands, Comedy Acts, Disc Jockey, Magic Shows, Poetry Readings, Dancing by Performers, Jukebox, Wrestling, Patron Contests, Patrons Dancing, Adult Entertainment/ Strippers/Erotic Dance, Karaoke, Bowling Alley, Pool Tables, Motion Pictures, Amusement Machines - Concerts, Theatrical Performances. Includes fields for 'How many screens?' and 'Approx. # per year?' for various categories.

(3) REMOVE ENTERTAINMENT

If applicable, list any entertainment you wish to remove:

(4) WILL PROMOTERS EVER BE USED FOR ANY OF THE ENTERTAINMENT?

[X] No [] Yes, describe:

(5) LEGAL CAPACITY OF PREMISES

68 (Call the Milwaukee Development Center at 414-286-8211 if you have questions.) Your legal capacity will determine the license fee for your Public Entertainment Premise License. If you would like to request that the license be approved with a lower capacity than that listed above, indicate lower capacity. If approved, this lower capacity will print on your license and override the capacity listed on your Occupancy Permit.

(6) IDENTIFY IF SOUND AMPLIFICATION IS USED

[X] No [] Yes, describe:

(7) DECLARATIONS, ACKNOWLEDGEMENTS, & DISCLOSURES

Read And Initial Each Item Confirming Your Understanding:

- 1 WMD I understand that after the license has been issued, a change to the plan of operation will require a written request to change and approval from the Common Council.
2 WMD I agree to inform the City Clerk within 10 days of any substantial changes in the information supplied in this application.
3 WMD I understand that I shall not willfully refuse to provide the services offered under this license, or add charges or require deposits not required of the general public because of race, color, sex, religion, national origin or ancestry, age, handicap, lawful source of income, marital status, sexual orientation, gender identity or expression, familial status or the fact that a person is now or has been a member of the military service, whether dressed in uniform or not; and shall not seek such information as a condition of employment, or penalize any employee or discriminate in the selection of personnel for training or promotion on the basis of such information.
4 WMD I have knowledge of the City Ordinances currently regulating public entertainment, and understand that the license may be subject to suspension, non-renewal or revocation, if I violate any rule, law or regulation of the city of Milwaukee and State of Wisconsin.
5 WMD I request that my Public Entertainment Premises License Application be held subject to the processing and review requirements of the other licenses for which I am applying. I, therefore, waive the requirement of the Milwaukee Code of Ordinances Section 108-5-1b requiring that the Common Council grant or deny my Public Entertainment Premises License Application within 60 days of certification. (If you do not wish to waive this requirement, you must complete the Public Entertainment Premises Waiver Exemption Form (ccl-pepxmpt) and submit it with this application.)

(9) NOTARIZED SIGNATURES OF APPLICANTS

SUBSCRIBED AND SWORN TO BEFORE ME

This 25th day of February, 20

David Harris

(Clerk/Notary Public)

My Commission Expires 2/19/17

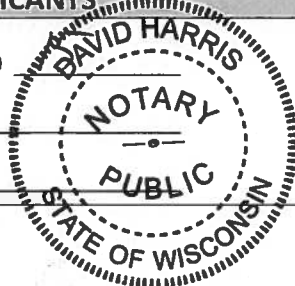

William MacNash

Agent/Owner/Partner

Additional Owner/Partner

*Notary Seal must be affixed.



**CITY OF MILWAUKEE
OFFICE OF THE CITY CLERK**

Friday, March 27, 2015

COMMITTEE MEETING NOTICE

AD 06

SINGH, Sukhdev, Agent
Chamber East Food Market LLC
200 E Chambers St

Milwaukee, WI 53212

You are requested to attend a hearing which is to be held in Room 301-B, Third Floor, City Hall on:

Monday, April 06, 2015 at 02:00 PM

Regarding: Your Class A Fermented Malt Beverage Retailer's License and Food Dealer Application as agent for "Chamber East Food Market LLC" for "Chamber East Food" at 200 E Chambers St.

There is a possibility that your application may be denied for one or more of the following reasons: The recommendation of the committee regarding the application shall be based on evidence presented at the hearing. Per MCO 85-2.7-4, probative evidence concerning whether or not a new license should be granted may be presented on the following subjects: whether or not the applicant meets the municipal requirements, the appropriateness of the location and premises where the licensed premises is to be located and whether use of the premises for the purposes or activities permitted by the license would tend to facilitate a public or private nuisance or create undesirable neighborhood problems such as disorderly patrons, unreasonably loud noise, litter, and excessive traffic and parking congestion. Probative evidence relating to these matters may be taken from the plan of operation submitted with the license application, if any, but shall not include the content of any music. Evidence regarding the fitness of the location of the premises to be maintained as the principal place of business, including but not limited to whether there is an overconcentration of businesses of the type for which the license is sought; whether the proposal is consistent with any pertinent neighborhood business or development plans, or the location's proximity to areas where children are typically present. The applicant's record in operating similarly licensed premises; and whether or not the applicant has been charged with or convicted of any felony, misdemeanor, municipal offense or other offense, the circumstances of which substantially relate to the activity to be permitted by the license being applied for or any other factor which reasonably relates to the public health, safety or welfare may also be considered. See attached police report or correspondence. Possible denial because: This proposed location is in an area that has previously been found by the Common Council to be over concentrated with alcohol outlets. Attached is the concentration of alcohol beverage outlets in the area map existing at the time of the determination of the over concentration based on an address of 109 E Burleigh. The Licenses Committee will consider concentration of alcohol beverage outlets as one question regarding the suitability of this location to be licensed as an alcohol beverage establishment. You may present evidence supporting your application. One issue that evidence should address is whether the licensure of this location is appropriate in light of the concentration of alcohol beverage outlets.

Notice for applicants with warrants or unpaid fines:

Proof of warrant satisfaction or payment of fines must be submitted at the hearing on the above date and time. Failure to comply with this requirement may result in a delay of the granting/denial of your application.

Failure to appear at this meeting may result in the denial of your license. Individual applicants must appear only in person or by an attorney. Corporate or Limited Liability applicants must appear only by the agent designated on the application or by an attorney. Partnership applicants must appear by a partner listed on the application or by an attorney. If you wish to do so and at your own expense, you may be accompanied by an attorney of your choosing to represent you at this hearing.

You will be given an opportunity to speak on behalf of the application and to respond and challenge any charges or reasons given for the denial. No petitions can be accepted by the committee, unless the people who signed the petition are present at the committee hearing and willing to testify. You may present witnesses under oath and you may also confront and cross-examine opposing witnesses under oath. If you have difficulty with the English language, you should bring an interpreter with you, at your expense, so that you can answer questions and participate in your hearing.

You may examine the application file at this office during regular business hours prior to the hearing date. Inquiries regarding this matter may be directed to the person whose signature appears below.

Limited parking for persons attending meetings in City Hall is available at reduced rates (5 hour limit) at the Milwaukee Center on the southwest corner of East Kilbourn and North Water Street. Parking tickets must be validated in the first floor information booth in City Hall.

PLEASE NOTE: Upon reasonable notice, efforts will be made to accommodate the needs of disabled individuals through sign language interpreters or other auxiliary aids. For additional information or to request this service, contact the Council Services Division ADA Coordinator at (414) 286-2998, Fax - (414) 286-3456, TDD - (414) 286-2025.

JIM OWZARSKI, CITY CLERK

BY:

Jason Schunk

License Division Manager

If you have questions regarding this notice, please contact the License Division at (414) 286-2238.

200 E. Wells Street, Room 105, City Hall, Milwaukee, WI 53202. www.milwaukee.gov/license
Phone: (414) 286-2238 Fax: (414) 286-3057 Email Address: License@milwaukee.gov



CITY OF MILWAUKEE
OFFICE OF THE CITY CLERK

Friday, March 27, 2015

COMMITTEE MEETING NOTICE

AD 06

SINGH, Sukhdev, Agent
Chamber East Food Market LLC
731 N 25th St #106

Milwaukee, WI 53233

You are requested to attend a hearing which is to be held in Room 301-B, Third Floor, City Hall on:

Monday, April 06, 2015 at 02:00 PM

Regarding: Your Class A Fermented Malt Beverage Retailer's License and Food Dealer Application as agent for "Chamber East Food Market LLC" for "Chamber East Food" at 200 E Chambers St.

There is a possibility that your application may be denied for one or more of the following reasons: The recommendation of the committee regarding the application shall be based on evidence presented at the hearing. Per MCO 85-2.7-4, probative evidence concerning whether or not a new license should be granted may be presented on the following subjects: whether or not the applicant meets the municipal requirements, the appropriateness of the location and premises where the licensed premises is to be located and whether use of the premises for the purposes or activities permitted by the license would tend to facilitate a public or private nuisance or create undesirable neighborhood problems such as disorderly patrons, unreasonably loud noise, litter, and excessive traffic and parking congestion. Probative evidence relating to these matters may be taken from the plan of operation submitted with the license application, if any, but shall not include the content of any music. Evidence regarding the fitness of the location of the premises to be maintained as the principal place of business, including but not limited to whether there is an overconcentration of businesses of the type for which the license is sought; whether the proposal is consistent with any pertinent neighborhood business or development plans, or the location's proximity to areas where children are typically present. The applicant's record in operating similarly licensed premises; and whether or not the applicant has been charged with or convicted of any felony, misdemeanor, municipal offense or other offense, the circumstances of which substantially relate to the activity to be permitted by the license being applied for or any other factor which reasonably relates to the public health, safety or welfare may also be considered. See attached police report or correspondence. Possible denial because: This proposed location is in an area that has previously been found by the Common Council to be over concentrated with alcohol outlets. Attached is the concentration of alcohol beverage outlets in the area map existing at the time of the determination of the over concentration based on an address of 109 E Burleigh. The Licenses Committee will consider concentration of alcohol beverage outlets as one question regarding the suitability of this location to be licensed as an alcohol beverage establishment. You may present evidence supporting your application. One issue that evidence should address is whether the licensure of this location is appropriate in light of the concentration of alcohol beverage outlets.

Notice for applicants with warrants or unpaid fines:

Proof of warrant satisfaction or payment of fines must be submitted at the hearing on the above date and time. Failure to comply with this requirement may result in a delay of the granting/denial of your application.

Failure to appear at this meeting may result in the denial of your license. Individual applicants must appear only in person or by an attorney. Corporate or Limited Liability applicants must appear only by the agent designated on the application or by an attorney. Partnership applicants must appear by a partner listed on the application or by an attorney. If you wish to do so and at your own expense, you may be accompanied by an attorney of your choosing to represent you at this hearing.

You will be given an opportunity to speak on behalf of the application and to respond and challenge any charges or reasons given for the denial. No petitions can be accepted by the committee, unless the people who signed the petition are present at the committee hearing and willing to testify. You may present witnesses under oath and you may also confront and cross-examine opposing witnesses under oath. If you have difficulty with the English language, you should bring an interpreter with you, at your expense, so that you can answer questions and participate in your hearing.

You may examine the application file at this office during regular business hours prior to the hearing date. Inquiries regarding this matter may be directed to the person whose signature appears below.

Limited parking for persons attending meetings in City Hall is available at reduced rates (5 hour limit) at the Milwaukee Center on the southwest corner of East Kilbourn and North Water Street. Parking tickets must be validated in the first floor information booth in City Hall.

PLEASE NOTE: Upon reasonable notice, efforts will be made to accommodate the needs of disabled individuals through sign language interpreters or other auxiliary aids. For additional information or to request this service, contact the Council Services Division ADA Coordinator at (414) 286-2998, Fax - (414) 286-3456, TDD - (414) 286-2025.

JIM OWCZARSKI, CITY CLERK

BY:

Jason Schunk

License Division Manager

If you have questions regarding this notice, please contact the License Division at (414) 286-2238.

200 E. Wells Street, Room 105, City Hall, Milwaukee, WI 53202. www.milwaukee.gov/license
Phone: (414) 286-2238 Fax: (414) 286-3057 Email Address: License@milwaukee.gov

Date: 03/11/2015
Officer: L. Lammers

City of Milwaukee Police Department
90-5-1.5 Crime Prevention Survey
Convenience Store/Liquor Store Inspection

Name of Premise: Chambers Food Market
Address: 200 E. Chambers St.
Phone: 414-263-1847

Owner: Charan Singh
Owner address: 200 E Chambers St
City State Zip: Milwaukee, WI 53212
Owner Phone:
Owner email:

Manager: Sukhdev Singh
Home Address: 731 N. 25th St. #106
City, State Zip: Milwaukee, WI 53233
Phone: 414-236-2862
Email:

Preferred contact: 414-263-1847 or Sukhdev at 414-236-2862

Location currently open: x YES NO

Projected open date:

Day's open: S M T W Th F SA x ALL

Hours of Operation: Sun: 8 am - 9 pm 24 hours Y x N
 Mon: 8 am - 9 pm
 Tue: 8 am - 9 pm
 Wed: 8 am - 9 pm
 Thu: 8 am - 9 pm
 Fri: 8 am - 9 pm
 Sat: 8 am - 9pm

Premise Type: Liquor Store
 x Convenience Store
 Other:

Licenses currently held:

- Alcohol: Yes x No Class: #:
Tobacco: Yes x No #:
Food: Yes x No #:
Extended Hours: Yes x No #:
Secondhand Dealer: Yes x No Type: #:
Other: Yes x No Type: #:
Other: Yes x No Type: #:

Exterior Survey:

1. Is the area around the location clean? x Yes No
2. What surrounds the location? (Check all the apply)
 - a. Park
 - b. School
 - c. Youth Center
 - d. Church
 - e. Tavern(s) If so, how many
 - f. x Residential
 - g. x Other businesses – possible day care
 - h. Other:
3. Can you see from the outside of the location into the interior x Yes No
4. Can you see the employees inside of the location from the outside x Yes No
5. Are exterior windows free of signage Yes x No
6. Is there a parking lot Yes x No
7. Is the parking lot clean? Yes No
8. Is the parking lot well lit? Yes No
9. Are there areas where a person could conceal themselves Yes x No
10. Is there exterior lighting? x Yes No. Does it appears to be adequate Yes No
11. Exterior Payphone? Yes x No
12. Are there No Loitering Signs posted? x Yes No
13. Are there exterior security cameras x Yes No How Many: 4
14. Are the address numbers prominently displayed and easy to see x Yes No

Camera Survey:

15. Does this location have security cameras? x Yes No
16. Are they in working order? x Yes No
17. What format are the cameras?
 - a. Color x Yes No
 - b. Digital x Yes No
 - c. VCR Yes x No
 - d. Recorded x Yes No
18. How long is footage stored for later viewing: one week
19. Are there exterior cameras x Yes No How many: 4
20. Are there interior cameras x Yes No How many: 8
21. Do all employees know how to retrieve recorded digital images/footage? Yes x No

Interior Survey:

- 22. Is the storcowner willing to be a standing complainant regarding loitering? xYes No
 - a. If yes have them fill out the standing complaint form and give them two of the commercial signs Yes xNo
- 23. Is the interior of the location neat and clean? xYes No
- 24. Does an interior camera face the entrance/exit? xYes No
- 25. Is there a lockable area that separates employecs from customers? xYes No
- 26. Does the store sell single chore boy? Yes xNo
- 27. Does the store sell blunt wraps? xYes No
- 28. Does the store sell scales? Yes xNo
- 29. Does the store sell items that may be used as crack pipes? Yes xNo
 - a. Describe item N/A
- 30. Does the store have an over abundance of sandwich baggies: Yes xNo
- 31. Does the owner understand that these items are often used for drug use?x Yes No
- 32. Do the products in the store appear to be new and rotated often?x Yes No
- 33. Are emergency and non-emergency numbers posted near the phone? Yes xNo
- 34. Does the owner know how to contact their police district directly? xYes No
 - a. Did you provide a district contact guide to the owner? xYes No

Complete this section if alcohol establishment is a convenience store:

(** Read full ordinance for all details "68-55 Convenience Food Stores")

All convenience food stores not exempted under sub. 3 shall:

- 1. Is the cash register located in a manner so that at the time of a sales transaction, the employee and customer are both visible from the sidewalk? xYes No **
- 2. Are the glass entrance and exit doors clear of any signs or advertisements with the exception of a sign which states that the cash register contains \$50 or less and that the safe is no accessible to employees? xYes No
- 3. Does the store maintain one of the following on the licensed premise:
 - a. A safe that was in use at the convenience food store on August 17, 1994? Yes xNo
 - b. A drop-safe or time release safe that weighs at least 500 pounds or which is attached to or set into the floor in a manner approved by the police department? xYes No
- 4. Is lighting provided for the store's parking area during all hours of darkness when employees or customers are on the premises at a minimum average of 2-foot candles per square foot, unless the store is not open for business after sunset and before sunrise? Yes No xN/A
- 5. Are at least two high-resolution surveillance security cameras installed? xYes No
- 6. Are the security cameras in working order? xYes No
- 7. Does one camera show an overall view of the counter and register area? xYes No
- 8. Does one camera show a clear, identifiable, full frame image of the face of each person entering and leaving the store? xYes No
- 9. Are the camera views obstructed by fixtures or displays? Yes xNo
- 10. Is the recorded footage stored for at least 30 days? Yes xNo

11. Do all store employees know how to record footage from the camera system to media capable of being transferred to police custody? Yes x No
12. Are customer entrances/exits made of glass or other transparent material? x Yes No
 a. Exception: A store that does not have such doors on August 17, 1994 shall not be required to install such doors until the holder of the store's food dealer license changes.
13. Has the owner and their employees attended the Robbery Prevention Training within 120 days of ownership or employment? Yes x No
 a. Contact Community Outreach and Education at 935-7836 for schedule.

Sub 3. Exemptions. The requirements of this section do not apply to a convenience food store that conforms to either of the following descriptions:

- a-1. The store is located in an enclosed shopping structure, enclosed commercial building or hospital. A convenience food store is not in an enclosed structure or building if a customer can enter it directly from the outside.
 Does store conform to a-1 Yes x No
- a-2 The store physically separates employees from customers with a solid partition that bars a person from entering the employee area from the customer area, has a secure lock on the employee side of any door between the employee area and the customer, and conducts all transaction through a service window or similar arrangement.
 Does store conform to a-2 x Yes No
- a. At the commissioner's discretion, a convenience store may be exempted from any or all of the regulations specified in sub 2.
 Does this location hold an exemption from the commissioner regarding any of the requirements of Sub 2? Yes x No

ADDITIONAL COMMENTS/RECOMMENDATIONS:

Other on site manager – Kulwinder Singh, 811 W Grange Ave #102, Milwaukee, WI 53221

Store is open 7 days a week, from 8 am – 9pm

The new applicant, Sukhdev, does not hold any other licenses at this time

The store is primarily surrounded by residences. At 2979 N. Palmer, looks like this could be a day care, My Children's Learning Academy. Unsure if this is an open business at this time.

You can see clearly into and out of the business through the main entrance door. The two windows to the business, which are both on the south side of the building, are blocked by product and signage. The door that encloses the cash register area, also has signage on it. I did recommend that they reduce that signage to increase visibility.

Parking is on street only.

I did not observe any exterior lighting other than the street lights. So I would suggest adding lighting to both the south side and west side of the building.

They currently do have no loitering signs posted.

The address numbers need to be posted. I did observe the address numbers for 202 E. Chambers St. but not for 200.

The camera system is quite good. There are 8 interior cameras and 4 exterior cameras. The cameras footage is shown in color and recorded on a DVR type system. As of now, the footage is only stored for a one week time period. So that could be improved upon. All employees do not know how to access the footage, so that also could be improved. The cameras are placed well, and cover the entrance, the cash register area, and other areas inside and outside of the store.

The interior was very neat and clean. Product did look faced and well rotated. There is a food prep counter at the back of the store along the north wall with a food cooler. The prepared food was covered, and separated neatly. The sink and counter areas appeared very clean.

I did observe that the store does sell blunt wrappers, but they are behind the counter in the employee enclosure and off to the side so they are not in the main area where children would see them. I did not see any other items being sold that could be used as drug paraphernalia.

Mr. Sukhdev Singh has not yet attended the Robbery Prevention Training. I did provide him with the phone number to obtain information on when the next classes will be held.

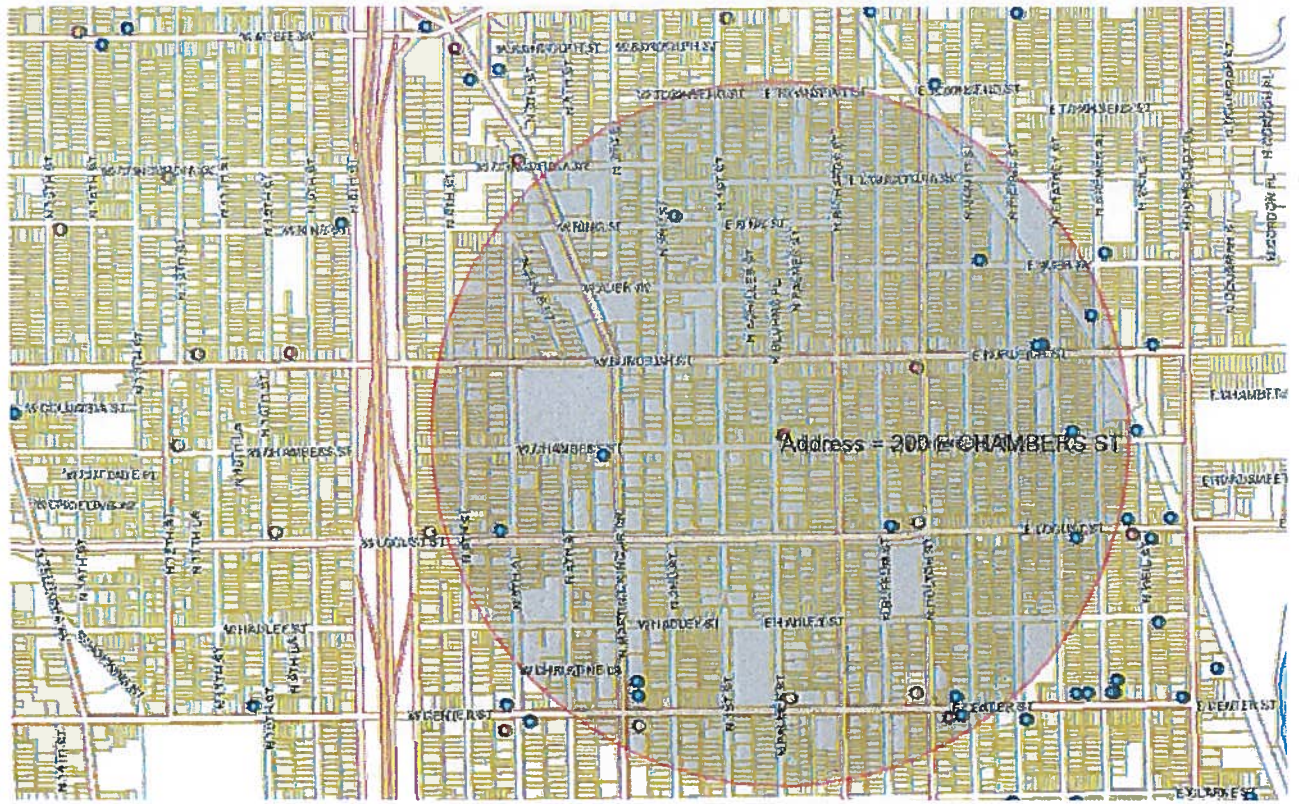

Licensed Alcohol Beverage Establishments within a .5 Mile Radius Centered on 200 E. Chambers Street, 2/11/2014

Legal entity	Trade name	Licensee	Address	License type name	Total capacity	Room capacity	Expiration date
	License Summary	Total					
	Class A Fermented Malt Beverage Retailer's License				5		
	Class A Malt & Class A Liquor License				2		
	Class B Tavern License				14		
	Grand Total				21		
Chamber Street Food, Inc.	Chambers Food Mart	Charan Singh, Agt	200 E Chambers ST	Class A Fermented Malt Beverage Retailer's License			11/26/2015
Freedom Grocery LLC	Freedom Grocery	SAED A NABHAN, Agt	2909 N Holton ST	Class A Fermented Malt Beverage Retailer's License			1/20/2016
Loves Supermarket II LLC	Loves Supermarket	HARJINDER S BRAICH, Agt	418 E CENTER ST	Class A Fermented Malt Beverage Retailer's License			11/26/2015
Palmer Street Food inc	Palmer Street Food	Baljit Kaur, Agt	200 E Center ST	Class A Fermented Malt Beverage Retailer's License			6/2/2015
PATIALA, INC	L'I GENERAL	PARMINDER S SEKHON, Agt	233 W CENTER ST	Class A Fermented Malt Beverage Retailer's License			1/16/2016
Center Street Liquor Store Inc	Center Street Liquor Store	Charanjit Kaur, Agt	513 E Center ST	Class A Malt & Class A Liquor License			12/16/2015
INDERPRI CORPORATION	CORNER LIQUOR II	AMANDEEP K DHINDSA, Agt	3079 N HOLTON ST	Class A Malt & Class A Liquor License			10/6/2015
ACD PRODUCTION INC	TWO	DONALD R KRAUSE, Agt	718 E BURLEIGH ST	Class B Tavern License	25		10/6/2015
ACD PRODUCTION, INC	ART BAR CAFE & GALLERY	DONALD R KRAUSE, Agt	722 E BURLEIGH ST	Class B Tavern License	80		12/18/2015
Best Friends Clubhouse, LLC	Best Friendz Klubhouse	PAULA J GRIFFIN-GASTON, Agt	2722 N Martin L King Jr DR	Class B Tavern License	160		7/29/2015
CAFE CORAZON INC	CAFE CORAZON	GEORGE MIRELES, Agt	3129 N BREMEN ST	Class B Tavern License	49	Interior capacity = 49, outdoor patio capacity = 20	
DINO'S DISTRIBUTING, LTD	Dino's Riverwest	NANCY M LOCCO, Agt	808 E CHAMBERS ST	Class B Tavern License			7/23/2015
GLASS SLIPPER	GLASS SLIPPER	JIMMY D JORDAN, SP	3250 N 2ND ST	Class B Tavern License	80		12/20/2015
G-MAN	G-MAN	LESLIE Y HODGES, SP	2979 N MARTIN L KING JR DR	Class B Tavern License	100		11/13/2015
KISMAYO, LLC	CLUB TIMBUKTU	YOUSSEUF KOMARA, Agt	520 E CENTER ST	Class B Tavern License	160		12/20/2015
LIL WIL'S TAP	LIL WIL'S TAP	Lori Liddell, SP	3200 N BOOTH ST	Class B Tavern License	25		1/23/2016
REDHEAD, INC	SAVOY'S	DIANA L CONDON, Agt	2901 N 5TH ST	Class B Tavern License	160		7/24/2015
Riverwest Public House Cooperative	Riverwest Public House Cooperative	Gene T Gallistel, Agt	815 E LOCUST ST	Class B Tavern License	80		2/28/2015
STEFF'S BAR AND LOUNGE	STEFF'S BAR AND LOUNGE	ARLISA L GEE, SP	400 E LOCUST ST	Class B Tavern License	67		1/21/2016
THE MAD PLANET, INC	THE MAD PLANET	ROSEMARY S SILAGY, Agt	533 E CENTER ST	Class B Tavern License	299		6/30/2015
TJ's	TJ's	THOMAS J HOLMES, SP	2712 N MARTIN L KING JR DR	Class B Tavern License			9/22/2015

**LICENSED ALCOHOL BEVERAGE ESTABLISHMENTS
WITHIN A HALF MILE RADIUS CENTERED ON
109 E Burleigh ST Milwaukee WI 53212, November 14, 2013**

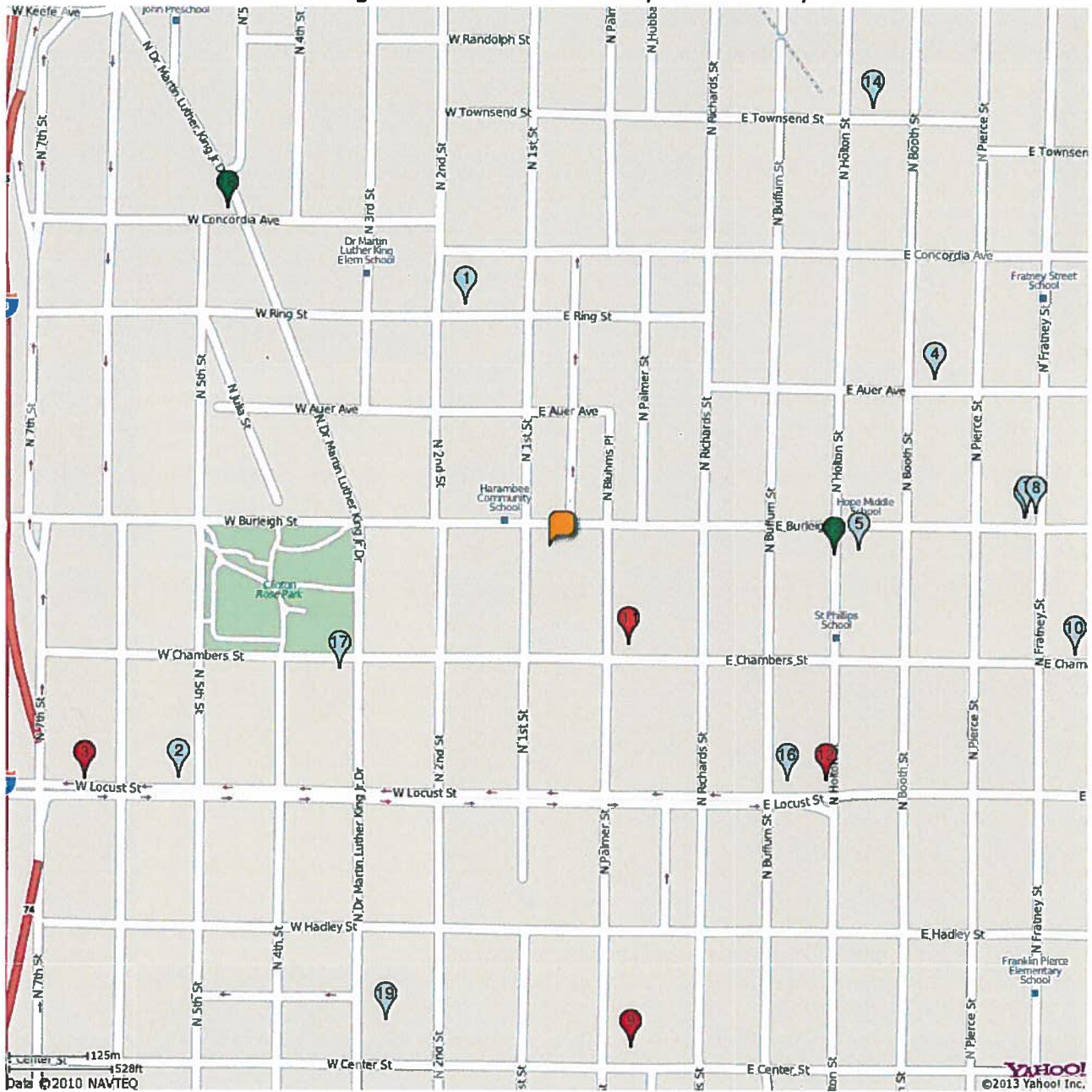

LICENSE SUMMARY	
 Class B Tavern License	- 12 LICENSES
 Class A Fermented Malt Beverage Retailer's License	- 5 LICENSES
 Class A Malt & Class A Liquor License	- 2 LICENSES
TOTAL: 19 LICENSES	

**LICENSED ALCOHOL BEVERAGE ESTABLISHMENTS
WITHIN A HALF MILE RADIUS CENTERED ON
109 E Burleigh ST Milwaukee WI 53212, November 14, 2013**

License Summary:

BTAVN - Class B Tavern License - 12 LICENSES
 AMALT - Class A Fermented Malt Beverage Retailer's License - 5 LICENSES
 ALQML - Class A Malt & Class A Liquor License - 2 LICENSES

TOTAL: 19 LICENSES

<u>Premises Address</u>	<u>Establishment Name</u>	<u>Lic. Type</u>	<u>Exp. Date</u>
1. 3250 N 2ND St	GLASS SLIPPER	BTAVN	12/20/2013
2. 2901 N 5TH St	SAVOY'S	BTAVN	7/24/2014
3. 2900 N 7TH St	7TH STREET FOODS	AMALT	1/14/2014
4. 3200 N BOOTH St	LIL WIL'S TAP	BTAVN	1/23/2014
5. 501 E BURLEIGH St	DELONEY'S LOUNGE	BTAVN	6/30/2014
6. 718 E BURLEIGH St	TWO	BTAVN	10/6/2014
7. 722 E BURLEIGH St	ART BAR CAFE & GALLERY	BTAVN	12/18/2013
8. 732 E BURLEIGH St	WEST BANK CAFE	BTAVN	12/15/2013
9. 200 E CENTER St	PALMER CENTER FOODS	AMALT	9/24/2014
10. 808 E CHAMBERS St	Dino's Riverwest	BTAVN	7/23/2014
11. 200 E Chambers St	Chambers Food Mart	AMALT	11/26/2014
12. 2909 N HOLTON St	RIVERWEST SUPER FOODS	AMALT	1/26/2014
13. 3079 N HOLTON St	CORNER LIQUOR II	ALQML	10/6/2014
14. 3400 N HOLTON St	RET LOUNGE	BTAVN	6/18/2014
15. 103 E KEEFE Av	SUNSHINE FOOD MARKET	AMALT	7/12/2014
16. 400 E LOCUST St	STEFF'S BAR AND LOUNGE	BTAVN	1/19/2014
17. 2979 N MARTIN L KING JR DR	G-MAN	BTAVN	11/13/2014
18. 3305 N MARTIN L KING JR DR	GREEN RING II	ALQML	3/3/2014
19. 2722 N Martin L King Jr DR	Best Friendz Klubhouse	BTAVN	7/29/2014



Friday, March 27, 2015



Notice of Public Hearing

SINGH, Sukhdev, Agent
Chamber East Food at 200 E Chambers St
Class A Fermented Malt Beverage Retailer's License and Food Dealer Application

Monday, April 06, 2015 at 2:00 PM

To whom it may concern:

The above application has been made by the above named applicant(s). This requires approval from the Licenses Committee and the Common Council of the City of Milwaukee. The hearing before the Licenses Committee will take place on 4/6/2015 at 2:00 PM, in Room 301-B, Third Floor, City Hall. If you wish, you may provide testimony at the hearing regarding the request; see below for further information. You are not required to attend the hearing. Once the Licenses Committee makes its recommendation, this recommendation is forwarded to the full Common Council for approval at its next regularly scheduled hearing. Please review the information below and if you have further questions regarding this process, please contact the License Division at (414) 286-2238.

Important details for those wishing to provide information for the Licenses Committee to consider when making its recommendation:

1. The license application is scheduled to be heard at the above time. Due to other hearings running longer than scheduled, you may have to wait some time to provide your testimony.
2. You must appear in person and testify as to matters that you have personally experienced or seen. (You cannot provide testimony for your neighbor, parent or anyone else; this is considered hearsay and cannot be considered by the committee.)
3. No letters or petitions can be accepted by the committee (unless the person who wrote the letter or the persons who signed the petition are present at the committee hearing and willing to testify).
4. Persons opposed to the license application are given the opportunity to testify first; supporters may testify after the opponents have finished.
5. When you are called to testify, you will be sworn in and asked to give your name, and address. (If your first and/or last names are uncommon please spell them.)
6. You may then provide testimony.
 - a. Include only information relating to the above license application.
 - b. Include only information you have personally witnessed or seen.
 - c. Provide concise and relevant information detailing how this business has affected or may affect the peaceful enjoyment of your neighborhood.
 - d. If by the time you have the opportunity to testify, the information you wish to share has already been provided to the committee, you may state that you agree with the previous testimony. Redundant or repetitive testimony will not assist the committee in making its recommendation.
7. After giving your testimony, the members of the Licenses Committee and the licensee may ask questions regarding the testimony you have given or other factors relating to the license application.
8. Business Competition is not a valid basis for denial or non-renewal of a license.
Please Note: If you have submitted an objection to the above application your objection cannot be considered by the committee unless you personally testify at the hearing.

RESIDENT	MAIL ADDRESS	CITY AND ZIP CODE
CURRENT RESIDENT	131 E CHAMBERS ST	MILWAUKEE, WI 53212-2413
CURRENT RESIDENT	131A E CHAMBERS ST	MILWAUKEE, WI 53212-2413
CURRENT RESIDENT	138 E CHAMBERS ST	MILWAUKEE, WI 53212-2414
CURRENT RESIDENT	140 E CHAMBERS ST	MILWAUKEE, WI 53212-2414
CURRENT RESIDENT	202 E CHAMBERS ST	MILWAUKEE, WI 53212-2416
CURRENT RESIDENT	206 E CHAMBERS ST	MILWAUKEE, WI 53212-2416
CURRENT RESIDENT	209 E CHAMBERS ST	MILWAUKEE, WI 53212-2415
CURRENT RESIDENT	210 E CHAMBERS ST	MILWAUKEE, WI 53212-2416
CURRENT RESIDENT	214 E CHAMBERS ST	MILWAUKEE, WI 53212-2416
CURRENT RESIDENT	215 E CHAMBERS ST	MILWAUKEE, WI 53212-2415
CURRENT RESIDENT	215A E CHAMBERS ST	MILWAUKEE, WI 53212-2415
CURRENT RESIDENT	217 E CHAMBERS ST	MILWAUKEE, WI 53212-2415
CURRENT RESIDENT	219 E CHAMBERS ST	MILWAUKEE, WI 53212-2415
CURRENT RESIDENT	223 E CHAMBERS ST	MILWAUKEE, WI 53212-2415
CURRENT RESIDENT	223A E CHAMBERS ST	MILWAUKEE, WI 53212-2415
CURRENT RESIDENT	226 E CHAMBERS ST	MILWAUKEE, WI 53212-2416
CURRENT RESIDENT	230 E CHAMBERS ST	MILWAUKEE, WI 53212-2416
CURRENT RESIDENT	234 E CHAMBERS ST	MILWAUKEE, WI 53212-2416
CURRENT RESIDENT	2946 N PALMER ST	MILWAUKEE, WI 53212-2429
CURRENT RESIDENT	2955 N PALMER ST	MILWAUKEE, WI 53212-2428
CURRENT RESIDENT	2956 N PALMER ST	MILWAUKEE, WI 53212-2429
CURRENT RESIDENT	2956A N PALMER ST	MILWAUKEE, WI 53212-2429
CURRENT RESIDENT	2956B N PALMER ST	MILWAUKEE, WI 53212-2429
CURRENT RESIDENT	2956C N PALMER ST	MILWAUKEE, WI 53212-2429
CURRENT RESIDENT	2957 N PALMER ST	MILWAUKEE, WI 53212-2428
CURRENT RESIDENT	2957A N PALMER ST	MILWAUKEE, WI 53212-2428
CURRENT RESIDENT	2958 N PALMER ST	MILWAUKEE, WI 53212-2429
CURRENT RESIDENT	2960 N PALMER ST	MILWAUKEE, WI 53212-2429
CURRENT RESIDENT	2960A N PALMER ST	MILWAUKEE, WI 53212-2429
CURRENT RESIDENT	2961 N PALMER ST	MILWAUKEE, WI 53212-2428
CURRENT RESIDENT	3015 N PALMER ST	MILWAUKEE, WI 53212-2005
CURRENT RESIDENT	3018 N PALMER ST	MILWAUKEE, WI 53212-2006
CURRENT RESIDENT	3018A N PALMER ST	MILWAUKEE, WI 53212-2006
CURRENT RESIDENT	3020 N PALMER ST	MILWAUKEE, WI 53212-2006
CURRENT RESIDENT	3021 N PALMER ST	MILWAUKEE, WI 53212-2005
CURRENT RESIDENT	3022 N PALMER ST	MILWAUKEE, WI 53212-2006
CURRENT RESIDENT	3023 N PALMER ST	MILWAUKEE, WI 53212-2005
CURRENT RESIDENT	3025 N RICHARDS ST	MILWAUKEE, WI 53212-0000
CURRENT RESIDENT	3027 N PALMER ST	MILWAUKEE, WI 53212-2005
CURRENT RESIDENT	3027 N RICHARDS ST	MILWAUKEE, WI 53212-2155
CURRENT RESIDENT	3027A N PALMER ST	MILWAUKEE, WI 53212-2005
CURRENT RESIDENT	3027A N RICHARDS ST	MILWAUKEE, WI 53212-2155
CURRENT RESIDENT	3029 N RICHARDS ST	MILWAUKEE, WI 53212-2155
CURRENT RESIDENT	3030 N PALMER ST	MILWAUKEE, WI 53212-2006
CURRENT RESIDENT	3031 N RICHARDS ST	MILWAUKEE, WI 53212-2155
CURRENT RESIDENT	3032 N PALMER ST	MILWAUKEE, WI 53212-2006
CURRENT RESIDENT	3034 N PALMER ST	MILWAUKEE, WI 53212-2006
CURRENT RESIDENT	3035 N PALMER ST	MILWAUKEE, WI 53212-2005
CURRENT RESIDENT	3035A N PALMER ST	MILWAUKEE, WI 53212-2005
CURRENT RESIDENT	3036 N PALMER ST	MILWAUKEE, WI 53212-2006
CURRENT RESIDENT	3045 N RICHARDS ST	MILWAUKEE, WI 53212-2155
CURRENT RESIDENT	3049 N PALMER ST	MILWAUKEE, WI 53212-2005

Total Records: 53

Radius: 250.0 feet and Center of Circle: 200 E Chambers ST



Friday, March 27, 2015

Licenses Committee Notice of Hearing

Charan Singh
811 W Grange Av #102

Milwaukee, WI 53221

Date: 4/6/2015
Time: 02:00 PM
Location: Room 301-B, Third Floor, City Hall

The Licenses Committee will consider the following license application:

Class A Fermented Malt Beverage Retailer's License and Food Dealer Application
SINGH, Sukhdev, Agent
Chamber East Food at 200 E Chambers St

Please note this application may be recommended for denial based on fitness of the location due to concentration of alcohol beverage outlets in the area. If the application is denied for this reason, no other application for an alcohol beverage license for this location shall be recommended for approval by the Licenses Committee within three years of the date of denial unless the applicant has demonstrated a change of circumstances since the prior denial.

If you have any questions, please call (414) 286-2238.





Friday, March 27, 2015

Licenses Committee Notice of Hearing

Charan Singh
200 E Chambers St

Milwaukee, WI 53212

Date: 4/6/2015
Time: 02:00 PM
Location: Room 301-B, Third Floor, City Hall

The Licenses Committee will consider the following license application:

Class A Fermented Malt Beverage Retailer's License and Food Dealer Application
SINGH, Sukhdev, Agent
Chamber East Food at 200 E Chambers St

Please note this application may be recommended for denial based on fitness of the location due to concentration of alcohol beverage outlets in the area. If the application is denied for this reason, no other application for an alcohol beverage license for this location shall be recommended for approval by the Licenses Committee within three years of the date of denial unless the applicant has demonstrated a change of circumstances since the prior denial.

If you have any questions, please call (414) 286-2238.





ALCOHOL BEVERAGE & PUBLIC ENTERTAINMENT PREMISES SUPPLEMENTAL PLAN OF OPERATION

Office of the City Clerk License Division

200 E. Wells St. Room 105, Milwaukee, WI 53202

(414) 286-2238 e-mail address: license@milwaukee.gov www.milwaukee.gov/license

Legal Entity Name: CHAMBER EAST FOOD MARKET LLC

Premise Address: 200 E CHAMBER ST.

Proximity of Premises to Church, School, Daycare Center or Hospital

Is there at least 300 feet between the building and any church, school, daycare center or hospital? Yes No

Building & Business Information

- a) Property Owners Name: CHARAN SINGH Phone Number: 414-400-2846
Address: 811 W GRANGE AVE, #102 MILWAUKEE WI 53221
- b) Are you taking out this application for anyone that may not be eligible for a license? No Yes
If yes, list name and address: _____
- c) Will the agent, a partner or the individual licensee be conducting the day-to-day operations of the business? No Yes
If no, list the name and address of the person(s) who will: _____

Class B Applicants: If the agent, a partner or the individual licensee will not be conducting the day-to-day operations of the business, the person(s) listed above must obtain a Class B Managers license.

- d) Does anyone else have money invested or any other interest in this business? No Yes
If yes, explain: _____
- e) Have you made an agreement with anyone to repay any loan or any other payments based upon income from the business?
 No Yes If yes, list name and address: _____
- f) If applying for Class B or C license, are you applying for "Service Bar Only"? No Yes
Service Bar Only means customers cannot sit at the bar. Alcohol is served to patrons seated at tables. No stools, chairs or other articles of furniture shall be placed at the service bar for patrons to sit upon.

Proof of Ownership, Lease, or Offer to Purchase (new & transfer applicants only)

Submit proof of ownership, lease, or offer to purchase the building with this application.

A lease or offer to purchase must:

- Be in the same legal entity name as that apply for the license
- Reflect the same address as the premises address on this application
- Reflect current dates and
- Be signed by the lessor/seller and lease/buyer

Property Information (new & transfer applicants only)

- a) Do you own or lease the building? Own Lease
- b) Who owns the fixtures (for example, coolers, etc.)? Charan Singh
- c) Are you purchasing the stock and/or fixtures? No Yes If yes, amount paid \$ 30000
- d) Total amount paid for business \$ 30000
- e) Total amount paid for goodwill of the business \$ 30000

Goodwill comprises the reputation and customer relationships of an existing business. If the price you pay for the business exceeds the fair market value of all of the rest of the assets of the business, the excess may be considered goodwill.

- f) Have you made arrangements with the seller for payment of personal property taxes? No Yes

See Application Information for a list of all required application forms.

Lease Information (new & transfer applicants who are leasing the premises only)

- a) Date lease begins 02/01/2015 Ends 01/31/2020
- b) Monthly rental \$ 1800
- c) Do you have an option to renew the lease? No Yes
- d) Does your lease allow for assignment to another party without the consent of the owner? No Yes
- e) For what length of time have you been guaranteed occupancy (number of years)? 10 YRS
- f) In addition to paying the monthly rental, will you have to pay anything additional to the owner of the building to guarantee performance of the lease? No Yes If yes, explain _____
- g) Does the present owner or occupancy object to the granting of your license? No Yes
If yes, explain _____

Change of Agent Applicants Only

Have there been any changes to the floor plan since the last application was submitted? No Yes
If no, a new floor plan is not required. If yes, submit a new floor plan and explain the change(s): _____

Notarized Signatures of Applicants

SUBSCRIBED AND SWORN TO BEFORE ME

This 05 day of FEB

Amrit N. Patel

(Clerk/Notary Public)

My Commission Expires 12/06/2015

*Notary Seal must be affixed.

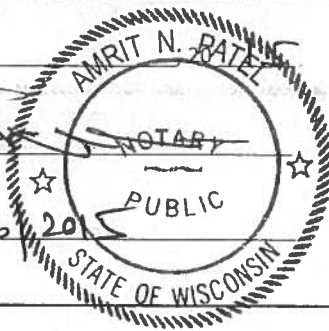

Sukhdev Singh

Sole Proprietor, Partner, 20% or more Shareholder, or Agent – only if there are no 20% or more shareholders

Additional partner or 20% or more shareholder

Note: All information contained in this application is subject to approval by the Common Council.
Deviating from approved plan of operation will subject licensee to citations, and/or suspension or non-renewal of the license.
Contact the License Division for information on how to request changes.

New and transfer of premise applicants must submit the following:

- Proof of ownership, lease or offer to purchase the building
- Detailed floor plan
- If a restaurant, copy of the menu



BUSINESS LICENSE PLAN OF OPERATION

ccl-busplan 12/8/14

Office of the City Clerk License Division
200 E. Wells St. Room 105, Milwaukee, WI 53202
(414) 286-2238 www.milwaukee.gov/license e-mail address: license@milwaukee.gov

1. Type of Business

Is this application for an Extended Hours Establishment License? No Yes

Provide a detailed description of the type of business you plan on operating:

Do you have any experience operating this type of business? No Yes

If yes, explain:

2. Business Operations

- a) Proposed Opening Date: 03/01/2015
- b) Is this premise under construction? No Yes If yes, list estimated completion date: _____
- c) Is this a franchise? No Yes
- d) Is this premises currently licensed? No Yes If yes, list type of license: FOOD | CIG | CLASS A BEER
- e) Is the current licensee operating? No Yes If no, list date closed: _____
- f) What other types of licenses/permits will you hold at this location? (check all that apply)
 - Occupancy Permit Cigarette & Tobacco Gas Station Extended Hours Class "B" Tavern Weights & Measures
 - Secondhand Dealer Precious Metal & Gem Other: _____
- g) Do you have future plans for other businesses, licenses or permits at this location? No Yes
If yes, explain: _____
- h) Have you previously held an Extended Hours License in Milwaukee? No Yes
If yes, list address(es): _____
- i) Are other businesses operating in the same building? No Yes If yes, describe: _____

3. Premises Description

- a) Identify all area(s) of the premises that will be used in operating this business (include areas used only for storage):
 - 1st Floor 2nd Floor Basement Storage Patio Beer Garden Sidewalk Café Deck Rooftop
 - Other: Describe: _____
- b) Describe Location: Major Thoroughfare Secondary Street Other: _____
- c) Nearest Major Cross Street: Palmer
- d) Describe Building: Free Standing Building Strip Mall Other: _____
- e) Describe Premises Structure: Single Story Multi-Story - # of Stories _____ Other: _____
- f) Describe Surrounding Area: Commercial Residential Industrial Other: _____
- g) Are there off-street parking places? No Yes If yes, how many? _____
- h) Property Owner's Name: CHARAN SINGH Phone Number: 414. 400-2846
Address: 811 W. GRAUSE AVE # 102 MILWAUKEE WI 53221

4. Businesses On The Premises (check all that apply):

Type 1

- | | | | |
|--|---|---|--|
| <input type="checkbox"/> Full Service Restaurant | <input type="checkbox"/> Cafe/Coffee Shop | <input type="checkbox"/> Deli or Fast Food Restaurant | <input type="checkbox"/> Private/Fraternal/Veterans Club |
| <input type="checkbox"/> Night Club | <input type="checkbox"/> Tavern | <input type="checkbox"/> Cocktail Lounge | <input type="checkbox"/> Teen Club |
| <input type="checkbox"/> Bowling Alley | <input type="checkbox"/> Hotel | <input type="checkbox"/> Banquet Hall | <input type="checkbox"/> Sports Facility |

Type 2

- | | | | |
|--|---|---|---|
| <input type="checkbox"/> Liquor Store | <input type="checkbox"/> Corner Store | <input type="checkbox"/> Supermarket | <input checked="" type="checkbox"/> Convenience Store |
| <input type="checkbox"/> Gas Station | <input type="checkbox"/> Amusement/Phonograph Distributor | <input type="checkbox"/> Auto Wrecker | |
| <input type="checkbox"/> Used Car Dealer | <input type="checkbox"/> Used Auto Parts | <input type="checkbox"/> Personal Service Establishment | <input type="checkbox"/> Recording Studio |

5. Legal Capacity (only if a Type 1 premises in #4 above) — N/A —

Capacity 25 (Call the Milwaukee Development Center at 414-286-8211 if you have questions.)

6. Percentage of Sales (must total 100%)

Alcohol <u>30</u> %	Cigarettes <u>30</u> %	Secondhand Merchandise <u>0</u> %	Precious Metals & Gems <u>0</u> %
Food <u>40</u> %	Entertainment <u>0</u> %		
Pawnbroker Activity <u>0</u> %	Salvaged Materials <u>0</u> % (such as scrap metal)	Other <u>0</u> % Describe: _____	

7. Litter and Noise Control

- a. How are grounds kept clean? Sweep Pressure Wash Pick Up Litter Other: _____
- b. How often will grounds be cleaned? Daily Weekly Other: _____
- c. Grounds cleaned by: Licensee Building Owner Employees Hired Maintenance Other: _____
- d. Number of Garbage Cans: Inside: 2 Locations: BY CASH REGISTER + IN BATHROOM
Outside: 1 Locations: BY FRONT DOOR
- e. Describe sanitation facilities (restrooms): one restroom
- f. Name of solid waste contractor: WASTE MANAGEMENT
- g. How are noise issues prevented and/or addressed? Security Manager approaches customer(s) Call Police
 Signs Posted Other: _____
- h. Will a sound amplification system be used? No Yes If yes, describe: _____

8. Security

- a. Will you have security personnel on premise? No Yes If yes, how many? _____
- What are their responsibilities? _____
- Is security equipment used? No Yes If yes, describe _____
- List their licensing, certification, or training credentials _____

- b. Will there be security cameras? No Yes If yes, where? MONITORS INSIDE / STORE SURROUNDINGS
- c. Will searches or identification checks be conducted upon entry? No Yes If yes, describe _____

9. Customers

- a. Will customers be entering the premises? No Yes
- b. Are there designated outdoor smoking areas? No Yes If yes, describe: _____
- c. Is a crowd control barrier used? No Yes If yes, describe: _____

10. Hours of Operation

Day of the Week	Proposed Hours of Operation:		Number of Customers expected each day	Potential Age Range of Customers	Class B Applicants: Age Restriction (If none, write 'None')
	Open (include a.m. or p.m.)	Close (include a.m. or p.m.)			
Sunday	8:00 AM	9:00 PM	200	16-70	
Monday	8:00 AM	9:00 PM	200	16-70	
Tuesday	8:00 AM	9:00 PM	200	16-70	
Wednesday	8:00 AM	9:00 PM	200	11-11	
Thursday	8:00 AM	9:00 PM	200		
Friday	8:00 AM	9:00 PM	200		
Saturday	8:00 AM	9:00 PM	200		

Entertainment Indoor Closing Hours - If alcohol beverage establishment, same as alcohol license hours.
If non-alcohol establishment 1:00 am Sunday to Thursday; 1:30 am Friday and Saturday.

Entertainment Outdoor Closing Hours - 10:00 pm Sunday – Thursday; 12:00 am Friday and Saturday, unless otherwise approved by Common Council in licensee's plan of operation.

11. Required Signature(s)

X Sukhdev Singh
Sole Proprietor, Partner, 20% or more Shareholder, or Agent - only if there are no 20% or more shareholders

/
Signature of additional partner or 20% or more shareholder

See Application Information for a list of all required application forms.

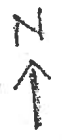

FIRST FLOOR

CHAMBER EAST FOOD MARKET LLC
D/B/A CHAMBERS EAST FOOD
200 E. CHAMBER STREET.
MILWAUKEE, WI 53212

SUKHDEV SINGH, AGENT

PAGE 1 OF 2
1100 Sq. Ft.

09/11/2015

PALMER STREET

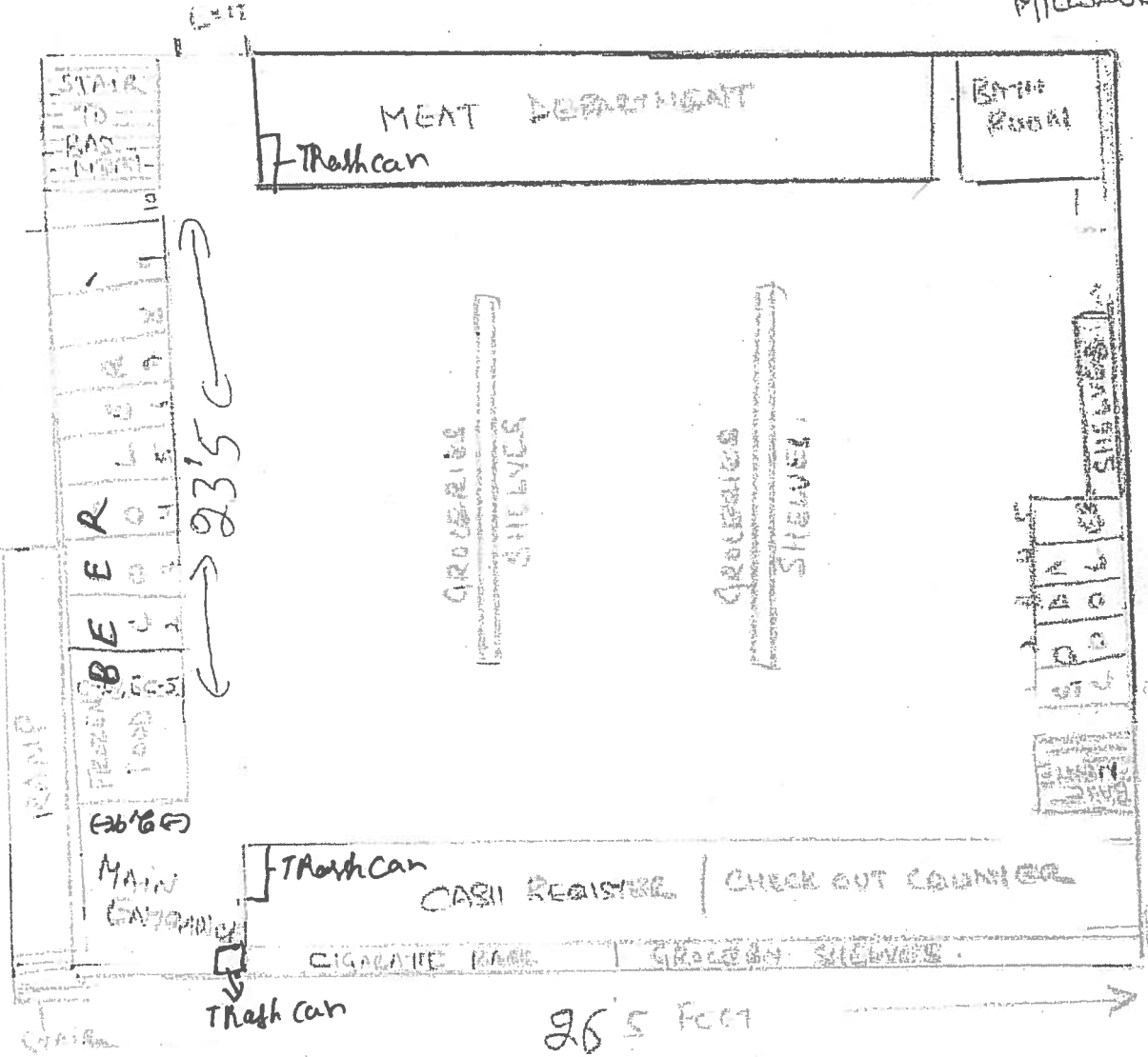

CHAMBER STREET



Palmer Street

BASEMENT

CHAMBER EAST FOOD MARKET LLC.

D/B/A CHAMBERS EAST FOOD

800 E CHAMBER STREET

MILWAUKEE, WI 53212

↑ SUKHDEV SINGH, AGENT

PAGE 2 OF 2.

1100 S.G. F.T

02/11/2015

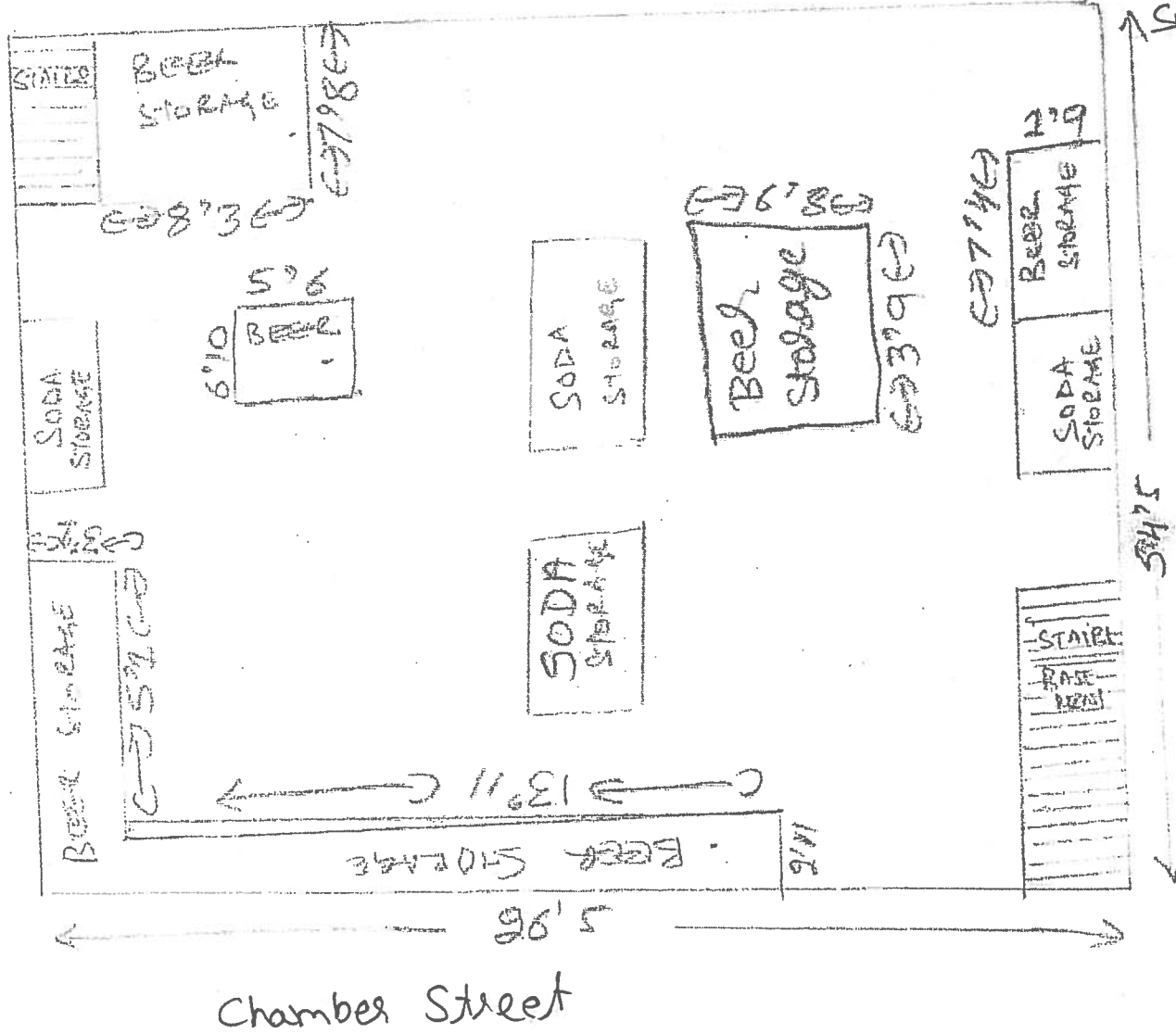

Chamber Street



FOOD DEALER LICENSE PLAN OF OPERATION

OFFICE OF THE CITY CLERK, LICENSE DIVISION
 CITY HALL, 200 E. WELLS ST, ROOM 105, MILWAUKEE, WI 53202 •
 (414) 286-2238 • license@milwaukee.gov • www.milwaukee.gov/license

Legal Entity Name: **CHAMBER EAST FOOD MARKET LLC.**

Premise Address: **200 E CHAMBER ST.**

1. Application Type

Indicate the application type and complete the corresponding section.

New application (fee is \$300). For new applications, answer questions below and then continue on to section 2.

Is this a simple change of ownership (no change in food operation) or a new establishment?

- Taking over existing operating licensed food business
- New establishment (anything other than a simple change of ownership)

Provide a brief description of the food establishment

GROCERY STORE WITH BEER

What is the anticipated opening date or date of change of ownership: **03/01/2015**

Site Evaluation - Optional (fee is \$100) Site evaluations are optional, and done only upon request. The purpose of the site evaluation is to assess the suitability of a prospective site for use as a food establishment.

Modification or amendment to an existing food license or public health approved operational plan. For modifications/amendments to existing establishments, both the operator and establishment cannot be different than on existing license or the application is considered new. Answer the two questions below (including the follow up detail if applicable) and then continue on to section 2.

What facilities (equipment or building) change(s) are you planning (check all that apply):

- Construction or renovation (fee is \$200)
- Significant equipment change without construction or renovation (fee is \$50)
- Adding an additional site at the same premises where food will be prepared/processed or sold (fee is \$100 per additional site)
- No equipment or renovations are being planned

What changes are being proposed to the food operation or specialized approvals are being requested (Note: \$75 operational change fee is charged only once even if multiple items are checked):

- Substantial changes to the menu including the type or complexity of food processing (fee is \$75)

Briefly describe proposed changes

[Empty box for describing proposed changes]

- Adding processing when no processing was previously performed, or adding additional types of processing (fee is \$75)

- Requests for modifications or variances to public health food code requirements or the review of a specialized process requiring health department approval prior to implementation (fee is \$75)

Indicate specialized processes/variances requested (check all that apply):

- | | |
|--|--|
| <input type="checkbox"/> Acidified Rice | <input type="checkbox"/> Sale without Consumer Advisory |
| <input type="checkbox"/> Bare Hand Contact to Ready to Eat Foods | <input type="checkbox"/> Shellfish - Comingling |
| <input type="checkbox"/> Curing | <input type="checkbox"/> Shellfish -Display Tanks |
| <input type="checkbox"/> Dogs in Outside Dining Areas | <input type="checkbox"/> Smoking |
| <input type="checkbox"/> Non-continuous Cooking | <input type="checkbox"/> Sprouting |
| <input type="checkbox"/> Peddler Base | <input type="checkbox"/> Time as a Public Health Control |
| <input type="checkbox"/> Reduced Oxygen Packaging | <input type="checkbox"/> Wild Game |
| <input type="checkbox"/> Other, specify | |

[Empty box for specifying other specialized processes]

- Amending existing license to reflect an increase in annual gross sales or change in food operation (fee is the difference in the cost between the food licenses plus \$25 for transfer fee)

- No significant changes are being proposed in how food is prepared/processed or substantial menu changes. No addition of specialized process or activities requiring approval is being requested (no fee)

2. Premises Description

Will food be prepared or sold at a single or multiple food preparation and/or sale sites: Single Multiple

If multiple sites will be used, how many distinct sites will be used?

List all sites and briefly describe the nature of the food activities at each site:

Note: Multiple sites may require more than one license or an additional site license depending upon the food activity conducted at any one site.

Indicate where on the premises food will be sold, served, consumed and/or stored: 1st Floor 2nd Floor Rooftop Basement

Other Floor, specify _____

Other location, specify _____

Are any outdoor operations planned? Yes No Unknown

What activities will be conducted outdoors (check all that apply)

Bar

Cooking/grilling

Dining – Patio

Dining – Sidewalk (DPW permit required)

Storage

Other, specify

Seating provided on site for dining? Yes No

If yes, what is the seating capacity both inside and outside?

If yes, are there additional banquet facilities other than the main dining area? Yes No

Total square footage of the establishment (exclude space utilized for other purposes other than food)

Annual Gross Food Sales: Sales Based on: Previous Year Previous Establishment Best Estimate

Note: Inspector will request to review receipts periodically to validate if establishment has the appropriate license.

Number of Full Time Employees

Number of Part Time Employees

The following items must be included with a new application at the time of filing:

- Site Plan/Floor Plan: Site plan must identify the building in relation to streets, sidewalks, parking & garbage area, see sample and instructions. Food manufacturers, distributors, commissaries, and meal service establishments as defined in section 4 are exempt.
- Shared Kitchen Agreement, if applicable: If not using your own establishment as your base, provide a written and signed commissary agreement. The agreement must include a list of all services provided by the commissary, such as restroom use, dry goods storage, use of refrigerator space (including the number of cubic feet of refrigeration space allocated to you), etc.

The following items must be submitted to inspector, prior to approval of inspection.

- Floor Plan: The plan must show the location of all equipment (sinks, refrigeration, stoves, ware-washing, etc.), plumbing, electrical services, mechanical ventilation, storage areas and restrooms. Plans must be a minimum of 11 X 14 inches in size including the layout of the floor plan accurately drawn to a minimum scale of 1/4 inch = 1 foot. Plans may be submitted in an electronic format.
- Equipment List: Provide the make and model number of all significant equipment (cooking, cooling, warewashing, etc.) All food equipment must be ANSI/NSF certified. No home-style equipment is allowed. Equipment specification sheets do not have to be provided at the time of submission, but must be provided upon Health Department request
- Finish Materials List: Provide a list of all finish materials (floors, walls, ceilings, counter tops). Surfaces must be smooth, nonabsorbent and easily cleanable, and ceramic, porcelain or quarry tile must have set in base cove.
- Lighting Plan: Provide a list of all light fixtures to be used in the food establishment. All light used in any food prep or storage areas must be shielded or covered and flush or integral to the ceiling. Lighting in food preparation area must meet minimum illumination standards defined in the WI Food Code.
- Pest Management Plan: Describe the establishments integrated pest management plan. Describe strategies to prevent pest entry into the food establishment & harborage of pests Identify if a licensed pest control service has been contracted, provide the name of the company and frequency of service.

3. Construction, Renovations, Kitchen Equipment Changes or Remodeling

Any construction, remodeling or equipment changes planned? Yes No If no, skip to section 4.

Scope of the planned project?

- New construction or conversion of an existing structure to be used as a food establishment
- Renovation/remodeling impacting 300ft² or more than of food preparation or display area
- Renovation/remodeling impacting less than 300ft² of food preparation or display area
- Renovation/remodeling limited to the instillation/change/replacement of food equipment

Provide a brief summary of the proposed construction, remodeling and/or equipment change:

Note: Building permits may be required, contact the Department of Neighborhood Services

Date alterations/changes planned to begin _____

Contact information for general contractor _____

Contact information for architect _____

4. BUSINESS TYPE

Overall Establishment Type (select the one that best describes the proposed business)

- Bed and Breakfast
- Commissary or Mobile Food Peddler Base – a commercial kitchen used for the production of food to be served or sold at another location; a base of operations for a mobile food peddler where the vehicle, cart or unit which is used at a minimum for the service or cleaning of the peddler vehicle, cart or container. A base of operations for a caterer or seasonal market vendor for the preparation of food.
- Community Food Program – free meal site or food pantry. Any site in which all food is provided free of cost to those in need or to organizations who serve person's in need.
- Distiller or Brewer – facilities that are primarily engaged in the production of alcoholic beverages
- Food Distributor – a business that transports food for sale to retail and wholesale establishments and does not perform any processing or repacking of food items

Is food stored on site Yes No

- Food Manufacturer - commercial operation that produces, packages, labels, or stores food for human consumption, but primarily does not provide food directly to a consumer, food is sole to distributors, retailers or restaurants, there may be a small store on site where only the manufacturers products are sold, but the majority of product is sold to other licensed food establishments
- Is there a retail store onsite? Yes No

- Food Store – a food establishment either mobile or permanent in which the majority of food sales consist of beverages or multi-serving food products requiring further preparation prior to consumption, examples of food stores include bakeries, grocery stores, convenience stores, coffee shops, liquor stores. Food stores include business whose primary business is other than food, but offer convenience food items.

Are you considered a convenience food store? Yes No

A convenience food store contains less than 5,000 sq ft of retail sales space AND has as its primary business the sale of basic food items and in addition sells household products. Basic food items may include, but are not limited to, milk and dairy products, bread products, prepared sandwiches, frozen entrees, refrigerated food and baby food. Household products may include, but are not limited to, cleaning products, paper products, baby products and pet food

- School – educational institution including elementary, middle and high schools, technical schools, colleges and university, where food service is limited to students (no sales to faculty or general public)
- Restaurant – a food establishment either mobile or permanent in which the majority food sales consist of meals

5. FOOD OPERATION SCOPE

Type of Sales (check all that apply, even if it reflects a small percentage of the proposed business)

- Made directly to the general public or end consumer (includes internet sales)
- Made to other food establishments (wholesaler, distributors, retail or restaurants) who will resell your product(s)

What percentage of your planned food sales will be meals versus grocery items?

% from meals (ready-to-eat food sold to in single portions)

100 % from grocery items (multi-serving food products, typically requiring preparation before serving, includes beverages, bakery items and raw produce)

Will 25% or more of your sales be to highly susceptible populations (defined as persons with medical conditions, elderly, or preschool age children)?

Yes No

Will customers be able to purchase food through a drive through? Yes No

Will customers be able to purchase food from a self-service salad or food bar? Yes No

Will food be prepared on site and then transported for sale or consumption at another location? Yes No

If yes, check all the reason why the food will be transported

Catering Delivery Base for Mobile Food Peddler Base for temporary or seasonal food stand

Other, specify

6. FOOD, FOOD PREPERATION, FOOD PROCESSING

For restaurants provide a copy of the proposed menu or a detailed menu of all the foods and drinks you will be serving.

For all other establishments provide a summary below of the brief types of food products being sold.

Will any potentially hazardous food (food that requires temperature control) be offered for sale? Yes No

Examples of potentially hazardous foods are meats, dairy, poultry, eggs, cut tomatoes or leafy greens, cut melons, cooked rice, beans or potatoes, or garlic in oil.

Will food be prepared or processed on site? Yes No

Examples of processing are assembling, grinding, cutting, mixing, baking, grilling, frying, coating, stuffing, packing, bottling, packaging, canning, extracting, fermenting, distilling, pickling, freezing, drying, smoking.

If yes, indicate the type of food processing that will be conducted:

MEAT (DELI SLICER)

If performing processing, will there be any processing of potentially hazardous food? Yes No

7. WEIGHTS AND MEASURES

Will any items be offered for sale by weight or by volume? Yes No

If yes, describe number and type of devices used:

A separate weights and measures license is required for each scale.

Will electronic scanning devices be used for pricing/check out? Yes No

If yes, how many devices will be used

A scanner license is required if using an electronic scanning device.

8. ISSUANCE OF LICENSE

Will any alcohol or intoxicating beverages be sold at the establishment? Yes No

If yes, what type of license do you have or will you be applying for (check all that apply)?

- Class A fermented malt beverage licenses
- Class A liquor licenses
- Class B fermented malt beverage licenses
- Class B liquor licenses
- Class C wine licenses

If yes, if your food license is approved prior to the alcohol license, would you like the food license issued (check one)

immediately so you can open your food business at the same time as the alcohol license

9. Affirmation of Understanding – Permit Needed to Operate

READ AND INITIAL EACH ITEM CONFIRMING YOUR UNDERSTANDING:

1. SS I understand that an inspection and sign off by the Health Department is required before my permit may be issued.
2. SS I understand that an occupancy permit must be issued and an inspection may be required from the Department of Neighborhood Services before my permit may be issued.
3. SS I understand that the Department of Neighborhood Services must sign off on my application with the License Division before my permit may be issued.
4. SS I understand the local council member must approve or deny my request before my permit is eligible to be issued. If denied, I understand that I may be scheduled for a hearing before the License Committee of the Common Council.
5. SS I understand that I must pay and the License Division must have proof of payment for the associated permit fees before my permit may be issued.
6. SS I understand that all of the above must be complete before my permit is eligible to be issued.
7. SS I understand that the license/permit for which I am applying must be issued and posted in my business premises prior to opening for business.
8. SS I will not operate my food business until the permit has been issued and posted in the establishment.

10. Required Signature(s)

SS Suknder Singh
Sole Proprietor, Partner, 20% or more Shareholder,
or the Agent - only if there are no 20% or more shareholders

Signature of additional partner or 20% or more shareholder

***SUBMIT THIS FORM ALONG WITH THE
"BUSINESS LICENSE APPLICATION" & "BUSINESS LICENSE PLAN OF OPERATION"***



CITY OF MILWAUKEE
OFFICE OF THE CITY CLERK

Thursday, March 26, 2015

COMMITTEE MEETING NOTICE

AD 06

THOMPSON, Paul S, Agent
BRIDGEMAN FOODS II, INC
9719 S FRANKLIN DR

Franklin, WI 53132

You are requested to attend a hearing which is to be held in Room 301-B, Third Floor, City Hall on:

Monday, April 06, 2015 at 02:00 PM

Regarding: Your Extended Hours Establishments Renewal Application as agent for "BRIDGEMAN FOODS II, INC" for "WENDY'S RESTAURANT #2" at 633 W NORTH Av.

There is a possibility that your application may be denied for one or more of the following reasons: The recommendation of the committee regarding the application shall be based on evidence presented at the hearing. Per MCO 85-4-4, unless otherwise specified in the code, probative evidence concerning non-renewal, suspension or revocation may include evidence of the following: failure of the applicant to meet municipal qualifications, pending charges against or the conviction of any felony, misdemeanor, municipal offense or other offense, the circumstances of which substantially relate to the circumstances of the particular licensed or permitted activity, by the applicant or by any employee or other agent of the applicant. If the activities of the applicant involve a licensed premises, whether the premises tends to facilitate a public or private nuisance or has been the source of congregations of persons which have resulted in any of the following: disturbance of the peace; illegal drug activity; public drunkenness; drinking in public; harassment of passers-by; gambling; prostitution; sale of stolen goods; public urination; theft; assaults; battery; acts of vandalism including graffiti, excessive littering, loitering, illegal parking, loud noise at times when the licensed premise is open for business; traffic violations; curfew violations; lewd conduct; display of materials harmful to minors, pursuant to s. 106-9.6; or any other factor which reasonably relates to the public health, safety and welfare, or failure to comply with the approved plan of operation. See attached police report or correspondence.

Notice for applicants with warrants or unpaid fines:

Proof of warrant satisfaction or payment of fines must be submitted at the hearing on the above date and time. Failure to comply with this requirement may result in a delay of the granting/denial of your application.

Failure to appear at this meeting may result in the denial of your license. Individual applicants must appear only in person or by an attorney. Corporate or Limited Liability applicants must appear only by the agent designated on the application or by an attorney. Partnership applicants must appear by a partner listed on the application or by an attorney. If you wish to do so and at your own expense, you may be accompanied by an attorney of your choosing to represent you at this hearing.

You will be given an opportunity to speak on behalf of the application and to respond and challenge any charges or reasons given for the denial. No petitions can be accepted by the committee, unless the people who signed the petition are present at the committee hearing and willing to testify. You may present witnesses under oath and you may also confront and cross-examine opposing witnesses under oath. If you have difficulty with the English language, you should bring an interpreter with you, at your expense, so that you can answer questions and participate in your hearing.

You may examine the application file at this office during regular business hours prior to the hearing date. Inquiries regarding this matter may be directed to the person whose signature appears below.

Limited parking for persons attending meetings in City Hall is available at reduced rates (5 hour limit) at the Milwaukee Center on the southwest corner of East Kilbourn and North Water Street. Parking tickets must be validated in the first floor information booth in City Hall.

PLEASE NOTE: Upon reasonable notice, efforts will be made to accommodate the needs of disabled individuals through sign language interpreters or other auxiliary aids. For additional information or to request this service, contact the Council Services Division ADA Coordinator at (414) 286-2998, Fax - (414) 286-3456, TDD - (414) 286-2025.

JIM OWCZARSKI, CITY CLERK

BY:



Jason Schunk
License Division Manager

If you have questions regarding this notice, please contact the License Division at (414) 286-2238.

200 E. Wells Street, Room 105, City Hall, Milwaukee, WI 53202. www.milwaukee.gov/license
Phone: (414) 286-2238 Fax: (414) 286-3057 Email Address: License@milwaukee.gov

Becker, Keren

From: License
Sent: Thursday, March 05, 2015 9:16 AM
To: Becker, Keren; Cooney, James
Subject: FW: Opposition to extended hours establishment - Wendy's on 7th and North Avenue



Jonathan Koberstein
License Specialist III
City Clerk's Office – License Division
City Hall Rm 105
200 E Wells St
Milwaukee, WI 53202
(414)286-2238 Office
(414)286-3057 Fax

From: ;
Sent: Thursday, March 05, 2015 9:05 AM
To: License
Subject: Opposition to extended hours establishment - Wendy's on 7th and North Avenue

To whom it may concern:

I am opposed to the Wendy's drive through being opened so late at night. My properties are right next door and the loud noise from the loudspeaker and customer audio systems is especially bad late at night and causes my tenants to not be able to sleep with the windows open in the summer. Additionally, littering on the property that blows onto my property is an ongoing problem.

Sincerely,



Thursday, March 26, 2015



Notice of Public Hearing

THOMPSON, Paul S, Agent
WENDY'S RESTAURANT #2 at 633 W NORTH Av
Extended Hours Establishments Renewal Application

Monday, April 06, 2015 at 2:00 PM

To whom it may concern:

The above application has been made by the above named applicant(s). This requires approval from the Licenses Committee and the Common Council of the City of Milwaukee. The hearing before the Licenses Committee will take place on 4/6/2015 at 2:00 PM, in Room 301-B, Third Floor, City Hall. If you wish, you may provide testimony at the hearing regarding the request; see below for further information. You are not required to attend the hearing. Once the Licenses Committee makes its recommendation, this recommendation is forwarded to the full Common Council for approval at its next regularly scheduled hearing. Please review the information below and if you have further questions regarding this process, please contact the License Division at (414) 286-2238.

Important details for those wishing to provide information for the Licenses Committee to consider when making its recommendation:

1. The license application is scheduled to be heard at the above time. Due to other hearings running longer than scheduled, you may have to wait some time to provide your testimony.
2. You must appear in person and testify as to matters that you have personally experienced or seen. (You cannot provide testimony for your neighbor, parent or anyone else; this is considered hearsay and cannot be considered by the committee.)
3. No letters or petitions can be accepted by the committee (unless the person who wrote the letter or the persons who signed the petition are present at the committee hearing and willing to testify).
4. Persons opposed to the license application are given the opportunity to testify first; supporters may testify after the opponents have finished.
5. When you are called to testify, you will be sworn in and asked to give your name, and address. (If your first and/or last names are uncommon please spell them.)
6. You may then provide testimony.
 - a. Include only information relating to the above license application.
 - b. Include only information you have personally witnessed or seen.
 - c. Provide concise and relevant information detailing how this business has affected or may affect the peaceful enjoyment of your neighborhood.
 - d. If by the time you have the opportunity to testify, the information you wish to share has already been provided to the committee, you may state that you agree with the previous testimony. Redundant or repetitive testimony will not assist the committee in making its recommendation.
7. After giving your testimony, the members of the Licenses Committee and the licensee may ask questions regarding the testimony you have given or other factors relating to the license application.
8. Business Competition is not a valid basis for denial or non-renewal of a license.
Please Note: If you have submitted an objection to the above application your objection cannot be considered by the committee unless you personally testify at the hearing.

RESIDENT	MAIL ADDRESS	CITY AND ZIP CODE
CURRENT RESIDENT	2200 N 6TH ST	MILWAUKEE, WI 53212-3111
CURRENT RESIDENT	2202 N 6TH ST	MILWAUKEE, WI 53212-3111
CURRENT RESIDENT	2204 N 6TH ST	MILWAUKEE, WI 53212-3111
CURRENT RESIDENT	2206 N 6TH ST	MILWAUKEE, WI 53212-3111
CURRENT RESIDENT	2208 N 7TH ST	MILWAUKEE, WI 53205-1301
CURRENT RESIDENT	2210 N 7TH ST	MILWAUKEE, WI 53205-1301
CURRENT RESIDENT	2215 N 5TH ST	MILWAUKEE, WI 53212-3105
CURRENT RESIDENT	2217 N 6TH ST	MILWAUKEE, WI 53212-3110
CURRENT RESIDENT	2220 N 7TH ST	MILWAUKEE, WI 53205-1301
CURRENT RESIDENT	2224 N 7TH ST B	MILWAUKEE, WI 53205-1301
CURRENT RESIDENT	2225 N 5TH ST	MILWAUKEE, WI 53212-3105
CURRENT RESIDENT	2227 N 5TH ST	MILWAUKEE, WI 53212-3105
CURRENT RESIDENT	2307 N 5TH ST	MILWAUKEE, WI 53212-3131
CURRENT RESIDENT	2307A N 5TH ST	MILWAUKEE, WI 53212-3131
CURRENT RESIDENT	2309 N 5TH ST	MILWAUKEE, WI 53212-3131
CURRENT RESIDENT	2322 N 6TH ST	MILWAUKEE, WI 53212-3134
CURRENT RESIDENT	2322A N 6TH ST	MILWAUKEE, WI 53212-3134
CURRENT RESIDENT	600 W GARFIELD AVE	MILWAUKEE, WI 53212-3118
CURRENT RESIDENT	602 W GARFIELD AVE	MILWAUKEE, WI 53212-3118
CURRENT RESIDENT	606 W GARFIELD AVE	MILWAUKEE, WI 53212-3118
CURRENT RESIDENT	610 W GARFIELD AVE	MILWAUKEE, WI 53212-3118
CURRENT RESIDENT	616 W GARFIELD AVE	MILWAUKEE, WI 53212-3118
CURRENT RESIDENT	626 W GARFIELD AVE	MILWAUKEE, WI 53212-3118
CURRENT RESIDENT	632 W GARFIELD AVE	MILWAUKEE, WI 53212-3118

Total Records: 25

Radius: 250.0 feet and Center of Circle: 633 W North AV



**EXTENDED HOURS ESTABLISHMENT
RENEWAL LICENSE SUPPLEMENTAL
APPLICATION & PLAN OF OPERATION**

Office of the City Clerk License Division
200 E. Wells St. Room 105, Milwaukee, WI 53202
(414) 286-2238 email address: license@milwaukee.gov www.milwaukee.gov/license

Current License # **24HRS 197417 BRIDGEMAN FOODS II, INC 633 W NORTH AV**

RENEWAL FEE = \$ \$225.00

SECTION I LICENSES, OCCUPANCY & PARKING

What type of business is operated at this location? (check all that apply) Convenience Store Filling Station
 Personal Service Establishment Recording Studio Restaurant, Sit-Down Restaurant, Fast-Food/Carry Out

What other types of licenses or permits do you, or will you, hold at this location? (check all that apply)
 Occupancy Permit Gas Station Cigarette Food Class "B" Tavern Other: _____

RESTAURANTS ONLY: _____ **RESTAURANTS & PERSONAL SERVICE ESTABLISHMENTS ONLY:** _____

Legal Occupancy Limit/Capacity ▶ 100 Number of Off-Street Parking Places ▶ 38

SECTION II HOURS OF OPERATION

Are there any changes to the current hours of operation (as listed on your current license) or number of customers expected each day?
 NO If NO, skip this section and go to Section III
 YES If YES, provide all proposed operating hours below. If closed on a certain day of the week, write "closed."
 Check here if proposed change of hours of operation is to be applied to a Food License

DAY OF THE WEEK	Opening Time (include AM/PM)	Closing Time (include AM/PM)	Number of customers expected each day
Sunday			
Monday			
Tuesday			
Wednesday			
Thursday			
Friday			
Saturday			

SECTION III PLANS FOR SECURITY, LITTER & NOISE

How is security provided at the premise?
 Security Cameras Alarm System Other: DUNBAR PICK-UP

Who is responsible for keeping the grounds clean of litter and debris?
 Licensee Building Owner Employees Hired Maintenance Other: _____

How are the grounds kept clean of litter and debris?
 Sweep Pressure Wash Pick Up Litter Garbage Cans Outside Other: _____

How often are the grounds cleaned of litter and debris? Daily Weekly Other: _____

How are noise issues prevented or addressed?
 Security Call police Signs posted Manager approaches customer(s) Other: _____

I agree to have all licenses I hold at this location aligned to expire on the same day.
Paul S. Thompson
Signature of Licensee

COMPLETE REVERSE SIDE ---->