



CITY OF MILWAUKEE
OFFICE OF THE CITY CLERK

Thursday, April 13, 2023

COMMITTEE MEETING NOTICE

AD 04

BURGESS, Evan C, Agent
ROCK OF GIBRALTAR LLC
131 N JACKSON St
Milwaukee, WI 53202

You are requested to attend a hearing which is to be held in Room 301-B, Third Floor, City Hall or you may attend virtually using the link below.

Tuesday, April 25, 2023 at 10:30 AM

The access code is <https://meet.goto.com/623644525>. If you wish to call in: +1 (408) 650-3123 and use Access Code: 623-644-525. Please see the enclosed best practices document for further instructions.

Regarding: Your Class B Tavern, Public Entertainment Premises and Food Dealer License Applications Requesting Instrumental Musicians, Disc Jockey, Bands, Karaoke, Poetry Readings, Patron Contests, 200 Concerts p/Yr, Dancing by Performers and Patrons Dancing as agent for "ROCK OF GIBRALTAR LLC" for "GIBRALTAR MKE" at 131 N JACKSON St.

There is a possibility that your application may be denied for one or more of the following reasons: The recommendation of the committee regarding the application shall be based on evidence presented at the hearing. Per MCO 85-2.7-4, probative evidence concerning whether or not a new license should be granted may be presented on the following subjects: whether or not the applicant meets the municipal requirements, the appropriateness of the location and premises where the licensed premises is to be located and whether use of the premises for the purposes or activities permitted by the license would tend to facilitate a public or private nuisance or create undesirable neighborhood problems such as disorderly patrons, unreasonably loud noise, litter, and excessive traffic and parking congestion. Probative evidence relating to these matters may be taken from the plan of operation submitted with the license application, if any, but shall not include the content of any music. Evidence regarding the fitness of the location of the premises to be maintained as the principal place of business, including but not limited to whether there is an overconcentration of businesses of the type for which the license is sought; whether the proposal is consistent with any pertinent neighborhood business or development plans, or the location's proximity to areas where children are typically present. The applicant's record in operating similarly licensed premises; and whether or not the applicant has been charged with or convicted of any felony, misdemeanor, municipal offense or other offense, the circumstances of which substantially relate to the activity to be permitted by the license being applied for or any other factor which reasonably relates to the public health, safety or welfare may also be considered. See attached police report or correspondence.

Notice for applicants with warrants or unpaid fines: Proof of warrant satisfaction or payment of fines must be submitted at the hearing on the above date and time. Failure to comply with this requirement may result in a delay of the granting/denial of your application.

Failure to appear at this meeting may result in the denial of your license. Individual applicants must appear only in person or by an attorney. Corporate or Limited Liability applicants must appear only by the agent designated on the application or by an attorney. Partnership applicants must appear by a partner listed on the application or by an attorney. If you wish to do so and at your own expense, you may be accompanied by an attorney of your choosing to represent you at this hearing. You will be given an opportunity to speak on behalf of the application and to respond and challenge any charges or reasons given for the denial. No petitions can be accepted by the committee, unless the people who signed the petition are present at the committee hearing and willing to testify. You may present witnesses under oath and you may also confront and cross-examine opposing witnesses under oath. If you have difficulty with the English language, you should bring an interpreter with you, at your expense, so that you can answer questions and participate in your hearing. You may examine the application file at this office during regular business hours prior to the hearing date. Inquiries regarding this matter may be directed to the person whose signature appears below.

Limited parking for persons attending meetings in City Hall is available at reduced rates (5 hour limit) at the Milwaukee Center on the southwest corner of East Kilbourn and North Water Street. Parking tickets must be validated in the first floor information booth in City Hall.

PLEASE NOTE: Upon reasonable notice, efforts will be made to accommodate the needs of disabled individuals through sign language interpreters or other auxiliary aids. For additional information or to request this service, contact the Council Services Division ADA Coordinator at (414) 286-2998, Fax - (414) 286-3456, TDD - (414) 286-2025.

JIM OWCZARSKI, CITY CLERK

BY: _____
Jim Cooney
License Division Manager

If you have questions regarding this notice, please contact the License Division at (414) 286-2238.

200 E. Wells Street, Room 105, City Hall, Milwaukee, WI 53202. www.milwaukee.gov/license
Phone: (414) 286-2238 Fax: (414) 286-3057 Email Address: License@milwaukee.gov



CITY OF MILWAUKEE
OFFICE OF THE CITY CLERK

Thursday, April 13, 2023

COMMITTEE MEETING NOTICE

AD 04

BURGESS, Evan C, Agent
ROCK OF GIBRALTAR LLC
1168 N 46TH ST
Milwaukee, WI 53208

You are requested to attend a hearing which is to be held in Room 301-B, Third Floor, City Hall or you may attend virtually using the link below.

Tuesday, April 25, 2023 at 10:30 AM

The access code is <https://meet.goto.com/623644525>. If you wish to call in: +1 (408) 650-3123 and use Access Code: 623-644-525.
Please see the enclosed best practices document for further instructions.

Regarding: Your Class B Tavern, Public Entertainment Premises and Food Dealer License Applications Requesting Instrumental Musicians, Disc Jockey, Bands, Karaoke, Poetry Readings, Patron Contests, 200 Concerts p/Yr, Dancing by Performers and Patrons Dancing as agent for "ROCK OF GIBRALTAR LLC" for "GIBRALTAR MKE" at 131 N JACKSON St.

There is a possibility that your application may be denied for one or more of the following reasons: The recommendation of the committee regarding the application shall be based on evidence presented at the hearing. Per MCO 85-2.7-4, probative evidence concerning whether or not a new license should be granted may be presented on the following subjects: whether or not the applicant meets the municipal requirements, the appropriateness of the location and premises where the licensed premises is to be located and whether use of the premises for the purposes or activities permitted by the license would tend to facilitate a public or private nuisance or create undesirable neighborhood problems such as disorderly patrons, unreasonably loud noise, litter, and excessive traffic and parking congestion. Probative evidence relating to these matters may be taken from the plan of operation submitted with the license application, if any, but shall not include the content of any music. Evidence regarding the fitness of the location of the premises to be maintained as the principal place of business, including but not limited to whether there is an overconcentration of businesses of the type for which the license is sought; whether the proposal is consistent with any pertinent neighborhood business or development plans, or the location's proximity to areas where children are typically present. The applicant's record in operating similarly licensed premises; and whether or not the applicant has been charged with or convicted of any felony, misdemeanor, municipal offense or other offense, the circumstances of which substantially relate to the activity to be permitted by the license being applied for or any other factor which reasonably relates to the public health, safety or welfare may also be considered. See attached police report or correspondence.

Notice for applicants with warrants or unpaid fines:

Proof of warrant satisfaction or payment of fines must be submitted at the hearing on the above date and time. Failure to comply with this requirement may result in a delay of the granting/denial of your application.

Failure to appear at this meeting may result in the denial of your license. Individual applicants must appear only in person or by an attorney. Corporate or Limited Liability applicants must appear only by the agent designated on the application or by an attorney. Partnership applicants must appear by a partner listed on the application or by an attorney. If you wish to do so and at your own expense, you may be accompanied by an attorney of your choosing to represent you at this hearing. You will be given an opportunity to speak on behalf of the application and to respond and challenge any charges or reasons given for the denial. No petitions can be accepted by the committee, unless the people who signed the petition are present at the committee hearing and willing to testify. You may present witnesses under oath and you may also confront and cross-examine opposing witnesses under oath. If you have difficulty with the English language, you should bring an interpreter with you, at your expense, so that you can answer questions and participate in your hearing. You may examine the application file at this office during regular business hours prior to the hearing date. Inquiries regarding this matter may be directed to the person whose signature appears below.

Limited parking for persons attending meetings in City Hall is available at reduced rates (5 hour limit) at the Milwaukee Center on the southwest corner of East Kilbourn and North Water Street. Parking tickets must be validated in the first floor information booth in City Hall.

PLEASE NOTE: Upon reasonable notice, efforts will be made to accommodate the needs of disabled individuals through sign language interpreters or other auxiliary aids. For additional information or to request this service, contact the Council Services Division ADA Coordinator at (414) 286-2998, Fax - (414) 286-3456, TDD - (414) 286-2025.

JIM OWCZARSKI, CITY CLERK

BY: _____

Jim Cooney
License Division Manager

If you have questions regarding this notice, please contact the License Division at (414) 286-2238.

200 E. Wells Street, Room 105, City Hall, Milwaukee, WI 53202. www.milwaukee.gov/license
Phone: (414) 286-2238 Fax: (414) 286-3057 Email Address: License@milwaukee.gov

Date: 3/24/2023
Officer: PLUMLEY

City of Milwaukee Police Department
90-5-1.5 Crime Prevention Survey
Tavern Inspection

Name of Premise: Rock of Gibraltar
Address: 131 N. Jackson St
Phone:

Owner: Evan C. Burgess
Owner address: 1168 N. 46th St
City State Zip: Milwaukee WI 53208
Owner Phone: 414-510-2435
Owner email: Evanchristianmusic@gmail.com

Licensee/Agent: Evan C. Burgess
Home Address: 1168 N. 46th St
City State Zip: Milwaukee WI 53208
Phone: 414-510-2435
Email:

Preferred contact: Phone

Location currently open: YES NO

Projected open date:

Day's open: S M T W Th F SA ALL

Hours of Operation: Sun: 24 hours Y N
Mon:
Tue: 1P-2A
Wed: 1P-2A
Thu: 1P-2A
Fri: 1P-230A
Sat: 1P-230A

Premise Type: Tavern/Bar
Restaurant
Other:

Licenses currently held:

Alcohol: Yes No Class: #:
 Tobacco: Yes No #:
 Food: Yes No #:
 Extended Hours: Yes No #:
 Secondhand Dealer: Yes No Type: #:
 Other: Yes No Type: #:
 Other: Yes No Type: #:

Exterior Survey:

1. Is the area around the location clean? Yes No
2. What surrounds the location? (Check all the apply)
 - a. Park
 - b. School
 - c. Youth Center
 - d. Church
 - e. Tavern(s) If so, how many
 - f. Residential
 - g. Other businesses
 - h. Other:
3. Can you see from the outside of the location into the interior Yes No
4. Can you see the employees inside of the location from the outside Yes No
5. Are exterior windows free of signage Yes No
6. Is there a parking lot Yes No
7. Is the parking lot clean? Yes No
8. Off-Street parking Yes No
9. Is the parking lot well lit? Yes No
10. Valet Parking Yes No
 - a. Will this lot have a guard? Yes No
 - b. Will this lot have cameras? Yes No
11. Are there areas where a person could conceal themselves Yes No
12. Is there exterior lighting? Yes No. Does it appears to be adequate Yes No
13. Exterior Payphone? Yes No
14. Are there No Loitering Signs posted? Yes No
15. Are there exterior security cameras Yes No How Many:
16. Are the address numbers prominently displayed and easy to see Yes No

Camera Survey:

17. Does this location have security cameras? Yes No
18. Are they in working order? Yes No
19. What format are the cameras?
 - a. Color Yes No
 - b. Digital Yes No
 - c. Recorded Yes No
20. How long is footage stored for later viewing:
21. Are there exterior cameras Yes No How many:
22. Are there interior cameras Yes No How many:
23. Do all employees know how to retrieve recorded digital images/footage? Yes No

24. Cameras located in parking lot Yes No How many

Interior Survey:

- 25. What is the planned capacity 129
- 26. What is the minimum number of employees That will be on premise 1
- 27. Is the storeowner willing to be a standing complainant regarding loitering? Yes No
 - a. If yes have them fill out the standing complaint form and give them two of the commercial signs Yes No
- 28. Is the interior of the location neat and clean? Yes No
- 29. Does an interior camera face the entrance/exit? Yes No
- 30. Is there a lockable area that separates employees from customers? Yes No
- 31. Are emergency and non-emergency numbers posted near the phone? Yes No
- 32. Does the owner know how to contact their police district directly? Yes No
 - a. Did you provide a district contact guide to the owner? Yes No

Security

- 33. How many security personnel are going to be employed: 2
- 34. How ill they be deployed: Interior 1 Exterior 1
- 35. What days will they be deployed Mon Tue Wed Thu Fri Sat Sun
- 36. Will the security be managed by business or contracted
- 37. Will they be armed Yes No
- 38. What type of security measures to be used:
 - Wanding/metal detector
 - ID Scanner
 - Dress Code
 - Cover Charge
 - Age restriction
 - Other Deescalation

ADDITIONAL COMMENTS/RECOMMENDATIONS:

Site still under construction. Owner will be putting interior and exterior cameras up for the establishment. Will have security that will focus on de-escalation of violence. Discussed proper liquor lock up for liquor not being used.



Concentration Map for 131 N Jackson St

Area of Interest (AOI) Information

Area : 21,862,585.76 ft²

Feb 17 2023 9:10:39 Central Standard Time

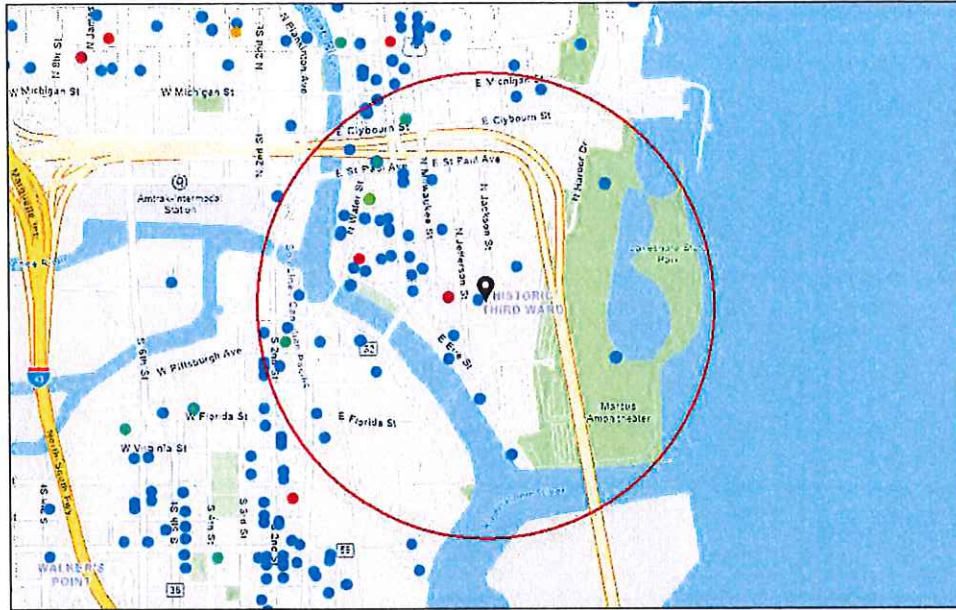

- Alcohol Licenses (active)
- Class A Fermented Malt Beverage
- Class A Liquor and Mall
- Class B Fermented Malt Beverage
- Class B Tavern
- Class C Wine Retailer

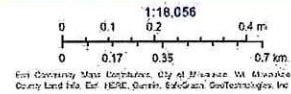

Summary

Name	Count	Area(ft ²)	Length(mi)
Alcohol Licenses	80		

Alcohol Licenses

#	Legal Entity	Trade Name	Licensee	Address	License Type Name	Total Capacity	Expiration Date	Count
1	THE WICKED HOP, LLC	THE WICKED HOP	MILES E O'NEIL, Agt	343-45 N BROADWAY	Class B Tavern License	160	2/28/2023, 6:00 PM	1
2	Joy DB LLC	DryBar	Joy N Vertz, Agt	241 N BROADWAY	Class B Tavern License	60	3/6/2023, 6:00 PM	1
3	Saz's Festival LLC	Saz's Dockside BBQ	Stephanie L Sazama-Schneck, Agt	200 N HARBOR DR	Class B Fermented Malt Beverage Retailer's License		3/14/2023, 7:00 PM	1
4	Camp Bar Inc	Camp Bar	Paul C Hackbarth, Agt	525 E Menomonee ST	Class B Tavern License		3/27/2023, 7:00 PM	1
5	SBB of Milwaukee Inc.	Stack'D Burger Bar	TREVOR M DANIELSEN, Agt	170 S 1st ST	Class B Tavern License		3/30/2023, 7:00 PM	1
6	Saz's Festival, LLC	Saz's Summerfest	Stephanie L Sazama-Schneck, Agt	200 N Harbor DR AREA P	Class B Fermented Malt Beverage Retailer's License		4/4/2023, 7:00 PM	1
7	Saz's Festival LLC	Summerfest - Corkscrew	Stephanie L Sazama-Schneck, Agt	200 N HARBOR DR Area F	Class B Tavern License		4/4/2023, 7:00 PM	1
8	Saz's Festival LLC	Summerfest - Corkscrew	Stephanie L Sazama-Schneck, Agt	200 N HARBOR DR Area G	Class B Tavern License		4/4/2023, 7:00 PM	1
9	MWF, LLC	SUMMERFEST	MICHAEL H WHITE, Agt	100-200 N HARBOR DR	Class B Tavern License		4/11/2023, 7:00 PM	1
10	Tropic LLC	Tropic	HYACINTH E NEMBHARDT, Agt	518 N Water ST	Class B Tavern License	156	4/12/2023, 7:00 PM	1
11	Steakhouse Milwaukee LLC	Rare Steakhouse	Mark D Burish, Agt	833 E MICHIGAN ST	Class B Tavern License		4/16/2023, 7:00 PM	1
12	Hungry Sailor, Inc	Milwaukee Sail Loft	JEFFREY G REINBOLD, Agt	649 E Erie ST	Class B Tavern License	300	4/17/2023, 7:00 PM	1
13	Kipper LLC	Fore Milwaukee	Timothy M Grogan, Agt	530 N Water ST	Class B Tavern License		4/17/2023, 7:00 PM	1
14	Memento LLC	Bavette La Boucherie	Karen E Bell, Agt	217 N BROADWAY	Class B Tavern License		4/25/2023, 7:00 PM	1
15	Benelux Third Ward, LLC	Cafe Benelux	ERIC G WAGNER, Agt	346 N Broadway	Class B Tavern License	455	5/1/2023, 7:00 PM	1
16	goRi Food Entertainment Inc	Char'd	Changhun Kim, Agt	222 E Erie ST 100	Class B Tavern License		5/9/2023, 7:00 PM	1
17	Mader's German Restaurant, Inc	Klement's Sausage Garden	DANIEL J HAZARD, Agt	200 N Harbor DR	Class B Fermented Malt Beverage Retailer's License		5/13/2023, 7:00 PM	1

18	Milwaukee Artist Resource Network Inc	Milwaukee Artist Resource Network	Malaquias E Montoya, Agt	191 N Broadway 102	Class B Tavern License	150	5/15/2023, 7:00 PM	1
19	Stone and Brick LLC	Saffron	Fatima K Kumar, Agt	223 N Water ST 100	Class B Tavern License		5/16/2023, 7:00 PM	1
20	JSWD Wisconsin Venture I LLC	The Westin Milwaukee	Melinda K Niketh, Agt	550 N Van Buren ST	Class B Tavern License		5/22/2023, 7:00 PM	1
21	HTWA MARKET PROJECT, LLC	MILWAUKEE PUBLIC MARKET	MICHAEL GARDNER, Agt	400 N WATER ST	Class B Tavern License	320	5/28/2023, 7:00 PM	1
22	Foltz Family Market, Inc	Foltz Family Market	Casey C Foltz, Agt	400 N WATER ST 6	Class B Tavern License		5/29/2023, 7:00 PM	1
23	The North/South Club, Inc	North South Club	Marla R Poytinger, Agt	175 S Water ST	Class B Tavern License	299	5/30/2023, 7:00 PM	1
24	MC ZAR'S, LLC	O'Lydia's Bar & Grill	Linda M Sackett, Agt	338 S 1ST ST	Class B Tavern License	150	6/4/2023, 7:00 PM	1
25	SCREAMING TUNA RESTAURANT, LLC	SCREAMING TUNA	Jeff T Bronstad, Agt	106 W SEEBOTH ST 102	Class B Tavern License	174	6/13/2023, 7:00 PM	1
26	Kimpton Hotel & Restaurant Group LLC	Journeyman Hotel	Kathleen M Neufeld, Agt	310 E Chicago ST	Class B Tavern License		6/15/2023, 7:00 PM	1
27	RILEY'S SANDWICH COMPANY LLC	Riley's Social House	John M Ludwig, Agt	411 E MENOMONEE ST	Class B Tavern License		6/19/2023, 7:00 PM	1
28	THIEF WINE, LLC	THIEF WINE SHOP & BAR	PHILIP M BILODEAU, Agt	400 N WATER ST	Class B Tavern License	42	6/29/2023, 7:00 PM	1
29	WA Cheese & Sausage Shoppe, Inc	WA Cheese & Sausage Shoppe	Mark S Lutz, Agt	400 N WATER ST 24	Class B Tavern License		6/29/2023, 7:00 PM	1
30	THE SALOON, LTD	JUST ART'S SALOON	ARTHUR R GUENTHER, Agt	181 S 2ND ST	Class B Tavern License	70	6/29/2023, 7:00 PM	1
31	MP On Wheels Catering Service	MP On Wheels Catering Service	DULCE M ALARCON, SP	400 N WATER ST	Class B Tavern License	320	7/11/2023, 7:00 PM	1
32	Toro MKE, LLC	2A Wine Merchants	Robert M Levin, Agt	577 E Erie ST	Class B Tavern License		7/11/2023, 7:00 PM	1
33	TUPELO HONEY HOSPITALITY CORPORATION	Tupelo Honey Cafe	Matthew J Rhoads, Agt	511 N BROADWAY 100	Class B Tavern License		7/11/2023, 7:00 PM	1
34	The Loft on Broadway, LLC	The Loft on Broadway	MEI LYN NELSON, Agt	177 N BROADWAY 3rd Floor	Class B Tavern License		7/13/2023, 7:00 PM	1
35	Fivebirds LLC	The Starling	Tyler T Curran, Agt	102 N WATER ST	Class B Tavern License		7/26/2023, 7:00 PM	1

36	RIVERWALK COMMONS LLC	Riverwalk Commons	PAUL H SCHWARTZ, Agt	423 N WATER ST	Class B Tavern License		7/28/2023, 7:00 PM	1
37	HTWA - Catalano Square	HTWA - Catalano Square	Jack R Lemmon, Agt	138 N Broadway	Class B Tavern License		7/28/2023, 7:00 PM	1
38	JING'S CORPORATION	JING'S	JING WANG, Agt	207 E BUFFALO ST 168	Class B Fermented Malt Beverage Retailer's License	45	7/29/2023, 7:00 PM	1
39	JING'S CORPORATION	JING'S	JING WANG, Agt	207 E BUFFALO ST 168	Class C Wine Retailer's License	45	7/29/2023, 7:00 PM	1
40	Dan Dan LLC	Dan Dan	Daniel P Jacobs, Agt	360 E ERIE ST	Class B Tavern License	165	8/3/2023, 7:00 PM	1
41	Central Standard LLC	Central Standard Craft Distillery	William P McQuillan, Agt	320 E Clybourn ST	Class B Fermented Malt Beverage Retailer's License		8/4/2023, 7:00 PM	1
42	Merriment Social LLC	Merriment Social	Andrew H Miller, Agt	240 E Pittsburgh AV	Class B Tavern License		8/4/2023, 7:00 PM	1
43	Black Tuna LLC	Lucky Ginger	Soukvilay Sayavongsa, Agt	221 N Water ST	Class B Tavern License		8/15/2023, 7:00 PM	1
44	MAJOR GOOLSBY'S, INC.	MAJOR GOOLSBY'S	PATRICK J MURPHY, Agt	200 N HARBOR DR Area J	Class B Fermented Malt Beverage Retailer's License		8/16/2023, 7:00 PM	1
45	WISCONSIN HISPANIC SCHOLARSHIP FOUNDATION, INC	MEXICAN FIESTA	Ruben A Burgos, Agt	200 N HARBOR DR	Class B Tavern License		8/23/2023, 7:00 PM	1
46	Maders German Restaurant Inc.	Maders	DANIEL J HAZARD, Agt	200 N Harbor DR Area Q #6	Class B Fermented Malt Beverage Retailer's License		8/30/2023, 7:00 PM	1
47	The Char-Grill, Inc	The Charcoal Grill & Rotisserie	Jeffrey Marsh, Agt	200 N Harbor DR	Class B Fermented Malt Beverage Retailer's License		8/30/2023, 7:00 PM	1
48	Woori Corp	Kanpai	Yosub Yoon, Agt	408 E Chicago ST	Class B Tavern License	99	9/3/2023, 7:00 PM	1
49	Grand Royale LLC	Fauntleroy	Daniel P Jacobs, Agt	316 N MILWAUKEE ST	Class B Tavern License		9/14/2023, 7:00 PM	1
50	GO GROCER MKE, INC.	GO GROCER MKE	John Rivera, Agt	415 E MENOMONEE ST	Class A Malt & Class A Liquor License		9/18/2023, 7:00 PM	1
51	Next Act Theatre, Inc.	Next Act Theatre	David A Cecsarini, Agt	255 S Water ST	Class B Tavern License		9/18/2023, 7:00 PM	1

52	Reign LLC	Reign	Shamia Washington, Agt	231 E BUFFALO ST	Class B Tavern License	250	9/19/2023, 7:00 PM	1
53	Picture Dis LLC	The Lower Level Lounge	STERLING O ODOM, Agt	207 E BUFFALO ST LL10	Class B Tavern License		9/19/2023, 7:00 PM	1
54	ST. PAUL SEAFOOD, LLC	ST. PAUL FISH CO.	TIMOTHY G COLLINS, Agt	400 N WATER ST	Class B Tavern License		9/20/2023, 7:00 PM	1
55	BARTOLOTTA CATERING-PIER WI LLC	BARTOLOTTA CATERING - PIER WI	CHRISTIAN M DAMIANO, Agt	500 N HARBOR DR	Class B Tavern License	250	9/21/2023, 7:00 PM	1
56	BARTOLOTTA CATERING - GRAIN EXCHANGE LLC	BARTOLOTTA CATERING - GRAIN EXCHANGE LLC	CHRISTIAN M DAMIANO, Agt	225 E MICHIGAN ST	Class B Tavern License	299	9/21/2023, 7:00 PM	1
57	BRG ICC LLC	Bartolotta Catering & Events at the Italian Community Center	CHRISTIAN M DAMIANO, Agt	631 E Chicago ST	Class B Tavern License	598	9/21/2023, 7:00 PM	1
58	SRW ACQUISITION , LLC	HARBOR HOUSE	CHRISTIAN M DAMIANO, Agt	550 N HARBOR DR	Class B Tavern License	250	9/21/2023, 7:00 PM	1
59	Sweet Diner LLC	Sweet Diner	George S Prassas, Agt	239 E Chicago ST 103	Class B Tavern License		10/10/2023, 6:11 AM	1
60	SINCERESWAN, LLC	SWINGIN DOOR EXCHANGE	MICHELLE M SINCERE, Agt	219 E MICHIGAN ST	Class B Tavern License	80	10/10/2023, 7:00 PM	1
61	VINO THIRD WARD, LLC	VINO THIRD WARD	Julie L Peck, Agt	102C N WATER ST	Class B Tavern License	41	11/22/2023, 6:00 PM	1
62	The Brownstone LLC	The Brownstone	COREY L SMITH, Agt	524 N Water ST	Class B Tavern License		11/27/2023, 6:00 PM	1
63	CIRCLE K LLC	CIRCLE K PANTRY	ZIAD W KAID, Agt	130 N WATER ST	Class A Malt & Class A Liquor License		12/9/2023, 6:00 PM	1
64	Pat's Rib Place 2, LLC	Pat's Rib Place 2	Tydus D Hayes, Agt	400 N WATER ST	Class B Fermented Malt Beverage Retailer's License		12/11/2023, 6:00 PM	1
65	ALRBAR LLC	The Copper Turtle Brewery & Taverne	Jonathon A Stanley, Agt	153 N MILWAUKEE ST	Class B Tavern License		12/13/2023, 6:00 PM	1
66	CARNAL LLC	CLUB CHARLIES	CRAIG M BLOOMFIELD , Agt	320 E MENOMONEE ST	Class B Tavern License	128	12/14/2023, 6:00 PM	1
67	TwoBirds LLC	Filament	Tyler T Curran, Agt	131 W SEEBOTH ST	Class B Tavern License		12/15/2023, 6:00 PM	1
68	NACAR LLC	Riverfront Pizzeria Bar & Grill	ARTURO NAPOLES CARRERA, Agt	509 E ERIE ST	Class B Tavern License	300	12/15/2023, 6:00 PM	1

69	Full of Beans LLC	Full of Beans Cafe	JoAnn R Hausknecht, Agt	184 S 2nd ST	Class B Fermented Malt Beverage Retailer's License		12/16/2023, 6:00 PM	1
70	Full of Beans LLC	Full of Beans Cafe	JoAnn R Hausknecht, Agt	184 S 2nd ST	Class C Wine Retailer's License		12/16/2023, 6:00 PM	1
71	The Xenia Group, LLC	Tied House	Ralph A Weber, Agt	124 N Water ST	Class B Tavern License		12/17/2023, 6:00 PM	1
72	COMPROV, INC	COMEDY SPORTZ	JOSHUA M LEFEVRE, Agt	420 S 1ST ST	Class B Tavern License	320	1/15/2024, 6:00 PM	1
73	Shake Shack Wisconsin LLC	Shake Shack	ARI B DOMNITZ, Agt	220 E Buffalo ST 110	Class B Fermented Malt Beverage Retailer's License		1/16/2024, 6:00 PM	1
74	Shake Shack Wisconsin LLC	Shake Shack	ARI B DOMNITZ, Agt	220 E Buffalo ST 110	Class C Wine Retailer's License		1/16/2024, 6:00 PM	1
75	S&S Hospitality Concepts, LLC	Black Sheep	MICHAEL R SORGE, Agt	216 S 2nd ST	Class B Tavern License	160	1/19/2024, 6:00 PM	1
76	ANACORP LLC	Cavas	Ana C Docta, Agt	401 E ERIE ST	Class B Tavern License		1/22/2024, 6:00 PM	1
77	Smoke Shack Mke, LLC	Smoke Shack	David J Marcus, Agt	332 N Milwaukee ST	Class B Tavern License	91	2/6/2024, 6:00 PM	1
78	Blue Bat Kitchen MKE, LLC	Blue Bat Kitchen	David J Marcus, Agt	249 N WATER ST	Class B Tavern License	240	2/6/2024, 6:00 PM	1
79	Onesto MKE, LLC	Onesto	David J Marcus, Agt	221-223 N Broadway	Class B Tavern License	288	2/6/2024, 6:00 PM	1
80	THE WICKED HOP, LLC	THE WICKED HOP	MILES E O'NEIL, Agt	343-45 N BROADWAY	Class B Tavern License	160	2/29/2024, 6:00 PM	1

Establishments within a 0.5 miles radius centered on area of interest.



Thursday, April 13, 2023



Notice of Public Hearing

Blank Notice

BURGESS, Evan C, Agent

GIBRALTAR MKE at 131 N JACKSON St

Class B Tavern, Public Entertainment Premises and Food Dealer License Applications Requesting Instrumental Musicians, Disc Jockey, Bands, Karaoke, Poetry Readings, Patron Contests, 200 Concerts p/Yr, Dancing by Performers and Patrons Dancing

Tuesday, April 25, 2023 at 10:30 AM

To whom it may concern:

The above application has been made by the above named applicant(s). This requires approval from the Licenses Committee and the Common Council of the City of Milwaukee. The hearing before the Licenses Committee will take place on 4/25/2023 at 10:30 AM in Room 301-B, Third Floor, City Hall. This is a public hearing. Those wishing to view the proceeding are able to do so via the City Channel – Channel 25 on Spectrum Cable – or on the Internet at <http://city.milwaukee.gov/citychannel>. Those wishing to provide oral testimony via phone or internet are asked to contact the staff assistant, Yadira Melendez at (414) 286-2775 or stasst5@milwaukee.gov for necessary information. Please make such requests no later than one business day prior to the start of the meeting. You are not required to attend the hearing, but please see the information below if you would like to provide testimony. Once the Licenses Committee makes its recommendation, this recommendation is forwarded to the full Common Council for approval at its next regularly scheduled hearing.

Important details for those wishing to provide information for the Licenses Committee to consider when making its recommendation:

1. The license application is scheduled to be heard at the above time. Due to other hearings running longer than scheduled, you may have to wait some time to provide your testimony.
2. You must appear in person and testify as to matters that you have personally experienced or seen. (You cannot provide testimony for your neighbor, parent or anyone else; this is considered hearsay and cannot be considered by the committee.)
3. No letters or petitions can be accepted by the committee (unless the person who wrote the letter or the persons who signed the petition are present at the committee hearing and willing to testify).
4. Persons opposed to the license application are given the opportunity to testify first; supporters may testify after the opponents have finished.
5. When you are called to testify, you will be sworn in and asked to give your name, and address. (If your first and/or last names are uncommon please spell them.)
6. You may then provide testimony.
 - a. Include only information relating to the above license application.
 - b. Include only information you have personally witnessed or seen.
 - c. Provide concise and relevant information detailing how this business has affected or may affect the peaceful enjoyment of your neighborhood.
 - d. If by the time you have the opportunity to testify, the information you wish to share has already been provided to the committee, you may state that you agree with the previous testimony. Redundant or repetitive testimony will not assist the committee in making its recommendation.
7. After giving your testimony, the members of the Licenses Committee and the licensee may ask questions regarding the testimony you have given or other factors relating to the license application.
8. Business Competition is not a valid basis for denial or non-renewal of a license.

Please Note: If you have submitted an objection to the above application your objection cannot be considered by the committee unless you personally testify at the hearing.

CURRENT OCCUPANT	444 E CORCORAN AVE# 608	MILWAUKEE, WI 53202-6166
CURRENT OCCUPANT	444 E CORCORAN AVE# 609	MILWAUKEE, WI 53202-6166
CURRENT OCCUPANT	444 E CORCORAN AVE# 610	MILWAUKEE, WI 53202-6166
CURRENT OCCUPANT	444 E CORCORAN AVE# 611	MILWAUKEE, WI 53202-6166
CURRENT OCCUPANT	444 E CORCORAN AVE# 612	MILWAUKEE, WI 53202-6166
CURRENT OCCUPANT	444 E CORCORAN AVE# 613	MILWAUKEE, WI 53202-6167
CURRENT OCCUPANT	444 E CORCORAN AVE# 614	MILWAUKEE, WI 53202-6167
CURRENT OCCUPANT	444 E CORCORAN AVE# 615	MILWAUKEE, WI 53202-6167
CURRENT OCCUPANT	444 E CORCORAN AVE# 616	MILWAUKEE, WI 53202-6167
CURRENT OCCUPANT	444 E CORCORAN AVE# 617	MILWAUKEE, WI 53202-6167
CURRENT OCCUPANT	444 E CORCORAN AVE# 618	MILWAUKEE, WI 53202-6167
CURRENT OCCUPANT	444 E CORCORAN AVE# 619	MILWAUKEE, WI 53202-6167

Blank Notice

Total Records: 528

Radius 250.0 feet and Center of Circle: 131 N Jackson St



BUSINESS LICENSE PLAN OF OPERATION

ccl-busplan 5/12/2020

Office of the City Clerk License Division
200 E. Wells St. Room 105, Milwaukee, WI 53202
(414) 286-2238 www.milwaukee.gov/license e-mail address: license@milwaukee.gov

1. Type of Business

Applying for: Extended Hours (12AM to 5AM) - If a food establishment, check all that apply: Delivery Drive Thru Dining Room
 Self Service Laundry Massage Establishment Filling Station
 Other (supplemental application for specific license also required)

Provide a detailed description of the type of business you plan on operating:

COCKTAIL LOUNGE WITH LIVE MUSIC

Do you have any experience operating this type of business? No Yes If yes, explain: PREVIOUSLY OPERATED GIBRALTAR IN

2. Business Operations

WALKERS POINT 2015-2018

- a. Proposed Opening Date: _____
- b. Is this premise under construction? No Yes If yes, list estimated completion date: _____
- c. Is this a franchise? No Yes
- d. Is this premises currently licensed? No Yes If yes, list type of license: _____
- e. Is the current licensee operating? No Yes If no, list date closed: _____
- f. Do you have future plans for other businesses, licenses or permits at this location? No Yes
If yes, explain: _____
- g. Have you previously held an Extended Hours License in Milwaukee? No Yes
If yes, list address(es): _____
- h. Are other businesses operating in the same building? No Yes If yes, describe: _____

3. Litter & Noise

- a. How are grounds kept clean? Sweep Pressure Wash Pick Up Litter Other: _____
- b. How often will grounds be cleaned? Daily Weekly As Needed Monthly Other: _____
- c. Grounds cleaned by: Licensee Building Owner Employees Hired Maintenance Other: _____
- d. How are noise issues prevented and/or addressed? Security Manager approaches customer(s) Call Police
 Signs Posted Other: _____
- e. Will a sound amplification system be used? No Yes If yes, describe: MINOR AMPLIFICATION AS NEEDED

4. Smoking & Sanitation

- a. Are there designated outdoor smoking areas? No Yes If yes, describe: _____
- b. Number of Garbage Cans: Inside: 5 Locations: BATHROOMS / BEHIND BAR / OFFICE
Outside: 2 Locations: SPACE DESIGNATED BY OWNER OF BUILDING
- c. Is a crowd control barrier used? No Yes If yes, describe: _____
- d. How many restrooms are on the premises? 2
- e. Name of solid waste contractor: Advanced Disposal Waste Management Other: _____

5. Security

- a. Are there onsite parking spaces? No Yes If yes, how many? 10 and describe the parking security plan: MONITORED BY MANAGEMENT AND SECURITY
- b. Is there a loading zone? No Yes If yes, describe the loading area security plan: _____
- c. Will you have security personnel on premise? No Yes If yes, how many? 2 and answer the following:
 What are their responsibilities? CHECKING IDS, MONITORING PREMISES
 Is security equipment used? No Yes If yes, describe _____
 List their licensing, certification, or training credentials _____
- d. Will there be security cameras? No Yes If yes, how many? 5 and list locations: BEHIND BAR, ENTRANCE, JACKSON ST (OUTDOOR), CORCORAN ST (OUT DOOR) OFFICE
- e. Will searches/identification checks be done upon entry? No Yes If yes, describe SECURITY WILL CHECK

6. Percentage of Sales (must total 100%)

Alcohol <u>80</u> %	Food <u>10</u> %	Secondhand Merchandise _____ %	Precious Metals & Gems _____ %
Entertainment <u>10</u> %	Cigarettes _____ %	Personal Services (such as tattoo, body piercing, salon, tailor, tanning, etc.) _____ %	Other _____ %
Pawnbroker Activity _____ %	Salvaged Materials _____ % (such as scrap metal)		Describe: _____

7. Businesses/Licenses on the Premises (check all that apply):

Type 1

- Full Service Restaurant Cafe/Coffee Shop Deli or Fast Food Restaurant Private/Fraternal/Veterans Club
- Night Club Tavern Cocktail Lounge Teen Club
- Banquet Hall Sports Facility Bowling Alley
- Hotel/Motel: Number of Floors: 1 Number of Rooms: 1
 Rooming House: Number of Floors: 1 Number of Rooms: 1

Type 2

- Liquor Store Corner Store Supermarket Convenience Store
- Gas Station Amusement/Phonograph Distributor Recycling, Salvage or Towing
- Used Car Dealer Personal Service Establishment (such as tattoo business, hair salon, tailor, etc.) Recording Studio

What other licenses/permits will you hold at this location? (check all that apply)

- Occupancy Permit Cigarette & Tobacco Gas Station Extended Hours Class "B" Tavern Weights & Measures
- Secondhand Dealer Precious Metal & Gem Other: _____

8. Legal Capacity (only if a Type 1 premises in #7 above)

Capacity 129 (INSIDE) (Call the Milwaukee Development Center at 414-286-8211 if you have questions.)

9. Premises Description

- a. Identify all area(s) of the premises that will be used in operating this business (include areas used only for storage):
 1st Floor 2nd Floor Basement Storage Patio Beer Garden Sidewalk Café Deck Rooftop
 EC/B EC/B
 Other: Describe: _____
- b. Describe Location: Major Thoroughfare Secondary Street Other: _____
- c. Nearest Major Cross Street: JACKSON STREET
- d. Describe Building: Free Standing Building Strip Mall Other: _____
- e. Describe Premises Structure: Single Story Multi-Story - # of Stories 6 Other: _____
- f. Describe Surrounding Area: Commercial Residential Industrial Other: _____
- g. Building Owner Name: JAMES WEICHMANN Phone Number: (414) 254-5411
 Building Owner Address: 1010 N. CASS ST. MILWAUKEE WI 53202

10. Hours of Operation & Customers

Will customers be entering the premises? No Yes

Day of the Week	Proposed Hours of Operation:		Estimated Number of Customers expected each day	Potential Age Range of Customers	Class B Tavern Applicant Only: Age Restriction (If none, write 'None')
	Open Time (include a.m. or p.m.)	Close Time (include a.m. or p.m.)			
Sunday	1 pm	2 am	50	21-65	NONE
Monday	1 pm	2 am	50	21-65	NONE
Tuesday	1 pm	2 am	50	21-65	NONE
Wednesday	1 pm	2 am	70	21-65	NONE
Thursday	1 pm	2 am	70	21-65	NONE
Friday	1 pm	2 am	130	21-65	NONE
Saturday	1 pm	2 am	130	21-65	NONE

An Extended Hours Establishment License is required for any convenience store, filling station, personal service establishment (such as tattoo, body piercing, salon, tailor, tanning, etc.), recording studio or restaurant which is open between the hours of 12:00 a.m. and 5:00 a.m.

Alcohol Establishments Class A: 8:00 am to 9:00 pm Sunday thru Saturday
 Permitted Hours of Operation: Class B: 6:00 am to 2:00 am Sunday thru Thursday, 6:00 am to 2:30 am Friday & Saturday

Entertainment Outdoor Closing Hours: 10:00pm Sunday-Thursday; 12:00am Friday & Saturday; unless a different time, either earlier or later, is established by the Common Council in its approval of the licensee's plan of operation.

11. Signature(s)

 Signature of Sole Proprietor, Partner, or 20% or more Shareholder
 (If there are no 20% or more shareholders,
 Corporate Officer-print name/title and sign)

 Signature of additional partner or 20% or more shareholder

See Application Information for a complete list of all required application forms.

Lease Information (Continued)

- f) In addition to paying the monthly rental, will you have to pay anything additional to the owner of the building to guarantee performance of the lease? No Yes If yes, explain _____
- g) Does the present owner or occupant object to the granting of your license? No Yes
If yes, explain _____

Change of Agent Applicants Only

Have there been any changes to the floor plan since the last application was submitted? No Yes
If no, a new floor plan is not required. If yes, submit a new floor plan and explain the change(s):

Signature

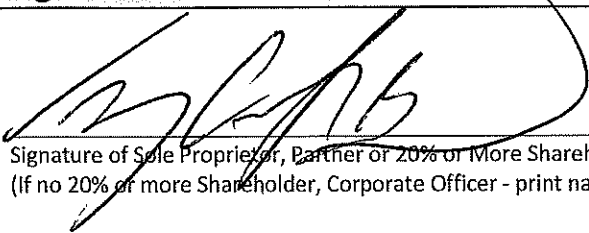

Signature of Sole Proprietor, Partner or 20% or More Shareholder
(If no 20% or more Shareholder, Corporate Officer - print name/title and sign)

Note: All information contained in this application is subject to approval by the Common Council.
Deviating from approved plan of operation will subject licensee to citations, and/or suspension or non-renewal of the license.
Contact the License Division for information on how to request changes.

New and transfer of premises applicants must submit the following:

- Detailed floor plan
- If a restaurant, copy of the menu



**ALCOHOL BEVERAGE & PUBLIC ENTERTAINMENT PREMISES
SUPPLEMENTAL APPLICATION**

Office of the City Clerk License Division
200 E. Wells St. Room 105, Milwaukee, WI 53202
(414) 286-2238 e-mail address: license@milwaukee.gov www.milwaukee.gov/license

Legal Entity Name: Rock of Gibraltar LLC
 Premise Address: 131 N. JACKSON Milwaukee WI 53202

Proximity of Premises to Church, School, Daycare Center or Hospital

Is the building within 300 feet of any church, school, daycare center or hospital? No Yes

"Service Bar Only" Designation

If applying for Class B or C license, are you applying for "Service Bar Only"? No Yes
 Service Bar Only means customers cannot sit at the bar. Alcohol is served to employees who serve patrons seated at tables. No stools, chairs or other articles of furniture shall be placed at the service bar for patrons to sit upon.

Business Information

a) Are you taking out this application for anyone that may not be eligible for a license? No Yes
 If yes, list their name and address: _____

b) Will the agent, a partner or the individual licensee be conducting the day-to-day operations of the business? No Yes
 If no, list the name and address of the person(s) who will: _____

Class B Applicants: If the agent, a partner or the individual licensee will not be conducting the day-to-day operations of the business, the person(s) listed above must obtain a Class B Managers license.

c) Does anyone else have money invested or any other interest in this business? No Yes
 If yes, explain: _____

d) Have you made an agreement with anyone to repay any loan or any other payments based upon income from the business? No Yes If yes, list name and address: _____

Property Information (New & Transfer Applicants Only)

a) Do you own or lease the building? Own Lease

b) Who owns the fixtures (for example, coolers, etc.)? ME

c) Are you purchasing the stock and/or fixtures? No Yes If yes, amount paid \$ _____

d) Total amount paid for business \$ _____

e) Total amount paid for goodwill of the business \$ _____

Goodwill comprises the reputation and customer relationships of an existing business. If the price you pay for the business exceeds the fair market value of all of the rest of the assets of the business, the excess may be considered goodwill.

f) Have you made arrangements with the seller for payment of personal property taxes? No Yes

Lease Information (New & Transfer Applicants who are leasing the premises only)

a) Date lease begins _____ Ends _____

b) Monthly rental \$ 3200

c) Do you have an option to renew the lease? No Yes

d) Does your lease allow for assignment to another party without the consent of the owner? No Yes

e) For what length of time have you been guaranteed occupancy (number of years)? 3



PUBLIC ENTERTAINMENT PREMISES LICENSE SUPPLEMENTAL APPLICATION

Office of the City Clerk License Division
200 E. Wells St. Room 105, Milwaukee, WI 53202
(414) 286-2238 www.milwaukee.gov/license e-mail address: license@milwaukee.gov

PREMISES ADDRESS:

TYPES OF ENTERTAINMENT (CHECK ALL THAT APPLY)

<input checked="" type="checkbox"/> Instrumental Musicians	<input type="checkbox"/> Battle of the Bands	<input checked="" type="checkbox"/> Dancing by Performers	<input type="checkbox"/> Amusement Machines How many? _____
<input checked="" type="checkbox"/> Bands	<input type="checkbox"/> Comedy Acts	<input checked="" type="checkbox"/> Adult Entertainment/ Strippers/Erotic Dance	<input checked="" type="checkbox"/> Concerts Approx. # per year? <u>200</u>
<input type="checkbox"/> Bowling Alley How many? _____	<input checked="" type="checkbox"/> Disc Jockey	<input type="checkbox"/> Wrestling	<input type="checkbox"/> Theatrical Performances Approx. # per year? _____
<input type="checkbox"/> Pool Tables How many? _____	<input type="checkbox"/> Magic Shows	<input checked="" type="checkbox"/> Patron Contests	<input type="checkbox"/> Jukebox
<input type="checkbox"/> Motion Pictures (movies by admission) - How many? _____	<input checked="" type="checkbox"/> Poetry Readings	<input checked="" type="checkbox"/> Patrons Dancing	<input checked="" type="checkbox"/> Karaoke
<input type="checkbox"/> Other: _____			

Entertainment Outdoor Closing Hours: 10:00pm Sunday-Thursday; 12:00am Friday & Saturday; unless a different time, either earlier or later, is established by the Common Council in its approval of the licensee's plan of operation.

PROMOTERS/SOUND AMPLIFICATION

Will promoters ever be used for any of the entertainment? No Yes If Yes, Describe:
TO AID IN LOCAL PROMOTION OF CERTAIN PERFORMERS

At any time will sound amplification be used? No Yes If Yes, Describe:
AS NEEDED FOR MUSICIANS / DJ'S

LEGAL CAPACITY OF PREMISES

_____ (Call the Development Center at 414-286-8211 with questions.) Legal capacity determines the fee for your Public Entertainment Premises License. If you would like to request the license be approved with a lower capacity than that listed above, indicate the lower capacity here: _____. If approved, this lower capacity will print on your license and override the capacity listed on your Occupancy Permit.

ACKNOWLEDGEMENT/SIGNATURE

I understand that after the license has been issued, a change to the plan of operation will require a written request to change and approval from the Common Council. I agree to inform the City Clerk within 10 days of any substantial changes in the information supplied in this application. I understand that I shall not willfully refuse to provide the services offered under this license, or add charges or require deposits not required of the general public because of race, color, sex, religion, national origin or ancestry, age, handicap, lawful source of income, marital status, sexual orientation, gender identity or expression, familial status or the fact that a person is now or has been a member of the military service, whether dressed in uniform or not; and shall not seek such information as a condition of employment, or penalize any employee or discriminate in the selection of personnel for training or promotion on the basis of such information.

I have knowledge of the City Ordinances currently regulating public entertainment, and understand that the license may be subject to suspension, non-renewal or revocation, if I violate any rule, law or regulation of the city of Milwaukee and State of Wisconsin.

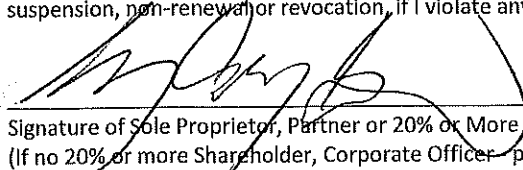

Signature of Sole Proprietor, Partner or 20% or More Shareholder
(If no 20% or more Shareholder, Corporate Officer - print name/title and sign)

Office Use Only:

Initials: _____ Filed: _____ App: _____

Only PEP? No Yes If Yes, Queue to MPD and Email Mgrs/Team Lead (must be heard w/in 60 days)



FOOD DEALER LICENSE PLAN OF OPERATION

ccl-foodplan 2/28/19

OFFICE OF THE CITY CLERK, LICENSE DIVISION
CITY HALL, 200 E. WELLS ST, ROOM 105, MILWAUKEE, WI 53202
(414) 286-2238 • license@milwaukee.gov • www.milwaukee.gov/license

Legal Entity Name: ROCK of GIBBANTAN LLC

Premises Address: 131 N. JACKSON Milwaukee WI 53202

SECTION 1 TYPE OF BUSINESS

What will be the majority of your food sales? (check one)

Restaurant Items (meals):
MEALS include, but are not limited to, chicken, ribs, sandwiches, roasted corn, baked potatoes, hot dogs, brats, tacos, nachos w/ cheese and meat, French fries, cooked or deep fried vegetables/fruit, cooked cheese curds, corn dogs, egg rolls, salads.

Retail Items (snacks and beverages):
RETAIL Items include, but are not limited to, ice cream/soft serve, lemonade, snow cones, coffee, espresso, cappuccino, tea, fruit juice, smoothies, candy, dispensed soda, fruit cups, bakery, cookies, kettle corn, cotton candy, funnel cakes, fritters, tortilla chips w/ cheese.

Will it be a convenience store? Yes No

A convenience store contains less than 5,000 square feet of retail space and has, as its primary business, the sale of basic food items and in addition, sells household products or is a filling station that sells basic food items and household products.

Bed & Breakfast

Micro Market

All Applicants: Submit a menu or a list of food items that will be sold.

Will any wholesale business be done? No Yes If yes, what percentage of food sales will be wholesale?

Less than 25%

25% or More AND:

Restaurant items (meals) will be sold – Complete this application and also contact DATCP.

NO restaurant items (meals) will be sold - Do NOT complete this application. Contact DATCP only.

SECTION 2 FOOD PROCESSING

Will any food processing be done? ^{EBP} No Yes

Processing is defined as assembling, grinding, cutting, mixing, baking, coating, stuffing, packing, bottling, grilling, canning, extracting, fermenting, distilling, pickling, freezing, drying, smoking, or packaging.

SECTION 3 FOOD REQUIRING TEMPERATURE CONTROL

Will any food that requires temperature control be sold? ^{EBP} No Yes
(includes dairy products such as milk, cheese, and ice cream, fish, shellfish, meat, poultry)

If yes, list the types of food items: CHOCOLATE PIZZA

SECTION 4 DETAILS OF OPERATION

- Will you have seating on site for dining? No Yes
- Will you be doing any catering? No Yes
- Will you be doing any delivery? No Yes
- Will you have outdoor activities? No Yes - Check all that apply: Bar Cooking/Grilling Dining
- Will you have a drive thru window? No Yes - Are hours different from inside? No Yes
 If Yes, provide drive thru hours: _____
- Will scales or barcode scanners be used? No Yes - You must also apply for a Weights & Measures License.

SECTION 5 ADDITIONAL SITES

Where will food be prepared and/or sold?
 At a single site At multiple sites: How many? _____ (for example, a hotel with several dining rooms or bars)
 If multiple sites, attach a Food Dealer Additional Site Addendum (ccl-foodadd) for each additional site.

SECTION 6 CONSTRUCTION OR CHANGES

Are you planning any construction, remodeling or equipment changes?
 No If No, SKIP to Section 8
 Yes If Yes, check all that apply: New construction of a building Renovation or remodeling
 Construction changes to existing building Equipment changes only

Provide a brief description of the changes: _____
 Start date: _____
 Name, Address & Phone Number of Architect: _____

 Name, Address & Phone Number of Contractor: _____

SECTION 7 ALCOHOL BEVERAGES

Are you applying for an alcohol beverage license?
 No If No, SKIP to Section 9
 Yes If YES, if your food license is approved prior to the alcohol license, when do you want the food license issued?
 Immediately At the same time as the alcohol license

SECTION 8 ACKNOWLEDGEMENTS & SIGNATURE

You must initial each item confirming your understanding:

- RCS I understand the Health Department must conduct an inspection and advise the License Division of their approval before the license may be issued.
- RCS I understand I must obtain an occupancy permit from the Department of Neighborhood Services and an inspection may be required. Neighborhood Services must advise the License Division of their approval before the license may be issued.
- RCS I understand the district alderperson will review and either support or object to my application. If he/she objects, I may appeal and be scheduled to appear before the Licenses Committee. The Licenses Committee will then make a recommendation to the Common Council. The Common Council must grant the license before it may be issued.
- RCS I understand proof of payment for all license fees must be on file in the License Division before the license may be issued and the license must be issued and posted in my establishment prior to opening for business.
- RCS I will not operate my food business until the license has been issued and posted in the establishment.

Signature of Sole Proprietor, Partner, or 20% Shareholder: [Signature]

Signature of Additional Partner: _____

N Jackson St.



SIDEWALK SEATING

43' X 5'

55'

enter/exit

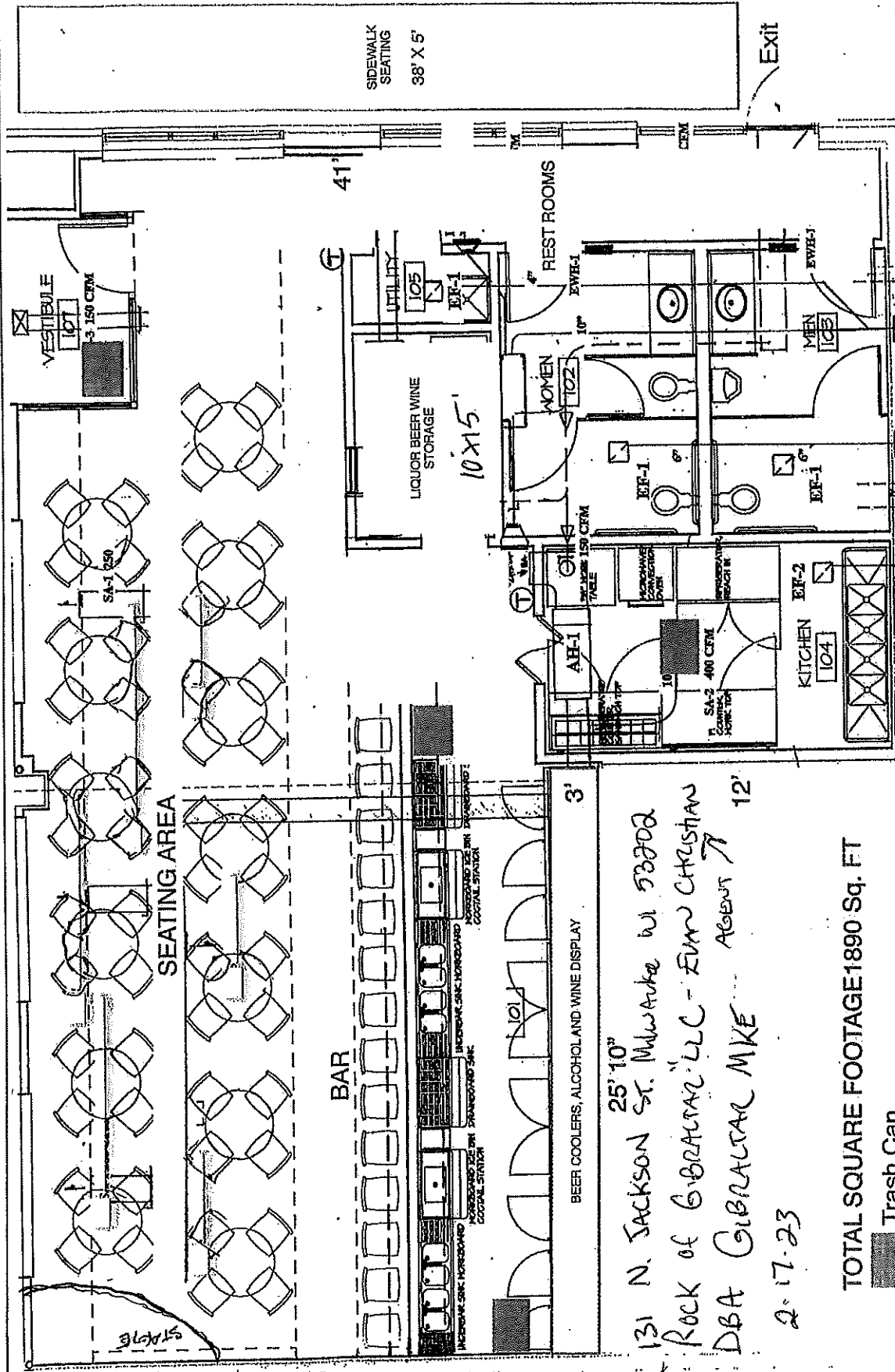

SIDEWALK SEATING 38' X 5'

Exit

BAR

SEATING AREA

LIQUOR BEER WINE STORAGE 10x15

REST ROOMS

KITCHEN 104

131 N. JACKSON ST. MILWAUKEE WI 53202
 ROCK OF GIBRALTAR LLC - EVAN CHRISTIAN
 DBA GIBRALTAR MKE AGENT 7 12'
 2.17.23

TOTAL SQUARE FOOTAGE 1890 Sq. FT

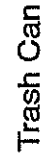

Trash Can

E Corcoran St.

29' 2"

29'

MENU

- 1) PRE PACKAGED PIZZA
- 2) CHARCUTERIE BOARD
- 3) OLIVE PLATE
- 4) BREAD, OLIVE OIL, BASALMIC VINEGAR
- 5) CHEESE PLATE

* CONVECTION OVEN

(1) AIR FRYER