

D&D #3042

MILWAUKEE COUNTY CERTIFIED SURVEY MAP NO. _____

BEING A DIVISION OF PART OF LOTS 1, 2 AND 3, IN KIEFER'S SUBDIVISION AND PART OF LOT 13, BLOCK 1, IN R. STEWART'S SUBDIVISION, ALSO PART OF VACATED E. ARCHER AVENUE AND THE NORTH 1/2 OF THE VACATED E. BRUNK'S LANE, ALL LOCATED IN THE SOUTHWEST 1/4 OF THE SOUTHWEST 1/4 OF SECTION 4, TOWN 6 NORTH, RANGE 22 EAST IN THE CITY OF MILWAUKEE, MILWAUKEE COUNTY, WISCONSIN.

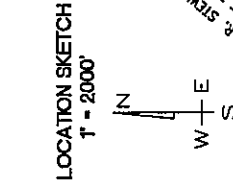
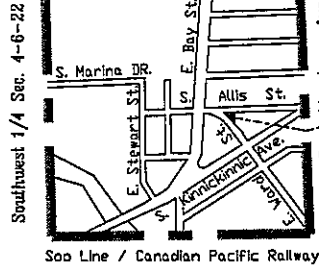

ANGLE CHART	
A	89°53'56"
B	90°08'05"
C	131°25'33"
D	183°41'44"
E	50°54'16"
F	173°56'28"

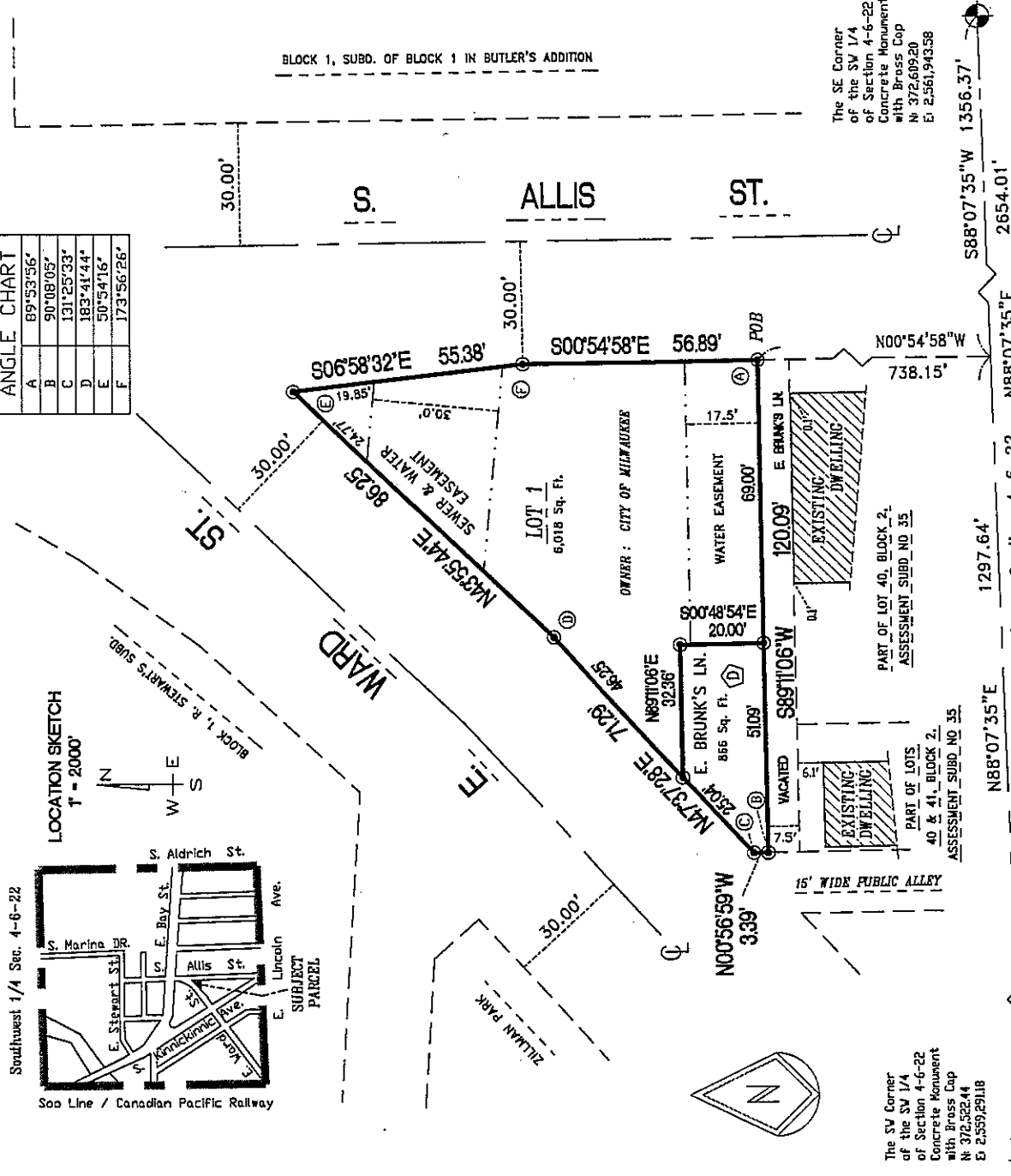

ALL BEARINGS ARE REFERENCED TO THE SOUTH LINE OF THE SOUTHWEST 1/4 OF SECTION 4-6-22, WHICH IS ASSUMED TO BEAR N 88°07'35" E, W. STATE PLANE COORDINATE SYSTEM SOUTH ZONE PER JAN, 2015 C.S.S.D.

Ⓧ - DEDICATED TO THE CITY OF MILWAUKEE FOR PUBLIC STREET PURPOSES.

Ⓞ - DENOTES SET 3/4" X 18" LONG IRON REBAR WEIGHING 118 LBS. PER LINEAL FOOT.



735 NORTH WATER STREET, SUITE 1000 MILWAUKEE, WI 53202 414.224.8300 (cell) - 414.224.8383 (fax)

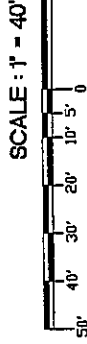

SCALE: 1" = 40'

Frederick W. Shibilski
FREDERICK W. SHIBILSKI S - 1154

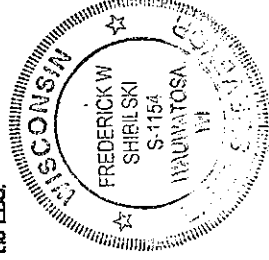

JUNE 24, 2015

INSTRUMENT DRAFTED BY : MARC C. PASSARELLI JOB NO. 34298-C5M-E SHEET 1 OF 4

INFRASTRUCTURE SERVICES DIVISION
 CENTRAL DRAFTING & RECORDS MANAGER
8/25/15
 ENGR. IN CHARGE / ENVIRON. ENGR.
 CORRECT
 CITY ENGINEER APPROVED
8/26/15

DEPARTMENT OF CITY DEVELOPMENT
CITY OF MILWAUKEE

JUL 27 2015
MARC C. PASSARELLI
STAFF APPROVED

MILWAUKEE COUNTY CERTIFIED SURVEY MAP NO. _____

BEING A DIVISION OF PART OF LOTS 1, 2 AND 3, IN KIEFER'S SUBDIVISION AND PART OF LOT 13, BLOCK 1, IN R. STEWART'S SUBDIVISION, ALSO PART OF VACATED E. ARCHER AVENUE AND THE NORTH ½ OF THE VACATED E. BRUNK'S LANE, ALL LOCATED IN THE SOUTHWEST ¼ OF THE SOUTHWEST ¼ OF SECTION 4, TOWN 6 NORTH, RANGE 22 EAST IN THE CITY OF MILWAUKEE, MILWAUKEE COUNTY, WISCONSIN.

SURVEYOR'S CERTIFICATE
STATE OF WISCONSIN,
MILWAUKEE COUNTY) ss

I, Frederick W. Shibilski, a registered land surveyor do hereby certify:

That I have surveyed, divided and mapped part of Lots 1, 2 and 3, in Kiefer's Subdivision and part of Lot 13, Block 1, in R. Stewart's Subdivision, also part of vacated E. Archer Avenue and the North ½ of the vacated E. Brunk's Lane, all located in the Southwest ¼ of Section 4, Town 6 North, Range 22 East in the City of Milwaukee, Milwaukee County, Wisconsin bounded and described as follows: Commencing at the Southeast corner of the Southwest ¼ of Section 4; thence South 88° 07' 35" West along the South line of said ¼ Section, 1356.37 feet; thence North 00° 54' 58" West, 738.15 feet to the point of beginning of the land to be described; thence South 89° 11' 06" West, 120.09 feet to a point on the East line of a 15 foot wide public alley; thence North 00° 56' 59" West along said East line, 3.39 feet; thence North 47° 37' 28" East, 71.29 feet; thence North 43° 55' 44" East, 86.25 feet; thence South 06° 58' 32" East, 55.38 feet; thence South 00° 54' 58" East, 56.89 feet to the point of beginning.

That I have made such survey, land division and map by the direction of the City of Milwaukee, owner of said land.

That this map is a correct representation of all exterior boundaries of land surveyed and the land division thereof made.

That I have fully complied with the provisions of Chapter 236 of the Wisconsin Statutes and Chapter 119 of the Milwaukee Code in surveying, dividing and mapping the same.

Dated June 24, 2015.

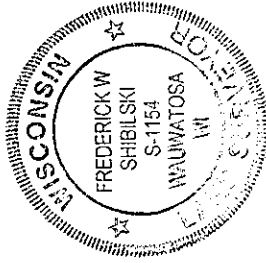

Frederick W. Shibilski
Frederick W. Shibilski S-1154
Wisconsin Reg. Land Surveyor

MILWAUKEE COUNTY CERTIFIED SURVEY MAP NO. _____

BEING A DIVISION OF PART OF LOTS 1, 2 AND 3, IN KIEFER'S SUBDIVISION AND PART OF LOT 13, BLOCK 1, IN R. STEWART'S SUBDIVISION, ALSO PART OF VACATED E. ARCHER AVENUE AND THE NORTH 1/2 OF THE VACATED E. BRUNK'S LANE, ALL LOCATED IN THE SOUTHWEST 1/4 OF THE SOUTHWEST 1/4 OF SECTION 4, TOWN 6 NORTH, RANGE 22 EAST IN THE CITY OF MILWAUKEE, MILWAUKEE COUNTY, WISCONSIN.

CORPORATE OWNERS CERTIFICATE:

The City of Milwaukee, a corporation duly organized and existing under and by virtue of the laws of the State of Wisconsin as owner, does hereby certify that said corporation caused the land described on this map to be surveyed, divided, dedicated and mapped as represented on this map in accordance with the requirements of Chapter 119 of the Milwaukee Code of Ordinances.

In consideration of the approval of this map by the Common Council, and in accordance with Chapter 119 of the Milwaukee Code of Ordinances, the undersigned agrees:

- a. That all utility lines to provide electric power and telephone services and cable television or communications systems lines or cables to all parcels in the certified survey map shall be installed underground in easements provided therefor, where feasible.

This agreement shall be binding on the undersigned and assigns.

IN WITNESS WHEREOF, the said City of Milwaukee has caused these presents to be signed by Tom Barrett, its Mayor and countersigned by James Owczarski, its City Clerk, and Martin Matson, its City Comptroller, at Milwaukee, Wisconsin, on this 19th day of October, 2015.

In the Presence of:

A. Peterson
Terry J. MacDonald
Sharon K. Kraft

The City of Milwaukee

Tom Barrett
 Tom Barrett, Mayor
James Owczarski
 James Owczarski, City Clerk
Martin Matson
 Martin Matson, City Comptroller

STATE OF WISCONSIN)
MILWAUKEE COUNTY)SS

Personally came before me this 19th day of October, 2015, the above named Tom Barrett, Mayor of the above named Corporation, to me known to be the person who executed the foregoing instrument and to me known to be such Mayor of said Corporation and acknowledged that he executed the foregoing instrument as such officer as the deed of said Corporation by its authority.

Terry J. MacDonald
 Notary Public, State of Wisconsin
 My Commission expires 11/15/15

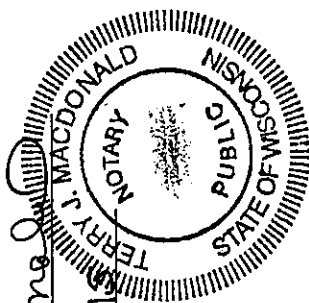

STATE OF WISCONSIN)
MILWAUKEE COUNTY)SS

Personally came before me this 19th day of October, 2015, the above named James Owczarski, City Clerk, of the above named Corporation, to me known to be the person who executed the foregoing instrument and to me known to be such City Clerk of said Corporation and acknowledged that he executed the foregoing instrument as such officer as the deed of said Corporation by its authority.

Terry J. MacDonald
 Notary Public, State of Wisconsin
 My Commission expires 11/15/15

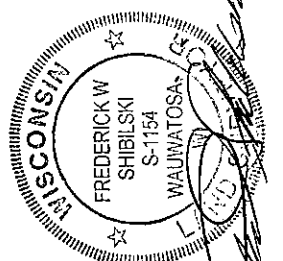

Frederick W. Shibilski
 Notary Public, State of Wisconsin
 My Commission expires 11/15/15

MILWAUKEE COUNTY CERTIFIED SURVEY MAP NO. _____

BEING A DIVISION OF PART OF LOTS 1, 2 AND 3, IN KIEFER'S SUBDIVISION AND PART OF LOT 13, BLOCK 1, IN R. STEWART'S SUBDIVISION, ALSO PART OF VACATED E. ARCHER AVENUE AND THE NORTH 1/2 OF THE VACATED E. BRUNK'S LANE, ALL LOCATED IN THE SOUTHWEST 1/4 OF THE SOUTHWEST 1/4 OF SECTION 4, TOWN 6 NORTH, RANGE 22 EAST IN THE CITY OF MILWAUKEE, MILWAUKEE COUNTY, WISCONSIN.

CORPORATE OWNERS CERTIFICATE (CONTINUED):

STATE OF WISCONSIN)
MILWAUKEE COUNTY)SS

Personally came before me this 27th day of October, 2015, the above named Martin Matson, City Comptroller, of the above named Corporation, to me known to be the person who executed the foregoing instrument and to me known to be such City Comptroller of said Corporation and acknowledged that he executed the foregoing instrument as such officer as the deed of said Corporation by its authority.



Notary Public, State of Wisconsin
My Commission expires 6-22-2019



CERTIFICATE OF CITY TREASURER
STATE OF WISCONSIN)
MILWAUKEE COUNTY)SS

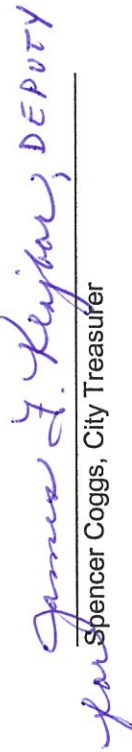

I, Spencer Coggs, being the duly elected, qualified and acting City Treasurer of the City of Milwaukee, certify that in accordance with the records in the Office of the City Treasurer of the City of Milwaukee there are no unpaid taxes or unpaid special assessments on the land included in this Certified Survey Map.

Date: 09/02/2015

Spencer Coggs, City Treasurer

COMMON COUNCIL CERTIFICATE OF APPROVAL

I certify that this Certified Survey Map was approved under Resolution File No. 150612, adopted by the Common Council of the City of Milwaukee on October 13, 2015.

James Owczarski, City Clerk

Tom Barrett, Mayor



