

DD# 2480

MILWAUKEE COUNTY CERTIFIED SURVEY MAP NO. _____

BEING A DIVISION OF LOT 5 AND THE NORTH 7 FEET OF THE VACATED ALLEY ADJACENT ON THE SOUTH, BLOCK 9, IN GARFIELD HEIGHTS SUBDIVISION, AND LOT 5, BLOCK 3, IN MILLER'S PARK SUBDIVISION ALL LOCATED IN THE SOUTHEAST 1/4 OF THE NORTHEAST 1/4 OF SECTION 24, TOWN 7 NORTH, RANGE 21 EAST, CITY OF MILWAUKEE, MILWAUKEE COUNTY, WISCONSIN.

TAX KEY NO. 349-0972-100 ZONING: RT4

The Southwest corner of the Northeast 1/4 of Section 24-7-21
N 1 390.56164
E 1 234.306339

The Southwest Measur Corner of the Northeast 1/4 of Section 24-7-21 Conc. Mon. with Brass Cap
N 1 390.561649
E 1 234.306338

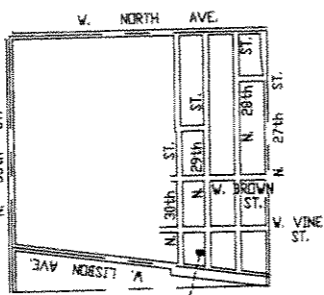

LOCATION SKETCH
NORTHEAST 1/4 SECTION 24-7-21
1" = 2000'

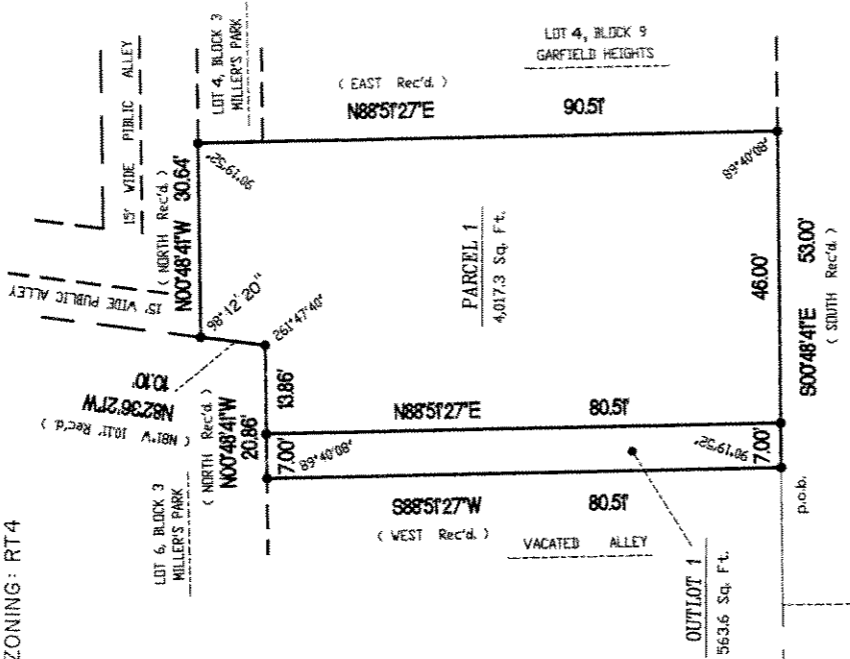

The South line of the Northeast 1/4 of Section 24-7-21

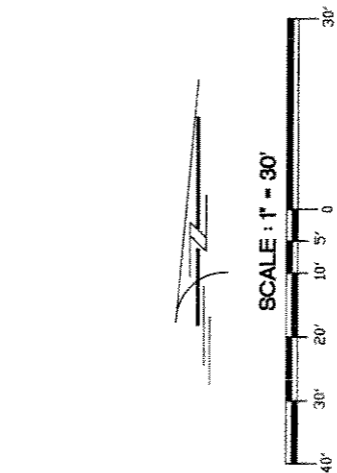

The Southeast corner of the Northeast 1/4 of Section 24-7-21 Conc. Mon. with Brass Cap
N 1 390.561635
E 1 234.653837

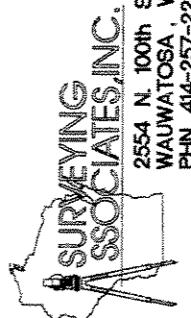

2554 N. 100th STREET
WAUWATOSA, WI 53226
PH-N 414-257-2212
FAX 414-257-2443

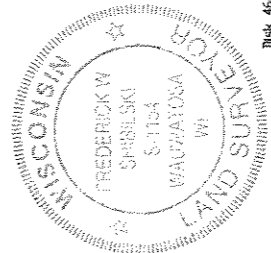

- - DENOTES SET 3/4" X 18" LONG IRON REBAR WEIGHING 15 LBS. PER LINEAL FOOT.
- ALL BEARINGS ARE REFERENCED TO THE SOUTH LINE OF THE NORTHEAST 1/4 OF SECTION 24-7-21, WHICH IS ASSUMED TO BEAR N 88°31'38" E, STATE PLANE COORDINATE SYSTEM SOUTH ZONE JUNE 2003 DATUM.

Frederick W. Shibilski

FREDERICK W. SHIBILSKI S - 1154

INSTRUMENT DRAFTED BY : WILLIAM J. KARPEN

DEPARTMENT OF CITY DEVELOPMENT
CITY OF MILWAUKEE

APR 22 2005

William J. Karpen
STAFF APPROVED

INFRASTRUCTURE SERVICES DIVISION

Marcia Smelchak 5/12/05
CENTRAL DRAFTING & RECORDS MANAGER

Tammy J. Thum 5/12/05
ENGR. IN CHARGE ENVIRON. ENGR.

Frederick W. Shibilski 5/16/05
CITY ENGINEER
APPROVED

Blk# 466
JOB NO. 30796 CSM

SHEET 1 OF 3

DUD# 2480

MILWAUKEE COUNTY CERTIFIED SURVEY MAP NO. _____

BEING A DIVISION OF LOT 5 AND THE NORTH 7 FEET OF THE VACATED ALLEY ADJACENT ON THE SOUTH, BLOCK 9, IN GARFIELD HEIGHTS SUBDIVISION, AND LOT 5, BLOCK 3, IN MILLER'S PARK SUBDIVISION ALL LOCATED IN THE SOUTHEAST ¼ OF THE NORTHEAST ¼ OF SECTION 24, TOWN 7 NORTH, RANGE 21 EAST, CITY OF MILWAUKEE, MILWAUKEE COUNTY, WISCONSIN.

SURVEYOR'S CERTIFICATE
STATE OF WISCONSIN)
MILWAUKEE COUNTY)SS

I, Frederick W. Shibilski, a registered land surveyor do hereby certify:

That I have surveyed, divided and mapped Lot 5 and the North 7 feet of the vacated alley adjacent on the South, Block 9, in Garfield Heights Subdivision, and Lot 5, Block 3, in Miller's Park Subdivision, all located in the Southeast ¼ of the Northeast ¼ of Section 24, Town 7 North, Range 21 East, City of Milwaukee, Milwaukee County, Wisconsin, bounded and described as follows: Commencing at the Southeast corner of the Northeast ¼ of Section 24; thence South 88° 31' 38" West along the South line of said ¼ Section, 660.29 feet; thence North 00° 48' 41" West, 332.49 feet to the point of beginning of the land to be described; thence South 88° 51' 27" West, 80.51 feet; thence North 00° 48' 41" West, 20.86 feet; thence North 82° 36' 21" West, 10.10 feet; thence North 00° 48' 41" West, 30.64 feet; thence North 88° 51' 27" East, 90.51 feet; thence South 00° 48' 41" East, 53.00 feet to the point of beginning.

That I have made such survey, land division and map by the direction of Milwaukee Habitat for Humanity, Inc., owner of said land.

That such map is a correct representation of the exterior boundaries of the land surveyed and the land division thereof made.

That I have fully complied with the provisions of Chapter 236 of the Wisconsin Statutes and Chapter 119 of the Milwaukee Code of Ordinances in surveying, dividing and mapping the same.

Dated this 7th day of April 2005.

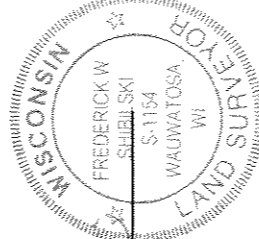
Frederick W. Shibilski S-1154
Wisconsin Reg. Land Surveyor

CORPORATE OWNERS CERTIFICATE:

Milwaukee Habitat for Humanity, Inc., a corporation duly organized and existing under and by virtue of the laws of the State of Wisconsin as owner, does hereby certify that said corporation caused the land described on this map to be surveyed, divided, and mapped as represented on this map in accordance with the requirements of Chapter 119 of the Milwaukee Code of Ordinances.



In consideration of the approval of this map by the Common Council, and in accordance with Chapter 119 of the Milwaukee Code of Ordinances, the undersigned agrees:

- a. That all utility lines to provide electric power and telephone services and cable television or communications systems lines or cables to all parcels in the certified survey map shall be installed underground in easements provided therefor, where feasible.



This agreement shall be binding on the undersigned and assigns.

IN WITNESS WHEREOF, the said Milwaukee Habitat for Humanity, Inc., has caused these presents to be signed by Ruth Kallio-Mielke, its President, David Schwab, its Secretary and by Jack West, its Treasurer, at Milwaukee, Wisconsin, on this 14th day of April, 2005.

In the Presence of:

Milwaukee Habitat for Humanity, Inc.

Ruth Kallio-Mielke, President

David Schwab, Secretary

Jack West, Treasurer

DIP # 2480

MILWAUKEE COUNTY CERTIFIED SURVEY MAP NO. _____

BEING A DIVISION OF LOT 5 AND THE NORTH 7 FEET OF THE VACATED ALLEY ADJACENT ON THE SOUTH, BLOCK 9, IN GARFIELD HEIGHTS SUBDIVISION, AND LOT 5, BLOCK 3, IN MILLER'S PARK SUBDIVISION ALL LOCATED IN THE SOUTHEAST ¼ OF THE NORTHEAST ¼ OF SECTION 24, TOWN 7 NORTH, RANGE 21 EAST, CITY OF MILWAUKEE, MILWAUKEE COUNTY, WISCONSIN.

CORPORATE OWNERS CERTIFICATE (CONTINUED):

STATE OF WISCONSIN)
MILWAUKEE COUNTY)SS

Personally came before me this 14th day of April, 2005, the above named Ruth Kallio-Mielke, David Schwab, and Jack West of the above named Corporation, to me known to be the persons who executed the foregoing instrument and to me known to be such President, Secretary and Treasurer of said Corporation and acknowledged that they executed the foregoing instrument as such officers as the deed of said Corporation by its authority.

Shane Kueyik
Notary Public, State of Wisconsin
My Commission expires 9-18-05

CERTIFICATE OF CITY TREASURER
STATE OF WISCONSIN)
MILWAUKEE COUNTY)SS

I, Wayne F. Whitlow, being the duly elected, qualified and acting City Treasurer of the City of Milwaukee, certify that in accordance with the records in the Office of the City Treasurer of the City of Milwaukee there are no unpaid taxes or unpaid special assessments on the land included in this certified survey map.

Date: 5-17-05
Wayne F. Whitlow
Wayne F. Whitlow, City Treasurer

COMMON COUNCIL CERTIFICATE OF APPROVAL

I certify that this Certified Survey Map was approved under Resolution File No. 050111, adopted by the Common Council of the City of Milwaukee on May 23, 2005.

Ronald D. Leonhardt
Ronald D. Leonhardt, City Clerk
Thomas Barrett
Thomas Barrett, Mayor

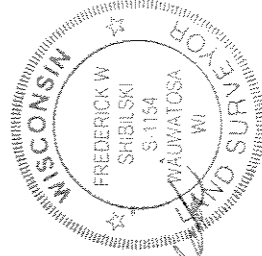

William J. Karpen