



**CITY OF MILWAUKEE
OFFICE OF THE CITY CLERK**

Wednesday, December 16, 2020

COMMITTEE MEETING NOTICE

AD 15

ABOHADBA, Yasser, Agent
Brother Plus Grocery LLC
4020 W NORTH Av

Milwaukee, WI 53208

You are requested to attend a virtual hearing to be held on:

Tuesday, January 05, 2021 at 11:50 AM

Regarding: Your Food Dealer License Application as agent for "Brother Plus Grocery LLC" for "Brother Plus Grocery" at 4020 W NORTH Av.

This meeting will be held via GoToMeeting. Please see the enclosed best practices document for further instructions. The access code is <https://global.gotomeeting.com/join/306018541>. If you wish to call in, please call **+1 (408) 650-3123** and use Access Code: 306-018-541.

There is a possibility that your application may be denied for one or more of the following reasons: The recommendation of the committee regarding the application shall be based on evidence presented at the hearing. Per MCO 85-2.7-4, probative evidence concerning whether or not a new license should be granted may be presented on the following subjects: whether or not the applicant meets the municipal requirements, the appropriateness of the location and premises where the licensed premises is to be located and whether use of the premises for the purposes or activities permitted by the license would tend to facilitate a public or private nuisance or create undesirable neighborhood problems such as disorderly patrons, unreasonably loud noise, litter, and excessive traffic and parking congestion. Probative evidence relating to these matters may be taken from the plan of operation submitted with the license application, if any, but shall not include the content of any music. Evidence regarding the fitness of the location of the premises to be maintained as the principal place of business, including but not limited to whether there is an overconcentration of businesses of the type for which the license is sought; whether the proposal is consistent with any pertinent neighborhood business or development plans, or the location's proximity to areas where children are typically present. The applicant's record in operating similarly licensed premises; and whether or not the applicant has been charged with or convicted of any felony, misdemeanor, municipal offense or other offense, the circumstances of which substantially relate to the activity to be permitted by the license being applied for or any other factor which reasonably relates to the public health, safety or welfare may also be considered. See attached police report or correspondence.

Notice for applicants with warrants or unpaid fines: Proof of warrant satisfaction or payment of fines must be submitted at the hearing on the above date and time. Failure to comply with this requirement may result in a delay of the granting/denial of your application.

Failure to attend this meeting may result in the denial of your license. Individual applicants and partnership applicants must attend or attend by an attorney. The agent or attorney for corporate or limited liability applicants must attend. If you wish to do so and at your own expense, you may be accompanied by an attorney of your choosing to represent you at this hearing.

You will be given an opportunity to speak on behalf of the application and to respond and challenge any charges or reasons given for the denial. No petitions can be accepted by the committee, unless the people who signed the petition attend the virtual hearing and are willing to testify. You may present witnesses under oath and you may also confront and cross-examine opposing witnesses under oath. If you have difficulty with the English language, you should request an interpreter attend the meeting with you, at your expense, so that you can answer questions and participate in your hearing.

PLEASE NOTE: Upon reasonable notice, efforts will be made to accommodate the needs of disabled individuals through sign language interpreters or other auxiliary aids. For additional information or to request this service, contact the Council Services Division ADA Coordinator at (414) 286-2998, Fax - (414) 286-3456, TDD - (414) 286-2025.

JIM OWCZARSKI, CITY CLERK

BY: _____

Jessica Celella
License Division Manager

If you have questions regarding this meeting, please contact the staff assistant, Molly Kuether-Steele at (414) 286-2775 or molly.kuether-steele@milwaukee.gov.

200 E. Wells Street, Room 105, City Hall, Milwaukee, WI 53202. www.milwaukee.gov/license
Phone: (414) 286-2238 Fax: (414) 286-3057 Email Address: License@milwaukee.gov



**CITY OF MILWAUKEE
OFFICE OF THE CITY CLERK**

Wednesday, December 16, 2020

COMMITTEE MEETING NOTICE

AD 15

ABOHADBA, Yasser, Agent
Brother Plus Grocery LLC
3741 S 61st St #204

Milwaukee, WI 53220

You are requested to attend a virtual hearing to be held on:

Tuesday, January 05, 2021 at 11:50 AM

Regarding: Your Food Dealer License Application as agent for "Brother Plus Grocery LLC" for "Brother Plus Grocery" at 4020 W NORTH Av.

This meeting will be held via GoToMeeting. Please see the enclosed best practices document for further instructions. The access code is <https://global.gotomeeting.com/join/306018541>. If you wish to call in, please call +1 (408) 650-3123 and use Access Code: 306-018-541.

There is a possibility that your application may be denied for one or more of the following reasons: The recommendation of the committee regarding the application shall be based on evidence presented at the hearing. Per MCO 85-2.7-4, probative evidence concerning whether or not a new license should be granted may be presented on the following subjects: whether or not the applicant meets the municipal requirements, the appropriateness of the location and premises where the licensed premises is to be located and whether use of the premises for the purposes or activities permitted by the license would tend to facilitate a public or private nuisance or create undesirable neighborhood problems such as disorderly patrons, unreasonably loud noise, litter, and excessive traffic and parking congestion. Probative evidence relating to these matters may be taken from the plan of operation submitted with the license application, if any, but shall not include the content of any music. Evidence regarding the fitness of the location of the premises to be maintained as the principal place of business, including but not limited to whether there is an overconcentration of businesses of the type for which the license is sought; whether the proposal is consistent with any pertinent neighborhood business or development plans, or the location's proximity to areas where children are typically present. The applicant's record in operating similarly licensed premises; and whether or not the applicant has been charged with or convicted of any felony, misdemeanor, municipal offense or other offense, the circumstances of which substantially relate to the activity to be permitted by the license being applied for or any other factor which reasonably relates to the public health, safety or welfare may also be considered. See attached police report or correspondence.

Notice for applicants with warrants or unpaid fines: Proof of warrant satisfaction or payment of fines must be submitted at the hearing on the above date and time. Failure to comply with this requirement may result in a delay of the granting/denial of your application.

Failure to attend this meeting may result in the denial of your license. Individual applicants and partnership applicants must attend or attend by an attorney. The agent or attorney for corporate or limited liability applicants must attend. If you wish to do so and at your own expense, you may be accompanied by an attorney of your choosing to represent you at this hearing.

You will be given an opportunity to speak on behalf of the application and to respond and challenge any charges or reasons given for the denial. No petitions can be accepted by the committee, unless the people who signed the petition attend the virtual hearing and are willing to testify. You may present witnesses under oath and you may also confront and cross-examine opposing witnesses under oath. If you have difficulty with the English language, you should request an interpreter attend the meeting with you, at your expense, so that you can answer questions and participate in your hearing.

PLEASE NOTE: Upon reasonable notice, efforts will be made to accommodate the needs of disabled individuals through sign language interpreters or other auxiliary aids. For additional information or to request this service, contact the Council Services Division ADA Coordinator at (414) 286-2998, Fax - (414) 286-3456, TDD - (414) 286-2025.

JIM OWCZARSKI, CITY CLERK

BY: _____

Jessica Celella
License Division Manager

If you have questions regarding this meeting, please contact the staff assistant, Molly Kuether-Steele at (414) 286-2775 or molly.kuether-steele@milwaukee.gov.

200 E. Wells Street, Room 105, City Hall, Milwaukee, WI 53202. www.milwaukee.gov/license
Phone: (414) 286-2238 Fax: (414) 286-3057 Email Address: License@milwaukee.gov

Brother Plus Grocery LLC
4020 W North Ave
Milwaukee, WI 53208

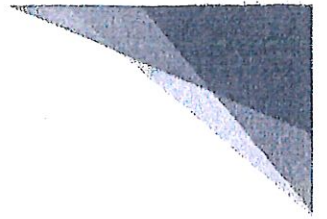

October 08, 2020

Dear Office City Clerk License Division,

I am writing to appeal the alderman's objection to approve my application for a Food Dealer Retail License at 4020 W North Ave Milwaukee, WI 53208.

Although there may be similar establishments near the proposed location, my hours of operation are different and the Food Dealer Retail License will help meet the needs of several customers.

I am consistently reminded by numerous of consumers their appreciation of the "convenience of a one stop shop". Given the License I am able to offer healthier food selections and accommodate reasonable demands for perishable items. I would also be able to provide a variety of food choices that aid in feeding families during the hours that other establishments are not operating.

In light of these facts I request that you reconsider your decision to grant Brother Plus Grocery LLC the Food Dealer Retail License. Thank you for your time and consideration.

Sincerely,

Yasser Abohadba

Owner of Brother Plus Grocery LLC

Summary

| Name | Count | Area(ft ²) | Length(mi) |
|---------------|-------|------------------------|------------|
| Food Licenses | 6 | | |

Food Licenses

| # | Legal entity | Trade name | Licensee | Address | License type name | Total capacity | Expiration date | Count |
|---|------------------------------|----------------------------|------------------------|------------------|---------------------------------------|----------------|---------------------|-------|
| 1 | RALPH'S COFFEE | RALPH'S COFFEE | RALPH E NEELY, SP | 4538 W LISBON AV | Public Entertainment Premises License | | 12/18/2020, 6:00 PM | 1 |
| 2 | MEGA MARTS, LLC | PICK 'N SAVE #879 | Brett T Lyons, Agt | 2355 N 35TH ST | Public Entertainment Premises License | | 1/17/2021, 6:00 PM | 1 |
| 3 | RALPH'S COFFEE | RALPH'S COFFEE | RALPH E NEELY, SP | 4538 W LISBON AV | Public Entertainment Premises License | | 12/18/2021, 6:00 PM | 1 |
| 4 | PREMIER SPORTS LOUNGE, LLC | PREMIER SPORTS LOUNGE | Tabitha A Harris, Agt | 4001 W NORTH AV | Public Entertainment Premises License | | 12/16/2021, 6:00 PM | 1 |
| 5 | Chocolate Rose Lounge LLC | Chocolate Rose Lounge | ANGELIA P ROSE, Agt | 4443 W Lisbon AV | Public Entertainment Premises License | | 2/18/2021, 6:00 PM | 1 |
| 6 | T A Acquisition Company, LLC | Village Valet Dry Cleaners | Thomas M Anderson, Agt | 3200 W North AV | Public Entertainment Premises License | | 8/30/2021, 7:00 PM | 1 |

Establishments within a 0.5 miles radius centered on area of interest.



Wednesday, December 16, 2020



Notice of Public Hearing

blank
notice

ABOHADBA, Yasser, Agent
Brother Plus Grocery at 4020 W NORTH Av
Food Dealer License Application

Tuesday, January 5, 2021 at 11:50 AM

To whom it may concern:

The above application has been made by the above named applicant(s). This requires approval from the Licenses Committee and the Common Council of the City of Milwaukee. The hearing before the Licenses Committee will take place virtually on 1/5/2021 at 11:50 AM. This is a public hearing. Those wishing to view the proceeding are able to do so via the City Channel – Channel 25 on Spectrum Cable – or on the Internet at <http://city.milwaukee.gov/citychannel>. Those wishing to provide oral testimony will be asked to do so by phone or internet and are asked to contact the staff assistant, Molly Kuether-Steele at (414) 286-2775 or molly.kuether-steele@milwaukee.gov for necessary information. Please make such requests no later than one business day prior to the start of the meeting. You are not required to attend the hearing, but please see the information below if you would like to provide testimony. Once the Licenses Committee makes its recommendation, this recommendation is forwarded to the full Common Council for approval at its next regularly scheduled hearing.

Important details for those wishing to provide information for the Licenses Committee to consider when making its recommendation:

1. The license application is scheduled to be heard at the above time. Due to other hearings running longer than scheduled, you may have to wait some time to provide your testimony.
2. You must testify as to matters that you have personally experienced or seen. (You cannot provide testimony for your neighbor, parent or anyone else; this is considered hearsay and cannot be considered by the committee.)
3. No letters or petitions can be accepted by the committee (unless the person who wrote the letter or the persons who signed the petition are willing to testify).
4. Persons opposed to the license application are given the opportunity to testify first; supporters may testify after the opponents have finished.
5. When you are called to testify, you will be sworn in and asked to give your name, and address. (If your first and/or last names are uncommon please spell them.)
6. You may then provide testimony.
 - a. Include only information relating to the above license application.
 - b. Include only information you have personally witnessed or seen.
 - c. Provide concise and relevant information detailing how this business has affected or may affect the peaceful enjoyment of your neighborhood.
 - d. If by the time you have the opportunity to testify, the information you wish to share has already been provided to the committee, you may state that you agree with the previous testimony. Redundant or repetitive testimony will not assist the committee in making its recommendation.
7. After giving your testimony, the members of the Licenses Committee and the licensee may ask questions regarding the testimony you have given or other factors relating to the license application.
8. Business Competition is not a valid basis for denial or non-renewal of a license.

Please Note: If you have submitted an objection to the above application your objection cannot be considered by the committee unless you personally testify at the hearing.

| OCCUPANT | MAIL ADDRESS | CITY, STATE ZIP |
|------------------|---------------------|---------------------|
| CURRENT OCCUPANT | 2236 N 41ST ST | MILWAUKEE, WI 53208 |
| CURRENT OCCUPANT | 2318 N 41ST ST | MILWAUKEE, WI 53210 |
| CURRENT OCCUPANT | 2314 N 41ST ST | MILWAUKEE, WI 53210 |
| CURRENT OCCUPANT | 2313 N 40TH ST | MILWAUKEE, WI 53210 |
| CURRENT OCCUPANT | 2307 N 40TH ST | MILWAUKEE, WI 53210 |
| CURRENT OCCUPANT | 3915 W MEINECKE AVE | MILWAUKEE, WI 53210 |
| CURRENT OCCUPANT | 3927 W MEINECKE AVE | MILWAUKEE, WI 53210 |
| CURRENT OCCUPANT | 3929 W MEINECKE AVE | MILWAUKEE, WI 53210 |
| CURRENT OCCUPANT | 2354 N 40TH ST | MILWAUKEE, WI 53210 |
| CURRENT OCCUPANT | 2366 N 40TH ST | MILWAUKEE, WI 53210 |
| CURRENT OCCUPANT | 2239 N 41ST ST | MILWAUKEE, WI 53208 |
| CURRENT OCCUPANT | 2245 N 41ST ST | MILWAUKEE, WI 53208 |
| CURRENT OCCUPANT | 4213 W MEINECKE AVE | MILWAUKEE, WI 53210 |
| CURRENT OCCUPANT | 2351 N GRANT BLVD | MILWAUKEE, WI 53210 |
| CURRENT OCCUPANT | 2364 N 41ST ST | MILWAUKEE, WI 53210 |
| CURRENT OCCUPANT | 2367 N 40TH ST | MILWAUKEE, WI 53210 |
| CURRENT OCCUPANT | 2337 N GRANT BLVD | MILWAUKEE, WI 53210 |
| CURRENT OCCUPANT | 2326 N 41ST ST | MILWAUKEE, WI 53210 |
| CURRENT OCCUPANT | 2342 N GRANT BLVD | MILWAUKEE, WI 53210 |
| CURRENT OCCUPANT | 2329 N 41ST ST | MILWAUKEE, WI 53210 |
| CURRENT OCCUPANT | 2336 N GRANT BLVD | MILWAUKEE, WI 53210 |
| CURRENT OCCUPANT | 2244 N 41ST ST | MILWAUKEE, WI 53208 |
| CURRENT OCCUPANT | 2242 N 41ST ST | MILWAUKEE, WI 53208 |
| CURRENT OCCUPANT | 2344 N 40TH ST | MILWAUKEE, WI 53210 |
| CURRENT OCCUPANT | 2362 N 40TH ST | MILWAUKEE, WI 53210 |
| CURRENT OCCUPANT | 2368 N 40TH ST | MILWAUKEE, WI 53210 |
| CURRENT OCCUPANT | 2354 N 41ST ST | MILWAUKEE, WI 53210 |
| CURRENT OCCUPANT | 2338 N GRANT BLVD | MILWAUKEE, WI 53210 |
| CURRENT OCCUPANT | 2355 N 41ST ST | MILWAUKEE, WI 53210 |
| CURRENT OCCUPANT | 2367 N GRANT BLVD | MILWAUKEE, WI 53210 |
| CURRENT OCCUPANT | 4027 W MEINECKE AVE | MILWAUKEE, WI 53210 |
| CURRENT OCCUPANT | 2335 N GRANT BLVD | MILWAUKEE, WI 53210 |
| CURRENT OCCUPANT | 2232 N 41ST ST | MILWAUKEE, WI 53208 |
| CURRENT OCCUPANT | 2315 N 41ST ST | MILWAUKEE, WI 53210 |
| CURRENT OCCUPANT | 2307 N 41ST ST | MILWAUKEE, WI 53210 |
| CURRENT OCCUPANT | 2309 N 40TH ST | MILWAUKEE, WI 53210 |
| CURRENT OCCUPANT | 3903 W MEINECKE AVE | MILWAUKEE, WI 53210 |
| CURRENT OCCUPANT | 3909 W MEINECKE AVE | MILWAUKEE, WI 53210 |
| CURRENT OCCUPANT | 3917 W MEINECKE AVE | MILWAUKEE, WI 53210 |
| CURRENT OCCUPANT | 2343 N 39TH ST | MILWAUKEE, WI 53210 |
| CURRENT OCCUPANT | 2347 N 39TH ST | MILWAUKEE, WI 53210 |
| CURRENT OCCUPANT | 2338 N 40TH ST | MILWAUKEE, WI 53210 |
| CURRENT OCCUPANT | 2256 N 42ND ST | MILWAUKEE, WI 53208 |
| CURRENT OCCUPANT | 4109 W NORTH AVE A | MILWAUKEE, WI 53208 |
| CURRENT OCCUPANT | 4123 W MEINECKE AVE | MILWAUKEE, WI 53210 |
| CURRENT OCCUPANT | 2362 N GRANT BLVD | MILWAUKEE, WI 53210 |

| | | |
|------------------|---------------------|---------------------|
| CURRENT OCCUPANT | 2341 N GRANT BLVD | MILWAUKEE, WI 53210 |
| CURRENT OCCUPANT | 4107 W MEINECKE AVE | MILWAUKEE, WI 53210 |
| CURRENT OCCUPANT | 2363 N 41ST ST | MILWAUKEE, WI 53210 |
| CURRENT OCCUPANT | 2248 N 41ST ST | MILWAUKEE, WI 53208 |
| CURRENT OCCUPANT | 3905 W MEINECKE AVE | MILWAUKEE, WI 53210 |
| CURRENT OCCUPANT | 3911 W MEINECKE AVE | MILWAUKEE, WI 53210 |
| CURRENT OCCUPANT | 2350 N 40TH ST | MILWAUKEE, WI 53210 |
| CURRENT OCCUPANT | 2253 N 41ST ST | MILWAUKEE, WI 53208 |
| CURRENT OCCUPANT | 4205 W MEINECKE AVE | MILWAUKEE, WI 53210 |
| CURRENT OCCUPANT | 2356 N 41ST ST | MILWAUKEE, WI 53210 |
| CURRENT OCCUPANT | 2340 N GRANT BLVD | MILWAUKEE, WI 53210 |
| CURRENT OCCUPANT | 2334 N GRANT BLVD | MILWAUKEE, WI 53210 |
| CURRENT OCCUPANT | 2352 N GRANT BLVD | MILWAUKEE, WI 53210 |
| CURRENT OCCUPANT | 4025 W MEINECKE AVE | MILWAUKEE, WI 53210 |
| CURRENT OCCUPANT | 4229 W MEINECKE AVE | MILWAUKEE, WI 53210 |
| CURRENT OCCUPANT | 3931 W MEINECKE AVE | MILWAUKEE, WI 53210 |
| CURRENT OCCUPANT | 2357 N 39TH ST | MILWAUKEE, WI 53210 |
| CURRENT OCCUPANT | 2330 N 40TH ST | MILWAUKEE, WI 53210 |
| CURRENT OCCUPANT | 2235 N 41ST ST | MILWAUKEE, WI 53208 |
| CURRENT OCCUPANT | 2252 N 42ND ST | MILWAUKEE, WI 53208 |
| CURRENT OCCUPANT | 4124 W NORTH AVE | MILWAUKEE, WI 53208 |
| CURRENT OCCUPANT | 2353 N GRANT BLVD | MILWAUKEE, WI 53210 |
| CURRENT OCCUPANT | 4007 W MEINECKE AVE | MILWAUKEE, WI 53210 |
| CURRENT OCCUPANT | 4203 W MEINECKE AVE | MILWAUKEE, WI 53210 |
| CURRENT OCCUPANT | 4215 W MEINECKE AVE | MILWAUKEE, WI 53210 |
| CURRENT OCCUPANT | 2349 N 41ST ST | MILWAUKEE, WI 53210 |
| CURRENT OCCUPANT | 4117 W MEINECKE AVE | MILWAUKEE, WI 53210 |
| CURRENT OCCUPANT | 2355 N GRANT BLVD | MILWAUKEE, WI 53210 |
| CURRENT OCCUPANT | 2337 N 41ST ST | MILWAUKEE, WI 53210 |
| CURRENT OCCUPANT | 2238 N 41ST ST | MILWAUKEE, WI 53208 |
| CURRENT OCCUPANT | 2250 N 41ST ST | MILWAUKEE, WI 53208 |
| CURRENT OCCUPANT | 2321 N 41ST ST | MILWAUKEE, WI 53210 |
| CURRENT OCCUPANT | 2319 N 41ST ST | MILWAUKEE, WI 53210 |
| CURRENT OCCUPANT | 2319 N 40TH ST | MILWAUKEE, WI 53210 |
| CURRENT OCCUPANT | 2321 N 40TH ST | MILWAUKEE, WI 53210 |
| CURRENT OCCUPANT | 3935 W MEINECKE AVE | MILWAUKEE, WI 53210 |
| CURRENT OCCUPANT | 2359 N 39TH ST | MILWAUKEE, WI 53210 |
| CURRENT OCCUPANT | 4109 W NORTH AVE | MILWAUKEE, WI 53208 |
| CURRENT OCCUPANT | 2304 N GRANT BLVD | MILWAUKEE, WI 53210 |
| CURRENT OCCUPANT | 2357 N GRANT BLVD | MILWAUKEE, WI 53210 |
| CURRENT OCCUPANT | 2329 N GRANT BLVD | MILWAUKEE, WI 53210 |
| CURRENT OCCUPANT | 4109 W MEINECKE AVE | MILWAUKEE, WI 53210 |
| CURRENT OCCUPANT | 2339 N GRANT BLVD | MILWAUKEE, WI 53210 |
| CURRENT OCCUPANT | 2357 N 40TH ST | MILWAUKEE, WI 53210 |
| CURRENT OCCUPANT | 2350 N GRANT BLVD | MILWAUKEE, WI 53210 |
| CURRENT OCCUPANT | 2344 N GRANT BLVD | MILWAUKEE, WI 53210 |
| CURRENT OCCUPANT | 2328 N GRANT BLVD | MILWAUKEE, WI 53210 |

| | | |
|------------------|---------------------|---------------------|
| CURRENT OCCUPANT | 2331 N 41ST ST | MILWAUKEE, WI 53210 |
| CURRENT OCCUPANT | 2335 N 41ST ST | MILWAUKEE, WI 53210 |
| CURRENT OCCUPANT | 2237 N 40TH ST | MILWAUKEE, WI 53208 |
| CURRENT OCCUPANT | 4001 W NORTH AVE | MILWAUKEE, WI 53208 |
| CURRENT OCCUPANT | 2252 N 41ST ST | MILWAUKEE, WI 53208 |
| CURRENT OCCUPANT | 2313 N 41ST ST | MILWAUKEE, WI 53210 |
| CURRENT OCCUPANT | 2309 N 41ST ST | MILWAUKEE, WI 53210 |
| CURRENT OCCUPANT | 2315 N 40TH ST | MILWAUKEE, WI 53210 |
| CURRENT OCCUPANT | 3925 W MEINECKE AVE | MILWAUKEE, WI 53210 |
| CURRENT OCCUPANT | 2341 N 39TH ST | MILWAUKEE, WI 53210 |
| CURRENT OCCUPANT | 2351 N 39TH ST | MILWAUKEE, WI 53210 |
| CURRENT OCCUPANT | 2353 N 39TH ST | MILWAUKEE, WI 53210 |
| CURRENT OCCUPANT | 2336 N 40TH ST | MILWAUKEE, WI 53210 |
| CURRENT OCCUPANT | 2348 N 40TH ST | MILWAUKEE, WI 53210 |
| CURRENT OCCUPANT | 2356 N 40TH ST | MILWAUKEE, WI 53210 |
| CURRENT OCCUPANT | 2360 N 40TH ST | MILWAUKEE, WI 53210 |
| CURRENT OCCUPANT | 2251 N 41ST ST | MILWAUKEE, WI 53208 |
| CURRENT OCCUPANT | 2254 N 42ND ST | MILWAUKEE, WI 53208 |
| CURRENT OCCUPANT | 2316 N GRANT BLVD | MILWAUKEE, WI 53210 |
| CURRENT OCCUPANT | 2357 N 41ST ST | MILWAUKEE, WI 53210 |
| CURRENT OCCUPANT | 2326 N GRANT BLVD | MILWAUKEE, WI 53210 |
| CURRENT OCCUPANT | 2362 N 41ST ST | MILWAUKEE, WI 53210 |
| CURRENT OCCUPANT | 2327 N GRANT BLVD | MILWAUKEE, WI 53210 |
| CURRENT OCCUPANT | 4009 W MEINECKE AVE | MILWAUKEE, WI 53210 |
| CURRENT OCCUPANT | 2320 N 41ST ST | MILWAUKEE, WI 53210 |
| CURRENT OCCUPANT | 2312 N 41ST ST | MILWAUKEE, WI 53210 |
| CURRENT OCCUPANT | 3937 W MEINECKE AVE | MILWAUKEE, WI 53210 |
| CURRENT OCCUPANT | 2345 N 39TH ST | MILWAUKEE, WI 53210 |
| CURRENT OCCUPANT | 2332 N 40TH ST | MILWAUKEE, WI 53210 |
| CURRENT OCCUPANT | 2342 N 40TH ST | MILWAUKEE, WI 53210 |
| CURRENT OCCUPANT | 2310 N GRANT BLVD | MILWAUKEE, WI 53210 |
| CURRENT OCCUPANT | 2333 N 41ST ST | MILWAUKEE, WI 53210 |
| CURRENT OCCUPANT | 2360 N GRANT BLVD | MILWAUKEE, WI 53210 |
| CURRENT OCCUPANT | 2370 N GRANT BLVD | MILWAUKEE, WI 53210 |
| CURRENT OCCUPANT | 2339 N 41ST ST | MILWAUKEE, WI 53210 |
| CURRENT OCCUPANT | 2365 N 41ST ST | MILWAUKEE, WI 53210 |

blank notice

Total Records: 129

Radius: 250.0 feet and Center of Circle: 4020 W North Ave



BUSINESS LICENSE PLAN OF OPERATION

ccl-busplan 5/12/2020

Office of the City Clerk License Division
200 E. Wells St. Room 105, Milwaukee, WI 53202
(414) 286-2238 www.milwaukee.gov/license e-mail address: license@milwaukee.gov

1. Type of Business

Applying for: Extended Hours (12AM to 5AM) - If a food establishment, check all that apply: Delivery Drive Thru Dining Room
 Self Service Laundry Massage Establishment Filling Station
 Other (supplemental application for specific license also required) Grocery Store

Provide a detailed description of the type of business you plan on operating:

Grocery Store

Do you have any experience operating this type of business? No Yes If yes, explain:

2. Business Operations

- a. Proposed Opening Date: 3/1/2018
- b. Is this premise under construction? No Yes If yes, list estimated completion date: _____
- c. Is this a franchise? No Yes
- d. Is this premises currently licensed? No Yes If yes, list type of license: Occupancy License Tobacco
- e. Is the current licensee operating? No Yes If no, list date closed: _____
- f. Do you have future plans for other businesses, licenses or permits at this location? No Yes
If yes, explain: Food Dealer, Food Stamps, W.I.C.
- g. Have you previously held an Extended Hours License in Milwaukee? No Yes
If yes, list address(es): _____
- h. Are other businesses operating in the same building? No Yes If yes, describe: _____

3. Litter & Noise

- a. How are grounds kept clean? Sweep Pressure Wash Pick Up Litter Other: _____
- b. How often will grounds be cleaned? Daily Weekly As Needed Monthly Other: _____
- c. Grounds cleaned by: Licensee Building Owner Employees Hired Maintenance Other: _____
- d. How are noise issues prevented and/or addressed? Security Manager approaches customer(s) Call Police
 Signs Posted Other: _____
- e. Will a sound amplification system be used? No Yes If yes, describe: _____

4. Smoking & Sanitation

- a. Are there designated outdoor smoking areas? No Yes If yes, describe: _____
- b. Number of Garbage Cans: Inside: 5 Locations: by cashier, office, Entrance (2), Restroom
Outside: 2 Locations: by entrance, in parking lot
- c. Is a crowd control barrier used? No Yes If yes, describe: _____
- d. How many restrooms are on the premises? 2
- e. Name of solid waste contractor: Advanced Disposal Waste Management Other: _____

5. Security

- a. Are there onsite parking spaces? No Yes If yes, how many? 8 and describe the parking security plan: Camera Systems provided; in parking lot, Entrance & Exit well marked
- b. Is there a loading zone? No Yes If yes, describe the loading area security plan: _____
- c. Will you have security personnel on premise? No Yes If yes, how many? _____ and answer the following:
 What are their responsibilities? _____
 Is security equipment used? No Yes If yes, describe Camera System covering inside & outside all directions
 List their licensing, certification, or training credentials _____
- d. Will there be security cameras? No Yes If yes, how many? 32 and list locations: all directions inside and outside location and Parking lot
- e. Will searches/identification checks be done upon entry? No Yes If yes, describe _____

6. Percentage of Sales (must total 100%)

| | | | |
|--------------------------------|--|---|-------------------------------------|
| Alcohol <u>0</u> % | Food <u>75</u> % | Secondhand Merchandise <u>0</u> % | Precious Metals & Gems <u>0</u> % |
| Entertainment <u>0</u> % | Cigarettes <u>25</u> % | Personal Services (such as tattoo, body piercing, salon, tailor, tanning, etc.) _____ % | Other <u>0</u> % Describe: _____ |
| Pawnbroker Activity <u>0</u> % | Salvaged Materials <u>0</u> % (such as scrap metal) | | |

7. Businesses/Licenses on the Premises (check all that apply):

Type 1

- Full Service Restaurant Cafe/Coffee Shop Deli or Fast Food Restaurant Private/Fraternal/Veterans Club
- Night Club Tavern Cocktail Lounge Teen Club
- Banquet Hall Sports Facility Bowling Alley
- Hotel/Motel : Number of Floors: _____ Rooming House: Number of Floors: _____
 Number of Rooms: _____ Number of Rooms: _____

Type 2

- Liquor Store Corner Store Supermarket Convenience Store
- Gas Station Amusement/Phonograph Distributor Recycling, Salvage or Towing
- Used Car Dealer Personal Service Establishment
(such as tattoo business, hair salon, tailor, etc.) Recording Studio

What other licenses/permits will you hold at this location? (check all that apply)

- Occupancy Permit Cigarette & Tobacco Gas Station Extended Hours Class "B" Tavern Weights & Measures
- Secondhand Dealer Precious Metal & Gem Other: _____

8. Legal Capacity (only if a Type 1 premises in #7 above)

Capacity N/A (Call the Milwaukee Development Center at 414-286-8211 if you have questions.) N/A

9. Premises Description

a. Identify all area(s) of the premises that will be used in operating this business (include areas used only for storage):

1st Floor 2nd Floor Basement Storage Patio Beer Garden Sidewalk Café Deck Rooftop

Other: Describe: _____

b. Describe Location: Major Thoroughfare Secondary Street Other: _____

c. Nearest Major Cross Street: 40th North Ave

d. Describe Building: Free Standing Building Strip Mall Other: _____

e. Describe Premises Structure: Single Story Multi-Story - # of Stories _____ Other: _____

f. Describe Surrounding Area: Commercial Residential Industrial Other: _____

g. Building Owner Name: JWH Investment Phone Number: (262) 305-4363

Building Owner Address: 4451 Honeywood Ct, Jackson, WI 53087

10. Hours of Operation & Customers

Will customers be entering the premises? No Yes

| Day of the Week | Proposed Hours of Operation: | | Estimated Number of Customers expected each day | Potential Age Range of Customers | Class B Tavern Applicant Only: Age Restriction (If none, write 'None') |
|-----------------|----------------------------------|-----------------------------------|---|----------------------------------|--|
| | Open Time (include a.m. or p.m.) | Close Time (include a.m. or p.m.) | | | |
| Sunday | 8:00am | 12:00am | 70 | Adults | |
| Monday | " | " | 45 | " | N/A |
| Tuesday | " | " | 50 | " | |
| Wednesday | " | " | 50 | " | |
| Thursday | " | " | 60 | " | |
| Friday | " | " | 70 | " | |
| Saturday | " | " | 80 | " | |

An Extended Hours Establishment License is required for any convenience store, filling station, personal service establishment (such as tattoo, body piercing, salon, tailor, tanning, etc.), recording studio or restaurant which is open between the hours of 12:00 a.m. and 5:00 a.m.

Alcohol Establishments Class A: 8:00 am to 9:00 pm Sunday thru Saturday
 Permitted Hours of Operation: Class B: 6:00 am to 2:00 am Sunday thru Thursday, 6:00 am to 2:30 am Friday & Saturday

Entertainment Outdoor Closing Hours: 10:00pm Sunday-Thursday; 12:00am Friday & Saturday; unless a different time, either earlier or later, is established by the Common Council in its approval of the licensee's plan of operation.

11. Signature(s)

 Signature of Sole Proprietor, Partner, or 20% or more Shareholder
 (If there are no 20% or more shareholders,
 Corporate Officer-print name/title and sign)

 Signature of additional partner or 20% or more shareholder

See Application Information for a complete list of all required application forms.



FOOD DEALER LICENSE PLAN OF OPERATION

OFFICE OF THE CITY CLERK, LICENSE DIVISION
 CITY HALL, 200 E. WELLS ST, ROOM 105, MILWAUKEE, WI 53202
 (414) 286-2238 • license@milwaukee.gov • www.milwaukee.gov/license

Legal Entity Name: Brother Plus Grocery LLC

Premises Address: 4020 W North Ave, Milwaukee, WI 53208

SECTION 1 TYPE OF BUSINESS

What will be the majority of your food sales? (check one)

Restaurant Items (meals):
 MEALS include, but are not limited to, chicken, ribs, sandwiches, roasted corn, baked potatoes, hot dogs, brats, tacos, nachos w/ cheese and meat, French fries, cooked or deep fried vegetables/fruit, cooked cheese curds, corn dogs, egg rolls, salads.

Retail Items (snacks and beverages):
 RETAIL items include, but are not limited to, ice cream/soft serve, lemonade, snow cones, coffee, espresso, cappuccino, tea, fruit juice, smoothies, candy, dispensed soda, fruit cups, bakery, cookies, kettle corn, cotton candy, funnel cakes, fritters, tortilla chips w/ cheese.

Will it be a convenience store? Yes No

A convenience store contains less than 5,000 square feet of retail space and has, as its primary business, the sale of basic food items and in addition, sells household products or is a filling station that sells basic food items and household products.

- Bed & Breakfast
- Micro Market

All Applicants: Submit a menu or a list of food items that will be sold.

Will any wholesale business be done? No Yes If yes, what percentage of food sales will be wholesale?

Less than 25%

25% or More AND:

Restaurant items (meals) will be sold – Complete this application and also contact DATCP.

NO restaurant items (meals) will be sold - Do NOT complete this application. Contact DATCP only.

SECTION 2 FOOD PROCESSING

Will any food processing be done? No Yes

Processing is defined as assembling, grinding, cutting, mixing, baking, coating, stuffing, packing, bottling, grilling, canning, extracting, fermenting, distilling, pickling, freezing, drying, smoking, or packaging.

SECTION 3 FOOD REQUIRING TEMPERATURE CONTROL

Will any food that requires temperature control be sold? No Yes
 (includes dairy products such as milk, cheese, and ice cream, fish, shellfish, meat, poultry)

If yes, list the types of food items: meat, cheese, Milk, fish

SECTION 4 DETAILS OF OPERATION

Will you have seating on site for dining? No Yes

Will you be doing any catering? No Yes

Will you be doing any delivery? No Yes

Will you have outdoor activities? No Yes - Check all that apply: Bar Cooking/Grilling Dining

Will you have a drive thru window? No Yes - Are hours different from inside? No Yes
 If Yes, provide drive thru hours: _____

Will scales or barcode scanners be used? No Yes - You must also apply for a Weights & Measures License.

SECTION 5 ADDITIONAL SITES

Where will food be prepared and/or sold?

At a single site At multiple sites: How many? _____ (for example, a hotel with several dining rooms or bars)

If multiple sites, attach a Food Dealer Additional Site Addendum (ccl-foodadd) for each additional site.

SECTION 6 CONSTRUCTION OR CHANGES

Are you planning any construction, remodeling or equipment changes?

No If No, SKIP to Section 8

Yes If Yes, check all that apply: New construction of a building Renovation or remodeling
 Construction changes to existing building Equipment changes only

Provide a brief description of the changes: _____

Start date: _____

Name, Address & Phone Number of Architect: _____

Name, Address & Phone Number of Contractor: _____

SECTION 7 ALCOHOL BEVERAGES

Are you applying for an alcohol beverage license?

No If No, SKIP to Section 8

Yes If YES, if your food license is approved prior to the alcohol license, when do you want the food license issued?
 Immediately At the same time as the alcohol license

SECTION 8 ACKNOWLEDGEMENTS & SIGNATURE

You must initial each item confirming your understanding:

[Signature] I understand the Health Department must conduct an inspection and advise the License Division of their approval before the license may be issued.

[Signature] I understand I must obtain an occupancy permit from the Department of Neighborhood Services and an inspection may be required. Neighborhood Services must advise the License Division of their approval before the license may be issued.

[Signature] I understand the district alderperson will review and either support or object to my application. If he/she objects, I may appeal and be scheduled to appear before the Licenses Committee. The Licenses Committee will then make a recommendation to the Common Council. The Common Council must grant the license before it may be issued.

[Signature] I understand proof of payment for all license fees must be on file in the License Division before the license may be issued and the license must be issued and posted in my establishment prior to opening for business.

[Signature] I will not operate my food business until the license has been issued and posted in the establishment.

Signature of Sole Proprietor, Partner, or 20% Shareholder: *[Signature]*

Signature of Additional Partner: _____

Brother Plus Grocery LLC
4020 W North Ave
Milwaukee, WI 53208
PH: (414) 202-8989

Brother Plus Grocery LLC

Menu or List of Food Items that will be Sold

1. Bakery and Bread

- Whole wheat bread, pita pockets, and English muffins
- Whole-grain flour tortillas

2. Meat

- Reduced-sodium lunchmeat (turkey, roast beef)
- Beef/Turkey bacon

4. Oils, Sauces, Salad Dressings, and Condiments

- Tomato sauce
- Mustard
- Barbecue sauce
- Salsa
- Extra virgin olive oil, canola oil, nonfat cooking spray
- Jarred capers and olives
- Hot pepper sauce
- Ketchup

Brother Plus Grocery LLC
4020 W North Ave
Milwaukee, WI 53208
PH: (414) 202-8989

5. Cereals and Breakfast Foods

- Whole-grain or multigrain cereals
- Steel-cut or instant oatmeal
- Whole-grain cereal bars

6. Soups and Canned Goods

- Diced or whole peeled tomatoes
- Tuna or salmon packed in water
- Low-sodium soups and broths

7. Frozen Foods

- Frozen vegetables: broccoli, spinach, peas, and carrots (no sauce)
- Frozen fruit: strawberries, raspberries, blueberries (without added sugar)
- Frozen shrimp
- Pre-portioned, low-fat ice cream or frozen yogurt
- Pizza
- Prepackaged dinner entre

8. Dairy, Cheese, and Eggs

- Milk
- yogurt
- cottage cheese
- cheese or string cheese snacks
- Eggs or egg substitutes

9. Snacks and Crackers

On Your List:

- crackers
- Dried fruit: apricots, figs, prunes, raisins, cranberries
- Nuts: almonds, cashews, walnuts, peanuts, pecans, pistachios
- Seeds: sunflower seeds
- Peanut butter, almond, or soy butter

Brother Plus Grocery LLC
4020 W North Ave
Milwaukee, WI 53208
PH: (414) 202-8989

10. Produce

- Fruit: bananas, apples, oranges, mangoes, strawberries, blueberries
- Vegetables: sweet potatoes, baby spinach, broccoli, carrot sticks

11. Drinks

- Green and flavored teas
- orange juice
- Sparkling water
- Water
- Soda POP
- Ice Coffee
- Gatorade

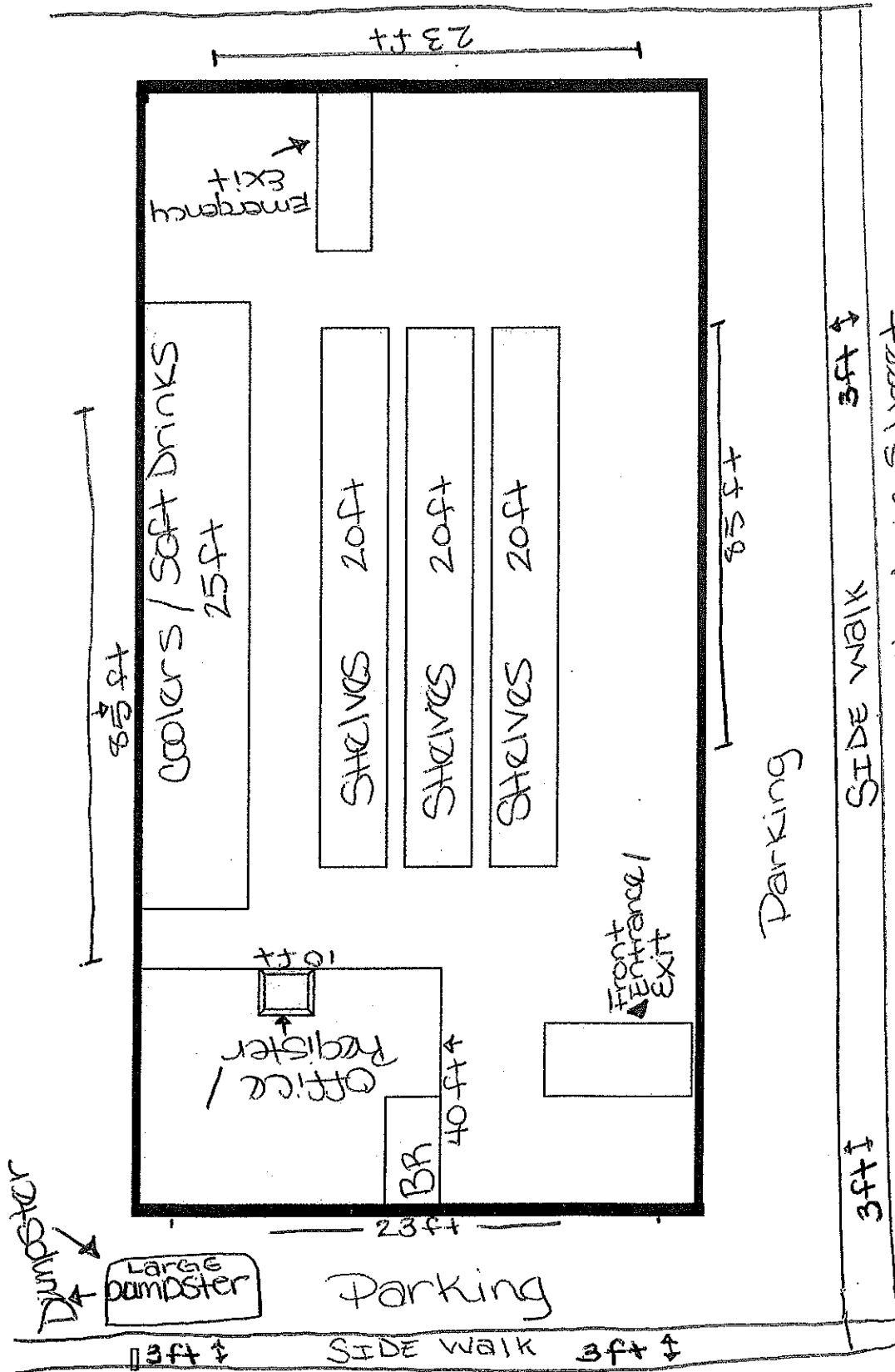

Total
Square
Footage = 1955 sqft

Brother Plus Grocery Inc
4020 W North Ave
Milwaukee, WI 53208
(414) 202-8989