



CERTIFICATE OF APPROPRIATENESS APPLICATION FORM

Incomplete applications will not be processed for Commission review.

Please print legibly.

1. HISTORIC NAME OF PROPERTY OR HISTORIC DISTRICT: (if known)

Willits/Sternmann House Cold Spring Park Historical District

ADDRESS OF PROPERTY:

3112 W. McKinley Blvd. Milwaukee, WI. 53208

2. NAME AND ADDRESS OF OWNER:

Name(s): Gerald & Maureen McCormack-Peters

Address: 3112 W. McKinley Blvd.

City: Milwaukee

State: WI.

ZIP: 53208

Email: jerbearmccormack@gmail.com

Telephone number (area code & number) Daytime: 414-975-4305

Evening: same

3. APPLICANT, AGENT OR CONTRACTOR: (if different from owner)

Name(s): Chris Egner Design-Build-Remodel LLC / DBA) Four Seasons Sunrooms

Address: 13198 W. National Ave.

City: New Berlin

State: WI.

ZIP Code: 53151

Email: chrisegnerdbr@aol.com

Telephone number (area code & number) Daytime: 262-797-8818

Evening: 262-797-8818

4. ATTACHMENTS: (Because projects can vary in size and scope, please call the HPC Office at 414-286-5712 for submittal requirements)

A. REQUIRED FOR MAJOR PROJECTS:

Photographs of affected areas & all sides of the building (annotated photos recommended)

Sketches and Elevation Drawings (1 full size and 1 reduced to 11" x 17" or 8 1/2" x 11")
A digital copy of the photos and drawings is also requested.

Material and Design Specifications (see next page)

B. NEW CONSTRUCTION ALSO REQUIRES:

Floor Plans (1 full size and 1 reduced to a maximum of 11" x 17")

Site Plan showing location of project and adjoining structures and fences

PLEASE NOTE: YOUR APPLICATION CANNOT BE PROCESSED UNLESS BOTH PAGES OF THIS FORM ARE PROPERLY COMPLETED AND SIGNED.

5. DESCRIPTION OF PROJECT:

Tell us what you want to do. Describe all proposed work including materials, design, and dimensions. Additional pages may be attached.

9'-8" x 19'-9" Sunroom addition above existing flat roof portion of existing house. No change to the existing footprint of house on lot.

The sunroom is a 2 in 12 pitched shed roof. All materials are white aluminum and glass. The small aluminum kick panels below the glass have a dimpled texture finish (samples will be provided at meeting). The roof is the same aluminum materials but not visible due to height and pitch of roof.

Existing railing for deck will be removed (see renderings).

The front wall is 7'-0" tall, the solid wall panel below the windows is 22" tall. There is a small wedge of wall panel above th windows on the side wall. This wedge will be approximately 16" tall at the back and sloping to 0" at the front (see renderings).

6. SIGNATURE OF APPLICANT:

Signature

Chris Egner MCR, UDCP
Please print or type name

4/15/2013
Date

This form and all supporting documentation **MUST** arrive by 12:00 noon on the deadline date established to be considered at the next Historic Preservation Commission Meeting. Any information not provided to staff in advance of the meeting will not be considered by the Commission during their deliberation. Please call if you have any questions and staff will assist you.

Hand Deliver or Mail Form to:
Historic Preservation Commission
City Clerk's Office
200 E. Wells St. Room B-4
Milwaukee, WI 53202

PHONE: (414) 286-5722

FAX: (414) 286-3004

www.milwaukee.gov/hpc



REAR ELEVATION 1/8" = 1'-0"

NO.	DESCRIPTION	BY	DATE

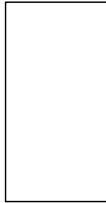

PROJECT DESCRIPTION:
 GERALD & MAUREEN McCORMACK-PETERS
 3112 W. McKinley Blvd.
 MILWAUKEE, WI. 53208

DRAWINGS PROVIDED BY:
 CHRIS EGNER DESIGN-
 BUILD-REMODEL
 13198 W. NATIONAL AVE.
 FISH KILL, WI. WISCONSIN 53151
 262-777-6818

DATE:

4/15/2013

SCALE:

1/8" = 1'-0"

SHEET:

A-1



LEFT SIDE ELEVATION 1/8" = 1'-0"

--

NO.	DESCRIPTION	BY	DATE

--

PROJECT DESCRIPTION:
GERALD & MAUREEN McCORMACK-PETERS
 3112 W. MCKINLEY BLVD.
 MILWAUKEE, WI. 53208

DRAWINGS PROVIDED BY:
CHRIS EGNER DESIGN-
BUILD-REMODEL
 13198 W. NATIONAL AVE. 53151
 262-777-6818

DATE:

4/15/2013

SCALE:

1/8" = 1'-0"

SHEET:

A-2



RIGHT SIDE ELEVATION 1/8" = 1'-0"

--

NO.	DESCRIPTION	BY	DATE

--

PROJECT DESCRIPTION:
GERALD & MAUREEN McCORMACK-PETERS
 3112 W. MCKINLEY BLVD.
 MILWAUKEE, WI. 53208

DRAWINGS PROVIDED BY:
CHRIS EGNER DESIGN-
BUILD-REMODEL
 13198 W. NATIONAL AVE. 53151
 262-777-6818 -

DATE:

4/15/2013

SCALE:

1/8" = 1'-0"

SHEET:

A-3

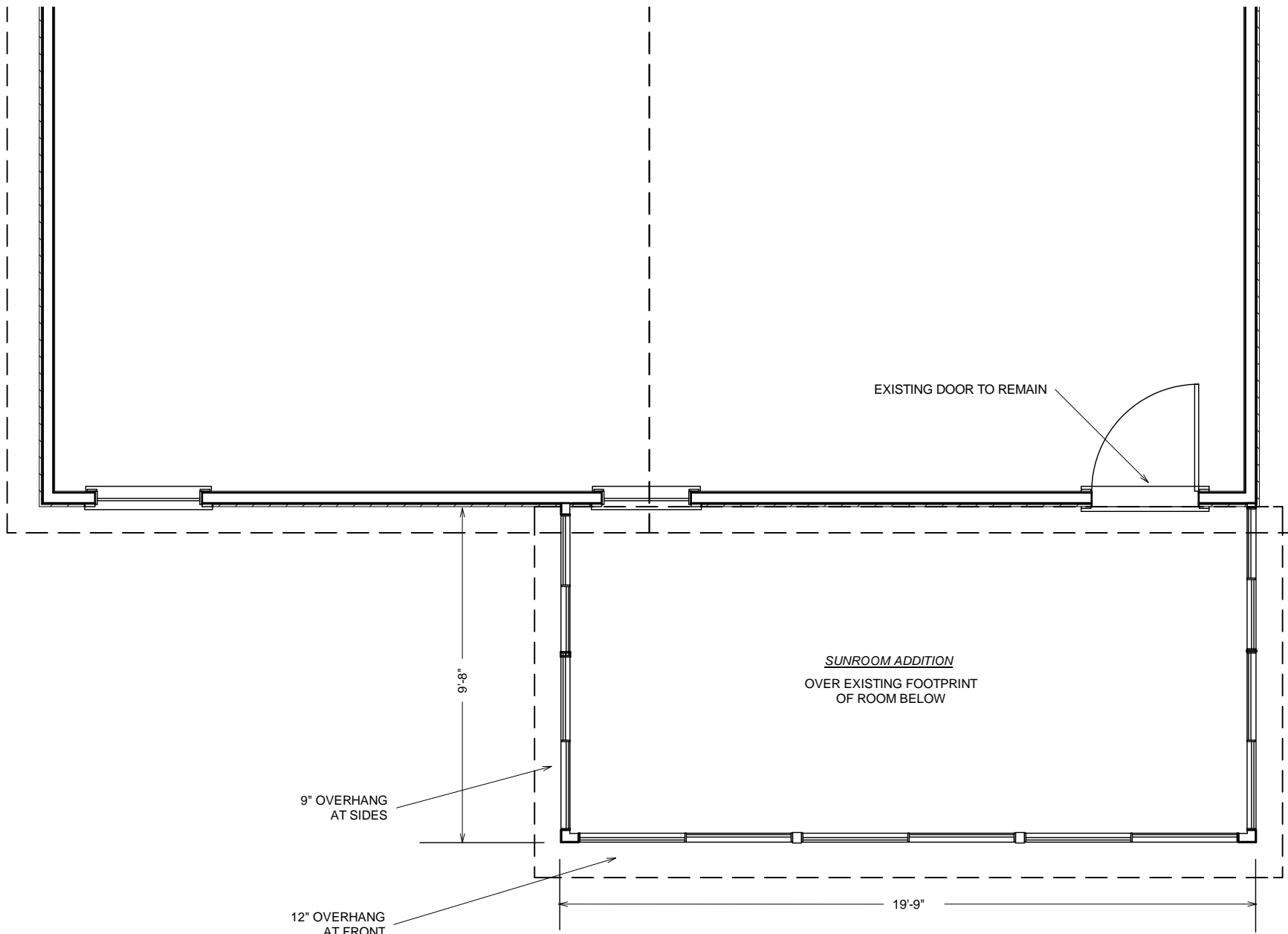

SUNROOM ADDITION
OVER EXISTING FOOTPRINT
OF ROOM BELOW

9" OVERHANG
AT SIDES

12" OVERHANG
AT FRONT

EXISTING DOOR TO REMAIN

9'-8"

19'-9"

FLOORPLAN 1/4" = 1'-0"

NO.	DESCRIPTION	BY	DATE

PROJECT DESCRIPTION:
GERALD & MAUREEN McCORMACK-PETERS
3112 W. MCKINLEY BLVD.
MILWAUKEE, WI. 53208

DRAWINGS PROVIDED BY:
CHRIS EGNER DESIGN-
BUILD-REMODEL
13198 W. NATIONAL AVE. 53151
262-777-6818

DATE:

4/15/2013

SCALE:

1/4" = 1'-0"

SHEET:

A-4