

DAD#278A

MILWAUKEE COUNTY CERTIFIED SURVEY MAP NO. \_\_\_\_\_

BEING A DIVISION OF LOTS 24, 25, 26 AND 27, BLOCK 2, M. KEENAN'S SUBDIVISION AND ALL OF CERTIFIED SURVY MAP NO. 7683 INCLUDING THE ALLEY (NOW VACATED) ALL LOCATED IN THE NORTHEAST 1/4 OF THE SOUTHEAST 1/4 OF SECTION 31, TOWN 7 NORTH, RANGE 22 EAST, CITY OF MILWAUKEE, MILWAUKEE COUNTY, WISCONSIN.

THE NW CORN. OF THE SE 1/4 OF SECT. 31-7-22 conc. mon. w/ brass cap N: 380,106.11 E: 2,551,384.61  
THE NE CORN. OF THE SE 1/4 OF SECT. 31-7-22 conc. mon. w/ brass cap N: 380,171.02 E: 2,554,019.25  
TAX KEY NO. 433-0927-000, -0928-000, -0929-000, -0930-000 & -2271-000  
• -- DENOTES SET 5/8" X 18" LONG IRON REBAR WEIGHING 1.5 LBS. PER LINEAL FOOT.

W. WALKER ST.  
(76' WIDE PUBLIC R-O-W)

N88°11'51"E 169.96'

S. CESAR E. CHAVEZ DR.  
(66' WIDE PUBLIC R-O-W)

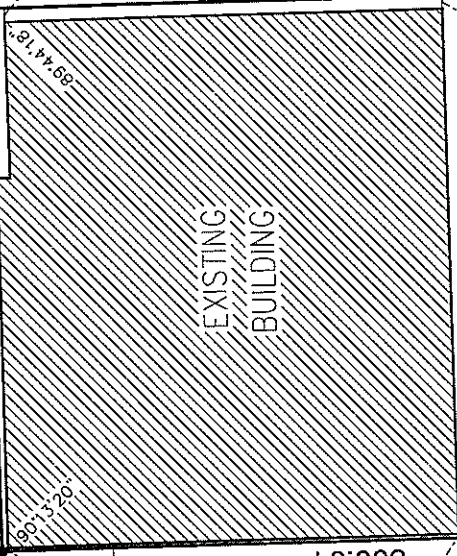

PARCEL 1  
69,259.7 Sq. Ft.  
1.59 Acres

DEDICATED TO THE CITY OF MILWAUKEE FOR PUBLIC ALLEY PURPOSES  
2,810.3 Sq. Ft.  
0.06 Acres

TOTAL AREA OF PROPERTY:  
72,070 Sq. Ft.  
1.65 Acres

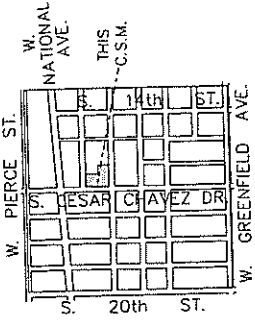

LOCATION SKETCH  
SOUTHEAST 1/4 SECTION 31-7-22  
SCALE: 1" = 2500'



1 inch = 60 ft.

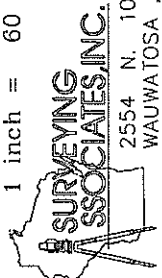

2554 N. 100th STREET  
WAUWATOSA, WI. 53226  
PHN 414-257-2212  
FAX 414-257-2443

INSTRUMENT DRAFTED BY: TRACI L. ZUPKE(dw) JOB NO. 32829 CSM

DECEMBER 7, 2009 SHEET 1 OF 3

S88°22'50"W 319.75'

W. MINERAL ST.  
(66.47' WIDE PUBLIC R-O-W)

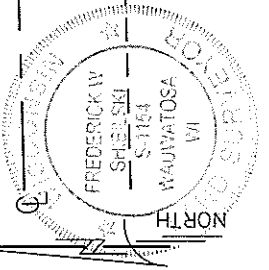

*Frederick W. Shibilski*  
FREDERICK W. SHIBILSKI S - 1164

DEPARTMENT OF CITY DEVELOPMENT  
CITY OF MILWAUKEE

DEC 10 2009

INFRASTRUCTURE SERVICES DIVISION

*Marcia Connell 12/17/09*  
CENTRAL DRAFTING & RECORDS MANAGER

*Tracy Colangelo 12/16/09*  
ENGR. IN CHARGE ENVIRON-ENGR.

*Jeffrey Colangelo 12/18/09*  
CITY ENGINEER  
CORRECT APPROVED

STAFF APPROVED

DD#2784

MILWAUKEE COUNTY CERTIFIED SURVEY MAP NO. \_\_\_\_\_

BEING A DIVISION OF LOTS 24, 25, 26 AND 27, BLOCK 2, M. KEENAN'S SUBDIVISION AND ALL OF CERTIFIED SURVY MAP NO. 7683 INCLUDING THE ALLEY (NOW VACATED) ALL LOCATED IN THE NORTHEAST ¼ OF THE SOUTHEAST ¼ OF SECTION 31, TOWN 7 NORTH, RANGE 22 EAST, CITY OF MILWAUKEE, MILWAUKEE COUNTY, WISCONSIN.

SURVEYOR'S CERTIFICATE  
STATE OF WISCONSIN)  
MILWAUKEE COUNTY )SS

I, Frederick W. Shibiliski, a registered land surveyor do hereby certify:



That I have surveyed, divided and mapped Lots 24, 25, 26 and 27, Block 2, M. Keenan's Subdivision and all of Certified Survey Map No. 7683 including the alley (now vacated) all located in the Northeast ¼ of the Southeast ¼ of Section 31, Town 7 North, Range 22 East, City of Milwaukee, Milwaukee County, Wisconsin, being more particularly described as follows: Commencing at the Northeast corner of th Southeast ¼ of Section 31; thence South 88° 35' 19" West along the North line of said ¼ Section, 1290.21 feet; thence South 01° 34' 49" East, 775.79 feet to the Northwest corner of Certified Survey Map No. 7683; thence North 88° 11' 51" East, 169.96 feet; thence South 01° 32' 27" East, 160.29 feet; thence North 88° 17' 18" East, 150.00 feet; thence South 01° 32' 27" East, 140.53 feet to a point on the North right-of-way line of West Mineral Street; thence South 88° 22' 46" West, 319.75 feet to a point on the East right-of-way line of South Cesar E. Chavez Drive; thence North 01° 34' 49" West 300.04 feet to the point of beginning.

That I have made such survey, land division and map by the direction of El Rey Enterprises II, LLC, owner of said land.

That this map is a correct representation of all exterior boundaries of land surveyed and the land division thereof made.

That I have fully complied with the provisions of Chapter 236 of the Wisconsin Statutes and Chapter 119 of the Milwaukee Code in surveying, dividing and mapping the same.

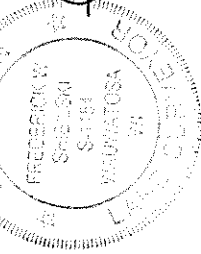
Dated this 7<sup>th</sup> day of December 2009.

  
  
Frederick W. Shibiliski S-1154  
Wisconsin Reg. Land Surveyor

CORPORATE OWNERS CERTIFICATE:

El Rey Enterprises II, LLC, a corporation duly organized and existing under and by virtue of the laws of the State of Wisconsin as owner, does hereby certify that said corporation caused the land described to be surveyed, divided, mapped and dedicated as represented on this map in accordance with the requirements of Chapter 119 of the Milwaukee Code of Ordinances.

In consideration of the approval of this map by the Common Council, and in accordance with Chapter 119 of the Milwaukee Code of Ordinances, the undersigned agrees:

- a. That all utility lines to provide electric power and telephone services and cable television or communications systems lines or cables to all parcels in the certified survey map shall be installed underground in easements provided therefor, where feasible.

This agreement shall be binding on the undersigned and assigns.

IN WITNESS WHEREOF, the said El Rey Enterprises II, LLC has caused these presents to be signed by Ernesto Villarreal, its Representative, at Milwaukee, Wisconsin, on this 9<sup>th</sup> day of December, 2009.

In the Presence of:

  
  
Ernesto Villarreal, Representative

STATE OF WISCONSIN)  
MILWAUKEE COUNTY )SS

Personally came before me this 9<sup>th</sup> day of December, 2009, the above named Ernesto Villarreal, of the above named Corporation, to me known to be the person who executed the foregoing instrument and to me known to be such Representative of said Corporation and acknowledged that he executed the foregoing instrument as such officer as the deed of said Corporation by its authority.

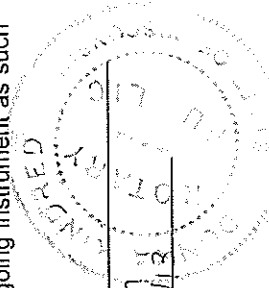

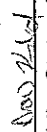
  
Notary Public, State of Wisconsin  
My Commission expires 2/24/13  
My commission is permanent.

DUD# 2784

MILWAUKEE COUNTY CERTIFIED SURVEY MAP NO. \_\_\_\_\_

BEING A DIVISION OF LOTS 24, 25, 26 AND 27, BLOCK 2, M. KEENAN'S SUBDIVISION AND ALL OF CERTIFIED SURVY MAP NO. 7683 INCLUDING THE ALLEY (NOW VACATED) ALL LOCATED IN THE NORTHEAST ¼ OF THE SOUTHEAST ¼ OF SECTION 31, TOWN 7 NORTH, RANGE 22 EAST, CITY OF MILWAUKEE, MILWAUKEE COUNTY, WISCONSIN.

CERTIFICATE OF CITY TREASURER  
STATE OF WISCONSIN)  
MILWAUKEE COUNTY )SS

I, Wayne F. Whittow, being the duly elected, qualified and acting City Treasurer of the City of Milwaukee, certify that in accordance with the records in the Office of the City Treasurer of the City of Milwaukee there are no unpaid taxes or unpaid special assessments on the land included in this Certified Survey Map.

Date: \_\_\_\_\_  
*Wayne F. Whittow*  
Wayne F. Whittow, City Treasurer

COMMON COUNCIL CERTIFICATE OF APPROVAL

I certify that this Certified Survey Map was approved under Resolution File No. \_\_\_\_\_, adopted by the Common Council of the City of Milwaukee on \_\_\_\_\_, 20\_\_\_\_.

\_\_\_\_\_  
Ronald D. Leonhardt, City Clerk

\_\_\_\_\_  
Tom Barrett, Mayor

