



LIVING WITH HISTORY

ORD-20-05913
FEN-20-00275

Certificate of Appropriateness

Milwaukee Historic Preservation Commission/200 E. Wells Street/Milwaukee, WI 53202/phone 414-286-5712/fax 414-286-3004

Property 3417 N. SHERMAN BL.
Description of work Metal picket fence in style and location shown. Sign must be compliant with zoning
Date issued 7/2/2020 PTS ID 114983 COA: metal fence

In accordance with the provisions of Section 320-21 (11) and (12) of the Milwaukee Code of Ordinances, the Milwaukee Historic Preservation Commission has issued a certificate of appropriateness for the work listed above. The work was found to be consistent with preservation guidelines. The following conditions apply to this certificate of appropriateness:

All work must be done in a craftsman-like manner, and must be completed within one year of the date this certificate was issued. Staff must approve any changes or additions to this certificate before work begins. Work that is not completed in accordance with this certificate may be subject to correction orders or citations. If you require technical assistance, please contact Dean Doerrfeld of the Historic Preservation staff as follows: Phone: (414) 286-5712 E-mail: Dean.Doerrfeld@milwaukee.gov.

If permits are required, you are responsible for obtaining them from the Milwaukee Development Center. If you have questions about permit requirements, please consult the Development Center's web site, www.milwaukee.gov/build, or call (414) 286-8210.

City of Milwaukee Historic Preservation Staff

Copies to: Development Center, Ald. K. Rainey, Contractor , Inspector Candace Eubanks

STABLE FENCE
 2564 N. Dr. Martin Luther King, Jr. Drive
 Milwaukee, WI 53212
 (414) 447-7988

LICENSED
 BONDED
 INSURED

Hotline needed Time _____ Control number _____ Date _____ Spotted Not spotted
 SF to get permit Customer to get permit Permit not needed

Submitted to		Work to Be Performed at	
Name _____	Name <u>SAME</u>	Street _____	Street _____
Street <u>3417 N. Sherman</u>	Street _____	City _____	City _____ State _____
City <u>Milw.</u> Zip <u>53216</u>	City _____	State _____	State _____
Telephone _____	Telephone _____	Telephone _____	Telephone _____

We propose to furnish all labor and material for the erection of fence as described below:

Fabric Ornamental Wire Only _____
 Total System _____
 Footage 146' O.D. of Line Posts in inches 2"
 Gauge _____ Line Posts spaced apart in feet 8'
 Mesh 3" End and Corner Posts in inches 2"
 Height 4'5" Gate Posts in inches 2 1/2 quantity 4
 Top Rail _____ Walk Gate Size Two Walk Gates
 Tension Wire _____ Gate Posts in inches _____ quantity _____
 Top _____ Double Drive Gate Size _____
 Bottom _____ Gate Posts in inches _____ quantity _____
 Barb Wire _____ Cantilever Gate Size _____

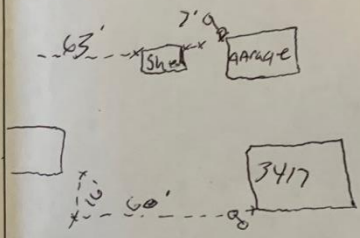

Misc. All posts set in concrete

