

3065 N. 124TH STREET
 BROOKFIELD, WI 53005
 (262) 784-3083 (FAX)
 www.one-source.com

ONE SOURCE CONSULTING
 Civil Engineers and Real Estate Advisors

DATE	
REVISION DESCRIPTION	

PREPARED FOR:
VOLUNTEERS OF AMERICA
 1660 Duke Street
 Alexandria, VA 22314

PROJECT:
3418 N. MLK DRIVE

SHEET TITLE:
PRELIMINARY BOUNDARY

COPYRIGHT NOTICE
 THESE DRAWINGS AS INSTRUMENTS OF SERVICE ARE THE PROPERTY OF ONE SOURCE CONSULTING. ANY CHANGE, PUBLICATION, OR REPRODUCTION OF THESE DRAWINGS WITHOUT THE EXPRESS WRITTEN CONSENT OF ONE SOURCE CONSULTING.

DESIGNED BY	DATE
Checked	12/11/2007
PROJECT NUMBER	124-07
PROJECT TASK	Task 1
SHEET NUMBER	C-1

N. MARTIN LUTHER KING DR.

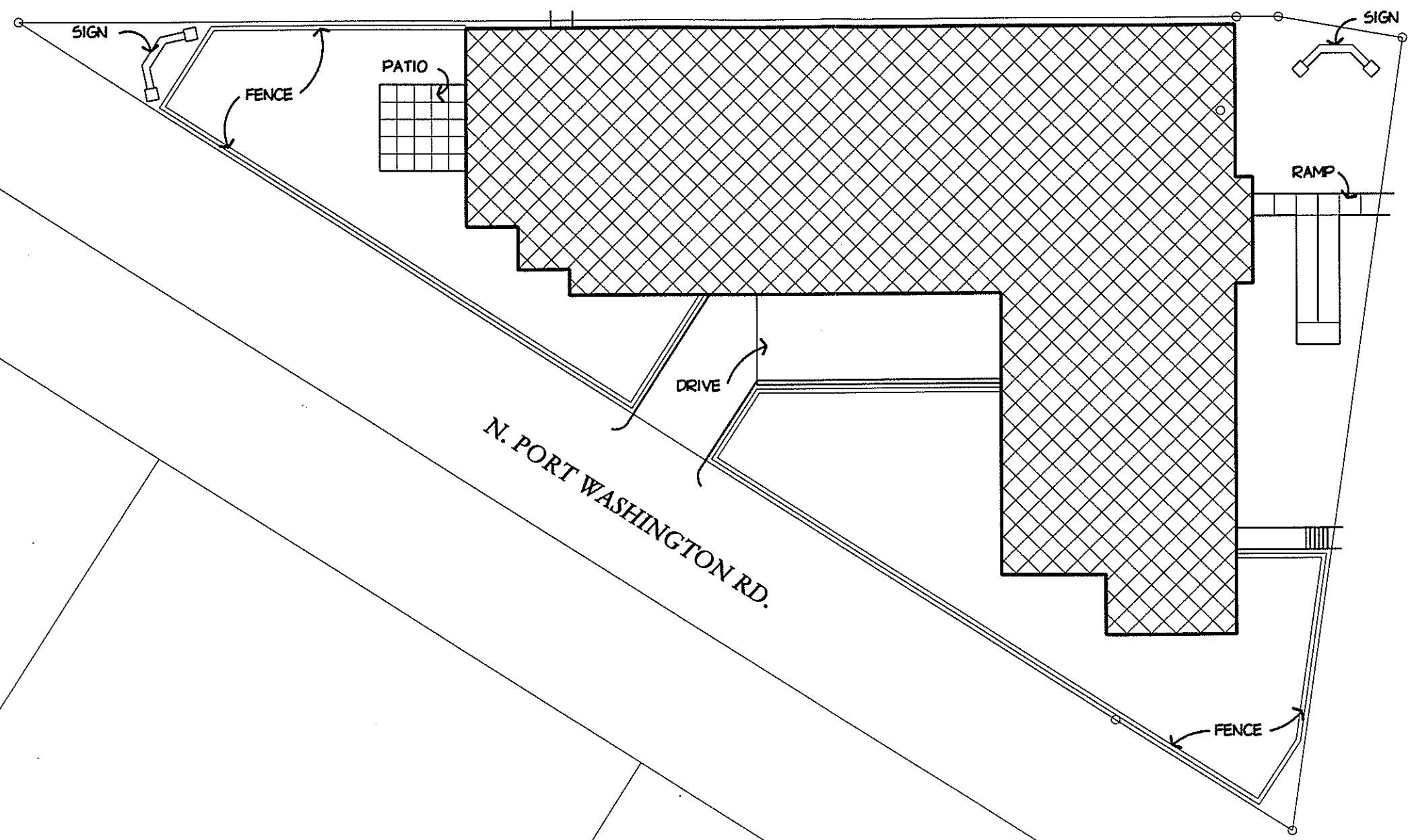

W. KEEFE AVE.

N. PORT WASHINGTON RD.

17 Dec 2007

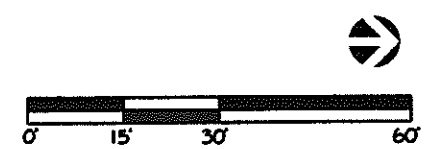

Shiloh Manor

Volunteers of America - Wisconsin
Shiloh Tabernacle Church

