



CERTIFICATE OF APPROPRIATENESS APPLICATION FORM

Incomplete applications will not be processed for Commission review.

Please print legibly.

*Rec'd @ HPC
6/7/2022
CW*

1. HISTORIC NAME OF PROPERTY OR HISTORIC DISTRICT: (if known)

ADDRESS OF PROPERTY:

2112 N Lake Drive, Milwaukee, WI 53202

2. NAME AND ADDRESS OF OWNER:

Name(s): Rebecca Osborn & Matthew Hetzel

Address: 2112 N Lake Drive

City: Milwaukee

State: WI

ZIP: 53202

Email: beckyo44@hotmail.com

Telephone number (area code & number) Daytime: 503-929-4125

Evening: 262-844-9656

3. APPLICANT, AGENT OR CONTRACTOR: (if different from owner)

Name(s): EVI Construction, Inc - Eric vick

Address: 1606 N Jackson St

City: Milwaukee

State: WI

ZIP Code: 53202

Email:

Telephone number (area code & number) Daytime: 414-755-9091

Evening:

4. ATTACHMENTS: (Because projects can vary in size and scope, please call the HPC Office at 414-286-5712 for submittal requirements)

A. REQUIRED FOR MAJOR PROJECTS:

Photographs of affected areas & all sides of the building (annotated photos recommended)

Sketches and Elevation Drawings (1 full size and 1 reduced to 11" x 17" or 8 1/2" x 11")
A digital copy of the photos and drawings is also requested.

Material and Design Specifications (see next page)

B. NEW CONSTRUCTION ALSO REQUIRES:

Floor Plans (1 full size and 1 reduced to a maximum of 11" x 17")

Site Plan showing location of project and adjoining structures and fences

PLEASE NOTE: YOUR APPLICATION CANNOT BE PROCESSED UNLESS BOTH PAGES OF THIS FORM ARE PROPERLY COMPLETED AND SIGNED.

5. DESCRIPTION OF PROJECT:

Tell us what you want to do. Describe all proposed work including materials, design, and dimensions. Additional pages may be attached via email.

We are re landscaping our front yard because all the retaining walls are falling down and the sidewalks are crumbly. Replacing existing landscape that includes dying trees and evergreen bushes. Attached below is Materials and Installation Process

HARDSCAPE

Retaining Walls: Summit Stone Majestic 7 1/4" x 3 5/8" x 10 7/8" (DxHxL)
Installation Process: 6" Tamped Base/ 1' Clear Stone/ Any Ret Wall Over 3' Use GEO GRID Concrete Adhesive.

Walkway Pavers: Discover Majestic (3 Sizes)
Installation Process: 6" 3/4 Drain Base/ 1" Fine TB
Size A: 4" x 2 3/4" x 8"
Size B: 8" x 2 3/4" x 8"
Size C: 8" x 2 3/4" x 12"

Soldier Course Border 4" x 2 3/4" x 8" Reflection

Steps: NY Blue Cut Stone 6' X 6" Thick 12" Deep Thermal Top Rockfaced

Outdoor Living Hardscapes: Rochester Kitchen Outdoor Series

Smoker Cabinet Kit: Bluestone/ Granite Top

Trash Cabinet Kit: Bluestone/ Granite Top

Two Drawer Cabinet Kit: Bluestone/ Granite Top

SOFTSCAPE

- Mississippi Rock
- Weed fabric
- Advanced Seed Blend
- Erosion Control
- Topsoil Clarification

6. SIGNATURE OF APPLICANT:

Signature

Please print or type name

Date

This form and all supporting documentation MUST arrive by 4:00 pm (11:59 pm via email) on the deadline date established to be considered at the next Historic Preservation Commission Meeting. Any information not provided to staff in advance of the meeting will not be considered by the Commission during their deliberation. Please call if you have any questions and staff will assist you.

Mail or Email Form to:
Historic Preservation Commission
City Clerk's Office
841 N. Broadway, Rm. B1
Milwaukee, WI 53202

PHONE: (414) 286-5712 or 286-5722

hpc@milwaukee.gov

www.milwaukee.gov/hpc

Or click the SUBMIT button to automatically email this form for submission.

SUBMIT

Matt & Becky Osborn
 2112 N Lake Dr
 Milwaukee WI

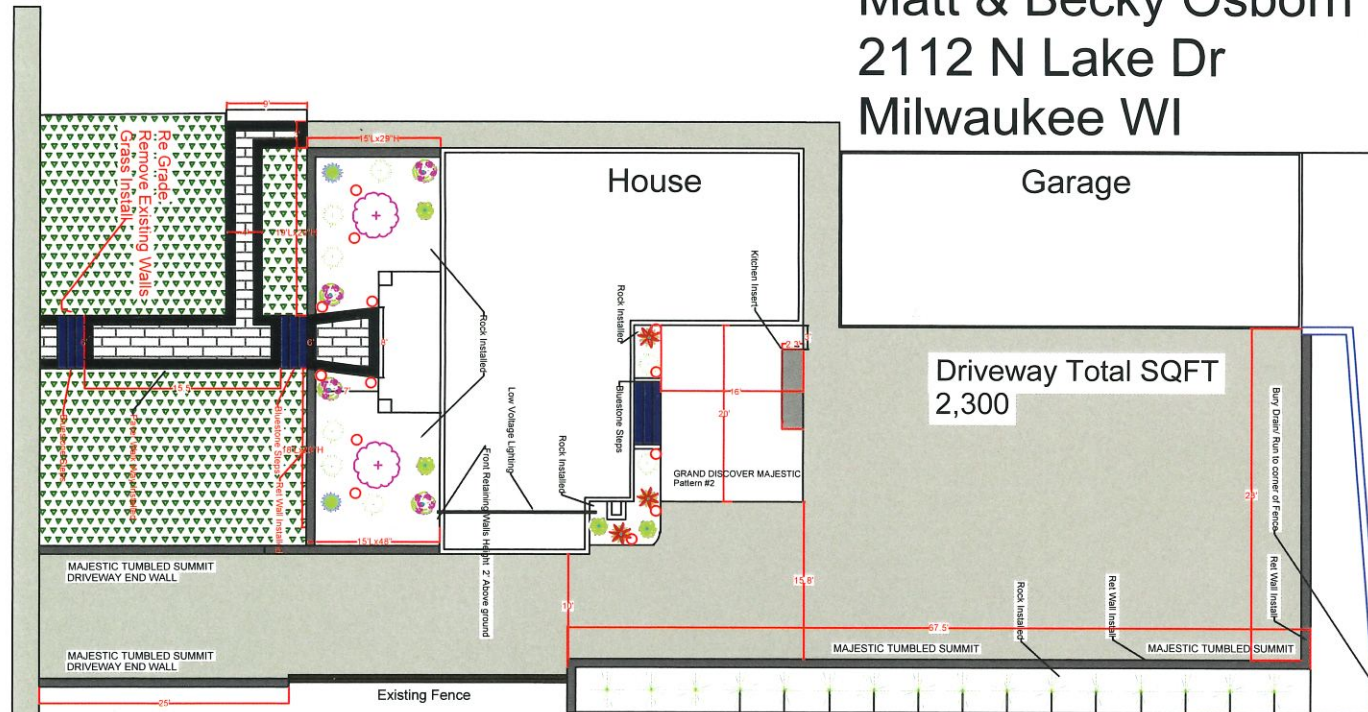

Blue Stone
(3) Cases



Stone/Mulch



Hydrangea
Annabelle



Magnolia
Tree 6'BB



Emerald Arb
7'BB



Boxwood



Ivory Halo Dogwood



Weigela W&R

