

COPYRIGHT SOLID STATE ARCHITECTURE. ALL RIGHTS RESERVED - THIS DRAWING AND/OR CONTENT IS NOT TO BE REPRODUCED, CHANGED, COPIED OR ASSIGNED TO ANY THIRD PARTY IN ANY FORM OR MANNER WITHOUT FIRST OBTAINING THE EXPRESSED WRITTEN CONSENT OF SOLID STATE ARCHITECTURE. THE USER AGREES TO INDEMNIFY AND HOLD THE ARCHITECT HARMLESS FROM ANY DAMAGES, LIABILITY, OR COST, INCLUDING ATTORNEY'S FEES AND COSTS OF DEFENSE RESULTING FROM ANY CHANGES OR MODIFICATIONS MADE BY ANYONE OTHER THAN THE ARCHITECT. THE OWNER OR OWNER'S AGENT SHALL ALSO HOLD HARMLESS THE ARCHITECT FROM ANY REUSE OF THE DRAWINGS OR DATA WITHOUT THE SECURING WRITTEN CONSENT OF THE ARCHITECT.

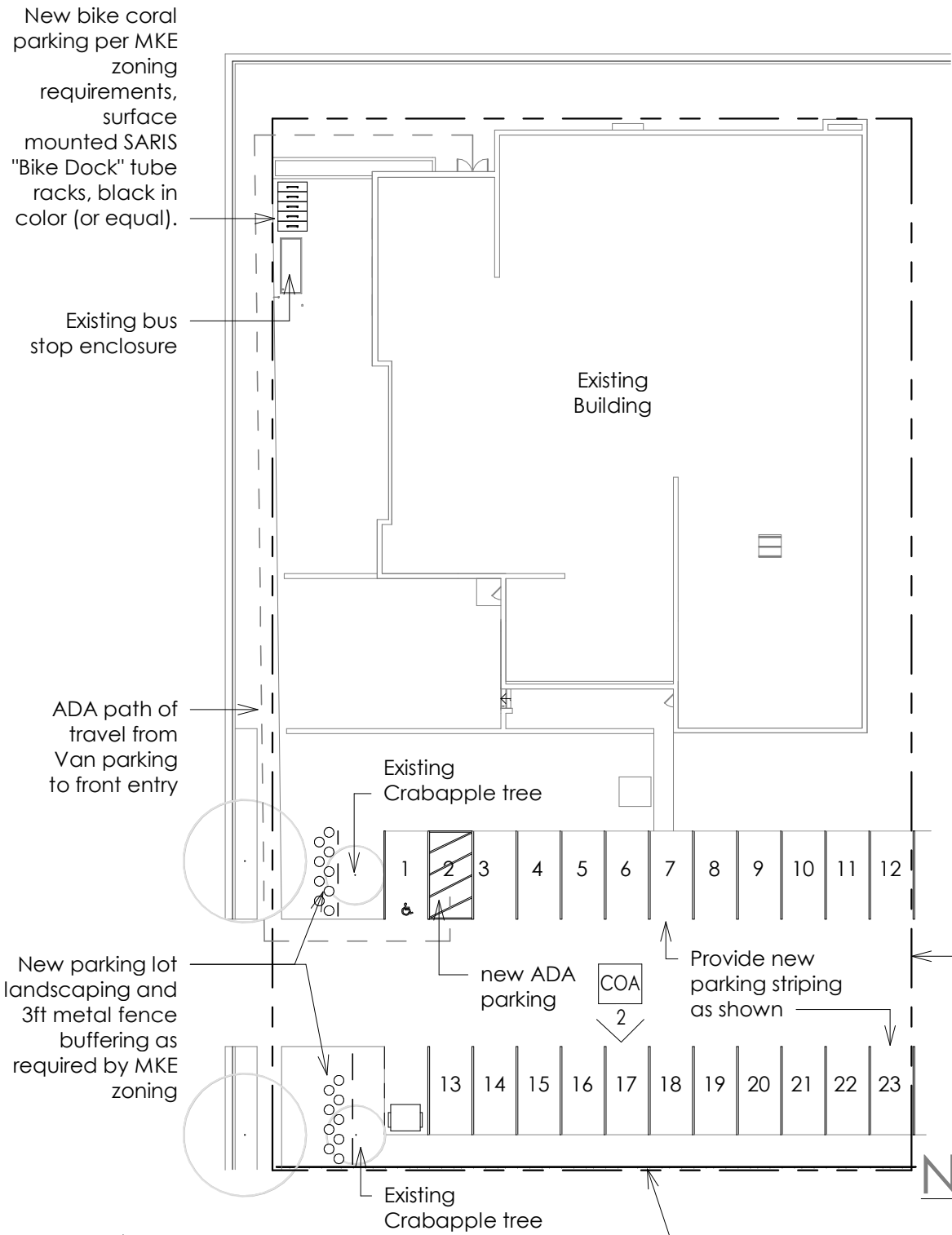

Site Work Scope Summary

- The proposed site work is being performed for compliance with MKE zoning requirements

Note: Parking lot continues to the East and is shared with neighboring property per a land agreement, parking within property limits of Finney property is for Finney use

New 6 ft opaque, painted wood fence @ shared property line w/ adjacent residential property, fence to extend to edge of "Finney" property line, new landscape buffer @ owner side per MKE zoning requirements.

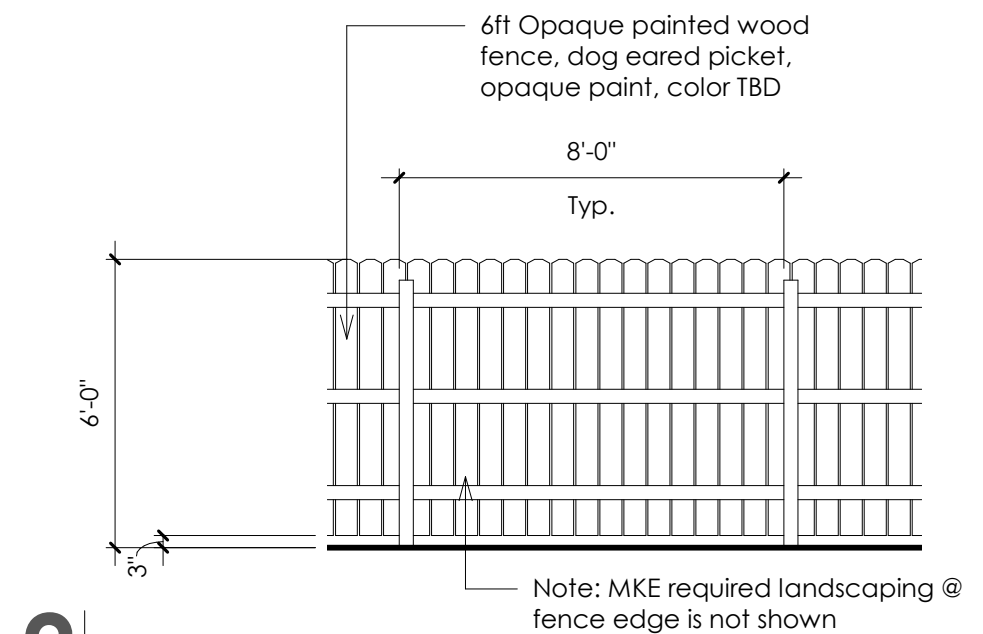

1 Site

Arch Site Plan | 1/32" = 1'-0"

2 Typical Fence @ Lot

Elevation | 1/4" = 1'-0"