



CITY OF MILWAUKEE
OFFICE OF THE CITY CLERK

Friday, October 08, 2021

COMMITTEE MEETING NOTICE

AD 05

SANGHA, Rajmanindr S, Agent
76th Fuel, LLC
7609 W Capitol DR
Milwaukee, WI 53222

You are requested to attend a virtual hearing to be held on:

Tuesday, October 19, 2021 at 09:55 AM

Regarding: Your Extended Hours Establishments, Filling Station, Food Dealer and Weights & Measures License Applications Requesting to be Open 24 Hours from Sun To Sat as agent for "76th Fuel, LLC" for "76th Fuel" at 7609 W Capitol DR. 

This meeting will be held via GoToMeeting. Please see the enclosed best practices document for further instructions. The access code is <https://global.gotomeeting.com/join/636199461>. If you wish to call in, please call +1 (872) 240-3212 and use Access Code: 636-199-461.

There is a possibility that your application may be denied for one or more of the following reasons: The recommendation of the committee regarding the application shall be based on evidence presented at the hearing. Per MCO 85-2.7-4, probative evidence concerning whether or not a new license should be granted may be presented on the following subjects: whether or not the applicant meets the municipal requirements, the appropriateness of the location and premises where the licensed premises is to be located and whether use of the premises for the purposes or activities permitted by the license would tend to facilitate a public or private nuisance or create undesirable neighborhood problems such as disorderly patrons, unreasonably loud noise, litter, and excessive traffic and parking congestion. Probative evidence relating to these matters may be taken from the plan of operation submitted with the license application, if any, but shall not include the content of any music. Evidence regarding the fitness of the location of the premises to be maintained as the principal place of business, including but not limited to whether there is an overconcentration of businesses of the type for which the license is sought; whether the proposal is consistent with any pertinent neighborhood business or development plans, or the location's proximity to areas where children are typically present. The applicant's record in operating similarly licensed premises; and whether or not the applicant has been charged with or convicted of any felony, misdemeanor, municipal offense or other offense, the circumstances of which substantially relate to the activity to be permitted by the license being applied for or any other factor which reasonably relates to the public health, safety or welfare may also be considered. See attached police report or correspondence.

Notice for applicants with warrants or unpaid fines: Proof of warrant satisfaction or payment of fines must be submitted at the hearing on the above date and time. Failure to comply with this requirement may result in a delay of the granting/denial of your application.

Failure to attend this meeting may result in the denial of your license. Individual applicants and partnership applicants must attend or attend by an attorney. The agent or attorney for corporate or limited liability applicants must attend. If you wish to do so and at your own expense, you may be accompanied by an attorney of your choosing to represent you at this hearing.

You will be given an opportunity to speak on behalf of the application and to respond and challenge any charges or reasons given for the denial. No petitions can be accepted by the committee, unless the people who signed the petition attend the virtual hearing and are willing to testify. You may present witnesses under oath and you may also confront and cross-examine opposing witnesses under oath. If you have difficulty with the English language, you should request an interpreter attend the meeting with you, at your expense, so that you can answer questions and participate in your hearing.

PLEASE NOTE: Upon reasonable notice, efforts will be made to accommodate the needs of disabled individuals through sign language interpreters or other auxiliary aids. For additional information or to request this service, contact the Council Services Division ADA Coordinator at (414) 286-2998, Fax - (414) 286-3456, TDD - (414) 286-2025.

JIM OWCZARSKI, CITY CLERK

BY: _____

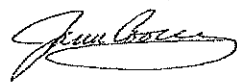

Jim Cooney
License Division Manager

If you have questions regarding this meeting, please contact the staff assistant, Yadira Melendez at (414) 286-2775 or stas5@milwaukee.gov



CITY OF MILWAUKEE
OFFICE OF THE CITY CLERK

Friday, October 08, 2021

COMMITTEE MEETING NOTICE

AD 05

SANGHA, Rajmanindr S, Agent
76th Fuel, LLC
W194 N 5700 DEER PARK CT
MENOMONEE FALLS WI 53051

You are requested to attend a virtual hearing to be held on:

Tuesday, October 19, 2021 at 09:55 AM

Regarding: Your Extended Hours Establishments, Filling Station, Food Dealer and Weights & Measures License Applications Requesting to be Open 24 Hours from Sun To Sat as agent for "76th Fuel, LLC" for "76th Fuel" at 7609 W Capitol DR.

This meeting will be held via GoToMeeting. Please see the enclosed best practices document for further instructions. The access code is <https://global.gotomeeting.com/join/636199461>. If you wish to call in, please call +1 (872) 240-3212 and use Access Code: 636-199-461.

There is a possibility that your application may be denied for one or more of the following reasons: The recommendation of the committee regarding the application shall be based on evidence presented at the hearing. Per MCO 85-2.7-4, probative evidence concerning whether or not a new license should be granted may be presented on the following subjects: whether or not the applicant meets the municipal requirements, the appropriateness of the location and premises where the licensed premises is to be located and whether use of the premises for the purposes or activities permitted by the license would tend to facilitate a public or private nuisance or create undesirable neighborhood problems such as disorderly patrons, unreasonably loud noise, litter, and excessive traffic and parking congestion. Probative evidence relating to these matters may be taken from the plan of operation submitted with the license application, if any, but shall not include the content of any music. Evidence regarding the fitness of the location of the premises to be maintained as the principal place of business, including but not limited to whether there is an overconcentration of businesses of the type for which the license is sought; whether the proposal is consistent with any pertinent neighborhood business or development plans, or the location's proximity to areas where children are typically present. The applicant's record in operating similarly licensed premises; and whether or not the applicant has been charged with or convicted of any felony, misdemeanor, municipal offense or other offense, the circumstances of which substantially relate to the activity to be permitted by the license being applied for or any other factor which reasonably relates to the public health, safety or welfare may also be considered. See attached police report or correspondence.

Notice for applicants with warrants or unpaid fines:

Proof of warrant satisfaction or payment of fines must be submitted at the hearing on the above date and time. Failure to comply with this requirement may result in a delay of the granting/denial of your application.

Failure to attend this meeting may result in the denial of your license. Individual applicants and partnership applicants must attend or attend by an attorney. The agent or attorney for corporate or limited liability applicants must attend. If you wish to do so and at your own expense, you may be accompanied by an attorney of your choosing to represent you at this hearing.

You will be given an opportunity to speak on behalf of the application and to respond and challenge any charges or reasons given for the denial. No petitions can be accepted by the committee, unless the people who signed the petition attend the virtual hearing and are willing to testify. You may present witnesses under oath and you may also confront and cross-examine opposing witnesses under oath. If you have difficulty with the English language, you should request an interpreter attend the meeting with you, at your expense, so that you can answer questions and participate in your hearing.

PLEASE NOTE: Upon reasonable notice, efforts will be made to accommodate the needs of disabled individuals through sign language interpreters or other auxiliary aids. For additional information or to request this service, contact the Council Services Division ADA Coordinator at (414) 286-2998, Fax - (414) 286-3456, TDD - (414) 286-2025.

JIM OWCZARSKI, CITY CLERK

BY:

Jim Cooney
License Division Manager

If you have questions regarding this meeting, please contact the staff assistant, Yadira Melendez at (414) 286-2775 or stasst5@milwaukee.gov



Friday, October 8, 2021



Notice of Public Hearing

Bank
Notice

SANGHA, Rajmanindr S
76th Fuel at 7609 W Capitol Dr
Extended Hours Establishments, Filling Station, Food Dealer and Weights & Measures License
Applications Requesting to be Open 24 Hours from Sun To Sat

Tuesday, October 19, 2021 at 09:55 AM

To whom it may concern:

The above application has been made by the above named applicant(s). This requires approval from the Licenses Committee and the Common Council of the City of Milwaukee. The hearing before the Licenses Committee will take place virtually on 10/19/2021 at 09:55 AM. This is a public hearing. Those wishing to view the proceeding are able to do so via the City Channel – Channel 25 on Spectrum Cable – or on the Internet at <http://city.milwaukee.gov/citychannel>. Those wishing to provide oral testimony will be asked to do so by phone or internet and are asked to contact the staff assistant, Yadira Melendez at (414) 286-2775 or stasst5@milwaukee.gov for necessary information. Please make such requests no later than one business day prior to the start of the meeting. You are not required to attend the hearing, but please see the information below if you would like to provide testimony. Once the Licenses Committee makes its recommendation, this recommendation is forwarded to the full Common Council for approval at its next regularly scheduled hearing.

Important details for those wishing to provide information for the Licenses Committee to consider when making its recommendation:

1. The license application is scheduled to be heard at the above time. Due to other hearings running longer than scheduled, you may have to wait some time to provide your testimony.
2. You must testify as to matters that you have personally experienced or seen. (You cannot provide testimony for your neighbor, parent or anyone else; this is considered hearsay and cannot be considered by the committee.)
3. No letters or petitions can be accepted by the committee (unless the person who wrote the letter or the persons who signed the petition are willing to testify).
4. Persons opposed to the license application are given the opportunity to testify first; supporters may testify after the opponents have finished.
5. When you are called to testify, you will be sworn in and asked to give your name, and address. (If your first and/or last names are uncommon please spell them.)
6. You may then provide testimony.
 - a. Include only information relating to the above license application.
 - b. Include only information you have personally witnessed or seen.
 - c. Provide concise and relevant information detailing how this business has affected or may affect the peaceful enjoyment of your neighborhood.
 - d. If by the time you have the opportunity to testify, the information you wish to share has already been provided to the committee, you may state that you agree with the previous testimony. Redundant or repetitive testimony will not assist the committee in making its recommendation.
7. After giving your testimony, the members of the Licenses Committee and the licensee may ask questions regarding the testimony you have given or other factors relating to the license application.
8. Business Competition is not a valid basis for denial or non-renewal of a license.

Please Note: If you have submitted an objection to the above application your objection cannot be considered by the committee unless you personally testify at the hearing.

OCCUPANT	MAIL ADDRESS	CITY STATE ZIP
CURRENT OCCUPANT	3927 N 77TH ST	MILWAUKEE, WI 53222-3027
CURRENT OCCUPANT	3933 N 76TH ST, 1	MILWAUKEE, WI 53222-3005
CURRENT OCCUPANT	3933 N 76TH ST, 2	MILWAUKEE, WI 53222-3005
CURRENT OCCUPANT	3933 N 76TH ST, 3	MILWAUKEE, WI 53222-3005
CURRENT OCCUPANT	3933 N 76TH ST, 4	MILWAUKEE, WI 53222-3005
CURRENT OCCUPANT	3935 N 76TH ST, 1	MILWAUKEE, WI 53222-3005
CURRENT OCCUPANT	3935 N 76TH ST, 2	MILWAUKEE, WI 53222-3005
CURRENT OCCUPANT	3935 N 76TH ST, 3	MILWAUKEE, WI 53222-3005
CURRENT OCCUPANT	3935 N 76TH ST, 4	MILWAUKEE, WI 53222-3005
CURRENT OCCUPANT	3935 N 77TH ST	MILWAUKEE, WI 53222-3027
CURRENT OCCUPANT	3937 N 76TH ST, 1	MILWAUKEE, WI 53222-3005
CURRENT OCCUPANT	3937 N 76TH ST, 2	MILWAUKEE, WI 53222-3005
CURRENT OCCUPANT	3937 N 76TH ST, 3	MILWAUKEE, WI 53222-3005
CURRENT OCCUPANT	3937 N 76TH ST, 4	MILWAUKEE, WI 53222-3005
CURRENT OCCUPANT	3938 N 77TH ST	MILWAUKEE, WI 53222-3028
CURRENT OCCUPANT	3942 N 78TH ST	MILWAUKEE, WI 53222-3098
CURRENT OCCUPANT	3943 N 77TH ST	MILWAUKEE, WI 53222-3027
CURRENT OCCUPANT	3944 N 77TH ST	MILWAUKEE, WI 53222-3028
CURRENT OCCUPANT	3949 N 77TH ST	MILWAUKEE, WI 53222-3027
CURRENT OCCUPANT	3950 N 77TH ST	MILWAUKEE, WI 53222-3028
CURRENT OCCUPANT	3950 N 78TH ST	MILWAUKEE, WI 53222-3098
CURRENT OCCUPANT	3954 N 77TH ST	MILWAUKEE, WI 53222-3028
CURRENT OCCUPANT	3954 N 78TH ST	MILWAUKEE, WI 53222-3098
CURRENT OCCUPANT	3955 N 77TH ST	MILWAUKEE, WI 53222-3027

Total Records: 24

Radius: 250.0 feet and Center of Circle: 7609 W Capitol Dr



Friday, October 08, 2021

Licenses Committee Notice of Hearing

West Capitol Realty LLC
7609 W CAPITOL DR
Milwaukee, WI 53222

The Licenses Committee will consider the following license application:

Extended Hours Establishments, Filling Station, Food Dealer and Weights & Measures License Applications Requesting to be Open 24 Hours from Sun To Sat
SANGHA, Rajmanindr S, Agent
76th Fuel at 7609 W Capitol DR

Date: 10/19/2021

Time: 09:55 AM

Location: The hearing before the Licenses Committee will take place virtually on Tuesday, October 19, 2021. This is a public hearing. Those wishing to view the proceeding are able to do so via the City Channel – Channel 25 on Spectrum Cable – or on the Internet at <http://city.milwaukee.gov/citychannel>. Those wishing to provide oral testimony will be asked to do so by phone or internet and are asked to contact the staff assistant, Yadira Melendez at (414) 286-2775 or stasst5@milwaukee.gov for necessary information. Please make such requests no later than one business day prior to the start of the meeting. You are not required to attend the hearing, but please see the information below if you would like to provide testimony.

Please note this application may be recommended for denial based on fitness of the location due to concentration of Extended Hours Establishments, Filling Station, Food Dealer and Weights & Measures License Applications Requesting to be Open 24 Hours from Sun To Sat in the area. If the application is denied for this reason, no other application for a Extended Hours Establishments, Filling Station, Food Dealer and Weights & Measures License Applications Requesting to be Open 24 Hours from Sun To Sat license for this location shall be recommended for approval by the Licenses Committee within three years of the date of denial unless the applicant has demonstrated a change of circumstances since the prior denial.





BUSINESS LICENSE PLAN OF OPERATION

ccl-busplan 5/12/2020

Office of the City Clerk License Division
200 E. Wells St. Room 105, Milwaukee, WI 53202
(414) 286-2238 www.milwaukee.gov/license e-mail address: license@milwaukee.gov

1. Type of Business

Applying for: Extended Hours (12AM to 5AM) - If a food establishment, check all that apply: Delivery Drive Thru Dining Room
 Self Service Laundry Massage Establishment Filling Station
 Other (supplemental application for specific license also required)

Provide a detailed description of the type of business you plan on operating:
GAS STATION & CONVENIENCE STORE & CARWASH

Do you have any experience operating this type of business? No Yes If yes, explain: own other filling station in MILWAUKEE COUNTY

2. Business Operations

- a. Proposed Opening Date: 08-01-2021
- b. Is this premise under construction? No Yes If yes, list estimated completion date: _____
- c. Is this a franchise? No Yes
- d. Is this premises currently licensed? No Yes If yes, list type of license: Cigarettes, Food, Filling
- e. Is the current licensee operating? No Yes If no, list date closed: _____
- f. Do you have future plans for other businesses, licenses or permits at this location? No Yes
If yes, explain: _____
- g. Have you previously held an Extended Hours License in Milwaukee? No Yes
If yes, list address(es): 4928 W VILLARD AVE MILWAUKEE WI 53218
- h. Are other businesses operating in the same building? No Yes if yes, describe: FAST FOOD located out to other operator

3. Litter & Noise

- a. How are grounds kept clean? Sweep Pressure Wash Pick Up Litter Other: _____
- b. How often will grounds be cleaned? Daily Weekly As Needed Monthly Other: _____
- c. Grounds cleaned by: Licensee Building Owner Employees Hired Maintenance Other: _____
- d. How are noise issues prevented and/or addressed? Security Manager approaches customer(s) Call Police
 Signs Posted Other: Security camera here installed
- e. Will a sound amplification system be used? No Yes If yes, describe: _____

4. Smoking & Sanitation

- a. Are there designated outdoor smoking areas? No Yes If yes, describe: _____
- b. Number of Garbage Cans: Inside: 6 Locations: 2 in back room, 1 CUBER AREA, 2 on main
Outside: 6 Locations: 1 in COFFEE AREA
4 between pumps 2 front of Dr
- c. Is a crowd control barrier used? No Yes If yes, describe: _____
- d. How many restrooms are on the premises? 2
- e. Name of solid waste contractor: Advanced Disposal Waste Management Other: _____

5. Security

- a. Are there onsite parking spaces? No Yes If yes, how many? 10 and describe the parking security plan: _____
- b. Is there a loading zone? No Yes If yes, describe the loading area security plan: _____
- c. Will you have security personnel on premise? No Yes If yes, how many? _____ and answer the following:
 What are their responsibilities? _____
 Is security equipment used? No Yes If yes, describe _____
 List their licensing, certification, or training credentials _____
- d. Will there be security cameras? No Yes If yes, how many? 16 and list locations: 8 inside 8 outside
- e. Will searches/identification checks be done upon entry? No Yes If yes, describe _____

6. Percentage of Sales (must total 100%)

Alcohol _____%	Food <u>40</u> %	Secondhand Merchandise _____%	Precious Metals & Gems _____%
Entertainment _____%	Cigarettes <u>30</u> %	Personal Services (such as tattoo, body piercing, salon, tailor, tanning, etc.) _____%	Other <u>40</u> % Describe: <u>Gas & Lottery</u>
Pawnbroker Activity _____%	Salvaged Materials _____% (such as scrap metal)		

7. Businesses/Licenses on the Premises (check all that apply):

Type 1

- Full Service Restaurant Cafe/Coffee Shop Deli or Fast Food Restaurant Private/Fraternal/Veterans Club
- Night Club Tavern Cocktail Lounge Teen Club
- Banquet Hall Sports Facility Bowling Alley
- Hotel/Motel : Number of Floors: _____ Rooming House: Number of Floors: _____
 Number of Rooms: _____ Number of Rooms: _____

Type 2

- Liquor Store Corner Store Supermarket Convenience Store
- Gas Station Amusement/Phonograph Distributor Recycling, Salvage or Towing
- Used Car Dealer Personal Service Establishment
 (such as tattoo business, hair salon, tailor, etc.) Recording Studio

What other licenses/permits will you hold at this location? (check all that apply).

- Occupancy Permit Cigarette & Tobacco Gas Station Extended Hours Class "B" Tavern Weights & Measures
- Secondhand Dealer Precious Metal & Gem Other: _____

8. Legal Capacity (only if a Type 1 premises in #7 above)

Capacity _____ (Call the Milwaukee Development Center at 414-286-8211 if you have questions.)

9. Premises Description

- a. Identify all area(s) of the premises that will be used in operating this business (include areas used only for storage):
 1st Floor 2nd Floor Basement Storage Patio Beer Garden Sidewalk Café Deck Rooftop
 Other: Describe: Kitchen space SE CORNER of building.
- b. Describe Location: Major Thoroughfare Secondary Street Other: 76th Street Capitol + 77th Street
- c. Nearest Major Cross Street: 76th Street
- d. Describe Building: Free Standing Building Strip Mall Other: _____
- e. Describe Premises Structure: Single Story Multi-Story - # of Stories _____ Other: _____
- f. Describe Surrounding Area: Commercial Residential Industrial Other: _____
- g. Building Owner Name: Saeed Sheikh Phone Number: (372)-212-2615
 Building Owner Address: 7609 W Capitol Drive Milwaukee WI 53222

10. Hours of Operation & Customers

Will customers be entering the premises? No Yes

Day of the Week	Proposed Hours of Operation:		Estimated Number of Customers expected each day	Potential Age Range of Customers	Class B Tavern Applicant Only: Age Restriction (if none, write 'None')
	Open Time (include a.m. or p.m.)	Close Time (include a.m. or p.m.)			
Sunday	24 Hours		300	all ages	
Monday	11	11	300	11	5
Tuesday	11	11	300	11	5
Wednesday	11	11	300	11	
Thursday	11	11	300	11	
Friday	11	11	300	11	
Saturday	11	11	300	11	

An Extended Hours Establishment License is required for any convenience store, filling station, personal service establishment (such as tattoo, body piercing, salon, tailor, tanning, etc.), recording studio or restaurant which is open between the hours of 12:00 a.m. and 5:00 a.m.

Alcohol Establishments Permitted Hours of Operation: Class A: 8:00 am to 9:00 pm Sunday thru Saturday
 Class B: 6:00 am to 2:00 am Sunday thru Thursday, 6:00 am to 2:30 am Friday & Saturday

Entertainment Outdoor Closing Hours: 10:00pm Sunday-Thursday; 12:00am Friday & Saturday; unless a different time, either earlier or later, is established by the Common Council in its approval of the licensee's plan of operation.

11. Signature(s)

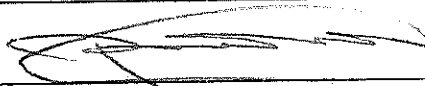
 Signature of Sole Proprietor, Partner, or 20% or more Shareholder
 (If there are no 20% or more shareholders, Corporate Officer-print name/title and sign)

 Signature of additional partner or 20% or more shareholder

See Application Information for a complete list of all required application forms.



FOOD DEALER LICENSE PLAN OF OPERATION

ccl-foodplan 2/28/19

OFFICE OF THE CITY CLERK, LICENSE DIVISION
CITY HALL, 200 E. WELLS ST, ROOM 105, MILWAUKEE, WI 53202
(414) 286-2238 • license@milwaukee.gov • www.milwaukee.gov/license

Legal Entity Name: 76th FUEL LLC

Premises Address: 7609 W CAPITOL DRIVE MILWAUKEE WI 53222

SECTION 1 TYPE OF BUSINESS

What will be the majority of your food sales? (check one)

Restaurant Items (meals):

MEALS include, but are not limited to, chicken, ribs, sandwiches, roasted corn, baked potatoes, hot dogs, brats, tacos, nachos w/ cheese and meat, French fries, cooked or deep fried vegetables/fruit, cooked cheese curds, corn dogs, egg rolls, salads.

Retail Items (snacks and beverages):

RETAIL Items include, but are not limited to, ice cream/soft serve, lemonade, snow cones, coffee, espresso, cappuccino, tea, fruit juice, smoothies, candy, dispensed soda, fruit cups, bakery, cookies, kettle corn, cotton candy, funnel cakes, fritters, tortilla chips w/ cheese.

Will it be a convenience store? Yes No

A convenience store contains less than 5,000 square feet of retail space and has, as its primary business, the sale of basic food items and in addition, sells household products or is a filling station that sells basic food items and household products.

Bed & Breakfast

Micro Market

All Applicants: Submit a menu or a list of food items that will be sold.

Will any wholesale business be done? No Yes If yes, what percentage of food sales will be wholesale?

Less than 25%

25% or More AND:

Restaurant items (meals) will be sold – Complete this application and also contact DATCP.

NO restaurant items (meals) will be sold - Do NOT complete this application. Contact DATCP only.

SECTION 2 FOOD PROCESSING

Will any food processing be done? No Yes

Processing is defined as assembling, grinding, cutting, mixing, baking, coating, stuffing, packing, bottling, grilling, canning, extracting, fermenting, distilling, pickling, freezing, drying, smoking, or packaging.

SECTION 3 FOOD REQUIRING TEMPERATURE CONTROL

Will any food that requires temperature control be sold? No Yes

(includes dairy products such as milk, cheese, and ice cream, fish, shellfish, meat, poultry)

If yes, list the types of food items: milk, cheese, ice cream, meat, FROZEN food

SECTION 4 DETAILS OF OPERATION

Will you have seating on site for dining? No Yes

Will you be doing any catering? No Yes

Will you be doing any delivery? No Yes

Will you have outdoor activities? No Yes - Check all that apply: Bar Cooking/Grilling Dining

Will you have a drive thru window? No Yes - Are hours different from inside? No Yes
 If Yes, provide drive thru hours: _____

Will scales or barcode scanners be used? No Yes - You must also apply for a Weights & Measures License.

SECTION 5 ADDITIONAL SITES

Where will food be prepared and/or sold?
 At a single site At multiple sites: How many? _____ (for example, a hotel with several dining rooms or bars)
 If multiple sites, attach a Food Dealer Additional Site Addendum (ccl-foodadd) for each additional site.

SECTION 6 CONSTRUCTION OR CHANGES

Are you planning any construction, remodeling or equipment changes?
 No If No, SKIP to Section 8
 Yes If Yes, check all that apply: New construction of a building Renovation or remodeling
 Construction changes to existing building Equipment changes only

Provide a brief description of the changes: _____
 Start date: _____
 Name, Address & Phone Number of Architect: _____

 Name, Address & Phone Number of Contractor: _____

SECTION 7 ALCOHOL BEVERAGES

Are you applying for an alcohol beverage license?
 No If No, SKIP to Section 8
 Yes If YES, if your food license is approved prior to the alcohol license, when do you want the food license issued?
 Immediately At the same time as the alcohol license

SECTION 8 ACKNOWLEDGEMENTS & SIGNATURE

You must initial each item confirming your understanding:

PS I understand the Health Department must conduct an inspection and advise the License Division of their approval before the license may be issued.

B I understand I must obtain an occupancy permit from the Department of Neighborhood Services and an inspection may be required. Neighborhood Services must advise the License Division of their approval before the license may be issued.

B I understand the district alderperson will review and either support or object to my application. If he/she objects, I may appeal and be scheduled to appear before the Licenses Committee. The Licenses Committee will then make a recommendation to the Common Council. The Common Council must grant the license before it may be issued.

PS I understand proof of payment for all license fees must be on file in the License Division before the license may be issued and the license must be issued and posted in my establishment prior to opening for business.

PS I will not operate my food business until the license has been issued and posted in the establishment.

Signature of Sole Proprietor, Partner, or 20% Shareholder: _____

Signature of Additional Partner: _____



**FILLING STATION LICENSE AND
WEIGHTS & MEASURES (RETAIL PETROLEUM METERS)
LICENSE SUPPLEMENTAL APPLICATION**

OFFICE OF THE CITY CLERK, LICENSE DIVISION
CITY HALL, 200 E. WELLS ST, ROOM 105, MILWAUKEE, WI 53202
(414) 286-2238 • license@milwaukee.gov • www.milwaukee.gov/license

Legal Entity Name: 76th FUEL LLC
Premise Address: 7609 W CAPITOL DRIVE MILWAUKEE WI 53222

Filling Station License Fee \$ 275

Weights & Measures License Fee
Number of Retail Petroleum Meters* 28 x \$60 per meter = \$ 1680

*For each nozzle, count the number of grades (not including midgrade if mixed in the pump), add the number of all grades together and that is your number of retail petroleum meters.

Will electronic scanners be used to determine/record the price of items? No Yes
Will scales be used to price items based on their weight? No Yes

If yes to either or both questions, a separate Weights & Measures License Application must be submitted for these devices.

Acknowledgements and Signature

I confirm that all information is true and correct. I understand any changes to the information in this application must be reported to the City Clerk License Division within 10 days. I have knowledge of the City of Milwaukee ordinances currently regulating the licenses applied for and understand that the licenses may be subject to suspension, non-renewal, or revocation if I violate these regulations.

Signature of Sole Proprietor, Partner, or 20% or more Shareholder
(If no 20% or more Shareholder, Corporate Officer must sign and provide title)

Signature of Additional Partner or 20% or more Shareholder

Submit this form with the following:

- Business License Application
- Business Plan of Operation
- Floor plan
- License fees

Forms can be obtained online at www.milwaukee.gov/licenses

Office Use Only:

App#	_____	Filed	_____	Initials	_____
Paid	_____	MPD	_____	CC	_____
HD	_____	DNS	_____	Lic #	_____



WEIGHTS & MEASURES PLAN OF OPERATION

ccl-wmplan 1/9/18

Office of the City Clerk License Division
200 E. Wells St. Room 105, Milwaukee, WI 53202
(414) 286-2238 www.milwaukee.gov/license license@milwaukee.gov

Legal Entity Name: 76th FUEL LLC
Premise Address: 7609 W CAPITAL DRIVE MILWAUKEE WI 53222

Type of Business

Provide a brief description of the establishment/business:

GAS Station & CONVENIENCE & CAR WASH

Other licenses may be required depending on the type of business you are operating.

24 HOURS, Cigarettes, Food, Pi Vng, weight men

Litter & Noise

- a. How are grounds kept clean? Sweep Pressure Wash Pick Up Litter Other: _____
- b. How often will grounds be cleaned? Daily Weekly As Needed Monthly Other: _____
- c. Grounds cleaned by: Licensee Building Owner Employees Hired Maintenance Other: _____
- d. How are noise issues prevented and/or addressed? Security Manager approaches customer(s) Call Police
 Signs Posted Other: CAMERAS

Signature

Signature of Sole Proprietor, Partner, or 20% or more Shareholder
(If there are no 20% or more shareholders,
Corporate Officer-print name/title and sign)

Signature of additional partner or 20% or more shareholder

This form must be submitted with the Business License Application, Weights & Measures License Supplemental Application, and appropriate fee. Forms can be obtained online at www.milwaukee.gov/licenses.

(7609 W. CAPITAL DR) FLOOR PLAN FOR 76th FUEL DIPLE

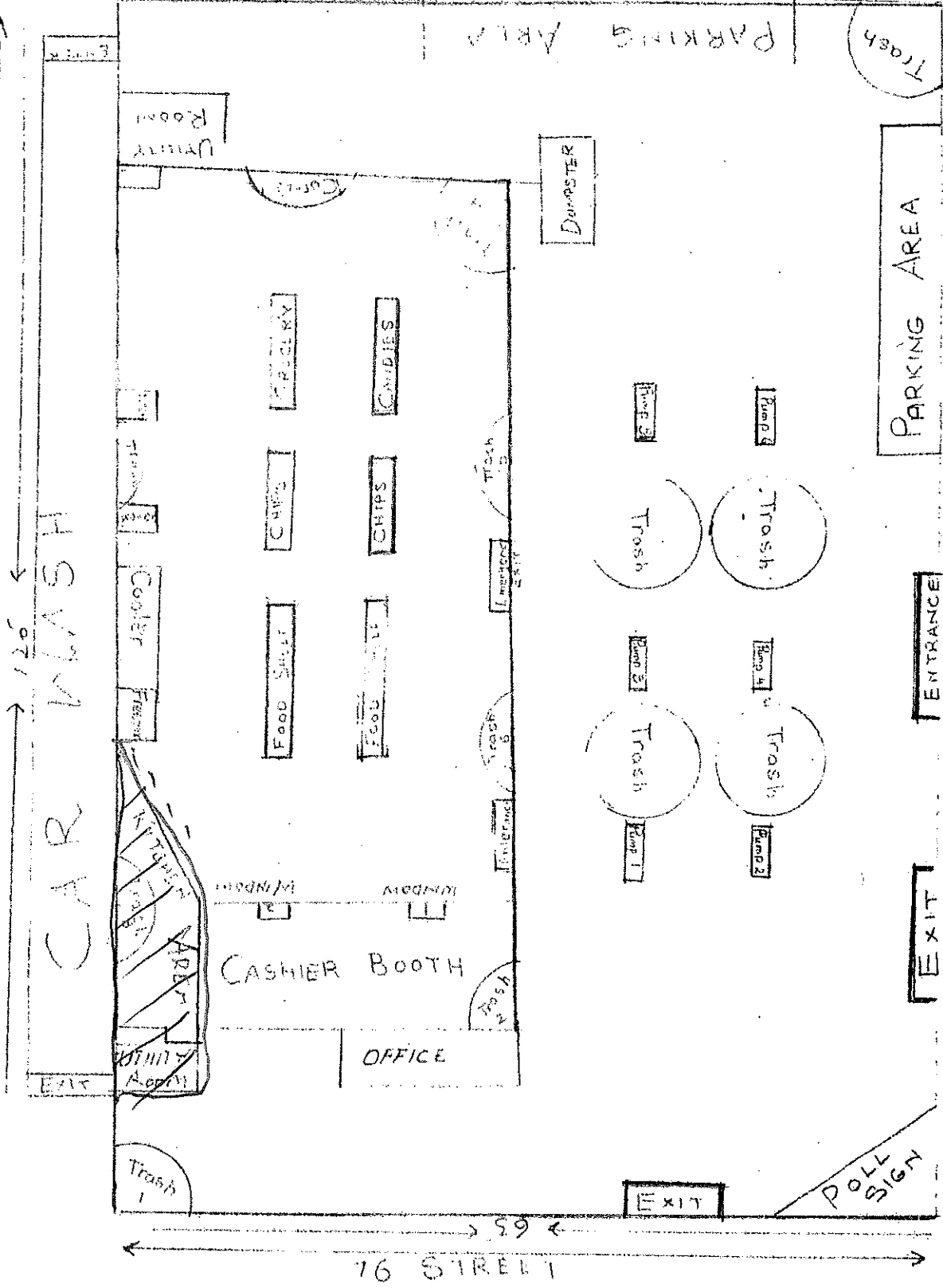

DATE 08/25/2021
 76th FUEL LLC
 AGENT - RAJ MANINDER S. SANGHA
 7609 W CAPITAL DR
 MINNEAPOLIS, MN