

CERTIFIED SURVEY MAP NO.

BEING A PART OF THE SOUTHWEST 1/4 OF THE SOUTHWEST 1/4 OF SECTION 17, TOWNSHIP 8 NORTH, RANGE 21 EAST IN THE CITY OF MILWAUKEE, MILWAUKEE COUNTY, WISCONSIN.

VICINITY MAP

1" = 2000'

N 99TH ST

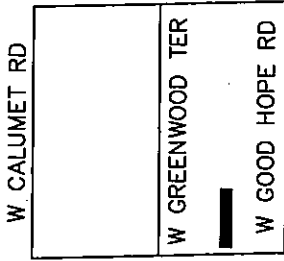

N 107TH ST

SW 1/4
SEC. 17-8-21

PREPARED FOR:
WILLIE & SHONDA HUERTA
7276 N 107TH ST
MILWAUKEE, WI



CAPITOL SURVEY ENTERPRISES
237 SOUTH CURTIS ROAD
MILWAUKEE, WI 53214
PH: (414) 727-7510
FAX: (414) 727-7518
WWW.CAPITOLSURVEY.COM

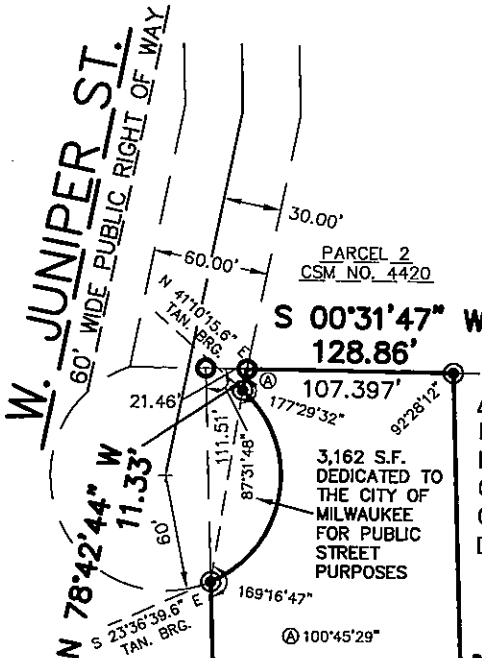

$\Delta=115^{\circ}13'04.8''$
 $R=60.00'$
 $L=120.656'$
 $CB=S81^{\circ}13'12''E$
 $CH=101.329'$
 $DEF. \Delta=57^{\circ}36'32.4''$

- INDICATES 1 INCH DIA. IRON PIPE, FOUND.
- ⊙ INDICATES 1 INCH DIA. IRON PIPE, 18 INCHES IN LENGTH, WEIGHING 1.68 LBS PER LINEAL FOOT, SET.
- Ⓜ INDICATES WATER WELL

NOTES:

TAX KEY NO. 110-9984-100

ZONED: RS1, SINGLE-FAMILY RESIDENTIAL DISTRICT.

MINIMUM SETBACK REQUIREMENTS PER THE CITY OF MILWAUKEE ZONING CODE ARE: FRONT - AVERAGE OR 25 FEET, WHICHEVER IS LESS, SOUTH OR EAST SIDE - 6.0 FEET, NORTH OR WEST SIDE - 3.0 FEET, COMBINED SIDE - 12 FEET, REAR - 25 FEET.

SUBJECT LANDS ARE ZONE "X" PER FLOOD INSURANCE RATE MAP #55079C0018E, EFFECTIVE DATE SEPTEMBER 26, 2008.

ALL BEARINGS REFER TO THE WEST LINE OF THE SOUTHWEST 1/4 OF SECTION 17-8-21, WHICH HAS A WISCONSIN STATE PLANE COORDINATE SYSTEM SOUTH ZONE (REVISION DECEMBER, 2008, NAD 27 DATUM) BEARING OF N 00°31'47" E.

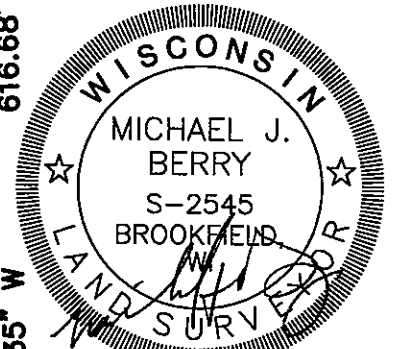

6-20-12
REVISED 9-20-12
REVISED 10-20-12

GRAPHIC SCALE

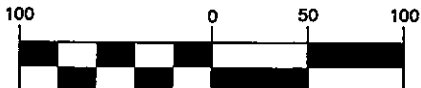

1 inch = 100 ft.

NW COR SW 1/4
SEC. 17-8-21
FND CONC MON
WITH BRASS CAP
N 427.313.64
E 2,521,704.87

SW COR SW 1/4
SEC. 17-8-21
FND IRON PLUG
WITH CHIS. CROSS
N 424,669.59
E 2,521,680.43

WEST LINE OF THE SW 1/4 OF SEC. 17-8-21 N 00°31'47" E 2644.41'
NORTH 107TH STREET
120' WIDE PUBLIC RIGHT OF WAY

INFRASTRUCTURE SERVICES DIVISION

Marcia Cornell 4/9/13
CENTRAL DRAFTING & RECORDS MANAGER

Z/ Timothy J. Thur 1/7/13
ENGR. IN CHARGE ENVIRON. ENGR.

[Signature] 1/14/13
CITY ENGINEER

CORRECT

APPROVED

DEPARTMENT OF CITY DEVELOPMENT
CITY OF MILWAUKEE

JUL 23, 2012

[Signature]
STAFF APPROVED

CERTIFIED SURVEY MAP NO. _____

BEING A PART OF THE SOUTHWEST 1/4 OF THE SOUTHWEST 1/4 OF SECTION 17, TOWNSHIP 8 NORTH, RANGE 21 EAST IN THE CITY OF MILWAUKEE, MILWAUKEE COUNTY, WISCONSIN.

SURVEYOR'S CERTIFICATE

STATE OF WISCONSIN)
MILWAUKEE COUNTY) SS

I, MICHAEL J BERRY, REGISTERED LAND SURVEYOR, DO HEREBY CERTIFY:

THAT I HAVE SURVEYED, DIVIDED AND MAPPED A DIVISION OF LANDS IN THE SOUTHWEST 1/4 OF THE SOUTHWEST 1/4 OF SECTION 17, TOWNSHIP 8 NORTH, RANGE 21 EAST, IN THE CITY OF MILWAUKEE, MILWAUKEE COUNTY, WISCONSIN, BOUNDED AND DESCRIBED AS FOLLOWS:

COMMENCING AT THE SOUTHWEST CORNER OF SAID 1/4 SECTION; THENCE NORTH 00°31'47" EAST ALONG THE WEST LINE OF SAID 1/4 SECTION, 548.85 FEET; THENCE NORTH 88°03'35" EAST, 60.06 FEET TO THE POINT OF BEGINNING OF LANDS TO BE DESCRIBED; THENCE NORTH 00°31'47" EAST, 128.86 FEET; THENCE NORTH 88°03'35" EAST, 616.68 FEET; THENCE SOUTH 00°31'47" WEST, 128.86 FEET; THENCE SOUTH 88°03'35" WEST, 616.68 FEET TO THE POINT OF BEGINNING.

SAID LANDS CONTAINING: 76,230 SQUARE FEET OR 1.750 ACRES

THAT I HAVE MADE SUCH SURVEY, LAND DIVISION AND MAP BY THE DIRECTION OF WILLIE M HUERTA AND SHONDA V HUERTA, OWNERS OF SAID LAND.

THAT SUCH MAP IS A CORRECT REPRESENTATION OF ALL EXTERIOR BOUNDARIES OF THE LAND SURVEYED AND THE DIVISION THEREOF MADE.

THAT I HAVE FULLY COMPLIED WITH THE PROVISIONS OF CHAPTER 236.34 OF THE STATUTES OF THE STATE OF WISCONSIN AND CHAPTER 119 OF THE CITY OF MILWAUKEE CODE OF ORDINANCES IN SURVEYING, DIVIDING, AND MAPPING THE SAME.

DATED THIS 20TH DAY OF SEPTEMBER, 2012.

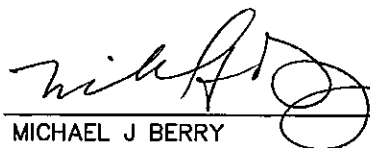

MICHAEL J BERRY
REGISTERED LAND SURVEYOR, S-2545
STATE OF WISCONSIN

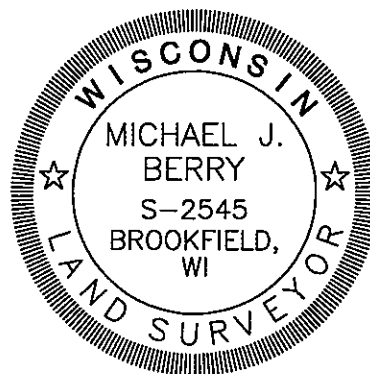

CERTIFIED SURVEY MAP NO. _____

BEING A PART OF THE SOUTHWEST 1/4 OF THE SOUTHWEST 1/4 OF SECTION 17, TOWNSHIP 8 NORTH, RANGE 21 EAST IN THE CITY OF MILWAUKEE, MILWAUKEE COUNTY, WISCONSIN.

OWNER'S CERTIFICATE

WILLIE M HUERTA AND SHONDA V HUERTA, AS OWNERS, DO HEREBY CERTIFY THAT THEY HAVE CAUSED THE LAND DESCRIBED ON THIS MAP TO BE SURVEYED, DIVIDED, AND MAPPED AS REPRESENTED ON THIS MAP IN ACCORDANCE WITH THE REQUIREMENTS OF CHAPTER 119 OF THE MILWAUKEE CODE OF ORDINANCES.



IN CONSIDERATION OF THE APPROVAL OF THE MAP BY THE COMMON COUNCIL OF THE CITY OF MILWAUKEE AND IN ACCORDANCE WITH CHAPTER 119 OF THE MILWAUKEE CODE, THE UNDERSIGNED AGREES:

A. THAT ALL UTILITY LINES TO PROVIDE ELECTRIC POWER AND TELEPHONE SERVICES AND CABLE TELEVISION OR COMMUNICATIONS SYSTEMS LINES OR CABLES TO ALL LOTS IN THE CERTIFIED SURVEY MAP SHALL BE INSTALLED UNDERGROUND IN EASEMENTS PROVIDED THEREFOR, WHERE FEASIBLE.

B. THAT DRIVEWAY ACCESS FROM LOT 1 TO NORTH 107TH STREET IS RESTRICTED AS DELINEATED ON THE ATTACHED MAP.

THIS AGREEMENT SHALL BE BINDING ON THE UNDERSIGNED AND ASSIGNS. IN WITNESS WHEREOF, WILLIE M HUERTA AND SHONDA V HUERTA, AT MILWAUKEE, WISCONSIN, ON THIS 12th DAY OF October, 2012.

STATE OF WISCONSIN) SS
MILWAUKEE COUNTY)

WILLIE M HUERTA, OWNER

SHONDA V HUERTA, OWNER

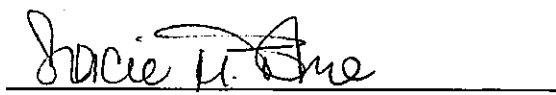
PERSONALLY CAME BEFORE ME THIS 12th DAY OF October, 2012, THE ABOVE NAMED OWNERS ARE TO ME KNOWN TO BE THE SAME PERSONS WHO EXECUTED THE FOREGOING INSTRUMENT AND ACKNOWLEDGE THE SAME.

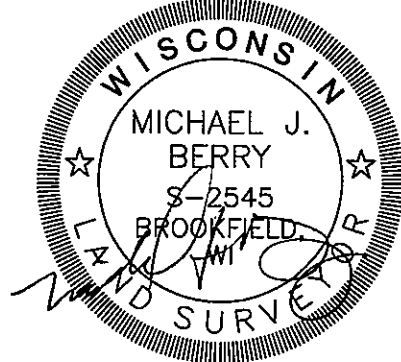
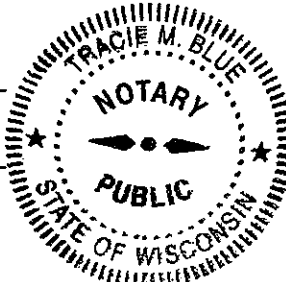
NOTARY PUBLIC
STATE OF WISCONSIN
MY COMMISSION EXPIRES: 10-30-2013



CERTIFICATE OF CITY TREASURER

STATE OF WISCONSIN) SS
MILWAUKEE COUNTY)

I, SPENCER COGGS, BEING THE DULY ELECTED, QUALIFIED AND ACTING CITY TREASURER OF THE CITY OF MILWAUKEE, CERTIFY THAT IN ACCORDANCE WITH THE RECORDS IN THE OFFICE OF THE CITY TREASURER OF THE CITY OF MILWAUKEE THERE ARE NO UNPAID TAXES OR UNPAID SPECIAL ASSESSMENTS ON THE LAND INCLUDED IN THIS CERTIFIED SURVEY MAP.

THIS 15th DAY OF Jan, 2012.

SPENCER COGGS, CITY TREASURER

COMMON COUNCIL CERTIFICATE OF APPROVAL

I CERTIFY THAT THIS CERTIFIED SURVEY MAP WAS APPROVED UNDER RESOLUTION FILE NO. 121414 ADOPTED BY THE COMMON COUNCIL OF THE CITY OF MILWAUKEE ON THIS 5th DAY OF February, 2012.

JAMES R. OWCZARSKI, CITY CLERK

TOM BARRETT, MAYOR