



CITY OF MILWAUKEE
OFFICE OF THE CITY CLERK

Tuesday, July 25, 2017

COMMITTEE MEETING NOTICE

AD 06

NAGRA, Gurinder S, Agent
N. Port Food & Liquor Inc
3876 N Port Washington Av
Milwaukee, WI 53212

You are requested to attend a hearing which is to be held in Common Council Chambers, Third Floor, City Hall on:

Monday, July 31, 2017 at 08:45 AM

Regarding: Your Class A Malt & Class A Liquor and Food Dealer License Applications as agent for "N. Port Food & Liquor Inc" for "N. Port Food & Liquor" at 3876 N Port Washington Av. 

There is a possibility that your application may be denied for one or more of the following reasons: The recommendation of the committee regarding the application shall be based on evidence presented at the hearing. Per MCO 85-2.7-4, probative evidence concerning whether or not a new license should be granted may be presented on the following subjects: whether or not the applicant meets the municipal requirements, the appropriateness of the location and premises where the licensed premises is to be located and whether use of the premises for the purposes or activities permitted by the license would tend to facilitate a public or private nuisance or create undesirable neighborhood problems such as disorderly patrons, unreasonably loud noise, litter, and excessive traffic and parking congestion. Probative evidence relating to these matters may be taken from the plan of operation submitted with the license application, if any, but shall not include the content of any music. Evidence regarding the fitness of the location of the premises to be maintained as the principal place of business, including but not limited to whether there is an overconcentration of businesses of the type for which the license is sought; whether the proposal is consistent with any pertinent neighborhood business or development plans, or the location's proximity to areas where children are typically present. The applicant's record in operating similarly licensed premises; and whether or not the applicant has been charged with or convicted of any felony, misdemeanor, municipal offense or other offense, the circumstances of which substantially relate to the activity to be permitted by the license being applied for or any other factor which reasonably relates to the public health, safety or welfare may also be considered. See attached police report or correspondence.

Notice for applicants with warrants or unpaid fines:

Proof of warrant satisfaction or payment of fines must be submitted at the hearing on the above date and time. Failure to comply with this requirement may result in a delay of the granting/denial of your application.

Failure to appear at this meeting may result in the denial of your license. Individual applicants must appear only in person or by an attorney. Corporate or Limited Liability applicants must appear only by the agent designated on the application or by an attorney. Partnership applicants must appear by a partner listed on the application or by an attorney. If you wish to do so and at your own expense, you may be accompanied by an attorney of your choosing to represent you at this hearing.

You will be given an opportunity to speak on behalf of the application and to respond and challenge any charges or reasons given for the denial. No petitions can be accepted by the committee, unless the people who signed the petition are present at the committee hearing and willing to testify. You may present witnesses under oath and you may also confront and cross-examine opposing witnesses under oath. If you have difficulty with the English language, you should bring an interpreter with you, at your expense, so that you can answer questions and participate in your hearing.

You may examine the application file at this office during regular business hours prior to the hearing date. Inquiries regarding this matter may be directed to the person whose signature appears below.

Limited parking for persons attending meetings in City Hall is available at reduced rates (5 hour limit) at the Milwaukee Center on the southwest corner of East Kilbourn and North Water Street. Parking tickets must be validated in the first floor information booth in City Hall.

PLEASE NOTE: Upon reasonable notice, efforts will be made to accommodate the needs of disabled individuals through sign language interpreters or other auxiliary aids. For additional information or to request this service, contact the Council Services Division ADA Coordinator at (414) 286-2998, Fax - (414) 286-3456, TDD - (414) 286-2025.

JIM OWCZARSKI, CITY CLERK

BY: _____

Jessica Celella
License Division Manager

If you have questions regarding this notice, please contact the License Division at (414) 286-2238.

200 E. Wells Street, Room 105, City Hall, Milwaukee, WI 53202. www.milwaukee.gov/license
Phone: (414) 286-2238 Fax: (414) 286-3057 Email Address: License@milwaukee.gov



CITY OF MILWAUKEE
OFFICE OF THE CITY CLERK

Tuesday, July 25, 2017

COMMITTEE MEETING NOTICE

AD 06

NAGRA, Gurinder S, Agent
N. Port Food & Liquor Inc
3776 Cypress Lane
Franklin, WI 53132

You are requested to attend a hearing which is to be held in Common Council Chambers, Third Floor, City Hall on:

Monday, July 31, 2017 at 08:45 AM

Regarding: Your Class A Malt & Class A Liquor and Food Dealer License Applications as agent for "N. Port Food & Liquor Inc" for "N. Port Food & Liquor" at 3876 N Port Washington Av.

There is a possibility that your application may be denied for one or more of the following reasons: The recommendation of the committee regarding the application shall be based on evidence presented at the hearing. Per MCO 85-2.7-4, probative evidence concerning whether or not a new license should be granted may be presented on the following subjects: whether or not the applicant meets the municipal requirements, the appropriateness of the location and premises where the licensed premises is to be located and whether use of the premises for the purposes or activities permitted by the license would tend to facilitate a public or private nuisance or create undesirable neighborhood problems such as disorderly patrons, unreasonably loud noise, litter, and excessive traffic and parking congestion. Probative evidence relating to these matters may be taken from the plan of operation submitted with the license application, if any, but shall not include the content of any music. Evidence regarding the fitness of the location of the premises to be maintained as the principal place of business, including but not limited to whether there is an overconcentration of businesses of the type for which the license is sought; whether the proposal is consistent with any pertinent neighborhood business or development plans, or the location's proximity to areas where children are typically present. The applicant's record in operating similarly licensed premises; and whether or not the applicant has been charged with or convicted of any felony, misdemeanor, municipal offense or other offense, the circumstances of which substantially relate to the activity to be permitted by the license being applied for or any other factor which reasonably relates to the public health, safety or welfare may also be considered. See attached police report or correspondence.

Notice for applicants with warrants or unpaid fines:

Proof of warrant satisfaction or payment of fines must be submitted at the hearing on the above date and time. Failure to comply with this requirement may result in a delay of the granting/denial of your application.

Failure to appear at this meeting may result in the denial of your license. Individual applicants must appear only in person or by an attorney. Corporate or Limited Liability applicants must appear only by the agent designated on the application or by an attorney. Partnership applicants must appear by a partner listed on the application or by an attorney. If you wish to do so and at your own expense, you may be accompanied by an attorney of your choosing to represent you at this hearing.

You will be given an opportunity to speak on behalf of the application and to respond and challenge any charges or reasons given for the denial. No petitions can be accepted by the committee, unless the people who signed the petition are present at the committee hearing and willing to testify. You may present witnesses under oath and you may also confront and cross-examine opposing witnesses under oath. If you have difficulty with the English language, you should bring an interpreter with you, at your expense, so that you can answer questions and participate in your hearing.

You may examine the application file at this office during regular business hours prior to the hearing date. Inquiries regarding this matter may be directed to the person whose signature appears below.

Limited parking for persons attending meetings in City Hall is available at reduced rates (5 hour limit) at the Milwaukee Center on the southwest corner of East Kilbourn and North Water Street. Parking tickets must be validated in the first floor information booth in City Hall.

PLEASE NOTE: Upon reasonable notice, efforts will be made to accommodate the needs of disabled individuals through sign language interpreters or other auxiliary aids. For additional information or to request this service, contact the Council Services Division ADA Coordinator at (414) 286-2998, Fax - (414) 286-3456, TDD - (414) 286-2025.

JIM OWCZARSKI, CITY CLERK

BY: _____

Jessica Ceella
License Division Manager

If you have questions regarding this notice, please contact the License Division at (414) 286-2238.

200 E. Wells Street, Room 105, City Hall, Milwaukee, WI 53202. www.milwaukee.gov/license
Phone: (414) 286-2238 Fax: (414) 286-3057 Email Address: License@milwaukee.gov

MILWAUKEE POLICE DEPARTMENT LICENSING

CRIMINAL RECORD/ORDINANCE VIOLATION/INCIDENTS SYNOPSIS

DATE: 05/26/2017

LICENSE TYPE: ALQML

NEW:

RENEWAL:

No. 256260

Application Date: 05/25/2017

License Location: 3876 N. Port Washington Ave.

Business Name: N. Port Food & Liquor

Licensee/Applicant: Nagra, Gurinder S
(Last Name, First Name, MI)

Date of Birth: 07/30/70

Home Address: 3776 Cypress Lane

City: Milwaukee

State: WI **Zip Code:** 53132

Home Phone: (414)

This report is written by Police Officer David NOVAK, assigned to the License Investigation Unit, Days.

The Milwaukee Police Department's investigation regarding this application revealed the following:

1. On 02/25/2014 the applicant was cited at 2667 North 5th Street in the city of Milwaukee for Responsible Person on Premises Required.

Charge: Responsible Person on Premises Required
Finding: Guilty
Sentence: \$368.00 fine
Date: 04/17/2014
Case: 14018997

2. On 05/15/2014 the applicant was cited at 2029 North Holton Street in the city of Milwaukee for Building Code Violations.

Charge: Building Code Violations
Finding: Guilty
Sentence: \$280.00 fine
Date: 01/15/2015
Case: 14062301

**MILWAUKEE POLICE DEPARTMENT
LICENSE INVESTIGATION UNIT**

**CRIMINAL RECORD/ORDINANCE VIOLATION/INCIDENTS
SYNOPSIS**

DATE: 10/11/2016
LICENSE TYPE: ALQML
NEW:
RENEWAL: X

No. 239639
Application Date: 10/11/2016
Expiration Date:

License Location: 3876 N. Port Washington Ave.
Business Name: Port Supermarket

Aldermanic District: 06

Licensee/Applicant: Kharag, Paramjeet S.
(Last Name, First Name, MI)
Date of Birth: 07/31/1968

Home Address: 5005 N. Golden Fields Dr. W142
City: Menomonee Falls **State:** WI **Zip Code:** 53051
Home Phone: (262) 781-1584

This report is written by Police Officer Gilbert Gwinn, assigned to the License Investigation Unit, Days.

The Milwaukee Police Department's investigation regarding this application revealed the following:

1. On 03/20/2009 at 9:03pm Milwaukee Police were dispatched to an armed robbery complaint at 3876 N. Port Washington Avenue (Port Supermarket). Investigation revealed 2 subjects, one of which was armed with a handgun, entered the store and demanded money. No injuries were reported. Milwaukee Police incident report number #090790159 filed.

- =====
2. On 05/29/2012 Milwaukee police, along with an agent from the Wisconsin Department of Revenue, conducted a licensed premise inspection at 3876 North Port Washington Avenue (Port Supermarket). The agent advised the cashier that they should not transfer bottles of liquor from other locations to this store and that they should not have open packs of cigars for individual sales.

- =====
3. On 03/23/2016 Milwaukee police, along with Agent Georgeanne King of the Department of Revenue, conducted a licensed premise check at 3876 N. Port Washington Rd. (Port Foods). The officer advised the applicant that the clerk, Vawnera Echols, needed to have a class D operator's license if he is going to leave her alone in the store. Additionally, Echols needs to attend the next Robbery Prevention class.

PREVIOUS PREMISE

Alcohol concentration for 3876 N Port Washington Av

City of Milwaukee, Wisconsin

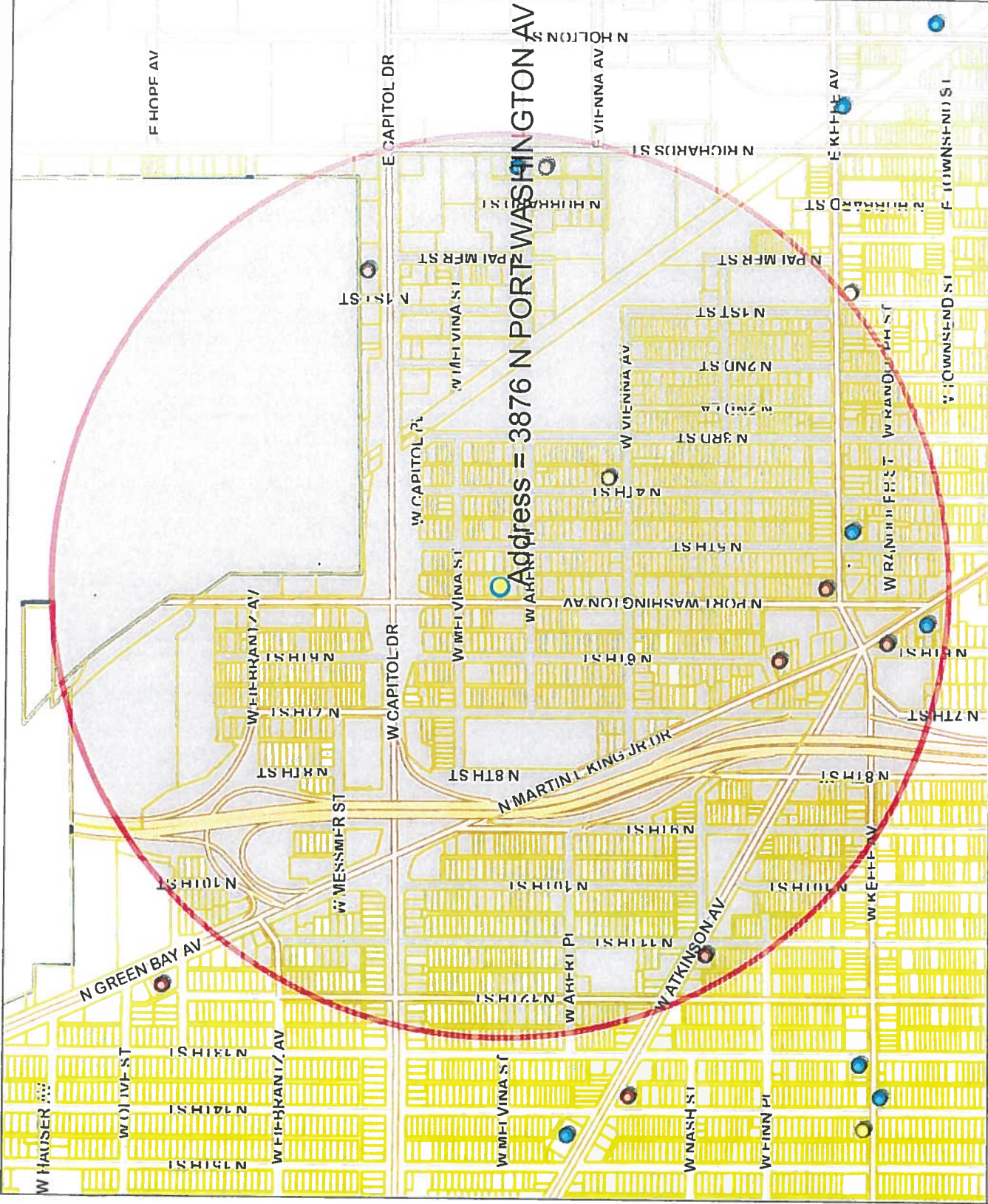

- Legend -**
- Milwaukee parcels
 - Street names 10,000
 - City limits
 - Freeways 15,000
 - Freeways
 - Exit ramps
 - Entry ramps
 - Ramps
 - Major streets 10,000
 - Streets 10,000
 - Street names 10,000
 - Alcohol licenses
 - Class A intoxicating liquor
 - Class A fermented malt beverage
 - Class A liquor and malt
 - Class B fermented malt beverage
 - Class B tavern
 - Class C wine retailer

- Notes -

Licensed Alcohol Beverage Establishments within a .5 Mile Radius Centered on 3876 N Port Washington Av on May 25, 2017.



Map Scale: 1: 10,000

© City of Milwaukee, Wisconsin
 Map Milwaukee: Property Information
 Disclaimer
 5/25/2017

Licensed Alcohol Beverage Establishments within a .5 Mile Radius Centered on 3876 N Port Washington Av on May 25, 2017

License Summary	Trade name	Licensee	License type name	Total capacity	Address	Expiration date
Class A Fermented Malt Beverage Retailer's License	WATKINS GROCERY	FLORA B WATKINS, SP	Class A Fermented Malt Beverage Retailer's License		3806 N 4TH ST	7/13/2017 19:00
Class A Malt & Class A Liquor License	OUTPOST NATURAL FOODS	EDWARD J SENGEL, Agt	Class A Malt & Class A Liquor License		100 E CAPITOL DR	5/24/2018 19:00
Class B Tavern License	ATKINSON BEER & LIQUOR MART, INC	DARRELL C NICHOLSON, Agt	Class A Malt & Class A Liquor License		1101 W ATKINSON AV	2/8/2018 18:00
	POST FOOD & LIQUOR	ADEL H ZEID, Agt	Class A Malt & Class A Liquor License		3455 N MARTIN L KING JR DR	5/23/2017 19:00
	CORNER LIQUOR	INDERJIT S DHINDSA, Agt	Class A Malt & Class A Liquor License		3500 N PORT WASHINGTON AV	12/10/2017 18:00
	3562 JPRM Mart LLC	LAKHWINDER KAUR, Agt	Class A Malt & Class A Liquor License		3562 N Martin L King Jr DR	8/3/2017 19:00
	CONNOISSEUR ENCOUNTERS CO, INC	DOMINIC A LAMPONE, Agt	Class A Malt & Class A Liquor License		3837 N RICHARDS ST	7/25/2017 19:00
	PORT FOOD SUPERMARKET	PARAMJEET S KHARAG, Agt	Class A Malt & Class A Liquor License		3876 N PORT WASHINGTON AV	1/14/2018 18:00
	King Hall, LLC	DAREN JACKSON, Agt	Class B Tavern License	200	3413 N Martin L King Jr DR	1/16/2018 18:00
	GUSANNI, LLC	JANE M MILACH, Agt	Class B Tavern License	80	3853 N RICHARDS ST	7/4/2017 19:00
	The Fox	Daria L Morse, SP	Class B Tavern License		421 W Keefe AV	6/21/2017 19:00
Total				Grand Total		11



Tuesday, July 25, 2017



Notice of Public Hearing

NAGRA, Gurinder S, Agent
N. Port Food & Liquor at 3876 N Port Washington Av
Class A Malt & Class A Liquor and Food Dealer License Applications

Monday, July 31, 2017 at 8:45 AM

To whom it may concern:

The above application has been made by the above named applicant(s). This requires approval from the Licenses Committee and the Common Council of the City of Milwaukee. The hearing before the Licenses Committee will take place on 7/31/2017 at 8:45 AM, in Common Council Chambers, Third Floor, City Hall. If you wish, you may provide testimony at the hearing regarding the request; see below for further information. You are not required to attend the hearing. Once the Licenses Committee makes its recommendation, this recommendation is forwarded to the full Common Council for approval at its next regularly scheduled hearing. Please review the information below and if you have further questions regarding this process, please contact the License Division at (414) 286-2238.

Important details for those wishing to provide information for the Licenses Committee to consider when making its recommendation:

1. The license application is scheduled to be heard at the above time. Due to other hearings running longer than scheduled, you may have to wait some time to provide your testimony.
2. You must appear in person and testify as to matters that you have personally experienced or seen. (You cannot provide testimony for your neighbor, parent or anyone else; this is considered hearsay and cannot be considered by the committee.)
3. No letters or petitions can be accepted by the committee (unless the person who wrote the letter or the persons who signed the petition are present at the committee hearing and willing to testify).
4. Persons opposed to the license application are given the opportunity to testify first; supporters may testify after the opponents have finished.
5. When you are called to testify, you will be sworn in and asked to give your name, and address. (If your first and/or last names are uncommon please spell them.)
6. You may then provide testimony.
 - a. Include only information relating to the above license application.
 - b. Include only information you have personally witnessed or seen.
 - c. Provide concise and relevant information detailing how this business has affected or may affect the peaceful enjoyment of your neighborhood.
 - d. If by the time you have the opportunity to testify, the information you wish to share has already been provided to the committee, you may state that you agree with the previous testimony. Redundant or repetitive testimony will not assist the committee in making its recommendation.
7. After giving your testimony, the members of the Licenses Committee and the licensee may ask questions regarding the testimony you have given or other factors relating to the license application.
8. Business Competition is not a valid basis for denial or non-renewal of a license.
Please Note: If you have submitted an objection to the above application your objection cannot be considered by the committee unless you personally testify at the hearing.

OCCUPANT	MAIL ADDRESS	CITY AND ZIP CODE
CURRENT OCCUPANT	3847 N 5TH ST	MILWAUKEE, WI 53212-1133
CURRENT OCCUPANT	3870A N 5TH ST	MILWAUKEE, WI 53212-1171
CURRENT OCCUPANT	3887 N 5TH ST	MILWAUKEE, WI 53212-1170
CURRENT OCCUPANT	3895 N 5TH ST	MILWAUKEE, WI 53212-1170
CURRENT OCCUPANT	3888 N PORT WASHINGTON AVE 4	MILWAUKEE, WI 53212-1165
CURRENT OCCUPANT	3846 N PORT WASHINGTON AVE 4	MILWAUKEE, WI 53212-1151
CURRENT OCCUPANT	3876 N 5TH ST	MILWAUKEE, WI 53212-1171
CURRENT OCCUPANT	3883 N 5TH ST	MILWAUKEE, WI 53212-1170
CURRENT OCCUPANT	3890 N 5TH ST	MILWAUKEE, WI 53212-1171
CURRENT OCCUPANT	3892 N 5TH ST	MILWAUKEE, WI 53212-1171
CURRENT OCCUPANT	3888 N PORT WASHINGTON AVE 7	MILWAUKEE, WI 53212-1178
CURRENT OCCUPANT	3870A N PORT WASHINGTON AVE	MILWAUKEE, WI 53212-1181
CURRENT OCCUPANT	3846 N PORT WASHINGTON AVE 2	MILWAUKEE, WI 53212-1151
CURRENT OCCUPANT	3846 N PORT WASHINGTON AVE 7	MILWAUKEE, WI 53212-1151
CURRENT OCCUPANT	3866 N 6TH ST	MILWAUKEE, WI 53212-1172
CURRENT OCCUPANT	3874 N 6TH ST	MILWAUKEE, WI 53212-1172
CURRENT OCCUPANT	3862 N 5TH ST	MILWAUKEE, WI 53212-1171
CURRENT OCCUPANT	3867 N 5TH ST	MILWAUKEE, WI 53212-1170
CURRENT OCCUPANT	3893 N 5TH ST	MILWAUKEE, WI 53212-1170
CURRENT OCCUPANT	3888 N PORT WASHINGTON AVE 5	MILWAUKEE, WI 53212-1165
CURRENT OCCUPANT	3888 N PORT WASHINGTON AVE 2	MILWAUKEE, WI 53212-1165
CURRENT OCCUPANT	3878 N PORT WASHINGTON AVE	MILWAUKEE, WI 53212-1181
CURRENT OCCUPANT	3846 N PORT WASHINGTON AVE 6	MILWAUKEE, WI 53212-1151
CURRENT OCCUPANT	3846 N PORT WASHINGTON AVE 8	MILWAUKEE, WI 53212-1151
CURRENT OCCUPANT	3846 N PORT WASHINGTON AVE 1	MILWAUKEE, WI 53212-1151
CURRENT OCCUPANT	3860 N 6TH ST	MILWAUKEE, WI 53212-1172
CURRENT OCCUPANT	3890 N 6TH ST	MILWAUKEE, WI 53212-1172
CURRENT OCCUPANT	3873 N 5TH ST	MILWAUKEE, WI 53212-1170
CURRENT OCCUPANT	3888 N 5TH ST	MILWAUKEE, WI 53212-1171
CURRENT OCCUPANT	3897 N 5TH ST	MILWAUKEE, WI 53212-1170
CURRENT OCCUPANT	3881 N PORT WASHINGTON AVE	MILWAUKEE, WI 53212-1180
CURRENT OCCUPANT	3888 N PORT WASHINGTON AVE 8	MILWAUKEE, WI 53212-1178
CURRENT OCCUPANT	3888 N PORT WASHINGTON AVE 3	MILWAUKEE, WI 53212-1165
CURRENT OCCUPANT	3872 N PORT WASHINGTON AVE A	MILWAUKEE, WI 53212-1181
CURRENT OCCUPANT	3846 N PORT WASHINGTON AVE 3	MILWAUKEE, WI 53212-1151
CURRENT OCCUPANT	3886 N 6TH ST	MILWAUKEE, WI 53212-1172
CURRENT OCCUPANT	3851 N 5TH ST	MILWAUKEE, WI 53212-1133
CURRENT OCCUPANT	3853 N 5TH ST	MILWAUKEE, WI 53212-1133
CURRENT OCCUPANT	508 W ABERT PL	MILWAUKEE, WI 53212-1183
CURRENT OCCUPANT	3861 N 5TH ST	MILWAUKEE, WI 53212-1170
CURRENT OCCUPANT	3871 N 5TH ST	MILWAUKEE, WI 53212-1170
CURRENT OCCUPANT	3870 N 5TH ST	MILWAUKEE, WI 53212-1171
CURRENT OCCUPANT	3882 N 5TH ST	MILWAUKEE, WI 53212-1171
CURRENT OCCUPANT	3886 N 5TH ST	MILWAUKEE, WI 53212-1171
CURRENT OCCUPANT	3888 N PORT WASHINGTON AVE 6	MILWAUKEE, WI 53212-1178
CURRENT OCCUPANT	3846 N PORT WASHINGTON AVE 5	MILWAUKEE, WI 53212-1151
CURRENT OCCUPANT	3864 N 5TH ST	MILWAUKEE, WI 53212-1171
CURRENT OCCUPANT	3893A N 5TH ST	MILWAUKEE, WI 53212-1170
CURRENT OCCUPANT	3896 N PORT WASHINGTON AVE	MILWAUKEE, WI 53212-1181
CURRENT OCCUPANT	3888 N PORT WASHINGTON AVE 1	MILWAUKEE, WI 53212-1165
CURRENT OCCUPANT	3851 N PORT WASHINGTON AVE	MILWAUKEE, WI 53212-1150
CURRENT OCCUPANT	3876 N 6TH ST	MILWAUKEE, WI 53212-1172
CURRENT OCCUPANT	3883 N PORT WASHINGTON AVE	MILWAUKEE, WI 53212-1180
CURRENT OCCUPANT	3894 N PORT WASHINGTON AVE	MILWAUKEE, WI 53212-1181
CURRENT OCCUPANT	3892 N PORT WASHINGTON AVE	MILWAUKEE, WI 53212-1181

CURRENT OCCUPANT	3872 N PORT WASHINGTON AVE	MILWAUKEE, WI 53212-1181
CURRENT OCCUPANT	3870 N 6TH ST	MILWAUKEE, WI 53212-1172
CURRENT OCCUPANT	3880 N PORT WASHINGTON AVE	MILWAUKEE, WI 53212-1181
CURRENT OCCUPANT	3864 N 6TH ST	MILWAUKEE, WI 53212-1172
CURRENT OCCUPANT	3872 N 6TH ST	MILWAUKEE, WI 53212-1172
CURRENT OCCUPANT	3878 N 6TH ST	MILWAUKEE, WI 53212-1172
CURRENT OCCUPANT	3882 N 6TH ST	MILWAUKEE, WI 53212-1172

Total Records: 63

Radius: 250.0 feet and Center of Circle: 3876 N Port Washington AV



Tuesday, July 25, 2017

Licenses Committee Notice of Hearing

Kamal Singh
3876 N Port Washington Av
Milwaukee, WI 53212

Date: 7/31/2017

Time: 08:45 AM

Location: Common Council Chambers, Third Floor, City Hall

The Licenses Committee will consider the following license application:

Class A Malt & Class A Liquor and Food Dealer License Applications
NAGRA, Gurinder S, Agent
N. Port Food & Liquor at 3876 N Port Washington Av

Please note this application may be recommended for denial based on fitness of the location due to concentration of alcohol beverage outlets in the area. If the application is denied for this reason, no other application for an alcohol beverage license for this location shall be recommended for approval by the Licenses Committee within three years of the date of denial unless the applicant has demonstrated a change of circumstances since the prior denial.

If you have any questions, please call (414) 286-2238.





Tuesday, July 25, 2017

Licenses Committee Notice of Hearing

Bachan Singh
4455 Acre View Ct
Brookfield, WI 53005

Date: 7/31/2017

Time: 08:45 AM

Location: Common Council Chambers, Third Floor, City Hall

The Licenses Committee will consider the following license application:

Class A Malt & Class A Liquor and Food Dealer License Applications
NAGRA, Gurinder S, Agent
N. Port Food & Liquor at 3876 N Port Washington Av

Please note this application may be recommended for denial based on fitness of the location due to concentration of alcohol beverage outlets in the area, If the application is denied for this reason, no other application for an alcohol beverage license for this location shall be recommended for approval by the Licenses Committee within three years of the date of denial unless the applicant has demonstrated a change of circumstances since the prior denial.

If you have any questions, please call (414) 286-2238.





BUSINESS LICENSE PLAN OF OPERATION

ccl-busplan 9/15/15

Office of the City Clerk License Division
200 E. Wells St. Room 105, Milwaukee, WI 53202
(414) 286-2238 www.milwaukee.gov/license e-mail address: license@milwaukee.gov

1. Type of Business

- Applying for: Extended Hours Establishment Filling Station Waste Tire Transporter Waste Tire Generator
 Self Service Laundry Rooming House: Number of Units: _____ Hotel/Motel: Number of Units: _____
 Massage Establishment Other (supplemental application for specific license also required)

Provide a detailed description of the type of business you plan on operating:

LIQUOR STORE

Do you have any experience operating this type of business? No Yes If yes, explain: I CURRENTLY OWN A LIQUOR STORE

2. Business Operations

- a. Proposed Opening Date: 06/01/2017
- b. Is this premise under construction? No Yes If yes, list estimated completion date: _____
- c. Is this a franchise? No Yes
- d. Is this premises currently licensed? No Yes If yes, list type of license: FOOD / CIG / CLASS A LIQUOR
- e. Is the current licensee operating? No Yes If no, list date closed: _____
- f. Do you have future plans for other businesses, licenses or permits at this location? No Yes
If yes, explain: _____
- g. Have you previously held an Extended Hours License in Milwaukee? No Yes
If yes, list address(es): _____
- h. Are other businesses operating in the same building? No Yes If yes, describe: _____

3. Litter & Noise

- a. How are grounds kept clean? Sweep Pressure Wash Pick Up Litter Hired Maintenance
 Building Owner Responsibility Garbage Cans Outside Other: _____
- b. How often will grounds be cleaned? Daily Weekly As Needed Monthly Other: _____
- c. Grounds cleaned by: Licensee Building Owner Employees Hired Maintenance Other: _____
- d. How are noise issues prevented and/or addressed? Security Manager approaches customer(s) Call Police
 Signs Posted Other: _____
- e. Will a sound amplification system be used? No Yes If yes, describe: _____

4. Smoking & Sanitation

- f. Are there designated outdoor smoking areas? No Yes If yes, describe: _____
- g. Number of Garbage Cans: Inside: 2 Locations: BY CASH REGISTER
Outside: 1 Locations: BY FRONT DOOR
- h. Is a crowd control barrier used? No Yes If yes, describe: _____
- i. Describe sanitation facilities (restrooms): EMPLOYEES CLEAN SANITIZE RESTROOMS
Name of solid waste contractor: Advanced Disposal Waste Management Other: _____

5. Security

a. Are there onsite parking spaces? No Yes If yes, how many? _____

Describe parking security plan: _____

b. Is there a loading zone? No Yes If yes, describe loading area security plan _____

c. Will you have security personnel on premise? No Yes If yes, how many? _____

What are their responsibilities? _____

Is security equipment used? No Yes If yes, describe _____

List their licensing, certification, or training credentials _____

Will there be security cameras? No Yes If yes, where? MONITORS INSIDE & STORE SURROUNDINGS

Will searches/identification verification be conducted upon entry? No Yes If yes, describe _____

6. Percentage of Sales (must total 100%)

Alcohol <u>30</u> %	Food <u>52</u> %	Secondhand Merchandise _____ %	Precious Metals & Gems _____ %
Entertainment _____ %	Cigarettes <u>18</u> %	Personal Services (such as tattoo, body piercing, salon, tailor, tanning, etc.) _____ %	Other _____ %
Pawnbroker Activity _____ %	Salvaged Materials _____ % (such as scrap metal)	Describe: _____	

7. Businesses/Licenses on the Premises (check all that apply):

Type 1

- Full Service Restaurant Cafe/Coffee Shop Deli or Fast Food Restaurant Private/Fraternal/Veterans Club
 Night Club Tavern Cocktail Lounge Teen Club
 Banquet Hall Sports Facility
 Hotel/Motel – Number of Rooms: _____ Rooming House – Number of Rooms: _____

Type 2

- Liquor Store Corner Store Supermarket Convenience Store
 Gas Station Amusement/Phonograph Distributor Auto Wrecker
 Used Car Dealer Used Auto Parts Personal Service Establishment
 (such as tattoo business, hair salon, tailor, etc.) Recording Studio

What other licenses/permits will you hold at this location? (check all that apply)

- Occupancy Permit Cigarette & Tobacco Gas Station Extended Hours Class "B" Tavern Weights & Measures
 Secondhand Dealer Precious Metal & Gem Other: _____

8. Legal Capacity (only if a Type 1 premises in #6 above)

N/A

Capacity _____ (Call the Milwaukee Development Center at 414-286-8211 if you have questions.)

9. Premises Description

d. Identify all area(s) of the premises that will be used in operating this business (include areas used only for storage):

1st Floor 2nd Floor Basement Storage Patio Beer Garden Sidewalk Café Deck Rooftop

Other: Describe: _____

e. Describe Location: Major Thoroughfare Secondary Street Other: _____

f. Nearest Major Cross Street: N. FORT WASHINGTON AVE @ 38TH ST

g. Describe Building: Free Standing Building Strip Mall Other: _____

h. Describe Premises Structure: Single Story Multi-Story - # of Stories _____ Other: _____

i. Describe Surrounding Area: Commercial Residential Industrial Other: _____

j. Building Owner Name: BAEHAN SINGH Phone Number: _____

Business Owner Address: 4455 ACRE VIEW CT BLOOMFIELD NJ 07005

10. Hours of Operation & Customers

Will customers be entering the premises? No Yes

Day of the Week	Proposed Hours of Operation:		Estimated Number of Customers expected each day	Potential Age Range of Customers	Class B Applicants: Age Restriction (If none, write 'None')
	Open Time (include a.m. or p.m.)	Close Time (include a.m. or p.m.)			
Sunday	8:00 AM	9:00 PM	300		
Monday			300		
Tuesday			300		
Wednesday			300		
Thursday			300		
Friday			300		
Saturday			300		

Extended Hours Establishment License is required for any convenience store, filling station, personal service establishment (such as tattoo, body piercing, salon, tailor, tanning, etc.), recording studio or restaurant which is open between the hours of 12 a.m. and 5 a.m.

Entertainment Indoor Closing Hours - If alcohol beverage establishment, same as alcohol license hours.
If non-alcohol establishment 1:00 am Sunday to Thursday; 1:30 am Friday and Saturday.

Entertainment Outdoor Closing Hours - 10:00 pm Sunday – Thursday; 12:00 am Friday and Saturday,
unless otherwise approved by Common Council in licensee's plan of operation.

11. Signature(s)

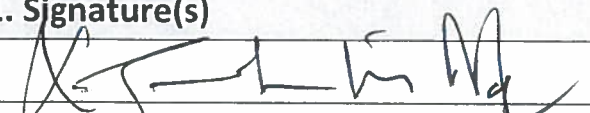
Sole Proprietor, Partner, Agent, or 20% or more Shareholder

Signature of additional partner or 20% or more Shareholder

See Application Information for a list of all required application forms.



ALCOHOL BEVERAGE & PUBLIC ENTERTAINMENT PREMISES SUPPLEMENTAL PLAN OF OPERATION

Office of the City Clerk License Division
200 E. Wells St. Room 105, Milwaukee, WI 53202
(414) 286-2238 e-mail address: license@milwaukee.gov www.milwaukee.gov/license

Legal Entity Name:	N. Post Food & Liquor Inc
Premise Address:	3876 N. PORT WASHINGTON AVE
Proximity of Premises to Church, School, Daycare Center or Hospital	
Is there at least 300 feet between the building and any church, school, daycare center or hospital? <input checked="" type="checkbox"/> Yes <input type="checkbox"/> No	
"Service Bar Only" Designation -N/A-	
If applying for Class B or C license, are you applying for "Service Bar Only"? <input type="checkbox"/> No <input type="checkbox"/> Yes	
Service Bar Only means customers cannot sit at the bar. Alcohol is served to patrons seated at tables. No stools, chairs or other articles of furniture shall be placed at the service bar for patrons to sit upon.	
Business Information	
a) Are you taking out this application for anyone that may not be eligible for a license? <input checked="" type="checkbox"/> No <input type="checkbox"/> Yes If yes, list name and address: _____	
b) Will the agent, a partner or the individual licensee be conducting the day-to-day operations of the business? <input type="checkbox"/> No <input checked="" type="checkbox"/> Yes If no, list the name and address of the person(s) who will: _____	
Class B Applicants: If the agent, a partner or the individual licensee will not be conducting the day-to-day operations of the business, the person(s) listed above must obtain a Class B Managers license.	
c) Does anyone else have money invested or any other interest in this business? <input checked="" type="checkbox"/> No <input type="checkbox"/> Yes If yes, explain: _____	
d) Have you made an agreement with anyone to repay any loan or any other payments based upon income from the business? <input checked="" type="checkbox"/> No <input type="checkbox"/> Yes If yes, list name and address: _____	
Proof of Ownership, Lease, or Offer to Purchase (new & transfer applicants only)	
Submit proof of ownership, lease, or offer to purchase the building with this application. A lease or offer to purchase must:	
a) Be in the same legal entity name as that apply for the license	
b) Reflect the same address as the premises address on this application	
c) Reflect current dates and	
d) Be signed by the lessor/seller and lessee/buyer	
Property Information (new & transfer applicants only)	
a) Do you own or lease the building? <input type="checkbox"/> Own <input checked="" type="checkbox"/> Lease	
b) Who owns the fixtures (for example, coolers, etc.)? N. Post Food & Liquor Inc	
c) Are you purchasing the stock and/or fixtures? <input type="checkbox"/> No <input checked="" type="checkbox"/> Yes If yes, amount paid \$ _____	
d) Total amount paid for business \$ 0.00	
e) Total amount paid for goodwill of the business \$ 0.00	
Goodwill comprises the reputation and customer relationships of an existing business. If the price you pay for the business exceeds the fair market value of all of the rest of the assets of the business, the excess may be considered goodwill.	
f) Have you made arrangements with the seller for payment of personal property taxes? <input type="checkbox"/> No <input checked="" type="checkbox"/> Yes	

See Application Information for a list of all required application forms.

Lease Information (new & transfer applicants who are leasing the premises only)

- a) Date lease begins 06/01/17 Ends 05/31/2019
- b) Monthly rental \$ 3000
- c) Do you have an option to renew the lease? No Yes
- d) Does your lease allow for assignment to another party without the consent of the owner? No Yes
- e) For what length of time have you been guaranteed occupancy (number of years)? 2 YES
- f) In addition to paying the monthly rental, will you have to pay anything additional to the owner of the building to guarantee performance of the lease? No Yes If yes, explain _____
- g) Does the present owner or occupancy object to the granting of your license? No Yes
If yes, explain _____

Change of Agent Applicants Only

Have there been any changes to the floor plan since the last application was submitted? No Yes
If no, a new floor plan is not required. If yes, submit a new floor plan and explain the change(s): _____

Notarized Signatures of Applicants

SUBSCRIBED AND SWORN TO BEFORE ME

This 24 day of MAY 17

Asit N. Patel
(Clerk/Notary Public)

My Commission Expires 12/06/2019
*Notary Seal must be affixed.

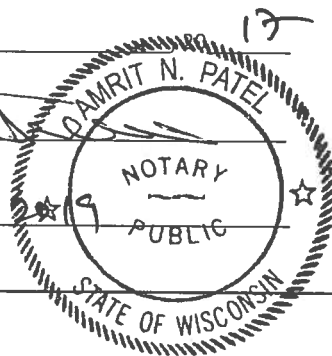

[Signature]

Sole Proprietor, Partner, 20% or more Shareholder, or Agent – only if there are no 20% or more shareholders

Additional partner or 20% or more shareholder

Note: All information contained in this application is subject to approval by the Common Council. Deviating from approved plan of operation will subject licensee to citations, and/or suspension or non-renewal of the license. Contact the License Division for information on how to request changes.

New and transfer of premise applicants must submit the following:

- Proof of ownership, lease or offer to purchase the building
- Detailed floor plan
- If a restaurant, copy of the menu



FOOD DEALER LICENSE PLAN OF OPERATION

OFFICE OF THE CITY CLERK, LICENSE DIVISION
CITY HALL, 200 E. WELLS ST, ROOM 105, MILWAUKEE, WI 53202
(414) 286-2238 • license@milwaukee.gov • www.milwaukee.gov/license

Legal Entity Name:	<u>N. PORT FOOD & LIQUOR INC.</u>
Premises Address:	<u>3876 N. PORT WASHINGTON AVE</u>
SECTION 1 TYPE OF BUSINESS	
Type of application (check one):	<input checked="" type="checkbox"/> taking over a currently operating business <input type="checkbox"/> starting a new business
Anticipated opening date?	<u>31ST JULY 2017</u>
Check the type that best describes your business (check only one): See Food Dealer License Information sheet for definitions.	
<input type="checkbox"/> Restaurant	<input type="checkbox"/> Community Food Program
<input checked="" type="checkbox"/> Retail Establishment	<input type="checkbox"/> Bed & Breakfast
If retail, will it be a convenience store? <input checked="" type="checkbox"/> Yes <input type="checkbox"/> No (less than 5,000 sq ft of retail space, primary business is the sale of basic food items, and in addition sells household products)	<input type="checkbox"/> Base for Food Peddler
	<input type="checkbox"/> Base for Temporary/Seasonal Food Stand
In addition, will any wholesale business be done? <input type="checkbox"/> Yes <input checked="" type="checkbox"/> No	
If yes, what percentage of the business will be wholesale? <input type="checkbox"/> Less than 25% <input type="checkbox"/> 25% or More (Contact DATCP)*	
Will retail items be sold? <input type="checkbox"/> No <input checked="" type="checkbox"/> Yes If Yes, indicate percentage of food sales <u>30</u> %	
Will restaurant items be sold? <input checked="" type="checkbox"/> No* <input type="checkbox"/> Yes If Yes, indicate percentage of food sales _____ %	
* If you checked "25% or More" of the business will be wholesale and answered "No" to restaurant items being sold, do not continue completing this application. A City of Milwaukee License is not required. Contact DATCP only.	
SECTION 2 FOOD PROCESSING	
Will any food processing be done? <input checked="" type="checkbox"/> No <input type="checkbox"/> Yes <i>Processing is defined as assembling, grinding, cutting, mixing, baking, coating, stuffing, packing, bottling, grilling, canning, extracting, fermenting, distilling, pickling, freezing, drying, smoking, or packaging.</i>	
If Yes, check the types of food items:	
<input checked="" type="checkbox"/> SNACKS & BEVERAGES <i>includes, but is not limited to, ice cream/soft serve, lemonade, snow cones, coffee, espresso, cappuccino, tea, fruit juice, smoothies, candy, dispensed soda, fruit cups, bakery, cookies, popcorn, kettle corn, cotton candy, funnel cakes, fritters, tortilla chips w/ cheese</i>	
<input type="checkbox"/> MEALS <i>includes, but is not limited to, chicken, ribs, sandwiches, roasted corn, baked potatoes, hot dogs, brats, tacos, nachos w/ cheese and meat, French fries, cooked or deep fried vegetables/fruit, cooked cheese curds, corn dogs, egg rolls, salads</i>	
SECTION 3 HAZARDOUS FOODS	
Will any hazardous food be sold? <input type="checkbox"/> No <input checked="" type="checkbox"/> Yes <i>Hazardous foods require temperature control (includes dairy products such as milk, cheese, and ice cream, fish shellfish, meat, poultry)</i>	
If yes, list the types of food items: <u>MILK, CHEESE ICE CREAM, PIZZA</u>	

SECTION 4 SHARED KITCHEN

Will you be sharing kitchen space with another operator?

- No If No, SKIP to Section 5
- Yes If Yes, check one:
 - I will rent space from another operator ("Shared Kitchen Agreement" is required)
 - I will rent space to another operator (peddler/caterer)

SECTION 5 DETAILS OF OPERATION

Answer the following questions:

- Will you have seating on site for dining? No Yes
- Will you be doing any catering? No Yes
- Will you be doing any delivery? No Yes
- Will you have outdoor activities? No Yes
 - If Yes to outdoor activities, check all that apply: Bar Cooking/Grilling Dining
- Will you have a drive thru window? No Yes
 - If Yes to drive thru, are hours different from inside? No Yes
 - If Yes, provide drive thru hours: _____
- Will any scales or barcode scanners be used? No Yes
 - If Yes, a Weights & Measures application must be completed and a license obtained.

SECTION 6 ADDITIONAL SITES

- Where will food be prepared and/or sold? **NO**
- At a single site
 - At multiple sites (for example, a hotel with several dining rooms or bars) How many? _____
- If multiple sites, attach a Food Dealer Additional Site Addendum (ccl-foodadd) for each additional site.

SECTION 7 CONSTRUCTION OR CHANGES

- Are you planning any construction, remodeling or equipment changes?
- No If No, SKIP to Section 6
 - Yes If Yes, check all that apply:
 - New construction of a building
 - Construction changes to an existing building
 - Renovation or remodeling
 - Equipment changes only (installation or replacement)
- Provide a brief description of the changes: _____
- Start date: _____
- Name, Address & Phone Number of Architect: _____
- Name, Address & Phone Number of Contractor: _____

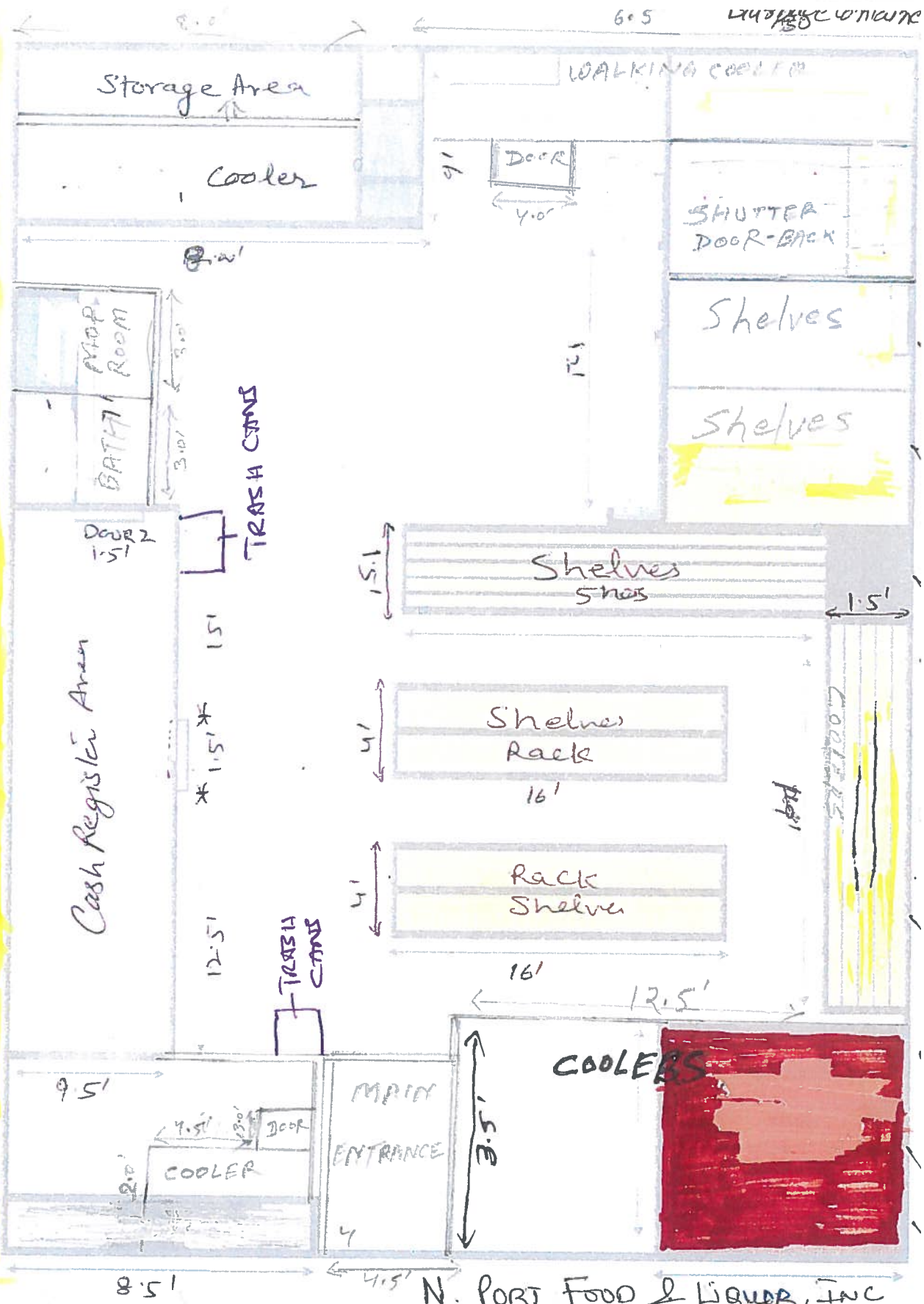

N. PORT FOOD & LIQUOR, INC
 DBA N PORT FOOD & LIQUOR
 3876 N PORT WASHINGTON AVE, MILWAUKEE, WI 53211

Length of Premise 86.5' x Width of Premise 41' = 3546 sq feet

Date: 5-25-2017

AGENT

GURINDER S. NAGRA

MAIN ROAD
 PORT WASHINGTON AVENUE



CITY OF MILWAUKEE
OFFICE OF THE CITY CLERK

Tuesday, July 25, 2017

COMMITTEE MEETING NOTICE

AD 07

SINGH, Harpreet, Agent
Harmeet, LLC
3200 N 27th St
Milwaukee, WI 53216

You are requested to attend a hearing which is to be held in Common Council Chambers, Third Floor, City Hall on:

Monday, July 31, 2017 at 08:45 AM

Regarding: Your Class A Malt & Class A Liquor License Renewal Application with Change of Agent as agent for "Harmeet, LLC" for "S & S Liquor" at 3200 N 27th St.

There is a possibility that your application may be denied for one or more of the following reasons: The recommendation of the committee regarding the application shall be based on evidence presented at the hearing. Per MCO 85-4-4, unless otherwise specified in the code, probative evidence concerning non-renewal, suspension or revocation may include evidence of the following: failure of the applicant to meet municipal qualifications, pending charges against or the conviction of any felony, misdemeanor, municipal offense or other offense, the circumstances of which substantially relate to the circumstances of the particular licensed or permitted activity, by the applicant or by any employee or other agent of the applicant. If the activities of the applicant involve a licensed premises, whether the premises tends to facilitate a public or private nuisance or has been the source of congregations of persons which have resulted in any of the following: disturbance of the peace; illegal drug activity; public drunkenness; drinking in public; harassment of passers-by; gambling; prostitution; sale of stolen goods; public urination; theft; assaults; battery; acts of vandalism including graffiti, excessive littering, loitering, illegal parking, loud noise at times when the licensed premise is open for business; traffic violations; curfew violations; lewd conduct; display of materials harmful to minors, pursuant to s. 106-9.6; or any other factor which reasonably relates to the public health, safety and welfare, or failure to comply with the approved plan of operation. See attached police report or correspondence.

Notice for applicants with warrants or unpaid fines:

Proof of warrant satisfaction or payment of fines must be submitted at the hearing on the above date and time. Failure to comply with this requirement may result in a delay of the granting/denial of your application.

Failure to appear at this meeting may result in the denial of your license. Individual applicants must appear only in person or by an attorney. Corporate or Limited Liability applicants must appear only by the agent designated on the application or by an attorney. Partnership applicants must appear by a partner listed on the application or by an attorney. If you wish to do so and at your own expense, you may be accompanied by an attorney of your choosing to represent you at this hearing.

You will be given an opportunity to speak on behalf of the application and to respond and challenge any charges or reasons given for the denial. No petitions can be accepted by the committee, unless the people who signed the petition are present at the committee hearing and willing to testify. You may present witnesses under oath and you may also confront and cross-examine opposing witnesses under oath. If you have difficulty with the English language, you should bring an interpreter with you, at your expense, so that you can answer questions and participate in your hearing.

You may examine the application file at this office during regular business hours prior to the hearing date. Inquiries regarding this matter may be directed to the person whose signature appears below.

Limited parking for persons attending meetings in City Hall is available at reduced rates (5 hour limit) at the Milwaukee Center on the southwest corner of East Kilbourn and North Water Street. Parking tickets must be validated in the first floor information booth in City Hall.

PLEASE NOTE: Upon reasonable notice, efforts will be made to accommodate the needs of disabled individuals through sign language interpreters or other auxiliary aids. For additional information or to request this service, contact the Council Services Division ADA Coordinator at (414) 286-2998, Fax - (414) 286-3456, TDD - (414) 286-2025.

JIM OWCZARSKI, CITY CLERK

BY: _____

Jessica Celella
License Division Manager

If you have questions regarding this notice, please contact the License Division at (414) 286-2238.

200 E. Wells Street, Room 105, City Hall, Milwaukee, WI 53202. www.milwaukee.gov/license
Phone: (414) 286-2238 Fax: (414) 286-3057 Email Address: License@milwaukee.gov

MILWAUKEE POLICE DEPARTMENT LICENSING

CRIMINAL RECORD/ORDINANCE VIOLATION/INCIDENTS SYNOPSIS

DATE: 06/13/2017

LICENSE TYPE: ALQML

NEW:

RENEWAL:

No. 257403

Application Date: 06/12/2017

License Location: 3200 N. 27th Street

Business Name: Harmeet LLC

Licensee/Applicant: Singh, Harpreet
(Last Name, First Name, MI)

Date of Birth: 11251973

Home Address: 5678 N. 96th Street

City: Milwaukee

State: WI **Zip Code:** 53225

Home Phone: 414-687-6012

This report is written by Police Officer Gilbert Gwinn, assigned to the License Investigation Unit, Days.

The Milwaukee Police Department's investigation regarding this application revealed the following:

1. On 01/11/2012 the applicant was cited at 2816 W. Fond Du Lac Avenue in the city of Milwaukee for Building Code Violations.

Charge: Building Code Violations

Finding: Guilty

Sentence: \$480.00 fine

Date: 04/25/2013

Case: 13018159

2. On 03/12/2015 the applicant was cited at 2816 W. Fond Du Lac Avenue in the city of Milwaukee for Building Code Violations.

Charge: Building Code Violations

Finding: Guilty

Sentence: \$480.00 fine

Date: 07/07/2016

Case: 16031024

3. On 04/25/2015 the applicant was cited at 5678 N. 96th Street in the city of Milwaukee for Building Code Violations.

Charge: Building Code Violations
Finding: Guilty
Sentence: \$1100.00 fine
Date: 02/25/2016
Case: 16000031

4. On 03/12/2015 Gagandeep Kaur was cited at 2816 W. Fond Du Lac Avenue in the city of Milwaukee for Building Code Violations. Gagandeep Kaur is listed on the application as 50% shareholder.

Charge: Building Code Violations
Finding: Guilty
Sentence: \$480.00 fine
Date: 07/07/2016
Case: 16031023

5. On 04/28/2015 Gagandeep Kaur was cited at 5678 N. 96th Street in the city of Milwaukee for Building Code Violations. Gagandeep is listed on the application as 50% shareholder.

Charge: Building Code Violations
Finding: Guilty
Sentence: \$1100.00 fine
Date: 02/25/2016
Case: 16000032

MILWAUKEE POLICE DEPARTMENT
LICENSE INVESTIGATION UNIT

CRIMINAL RECORD/ORDINANCE VIOLATION/INCIDENTS
SYNOPSIS

Previous
Premises

DATE: 05/26/2016
LICENSE TYPE: ALQML
NEW:
RENEWAL: X

No. 231455
Application Date: 05/25/2016
Expiration Date:

License Location: 3200 N 27th Street
Business Name: S & S Liquor

Aldermanic District:

Licensee/Applicant: Kohli, Nitpreet S.
(Last Name, First Name, MI)
Date of Birth: 10/29/1988

Male:

Female:

Home Address: 5678 North 96th
City: Milwaukee
Home Phone: (563) 508-5085

State: WI Zip Code: 53225

This report is written by Police Officer Gilbert Gwinn, assigned to the License Investigation Unit, Days.

The Milwaukee Police Department's investigation regarding this application revealed the following:

1. On 06-12-04 at 11:00am, applicant received a citation for Sale of Cigarettes to Minor/Underage at 11006 W Silver Spring Dr.
Charge: Sale of Cigarette To Minor/Underage
Finding: Guilty
Sentence: Fined \$152.00
Date: 08-03-04
Case: 04077457
 2. On 12/04/09 at 12:30 pm, Milwaukee police were conducting Sales of Alcohol To Underage Persons and had a Milwaukee police aide, who is under the age of 21, enter 1935 W Center in attempts to purchase alcohol. The clerk identified as Daniel Pilcher sold the aide a six-pack of Heineken Beer without asking for any ID. Police questioned Pilcher why he didn't ask for any ID and Pilcher stated he thought the subject looked old enough. The licensee Harpreet Singh was not scene but was cited for Sale of Alcohol To Underage.
Charge: Sale of Alcohol To Underage Person
Finding: Guilty
Sentence: Fined \$160.00
Date: 01/27/10
Case: 10002275
- On 11/05/02, applicant was convicted of OWI in Milwaukee County. His license was suspended for 9 months.
-

3. On 03/14/2011 the applicant was cited in the city of Milwaukee for Sale of Alcohol to Underage Person.

Charge: Sale of Alcohol to Underage Person
Finding: **Guilty**
Sentence: Fined \$171.00
Date: 06/08/11
Case: 11038872

4. On 03/14/2011 the applicant was cited in the city of Milwaukee for Responsible Person on Premises Required.

Charge: Responsible Person on Premises Required
Finding: **Dismissed w/o prejudice**
Date: 06/08/11
Case: 11038873

=====
Incident # 3 & 4 previously reported, disposition now added on 05/16/12.

5. On 06/28/10, applicant received a citation for Building Code Violations at 2816 W Fond Du Lac.

Charge: Building Code Violations
Finding: Guilty
Sentence: Fined \$280.00
Date: 01/26/12
Case: 11120842

6. On 08/31/11, applicant received a citation for Submit Untrue Statements on Liquor Application at 200 E Wells Street.

Charge: Submit Untrue Statements on Liquor Application
Finding: Guilty
Sentence: Fined \$500.00
Date: 01/04/12
Case: 11118482

7. On 01/16/12 at 5:23 pm, Milwaukee police conducted a License Premise Check at 3200 N 27th Street. The licensee was not on scene but officers spoke with the manager Samrat Vashisht. No violations were observed.

=====
8. On 01/11/12, Harpreet Singh received a citation for Building Code Violations at 2816 W Fond Du Lac Avenue.

Charge: Building Code Violations
Finding: Guilty
Sentence: Fined \$480.00
Date: 04/25/13
Case: 13018159

=====

9. On 12/20/2013 the Wisconsin Department of Transportation revoked the applicant's driver's license for 6 months for Operating While Intoxicated.

=====

10. On 04/25/2015 Harpreet Singh was cited at 5678 North 96th Street in the city of Milwaukee for Building Code Violations. Harpreet Singh is listed on the application as 50% shareholder.

Charge: Building Code Violations
Finding: Guilty
Sentence: \$1100.00 fine
Date: 02/25/2016
Case: 16000031

11. On 04/28/2015 Gagandeep Kaur was cited at 5678 North 96th Street in the city of Milwaukee for Building Code Violations. Gagandeep Kaur is listed on the application as 50% shareholder.

Charge: Building Code Violations
Finding: Guilty
Sentence: \$1100.00 fine***in warrant status for failure to appear***
Date: 02/25/2016
Case: 16000032

12. On 04/05/2017 Milwaukee police conducted a licensed premise check at 3200 North 27th Street (S&S Liquor). During this check, officers discovered that the sole employee on the scene, Billie Lynch, did not possess a valid class D operator's license.

Previous premise



Tuesday, July 25, 2017



Notice of Public Hearing

SINGH, Harpreet, Agent
S & S Liquor at 3200 N 27th St
Class A Malt & Class A Liquor License Renewal Application with Change of Agent

Monday, July 31, 2017 at 8:45 AM

To whom it may concern:

The above application has been made by the above named applicant(s). This requires approval from the Licenses Committee and the Common Council of the City of Milwaukee. The hearing before the Licenses Committee will take place on 7/31/2017 at 8:45 AM, in Common Council Chambers, Third Floor, City Hall. If you wish, you may provide testimony at the hearing regarding the request; see below for further information. You are not required to attend the hearing. Once the Licenses Committee makes its recommendation, this recommendation is forwarded to the full Common Council for approval at its next regularly scheduled hearing. Please review the information below and if you have further questions regarding this process, please contact the License Division at (414) 286-2238.

Important details for those wishing to provide information for the Licenses Committee to consider when making its recommendation:

1. The license application is scheduled to be heard at the above time. Due to other hearings running longer than scheduled, you may have to wait some time to provide your testimony.
2. You must appear in person and testify as to matters that you have personally experienced or seen. (You cannot provide testimony for your neighbor, parent or anyone else; this is considered hearsay and cannot be considered by the committee.)
3. No letters or petitions can be accepted by the committee (unless the person who wrote the letter or the persons who signed the petition are present at the committee hearing and willing to testify).
4. Persons opposed to the license application are given the opportunity to testify first; supporters may testify after the opponents have finished.
5. When you are called to testify, you will be sworn in and asked to give your name, and address. (If your first and/or last names are uncommon please spell them.)
6. You may then provide testimony.
 - a. Include only information relating to the above license application.
 - b. Include only information you have personally witnessed or seen.
 - c. Provide concise and relevant information detailing how this business has affected or may affect the peaceful enjoyment of your neighborhood.
 - d. If by the time you have the opportunity to testify, the information you wish to share has already been provided to the committee, you may state that you agree with the previous testimony. Redundant or repetitive testimony will not assist the committee in making its recommendation.
7. After giving your testimony, the members of the Licenses Committee and the licensee may ask questions regarding the testimony you have given or other factors relating to the license application.
8. Business Competition is not a valid basis for denial or non-renewal of a license.
Please Note: If you have submitted an objection to the above application your objection cannot be considered by the committee unless you personally testify at the hearing.

OCCUPANT	MAIL ADDRESS	CITY AND ZIP CODE
CURRENT OCCUPANT	3159A N 26TH ST	MILWAUKEE, WI 53206-1219
CURRENT OCCUPANT	3166 N 27TH ST 3	MILWAUKEE, WI 53216-3808
CURRENT OCCUPANT	2605 W AUER AVE	MILWAUKEE, WI 53206-1225
CURRENT OCCUPANT	3218 N 28TH ST	MILWAUKEE, WI 53216-3814
CURRENT OCCUPANT	3225 N 27TH ST	MILWAUKEE, WI 53216-3809
CURRENT OCCUPANT	3232 N 27TH ST	MILWAUKEE, WI 53216-3810
CURRENT OCCUPANT	2712 W AUER AVE	MILWAUKEE, WI 53216-3829
CURRENT OCCUPANT	3226 N 27TH ST	MILWAUKEE, WI 53216-3810
CURRENT OCCUPANT	3237 N 26TH ST	MILWAUKEE, WI 53206-1239
CURRENT OCCUPANT	3246 N 27TH ST	MILWAUKEE, WI 53216-3810
CURRENT OCCUPANT	3154 N 27TH ST	MILWAUKEE, WI 53216-3808
CURRENT OCCUPANT	2727 W AUER AVE	MILWAUKEE, WI 53216-3849
CURRENT OCCUPANT	2630 W AUER AVE	MILWAUKEE, WI 53206-1224
CURRENT OCCUPANT	3222 N 28TH ST	MILWAUKEE, WI 53216-3814
CURRENT OCCUPANT	3222 N 27TH ST	MILWAUKEE, WI 53216-3810
CURRENT OCCUPANT	3223 N 26TH ST	MILWAUKEE, WI 53206-1239
CURRENT OCCUPANT	3229 N 26TH ST	MILWAUKEE, WI 53206-1239
CURRENT OCCUPANT	3239 N 26TH ST	MILWAUKEE, WI 53206-1239
CURRENT OCCUPANT	3247 N 27TH ST	MILWAUKEE, WI 53216-3809
CURRENT OCCUPANT	3159 N 26TH ST	MILWAUKEE, WI 53206-1219
CURRENT OCCUPANT	2718 W AUER AVE	MILWAUKEE, WI 53216-3829
CURRENT OCCUPANT	2612 W AUER AVE	MILWAUKEE, WI 53206-1224
CURRENT OCCUPANT	3219 N 26TH ST	MILWAUKEE, WI 53206-1239
CURRENT OCCUPANT	3225 N 26TH ST	MILWAUKEE, WI 53206-1239
CURRENT OCCUPANT	3240 N 27TH ST	MILWAUKEE, WI 53216-3810
CURRENT OCCUPANT	3242 N 27TH ST	MILWAUKEE, WI 53216-3810
CURRENT OCCUPANT	3243 N 27TH ST	MILWAUKEE, WI 53216-3809
CURRENT OCCUPANT	3218 N 27TH ST	MILWAUKEE, WI 53216-3810
CURRENT OCCUPANT	3233 N 27TH ST	MILWAUKEE, WI 53216-3809
CURRENT OCCUPANT	3235 N 27TH ST	MILWAUKEE, WI 53216-3809
CURRENT OCCUPANT	3249 N 27TH ST	MILWAUKEE, WI 53216-3809
CURRENT OCCUPANT	3156 N 27TH ST	MILWAUKEE, WI 53216-3808
CURRENT OCCUPANT	3166 N 27TH ST 2	MILWAUKEE, WI 53216-3808
CURRENT OCCUPANT	2712A W AUER AVE	MILWAUKEE, WI 53216-3829
CURRENT OCCUPANT	2632 W AUER AVE	MILWAUKEE, WI 53206-1224
CURRENT OCCUPANT	3226 N 28TH ST	MILWAUKEE, WI 53216-3814
CURRENT OCCUPANT	3230 N 28TH ST	MILWAUKEE, WI 53216-3814
CURRENT OCCUPANT	3155 N 27TH ST	MILWAUKEE, WI 53216-3807
CURRENT OCCUPANT	3157 N 27TH ST	MILWAUKEE, WI 53216-3807
CURRENT OCCUPANT	3166 N 27TH ST 1	MILWAUKEE, WI 53216-3808
CURRENT OCCUPANT	2717 W AUER AVE	MILWAUKEE, WI 53216-3849
CURRENT OCCUPANT	2632 W AUER AVE 2	MILWAUKEE, WI 53206-1224
CURRENT OCCUPANT	2628 W AUER AVE	MILWAUKEE, WI 53206-1224
CURRENT OCCUPANT	3218 N 28TH ST A	MILWAUKEE, WI 53216-3814
CURRENT OCCUPANT	3220 N 28TH ST	MILWAUKEE, WI 53216-3814
CURRENT OCCUPANT	3230A N 28TH ST	MILWAUKEE, WI 53216-3814
CURRENT OCCUPANT	3248 N 27TH ST	MILWAUKEE, WI 53216-3810
CURRENT OCCUPANT	2725 W AUER AVE	MILWAUKEE, WI 53216-3849
CURRENT OCCUPANT	2632 W AUER AVE 3	MILWAUKEE, WI 53206-1224
CURRENT OCCUPANT	2618 W AUER AVE	MILWAUKEE, WI 53206-1224
CURRENT OCCUPANT	3219 N 27TH ST	MILWAUKEE, WI 53216-3809
CURRENT OCCUPANT	3231 N 26TH ST	MILWAUKEE, WI 53206-1239
CURRENT OCCUPANT	3236 N 27TH ST	MILWAUKEE, WI 53216-3810
CURRENT OCCUPANT	3239 N 27TH ST	MILWAUKEE, WI 53216-3809

OCCUPANT	MAIL ADDRESS	CITY AND ZIP CODE
CURRENT OCCUPANT	3159A N 26TH ST	MILWAUKEE, WI 53206-1219
CURRENT OCCUPANT	3166 N 27TH ST 3	MILWAUKEE, WI 53216-3808
CURRENT OCCUPANT	2605 W AUER AVE	MILWAUKEE, WI 53206-1225
CURRENT OCCUPANT	3218 N 28TH ST	MILWAUKEE, WI 53216-3814
CURRENT OCCUPANT	3225 N 27TH ST	MILWAUKEE, WI 53216-3809
CURRENT OCCUPANT	3232 N 27TH ST	MILWAUKEE, WI 53216-3810
CURRENT OCCUPANT	2712 W AUER AVE	MILWAUKEE, WI 53216-3829
CURRENT OCCUPANT	3226 N 27TH ST	MILWAUKEE, WI 53216-3810
CURRENT OCCUPANT	3237 N 26TH ST	MILWAUKEE, WI 53206-1239
CURRENT OCCUPANT	3246 N 27TH ST	MILWAUKEE, WI 53216-3810
CURRENT OCCUPANT	3154 N 27TH ST	MILWAUKEE, WI 53216-3808
CURRENT OCCUPANT	2727 W AUER AVE	MILWAUKEE, WI 53216-3849
CURRENT OCCUPANT	2630 W AUER AVE	MILWAUKEE, WI 53206-1224
CURRENT OCCUPANT	3222 N 28TH ST	MILWAUKEE, WI 53216-3814
CURRENT OCCUPANT	3222 N 27TH ST	MILWAUKEE, WI 53216-3810
CURRENT OCCUPANT	3223 N 26TH ST	MILWAUKEE, WI 53206-1239
CURRENT OCCUPANT	3229 N 26TH ST	MILWAUKEE, WI 53206-1239
CURRENT OCCUPANT	3239 N 26TH ST	MILWAUKEE, WI 53206-1239
CURRENT OCCUPANT	3247 N 27TH ST	MILWAUKEE, WI 53216-3809
CURRENT OCCUPANT	3159 N 26TH ST	MILWAUKEE, WI 53206-1219
CURRENT OCCUPANT	2718 W AUER AVE	MILWAUKEE, WI 53216-3829
CURRENT OCCUPANT	2612 W AUER AVE	MILWAUKEE, WI 53206-1224
CURRENT OCCUPANT	3219 N 26TH ST	MILWAUKEE, WI 53206-1239
CURRENT OCCUPANT	3225 N 26TH ST	MILWAUKEE, WI 53206-1239
CURRENT OCCUPANT	3240 N 27TH ST	MILWAUKEE, WI 53216-3810
CURRENT OCCUPANT	3242 N 27TH ST	MILWAUKEE, WI 53216-3810
CURRENT OCCUPANT	3243 N 27TH ST	MILWAUKEE, WI 53216-3809
CURRENT OCCUPANT	3218 N 27TH ST	MILWAUKEE, WI 53216-3810
CURRENT OCCUPANT	3233 N 27TH ST	MILWAUKEE, WI 53216-3809
CURRENT OCCUPANT	3235 N 27TH ST	MILWAUKEE, WI 53216-3809
CURRENT OCCUPANT	3249 N 27TH ST	MILWAUKEE, WI 53216-3809
CURRENT OCCUPANT	3156 N 27TH ST	MILWAUKEE, WI 53216-3808
CURRENT OCCUPANT	3166 N 27TH ST 2	MILWAUKEE, WI 53216-3808
CURRENT OCCUPANT	2712A W AUER AVE	MILWAUKEE, WI 53216-3829
CURRENT OCCUPANT	2632 W AUER AVE	MILWAUKEE, WI 53206-1224
CURRENT OCCUPANT	3226 N 28TH ST	MILWAUKEE, WI 53216-3814
CURRENT OCCUPANT	3230 N 28TH ST	MILWAUKEE, WI 53216-3814
CURRENT OCCUPANT	3155 N 27TH ST	MILWAUKEE, WI 53216-3807
CURRENT OCCUPANT	3157 N 27TH ST	MILWAUKEE, WI 53216-3807
CURRENT OCCUPANT	3166 N 27TH ST 1	MILWAUKEE, WI 53216-3808
CURRENT OCCUPANT	2717 W AUER AVE	MILWAUKEE, WI 53216-3849
CURRENT OCCUPANT	2632 W AUER AVE 2	MILWAUKEE, WI 53206-1224
CURRENT OCCUPANT	2628 W AUER AVE	MILWAUKEE, WI 53206-1224
CURRENT OCCUPANT	3218 N 28TH ST A	MILWAUKEE, WI 53216-3814
CURRENT OCCUPANT	3220 N 28TH ST	MILWAUKEE, WI 53216-3814
CURRENT OCCUPANT	3230A N 28TH ST	MILWAUKEE, WI 53216-3814
CURRENT OCCUPANT	3248 N 27TH ST	MILWAUKEE, WI 53216-3810
CURRENT OCCUPANT	2725 W AUER AVE	MILWAUKEE, WI 53216-3849
CURRENT OCCUPANT	2632 W AUER AVE 3	MILWAUKEE, WI 53206-1224
CURRENT OCCUPANT	2618 W AUER AVE	MILWAUKEE, WI 53206-1224
CURRENT OCCUPANT	3219 N 27TH ST	MILWAUKEE, WI 53216-3809
CURRENT OCCUPANT	3231 N 26TH ST	MILWAUKEE, WI 53206-1239
CURRENT OCCUPANT	3236 N 27TH ST	MILWAUKEE, WI 53216-3810
CURRENT OCCUPANT	3239 N 27TH ST	MILWAUKEE, WI 53216-3809

Total Records: 55
Radius: 250.0 feet and Center of Circle: 3200 N 27th ST

2017-2018 Plan of Operation for 3200 N 27TH ST

1. Litter & Security Plans			
How are the grounds kept clean? <input checked="" type="checkbox"/> Sweep <input type="checkbox"/> Pressure Wash <input checked="" type="checkbox"/> Pick Up Litter <input type="checkbox"/> Other:			
How often will grounds be cleaned? <input checked="" type="checkbox"/> Daily <input checked="" type="checkbox"/> Weekly <input type="checkbox"/> Other:			
Who cleans the grounds? <input type="checkbox"/> Licensee <input type="checkbox"/> Building Owner <input checked="" type="checkbox"/> Employees <input checked="" type="checkbox"/> Hired Maintenance <input type="checkbox"/> Other:			
How are noise issues prevented and/or addressed? <input checked="" type="checkbox"/> Security <input checked="" type="checkbox"/> Manager approaches customer(s) <input type="checkbox"/> Call Police <input checked="" type="checkbox"/> Signs Posted <input type="checkbox"/> Other:			
Are there designated outdoor smoking areas? <input checked="" type="checkbox"/> No <input type="checkbox"/> Yes If Yes, Describe:			
Number of garbage cans: Inside <u>3</u> Locations: <u>BY THE DOOR / ATM / ICE MACHINE</u> Outside <u>2</u> Locations: <u>27 ST N-SIDE / AVE 2 ST</u>			
Is a crowd control barrier used? <input checked="" type="checkbox"/> No <input type="checkbox"/> Yes If Yes, Describe:			
Number of restrooms: <u>1</u>			
Name of solid waste contractor: <u>Waste Management</u>			
Are there parking spaces on the premises? <input checked="" type="checkbox"/> No <input type="checkbox"/> Yes If Yes, list number of spaces: _____ and describe security plans:			
Are there designated loading areas? <input checked="" type="checkbox"/> No <input type="checkbox"/> Yes If Yes, describe security plans:			
Do you have security personnel on the premise? <input type="checkbox"/> No <input checked="" type="checkbox"/> Yes If Yes, how many? <u>1</u> AND What are their responsibilities? <u>Stop loitering, observe customers</u> What security equipment do they use? <u>None</u> List their licensing, certification or training credentials: _____			
Are there security cameras? <input type="checkbox"/> No <input checked="" type="checkbox"/> Yes If Yes, list all locations: <u>4 outside, 8 inside</u>			
Are searches and/or identification checks conducted upon entry? <input checked="" type="checkbox"/> No <input type="checkbox"/> Yes If Yes, describe:			
2. Percentage of Sales (must total 100%)			
Alcohol <u>70</u> %	Food Sales <u>30</u> %	Entertainment _____ %	Other _____ %
3. Businesses On The Premises (choose all that apply):			
<input type="checkbox"/> Restaurant	<input type="checkbox"/> Cafe/Coffee Shop	<input type="checkbox"/> Cocktail Lounge	<input type="checkbox"/> Convenience Store <input type="checkbox"/> Other:
<input type="checkbox"/> Night Club	<input type="checkbox"/> Tavern	<input type="checkbox"/> Banquet Hall	<input type="checkbox"/> Sports Facility
<input checked="" type="checkbox"/> Liquor Store	<input type="checkbox"/> Hotel	<input type="checkbox"/> Supermarket	<input type="checkbox"/> Private/Fraternal/Veterans' Club
4. Hours of Operation and Age Restriction			
Are there any changes to the current hours of operation or age restriction? <input checked="" type="checkbox"/> No <input type="checkbox"/> Yes If Yes, Describe:			
Please Note: If you will be open earlier or later than the hours listed on your current license for even one event or holiday (for example, St. Patrick's Day, Brewers Opening Day, etc.) during the license period, this must be reported and printed on your license. Your hours of operation and age restriction are listed on your current license.			
5. Floor Plan and Capacity			
Are you requesting any changes to the floor plan or capacity? <input checked="" type="checkbox"/> No <input type="checkbox"/> Yes If Yes, Describe:			
If requesting changes to the floor plan, submit a new floor plan with this application. Changes in floor plan include changing the location of tables, games, etc. within your current licensed premises. If your changes include adding any additional areas or square footage to your premises, or any renovations to the building will be done, a Permanent Extension of Premises application must be filed.			
6. Sidewalk Dining (if renewing a current license)			
Are there any changes to the sidewalk dining site plan? <input checked="" type="checkbox"/> No <input type="checkbox"/> Yes If Yes, submit an updated site plan with this application.			



CITY OF MILWAUKEE
OFFICE OF THE CITY CLERK

Tuesday, July 25, 2017

COMMITTEE MEETING NOTICE

AD 09

GHAFFAR, Mohammed A, Agent
G Mirch Masala LLC
7225 N 76th St
Milwaukee, WI 53223

You are requested to attend a hearing which is to be held in Common Council Chambers, Third Floor, City Hall on:

Monday, July 31, 2017 at 08:45 AM

Regarding: Your Class B Tavern and Public Entertainment of Premises License Applications Requesting Instrumental Musicians, Disc Jockey, Jukebox, Bands, Karaoke, Comedy Acts, and Patrons Dances agent for "G Mirch Masala LLC" for "G Mirch Masala" at 7225 N 76th St.

There is a possibility that your application may be denied for one or more of the following reasons: The recommendation of the committee regarding the application shall be based on evidence presented at the hearing. Per MCO 85-2.7-4, probative evidence concerning whether or not a new license should be granted may be presented on the following subjects: whether or not the applicant meets the municipal requirements, the appropriateness of the location and premises where the licensed premises is to be located and whether use of the premises for the purposes or activities permitted by the license would tend to facilitate a public or private nuisance or create undesirable neighborhood problems such as disorderly patrons, unreasonably loud noise, litter, and excessive traffic and parking congestion. Probative evidence relating to these matters may be taken from the plan of operation submitted with the license application, if any, but shall not include the content of any music. Evidence regarding the fitness of the location of the premises to be maintained as the principal place of business, including but not limited to whether there is an overconcentration of businesses of the type for which the license is sought; whether the proposal is consistent with any pertinent neighborhood business or development plans, or the location's proximity to areas where children are typically present. The applicant's record in operating similarly licensed premises; and whether or not the applicant has been charged with or convicted of any felony, misdemeanor, municipal offense or other offense, the circumstances of which substantially relate to the activity to be permitted by the license being applied for or any other factor which reasonably relates to the public health, safety or welfare may also be considered. See attached police report or correspondence.

Notice for applicants with warrants or unpaid fines:

Proof of warrant satisfaction or payment of fines must be submitted at the hearing on the above date and time. Failure to comply with this requirement may result in a delay of the granting/denial of your application.

Failure to appear at this meeting may result in the denial of your license. Individual applicants must appear only in person or by an attorney. Corporate or Limited Liability applicants must appear only by the agent designated on the application or by an attorney. Partnership applicants must appear by a partner listed on the application or by an attorney. If you wish to do so and at your own expense, you may be accompanied by an attorney of your choosing to represent you at this hearing.

You will be given an opportunity to speak on behalf of the application and to respond and challenge any charges or reasons given for the denial. No petitions can be accepted by the committee, unless the people who signed the petition are present at the committee hearing and willing to testify. You may present witnesses under oath and you may also confront and cross-examine opposing witnesses under oath. If you have difficulty with the English language, you should bring an interpreter with you, at your expense, so that you can answer questions and participate in your hearing.

You may examine the application file at this office during regular business hours prior to the hearing date. Inquiries regarding this matter may be directed to the person whose signature appears below.

Limited parking for persons attending meetings in City Hall is available at reduced rates (5 hour limit) at the Milwaukee Center on the southwest corner of East Kilbourn and North Water Street. Parking tickets must be validated in the first floor information booth in City Hall.

PLEASE NOTE: Upon reasonable notice, efforts will be made to accommodate the needs of disabled individuals through sign language interpreters or other auxiliary aids. For additional information or to request this service, contact the Council Services Division ADA Coordinator at (414) 286-2998, Fax - (414) 286-3456, TDD - (414) 286-2025.

JIM OWCZARSKI, CITY CLERK

BY: _____

Jessica Celella
License Division Manager

If you have questions regarding this notice, please contact the License Division at (414) 286-2238.



**CITY OF MILWAUKEE
OFFICE OF THE CITY CLERK**

Tuesday, July 25, 2017

COMMITTEE MEETING NOTICE

AD 09

GHAFFAR, Mohammed A, Agent
G Mirch Masala LLC
1215 W Manor Lane
Milwaukee, WI 53217

You are requested to attend a hearing which is to be held in Common Council Chambers, Third Floor, City Hall on:

Monday, July 31, 2017 at 08:45 AM

Regarding: Your Class B Tavern and Public Entertainment of Premises License Applications Requesting Instrumental Musicians, Disc Jockey, Jukebox, Bands, Karaoke, Comedy Acts, and Patrons Dancing as agent for "G Mirch Masala LLC" for "G Mirch Masala" at 7225 N 76th St.

There is a possibility that your application may be denied for one or more of the following reasons: The recommendation of the committee regarding the application shall be based on evidence presented at the hearing. Per MCO 85-2.7-4, probative evidence concerning whether or not a new license should be granted may be presented on the following subjects: whether or not the applicant meets the municipal requirements, the appropriateness of the location and premises where the licensed premises is to be located and whether use of the premises for the purposes or activities permitted by the license would tend to facilitate a public or private nuisance or create undesirable neighborhood problems such as disorderly patrons, unreasonably loud noise, litter, and excessive traffic and parking congestion. Probative evidence relating to these matters may be taken from the plan of operation submitted with the license application, if any, but shall not include the content of any music. Evidence regarding the fitness of the location of the premises to be maintained as the principal place of business, including but not limited to whether there is an overconcentration of businesses of the type for which the license is sought; whether the proposal is consistent with any pertinent neighborhood business or development plans, or the location's proximity to areas where children are typically present. The applicant's record in operating similarly licensed premises; and whether or not the applicant has been charged with or convicted of any felony, misdemeanor, municipal offense or other offense, the circumstances of which substantially relate to the activity to be permitted by the license being applied for or any other factor which reasonably relates to the public health, safety or welfare may also be considered. See attached police report or correspondence.

Notice for applicants with warrants or unpaid fines:

Proof of warrant satisfaction or payment of fines must be submitted at the hearing on the above date and time. Failure to comply with this requirement may result in a delay of the granting/denial of your application.

Failure to appear at this meeting may result in the denial of your license. Individual applicants must appear only in person or by an attorney. Corporate or Limited Liability applicants must appear only by the agent designated on the application or by an attorney. Partnership applicants must appear by a partner listed on the application or by an attorney. If you wish to do so and at your own expense, you may be accompanied by an attorney of your choosing to represent you at this hearing.

You will be given an opportunity to speak on behalf of the application and to respond and challenge any charges or reasons given for the denial. No petitions can be accepted by the committee, unless the people who signed the petition are present at the committee hearing and willing to testify. You may present witnesses under oath and you may also confront and cross-examine opposing witnesses under oath. If you have difficulty with the English language, you should bring an interpreter with you, at your expense, so that you can answer questions and participate in your hearing.

You may examine the application file at this office during regular business hours prior to the hearing date. Inquiries regarding this matter may be directed to the person whose signature appears below.

Limited parking for persons attending meetings in City Hall is available at reduced rates (5 hour limit) at the Milwaukee Center on the southwest corner of East Kilbourn and North Water Street. Parking tickets must be validated in the first floor information booth in City Hall.

PLEASE NOTE: Upon reasonable notice, efforts will be made to accommodate the needs of disabled individuals through sign language interpreters or other auxiliary aids. For additional information or to request this service, contact the Council Services Division ADA Coordinator at (414) 286-2998, Fax - (414) 286-3456, TDD - (414) 286-2025.

JIM OWCZARSKI, CITY CLERK

BY: _____

Jessica Celella
License Division Manager

If you have questions regarding this notice, please contact the License Division at (414) 286-2238.

Date:07-14-17
Officer: PO Carrie Resnick

City of Milwaukee Police Department
90-5-1.5 Crime Prevention Survey
Tavern Inspection

Name of Premise: Mirch Masala
Address: 7225 N 76th Street Milwaukee, WI. 53223
Phone: 414-353-7300

Owner: Farhan Ghaffar
Owner address: 12069 W Willow Glen Ct
City State Zip: Mequon, WI. 53092
Owner Phone: 414-801-0786
Owner email: aliamoco1@yahoo.com

Licensee/Agent: Mohammad Ghaffar
Home Address: 1215 W Manor Lane
City State Zip: River Hills, WI. 53217
Phone: 414-839-9671
Email: aliamoco1@yahoo.com

Preferred contact: Mohammad Ghaffar

Location currently open: YES NO

Projected open date: September 1, 2017

Day's open: S M T W Th F SA ALL

Hours of Operation: Sun: 11AM-2AM
Mon: 11AM-2AM
Tue: 11AM-2AM
Wed: 11AM-2AM
Thu: 11AM-2AM
Fri: 11AM-230AM
Sat: 11AM-230AM
24 hours Y N

Premise Type: Tavern/Bar
Restaurant
Other: And Banquet Hall

Licenses currently held:

- Alcohol: Yes No Class: #:
- Tobacco: Yes No #:
- Food: Yes No #: FREST 0010098
- Occupancy: Yes No #:
- Other: Yes No Type: #:
- Other: Yes No Type: #:

Who is your alcohol distributor? Beer Capitol

Exterior Survey:

1. Is the area around the location clean? Yes No
2. What surrounds the location? (Check all the apply)
 - a. Park
 - b. School
 - c. Youth Center
 - d. Church
 - e. Tavern(s) If so, how many1
 - f. Residential
 - g. Other businesses
 - h. Other:
3. Can you see from the outside of the location into the interior Yes No
4. Can you see the employees inside of the location from the outside Yes No
5. Are exterior windows free of signage Yes No
6. Is there a bus stop? Yes No
7. Is there a bus shelter? Yes No N/A
8. Street parking Yes No
9. Is there a parking lot Yes No
10. Is the parking lot clean? Yes No N/A
11. Is the parking lot well lit? Yes No N/A
12. Valet Parking Yes No
 - a. Will this lot have a guard? Yes No N/A
 - b. Will this lot have cameras? Yes No N/A
13. Are there areas where a person could conceal themselves Yes No
14. Is there exterior lighting? Yes No. Does it appears to be adequate Yes No
15. Exterior Payphone? Yes No
16. Are there No Loitering Signs posted? Yes No
17. Are there exterior security cameras Yes No How Many:
18. Are the address numbers prominently displayed and easy to see Yes No

Exterior Comments: Will be upgarding lighting system and adding additional lights on the exterior

Camera Survey:

19. Does this location have security cameras? Yes No
20. Are they in working order? Yes No
21. What format are the cameras?

- a. Color Yes No
- b. Digital Yes No
- c. VCR Yes No
- d. Recorded Yes No

22. How long is footage stored for later viewing: N/A

23. Are there exterior cameras Yes No How many:

24. Are there interior cameras Yes No How many:

25. Do all employees know how to retrieve recorded digital images/footage? Yes No

26. Cameras located in parking lot Yes No N/A How many

Camera Survey Comments: Restaurant is under renovation and camera system will be installed after renovation is complete. Owner plans on having 7-8 cameras on the exterior and 10 inside, one of which will be facing the entrance. He plans on getting a system that will hold footage for 30 days and he will be training at least 3 employees how to operate the system.

Interior Survey:

27. What is the planned/posted capacity 205 upper level restaurant and 170 lower level banquet hall

28. What is the minimum number of employees that will be on premise 6

29. Is the storeowner willing to be a standing complainant regarding loitering? Yes No

a. If yes have them fill out the standing complaint form and give them two of the commercial signs Yes No

30. Is the interior of the location neat and clean? Yes No

31. Does an interior camera face the entrance/exit? Yes No

32. Are emergency and non-emergency numbers posted near the phone? Yes No

33. Does the owner know how to contact their police district directly? Yes No

a. Did you provide a district contact guide to the owner? Yes No

Interior Comments: I provided him information on how to call the police and also emailed him a standing complaint form.

Security

34. How many security personnel are going to be employed: 6 N/A

35. How will they be deployed: Interior 3 Exterior 3 N/A

36. What days will they be deployed Mon Tue Wed Thu Fri Sat Sun ALL

37. Will the security be managed by business or contracted

38. Will they be armed Yes No N/A

39. What type of security measures will be used: N/A

Wanding/metal detector

ID Scanner

Dress Code

Cover Charge

Age restriction

Other

40. When at capacity, how will the overflow crowd be managed? Doors will be closed and security will handle

41. Will a guard monitor the overflow crowd at all times? Yes No

Security Comments: Owner stated that they will have one guard everyday and they will add the other guards for special events and partys. Only one guard will be armed and he will be outside in a security vehicle, the rest of the guards will not be armed.

ADDITIONAL COMMENTS/RECOMMENDATIONS:

Building is currently under renovation and owner will contact me a week before it opens to do a final walk through and look at the security system.

Alcohol Concentration for 7225 N 76th St.

City of Milwaukee, Wisconsin



- Legend -

- Milwaukee parcels
- Street names 10,000
- City limits
- Freeways 15,000
- Freeways
- Exit ramps
- Entry ramps
- Ramps
- Major streets 10,000
- Streets 10,000
- Street names 10,000
- Alcohol licenses
 - Class A intoxicating liquor
 - Class A fermented malt beverage
 - Class A liquor and malt
 - Class B fermented malt beverage
 - Class B tavern
 - Class C wine retailer

- Notes -

Licensed Alcohol Beverage Establishments within a .5 Mile Radius Centered on 7225 N 76th St, June 19, 2017.



Department of Administration - ITMD



Map Scale: 1: 10,000

[Disclaimer](#) 6/19/2017

© City of Milwaukee, Wisconsin
Map Milwaukee: Property Information



Tuesday, July 25, 2017

Licenses Committee Notice of Hearing

Farhan Ghaffar
1215 W Manor Ln
River Hills, WI 53217

Date: 7/31/2017
Time: 08:45 AM
Location: Common Council Chambers, Third Floor, City Hall

The Licenses Committee will consider the following license application:

Class B Tavern and Public Entertainment of Premises License Applications
Requesting Instrumental Musicians, Disc Jockey, Jukebox, Bands, Karaoke,
Comedy Acts, and Patrons Dancing
GHAFFAR, Mohammed A, Agent
G Mirch Masala at 7225 N 76th St

Please note this application may be recommended for denial based on fitness of the location due to concentration of alcohol beverage outlets in the area. If the application is denied for this reason, no other application for an alcohol beverage license for this location shall be recommended for approval by the Licenses Committee within three years of the date of denial unless the applicant has demonstrated a change of circumstances since the prior denial.

If you have any questions, please call (414) 286-2238.





Tuesday, July 25, 2017

Licenses Committee Notice of Hearing

Farhan Ghaffar
7225 N 76th Street
Milwaukee, WI 53223

Date: 7/31/2017
Time: 08:45 AM
Location: Common Council Chambers, Third Floor, City Hall

The Licenses Committee will consider the following license application:

Class B Tavern and Public Entertainment of Premises License Applications
Requesting Instrumental Musicians, Disc Jockey, Jukebox, Bands, Karaoke,
Comedy Acts, and Patrons Dancing
GHAFFAR, Mohammed A, Agent
G Mirch Masala at 7225 N 76th St

Please note this application may be recommended for denial based on fitness of the location due to concentration of alcohol beverage outlets in the area. If the application is denied for this reason, no other application for an alcohol beverage license for this location shall be recommended for approval by the Licenses Committee within three years of the date of denial unless the applicant has demonstrated a change of circumstances since the prior denial.

If you have any questions, please call (414) 286-2238.





BUSINESS LICENSE PLAN OF OPERATION

ccl-busplan 9/26/16

Office of the City Clerk License Division
200 E. Wells St. Room 105, Milwaukee, WI 53202
(414) 286-2238 www.milwaukee.gov/license e-mail address: license@milwaukee.gov

1. Type of Business

Applying for: ~~Extended Hours~~ (12AM to 5AM) - If a food establishment, check all that apply: Delivery Drive Thru Dining Room
 Self Service Laundry Massage Establishment Filling Station
 Other (supplemental application for specific license also required)

Provide a detailed description of the type of business you plan on operating:

Restaurant, large events, halls for ^{Night club dancing} weddings, parties, events, meetings, ^{political event}
Do you have any experience operating this type of business? No Yes If yes, explain: ^{currently operating w/out class Bor REF}

2. Business Operations

- a. Proposed Opening Date: ASAP
- b. Is this premise under construction? No Yes If yes, list estimated completion date: _____
- c. Is this a franchise? No Yes
- d. Is this premises currently licensed? No Yes If yes, list type of license: Food dealer license
- e. Is the current licensee operating? No Yes If no, list date closed: _____
- f. Do you have future plans for other businesses, licenses or permits at this location? No Yes
If yes, explain: _____
- g. Have you previously held an Extended Hours License in Milwaukee? No Yes
If yes, list address(es): _____
- h. Are other businesses operating in the same building? No Yes If yes, describe: _____

3. Litter & Noise

- a. How are grounds kept clean? Sweep Pressure Wash Pick Up Litter Other: _____
- b. How often will grounds be cleaned? Daily Weekly As Needed Monthly Other: _____
- c. Grounds cleaned by: Licensee Building Owner Employees Hired Maintenance Other: _____
- d. How are noise issues prevented and/or addressed? Security Manager approaches customer(s) Call Police
 Signs Posted Other: _____
- e. Will a sound amplification system be used? No Yes If yes, describe: _____

4. Smoking & Sanitation

- a. Are there designated outdoor smoking areas? No Yes If yes, describe: outside side of building
- b. Number of Garbage Cans: Inside: 12 Locations: throughout building
Outside: 3 Locations: around entrance
- c. Is a crowd control barrier used? No Yes If yes, describe: _____
- d. How many restrooms are on the premises? 4
- e. Name of solid waste contractor: Advanced Disposal Waste Management Other: Eagle

5. Security

a. Are there onsite parking spaces? No Yes If yes, indicate how many? 160 and describe the parking security plan: Cameras, Lights

b. Is there a loading zone? No Yes If yes, describe the loading area security plan: _____

c. Will you have security personnel on premise? No Yes If yes, how many? 1 as needed and answer the following:

What are their responsibilities? Service area

Is security equipment used? No Yes If yes, describe _____

List their licensing, certification, or training credentials None

d. Will there be security cameras? No Yes If yes, where? throughout

e. Will searches/identification checks be done upon entry? No Yes If yes, describe only if necessary

6. Percentage of Sales (must total 100%)

Alcohol <u>35</u> %	Food <u>50</u> %	Secondhand Merchandise _____ %	Precious Metals & Gems _____ %
Entertainment <u>15</u> %	Cigarettes _____ %	_____ %	_____ %
Pawnbroker Activity _____ %	Salvaged Materials _____ % (such as scrap metal)	Personal Services (such as tattoo, body piercing, salon, tailor, tanning, etc.) _____ %	Other _____ % Describe: _____

7. Businesses/Licenses on the Premises (check all that apply):

Type 1

- Full Service Restaurant
- Cafe/Coffee Shop
- Deli or Fast Food Restaurant
- Private/Fraternal/Veterans Club
- Night Club
- Tavern
- Cocktail Lounge
- Teen Club
- Banquet Hall
- Sports Facility
- Bowling Alley
- Hotel/Motel: Number of Floors: _____
Number of Rooms: _____
- Rooming House: Number of Floors: _____
Number of Rooms: _____

Type 2

- Liquor Store
- Corner Store
- Supermarket
- Convenience Store
- Gas Station
- Amusement/Phonograph Distributor
- Recycling, Salvage or Towing
- Used Car Dealer
- Personal Service Establishment
(such as tattoo business, hair salon, tailor, etc.)
- Recording Studio

What other licenses/permits will you hold at this location? (check all that apply)

- Occupancy Permit
- Cigarette & Tobacco
- Gas Station
- Extended Hours
- Class "B" Tavern
- Weights & Measures
- Secondhand Dealer
- Precious Metal & Gem
- Other: _____

8. Legal Capacity (only if a Type 1 premises in #7 above)

Capacity 374 (Call the Milwaukee Development Center at 414-286-8211 if you have questions.)

9. Premises Description

- a. Identify all area(s) of the premises that will be used in operating this business (include areas used only for storage):
 1st Floor 2nd Floor Basement Storage Patio Beer Garden Sidewalk Café Deck Rooftop
 Other: Describe: _____
- b. Describe Location: Major Thoroughfare Secondary Street Other: _____
- c. Nearest Major Cross Street: 76th & Good Hope
- d. Describe Building: Free Standing Building Strip Mall Other: _____
- e. Describe Premises Structure: Single Story Multi-Story - # of Stories _____ Other: _____
- f. Describe Surrounding Area: Commercial Residential Industrial Other: 414
- Building Owner Name: Farhan Ghaffar Phone Number: 801-0786
- Business Owner Address: 7225 N 76th Mke, WI 53223

10. Hours of Operation & Customers

Will customers be entering the premises? No Yes

Day of the Week	Proposed Hours of Operation:		Estimated Number of Customers expected each day	Potential Age Range of Customers	Class B Tavern Applicant Only: Age Restriction (If none, write 'None')
	Open Time (include a.m. or p.m.)	Close Time (include a.m. or p.m.)			
Sunday	6 AM	2:00 AM	200	0-100	10Ae
Monday	"	"	75	0-100	"
Tuesday	"	"	75	0-100	"
Wednesday	"	"	75	0-100	"
Thursday	"	"	75	0-100	"
Friday	"	2:30 AM	250	0-100	"
Saturday	"	2:30 AM	250	0-100	"

An Extended Hours Establishment License is required for any convenience store, filling station, personal service establishment (such as tattoo, body piercing, salon, tailor, tanning, etc.), recording studio or restaurant which is open between the hours of 12:00 a.m. and 5:00 a.m.

Alcohol Establishments	Class A:	8:00 am to 9:00 pm Sunday thru Saturday
Permitted Hours of Operation:	Class B:	6:00 am to 2:00 am Sunday thru Thursday, 6:00 am to 2:30 am Friday & Saturday
Entertainment Closing Hours:	Indoors:	Alcohol beverage establishments: Same as alcohol license hours Non-alcohol establishments: 1:00 am Sunday thru Thursday, 1:30 am Friday & Saturday
	Outdoors:	All establishments: 10:00 pm Sunday thru Thursday, 12:00 am Friday & Saturday (unless otherwise approved by the Common Council in licensee's plan of operation)

11. Signature(s)

 Sole Proprietor, Partner, Agent, or 20% or more Shareholder

M. Ghaffar
 Signature of additional partner or 20% or more Shareholder



ALCOHOL BEVERAGE & PUBLIC ENTERTAINMENT PREMISES SUPPLEMENTAL PLAN OF OPERATION

cci-alcpeplan 2/18/15

Office of the City Clerk License Division
200 E. Wells St. Room 105, Milwaukee, WI 53202
(414) 286-2238 e-mail address: license@milwaukee.gov www.milwaukee.gov/license

Legal Entity Name: G Mirch Masala LLC
Premise Address: 7225 N 76th Street MKE, WI 53223

Proximity of Premises to Church, School, Daycare Center or Hospital

Is there at least 300 feet between the building and any church, school, daycare center or hospital? Yes No

"Service Bar Only" Designation

If applying for Class B or C license, are you applying for "Service Bar Only"? No Yes

Service Bar Only means customers cannot sit at the bar. Alcohol is served to patrons seated at tables. No stools, chairs or other articles of furniture shall be placed at the service bar for patrons to sit upon.

Business Information

a) Are you taking out this application for anyone that may not be eligible for a license? No Yes
If yes, list name and address: _____

b) Will the agent, a partner or the individual licensee be conducting the day-to-day operations of the business? No Yes
If no, list the name and address of the person(s) who will: until we hire a manager

Class B Applicants: If the agent, a partner or the individual licensee will not be conducting the day-to-day operations of the business, the person(s) listed above must obtain a Class B Managers license.

c) Does anyone else have money invested or any other interest in this business? No Yes
If yes, explain: _____

d) Have you made an agreement with anyone to repay any loan or any other payments based upon income from the business? No Yes
If yes, list name and address: _____

Proof of Ownership, Lease, or Offer to Purchase (new & transfer applicants only)

Submit proof of ownership, lease, or offer to purchase the building with this application.

A lease or offer to purchase must:

- a) Be in the same legal entity name as that apply for the license
- b) Reflect the same address as the premises address on this application
- c) Reflect current dates and
- d) Be signed by the lessor/seller and lessee/buyer

Property Information (new & transfer applicants only)

a) Do you own or lease the building? Own Lease

b) Who owns the fixtures (for example, coolers, etc.)? Applicant

c) Are you purchasing the stock and/or fixtures? No Yes If yes, amount paid \$ _____

d) Total amount paid for business \$ current operation none

e) Total amount paid for goodwill of the business \$ none none

Goodwill comprises the reputation and customer relationships of an existing business. If the price you pay for the business exceeds the fair market value of all of the rest of the assets of the business, the excess may be considered goodwill.

f) Have you made arrangements with the seller for payment of personal property taxes? No Yes

Lease Information (new & transfer applicants who are leasing the premises only)

- a) Date lease begins 6-19-17 Ends July 31, 2022
- b) Monthly rental \$ 4500.00
- c) Do you have an option to renew the lease? No Yes
- d) Does your lease allow for assignment to another party without the consent of the owner? No Yes
- e) For what length of time have you been guaranteed occupancy (number of years)? 5
- f) In addition to paying the monthly rental, will you have to pay anything additional to the owner of the building to guarantee performance of the lease? No Yes If yes, explain _____
- g) Does the present owner or occupancy object to the granting of your license? No Yes
If yes, explain _____

Change of Agent Applicants Only

Have there been any changes to the floor plan since the last application was submitted? No Yes
If no, a new floor plan is not required. If yes, submit a new floor plan and explain the change(s): _____

Notarized Signatures of Applicants

SUBSCRIBED AND SWORN TO BEFORE ME

This 16th day of June 2022

(Clerk/Notary Public)

My Commission Expires 8/17/18

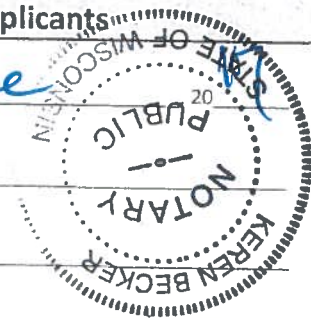

[Handwritten Signature]

Sole Proprietor, Partner, 20% or more Shareholder, or Agent – only if there are no 20% or more shareholders

Additional partner or 20% or more shareholder

Note: All information contained in this application is subject to approval by the Common Council. Deviating from approved plan of operation will subject licensee to citations, and/or suspension or non-renewal of the license. Contact the License Division for information on how to request changes.

New and transfer of premise applicants must submit the following:

- Proof of ownership, lease or offer to purchase the building
- Detailed floor plan
- If a restaurant, copy of the menu



PUBLIC ENTERTAINMENT PREMISES LICENSE SUPPLEMENTAL APPLICATION

Office of the City Clerk License Division
200 E. Wells St. Room 105, Milwaukee, WI 53202
(414) 286-2238 www.milwaukee.gov/license e-mail address: license@milwaukee.gov

TYPES OF ENTERTAINMENT (CHECK ALL THAT APPLY)

<input checked="" type="checkbox"/> Instrumental Musicians	<input checked="" type="checkbox"/> Bands	<input type="checkbox"/> Battle of the Bands	<input checked="" type="checkbox"/> Comedy Acts
<input checked="" type="checkbox"/> Disc Jockey	<input type="checkbox"/> Magic Shows	<input type="checkbox"/> Poetry Readings	<input type="checkbox"/> Dancing by Performers
<input checked="" type="checkbox"/> Jukebox	<input type="checkbox"/> Wrestling	<input type="checkbox"/> Patron Contests	<input checked="" type="checkbox"/> Patrons Dancing
<input type="checkbox"/> Adult Entertainment/ Strippers/Erotic Dance	<input checked="" type="checkbox"/> Karaoke	<input type="checkbox"/> Bowling Alley	<input type="checkbox"/> Pool Tables
<input type="checkbox"/> Motion Pictures	<input type="checkbox"/> Amusement Machines –	How many? _____	How many? _____
How many? _____	How many? _____	<input type="checkbox"/> Concerts	<input type="checkbox"/> Theatrical Performances
<input type="checkbox"/> Other: _____		Approx. # per year? _____	Approx. # per year? _____

Entertainment Indoor Hours: Alcohol beverage establishment: same as alcohol license hours.
Non-alcohol establishment: 10:30am to 1:00am Sun to Thurs; 1:30am Fri-Sat

Entertainment Outdoor Closing Hours: 10:00pm Sunday-Thursday; 12:00am Friday & Saturday; unless otherwise approved by Common Council.

PROMOTERS/SOUND AMPLIFICATION

Will promoters ever be used for any of the entertainment? No Yes If Yes, Describe: _____

At any time will sound amplification be used? No Yes If Yes, Describe: Speakers

LEGAL CAPACITY OF PREMISES

374 (Call the Development Center at 414-286-8211 with questions.) Legal capacity determines the fee for your Public Entertainment Premises License. If you would like to request the license be approved with a lower capacity than that listed above, indicate the lower capacity here: _____. If approved, this lower capacity will print on your license and override the capacity listed on your Occupancy Permit.

NOTARIZED SIGNATURES

I understand that after the license has been issued, a change to the plan of operation will require a written request to change and approval from the Common Council.

I agree to inform the City Clerk within 10 days of any substantial changes in the information supplied in this application.

I understand that I shall not willfully refuse to provide the services offered under this license, or add charges or require deposits not required of the general public because of race, color, sex, religion, national origin or ancestry, age, handicap, lawful source of income, marital status, sexual orientation, gender identity or expression, familial status or the fact that a person is now or has been a member of the military service, whether dressed in uniform or not; and shall not seek such information as a condition of employment, or penalize any employee or discriminate in the selection of personnel for training or promotion on the basis of such information.

I have knowledge of the City Ordinances currently regulating public entertainment, and understand that the license may be subject to suspension, non-renewal or revocation, if I violate any rule or regulation of the city of Milwaukee and State of Wisconsin.

SUBSCRIBED AND SWORN TO BEFORE ME

This 19th day of June 2018

(Clerk/Notary Public)

My Commission Expires 8/2/18

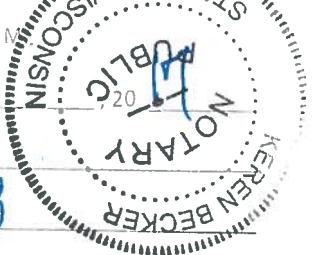

[Signature]
Agent/20% or More Shareholder/Partner

Additional 20% or More Shareholder/Partner

Office Use Only: Initials: _____ Filed: _____ App: _____

Check if only PEP (must be heard w/in 60 days) Granted _____ License # _____

6 MARCH MASALA
777 E W 76th Street

6 March Masala, LLC
76th Street

EXIT

50 FEET
PARKING AREA



4500 sq FT

SEATING AREA

KITCHEN
48 FT x 20 FT

PARKING AREA
100 FT

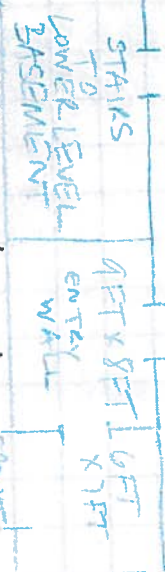

100 FT
PARKING AREA

N
↓

PARKING AREA

6-19-17

6-19-17

