

( E. Linnwood Ave. )

N. Cambridge Ave.

(R.O.W. VARIES)

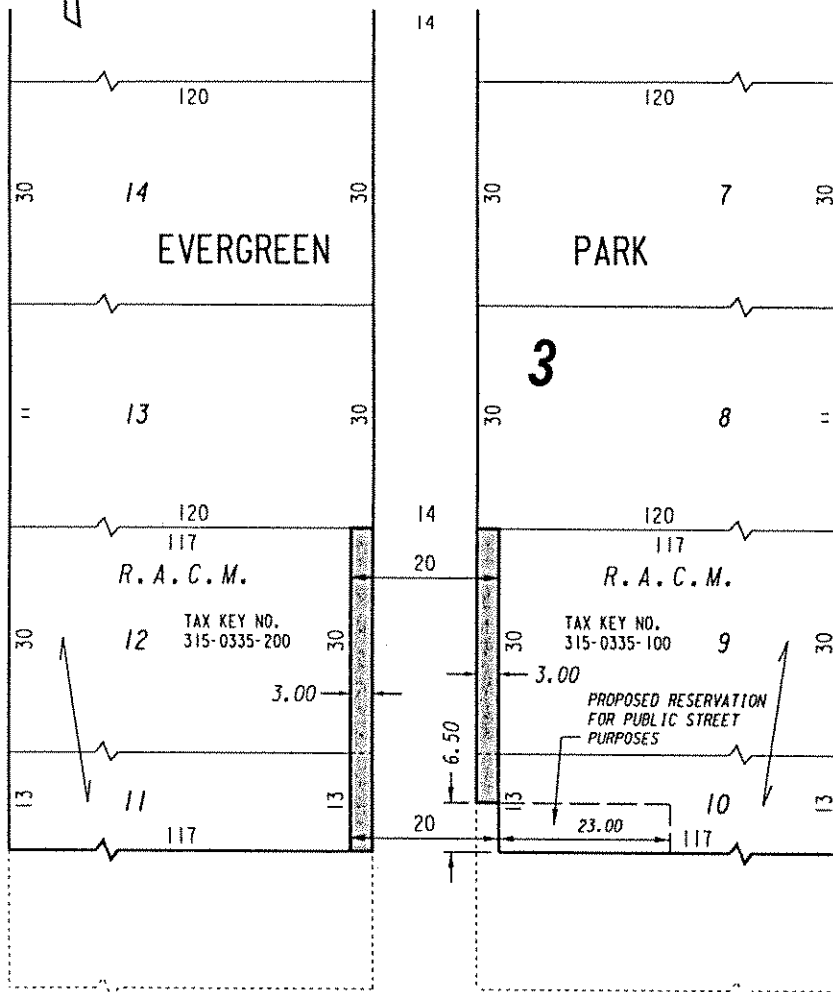

(70' R.O.W.)

St.

N. Newhall

E. Locust (78.20' R.O.W.) St.

EXHIBIT "A"

FILE NO. 031012

INFRASTRUCTURE SERVICES DIVISION

MILWAUKEE, WISCONSIN

ASSIGNED TO: W.E. FUCHS

CH'K'D. BY: W.E. FUCHS

DRAWN BY: W.E.F.

DATE: JAN. 6, 2004

PROJECT/GRANT NO.: WK52337188

SCALE: 1" = 20'

APPROVED BY:

PORTIONS OF PUBLIC ALLEY PROPOSED TO BE VACATED

marcia Lindholm

CENTRAL DRAFTING & RECORDS MANAGER

*[Signature]*  
CIVIL ENGINEER