

CERTIFIED SURVEY MAP NO. \_\_\_\_\_

TAX KEY NO. 3190705000

ZONING: RT4

REDIVISION OF LOTS 10, 11, & 12, BLOCK 205, "MURRAY'S ADDITION", BEING A PART OF THE SOUTHWEST 1/4 OF THE SOUTHWEST 1/4 OF SECTION 15, TOWNSHIP 7 NORTH, RANGE 22 EAST, IN THE CITY OF MILWAUKEE, MILWAUKEE COUNTY, WISCONSIN.

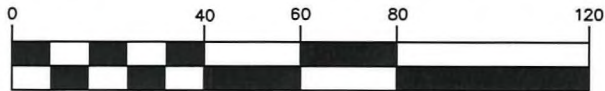

SCALE 1" = 40'



**NORTH SHORE ENGINEERING, INC.**  
Consulting Engineers & Land Surveyors  
11433 N. Port Washington Rd., Mequon, Wisconsin, 53092  
(262) 241-9400 • FAX: (262) 241-5337  
www.northshoreengineering.net

### LEGEND

- - DENOTES 1.315"X18" STEEL PIPE WEIGHING 1.13 LBS. PER LINEAL FOOT (SET)
- ▲ - DENOTES MAG NAIL (SET)
- ✦ - DENOTES CHISELED CROSS FOUND
- - DENOTES STEEL PIPE (FOUND)
- ( ) - DENOTES ALSO RECORDED AS DIRECTION OR DISTANCE

ALL BEARINGS REFERENCED TO GRID NORTH OF THE WISCONSIN STATE PLANE COORDINATE SYSTEM, SOUTH ZONE, SOUTH LINE OF THE SW. 1/4 OF SEC. 15-7-22, WHICH BEARS N88°51'30"E, PER THE DEC. 2012 DATUM/NAD-27.

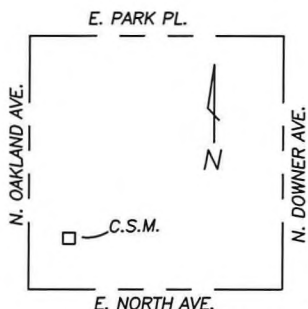

### LOCATION MAP

SOUTHWEST 1/4 SEC. 15-7-22  
(SCALE 1"=2000')

OWNER & SUBDIVIDER:  
SALEM EVANGELICAL  
LUTHERAN CHURCH  
2400 N. CRAMER STREET  
MILWAUKEE, WI 53211

SW. CORNER OF THE SW. 1/4 OF SEC. 15-7-22  
CONC. MON. WITH BRASS CAP



N88°51'30"E 365.71'

N88°51'30"E

S. LINE OF THE SW. 1/4 OF SEC. 15-7-22

2643.17' TOTAL

E. NORTH AVENUE  
(90.0' RIGHT OF WAY)

SE. CORNER OF THE SW. 1/4 OF SEC. 15-7-22  
CONC. MON. WITH BRASS CAP



INFRASTRUCTURE SERVICES DIVISION

*Timothy J. Thun* 1/6/23  
CENTRAL DRAFTING & RECORDS MANAGER

*KT* 1-6-23  
ENGR. IN CHARGE ENVIRON. ENGR.

**CORRECT**

*KEB* 1/6/23  
CITY ENGINEER

**APPROVED**

DEPARTMENT OF CITY DEVELOPMENT  
CITY OF MILWAUKEE

NOV 28 2022  
*[Signature]*  
**STAFF APPROVED**



11-30-2022  
REV. 1-5-2023

N. CRAMER STREET  
(72' RIGHT OF WAY)

(NORTH)

N0°47'46"W 120.00'

69.45'

12.0'

5.0'

3.0'

3.0'

12.0'

51.32'

N88°51'30"E

51.32'

N88°51'30"E

127.30'

STAIRWELL

3.0'

69.45'

7.0'

SO°45'29"E 120.00'

(SOUTH)

40.00'

7.0'

50.55'

1.7'

1.9'

50.55'

25.80'

43.27'

S89°02'17"W

35.65'

N65°51'00"E

10.4'

N88°51'30"E

127.34'

(EAST 127.00')

MURRAY'S ADDITION  
LOT 13  
BLOCK 205

N88°51'30"E 127.34'

HATCHED AREA DENOTES SHARED ACCESS EASEMENT

BRICK & FRAME HOUSE #2412

LOT 2  
6,436± SQ. FT.  
0.148± ACRES

BRICK & FRAME GARAGE

LOT 1  
8,840± SQ. FT.  
0.203± ACRES

BRICK CHURCH BUILDING #2400

LOT 6  
BLOCK 205

LOT 7  
BLOCK 205

LOT 8  
BLOCK 205

LOT 9  
BLOCK 205

MURRAY'S ADDITION

E. THOMAS AVENUE  
(74.5' RIGHT OF WAY)

S88°51'30"W 127.26'

(WEST 127.00')

479.81'

N0°47'46"W

479.81'

72'

72'

72'

72'

72'

72'

72'

72'

72'

72'

72'

72'

72'

72'

72'

72'

72'

72'

72'

72'

72'

72'

72'

72'

72'



CERTIFIED SURVEY MAP NO. \_\_\_\_\_

REDIVISION OF LOTS 10, 11 & 12, BLOCK 205, IN "MURRAY'S ADDITION", BEING A PART OF THE SOUTHWEST 1/4 OF THE SOUTHWEST 1/4 OF SECTION 15, TOWN 7 NORTH, RANGE 22 EAST, IN THE CITY OF MILWAUKEE, MILWAUKEE COUNTY, WISCONSIN

SURVEYOR'S CERTIFICATE

I, James G. Schneider, Professional Land Surveyor, do hereby certify:

THAT I have surveyed, divided and mapped the following parcel of land:

A Redivision of Lots 10, 11 & 12, Block 205, in "MURRAY'S ADDITION", being a part of the Southwest 1/4 of the Southwest 1/4 of Section 15, in Township 7 North, Range 22 East, in the City of Milwaukee, County of Milwaukee, State of Wisconsin, bounded and described as follows:

Commencing at the Southwest corner of said Southwest 1/4 Section; thence N88°51'30"E along the South line of said 1/4 Section, 365.71 feet to the southerly extension of the east right of way line of N. Cramer Street; thence N0°47'46"W along said east right of way line, 479.81 feet to the intersection of the east right of way line of N. Cramer Street and the north right of way of E. Thomas Avenue, said point also beginning the Southwest corner of Lot 10, Block 205 of "MURRAY'S ADDITION" and the point of beginning of lands to be described; thence continuing N0°47'46"W along said east right of way line and the west line of Lot 10, Lot 11 and Lot 12 all in Block 205 of "MURRAY'S ADDITION, 120.00 feet, to the southwest corner of Lot 13, Block 205 of "MURRAY'S ADDITION; thence N88°51'30"E along the south line of said Lot 13, 127.34 feet to the southeast corner of said Lot 13 and the northwest corner of Lot 7, Block 205 of "MURRAY'S ADDITION"; thence S0°45'29"E along the east line of Lots 7, 8 and 9, Block 205 of 'MURRAY'S ADDTION', 120.00 feet to a point on the north right of way of E. Thomas Avenue, said point also being the southwest corner of Lot 9, Block 205 of "MURRAY'S ADDITION"; thence S88°51'30"W along said north right of way line, 127.26 feet to the point of beginning.

Said lands containing 0.350 acres of land, more or less.

That I have made such survey, land division, and plat at the direction of Salem Evangelical Lutheran Church, OWNERS of said lands.

That such map is a correct representation of all the exterior boundaries of the land surveyed and the land division thereof made.

That I have complied with Chapter 236.34 of the Wisconsin Statutes and Chapter 119 of the Milwaukee Code in surveying, dividing and mapping the same. Per Wis. Stat. 236.21 (1), this certificate has the same force and effect as an affidavit.

  
James G. Schneider S-2127

11-30-2022

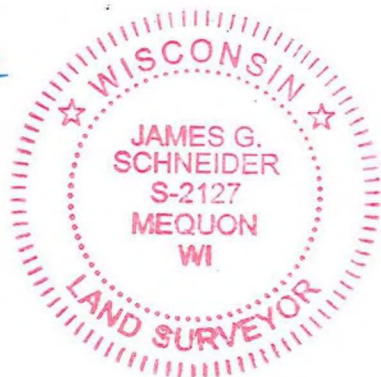

This instrument drafted by James G. Schneider

CERTIFIED SURVEY MAP NO. \_\_\_\_\_

REDIVISION OF LOTS 10, 11 & 12, BLOCK 205, IN "MURRAY'S ADDITION", BEING A PART OF THE SOUTHWEST 1/4 OF THE SOUTHWEST 1/4 OF SECTION 15, TOWN 7 NORTH, RANGE 22 EAST, IN THE CITY OF MILWAUKEE, MILWAUKEE COUNTY, WISCONSIN

OWNER'S CERTIFICATE

I, Roger Lowry (Church Council President) of Salem Evangelical Lutheran Church, duly organized and existing under and by virtue of the laws of the State of Wisconsin, as owner, certify that I caused the land described on this certified survey map to be surveyed, divided and mapped as represented on this map in accordance with the requirements of Chapter 236 of the Wisconsin Statutes and Chapter 119 of the Milwaukee Code of Ordinances.

In consideration of the approval of the map by the Milwaukee Common Council, the undersigned agrees:

That all utility lines to provide electric power and telephone services and cable television or communications systems lines or cables to all lots in the certified survey map (other than already existing lines and cables) shall be installed underground in easements provided therefor, where feasible.

This agreement shall be binding on the undersigned and successors and assigns.

Salem Evangelical Lutheran Church

Date: 01.06.23

[Signature]  
Roger Lowry (Church Council President)

STATE OF WISCONSIN)

Milwaukee COUNTY )<sup>ss</sup>

PERSONALLY came before me on this 6<sup>th</sup> day of January, 2023 Roger Lowry (Church Council President), to me known to be the person who executed the foregoing certificate and acknowledged the same.

[Signature]  
Notary Public

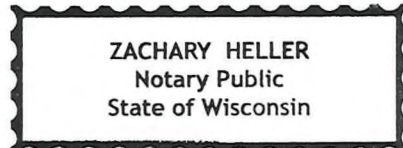

Print Notary name: Zachary Heller

Notary Public, State of: Wisconsin

My Commissions expires: April 3, 2023

This instrument drafted by James G. Schneider



11-30-2022



CERTIFIED SURVEY MAP NO. \_\_\_\_\_

REDIVISION OF LOTS 10, 11 & 12, BLOCK 205, IN "MURRAY'S ADDITION", BEING A PART OF THE SOUTHWEST 1/4 OF THE SOUTHWEST 1/4 OF SECTION 15, TOWN 7 NORTH, RANGE 22 EAST, IN THE CITY OF MILWAUKEE, MILWAUKEE COUNTY, WISCONSIN

CERTIFICATE OF CITY TREASURER

STATE OF WISCONSIN)  
MILWAUKEE COUNTY)<sup>SS</sup>

I, Spencer Coggs, being the duly elected and acting City Treasurer of the City of Milwaukee, certify that in accordance with the records in the office of the City Treasurer of the City of Milwaukee there are no unpaid taxes or unpaid special assessments on the land included in this certified survey map.

Per Wis. Stat. 75.06 and 74.87, the City of Milwaukee collects property taxes and enforces nonpayment of same on parcels in the City of Milwaukee. Per Wis. Stat. 74.83, the City of Milwaukee and Milwaukee County entered into an Intergovernmental Cooperation Agreement approved by Council Resolution 901408, whereby the city is the sole collector and enforcer of property taxes for parcels in the city.

*James F. Klaybor*, DEPUTY  
for Spencer Coggs, City Treasurer

01/06/2023  
(Date)

CERTIFICATE OF CITY CLERK REGARDING COMMON COUNCIL APPROVAL

I certify that this certified survey map was approved under Resolution File No. 221472, adopted by the Common Council of the City of Milwaukee on 1-17-2023

*James Owczarski*  
James Owczarski, City Clerk

1-24-2023  
(Date)

This instrument drafted by James G. Schneider



11-30-2022