



Certificate of Appropriateness

Milwaukee Historic Preservation Commission/200 E. Wells Street/Milwaukee, WI 53202/phone 414-286-5712/fax 414-286-3004

| | | |
|----------------------------|---|---------------------------------------|
| Property | 3360 – 3370 N. Sherman Boulevard | Townsend School, Sherman Boulevard HD |
| Description of work | Install insect screens at the operable portion of the first, second and third floor exterior windows. These insect screens are to be secured into the window frame. The aluminum frame insect screen basis of design product is Tapco with an almond frame finish to match the existing windows and an anodized screen finish. The described insect screens are permitted on all windows, although only the Sherman Boulevard façade is illustrated. The ground floor will be reviewed separately for a different type of screen. | |
| Date issued | 12/20/2022 | PTS ID N/A |

In accordance with the provisions of Section 320-21 (11) and (12) of the Milwaukee Code of Ordinances, the Milwaukee Historic Preservation Commission has issued a certificate of appropriateness for the work listed above. The work was found to be consistent with preservation guidelines. The following conditions apply to this certificate of appropriateness: N/A

All work must be done in a craftsman-like manner, and must be completed within one year of the date this certificate was issued. Staff must approve any changes or additions to this certificate before work begins. Work that is not completed in accordance with this certificate may be subject to correction orders or citations. If you require technical assistance, please contact hpc@milwaukee.gov.

If permits are required, you are responsible for obtaining them from the Milwaukee Development Center. If you have questions about permit requirements, please consult the Development Center's web site, www.milwaukee.gov/lms, or call (414) 286-8210.

City of Milwaukee Historic Preservation Staff

Copies to: Development Center, Ald. Milele Coggs

Installation diagrams

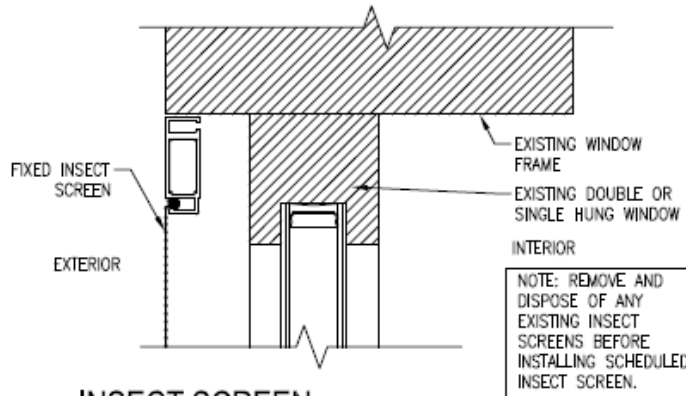

INSECT SCREEN -
HEAD DETAIL (DOUBLE & SINGLE-HUNG)

SCALE: 6" = 1'-0"

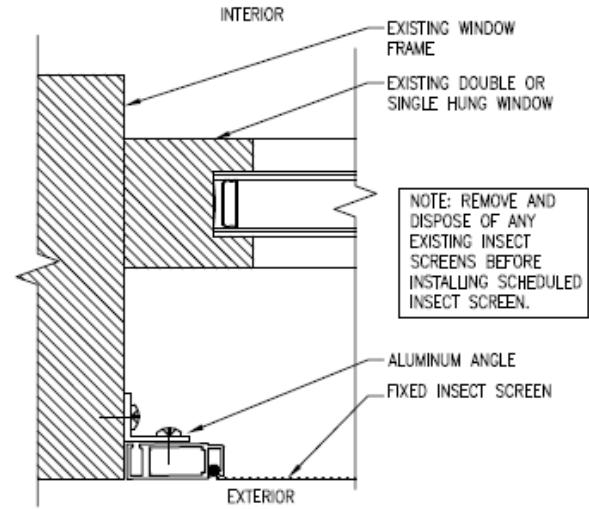

INSECT SCREEN -
JAMB DETAIL (DOUBLE & SINGLE-HUNG)

SCALE: 6" = 1'-0"

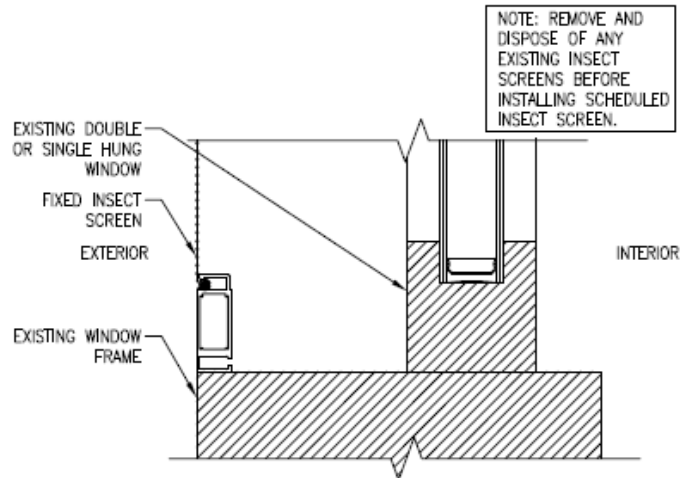

INSECT SCREEN -
SILL DETAIL (DOUBLE & SINGLE-HUNG)

SCALE: 6" = 1'-0"



Townsend: West Elevation Sherman Blvd

3360 N Sherman Blvd
Milwaukee, WI 53216

Location of Proposed Insect Screens



Townsend: West Elevation Sherman Blvd

3360 N Sherman Blvd
Milwaukee, WI 53216

Architect's Rendering of the Proposed Security
Screens Installed