

CERTIFIED SURVEY MAP NO.

All of Lots 1, 2, 3, 4, 8 and part of Lots 7 and 9 in Assessor's Plat No. 291 and vacated West Rogers Street being a part of the Northeast 1/4 of the Southeast 1/4 of Section 5, Town 6 North, Range 22 East, in the City of Milwaukee, County of Milwaukee, Wisconsin.

Graphic Scale



1 Inch = 100 Ft.

Tax Keys:  
Lot 1 - 4670001110  
Remainder - 4670008111

Zoning: IM

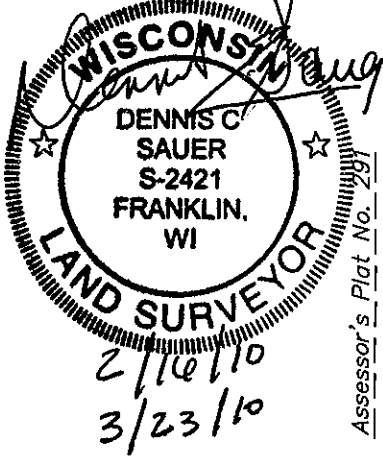
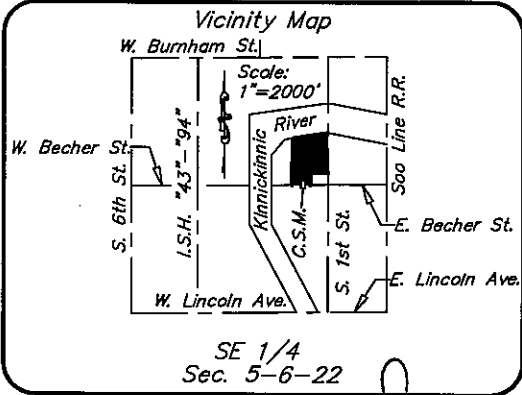

NW Corner Of SE 1/4  
Section 5-6-22  
N=375,097.15  
E=2,556,681.48  
Conc. Mon. W/ Brass Cap

2653.24'  
W/L SE 1/4  
Sec. 5-6-22

N 88°18'55" E  
1588.66'

S. 2nd St.

S 00°23'05" E  
36.53'

West Becher Street

N 00°29'12" W  
1358.17'  
Bearings Referenced To The  
Wisconsin State Plane Co-  
ordinate System, South Zone,  
(NAD-27) (June 2009 Datum).  
(S 50°34' W) - Denotes Recorded Bearing

South Corner  
Section 5-6-22  
N=372,444.21  
E=2,556,704.01  
Conc. Mon. W/ Brass Cap

**Legend**  
○ = 1 1/4" O.D. x 24" Iron Pipe Set, 1.13 Lbs. Per Lin. Ft.  
⊙ = Power Pole  
— OHW — = Overhead Wires

Prepared By:  
Metropolitan Survey Service, Inc.  
5307 S. 92nd St. Suite 140  
Hales Corners, WI 53130

Prepared For:  
Brew Haus LLC  
1120 S. Barclay Ave.  
Milwaukee, WI 53204

Certificates

SERVICE INFRASTRUCTURE  
SERVICES DIVISION  
CENTRAL DRAFTING & RECORDS MANAGER  
Maura Connell 8/20/10  
CENTRAL DRAFTING & RECORDS MANAGER  
ENGR. IN CHARGE ENVIRON. ENGR.  
Jeffrey S. Polinski 8/19/10  
CITY ENGINEER  
APPROVED

DCD  
STAMP



Stock No. 26273

PLD# 2808

## CERTIFIED SURVEY MAP NO. \_\_\_\_\_

All of Lots 1, 2, 3, 4, 8 and part of Lots 7 and 9, in Assessor's Plat No. 291 and vacated West Rogers Street, being a part of the Northeast 1/4 of the Southeast 1/4 of Section 5, Town 6 North, Range 22 East, in the City of Milwaukee, County of Milwaukee, Wisconsin.

SURVEYOR'S CERTIFICATE

STATE OF WISCONSIN)  
MILWAUKEE COUNTY ) SS

I, Dennis C. Sauer, Registered Land Surveyor, do hereby certify:

That I have surveyed, divided and mapped all of Lots 1, 2, 3, 4, 8 and part of Lots 7 and 9 in Assessor's Plat No. 291 and vacated West Rogers Street being a part of part of the Northeast 1/4 of the Southeast 1/4 of Section 5, Town 6 North, Range 22 East, in the City of Milwaukee, County of Milwaukee, State of Wisconsin, bounded and described as follows: Commencing at the South corner of said Section 5; thence N 00°29'12" W along the West line of the Southeast 1/4 of said Section 5, 1358.17 feet to a point; thence N 88°18'55" E, 1588.66 feet to a point; thence N 00°23'05" W, 36.53 feet to a point on the North line of West Becher Street and the point of beginning of the lands to be described; thence N 85°27'24" E along the North line of West Becher Street, 149.98 feet to a point; thence N 88°18'55" E along the North line of West Becher Street, 43.80 feet to point; thence N 00°23'44" W, 87.39 feet to a point; thence N 89°36'16" E, 176.20 feet to a point on the West line of South 1st Street; thence N 00°23'44" W, along the West line of South 1st Street, 410.00 feet to a point on the South line of the Kinnickinnic River; thence S 79°56'42" W, along the South line of the Kinnickinnic River, 374.80 feet to a point; thence S 00°23'05" E, 446.33 feet to the point of beginning. Said lands containing 157,767 square feet (3.62 acres).

That I have made such survey, land division and map by the direction of Brew Haus, LLC, owners of said land.

That such map is a correct representation of all the exterior boundaries of the land surveyed and the land division thereof made.

That I have fully complied with the provisions of Chapter 236.34 of the Wisconsin State Statutes and Chapter 119 of the Milwaukee Code of Ordinances, in surveying, dividing and mapping the same.

Date

2-16-10

3-23-10



*Dennis C. Sauer*  
Dennis C. Sauer  
Registered Land Surveyor S-2421

PREPARED FOR:  
Brew Haus, LLC  
1120 S. Barclay Avenue  
Milwaukee, WI 53204

PREPARED BY:  
Metropolitan Survey Service, Inc.  
5307 South 92nd Street #140  
Hales Corners, WI 53130



Stock No. 26273

DLD# 2808

CERTIFIED SURVEY MAP NO. \_\_\_\_\_

All of Lots 1, 2, 3, 4, 8 and part of Lots 7 and 9, in Assessor's Plat No. 291 and vacated West Rogers Street, being a part of the Northeast 1/4 of the Southeast 1/4 of Section 5, Town 6 North, Range 22 East, in the City of Milwaukee, County of Milwaukee, Wisconsin.

CORPORATE OWNER'S CERTIFICATE OF DEDICATION

Brew Haus, LLC, a corporation duly organized and existing under and by virtue of the laws of the State of Wisconsin, as owner, certifies that the said corporation caused the land described on this map to be surveyed, divided, mapped and dedicated as represented on this map in accordance with the requirements of Chapter 119 of the Milwaukee Code of Ordinances.

In consideration of the approval of the map by the Common Council and in accordance with Chapter 119 of the Milwaukee Code, the undersigned agrees:

- a) That all utility lines to provide electric power and telephone service and cable television or communication systems, lines or cables to all lots in the certified survey map shall be installed underground in easements provided thereof, where feasible.

This agreement shall be binding on the undersigned and assigns.

IN WITNESS WHEREOF, the said Brew Haus, LLC, has caused these presents to be signed by Rex Runzheimer, its Owner; and countersigned by its, at Wauwatosa, WI, this 13 day of August, 2010.

In the presence of:

\_\_\_\_\_  
Brew Haus, LLC

Rex Runzheimer: Owner

Rex Runzheimer  
\_\_\_\_\_  
Rex Runzheimer

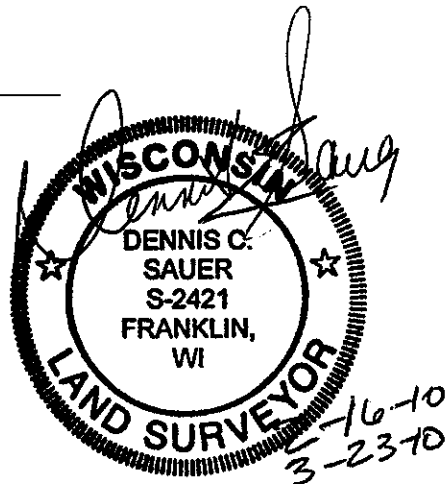

STATE OF WISCONSIN)  
Racine COUNTY) SS

PERSONALLY came before me this 13th day of August, 2010, Rex A. Runzheimer, Owner, and \_\_\_\_\_, \_\_\_\_\_ of the above named corporation, to me known to be the persons who executed the foregoing instrument and to me known to be the owner and \_\_\_\_\_ of the corporation, and acknowledged that they executed the foregoing instrument as such officers as the deed of the corporation.

Dawn M. Kirby  
Print Name Dawn M. Kirby  
Notary Public-State of Wisconsin  
My Commission Expires: June 15, 2014  
My Commission is permanent

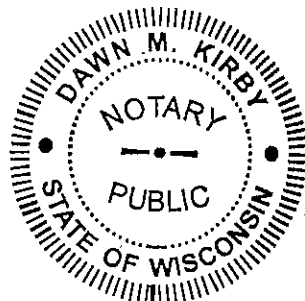



Stock No. 26273

Ded #2808

CERTIFIED SURVEY MAP NO. \_\_\_\_\_

All of Lots 1, 2, 3, 4, 8 and part of Lots 7 and 9, in Assessor's Plat No. 291 and vacated West Rogers Street, being a part of the Northeast 1/4 of the Southeast 1/4 of Section 5, Town 6 North, Range 22 East, in the City of Milwaukee, County of Milwaukee, Wisconsin.

CERTIFICATE OF CITY TREASURER

STATE OF WISCONSIN)  
MILWAUKEE COUNTY ) SS

I, Wayne F. Whittow, being the duly elected, qualified and acting City Treasurer of the City of Milwaukee, do hereby certify that in accordance with the records in the office of the City Treasurer of the City of Milwaukee there are no unpaid taxes or unpaid special assessments on the land included in this Certified Survey Map.

8-23-10  
Date

Wayne F. Whittow  
Wayne F. Whittow, Treasurer  
City of Milwaukee

COMMON COUNCIL APPROVAL

I certify that this Certified Survey Map was approved and adopted under Resolution File No. \_\_\_\_\_, on this \_\_\_\_\_ day of \_\_\_\_\_, 20\_\_\_\_, by the Common Council of the City of Milwaukee.

\_\_\_\_\_  
Tom Barrett, Mayor  
City of Milwaukee

\_\_\_\_\_  
Ronald D. Leonhardt, City Clerk  
City of Milwaukee

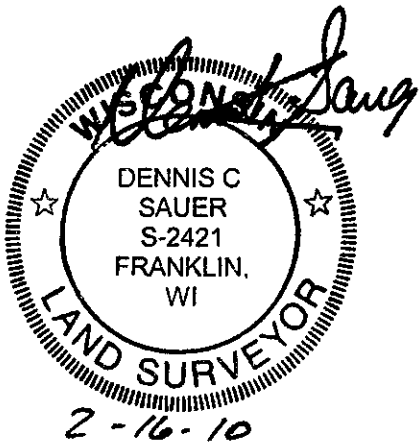

THIS INSTRUMENT WAS DRAFTED BY:  
Dennis C. Sauer, R.L.S. S-2421