

W. Walker

(76' R.O.W.)

St.

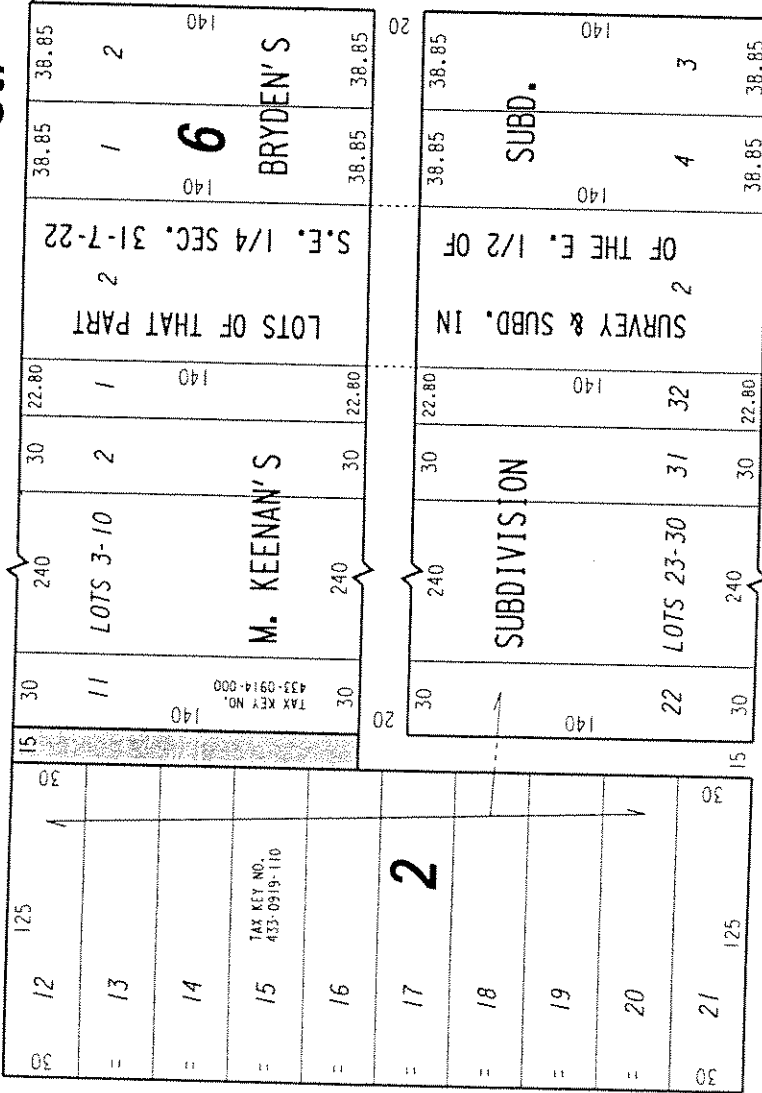

S. Cesar E. Chavez (66' R.O.W.) Dr.

S. 15th St. (41' R.O.W.)

433

S.E. 1/4 SEC. 31, T.7N., R.22E.

W. Mineral

(66.47' R.O.W.)

St.

EXHIBIT "A"

FILE NO. 040717

INFRASTRUCTURE SERVICES DIVISION

MILWAUKEE, WISCONSIN

ASSIGNED TO: W.E. FUCHS

DRAWN BY: W.E.F.

PROJECT/GRANT NO.: WK52337202

APPROVED BY:

CH'K'D. BY: W.E. FUCHS

DATE: OCT. 25, 2004

SCALE: 1" = 60'

PORTION OF PUBLIC ALLEY PROPOSED TO BE VACATED

Maxine Lindholm  
CENTRAL DRAFTING & RECORDS MANAGER  
City Engineer

# PUBLIC HEARING

MARCH 21, 2005

1/4 SECTION NO. 433

C.C. FILE NO. 040717

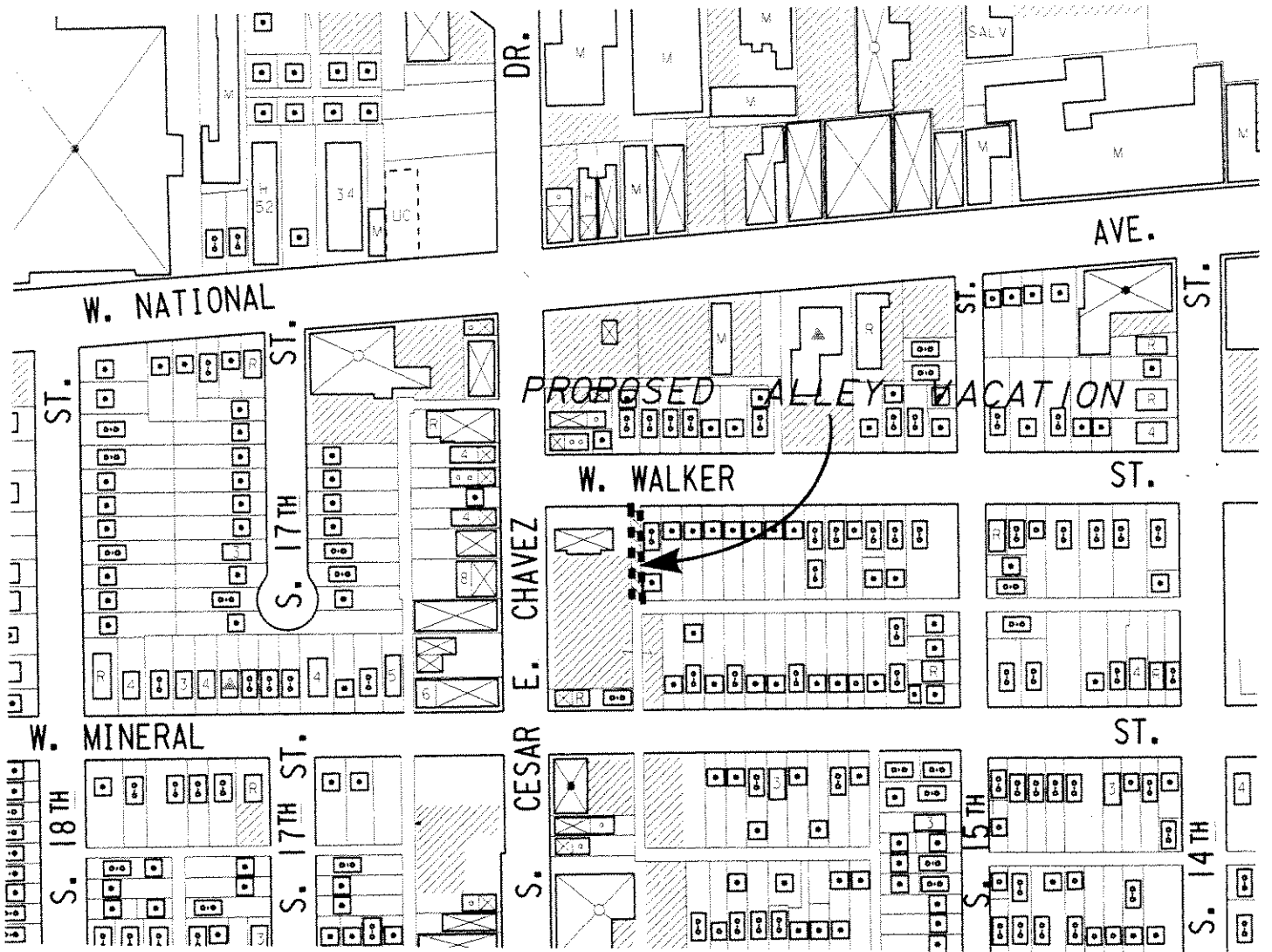

## LEGEND

PROPOSED CHANGE:

ALLEY VACATION

PRESENT ZONING DISTRICT BOUNDARY

NET AREA OF CHANGE:



5

DEPARTMENT OF CITY DEVELOPMENT  
LAND USE PLANNING

MILWAUKEE WISCONSIN

SCALE: GRAPHIC

DRAWN BY: R. EBERT

DATE: MARCH 15, 2005