

WEST ELEVATION

Scale: 1/8" = 1'-0"

- = POLISHED CONCRETE
- = RUBBER FLOOR TILE
- = TURF

SUPPORT AREA = 93 SQUARE FEET
 WORK OUT AREA = 1,740 SQUARE FEET
 TOTAL AREA = 1,833 SQUARE FEET

Square Footage changes are due to the revised entry condition (eliminating ramp & landing on North), and locating the electrical panel with required clearances in the Mechanical Room.

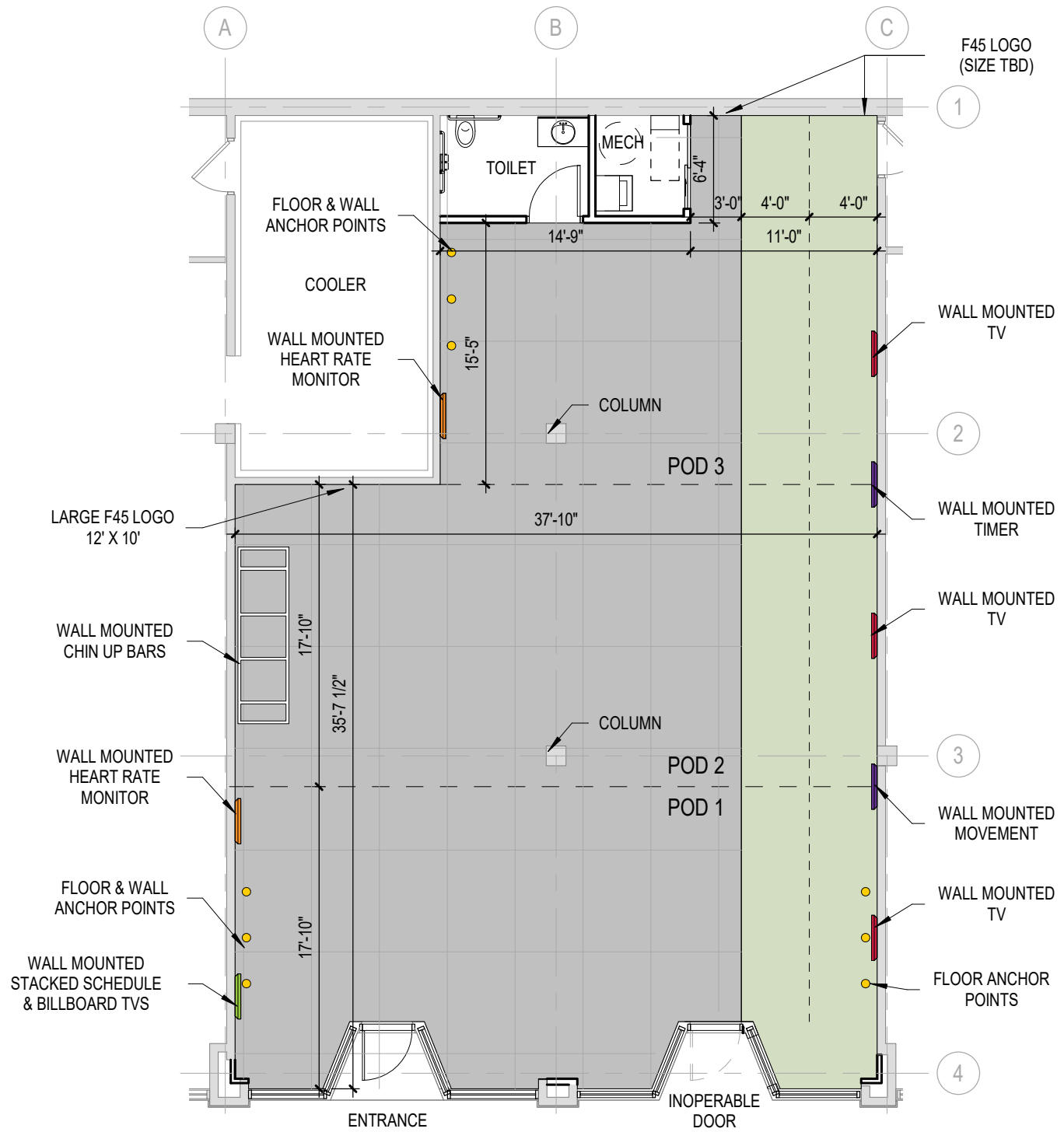

PROPOSED FLOOR PLAN

Scale: 1/8" = 1'-0"

F45 FITNESS
 MILWAUKEE, WI

03/05/19

001 - F45 SUBMISSION
 © 2019 Bray Associates Architects, Inc.