



CERTIFICATE OF APPROPRIATENESS APPLICATION FORM

Incomplete applications will not be processed for Commission review.
Please print legibly.

1. **HISTORIC NAME OF PROPERTY OR HISTORIC DISTRICT:** (if known)

Armin C. Frank House

ADDRESS OF PROPERTY:

2044 N. Lake Drive Milwaukee, WI 53202

2. **NAME AND ADDRESS OF OWNER:**

Name(s): John & Pam Stampen

Address: 2044 N. Lake Drive

City: Milwaukee

State: WI

ZIP: 53202

Email: johnstampen@gmail.com

Telephone number (area code & number) Daytime: 608-698-5282 Evening: 608-698-5282

3. **APPLICANT, AGENT OR CONTRACTOR:** (if different from owner)

Name(s): Antiquity General Contract Management Services

Address: N79 W12855 Fond du Lac Avenue

City: Menomonee Falls

State: WI

ZIP Code: 53051

Email: eschneider@antiquitygc.com

Telephone number (area code & number) Daytime: 262-347-7555 Evening:

4. **ATTACHMENTS:** (Because projects can vary in size and scope, please call the HPC Office at 414-286-5712 or 414-286-5722 for submittal requirements)

A. REQUIRED FOR MAJOR PROJECTS:

☒ Digital photographs of affected areas & all sides of the building

☐ Sketches and Elevation Drawings in PDF form. New construction, major storefront remodels, etc., must provide one set of D or E size drawings and sections

☒ Material and Design Specifications (please attach)

B. NEW CONSTRUCTION ALSO REQUIRES:

☐ Floor Plans (show fenestration and approximate wall locations, final floor plans are not required)

☐ Site Plan showing location of project and adjoining structures and fences

PLEASE NOTE: YOUR APPLICATION CANNOT BE PROCESSED UNLESS BOTH PAGES OF THIS FORM ARE PROPERLY COMPLETED.

5. DESCRIPTION OF PROJECT:

Tell us what you want to do. Describe all proposed work including materials, design, and dimensions. Additional pages may be attached via email.

We propose to do the following updates:

Both upstairs bathrooms currently do not have bath fans that exhaust to the outside to meet code. We plan to run a single exhaust outlet on the back (east) side of the house, up to 6" diameter, to vent both bathrooms. We will use a vent similar to the attached vent picture and paint it to match the exterior of the house. The exact location will be subject to piping accessibility through the attic, but it will be in the general location marked in the attached gable picture.

At what presumably used to be a small window adjacent to the historic milk delivery door and near the side entry door by the driveway (south side), there is currently a wall mounted AC unit in the window opening. We plan to remove the AC unit that is an eyesore and replace it with a properly installed and trimmed window. The window would be a Marvin Ultimate fixed window with divided lites to resemble the aesthetic of the original windows. See attached spec and location picture.

6. SIGNATURE OF APPLICANT (owner signature required for demolition):

Antiquity GCMS

Signature

Antiquity GCMS

Please print or type name

6/16/2025

Date

This form and all supporting documentation MUST arrive by 4:00 pm (11:59 pm via email) on the deadline date established to be considered at the next Historic Preservation Commission Meeting. Any information not provided to staff in advance of the meeting will not be considered by the Commission during their deliberation. Please call if you have any questions and staff will assist you.

Email Form to: hpc@milwaukee.gov

Historic Preservation Commission
841 N. Broadway, Rm. B1
Milwaukee, WI 53202

PHONE: (414) 286-5712 or 286-5722

www.milwaukee.gov/hpc

Or click the SUBMIT button to automatically email this form, if using an app such as Outlook or Apple Mail. The submit button does not work with web-based email interfaces.

SUBMIT

SINGLE BATH FAN VENT
TO TERMINATE
SOMEWHERE WITHIN
DASHED LINES. UP TO 6"
DIAMETER. SEE NEXT
PAGE FOR VENT
TERMINATION COVER.



PRODUCT: COPPER WALL VENT CAP (__WVC_)

MATERIALS: COPPER

SIZES: 3" - 10" | SCREEN ONLY, DAMPER ONLY, DAMPER & SCREEN



PRODUCT HIGHLIGHTS

THE WALL CAP IS IDEAL FOR USE WITH THE DAMPER ONLY DRYER VENTING, KITCHEN FAN EXHAUST, BATH FAN EXHAUST, FURNACE AIR INTAKE (SCREEN ONLY), WHOLE HOUSE VENTILATIONS, AND HRV'S. VENTS WITH DAMPERS COME STANDARD WITH A SPRING CLOSURE DAMPER AND WEATHER SEAL FOR INCREASED ENERGY

- SPRING CLOSE FOAM LINED DAMPERS
- COPPER SCREENS ARE 1/4"
- 1/8" SCREENS AVAILABLE UPON REQUEST
- 16 OZ. COPPER

SPECIFICATION KEY

SPECIFY DAMPER & SCREEN OPTIONS

BEFORE PART

D = DAMPER ONLY (DWV__#)

S = SCREEN ONLY (SWV__#)

SD = SCREEN & DAMPER (SDWV__#)

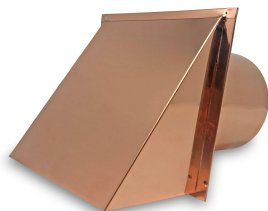
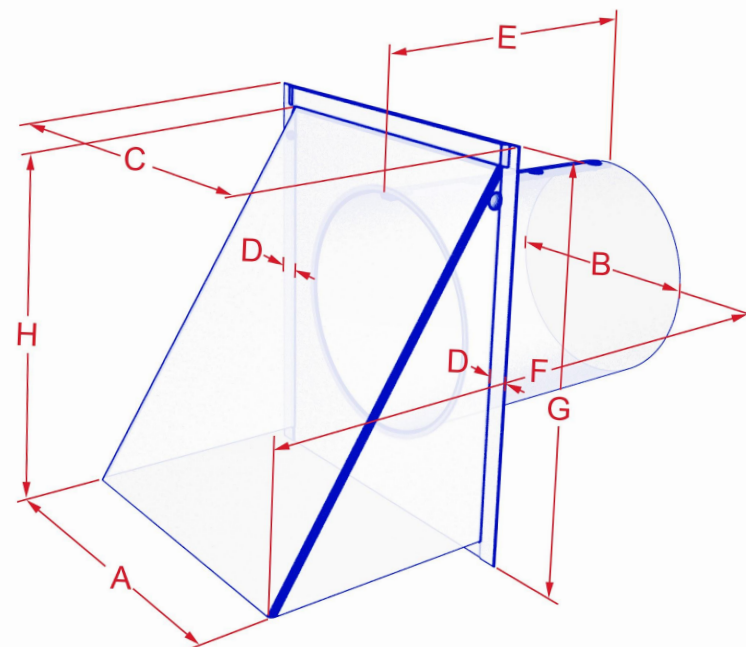

SKU	SIZE	A	B	C	D	E	F	G	H
__WVC3	3"	5.000	3.00	6.00	.5	5.00	12.375	6.625	5.375
__WVC4	4"	5.000	4.00	6.00	.5	5.00	12.375	6.625	5.375
__WVC5	5"	6.000	5.00	7.00	.5	5.00	12.250	7.000	6.125
__WVC6	6"	7.0625	6.00	8.00	.5	5.00	12.750	8.000	7.375
__WVC7	7"	9.375	7.00	9.00	.5	5.00	13.750	9.000	7.875
__WVC8	8"	9.375	8.00	11.00	.5	5.00	13.625	11.000	9.812
__WVC10	10"	12.000	10.00	13.00	.5	5.00	15.000	13.500	11.812



EMAIL: DAVE@LUXURYMETALS.COM
PHONE: (206) 406-7346 | WEBSITE: WWW.LUXURYMETALS.COM



Luxury Metals LLC
4708 W Fairview Ave #100
Boise, ID 83706



HISTORIC MILK
DELIVERY DOOR
REMAINS.

AC UNIT TO BE REMOVED
FROM WINDOW OPENING
AND REPLACED WITH
MARVIN ULTIMATE WINDOW.
SEE NEXT PAGE FOR
WINDOW SPEC.

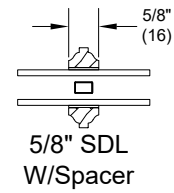
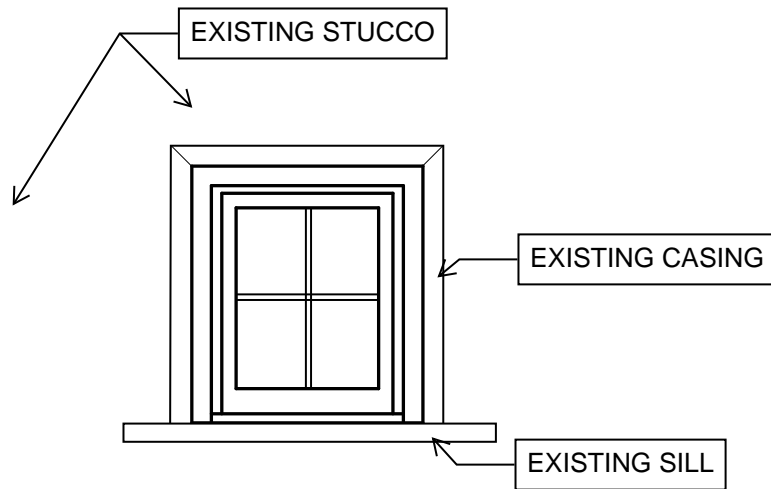

WOOD EXTERIOR,
PAINTED TO MATCH
HOUSE EXTERIOR

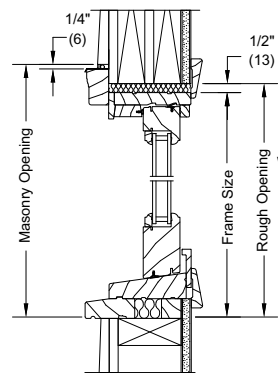

WOOD INTERIOR,
PAINTED TO MATCH
HOUSE INTERIOR

2" (51) SASH PICTURE UNIT
HEAD JAMB

WOOD INTERIOR,
PAINTED TO MATCH
HOUSE INTERIOR

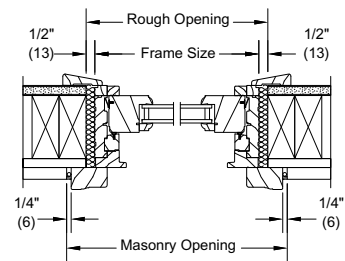

2" (51) SASH PICTURE UNIT
JAMB

WOOD EXTERIOR,
PAINTED TO MATCH
HOUSE EXTERIOR