



DGD # 2555

**MILWAUKEE COUNTY CERTIFIED SURVEY MAP NO. \_\_\_\_\_**

**BEING A DIVISION OF PARCEL 1 OF CERTIFIED SURVEY MAP NO. 4020, LOCATED IN PART OF THE NORTHWEST ¼ OF THE SOUTHWEST ¼ OF SECTION 19, TOWN 7 NORTH, RANGE 22 EAST, IN THE CITY OF MILWAUKEE, MILWAUKEE COUNTY, WISCONSIN.**

**SURVEYOR'S CERTIFICATE**  
**STATE OF WISCONSIN)**  
**MILWAUKEE COUNTY)SS**

I, Frederick W. Shibilski, a registered land surveyor do hereby certify:

That I have surveyed, divided and mapped Parcel 1 of Certified Survey Map No. 4020, located in part of the Northwest ¼ of the Southwest ¼ of Section 19, Town 7 North, Range 22 East, in the City of Milwaukee, Milwaukee County, Wisconsin, bounded and described as follows: Commencing at the Northwest corner of the Southwest ¼ of Section 19; thence South 01° 08' 04" East along the West line of said ¼ Section, 208.89 feet; thence North 89° 01' 32" East, 33.00 feet to the Northwest corner of Parcel 1 of Certified survey Map No. 4020 and the point of beginning; thence North 89° 01' 32" East, 125.00 feet to the Northeast corner of said Certified Survey Map; thence South 01° 08' 04" East, 60.00 feet to the Southeast corner of Parcel 1 of said Certified Survey Map; thence South 89° 01' 32" West, 125.00 feet to the Southwest corner of said Parcel 1; thence North 01° 08' 04" West, 60.00 feet to the point of beginning.

That I have made such survey, land division and map by the direction of the Housing Authority of the City of Milwaukee, owner of said land.

That this map is a correct representation of all exterior boundaries of land surveyed and the land division thereof made.

That I have fully complied with the provisions of Chapter 236 of the Wisconsin Statutes and Chapter 119 of the Milwaukee Code in surveying, dividing and mapping the same.

Dated this 25<sup>th</sup> day of October, 2005.

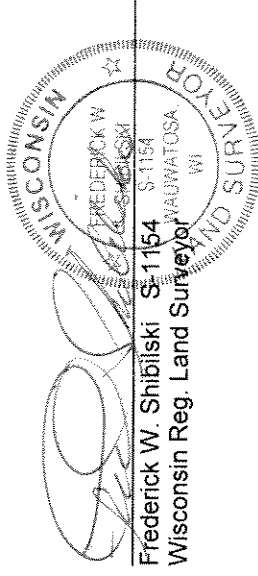

**CORPORATE OWNERS CERTIFICATE:**

The Housing Authority of the City of Milwaukee, a corporation duly organized and existing under and by virtue of the laws of the State of Wisconsin, as owner, does hereby certify that said corporation caused the land described on this map to be surveyed, divided, dedicated and mapped as represented on this map in accordance with the requirements of Chapter 119 of the Milwaukee Code of Ordinances.

In consideration of the approval of this map by the Common Council, and in accordance with Chapter 119 of the Milwaukee Code of Ordinances, the undersigned agrees:

- a. That all utility lines to provide electric power and telephone services and cable television or communications systems lines or cables to all parcels in the certified survey map shall be installed underground in easements provided therefor, where feasible.

This agreement shall be binding on the undersigned and assigns.

IN WITNESS WHEREOF, the said Housing Authority of the City of Milwaukee, has caused these presents to be signed by Willie L. Hines, Jr., Chair and countersigned by Antonio Perez, Secretary-Executive Director, at Milwaukee, Wisconsin, on this 17<sup>th</sup> day of May, 2006.

In the Presence of:

Adelle Burman

Willie L. Hines, Jr.

**The Housing Authority of the City of Milwaukee**

Willie L. Hines, Jr., Chair

Antonio Perez, Secretary-Executive Director

DCD#2555

**MILWAUKEE COUNTY CERTIFIED SURVEY MAP NO.** \_\_\_\_\_

BEING A DIVISION OF PARCEL 1 OF CERTIFIED SURVEY MAP NO. 4020, LOCATED IN PART OF THE NORTHWEST ¼ OF THE SOUTHWEST ¼ OF SECTION 19, TOWN 7 NORTH, RANGE 22 EAST, IN THE CITY OF MILWAUKEE, MILWAUKEE COUNTY, WISCONSIN.

**CORPORATE OWNERS CERTIFICATE (CONTINUED):**

**STATE OF WISCONSIN)  
MILWAUKEE COUNTY )SS**

Personally came before me this 17<sup>th</sup> day of May, 2006, the above named Willie L. Hines, Jr. and Antonio Perez of the above named Corporation, to me known to be the persons who executed the foregoing instrument and to me known to be such Chair and Secretary-Executive Director of said Corporation and acknowledged that they executed the foregoing instrument as such officers as the deed of said Corporation by its authority.

Adelia M. Burnham  
Notary Public, State of Wisconsin  
My Commission expires March 9, 2008

**CERTIFICATE OF CITY TREASURER  
STATE OF WISCONSIN)  
MILWAUKEE COUNTY )SS**

I, Wayne F. Whittow, being the duly elected, qualified and acting City Treasurer of the City of Milwaukee, certify that in accordance with the records in the Office of the City Treasurer of the City of Milwaukee there are no unpaid taxes or unpaid special assessments on the land included in this Certified Survey Map.

Date: 6-15-06 \_\_\_\_\_  
Wayne F. Whittow  
Wayne F. Whittow, City Treasurer

**COMMON COUNCIL CERTIFICATE OF APPROVAL**

I certify that this Certified Survey Map was approved under Resolution File No. 060348, adopted by the Common Council of the City of Milwaukee on July 12, 2006.

Ronald D. Leonhardt  
Ronald D. Leonhardt, City Clerk  
Thomas Barrett  
Thomas Barrett, Mayor

