



**CITY OF MILWAUKEE  
OFFICE OF THE CITY CLERK**

Wednesday, June 26, 2024

**COMMITTEE MEETING NOTICE**

AD 03

STACHNIK, Daniel J, Agent  
7-ELEVEN, INC  
P.O. Box 139044  
Dallas, TX 75313

You are requested to attend a hearing which is to be held in Room 301-B, Third Floor, City Hall or you may attend virtually using the link below.

**Tuesday, July 09, 2024 at 10:55 AM**

The access code is <https://meet.goto.com/616682381>. Please see the enclosed best practices document for further instructions.

**Regarding:** Your Class A Fermented Malt and Liquor (Cider Only), Extended Hours Establishments, Food Dealer and Weights & Measures License Applications as agent for "7-ELEVEN, INC" or "7-ELEVEN # 35852J" at 1609 E NORTH Av.

There is a possibility that your application may be denied for one or more of the following reasons: The recommendation of the committee regarding the application shall be based on evidence presented at the hearing. Per MCO 85-2.7-4, probative evidence concerning whether or not a new license should be granted may be presented on the following subjects: whether or not the applicant meets the municipal requirements, the appropriateness of the location and premises where the licensed premises is to be located and whether use of the premises for the purposes or activities permitted by the license would tend to facilitate a public or private nuisance or create undesirable neighborhood problems such as disorderly patrons, unreasonably loud noise, litter, and excessive traffic and parking congestion. Probative evidence relating to these matters may be taken from the plan of operation submitted with the license application, if any, but shall not include the content of any music. Evidence regarding the fitness of the location of the premises to be maintained as the principal place of business, including but not limited to whether there is an overconcentration of businesses of the type for which the license is sought; whether the proposal is consistent with any pertinent neighborhood business or development plans, or the location's proximity to areas where children are typically present. The applicant's record in operating similarly licensed premises; and whether or not the applicant has been charged with or convicted of any felony, misdemeanor, municipal offense or other offense, the circumstances of which substantially relate to the activity to be permitted by the license being applied for or any other factor which reasonably relates to the public health, safety or welfare may also be considered. See attached police report or correspondence.

**Notice for applicants with warrants or unpaid fines:**

**Proof of warrant satisfaction or payment of fines must be submitted at the hearing on the above date and time. Failure to comply with this requirement may result in a delay of the granting/denial of your application.**

Failure to appear at this meeting may result in the denial of your license. Individual applicants must appear only in person or by an attorney. Corporate or Limited Liability applicants must appear only by the agent designated on the application or by an attorney. Partnership applicants must appear by a partner listed on the application or by an attorney. If you wish to do so and at your own expense, you may be accompanied by an attorney of your choosing to represent you at this hearing. You will be given an opportunity to speak on behalf of the application and to respond and challenge any charges or reasons given for the denial. No petitions can be accepted by the committee, unless the people who signed the petition are present at the committee hearing and willing to testify. You may present witnesses under oath and you may also confront and cross-examine opposing witnesses under oath. If you have difficulty with the English language, you should bring an interpreter with you, at your expense, so that you can answer questions and participate in your hearing.

You may examine the application file at this office during regular business hours prior to the hearing date. Inquiries regarding this matter may be directed to the person whose signature appears below.

Limited parking for persons attending meetings during normal business hours is available at reduced rates (5 hour limit) at the Milwaukee Center on the southwest corner of Kilbourn Avenue and Water Street. You must present a copy of the meeting notice to the parking cashier.

PLEASE NOTE: Upon reasonable notice, efforts will be made to accommodate the needs of disabled individuals through sign language interpreters or other auxiliary aids. For additional information or to request this service, contact the Council Services Division ADA Coordinator at (414) 286-2998, Fax - (414) 286-3456, TDD - (414) 286-2025.

JIM OWCZARSKI, CITY CLERK

BY: \_\_\_\_\_

Jim Cooney  
License Division Manager

**If you have questions regarding this notice, please contact the License Division at (414) 286-2238.**

200 E. Wells Street, Room 105, City Hall, Milwaukee, WI 53202. [www.milwaukee.gov/license](http://www.milwaukee.gov/license)  
Phone: (414) 286-2238 Fax: (414) 286-3057 Email Address: [License@milwaukee.gov](mailto:License@milwaukee.gov)





CITY OF MILWAUKEE  
OFFICE OF THE CITY CLERK

Wednesday, June 26, 2024

COMMITTEE MEETING NOTICE

AD 03

STACHNIK, Daniel J, Agent  
7-ELEVEN, INC  
5650 W WAHNER AV #205  
Brown Deer, WI 53223

You are requested to attend a hearing which is to be held in Room 301-B, Third Floor, City Hall or you may attend virtually using the link below.

**Tuesday, July 09, 2024 at 10:55 AM**

The access code is <https://meet.goto.com/616682381>. Please see the enclosed best practices document for further instructions.

**Regarding:** Your Class A Fermented Malt and Liquor (Cider Only), Extended Hours Establishments, Food Dealer and Weights & Measures License Applications as agent for "7-ELEVEN, INC" for "7-ELEVEN # 35852J" at 1609 E NORTH Av.

There is a possibility that your application may be denied for one or more of the following reasons: The recommendation of the committee regarding the application shall be based on evidence presented at the hearing. Per MCO 85-2.7-4, probative evidence concerning whether or not a new license should be granted may be presented on the following subjects: whether or not the applicant meets the municipal requirements, the appropriateness of the location and premises where the licensed premises is to be located and whether use of the premises for the purposes or activities permitted by the license would tend to facilitate a public or private nuisance or create undesirable neighborhood problems such as disorderly patrons, unreasonably loud noise, litter, and excessive traffic and parking congestion. Probative evidence relating to these matters may be taken from the plan of operation submitted with the license application, if any, but shall not include the content of any music. Evidence regarding the fitness of the location of the premises to be maintained as the principal place of business, including but not limited to whether there is an overconcentration of businesses of the type for which the license is sought; whether the proposal is consistent with any pertinent neighborhood business or development plans, or the location's proximity to areas where children are typically present. The applicant's record in operating similarly licensed premises; and whether or not the applicant has been charged with or convicted of any felony, misdemeanor, municipal offense or other offense, the circumstances of which substantially relate to the activity to be permitted by the license being applied for or any other factor which reasonably relates to the public health, safety or welfare may also be considered. See attached police report or correspondence.

**Notice for applicants with warrants or unpaid fines:**

**Proof of warrant satisfaction or payment of fines must be submitted at the hearing on the above date and time. Failure to comply with this requirement may result in a delay of the granting/denial of your application.**

Failure to appear at this meeting may result in the denial of your license. Individual applicants must appear only in person or by an attorney. Corporate or Limited Liability applicants must appear only by the agent designated on the application or by an attorney. Partnership applicants must appear by a partner listed on the application or by an attorney. If you wish to do so and at your own expense, you may be accompanied by an attorney of your choosing to represent you at this hearing. You will be given an opportunity to speak on behalf of the application and to respond and challenge any charges or reasons given for the denial. No petitions can be accepted by the committee, unless the people who signed the petition are present at the committee hearing and willing to testify. You may present witnesses under oath and you may also confront and cross-examine opposing witnesses under oath. If you have difficulty with the English language, you should bring an interpreter with you, at your expense, so that you can answer questions and participate in your hearing.

You may examine the application file at this office during regular business hours prior to the hearing date. Inquiries regarding this matter may be directed to the person whose signature appears below.

Limited parking for persons attending meetings during normal business hours is available at reduced rates (5 hour limit) at the Milwaukee Center on the southwest corner of Kilbourn Avenue and Water Street. You must present a copy of the meeting notice to the parking cashier.

PLEASE NOTE: Upon reasonable notice, efforts will be made to accommodate the needs of disabled individuals through sign language interpreters or other auxiliary aids. For additional information or to request this service, contact the Council Services Division ADA Coordinator at (414) 286-2998, Fax - (414) 286-3456, TDD - (414) 286-2025.

JIM OWCZARSKI, CITY CLERK

BY: \_\_\_\_\_

Jim Cooney  
License Division Manager

**If you have questions regarding this notice, please contact the License Division at (414) 286-2238.**

200 E. Wells Street, Room 105, City Hall, Milwaukee, WI 53202. [www.milwaukee.gov/license](http://www.milwaukee.gov/license)  
Phone: (414) 286-2238 Fax: (414) 286-3057 Email Address: License@milwaukee.gov

Date: 5/23/24

Officer: Mustafa

City of Milwaukee Police Department  
90-5-1.5 Crime Prevention Survey  
Convenience Store/Liquor Store Inspection

Name of Premise: 7-Eleven  
Address: 1609 E. North Av  
Phone: 414.224.7793

Owner: 7-Eleven Corporate  
Owner address: 3200 Hackberry Rd.  
City State Zip: Irving, TX  
Owner Phone: 800.255.0711  
Owner email: UNKNOWN

Manager: As of now Daniel STACHNIK  
Home Address: 5650 W Wahner Av  
City State Zip: Brown Deer, WI 53223  
Phone: 414.559.9203  
Email: DanielStachnik@hotmail.com

Preferred contact: Daniel STACHNIK

Location currently open:  YES  NO

Projected open date:

Day's open:  S  M  T  W  Th  F  SA  ALL

Hours of Operation: Sun:  24 hours  Y  N  
Mon:  
Tue:  
Wed:  
Thu:  
Fri:  
Sat:

Premise Type:  Liquor Store  
 Convenience Store  
 Other:

Licenses currently held:

- Alcohol:  Yes  No Class: A #: AMALT-0199701
- Tobacco:  Yes  No #: CIG 1032778
- Food:  Yes  No #: 0015032
- Extended Hours:  Yes  No #:
- Secondhand Dealer:  Yes  No Type: #:
- Other:  Yes  No Type:
- Other:  Yes  No Type: NOCC-18-00678 #:

Who is your alcohol distributor? Beer Capitol, and BEECHWOOD

**Exterior Survey:**

1. Is the area around the location clean?  Yes  No
2. What surrounds the location? (Check all the apply)
  - a.  Park
  - b.  School
  - c.  Youth Center
  - d.  Church
  - e.  Tavern(s) If so, how many
  - f.  Residential
  - g.  Other businesses
  - h.  Other:
3. Can you see from the outside of the location into the interior  Yes  No
4. Can you see the employees inside of the location from the outside  Yes  No
5. Are exterior windows free of signage  Yes  No
6. Is there a parking lot  Yes  No
7. Is the parking lot clean?  Yes  No
8. Is the parking lot well lit?  Yes  No
9. Are there areas where a person could conceal themselves  Yes  No
10. Is there exterior lighting?  Yes  No. Does it appears to be adequate  Yes  No
11. Exterior Payphone?  Yes  No
12. Are there No Loitering Signs posted?  Yes  No
13. Are there exterior security cameras  Yes  No How Many:
14. Are the address numbers prominently displayed and easy to see  Yes  No

**Camera Survey:**

15. Does this location have security cameras?  Yes  No
16. Are they in working order?  Yes  No
17. What format are the cameras?
  - a. Color  Yes  No
  - b. Digital  Yes  No
  - c. VCR  Yes  No
  - d. Recorded  Yes  No
18. How long is footage stored for later viewing: unknown
19. Are there exterior cameras  Yes  No How many:

20. Are there interior cameras  Yes  No How many: 4  
 21. Do all employees know how to retrieve recorded digital images/footage?  Yes  No

**Interior Survey:**

22. Is the storeowner willing to be a standing complainant regarding loitering?  Yes  No  
 a. If yes have them fill out the standing complaint form and give them two of the commercial signs  Yes  No
23. Is the interior of the location neat and clean?  Yes  No  
 24. Does an interior camera face the entrance/exit?  Yes  No  
 25. Is there a lockable area that separates employees from customers?  Yes  No  
 26. Does the store sell single chore boy?  Yes  No  
 27. Does the store sell blunt wraps?  Yes  No  
 28. Does the store sell scales?  Yes  No  
 29. Does the store sell items that may be used as crack pipes?  Yes  No  
 a. Describe item N/A
30. Does the store have an over abundance of sandwich baggies?  Yes  No  
 31. Does the owner understand that these items are often used for drug use?  Yes  No  
 32. Do the products in the store appear to be new and rotated often?  Yes  No  
 33. Are emergency and non-emergency numbers posted near the phone?  Yes  No  
 34. Does the owner know how to contact their police district directly?  Yes  No  
 a. Did you provide a district contact guide to the owner?  Yes  No

**Complete this section if alcohol establishment is a convenience store:**

(\*\* Read full ordinance for all details "68-55 Convenience Food Stores")

All convenience food stores not exempted under sub. 3 shall:

1. Is the cash register located in a manner so that at the time of a sales transaction, the employee and customer are both visible from the sidewalk?  Yes  No \*\*
2. Are the glass entrance and exit doors clear of any signs or advertisements with the exception of a sign which states that the cash register contains \$50 or less and that the safe is no accessible to employees?  Yes  No
3. Does the store maintain one of the following on the licensed premise:
  - a. A safe that was in use at the convenience food store on August 17, 1994?  Yes  No
  - b. A drop-safe or time release safe that weighs at least 500 pounds or which is attached to or set into the floor in a manner approved by the police department?  Yes  No
4. Is lighting provided for the store's parking area during all hours of darkness when employees or customers are on the premises at a minimum average of 2-foot candles per square foot, unless the store is not open for business after sunset and before sunrise?  Yes  No  N/A
5. Are at least two high-resolution surveillance security cameras installed?  Yes  No
6. Are the security cameras in working order?  Yes  No
7. Does one camera show an overall view of the counter and register area?  Yes  No
8. Does one camera show a clear, identifiable, full frame image of the face of each person entering and leaving the store?  Yes  No
9. Are the camera views obstructed by fixtures or displays?  Yes  No
10. Is the recorded footage stored for at least 30 days?  Yes  No (Unknown)
11. Do all store employees know how to record footage from the camera system to media capable of being transferred to police custody?  Yes  No

12. Are customer entrances/exits made of glass or other transparent material?  Yes  No  
 a. Exception: A store that does not have such doors on August 17, 1994 shall not be required to install such doors until the holder of the store's food dealer license changes.
13. Has the owner and their employees attended the Robbery Prevention Training within 120 days of ownership or employment?  Yes  No  
 a. Contact Community Outreach and Education at 935-7836 for schedule.

**Sub 3. Exemptions.** The requirements of this section do not apply to a convenience food store that conforms to either of the following descriptions:

- a-1. The store is located in an enclosed shopping structure, enclosed commercial building or hospital. A convenience food store is not in an enclosed structure or building if a customer can enter it directly from the outside.  
 Does store conform to a-1  Yes  No
- a-2. The store physically separates employees from customers with a solid partition that bars a person from entering the employee area from the customer area, has a secure lock on the employee side of any door between the employee area and the customer, and conducts all transaction through a service window or similar arrangement.  
 Does store conform to a-2  Yes  No
- a. At the commissioner's discretion, a convenience store may be exempted from any or all of the regulations specified in sub 2.  
 Does this location hold an exemption from the commissioner regarding any of the requirements of Sub 2?  Yes  No

**ADDITIONAL COMMENTS/RECOMMENDATIONS:**





# Concentration Map 1609 E NORTH AVE

## Area of Interest (AOI) Information

Area : 21,862,585.76 ft<sup>2</sup>

May 14 2024 15:34:21 Central Daylight Time

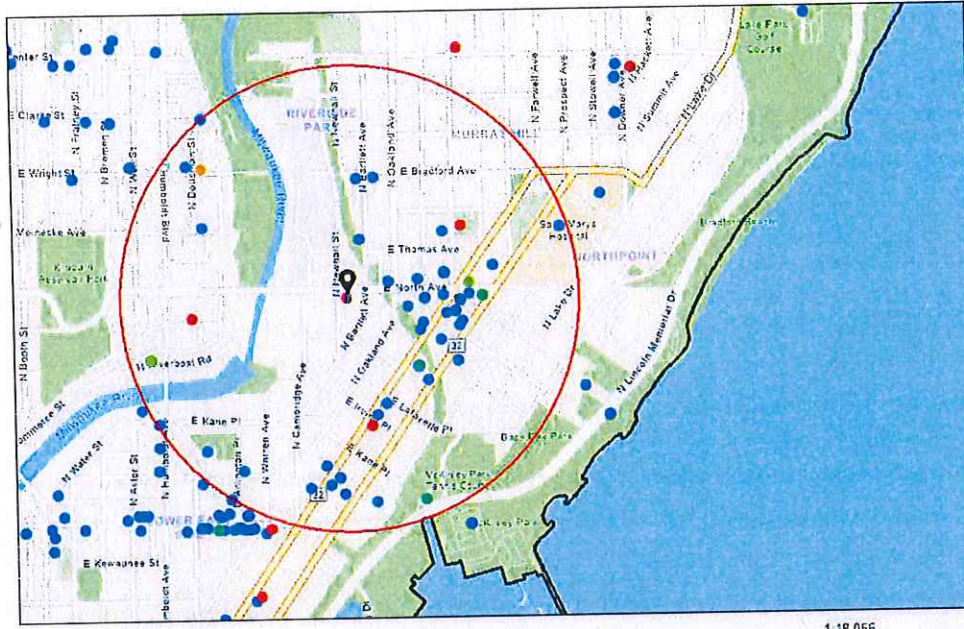

- Alcohol Licenses (active)
- Class A Intoxicating Liquor
  - Class A Fermented Malt Beverage
  - Class A Liquor and Malt
  - Class B Fermented Malt Beverage
  - Class B Tavern
  - Class C Wine Retailer
  - City Limits

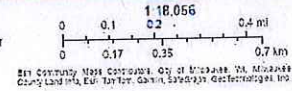

1609 E NORTH AVE

### Summary

Name	Count	Area(ft <sup>2</sup> )	Length(mi)
Alcohol Licenses	65		

Alcohol Licenses



#	Legal Entity	Trade Name	Licensee	Address	License Type Name	Total Capacity	Expiration Date	Count
1	Nine Below Inc	Nine Below	Marla R Poytinger, Agt	1905 E North AV	Class B Tavern License	270	5/30/2024, 7:00 PM	1
2	Axe MKE, Inc	Axe MKE	Marla R Poytinger, Agt	1924 E KENILWORTH PL	Class B Tavern License		5/30/2024, 7:00 PM	1
3	BENJAMIN'S FINE WINE & SPIRITS LLC	Waterford Wine Company	BENJAMIN T CHRISTIANS EN, Agt	2120 N FARWELL AV	Class B Tavern License		5/30/2024, 7:00 PM	1
4	Good City Brewing LLC	Good City Brewing	David C Dupee, Agt	2108 N Farwell AV	Class B Tavern License		5/31/2024, 7:00 PM	1
5	WHOLE FOODS MARKET GROUP, INC	WHOLE FOODS MARKET	Brooke M Remitz, Agt	2305 N PROSPECT AV	Class B Tavern License		6/13/2024, 7:00 PM	1
6	Black Gate LLC	Von Trier	MARK A ZIERATH, Agt	2235 N Farwell AV	Class B Tavern License	153	6/13/2024, 7:00 PM	1
7	Dairyland Retail Group LLC	7-Eleven #35852B	Daniel J Stachnik, Agt	1609 E NORTH AV	Class A Fermented Malt Beverage Retailer's License		6/14/2024, 7:00 PM	1
8	Dairyland Retail Group LLC	7-Eleven #35852B	Daniel J Stachnik, Agt	1609 E NORTH AV	Class A Retailer's Intoxicating Liquor License		6/14/2024, 7:00 PM	1
9	CHAMPION'S PUB, LLC	CHAMPION'S PUB	ROBERT R GREENYA, Agt	2417 N BARTLETT AV	Class B Tavern License	148	6/28/2024, 7:00 PM	1
10	HOOLIGAN'S SUPER IRISH DELI & BAR, INC	HOOLIGAN'S	MARK B BUESING, Agt	2017 E NORTH AV	Class B Tavern License	118	6/29/2024, 7:00 PM	1
11	THE SQUIRREL CAGE	THE SQUIRREL CAGE	PATRICIA L ULIK, SP	2402 N DOUSMAN ST	Class B Tavern License	25	6/29/2024, 7:00 PM	1
12	OCTOPUS, LTD	WOLSKI'S TAVERN	DENNIS BONDAR, Agt	1836 N PULASKI ST	Class B Tavern License	80	6/29/2024, 7:00 PM	1
13	WV, LLC	TESS	MITCHELL D WAKEFIELD, Agt	2499 N BARTLETT AV	Class B Tavern License	60	7/30/2024, 7:00 PM	1
14	IFM Farwell LLC	Oriental Theatre	Kristen C Heller, Agt	2230 N FARWELL AV	Class B Tavern License	1,834	7/31/2024, 7:00 PM	1
15	DP Hospitality Group LLC	Tavolino	Peter J Dietrich, Agt	2315 N MURRAY AV	Class B Tavern License	99	8/20/2024, 7:00 PM	1
16	Sip & Purr LLC	Sip & Purr Cat Cafe	Katherine E McHugh, Agt	2021 E Ivanhoe PL	Class B Tavern License		8/30/2024, 7:00 PM	1
17	BEANS & BARLEY, INC	BEANS & BARLEY	JAMES C NEUMEYER, Agt	1901 E NORTH AV	Class B Tavern License	180	8/30/2024, 7:00 PM	1

18	Beau Chalet, LLC	Beerline Cafe	Michael G Allen, Agt	2076 N COMMERCE ST	Class B Fermented Malt Beverage Retailer's License		9/2/2024, 7:00 PM	1
19	Beau Chalet, LLC	Beerline Cafe	Michael G Allen, Agt	2076 N COMMERCE ST	Class C Wine Retailer's License		9/2/2024, 7:00 PM	1
20	The Original MKE, LLC	The Original	Eric E Rzepka, Agt	2498 N Bartlett AV	Class B Tavern License	99	9/3/2024, 7:00 PM	1
21	Kawa Ramen & Sushi Inc	Kawa	LinJin Xiao, Agt	2321-23 N Murray AV	Class B Tavern License		9/12/2024, 7:00 PM	1
22	Milwaukee Catholic Home Inc	Milwaukee Catholic Home	Christopher A Reinheimer, Agt	2462 N PROSPECT AV	Class B Tavern License		9/18/2024, 7:00 PM	1
23	Ardent Milwaukee, LLC	Ardent	Justin K Carlisle, Agt	1749-51 N Farwell AV	Class B Tavern License		10/13/2024, 7:00 PM	1
24	Colectivo Coffee Roasters Inc	Colectivo Coffee Roasters Inc	Curtis W Fowler, Agt	2211 N Prospect AV	Class B Tavern License	299	10/17/2024, 7:00 PM	1
25	Colectivo Coffee Roasters Inc	Colectivo Coffee Roasters Inc	William D Suskey, Agt	1701 N LINCOLN MEMORIAL DR	Class B Fermented Malt Beverage Retailer's License		10/29/2024, 7:00 PM	1
26	Sunny Days Food LLC	Sunny Days Food	Michael I Hudson, Agt	2500 N DOUSMAN ST	Class A Fermented Malt Beverage Retailer's License		10/29/2024, 7:00 PM	1
27	EE SANE THAI LAO CUISINE	EE SANE THAI LAO CUISINE	Prasith Nanthasane, SP	1806 N FARWELL AV	Class B Tavern License		10/29/2024, 7:00 PM	1
28	Yangzi, LLC	Huan Xi	Jun Yang, Agt	2428 N Murray AV	Class C Wine Retailer's License		10/31/2024, 7:00 PM	1
29	Yangzi, LLC	Huan Xi	Jun Yang, Agt	2428 N Murray AV	Class B Fermented Malt Beverage Retailer's License		10/31/2024, 7:00 PM	1
30	The National, LLC	The LaFayette Place	Amy R Plennes, Agt	1978 N Farwell AV	Class B Tavern License		11/3/2024, 6:00 PM	1
31	ETHIOPIAN COTTAGE RESTAURANT, INC	ETHIOPIAN COTTAGE RESTAURANT	YIGLETU DEBEBE, Agt	1824 N FARWELL AV	Class C Wine Retailer's License		11/19/2024, 6:00 PM	1
32	ETHIOPIAN COTTAGE RESTAURANT, INC	ETHIOPIAN COTTAGE RESTAURANT	YIGLETU DEBEBE, Agt	1824 N FARWELL AV	Class B Fermented Malt Beverage Retailer's License	75	11/19/2024, 6:00 PM	1
33	Door County Brewing Co, LLC	Hacienda Beer Co	James W Anderson, Agt	2018 E North AV	Class C Wine Retailer's License	240	11/24/2024, 6:00 PM	1
34	Crossroads Collective, LLC	Crossroads Collective	TIM B GOKHMAN, Agt	2238 N Farwell AV	Class B Tavern License	231	12/10/2024, 6:00 PM	1

35	VIER NORTH LLC	VIER NORTH	Melanie P Petersen, Agt	1832 E NORTH AV	Class B Tavern License		12/11/2024, 6:00 PM	1
36	The Jazz Estate Inc	The Jazz Estate	JOHN M DYE, Agt	2423 N MURRAY AV	Class B Tavern License	62	12/14/2024, 6:00 PM	1
37	Stone Bowl Grill, LLC	Stone Bowl	Young B Kim, Agt	1958-62 N Farwell AV	Class B Tavern License	99	12/15/2024, 6:00 PM	1
38	MAA VERAI, INC.	Murray Pantry	Sandipkumar M Patel, Agt	2430 N MURRAY AV	Class A Malt & Class A Liquor License		1/16/2025, 6:00 PM	1
39	Mex Ave East LLC	Mex Avenue	Melissa G Escobar, Agt	2238 N FARWELL AV 6	Class B Tavern License		1/22/2025, 6:00 PM	1
40	Saint John's Communities, Inc	Saint John's on the Lake	Renee E Anderson, Agt	1840 N PROSPECT AV	Class B Tavern License		2/3/2025, 6:00 PM	1
41	THE GIG	THE GIG	BARRY LEWIS, SP	1132 E WRIGHT ST	Class B Tavern License	100	2/4/2025, 6:00 PM	1
42	Pomona Cider Company LLC	Pomona Cider Company	Thomas S Gabert, Agt	2163 N FARWELL AV	Class B Tavern License		2/5/2025, 6:00 PM	1
43	Izzy Hops LLC	Izzy Hops	MICHAEL J VITUCCI, Agt	2311 N Murray AV	Class B Tavern License		2/6/2025, 6:00 PM	1
44	Strange Town, LLC	Strange Town	Mia L LeTendre, Agt	2101-2103 N Prospect AV	Class B Tavern License	49	2/13/2025, 6:00 PM	1
45	PTG Live Events, LLC	Pabst Theater Group	RICHARD J RYAN, Agt	1818 N FARWELL AV	Class B Tavern License	680	2/13/2025, 6:00 PM	1
46	Fink's of Milwaukee, Inc	Fink's	KRISTYN A Eitel, Agt	1875 N Humboldt AV	Class B Tavern License	80	2/20/2025, 6:00 PM	1
47	Gee Willickers LLC	Gee Willickers	Susan A Strege, Agt	2578 N DOUSMAN ST	Class B Tavern License	25	2/25/2025, 6:00 PM	1
48	Charles Allis and Villa Terrace Museums, Inc.	Charles Allis Art Museum	Jaymee Harvey Willms, Agt	1801 N PROSPECT AV	Class B Tavern License	99	2/25/2025, 6:00 PM	1
49	Erth Wellness, LLC	Kind Oasis	Salem J Kashou, Agt	2169 N FARWELL AV	Class B Tavern License		2/25/2025, 6:00 PM	1
50	Woori Wells Corp	Maru	Jongsoo Kim, Agt	2150 N Prospect AV	Class B Tavern License		2/25/2025, 6:00 PM	1
51	Krikar LLC	Koppa's Fulbeli Deli	Karthik B Pothumachi, Agt	1940 N FARWELL AV	Class A Malt & Class A Liquor License		2/26/2025, 6:00 PM	1
52	PADDY'S PET & PUB, LLC	PADDY'S PET & PUB	ORLEN G WOOD, Agt	2339-A N MURRAY AV	Class B Tavern License	179	3/1/2025, 6:00 PM	1
53	Ian's Pizza Milwaukee, LLC	Ian's Pizza Milwaukee	Ryan W Donovan, Agt	2035 E NORTH AV	Class B Fermented Malt Beverage Retailer's License		3/1/2025, 6:00 PM	1

54	Ian's Pizza Milwaukee, LLC	Ian's Pizza Milwaukee	Ryan W Donovan, Agt	2035 E NORTH AV	Class C Wine Retailer's License		3/1/2025, 6:00 PM	1
55	PIZZA SHUTTLE, INC	PIZZA SHUTTLE	Kirby F Clark, Agt	1827 N Farwell AV	Class B Tavern License	150	3/6/2025, 6:00 PM	1
56	WI LJ INC	Back Street	Ying Li, Agt	2116 N FARWELL AV	Class B Fermented Malt Beverage Retailer's License		3/18/2025, 7:00 PM	1
57	JAMOHEAD, INC	JAMO'S	JAMISON H GOLL, Agt	1800 N ARLINGTON PL	Class B Tavern License	25	3/24/2025, 7:00 PM	1
58	Saz's Catering Inc	Jan Serr Studio	Stephanie L Sazama-Schneck, Agt	2155 N Prospect AV	Class B Tavern License		4/4/2025, 7:00 PM	1
59	Premier Closers LLC	Upper East Bar	Stephanie R Townsend, Agt	1732 E NORTH AV	Class B Tavern License		4/7/2025, 7:00 PM	1
60	INCONTRO GROUP LLC	L'INCONTRO	Paul J Piotrowski, Agt	2315 N MURRAY AV	Class B Tavern License		4/7/2025, 7:00 PM	1
61	PROSPECTOR PARTNERSHIP LLC	VINTAGE	REBECCA E GODFREY, Agt	2203 N PROSPECT AV	Class B Tavern License	151	4/10/2025, 7:00 PM	1
62	GPJ OF MILWAUKEE, INC	MA FISCHER'S	HEIDI A PANAGIOTOP OULOS, Agt	2214 N FARWELL AV	Class B Tavern License	240	4/11/2025, 7:00 PM	1
63	LANDMARK BARS, INC	LANDMARK LANES	SLAVA TUZHILKOV, Agt	2220 N FARWELL AV	Class B Tavern License	240	4/11/2025, 7:00 PM	1
64	MEGA MARTS, LLC	PICK 'N SAVE #882	Jon Piasecki, Agt	1100 E GARFIELD AV	Class A Malt & Class A Liquor License		4/17/2025, 7:00 PM	1
65	FRANKIES RESTAURANT AND CATERING, LLC	Frankies Restaurant and Catering	Donna D Afrifa, Agt	1815 E KENILWORTH PL	Class B Tavern License		5/10/2025, 7:00 PM	1

Establishments within a 0.5 miles radius centered on area of Interest.





Wednesday, June 26, 2024



# Notice of Public Hearing

Blank Notice

---

STACHNIK, Daniel J, Agent  
7-ELEVEN # 35852J at 1609 E NORTH Av  
Class A Fermented Malt and Liquor (Cider Only), Extended Hours Establishments, Food Dealer  
and Weights & Measures License Applications

**Tuesday, July 09, 2024 at 10:55 AM**

To whom it may concern:

The above application has been made by the above named applicant(s). This requires approval from the Licenses Committee and the Common Council of the City of Milwaukee. The hearing before the Licenses Committee will take place on 7/9/2024 at 10:55 AM in Room 301-B, Third Floor, City Hall. This is a public hearing. Those wishing to view the proceeding are able to do so via the City Channel – Channel 25 on Spectrum Cable – or on the Internet at <http://city.milwaukee.gov/citychannel>. Those wishing to provide oral testimony via internet are asked to contact the staff assistant, Yadira Melendez at (414) 286-2775 or [stasst5@milwaukee.gov](mailto:stasst5@milwaukee.gov) for necessary information. Please make such requests no later than one business day prior to the start of the meeting. You are not required to attend the hearing, but please see the information below if you would like to provide testimony. Once the Licenses Committee makes its recommendation, this recommendation is forwarded to the full Common Council for approval at its next regularly scheduled hearing.

---

## Important details for those wishing to provide information for the Licenses Committee to consider when making its recommendation:

1. The license application is scheduled to be heard at the above time. Due to other hearings running longer than scheduled, you may have to wait some time to provide your testimony.
2. You must appear in person and testify as to matters that you have personally experienced or seen. (You cannot provide testimony for your neighbor, parent or anyone else; this is considered hearsay and cannot be considered by the committee.)
3. No letters or petitions can be accepted by the committee (unless the person who wrote the letter or the persons who signed the petition are present at the committee hearing and willing to testify).
4. Persons opposed to the license application are given the opportunity to testify first; supporters may testify after the opponents have finished.
5. When you are called to testify, you will be sworn in and asked to give your name, and address. (If your first and/or last names are uncommon please spell them.)
6. You may then provide testimony.
  - a. Include only information relating to the above license application.
  - b. Include only information you have personally witnessed or seen.
  - c. Provide concise and relevant information detailing how this business has affected or may affect the peaceful enjoyment of your neighborhood.
  - d. If by the time you have the opportunity to testify, the information you wish to share has already been provided to the committee, you may state that you agree with the previous testimony. Redundant or repetitive testimony will not assist the committee in making its recommendation.
7. After giving your testimony, the members of the Licenses Committee and the licensee may ask questions regarding the testimony you have given or other factors relating to the license application.
8. Business Competition is not a valid basis for denial or non-renewal of a license.  
**Please Note: If you have submitted an objection to the above application your objection cannot be considered by the committee unless you personally testify at the hearing.**

OCCUPANT	MAIL ADDRESS	CITY STATE ZIP
CURRENT OCCUPANT	1527 E NORTH AVE	MILWAUKEE, WI 53202-1032
CURRENT OCCUPANT	1531 E NORTH AVE	MILWAUKEE, WI 53202-1032
CURRENT OCCUPANT	1533 E NORTH AVE	MILWAUKEE, WI 53202-1032
CURRENT OCCUPANT	1537 E NORTH AVE	MILWAUKEE, WI 53202-1032
CURRENT OCCUPANT	1538 E WINDSOR PL	MILWAUKEE, WI 53202-1043
CURRENT OCCUPANT	1540 E WINDSOR PL	MILWAUKEE, WI 53202-1043
CURRENT OCCUPANT	1541 E NORTH AVE	MILWAUKEE, WI 53202-1032
CURRENT OCCUPANT	2112 N NEWHALL ST	MILWAUKEE, WI 53202-1027
CURRENT OCCUPANT	2114 N NEWHALL ST	MILWAUKEE, WI 53202-1027
CURRENT OCCUPANT	2115 N BARTLETT AVE	MILWAUKEE, WI 53202-1019
CURRENT OCCUPANT	2115 N NEWHALL ST	MILWAUKEE, WI 53202-1026
CURRENT OCCUPANT	2116 N NEWHALL ST	MILWAUKEE, WI 53202-1027
CURRENT OCCUPANT	2117 N NEWHALL ST	MILWAUKEE, WI 53202-1026
CURRENT OCCUPANT	2118 N NEWHALL ST	MILWAUKEE, WI 53202-1027
CURRENT OCCUPANT	2121 N BARTLETT AVE	MILWAUKEE, WI 53202-1019
CURRENT OCCUPANT	2121 N NEWHALL ST	MILWAUKEE, WI 53202-1026
CURRENT OCCUPANT	2123 N BARTLETT AVE	MILWAUKEE, WI 53202-1019
CURRENT OCCUPANT	2124 N NEWHALL ST	MILWAUKEE, WI 53202-1027
CURRENT OCCUPANT	2125 N NEWHALL ST	MILWAUKEE, WI 53202-1026
CURRENT OCCUPANT	2127 N BARTLETT AVE	MILWAUKEE, WI 53202-1019
CURRENT OCCUPANT	2128 N NEWHALL ST	MILWAUKEE, WI 53202-1027
CURRENT OCCUPANT	2129 N NEWHALL ST	MILWAUKEE, WI 53202-1026
CURRENT OCCUPANT	2200 N NEWHALL ST	MILWAUKEE, WI 53202-1028
CURRENT OCCUPANT	2202 N CAMBRIDGE AVE# 1	MILWAUKEE, WI 53202-1016
CURRENT OCCUPANT	2202 N CAMBRIDGE AVE# 2	MILWAUKEE, WI 53202-1016
CURRENT OCCUPANT	2202 N CAMBRIDGE AVE# 3	MILWAUKEE, WI 53202-1016
CURRENT OCCUPANT	2202 N CAMBRIDGE AVE# 4	MILWAUKEE, WI 53202-1016
CURRENT OCCUPANT	2203 N BARTLETT AVE	MILWAUKEE, WI 53202-1021
CURRENT OCCUPANT	2203 N NEWHALL ST	MILWAUKEE, WI 53202-1029
CURRENT OCCUPANT	2204 N NEWHALL ST	MILWAUKEE, WI 53202-1028
CURRENT OCCUPANT	2206 N CAMBRIDGE AVE	MILWAUKEE, WI 53202-1016
CURRENT OCCUPANT	2207 N NEWHALL ST	MILWAUKEE, WI 53202-1029
CURRENT OCCUPANT	2208 N NEWHALL ST	MILWAUKEE, WI 53202-1028
CURRENT OCCUPANT	2209 N BARTLETT AVE	MILWAUKEE, WI 53202-1021
CURRENT OCCUPANT	2209 N NEWHALL ST	MILWAUKEE, WI 53202-1029
CURRENT OCCUPANT	2209A N BARTLETT AVE	MILWAUKEE, WI 53202-1021
CURRENT OCCUPANT	2210 N NEWHALL ST	MILWAUKEE, WI 53202-1028
CURRENT OCCUPANT	2211 N NEWHALL ST	MILWAUKEE, WI 53202-1029
CURRENT OCCUPANT	2212 N NEWHALL ST	MILWAUKEE, WI 53202-1028
CURRENT OCCUPANT	2213 N BARTLETT AVE	MILWAUKEE, WI 53202-1021
CURRENT OCCUPANT	2213A N BARTLETT AVE	MILWAUKEE, WI 53202-1021
CURRENT OCCUPANT	2214 N NEWHALL ST	MILWAUKEE, WI 53202-1028

Blank Notice

Total Records: 42

Radius 250 feet and Center of the Circle: 1609 E North Av



# BUSINESS LICENSE PLAN OF OPERATION

ccl-busplan 5/12/2020

Office of the City Clerk License Division  
200 E. Wells St. Room 105, Milwaukee, WI 53202  
(414) 286-2238 www.milwaukee.gov/licensed e-mail address: license@milwaukee.gov

## 1. Type of Business

Applying for:  Extended Hours (12AM to 5AM) - If a food establishment, check all that apply:  Delivery  Drive Thru  Dining Room  
 Self Service Laundry  Massage Establishment  Filling Station  
 Other (supplemental application for specific license also required)

Provide a detailed description of the type of business you plan on operating:

Convenience Store

Do you have any experience operating this type of business?  No  Yes If yes, explain:

## 2. Business Operations

- a. Proposed Opening Date: currently open - change of operator
- b. Is this premise under construction?  No  Yes If yes, list estimated completion date: \_\_\_\_\_
- c. Is this a franchise?  No  Yes
- d. Is this premises currently licensed?  No  Yes If yes, list type of license: Class "A" Malt Bev./Class "A" Liquor (Cider) Extended hours/food dealer/cigarette related licenses
- e. Is the current licensee operating?  No  Yes If no, list date closed: \_\_\_\_\_
- f. Do you have future plans for other businesses, licenses or permits at this location?  No  Yes  
If yes, explain: \_\_\_\_\_
- g. Have you previously field an Extended Hours License in Milwaukee?  No  Yes  
If yes, list address(es): 3301 N. Oakland, Milwaukee
- h. Are other businesses operating in the same building?  No  Yes If yes, describe: \_\_\_\_\_

## 3. Litter & Noise

- a. How are grounds kept clean?  Sweep  Pressure Wash  Pick Up Litter  Other: \_\_\_\_\_
- b. How often will grounds be cleaned?  Daily  Weekly  As Needed  Monthly  Other: \_\_\_\_\_
- c. Grounds cleaned by:  Licensee  Building Owner  Employees  Hired Maintenance  Other: \_\_\_\_\_
- d. How are noise issues prevented and/or addressed?  Security  Manager approaches customer(s)  Call Police  
 Signs Posted  Other: \_\_\_\_\_
- e. Will a sound amplification system be used?  No  Yes If yes, describe: \_\_\_\_\_

## 4. Smoking & Sanitation

- a. Are there designated outdoor smoking areas?  No  Yes If yes, describe: \_\_\_\_\_
- b. Number of Garbage Cans: Inside: 7 Locations: Coffee bar/front counter  
Outside: 2 Locations: each side of entrance
- c. Is a crowd control barrier used?  No  Yes If yes, describe: \_\_\_\_\_
- d. How many restrooms are on the premises? 2
- e. Name of solid waste contractor:  Advanced Disposal  Waste Management  Other: GFL Environmental

## 5. Security

- a. Are there onsite parking spaces?  No  Yes If yes, how many? 7 and describe the parking security plan: LED lighting
- b. Is there a loading zone?  No  Yes If yes, describe the loading area security plan: \_\_\_\_\_
- c. Will you have security personnel on premise?  No  Yes If yes, how many? \_\_\_\_\_ and answer the following:  
 What are their responsibilities? \_\_\_\_\_  
 Is security equipment used?  No  Yes If yes, describe Camera's  
 List their licensing, certification, or training credentials \_\_\_\_\_
- d. Will there be security cameras?  No  Yes If yes, how many? 4 and list locations: entrance - 2  
Over register, beer cooler
- e. Will searches/identification checks be done upon entry?  No  Yes If yes, describe \_\_\_\_\_

## 6. Percentage of Sales (must total 100%)

Alcohol <u>7</u> %	Food <u>26</u> %	Secondhand Merchandise <u>0</u> %	Precious Metals & Gems <u>0</u> %
Entertainment <u>0</u> %	Cigarettes <u>23</u> %	Personal Services (such as tattoo, body piercing, salon, tailor, tanning, etc.) _____ %	Other <u>44</u> %
Pawnbroker Activity <u>0</u> %	Salvaged Materials (such as scrap metal) <u>0</u> %		Describe: <u>non-food merchandise</u>

## 7. Businesses/Licenses on the Premises (check all that apply):

### Type 1

- Full Service Restaurant     Cafe/Coffee Shop     Deli or Fast Food Restaurant     Private/Fraternal/Veterans Club
- Night Club     Tavern     Cocktail Lounge     Teen Club
- Banquet Hall     Sports Facility     Bowling Alley
- Hotel/Motel: Number of Floors: \_\_\_\_\_ Number of Rooms: \_\_\_\_\_  
 Rooming House: Number of Floors: \_\_\_\_\_ Number of Rooms: \_\_\_\_\_

### Type 2

- Liquor Store     Corner Store     Supermarket     Convenience Store
- Gas Station     Amusement/Phonograph Distributor     Recycling, Salvage or Towing
- Used Car Dealer     Personal Service Establishment (such as tattoo business, hair salon, tailor, etc.)     Recording Studio

What other licenses/permits will you hold at this location? (check all that apply)

- Occupancy Permit     Cigarette & Tobacco     Gas Station     Extended Hours     Class "B" Tavern     Weights & Measures
- Secondhand Dealer     Precious Metal & Gem     Other: \_\_\_\_\_

## 8. Legal Capacity (only if a Type 1 premises in #7 above)

Capacity: N/A (Call the Milwaukee Development Center at 414-286-8211 if you have questions.)



## 9. Premises Description

- a. Identify all area(s) of the premises that will be used in operating this business (include areas used only for storage):  
 1<sup>st</sup> Floor  2<sup>nd</sup> Floor  Basement Storage  Patio  Beer Garden  Sidewalk Café  Deck  Rooftop  
 Other: Describe: \_\_\_\_\_
- b. Describe Location:  Major Thoroughfare  Secondary Street  Other: \_\_\_\_\_
- c. Nearest Major Cross Street: Dakota Ave.
- d. Describe Building:  Free Standing Building  Strip Mall  Other: \_\_\_\_\_
- e. Describe Premises Structure:  Single Story  Multi-Story - # of Stories \_\_\_\_\_  Other: \_\_\_\_\_
- f. Describe Surrounding Area:  Commercial  Residential  Industrial  Other: \_\_\_\_\_
- g. Building Owner Name: E+K Land LLC Phone Number: (262) 857-1156  
 Building Owner Address: jborchard + @openpantry . com

## 10. Hours of Operation & Customers Class "A": 8:00 am to 9:00 pm Sunday thru Sunday

Will customers be entering the premises?  No  Yes

Day of the Week	Proposed Hours of Operation:		Estimated Number of Customers expected each day	Potential Age Range of Customers	Class B Tavern Applicant Only: Age Restriction (if none, write 'None')
	Open Time (include a.m. or p.m.)	Close Time (include a.m. or p.m.)			
Sunday	12:00 AM	11:59 pm	350	19-50	
Monday	24 hours		350		N/A
Tuesday	7 days a week		350		
Wednesday			350		
Thursday			450		
Friday			500		
Saturday			500		

An Extended Hours Establishment License is required for any convenience store, filling station, personal service establishment (such as tattoo, body piercing, salon, tailor, tanning, etc.), recording studio or restaurant which is open between the hours of 12:00 a.m. and 5:00 a.m.

Alcohol Establishments Permitted Hours of Operation: Class A: 8:00 am to 9:00 pm Sunday thru Saturday  
 Class B: 6:00 am to 2:00 am Sunday thru Thursday, 6:00 am to 2:30 am Friday & Saturday

Entertainment Outdoor Closing Hours: 10:00pm Sunday-Thursday; 12:00am Friday & Saturday; unless a different time, either earlier or later, is established by the Common Council in its approval of the licensee's plan of operation.

## 11. Signature(s)

Jennifer Mendola Asst. Sec.  
 Signature of Sole Proprietor, Partner, or 20% or more Shareholder  
 Signature of additional partner or 20% or more shareholder  
 (If there are no 20% or more shareholders, Corporate Officer-print name/title and sign)

See Application Information for a complete list of all required application forms.



Legal Entity Name: 7-Eleven, Inc. d/b/a 7-Eleven #35852J

Premise Address: 1609 E. North Ave., Milwaukee WI 53202

**Proximity of Premises to Church, School, Daycare Center or Hospital**

Is the building within 300 feet of any church, school, daycare center or hospital?  No  Yes

**"Service Bar Only" Designation**

If applying for Class B or C license, are you applying for "Service Bar Only"?  No  Yes

Service Bar Only means customers cannot sit at the bar. Alcohol is served to employees who serve patrons seated at tables. No stools, chairs or other articles of furniture shall be placed at the service bar for patrons to sit upon.

**Business Information**

a) Are you taking out this application for anyone that may not be eligible for a license?  No  Yes  
If yes, list their name and address: \_\_\_\_\_

b) Will the agent, a partner or the individual licensee be conducting the day-to-day operations of the business?  No  Yes  
If no, list the name and address of the person(s) who will: \_\_\_\_\_

Class B Applicants: If the agent, a partner or the individual licensee will not be conducting the day-to-day operations of the business, the person(s) listed above must obtain a Class B Managers License.

c) Does anyone else have money invested or any other interest in this business?  No  Yes  
If yes, explain: \_\_\_\_\_

d) Have you made an agreement with anyone to repay any loan or any other payments based upon income from the business?  No  Yes  
If yes, list name and address: \_\_\_\_\_

**Property Information (New & Transfer Applicants Only)**

a) Do you own or lease the building?  Own  Lease

b) Who owns the fixtures (for example, coolers, etc.)? 7-Eleven, Inc.

c) Are you purchasing the stock and/or fixtures?  No  Yes if yes, amount paid \$ \_\_\_\_\_

d) Total amount paid for business \$ 0

e) Total amount paid for goodwill of the business \$ 0

Goodwill comprises the reputation and customer relationships of an existing business. If the price you pay for the business exceeds the fair market value of all of the rest of the assets of the business, the excess may be considered goodwill.

f) Have you made arrangements with the seller for payment of personal property taxes?  No  Yes

**Lease Information (New & Transfer Applicants who are leasing the premises only)**

a) Date lease begins 6-1-2012 Ends 6-18-2027

b) Monthly rental \$ \_\_\_\_\_

c) Do you have an option to renew the lease?  No  Yes

d) Does your lease allow for assignment to another party without the consent of the owner?  No  Yes

e) For what length of time have you been guaranteed occupancy (number of years)? \_\_\_\_\_



**ALCOHOL BEVERAGE & PUBLIC ENTERTAINMENT PREMISES  
SUPPLEMENTAL APPLICATION**

Office of the City Clerk License Division  
200 E. Wells St. Room 105, Milwaukee, WI 53202  
(414) 286-2238 e-mail address: license@milwaukee.gov www.milwaukee.gov/license

Legal Entity Name: 7-Eleven, Inc. d/b/a 7-Eleven #35852J

Premise Address: 1609 E. North Ave., Milwaukee WI 53202

**Proximity of Premises to Church, School, Daycare Center or Hospital**

Is the building within 300 feet of any church, school, daycare center or hospital?  No  Yes

**"Service Bar Only" Designation**

If applying for Class B or C license, are you applying for "Service Bar Only"?  No  Yes

Service Bar Only means customers cannot sit at the bar. Alcohol is served to employees who serve patrons seated at tables. No stools, chairs or other articles of furniture shall be placed at the service bar for patrons to sit upon.

**Business Information**

a) Are you taking out this application for anyone that may not be eligible for a license?  No  Yes

If yes, list their name and address: \_\_\_\_\_

b) Will the agent, a partner or the individual licensee be conducting the day-to-day operations of the business?  No  Yes

If no, list the name and address of the person(s) who will: \_\_\_\_\_

Class B Applicants: If the agent, a partner or the individual licensee will not be conducting the day-to-day operations of the business, the person(s) listed above must obtain a Class B Managers license.

c) Does anyone else have money invested or any other interest in this business?  No  Yes

If yes, explain: \_\_\_\_\_

d) Have you made an agreement with anyone to repay any loan or any other payments based upon income from the business?

No  Yes If yes, list name and address: \_\_\_\_\_

**Property Information (New & Transfer Applicants Only)**

a) Do you own or lease the building?  Own  Lease

b) Who owns the fixtures (for example, coolers, etc)? 7-Eleven, Inc.

c) Are you purchasing the stock and/or fixtures?  No  Yes If yes, amount paid \$ \_\_\_\_\_

d) Total amount paid for business \$ 0

e) Total amount paid for goodwill of the business \$ 0

Goodwill comprises the reputation and customer relationships of an existing business. If the price you pay for the business exceeds the fair market value of all of the rest of the assets of the business, the excess may be considered goodwill.

f) Have you made arrangements with the seller for payment of personal property taxes?  No  Yes

**Lease Information (New & Transfer Applicants who are leasing the premises only)**

a) Date lease begins 6-1-2012 Ends 6-18-2027

b) Monthly rental \$ 9816.00

c) Do you have an option to renew the lease?  No  Yes

d) Does your lease allow for assignment to another party without the consent of the owner?  No  Yes

e) For what length of time have you been guaranteed occupancy (number of years)? 6-18-27 (add'l five year option)

**Lease Information (Continued)**

- f) In addition to paying the monthly rental, will you have to pay anything additional to the owner of the building to guarantee performance of the lease?  No  Yes If yes, explain \_\_\_\_\_
- g) Does the present owner or occupant object to the granting of your license?  No  Yes  
If yes, explain \_\_\_\_\_

**Change of Agent Applicants Only**

Have there been any changes to the floor plan since the last application was submitted?  No  Yes  
If no, a new floor plan is not required. If yes, submit a new floor plan and explain the change(s):  
\_\_\_\_\_

**Signature**

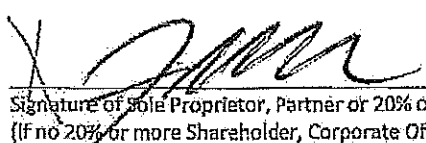
 Jennifer Mendora  
Asst. Secretary

Signature of Sole Proprietor, Partner or 20% or More Shareholder  
(If no 20% or more Shareholder, Corporate Officer - print name/title and sign)

Note: All information contained in this application is subject to approval by the Common Council.  
Deviating from approved plan of operation will subject licensee to citations, and/or suspension or non-renewal of the license.  
Contact the License Division for information on how to request changes.

**New and transfer of premises applicants must submit the following:**

- Detailed floor plan
- If a restaurant, copy of the menu





# FOOD DEALER LICENSE PLAN OF OPERATION

OFFICE OF THE CITY CLERK, LICENSE DIVISION  
 CITY HALL, 200 E. WELLS ST, ROOM 105, MILWAUKEE, WI 53202  
 (414) 286-2238 • [license@milwaukee.gov](mailto:license@milwaukee.gov) • [www.milwaukee.gov/license](http://www.milwaukee.gov/license)

Legal Entity Name: 7-Eleven, Inc. d/b/a 7-Eleven #35852J  
 Premises Address: 1609 E. North Ave. Milwaukee, WI 53202

**SECTION 1 TYPE OF BUSINESS**

What will be the majority of your food sales? (check one)

Restaurant Items (meals):  
 MEALS include, but are not limited to, chicken, ribs, sandwiches, roasted corn, baked potatoes, hot dogs, brats, tacos, nachos w/ cheese and meat, French fries, cooked or deep fried vegetables/fruit, cooked cheese curds, corn dogs, egg rolls, salads.

Retail Items (snacks and beverages):  
 RETAIL items include, but are not limited to, ice cream/soft serve, lemonade, snow cones, coffee, espresso, cappuccino, tea, fruit juice, smoothies, candy, dispensed soda, fruit cups, bakery, cookies, kettle corn, cotton candy, funnel cakes, fritters, tortilla chips w/ cheese.

Will it be a convenience store?  Yes  No  
 A convenience store contains less than 5,000 square feet of retail space and has, as its primary business, the sale of basic food items and in addition, sells household products or is a filling station that sells basic food items and household products.

Bed & Breakfast  
 Micro Market

All Applicants: Submit a menu or a list of food items that will be sold.

Will any wholesale business be done?  No  Yes if yes, what percentage of food sales will be wholesale?

Less than 25%

25% or More AND:  
 Restaurant items (meals) will be sold - Complete this application and also contact DATCP.  
 NO restaurant items (meals) will be sold - Do NOT complete this application. Contact DATCP only.

**SECTION 2 FOOD PROCESSING**

Will any food processing be done?  No  Yes

Processing is defined as assembling, grinding, cutting, mixing, baking, coating, stuffing, packing, bottling, grilling, canning, extracting, fermenting, distilling, pickling, freezing, drying, smoking, or packaging.

**SECTION 3 FOOD REQUIRING TEMPERATURE CONTROL**

Will any food that requires temperature control be sold?  No  Yes  
 (includes dairy products such as milk, cheese, and ice cream, fish, shellfish, meat, poultry)

If yes, list the types of food items: hot dogs/pizza/dairy/breakfast sandwiches

**SECTION 4 DETAILS OF OPERATION**

- Will you have seating on site for dining?  No  Yes
- Will you be doing any catering?  No  Yes
- Will you be doing any delivery?  No  Yes
- Will you have outdoor activities?  No  Yes - Check all that apply:  Bar  Cooking/Grilling  Dining
- Will you have a drive thru window?  No  Yes - Are hours different from inside?  No  Yes  
 If Yes, provide drive thru hours: \_\_\_\_\_
- Will scales or barcode scanners be used?  No  Yes - You must also apply for a Weights & Measures License.

**SECTION 5 ADDITIONAL SITES**

Where will food be prepared and/or sold?  
 At a single site  At multiple sites: How many? \_\_\_\_\_ (for example, a hotel with several dining rooms or bars)  
 If multiple sites, attach a Food Dealer Additional Site Addendum (ccl-foodadd) for each additional site.

**SECTION 6 CONSTRUCTION OR CHANGES**

Are you planning any construction, remodeling or equipment changes?  
 No If No, SKIP to Section 7  
 Yes If Yes, check all that apply:  New construction of a building  Renovation or remodeling  
 Construction changes to existing building  Equipment changes only

Provide a brief description of the changes: \_\_\_\_\_  
 Start date: \_\_\_\_\_  
 Name, Address & Phone Number of Architect: \_\_\_\_\_  
 \_\_\_\_\_  
 Name, Address & Phone Number of Contractor: \_\_\_\_\_  
 \_\_\_\_\_

**SECTION 7 ALCOHOL BEVERAGES**

Are you applying for an alcohol beverage license?  
 No If No, SKIP to Section 8  
 Yes If YES, if your food license is approved prior to the alcohol license, when do you want the food license issued?  
 Immediately  At the same time as the alcohol license

**SECTION 8 ACKNOWLEDGEMENTS & SIGNATURE**

You must Initial each item confirming your understanding:

JM I understand the Health Department must conduct an inspection and advise the License Division of their approval before the license may be issued.

JM I understand I must obtain an occupancy permit from the Department of Neighborhood Services and an inspection may be required. Neighborhood Services must advise the License Division of their approval before the license may be issued.

JM I understand the district alderperson will review and either support or object to my application. If he/she objects, I may appeal and be scheduled to appear before the Licenses Committee. The Licenses Committee will then make a recommendation to the Common Council. The Common Council must grant the license before it may be issued.

JM I understand proof of payment for all license fees must be on file in the License Division before the license may be issued and the license must be issued and posted in my establishment prior to opening for business.

JM I will not operate my food business until the license has been issued and posted in the establishment.

Signature of Sole Proprietor, Partner, or 20% Shareholder: [Signature] Asst. Sec.

Signature of Additional Partner: \_\_\_\_\_



# WEIGHTS & MEASURES LICENSE SUPPLEMENTAL APPLICATION

OFFICE OF THE CITY CLERK, LICENSE DIVISION  
CITY HALL, 200 E. WELLS ST, ROOM 105, MILWAUKEE, WI 53202  
(414) 286-2238 • [license@milwaukee.gov](mailto:license@milwaukee.gov) • [www.milwaukee.gov/licenses](http://www.milwaukee.gov/licenses)

Office Use Only:  
App# W&M 3089141  
Filed 5/14/2024  
Initials \_\_\_\_\_  
Paid \_\_\_\_\_  
Lic# \_\_\_\_\_

Legal Entity Name: 7-Eleven, Inc. d/b/a 7-Eleven # 36852J

Premise Address: 1609 E. North Ave. Milwaukee WI 53202

### Device Type(s)

- Check all device types for which you need a license.
  - For each device type checked, indicate how many you have in the Number of Devices column (b).
  - Calculate the Total Fee Per Device Type by multiplying the Fee Per Device Type (a) by the Number of Devices (b).
  - Add all Total Fee Per Device Type amounts together and that will be your Total Fee Due.
- \* Exception: The Scanner fee is not per device. Check the box for the appropriate range.  
If you have 1-3 scanners, the total due is \$130. If you have 4 or more scanners, the total due is \$250.  
Check the Number of Devices (b).

Device Type	License Period	Fee Per Device Type (a)	Number of Devices (b)	Total Fee Per Device Type (a x b)
<b>Liquid Measuring Devices</b>				
<input type="checkbox"/> Retail Petroleum Meters	12 months	\$60		
<input type="checkbox"/> 0 to 30 gallons per minute	24 months	\$60		
<input type="checkbox"/> 31 to 200 gallons per minute	24 months	\$250		
<input type="checkbox"/> Over 200 gallons per minute	24 months	\$250		
<b>Scales</b>				
<input type="checkbox"/> Measuring any weight amount	24 months	\$55		
<b>Scanners</b>				
		Fee for scanners by range:	Check how many scanners you have	
<input checked="" type="checkbox"/> Up to 3 scanners	24 months	\$130 total*	<input type="checkbox"/> 1 <input checked="" type="checkbox"/> 2 <input type="checkbox"/> 3	
<input type="checkbox"/> Four or more scanners	24 months	\$250 total*	<input type="checkbox"/> 4 <input type="checkbox"/> Other _____	
<b>Other Devices</b>				
<input type="checkbox"/> Length Measuring Device	24 months	\$60		
<input type="checkbox"/> Timing Device	24 months	\$30		
<b>Total Fee Due</b>				<b>130.00</b>

### Signature

I hereby agree that I will comply with the applicable sections of the Wisconsin State Statutes, Administrative Code and the Milwaukee Code of Ordinances regarding the operation of weighing and measuring devices.

I understand that all devices must be operated within the specifications, tolerances and other technical requirements set forth in the National Institute of Standards and Technology Handbook 44. I understand that the license for which I am applying must be posted on the premises or in my vehicle prior to opening for business or operating the device.

I understand that these device licenses are not transferable (with the exception of scanners). If the device is replaced or needs to be resealed, I must apply for and receive a new license so that an inspection of the device can be performed prior to its use. I acknowledge that as a condition of being issued this license, I must allow the Health Department into the establishment to test the device to validate its specifications/tolerances. If my devices are found out of compliance, I may be charged inspection fees. I have read, understand, and will adhere to all the above acknowledgments.

Jennifer Mendola  
Asst. Secretary

Signature of Sole Proprietor, Partner, or 20% or more Shareholder  
(If there are no 20% or more shareholders, Corporate Officer-print name/title and sign)

Signature of additional partner or 20% or more shareholder

This form must be submitted with the Business License Application, Weights & Measures Plan of Operation, and appropriate fee. Forms can be obtained online at [www.milwaukee.gov/licenses](http://www.milwaukee.gov/licenses).



# WEIGHTS & MEASURES PLAN OF OPERATION

ccl-wmplan 1/9/18

Office of the City Clerk License Division  
200 E. Wells St. Room 105, Milwaukee, WI 53202  
(414) 286-2238 [www.milwaukee.gov/licenses](http://www.milwaukee.gov/licenses) [license@milwaukee.gov](mailto:license@milwaukee.gov)

Legal Entity Name: 7-Eleven, Inc. d/b/a 7-Eleven #35652J

Premise Address: 1109 E. North Ave, Milwaukee WI 53202

## Type of Business

Provide a brief description of the establishment/business:

existing convenience store with change in operator

Other licenses may be required depending on the type of business you are operating.

## Litter & Noise

- a. How are grounds kept clean?  Sweep  Pressure Wash  Pick Up Litter  Other: \_\_\_\_\_
- b. How often will grounds be cleaned?  Daily  Weekly  As Needed  Monthly  Other: \_\_\_\_\_
- c. Grounds cleaned by:  Licensee  Building Owner  Employees  Hired Maintenance  Other: \_\_\_\_\_
- d. How are noise issues prevented and/or addressed?  Security  Manager approaches customer(s)  Call Police  
 Signs Posted  Other: \_\_\_\_\_

## Signature

*Jennifer Mendel*  
*Asst. Secretary*

Signature of Sole Proprietor, Partner, or 20% or more Shareholder  
(If there are no 20% or more shareholders,  
Corporate Officer-print name/title and sign)

Signature of additional partner or 20% or more shareholder

This form must be submitted with the Business License Application, Weights & Measures License Supplemental Application, and appropriate fee. Forms can be obtained online at [www.milwaukee.gov/licenses](http://www.milwaukee.gov/licenses).

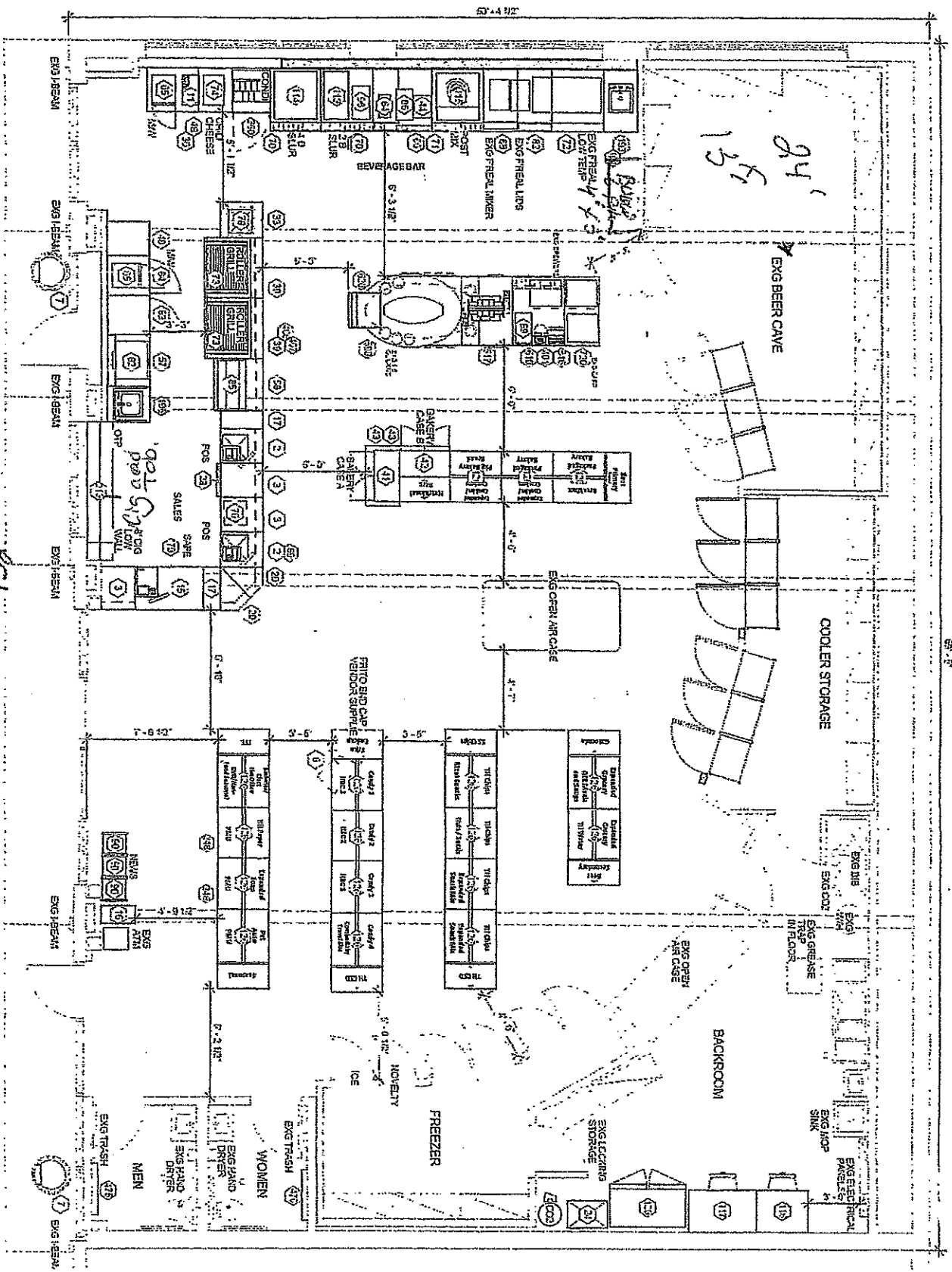

North Ave

Legal  
 7 - Eleven, Inc  
 Trade:  
 #35852  
 E. North Ave.  
 Milwaukee, WI  
 Agents: Daniel Stechlik  
 107 Grandview  
 35852 MILWAUKEE, WI - EQUIPMENT LAYOUT 3  
 6-13-2012  
 1851  
 15 ft  
 24'

1605 E NORTH AVE  
 SITE #1031743  
 HFA #12-00201  
 LAYOUT APPROVED 6-13-12





35852

NORTH NEWHALL STREET

E. NORTH AVENUE

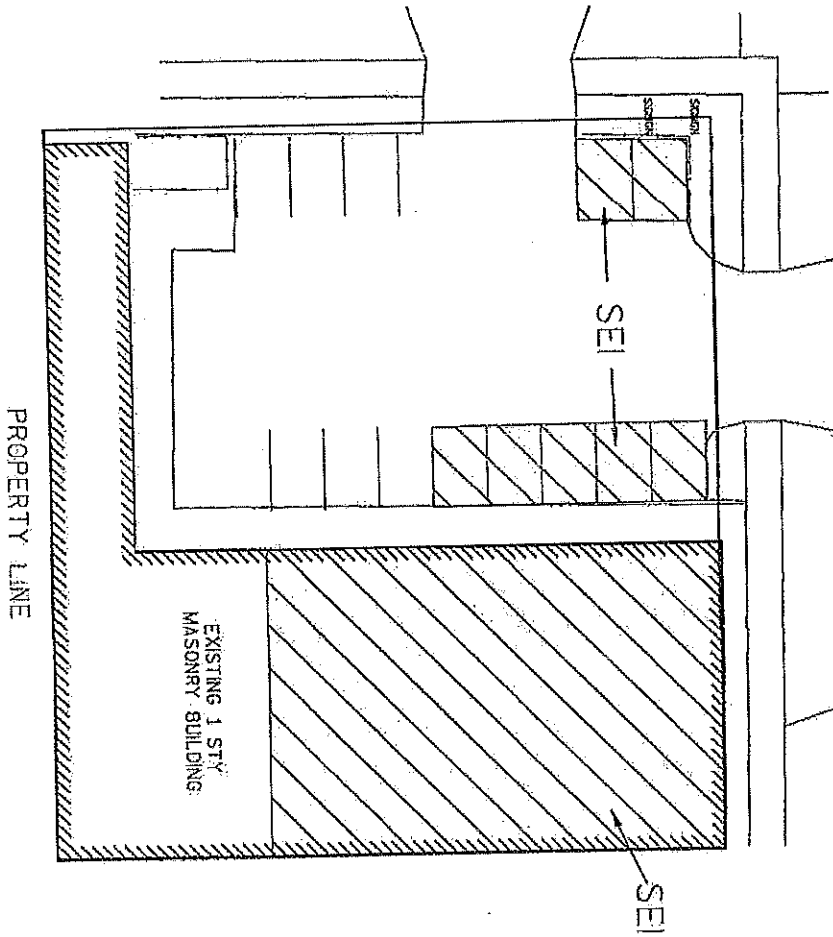

STORE 436	CLIENT OPEN PANTRY FOOD MARTS OF WISCONSIN 10505 CORPORATE DRIVE, SUITE 101 PLEASANT PRAIRIE, WI 53159-1605	TITLE EXHIBIT 1609 E. NORTH AVE MILWAUKEE, WISCONSIN	ENGINEER <b>K. Singh &amp; Associates, Inc.</b> <small>REGISTERED ARCHITECTS &amp; PROFESSIONAL ENGINEERS CONSULTANTS 3125 Irving Street Milwaukee, WI 53212 PHONE: (414) 224-1117 FAX: (414) 224-1118</small>	DRAWN BY:	G.S.J.
				CHECKED BY:	P.A.K.
				DATE:	08/08/12
				PROJECT NO.:	2844
				DRAWING FILE:	EX101020