



Certificate of Appropriateness

Milwaukee Historic Preservation Commission/200 E. Wells Street/Milwaukee, WI 53202/phone 414-286-5712/fax 414-286-3004

Property	3133 E. NEWBERRY BL.	Lake Park in North Point North
Description of work	Construct replacement bridge over small ravine at the north end of Lake Park. The bridge will be constructed primarily of pressure-treated lumber because of park use. Size is roughly 10' x 60'. Build per attached plans Wood will be stained with Milwaukee County Parks standard brown stain for consistent appearance. Acetylated wood may be used as an alternative. <u>There are 9 pages of attached construction drawings.</u>	
Date issued	7/23/2020	PTS ID 114965 COA: new rustic bridge

In accordance with the provisions of Section 320-21 (11) and (12) of the Milwaukee Code of Ordinances, the Milwaukee Historic Preservation Commission has issued a certificate of appropriateness for the work listed above. The work was found to be consistent with preservation guidelines. The following conditions apply to this certificate of appropriateness:

Incision marks on the wood should not be visible, if at all possible.

All work must be done in a craftsman-like manner, and must be completed within one year of the date this certificate was issued. Staff must approve any changes or additions to this certificate before work begins. Work that is not completed in accordance with this certificate may be subject to correction orders or citations. If you require technical assistance, please contact Historic Preservation staff as follows: Phone: (414) 286-5712 E-mail: hpc@milwaukee.gov.

If permits are required, you are responsible for obtaining them from the Milwaukee Development Center. If you have questions about permit requirements, please consult the Development Center's web site, www.milwaukee.gov/build, or call (414) 286-8210.

City of Milwaukee Historic Preservation Staff

Copies to: Development Center, Ald. Nik Kovac, Contractor, Inspector Paul Wolfgramm (286-2590)



MX-016 Oxford Brown

County Parks' standard stain.

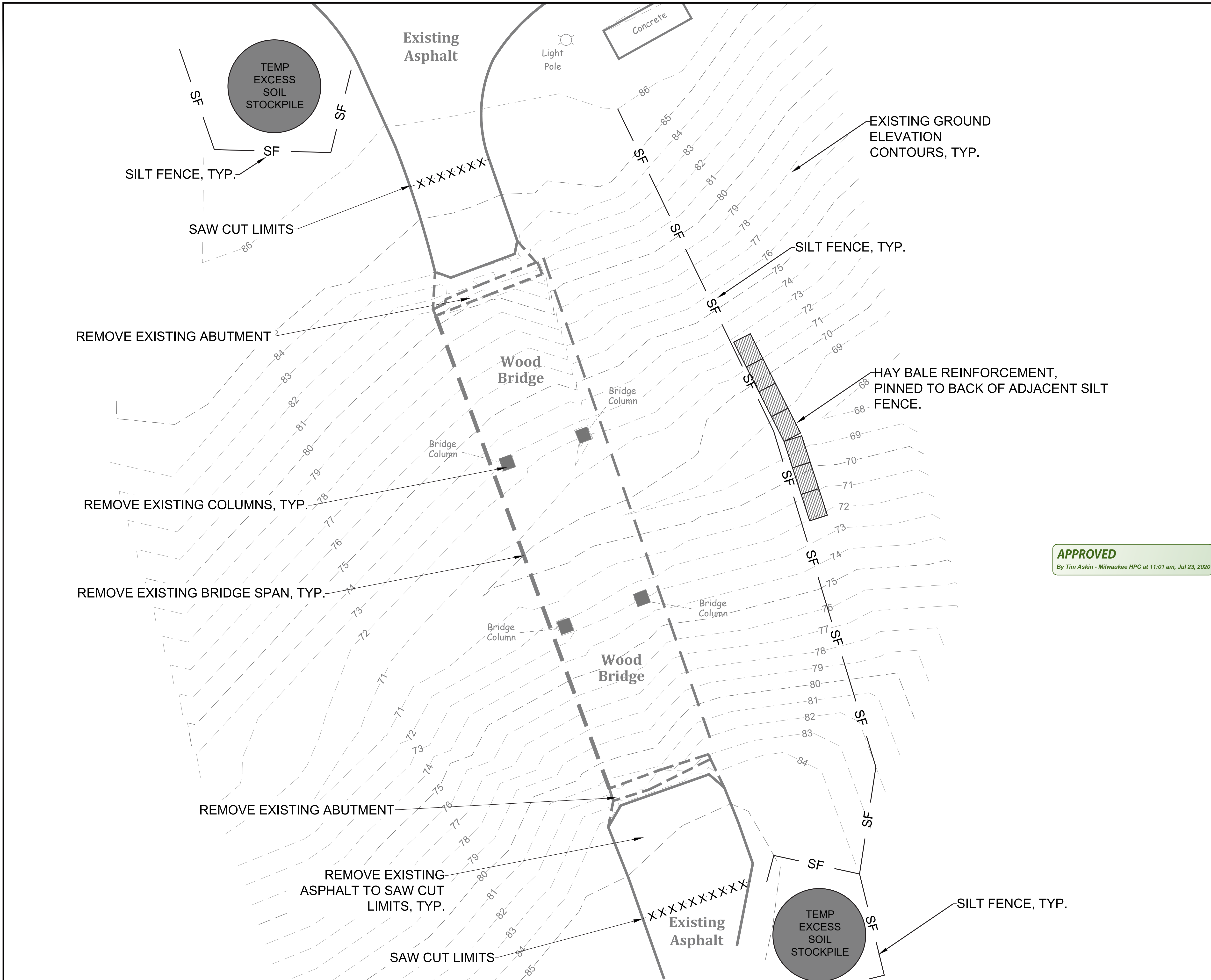

MAINTENANCE PLAN

1. ALL EROSION AND SEDIMENT CONTROL PRACTICES WILL BE INSPECTED FOR FUNCTIONAL EFFECTIVENESS FOLLOWING EVERY 1/2-INCH RAIN EVENT AND IN NO CASE LESS THAN ONCE PER WEEK. ANY NEEDED REPAIRS WILL BE MADE IMMEDIATELY TO ENSURE THE DEVICE FUNCTIONS AS DESIGNED.
2. ALL SEEDED AREAS WILL BE WATERED, FERTILIZED, MULCHED AND RESEEDED AS NECESSARY TO MAINTAIN A VIGOROUS, DENSE VEGETATIVE COVER.
3. ANY SEDIMENT REACHING A PUBLIC OR PRIVATE STREET SHALL BE REMOVED BY STREET CLEANING BEFORE THE END OF EACH DAY OR AS NECESSARY TO PREVENT DEBRIS FROM ENTERING A STORM SEWER, DITCH, OR WATERWAY.
4. IN THE EVENT CONSTRUCTION ACTIVITIES RESULT IN SEVERE DUST CONDITIONS, SEE WDNR TECHNICAL STANDARD 1068.
5. IN THE EVENT OF DEWATERING ACTIVITIES, FOLLOW WDNR TECHNICAL STANDARD 1061. ALL WATER DISCHARGED FROM THE DEWATERING EQUIPMENT MUST BE FILTERED BY A TYPE II GEOTEXTILE BAG SIZED FOR THE PUMP DISCHARGE FLOW RATE.
6. ANIONIC POLYACRYLAMIDE SHALL BE APPLIED TO ALL DISTURBED AREAS WHERE STABILIZATION OR EROSION IS PROBLEMATIC DURING INCLIMATIC WEATHER WHEN SEEDING IS NOT LIKELY TO GERMINATE. APPLICATION OF POLYACRYLAMIDE SHALL BE PERFORMED IN ACCORDANCE WITH WDNR CONSERVATION PRACTICE STANDARD 1050 (EROSION CONTROL, LAND APPLICATION OF ANIONIC POLYACRYLAMIDE.)

NOTES:

1. ALL PROPOSED ELEVATIONS ARE SHOWN AS FINISHED SURFACE GRADES, LOCATED AT GEOMETRY POINTS AND SPOT ELEVATIONS.
2. THE EROSION CONTROL PLAN MUST COMPLY WITH CITY OF MILWAUKEE AND DNR TECHNICAL STANDARDS.
3. STREETS SHALL BE KEPT CLEAN WITH STREET SWEEPING DURING CONSTRUCTION.
4. ALL EXPOSED SOIL AREAS NOT DISTURBED FOR UP TO SEVEN DAYS MUST BE IMMEDIATELY RESTORED WITH SEED AND MULCH.
5. EXCESS TOPSOIL SHALL BE HAULED OFFSITE. NO SALES OF TOPSOIL FROM SITE IS PERMITTED BY THE CITY OF MILWAUKEE.

CONSTRUCTION SCHEDULE

1. OBTAIN PLAN APPROVAL AND APPLICABLE PERMITS.
2. INSTALL PERIMETER EROSION CONTROL.
3. COMPLETE DEMOLITION ACTIVITIES.
4. STRIP AND REMOVE TOPSOIL WITHIN DISTURBANCE LIMITS FROM PROJECT SITE.
5. TEMPORARY STOCKPILES SHALL BE PROTECTED WITH STRAW BALES, SILT FENCE, OR OTHER PERIMETER CONTROL MEASURES.
6. ROUGH GRADE FOR PROPOSED IMPROVEMENTS.
7. INSTALL CONCRETE ABUTMENTS AND CONCRETE PIERS & FOUNDATION.
8. CONSTRUCT BRIDGE AND DECKING.
9. INSTALL PAVEMENT.
10. FINAL GRADE, INSTALL PERMANENT EROSION MATTING, TOPSOIL, INSTALL PLANT MATERIAL, SEED AND STABILIZE ALL DISTURBED AREAS.
11. REMOVE ALL TEMPORARY EROSION CONTROL MEASURES AFTER 70% GROWTH OF HEALTHY VEGETATION.
12. ESTIMATED TIME TO FINAL STABILIZATION - 3 MONTHS FROM THE START OF CONSTRUCTION ACTIVITIES.

APPROVED
By Tim Askin - Milwaukee HPC at 11:01 am, Jul 23, 2020

LEGEND

- - SET IRON STAKE
- - - FOUND IRON PIPE
- PL - PROPERTY LINE
- x 100.00 - EXISTING SPOT ELEVATION
- ⊙ - SEWER MANHOLE
- ⊙ - COMMUNICATION MANHOLE
- ⊙ - ELECTRIC MANHOLE
- - CATCH BASIN
- ⊙ - TRAFFIC MANHOLE
- EM - ELECTRIC METER
- GM - GAS METER
- WV - WATER VALVE
- GV - GAS VALVE
- HY - HYDRANT
- ⊙ - UTILITY BOX
- UL - UTILITY POLE
- FL - FLOOD LIGHT
- LP - LIGHT POLE
- W - WELL
- B-40 - BORING
- - CLEAN OUT
- ⊠ - TRANSFORMER
- ⊠ - AIR CONDITIONER
- - BOLLARD
- - UNDERGROUND WATER
- E --- E --- E --- - UNDERGROUND ELECTRIC
- T --- T --- T --- - UNDERGROUND TELECOMMUNICATIONS
- O --- O --- O --- - OVERHEAD ELECTRIC
- G --- G --- G --- - UNDERGROUND GAS
- SAN --- SAN --- SAN --- - SANITARY SEWER
- ST --- ST --- ST --- - STORM SEWER
- CL --- CL --- CL --- - CHAIN LINK FENCE
- SF --- SF --- SF --- - SILT FENCE
- H --- H --- H --- - HAND RAIL
- WET --- WET --- WET --- - WETLAND
- FP --- FP --- FP --- - FLOOD PLAIN
- PP --- PP --- PP --- - PERMANENT POOL
- PEC --- PEC --- PEC --- - PRIMARY ENVIRONMENTAL CORRIDOR
- SC --- SC --- SC --- - SAW CUT
- T --- T --- T --- - TREE LINE



REVISION NO.	DESCRIPTION	DATE	BY	DESIGNED BY	ISSUANCE TYPE
				RJN	PERMIT
				RJN	
				DAT	
				DAT	
				05.15.2020	

PROPOSED DEMOLITION & EROSION CONTROL PLAN
OGDEN CONSTRUCTION GROUP, LLC
LAKE PARK PEDESTRIAN BRIDGE
MILWAUKEE, WISCONSIN

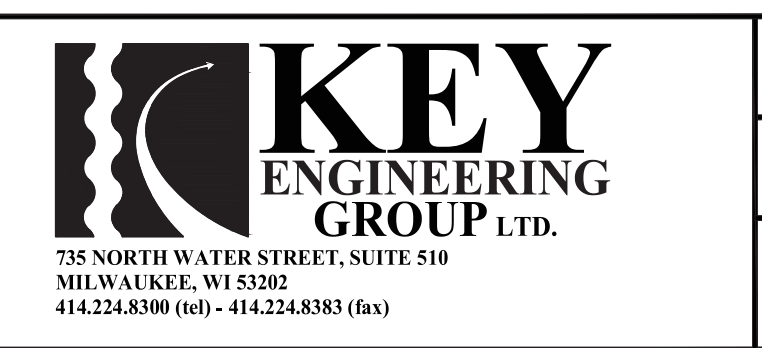
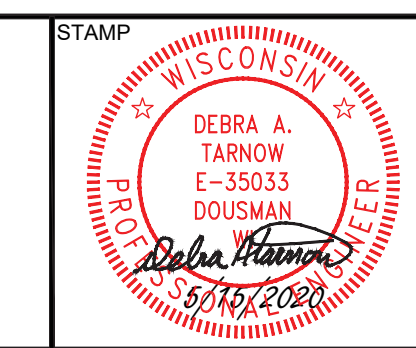

KEY PROJECT NUMBER	2002-0285-0001
PROJECT SCALE	1" = 5'
SHEET NUMBER	C-1

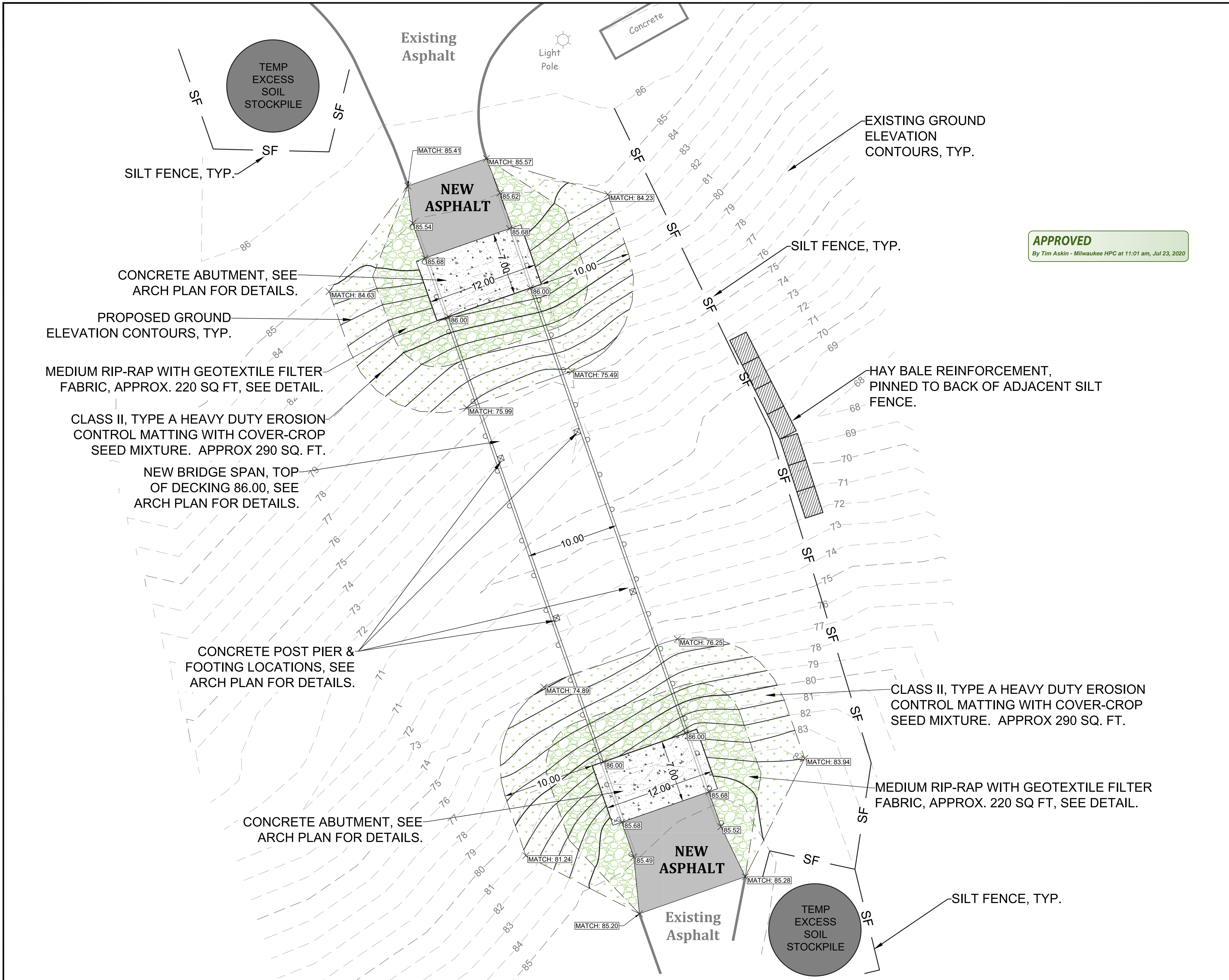

- MAINTENANCE PLAN**
- ALL EROSION AND SEDIMENT CONTROL PRACTICES WILL BE INSPECTED FOR FUNCTIONAL EFFECTIVENESS FOLLOWING EVERY 1/2-INCH RAIN EVENT AND IN NO CASE LESS THAN ONCE PER WEEK. ANY NEEDED REPAIRS WILL BE MADE IMMEDIATELY TO ENSURE THE DEVICE FUNCTIONS AS DESIGNED.
 - ALL SEEDED AREAS WILL BE WATERED, FERTILIZED, MULCHED AND RESEEDED AS NECESSARY TO MAINTAIN A VIGOROUS, DENSE VEGETATIVE COVER.
 - ANY SEDIMENT REACHING A PUBLIC OR PRIVATE STREET SHALL BE REMOVED BY STREET CLEANING BEFORE THE END OF EACH DAY OR AS NECESSARY TO PREVENT DEBRIS FROM ENTERING A STORM SEWER, DITCH, OR WATERWAY.
 - IN THE EVENT CONSTRUCTION ACTIVITIES RESULT IN SEVERE DUST CONDITIONS, SEE WDNR TECHNICAL STANDARD 1068.
 - IN THE EVENT OF DEWATERING ACTIVITIES, FOLLOW WDNR TECHNICAL STANDARD 1061. ALL WATER DISCHARGED FROM THE DEWATERING EQUIPMENT MUST BE FILTERED BY A TYPE II GEOTEXTILE BAG SIZED FOR THE PUMP DISCHARGE FLOW RATE.
 - ANIONIC POLYACRYLAMIDE SHALL BE APPLIED TO ALL DISTURBED AREAS WHERE STABILIZATION OR EROSION IS PROBLEMATIC DURING INCLIMATIC WEATHER WHEN SEEDING IS NOT LIKELY TO GERMINATE. APPLICATION OF POLYACRYLAMIDE SHALL BE PERFORMED IN ACCORDANCE WITH WDNR CONSERVATION PRACTICE STANDARD 1050 (EROSION CONTROL, LAND APPLICATION OF ANIONIC POLYACRYLAMIDE.)

- NOTES:**
- ALL PROPOSED ELEVATIONS ARE SHOWN AS FINISHED SURFACE GRADES, LOCATED AT GEOMETRY POINTS AND SPOT ELEVATIONS.
 - THE EROSION CONTROL PLAN MUST COMPLY WITH CITY OF MILWAUKEE AND DNR TECHNICAL STANDARDS.
 - STREETS SHALL BE KEPT CLEAN WITH STREET SWEEPING DURING CONSTRUCTION.
 - ALL EXPOSED SOIL AREAS NOT DISTURBED FOR UP TO SEVEN DAYS MUST BE IMMEDIATELY RESTORED WITH SEED AND MULCH.
 - EXCESS TOPSOIL SHALL BE HAULED OFFSITE. NO SALES OF TOPSOIL FROM SITE IS PERMITTED BY THE CITY OF MILWAUKEE.

- SEEDING NOTES:**
- AGRECOL CUSTOM SEED MIX ORDER NUMBER 0050726, OR EQUAL, IN ALL DISTURBED AREAS NOT COVERED BY FILTER FABRIC AND RIP-RAP, PER STANDARD SPECIFICATIONS.
 - MINIMIZE DISTURBED AREAS TO THOSE NEEDED FOR CONSTRUCTION ONLY.
- CUSTOM SEED MIX**
 HYSTRIX PATULA
 CAREX BREVIOR
 ELYMUS VIRGINICUS
 GLYCERIA STRIATA
 CAREX SPRENGELII
 AQUILEGIA CANADENSIS
 CAMPANULA AMERICANA
 EUPATORIUM PURPUREUM
 SOLIDAGO FLEXICAULIS

LEGEND

● - SET IRON STAKE	B-40 - BORING
- - - FOUND IRON PIPE	○ - CLEAN OUT
PL - PROPERTY LINE	⊠ - TRANSFORMER
x 100.00 - EXISTING SPOT ELEVATION	⊞ - AIR CONDITIONER
○ - SEWER MANHOLE	● - BOLLARD
⊙ - COMMUNICATION MANHOLE	— - - UNDERGROUND WATER
⊕ - ELECTRIC MANHOLE	- - - UNDERGROUND ELECTRIC
■ - CATCH BASIN	- - - UNDERGROUND TELECOMMUNICATIONS
⊕ - TRAFFIC MANHOLE	- - - OVERHEAD ELECTRIC
EM - ELECTRIC METER	- - - UNDERGROUND GAS
GM - GAS METER	- - - SANITARY SEWER
⊕ - WATER VALVE	- - - STORM SEWER
⊕ - GAS VALVE	— - - CHAIN LINK FENCE
⊕ - HYDRANT	- - - SILT FENCE
⊕ - TRAFFIC SIGNAL	- - - HAND RAIL
⊕ - UTILITY BOX	- - - WETLAND
⊕ - UTILITY POLE	- - - FLOOD PLAIN
⊕ - FLOOD LIGHT	- - - PERMANENT POOL
☆ - LIGHT POLE	- - - PRIMARY ENVIRONMENTAL CORRIDOR
○ - WELL	⋯ - SAW CUT
	~ ~ ~ - TREE LINE

REVISION NO.	DESCRIPTION	DATE	BY	DESIGNED BY	ISSUANCE TYPE
				RJN	PERMIT
				RJN	
				DAT	
				DAT	
		05.15.2020			

PROPOSED GRADING PLAN
OGDEN CONSTRUCTION GROUP, LLC
LAKE PARK PEDESTRIAN BRIDGE
MILWAUKEE, WISCONSIN

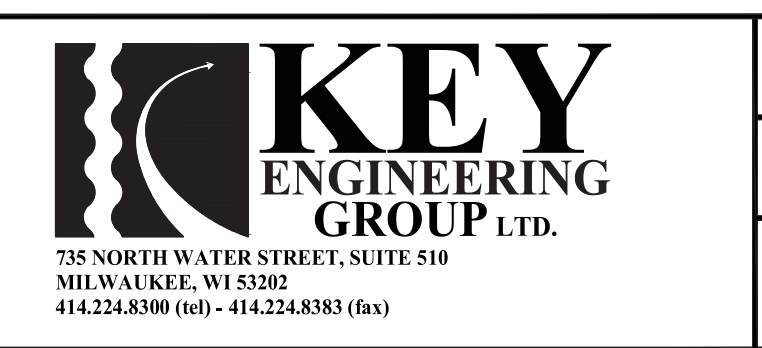
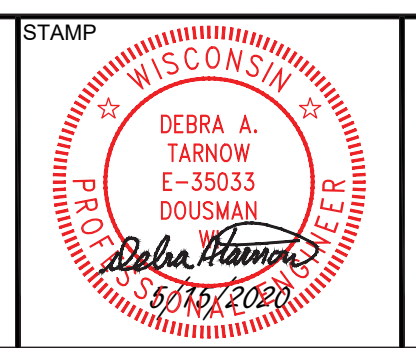

KEY PROJECT NUMBER 2002-0285-0001
PROJECT SCALE 1" = 5'
SHEET NUMBER C-2

C:\Users\rlarson\AppData\Local\Temp\ACF\acfb3b1b-2474-42c1-8a9c-9a9c9a9c9a9c\20200723_110101am_07232020.dwg

SILT FENCE GENERAL NOTES:

DETAIL OF CONSTRUCTION NOT SHOWN ON THIS DRAWING SHALL CONFORM TO THE PERTINENT REQUIREMENTS OF THE STANDARD SPECIFICATIONS AND APPLICABLE SPECIAL PROVISIONS.

WHEN POSSIBLE THE SILT FENCE SHOULD BE CONSTRUCTED IN AN ARC OR HORSESHOE SHAPE, WITH THE ENDS POINTING UPSLOPE TO MAXIMIZE BOTH STRENGTH AND EFFECTIVENESS.

- ① CROSS BRACE WITH 2" x 4" WOODEN FRAME OR EQUIVALENT AT TOP OF POSTS AS DIRECTED BY THE ENGINEER.
- ② MINIMUM 14 GAGE WIRE REQUIRED, FOLD FABRIC 3" OVER THE WIRE AND STAPLE OR PLACE WIRE RINGS ON 12" C-C.
- ③ EXCAVATE A TRENCH A MINIMUM OF 4" WIDE AND 6" DEEP TO BURY AND ANCHOR THE GEOTEXTILE FABRIC, FOLD MATERIAL TO FIT TRENCH AND BACKFILL AND COMPACT TRENCH WITH EXCAVATED SOIL.
- ④ WIRE SUPPORT FENCE SHALL BE 14 GAGE MINIMUM WOVEN WIRE WITH A MAXIMUM MESH SPACING OF 6". SECURE TOP OF GEOTEXTILE FABRIC TO TOP OF FENCE WITH STAPLES OR WIRE RINGS AT 12" C-C.
- ⑤ GEOTEXTILE FABRIC SHALL BE REINFORCED WITH AN INDUSTRIAL POLY-PROPYLENE NETTING WITH A MAXIMUM MESH SPACING OF 3/4" OR EQUAL. A HEAVY DUTY NYLON TOP SUPPORT CORD OR EQUIVALENT IS REQUIRED.
- ⑥ STEEL POSTS SHALL BE STUDDED "TEE" OR "U" TYPE WITH A MINIMUM WEIGHT OF 1.28 lbs/lin. ft. (WITHOUT ANCHOR). PIN ANCHORS SUFFICIENT TO RESIST POST MOVEMENT ARE REQUIRED. WOOD POSTS SHALL BE A MINIMUM SIZE OF 4" DIA. OR 1-1/2" x 3-1/2" EXCEPT WOOD POSTS FOR GEOTEXTILE FABRIC REINFORCED WITH NETTING SHALL BE A MINIMUM SIZE OF 1-1/8" x 1-1/8" OAK OR HICKORY.

ALTERNATIVES A AND B ARE EQUAL AND EITHER MAY BE USED.

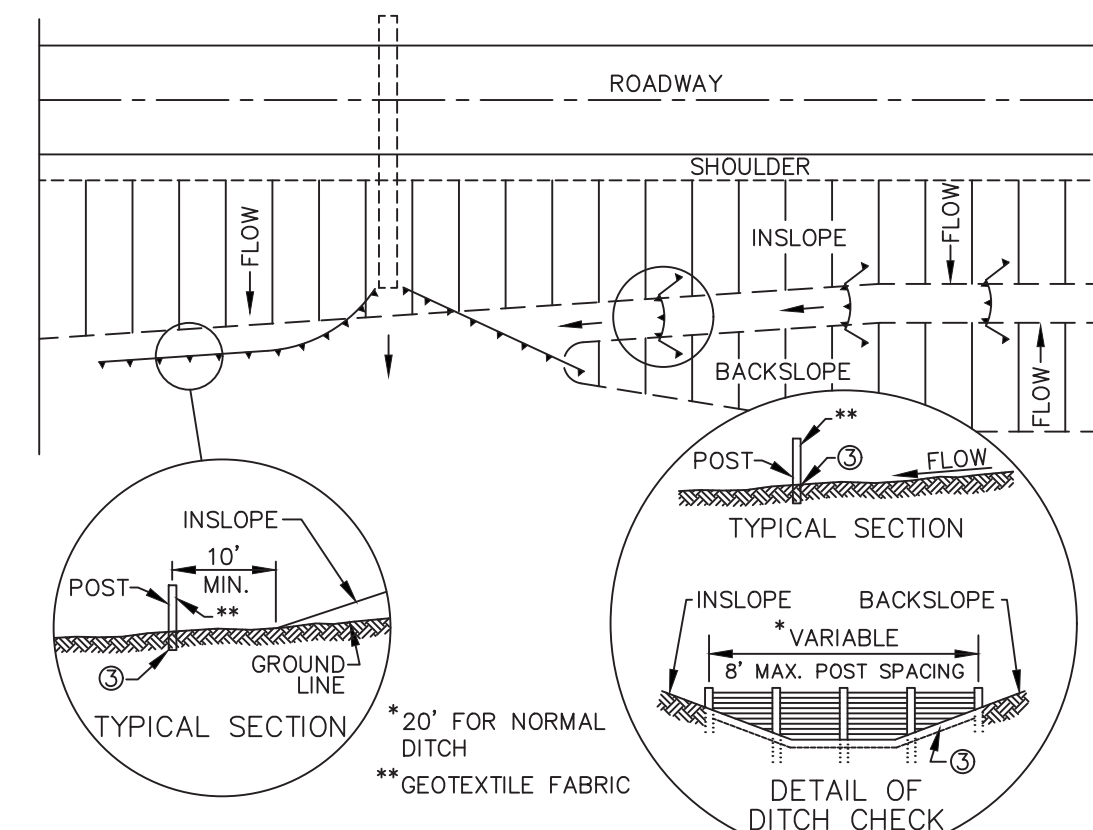

PLAN VIEW
TYPICAL APPLICATIONS OF SILT FENCE

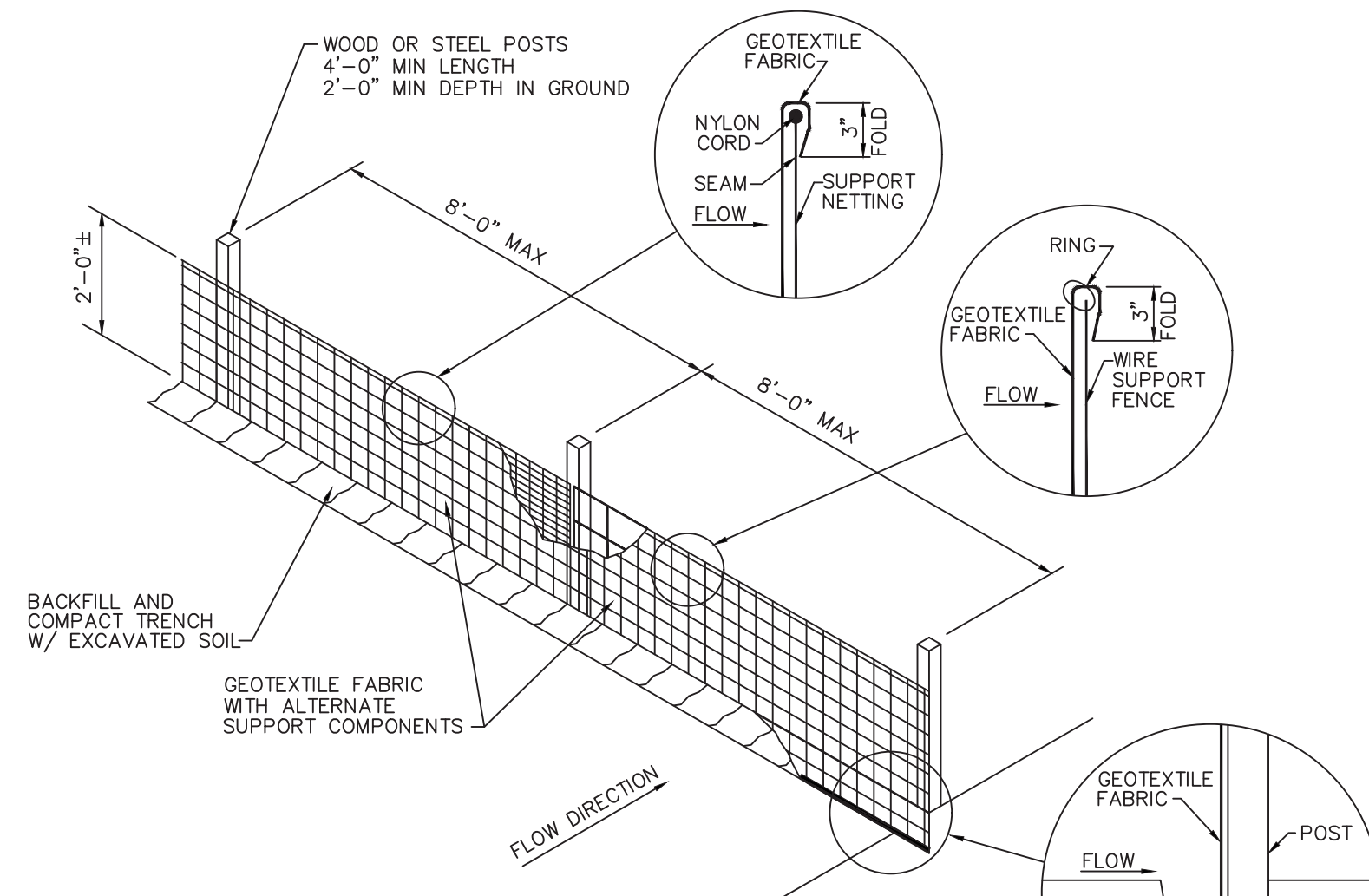

NOTE: ATTACH THE FABRIC TO THE POSTS WITH WIRE STAPLES OR WOODEN LATHE & NAILS.
SILT FENCE - ALTERNATE "A"

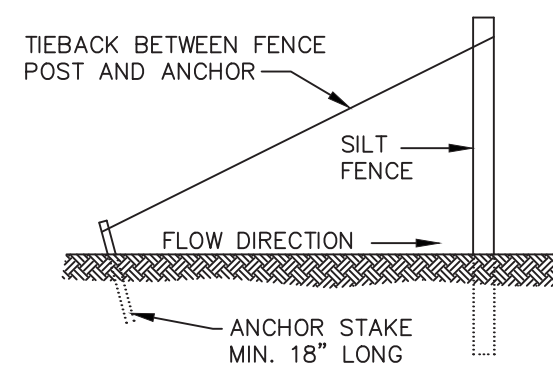

SILT FENCE TIE BACK
(WHEN REQUIRED BY THE ENGINEER)

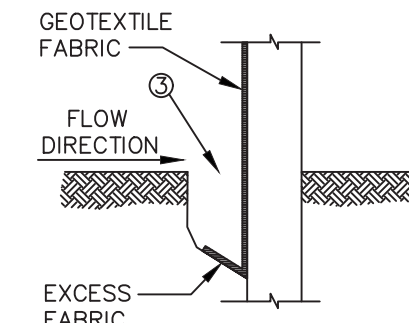

TRENCH DETAIL

NOTE: ADDITIONAL POST DEPTH OR TIE BACKS MAY BE REQUIRED IN UNSTABLE SOILS.

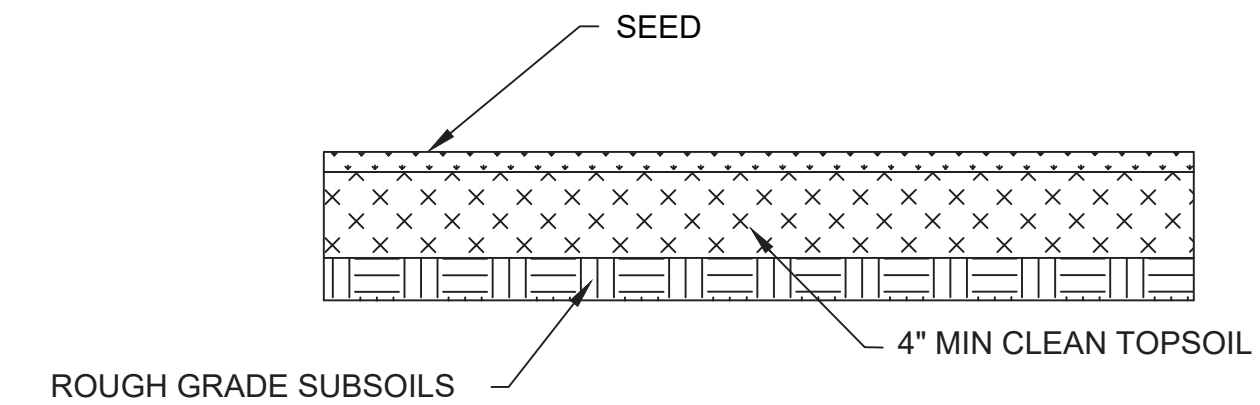

SEED AND TOPSOIL DETAIL
NOT TO SCALE

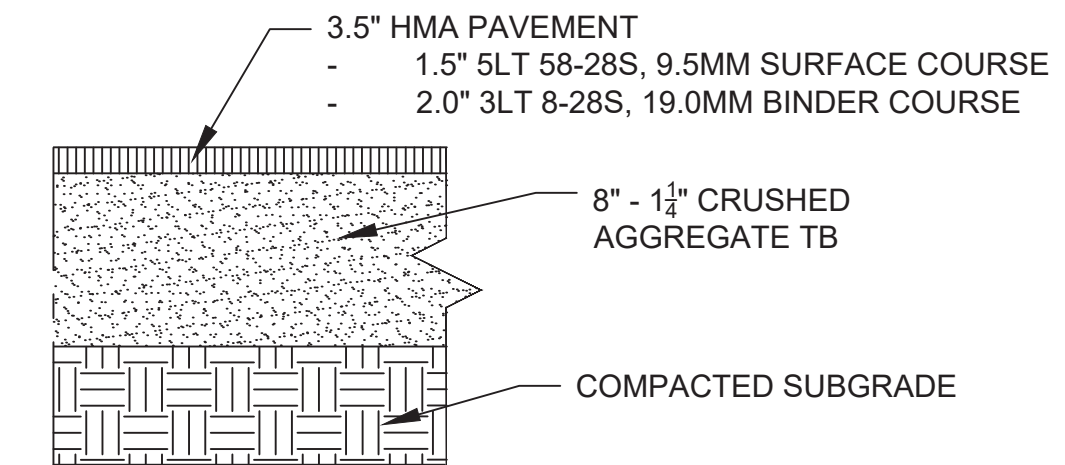

STANDARD DUTY ASPHALT PAVEMENT
NOT TO SCALE

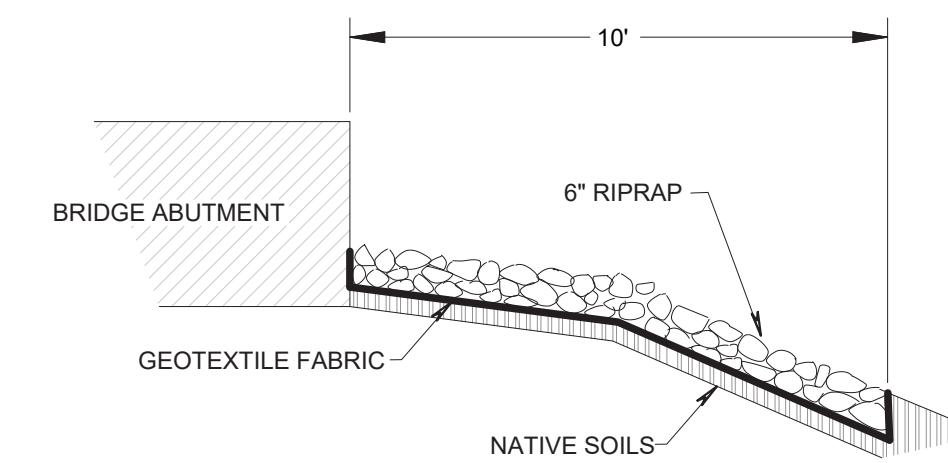

RIPRAP AND GEOTEXTILE FABRIC
AT ABUTMENTS DETAIL
NTS

APPROVED
By Tim Askin - Milwaukee HPC at 11:01 am, Jul 23, 2020

REVISION NO.	DESCRIPTION	DATE	BY	DESIGNED BY	ISSUANCE TYPE
				RJN	PERMIT
				RJN	
				DAT	
				DAT	
				DATE	05.15.2020

STANDARD DETAILS
OGDEN CONSTRUCTION GROUP, LLC
LAKE PARK PEDESTRIAN BRIDGE
MILWAUKEE, WISCONSIN

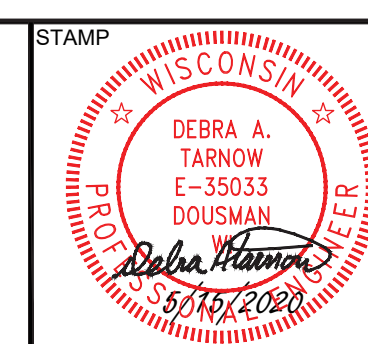

KEY PROJECT NUMBER	2002-0285-0001
PROJECT SCALE	NTS
SHEET NUMBER	C-3

C:\Users\atarnow\AppData\Local\Temp\ACF-publib_247921 Lake Park Pedestrian Bridge 5.7.2020.dwg

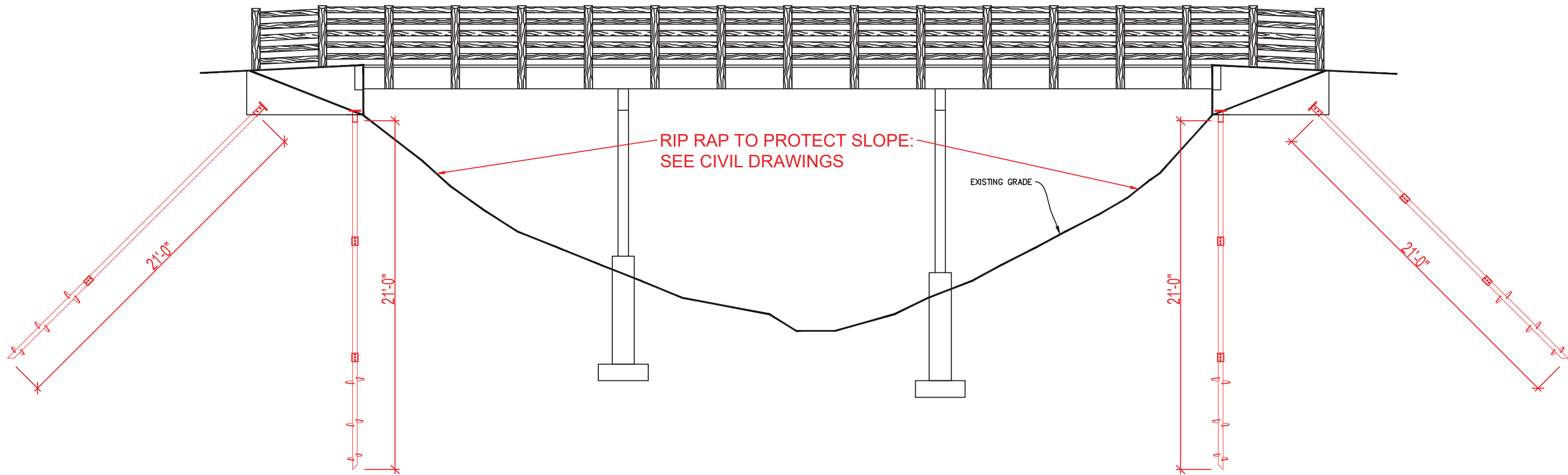

APPROVED

By Tim Askin - Milwaukee HPC at 11:01 am, Jul 23, 2020



Midwest Drilled Foundations
& Engineering, Inc.
200 S. Prairie Avenue
Waukesha, WI 53186

Subject	LAKE PARK - BRIDGE ABUTMENTS
Notes	Bridge Elevation w/ Helical Pier Support

Revision #	Description of Revision	By	Date

Job No.	20-xxx	Date	5/1/2020	Drawn By	R.F.P.
Contractor	MDF&E	Scale	N.T.S.	Sheet	1 of 3

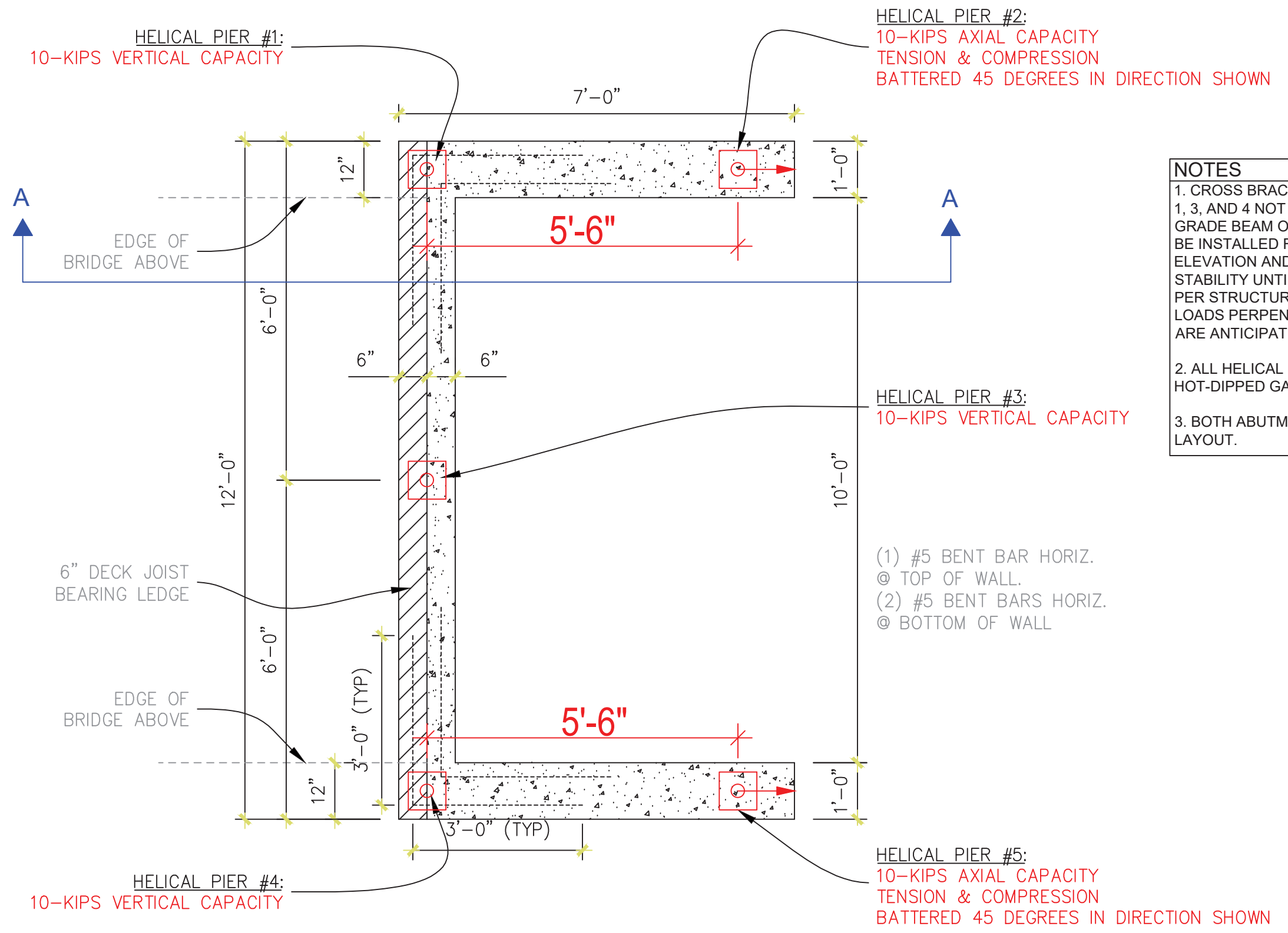

HELICAL PIER #1:
10-KIPS VERTICAL CAPACITY

HELICAL PIER #2:
10-KIPS AXIAL CAPACITY
TENSION & COMPRESSION
BATTERED 45 DEGREES IN DIRECTION SHOWN

HELICAL PIER #3:
10-KIPS VERTICAL CAPACITY

(1) #5 BENT BAR HORIZ.
@ TOP OF WALL.
(2) #5 BENT BARS HORIZ.
@ BOTTOM OF WALL

HELICAL PIER #5:
10-KIPS AXIAL CAPACITY
TENSION & COMPRESSION
BATTERED 45 DEGREES IN DIRECTION SHOWN

NOTES

- CROSS BRACING BETWEEN HELICAL PIERS 1, 3, AND 4 NOT REQUIRED FOR CONCRETE GRADE BEAM OPTION. HELICAL PIERS WILL BE INSTALLED FROM B/GRADE BEAM ELEVATION AND SOIL WILL PROVIDE LATERAL STABILITY UNTIL CONCRETE PLACEMENT. PER STRUCTURAL ENGINEER, NO LATERAL LOADS PERPENDICULAR TO BRIDGE TRAFFIC ARE ANTICIPATED.
- ALL HELICAL PIER MATERIAL TO BE HOT-DIPPED GALVANIZED.
- BOTH ABUTMENTS TO HAVE IDENTICAL LAYOUT.

APPROVED
By Tim Askin - Milwaukee HPC at 11:01 am, Jul 23, 2020

ABUTMENT PLAN VIEW
SCALE = 1/2" = 1'-0"

Revision #	Description of Revision	By	Date

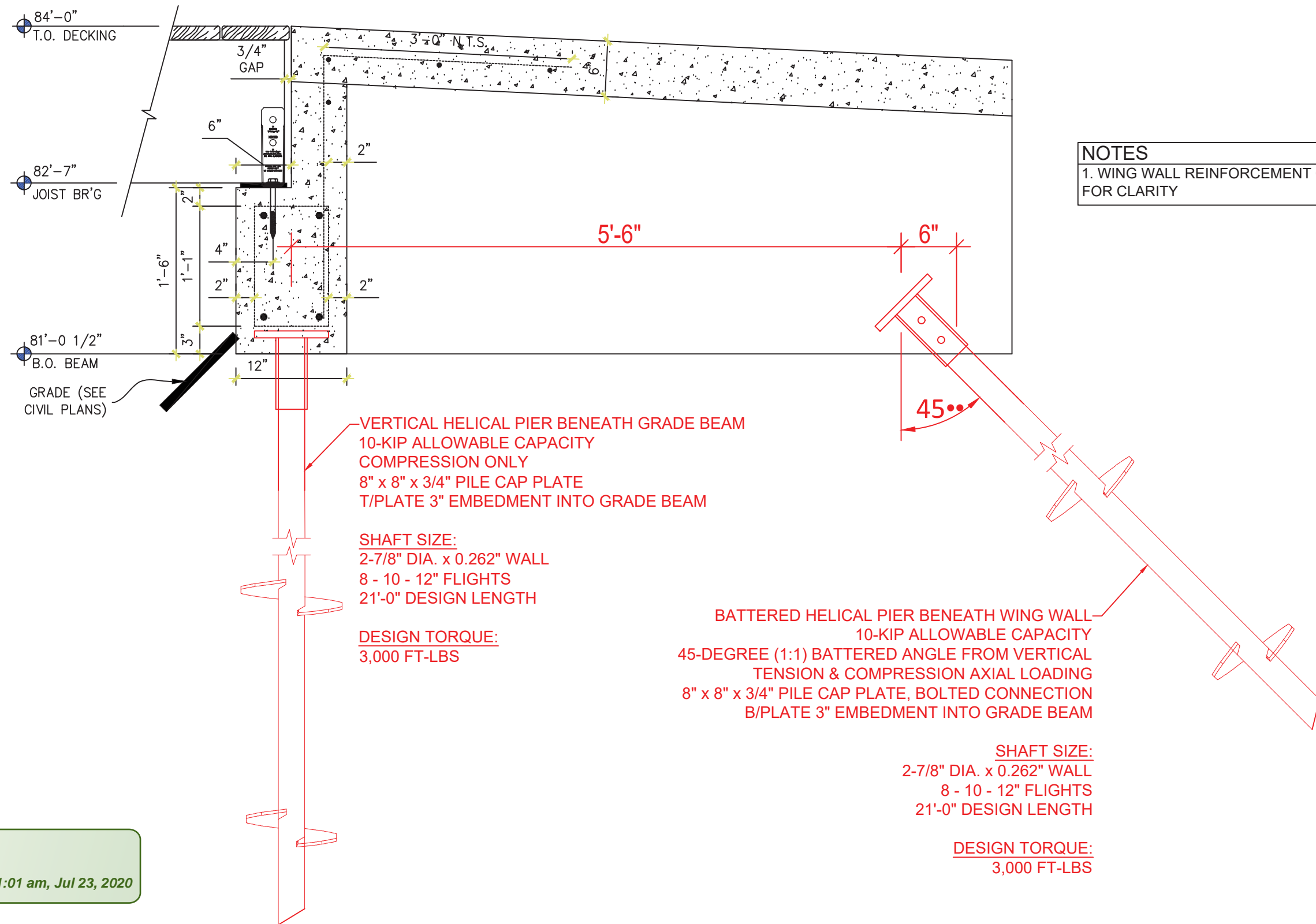

NOTES
 1. WING WALL REINFORCEMENT OMITTED FOR CLARITY

VERTICAL HELICAL PIER BENEATH GRADE BEAM
 10-KIP ALLOWABLE CAPACITY
 COMPRESSION ONLY
 8" x 8" x 3/4" PILE CAP PLATE
 T/PLATE 3" EMBEDMENT INTO GRADE BEAM

SHAFT SIZE:
 2-7/8" DIA. x 0.262" WALL
 8 - 10 - 12" FLIGHTS
 21'-0" DESIGN LENGTH

DESIGN TORQUE:
 3,000 FT-LBS

BATTERED HELICAL PIER BENEATH WING WALL
 10-KIP ALLOWABLE CAPACITY
 45-DEGREE (1:1) BATTERED ANGLE FROM VERTICAL
 TENSION & COMPRESSION AXIAL LOADING
 8" x 8" x 3/4" PILE CAP PLATE, BOLTED CONNECTION
 B/PLATE 3" EMBEDMENT INTO GRADE BEAM

SHAFT SIZE:
 2-7/8" DIA. x 0.262" WALL
 8 - 10 - 12" FLIGHTS
 21'-0" DESIGN LENGTH

DESIGN TORQUE:
 3,000 FT-LBS

APPROVED
 By Tim Askin - Milwaukee HPC at 11:01 am, Jul 23, 2020

SECTION A-A
 SCALE = 1" = 1'-0"

Subject	LAKE PARK - BRIDGE ABUTMENTS		
Notes	Helical Pier Plan View Abutment		

Revision #	Description of Revision	By	Date

Job No.	20-xxx	Date	5/1/2020	Drawn By	R.F.P.
Contractor	MDF&E	Scale	1" = 1'-0"	Sheet	3 of 3