



CITY OF MILWAUKEE
OFFICE OF THE CITY CLERK

Thursday, January 16, 2020

COMMITTEE MEETING NOTICE

AD 08

BHATTI, Rita M, Agent
Punjab Food LLC
2082 S Muskego Av

Milwaukee, WI 53204

You are requested to attend a hearing which is to be held in Room 301-B, Third Floor, City Hall on:

Tuesday, January 28, 2020 at 10:00 AM

Regarding: Your Class A Malt and Food Dealer License Applications as agent for "Punjab Food LLC" for "J&C El Centario Market" at 2082 S Muskego Av.

There is a possibility that your application may be denied for one or more of the following reasons: The recommendation of the committee regarding the application shall be based on evidence presented at the hearing. Per MCO 85-2.7-4, probative evidence concerning whether or not a new license should be granted may be presented on the following subjects: whether or not the applicant meets the municipal requirements, the appropriateness of the location and premises where the licensed premises is to be located and whether use of the premises for the purposes or activities permitted by the license would tend to facilitate a public or private nuisance or create undesirable neighborhood problems such as disorderly patrons, unreasonably loud noise, litter, and excessive traffic and parking congestion. Probative evidence relating to these matters may be taken from the plan of operation submitted with the license application, if any, but shall not include the content of any music. Evidence regarding the fitness of the location of the premises to be maintained as the principal place of business, including but not limited to whether there is an overconcentration of businesses of the type for which the license is sought; whether the proposal is consistent with any pertinent neighborhood business or development plans; or the location's proximity to areas where children are typically present. The applicant's record in operating similarly licensed premises; and whether or not the applicant has been charged with or convicted of any felony, misdemeanor, municipal offense or other offense, the circumstances of which substantially relate to the activity to be permitted by the license being applied for or any other factor which reasonably relates to the public health, safety or welfare may also be considered. See attached police report or correspondence.

Notice for applicants with warrants or unpaid fines:

Proof of warrant satisfaction or payment of fines must be submitted at the hearing on the above date and time. Failure to comply with this requirement may result in a delay of the granting/denial of your application.

Failure to appear at this meeting may result in the denial of your license. Individual applicants must appear only in person or by an attorney. Corporate or Limited Liability applicants must appear only by the agent designated on the application or by an attorney. Partnership applicants must appear by a partner listed on the application or by an attorney. If you wish to do so and at your own expense, you may be accompanied by an attorney of your choosing to represent you at this hearing.

You will be given an opportunity to speak on behalf of the application and to respond and challenge any charges or reasons given for the denial. No petitions can be accepted by the committee, unless the people who signed the petition are present at the committee hearing and willing to testify. You may present witnesses under oath and you may also confront and cross-examine opposing witnesses under oath. If you have difficulty with the English language, you should bring an interpreter with you, at your expense, so that you can answer questions and participate in your hearing.

You may examine the application file at this office during regular business hours prior to the hearing date. Inquiries regarding this matter may be directed to the person whose signature appears below.

Limited parking for persons attending meetings in City Hall is available at reduced rates (5 hour limit) at the Milwaukee Center on the southwest corner of East Kilbourn and North Water Street. Parking tickets must be validated in the first floor information booth in City Hall.

PLEASE NOTE: Upon reasonable notice, efforts will be made to accommodate the needs of disabled individuals through sign language interpreters or other auxiliary aids. For additional information or to request this service, contact the Council Services Division ADA Coordinator at (414) 286-2998, Fax - (414) 286-3456, TDD - (414) 286-2025.

JIM OW CZARSKI, CITY CLERK

BY: _____

Jessica Celella

License Division Manager

If you have questions regarding this notice, please contact the License Division at (414) 286-2238.

200 E. Wells Street, Room 105, City Hall, Milwaukee, WI 53202. www.milwaukee.gov/license
Phone: (414) 286-2238 Fax: (414) 286-3057 Email Address: License@milwaukee.gov



**CITY OF MILWAUKEE
OFFICE OF THE CITY CLERK**

Thursday, January 16, 2020

COMMITTEE MEETING NOTICE

AD 08

BHATTI, Rita M, Agent
Punjab Food LLC
4384 W Victory Creek Dr

Franklin, WI 53132

You are requested to attend a hearing which is to be held in Room 301-B, Third Floor, City Hall on:

Tuesday, January 28, 2020 at 10:00 AM

Regarding: Your Class A Malt and Food Dealer License Applications as agent for "Punjab Food LLC" for "J&C El Centarrio Market" at 2082 S Muskego Av.

There is a possibility that your application may be denied for one or more of the following reasons: The recommendation of the committee regarding the application shall be based on evidence presented at the hearing. Per MCO 85-2.7-4, probative evidence concerning whether or not a new license should be granted may be presented on the following subjects: whether or not the applicant meets the municipal requirements, the appropriateness of the location and premises where the licensed premises is to be located and whether use of the premises for the purposes or activities permitted by the license would tend to facilitate a public or private nuisance or create undesirable neighborhood problems such as disorderly patrons, unreasonably loud noise, litter, and excessive traffic and parking congestion. Probative evidence relating to these matters may be taken from the plan of operation submitted with the license application, if any, but shall not include the content of any music. Evidence regarding the fitness of the location of the premises to be maintained as the principal place of business, including but not limited to whether there is an overconcentration of businesses of the type for which the license is sought; whether the proposal is consistent with any pertinent neighborhood business or development plans, or the location's proximity to areas where children are typically present. The applicant's record in operating similarly licensed premises; and whether or not the applicant has been charged with or convicted of any felony, misdemeanor, municipal offense or other offense, the circumstances of which substantially relate to the activity to be permitted by the license being applied for or any other factor which reasonably relates to the public health, safety or welfare may also be considered. See attached police report or correspondence.

Notice for applicants with warrants or unpaid fines:

Proof of warrant satisfaction or payment of fines must be submitted at the hearing on the above date and time. Failure to comply with this requirement may result in a delay of the granting/denial of your application.

Failure to appear at this meeting may result in the denial of your license. Individual applicants must appear only in person or by an attorney. Corporate or Limited Liability applicants must appear only by the agent designated on the application or by an attorney. Partnership applicants must appear by a partner listed on the application or by an attorney. If you wish to do so and at your own expense, you may be accompanied by an attorney of your choosing to represent you at this hearing.

You will be given an opportunity to speak on behalf of the application and to respond and challenge any charges or reasons given for the denial. No petitions can be accepted by the committee, unless the people who signed the petition are present at the committee hearing and willing to testify. You may present witnesses under oath and you may also confront and cross-examine opposing witnesses under oath. If you have difficulty with the English language, you should bring an interpreter with you, at your expense, so that you can answer questions and participate in your hearing.

You may examine the application file at this office during regular business hours prior to the hearing date. Inquiries regarding this matter may be directed to the person whose signature appears below.

Limited parking for persons attending meetings in City Hall is available at reduced rates (5 hour limit) at the Milwaukee Center on the southwest corner of East Kilbourn and North Water Street. Parking tickets must be validated in the first floor information booth in City Hall.

PLEASE NOTE: Upon reasonable notice, efforts will be made to accommodate the needs of disabled individuals through sign language interpreters or other auxiliary aids. For additional information or to request this service, contact the Council Services Division ADA Coordinator at (414) 286-2998, Fax - (414) 286-3456, TDD - (414) 286-2025.

JIM OWCZARSKI, CITY CLERK

BY: _____

Jessica Celella

License Division Manager

If you have questions regarding this notice, please contact the License Division at (414) 286-2238.

200 E. Wells Street, Room 105, City Hall, Milwaukee, WI 53202. www.milwaukee.gov/license
Phone: (414) 286-2238 Fax: (414) 286-3057 Email Address: License@milwaukee.gov

MILWAUKEE POLICE DEPARTMENT LICENSING

CRIMINAL RECORD/ORDINANCE VIOLATION/INCIDENTS SYNOPSIS

DATE: 09/19/19
LICENSE TYPE: FOOD
NEW:
RENEWAL:

No. 299249
Application Date: 09/19/19

License Location: 2082 S. Muskego Avenue
Business Name: El Centenario

Licensee/Applicant: VIDRIO, Jose S
(Last Name, First Name, MI)
Date of Birth: 09/13/1968

Home Address: 3573 S. 46th Street
City: Greenfield **State:** WI **Zip Code:** 53220
Home Phone: 414-881-4277

This report is written by Police Officer Corstan D. COURT, assigned to the License Investigation Unit, Days.

The Milwaukee Police Department's investigation regarding this application revealed the following:

1. On 08/25/18 a 17 year old working in conjunction with the Milwaukee Police Department and WI WINS Tobacco initiative, was able to purchase a 2 pack of Grape Swisher Sweet Cigars at 2082 S. Muskego Avenue, The sales clerk admitted to selling the item and the station was mailed a MARTS enrollment packet. As of 12/10/18 the applicant had not registered in the MARTS program, therefore, a citation was issued.

Charge: Sale of Cigarette to Underage
Finding: Dismissed without Prejudice
Sentence:
Date: 03/13/19
Case: 19000756

2. On 03/31/19 the applicant was cited in the City of Milwaukee at 733 W. Oklahoma Avenue for Responsible Person on Premise Required.

Charge: Responsible Person on Premise Required
Finding: Trial set for 09/24/19 at 8:30am
Sentence:
Date:
Case: 19025795

3. On 06/01/19 a 16 year old working in conjunction with the Milwaukee Police Department and WI WINS Tobacco initiative, was able to purchase a 2 pack of Mango Flavored Swisher Sweet Cigars at 2082 S. Muskego Avenue, The sales clerk admitted to selling the item and the applicant was issued a citation.

MILWAUKEE POLICE
LICENSER

Charge: Sale of Cigarette to Minor/Underage
Finding: Further Proceedings on 12/03/19
Sentence:
Date:
Case: 19025982

CRIMINAL RECORDS/ORDINANCE
LICENSER

PREVIOUS PREMSIE

Date: 12/31/19
Officer: PO Matthew Diener

City of Milwaukee Police Department
90-5-1.5 Crime Prevention Survey
Convenience Store/Liquor Store Inspection

Name of Premise: JNC Market
Address: 2082 S Muskego Av
Phone: N/P

Owner: Rita M BHATTI
Owner address: 4384 W Victory Creek Dr
City State Zip: Franklin, WI 53132
Owner Phone: 414-418-8314
Owner email: ritabhatti97@ymail.com

Manager: same
Home Address:
City State Zip:
Phone:
Email:

Preferred contact: phone

Location currently open: YES NO

Projected open date:

Day's open: S M T W Th F SA ALL

Hours of Operation: Sun: 9a-9p 24 hours Y N
Mon: 9a-9p
Tue: 9a-9p
Wed: 9a-9p
Thu: 9a-9p
Fri: 9a-9p
Sat: 9a-9p

Premise Type: Liquor Store
Convenience Store
Other: Beer

Licenses currently held:

- Alcohol: Yes No Class: #:
Tobacco: Yes No #:
Food: Yes No #: 12235
Extended Hours: Yes No #: 198826
Secondhand Dealer: Yes No Type: #:
Other: Yes No Type: #:
Other: Yes No Type: #:

Exterior Survey:

1. Is the area around the location clean? Yes No
2. What surrounds the location? (Check all the apply)
 - a. Park
 - b. School
 - c. Youth Center
 - d. Church
 - e. Tavern(s) If so, how many
 - f. Residential
 - g. Other businesses
 - h. Other:
3. Can you see from the outside of the location into the interior Yes No
4. Can you see the employees inside of the location from the outside Yes No
5. Are exterior windows free of signage Yes No
6. Is there a parking lot Yes No
7. Is the parking lot clean? Yes No
8. Is the parking lot well lit? Yes No
9. Are there areas where a person could conceal themselves Yes No
10. Is there exterior lighting? Yes No. Does it appear to be adequate Yes No
11. Exterior Payphone? Yes No
12. Are there No Loitering Signs posted? Yes No
13. Are there exterior security cameras Yes No How Many: 4
14. Are the address numbers prominently displayed and easy to see Yes No

Camera Survey:

15. Does this location have security cameras? Yes No
16. Are they in working order? Yes No
17. What format are the cameras?
 - a. Color Yes No
 - b. Digital Yes No
 - c. VCR Yes No
 - d. Recorded Yes No
18. How long is footage stored for later viewing: Unknown to applicant
19. Are there exterior cameras Yes No How many: 4
20. Are there interior cameras Yes No How many: 12 (9 working)
21. Do all employees know how to retrieve recorded digital images/footage? Yes No

License currently held:

Alcohol:

Food:

Other:

Yes No Class:

Yes No

Yes No

Yes No

Interior Survey:

22. Is the storeowner willing to be a standing complainant regarding loitering? Yes No
a. If yes have them fill out the standing complaint form and give them two of the commercial signs Yes No
23. Is the interior of the location neat and clean? Yes No
24. Does an interior camera face the entrance/exit? Yes No
25. Is there a lockable area that separates employees from customers? Yes No
26. Does the store sell single chore boy? Yes No
27. Does the store sell blunt wraps? Yes No
28. Does the store sell scales? Yes No
29. Does the store sell items that may be used as crack pipes? Yes No
a. Describe item Glass tire gauges.
30. Does the store have an over abundance of sandwich baggies: Yes No
31. Does the owner understand that these items are often used for drug use? Yes No
32. Do the products in the store appear to be new and rotated often? Yes No
33. Are emergency and non-emergency numbers posted near the phone? Yes No
34. Does the owner know how to contact their police district directly? Yes No
a. Did you provide a district contact guide to the owner? Yes No

Complete this section if alcohol establishment is a convenience store:

(** Read full ordinance for all details "68-4.3 Convenience Food Stores")

All convenience food stores not exempted under sub. 3 shall:

1. Is the cash register located in a manner so that at the time of a sales transaction, the employee and customer are both visible from the sidewalk? Yes No **
2. Are the glass entrance and exit doors clear of any signs or advertisements with the exception of a sign which states that the cash register contains \$50 or less and that the safe is no accessible to employees? Yes No
3. Does the store maintain one of the following on the licensed premise:
 - a. A safe that was in use at the convenience food store on August 17, 1994? Yes No
 - b. A drop-safe or time release safe that weighs at least 500 pounds or which is attached to or set into the floor in a manner approved by the police department? Yes No
4. Is lighting provided for the store's parking area during all hours of darkness when employees or customers are on the premises at a minimum average of 2-foot candles per square foot, unless the store is not open for business after sunset and before sunrise? Yes No N/A
5. Are at least two high-resolution surveillance security cameras installed? Yes No
6. Are the security cameras in working order? Yes No
7. Does one camera show an overall view of the counter and register area? Yes No
8. Does one camera show a clear, identifiable, full frame image of the face of each person entering and leaving the store? Yes No
9. Are the camera views obstructed by fixtures or displays? Yes No
10. Is the recorded footage stored for at least 30 days? Yes No
11. Do all store employees know how to record footage from the camera system to media capable of being transferred to police custody? Yes No

12. Are customer entrances/exits made of glass or other transparent material? Yes No
a. Exception: A store that does not have such doors on August 17, 1994 shall not be required to install such doors until the holder of the store's food dealer license changes.
13. Has the owner and their employees attended the Robbery Prevention Training within 120 days of ownership or employment? Yes No
a. Contact Community Outreach and Education at 935-7836 for schedule.

Sub 3. Exemptions. The requirements of this section do not apply to a convenience food store that conforms to either of the following descriptions:

- a-1. The store is located in an enclosed shopping structure, enclosed commercial building or hospital. A convenience food store is not in an enclosed structure or building if a customer can enter it directly from the outside.
Does store conform to a-1 Yes No
- a-2. The store physically separates employees from customers with a solid partition that bars a person from entering the employee area from the customer area, has a secure lock on the employee side of any door between the employee area and the customer, and conducts all transaction through a service window or similar arrangement.
Does store conform to a-2 Yes No
- a. At the commissioner's discretion, a convenience store may be exempted from any or all of the regulations specified in sub 2.
Does this location hold an exemption from the commissioner regarding any of the requirements of Sub 2? Yes No

ADDITIONAL COMMENTS/RECOMMENDATIONS:

The applicant is purchasing the store from the current licensee. The current store sells glass tire gauges and Chore Boy scrub brushes, which was explained to the applicant that they are used for smoking crack cocaine. The applicant then stated that she does not want to sell those items if they are used as drug paraphernalia. The premise has working digital cameras, however, the applicant does not know how they operate, I stressed to the applicant the importance of learning the camera system. I also advised the applicant to attend Robbery Prevention Training, and provided her with the number to schedule. The premise does also not have an approved safe, and I advised the applicant of the importance with securing safes for the business.

Alcohol Concentration for 2082 S Muskego Ave

City of Milwaukee, Wisconsin



- Legend -**
- Milwaukee parcels
 - Street names 10,000
 - City limits
 - Freeways 15,000
 - Freeways
 - Exit ramps
 - Entry ramps
 - Ramps
 - Major streets 10,000
 - Streets 10,000
 - Waterways
 - Milwaukee parcels
 - Alcohol Licenses
 - Class A Intoxicating Liquor
 - Class A Fermented Malt Beverage
 - Class A Liquor and Malt
 - Class B Fermented Malt Beverage
 - Class B Tavern
 - Class C Wine Retailer

- Notes -

Alcohol Establishments within a .5 Mile Radius Centered on 2082 S Muskego Ave as of 12/12/2019



Department of Administration - IT/MD

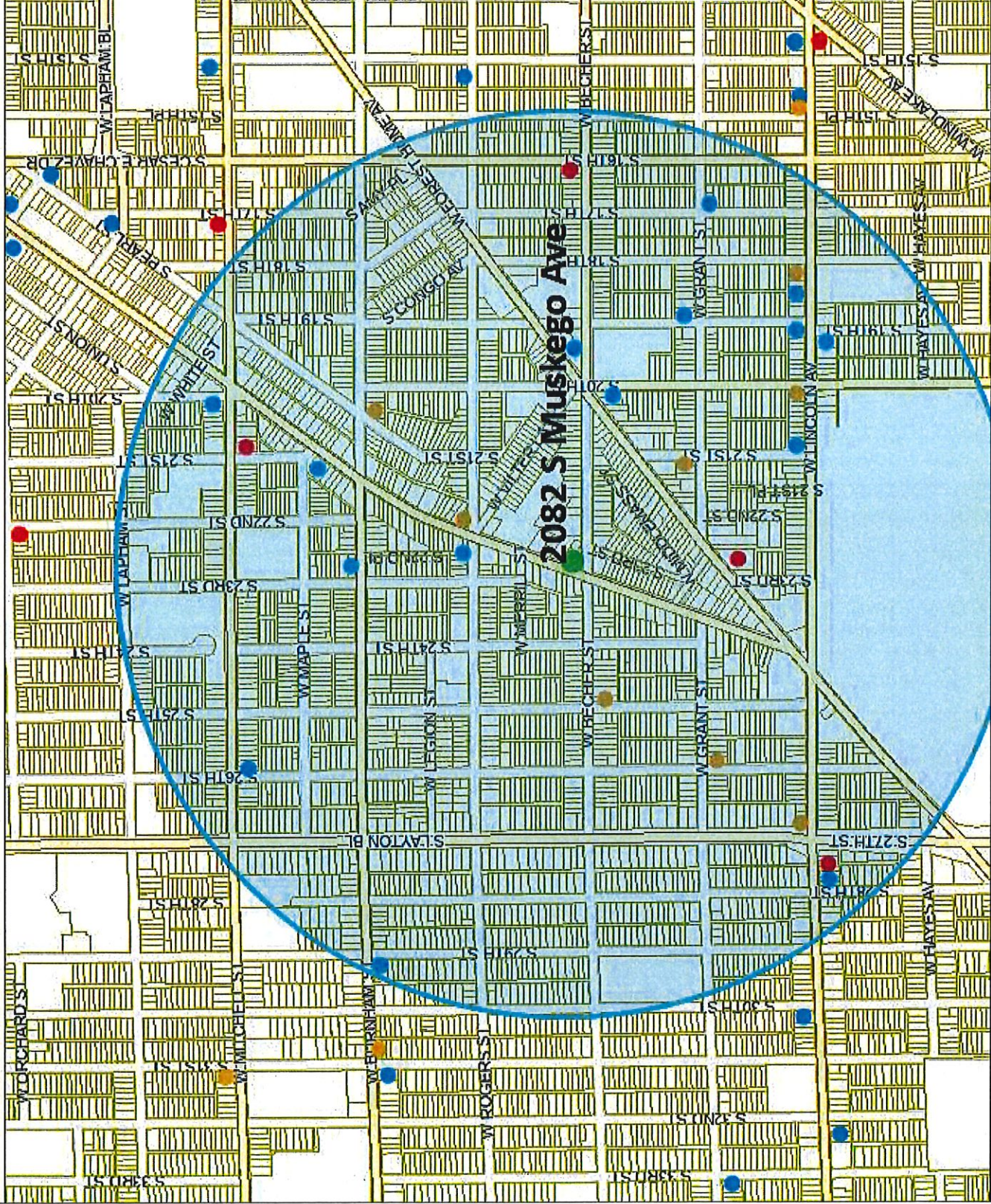

Map Scale: 1: 10,000

© City of Milwaukee, Wisconsin
 Map Milwaukee: Property Information
 Disclaimer
 12/12/2019

Licensed Alcohol Beverage Establishments within a .5 Miles Radius Centered on 2082 S Muskego Ave as of 12/12/2019

License Summary

Class A Fermented Malt Beverage Retailer's License
 Class A Malt & Class A Liquor License
 Class B Tavern License

Total
 9
 4
 15
 28

Grand Total

CORP_NAME	TRADE_NAME	LICENSEE	ENTITY_ADDRESS	PROFESSION_FULL_NAME	TOT_CAP	ROOM_CAP
Lincoln Express, Inc.	Express Pantry	PETTY BABBER, Agt	1804 W Lincoln AV	Class A Fermented Malt Beverage Retailer's License		
LA ARRACHERA	LA ARRACHERA	MARINA VARA DE ARANA, SP	1988 S MUSKEGO AV	Class A Fermented Malt Beverage Retailer's License		
Porullo, LLC	Jalisco's Super Market	Hilda Gomez, Agt	2000 W Lincoln AV	Class A Fermented Malt Beverage Retailer's License		
Starlite Beer & Food, Inc.	Starlite Food	GURMUKH SINGH, Agt	2013 W Burnham ST	Class A Fermented Malt Beverage Retailer's License		
Mona LLC	Mona Grocery Store	JOSE S VIDRIO, Agt	2082 S MUSKEGO AV	Class A Fermented Malt Beverage Retailer's License		
ABDELAL, LLC	GRANT MARKET	SAED F ABDELAL, Agt	2100 W GRANT ST	Class A Fermented Malt Beverage Retailer's License		
Farida, LLC	South Ave Foods	Thaier M Qatour, Agt	2108 S 25TH ST	Class A Fermented Malt Beverage Retailer's License		
Treder KMK Inc	Supermarket La Veracruzana	ERIC J TREDER, Agt	2539 W Grant ST	Class A Fermented Malt Beverage Retailer's License		
Aarvind Food Mart, LLC	Lucky Food & Beer	LAKHWINDER KAUR, Agt	2638 W Lincoln AV	Class A Fermented Malt Beverage Retailer's License		
Paul's Liquor LLC	Paul's Liquor	AGIAPAL SINGH, Agt	1600 W Becher ST	Class A Malt & Class A Liquor License		
Gunny Food Mart Inc	Gunny Food Mart	MANPREET KAUR, Agt	2033 W Mitchell ST	Class A Malt & Class A Liquor License		
Seven Star Liquor LLC	Seven Star Liquor	JASJEET SINGH, Agt	2223 W Forest Home AV	Class A Malt & Class A Liquor License		
CITIZEN, INC	LINCOLN AVENUE FOOD & LIQUOR	INTISAR HASAN, Agt	2717 W LINCOLN AV	Class A Malt & Class A Liquor License		
PRIMOS PLACE	PRIMOS PLACE	ENRIQUE TERRONES, SP	1651 W GRANT ST	Class B Tavern License	161	First Floor 62, Second Floor 99
La Caleta LLC	La Caleta Restaurant & Bar	Monica Hernandez-Gaspar, Agt	1801 S Muskego AV	Class B Tavern License	49	
TEDDY'S INCOME, INC	SHARI'S STILL	SHERYL L LARSON, Agt	1834 S 23RD ST	Class B Tavern License	25	
ANNA'S TAP	ANNA'S TAP	SAMANTHA L RITCHIE, SP	1838 W GRANT ST	Class B Tavern License		
Tabasco Bar	Tabasco Bar	Jose De Dios-Sosa, Agt	1900 W LINCOLN AV	Class B Tavern License		
Irene's Catering Service, Inc	Irene's Catering Service, Inc	Thomas E Rewolinski, Agt	1901 W Lincoln AV	Class B Tavern License		
Forest Home Ave Chicken Palace LLC	Chicken Palace - Forest Home	Rosa Isela Real Perez, Agt	1937 W Forest Home AV	Class B Tavern License		
La Hamaca Bar LLC	La Hamaca Bar	Luis Lopez-Gonzalez, Agt	1993 S MUSKEGO AV	Class B Tavern License	71	
EL INFIERNO LLC	EL INFIERNO	ANTONIO MARTINEZ, Agt	2000 W Mitchell ST	Class B Tavern License		
PROMOCIONES MEXICAS LLC	EL GRAN TEOCALLI	PALOMA NAVYA, Agt	2011 W FOREST HOME AV	Class B Tavern License	282	
HOLLER HOUSE	HOLLER HOUSE	TODD C STUCKERT, SP	2042 W LINCOLN AV	Class B Tavern License	50	
SCHULIST TAP	SCHULIST TAP	DAVID SCHULIST, SP	2539 W MITCHELL ST	Class B Tavern License	49	
EL PARIAN	EL PARIAN	RICARDO MONTES ALVARADO, SP	2901 W BURNHAM ST	Class B Tavern License	60	
LA PICA #3, LLC	LA PICA CARR 3 BAR & HALL	WILLIAM RIVERA, Agt	3427-31 W LINCOLN AV	Class B Tavern License	162	
OLD TOWN SERBIAN GOURMET RESTAURANT, LLC	OLD TOWN SERBIAN GOURMET RESTAURANT	NATALIA A RADICEVIC, Agt	518-522 W LINCOLN AV	Class B Tavern License	200	



Thursday, January 16, 2020

Licenses Committee Notice of Hearing

ATARY INVESTMENTS LLC
7849 W Bur Oak DR
Franklin, WI 53132

Date: 1/28/2020
Time: 10:00 AM
Location: Room 301-B, Third Floor, City Hall

The Licenses Committee will consider the following license application:

Class A Malt and Food Dealer License Applications
BHATTI, Rita M, Agent
J&C El Centario Market at 2082 S Muskego Av

Please note this application may be recommended for denial based on fitness of the location due to concentration of alcohol beverage outlets in the area. If the application is denied for this reason, no other application for an alcohol beverage license for this location shall be recommended for approval by the Licenses Committee within three years of the date of denial unless the applicant has demonstrated a change of circumstances since the prior denial.

If you have any questions, please call (414) 286-2238.





Thursday, January 16, 2020

Licenses Committee Notice of Hearing

ATARY INVESTMENTS LLC
2082 S Muskego Ave
Milwaukee, WI 53204

Date: 1/28/2020
Time: 10:00 AM
Location: Room 301-B, Third Floor, City Hall

The Licenses Committee will consider the following license application:

Class A Malt and Food Dealer License Applications
BHATTI, Rita M, Agent
J&C El Centario Market at 2082 S Muskego Av

Please note this application may be recommended for denial based on fitness of the location due to concentration of alcohol beverage outlets in the area. If the application is denied for this reason, no other application for an alcohol beverage license for this location shall be recommended for approval by the Licenses Committee within three years of the date of denial unless the applicant has demonstrated a change of circumstances since the prior denial.

If you have any questions, please call (414) 286-2238.





Thursday, January 16, 2020



Notice of Public Hearing

BHATTI, Rita M, Agent
J&C El Centario Market at 2082 S Muskego Av
Class A Malt and Food Dealer License Applications

Tuesday, January 28, 2020 at 10:00 AM

To whom it may concern:

The above application has been made by the above named applicant(s). This requires approval from the Licenses Committee and the Common Council of the City of Milwaukee. The hearing before the Licenses Committee will take place on 1/28/2020 at 10:00 AM, in Room 301-B, Third Floor, City Hall. If you wish, you may provide testimony at the hearing regarding the request; see below for further information. You are not required to attend the hearing. Once the Licenses Committee makes its recommendation, this recommendation is forwarded to the full Common Council for approval at its next regularly scheduled hearing. Please review the information below and if you have further questions regarding this process, please contact the License Division at (414) 286-2238.

Important details for those wishing to provide information for the Licenses Committee to consider when making its recommendation:

1. The license application is scheduled to be heard at the above time. Due to other hearings running longer than scheduled, you may have to wait some time to provide your testimony.
2. You must appear in person and testify as to matters that you have personally experienced or seen. (You cannot provide testimony for your neighbor, parent or anyone else; this is considered hearsay and cannot be considered by the committee.)
3. No letters or petitions can be accepted by the committee (unless the person who wrote the letter or the persons who signed the petition are present at the committee hearing and willing to testify).
4. Persons opposed to the license application are given the opportunity to testify first; supporters may testify after the opponents have finished.
5. When you are called to testify, you will be sworn in and asked to give your name, and address. (If your first and/or last names are uncommon please spell them.)
6. You may then provide testimony.
 - a. Include only information relating to the above license application.
 - b. Include only information you have personally witnessed or seen.
 - c. Provide concise and relevant information detailing how this business has affected or may affect the peaceful enjoyment of your neighborhood.
 - d. If by the time you have the opportunity to testify, the information you wish to share has already been provided to the committee, you may state that you agree with the previous testimony. Redundant or repetitive testimony will not assist the committee in making its recommendation.
7. After giving your testimony, the members of the Licenses Committee and the licensee may ask questions regarding the testimony you have given or other factors relating to the license application.
8. Business Competition is not a valid basis for denial or non-renewal of a license.
Please Note: If you have submitted an objection to the above application your objection cannot be considered by the committee unless you personally testify at the hearing.

OCCUPANT	MAIL ADDRESS	CITY, STATE ZIP
CURRENT OCCUPANT	2118 S 23RD ST	MILWAUKEE, WI 53215
CURRENT OCCUPANT	2215A W BECHER ST	MILWAUKEE, WI 53215
CURRENT OCCUPANT	2209 W BECHER ST	MILWAUKEE, WI 53215
CURRENT OCCUPANT	2219 W BECHER ST	MILWAUKEE, WI 53215
CURRENT OCCUPANT	2068 S MUSKEGO AVE	MILWAUKEE, WI 53204
CURRENT OCCUPANT	2047 S MUSKEGO AVE	MILWAUKEE, WI 53204
CURRENT OCCUPANT	2041 S MUSKEGO AVE	MILWAUKEE, WI 53204
CURRENT OCCUPANT	2116A S MUSKEGO AVE	MILWAUKEE, WI 53215
CURRENT OCCUPANT	2121 S MUSKEGO AVE	MILWAUKEE, WI 53215
CURRENT OCCUPANT	2108 S MUSKEGO AVE	MILWAUKEE, WI 53215
CURRENT OCCUPANT	2343 W BECHER ST	MILWAUKEE, WI 53215
CURRENT OCCUPANT	2344 W BECHER ST	MILWAUKEE, WI 53215
CURRENT OCCUPANT	2124 S 23RD ST	MILWAUKEE, WI 53215
CURRENT OCCUPANT	2114 S 23RD ST	MILWAUKEE, WI 53215
CURRENT OCCUPANT	2110 S 23RD ST	MILWAUKEE, WI 53215
CURRENT OCCUPANT	2205 W BECHER ST	MILWAUKEE, WI 53215
CURRENT OCCUPANT	2138A W BECHER ST	MILWAUKEE, WI 53215
CURRENT OCCUPANT	2303A W MERRILL ST	MILWAUKEE, WI 53204
CURRENT OCCUPANT	2116 S MUSKEGO AVE	MILWAUKEE, WI 53215
CURRENT OCCUPANT	2345 W BECHER ST	MILWAUKEE, WI 53215
CURRENT OCCUPANT	2103 S MUSKEGO AVE	MILWAUKEE, WI 53215
CURRENT OCCUPANT	2340 W BECHER ST	MILWAUKEE, WI 53215
CURRENT OCCUPANT	2079A S MUSKEGO AVE	MILWAUKEE, WI 53204
CURRENT OCCUPANT	2215 W BECHER ST	MILWAUKEE, WI 53215
CURRENT OCCUPANT	2302 W BECHER ST	MILWAUKEE, WI 53215
CURRENT OCCUPANT	2060A S MUSKEGO AVE	MILWAUKEE, WI 53204
CURRENT OCCUPANT	2124A S MUSKEGO AVE	MILWAUKEE, WI 53215
CURRENT OCCUPANT	2073 S MUSKEGO AVE	MILWAUKEE, WI 53204
CURRENT OCCUPANT	2313 W MERRILL ST	MILWAUKEE, WI 53204
CURRENT OCCUPANT	2309A W MERRILL ST	MILWAUKEE, WI 53204
CURRENT OCCUPANT	2049 S MUSKEGO AVE	MILWAUKEE, WI 53204
CURRENT OCCUPANT	2043 S MUSKEGO AVE	MILWAUKEE, WI 53204
CURRENT OCCUPANT	2123 S MUSKEGO AVE	MILWAUKEE, WI 53215
CURRENT OCCUPANT	2108A S MUSKEGO AVE	MILWAUKEE, WI 53215
CURRENT OCCUPANT	2342 W BECHER ST	MILWAUKEE, WI 53215
CURRENT OCCUPANT	2112 S 23RD ST	MILWAUKEE, WI 53215
CURRENT OCCUPANT	2068A S MUSKEGO AVE	MILWAUKEE, WI 53204
CURRENT OCCUPANT	2071 S MUSKEGO AVE	MILWAUKEE, WI 53204
CURRENT OCCUPANT	2079 S MUSKEGO AVE	MILWAUKEE, WI 53204
CURRENT OCCUPANT	2120 S MUSKEGO AVE	MILWAUKEE, WI 53215
CURRENT OCCUPANT	2113 S MUSKEGO AVE	MILWAUKEE, WI 53215
CURRENT OCCUPANT	2301 W BECHER ST	MILWAUKEE, WI 53215
CURRENT OCCUPANT	2105 S MUSKEGO AVE	MILWAUKEE, WI 53215
CURRENT OCCUPANT	2217 W BECHER ST	MILWAUKEE, WI 53215
CURRENT OCCUPANT	2222 W BECHER ST	MILWAUKEE, WI 53215
CURRENT OCCUPANT	2060 S MUSKEGO AVE	MILWAUKEE, WI 53204

CURRENT OCCUPANT	2138 W BECHER ST	MILWAUKEE, WI 53215
CURRENT OCCUPANT	2124 S MUSKEGO AVE	MILWAUKEE, WI 53215
CURRENT OCCUPANT	2309 W MERRILL ST	MILWAUKEE, WI 53204
CURRENT OCCUPANT	2119 S MUSKEGO AVE	MILWAUKEE, WI 53215
CURRENT OCCUPANT	2305 W BECHER ST	MILWAUKEE, WI 53215
CURRENT OCCUPANT	2307 W BECHER ST	MILWAUKEE, WI 53215
CURRENT OCCUPANT	2338A W BECHER ST	MILWAUKEE, WI 53215
CURRENT OCCUPANT	2076 S MUSKEGO AVE	MILWAUKEE, WI 53204
CURRENT OCCUPANT	2080 S MUSKEGO AVE	MILWAUKEE, WI 53204
CURRENT OCCUPANT	2209A W BECHER ST	MILWAUKEE, WI 53215
CURRENT OCCUPANT	2303 W MERRILL ST	MILWAUKEE, WI 53204
CURRENT OCCUPANT	2338 W BECHER ST	MILWAUKEE, WI 53215
CURRENT OCCUPANT	2336 W BECHER ST	MILWAUKEE, WI 53215
CURRENT OCCUPANT	2050 S MUSKEGO AVE	MILWAUKEE, WI 53204
CURRENT OCCUPANT	2124A S 23RD ST	MILWAUKEE, WI 53215
CURRENT OCCUPANT	2203 W BECHER ST	MILWAUKEE, WI 53215
CURRENT OCCUPANT	2043 S MUSKEGO AVE A	MILWAUKEE, WI 53204
CURRENT OCCUPANT	2112 S MUSKEGO AVE	MILWAUKEE, WI 53215
CURRENT OCCUPANT	2336A W BECHER ST	MILWAUKEE, WI 53215
CURRENT OCCUPANT	2211 W BECHER ST	MILWAUKEE, WI 53215
CURRENT OCCUPANT	2070 S MUSKEGO AVE	MILWAUKEE, WI 53204
CURRENT OCCUPANT	2120A S MUSKEGO AVE	MILWAUKEE, WI 53215
CURRENT OCCUPANT	2114 S MUSKEGO AVE	MILWAUKEE, WI 53215
CURRENT OCCUPANT	2111 S MUSKEGO AVE	MILWAUKEE, WI 53215
CURRENT OCCUPANT	2303 W BECHER ST	MILWAUKEE, WI 53215
CURRENT OCCUPANT	2342A W BECHER ST	MILWAUKEE, WI 53215

Total Records: 72

Radius: 250.0 feet and Center of Circle: 2082 S Muskego Ave



BUSINESS LICENSE PLAN OF OPERATION

ccl-busplan 3/15/18

Office of the City Clerk License Division
200 E. Wells St. Room 105, Milwaukee, WI 53202
(414) 286-2238 www.milwaukee.gov/license e-mail address: license@milwaukee.gov

1. Type of Business

Applying for: Extended Hours (12AM to 5AM) - If a food establishment, check all that apply: Delivery Drive Thru Dining Room
 Self Service Laundry Massage Establishment Filling Station
 Other (supplemental application for specific license also required)

Provide a detailed description of the type of business you plan on operating:

Convenience store.

Do you have any experience operating this type of business? No Yes If yes, explain:

2. Business Operations

- a. Proposed Opening Date: 11/10/2019
- b. Is this premise under construction? No Yes If yes, list estimated completion date: _____
- c. Is this a franchise? No Yes
- d. Is this premises currently licensed? No Yes If yes, list type of license: Food Dealer; Cig./tobacco; Beer
- e. Is the current licensee operating? No Yes If no, list date closed: _____
- f. Do you have future plans for other businesses, licenses or permits at this location? No Yes
If yes, explain: _____
- g. Have you previously held an Extended Hours License in Milwaukee? No Yes
If yes, list address(es): _____
- h. Are other businesses operating in the same building? No Yes If yes, describe: _____

3. Litter & Noise

- a. How are grounds kept clean? Sweep Pressure Wash Pick Up Litter Other: _____
- b. How often will grounds be cleaned? Daily Weekly As Needed Monthly Other: _____
- c. Grounds cleaned by: Licensee Building Owner Employees Hired Maintenance Other: _____
- d. How are noise issues prevented and/or addressed? Security Manager approaches customer(s) Call Police
 Signs Posted Other: _____
- e. Will a sound amplification system be used? No Yes If yes, describe: _____

4. Smoking & Sanitation

- a. Are there designated outdoor smoking areas? No Yes If yes, describe: _____
- b. Number of Garbage Cans: Inside: 3 Locations: Cashier, entrance door, exit door
Outside: 1 Locations: entrance door
- c. Is a crowd control barrier used? No Yes If yes, describe: _____
- d. How many restrooms are on the premises? 1
- e. Name of solid waste contractor: Advanced Disposal Waste Management Other: _____

5. Security

- a. Are there onsite parking spaces? No Yes If yes, how many? _____ and describe the parking security plan: _____
- b. Is there a loading zone? No Yes If yes, describe the loading area security plan: _____
- c. Will you have security personnel on premise? No Yes If yes, how many? _____ and answer the following:
 What are their responsibilities? _____
 Is security equipment used? No Yes If yes, describe _____
 List their licensing, certification, or training credentials _____
- d. Will there be security cameras? No Yes If yes, how many? 3 and list locations: Above cashier, by entrance door and by exit door.
- e. Will searches/identification checks be done upon entry? No Yes If yes, describe _____

6. Percentage of Sales (must total 100%)

Alcohol <u>20</u> %	Food <u>50</u> %	Secondhand Merchandise _____ %	Precious Metals & Gems _____ %
Entertainment _____ %	Cigarettes <u>30</u> %	Personal Services (such as tattoo, body piercing, salon, tailor, tanning, etc.) _____ %	Other _____ % Describe: _____
Pawnbroker Activity _____ %	Salvaged Materials _____ % (such as scrap metal)		

7. Businesses/Licenses on the Premises (check all that apply):

Type 1

- Full Service Restaurant Cafe/Coffee Shop Deli or Fast Food Restaurant Private/Fraternal/Veterans Club
- Night Club Tavern Cocktail Lounge Teen Club
- Banquet Hall Sports Facility Bowling Alley
- Hotel/Motel: Number of Floors: _____ Rooming House: Number of Floors: _____
 Number of Rooms: _____ Number of Rooms: _____

Type 2

- Liquor Store Corner Store Supermarket Convenience Store
- Gas Station Amusement/Phonograph Distributor Recycling, Salvage or Towing
- Used Car Dealer Personal Service Establishment
(such as tattoo business, hair salon, tailor, etc.) Recording Studio

What other licenses/permits will you hold at this location? (check all that apply)

- Occupancy Permit Cigarette & Tobacco Gas Station Extended Hours Class "B" Tavern Weights & Measures
 Secondhand Dealer Precious Metal & Gem Other: _____

8. Legal Capacity (only if a Type 1 premises in #7 above)

Capacity _____ (Call the Milwaukee Development Center at 414-286-8211 if you have questions.)

9. Premises Description

a. Identify all area(s) of the premises that will be used in operating this business (include areas used only for storage):

1st Floor 2nd Floor Basement Storage Patio Beer Garden Sidewalk Café Deck Rooftop

Other: Describe: _____

b. Describe Location: Major Thoroughfare Secondary Street Other: _____

c. Nearest Major Cross Street: Muskego Ave.

d. Describe Building: Free Standing Building Strip Mall Other: _____

e. Describe Premises Structure: Single Story Multi-Story - # of Stories 2 Other: _____

f. Describe Surrounding Area: Commercial Residential Industrial Other: _____

g. Building Owner Name: Atary Investments LLC Phone Number: 414-975-7291

Business Owner Address: 2082 S. Muskego Ave Milwaukee WI 53204

10. Hours of Operation & Customers

Will customers be entering the premises? No Yes

Day of the Week	Proposed Hours of Operation:		Estimated Number of Customers expected each day	Potential Age Range of Customers	Class B Tavern Applicant Only: Age Restriction (If none, write 'None')
	Open Time (include a.m. or p.m.)	Close Time (include a.m. or p.m.)			
Sunday	9am	9pm	30	18+	
Monday	9am	9pm	30	18+	
Tuesday	9am	9pm	30	18+	
Wednesday	9am	9pm	30	18+	
Thursday	9am	9pm	30	18+	
Friday	9am	9pm	30	18+	
Saturday	9am	9pm	30	18+	

An Extended Hours Establishment License is required for any convenience store, filling station, personal service establishment (such as tattoo, body piercing, salon, tailor, tanning, etc.), recording studio or restaurant which is open between the hours of 12:00 a.m. and 5:00 a.m.

Alcohol Establishments Permitted Hours of Operation: Class A: 8:00 am to 9:00 pm Sunday thru Saturday
Class B: 6:00 am to 2:00 am Sunday thru Thursday, 6:00 am to 2:30 am Friday & Saturday

Entertainment Outdoor-Closing Hours: 10:00pm Sunday-Thursday; 12:00am Friday & Saturday; unless a different time, either earlier or later, is established by the Common Council in its approval of the licensee's plan of operation.

11. Signature(s)

Rita Bhatt

Signature of Sole Proprietor, Partner, or 20% or more Shareholder
(If there are no 20% or more shareholders,
Corporate Officer-print name/title and sign)

Signature of additional partner or 20% or more shareholder

See Application Information for a complete list of all required application forms.



ALCOHOL BEVERAGE & PUBLIC ENTERTAINMENT PREMISES SUPPLEMENTAL APPLICATION

Office of the City Clerk License Division
200 E. Wells St. Room 105, Milwaukee, WI 53202
(414) 286-2238 e-mail address: license@milwaukee.gov www.milwaukee.gov/license

Legal Entity Name: <u>Punjab Food LLC</u>
Premise Address: <u>2082 S. Muskego Ave Milwaukee, WI 53204</u>
Proximity of Premises to Church, School, Daycare Center or Hospital
Is the building within 300 feet of any church, school, daycare center or hospital? <input checked="" type="checkbox"/> No <input type="checkbox"/> Yes
"Service Bar Only" Designation
If applying for Class B or C license, are you applying for "Service Bar Only"? <input checked="" type="checkbox"/> No <input type="checkbox"/> Yes Service Bar Only means customers cannot sit at the bar. Alcohol is served to employees who serve patrons seated at tables. No stools, chairs or other articles of furniture shall be placed at the service bar for patrons to sit upon.
Business Information
a) Are you taking out this application for anyone that may not be eligible for a license? <input checked="" type="checkbox"/> No <input type="checkbox"/> Yes If yes, list their name and address: _____
b) Will the agent, a partner or the individual licensee be conducting the day-to-day operations of the business? <input type="checkbox"/> No <input checked="" type="checkbox"/> Yes If no, list the name and address of the person(s) who will: _____ _____ Class B Applicants: If the agent, a partner or the individual licensee will not be conducting the day-to-day operations of the business, the person(s) listed above must obtain a Class B Managers license.
c) Does anyone else have money invested or any other interest in this business? <input checked="" type="checkbox"/> No <input type="checkbox"/> Yes If yes, explain: _____
d) Have you made an agreement with anyone to repay any loan or any other payments based upon income from the business? <input checked="" type="checkbox"/> No <input type="checkbox"/> Yes If yes, list name and address: _____
Proof of Ownership, Lease, or Offer to Purchase (New & Transfer Applicants Only)
Submit proof of ownership, lease, or offer to purchase the building with this application. A lease or offer to purchase must: a) Be in the same legal entity name as that apply for the license b) Reflect the same address as the premises address on this application c) Reflect current dates and d) Be signed by the lessor/seller and lessee/buyer
Property Information (New & Transfer Applicants Only)
a) Do you own or lease the building? <input type="checkbox"/> Own <input checked="" type="checkbox"/> Lease
b) Who owns the fixtures (for example, coolers, etc.)? <u>Applicant</u>
c) Are you purchasing the stock and/or fixtures? <input checked="" type="checkbox"/> No <input type="checkbox"/> Yes If yes, amount paid \$ _____
d) Total amount paid for business \$ <u>51,000</u>
e) Total amount paid for goodwill of the business \$ <u>0</u> Goodwill comprises the reputation and customer relationships of an existing business. If the price you pay for the business exceeds the fair market value of all of the rest of the assets of the business, the excess may be considered goodwill.
f) Have you made arrangements with the seller for payment of personal property taxes? <input checked="" type="checkbox"/> No <input type="checkbox"/> Yes

See Application Information for a list of all required application forms.

Lease Information (New & Transfer Applicants who are leasing the premises only)

- a) Date lease begins Nov. 1, 2019 Ends Oct 29, 2029
- b) Monthly rental \$ 1350
- c) Do you have an option to renew the lease? No Yes
- d) Does your lease allow for assignment to another party without the consent of the owner? No Yes
- e) For what length of time have you been guaranteed occupancy (number of years)? 10
- f) In addition to paying the monthly rental, will you have to pay anything additional to the owner of the building to guarantee performance of the lease? No Yes If yes, explain _____
- g) Does the present owner or occupancy object to the granting of your license? No Yes
If yes, explain _____

Change of Agent Applicants Only

Have there been any changes to the floor plan since the last application was submitted? No Yes

If no, a new floor plan is not required. If yes, submit a new floor plan and explain the change(s): _____

Signature

Rita Bhatt

Signature of Sole Proprietor, Partner or 20% or More Shareholder
(If no 20% or more Shareholder, Corporate Officer - print name/title and sign)

Note: All information contained in this application is subject to approval by the Common Council.
Deviating from approved plan of operation will subject licensee to citations, and/or suspension or non-renewal of the license.
Contact the License Division for information on how to request changes.

New and transfer of premises applicants must submit the following:

- Proof of ownership, lease or offer to purchase the building
- Detailed floor plan
- If a restaurant, copy of the menu



FOOD DEALER LICENSE PLAN OF OPERATION

OFFICE OF THE CITY CLERK, LICENSE DIVISION
 CITY HALL, 200 E. WELLS ST, ROOM 105, MILWAUKEE, WI 53202
 (414) 286-2238 • license@milwaukee.gov • www.milwaukee.gov/license

Legal Entity Name: Punjab Food LLC
 Premises Address: 2082 S. Muskego Ave Milwaukee, WI 53204

SECTION 1 TYPE OF BUSINESS

What will be the majority of your food sales? (check one)

- Restaurant Items (meals):
 MEALS include, but are not limited to, chicken, ribs, sandwiches, roasted corn, baked potatoes, hot dogs, brats, tacos, nachos w/ cheese and meat, French fries, cooked or deep fried vegetables/fruit, cooked cheese curds, corn dogs, egg rolls, salads.
- Retail Items (snacks and beverages):
 RETAIL items include, but are not limited to, ice cream/soft serve, lemonade, snow cones, coffee, espresso, cappuccino, tea, fruit juice, smoothies, candy, dispensed soda, fruit cups, bakery, cookies, kettle corn, cotton candy, funnel cakes, fritters, tortilla chips w/ cheese.

Will it be a convenience store? Yes No

A convenience store contains less than 5,000 square feet of retail space and has, as its primary business, the sale of basic food items and in addition, sells household products or is a filling station that sells basic food items and household products.

- Bed & Breakfast
- Micro Market

All Applicants: Submit a menu or a list of food items that will be sold.

Will any wholesale business be done? No Yes If yes, what percentage of food sales will be wholesale?

Less than 25%

25% or More AND:

Restaurant items (meals) will be sold – Complete this application and also contact DATCP.

NO restaurant items (meals) will be sold - Do NOT complete this application. Contact DATCP only.

SECTION 2 FOOD PROCESSING

Will any food processing be done? No Yes

Processing is defined as assembling, grinding, cutting, mixing, baking, coating, stuffing, packing, bottling, grilling, canning, extracting, fermenting, distilling, pickling, freezing, drying, smoking, or packaging.

SECTION 3 FOOD REQUIRING TEMPERATURE CONTROL

Will any food that requires temperature control be sold? No Yes
 (includes dairy products such as milk, cheese, and ice cream, fish, shellfish, meat, poultry)

If yes, list the types of food items: milk, cheese, eggs, ice cream

SECTION 4 DETAILS OF OPERATION

- Will you have seating on site for dining? No Yes
- Will you be doing any catering? No Yes
- Will you be doing any delivery? No Yes
- Will you have outdoor activities? No Yes - Check all that apply: Bar Cooking/Grilling Dining
- Will you have a drive thru window? No Yes - Are hours different from inside? No Yes
 If Yes, provide drive thru hours: _____
- Will scales or barcode scanners be used? No Yes - You must also apply for a Weights & Measures License.

SECTION 5 ADDITIONAL SITES

Where will food be prepared and/or sold?
 At a single site At multiple sites: How many? _____ (for example, a hotel with several dining rooms or bars)
 If multiple sites, attach a Food Dealer Additional Site Addendum (ccl-foodadd) for each additional site.

SECTION 6 CONSTRUCTION OR CHANGES

Are you planning any construction, remodeling or equipment changes?
 No If No, SKIP to Section 8
 Yes If Yes, check all that apply: New construction of a building Renovation or remodeling
 Construction changes to existing building Equipment changes only

Provide a brief description of the changes: _____

Start date: _____

Name, Address & Phone Number of Architect: _____

Name, Address & Phone Number of Contractor: _____

SECTION 7 ALCOHOL BEVERAGES

Are you applying for an alcohol beverage license?
 No If No, SKIP to Section 9
 Yes If YES, if your food license is approved prior to the alcohol license, when do you want the food license issued?
 Immediately At the same time as the alcohol license

SECTION 8 ACKNOWLEDGEMENTS & SIGNATURE

You must initial each item confirming your understanding:

RB I understand the Health Department must conduct an inspection and advise the License Division of their approval before the license may be issued.

RB I understand I must obtain an occupancy permit from the Department of Neighborhood Services and an inspection may be required. Neighborhood Services must advise the License Division of their approval before the license may be issued.

RB I understand the district alderperson will review and either support or object to my application. If he/she objects, I may appeal and be scheduled to appear before the Licenses Committee. The Licenses Committee will then make a recommendation to the Common Council. The Common Council must grant the license before it may be issued.

RB I understand proof of payment for all license fees must be on file in the License Division before the license may be issued and the license must be issued and posted in my establishment prior to opening for business.

RB I will not operate my food business until the license has been issued and posted in the establishment.

Signature of Sole Proprietor, Partner, or 20% Shareholder: Nita Bhatti

Signature of Additional Partner: _____

Punjab Food LLC
 Agent: Rita Bhatti
 2082 S. Muskego Ave
 Milwaukee, WI 53204-3622

Square
 Feet = 1,750

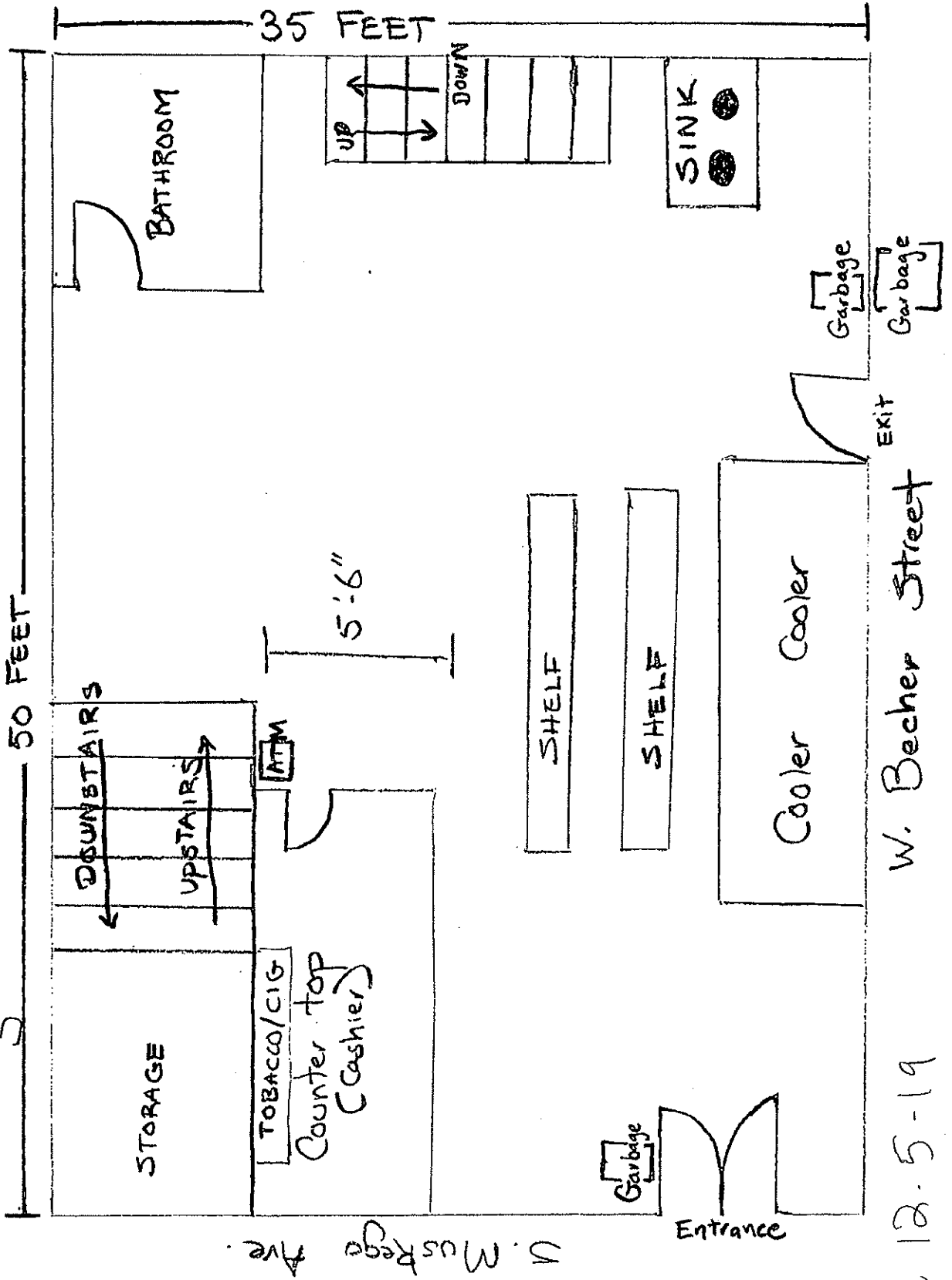
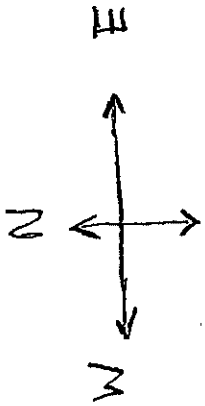

W. Becher Street

Date 12.5-19

Punjab Food LLC
Agnit, Rita Bhatti
2082 S. Muskego Ave
Milwaukee, WI 53204
3022

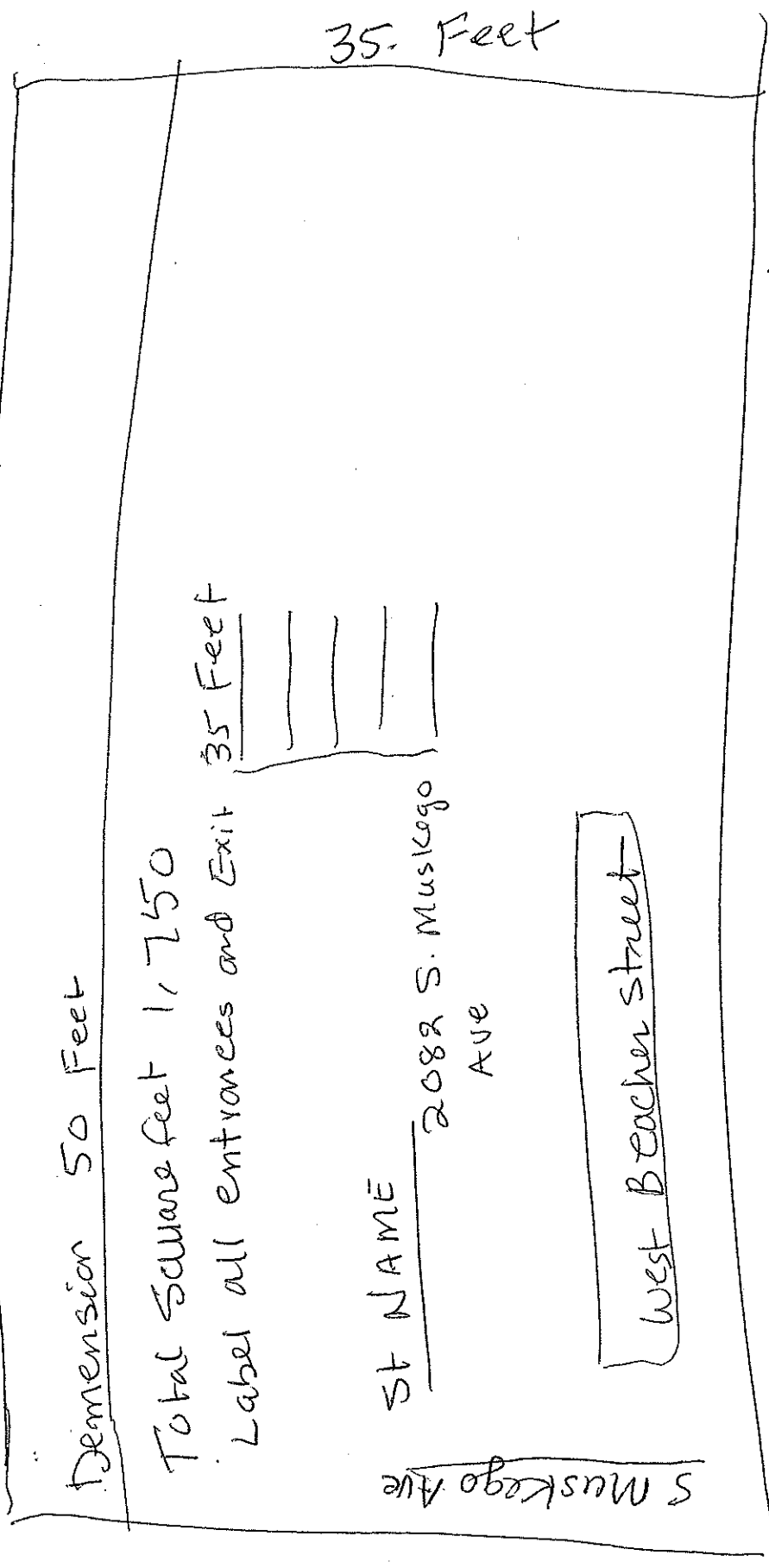
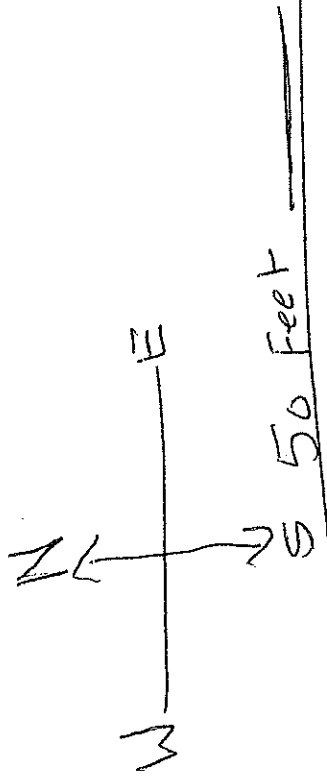

Date 12.5-19

Cigaretts

Beer

Soda

Soap

Eggs

Breads

HOME staf

For cleaning

Dishes

Clothes

Sacks

gloves

Chips

all kinds

Candy

Dounts

Beers

Juices

Butter

~~Beer~~
New port
Cigaret

Food



**CITY OF MILWAUKEE
OFFICE OF THE CITY CLERK**

Thursday, January 16, 2020

COMMITTEE MEETING NOTICE

AD 08

HYLAND, Eric J, Agent
EL REY PLAZA, INC
3524 W BURNHAM St

MILWAUKEE, WI 53215

You are requested to attend a hearing which is to be held in Room 301-B, Third Floor, City Hall on:

Tuesday, January 28, 2020 at 10:00 AM

Regarding: Your Class A Retailer's Intoxicating Liquor License Application as agent for "EL REY PLAZA, INC" for "EL REY PLAZA SUPERMARKET" at 3524 W BURNHAM St.

There is a possibility that your application may be denied for one or more of the following reasons: The recommendation of the committee regarding the application shall be based on evidence presented at the hearing. Per MCO 85-2.7-4, probative evidence concerning whether or not a new license should be granted may be presented on the following subjects: whether or not the applicant meets the municipal requirements, the appropriateness of the location and premises where the licensed premises is to be located and whether use of the premises for the purposes or activities permitted by the license would tend to facilitate a public or private nuisance or create undesirable neighborhood problems such as disorderly patrons, unreasonably loud noise, litter, and excessive traffic and parking congestion. Probative evidence relating to these matters may be taken from the plan of operation submitted with the license application, if any, but shall not include the content of any music. Evidence regarding the fitness of the location of the premises to be maintained as the principal place of business, including but not limited to whether there is an overconcentration of businesses of the type for which the license is sought; whether the proposal is consistent with any pertinent neighborhood business or development plans, or the location's proximity to areas where children are typically present. The applicant's record in operating similarly licensed premises; and whether or not the applicant has been charged with or convicted of any felony, misdemeanor, municipal offense or other offense, the circumstances of which substantially relate to the activity to be permitted by the license being applied for or any other factor which reasonably relates to the public health, safety or welfare may also be considered. See attached police report or correspondence.

Notice for applicants with warrants or unpaid fines:

Proof of warrant satisfaction or payment of fines must be submitted at the hearing on the above date and time. Failure to comply with this requirement may result in a delay of the granting/denial of your application.

Failure to appear at this meeting may result in the denial of your license. Individual applicants must appear only in person or by an attorney. Corporate or Limited Liability applicants must appear only by the agent designated on the application or by an attorney. Partnership applicants must appear by a partner listed on the application or by an attorney. If you wish to do so and at your own expense, you may be accompanied by an attorney of your choosing to represent you at this hearing.

You will be given an opportunity to speak on behalf of the application and to respond and challenge any charges or reasons given for the denial. No petitions can be accepted by the committee, unless the people who signed the petition are present at the committee hearing and willing to testify. You may present witnesses under oath and you may also confront and cross-examine opposing witnesses under oath. If you have difficulty with the English language, you should bring an interpreter with you, at your expense, so that you can answer questions and participate in your hearing.

You may examine the application file at this office during regular business hours prior to the hearing date. Inquiries regarding this matter may be directed to the person whose signature appears below.

Limited parking for persons attending meetings in City Hall is available at reduced rates (5 hour limit) at the Milwaukee Center on the southwest corner of East Kilbourn and North Water Street. Parking tickets must be validated in the first floor information booth in City Hall.

PLEASE NOTE: Upon reasonable notice, efforts will be made to accommodate the needs of disabled individuals through sign language interpreters or other auxiliary aids. For additional information or to request this service, contact the Council Services Division ADA Coordinator at (414) 286-2998, Fax - (414) 286-3456, TDD - (414) 286-2025.

JIM OWCZARSKI, CITY CLERK

BY: _____

Jessica Celella

License Division Manager

If you have questions regarding this notice, please contact the License Division at (414) 286-2238.

200 E. Wells Street, Room 105, City Hall, Milwaukee, WI 53202. www.milwaukee.gov/license
Phone: (414) 286-2238 Fax: (414) 286-3057 Email Address: License@milwaukee.gov



**CITY OF MILWAUKEE
OFFICE OF THE CITY CLERK**

Thursday, January 16, 2020

COMMITTEE MEETING NOTICE

AD 08

HYLAND, Eric J, Agent
EL REY PLAZA, INC
N29W30799 Foxwood Dr

Pewaukee, WI 53072

You are requested to attend a hearing which is to be held in Room 301-B, Third Floor, City Hall on:

Tuesday, January 28, 2020 at 10:00 AM

Regarding: Your Class A Retailer's Intoxicating Liquor License Application as agent for "EL REY PLAZA, INC" for "EL REY PLAZA SUPERMARKET" at 3524 W BURNHAM St.

There is a possibility that your application may be denied for one or more of the following reasons: The recommendation of the committee regarding the application shall be based on evidence presented at the hearing. Per MCO 85-2.7-4, probative evidence concerning whether or not a new license should be granted may be presented on the following subjects: whether or not the applicant meets the municipal requirements, the appropriateness of the location and premises where the licensed premises is to be located and whether use of the premises for the purposes or activities permitted by the license would tend to facilitate a public or private nuisance or create undesirable neighborhood problems such as disorderly patrons, unreasonably loud noise, litter, and excessive traffic and parking congestion. Probative evidence relating to these matters may be taken from the plan of operation submitted with the license application, if any, but shall not include the content of any music. Evidence regarding the fitness of the location of the premises to be maintained as the principal place of business, including but not limited to whether there is an overconcentration of businesses of the type for which the license is sought; whether the proposal is consistent with any pertinent neighborhood business or development plans, or the location's proximity to areas where children are typically present. The applicant's record in operating similarly licensed premises; and whether or not the applicant has been charged with or convicted of any felony, misdemeanor, municipal offense or other offense, the circumstances of which substantially relate to the activity to be permitted by the license being applied for or any other factor which reasonably relates to the public health, safety or welfare may also be considered. See attached police report or correspondence.

**Notice for applicants with
warrants or unpaid fines:**

Proof of warrant satisfaction or payment of fines must be submitted at the hearing on the above date and time. Failure to comply with this requirement may result in a delay of the granting/denial of your application.

Failure to appear at this meeting may result in the denial of your license. Individual applicants must appear only in person or by an attorney. Corporate or Limited Liability applicants must appear only by the agent designated on the application or by an attorney. Partnership applicants must appear by a partner listed on the application or by an attorney. If you wish to do so and at your own expense, you may be accompanied by an attorney of your choosing to represent you at this hearing.

You will be given an opportunity to speak on behalf of the application and to respond and challenge any charges or reasons given for the denial. No petitions can be accepted by the committee, unless the people who signed the petition are present at the committee hearing and willing to testify. You may present witnesses under oath and you may also confront and cross-examine opposing witnesses under oath. If you have difficulty with the English language, you should bring an interpreter with you, at your expense, so that you can answer questions and participate in your hearing.

You may examine the application file at this office during regular business hours prior to the hearing date. Inquiries regarding this matter may be directed to the person whose signature appears below.

Limited parking for persons attending meetings in City Hall is available at reduced rates (5 hour limit) at the Milwaukee Center on the southwest corner of East Kilbourn and North Water Street. Parking tickets must be validated in the first floor information booth in City Hall.

PLEASE NOTE: Upon reasonable notice, efforts will be made to accommodate the needs of disabled individuals through sign language interpreters or other auxiliary aids. For additional information or to request this service, contact the Council Services Division ADA Coordinator at (414) 286-2998, Fax - (414) 286-3456, TDD - (414) 286-2025.

JIM OWCZARSKI, CITY CLERK

BY: _____

Jessica Celella

License Division Manager

If you have questions regarding this notice, please contact the License Division at (414) 286-2238.

200 E. Wells Street, Room 105, City Hall, Milwaukee, WI 53202. www.milwaukee.gov/license
Phone: (414) 286-2238 Fax: (414) 286-3057 Email Address: License@milwaukee.gov

Date: 1/2/20
Officer: PO Matthew Diener

City of Milwaukee Police Department
90-5-1.5 Crime Prevention Survey
Convenience Store/Liquor Store Inspection

Name of Premise: El Rey Grocery
Address: 3524 W Burnham St
Phone: 414-643-1616

Owner: Eric J HYLAND
Owner address: N29W30799 Foxwood Dr
City State Zip: Pewaukee, WI 53072
Owner Phone: 414-405-7026
Owner email: jason@elreyfoods.com

Manager: same
Home Address:
City State Zip:
Phone:
Email:

Preferred contact: Phone

Location currently open: YES NO

Projected open date:

Day's open: S M T W Th F SA ALL

Hours of Operation: Sun: 7a-9p 24 hours Y N
Mon: 7a-9p
Tue: 7a-9p
Wed: 7a-9p
Thu: 7a-9p
Fri: 7a-9p
Sat: 7a-9p

Premise Type: Liquor Store
Convenience Store
Other: Grocery store

Licenses currently held:

Alcohol: Yes No Class: #:
Tobacco: Yes No #: 1028083
Food: Yes No #: 10563
Extended Hours: Yes No #:
Secondhand Dealer: Yes No Type: #:
Other: Yes No Type: W&M #: 4844
Other: Yes No Type: #:

Exterior Survey:

1. Is the area around the location clean? Yes No
2. What surrounds the location? (Check all the apply)
 - a. Park
 - b. School
 - c. Youth Center
 - d. Church
 - e. Tavern(s) If so, how many
 - f. Residential
 - g. Other businesses
 - h. Other:
3. Can you see from the outside of the location into the interior Yes No
4. Can you see the employees inside of the location from the outside Yes No
5. Are exterior windows free of signage Yes No
6. Is there a parking lot Yes No
7. Is the parking lot clean? Yes No
8. Is the parking lot well lit? Yes No
9. Are there areas where a person could conceal themselves Yes No
10. Is there exterior lighting? Yes No. Does it appears to be adequate Yes No
11. Exterior Payphone? Yes No
12. Are there No Loitering Signs posted? Yes No
13. Are there exterior security cameras Yes No How Many: 4
14. Are the address numbers prominently displayed and easy to see Yes No

Camera Survey:

15. Does this location have security cameras? Yes No
16. Are they in working order? Yes No
17. What format are the cameras?
 - a. Color Yes No
 - b. Digital Yes No
 - c. VCR Yes No
 - d. Recorded Yes No
18. How long is footage stored for later viewing: 30 days (will be 15 days after new camera installation)
19. Are there exterior cameras Yes No How many: 4 (2 more to be installed soon)
20. Are there interior cameras Yes No How many: 21
21. Do all employees know how to retrieve recorded digital images/footage? Yes No

Licenses currently held:

Alcohol:

Tobacco:

Food:

Yes No (Class)

Yes No # 1028063

Yes No # 1028063

Interior Survey:

- 22. Is the storeowner willing to be a standing complainant regarding loitering? Yes No
 - a. If yes have them fill out the standing complaint form and give them two of the commercial signs Yes No
- 23. Is the interior of the location neat and clean? Yes No
- 24. Does an interior camera face the entrance/exit? Yes No
- 25. Is there a lockable area that separates employees from customers? Yes No
- 26. Does the store sell single chore boy? Yes No
- 27. Does the store sell blunt wraps? Yes No
- 28. Does the store sell scales? Yes No
- 29. Does the store sell items that may be used as crack pipes? Yes No
 - a. Describe item
- 30. Does the store have an over abundance of sandwich baggies? Yes No
- 31. Does the owner understand that these items are often used for drug use? Yes No
- 32. Do the products in the store appear to be new and rotated often? Yes No
- 33. Are emergency and non-emergency numbers posted near the phone? Yes No
- 34. Does the owner know how to contact their police district directly? Yes No
 - a. Did you provide a district contact guide to the owner? Yes No

Complete this section if alcohol establishment is a convenience store:

(** Read full ordinance for all details "68-4.3 Convenience Food Stores")

All convenience food stores not exempted under sub. 3 shall:

- 1. Is the cash register located in a manner so that at the time of a sales transaction, the employee and customer are both visible from the sidewalk? Yes No **
- 2. Are the glass entrance and exit doors clear of any signs or advertisements with the exception of a sign which states that the cash register contains \$50 or less and that the safe is no accessible to employees? Yes No
- 3. Does the store maintain one of the following on the licensed premise:
 - a. A safe that was in use at the convenience food store on August 17, 1994? Yes No
 - b. A drop-safe or time release safe that weighs at least 500 pounds or which is attached to or set into the floor in a manner approved by the police department? Yes No
- 4. Is lighting provided for the store's parking area during all hours of darkness when employees or customers are on the premises at a minimum average of 2-foot candles per square foot, unless the store is not open for business after sunset and before sunrise? Yes No N/A
- 5. Are at least two high-resolution surveillance security cameras installed? Yes No
- 6. Are the security cameras in working order? Yes No
- 7. Does one camera show an overall view of the counter and register area? Yes No
- 8. Does one camera show a clear, identifiable, full frame image of the face of each person entering and leaving the store? Yes No
- 9. Are the camera views obstructed by fixtures or displays? Yes No
- 10. Is the recorded footage stored for at least 30 days? Yes No

11. Do all store employees know how to record footage from the camera system to media capable of being transferred to police custody? Yes No
12. Are customer entrances/exits made of glass or other transparent material? Yes No
- a. Exception: A store that does not have such doors on August 17, 1994 shall not be required to install such doors until the holder of the store's food dealer license changes.
13. Has the owner and their employees attended the Robbery Prevention Training within 120 days of ownership or employment? Yes No
- a. Contact Community Outreach and Education at 935-7836 for schedule.

Sub 3. Exemptions. The requirements of this section do not apply to a convenience food store that conforms to either of the following descriptions:

- a-1. The store is located in an enclosed shopping structure, enclosed commercial building or hospital. A convenience food store is not in an enclosed structure or building if a customer can enter it directly from the outside.
Does store conform to a-1 Yes No
- a-2. The store physically separates employees from customers with a solid partition that bars a person from entering the employee area from the customer area, has a secure lock on the employee side of any door between the employee area and the customer, and conducts all transaction through a service window or similar arrangement.
Does store conform to a-2 Yes No
- a. At the commissioner's discretion, a convenience store may be exempted from any or all of the regulations specified in sub 2.
Does this location hold an exemption from the commissioner regarding any of the requirements of Sub 2? Yes No

ADDITIONAL COMMENTS/RECOMMENDATIONS:

The premise is El Rey Grocery Store, and the applicant plans to sell a limited amount of alcohol. The location does not currently sell beer and/or liquor. I provided the applicant with information for Robbery Prevention Training, although since the premise is not a "convenience store", I advised the applicant that it might not be necessary. The location has armed security daily to prevent retail thefts and other incidents at the premise. I also advised the applicant to contact the WI Department of Revenue for any further instruction regarding new alcohol sales at the premise.



Concentration Map

3524 W Burnham Street

Area : 21,862,585.72 ft²

Dec 18 2019 11:00:49 Central Standard Time

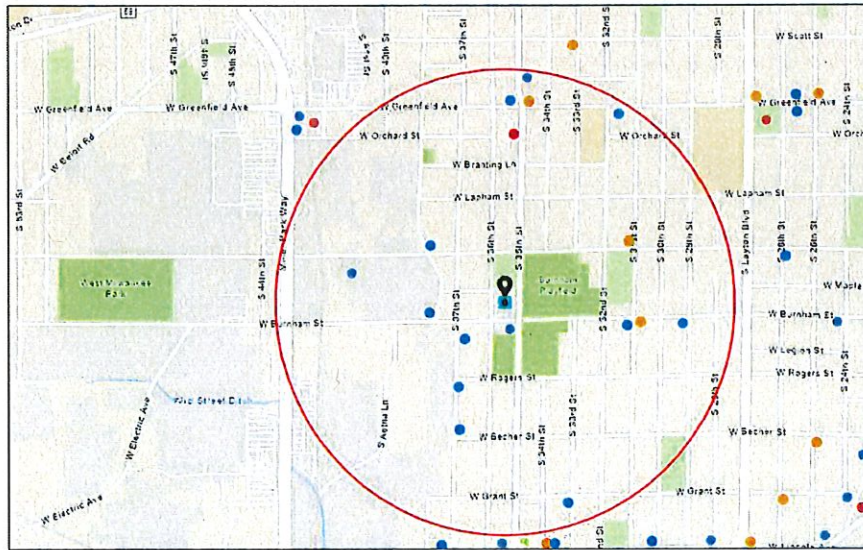

- | | | |
|-----------------------------------|--------------------------------|----------------------------|
| Alcohol Licenses | Class A Liquor and Malt | Food Licenses |
| ● Class A Intoxicating Liquor | ● Class B Tavern | ● Food Dealer - Retail |
| ● Class A Fermented Malt Beverage | | ● Food Dealer - Restaurant |

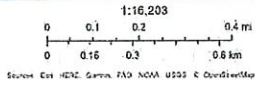

Summary

Name	Count	Area(ft ²)	Length(mi)
Alcohol Licenses	17		

Alcohol Licenses

#	Legal Entity	Trade Name	Licensee	Address	License Type Name	Total Capacity	Expiration Date	Count
1	Celebrity's Hall	Celebrity's Hall	Raul Varela-Rodriguez, SP	1329 S 35th ST	Class B Tavern License	91	4/4/2020, 7:00 PM	1
2	FIRST STOP FOODS	FIRST STOP FOODS	ABDELMUNA M AASAD, SP	1330 S 35TH ST	Class A Fermented Malt Beverage Retailer's License		12/19/2019, 6:00 PM	1
3	GOLD RUSH 1900, LLC	JO JO'S FRIED CHICKEN	YOUSEF N HINNAWI, Agt	1900 S 31ST ST	Class A Fermented Malt Beverage Retailer's License		1/17/2020, 6:00 PM	1
4	HALEY CORPORATION	JACKSON GRILL	HEIDI A SCHMIDT, Agt	3736 W MITCHELL ST	Class B Tavern License	55	11/4/2020, 6:00 PM	1
5	POLKA DOT SPIRITS, LLC	KOCHANSKI'S CONCERTINA BEER HALL	ANDREW J KOCHANSKI, Agt	1920 S 37TH ST	Class B Tavern License	80	11/3/2020, 6:00 PM	1
6	TORY OF MILWAUKEE, INC	MC KIERNANS	GENE M MC KIERNAN, Agt	2066 S 37TH ST	Class B Tavern License	99	5/30/2020, 7:00 PM	1
7	La Tapatia Mini Mart Inc	La Tapatia Mini Mart	Samuel Perez Vallejo, Agt	3100 W Mitchell ST	Class A Fermented Malt Beverage Retailer's License		10/13/2020, 7:00 PM	1
8	EL PARIAN	EL PARIAN	RICARDO MONTES ALVARADO, SP	2901 W BURNHAM ST	Class B Tavern License	60	11/11/2020, 6:00 PM	1
9	Hangoverz	Hangoverz	TINA M MINTO, SP	3121 W GREENFIELD AV	Class B Tavern License	25	1/22/2020, 6:00 PM	1
10	FIRST STOP FOODS	FIRST STOP FOODS	ABDELMUNA M AASAD, SP	1330 S 35TH ST	Class A Fermented Malt Beverage Retailer's License		12/19/2020, 6:00 PM	1
11	EL SENORIAL, LLC	EL SENORIAL	MIGUEL HUERTA, Agt	1901 S 31ST ST	Class B Tavern License	76	2/25/2020, 6:00 PM	1
12	Oscar's Winner's Circle LLC	Oscar's Winner's Circle	Elisabeth Stoeger, Agt	3800 W BURNHAM ST	Class B Tavern License	126	2/17/2020, 6:00 PM	1
13	CJ's Pub LLC	CJ's Pub	CORINA L WAGE, Agt	3643 W Rogers ST	Class B Tavern License	49	7/23/2020, 7:00 PM	1
14	TERRY SRA, LLC	Harbin Food & Beer	HARVENDER SINGH, Agt	3100 W MITCHELL ST	Class A Fermented Malt Beverage Retailer's License		1/15/2020, 6:00 PM	1
15	GOLD RUSH 1900, LLC	JO JO'S FRIED CHICKEN	YOUSEF N HINNAWI, Agt	1900 S 31ST ST	Class A Fermented Malt Beverage Retailer's License		1/17/2021, 6:00 PM	1
16	ALDI, INC	ALDI #87	Destiny S Fleischmann, Agt	1441 S 35TH ST	Class A Malt & Class A Liquor License		2/20/2020, 6:00 PM	1

17	CHILLY WILLYS SALOON	CHILLY WILLYS SALOON	DAVID W OLSON, SP	3301 W GRANT ST	Class B Tavern License	25	2/29/2020, 6:00 PM	1
----	----------------------------	----------------------------	----------------------	--------------------	------------------------------	----	-----------------------	---

Establishments within a 0.5 miles radius centered on area of Interest.



Thursday, January 16, 2020

Licenses Committee Notice of Hearing

El Rey Enterprises
5200 W Oklahoma Ave
Milwaukee, WI 53219

Date: 1/28/2020
Time: 10:00 AM
Location: Room 301-B, Third Floor, City Hall

The Licenses Committee will consider the following license application:

Class A Retailer's Intoxicating Liquor License Application
HYLAND, Eric J, Agent
EL REY PLAZA SUPERMARKET at 3524 W BURNHAM St

Please note this application may be recommended for denial based on fitness of the location due to concentration of alcohol beverage outlets in the area. If the application is denied for this reason, no other application for an alcohol beverage license for this location shall be recommended for approval by the Licenses Committee within three years of the date of denial unless the applicant has demonstrated a change of circumstances since the prior denial.

If you have any questions, please call (414) 286-2238.





Thursday, January 16, 2020

Licenses Committee Notice of Hearing

El Rey Enterprises
411 W Thornbush Cr
Hartland, WI 53029

Date: 1/28/2020
Time: 10:00 AM
Location: Room 301-B, Third Floor, City Hall

The Licenses Committee will consider the following license application:

Class A Retailer's Intoxicating Liquor License Application
HYLAND, Eric J, Agent
EL REY PLAZA SUPERMARKET at 3524 W BURNHAM St

Please note this application may be recommended for denial based on fitness of the location due to concentration of alcohol beverage outlets in the area. If the application is denied for this reason, no other application for an alcohol beverage license for this location shall be recommended for approval by the Licenses Committee within three years of the date of denial unless the applicant has demonstrated a change of circumstances since the prior denial.

If you have any questions, please call (414) 286-2238.





Thursday, January 16, 2020



Notice of Public Hearing

HYLAND, Eric J, Agent
EL REY PLAZA SUPERMARKET at 3524 W BURNHAM St
Class A Retailer's Intoxicating Liquor License Application

Tuesday, January 28, 2020 at 10:00 AM

To whom it may concern:

The above application has been made by the above named applicant(s). This requires approval from the Licenses Committee and the Common Council of the City of Milwaukee. The hearing before the Licenses Committee will take place on 1/28/2020 at 10:00 AM, in Room 301-B, Third Floor, City Hall. If you wish, you may provide testimony at the hearing regarding the request; see below for further information. You are not required to attend the hearing. Once the Licenses Committee makes its recommendation, this recommendation is forwarded to the full Common Council for approval at its next regularly scheduled hearing. Please review the information below and if you have further questions regarding this process, please contact the License Division at (414) 286-2238.

Important details for those wishing to provide information for the Licenses Committee to consider when making its recommendation:

1. The license application is scheduled to be heard at the above time. Due to other hearings running longer than scheduled, you may have to wait some time to provide your testimony.
2. You must appear in person and testify as to matters that you have personally experienced or seen. (You cannot provide testimony for your neighbor, parent or anyone else; this is considered hearsay and cannot be considered by the committee.)
3. No letters or petitions can be accepted by the committee (unless the person who wrote the letter or the persons who signed the petition are present at the committee hearing and willing to testify).
4. Persons opposed to the license application are given the opportunity to testify first; supporters may testify after the opponents have finished.
5. When you are called to testify, you will be sworn in and asked to give your name, and address. (If your first and/or last names are uncommon please spell them.)
6. You may then provide testimony.
 - a. Include only information relating to the above license application.
 - b. Include only information you have personally witnessed or seen.
 - c. Provide concise and relevant information detailing how this business has affected or may affect the peaceful enjoyment of your neighborhood.
 - d. If by the time you have the opportunity to testify, the information you wish to share has already been provided to the committee, you may state that you agree with the previous testimony. Redundant or repetitive testimony will not assist the committee in making its recommendation.
7. After giving your testimony, the members of the Licenses Committee and the licensee may ask questions regarding the testimony you have given or other factors relating to the license application.
8. Business Competition is not a valid basis for denial or non-renewal of a license.
Please Note: If you have submitted an objection to the above application your objection cannot be considered by the committee unless you personally testify at the hearing.

OCCUPANT	MAIL ADDRESS	CITY, STATE ZIP
CURRENT OCCUPANT	3617 W BURNHAM ST	MILWAUKEE, WI 53215
CURRENT OCCUPANT	3601 W BURNHAM ST A	MILWAUKEE, WI 53215
CURRENT OCCUPANT	3624 W BURNHAM ST	MILWAUKEE, WI 53215
CURRENT OCCUPANT	3623 W MAPLE ST	MILWAUKEE, WI 53215
CURRENT OCCUPANT	1921 S 36TH ST	MILWAUKEE, WI 53215
CURRENT OCCUPANT	3625 W BURNHAM ST	MILWAUKEE, WI 53215
CURRENT OCCUPANT	3618 W BURNHAM ST	MILWAUKEE, WI 53215
CURRENT OCCUPANT	3610 W BURNHAM ST	MILWAUKEE, WI 53215
CURRENT OCCUPANT	3629 W MAPLE ST	MILWAUKEE, WI 53215
CURRENT OCCUPANT	3614A W MAPLE ST	MILWAUKEE, WI 53215
CURRENT OCCUPANT	1729 S 36TH ST	MILWAUKEE, WI 53215
CURRENT OCCUPANT	3618 W BURNHAM ST A	MILWAUKEE, WI 53215
CURRENT OCCUPANT	3603 W MAPLE ST	MILWAUKEE, WI 53215
CURRENT OCCUPANT	3601 W BURNHAM ST	MILWAUKEE, WI 53215
CURRENT OCCUPANT	3613 W MAPLE ST	MILWAUKEE, WI 53215
CURRENT OCCUPANT	3623A W MAPLE ST	MILWAUKEE, WI 53215
CURRENT OCCUPANT	3622 W MAPLE ST	MILWAUKEE, WI 53215
CURRENT OCCUPANT	3618 W MAPLE ST	MILWAUKEE, WI 53215
CURRENT OCCUPANT	1728 S 37TH ST	MILWAUKEE, WI 53215
CURRENT OCCUPANT	3622 W BURNHAM ST	MILWAUKEE, WI 53215
CURRENT OCCUPANT	3604 W BURNHAM ST	MILWAUKEE, WI 53215
CURRENT OCCUPANT	3619 W MAPLE ST	MILWAUKEE, WI 53215
CURRENT OCCUPANT	1727 S 36TH ST	MILWAUKEE, WI 53215
CURRENT OCCUPANT	3610A W BURNHAM ST	MILWAUKEE, WI 53215
CURRENT OCCUPANT	3614 W MAPLE ST	MILWAUKEE, WI 53215
CURRENT OCCUPANT	1719 S 36TH ST	MILWAUKEE, WI 53215
CURRENT OCCUPANT	3609 W MAPLE ST	MILWAUKEE, WI 53215
CURRENT OCCUPANT	3604 W MAPLE ST	MILWAUKEE, WI 53215
CURRENT OCCUPANT	1735 S 36TH ST	MILWAUKEE, WI 53215
CURRENT OCCUPANT	1728A S 37TH ST	MILWAUKEE, WI 53215
CURRENT OCCUPANT	1717 S 36TH ST	MILWAUKEE, WI 53215

Total Records: 31

Radius: 250.0 feet and Center of Circle: 3524 W Burnham St



BUSINESS LICENSE PLAN OF OPERATION

ccl-busplan 3/15/18

Office of the City Clerk License Division
200 E. Wells St. Room 105, Milwaukee, WI 53202
(414) 286-2238 www.milwaukee.gov/license e-mail address: license@milwaukee.gov

1. Type of Business

Applying for: Extended Hours (12AM to 5AM) - If a food establishment, check all that apply: Delivery Drive Thru Dining Room
 Self Service Laundry Massage Establishment Filling Station
 Other (supplemental application for specific license also required)

Provide a detailed description of the type of business you plan on operating:

Grocery Store

Do you have any experience operating this type of business? No Yes If yes, explain:

2. Business Operations

- a. Proposed Opening Date: *when license issued*
- b. Is this premise under construction? No Yes If yes, list estimated completion date: _____
- c. Is this a franchise? No Yes
- d. Is this premises currently licensed? No Yes If yes, list type of license: _____
- e. Is the current licensee operating? No Yes If no, list date closed: _____
- f. Do you have future plans for other businesses, licenses or permits at this location? No Yes
If yes, explain: _____
- g. Have you previously held an Extended Hours License in Milwaukee? No Yes
If yes, list address(es): _____
- h. Are other businesses operating in the same building? No Yes If yes, describe: _____

3. Litter & Noise

- a. How are grounds kept clean? Sweep Pressure Wash Pick Up Litter Other: _____
- b. How often will grounds be cleaned? Daily Weekly As Needed Monthly Other: _____
- c. Grounds cleaned by: Licensee Building Owner Employees Hired Maintenance Other: _____
- d. How are noise issues prevented and/or addressed? Security Manager approaches customer(s) Call Police
 Signs Posted Other: _____
- e. Will a sound amplification system be used? No Yes If yes, describe: _____

4. Smoking & Sanitation

- a. Are there designated outdoor smoking areas? No Yes If yes, describe: _____
- b. Number of Garbage Cans: Inside: *12* Locations: *registers offices, bakery deli, meat +*
Outside: *8* Locations: *parking lot, alley, + sidewalks, produce, restaurant*
- c. Is a crowd control barrier used? No Yes If yes, describe: _____
- d. How many restrooms are on the premises? *2*
- e. Name of solid waste contractor: Advanced Disposal Waste Management Other: _____

corrected + emailed to
Linda Moon Siefert
12/9/19

5. Security

- a. Are there onsite parking spaces? No Yes If yes, how many? 10 and describe the parking security plan: Security guards walk the parking lot.
- b. Is there a loading zone? No Yes If yes, describe the loading area security plan: remains locked except in active receiving
- c. Will you have security personnel on premise? No Yes If yes, how many? 1 and answer the following:
 What are their responsibilities? prevent shoplifting + ensure safety
 Is security equipment used? No Yes If yes, describe _____
 List their licensing, certification, or training credentials _____
- d. Will there be security cameras? No Yes If yes, how many? 23 and list locations: 5 Exterior
18 Interior
- e. Will searches/identification checks be done upon entry? No Yes If yes, describe _____

6. Percentage of Sales (must total 100%)

Alcohol <u>1</u> %	Food <u>98</u> %	Secondhand Merchandise <u>0</u> %	Precious Metals & Gems <u>0</u> %
Entertainment <u>0</u> %	Cigarettes <u>1</u> %	Personal Services (such as tattoo, body piercing, salon, tailor, tanning, etc.) _____ %	Other _____ % Describe: _____
Pawnbroker Activity _____ %	Salvaged Materials _____ % (such as scrap metal)		

7. Businesses/Licenses on the Premises (check all that apply):

- Type 1**
- Full Service Restaurant Cafe/Coffee Shop Deli or Fast Food Restaurant Private/Fraternal/Veterans Club
- Night Club Tavern Cocktail Lounge Teen Club
- Banquet Hall Sports Facility Bowling Alley
- Hotel/Motel: Number of Floors: _____ Rooming House: Number of Floors: _____
 Number of Rooms: _____ Number of Rooms: _____

- Type 2**
- Liquor Store Corner Store Supermarket Convenience Store
- Gas Station Amusement/Phonograph Distributor Recycling, Salvage or Towing
- Used Car Dealer Personal Service Establishment
(such as tattoo business, hair salon, tailor, etc.) Recording Studio
- What other licenses/permits will you hold at this location? (check all that apply)
- Occupancy Permit Cigarette & Tobacco Gas Station Extended Hours Class "B" Tavern Weights & Measures
- Secondhand Dealer Precious Metal & Gem Other: _____

8. Legal Capacity (only if a Type 1 premises in #7 above)

Capacity _____ (Call the Milwaukee Development Center at 414-286-8211 if you have questions.)

9. Premises Description

- a. Identify all area(s) of the premises that will be used in operating this business (include areas used only for storage):
 1st Floor 2nd Floor Basement Storage Patio Beer Garden Sidewalk Café Deck Rooftop
 Other: Describe: _____
- b. Describe Location: Major Thoroughfare Secondary Street Other: _____
- c. Nearest Major Cross Street: 35th St.
- d. Describe Building: Free Standing Building Strip Mall Other: _____
- e. Describe Premises Structure: Single Story Multi-Story - # of Stories _____ Other: _____
- f. Describe Surrounding Area: Commercial Residential Industrial Other: _____
- g. Building Owner Name: El Rey Enterprises / Criselda Villarreal Phone Number: 414-643-1616
 Business Owner Address: 411 N. Thornbush Circle Hartland, WI 53029

10. Hours of Operation & Customers

Will customers be entering the premises? No Yes

Day of the Week	Proposed Hours of Operation:		Estimated Number of Customers expected each day	Potential Age Range of Customers	Class B Tavern Applicant Only: Age Restriction (If none, write 'None')
	Open Time (include a.m. or p.m.)	Close Time (include a.m. or p.m.)			
Sunday	8am	9pm	1500	18-70	
Monday	8am	9pm	1400		
Tuesday	8am	9pm	1200		
Wednesday	8am	9pm	1100		
Thursday	8am	9pm	1300		
Friday	8am	9pm	1300		
Saturday	8am	9pm	1500		

An Extended Hours Establishment License is required for any convenience store, filling station, personal service establishment (such as tattoo, body piercing, salon, tailor, tanning, etc.), recording studio or restaurant which is open between the hours of 12:00 a.m. and 5:00 a.m.

Alcohol Establishments Permitted Hours of Operation: Class A: 8:00 am to 9:00 pm Sunday thru Saturday
 Class B: 6:00 am to 2:00 am Sunday thru Thursday, 6:00 am to 2:30 am Friday & Saturday

Entertainment Outdoor Closing Hours: 10:00pm Sunday-Thursday; 12:00am Friday & Saturday; unless a different time, either earlier or later, is established by the Common Council in its approval of the licensee's plan of operation.

11. Signature(s)

Sonia Ornel
 Signature of Sole Proprietor, Partner, or 20% or more Shareholder
 (If there are no 20% or more shareholders, Corporate Officer-print name/title and sign)

Sonia Ornel, trustee
 Signature of additional partner or 20% or more shareholder

See Application Information for a complete list of all required application forms.



ALCOHOL BEVERAGE & PUBLIC ENTERTAINMENT PREMISES SUPPLEMENTAL APPLICATION

Office of the City Clerk License Division
200 E. Wells St. Room 105, Milwaukee, WI 53202
(414) 286-2238 e-mail address: license@milwaukee.gov www.milwaukee.gov/license

Legal Entity Name: El Rey Plaza, Inc.

Premise Address: 3524 W. Burnham St. Milwaukee, WI 53215

Proximity of Premises to Church, School, Daycare Center or Hospital

Is the building within 300 feet of any church, school, daycare center or hospital? No Yes

"Service Bar Only" Designation

If applying for Class B or C license, are you applying for "Service Bar Only"? No Yes
Service Bar Only means customers cannot sit at the bar. Alcohol is served to employees who serve patrons seated at tables. No stools, chairs or other articles of furniture shall be placed at the service bar for patrons to sit upon.

Business Information

a) Are you taking out this application for anyone that may not be eligible for a license? No Yes
If yes, list their name and address: _____

b) Will the agent, a partner or the individual licensee be conducting the day-to-day operations of the business? No Yes
If no, list the name and address of the person(s) who will: _____

Class B Applicants: If the agent, a partner or the individual licensee will not be conducting the day-to-day operations of the business, the person(s) listed above must obtain a Class B Managers license.

c) Does anyone else have money invested or any other interest in this business? No Yes
If yes, explain: _____

d) Have you made an agreement with anyone to repay any loan or any other payments based upon income from the business? No Yes If yes, list name and address: _____

Proof of Ownership, Lease, or Offer to Purchase (New & Transfer Applicants Only)

Submit proof of ownership, lease, or offer to purchase the building with this application.
A lease or offer to purchase must:

- Be in the same legal entity name as that apply for the license
- Reflect the same address as the premises address on this application
- Reflect current dates and
- Be signed by the lessor/seller and lessee/buyer

Property Information (New & Transfer Applicants Only)

a) Do you own or lease the building? Own Lease

b) Who owns the fixtures (for example, coolers, etc.)? El Rey Plaza, Inc.

c) Are you purchasing the stock and/or fixtures? No Yes If yes, amount paid \$ _____

d) Total amount paid for ~~business~~ n/a

e) Total amount paid for goodwill of the business \$ _____

Goodwill comprises the reputation and customer relationships of an existing business. If the price you pay for the business exceeds the fair market value of all of the rest of the assets of the business, the excess may be considered goodwill.

f) Have you made arrangements with the seller for payment of personal property taxes? No Yes

Lease Information (New & Transfer Applicants who are leasing the premises only)

- a) Date lease begins 11/15/94 Ends: tbd
- b) Monthly rental \$ 10,000.
- c) Do you have an option to renew the lease? No Yes
- d) Does your lease allow for assignment to another party without the consent of the owner? No Yes
- e) For what length of time have you been guaranteed occupancy (number of years)? CONTINUOUS
- f) In addition to paying the monthly rental, will you have to pay anything additional to the owner of the building to guarantee performance of the lease? No Yes If yes, explain _____
- g) Does the present owner or occupancy object to the granting of your license? No Yes
If yes, explain _____

Change of Agent Applicants Only

Have there been any changes to the floor plan since the last application was submitted? No Yes

If no, a new floor plan is not required. If yes, submit a new floor plan and explain the change(s): _____

Signature

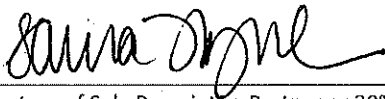

Signature of Sole Proprietor, Partner or 20% or More Shareholder
(If no 20% or more Shareholder, Corporate Officer - print name/title and sign)

Note: All information contained in this application is subject to approval by the Common Council.
Deviating from approved plan of operation will subject licensee to citations, and/or suspension or non-renewal of the license.
Contact the License Division for information on how to request changes.

New and transfer of premises applicants must submit the following:

- Proof of ownership, lease or offer to purchase the building
- Detailed floor plan
- If a restaurant, copy of the menu

N.W.

35TH STREET

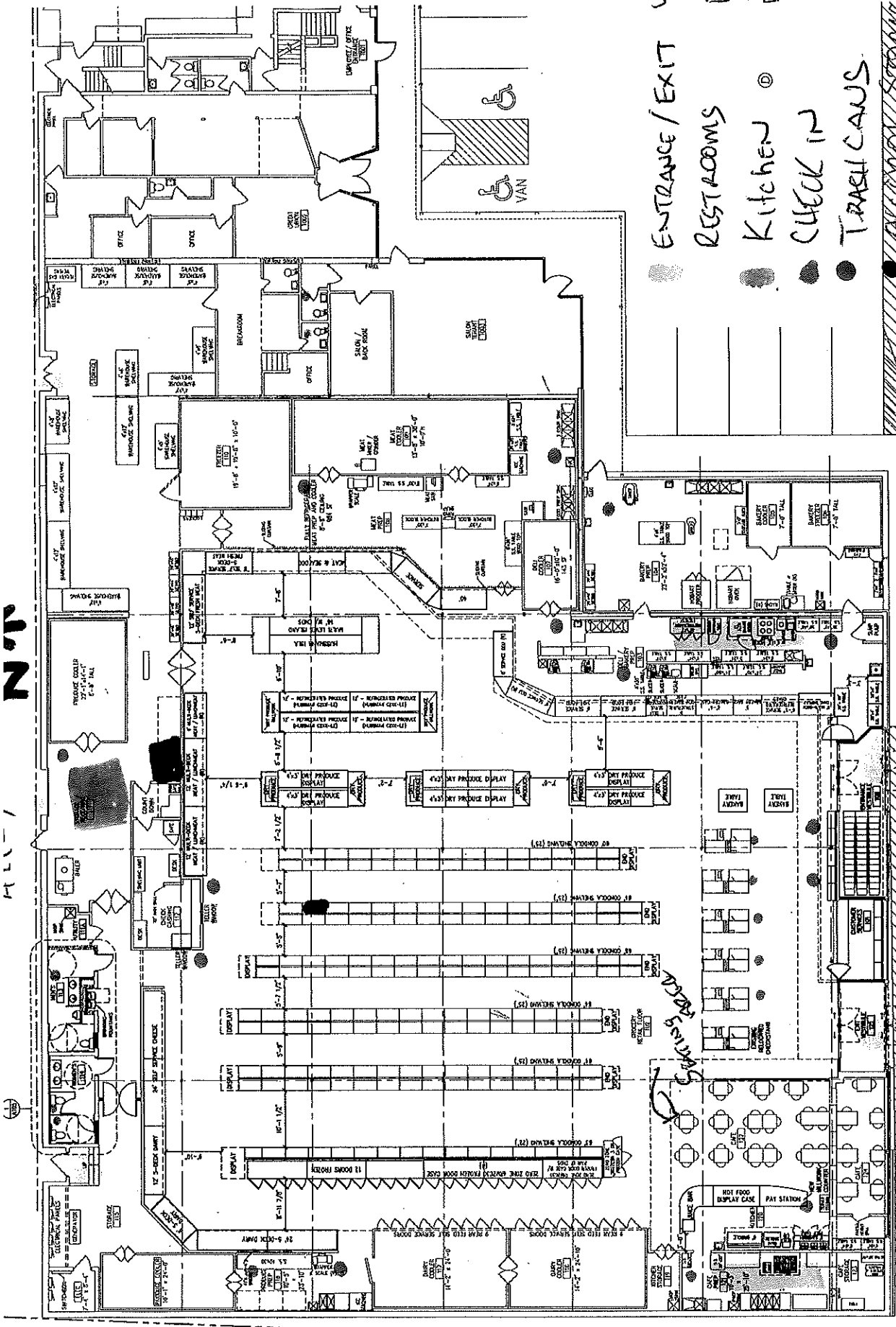

- ENTRANCE / EXIT
- RESTROOMS
- KITCHEN ⊕
- CHECK IN
- TRASH CANS

ALCOHOL STORAGE

EL REY PLAZA INC

EL REY PLAZA Supermarket

Agent Eric Higland

3524 W. Burnham St
Milwaukee, WI 53215

Total Sq. Footage 21,250

5' TRASH BINS

36TH ST.

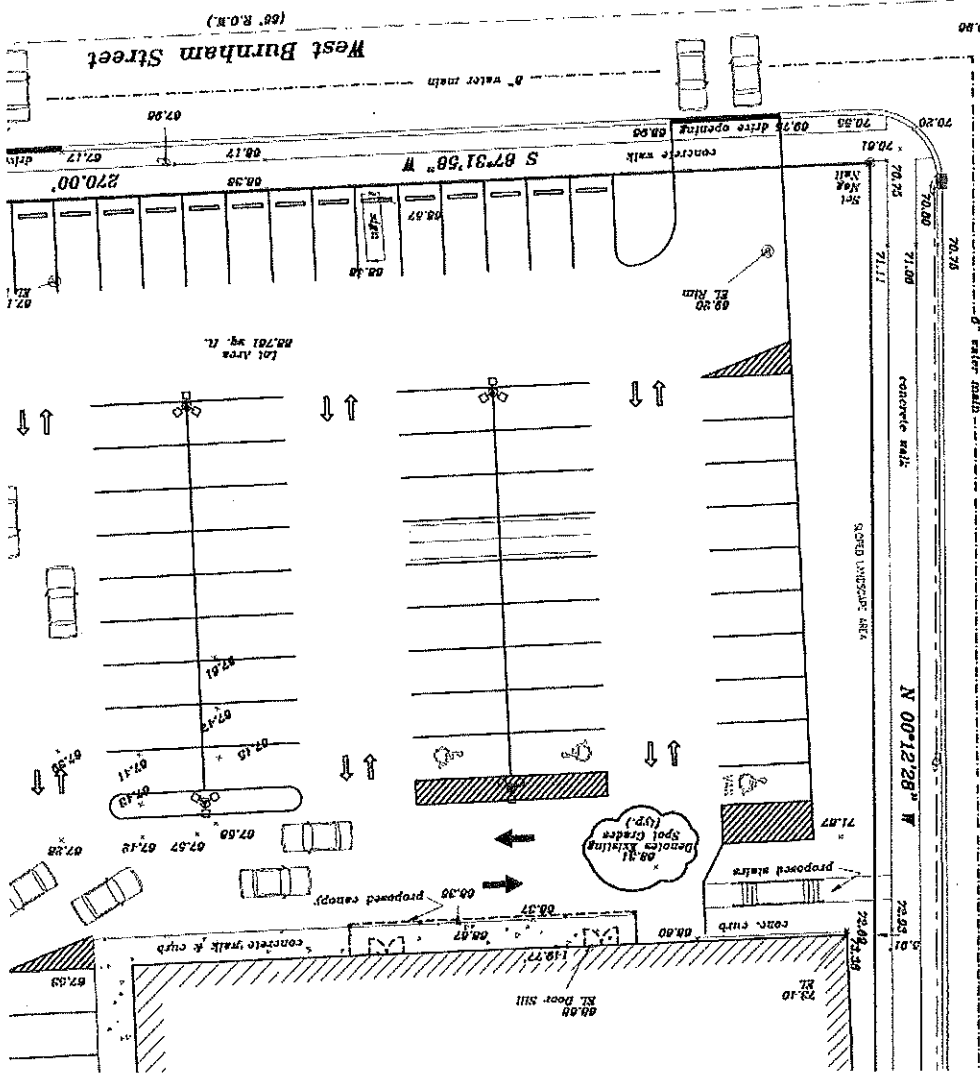
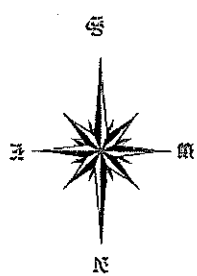

SP footage 469,000

EL Key Plaza INC.

EL Key Plaza Supermarket

Agent Eric Hyland

Address 3524 W. Burnham St.

Minwaukee, WI 53215

South 36th St
(60' R.O.K.)



**CITY OF MILWAUKEE
OFFICE OF THE CITY CLERK**

Wednesday, January 22, 2020

COMMITTEE MEETING NOTICE

AD 08

MCCANN, Samona, Agent
Milwaukee Nights Pub, LLC
3536 N 23rd St

Milwaukee, WI 53206

You are requested to attend a hearing which is to be held in Room 301-B, Third Floor, City Hall on:

Tuesday, January 28, 2020 at 10:00 AM

Regarding: Your Class B Tavern and Public Entertainment Premises License Renewal Applications as agent for "Milwaukee Nights Pub, LLC" for "Milwaukee Nights Pub" at 3830 W NATIONAL Av.

There is a possibility that your application may be denied for one or more of the following reasons: The recommendation of the committee regarding the application shall be based on evidence presented at the hearing. Per MCO 85-4-4, unless otherwise specified in the code, probative evidence concerning non-renewal, suspension or revocation may include evidence of the following: failure of the applicant to meet municipal qualifications, pending charges against or the conviction of any felony, misdemeanor, municipal offense or other offense, the circumstances of which substantially relate to the circumstances of the particular licensed or permitted activity, by the applicant or by any employee or other agent of the applicant. If the activities of the applicant involve a licensed premises, whether the premises tends to facilitate a public or private nuisance or has been the source of congregations of persons which have resulted in any of the following: disturbance of the peace; illegal drug activity; public drunkenness; drinking in public; harassment of passers-by; gambling; prostitution; sale of stolen goods; public urination; theft; assaults; battery; acts of vandalism including graffiti, excessive littering, loitering, illegal parking, loud noise at times when the licensed premise is open for business; traffic violations; curfew violations; lewd conduct; display of materials harmful to minors, pursuant to s. 106-9.6; or any other factor which reasonably relates to the public health, safety and welfare, or failure to comply with the approved plan of operation. See attached police report or correspondence.

Notice for applicants with warrants or unpaid fines:

Proof of warrant satisfaction or payment of fines must be submitted at the hearing on the above date and time. Failure to comply with this requirement may result in a delay of the granting/denial of your application.

Failure to appear at this meeting may result in the denial of your license. Individual applicants must appear only in person or by an attorney. Corporate or Limited Liability applicants must appear only by the agent designated on the application or by an attorney. Partnership applicants must appear by a partner listed on the application or by an attorney. If you wish to do so and at your own expense, you may be accompanied by an attorney of your choosing to represent you at this hearing.

You will be given an opportunity to speak on behalf of the application and to respond and challenge any charges or reasons given for the denial. No petitions can be accepted by the committee, unless the people who signed the petition are present at the committee hearing and willing to testify. You may present witnesses under oath and you may also confront and cross-examine opposing witnesses under oath. If you have difficulty with the English language, you should bring an interpreter with you, at your expense, so that you can answer questions and participate in your hearing.

You may examine the application file at this office during regular business hours prior to the hearing date. Inquiries regarding this matter may be directed to the person whose signature appears below.

Limited parking for persons attending meetings in City Hall is available at reduced rates (5 hour limit) at the Milwaukee Center on the southwest corner of East Kilbourn and North Water Street. Parking tickets must be validated in the first floor information booth in City Hall.

PLEASE NOTE: Upon reasonable notice, efforts will be made to accommodate the needs of disabled individuals through sign language interpreters or other auxiliary aids. For additional information or to request this service, contact the Council Services Division ADA Coordinator at (414) 286-2998, Fax - (414) 286-3456, TDD - (414) 286-2025.

JIM OW CZARSKI, CITY CLERK

BY: _____

Jessica Celella
License Division Manager

If you have questions regarding this notice, please contact the License Division at (414) 286-2238.

200 E. Wells Street, Room 105, City Hall, Milwaukee, WI 53202. www.milwaukee.gov/license
Phone: (414) 286-2238 Fax: (414) 286-3057 Email Address: License@milwaukee.gov

MILWAUKEE POLICE DEPARTMENT

LICENSING

CRIMINAL RECORD/ORDINANCE VIOLATION/INCIDENTS SYNOPSIS

DATE: 12/19/2019

LICENSE TYPE: Class B Tavern

NEW:

RENEWAL:

No. 304176

Application Date: 12/18/2019

License Location: 3830 W National Ave

Business Name: Milwaukee Nights Pub

Licensee/Applicant: MCCANN, Samona L
(Last Name, First Name, MI)

Date of Birth: 02/26/1984

Home Address: 1814 W Morgan Av

City: Milwaukee

State: WI **Zip Code:** 53221

Home Phone:

This report is written by Police Officer David Novak, assigned to the License Investigation Unit, Days.

The Milwaukee Police Department's investigation regarding this application revealed the following:

1. On 12/03/2016 officers received an anonymous call of a shooting at Milwaukee Nights Pub, 3830 W. National Av. The officers arrived on scene and determined the call was not legitimate.
2. On 02/07/2017 at 12:15am officers were dispatched to a noise complaint at Milwaukee Night Pub, 3830 W. National Av. The officers arrived and found the music inside was at a reasonable level but did increase when patrons opened the front door. The officer advised the bar to lower the music to fix this problem.
3. On 04/15/2017 at 2:11am officers responded to shots fired in the area of S. 38th St and W. National Av. Milwaukee Nights Pub was closed when officers arrived but the applicant was on scene and interviewed. She stated she told by her security that something was happening outside and she should close. She closed down but is not aware of what happened outside. Her security stated he was outside when he heard what sounded like two gun shots coming from around S. 39th St. The officers found no witnesses or evidence of shots being fired.
4. On 05/04/2017 officers conducted underage tavern enforcement in District 2. An underage Police Aid attempted to gain entry to Milwaukee Nights Pub, 3830 W. National Av. The Police Aid was turned away by security when she could not provide ID.

5. On 05/15/2017 officers were dispatched to a noise complaint at Milwaukee Nights Pub, 3830 W. National Av. The officers arrived and did not find the noise level to be excessively loud. They spoke with Steven ESTRADA who agreed to turn the music down because he did not want any problems. He stated the neighbors have his phone number and will text when the music is loud and he will turn it down. The staff was cooperative with the officers.

CRIMINAL RECORD/ORDINANCE

6. On 02/10/2018 at 2:44am officers were dispatched to 3830 W. National Av for a battery complaint. The investigation revealed a fight occurred between two male patrons, who were fighting over a female patron. The male patrons both had stab wounds to the abdomen and the female had a cut to her wrist. The bartender, Dominique EWAN, got hit in the mouth by a bottle while attempting to break up the fight. The officers found 6 people in the bar after hours who were not employees. The business has cameras but they do not record. The applicant was cited for Class B Allow Patron After Hours.

Charge: Class B Allow Patron After Hours
Finding: Guilty
Sentence: Fined \$1,637.95
Date: 01/17/2019
Case: 18043992

7. On 02/27/2018 a meeting was held regarding the incident on 02/10/2018 at Milwaukee Nights Bar. Present at the meeting was the applicant's husband, Steven ESTRADA, because the applicant was her day job. The officers stated they had concerns about the employees being uncooperative with the investigation and that no employees called to notify police about the incident. ESTRADA stated the employees no longer work at the bar, and he has brought back security on the weekends. He also stated he will fix the cameras so they record and will look into enrolling in the Pivot Program.
8. On 05/16/2018 officers were dispatched to Milwaukee Nights Pub, 3830 W. National Av, for a battery complaint. The officers located the victim who stated he was stabbed in the hand at the tavern. The officers interviewed the applicant and several witnesses who stated the subject was being disorderly and fell while walking out the door. The officer stated the injury was consistent with a fall. Steven ESTRADA stated there are no functional cameras at the location.
9. On 06/03/2018 at 2:08am officers were dispatched to Milwaukee Nights Pub, 3830 W. National Av, for a battery complaint. The officer spoke with the security guard, Raul PEREZ, who stated there were two large groups in the bar. A female from one group threw a drink on some one. In order to prevent a fight PEREZ put the female out of the bar and locked the door, preventing anyone from leaving until the female was gone. The officer did not observe anyone that was injured.

Item #6 updated with disposition on 12/19/2019

10. On 02/23/2019 at 9:00pm officers investigated a shooting at Milwaukee Nights Pub, 3830 W. National Av. The officer spoke with the bartender who stated the bar was having a "Rap Battle" and the two subjects ended up physically fighting throughout the bar. During the fight one of the subjects produced a firearm and shot the other subject. The patrons of the bar grabbed the victim and the suspect fled. The applicant arrived after the incident and spoke with the officers. She stated the cameras only record when the door opens or there is a break in. She stated she rented out the business to a group she only knew from Facebook. The officers advised her of the tavern violations and she said "I can't control everything like that". The applicant was cooperative with the detectives investigating the shooting.

Charge: Public Entertainment Premise-License Required
Finding: **WARRANT ISSUED**
Sentence:
Date:
Case: 19021161

11. On 03/07/2019 a meeting was held at District 2 regarding recent incidents at 3830 W. National Av. The officers stated their concerns with only one employee working, security cameras not recoding, liquor bottles not purchased at a distributor, food sales without a permit and events not covered by her PEP license. The applicant was advised her PEP does not cover DJ's and the use of promotors could impact her license. She was also advised a food dealers license was required even if food was given away. The applicant stated she will not have Rap Battles again, has updated her security cameras, and is getting a new security company.

12. On 03/09/2019 officers conducted a licensed premise check at 3830 W. National Av. The applicant stated she has security on Friday and Saturday nights starting at 9:00pm and has new security cameras that she can view on her phone. The officer advised her to have security pat down patrons for weapons and to use the front door as the main entrance and only use the side door for emergencies. No violations were observed.

13. On 03/14/2019 officers, along with agents from the Wisconsin Department of Revenue, conducted a licensed premise check at 3830 W. National Av. The agents located six bottles of alcohol that the applicant didn't have proof of purchase and one bottle of liquor contaminated with fruit flies. The applicant was advised to not advertise special events due to the tavern not having a food license. No other violations observed.

Milwaukee Police Department

749 W. State Street Milwaukee, WI 53233

414-933-4444

Case #: 190540114

OtherEvent #: 19-LP-0137

Incident

3830 W NATIONAL AV Milwaukee, WISCONSIN 53215

Incident Date/Time:: 02/23/2019 20:58:00
CAD Number:: 190542232
District:: 2
Beat:: 220
Reporting Area:: 5263

Business Agent (1)

MCCANN, SAMONA

Person Involvement: (Must choose Agent
AGENT from drop down):
DOB:: 02/26/1984
Sex:: FEMALE
Race:: BLACK/AFRICAN AMERICAN
Phone 1 Number:: 839-9299
Phone 1 Type:: Cell
Address:: 1806 S 23RD ST
City:: Milwaukee
State:: WISCONSIN
Zip Code:: 53204

Licensed Persons Involved (1)

ZACHOW, AMBER LYNN

Person Involvement:: Bartender
DOB:: 09/28/1990
Sex:: FEMALE
Race:: WHITE
Phone 1 Number:: 3439379
Phone 1 Type:: CELL
Address:: 4403 S 14TH ST
City:: Milwaukee
State:: WISCONSIN
Zip Code:: 53221

Licensed Premise Data (1)

MILWAUKEE NIGHTS PUB

Phone 1 Number:: 839-9299
Phone 1 Type:: Cell
Address:: 3830 W NATIONAL AV
City:: Milwaukee
State:: WISCONSIN
Zip Code:: 53215
License Type:: Public Entertainment Premise
Licensee Notification Was Made:: Yes
Licensee Notified Date/Time:: 02/23/2019 22:00:00

Milwaukee Police Department

749 W. State Street Milwaukee, WI 53233

414-933-4444

Case #: 190540114

OtherEvent #: 19-LP-0137

Business Was Cited For Violation: No

Licensee was cooperative: (If not explain in narrative): No

Licensee or Manager was on premises at time of violation/incident: No

Narrative (1)

LICENSE PREMISE REPORT

Rusch, Adam J 018438

02/24/2019

This report is written by P.O. Adam J. RUSCH, District 2, Late Power Shift, squad 2464, with P.O. James SPINATO.

On Saturday February 23rd, 2019, at approximately 9:00p.m. I responded to the address of 3830 W. National Av. (Milwaukee Nights Pub LLC. B-Tavern License #0205852) to assist with a shooting scene.

On scene, I conducted a License Premise check.

Upon entering the establishment, I detected a strong odor of marijuana coming from inside.

I spoke with the bartender, identified as Amber L. ZACHOW, f/w, 9-28-1990. Bartender license #0224503. Effective Date - 1-1-2018 Expires - 12-31-2019.

Amber stated she had been working behind the bar since approximately 5:00p.m. Amber stated there was a special event going on today near the North end of the bar. Amber stated the special event was a "Rap Battle". Amber stated two subjects were "Battling" and began physically fighting. Amber stated the physical fight continued from the North end of the bar to the South East corner of the bar. Amber stated the two subject fell onto the ground and continued to physically fight. Amber stated during the fight, one subject, unknown if top or bottom subject, pulled a firearm and shot. Amber stated the crowd of people then grabbed the victim, identified as Joshua J. THOMAS, m/b, 9-27-1994, portion of the fight and dragged him to the North end of the bar and the suspect fled in an unknown direction.

Joshua suffered a gun shot wound to his left upper side, which is not life threatening. A 9mm casing was recovered from inside the tavern in the South East corner.

I conducted a check of the bar area and rest of the business.

I located several items of interest:

- 1 - Two 1.75L Malibu Caribbean Rum bottles.
- 2 - 1.0L Gray Goose bottle with blue liquid inside.
- 3 - 1.75L Malibu Bottle. (Empty).

Milwaukee Police Department

749 W. State Street Milwaukee, WI 53233

414-933-4444

Milwaukee Police Department

749 W. State Street Milwaukee, WI 53233

414-933-4444

OtherEvent #: 19-LP-0137

Case #: 190540114

4 - 1.0L Ciroc Apple liquor bottle, which was contaminated with flies.

5 - 1.0L Ciroc Peach liquor bottle, which was contaminated with flies.

6 - 1.75L Dr. McGillicuddy Cherry bottle of liquor. (Empty).

7 - 1.75L Taak Vodka bottle of liquor. (Empty).

8 - 1.75L Fireball Cinnamon Whisky bottle of liquor. (Empty).

9 - Two 1.75L 1800 Silver Tequila bottles of liquor. (Empty).

1.75L bottles are not sold by distributors.

Also located was several small blunt wraps filled with marijuana. Total weight of 2.3grams, on MPD Inventory #19005987.

One was located on the window sill on the North end of the business. Two were located inside the employee area, which is a door located in the North end of the bar that clearly displays employee only. The owner, identified as Samona L. MCCANN, f/b, 2-26-1984, stated only employees were allowed into the employee restricted area.

Also located inside the business was a food sign depicting food sales and food on top of a table located near the East end of the business. The license does not permit food sales on the premises.

I spoke with the owner, Samona, who arrived on scene after the incident. Samona stated she does not need security during the day and said, "I can't control everything like that" and at first, appeared hostile while Sgt. MARTIN was explaining all of the possible violations within the business.

I attempted to have Samona access the camera system, which Samona stated the camera system does not record unless the door opens or there is a security risk, ie: break in.

Samona stated she rented out the business for \$150.00 to a group that she only knew from Facebook. Samona did not have a contract with them and did not know their legal names.

Samona was cooperative with detectives during their investigation.

The basement area was checked and officers observed standing water inside the basement.

P.O. Rachel SMITH conducted a CST investigation and took photos of tavern check portion of this instigation.

Officer (2)

Reporting Officer:	Rusch, Adam J (018438)	02/23/2019 23:54:00
Section: (Work Location):	24	
Approving Officer:	Raden, Chad M (010032)	02/25/2019 11:53:26

Milwaukee Police Department

749 W. State Street Milwaukee, WI 53233

414-933-4444

...
...
414-933-4444

Case #: 190540114

OtherEvent #: 19-LP-0137

Section: (Work Location): 27

... Small Green Apple liquor bottle, which was examined...

Milwaukee Police Department

749 W. State Street Milwaukee, WI 53233

414-933-4444

Milwaukee Police Department

749 W. State Street Milwaukee, WI 53233

414-933-4444

Case #: 190660075

OtherEvent #: 19-LP-0177

Incident

3830 W NATIONAL AV Milwaukee, WISCONSIN 53215

Incident Date/Time:: 03/07/2019 15:00:00
CAD Number:: 190661829
District:: 2
Beat:: 220
Reporting Area:: 5263

Business Agent (1)

MCCANN, SAMONA

Person Involvement: (Must choose Agent
AGENT from drop down):
DOB:: 02/26/1984
Sex:: FEMALE
Race:: BLACK/AFRICAN AMERICAN
Phone 1 Number:: 839-9299
Address:: 1814 W MORGAN AV
City:: Milwaukee
State:: WISCONSIN
Zip Code:: 53221

Licensed Premise Data (1)

MILWAUKEE NIGHTS PUB

Phone 1 Number:: 839-9299
Address:: 3830 W NATIONAL AV
City:: Milwaukee
State:: WISCONSIN
Zip Code:: 53215
License Type:: Alcohol
Licensee Notification Was Made:: Yes
Licensee Notified Date/Time:: 03/07/2019 15:00:00
Business Was Cited For Violation:: No
Licensee was cooperative: (If not explain in narrative): Yes
Licensee or Manager was on premises at time of violation/incident:: Yes

Narrative (1)

LICENSED PREMISES MEETING

Vodicka, Kevin E 018950

03/07/2019

This report is written by P.O. Kevin VODICKA assigned to District Two, Early Power Shift Community

Milwaukee Police Department

749 W. State Street Milwaukee, WI 53233

414-933-4444

Milwaukee Police Department
749 W. State Street, Milwaukee, WI 53233
414-933-4444

Case #:190660075

OtherEvent #:19-LP-0177

Prosecution Unit. On Thursday, March 7, 2019, at 3:00 PM, LT. Elizabeth IBARRA, SGT. Chad RADEN, P.O. Oscar PICENO, P.O. Benjamin SPITZER, P.O. Mariolys FLORES, A.C.A. Heather HOUGH, and I met with the licensee of Milwaukee Nights Pub, LLC, Samona MCCANN, at District Two to discuss the recent shooting incident that occurred at her tavern and events surrounding the incident.

The meeting began with a recap of the incident from the license premises report. Areas of concern from the report were; smoking (marijuana) in the public and employee areas of the tavern, one employee working with approximately forty (40) patrons inside of the premises, security cameras that were not recording, no security guard at the premises, liquor bottles possibly not purchased from a distributor, food sales without a permit, and that the event stemmed from "rap battle" which is not included in the premises' Public Entertainment permit.

MCCANN stated that she had attended rap battles at other taverns where no incidents occurred and no security was present. MCCANN stated that she allowed the group to host the battle at her tavern in exchange for a \$150.00 cleaning fee. MCCANN stated that she left prior to the incident and that shortly after she left the group put up signs for the food sales and one of her employees also left, leaving one bartender. MCCANN stated that she always has security present on Saturday nights (the busiest night for the bar) after 10:00 PM.

SGT. RADEN discussed the use of promoters, the danger they potentially pose to a licensee, and how a licensee is ultimately responsible for actions done by a promoter inside of a licensed premises. IT should be noted that the license application indicates that promoters and sound amplification would NOT be used. SGT RADEN also discussed the selling or giving away of food and how a food dealer's license is required and inspections by the Health Department. SGT RADEN also discussed the use "DJs" which is also not a part of the premises' license. MCCANN contended that most of the time the "DJ" is just a subject playing music from an Iphone or Ipad. SGT RADEN and ACA HOUGH informed MCCANN that if the subject is not an employee, is featured or advertised as a DJ, is using a sound amplifier, and is not simply playing music in the background then the subject should be considered as a "DJ".

I then reviewed several Face Book postings for the tavern that included the advertisement for DJs, food, and hookahs. MCCANN stated that she had created the posts and would remove items or posts that were not allowed by her license and that she would seek special event permits for St. Patrick's Day and for opening day of the Milwaukee Brewer's season.

MCCANN stated that after the shooting she had already implemented the following changes:

No more "Rap Battles" or similar events

Milwaukee Police Department

749 W. State Street Milwaukee, WI 53233

414-933-4444

Milwaukee Police Department

749 W. State Street Milwaukee, WI 53233

414-933-4444

Case #:190660075

OtherEvent #:19-LP-0177

Security at all special events

Replaced old security system with a remotely accessed system with 24 hour recording

New security system can be accessed by herself and her husband

Is in the process of replacing existing security contractor due to current security moving out of state.

MCCANN was also cautioned that she is responsible for any actions taken by a contracted security company.

The use of some type of "ID scanner" was discussed.

MCCANN was given information on how to apply to amend her current PEP license and how to apply for a special event permit.

Officer (2)

Reporting Officer:	Vodicka, Kevin E (018950)	03/07/2019 18:36:00
Section: (Work Location):	22	
Approving Officer:	Raden, Chad M (010032)	03/08/2019 10:54:38
Section: (Work Location):	27	

Milwaukee Police Department

749 W. State Street Milwaukee, WI 53233

414-933-4444

Milwaukee Police Department List
749 W. State Street Milwaukee, WI 53233
414-933-4444

Case #: 190680118

OtherEvent #: 19-LP-0224

Incident

3830 W NATIONAL AV MILWAUKEE, WISCONSIN 53215

Incident Date/Time:: 03/09/2019 23:09:00
CAD Number:: 190682548
District:: 2
Beat:: 220
Reporting Area:: 5263

Business Agent (1)

MCCANN, SAMONA

Person Involvement: (Must choose Agent
AGENT from drop down):
DOB:: 02/26/1984
Sex:: FEMALE
Race:: BLACK/AFRICAN AMERICAN
Phone 1 Number:: 839-9299
Address:: 1814 W MORGAN AV
City:: Milwaukee
State:: WISCONSIN
Zip Code:: 53221

Licensed Persons Involved (1)

ESTRADA, STEVEN NMN

Person Involvement:: CO-OWNER
DOB:: 01/06/1979
Sex:: MALE
Race:: WHITE
Phone 1 Number:: 414-839-9299
Phone 1 Type:: CELL
Address:: 1806 S 23RD ST
City:: Milwaukee
State:: WISCONSIN
Zip Code:: 53204

Licensed Premise Data (1)

MIKE NIGHTS

Phone 1 Number:: (414)-988-4130
Phone 1 Type:: Work
Address:: 3830 W NATIONAL AV
City:: Milwaukee
State:: WISCONSIN
Zip Code:: 53215
License Type:: Alcohol
Licensee Notification Was Made:: Yes
Licensee Notified Date/Time:: 03/09/2019 23:09:00
Business Was Cited For Violation:: No

Milwaukee Police Department

749 W. State Street Milwaukee, WI 53233

414-933-4444

Milwaukee Police Department 

749 W. State Street Milwaukee, WI 53233

414-933-4444

Case #: 190680118

(OtherEvent #: 19-LP-0224

Licensee was cooperative: (If not explain in narrative): Yes

Licensee or Manager was on premises at time of violation/incident: No

Narrative (1)

INITIAL INVESTIGATION

Espitia, Oscar 025682

03/11/2019

This report is typed by PO Oscar ESPITIA assigned to District Two, Late Power Shift and Tavern Squad 2464.

On Saturday March 09, 2019 at approximately 11:08 PM I conducted a tavern check at 3830 W. National Ave (MKE Nights). I spoke to the owner, Samona McCann (W/F, 02/26/84) and her husband Steven ESTRADA (W/M, 01/06/79). McCann stated since the shooting took place she hired an armed security guard for Fridays and Saturday from 9:00 PM to close. I advised her to tell her security guard to pat down patrons for weapons and check purses and if a patron leaves the tavern and returned to check them again. I also explained to them it was safer if they just use the front entrance door and not permit people use the side door, only for emergencies. McCann and ESTRADA agreed.

McCann and ESTRADA showed us there new surveillance cameras and the footage streams directly to his phones. McCann and ESTRADA stated in case of an incident they will be able to show us surveillance footage.

I didn't observe any other violations and the owners where cooperative.

End of Report...

Officer (2)

Reporting Officer:	Espitia, Oscar (025682)	03/11/2019 00:21:00
Section: (Work Location):	24	
Approving Officer:	Krueger, Jeffrey S (017798)	03/18/2019 21:40:21
Section: (Work Location):	24	

Milwaukee Police Department

749 W. State Street Milwaukee, WI 53233

414-933-4444

Milwaukee Police Department

749 W. State Street Milwaukee, WI 53233

414-933-4444

Case #: 190730123

OtherEvent #: 19-LP-0223

Incident

3830 W NATIONAL AV Milwaukee, WISCONSIN 53215

Incident Date/Time:: 03/14/2019 19:26:00
CAD Number:: 190732359
District:: 2
Beat:: 220
Reporting Area:: 5263

Business Agent (2)

MCCAN, SAMONA

Person Involvement: (Must choose Agent
AGENT from drop down):
Sex:: FEMALE
Race:: BLACK/AFRICAN AMERICAN

ZACHOW, AMBER L

Person Involvement: (Must choose Bartender
AGENT from drop down):
DOB:: 09/28/1990
Sex:: FEMALE
Race:: WHITE
Address:: 4403 S 14TH ST
City:: Milwaukee
State:: WISCONSIN
Zip Code:: 53221

Licensed Premise Data (1)

MILWAUKEE NIGHTS PUB LOCA

Phone 1 Number:: (414)-988-4130
Address:: 3830 W NATIONAL AV
City:: Milwaukee
State:: WISCONSIN
Zip Code:: 53215
License Type:: Alcohol
Licensee Notification Was Made:: Yes
Licensee Notified Date/Time:: 03/14/2019 19:26:00
Business Was Cited For Violation:: No
Licensee was cooperative: (If not Yes
explain in narrative):
Licensee or Manager was on No
premises at time of
violation/incident::

Narrative (1)

INITIAL INVESTIGATION

Milwaukee Police Department

749 W. State Street Milwaukee, WI 53233

414-933-4444

Milwaukee Police Department 

Police Secretariat Eugene J. J. J.

414-933-4444

Case #: 190730123

OtherEvent #: 19-LP-0223

Diaz-Suarez, Michael 029794

03/18/2019

This report is being typed by P.O. Michael DIAZ, assigned to District Two late Power along with my partner P.O. ESPITIA, on Thursday March 14th 2019 at approximately 7:42PM, we were dispatched to the address of 3830 W National AV to assist the Dept. of Revenue on a tavern check, which is located in the City and County of Milwaukee.

Upon arrival we spoke to tavern owner of "MKE Nights" Samona MCCAN who had a valid class B tavern license that it expires on 2/29/20. MCCAN was cooperative throughout the whole process of the tavern check. While assisting with tavern check Agent UHLING came across six bottles that MCCAN didn't have proof of purchase for. These bottles were seized. One bottle was also dumped due to it having fruit flies. We then spoke to Bartender Amber L. ZACHOW who had a valid class D bartering license. P.O. VODICKA advised the owner MCCAN that she shouldn't advertise events such as, Saint Patrick day, Opening day for the brewers or live DJ due to the tavern not having a food license. No other violations were observed and no citations were issued during the tavern check.

Officer (2)

Reporting Officer:	Diaz-Suarez, Michael (029794)	03/14/2019 20:29:00
Section: (Work Location):	24	
Approving Officer:	Krueger, Jeffrey S (017798)	03/18/2019 21:12:42
Section: (Work Location):	24	



Wednesday, January 22, 2020



Notice of Public Hearing

MCCANN, Samona, Agent
Milwaukee Nights Pub at 3830 W NATIONAL Av
Class B Tavern and Public Entertainment Premises License Renewal Applications

Tuesday, January 28, 2020 at 10:00 AM

To whom it may concern:

The above application has been made by the above named applicant(s). This requires approval from the Licenses Committee and the Common Council of the City of Milwaukee. The hearing before the Licenses Committee will take place on 1/28/2020 at 10:00 AM, in Room 301-B, Third Floor, City Hall. If you wish, you may provide testimony at the hearing regarding the request; see below for further information. You are not required to attend the hearing. Once the Licenses Committee makes its recommendation, this recommendation is forwarded to the full Common Council for approval at its next regularly scheduled hearing. Please review the information below and if you have further questions regarding this process, please contact the License Division at (414) 286-2238.

Important details for those wishing to provide information for the Licenses Committee to consider when making its recommendation:

1. The license application is scheduled to be heard at the above time. Due to other hearings running longer than scheduled, you may have to wait some time to provide your testimony.
2. You must appear in person and testify as to matters that you have personally experienced or seen. (You cannot provide testimony for your neighbor, parent or anyone else; this is considered hearsay and cannot be considered by the committee.)
3. No letters or petitions can be accepted by the committee (unless the person who wrote the letter or the persons who signed the petition are present at the committee hearing and willing to testify).
4. Persons opposed to the license application are given the opportunity to testify first; supporters may testify after the opponents have finished.
5. When you are called to testify, you will be sworn in and asked to give your name, and address. (If your first and/or last names are uncommon please spell them.)
6. You may then provide testimony.
 - a. Include only information relating to the above license application.
 - b. Include only information you have personally witnessed or seen.
 - c. Provide concise and relevant information detailing how this business has affected or may affect the peaceful enjoyment of your neighborhood.
 - d. If by the time you have the opportunity to testify, the information you wish to share has already been provided to the committee, you may state that you agree with the previous testimony. Redundant or repetitive testimony will not assist the committee in making its recommendation.
7. After giving your testimony, the members of the Licenses Committee and the licensee may ask questions regarding the testimony you have given or other factors relating to the license application.
8. Business Competition is not a valid basis for denial or non-renewal of a license.
Please Note: If you have submitted an objection to the above application your objection cannot be considered by the committee unless you personally testify at the hearing.

OCCUPANT	MAIL ADDRESS	CITY, STATE ZIP
CURRENT OCCUPANT	3739 W NATIONAL AVE 2	MILWAUKEE, WI 53215
CURRENT OCCUPANT	803 S 38TH ST	MILWAUKEE, WI 53215
CURRENT OCCUPANT	3814A W NATIONAL AVE	MILWAUKEE, WI 53215
CURRENT OCCUPANT	734 S 39TH ST	MILWAUKEE, WI 53215
CURRENT OCCUPANT	818 S 39TH ST	MILWAUKEE, WI 53215
CURRENT OCCUPANT	800 S 39TH ST	MILWAUKEE, WI 53215
CURRENT OCCUPANT	3739 W NATIONAL AVE 1	MILWAUKEE, WI 53215
CURRENT OCCUPANT	3739 W NATIONAL AVE 3	MILWAUKEE, WI 53215
CURRENT OCCUPANT	745 S 38TH ST	MILWAUKEE, WI 53215
CURRENT OCCUPANT	744A S 39TH ST	MILWAUKEE, WI 53215
CURRENT OCCUPANT	806 S 39TH ST	MILWAUKEE, WI 53215
CURRENT OCCUPANT	744 S 39TH ST	MILWAUKEE, WI 53215
CURRENT OCCUPANT	812 S 39TH ST	MILWAUKEE, WI 53215
CURRENT OCCUPANT	740 S 39TH ST	MILWAUKEE, WI 53215
CURRENT OCCUPANT	3748 W HILDA PL	MILWAUKEE, WI 53215
CURRENT OCCUPANT	809A S 38TH ST	MILWAUKEE, WI 53215
CURRENT OCCUPANT	809 S 38TH ST	MILWAUKEE, WI 53215
CURRENT OCCUPANT	3814 W NATIONAL AVE	MILWAUKEE, WI 53215
CURRENT OCCUPANT	819 S 38TH ST	MILWAUKEE, WI 53215
CURRENT OCCUPANT	3810A W NATIONAL AVE	MILWAUKEE, WI 53215
CURRENT OCCUPANT	825 S 38TH ST	MILWAUKEE, WI 53215
CURRENT OCCUPANT	827 S 38TH ST	MILWAUKEE, WI 53215
CURRENT OCCUPANT	802A S 39TH ST	MILWAUKEE, WI 53215
CURRENT OCCUPANT	802 S 39TH ST	MILWAUKEE, WI 53215
CURRENT OCCUPANT	740A S 39TH ST	MILWAUKEE, WI 53215
CURRENT OCCUPANT	815 S 38TH ST	MILWAUKEE, WI 53215
CURRENT OCCUPANT	3812 W NATIONAL AVE	MILWAUKEE, WI 53215
CURRENT OCCUPANT	906 S 38TH ST	MILWAUKEE, WI 53215
CURRENT OCCUPANT	3739 W NATIONAL AVE 4	MILWAUKEE, WI 53215
CURRENT OCCUPANT	3830A W NATIONAL AVE	MILWAUKEE, WI 53215
CURRENT OCCUPANT	3814B W NATIONAL AVE	MILWAUKEE, WI 53215

Total Records: 31

Radius: 250.0 feet and Center of Circle: 3830 W National Ave

2020-2021 Plan of Operation for 3830 W NATIONAL AV

1. Litter & Security Plans			
How are the grounds kept clean? <input checked="" type="checkbox"/> Sweep <input type="checkbox"/> Pressure Wash <input checked="" type="checkbox"/> Pick Up Litter <input type="checkbox"/> Other:			
How often will grounds be cleaned? <input type="checkbox"/> Daily <input checked="" type="checkbox"/> Weekly <input type="checkbox"/> Other:			
Who cleans the grounds? <input checked="" type="checkbox"/> Licensee <input type="checkbox"/> Building Owner <input checked="" type="checkbox"/> Employees <input type="checkbox"/> Hired Maintenance <input type="checkbox"/> Other:			
How are noise issues prevented and/or addressed? <input type="checkbox"/> Security <input checked="" type="checkbox"/> Manager approaches customer(s) <input type="checkbox"/> Call Police <input type="checkbox"/> Signs Posted <input type="checkbox"/> Other:			
Are there designated outdoor smoking areas? <input type="checkbox"/> No <input checked="" type="checkbox"/> Yes If Yes, Describe: <u>Outside in front of building</u>			
Number of garbage cans: Inside <u>4</u> Locations: <u>2 behind bar and 1 in each bathroom</u> Outside <u>1</u> Locations: <u>Back of building</u>			
Is a crowd control barrier used? <input checked="" type="checkbox"/> No <input type="checkbox"/> Yes If Yes, Describe:			
Number of restrooms: <u>2</u>		Name of solid waste contractor: <u>Waste management</u>	
Are there parking spaces on the premises? <input checked="" type="checkbox"/> No <input type="checkbox"/> Yes If Yes, list number of spaces: _____ and describe security plans:			
Are there designated loading areas? <input checked="" type="checkbox"/> No <input type="checkbox"/> Yes If Yes, describe security plans:			
Do you have security personnel on the premise? <input checked="" type="checkbox"/> No <input type="checkbox"/> Yes If Yes, how many? _____ AND What are their responsibilities? _____ What security equipment do they use? _____ List their licensing, certification or training credentials: _____			
Are there security cameras? <input type="checkbox"/> No <input checked="" type="checkbox"/> Yes If Yes, list all locations: <u>Above bar, back door, and front door</u>			
Are searches and/or identification checks conducted upon entry? <input type="checkbox"/> No <input checked="" type="checkbox"/> Yes If Yes, describe: <u>All bartenders check identification of each customer that enter building</u>			
2. Percentage of Sales (must total 100%)			
Alcohol <u>100</u> %	Food Sales _____ %	Entertainment _____ %	Other _____ %
3. Businesses On The Premises (choose all that apply):			
<input type="checkbox"/> Restaurant <input type="checkbox"/> Cafe/Coffee Shop <input type="checkbox"/> Cocktail Lounge <input type="checkbox"/> Convenience Store <input type="checkbox"/> Night Club <input type="checkbox"/> Liquor Store <input checked="" type="checkbox"/> Tavern <input type="checkbox"/> Sports Facility <input type="checkbox"/> Hotel <input type="checkbox"/> Banquet Hall <input type="checkbox"/> Supermarket <input type="checkbox"/> Private/Fraternal/Veterans' Club <input type="checkbox"/> Other:			
4. Hours of Operation and Age Restriction			
Are there any changes to the current hours of operation or age restriction? <input checked="" type="checkbox"/> No <input type="checkbox"/> Yes If Yes, Describe:			
Please Note: If you will be open earlier or later than the hours listed on your current license for even one event or holiday (for example, St. Patrick's Day, Brewers Opening Day, etc.) during the license period, this must be reported and printed on your license. Your hours of operation and age restriction are listed on your current license.			
5. Floor Plan and Capacity			
Are you requesting any changes to your capacity or floor plan*? <input checked="" type="checkbox"/> No <input type="checkbox"/> Yes If yes, describe: _____ and submit a new floor plan with this renewal application. A sample plan can be found online at www.milwaukee.gov/licenses under License Forms and Related Information.			
Alcohol/Food Establishments: A "Permanent Extension of Premises Application" is required if you are adding any square footage to the licensed premises.			
6. Sidewalk Dining: Fee:			
Are there any changes to the sidewalk dining site plan? <input checked="" type="checkbox"/> No <input type="checkbox"/> Yes If Yes, submit an updated site plan with this application.			
7. Food License: Fee:		8. Weights and Measures: Fee:	
Your current food license includes the following food operations: Are there any changes to your food operations as listed above? <input type="checkbox"/> No <input type="checkbox"/> Yes, if Yes, explain _____		Number/Type of Devices: Are there any changes to the number or types of devices? <input type="checkbox"/> No <input type="checkbox"/> Yes If yes, contact our office for further instructions.	

1. CURRENT APPROVED ENTERTAINMENT

The following types of entertainment have been approved for your current Public Entertainment Premises license:

Jukebox, 1 Pool Table, 5 Amusement Machines

2. ADDING ENTERTAINMENT

If applicable, check any entertainment you wish to add: **ONLY CHECK ENTERTAINMENT TYPE(S) YOU ARE ADDING. YOUR CURRENT APPROVED ENTERTAINMENT IS LISTED ABOVE.**

- | | | | |
|---|--|--|---|
| <input type="checkbox"/> Instrumental Musicians | <input type="checkbox"/> Bands | <input type="checkbox"/> Battle of the Bands | <input type="checkbox"/> Comedy Acts |
| <input type="checkbox"/> Disc Jockey | <input type="checkbox"/> Magic Shows | <input type="checkbox"/> Poetry Readings | <input type="checkbox"/> Dancing by Performers |
| <input type="checkbox"/> Jukebox | <input type="checkbox"/> Wrestling | <input type="checkbox"/> Patron Contests | <input type="checkbox"/> Patrons Dancing |
| <input type="checkbox"/> Adult Entertainment/
Strippers/Erotic Dance | <input type="checkbox"/> Karaoke | <input type="checkbox"/> Bowling Alley | <input type="checkbox"/> Pool Tables |
| <input type="checkbox"/> Motion Pictures (movies by admission)
How many screens? _____ | <input type="checkbox"/> Amusement Machines
How many? _____ | <input type="checkbox"/> Concerts
Approx. # per year? _____ | <input type="checkbox"/> Theatrical Performances
Approx. # per year? _____ |
| <input type="checkbox"/> Other: _____ | | | |

No entertainment changes can take place until approved by Common Council and a new license has been issued and posted on the premises.

3. REMOVING ENTERTAINMENT

If applicable, list any entertainment you wish to remove:

4. PROMOTERS/SOUND AMPLIFICATION

Will promoters ever be used for any of the entertainment? No Yes If Yes, Describe:

At any time will sound amplification be used? No Yes If Yes, Describe:

5. SIGNATURE

I understand that after the license has been issued, a change to the plan of operation will require a written request to change and approval from the Common Council.

I agree to inform the City Clerk within 10 days of any substantial changes in the information supplied in this application.

I understand that I shall not willfully refuse to provide the services offered under this license, or add charges or require deposits not required of the general public because of race, color, sex, religion, national origin or ancestry, age, handicap, lawful source of income, marital status, sexual orientation, gender identity or expression, familial status or the fact that a person is now or has been a member of the military service, whether dressed in uniform or not; and shall not seek such information as a condition of employment, or penalize any employee or discriminate in the selection of personnel for training or promotion on the basis of such information.

I have knowledge of the City Ordinances currently regulating public entertainment, and understand that the license may be subject to suspension, non-renewal or revocation, if I violate any rule, law or regulation of the city of Milwaukee and State of Wisconsin.

Samara Melan

Signature of Sole Proprietor, a Partner, or if a Corporation or LLC, the Agent must sign



CITY OF MILWAUKEE
OFFICE OF THE CITY CLERK

Thursday, January 16, 2020

COMMITTEE MEETING NOTICE

AD 11

BLAKE, IV, Clifford D, Agent
Ruckus Art, LLC
3224 S 92nd St

Milwaukee, WI 53227

You are requested to attend a hearing which is to be held in Room 301-B, Third Floor, City Hall on:

Tuesday, January 28, 2020 at 10:00 AM

Regarding: Your Tattoo and Body Piercing Renewal Application as ag  or "Ruckus Art, LLC" for "Ruckus Art" at 3224 S 92ND St.

There is a possibility that your application may be denied for one or more of the following reasons: The recommendation of the committee regarding the application shall be based on evidence presented at the hearing. Per MCO 85-2.7-4, probative evidence concerning whether or not a new license should be granted may be presented on the following subjects: whether or not the applicant meets the municipal requirements, the appropriateness of the location and premises where the licensed premises is to be located and whether use of the premises for the purposes or activities permitted by the license would tend to facilitate a public or private nuisance or create undesirable neighborhood problems such as disorderly patrons, unreasonably loud noise, litter, and excessive traffic and parking congestion. Probative evidence relating to these matters may be taken from the plan of operation submitted with the license application, if any, but shall not include the content of any music. Evidence regarding the fitness of the location of the premises to be maintained as the principal place of business, including but not limited to whether there is an overconcentration of businesses of the type for which the license is sought; whether the proposal is consistent with any pertinent neighborhood business or development plans, or the location's proximity to areas where children are typically present. The applicant's record in operating similarly licensed premises; and whether or not the applicant has been charged with or convicted of any felony, misdemeanor, municipal offense or other offense, the circumstances of which substantially relate to the activity to be permitted by the license being applied for or any other factor which reasonably relates to the public health, safety or welfare may also be considered. See attached police report or correspondence.

Notice for applicants with warrants or unpaid fines:

Proof of warrant satisfaction or payment of fines must be submitted at the hearing on the above date and time. Failure to comply with this requirement may result in a delay of the granting/denial of your application.

Failure to appear at this meeting may result in the denial of your license. Individual applicants must appear only in person or by an attorney. Corporate or Limited Liability applicants must appear only by the agent designated on the application or by an attorney. Partnership applicants must appear by a partner listed on the application or by an attorney. If you wish to do so and at your own expense, you may be accompanied by an attorney of your choosing to represent you at this hearing.

You will be given an opportunity to speak on behalf of the application and to respond and challenge any charges or reasons given for the denial. No petitions can be accepted by the committee, unless the people who signed the petition are present at the committee hearing and willing to testify. You may present witnesses under oath and you may also confront and cross-examine opposing witnesses under oath. If you have difficulty with the English language, you should bring an interpreter with you, at your expense, so that you can answer questions and participate in your hearing.

You may examine the application file at this office during regular business hours prior to the hearing date. Inquiries regarding this matter may be directed to the person whose signature appears below.

Limited parking for persons attending meetings in City Hall is available at reduced rates (5 hour limit) at the Milwaukee Center on the southwest corner of East Kilbourn and North Water Street. Parking tickets must be validated in the first floor information booth in City Hall.

PLEASE NOTE: Upon reasonable notice, efforts will be made to accommodate the needs of disabled individuals through sign language interpreters or other auxiliary aids. For additional information or to request this service, contact the Council Services Division ADA Coordinator at (414) 286-2998, Fax - (414) 286-3456, TDD - (414) 286-2025.

JIM OWCZARSKI, CITY CLERK

BY: _____

Jessica Ceella

License Division Manager

If you have questions regarding this notice, please contact the License Division at (414) 286-2238.

200 E. Wells Street, Room 105, City Hall, Milwaukee, WI 53202. www.milwaukee.gov/license
Phone: (414) 286-2238 Fax: (414) 286-3057 Email Address: License@milwaukee.gov

MILWAUKEE POLICE DEPARTMENT LICENSING

CRIMINAL RECORD/ORDINANCE VIOLATION/INCIDENTS SYNOPSIS

DATE: 05/01/18
LICENSE TYPE: TATTOO AND BODY PIERCING
NEW:
RENEWAL:

No. 273761
Application Date: 05/01/18

License Location: 3224 S. 92nd Street
Business Name: Ruckus Art, LLC

Licensee/Applicant: Blake IV, Clifford D.
(Last Name, First Name, MI)
Date of Birth: 10/12/1983

Home Address: 11107 N. Wyngate Tr
City: Mequon **State:** WI **Zip Code:** 53092
Home Phone: 414-688-0012

This report is written by Police Officer Corstan D. COURT, assigned to the License Investigation Unit, Days.

The Milwaukee Police Department's investigation regarding this application revealed the following:

1. On 07/05/2016 the applicant was charged in Milwaukee County with Disorderly Conduct.

Charge: Disorderly Conduct
Finding: Guilty
Sentence: Fine
Date: 09/15/2016
Case: 2016CM002179

- =====
2. On 01/09/18 the applicant was charged in Ozaukee County with Retail Theft – Intentionally Take Over \$500.00 (Misdemeanor).

Charge: Retail Theft – Intentionally Take Over \$500.00
Finding: **Guilty**
Sentence: **fine**
Date: **08/07/18**
Case: 2018CM000014

3. On 03/08/18 the applicant was cited for Refusing to Take Test for Intoxication After Arrest.

=====

Item #2 updated with disposition

4. On 04/02/18 the applicant was cited for Operating While Intoxicated. On 09/05/18 he was convicted and his driver's license was revoked for 7 months.
5. On 12/21/18 the applicant was charged in Milwaukee County with OWI (2nd with Passenger under the age of 16) and Operate with Restricted Controlled Substance (2nd with Minor Passenger under the age of 16) Misdemeanors.

Charge 1: OWI- 2nd with Passenger under the age of 16
2: Operate with Restricted Control Substance -2nd with Passenger under the age of 16
Finding: Court date on 01/22/20
Sentence:
Date:
Case: 2018CT002555

6. On 02/06/19 the applicant was charged in Ozaukee County with Possession of Amphetamine/LSD/Psilocin (Misdemeanors).

Charge: Possession of Amphetamine/LSD/Psilocin
Finding: Guilty
Sentence: 12 months probation
Date: 06/11/19
Case: 2019CM000053

7. The applicant is on Probation for item #6. Email notification to the Wisconsin Department of Corrections on 01/02/20 requesting they provide information to the License Division regarding the probation status and the end date of the status.



Thursday, January 16, 2020



Notice of Public Hearing

BLAKE, IV, Clifford D, Agent
Ruckus Art at 3224 S 92ND St
Tattoo and Body Piercing Renewal Application

Tuesday, January 28, 2020 at 10:00 AM

To whom it may concern:

The above application has been made by the above named applicant(s). This requires approval from the Licenses Committee and the Common Council of the City of Milwaukee. The hearing before the Licenses Committee will take place on 1/28/2020 at 10:00 AM, in Room 301-B, Third Floor, City Hall. If you wish, you may provide testimony at the hearing regarding the request; see below for further information. You are not required to attend the hearing. Once the Licenses Committee makes its recommendation, this recommendation is forwarded to the full Common Council for approval at its next regularly scheduled hearing. Please review the information below and if you have further questions regarding this process, please contact the License Division at (414) 286-2238.

Important details for those wishing to provide information for the Licenses Committee to consider when making its recommendation:

1. The license application is scheduled to be heard at the above time. Due to other hearings running longer than scheduled, you may have to wait some time to provide your testimony.
2. You must appear in person and testify as to matters that you have personally experienced or seen. (You cannot provide testimony for your neighbor, parent or anyone else; this is considered hearsay and cannot be considered by the committee.)
3. No letters or petitions can be accepted by the committee (unless the person who wrote the letter or the persons who signed the petition are present at the committee hearing and willing to testify).
4. Persons opposed to the license application are given the opportunity to testify first; supporters may testify after the opponents have finished.
5. When you are called to testify, you will be sworn in and asked to give your name, and address. (If your first and/or last names are uncommon please spell them.)
6. You may then provide testimony.
 - a. Include only information relating to the above license application.
 - b. Include only information you have personally witnessed or seen.
 - c. Provide concise and relevant information detailing how this business has affected or may affect the peaceful enjoyment of your neighborhood.
 - d. If by the time you have the opportunity to testify, the information you wish to share has already been provided to the committee, you may state that you agree with the previous testimony. Redundant or repetitive testimony will not assist the committee in making its recommendation.
7. After giving your testimony, the members of the Licenses Committee and the licensee may ask questions regarding the testimony you have given or other factors relating to the license application.
8. Business Competition is not a valid basis for denial or non-renewal of a license.
Please Note: If you have submitted an objection to the above application your objection cannot be considered by the committee unless you personally testify at the hearing.

OCCUPANT	MAIL ADDRESS	CITY, STATE ZIP
CURRENT OCCUPANT	3243 S 92ND ST 113	MILWAUKEE, WI 53227
CURRENT OCCUPANT	3243 S 92ND ST 109	MILWAUKEE, WI 53227
CURRENT OCCUPANT	3243 S 92ND ST 300	MILWAUKEE, WI 53227
CURRENT OCCUPANT	3248 S 92ND ST	MILWAUKEE, WI 53227
CURRENT OCCUPANT	3252 S 91ST ST	MILWAUKEE, WI 53227
CURRENT OCCUPANT	3223 S LANDL LN 107	MILWAUKEE, WI 53227
CURRENT OCCUPANT	3223 S LANDL LN 112	MILWAUKEE, WI 53227
CURRENT OCCUPANT	3223 S LANDL LN 224	MILWAUKEE, WI 53227
CURRENT OCCUPANT	3235 S LANDL LN 218	MILWAUKEE, WI 53227
CURRENT OCCUPANT	3235 S LANDL LN 219	MILWAUKEE, WI 53227
CURRENT OCCUPANT	3235 S LANDL LN 328	MILWAUKEE, WI 53227
CURRENT OCCUPANT	3235 S LANDL LN 332	MILWAUKEE, WI 53227
CURRENT OCCUPANT	3235 S LANDL LN 334	MILWAUKEE, WI 53227
CURRENT OCCUPANT	3218 S LANDL LN 214	MILWAUKEE, WI 53227
CURRENT OCCUPANT	3218 S LANDL LN 321	MILWAUKEE, WI 53227
CURRENT OCCUPANT	3227 S LANDL LN 215	MILWAUKEE, WI 53227
CURRENT OCCUPANT	3227 S LANDL LN 216	MILWAUKEE, WI 53227
CURRENT OCCUPANT	3231 S LANDL LN 219	MILWAUKEE, WI 53227
CURRENT OCCUPANT	3211 S LANDL LN 214	MILWAUKEE, WI 53227
CURRENT OCCUPANT	3211 S LANDL LN 215	MILWAUKEE, WI 53227
CURRENT OCCUPANT	3211 S LANDL LN 216	MILWAUKEE, WI 53227
CURRENT OCCUPANT	3215 S LANDL LN 111	MILWAUKEE, WI 53227
CURRENT OCCUPANT	3215 S LANDL LN 224	MILWAUKEE, WI 53227
CURRENT OCCUPANT	3243 S 92ND ST 114	MILWAUKEE, WI 53227
CURRENT OCCUPANT	3243 S 92ND ST 104	MILWAUKEE, WI 53227
CURRENT OCCUPANT	3243 S 92ND ST 200	MILWAUKEE, WI 53227
CURRENT OCCUPANT	3243 S 92ND ST 100	MILWAUKEE, WI 53227
CURRENT OCCUPANT	3249 S 91ST ST	MILWAUKEE, WI 53227
CURRENT OCCUPANT	3219 S LANDL LN 101	MILWAUKEE, WI 53227
CURRENT OCCUPANT	3223 S LANDL LN 111	MILWAUKEE, WI 53227
CURRENT OCCUPANT	3223 S LANDL LN 221	MILWAUKEE, WI 53227
CURRENT OCCUPANT	3231 S LANDL LN 220	MILWAUKEE, WI 53227
CURRENT OCCUPANT	3231 S LANDL LN 224	MILWAUKEE, WI 53227
CURRENT OCCUPANT	3235 S LANDL LN 112	MILWAUKEE, WI 53227
CURRENT OCCUPANT	3235 S LANDL LN 214	MILWAUKEE, WI 53227
CURRENT OCCUPANT	3235 S LANDL LN 221	MILWAUKEE, WI 53227
CURRENT OCCUPANT	3235 S LANDL LN 336	MILWAUKEE, WI 53227
CURRENT OCCUPANT	3218 S LANDL LN 102	MILWAUKEE, WI 53227
CURRENT OCCUPANT	3218 S LANDL LN 108	MILWAUKEE, WI 53227
CURRENT OCCUPANT	3218 S LANDL LN 110	MILWAUKEE, WI 53227
CURRENT OCCUPANT	3218 S LANDL LN 216	MILWAUKEE, WI 53227
CURRENT OCCUPANT	3218 S LANDL LN 324	MILWAUKEE, WI 53227
CURRENT OCCUPANT	3218 S LANDL LN 329	MILWAUKEE, WI 53227
CURRENT OCCUPANT	3227 S LANDL LN 101	MILWAUKEE, WI 53227
CURRENT OCCUPANT	3227 S LANDL LN 218	MILWAUKEE, WI 53227
CURRENT OCCUPANT	3231 S LANDL LN 108	MILWAUKEE, WI 53227

CURRENT OCCUPANT	3231 S LANDL LN 109	MILWAUKEE, WI 53227
CURRENT OCCUPANT	3215 S LANDL LN 112	MILWAUKEE, WI 53227
CURRENT OCCUPANT	3215 S LANDL LN 219	MILWAUKEE, WI 53227
CURRENT OCCUPANT	3215 S LANDL LN 222	MILWAUKEE, WI 53227
CURRENT OCCUPANT	3243 S 92ND ST 102	MILWAUKEE, WI 53227
CURRENT OCCUPANT	3243 S 92ND ST 204	MILWAUKEE, WI 53227
CURRENT OCCUPANT	3243 S 92ND ST 111	MILWAUKEE, WI 53227
CURRENT OCCUPANT	3222 S 92ND ST A	MILWAUKEE, WI 53227
CURRENT OCCUPANT	3264 S 92ND ST E	MILWAUKEE, WI 53227
CURRENT OCCUPANT	3243 S 92ND ST 105	MILWAUKEE, WI 53227
CURRENT OCCUPANT	3243 S 92ND ST 207	MILWAUKEE, WI 53227
CURRENT OCCUPANT	3243 S 92ND ST 203	MILWAUKEE, WI 53227
CURRENT OCCUPANT	3243 S 92ND ST 304	MILWAUKEE, WI 53227
CURRENT OCCUPANT	3248A S 92ND ST	MILWAUKEE, WI 53227
CURRENT OCCUPANT	3257 S 91ST ST	MILWAUKEE, WI 53227
CURRENT OCCUPANT	3219 S LANDL LN 217	MILWAUKEE, WI 53227
CURRENT OCCUPANT	3223 S LANDL LN 220	MILWAUKEE, WI 53227
CURRENT OCCUPANT	3235 S LANDL LN 102	MILWAUKEE, WI 53227
CURRENT OCCUPANT	3235 S LANDL LN 105	MILWAUKEE, WI 53227
CURRENT OCCUPANT	3235 S LANDL LN 107	MILWAUKEE, WI 53227
CURRENT OCCUPANT	3235 S LANDL LN 224	MILWAUKEE, WI 53227
CURRENT OCCUPANT	3218 S LANDL LN 105	MILWAUKEE, WI 53227
CURRENT OCCUPANT	3218 S LANDL LN 218	MILWAUKEE, WI 53227
CURRENT OCCUPANT	3227 S LANDL LN 217	MILWAUKEE, WI 53227
CURRENT OCCUPANT	3211 S LANDL LN 101	MILWAUKEE, WI 53227
CURRENT OCCUPANT	3211 S LANDL LN 218	MILWAUKEE, WI 53227
CURRENT OCCUPANT	3215 S LANDL LN 108	MILWAUKEE, WI 53227
CURRENT OCCUPANT	3215 S LANDL LN 221	MILWAUKEE, WI 53227
CURRENT OCCUPANT	3215 S LANDL LN 223	MILWAUKEE, WI 53227
CURRENT OCCUPANT	3243 S 92ND ST 108	MILWAUKEE, WI 53227
CURRENT OCCUPANT	3222 S 92ND ST B	MILWAUKEE, WI 53227
CURRENT OCCUPANT	3267 S 91ST ST	MILWAUKEE, WI 53227
CURRENT OCCUPANT	3264 S 92ND ST B	MILWAUKEE, WI 53227
CURRENT OCCUPANT	3264 S 92ND ST C	MILWAUKEE, WI 53227
CURRENT OCCUPANT	3255 S 92ND ST	MILWAUKEE, WI 53227
CURRENT OCCUPANT	3256 S 92ND ST 2	MILWAUKEE, WI 53227
CURRENT OCCUPANT	3243 S 92ND ST 112	MILWAUKEE, WI 53227
CURRENT OCCUPANT	3243 S 92ND ST 306	MILWAUKEE, WI 53227
CURRENT OCCUPANT	3243 S 92ND ST 208	MILWAUKEE, WI 53227
CURRENT OCCUPANT	3243 S 92ND ST 212	MILWAUKEE, WI 53227
CURRENT OCCUPANT	3219 S LANDL LN 214	MILWAUKEE, WI 53227
CURRENT OCCUPANT	3223 S LANDL LN 110	MILWAUKEE, WI 53227
CURRENT OCCUPANT	3223 S LANDL LN 219	MILWAUKEE, WI 53227
CURRENT OCCUPANT	3223 S LANDL LN 222	MILWAUKEE, WI 53227
CURRENT OCCUPANT	3231 S LANDL LN 223	MILWAUKEE, WI 53227
CURRENT OCCUPANT	3235 S LANDL LN 223	MILWAUKEE, WI 53227
CURRENT OCCUPANT	3235 S LANDL LN 335	MILWAUKEE, WI 53227

CURRENT OCCUPANT	3218 S LANDL LN 211	MILWAUKEE, WI 53227
CURRENT OCCUPANT	3211 S LANDL LN 103	MILWAUKEE, WI 53227
CURRENT OCCUPANT	3243 S 92ND ST 106	MILWAUKEE, WI 53227
CURRENT OCCUPANT	3243 S 92ND ST 303	MILWAUKEE, WI 53227
CURRENT OCCUPANT	3243 S 92ND ST 214	MILWAUKEE, WI 53227
CURRENT OCCUPANT	3243 S 92ND ST 205	MILWAUKEE, WI 53227
CURRENT OCCUPANT	3243 S 92ND ST 110	MILWAUKEE, WI 53227
CURRENT OCCUPANT	3243 S 92ND ST 101	MILWAUKEE, WI 53227
CURRENT OCCUPANT	3219 S LANDL LN 102	MILWAUKEE, WI 53227
CURRENT OCCUPANT	3219 S LANDL LN 103	MILWAUKEE, WI 53227
CURRENT OCCUPANT	3223 S LANDL LN 108	MILWAUKEE, WI 53227
CURRENT OCCUPANT	3235 S LANDL LN 104	MILWAUKEE, WI 53227
CURRENT OCCUPANT	3235 S LANDL LN 108	MILWAUKEE, WI 53227
CURRENT OCCUPANT	3235 S LANDL LN 111	MILWAUKEE, WI 53227
CURRENT OCCUPANT	3235 S LANDL LN 216	MILWAUKEE, WI 53227
CURRENT OCCUPANT	3235 S LANDL LN 331	MILWAUKEE, WI 53227
CURRENT OCCUPANT	3218 S LANDL LN 106	MILWAUKEE, WI 53227
CURRENT OCCUPANT	3218 S LANDL LN 212	MILWAUKEE, WI 53227
CURRENT OCCUPANT	3218 S LANDL LN 215	MILWAUKEE, WI 53227
CURRENT OCCUPANT	3218 S LANDL LN 217	MILWAUKEE, WI 53227
CURRENT OCCUPANT	3218 S LANDL LN 220	MILWAUKEE, WI 53227
CURRENT OCCUPANT	3218 S LANDL LN 330	MILWAUKEE, WI 53227
CURRENT OCCUPANT	3227 S LANDL LN 214	MILWAUKEE, WI 53227
CURRENT OCCUPANT	3231 S LANDL LN 112	MILWAUKEE, WI 53227
CURRENT OCCUPANT	3215 S LANDL LN 220	MILWAUKEE, WI 53227
CURRENT OCCUPANT	3243 S 92ND ST 206	MILWAUKEE, WI 53227
CURRENT OCCUPANT	3243 S 92ND ST 201	MILWAUKEE, WI 53227
CURRENT OCCUPANT	3264 S 92ND ST A	MILWAUKEE, WI 53227
CURRENT OCCUPANT	3248B S 92ND ST	MILWAUKEE, WI 53227
CURRENT OCCUPANT	3219 S LANDL LN 215	MILWAUKEE, WI 53227
CURRENT OCCUPANT	3219 S LANDL LN 218	MILWAUKEE, WI 53227
CURRENT OCCUPANT	3223 S LANDL LN 109	MILWAUKEE, WI 53227
CURRENT OCCUPANT	3223 S LANDL LN 223	MILWAUKEE, WI 53227
CURRENT OCCUPANT	3231 S LANDL LN 221	MILWAUKEE, WI 53227
CURRENT OCCUPANT	3235 S LANDL LN 103	MILWAUKEE, WI 53227
CURRENT OCCUPANT	3235 S LANDL LN 215	MILWAUKEE, WI 53227
CURRENT OCCUPANT	3235 S LANDL LN 220	MILWAUKEE, WI 53227
CURRENT OCCUPANT	3235 S LANDL LN 327	MILWAUKEE, WI 53227
CURRENT OCCUPANT	3235 S LANDL LN 333	MILWAUKEE, WI 53227
CURRENT OCCUPANT	3218 S LANDL LN 101	MILWAUKEE, WI 53227
CURRENT OCCUPANT	3218 S LANDL LN 107	MILWAUKEE, WI 53227
CURRENT OCCUPANT	3218 S LANDL LN 109	MILWAUKEE, WI 53227
CURRENT OCCUPANT	3218 S LANDL LN 322	MILWAUKEE, WI 53227
CURRENT OCCUPANT	3227 S LANDL LN 102	MILWAUKEE, WI 53227
CURRENT OCCUPANT	3227 S LANDL LN 103	MILWAUKEE, WI 53227
CURRENT OCCUPANT	3231 S LANDL LN 110	MILWAUKEE, WI 53227
CURRENT OCCUPANT	3211 S LANDL LN 213	MILWAUKEE, WI 53227

CURRENT OCCUPANT	3243 S 92ND ST 305	MILWAUKEE, WI 53227
CURRENT OCCUPANT	3243 S 92ND ST 107	MILWAUKEE, WI 53227
CURRENT OCCUPANT	3254 S 92ND ST	MILWAUKEE, WI 53227
CURRENT OCCUPANT	3254 S 92ND ST B	MILWAUKEE, WI 53227
CURRENT OCCUPANT	3243 S 92ND ST 210	MILWAUKEE, WI 53227
CURRENT OCCUPANT	3243 S 92ND ST 302	MILWAUKEE, WI 53227
CURRENT OCCUPANT	3243 S 92ND ST 202	MILWAUKEE, WI 53227
CURRENT OCCUPANT	3246 S 92ND ST	MILWAUKEE, WI 53227
CURRENT OCCUPANT	3219 S LANDL LN 105	MILWAUKEE, WI 53227
CURRENT OCCUPANT	3219 S LANDL LN 106	MILWAUKEE, WI 53227
CURRENT OCCUPANT	3219 S LANDL LN 213	MILWAUKEE, WI 53227
CURRENT OCCUPANT	3219 S LANDL LN 216	MILWAUKEE, WI 53227
CURRENT OCCUPANT	3231 S LANDL LN 222	MILWAUKEE, WI 53227
CURRENT OCCUPANT	3235 S LANDL LN 101	MILWAUKEE, WI 53227
CURRENT OCCUPANT	3235 S LANDL LN 109	MILWAUKEE, WI 53227
CURRENT OCCUPANT	3235 S LANDL LN 110	MILWAUKEE, WI 53227
CURRENT OCCUPANT	3235 S LANDL LN 217	MILWAUKEE, WI 53227
CURRENT OCCUPANT	3235 S LANDL LN 326	MILWAUKEE, WI 53227
CURRENT OCCUPANT	3235 S LANDL LN 329	MILWAUKEE, WI 53227
CURRENT OCCUPANT	3218 S LANDL LN 103	MILWAUKEE, WI 53227
CURRENT OCCUPANT	3218 S LANDL LN 219	MILWAUKEE, WI 53227
CURRENT OCCUPANT	3227 S LANDL LN 104	MILWAUKEE, WI 53227
CURRENT OCCUPANT	3227 S LANDL LN 105	MILWAUKEE, WI 53227
CURRENT OCCUPANT	3227 S LANDL LN 106	MILWAUKEE, WI 53227
CURRENT OCCUPANT	3227 S LANDL LN 213	MILWAUKEE, WI 53227
CURRENT OCCUPANT	3211 S LANDL LN 217	MILWAUKEE, WI 53227
CURRENT OCCUPANT	3215 S LANDL LN 109	MILWAUKEE, WI 53227
CURRENT OCCUPANT	3243 S 92ND ST 209	MILWAUKEE, WI 53227
CURRENT OCCUPANT	3256 S 92ND ST 1	MILWAUKEE, WI 53227
CURRENT OCCUPANT	3243 S 92ND ST 211	MILWAUKEE, WI 53227
CURRENT OCCUPANT	3243 S 92ND ST 213	MILWAUKEE, WI 53227
CURRENT OCCUPANT	3243 S 92ND ST 307	MILWAUKEE, WI 53227
CURRENT OCCUPANT	3219 S LANDL LN 104	MILWAUKEE, WI 53227
CURRENT OCCUPANT	3235 S LANDL LN 106	MILWAUKEE, WI 53227
CURRENT OCCUPANT	3235 S LANDL LN 213	MILWAUKEE, WI 53227
CURRENT OCCUPANT	3235 S LANDL LN 222	MILWAUKEE, WI 53227
CURRENT OCCUPANT	3235 S LANDL LN 325	MILWAUKEE, WI 53227
CURRENT OCCUPANT	3235 S LANDL LN 330	MILWAUKEE, WI 53227
CURRENT OCCUPANT	3218 S LANDL LN 104	MILWAUKEE, WI 53227
CURRENT OCCUPANT	3218 S LANDL LN 213	MILWAUKEE, WI 53227
CURRENT OCCUPANT	3218 S LANDL LN 323	MILWAUKEE, WI 53227
CURRENT OCCUPANT	3218 S LANDL LN 325	MILWAUKEE, WI 53227
CURRENT OCCUPANT	3218 S LANDL LN 326	MILWAUKEE, WI 53227
CURRENT OCCUPANT	3218 S LANDL LN 327	MILWAUKEE, WI 53227
CURRENT OCCUPANT	3218 S LANDL LN 328	MILWAUKEE, WI 53227
CURRENT OCCUPANT	3231 S LANDL LN 107	MILWAUKEE, WI 53227
CURRENT OCCUPANT	3231 S LANDL LN 111	MILWAUKEE, WI 53227

CURRENT OCCUPANT	3211 S LANDL LN 102	MILWAUKEE, WI 53227
CURRENT OCCUPANT	3211 S LANDL LN 104	MILWAUKEE, WI 53227
CURRENT OCCUPANT	3211 S LANDL LN 105	MILWAUKEE, WI 53227
CURRENT OCCUPANT	3211 S LANDL LN 106	MILWAUKEE, WI 53227
CURRENT OCCUPANT	3215 S LANDL LN 107	MILWAUKEE, WI 53227
CURRENT OCCUPANT	3215 S LANDL LN 110	MILWAUKEE, WI 53227
CURRENT OCCUPANT	3243 S 92ND ST 301	MILWAUKEE, WI 53227
CURRENT OCCUPANT	3243 S 92ND ST 103	MILWAUKEE, WI 53227
CURRENT OCCUPANT	9229 W BELOIT RD	MILWAUKEE, WI 53227
CURRENT OCCUPANT	3264 S 92ND ST D	MILWAUKEE, WI 53227

Total Records: 197

Radius: 250.0 feet and Center of Circle: 3224 S 9nd St



TATTOO & BODY PIERCING ESTABLISHMENT LICENSE SUPPLEMENTAL RENEWAL APPLICATION

Office of the City Clerk License Division
200 E. Wells St. Room 105, Milwaukee, WI 53202
(414) 286-2238 license@milwaukee.gov www.milwaukee.gov/license

BLAKE, IV, Clifford D, Agent
Ruckus Art, LLC
314 E SPOONER RD
Milwaukee WI 53217

AD 11

Current License Expiration Date: 6/30/2019

Tattoo Application

Due Date: 4/18/2019

Renewal Fee: \$200

\$25 Late Fee Begins: 4/19/2019

SERVICES OFFERED (check all that apply)

TATTOO SERVICES

- Tattoo
- Tattoo Removal
- Permanent Makeup
- Microblading

Other Body Art:

- Scarification
- Braiding
- Other:
- Subdermal Implants
- Branding

PIERCING SERVICES

- Body Piercing
- Ear Piercing
- Microdermals
- Other:

HOURS OF OPERATION

Are there any changes to the current hours of operation? No Yes If yes, describe: _____

Your current hours of operation are listed on your current license.

An Extended Hours Establishment License is required to operate during the hours of 12:00 a.m. and 5:00 a.m.

HAND WASHING

Describe the hand washing method used in procedure area(s)? Wash hands thoroughly w/ anti-bacterial soap for one min. w/ vigorous scrubbing & rinse & dry

PLAN OF OPERATION

Are there any changes to your Litter/Noise plan? No Yes If yes, describe: _____

Are there any changes to your current plan of operation or floor plan*? No Yes If yes, describe: _____

*If there are changes to the floor plan, a new floor plan must be submitted with this renewal application. A sample plan can be found online at www.milwaukee.gov/licenses under License Forms and Related Information.

ACKNOWLEDGEMENT & SIGNATURE

By signing below, I certify that all the information on this application is correct and acknowledge that any change in the information on the application shall be reported to the City Clerk's License Division within 10 days of the change. I shall promptly notify the City Clerk's License Division in writing if my establishment ceases operation.

Signature of Sole Proprietor, Partner, Agent or 20% or More Shareholder

Complete Reverse Side