

AFFIDAVIT OF CORRECTION

Document Number

AFFIANT, Baiba M. Rozite, hereby swears or affirms that a certain document known as Certified Survey Map No. 8010, recorded on December 21, 2007, as Document No. 09538314, in Milwaukee County, State of Wisconsin, contained the following error:

The bearing in line 21 of the Surveyor's Certificate, on Sheet 2 of 6 is shown incorrectly as "N34°14'51"E, 35.88 feet."

AFFIANT makes this Affidavit for the purpose of correcting the above document as follows:

The bearing in line 21 of the Surveyor's Certificate, on Sheet 2 of 6 is changed to "N34°14'51"W, 35.88 feet."

AFFIANT is the drafter of the document being corrected.

The original document is not attached to the Affidavit.

Signed: Baiba M. Rozite 1-16-2008  
Baiba M. Rozite, Registration No. S-2351

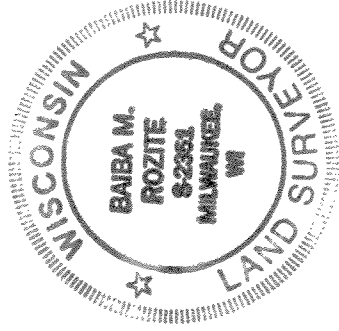

State of Wisconsin )  
                                  ) SS.  
County of Milwaukee)

Subscribed and sworn to (or affirmed) before me this 16 day of January, 2008

David L. Gessnick  
David L. Gessnick (print name)

Notary Public, State of Wisconsin  
My Commission expires: 3/2/08

THIS INSTRUMENT WAS DRAFTED BY: Baiba M. Rozite  
This instrument IS NOT a conveyance of real property as per s. 77.21(1) Wisconsin Statutes (A Wisconsin Real Estate Transfer Return is required for instruments that do convey real property.)

DEPARTMENT OF CITY  
DEVELOPMENT  
CITY OF MILWAUKEE

JAN 24 2008

[Signature]  
STAFF APPROVED

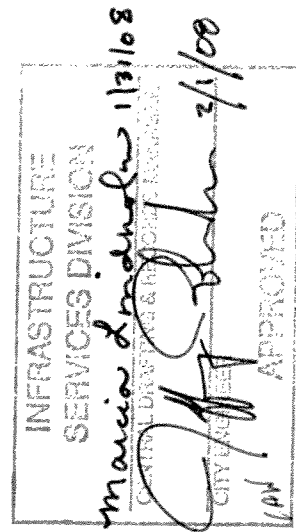

Name and Return Address  
Recording Area

SIGMA DEVELOPMENT, INC.  
1300 W. CANAL STREET  
MILWAUKEE, WI 53233

Parcel Identification Number (PIN)

Common Council Certificate of Approval

I certify that this Affidavit of Correction for Certified Survey Map No. 8010 was approved under Resolution File No.

by the Common Council of the City of Milwaukee on \_\_\_\_\_, adopted

Ronald D. Leonhardt, City Clerk

Tom Barrett, Mayor