

CITY OF MILWAUKEE

01 JUL 23 PM 2: 20

RONALD D. LEONHARDT  
CITY CLERK

**Blue Circle Cement**

712 W. Canal Street  
Milwaukee, WI. 53233  
(414) 276-4408  
Fax: (414) 276-0568

July 20, 2001

The following is a summary of costs accrued by Blue Circle Cement starting April 10, 2001 to June 13, 2001, due to construction of the 6<sup>th</sup> Street Viaduct:

Dredging needed to be done along south canal dock wall in order for tug and barge to fit in properly. We had to reverse the order of the tug and barge. It normally comes in tug first, but because of the tight space and water depth, it had to be reversed.

✓ - HAVE: ✓ Cost: \$44,028.00

The disposal of dredging material.

Cost: \$16,440.00

+ /  
\$60,468.00

Unloading pipes had to be relocated in order for barge hoses to connect. This involved moving the pipes to the opposite end of the dock because of the reversal of the tug and barge.

✓ Cost: \$28,000.00

Miscellaneous costs, such as:

- ✓ Crane services. -- \$620.00
- ✓ Grading and hauling of underground concrete for placement of pipe.-- \$4,285.00
- ✓ Miscellaneous clean-up.-- \$4,100.00

Cost: \$9,005.00

+ /  
\$37,005.00

✓ Expenses accrued by Senior Terminals Manager for meetings.

Cost: \$2,632.00

Transportation cost for railcars needed to bring in cement during This period.

Cost: \$63,272.00

Loss of profit during this period:

Cost: \$150,000.00

TOTAL COST

+ /  
\$313,377.00

Attachments

OFFICE OF  
CITY ATTORNEY  
CITY OF MILWAUKEE  
RECEIVED  
01 JUL 23 PM 4: 13

Kadinger Marine Service, Inc.  
401 East Greenfield Avenue  
Milwaukee, WI 53204

**INVOICE**

Invoice Number

1596

Invoice Date

Jun 7, 2001

Page

Voice: (414) 383-2040  
Fax: (414) 383-0718

Duplicate

Sold To:  
Blue Circle Cement  
240 Jefferson Ave.  
Cleveland, OH 44113

Ship to:

Customer ID		Customer PO		Payment Terms	
Blue Circle C				C.O.D.	
Sales Rep ID		Shipping Method		Ship Date	Due Date
		UPS Ground			6/7/01
Quantity	Item	Description	Unit Price	Extension	
		6/1/01 DREDGING 1 load 300yards@12.23 per yard		3,669.00	
		6/2/01 DREDGING 3 loads 900yards@12.23 per yard		11,007.00	
		6/4/01 DREDGING 4 loads 1200yards@12.23 per yard		14,676.00	
		6/5/01 DREDGING 4 loads 1200yards@12.23 per yard		14,676.00	

670000  
 61390000  
 Linda R.  
 7-6-01  
 # 44,028.00 DUE  
 DUE NOW

Subtotal 44,028.00  
 Sales Tax  
 Total Invoice Amount 44,028.00  
 Payment Received  
 TOTAL 44,028.00

Check No

TOTAL \$ 44,028.00

**MIDWEST MACHINERY**  
**MAINTENANCE INC.**

28600 Martha Ct.  
 Waterford, Wisconsin 53185  
 Phone: 895-6447

DATE	5/17/01
NO	2249

STEEL FABRICATION - Erection - Installation  
 MACHINERY MOVING - MILLWRIGHT WORK  
 CONVEYOR INSTALLATION and MAINTENANCE  
 BALER INSTALLATION and MAINTENANCE  
 PRINTING MCHY. and COMPUTER INSTALLATION

Blue Circle Cement Co.  
712 West Canal Street  
Milwaukee, WI. 53233

ATT'N: LINDA RAMBOUSEK

TERMS: NET

\$ 14,000.00

DATE	CHARGES AND CREDITS	BALANCE
	BALANCE FORWARD	
	EMERGENCY PROJECT:	
	Run approx. 400' of 10" pipe for	
	Barge Unload.	
	50% Down for Materials	\$14,000.00
	670000	
	6790200	
	5-18-01	
	Linda Rambousek	
	<u>DUE NOW</u>	

*Thank You*

PAY LAST AMOUNT  
 IN THIS COLUMN

1 1/2% Interest charged after 30 days

**MIDWEST MACHINERY**

**MAINTENANCE INC.**

STEEL FABRICATION • Erection • Installation  
MACHINERY MOVING • MILLWRIGHT WORK  
CONVEYOR INSTALLATION and MAINTENANCE  
BALER INSTALLATION and MAINTENANCE  
PRINTING MCHY. and COMPUTER INSTALLATION

28600 Martha Ct.  
Waterford, Wisconsin 53185  
Phone: 895-6447

DATE
6/4/01
No 2256

Blue Circle Cement Co.

712 West Canal Street

Milwaukee, WI. 53233

ATT'N: LINDA RAMBOUSEK

TERMS: NET: 10 DAYS

\$ 14,000.00

DATE	CHARGES AND CREDITS	BALANCE
	BALANCE FORWARD	
	Ran approx. 400' of 10" pipe for Barge Unload.	
	Balance Due	\$14,000 00
	670000	
	61790200	
	Linda R. [Signature]	
	6-6-01	
	JOB complete	

1½% Interest charged after 30 days

Thank You

PAY LAST AMOUNT  
IN THIS COLUMN

*Lower Lakes Marine Services*

1200 W. Canal Street  
 Milwaukee, WI 53233  
 Phone: 414-384-6495

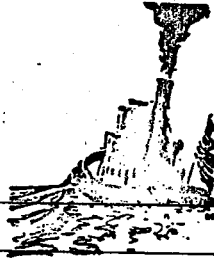

**PURCHASE  
 ORDER**

053966

DATE

6-13-01

ISSUED TO:

ADDRESS

SHIP TO:

BLUE CIRCLE

ADDRESS

SHIP VIA	FOB	TERMS	DATE REQUIRED

	ORDERED	REC'D	ITEMS	PRICE	PER	AMOUNT
1	1 HR		CRANE SERVICE			130.00
2			TRUCK			50.00
3	1 HR		LABOR			25.00
4			CABLE			25.00
5						230.00
6						
7						
8						
9						
10						
11						
12						

670000  
 61390000  
 J. J. R.  
 6-17-01  
 BLUE  
 NOW

**IMPORTANT:**  
 Our order number must appear on all  
 invoices, packages and correspondence.  
 Advise us if unable to deliver complete  
 order by the date required

BUYER \_\_\_\_\_



©1993 ACCO USA, Inc.

Carbonless  
 S8258-CL Duplicate  
 S8358-CL Triplicate

*Lower Lakes Marine Services*

1200 W. Canal Street  
 Milwaukee, WI 53233  
 Phone: 414-384-6495



**PURCHASE  
 ORDER**

053967

DATE

6-14-01

ISSUED TO:

ADDRESS

SHIP TO:

BLUE CIRCLE

ADDRESS

SHIP VIA	FOB	TERMS	DATE REQUIRED

	ORDERED	REC'D	ITEMS	PRICE	PER	AMOUNT
1	3 HRS		CRANE SERVICE			
2			@ 130.00			390.00
3						
4						
5						
6						
7						
8						
9						
10						
11						
12						

670000  
 61390000 P.  
 J. J. P.  
 7-12-01  
 DUE  
 NOW

**IMPORTANT:**  
 Our order number must appear on all  
 invoices, packages and correspondence.  
 Advise us if unable to deliver complete  
 order by the date required

BUYER \_\_\_\_\_



©1993 ACCO USA, Inc.

Carbonless  
 S828-CL Duplicate  
 S835P-CL Triplicate

A - 1 Grading & Landscape  
6404 23rd ave Kenosha Wi. 53143  
(262)-945-5122

# Invoice

DATE	INVOICE #
6/19/01	105

BILL TO	SHIP TO
Blue Circle Cement 712 West Canal Street Milwaukee Wi. 53233	Same

DUE DATE	P.O. NUMBER
7/19/01	

ITEM	DESCRIPTION	QTY	RATE	AMOUNT
material removal	Break out concrete and hardend cement, and load out	1	2,775.00	2,775.00
Trucking	Haul out concrete and cement	1	1,250.00	1,250.00
Disposal	Dumping charges	1	260.00	260.00
<p style="text-align: center;"><i>670000 61370000 Linda R. 7-16-01 DUE NOW</i></p>				
Verbal per Linda				
Subtotal				4,285.00
0% Tax				
<b>Total</b>				<b>4,285.00</b>

**MIDWEST MACHINERY**

**MAINTENANCE INC.**

28600 Martha Ct.  
Waterford, Wisconsin 53185  
Phone: 895-6447

STEEL FABRICATION • Erection • Installation  
MACHINERY MOVING • MILLWRIGHT WORK  
CONVEYOR INSTALLATION and MAINTENANCE  
BALER INSTALLATION and MAINTENANCE  
PRINTING MCHY. and COMPUTER INSTALLATION

DATE	6/4/01
No	2258

Blue Circle Cement Co.

712 West Canal Street

Milwaukee, WI. 53233

ATT'N: LINDA RAMBOUSEK

TERMS: NET: 10 DAYS

\$ 4,100.00

*670000  
61390000  
P  
6-5-01*

DATE	CHARGES AND CREDITS	BALANCE
	BALANCE FORWARD	
	EXTRAS - BCC	
	Extra for Back Hoe digging around sheeting walls, footings, boulders, etc. Haul away large concrete pieces	1,210 00
	Jack Hammer and burn off 2 sheeting walls.	1,120 00
	Clean up pipes and tires -sludge was deposited on them from the dredger.	
	Clean up debris from rest of area.	990 00
	Saw up wood pilings and haul away.	175 00
	Install hand rail by Dock area.	550 00
	Install cabinet by Dock area for Life savers and Life Jackets.	55 00
	TOTAL	\$4,100 00

*Thank You*

PAY LAST AMOUNT  
IN THIS COLUMN

1½% Interest charged after 30 days



**Rambousek Linda**

---

**From:** Pajk Jim  
**Sent:** Friday, July 20, 2001 1:06 PM  
**To:** Rambousek Linda  
**Subject:** Expenses

Expenses for meetings regarding bridge issue:

<b>Airfare</b>	<b>Date</b>
\$735.00	3/27/01
\$421.00	4/17/01
\$401.00	5/09/01
\$755.00	6/13/01
<hr/>	
\$2312.00	
\$ 320.00	car rental (4 x \$80)
<hr/>	
\$2632.00	Total expenses

**Jim Pajk**  
Senior Terminals Manager  
Great Lakes Region  
Blue Circle Cement  
Cleveland, Ohio  
[jipajk@bluecir.com](mailto:jipajk@bluecir.com)

360+00

TRAIN PLATFORM

O/H PIPELINE

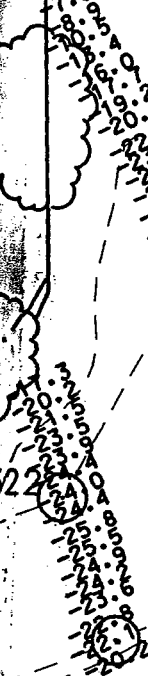

3.6

320

12.2  
11.2  
10.2  
9.2  
8.2  
7.2  
6.2  
5.2  
4.2  
3.2  
2.2  
1.2  
0.2  
-0.8  
-1.8  
-2.8  
-3.8  
-4.8  
-5.8  
-6.8  
-7.8  
-8.8  
-9.8  
-10.8  
-11.8  
-12.8  
-13.8  
-14.8  
-15.8  
-16.8  
-17.8  
-18.8  
-19.8  
-20.8  
-21.8  
-22.8  
-23.8  
-24.8  
-25.8  
-26.8  
-27.8  
-28.8  
-29.8  
-30.8  
-31.8  
-32.8  
-33.8  
-34.8  
-35.8  
-36.8  
-37.8  
-38.8  
-39.8  
-40.8  
-41.8  
-42.8  
-43.8  
-44.8  
-45.8  
-46.8  
-47.8  
-48.8  
-49.8  
-50.8  
-51.8  
-52.8  
-53.8  
-54.8  
-55.8  
-56.8  
-57.8  
-58.8  
-59.8  
-60.8  
-61.8  
-62.8  
-63.8  
-64.8  
-65.8  
-66.8  
-67.8  
-68.8  
-69.8  
-70.8  
-71.8  
-72.8  
-73.8  
-74.8  
-75.8  
-76.8  
-77.8  
-78.8  
-79.8  
-80.8  
-81.8  
-82.8  
-83.8  
-84.8  
-85.8  
-86.8  
-87.8  
-88.8  
-89.8  
-90.8  
-91.8  
-92.8  
-93.8  
-94.8  
-95.8  
-96.8  
-97.8  
-98.8  
-99.8  
-100.8

14.7  
13.7  
12.7  
11.7  
10.7  
9.7  
8.7  
7.7  
6.7  
5.7  
4.7  
3.7  
2.7  
1.7  
0.7  
-0.3  
-1.3  
-2.3  
-3.3  
-4.3  
-5.3  
-6.3  
-7.3  
-8.3  
-9.3  
-10.3  
-11.3  
-12.3  
-13.3  
-14.3  
-15.3  
-16.3  
-17.3  
-18.3  
-19.3  
-20.3  
-21.3  
-22.3  
-23.3  
-24.3  
-25.3  
-26.3  
-27.3  
-28.3  
-29.3  
-30.3  
-31.3  
-32.3  
-33.3  
-34.3  
-35.3  
-36.3  
-37.3  
-38.3  
-39.3  
-40.3  
-41.3  
-42.3  
-43.3  
-44.3  
-45.3  
-46.3  
-47.3  
-48.3  
-49.3  
-50.3  
-51.3  
-52.3  
-53.3  
-54.3  
-55.3  
-56.3  
-57.3  
-58.3  
-59.3  
-60.3  
-61.3  
-62.3  
-63.3  
-64.3  
-65.3  
-66.3  
-67.3  
-68.3  
-69.3  
-70.3  
-71.3  
-72.3  
-73.3  
-74.3  
-75.3  
-76.3  
-77.3  
-78.3  
-79.3  
-80.3  
-81.3  
-82.3  
-83.3  
-84.3  
-85.3  
-86.3  
-87.3  
-88.3  
-89.3  
-90.3  
-91.3  
-92.3  
-93.3  
-94.3  
-95.3  
-96.3  
-97.3  
-98.3  
-99.3  
-100.3

13.4  
12.4  
11.4  
10.4  
9.4  
8.4  
7.4  
6.4  
5.4  
4.4  
3.4  
2.4  
1.4  
0.4  
-0.6  
-1.6  
-2.6  
-3.6  
-4.6  
-5.6  
-6.6  
-7.6  
-8.6  
-9.6  
-10.6  
-11.6  
-12.6  
-13.6  
-14.6  
-15.6  
-16.6  
-17.6  
-18.6  
-19.6  
-20.6  
-21.6  
-22.6  
-23.6  
-24.6  
-25.6  
-26.6  
-27.6  
-28.6  
-29.6  
-30.6  
-31.6  
-32.6  
-33.6  
-34.6  
-35.6  
-36.6  
-37.6  
-38.6  
-39.6  
-40.6  
-41.6  
-42.6  
-43.6  
-44.6  
-45.6  
-46.6  
-47.6  
-48.6  
-49.6  
-50.6  
-51.6  
-52.6  
-53.6  
-54.6  
-55.6  
-56.6  
-57.6  
-58.6  
-59.6  
-60.6  
-61.6  
-62.6  
-63.6  
-64.6  
-65.6  
-66.6  
-67.6  
-68.6  
-69.6  
-70.6  
-71.6  
-72.6  
-73.6  
-74.6  
-75.6  
-76.6  
-77.6  
-78.6  
-79.6  
-80.6  
-81.6  
-82.6  
-83.6  
-84.6  
-85.6  
-86.6  
-87.6  
-88.6  
-89.6  
-90.6  
-91.6  
-92.6  
-93.6  
-94.6  
-95.6  
-96.6  
-97.6  
-98.6  
-99.6  
-100.6

15.6  
14.6  
13.6  
12.6  
11.6  
10.6  
9.6  
8.6  
7.6  
6.6  
5.6  
4.6  
3.6  
2.6  
1.6  
0.6  
-0.4  
-1.4  
-2.4  
-3.4  
-4.4  
-5.4  
-6.4  
-7.4  
-8.4  
-9.4  
-10.4  
-11.4  
-12.4  
-13.4  
-14.4  
-15.4  
-16.4  
-17.4  
-18.4  
-19.4  
-20.4  
-21.4  
-22.4  
-23.4  
-24.4  
-25.4  
-26.4  
-27.4  
-28.4  
-29.4  
-30.4  
-31.4  
-32.4  
-33.4  
-34.4  
-35.4  
-36.4  
-37.4  
-38.4  
-39.4  
-40.4  
-41.4  
-42.4  
-43.4  
-44.4  
-45.4  
-46.4  
-47.4  
-48.4  
-49.4  
-50.4  
-51.4  
-52.4  
-53.4  
-54.4  
-55.4  
-56.4  
-57.4  
-58.4  
-59.4  
-60.4  
-61.4  
-62.4  
-63.4  
-64.4  
-65.4  
-66.4  
-67.4  
-68.4  
-69.4  
-70.4  
-71.4  
-72.4  
-73.4  
-74.4  
-75.4  
-76.4  
-77.4  
-78.4  
-79.4  
-80.4  
-81.4  
-82.4  
-83.4  
-84.4  
-85.4  
-86.4  
-87.4  
-88.4  
-89.4  
-90.4  
-91.4  
-92.4  
-93.4  
-94.4  
-95.4  
-96.4  
-97.4  
-98.4  
-99.4  
-100.4

15.5  
14.5  
13.5  
12.5  
11.5  
10.5  
9.5  
8.5  
7.5  
6.5  
5.5  
4.5  
3.5  
2.5  
1.5  
0.5  
-0.5  
-1.5  
-2.5  
-3.5  
-4.5  
-5.5  
-6.5  
-7.5  
-8.5  
-9.5  
-10.5  
-11.5  
-12.5  
-13.5  
-14.5  
-15.5  
-16.5  
-17.5  
-18.5  
-19.5  
-20.5  
-21.5  
-22.5  
-23.5  
-24.5  
-25.5  
-26.5  
-27.5  
-28.5  
-29.5  
-30.5  
-31.5  
-32.5  
-33.5  
-34.5  
-35.5  
-36.5  
-37.5  
-38.5  
-39.5  
-40.5  
-41.5  
-42.5  
-43.5  
-44.5  
-45.5  
-46.5  
-47.5  
-48.5  
-49.5  
-50.5  
-51.5  
-52.5  
-53.5  
-54.5  
-55.5  
-56.5  
-57.5  
-58.5  
-59.5  
-60.5  
-61.5  
-62.5  
-63.5  
-64.5  
-65.5  
-66.5  
-67.5  
-68.5  
-69.5  
-70.5  
-71.5  
-72.5  
-73.5  
-74.5  
-75.5  
-76.5  
-77.5  
-78.5  
-79.5  
-80.5  
-81.5  
-82.5  
-83.5  
-84.5  
-85.5  
-86.5  
-87.5  
-88.5  
-89.5  
-90.5  
-91.5  
-92.5  
-93.5  
-94.5  
-95.5  
-96.5  
-97.5  
-98.5  
-99.5  
-100.5

15.0  
14.0  
13.0  
12.0  
11.0  
10.0  
9.0  
8.0  
7.0  
6.0  
5.0  
4.0  
3.0  
2.0  
1.0  
0.0  
-1.0  
-2.0  
-3.0  
-4.0  
-5.0  
-6.0  
-7.0  
-8.0  
-9.0  
-10.0  
-11.0  
-12.0  
-13.0  
-14.0  
-15.0  
-16.0  
-17.0  
-18.0  
-19.0  
-20.0  
-21.0  
-22.0  
-23.0  
-24.0  
-25.0  
-26.0  
-27.0  
-28.0  
-29.0  
-30.0  
-31.0  
-32.0  
-33.0  
-34.0  
-35.0  
-36.0  
-37.0  
-38.0  
-39.0  
-40.0  
-41.0  
-42.0  
-43.0  
-44.0  
-45.0  
-46.0  
-47.0  
-48.0  
-49.0  
-50.0  
-51.0  
-52.0  
-53.0  
-54.0  
-55.0  
-56.0  
-57.0  
-58.0  
-59.0  
-60.0  
-61.0  
-62.0  
-63.0  
-64.0  
-65.0  
-66.0  
-67.0  
-68.0  
-69.0  
-70.0  
-71.0  
-72.0  
-73.0  
-74.0  
-75.0  
-76.0  
-77.0  
-78.0  
-79.0  
-80.0  
-81.0  
-82.0  
-83.0  
-84.0  
-85.0  
-86.0  
-87.0  
-88.0  
-89.0  
-90.0  
-91.0  
-92.0  
-93.0  
-94.0  
-95.0  
-96.0  
-97.0  
-98.0  
-99.0  
-100.0

NEW BRIDGE

318

316

315

77-40

314

313

-12.7

-16.2

-20.1

-24.8

-29.5

-34.2

-38.9

-43.6

-48.3

-53.0

-57.7

-62.4

-67.1

-71.8

-76.5

-81.2

-85.9

-90.6

-95.3

-100.0

STREET

UNPAVE

N 383.0

UNPAV

OPEN STORAGE

O/H PIPELINE

NEW PIPELINE

89-9

STRUCTURE

STRUCTURE

CANAL

6TH

STREET

86-35

BILLBOARD

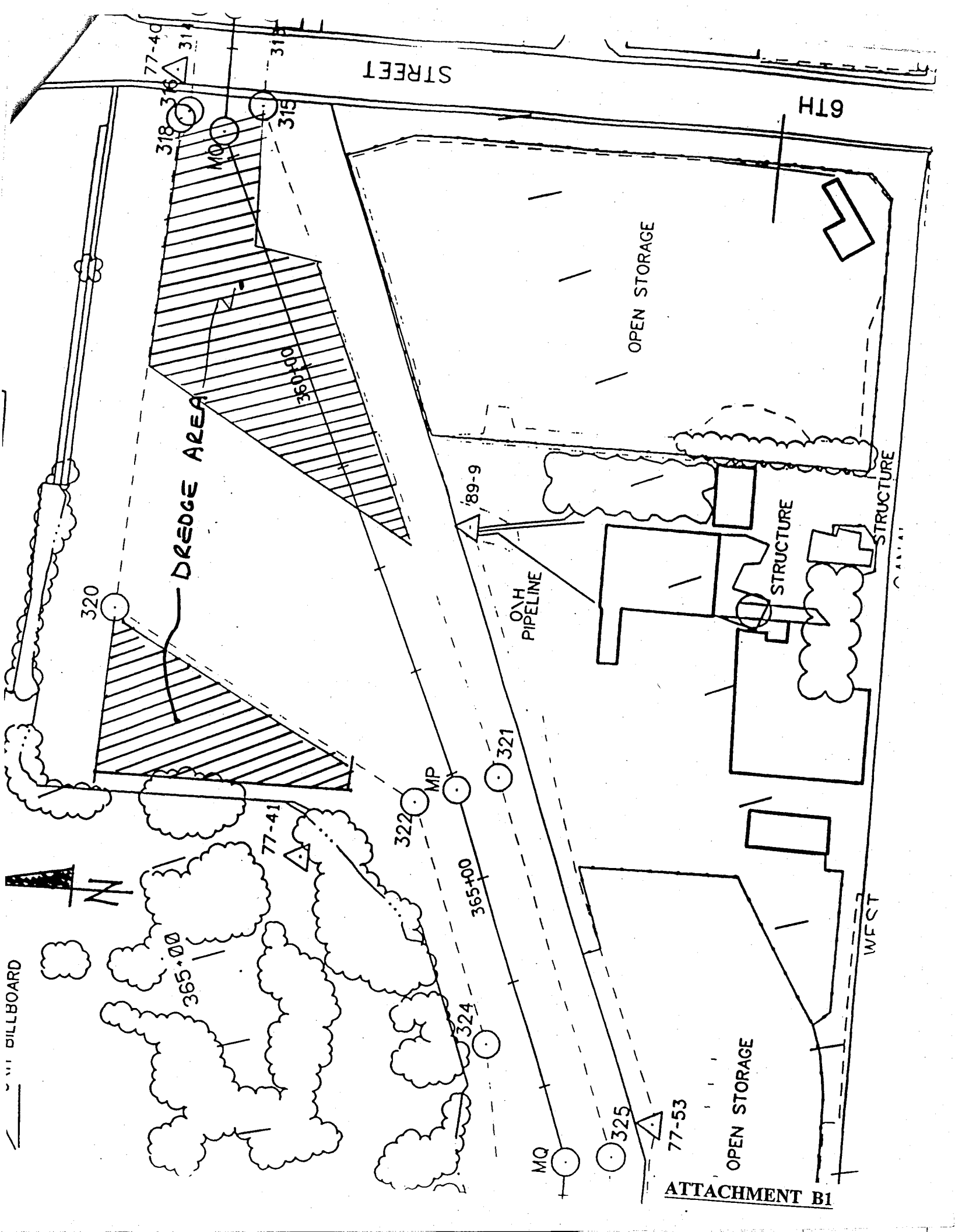
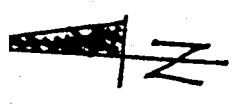

STREET

6TH

DREDGE AREA

OPEN STORAGE

OAH PIPELINE

STRUCTURE

STRUCTURE

WEST

OPEN STORAGE

ATTACHMENT B1

77-40

318

MQ

315

360+00

320

'89-9

77-41

322

MP

321

365+00

324

MQ

325

77-53

ST. MARY'S BARGE  
TUG TRITON

460'  
 Length  
 TUG + BARGE  
 TOGETHER  
 60' WIDE

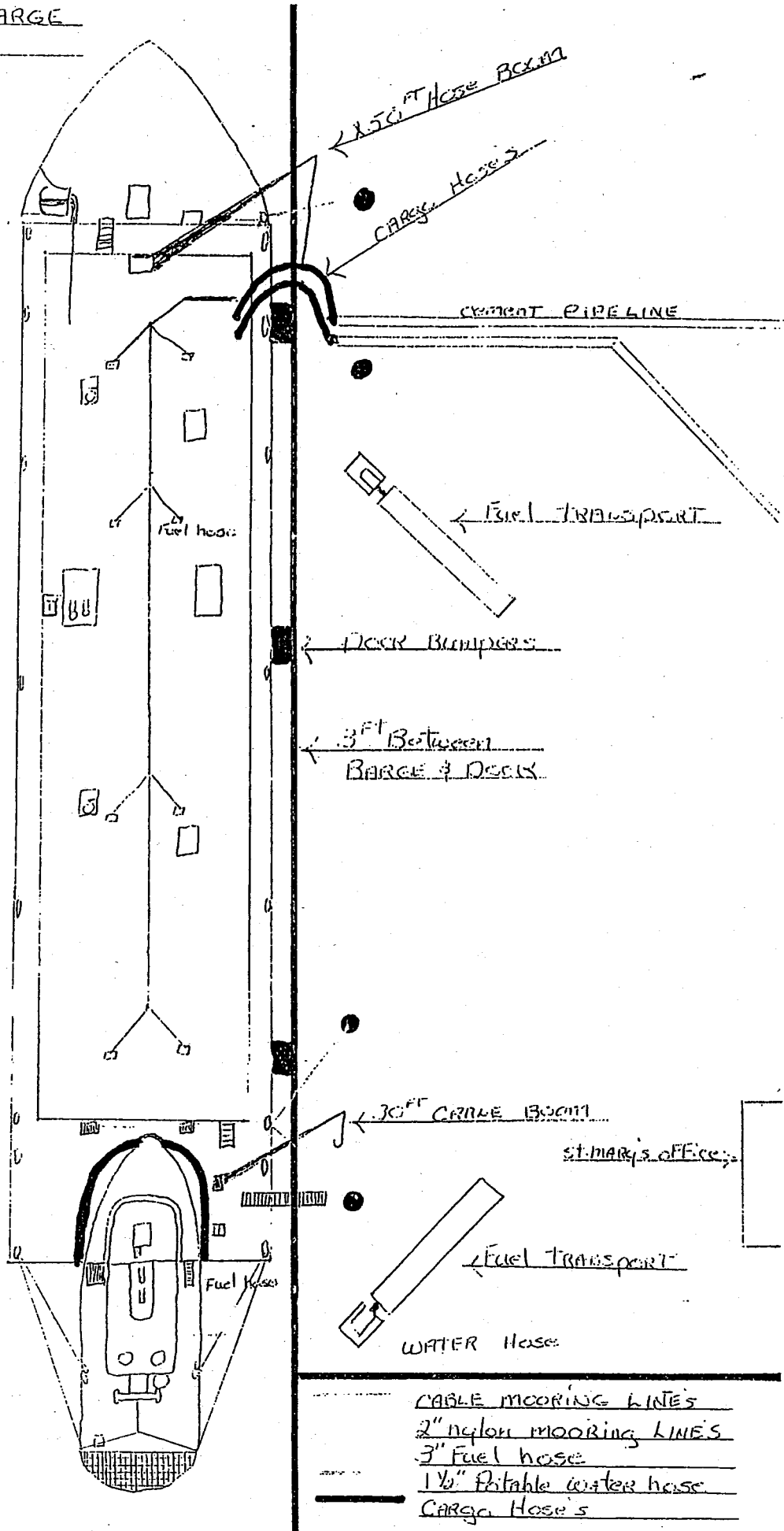

- CABLE MOORING LINES
- 2" NYLON MOORING LINES
- 3" FUEL HOSE
- 1 1/2" POTABLE WATER HOSE
- CARGO HOSES